

SITE PLANS FOR DRAINAGE AND PARKING IMPROVEMENTS FOR

GEORGE R. HANAFORD ELEMENTARY SCHOOL

AP 7 LOT 207
200 MIDDLE ROAD
EAST GREENWICH, RHODE ISLAND

FOR PERMIT ONLY

PROJECT TEAM

OWNER: EAST GREENWICH SCHOOL DEPARTMENT
111 PEIRCE STREET
EAST GREENWICH, RI 02818

ARCHITECT: SACCOCIO & ASSOCIATES, INC.
1085 PARK AVENUE
CRANSTON, RI 02910

CIVIL: JOE CASALI ENGINEERING, INC.
300 POST ROAD
WARWICK, RI 02888
PHONE: 401-944-1300
FAX: 401-944-1313

LOCUS MAP (NOT TO SCALE)

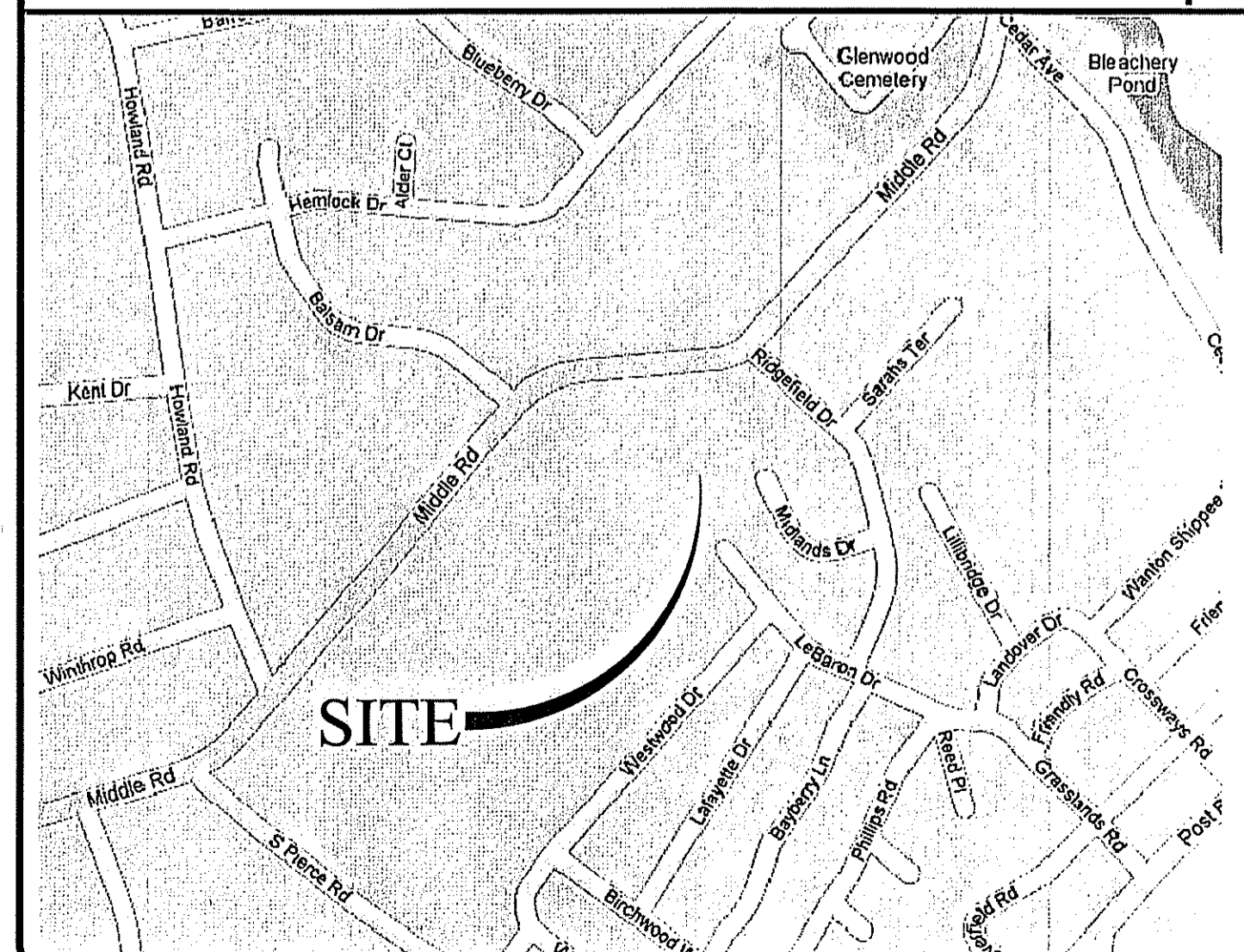

STATE WIDE MAP

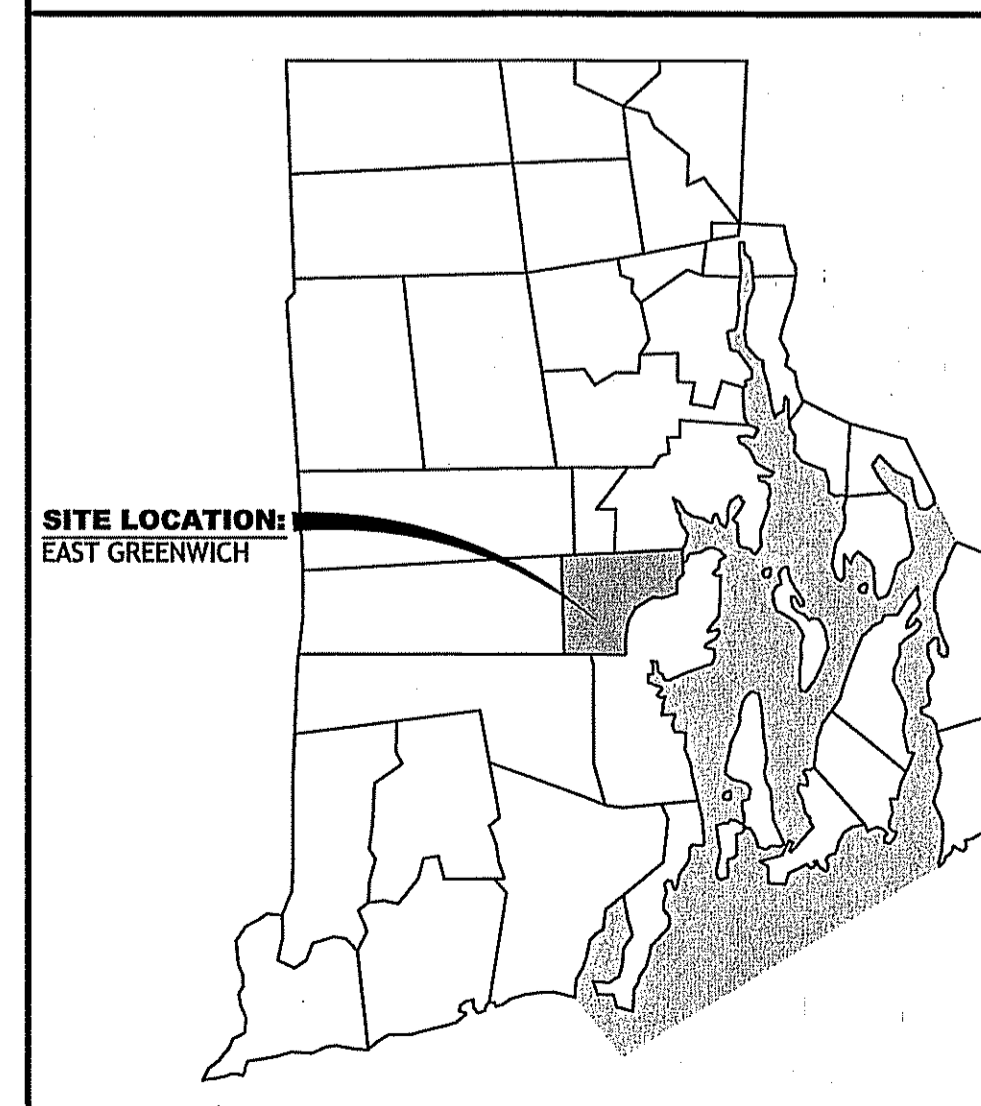

INDEX OF DRAWINGS

SHEET NO.	PLAN
1	COVER SHEET
2	GENERAL NOTES
3	EXISTING CONDITIONS PLAN
4	SITE PLAN
5	GRADING AND DRAINAGE PLAN
6	DETAILS I
7	DETAILS II

Kindly be advised that this
Permit is not equivalent to a
verification of the type or extent
of freshwater wetlands on site.

DEPARTMENT OF ENVIRONMENTAL MANAGEMENT
OFFICE OF WATER RESOURCES
FRESHWATER WETLANDS PROGRAM
APPROVED WITH CONDITIONS
AS SPECIFIED IN THE LETTER OF APPROVAL
DATED MAR 16 2007 FILE # 27-060
NO CHANGES ALLOWED WITHOUT PRIOR APPROVAL.
APPROVED PLANS MUST BE AT CONSTRUCTION SITE.

W. Joseph Cooney

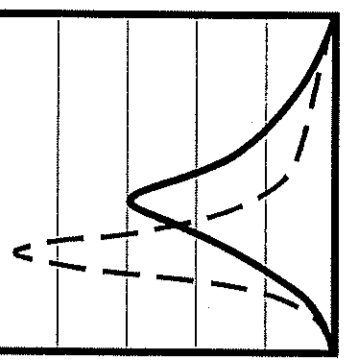

JCE
JOE CASALI ENGINEERING, Inc.
Civil - Site Development - Drainage
Wetlands - Floodplain - ISDS
300 Post Road, Warwick, RI 02888
(401) 944-1300 (401) 944-1313 fax
www.joeCasaliEngineering.com

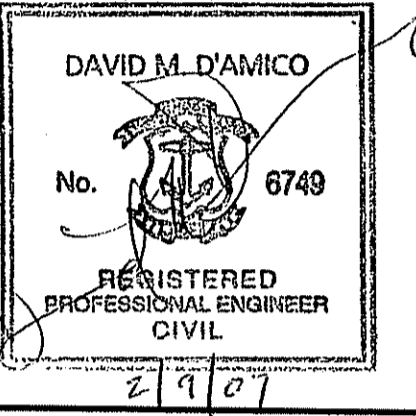

**GEORGE R. HANAFORD
ELEMENTARY SCHOOL
200 MIDDLE ROAD
EAST GREENWICH, RHODE ISLAND**

FEB 12 2007

REVISIONS:

NO.	DATE	DESCRIPTION

DESIGNED BY: GEC / WRA
DRAWN BY: GAH / MRB
CHECKED BY: DMD
DATE: FEBRUARY 2007
PROJECT NO: 05-43e

PRELIMINARY, NOT FOR CONSTRUCTION

COVER SHEET

SHEET 1 OF 7

C:\DOCS\11\hatch\LOCUS-1\Temp\AC-Publish_500\Hanford\Plumest.dwg, Feb. 12, 2007 11:34am

GENERAL NOTES:

- CLASS III TOPOGRAPHIC SURVEY COMPLETED BY JOE CASALI ENGINEERING, Inc., 300 POST ROAD WARWICK, RI IN JANUARY 2007.
- THE LOCATION AND DEPTH OF EXISTING UTILITIES ARE APPROXIMATE AND HAVE BEEN PLOTTED FROM THE LATEST AVAILABLE INFORMATION. THE UTILITY LOCATIONS ARE APPROXIMATE AND MAY NOT BE ALL INCLUSIVE. THE CONTRACTOR SHALL CHECK AND VERIFY THE LOCATIONS OF ALL EXISTING UTILITIES, BOTH OVERHEAD AND UNDERGROUND, AND "DIG-SAFE" MUST BE NOTIFIED PRIOR TO COMMENCING ANY CONSTRUCTION OPERATIONS. RESTORATION AND REPAIR OF DAMAGE TO EXISTING UTILITIES SHALL BE THE RESPONSIBILITY OF THE CONTRACTOR WITH NO ADDITIONAL COST TO THE OWNER. NO EXCAVATION SHALL COMMENCE UNTIL ALL INVOLVED UTILITY COMPANIES AND/OR CITY WHOSE FACILITIES MIGHT BE AFFECTED BY ANY WORK TO BE PERFORMED BY THE CONTRACTOR ARE NOTIFIED AT LEAST 72 HOURS IN ADVANCE.
- THIS SITE LIES IN ZONE - C (DEFINED BY FEMA AS AN AREA OF MINIMAL FLOODING), AS SHOWN ON THE FIRM MAP FOR THE TOWNY OF EAST GREENWICH, RI COMMUNITY PANEL NO. 445397 0002B, MAP REVISED FEBRUARY 16, 1983.
- SOILS EXISTING ON THE SITE ARE MERIMAC URBAN (MU), WALPOLE (Wa), AND SUDBURY (Ss).
- PER THE RHODE ISLAND DEPARTMENT OF ENVIRONMENTAL MANGEMENT, ALL RIVERS, STREAMS AND INTERMITTENT STREAMS HAVE A 100 YEAR FLOODPLAIN.
- THE 100 YEAR FLOODPLAIN WAS DELINEATED BY JOE CASALI ENGINEERING, INC. IN A REPORT TITLED "DRAINAGE ANALYSIS REPORT" FOR HANAFORD ELEMENTRY SCHOOL DATED FEBRUARY 2007.
- WETLANDS WERE DELANATED BY JOE CASALI ENGINEERING, INC. IN DECEMBER 2006.

SITE NOTES:

- CONTRACTOR SHALL BE RESPONSIBLE FOR REMOVING AND LEGALLY DISPOSING (R&D) OF ALL MATERIALS INDICATED ON THE PLANS.
- STOCKPILES OF EARTH MATERIALS SHALL NOT BE LOCATED ADJACENT TO DRAINAGE STRUCTURES.
- ALL DISTURBED AREAS OUTSIDE OF THE PAVED AREAS WILL RECEIVE A MINIMUM OF 6" OF LOAM AND SEED.
- THE CONTRACTOR SHALL PROVIDE AND MAINTAIN SURVEY LAYOUT SERVICES FOR THE WORK AND SHALL SUBMIT "AS-BUILT" DRAWINGS OF ALL WORK, WHICH SHALL BE STAMPED AND CERTIFIED BY A RHODE ISLAND REGISTERED PROFESSIONAL LAND SURVEYOR.
- ANY ITEM OF WORK NOT SPECIFICALLY INDICATED ON THE PLANS BUT IS REQUIRED FOR THE COMPLETE CONSTRUCTION OF THE PROJECT WILL BE CONSIDERED INCIDENTAL TO THE CONTRACT AND INCLUDED IN THE CONTRACT BID PRICE. IT WILL BE THE CONTRACTOR'S RESPONSIBILITY TO VERIFY ALL EXISTING SITE CONDITIONS.
- WHERE NECESSARY TO REMOVE CURBS, CATCH BASINS OR DRAINS TO COMPLETE WORK, THE CONTRACTOR SHALL REPLACE SUCH ITEMS TO THE SATISFACTION OF THE TOWN AT NO ADDITIONAL COST TO THE OWNER OR TOWN. NO CATCH BASINS, DRAINS OR CURBS WILL BE REMOVED WITHOUT FIRST OBTAINING APPROVAL FROM THE TOWN OF EAST GREENWICH.
- ANY EXISTING PIPE OR UTILITY DAMAGED BY THE CONTRACTOR'S OPERATIONS SHALL BE REPAIRED IMMEDIATELY. REPAIRS WILL BE MADE BY WOONSOCKET LICENSED CONTRACTORS AND UNDER THE SUPERVISION OF THE WOONSOCKET ENGINEERING DIVISION AT NO COST TO THE OWNER OR CITY.
- THE CONTRACTOR SHALL RESTORE TO ITS ORIGINAL CONDITION OR REPLACE TREES, SHRUBS, FENCES, SIGNS, GUARDRAILS, DRIVEWAYS, SIDEWALKS AND ANY OTHER OBJECT AFFECTED BY THIS OPERATION.
- THE TOPS OF ALL VALVE BOXES AND CURB BOXES SHALL BE FLUSH WITH GROUND OR PAVEMENT SURFACE LEVEL AND PLUMB, UNLESS OTHERWISE DIRECTED.
- ROADWAYS SHALL BE LEFT PASSABLE AT ALL TIMES. CLOSURE OF ROADWAY IS NOT PERMITTED.
- THE CONTRACTOR SHALL PROVIDE ACCESS TO ALL DRIVEWAYS AT COMPLETION OF EACH DAYS WORK.
- WATER SERVICE SHALL BE MAINTAINED AT ALL TIMES.
- ALL LEDGE TO BE REMOVED BY MECHANICAL MEANS.
- ALL CONSTRUCTION WORK SHALL BE PERFORMED IN THE DRY. THE CONTRACTOR SHALL PROVIDE, OPERATE AND MAINTAIN ALL PUMPS, DRAINS, WET POINTS, SCREENS, OR OTHER FACILITIES NECESSARY TO CONTROL, COLLECT AND DISPOSE OF ALL SURFACE AND SUBSURFACE WATER ENCOUNTERED IN THE PERFORMANCE OF THE WORK.
- REFER TO ELECTRICAL PLANS FOR PROPOSED LIGHTING.
- ALL PROPOSED PAVEMENT MARKINGS SHALL BE 4" WHITE OIL BASE PAINT.

MISCELLANEOUS UTILITY NOTES:

- PRIOR TO CONSTRUCTION ALL POTENTIAL UTILITY/DRAINAGE CONFLICTS MUST BE IDENTIFIED BY THE CONTRACTOR. ANY MODIFICATIONS TO THE PROPOSED UTILITIES TO AVOID CONFLICTS MUST BE APPROVED BY THE ENGINEER PRIOR TO CONSTRUCTION. NO EXTRA PAYMENT TO THE CONTRACTOR DUE TO RELOCATION'S WILL BE AUTHORIZED.
- THE UTILITY PLAN DOES NOT DEPICT THE NECESSARY ELECTRICAL CONDUIT/WIRING TO SERVICE THE PROPOSED LIGHTING.
- OVERHEAD ELECTRIC AND TELEPHONE SERVICES ARE PRESENT ON SITE AND SHOWN ON PLANS. THE CONTRACTOR SHALL MAKE THEMSELVES AWARE OF OVERHEAD WIRES LOCATIONS BEFORE CONSTRUCTION.
- THE CONTRACTOR SHALL AT ALL TIMES PROVIDE A SUFFICIENT NUMBER OF WORKMEN AND GUARDS AS MAY BE NECESSARY TO PROPERLY SAFEGUARD THE PUBLIC FROM THEIR OPERATIONS.
- THE CONTRACTOR SHALL TAKE PRECAUTIONS AGAINST DAMAGING OF PAVING, SIDEWALKS, UTILITIES, OR PRIVATE PROPERTIES AND SHALL PROMPTLY REPAIR AT HIS OWN EXPENSE ANY DAMAGE TO SUCH PAVING, SIDEWALKS, UTILITIES, OR PRIVATE PROPERTIES TO THE SATISFACTION OF THE OWNER OR CITY.
- EXISTING UTILITY FRAMES AND COVERS FOR SANITARY SEWER, WATER, GAS, STORM DRAINAGE AND OTHER UTILITIES SHALL BE ADJUSTED TO GRADE AS REQUIRED IN NEW PAVING AND PAVEMENT OVERLAY AREAS.

LAYOUT NOTE:

THE LAYOUT SHOWN REPRESENTS A GRAPHICAL DESIGN, AND PRIOR TO THE CONSTRUCTION, THE CONTRACTOR SHALL ENGAGE A PROFESSIONAL LAND SURVEYOR (PLS) REGISTERED IN THE STATE OF RHODE ISLAND TO SET AND VERIFY ALL LINES AND GRADES. ALL EXISTING UTILITY LOCATIONS AND ELEVATIONS ARE TO BE CONFIRMED BY THE CONTRACTOR PRIOR TO CONSTRUCTION. ANY ITEMS FOUND WHICH DO NOT MATCH THE PLANS MUST BE BROUGHT TO THE ENGINEER'S ATTENTION PRIOR TO CONSTRUCTION FOR REVIEW. NO WORK SHALL PROCEED UNTIL AUTHORIZED BY THE ENGINEER.

MAINTENANCE AND PROTECTION OF TRAFFIC NOTES:

- THE CONTRACTOR SHALL BE RESPONSIBLE FOR ALL MAINTENANCE AND PROTECTION OF PEDESTRIAN AND VEHICULAR TRAFFIC INCLUDING POLICE PROTECTION. ALL TEMPORARY AND VEHICULAR SIGNS, BARRICADES AND LANE CLOSURES SHALL BE IN CONFORMANCE WITH THE LATEST REVISIONS OF MANUAL OF UNIFORM TRAFFIC CONTROL DEVICES (M.U.T.C.D.)
- TEMPORARY CONSTRUCTION SIGNS AND ALL APPLICABLE TRAFFIC CONTROL DIVIDES SHALL BE IN PLACE PRIOR TO THE START OF WORK IN ANY AREA OPEN TO TRAFFIC.
- THE PRIVATE VEHICLES OF CONSTRUCTION WORKERS SHALL NOT BE PARKED IN THE STATE OR CITY/TOWN RIGHT-OF-WAY.
- ALL MAINTENANCE AND PROTECTION OF TRAFFIC CONTROL SETUPS, SIGNS CHANNELING DEVICES, ETC. SHALL BE IN ACCORDANCE WITH THE MANUAL OF UNIFORM TRAFFIC CONTROL DEVICES. 1988 EDITION, INCLUDING REVISION 3, SEPTEMBER 3, 1993 AND SUBSEQUENT ADDENDA.
- SIGN MOUNTINGS SHALL BE IN ACCORDANCE WITH THE R.I.D.O.T. SPECIFICATIONS FOR TEMPORARY CONSTRUCTION SIGNS.

DRAINAGE SYSTEM MAINTENANCE SCHEDULE:

UPON PROJECT COMPLETION, THE PROPERTY OWNER SHALL ADHERE TO THE FOLLOWING MAINTENANCE PLAN AND SCHEDULE. THE MAINTENANCE SCHEDULE SHALL ALSO BE FILED IN THE TOWNS CLERKS OFFICE.

- CATCH BASINS, MANHOLES AND DRAIN LINES** ---AN INSPECTION MUST OCCUR ON AN ANNUAL BASIS BY QUALIFIED PERSONNEL TO ENSURE PROPER OPERATION. THE INSPECTION SHOULD, AS A MINIMUM, CONCENTRATE ON THE FOLLOWING:
 - * DAMAGE TO GRATE/ COVERS
 - * EVIDENCE OF STANDING WATER
 - * DEBRIS REMOVAL
 - * STRUCTURAL ALIGNMENT/ INTEGRITY

ANY DEFICIENCY NOTED DURING THE INSPECTION WILL BE IMMEDIATELY REPAIRED OR REPLACED.

- SEDIMENT REMOVAL** ---ALL REMOVED SEDIMENT IS TO BE TESTED TO DETERMINE POLLUTANT CONTENT. THE SEDIMENT IS TO BE PROPERLY DISPOSED IN UPLAND AREAS BASED UPON THE TEST RESULTS AND LOCAL, STATE, AND FEDERAL REGULATIONS. SEDIMENT TO BE REMOVED ANNUALLY.

DRAINAGE SYSTEM NOTES:

- THE PROPOSED DRAINAGE LINES SHALL BE DUCTILE IRON OR ADS N-12 HDPE OR AN APPROVED EQUAL AS INDICATED ON THE PLANS.
- THE DESIGN ENGINEER MUST SUBMIT AN AS BUILT PLAN AND A CERTIFICATION TO THE TOWN ENGINEER THAT THE CONSTRUCTION IS IN COMPLIANCE WITH THE DESIGN PLANS FOR ALL ELEMENTS OF THE STORM OR DRAINAGE SYSTEM PRIOR TO THE ISUANCE OF THE CERTIFICATE OF OCCUPANCY.

PROPOSED PAVEMENT STRUCTURE:(PVMT A) FOR PARENT / STUDENT DROP-OFF

- 1 1/2" BITUMINOUS CONCRETE SURFACE COURSE CLASS I-1
 - 1 1/2" BITUMINOUS CONCRETE BINDER COURSE
 - 12" GRAVEL BORROW SUBBASE
- ASPHALT EMULSION TACK COAT TO BE PLACED PRIOR TO SURFACE COURSE PAVING IF INTERMEDIATE COURSE IS OPENED TO VEHICULAR USE, OR IF INTERMEDIATE COURSE IS GREATER THAN 30 DAYS OLD.

PROPOSED PAVEMENT STRUCTURE:(PVMT B) FOR FOR EXISTING DRIVEWAY AND PARKING AREAS

- 1 1/2" COLD PLANE OF EXISTING PAVEMENT. (LEVEL ANY AREAS WHERE NEEDED BEFORE FINAL PAVING OPERATIONS)
- 1 1/2" BITUMINOUS CONCRETE SURFACE COURSE OVERLAY

EROSION CONTROL & SOIL STABILIZATION PROGRAM

- DENUDED SLOPES SHALL NOT BE LEFT UNATTENDED OR EXPOSED FOR EXCESSIVE PERIODS OF TIME SUCH AS THE INACTIVE WINTER SEASON.
- SEED, LOAM AND HAY DISTURBED ARAES WITH LAWN GRASS.
- HAY OR STRAW APPLICATIONS SHOULD BE IN THE AMOUNT OF 3,000 - 4,000 LBS. PER ACRE.
- STABILIZATION OF ONE FORM OR ANOTHER AS DESCRIBED ABOVE SHALL BE ACHIEVED IMMEDIATELY AFTER FINAL GRADING.
- REFERENCE THE SEDIMENTATION CONTROL PROGRAM AND THE ORDER OF PROCEDURE FOR PROPER COORDINATION.

SEDIMENTATION CONTROL PROGRAM

- EXTREME CARE SHALL BE EXERCISED SO AS TO PREVENT ANY UNSUITABLE MATERIAL FROM ENTERING THE WETLANDS.
- ALL DISTURBED AREAS SUBJECT TO EROSION TENDENCIES WHETHER THEY ARE NEWLY FILLED OR EXCAVATED, SHALL RECEIVE SUITABLE SLOPE PROTECTION.
- DURING CONSTRUCTION, THE CONTRACTOR AND/OR DEVELOPER SHALL BE RESPONSIBLE FOR MAINTAINING DRAINAGE AND RUNOFF DURING STORMS AND PERIODS OF RAINFALL.
- SEDIMENTATION CONTROL DEVICES SHALL BE INSPECTED PERIODICALLY AND AFTER PERIODS OF RAINFALL. SUCH DEVICES SHALL BE REPAIRED OR REPLACED AS NEEDED.
- REFERENCE THE "RHODE ISLAND EROSION AND SEDIMENT CONTROL HANDBOOK" PREPARED BY THE U.S. DEPT. OF AGRICULTURE, SOIL CONSERVATION SERVICE 1989, AS A GUIDE.

SOIL EROSION AND SEDIMENTATION CONTROL NOTES

- THE LIMITS OF CLEARING, GRADING, AND DISTURBANCE SHALL BE KEPT TO A MINIMUM WITHIN THE PROPOSED AREA OF CONSTRUCTION. ALL AREAS OUTSIDE OF THESE LIMITS, AS DEPICTED ON THE PLAN SHALL BE TOTALLY UNDISTURBED, TO REMAIN IN NATURAL CONDITION.
- ALL DISTURBED SLOPES EITHER NEWLY CREATED OR CURRENTLY EXPOSED SHALL BE SEEDED, PROTECTED AND MAINTAINED BY THE CONTRACTOR. THE CONTRACTOR SHALL REGULARLY CHECK ALL SEEDED AREAS TO ENSURE THAT A GOOD STAND IS MAINTAINED.
- ALL TEMPORARY EROSION PROTECTION SHALL BE MAINTAINED BY THE CONTRACTOR THROUGHOUT CONSTRUCTION AND SHALL REMAIN IN PLACE UNTIL AN ACCEPTABLE STAND OF GRASS OR APPROVED GROUND COVER IS ESTABLISHED.
- THE EROSION CONTROL MEASURES SHALL BE CHECKED BY THE CONTRACTOR ON A WEEKLY BASIS AND AFTER EACH STORM FOR UNDERMINING OR DETERIORATION. THE CONTRACTOR SHALL REPAIR OR REPLACE ANY SILT FENCE AS NEEDED. THE CONTRACTOR SHALL CLEAN THE ACCUMULATED SEDIMENT IF HALF OF THE ORIGINAL HEIGHT OF THE SILT FENCE BECOMES FILLED WITH SEDIMENTS.
- IT SHALL BE THE RESPONSIBILITY OF THE CONTRACTOR TO MAINTAIN ALL SOIL EROSION AND SEDIMENT CONTROLS ON THE PROJECT SITE FOR THE ENTIRE DURATION OF THE CONSTRUCTION PERIOD. THE CONTRACTOR SHALL FOLLOW THE DIRECTION OF THE RESIDENT ENGINEER WITH REGARD TO INSTALLATION, MAINTENANCE, AND REPAIR OF ALL SOIL EROSION AND SEDIMENTATION CONTROLS ON THE PROJECT SITE. TEMPORARY SOIL EROSION AND SEDIMENTATION CONTROLS (HAYBALES, SILT FENCE, ETC.) SHALL BE MAINTAINED UNTIL ALL EXPOSED SOILS ARE SATISFACTORILY STABILIZED. THE CONTRACTOR SHALL BE RESPONSIBLE FOR REPAIRING AND/OR RESEEDING ALL AREAS THAT DO NOT DEVELOP WITHIN ONE YEAR FROM THE COMPLETION OF CONSTRUCTION.
- ALL REFERENCED SOIL EROSION AND SEDIMENTATION CONTROLS INCLUDING MATERIALS USED, APPLICATION RATES AND THE INSTALLATION PROCEDURES SHALL BE PERFORMED PER THE "RHODE ISLAND EROSION AND SEDIMENTATION HANDBOOK", DATED 1993.

BMP MAINTENANCE SCHEDULE

- ALL MAINTENANCE (INCLUDING CLEANING) REQUIRED DURING THE CONSTRUCTION PHASE OF THE PROJECT SHALL BE THE RESPONSIBILITY OF THE CONTRACTOR UNTIL INSPECTED AND ACCEPTED BY THE CITY ENGINEER. CONTRACTOR'S RESPONSIBILITIES INCLUDE BUT ARE NOT LIMITED TO THE FOLLOWING:
 - MEASURES NEEDED TO ENSURE THE PROPER OPERATION OF THE STORMWATER DRAINAGE SYSTEMS AND WATER QUALITY CONTROL SYSTEMS TO INCLUDE INSPECTION, CLEANING AND REPAIRS TO ALL PIPES, INTAKE AND DISCHARGE STRUCTURES (INCLUDING RIP-RAP SPLASH PADS), CATCH BASIN SUMPS, AND MANHOLES.
 - INSPECTION OF ALL SLOPES, BERMS, AND OTHER CONTROL STRUCTURES (INCLUDING ROADWAY SIDE SLOPES, FOR STRUCTURAL INTEGRITY, STABILITY AND EVIDENCE OF SOIL EROSION, SHALL INCLUDE MAINTENANCE OF THESE STRUCTURES IF NECESSARY. INSPECTIONS SHALL BE PERFORMED FOLLOWING ALL RAIN EVENTS OF 1/4 INCH RAINFALL OR MORE IN A 24-HOUR PERIOD, OR BIMONTHLY IF NO RAINFALL EVENT OCCURS.
 - FOLLOWING THE CONSTRUCTION OF A SWALE, ALL DISTURBED AREAS WITHIN THE VICINITY OF A SWALE SHALL BE SEEDED AND STABILIZED IMMEDIATELY UPON COMPLETION OF THEIR CONSTRUCTION TO PREVENT EROSION.
 - UPON COMPLETION OF PROJECT CONSTRUCTION, AND PRIOR TO VACATING THE SITE, THE CONTRACTOR SHALL CONDUCT A FINAL INSPECTION, REPAIR ANY VEGETATIVE SOIL EROSION AND SEDIMENTATION CONTROL MEASURES, (SEEDING, PLANTING, ETC.) WHERE REQUIRED, AND REPAIR (OR REMOVE WHERE APPROPRIATE) ANY TEMPORARY SOIL EROSION AND SEDIMENTATION CONTROL DEVICES. AFTER PERMANENT SOIL STABILIZATION ON THE ENTIRE SITE HAS OCCURRED, ALL TEMPORARY CONTROL MEASURES MUST BE REMOVED.
- AFTER THE COMPLETION OF PROJECT CONSTRUCTION AND THE FINAL STABILIZATION OF THE ENTIRE SITE, THE INSPECTION AND MAINTENANCE OF ALL STORMWATER FACILITIES MUST BE PERFORMED BY THE CITY. THE CITY'S RESPONSIBILITIES SHALL INCLUDE, BUT NOT BE LIMITED TO THE FOLLOWING:
 - REPLANTING, REGRADING, OR OTHER REPAIRS NEEDED AS A RESULT OF SOIL EROSION AND SEDIMENTATION PROCESSES SHALL BE DONE PROMPTLY TO ENSURE PROPER FUNCTIONING OF THE ENTIRE SYSTEM.
 - ANY TRASH, DEBRIS, ETC. SHOULD BE REMOVED FROM ANY WETLAND AREAS, SWALE, AND PIPE OUTLETS.
 - SWALES SHALL BE MOWED AT LEAST ONCE DURING THE GROWING SEASON TO PREVENT UNWANTED WOODY GROWTH.
 - SWALES SHALL BE INSPECTED AFTER MAJOR STORM EVENTS OR ON AN ANNUAL BASIS. REPAIRS SHALL BE PERFORMED IMMEDIATELY AS CONDITIONS WARRANT. BARE SPOTS AND ERODED AREAS SHALL BE RESEDED IMMEDIATELY FOLLOWING OBSERVATIONS. ALL LITTER AND TRASH SHALL BE REMOVED DURING INSPECTIONS.
- SIDESLOPE AND EMBANKMENTS SHALL BE MOWED AT LEAST ONCE DURING THE GROWING SEASON, MOWING CAN BE MORE FREQUENT. ALL TRASH AND LITTER SHALL BE REMOVED DURING MOWING OPERATIONS.

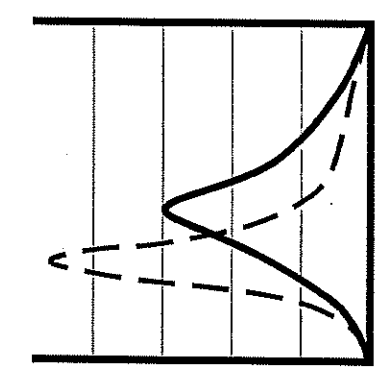

JCE
JOE CASALI ENGINEERING, Inc.
 Civil - Site Development - Drainage
 Wetlands - Floodplain - ISDS
 300 Post Road, Warwick, RI 02888
 (401) 944-1300 (401) 944-1313 fax
 www.joeCasaliEngineering.com

DAVID M. D'AMICO
 No. 6749
 REGISTERED PROFESSIONAL ENGINEER
 CIVIL
 2/9/07

**GEORGE R. HANAFORD
 ELEMENTARY SCHOOL**
 200 MIDDLE ROAD
 EAST GREENWICH, RHODE ISLAND

FEB 12 2007

NO.	DATE	DESCRIPTION

DESIGNED BY: GEC / WRA
 DRAWN BY: GAH / MRB
 CHECKED BY: DMD
 DATE: FEBRUARY 2007
 PROJECT NO: 05-43e

PRELIMINARY, NOT FOR CONSTRUCTION

GENERAL NOTES

SHEET 2 OF 7

Kindly be advised that this Permit is not equivalent to a verification of the type or extent of freshwater wetlands on site.

DEPARTMENT OF ENVIRONMENTAL MANAGEMENT
 OFFICE OF WATER RESOURCES
 FRESHWATER WETLANDS PROGRAM
 APPROVED WITH CONDITIONS
 AS SPECIFIED IN THE LETTER OF APPROVAL
 DATED MAR 16 2007 FILE # 07-0060
 NO CHANGES ALLOWED WITHOUT PRIOR APPROVAL
 APPROVED PLANS MUST BE AT CONSTRUCTION SITE.

W. Joseph Casey

C:\DOCLINE\1\ghatchen\LOCALS-1\Temp\Ac\N\10\hanaford\Element.dwg Feb. 12, 2007 11:24am

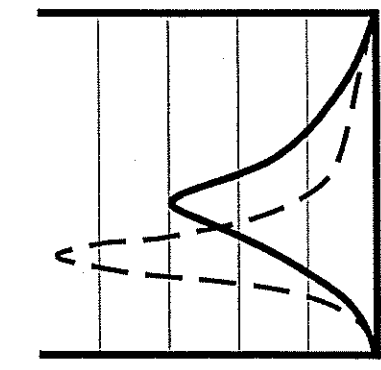

JCE
JOE CASALI ENGINEERING, Inc.
 Civil - Site Development - Drainage
 Wetlands - Floodplain - ISDS
 300 Park St., Warwick, RI 02888
 (401) 844-3300 (401) 844-1313 fax
 www.joecasalienr.com

DAVID M. D'AMICO
 No. 6749
 REGISTERED PROFESSIONAL ENGINEER
 CIVIL
 2/9/07

**GEORGE R. HANAFORD
 ELEMENTARY SCHOOL**
 200 MIDDLE ROAD
 EAST GREENWICH, RHODE ISLAND

FEB 12 2007

REVISIONS:

NO.	DATE	DESCRIPTION

DESIGNED BY: GEC / WRA
 DRAWN BY: GAH / MRB
 CHECKED BY: DMD
 DATE: FEBRUARY 2007
 PROJECT NO: 05-43e

PRELIMINARY, NOT FOR CONSTRUCTION

EXISTING CONDITIONS PLAN

SHEET 3 OF 7

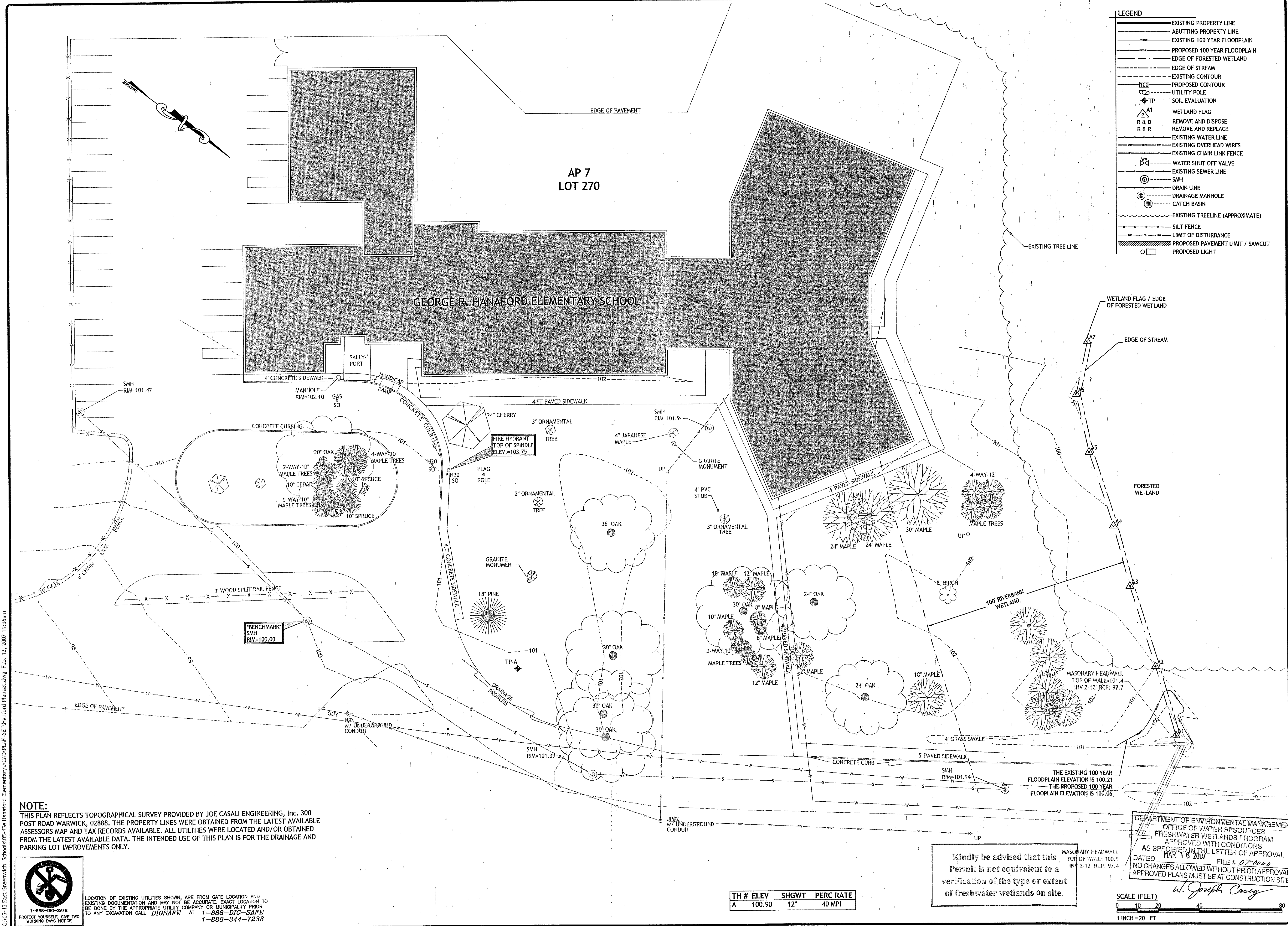

NOTE:
 THIS PLAN REFLECTS TOPOGRAPHICAL SURVEY PROVIDED BY JOE CASALI ENGINEERING, Inc. 300 POST ROAD WARWICK, 02888. THE PROPERTY LINES WERE OBTAINED FROM THE LATEST AVAILABLE ASSESSORS MAP AND TAX RECORDS AVAILABLE. ALL UTILITIES WERE LOCATED AND/OR OBTAINED FROM THE LATEST AVAILABLE DATA. THE INTENDED USE OF THIS PLAN IS FOR THE DRAINAGE AND PARKING LOT IMPROVEMENTS ONLY.

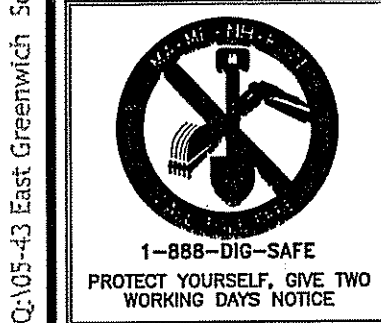

LOCATION OF EXISTING UTILITIES SHOWN, ARE FROM GATE LOCATION AND EXISTING DOCUMENTATION AND MAY NOT BE ACCURATE. EXACT LOCATION TO BE DONE BY THE APPROPRIATE UTILITY COMPANY OR MUNICIPALITY PRIOR TO ANY EXCAVATION CALL **DIGSAFE** AT 1-888-DIG-SAFE
 PROTECT YOURSELF, GIVE TWO WORKING DAYS NOTICE 1-888-344-7233

TH #	ELEV	SHGWT	PERC RATE
A	100.90	12"	40 MPI

Kindly be advised that this Permit is not equivalent to a verification of the type or extent of freshwater wetlands on site.

DEPARTMENT OF ENVIRONMENTAL MANAGEMENT
 OFFICE OF WATER RESOURCES
 FRESHWATER WETLANDS PROGRAM
 APPROVED WITH CONDITIONS
 AS SPECIFIED IN THE LETTER OF APPROVAL
 DATED **MAR 16 2007**
 FILE # **07-060**
 NO CHANGES ALLOWED WITHOUT PRIOR APPROVAL
 APPROVED PLANS MUST BE AT CONSTRUCTION SITE

W. Joseph Casey

SCALE (FEET)
 0 10 20 40 80
 1 INCH = 20 FT

C:\05-43 East Greenwich - School\05-43e Hanaford Elementary\AC\05-43e Hanaford Elementary.dwg, Feb. 12, 2007 11:26am

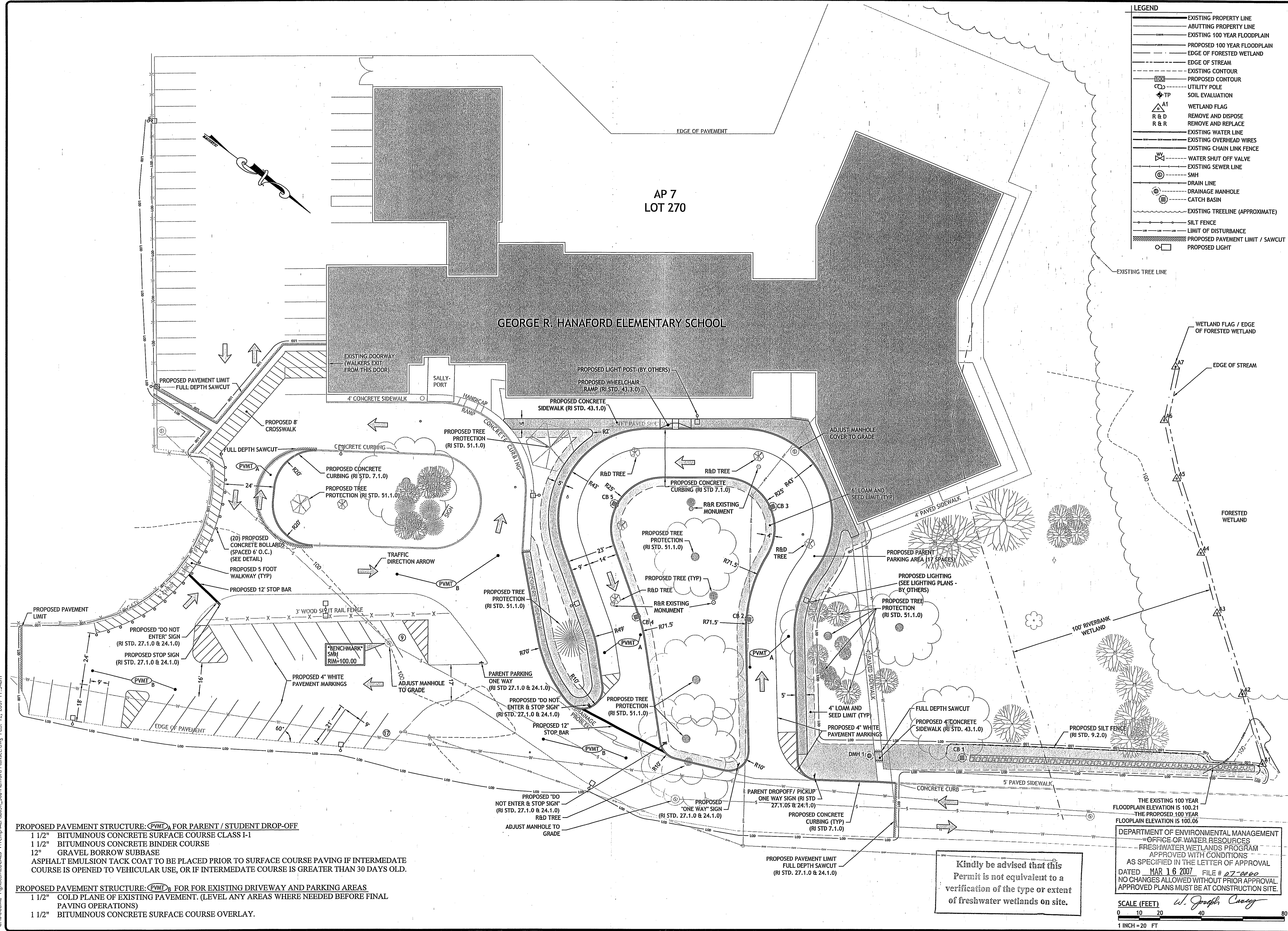

LEGEND

- EXISTING PROPERTY LINE
- ABUTTING PROPERTY LINE
- EXISTING 100 YEAR FLOODPLAIN
- - - PROPOSED 100 YEAR FLOODPLAIN
- - - EDGE OF FORESTED WETLAND
- - - EDGE OF STREAM
- - - EXISTING CONTOUR
- - - PROPOSED CONTOUR
- UTILITY POLE
- △ TP SOIL EVALUATION
- △ A1 WETLAND FLAG
- R & D REMOVE AND DISPOSE
- R & R REMOVE AND REPLACE
- EXISTING WATER LINE
- EXISTING OVERHEAD WIRES
- EXISTING CHAIN LINK FENCE
- ⊗ WATER SHUT OFF VALVE
- EXISTING SEWER LINE
- ⊙ SMH
- DRAIN LINE
- ⊙ DRAINAGE MANHOLE
- ⊙ CATCH BASIN
- - - EXISTING TREELINE (APPROXIMATE)
- - - SILT FENCE
- - - LIMIT OF DISTURBANCE
- PROPOSED PAVEMENT LIMIT / SAWCUT
- PROPOSED LIGHT

JCE
JOE CASALI ENGINEERING, Inc.
 Civil - Site Development - Drainage
 Wetlands - Floodplain - ISDS
 300 Post Road, Warwick, RI 02889
 (401) 944-1300 (401) 944-1313 fax
 www.joecasalengineering.com

DAVID M. D'AMICO
 No. 6749
 REGISTERED PROFESSIONAL ENGINEER CIVIL
 2/9/07

**GEORGE R. HANAFORD
 ELEMENTARY SCHOOL**
 200 MIDDLE ROAD
 EAST GREENWICH, RHODE ISLAND

FEB 12 2007

REVISIONS:

NO.	DATE	DESCRIPTION

DESIGNED BY: GEC / WRA
 DRAWN BY: GAH / MRB
 CHECKED BY: DMJ
 DATE: FEBRUARY 2007
 PROJECT NO: 05-43e

PRELIMINARY, NOT FOR CONSTRUCTION

SITE PLAN

SHEET 4 OF 7

PROPOSED PAVEMENT STRUCTURE: (PVMT) A FOR PARENT / STUDENT DROP-OFF
 1 1/2" BITUMINOUS CONCRETE SURFACE COURSE CLASS 1-1
 1 1/2" BITUMINOUS CONCRETE BINDER COURSE
 12" GRAVEL BORROW SUBBASE
 ASPHALT EMULSION TACK COAT TO BE PLACED PRIOR TO SURFACE COURSE PAVING IF INTERMEDIATE COURSE IS OPENED TO VEHICULAR USE, OR IF INTERMEDIATE COURSE IS GREATER THAN 30 DAYS OLD.

PROPOSED PAVEMENT STRUCTURE: (PVMT) B FOR EXISTING DRIVEWAY AND PARKING AREAS
 1 1/2" COLD PLANE OF EXISTING PAVEMENT. (LEVEL ANY AREAS WHERE NEEDED BEFORE FINAL PAVING OPERATIONS)
 1 1/2" BITUMINOUS CONCRETE SURFACE COURSE OVERLAY.

Kindly be advised that this Permit is not equivalent to a verification of the type or extent of freshwater wetlands on site.

THE EXISTING 100 YEAR FLOODPLAIN ELEVATION IS 100.21
 THE PROPOSED 100 YEAR FLOODPLAIN ELEVATION IS 100.06

DEPARTMENT OF ENVIRONMENTAL MANAGEMENT
 OFFICE OF WATER RESOURCES
 FRESHWATER WETLANDS PROGRAM
 APPROVED WITH CONDITIONS
 AS SPECIFIED IN THE LETTER OF APPROVAL
 DATED MAR 16 2007 FILE # 07-0000
 NO CHANGES ALLOWED WITHOUT PRIOR APPROVAL.
 APPROVED PLANS MUST BE AT CONSTRUCTION SITE.

SCALE (FEET) 1" = 20' FT

C:\DOCU-1\hatch\LOCALS-1\Temp\AcPublish_500\Hanford Planset.dwg Feb. 12, 2007 11:33am

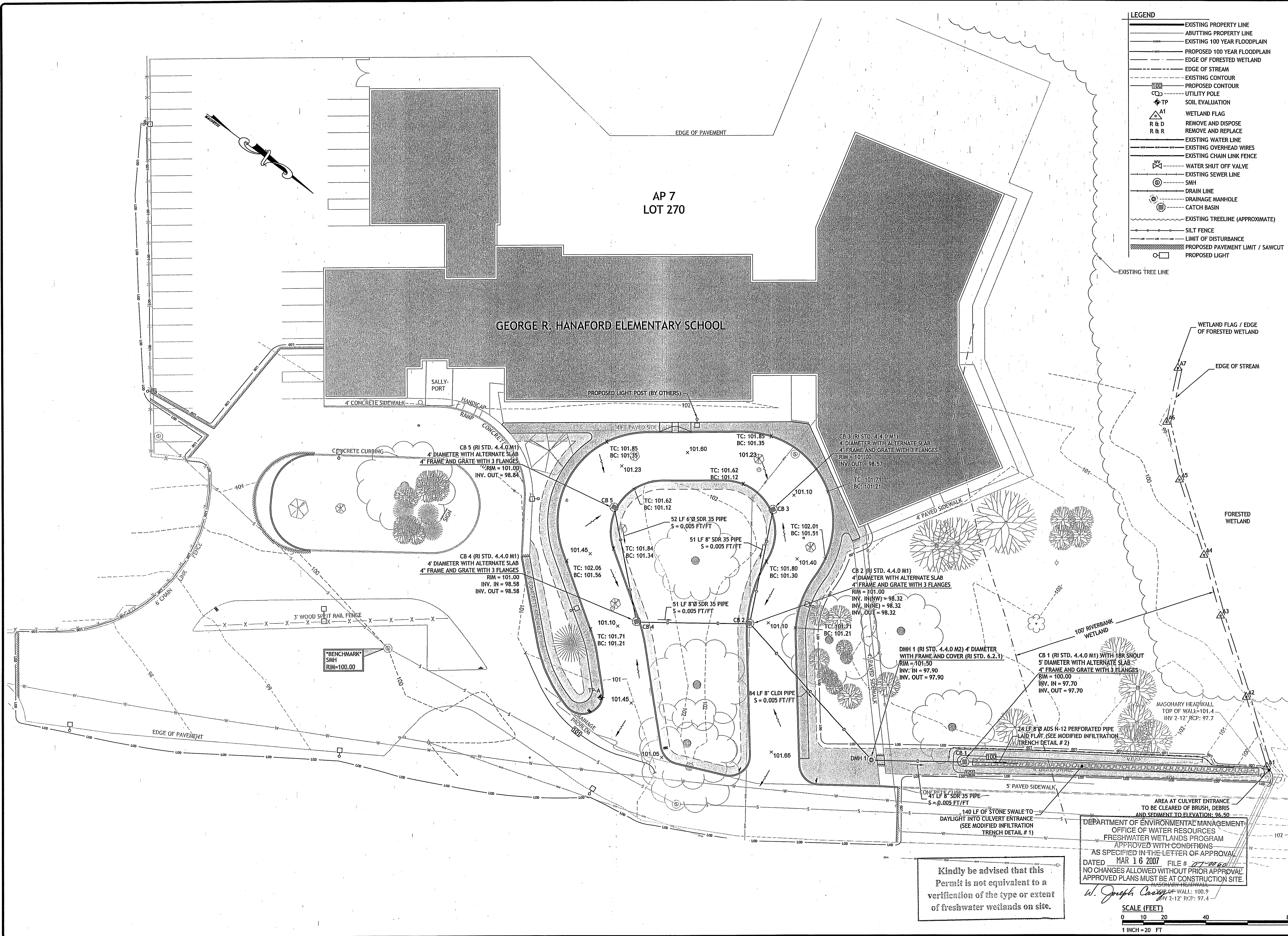

- LEGEND**
- EXISTING PROPERTY LINE
 - ABUTTING PROPERTY LINE
 - EXISTING 100 YEAR FLOODPLAIN
 - PROPOSED 100 YEAR FLOODPLAIN
 - EDGE OF FORESTED WETLAND
 - EDGE OF STREAM
 - EXISTING CONTOUR
 - PROPOSED CONTOUR
 - UTILITY POLE
 - TP
 - A1
 - R & D
 - R & R
 - EXISTING WATER LINE
 - EXISTING OVERHEAD WIRES
 - EXISTING CHAIN LINK FENCE
 - WATER SHUT OFF VALVE
 - EXISTING SEWER LINE
 - SMH
 - DRAIN LINE
 - DRAINAGE MANHOLE
 - CATCH BASIN
 - EXISTING TREELINE (APPROXIMATE)
 - SILT FENCE
 - LIMIT OF DISTURBANCE
 - PROPOSED PAVEMENT LIMIT / SAWCUT
 - PROPOSED LIGHT

JCE
JOE CASALI ENGINEERING, Inc.
 Civil - Site Development - Drainage
 Wetlands - Floodplain - ISDS
 300 Post Road, Warwick, RI 02888
 (401) 944-1300 (401) 944-1315 fax
 www.jce-engineering.com

DAVID M. D'AMICO
 No. 6749
 REGISTERED PROFESSIONAL ENGINEER
 CIVIL
 2/1/07

**GEORGE R. HANAFORD
 ELEMENTARY SCHOOL**
 200 MIDDLE ROAD
 EAST GREENWICH, RHODE ISLAND
 FEB 12 2007

REVISIONS:

NO.	DATE	DESCRIPTION

DESIGNED BY: GEC/WRA
 DRAWN BY: GAH/MRB
 CHECKED BY: DMD
 DATE: FEBRUARY 2007
 PROJECT NO: 05-43e

PRELIMINARY, NOT FOR CONSTRUCTION

GRADING AND DRAINAGE PLAN

SHEET 5 OF 7

Kindly be advised that this Permit is not equivalent to a verification of the type or extent of freshwater wetlands on site.

AREA AT CULVERT ENTRANCE TO BE CLEARED OF BRUSH, DEBRIS AND SEDIMENT TO ELEVATION: 96.50
 DEPARTMENT OF ENVIRONMENTAL MANAGEMENT
 OFFICE OF WATER RESOURCES
 FRESHWATER WETLANDS PROGRAM
 APPROVED WITH CONDITIONS
 AS SPECIFIED IN THE LETTER OF APPROVAL
 DATED MAR 16 2007 FILE # 07-0060
 NO CHANGES ALLOWED WITHOUT PRIOR APPROVAL
 APPROVED PLANS MUST BE AT CONSTRUCTION SITE.
 W. Joseph Casali

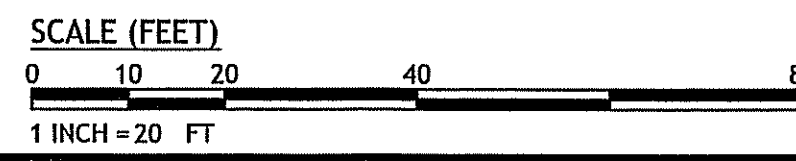

C:\DOCUME~1\jchachal\LOCALS~1\Temp\Acad\blsh_5000\Hanford Plans\sh.dwg, Feb. 12, 2007 11:34am

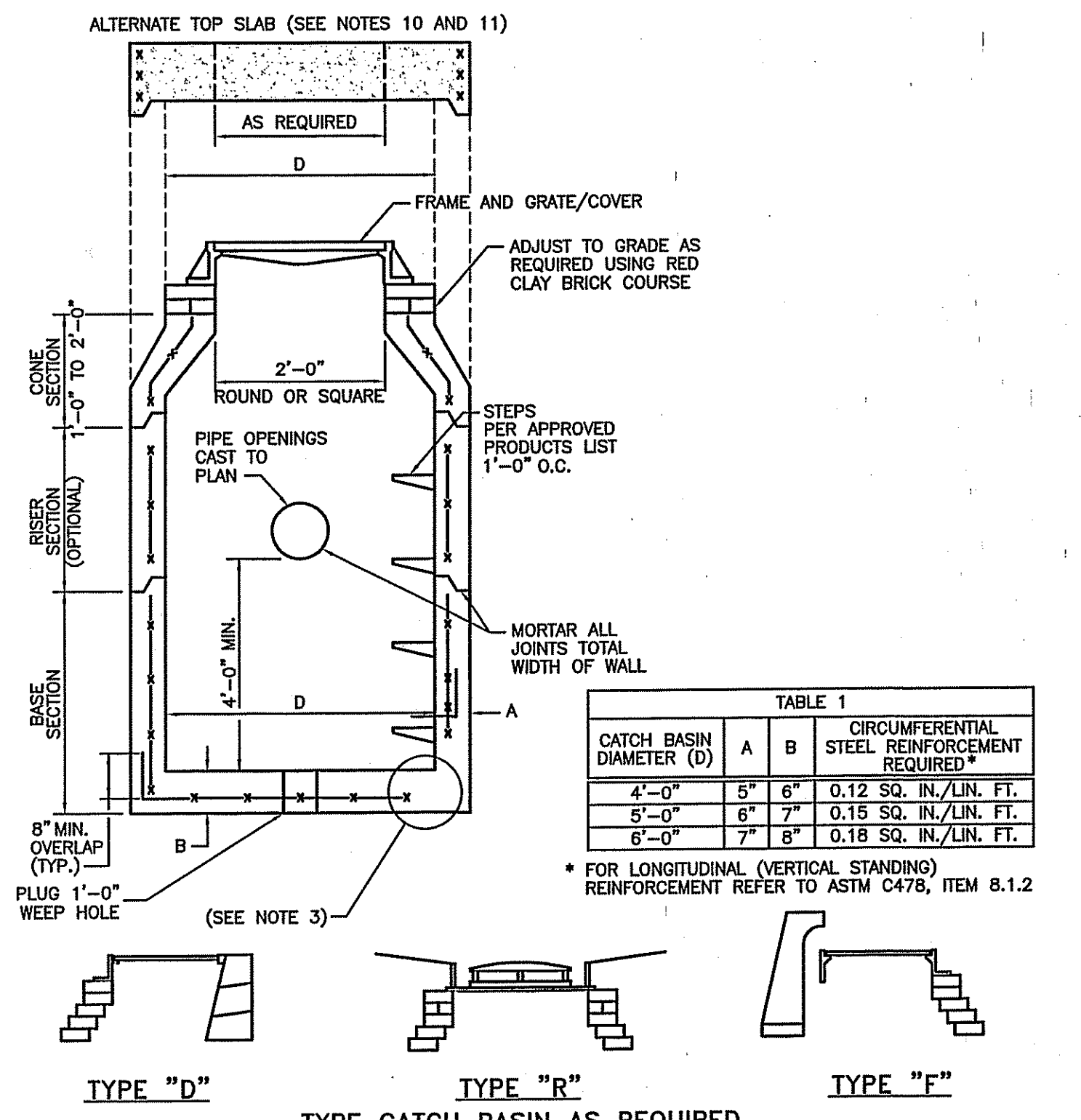

TABLE 1
CATCH BASIN DIAMETER (D)

A	B	CIRCUMFERENTIAL STEEL REINFORCEMENT REQUIRED*
4'-0"	5'-6"	0.12 SQ. IN./LIN. FT.
5'-0"	6'-7"	0.15 SQ. IN./LIN. FT.
6'-0"	7'-8"	0.18 SQ. IN./LIN. FT.

* FOR LONGITUDINAL (VERTICAL) REINFORCEMENT REFER TO ASTM C478, ITEM 8.1.2

- NOTES:
1. SHALL BE IN ACCORDANCE WITH SECTION 702 OF THE R.I. STANDARD SPECIFICATIONS.
 2. SEE TABLE 1 FOR STEEL REINFORCEMENT REQUIREMENTS.
 3. STEEL REINFORCEMENT FOR BASE SECTION BOTTOM SHALL BE A MINIMUM OF 0.12 SQ. IN./LIN. FT. (BOTH WAYS).
 4. STEPS SHALL CONFORM TO STD. 5.3.0 AND SHALL BE INSTALLED AT THE CASTING PLANT.
 5. ONE POUR MONOLITHIC BASE SECTION.
 6. ANY NECESSARY ADJUSTMENTS DURING CONSTRUCTION WILL BE DONE BY SAW-CUTTING AND/OR CORING ONLY. NO JACKHAMMERS, HAMMERS AND CHISELS OR PNEUMATIC TOOLS WILL BE ALLOWED.
 7. CORBEL MADE OF RED CLAY BRICK WILL BE PERMITTED FOR THE "CONE SECTION" OF THE 4'-0" CATCH BASIN ONLY.
 8. FOR CATCH BASIN TYPES "D" AND "R" STEPS MUST BE INSTALLED ON THE CURB SIDE OF THE STRUCTURE.
 9. THE CENTERLINE OF THE OPENING MUST BE WITHIN 2'-0" FROM THE STEPS.
 10. ALTERNATE TOP SLAB IS STEEL REINFORCED TO MEET OR EXCEED H-25 LOADING (SEE STD. 4.7.2).
 11. ALTERNATE TOP SLAB IS ONLY FOR USE WHEN REDUCING SECTION DOES NOT FIT BECAUSE OF STRUCTURE DEPTH.
 12. REFER TO STD. 5.2.0 FOR MAXIMUM PIPE SIZES.

PRECAST 4'-0", 5'-0" OR 6'-0" ROUND CATCH BASIN R.I. STANDARD 4.4.0 M1

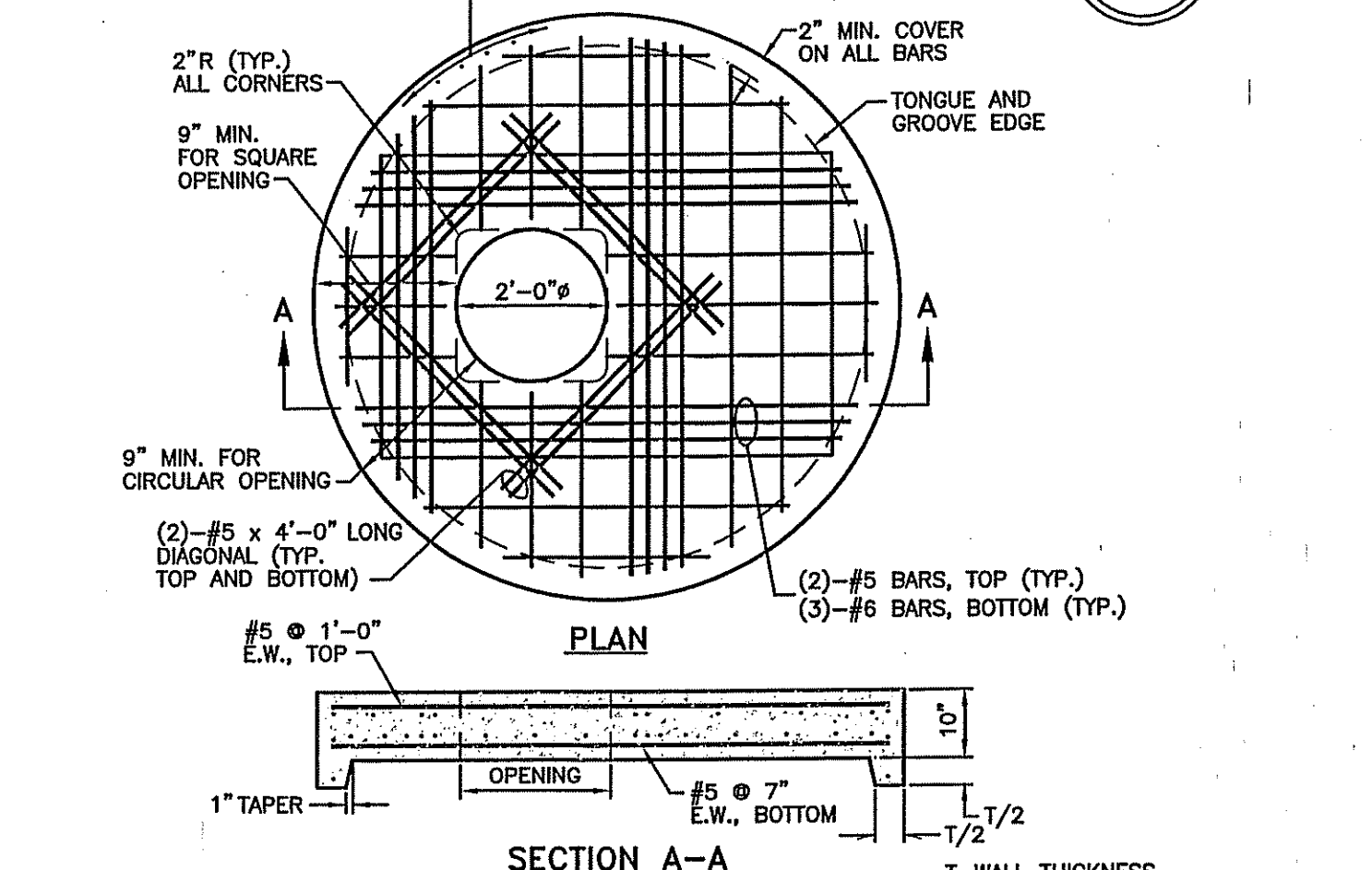

- NOTES:
1. SHALL BE IN ACCORDANCE WITH SECTION 702 OF THE R.I. STANDARD SPECIFICATIONS.
 2. ANY NECESSARY ADJUSTMENTS DURING CONSTRUCTION WILL BE DONE BY SAW-CUTTING AND/OR CORING ONLY. NO JACKHAMMERS, HAMMERS AND CHISELS OR PNEUMATIC TOOLS WILL BE ALLOWED.
 3. THE CENTER LINE OF THE OPENING MUST BE WITHIN 2" FROM THE STEPS.
 4. ALTERNATE TOP COVER IS STEEL REINFORCED TO MEET OR EXCEED H-25 OR HS-25 LOADINGS WITH EARTH PRESSURES INCLUDED. THIS IMPLIES THAT THE TOP SLAB IS DESIGNED FOR AXLE LOADS OF NO MORE THAN 20 TONS.
 5. ALL REBAR SHALL HAVE A MINIMUM OF 2" CLEARANCE FROM OPENING.
 6. ALL REBARS IN THE BOTTOM MAT ARE #5 @ 2" BOTH WAYS, WITH 2" MINIMUM COVER, EXCEPT FOR REBARS ADJACENT TO THE OPENING. THESE BARS SHALL BE (3) #6 SHOWN WITH A HEAVIER LINE FOR CLARITY. REBARS IN THE TOP MAT ARE #5 @ 1'-0", BOTH WAYS, WITH 2" MINIMUM COVER, EXCEPT FOR REBARS ADJACENT TO THE OPENING. THESE BARS SHALL BE (2) #5 BARS.

ALTERNATE TOP COVER FOR ROUND PRECAST MANHOLES AND CATCH BASINS R.I. STANDARD 4.7.2

LEGEND

SIGN NUMBER	RS-1	RS-1	RS-1 (R OR L)
STOP	STOP	STOP	STOP
DON'T ENTER	DON'T ENTER	DON'T ENTER	DON'T ENTER
ONE WAY	ONE WAY	ONE WAY	ONE WAY
COLOR	RED	RED	BLACK-ARROW WHITE
COPY	WHITE	WHITE	BLACK
SIGN DIMENSION	24" x 30"	36" x 48"	36" x 48"
HEIGHT	24"	36"	48"

- NOTES:
1. SHALL BE IN ACCORDANCE WITH SECTION 905 OF THE R.I. STANDARD SPECIFICATIONS.
 2. MINIMUM LENGTH OF STRAIGHT OR CIRCULAR FILLER PIECES TO BE 3'-0".
 3. EXPOSED SURFACES TO HAVE A SPONGE FLOAT FINISH.
 4. CIRCULAR CURB IS REQUIRED ON CURVES WITH RADIUS OF 160'-0" OR LESS. STRAIGHT CURB TO BE USED ON CURVES OF MORE THAN 160'-0" RADIUS.
 5. EXPOSED EDGES TO HAVE A 3/4" CHAMFER.

REGULATORY SIGNS R.I. STANDARD 27.1.0

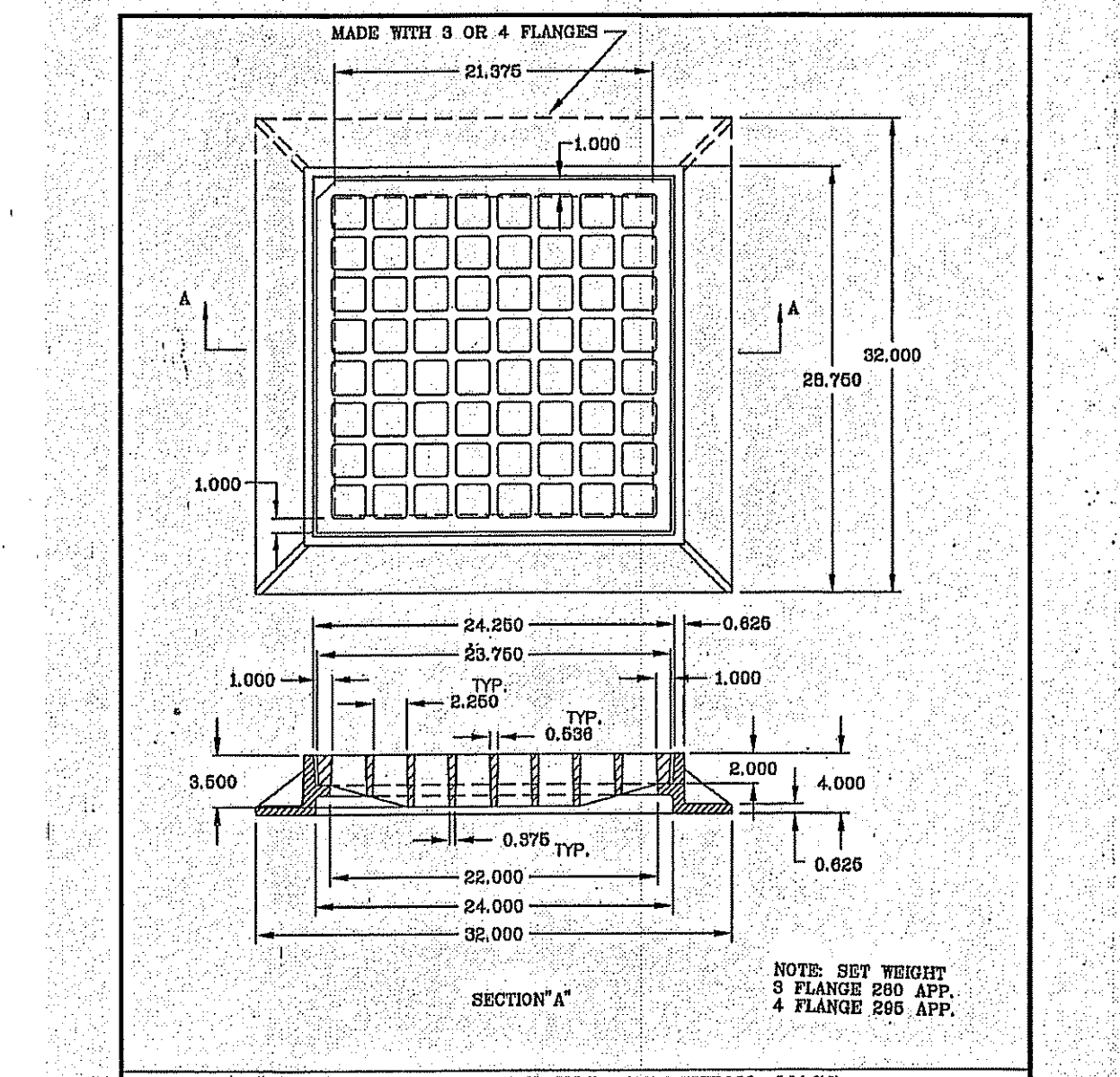

NOTES: SEE WEIGHT OF FLANGE 280 APP. 4 FLANGE 285 APP.

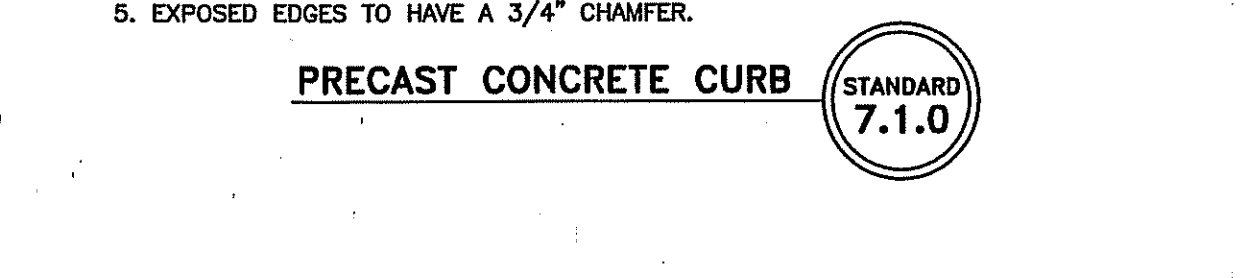
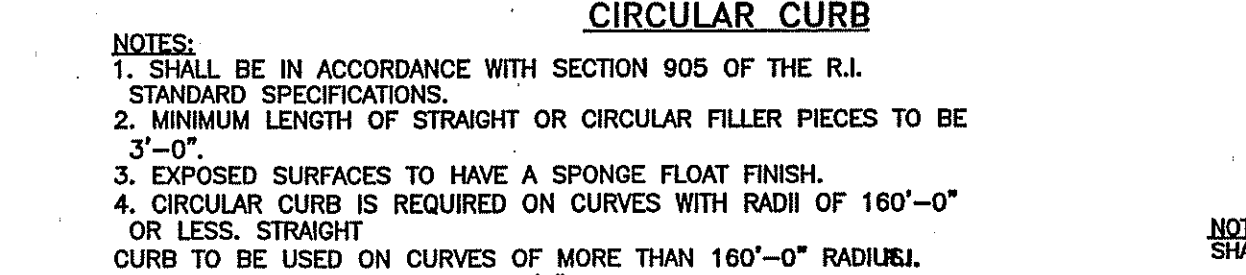
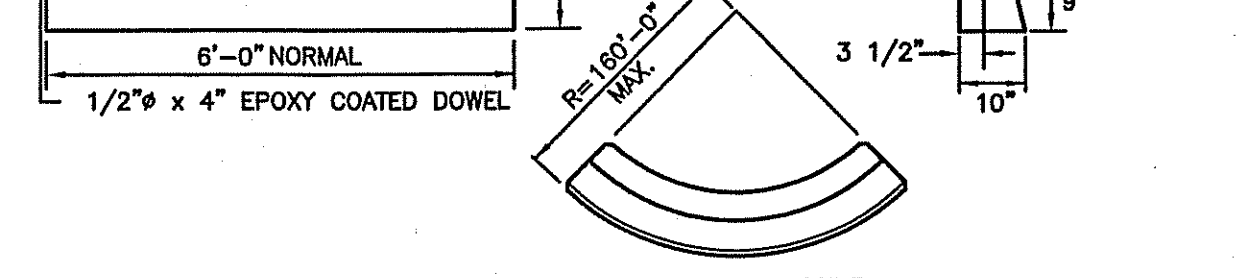
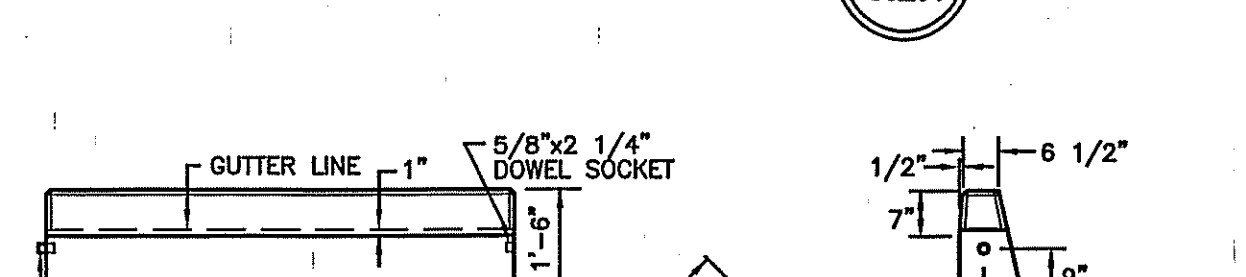
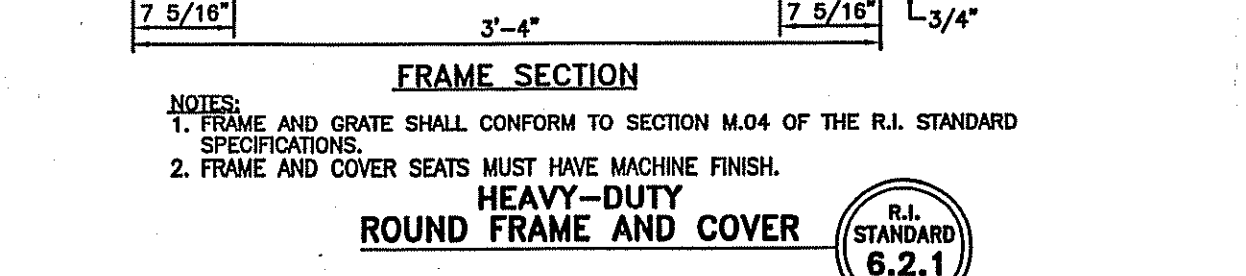
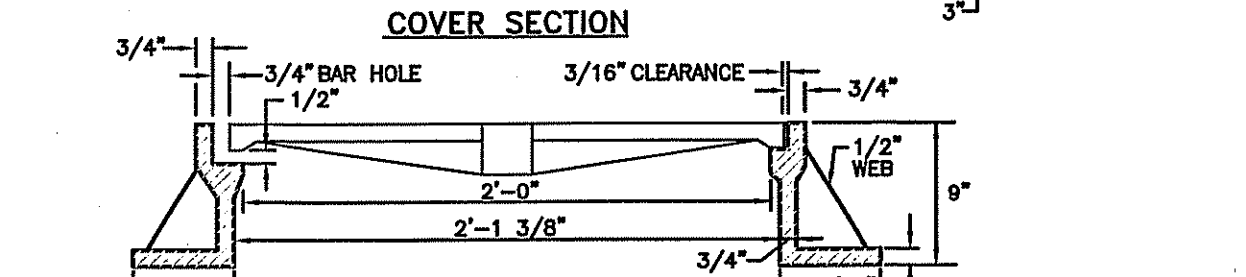
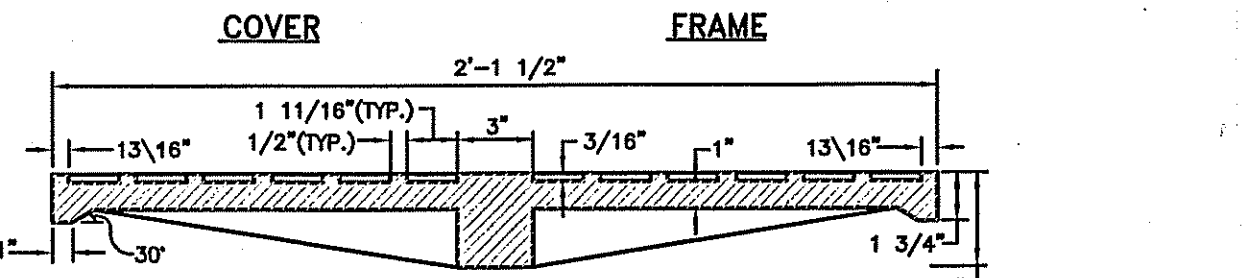
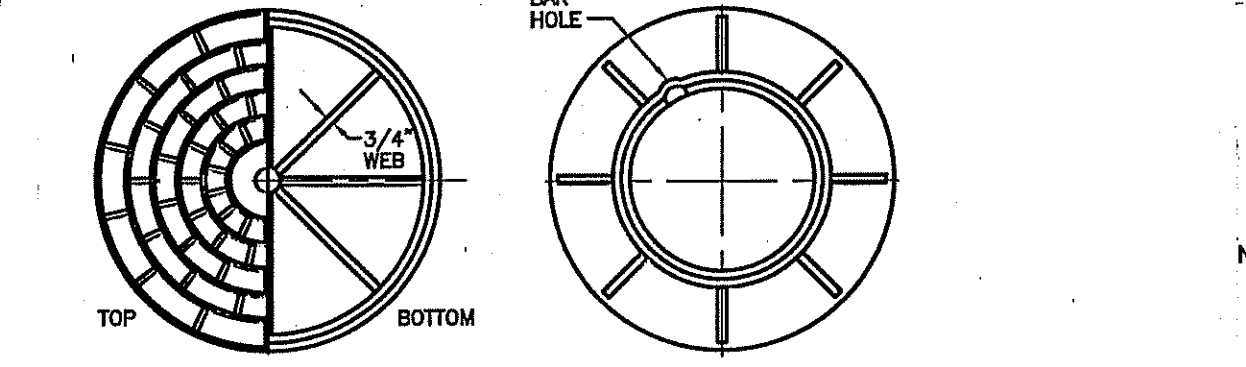
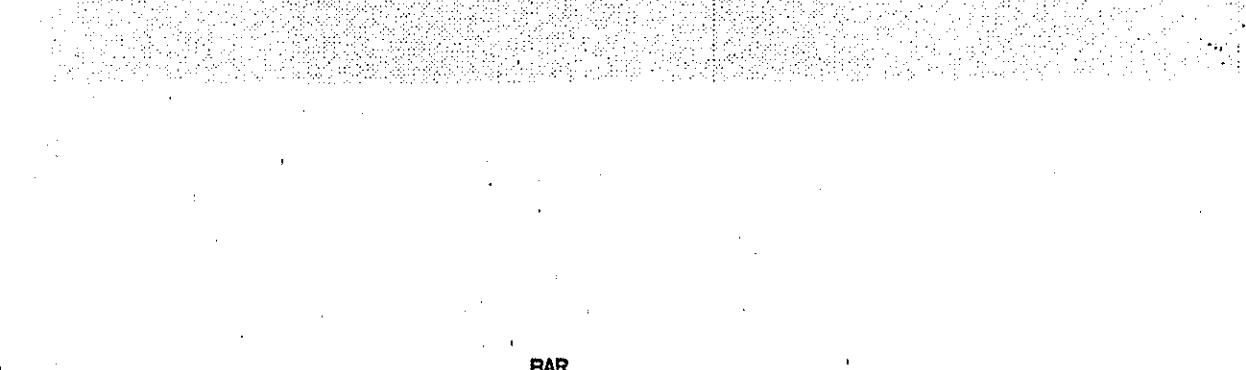

- NOTES:
1. SHALL BE IN ACCORDANCE WITH SECTION 206 OF THE R.I. STANDARD SPECIFICATIONS.
 2. 2"x4"x4'-6" (MAX.) OAK POSTS FOR SILT FENCE SHALL BE LOCATED 8'-0" (MAX.) O.C. IN WETLAND AREAS AND 4'-0" (MAX.) O.C. IN WETLAND RAINE, GULLY OR DROP-OFF AREAS AS SHOWN ON PLANS.
 3. 1"x4'-6" (MIN.) POSTS PERMITTED FOR PRE-FABRICATED SILT FENCE.
 4. SILT FENCE SHALL BE INSTALLED BEFORE ANY GRUBBING OR EARTH EXCAVATION TAKES PLACE.

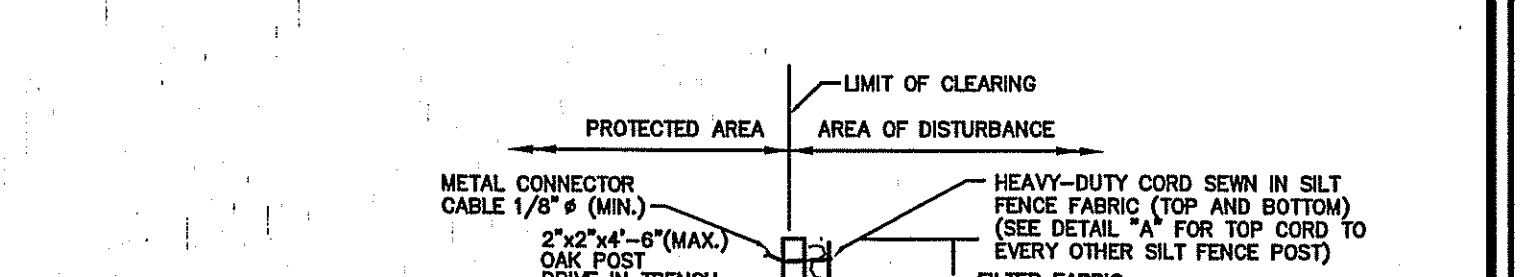
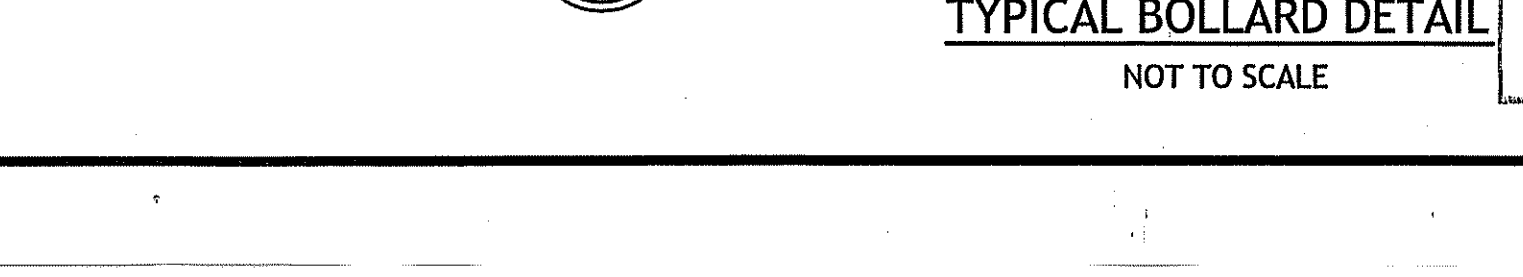
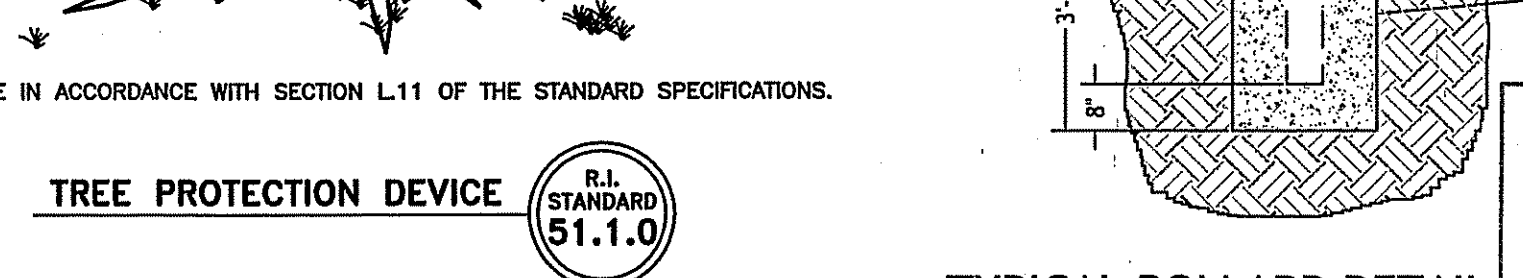
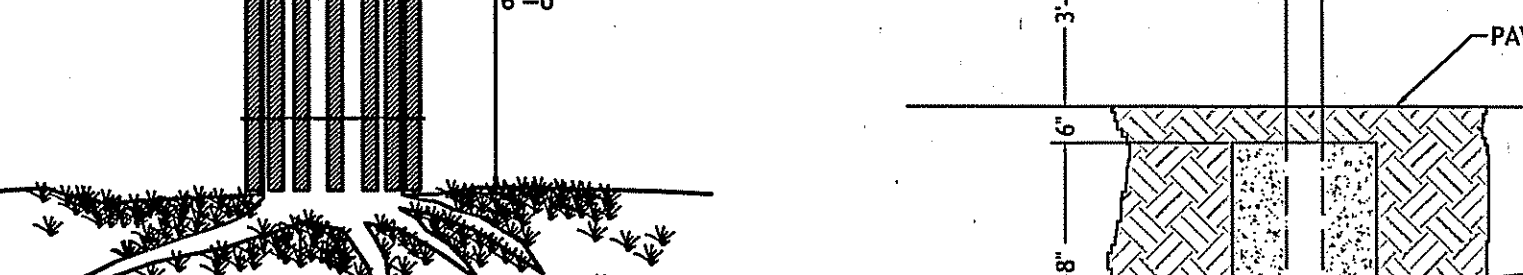
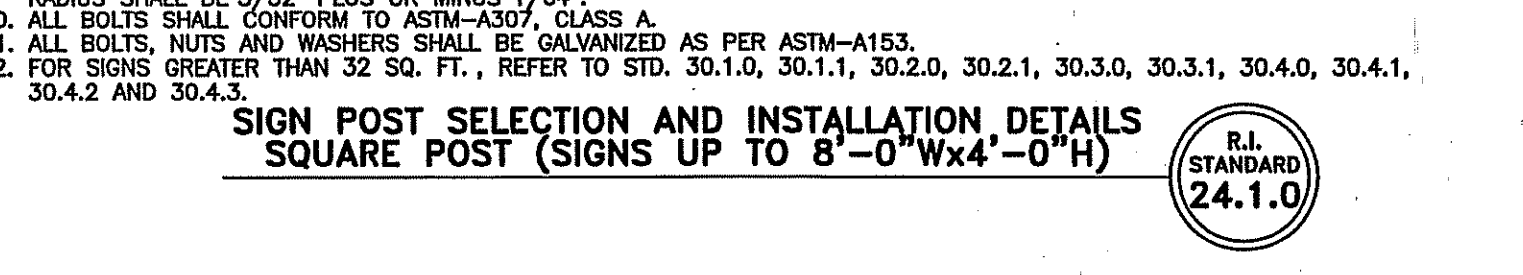
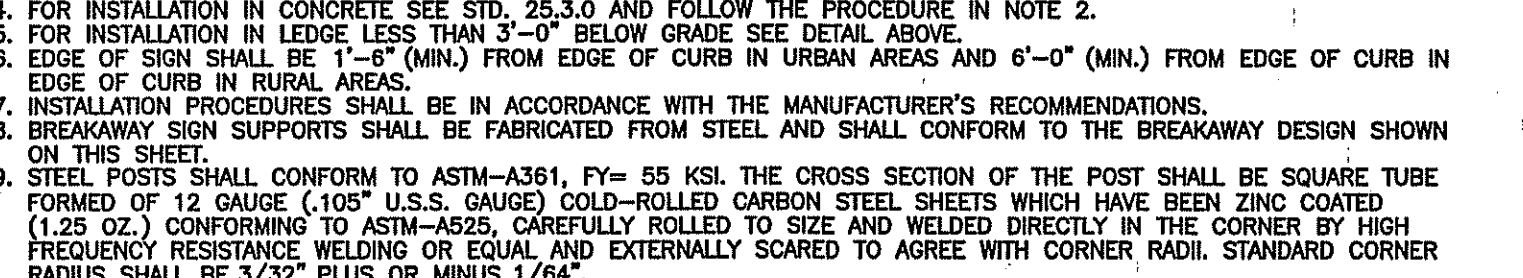
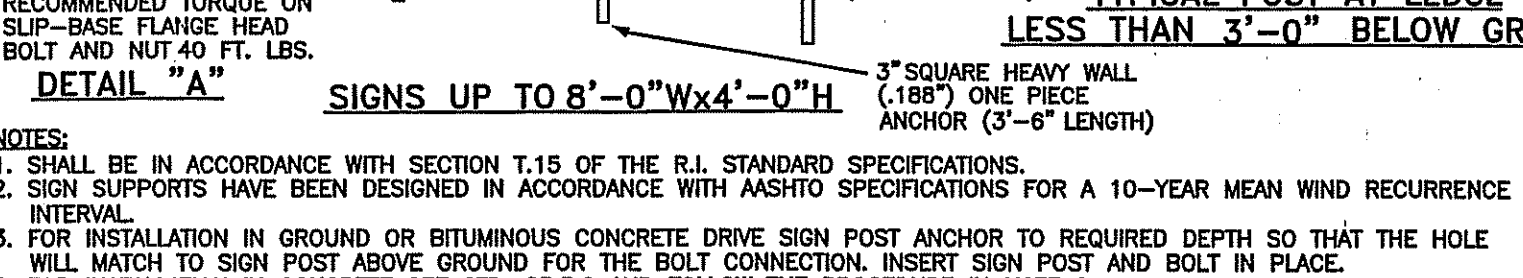
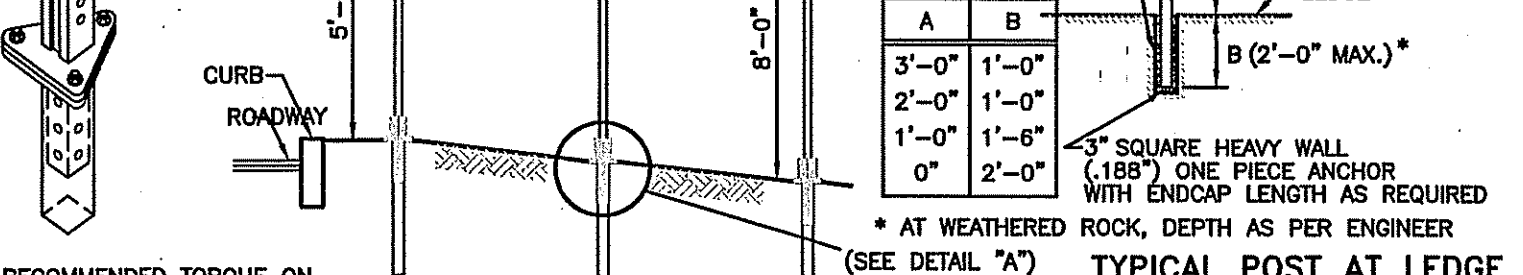
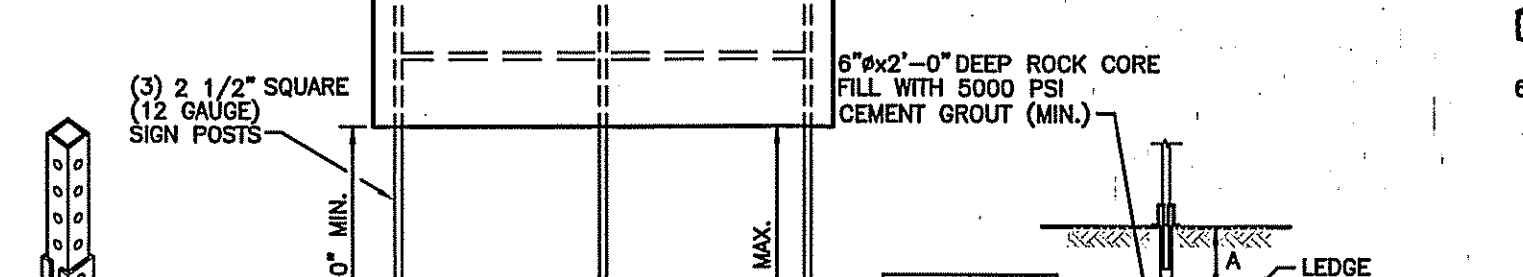
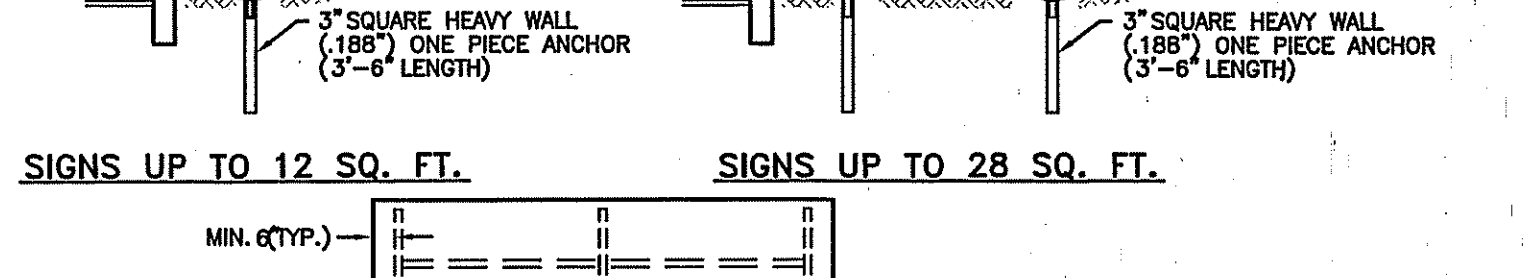
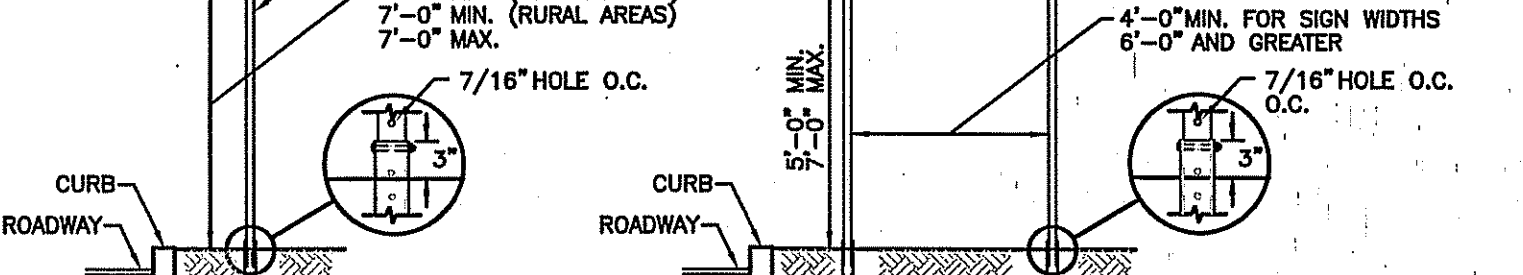
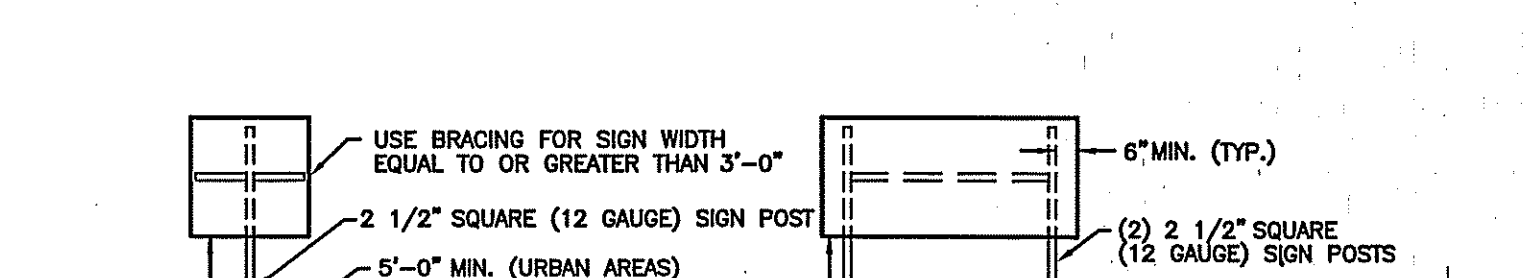
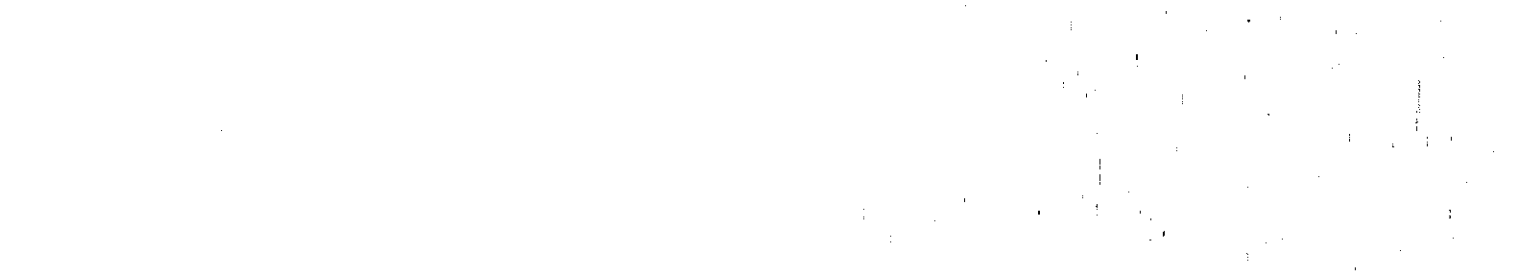

- NOTES:
1. SHALL BE IN ACCORDANCE WITH SECTION 206 OF THE R.I. STANDARD SPECIFICATIONS.
 2. 2"x4"x4'-6" (MAX.) OAK POSTS FOR SILT FENCE SHALL BE LOCATED 8'-0" (MAX.) O.C. IN WETLAND AREAS AND 4'-0" (MAX.) O.C. IN WETLAND RAINE, GULLY OR DROP-OFF AREAS AS SHOWN ON PLANS.
 3. 1"x4'-6" (MIN.) POSTS PERMITTED FOR PRE-FABRICATED SILT FENCE.
 4. SILT FENCE SHALL BE INSTALLED BEFORE ANY GRUBBING OR EARTH EXCAVATION TAKES PLACE.

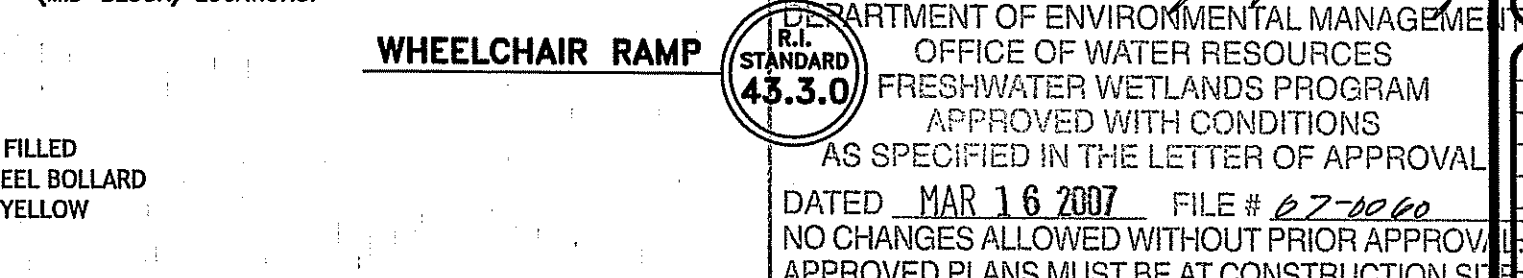
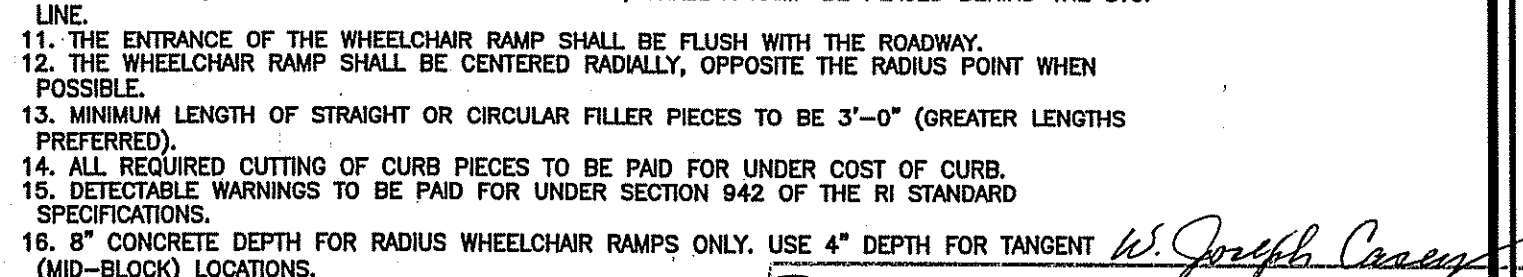
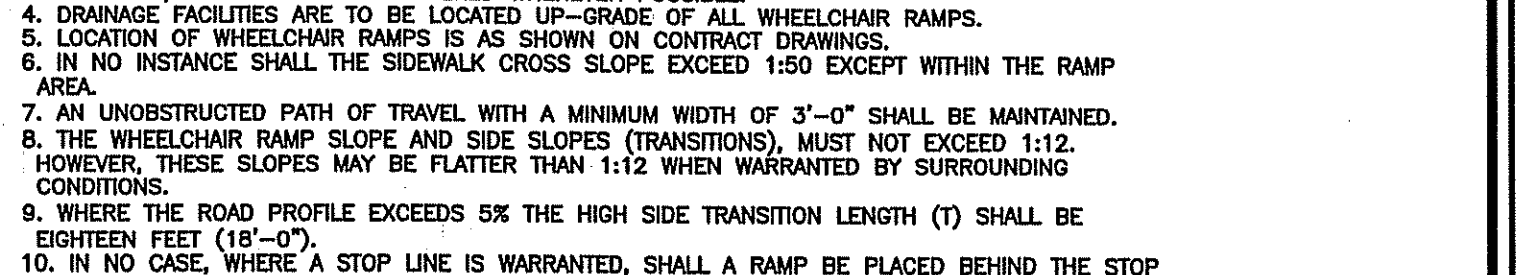
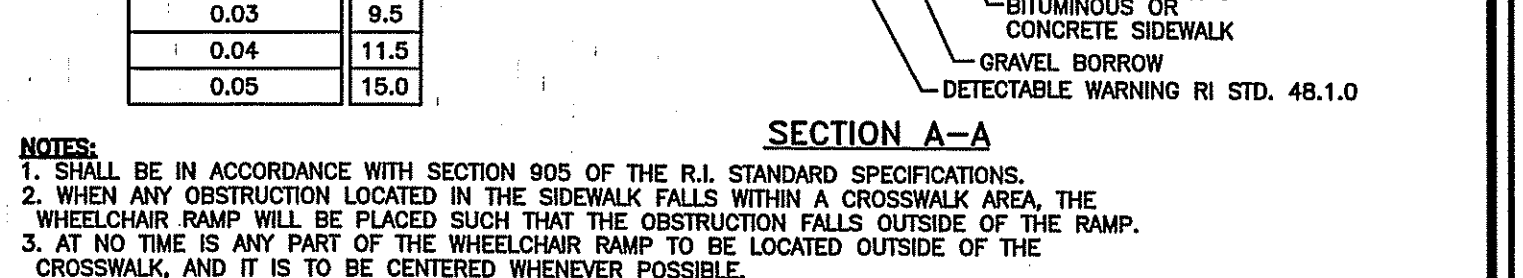
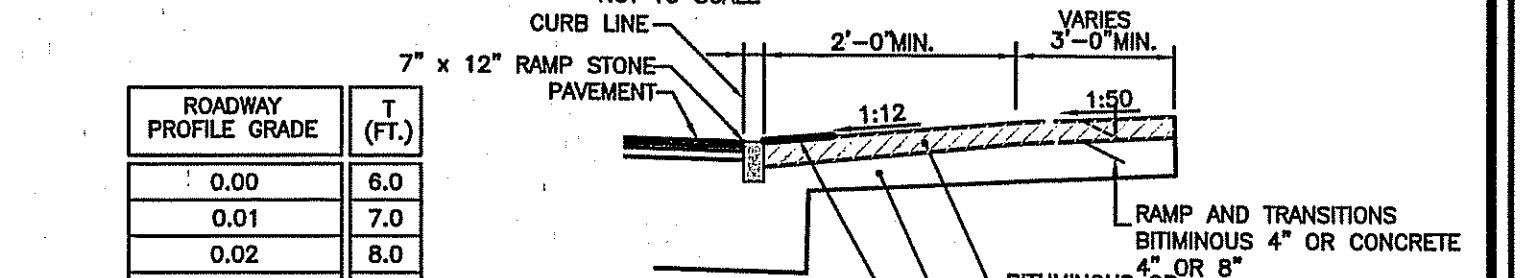
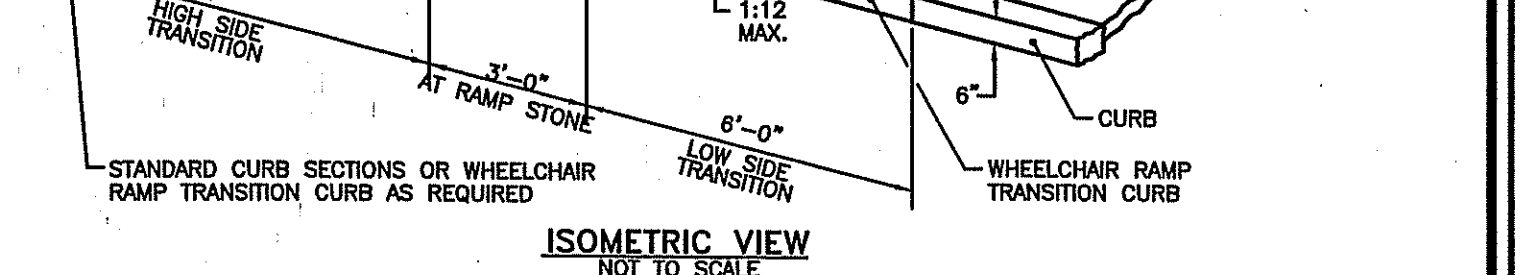
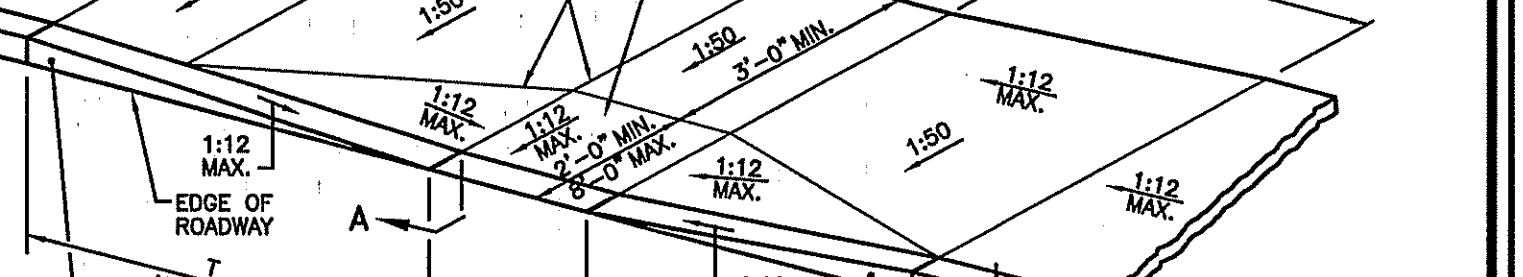
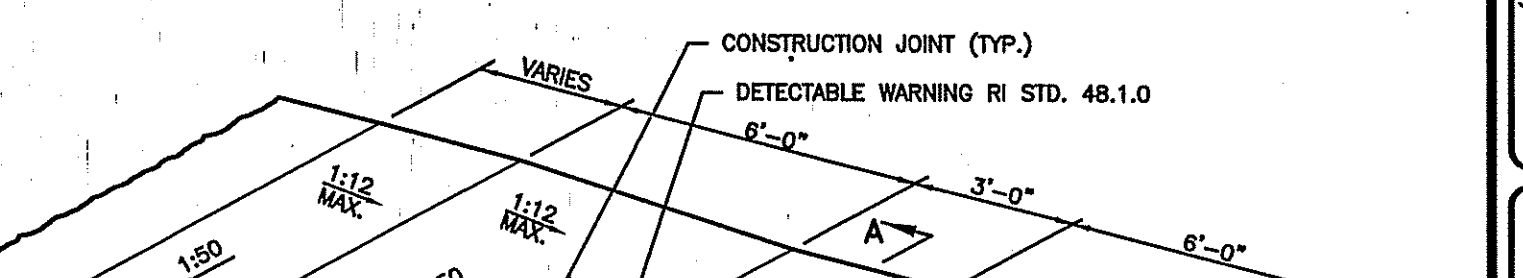
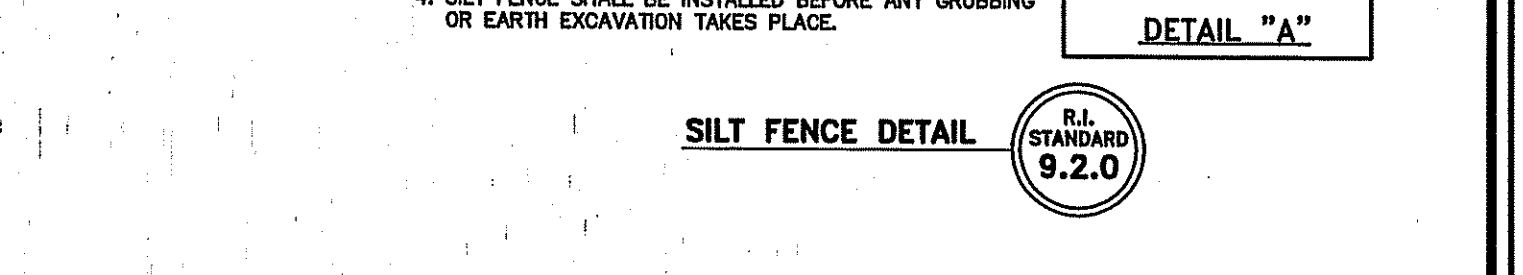
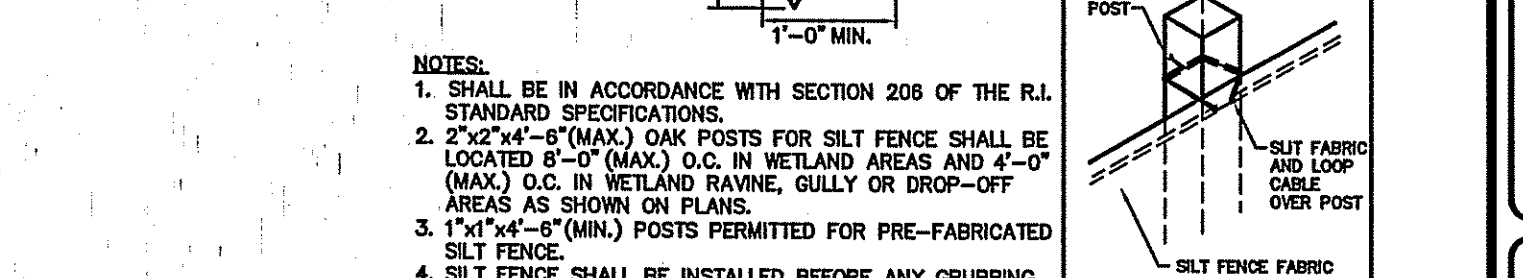
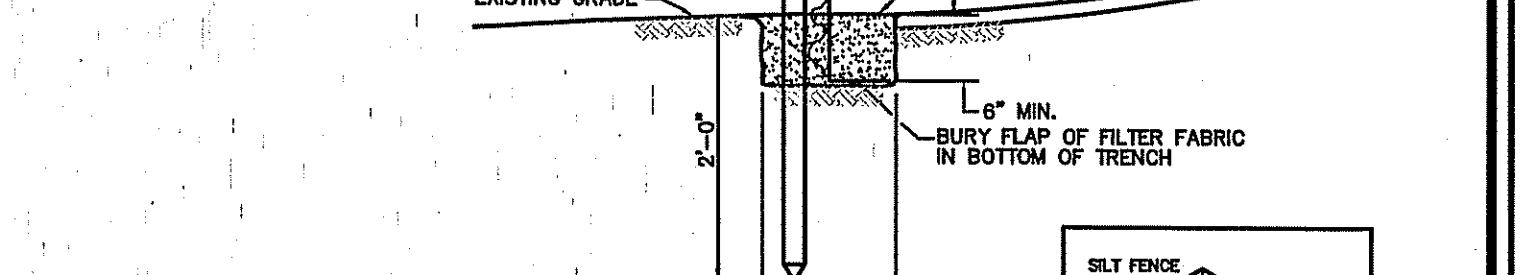

C:\DOCUMENTS - 1\ghatch\LOCALS - 1\Temp\A\Pub\sh_500\Hamford Plans\set.dwg Feb. 12, 2007 11:33am

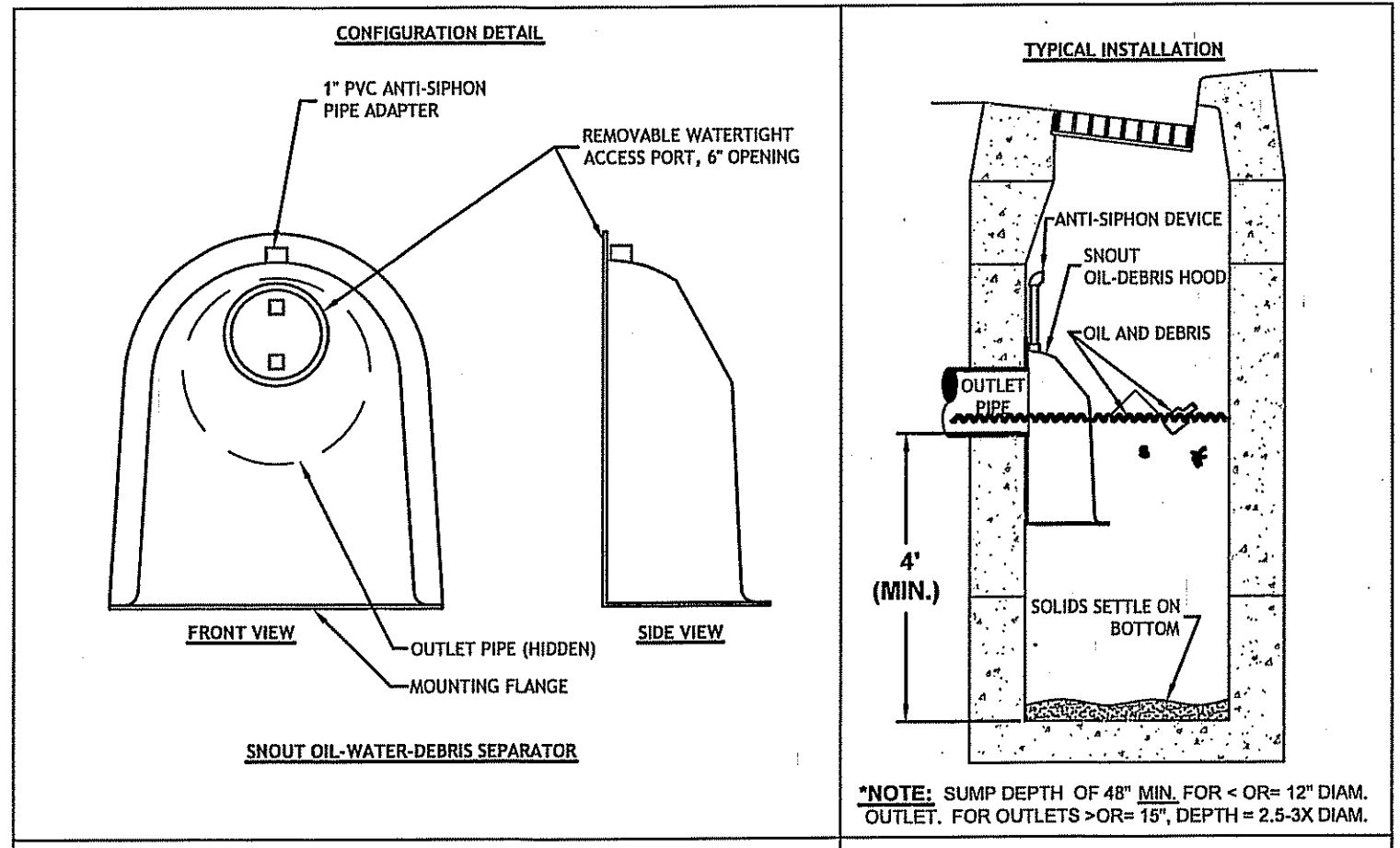

- NOTES:**
1. ALL HOODS AND TRAPS FOR CATCH BASINS AND WATER QUALITY STRUCTURES SHALL BE AS MANUFACTURED BY: BEST MANAGEMENT PRODUCTS, INC. 53 MT. ARCHER RD. LYME, CT 06371 (860) 434-0277, (860) 434-3195 FAX TOLL FREE: (800) 504-8008 OR (888) 354-7585 WEB SITE: www.bestmp.com OR PRE-APPROVED EQUAL.
 2. ALL HOODS SHALL BE CONSTRUCTED OF A GLASS REINFORCED RESIN COMPOSITE WITH ISO GEL COAT EXTERIOR FINISH WITH A MINIMUM 0.125\"/>
 - 3. ALL HOODS SHALL BE EQUIPPED WITH A WATER TIGHT ACCESS PORT, A MOUNTING FLANGE, AND AN ANTI-SIPHON VENT AS DRAWN. (SEE CONFIGURATION DETAIL).
 - 4. THE SIZE AND POSITION OF THE HOOD SHALL BE DETERMINED BY OUTLET PIPE SIZE AS PER MANUFACTURERS RECOMMENDATION.
 - 5. THE BOTTOM OF THE HOOD SHALL EXTEND DOWNWARD 2\"/>
 - 6. THE ANTI-SIPHON VENT SHALL EXTEND ABOVE HOOD BY MINIMUM OF 3\"/>
 - 7. THE SURFACE OF THE STRUCTURE WHERE THE HOOD IS MOUNTED SHALL BE FINISHED SMOOTH AND FREE OF LOOSE MATERIAL.
 - 8. THE HOOD SHALL BE SECURELY ATTACHED TO STRUCTURE WALL WITH 3/8\"/>
 - 9. INSTALLATION INSTRUCTIONS SHALL BE FURNISHED WITH MANUFACTURER SUPPLIED INSTALLATION KIT. INSTALLATION KIT SHALL INCLUDE:
 - A. INSTALLATION INSTRUCTIONS
 - B. PVC ANTI-SIPHON VENT PIPE AND ADAPTER
 - C. OIL-RESISTANT CRUSHED CELL FOAM GASKET WITH PSA BACKING
 - D. 3/8\"/>
 - E. ANCHOR SHIELDS

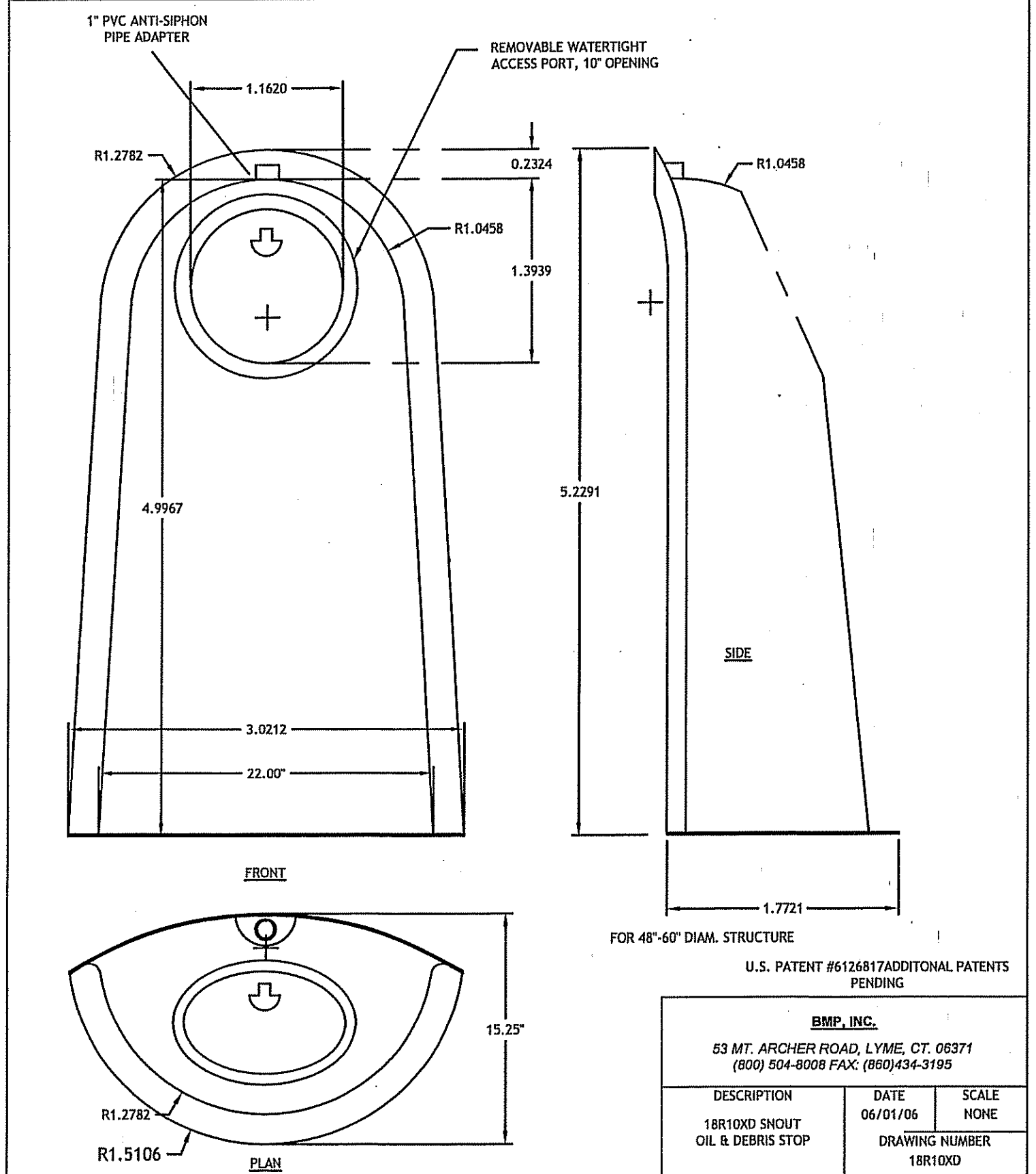
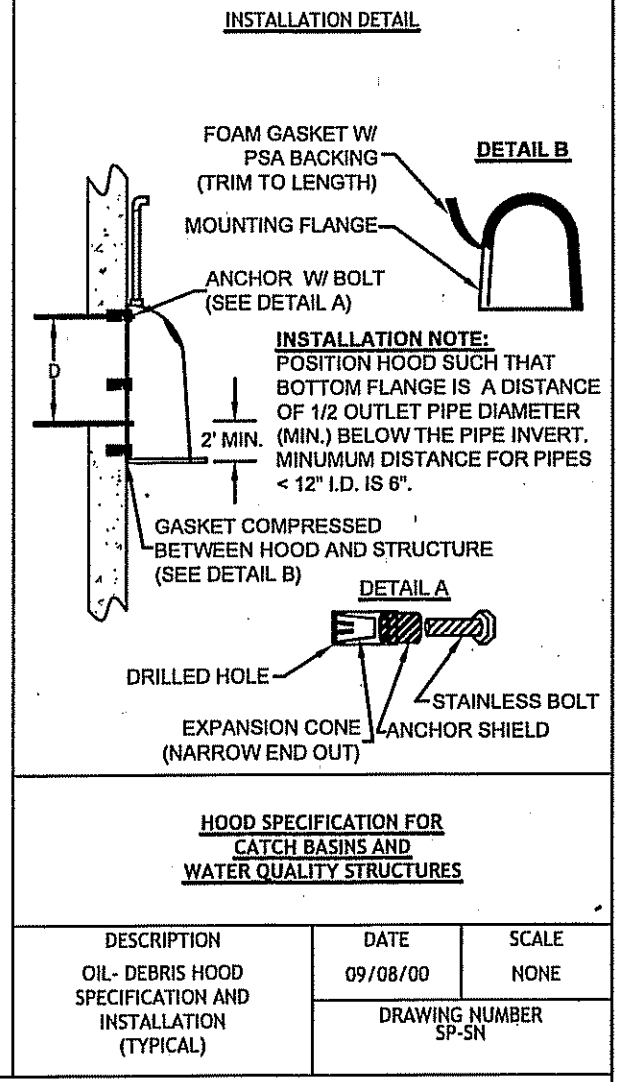

BMP, INC.
53 MT. ARCHER ROAD, LYME, CT, 06371
(860) 504-8008 FAX: (860) 434-3195

DESCRIPTION	DATE	SCALE
18R100D SHOUT OIL & DEBRIS STOP	06/01/05	NONE
		DRAWING NUMBER 18R100D

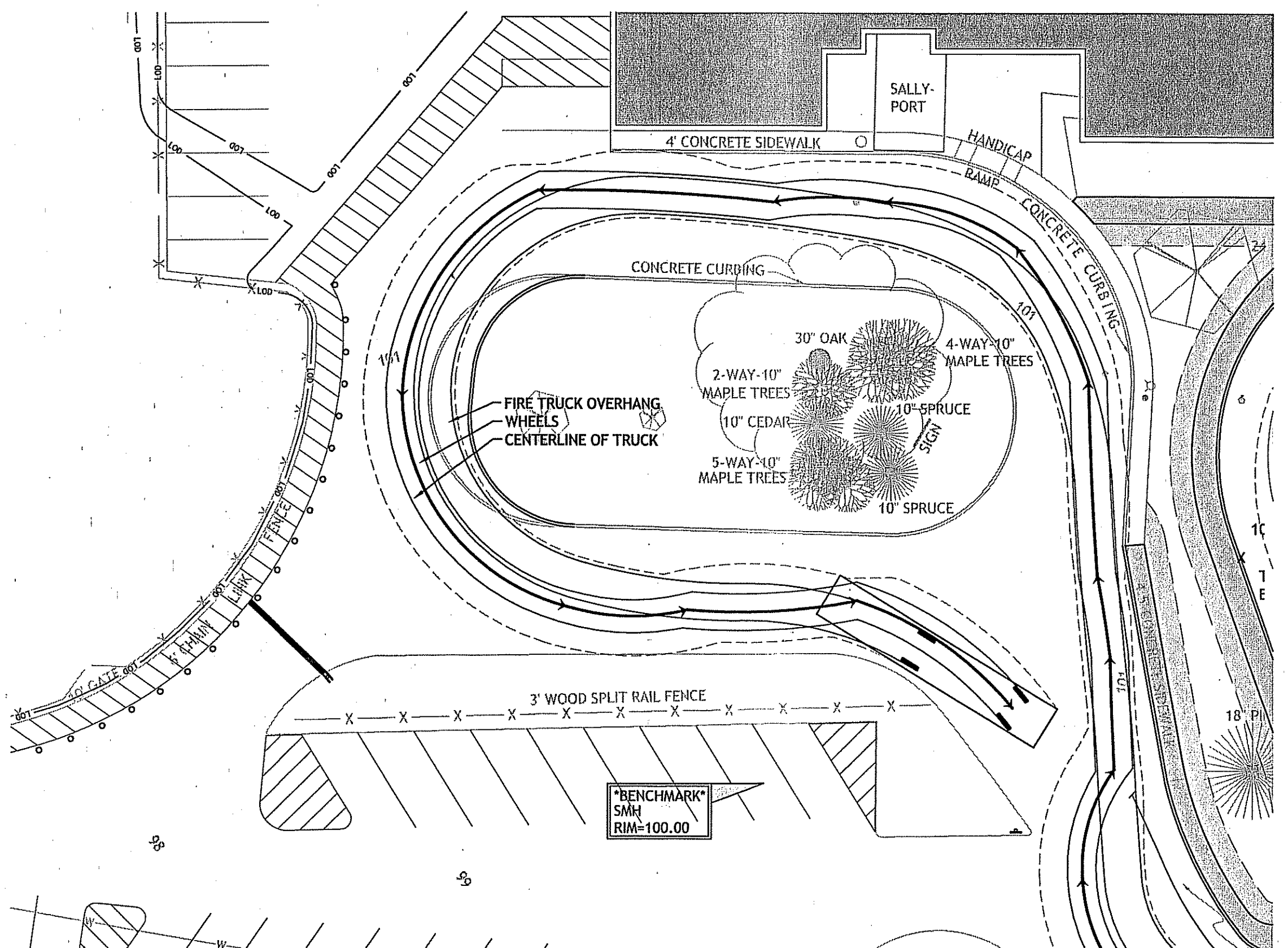

AUTOTURN - EXISTING DRIVEWAY
SCALE (FEET)
0 10 20 40 80
1 INCH = 20 FT

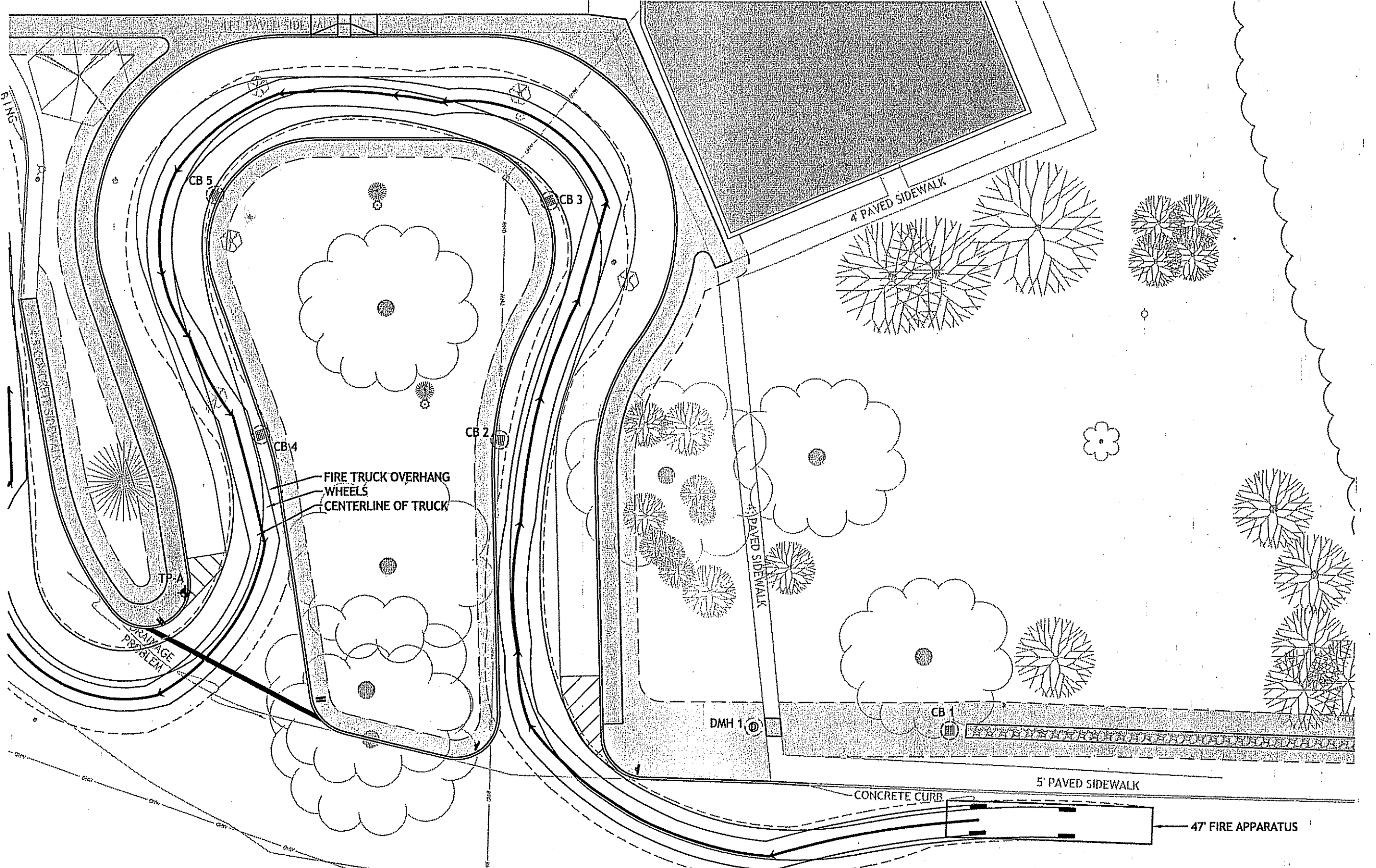

AUTOTURN - PROPOSED DRIVEWAY
SCALE (FEET)
0 10 20 40 80
1 INCH = 20 FT

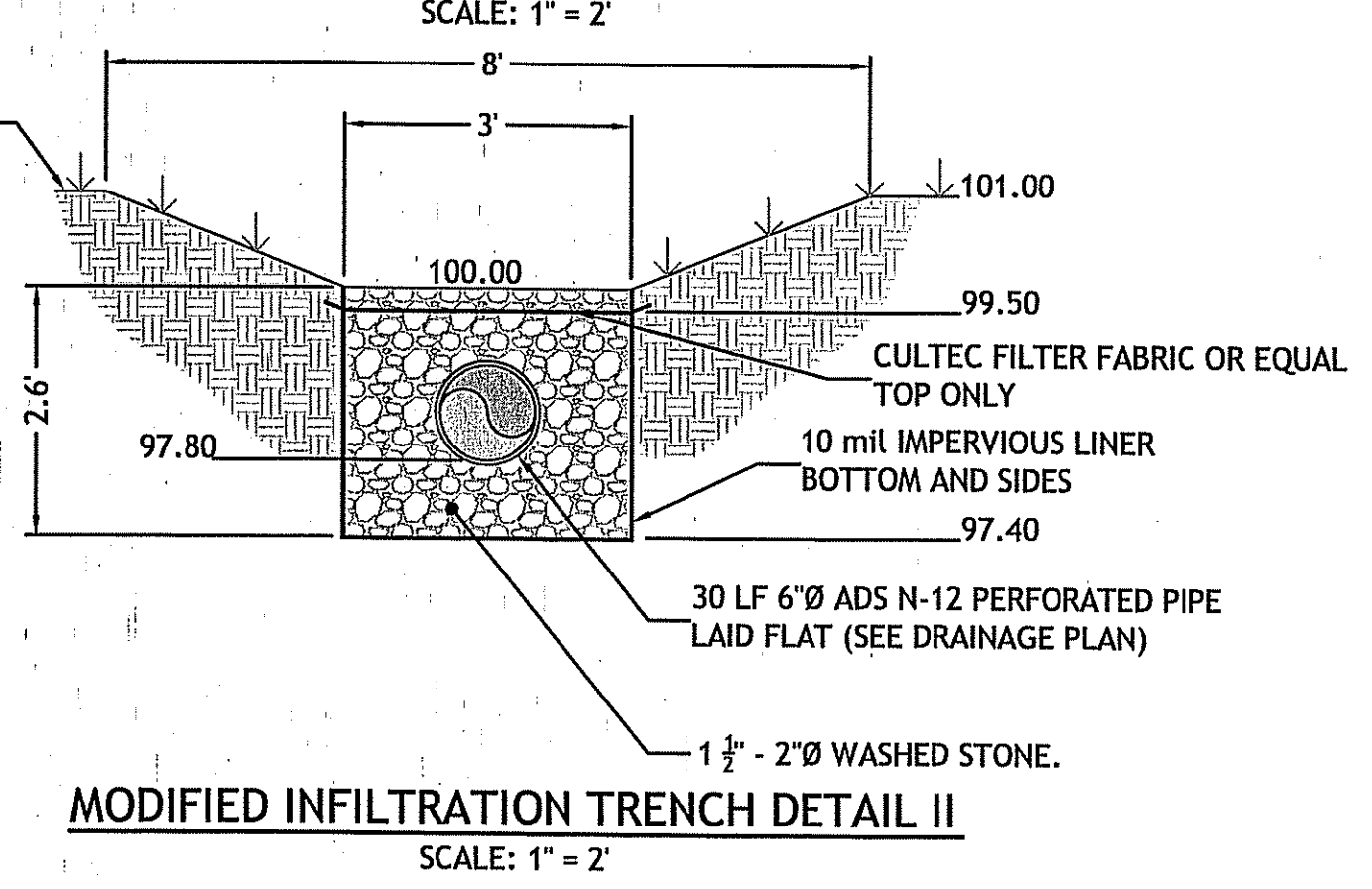
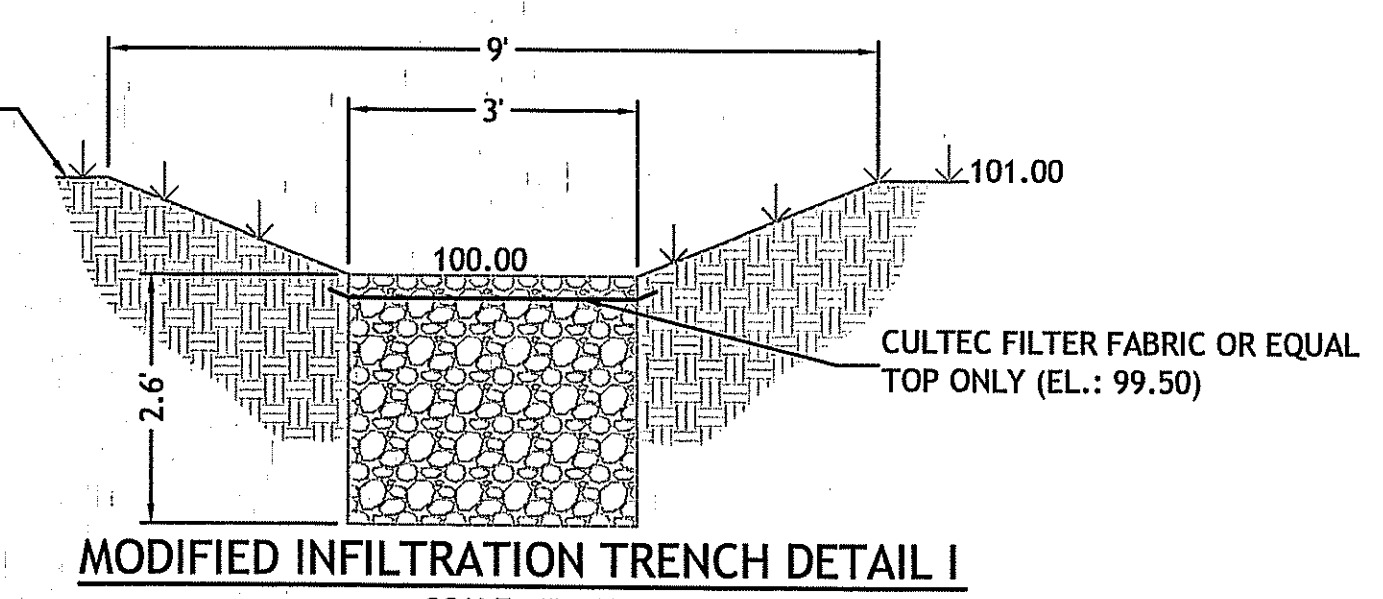

Kindly be advised that this Permit is not equivalent to a verification of the type or extent of freshwater wetlands on site.

DEPARTMENT OF ENVIRONMENTAL MANAGEMENT
OFFICE OF WATER RESOURCES
FRESHWATER WETLANDS PROGRAM
APPROVED WITH CONDITIONS
AS SPECIFIED IN THE LETTER OF APPROVAL
DATED MAR 16 2007 FILE # 07-002
NO CHANGES ALLOWED WITHOUT PRIOR APPROVAL.
APPROVED PLANS MUST BE AT CONSTRUCTION SITE.

W. Joseph Cray

JCE
JOE CASALI ENGINEERING, INC.
Civil - Site Development - Drainage
Wetlands - Floodplain - ISDS
300 Post Road, Warwick, RI 02888
(401) 944-1300 (401) 944-1313 fax
www.jcecasaliengineering.com

DAVID M. D'AMICO
No. 6749
REGISTERED PROFESSIONAL ENGINEER
CIVIL
2/9/07

**GEORGE R. HANAFORD
ELEMENTARY SCHOOL**
200 MIDDLE ROAD
EAST GREENWICH, RHODE ISLAND

FEB 12 2007

REVISIONS:

NO.	DATE	DESCRIPTION

DESIGNED BY: GEC / WRA
DRAWN BY: GAH / MRB
CHECKED BY: DMJ
DATE: FEBRUARY 2007
PROJECT NO: 05-43e

PRELIMINARY, NOT FOR CONSTRUCTION

DETAILS II

**SHEET
7 OF 7**