

FED. RD. DIV. NO.	STATE	FEDERAL AID PROJECT NO.	FISCAL YEAR	SHEET NO.	TOTAL SHEETS
1	R.I.			1	6

**INDEX OF DRAWINGS**  
**SHEET NO. DESCRIPTION**

- 1 COVER SHEET
- 2 PLAN SYMBOLS AND GENERAL LEGEND
- 3 GENERAL NOTES
- 4 TYPICAL SECTIONS AND DETAILS
- 5 GENERAL PLAN NO. 3
- 6 DRAINAGE AND UTILITY PLAN NO. 3

STATE OF RHODE ISLAND  
**DEPARTMENT OF TRANSPORTATION**

PLANS OF PROPOSED  
**1R HIGHWAY IMPROVEMENTS TO**  
**U.S. ROUTE 44 (PUTNAM PIKE)**  
**CONTRACT 2A**  
**FROM WEST GREENVILLE ROAD TO AUSTIN AVENUE**  
**TOWN OF SMITHFIELD**  
**PROVIDENCE COUNTY**

R.I. DESIGN CONTRACT NO. 84109      F.A. DESIGN PROJECT NO. F-0044 (007)  
 LENGTH = 1.17 MILES

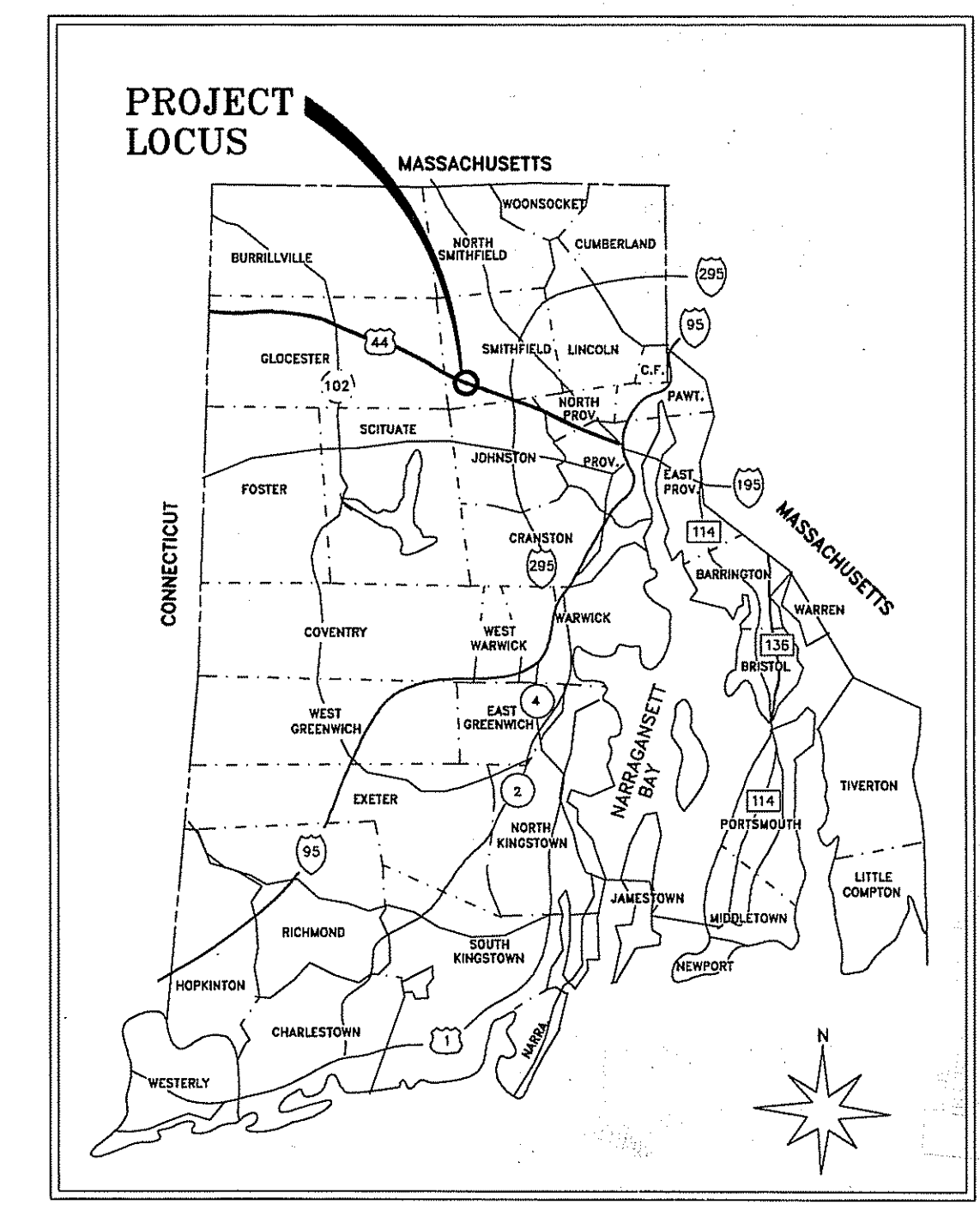

**LOCATION MAP**  
 SCALE: 1" = 8 MILES

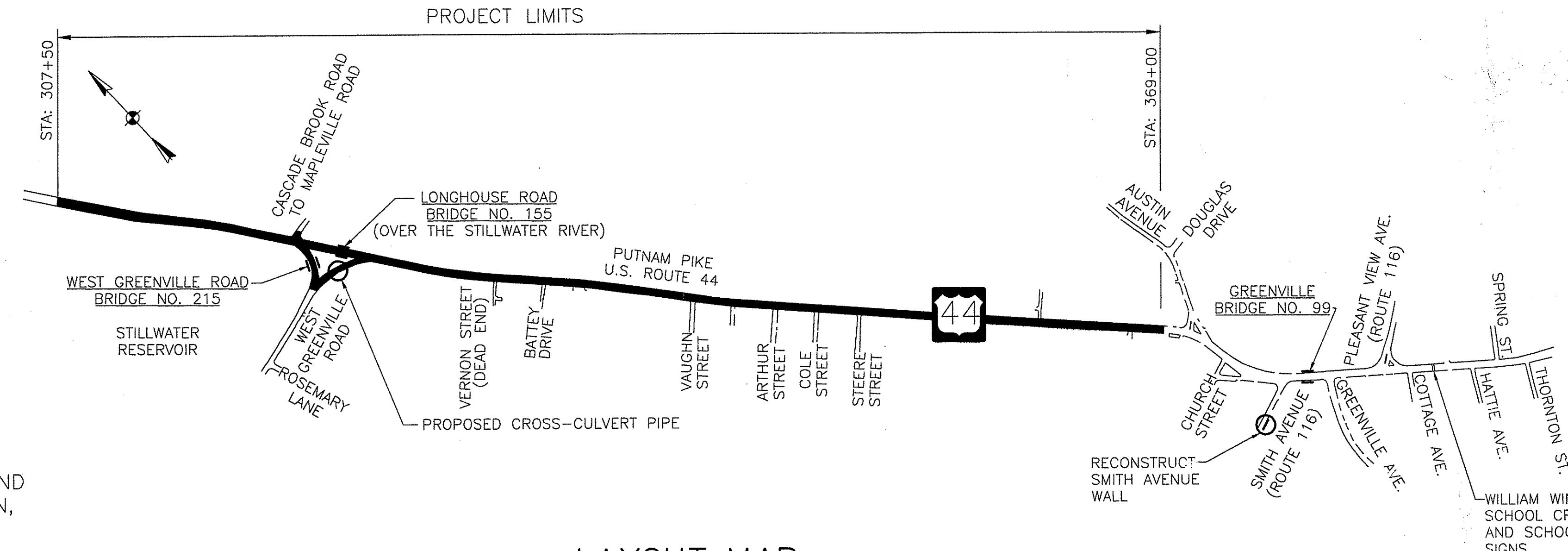

**LAYOUT MAP**  
 SCALE: 1" = 500'

**SCALE OF DRAWINGS**  
 PLANS: 1" = 20'  
 TYPICAL SECTIONS: 1" = 4'

**BASE OF LEVELS**  
 NGVD 1929

**STATEWIDE COORDINATE SYSTEM**  
 NAD 1983

**RIDEM REQUEST FOR  
 PRELIMINARY DETERMINATION  
 APRIL 23, 2007**

**DESIGN DESIGNATION**

2005 AADT = 14,600  
 DHV = 1300  
 K = 0.09  
 D = 50/50  
 T = 5%  
 V = 35 MPH (GLOCESTER TOWN LINE TO AUSTIN AVENUE) STATE TRAFFIC COMMISSION

**PAVEMENT STRUCTURE**

COLD PLANE 1-1/2" DEPTH AND OVERLAY WITH 2" BITUMINOUS SURFACE COURSE CLASS 1-1

DEPARTMENT OF ENVIRONMENTAL MANAGEMENT  
 OFFICE OF WATER RESOURCES  
 FRESHWATER WETLANDS PROGRAM  
 APPROVED WITH CONDITIONS  
 AS SPECIFIED IN THE LETTER OF APPROVAL  
 DATED JUN 15 2007 FILE # 07-0197  
 NO CHANGES ALLOWED WITHOUT PRIOR APPROVAL  
 APPROVED PLANS MUST BE AT CONSTRUCTION SITE

*Charles A. Harbert* DEPARTMENT OF TRANSPORTATION

STEVEN M. CLARKE  
 REGISTERED PROFESSIONAL ENGINEER  
*Steven M. Clarke*

APPROVED	DATE
DEPUTY CHIEF ENGINEER	DATE
APPROVED	DATE
CHIEF ENGINEER	DATE
APPROVED	DATE
DIRECTOR	DATE

U.S. DEPARTMENT OF TRANSPORTATION FEDERAL HIGHWAY ADMINISTRATION	
APPROVED	DATE
DIVISION ADMINISTRATOR	DATE

**COMMONWEALTH**  
 ENGINEERS & CONSULTANTS, INC.  
 400 SMITH STREET  
 PROVIDENCE, RI 02908

CONTRACT NUMBER	X
NUMBER OF SHEET	1
TOTAL SHEETS	6

**RHODE ISLAND SPECIFICATIONS AND STANDARD DETAILS**

SPECIFICATIONS TO GOVERN THIS PROJECT ARE THE RHODE ISLAND STANDARD SPECIFICATIONS FOR ROAD AND BRIDGE CONSTRUCTION, 2004 EDITION, WITH ALL REVISIONS, AND STATE AND FEDERAL SPECIAL PROVISIONS INCLUDED IN THE CONTRACT SPECIFIC DOCUMENTS.

STANDARD DETAILS FOR THIS PROJECT ARE THE RI STANDARD DETAILS, 1998 EDITION WITH ALL REVISIONS.

P:\97000\97061.03 Route 44 - Contract I\Drawings\Transportation\Current\_Drawings\Transportation\Current\_Drawings\CONTRACT-2A\RIDEM001-TITLE.dwg, 4/20/2007 4:26:17 PM, xerox.pc3, KMM



**GENERAL NOTES**

- ALL ITEMS NOT REFERENCED FOR MODIFICATION WILL BE "EXISTING TO REMAIN" UNLESS OTHERWISE DIRECTED BY THE ENGINEER.
- ANY DAMAGE TO EXISTING STATE OR PRIVATE PROPERTY CAUSED BY THE CONTRACTOR SHALL BE REPAIRED BY THE CONTRACTOR AT NO ADDITIONAL COST TO THE STATE.
- THE COST OF ANY CURB CUTTING REQUIRED TO INSTALL NEW CURB WILL BE INCLUDED IN THE UNIT PRICE BID FOR THE NEW CURB.
- THE CONTRACTOR MUST PAVE TO THE CUT AND MATCH LINES ON SIDE STREETS SIMULTANEOUSLY WITH THE MAIN LINE PAVING.

**GENERAL NOTES – DRAINAGE**

- ALL EXISTING DRAIN PIPES, CATCH BASINS, AND DRAIN MANHOLES TO REMAIN WITHIN THE PROJECT LIMITS ARE TO BE CLEANED IN ACCORDANCE WITH THE SPECIFICATIONS AS DIRECTED BY THE ENGINEER.
- THE CONTRACTOR SHALL FIELD VERIFY ALL EXISTING STORM DRAIN PIPE DISCHARGE LOCATIONS PRIOR TO BEGINNING WORK.
- ALL EXISTING CATCH BASINS AND MANHOLES TO REMAIN SHALL BE INSPECTED AFTER CLEANING AND THOSE FOUND TO BE UNSUITABLE BY THE ENGINEER SHALL BE RECONSTRUCTED BY THE CONTRACTOR IN ACCORDANCE WITH THE STANDARD SPECIFICATIONS. MEASUREMENT AND PAYMENT FOR THIS WORK SHALL APPLY TO ALL TYPES AND SIZES OF MANHOLES AND CATCH BASINS INCLUDING THOSE WITH GUTTER INLETS AND SHALL BE INCLUDED IN THE FOLLOWING PROPOSAL ITEMS:  
  
 CODE 704.0100 RECONSTRUCT CATCH BASIN CORBEL CONES (EACH)  
 CODE 704.0200 RECONSTRUCT MANHOLE CORBEL CONES (EACH)  
  
 ANY FURTHER RECONSTRUCTION WILL BE PERFORMED IN ACCORDANCE WITH SECTION 109.04, DIFFERING SITE CONDITIONS, CHANGES, EXTRA WORK AND FORCE ACCOUNT WORK OF THE STANDARD SPECIFICATIONS.
- THE CONTRACTOR WILL BE RESPONSIBLE TO ENSURE DRAINAGE FLOW TO ALL CATCH BASINS AFTER THE SURFACE COURSE IS PLACED. ANY ADDITIONAL MODIFICATIONS REQUIRED TO CORRECT THE DRAINAGE FLOW AFTER PLACEMENT OF THE SURFACE COURSE WILL BE PAID FOR BY THE CONTRACTOR.
- FINAL CATCH BASIN RIM ELEVATIONS ARE TO BE SET 0.10 FEET BELOW FINISHED PAVEMENT GRADE.
- THE CONTRACTOR SHALL BE RESPONSIBLE FOR MAINTAINING DRAINAGE AND RUNOFF FLOW DURING CONSTRUCTION.
- STORMWATER OUTFALL LOCATIONS WHERE PIPES ARE TO BE CLEANED AND FLUSHED MUST HAVE OUTFALL PROTECTION DEVICES (R.I. STD. 9.1.0 OR 9.3.0) INSTALLED PRIOR TO CLEANING AND FLUSHING TO TRAP SEDIMENTS. THE SEDIMENTS SHALL BE REMOVED AND DISPOSED OF PROPERLY BEFORE THE EROSION CONTROL DEVICES ARE REMOVED. IF OUTLET PROTECTION AT THE OUTFALL IS NOT FEASIBLE, THEN THE OUTLET PIPE OF THE LAST DRAINAGE STRUCTURE TO BE CLEANED SHALL BE PLUGGED TO CONTAIN ALL FLUSHED MATERIALS IN THAT STRUCTURE. ONCE THE WASTE MATERIALS HAVE BEEN REMOVED FROM THE DRAINAGE STRUCTURE, THE OUTLET SHALL BE UNPLUGGED TO RESUME NORMAL FUNCTIONING.

**GENERAL NOTES – EROSION CONTROL**

- THE CONTRACTOR SHALL REFER TO THE 1989 RI SOIL EROSION AND SEDIMENT CONTROL HANDBOOK PREPARED BY THE US DEPARTMENT OF AGRICULTURE SOIL CONSERVATION SERVICE AND THE RI DEPARTMENT OF ENVIRONMENTAL MANAGEMENT AND SHALL ABIDE BY THE TOWN'S SOIL EROSION ORDINANCE.
- PRIOR TO COMMENCING CONSTRUCTION ACTIVITIES, EROSION AND SEDIMENTATION CONTROLS WILL BE INSTALLED AT THOSE AREAS INDICATED ON THE PLANS OR AS DIRECTED BY THE ENGINEER. CLEARING MAY OCCUR PRIOR TO INSTALLATION OF SUCH CONTROLS, HOWEVER, NO GRUBBING, GRADING, FILLING, OR OTHER SOIL DISTURBANCE SHALL OCCUR PRIOR TO INSTALLATION.
- NO UNDISTURBED AREAS WILL BE CLEARED OF EXISTING VEGETATION AFTER OCTOBER 15 OF ANY CALENDAR YEAR.
- THE CONTRACTOR WILL BE REQUIRED TO PROVIDE PLANTABLE SOIL OR LOAM AND SEED ALL DISTURBED ROADSIDE AREAS AND MATCH EXISTING GRADE.
- ALL SOIL EXPOSED PRIOR TO OCTOBER 15 OF ANY CALENDAR YEAR SHALL BE SEED OR PROTECTED BY THIS DATE. ANY SUCH AREAS WHICH DO NOT HAVE ADEQUATE VEGETATIVE STABILIZATION, AS DETERMINED BY THE RIDOT RESIDENT ENGINEER OR ENVIRONMENTAL INSPECTOR, BY NOVEMBER 15 OF ANY CALENDAR YEAR, MUST BE STABILIZED THROUGH THE USE OF EROSION CONTROL MATTING OR HAY MULCH, IN ACCORDANCE WITH SPECIFICATIONS CONTAINED WITHIN THE RI SOIL EROSION AND SEDIMENT CONTROL HANDBOOK. IF WORK CONTINUES WITHIN ANY OF THESE AREAS DURING THE PERIOD FROM OCTOBER 15 THROUGH APRIL 15, CARE MUST BE TAKEN TO ENSURE THAT ONLY THE AREA REQUIRED FOR THAT DAY'S WORK IS EXPOSED, AND ALL ERODABLE SOIL MUST BE RESTABILIZED WITHIN 5 WORKING DAYS. ANY ADDITIONAL WORK REQUIRED TO CORRECT PROBLEMS RESULTING FROM FAILURE TO COMPLY WITH THIS PROVISION SHALL BE THE RESPONSIBILITY OF THE CONTRACTOR. THERE SHALL BE NO SEPARATE PAYMENT FOR THIS PROVISION, IT SHALL BE CONSIDERED INCIDENTAL TO CONSTRUCTION OPERATIONS.
- ALL HAYBALES ARE TO BE INSTALLED WITH THE LOWER 6 INCHES BURIED AND BACKFILLED WITH COMPACTED SOIL MATERIAL.
- THE TOE OF ANY FILL SLOPE IS TO REMAIN AT LEAST ONE FOOT INSIDE OF ALL EROSION CONTROLS. UNDER NO CIRCUMSTANCE SHALL THE CONTRACTOR COVER ANY PORTION OF THE EROSION CONTROLS WITH FILL MATERIAL. ANY FILL MATERIAL WHICH IS PLACED ON ANY EROSION CONTROLS BY THE CONTRACTOR, SHALL BE IMMEDIATELY REMOVED BY THE CONTRACTOR, AND ANY NECESSARY REPAIRS TO THE EROSION CONTROLS ACCOMPLISHED, AT NO COST TO THE STATE.
- ADDITIONAL EROSION CONTROLS WILL BE INSTALLED AS CONDITIONS WARRANT, OR AS DIRECTED BY THE RIDOT RESIDENT ENGINEER.
- DURING CONSTRUCTION, THE CONTRACTOR SHALL BE RESPONSIBLE FOR ALL EROSION CONTROL MAINTENANCE AND SHALL INSPECT/REPLACE ALL CONTROLS AS NEEDED. MAINTENANCE WILL BE CARRIED OUT IN ACCORDANCE WITH SECTION 212 OF THE LATEST EDITION OF THE RIDOT STANDARD SPECIFICATIONS. THE CONTRACTOR IS RESPONSIBLE FOR CARRYING OUT NECESSARY MAINTENANCE DURING ALL PHASES OF PROJECT CONSTRUCTION, INCLUDING PERIODS OF "WINTER SHUTDOWN".

**GENERAL NOTES – UTILITIES**

- THE LOCATIONS OF EXISTING UTILITIES AS SHOWN ON THE PLANS ARE APPROXIMATE AND SHOULD NOT BE RELIED UPON BY THE CONTRACTOR. THE CONTRACTOR SHALL CHECK AND VERIFY THE EXACT LOCATION OF ALL EXISTING UTILITIES, BOTH UNDERGROUND AND OVERHEAD, WITH RHODE ISLAND DIG SAFE. DAMAGE TO UTILITIES WHICH ARE SHOWN ON THE PLANS OR DETAILED BY DIG SAFE SHALL BE THE CONTRACTOR'S RESPONSIBILITY. REFER TO SECTION 105.06 COOPERATION WITH UTILITIES OF THE STANDARD SPECIFICATIONS FOR ADDITIONAL REQUIREMENTS.
- THE GUARDRAIL AND SIGNING CONTRACTORS SHALL INVESTIGATE THE LOCATIONS OF ANY UNDERGROUND PRIVATE SECONDARY ELECTRIC SERVICE LINES, COMMUNICATION CABLES OR OTHER UNDERGROUND UTILITY SERVICE AND EXERCISE CAUTION WHILE INSTALLING THE NEW POSTS.

**GENERAL NOTES – SIGNS**

- PRIOR TO INSTALLATION, ALL SIGNS, MOUNTINGS AND LOCATIONS SHALL BE APPROVED BY THE ENGINEER.
- ALL SIGNS SHALL CONFORM TO THE MANUAL ON UNIFORM TRAFFIC CONTROL DEVICES (MUTCD) 2003 EDITION WITH THE LATEST REVISIONS.
- THE STREET SIGN ASSEMBLY SHALL BE IN ACCORDANCE WITH RI STD. DETAIL NO. 24.6.1 AND SECTION T.15 OF THE RI STANDARD SPECIFICATIONS. THE INTERSECTING TOWN STREET SIGN BLADES SHALL MATCH THE DESIGN OF THE EXISTING SIGNS AND INCLUDE THE TOWN SHIELD. THE RIDOT STANDARD SIGN BLADES SHALL BE USED FOR ALL STATE ROADS:  
 -PUTNAM PIKE  
 -WEST GREENVILLE RD.

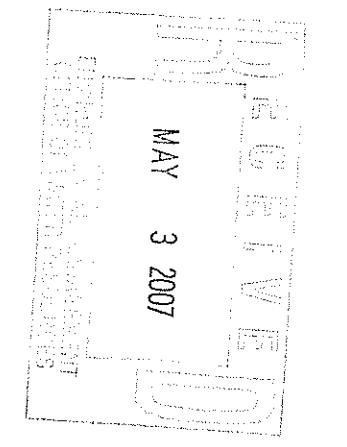

**GENERAL NOTES--PAVEMENT MARKINGS**

- ALL PAVEMENT MARKINGS ARE TO BE IN ACCORDANCE WITH THE REQUIREMENTS OF THE MANUAL ON UNIFORM TRAFFIC CONTROL DEVICES, 2003 EDITION, WITH THE LATEST REVISIONS.
- AT THE COMPLETION OF EACH DAY'S COLD PLANING OR REPAVING OPERATION, THE CONTRACTOR IS REQUIRED TO PROVIDE TEMPORARY FAST DRYING WATERBORNE WHITE AND YELLOW PAVEMENT MARKING PAINT IN AREAS OPEN TO VEHICULAR TRAFFIC. THESE MARKINGS SHALL MATCH THE EXISTING MARKINGS REMOVED.

RIDEM REQUEST FOR  
PRELIMINARY DETERMINATION  
APRIL 25, 2007

DEPARTMENT OF ENVIRONMENTAL MANAGEMENT  
OFFICE OF WATER RESOURCES  
FRESHWATER WETLANDS PROGRAM  
APPROVED WITH CONDITIONS  
AS SPECIFIED IN THE LETTER OF APPROVAL  
DATED JUN 15 2007. FILE # 07-097  
NO CHANGES ALLOWED WITHOUT PRIOR APPROVAL  
APPROVED PLANS MUST BE AT CONSTRUCTION SITE

*Charles A. Herbert*

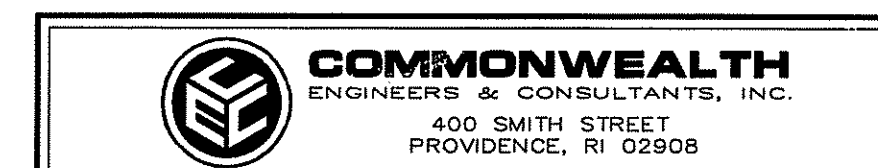
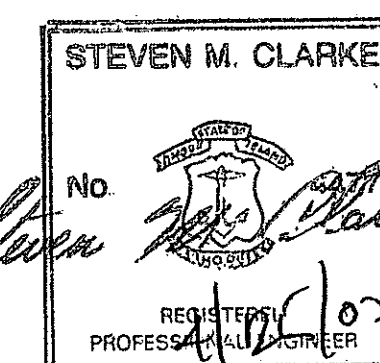

REVISIONS			RHODE ISLAND DEPARTMENT OF TRANSPORTATION	
No.	DATE	BY		
			1R HIGHWAY IMPROVEMENTS TO U.S ROUTE 44 (PUTNAM PIKE) WEST GREENVILLE ROAD TO AUSTIN AVENUE	
			SMITHFIELD	RHODE ISLAND
			GENERAL NOTES	
			CHECKED BY _____	DATE _____ SCALE N/A

P:\97061\03 Route 44 - Contract III Drawings\Transportation\Current Drawings\Transportation\GENERAL-NOTES.dwg, 4/20/2007 4:27:56 PM, xerox.pc3, KMM

FED. RD. DIVISION	STATE	FEDERAL AID PROJECT NO.	FISCAL YEAR	SHEET NO.	TOTAL SHEETS
1	R.I.			4	6

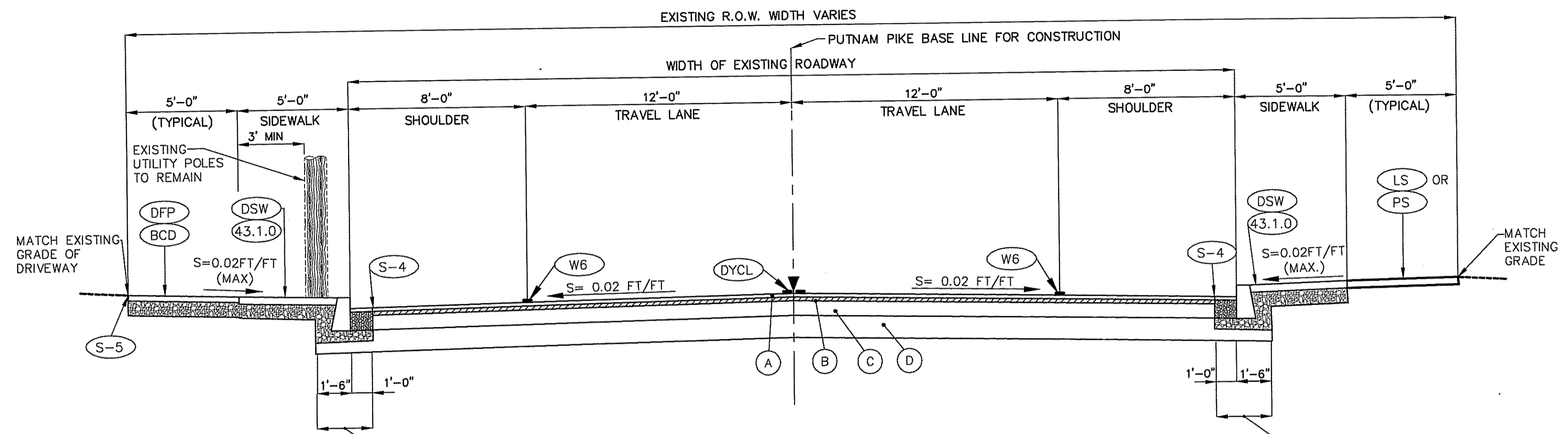

- PAVEMENT LEGEND**
- (A) COLD PLANE 1-1/2" DEPTH (935.0500) AND APPLY ASPHALT EMULSION TACK COAT (403.0300) AND 2" BITUMINOUS CONCRETE CLASS 1-1 OVERLAY (401.0200).
  - (B) EXISTING 1-1/2"± TO 2-1/2"± BITUMINOUS PAVEMENT TO REMAIN (PER BORING LOGS).
  - (C) EXISTING 8"± CEMENT CONCRETE BASE COURSE TO REMAIN (PER BORING LOGS).
  - (D) EXISTING GRAVEL BORROW SUBBASE COURSE TO REMAIN.

**U.S. ROUTE 44  
TYPICAL SECTION NO. 1  
STA. 318+00 TO 354+75  
SCALE: 1/4"=1'-0"**

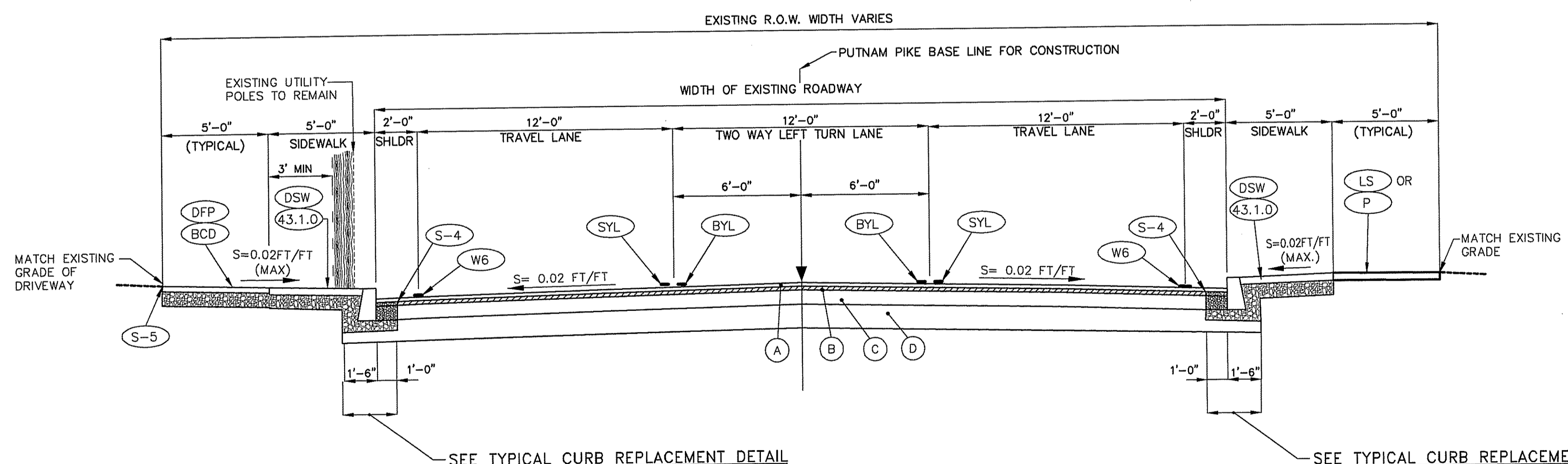

**U.S. ROUTE 44  
TYPICAL SECTION NO. 2  
STA. 355+75 TO 369+00  
SCALE: 1/4"=1'-0"**

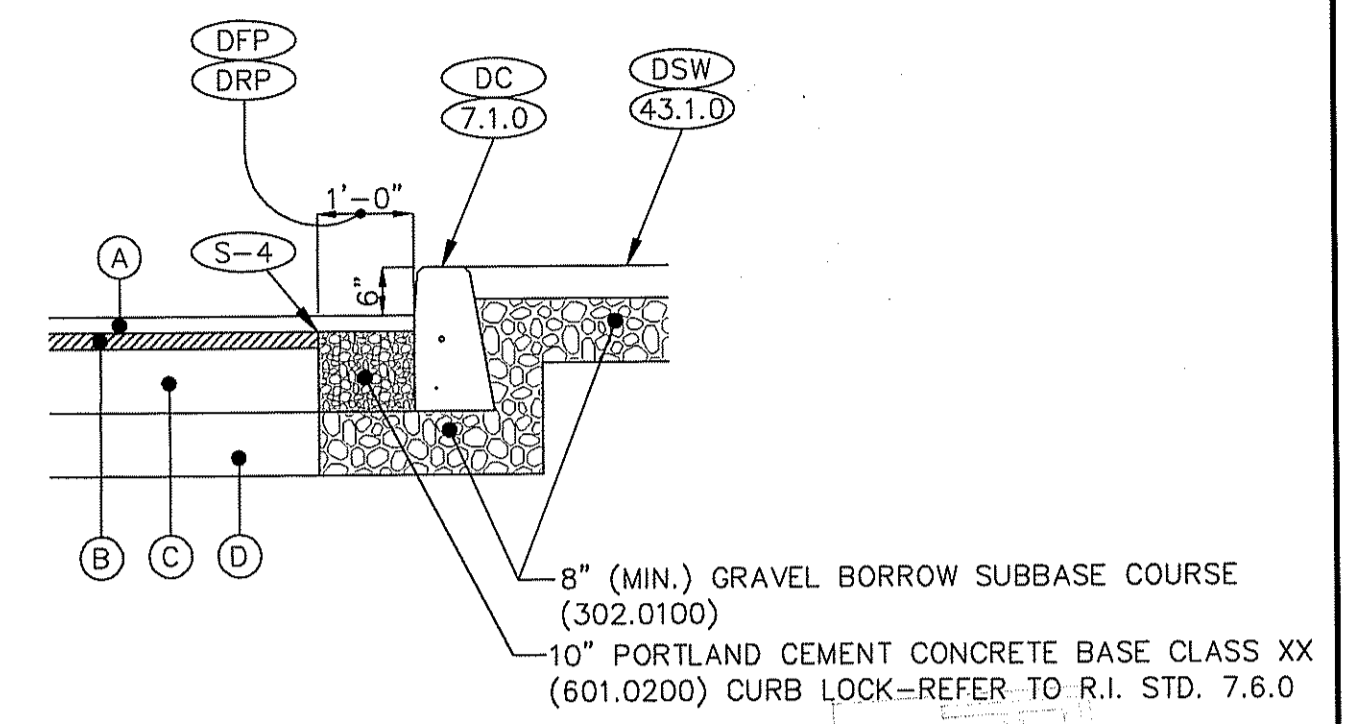

**TYPICAL CURB REPLACEMENT DETAIL**  
SCALE: 1/2"=1'-0"

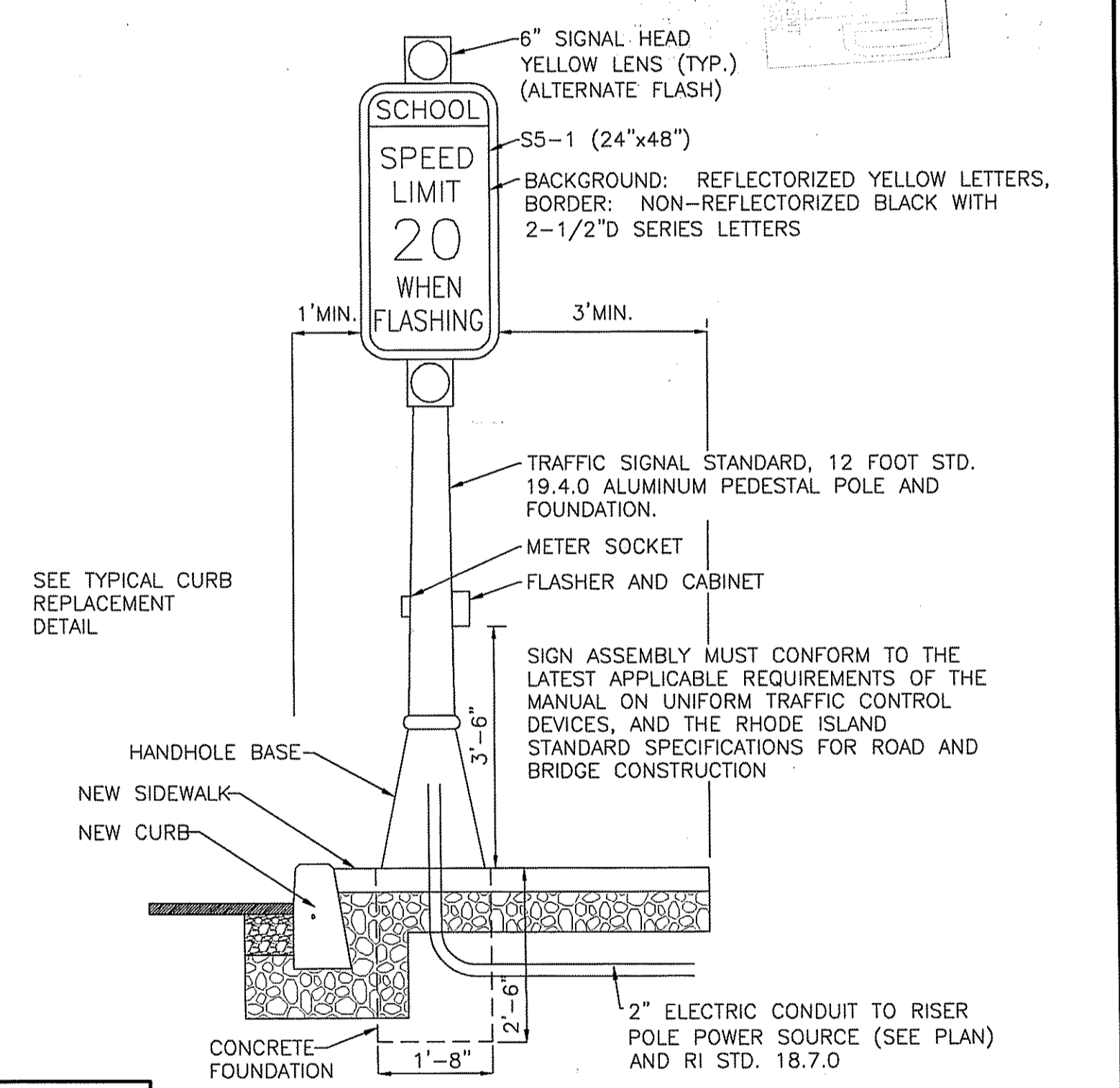

**SCHOOL ZONE FLASHING SIGN DETAIL**  
SCALE: 1"=2'  
DATE: JUN 15 2007  
FILE # 07-017

**RIDEM REQUEST FOR  
PRELIMINARY DETERMINATION  
APRIL 25, 2007**

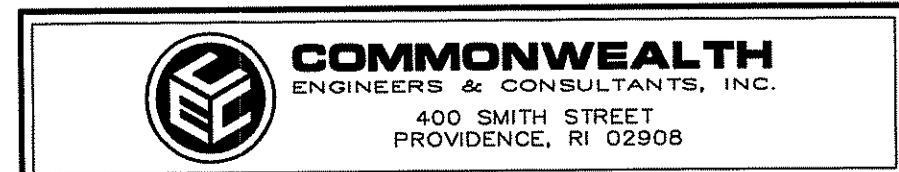
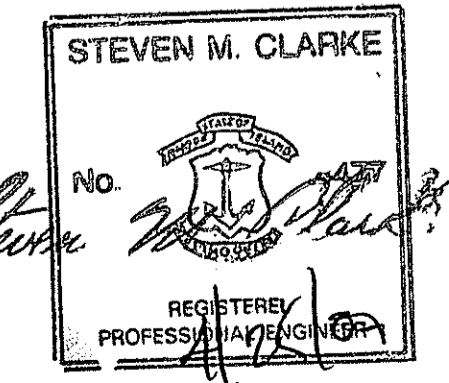

REVISIONS		
No.	DATE	BY

**RHODE ISLAND**  
**DEPARTMENT OF TRANSPORTATION**  
 1R HIGHWAY IMPROVEMENTS TO  
**U.S. ROUTE 44 (PUTNAM PIKE)**  
 WEST GREENVILLE ROAD TO AUSTIN AVENUE  
 SMITHFIELD RHODE ISLAND  
**TYPICAL SECTIONS AND DETAILS**  
 CHECKED BY \_\_\_\_\_ DATE \_\_\_\_\_ SCALE AS SHOWN

P:\97000\97061.03 Route 44 - Contract I\Drawings\Transportation\Current\_Drawings\Transportation\Typical Section.dwg, 4/20/2007 4:28:38 PM, xerox.pc3, KMM

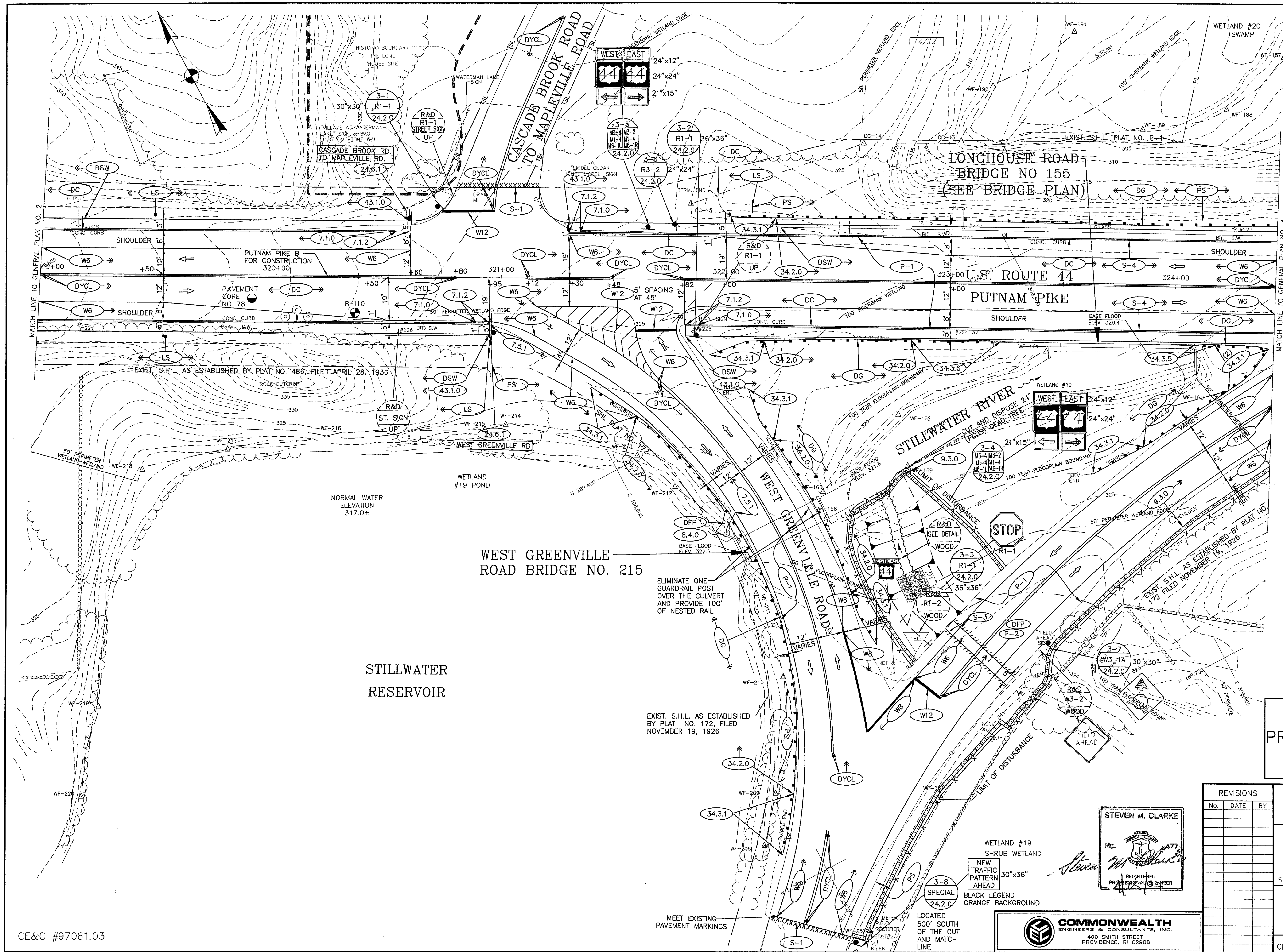

DEPARTMENT OF ENVIRONMENTAL MANAGEMENT  
OFFICE OF WATER RESOURCES  
FRESHWATER WETLANDS PROGRAM  
APPROVED WITH CONDITIONS  
AS SPECIFIED IN THE LETTER OF APPROVAL  
DATED JUN 15 2007 FILE # 07-0177  
NO CHANGES ALLOWED WITHOUT PRIOR APPROVAL  
APPROVED PLANS MUST BE AT CONSTRUCTION SITE

*Charles A. Harbert*

RIDEM REQUEST FOR  
PRELIMINARY DETERMINATION  
APRIL 25, 2007

RHODE ISLAND  
DEPARTMENT OF TRANSPORTATION

1R HIGHWAY IMPROVEMENTS TO  
**U.S. ROUTE 44 (PUTNAM PIKE)**  
WEST GREENVILLE ROAD TO AUSTIN AVENUE

SMITHFIELD RHODE ISLAND

GENERAL PLAN NO. 3

CHECKED BY \_\_\_\_\_ DATE \_\_\_\_\_ SCALE 1"=20'

REVISIONS		
No.	DATE	BY

STEVEN M. CLARKE  
No. 477  
REGISTERED PROFESSIONAL ENGINEER

*Steven M. Clarke*

COMMONWEALTH  
ENGINEERS & CONSULTANTS, INC.  
400 SMITH STREET  
PROVIDENCE, RI 02908

P:\97000\97061.03 Route 44 - Contract II\_Drawings\Transportation\_Current\_Drawings\GENERAL.dwg, 4/20/2007 4:28:48 PM, xerox.pcs, KMM

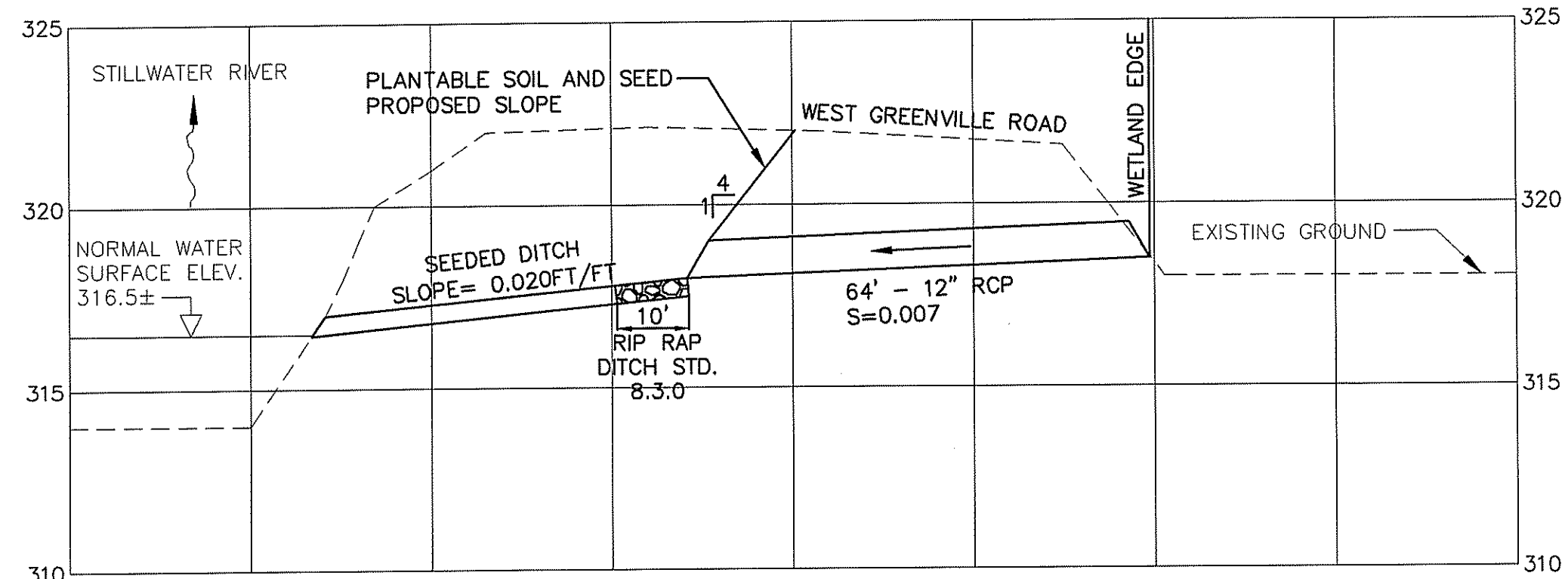
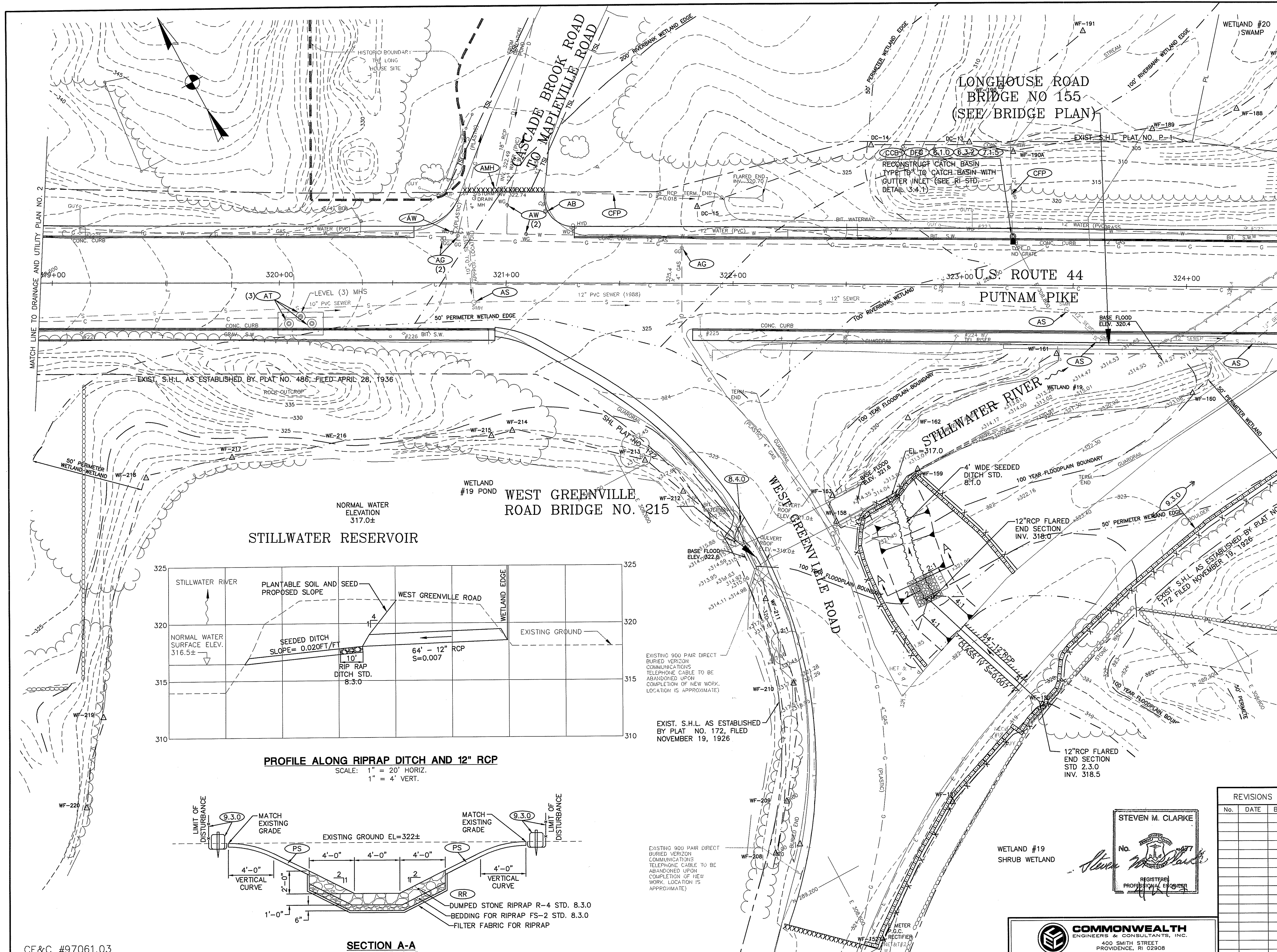

**PROFILE ALONG RIPRAP DITCH AND 12" RCP**  
 SCALE: 1" = 20' HORIZ.  
 1" = 4' VERT.

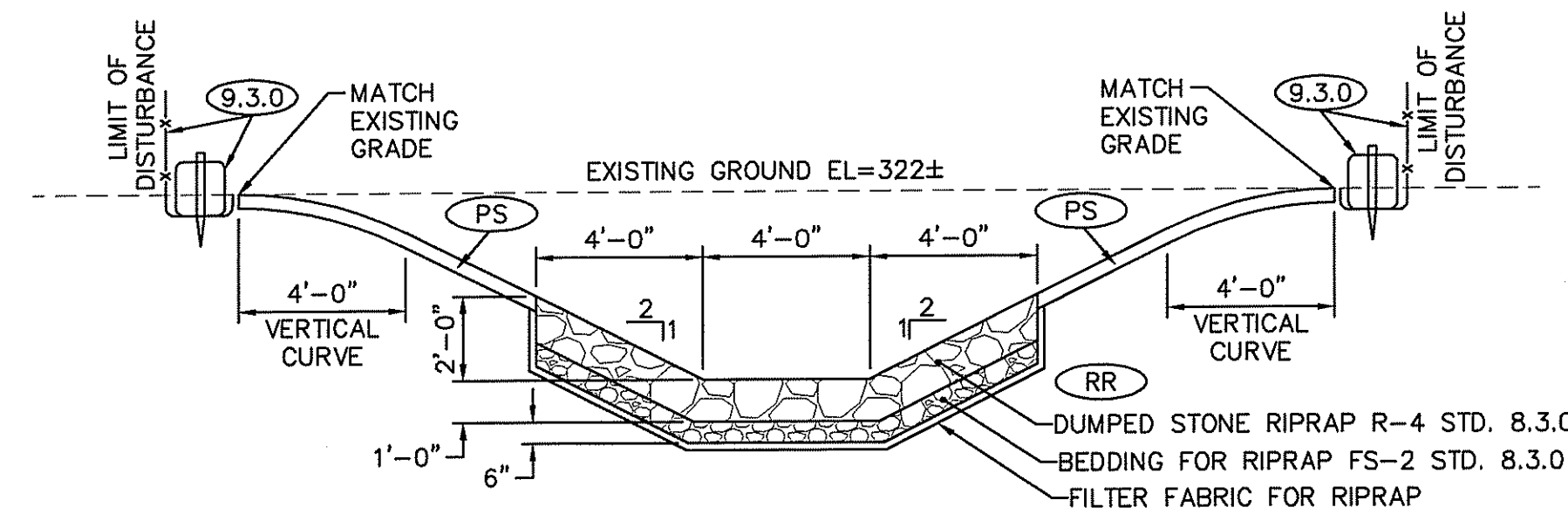

**SECTION A-A**  
 SCALE: 1/4" = 1'-0"

**RIDEM REQUEST FOR PRELIMINARY DETERMINATION**  
 APRIL 25, 2007

DEPARTMENT OF ENVIRONMENTAL MANAGEMENT  
 OFFICE OF WATER RESOURCES  
 FRESHWATER WETLANDS PROGRAM  
 APPROVED WITH CONDITIONS  
 AS SPECIFIED IN THE LETTER OF APPROVAL  
 DATED JUN 13 2007 FILE # 07-0197  
 NO CHANGES ALLOWED WITHOUT PRIOR APPROVAL  
 APPROVED PLANS MUST BE AT CONSTRUCTION SITE

*Charles A. Haber*

**RHODE ISLAND DEPARTMENT OF TRANSPORTATION**

1R HIGHWAY IMPROVEMENTS TO  
**U.S. ROUTE 44 (PUTNAM PIKE)**  
 WEST GREENVILLE ROAD TO AUSTIN AVENUE

**DRAINAGE AND UTILITY PLAN NO. 3**

CHECKED BY \_\_\_\_\_ DATE \_\_\_\_\_ SCALE 1"=20'

REVISIONS		
No.	DATE	BY

STEVEN M. CLARKE  
 No. 071000001  
 REGISTERED PROFESSIONAL ENGINEER

**COMMONWEALTH ENGINEERS & CONSULTANTS, INC.**  
 400 SMITH STREET  
 PROVIDENCE, RI 02908

P:\97000\97061.03 Route 44 - Contract III\_Drawings\Transportation\Current\_Drawings\DRAINAGE.dwg, 4/20/2007 4:31:35 PM, xerox.pc3, KMM

CE&C #97061.03

MAY 3 2007