

GENERAL NOTES:

1. THE LOCATION AND DEPTH OF EXISTING UTILITIES ARE APPROXIMATE AND HAVE BEEN PLOTTED FROM THE LATEST AVAILABLE INFORMATION. THE UTILITY LOCATIONS ARE APPROXIMATE AND MAY NOT BE ALL INCLUSIVE. THE CONTRACTOR SHALL CHECK AND VERIFY THE LOCATIONS OF ALL EXISTING UTILITIES, BOTH OVERHEAD AND UNDERGROUND, AND "DIG-SAFE" MUST BE NOTIFIED PRIOR TO COMMENCING ANY CONSTRUCTION OPERATIONS. RESTORATION AND REPAIR OF DAMAGE TO EXISTING UTILITIES SHALL BE THE RESPONSIBILITY OF THE CONTRACTOR WITH NO ADDITIONAL COST TO THE OWNER. NO EXCAVATION SHALL COMMENCE UNTIL ALL INVOLVED UTILITY COMPANIES AND/OR TOWN WHOSE FACILITIES MIGHT BE AFFECTED BY ANY WORK TO BE PERFORMED BY THE CONTRACTOR ARE NOTIFIED AT LEAST 72 HOURS IN ADVANCE.

2. ALL ELEVATIONS ON BURRILLVILLE SEWER DATUM.

LEGEND
NOT TO SCALE

	MAJOR CONTOUR
	MINOR CONTOUR
	TREELINE
	WETLANDS EDGE
	50' PERIMETER WETLAND
	DRAINAGE LINE
	SEWER LINE
	WATER LINE
	ELECTRIC LINE
	WELL
	UTILITY POLE

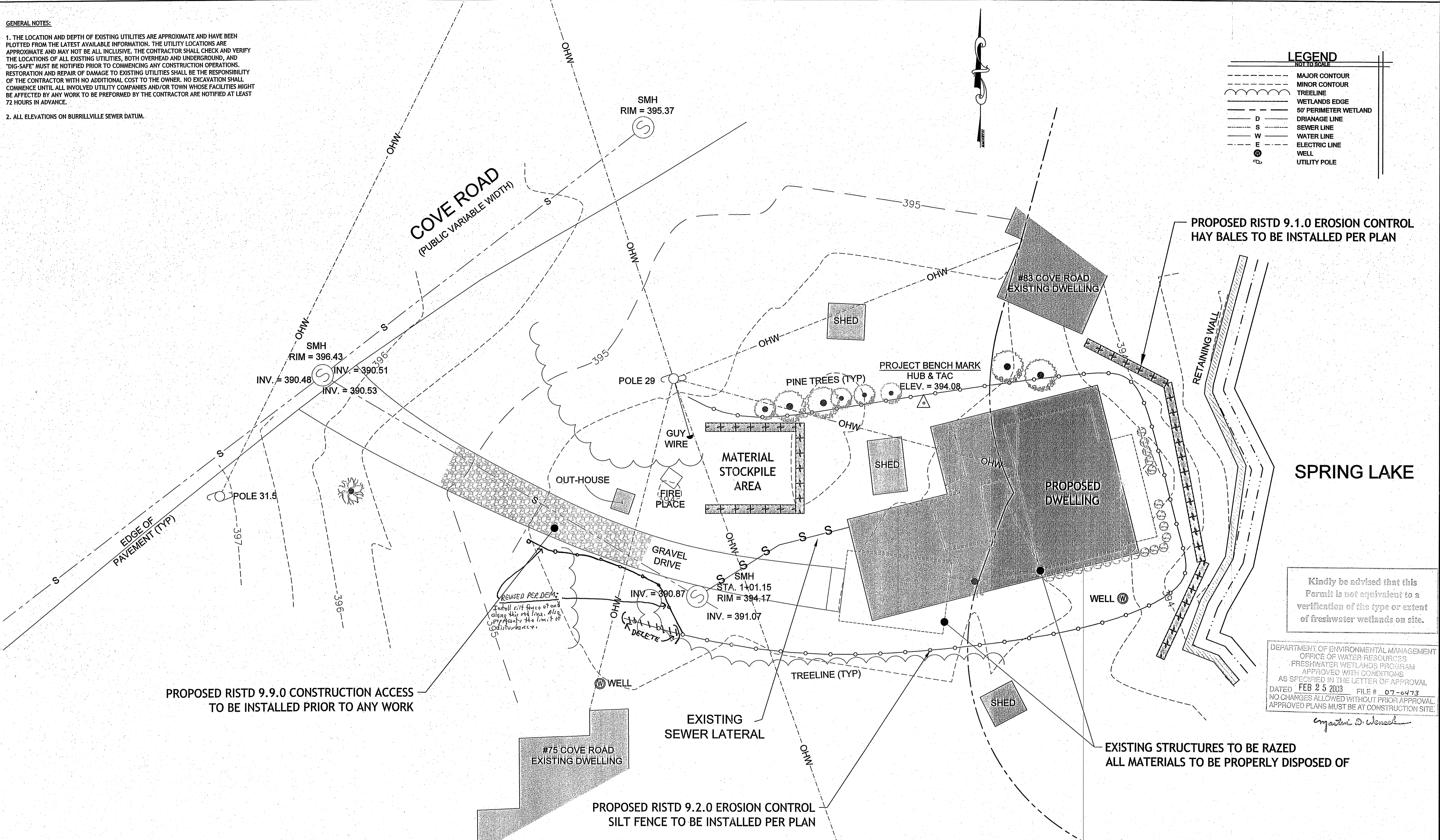

PROPOSED RISTD 9.9.0 CONSTRUCTION ACCESS TO BE INSTALLED PRIOR TO ANY WORK

PROPOSED RISTD 9.1.0 EROSION CONTROL HAY BALES TO BE INSTALLED PER PLAN

PROPOSED RISTD 9.2.0 EROSION CONTROL SILT FENCE TO BE INSTALLED PER PLAN

SPRING LAKE

Kindly be advised that this Permit is not equivalent to a verification of the type or extent of freshwater wetlands on site.

DEPARTMENT OF ENVIRONMENTAL MANAGEMENT
OFFICE OF WATER RESOURCES
FRESHWATER WETLANDS PROGRAM
APPROVED WITH CONDITIONS
AS SPECIFIED IN THE LETTER OF APPROVAL
DATED FEB 25 2003 FILE # 07-0473
NO CHANGES ALLOWED WITHOUT PRIOR APPROVAL
APPROVED PLANS MUST BE AT CONSTRUCTION SITE.

Ernesto D. Wenzel

EXISTING STRUCTURES TO BE RAZED
ALL MATERIALS TO BE PROPERLY DISPOSED OF

I CERTIFY THAT THE INFORMATION SHOWN HEREON HAS BEEN OBTAINED BY AN ACTUAL SURVEY ON THE GROUND, THAT IT IS CORRECT AND THIS PROPERTY LINE SURVEY AND PLAN CONFORM TO A CLASS I STANDARD; THIS TOPOGRAPHIC SURVEY AND PLAN CONFORM TO A CLASS III STANDARD AS ADOPTED BY THE RHODE ISLAND BOARD OF REGISTRATION FOR PROFESSIONAL LAND SURVEYORS.
BY: *Norbert A. Therien*
NORBERT A. THERIEN, PLS DATE

NATIONAL SURVEYORS-DEVELOPERS INC.
42 HAMLET AVE. WOODSBOCKET, R.I.
(401) 769-7779

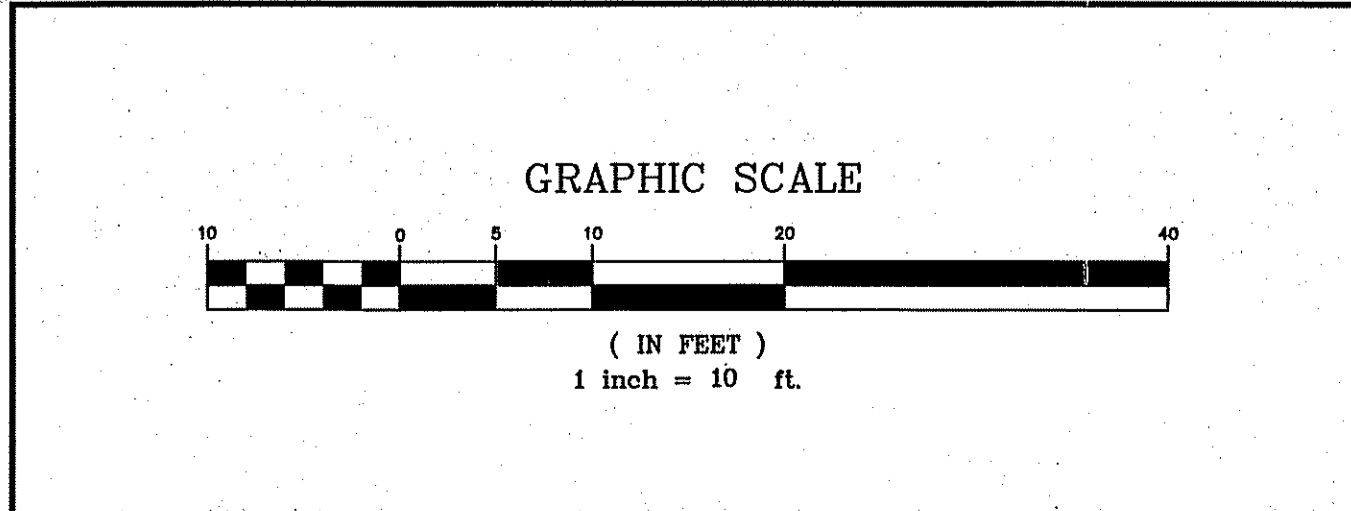

NORBERT A. THERIEN
No. 1739
PROFESSIONAL LAND SURVEYOR

GERMAINE CAYER
79 COVE ROAD
BURRILLVILLE, RHODE ISLAND
AP 110/003 LOT 26

FIELD WORK BY:	EM/CM
DRAWN/CLAC BY:	JS
CHECKED BY:	RCS
DATE:	07/07/07
PROJECT NO.:	2007-130
PROPOSED SITE PLAN	
SHEET 2 OF 3	

LAYOUT NOTE:

THE LAYOUT SHOWN REPRESENTS A GRAPHICAL DESIGN, AND PRIOR TO THE CONSTRUCTION, THE CONTRACTOR SHALL ENGAGE A PROFESSIONAL LAND SURVEYOR (PLS) REGISTERED IN THE STATE OF RHODE ISLAND TO SET AND VERIFY ALL LINES AND GRADES. ALL EXISTING UTILITY LOCATIONS AND ELEVATIONS ARE TO BE CONFIRMED BY THE CONTRACTOR PRIOR TO CONSTRUCTION. ANY ITEM FOUND WHICH DOES NOT MATCH THE PLANS MUST BE BROUGHT TO THE ENGINEERS ATTENTION PRIOR TO CONSTRUCTION FOR REVIEW. NO WORK SHALL PROCEED UTILITY AUTHORIZED BY THE ENGINEER.

MISCELLANEOUS UTILITY NOTES:

1. PRIOR TO CONSTRUCTION ALL POTENTIAL UTILITY/DRAINAGE CONFLICTS MUST BE IDENTIFIED BY THE CONTRACTOR. ANY MODIFICATIONS TO THE PROPOSED UTILITIES TO AVOID CONFLICTS MUST BE APPROVED BY THE ENGINEER PRIOR TO CONSTRUCTION. NO EXTRA PAYMENT TO THE CONTRACTOR DUE TO RELOCATIONS WILL BE AUTHORIZED.
3. THE CONTRACTOR SHALL AT ALL TIMES PROVIDE A SUFFICIENT NUMBER OF WORKMEN AND GUARDS AS MAY BE NECESSARY TO PROPERLY SAFEGUARD THE PUBLIC FROM THESE OPERATIONS.
5. THE CONTRACTOR SHALL TAKE PRECAUTIONS AGAINST THE DAMAGING OF PAVING, SIDEWALKS, UTILITIES, OR PRIVATE PROPERTIES AND SHALL PROMPTLY REPAIR AT HIS OWN EXPENSE ANY DAMAGE TO SUCH PAVING, SIDEWALKS, UTILITIES, OR PRIVATE PROPERTIES TO THE SATISFACTION OF THE OWNER.

SITE NOTES:

1. CONTRACTOR SHALL BE RESPONSIBLE FOR REMOVING AND LEGALLY DISPOSING (R&D) OF ALL MATERIALS INDICATED ON THE PLANS.
2. STOCKPILES OF EARTH MATERIALS SHALL NOT BE LOCATED ADJACENT TO DRAINAGE STRUCTURES.
3. ALL DISTURBED AREAS OUTSIDE OF THE PAVED AREAS WILL RECEIVE A MINIMUM OF 6" OF LOAM AND SEED.
6. WHERE NECESSARY TO REMOVE CURBS, CATCH BASINS OR DRAINS TO COMPLETE WORK, THE CONTRACTOR SHALL REPLACE SUCH ITEMS TO THE SATISFACTION OF THE CITY AT NO ADDITIONAL COST TO THE OWNER.
7. ANY EXISTING PIPE OR UTILITY DAMAGED BY THE CONTRACTOR'S OPERATIONS SHALL BE REPAIRED IMMEDIATELY BY THE CONTRACTOR AT NO COST TO THE OWNER OR CITY.
8. THE CONTRACTOR SHALL RESTORE TO ITS ORIGINAL CONDITION OR REPLACE TREES, SHRUBS, FENCES, SIGNS, GUARDRAILS, DRIVEWAYS, SIDEWALKS AND ANY OTHER OBJECT AFFECTED BY THIS OPERATION.
9. THE TOPS OF ALL CLEANOUTS, VALVE BOXES AND CURB BOXES SHALL BE FLUSH WITH GROUND OR PAVEMENT SURFACE LEVEL AND PLUMB, UNLESS OTHERWISE DIRECTED.
10. ROADWAYS SHALL BE LEFT PASSABLE AT ALL TIMES. CLOSURE OF ROADWAY IN NOT PERMITTED.
11. THE CONTRACTOR SHALL PROVIDE ACCESS TO ALL DRIVEWAYS AT COMPLETION OF EACH DAYS WORK.
12. WATER SERVICE SHALL BE MAINTAINED AT ALL TIMES.
14. ALL LEDGE TO BE REMOVED BY MECHANICAL MEANS.
13. ALL CONSTRUCTION WORK SHALL BE PERFORMED IN THE DRY. THE CONTRACTOR SHALL PROVIDE, OPERATE AND MAINTAIN ALL PUMPS, DRAINS, WET POINTS, SCREENS, OR OTHER FACILITIES NECESSARY TO CONTROL, COLLECT AND DISPOSE OF ALL SURFACE AND SUBSURFACE WATER ENCOUNTERED IN THE PERFORMANCE OF THE WORK.
14. 40 EMPLOYEES AT 15 GAL./DAY, 600 GAL./DAY TOTAL

SOIL EROSION AND SEDIMENTATION CONTROL NOTES:

THE HAYBALE AND SILT FENCE LINE ILLUSTRATED ON THESE PLANS SHALL SERVE AS THE STRICT LIMIT OF DISTURBANCE FOR THE PROJECT WITHIN OR ADJACENT TO REGULATED FRESHWATER WETLAND AREAS.

THE LIMITS OF CLEARING, GRADING, AND DISTURBANCE SHALL BE KEPT TO A MINIMUM WITHIN THE PROPOSED AREA OF CONSTRUCTION. ALL AREAS OUTSIDE OF THESE LIMITS, AS DEPICTED ON THE PLAN SHALL BE TOTALLY UNDISTURBED, TO REMAIN IN NATURAL CONDITION.

ALL CATCH BASINS SHALL BE PROTECTED WITH STAKED HAYBALES (R.I. STD. 9.8.0) DURING CONSTRUCTION ACTIVITIES. ALL PROPOSED STORMWATER DISCHARGE AREAS SHALL BE LINED WITH A RIPRAP SPLASH PAD AND PROTECTED WITH STAKED HAYBALE OUTLET PROTECTION (R.I. STD. 9.4.0), OR STAKED HAYBALE WITH SILT FENCE (R.I. STD. 9.3.0) SHALL ALSO BE INSTALLED AT ALL EXISTING STORMWATER DISCHARGE LOCATIONS WHERE DISTRIBUTING PIPES, CATCH BASINS, AND MANHOLES ARE TO BE CLEANED AND FLUSHED.

ALL DISTURBED SLOPES EITHER NEWLY CREATED OR CURRENTLY EXPOSED SHALL BE SEEDED, PROTECTED AND MAINTAINED BY THE CONTRACTOR. THE CONTRACTOR SHALL REGULARLY CHECK ALL SEEDED AREAS TO ENSURE THAT A GOOD STAND OF VEGETATION IS MAINTAINED.

ALL HAYBALES, TEMPORARY TREATMENT (HAY, STRAW, ETC.) AND TEMPORARY EROSION PROTECTION SHALL BE MAINTAINED BY THE CONTRACTOR THROUGHOUT CONSTRUCTION AND SHALL REMAIN IN PLACE UNTIL AN ACCEPTABLE STAND OF GRASS OR APPROVED GROUND COVER IS ESTABLISHED.

STOCKPILES OF TOPSOIL SHALL NOT BE LOCATED NEAR WATERWAYS OR WETLAND EDGES. THEY SHALL HAVE SIDE SLOPES OF NO GREATER THAN 2:1 AND SHALL BE TEMPORARILY SEEDED AND/OR STABILIZED PER CONTRACT SPECIFICATIONS.

THE HAYBALES SHALL BE CHECKED BY THE CONTRACTOR ON A WEEKLY BASIS AND AFTER EACH STORM FOR UNDERMINING OR DETERIORATION. THE CONTRACTOR SHALL REPAIR OR REPLACE ANY HAYBALES AS NEEDED. THE CONTRACTOR SHALL CLEAN THE ACCUMULATED SEDIMENT IF HALF OF THE ORIGINAL HEIGHT OF THE BALES BECOMES FILLED WITH SEDIMENTS.

IT SHALL BE THE RESPONSIBILITY OF THE CONTRACTOR TO MAINTAIN ALL SOIL EROSION AND SEDIMENT CONTROLS ON THE PROJECT SITE FOR THE ENTIRE DURATION OF THE CONSTRUCTION PERIOD. THE CONTRACTOR SHALL FOLLOW THE DIRECTION OF THE RESIDENT ENGINEER WITH REGARD TO INSTALLATION, MAINTENANCE, AND REPAIR OF ALL SOIL EROSION AND SEDIMENTATION CONTROLS ON THE PROJECT SITE. TEMPORARY SOIL EROSION AND SEDIMENTATION CONTROLS (HAYBALES, SILT FENCE, ETC.) SHALL BE MAINTAINED UNTIL ALL EXPOSED SOILS ARE SATISFACTORILY STABILIZED. THE CONTRACTOR SHALL BE RESPONSIBLE FOR REPAIRING AND/OR RESEEDING ALL AREAS THAT DO NOT DEVELOP WITHIN ONE YEAR FROM THE COMPLETION OF CONSTRUCTION.

ALL REFERENCED SOIL EROSION AND SEDIMENTATION CONTROLS INCLUDING MATERIALS USED, APPLICATION RATES AND THE INSTALLATION PROCEDURES SHALL BE PERFORMED PER THE "RHODE ISLAND EROSION AND SEDIMENTATION HANDBOOK", DATED 1993.

BMP MAINTENANCE SCHEDULE:

ALL MAINTENANCE (INCLUDING CLEANING) REQUIRED DURING THE CONSTRUCTION PHASE OF THE PROJECT SHALL BE THE RESPONSIBILITY OF THE CONTRACTOR AND SHALL INCLUDE:

INSPECTION OF ALL SLOPES, BERMS, AND OTHER CONTROL STRUCTURES (INCLUDING ROADWAY SIDE SLOPES, FOR STRUCTURAL INTEGRITY/STABILITY AND EVIDENCE OF SOIL EROSION PROCESSES, AND MAINTENANCE OF THESE STRUCTURES IF NECESSARY. INSPECTIONS SHALL BE PERFORMED FOLLOWING ALL RAIN EVENTS OF 1/8 INCH RAINFALL OR MORE IN A 24-HOUR PERIOD, OR BI-MONTHLY IF NO RAINFALL EVENT OCCURS.

REPLANTING, REGRADING, OR OTHER REPAIRS NEEDED AS A RESULT OF SOIL EROSION AND SEDIMENTATION PROCESSES SHALL BE DONE PROMPTLY.

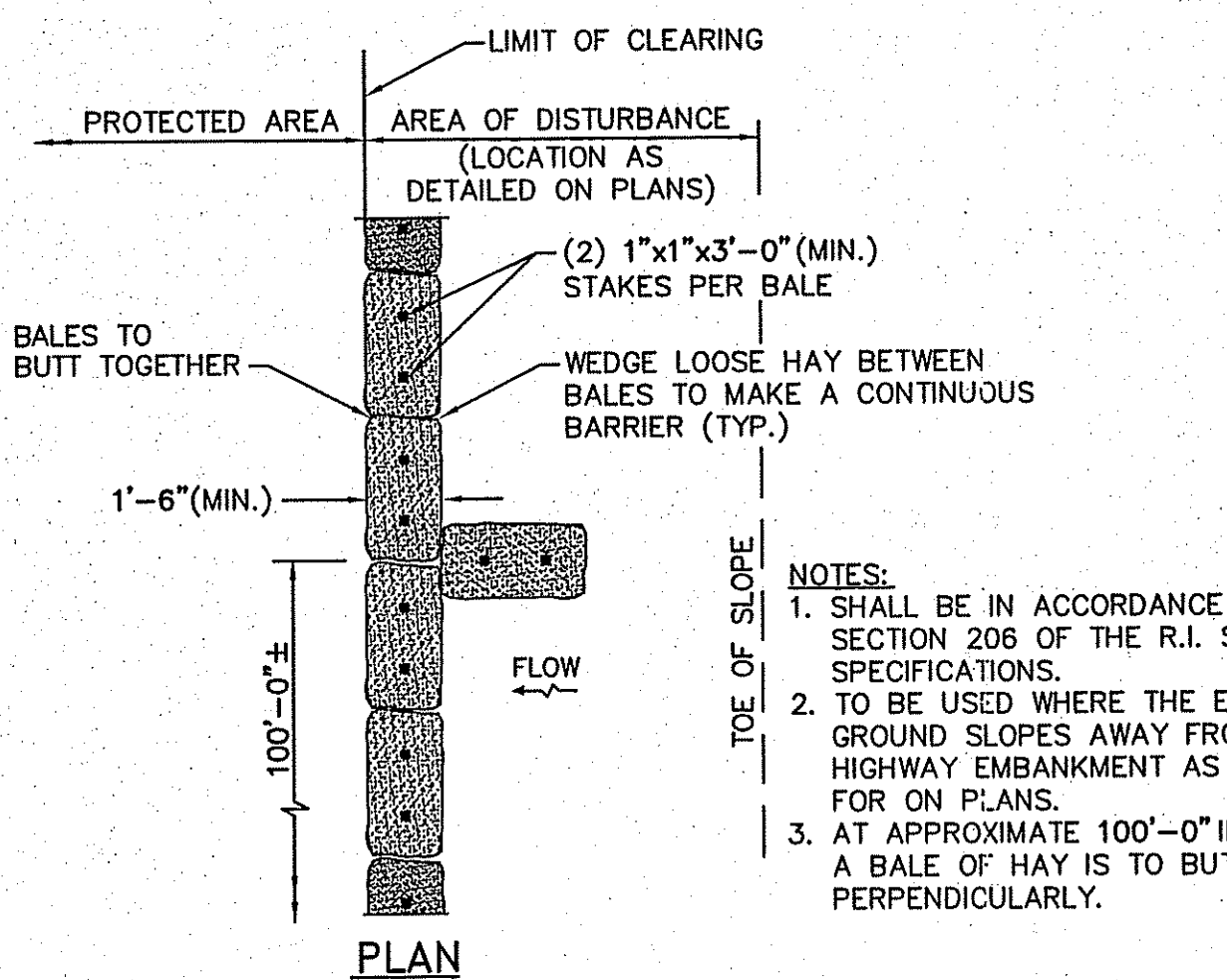
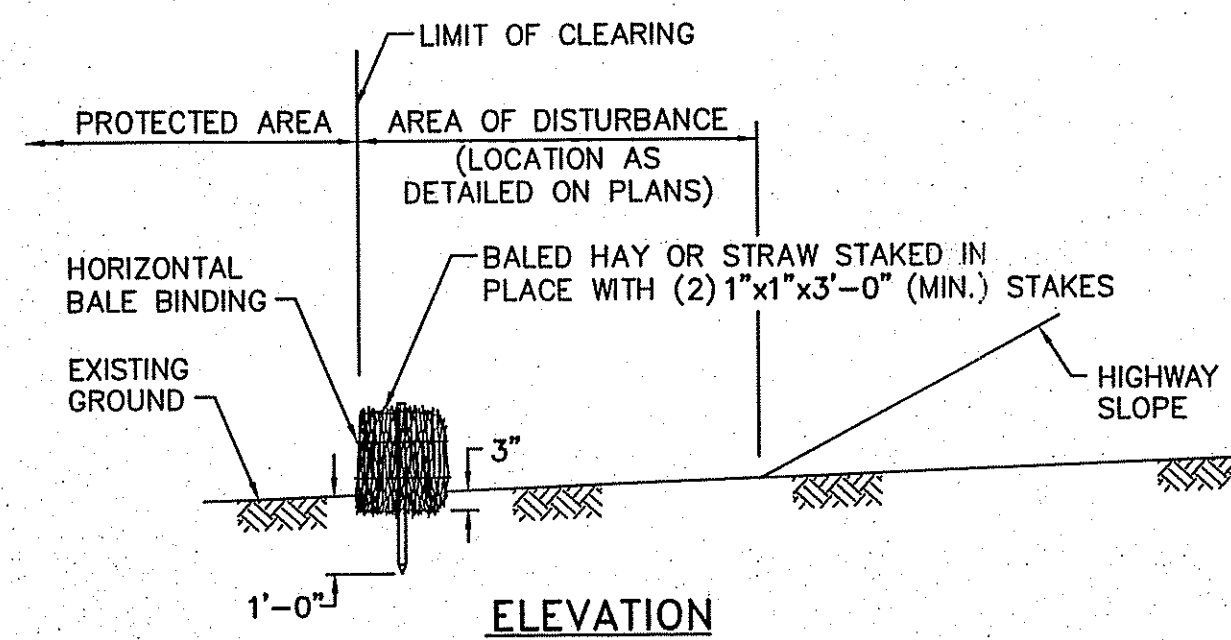

- NOTES:**
1. SHALL BE IN ACCORDANCE WITH SECTION 206 OF THE R.I. STANDARD SPECIFICATIONS.
 2. TO BE USED WHERE THE EXISTING GROUND SLOPES AWAY FROM THE HIGHWAY EMBANKMENT AS CALLED FOR ON PLANS.
 3. AT APPROXIMATE 100'-0" INTERVALS A BALE OF HAY IS TO BUTT PERPENDICULARLY.

BALED HAY EROSION CHECK
R.I. STANDARD 9.1.0

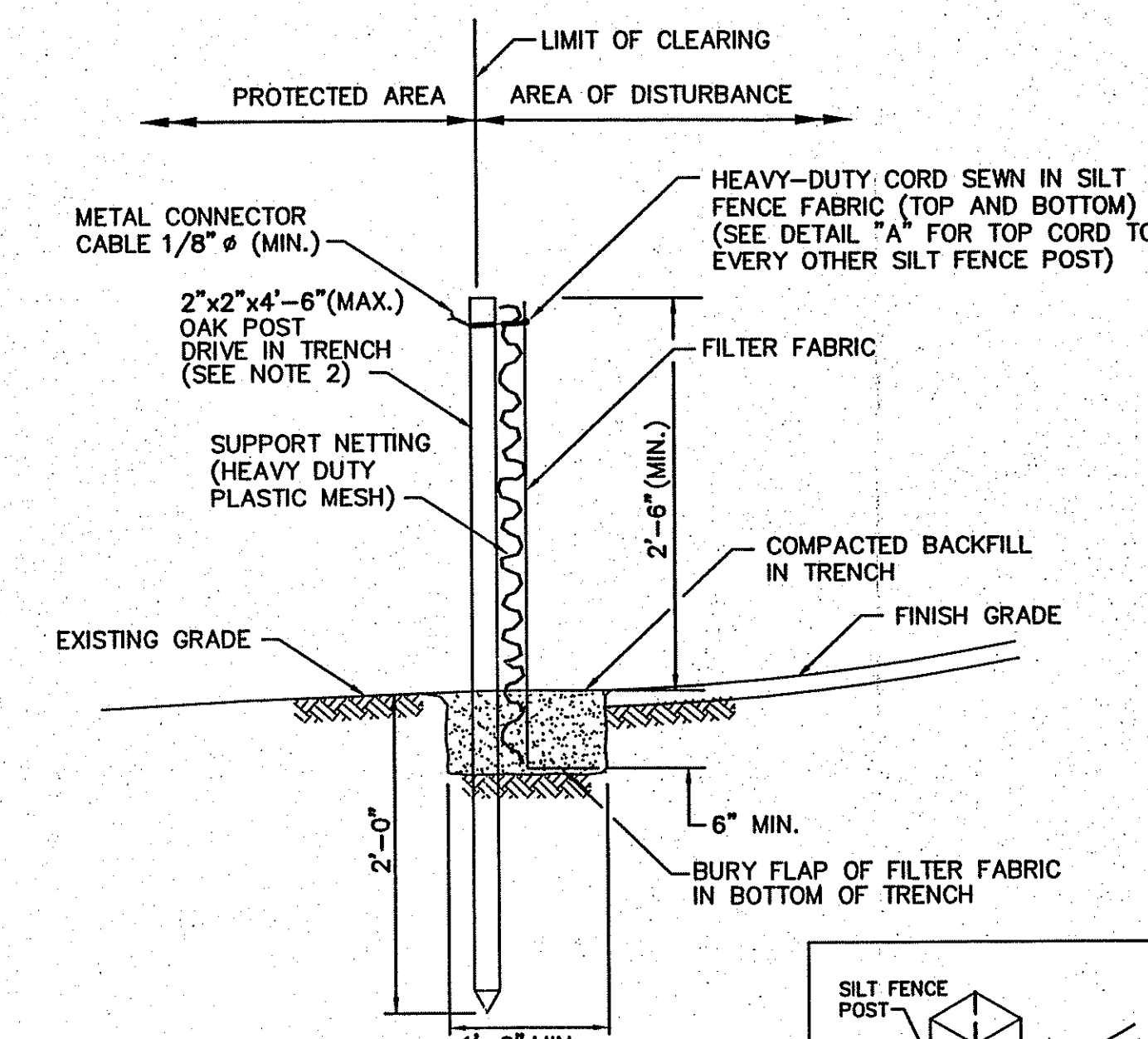

- NOTES:**
1. SHALL BE IN ACCORDANCE WITH SECTION 206 OF THE R.I. STANDARD SPECIFICATIONS.
 2. 2"x2"x4'-6" (MAX.) OAK POSTS FOR SILT FENCE SHALL BE LOCATED 8'-0" (MAX.) O.C. IN WETLAND AREAS AND 4'-0" (MAX.) O.C. IN WETLAND RAVINE, GULLY OR DROP-OFF AREAS AS SHOWN ON PLANS.
 3. 1"x1"x4'-6" (MIN.) POSTS PERMITTED FOR PRE-FABRICATED SILT FENCE.
 4. SILT FENCE SHALL BE INSTALLED BEFORE ANY GRUBBING OR EARTH EXCAVATION TAKES PLACE.

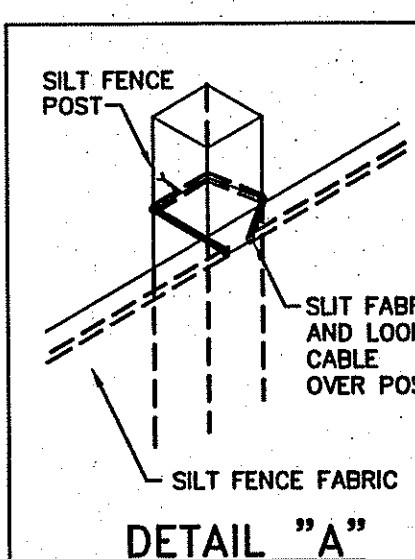

SILT FENCE DETAIL
R.I. STANDARD 9.2.0

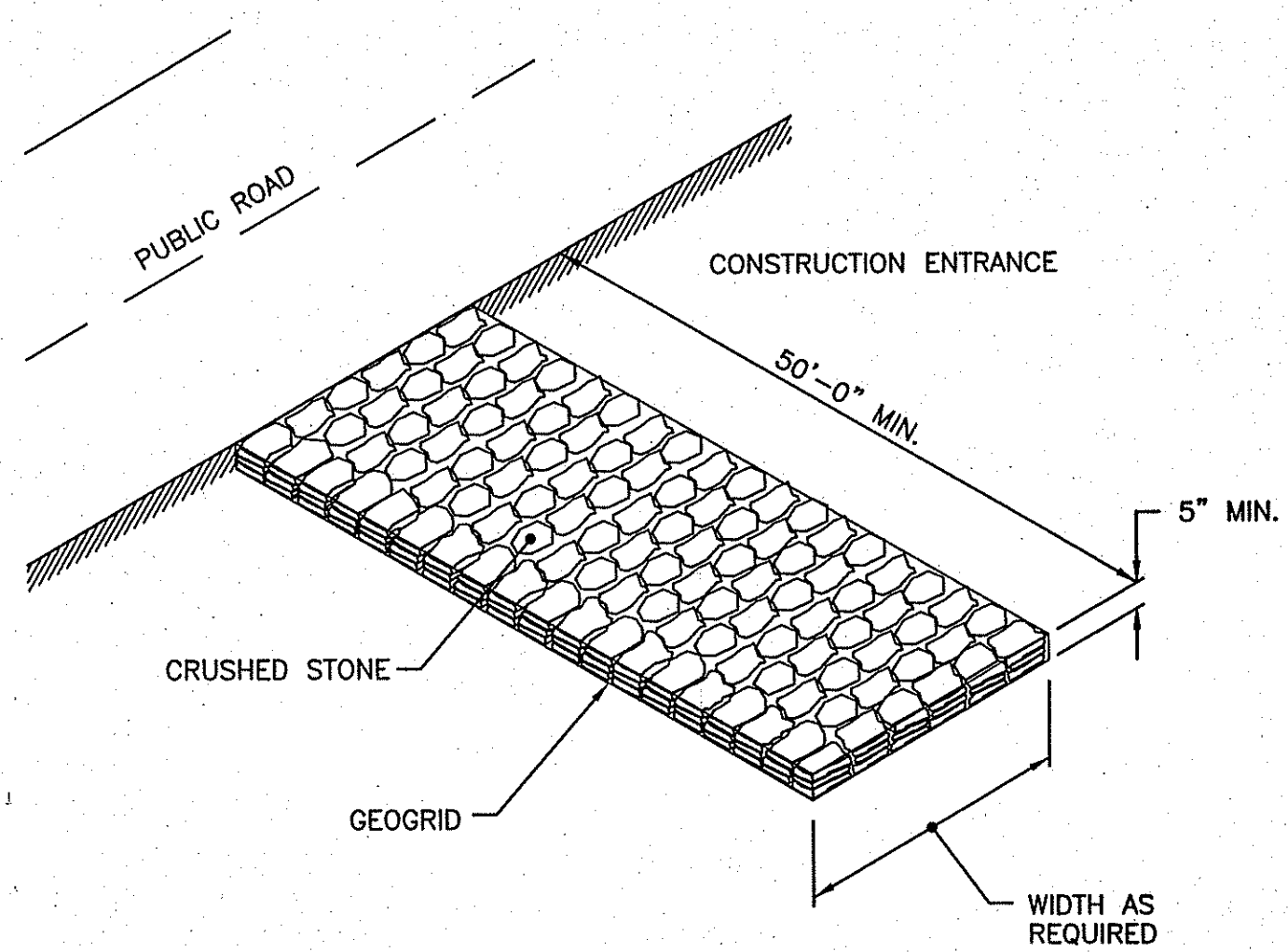

NOTE: SHALL BE IN ACCORDANCE WITH SECTION 211 OF THE R.I. STANDARD SPECIFICATIONS.

CONSTRUCTION ACCESS
R.I. STANDARD 9.9.0

Kindly be advised that this Permit is not equivalent to a verification of the type or extent of freshwater wetlands on site.

DEPARTMENT OF ENVIRONMENTAL MANAGEMENT
OFFICE OF WATER RESOURCES
FRESHWATER WETLANDS PROGRAM
APPROVED WITH CONDITIONS
AS SPECIFIED IN THE LETTER OF APPROVAL
DATED FEB 25 2008 FILE # 07-0473
NO CHANGES ALLOWED WITHOUT PRIOR APPROVAL.
APPROVED PLANS MUST BE AT CONSTRUCTION SITE.

Matthew D. Wernick

NATIONAL SURVEYORS-DEVELOPERS INC.
42 HAMLET AVE. WOONSOCKET, R.I.
(401) 769-7779

NORBERT A. THERIEN
No. 1739
PROFESSIONAL LAND SURVEYOR

GERMAINE CAYER
79 COVE ROAD
BURRILLVILLE, RHODE ISLAND
AP 110/003 LOT 26
DEC 19 2007

FIELD WORK BY:	EM/CM
DRAWN/CLAC BY:	JS
CHECKED BY:	RCS
DATE:	07/07/07
PROJECT NO:	2007-130

NOTES & DETAILS

SHEET 3 OF 3