

TYPICAL SECTION

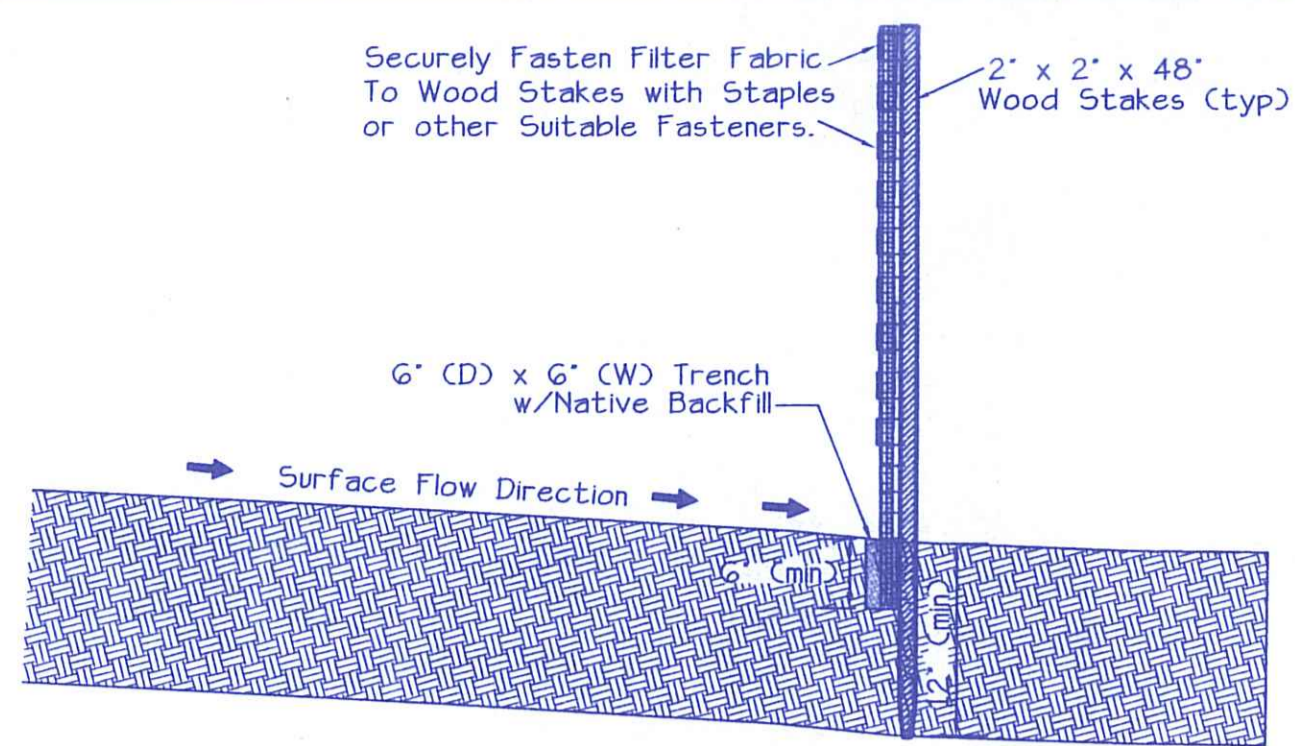

SECTION A-A

SILT FENCE DETAIL (N.T.S.)

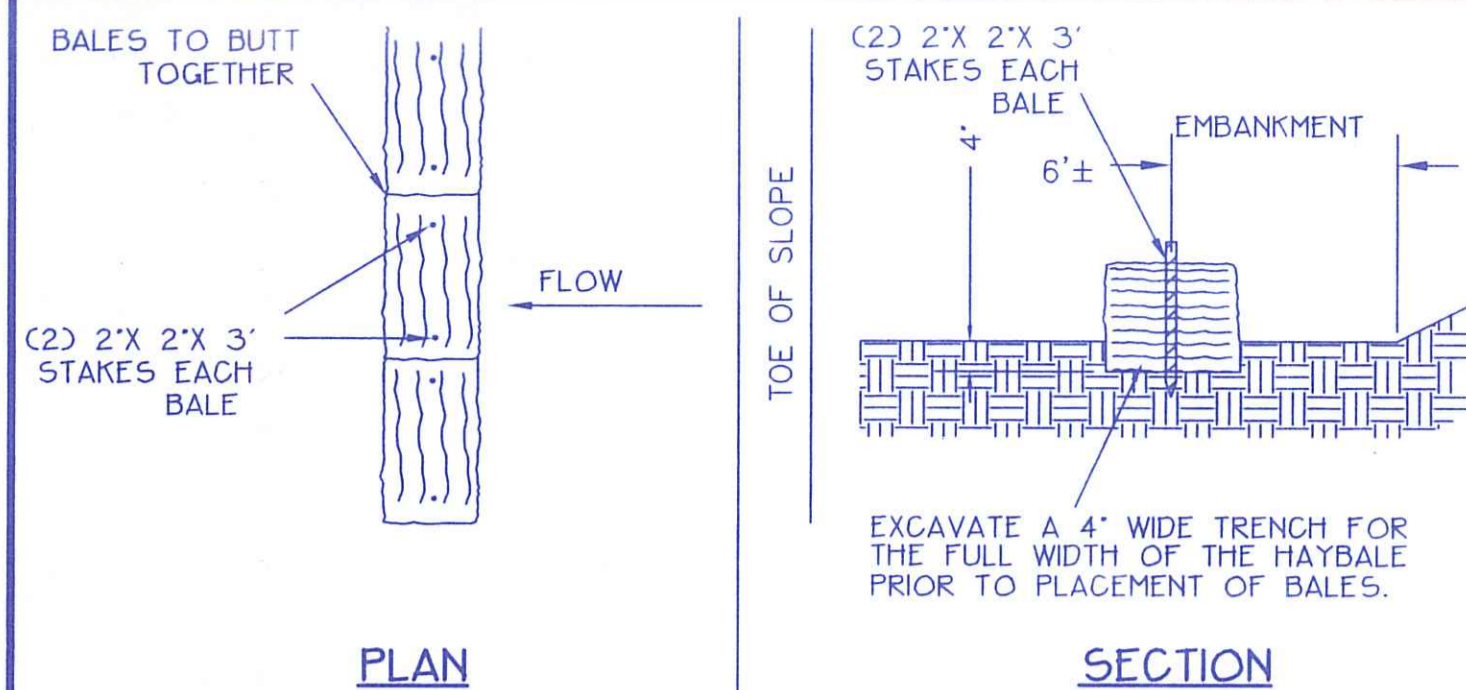

PLAN

SECTION

NOTES:

1. INSTALL HAY BALES FOR TEMPORARY EROSION CONTROL AS SHOWN ON SITE PLAN.
2. PERFORM SITE CONSTRUCTION.
3. LOAM AND SEED ALL SLOPES AND DISTURBED AREAS.
4. REMOVE TEMPORARY EROSION CONTROL AFTER VEGETATION IS ESTABLISHED.
5. RESTORE ALL DISTURBED AREAS.

HAYBALE INSTALLATION DETAIL

EROSION CONTROL PROGRAM

GENERAL EROSION CONTROL NOTES:

1. Steep banks or slopes not receiving rip-rap shall be seeded and protected with a fiber mulch. (mulch for slopes > or = 3:1)
2. During construction, the contractor and/or developer shall be responsible for maintaining drainage and storm runoff.
3. Sedimentation control devices shall be inspected closely and maintained promptly after each and every storm occurrence.
4. Additional erosion control devices shall be located as conditions warrant or as directed by Town of Tiverton Department of Public Works or Building Department.
5. Disturbed slopes shall not be left unattended or exposed for excessive periods of time.
6. All disturbed slopes, either newly created or exposed prior to October 15, shall be seeded or protected by that date for any work completed during the construction season.
7. The topsoil shall have a sandy loam texture relatively free of subsoil materials, stones, roots, lumps of soil, tree limbs, trash or construction debris.
8. All disturbed areas are to be permanently stabilized with seed mix prior to completion of project. Seed mix and application rates as per plan.
9. Areas exposed for extended periods of time are to be completely covered with temporary treatments. Temporary treatments are to consist of a hay, straw, or fiber mulch or protective covers such as a mat or fiber lining (curb, jute, fiber glass netting, excelsior blankets). They shall be incorporated into the work as warranted or as ordered by the engineer. (For all banks or slopes > or = 3:1)
10. Hay or straw applications shall be applied at the rate of 200 lbs/acre.
11. The normal acceptable seasonal seeding dates are April 1st - October 15th.

12. As soon as weather permits and after the completion of final grading, all disturbed areas shall be loamed and seeded.
13. Stockpiles of topsoil shall not be located near waterways. They shall have side slopes no greater than 3:1 and stockpiles shall also be seeded and/or stabilized. Location of all stockpiles to be as per plan.

CONSTRUCTION SEQUENCE

1. Prior to the start of construction, the contractor is to contact the Town of Tiverton Department of Public Works or Building Department.
2. All erosion control systems at the site are to be installed prior to the start of construction and to be properly maintained until all disturbed areas are stabilized.
3. Upon completion of construction and prior to removal of the erosion control devices, the contractor is to contact the Tiverton Department of Public Works or Building Department.
4. Erosion control systems are to be maintained in the condition shown on plans throughout the duration of the project. Any damaged erosion control systems must be immediately repaired.
5. Erosion control devices are to remain in place after completion of the project until after the grass has been cut 3 times.

SEED MIX

Z by weight	Variety
50%	Cleaned Tall Fescue
30%	Creole vetch
10%	Robert Hard Fescue
10%	Nassau Kentucky Bluegrass
10%	James town Cheving Fescue

Apply at the rate of 23/1000 Square Feet or 22#/acre

PERTINENT ZONING INFORMATION:

ZONING DISTRICT:	R-60
MINIMUM LOT SIZE:	60,000 SF
MINIMUM LOT WIDTH:	175.0'
MAXIMUM HEIGHT (PRINCIPAL):	35.0'

BUILDING SETBACKS (PRINCIPAL STRUCTURE)

MINIMUM FRONT YARD:	40.0'
MINIMUM SIDE YARD:	30.0'
MINIMUM REAR YARD:	60.0'
MAXIMUM LOT COVERAGE:	15%

LEGEND

—	PROPERTY LINE
- - - -	BUILDING SETBACK LINE
—+—+—	EDGE OF PAVEMENT
—+—+—	CONC CURBING
—+—+—	OVERHEAD WIRES
⊖	BOUND
○	STEEL REBAR/PIN
□	WOOD FENCE
x-x-x-x	CHAIN LINK FENCE
⊕	WATER SHUTOFF
⊕	WATER VALVE
⊕	HYDRANT
A.P.	TAX ASSESSOR'S MAP
⊕	CATCH BASIN
⊕	DRAINAGE MANHOLE
⊕	CURB INLET/BASIN
⊕	SEWER MANHOLE
⊕	SIGN
⊕	UTILITY POLE
⊕	GLYF POLE
—	HAY BALES AND/OR SILT FENCE

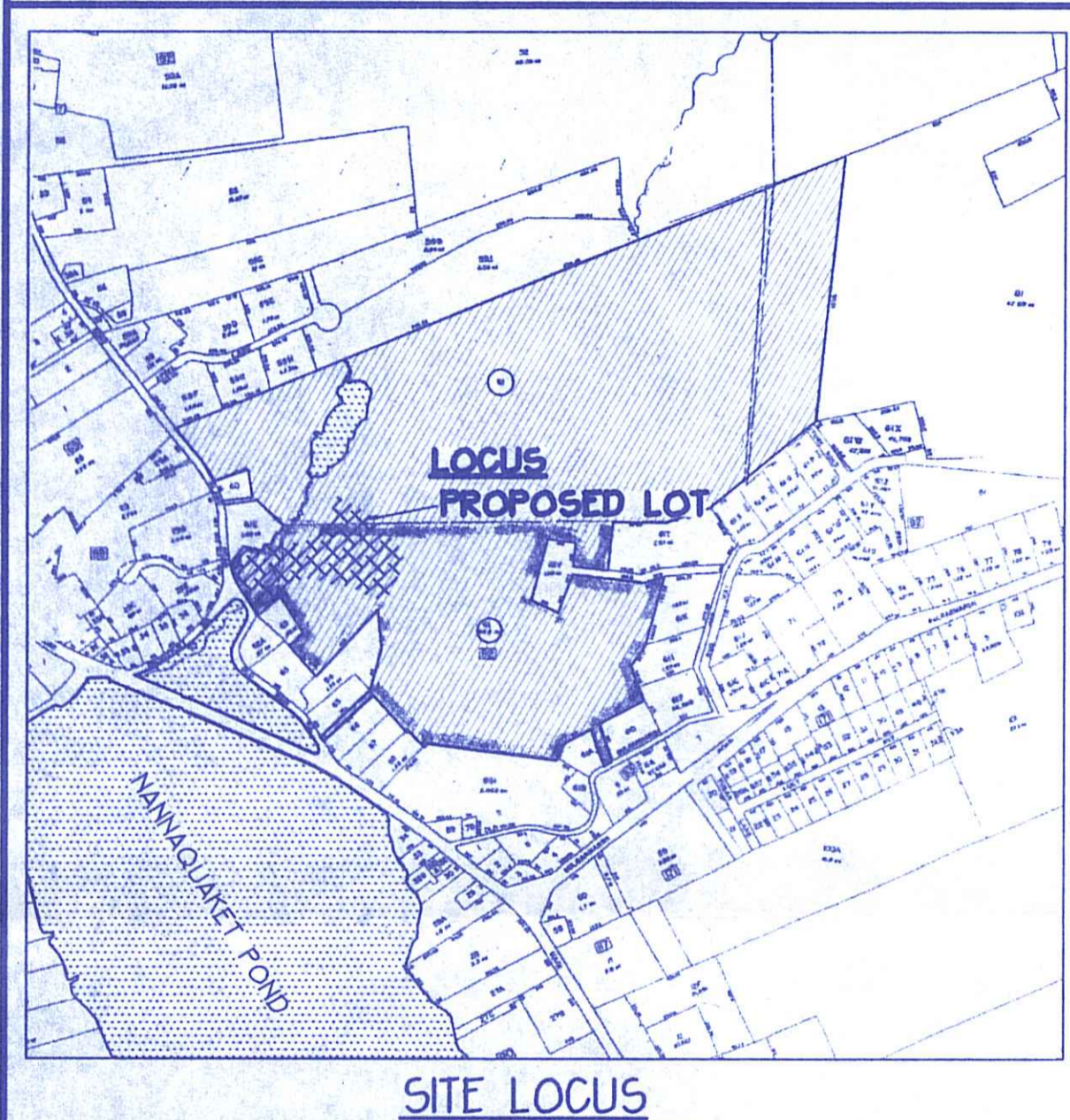

SITE LOCUS

THIS SITE IS LOCATED ON NATIONAL FLOOD INSURANCE RATE MAP (FIRM) COMMUNITY PANEL NUMBER 440012 0005 E - LATEST REVISION - SEPTEMBER 30, 1995. THE PROJECT IS WITHIN "FLOOD ZONE C" -

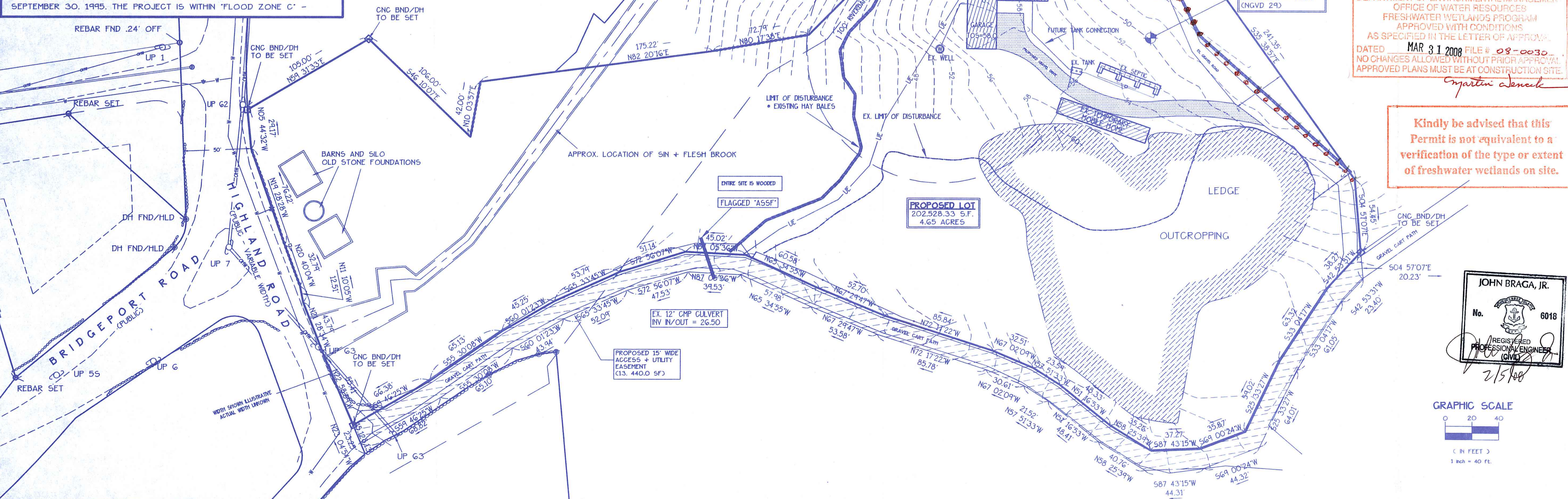

DEPARTMENT OF ENVIRONMENTAL MANAGEMENT
OFFICE OF WATER RESOURCES
FRESHWATER WETLANDS PROGRAM
APPROVED WITH CONDITIONS
AS SPECIFIED IN THE LETTER OF APPROVAL.
DATED MAR 31 2008 FILE # 08-0030
NO CHANGES ALLOWED WITHOUT PRIOR APPROVAL.
APPROVED PLANS MUST BE AT CONSTRUCTION SITE.
Martin J. Braga

Kindly be advised that this
Permit is not equivalent to a
verification of the type or extent
of freshwater wetlands on site.

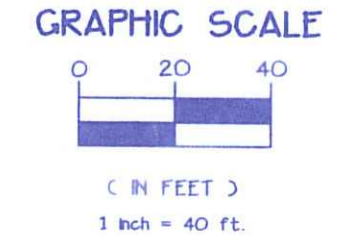
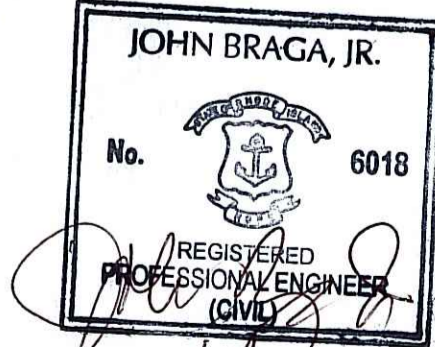

DRAWN BY:	JBAJ	DATE:	02/05/08
CHECKED BY:	JB	DRAWING NO.:	07005-51
JOB NO.:	07005	SHEET 1 OF 1	
NO.	DATE	DESCRIPTION	BY

SOIL EROSION + SEDIMENT CONTROL

PREPARED FOR:
EDWARD S. + BETTY E. JEROME
610 HIGHLAND ROAD
TIVERTON, RHODE ISLAND 02878

PROJECT LOCATION:
TIVERTON TAX ASSESSOR'S
PLAT 1-9, BLOCK 92, LOT 61

JOHN BRAGA + ASSOCIATES, INC.
CIVIL ENGINEERS • LAND SURVEYORS
P.O. BOX 944
PORTSMOUTH, R.I. 02871-0919
PHONE (401) 683-0101

