

FED. ROAD DIV. NO.	STATE	FEDERAL AID PROJECT NO.	FISCAL YEAR	SHEET NO.	TOTAL SHEETS
	RI		2008	1	2

STATE OF RHODE ISLAND

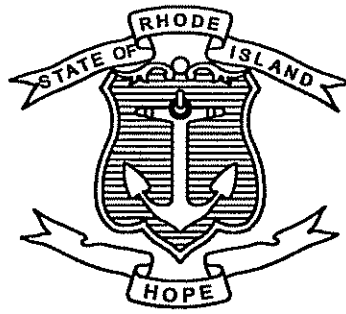

DEPARTMENT OF TRANSPORTATION

PLAN, PROFILE AND SECTIONS OF PROPOSED STATE HIGHWAY

DRAINAGE IMPROVEMENTS TO WINSOR AVENUE (@ U.P. NO. 13)

JOHNSTON, RI

COUNTY OF PROVIDENCE

R.I. CONTRACT NO. 2008-XX-XXX F.A. PROJECT NO. XXX-XXXX(000)

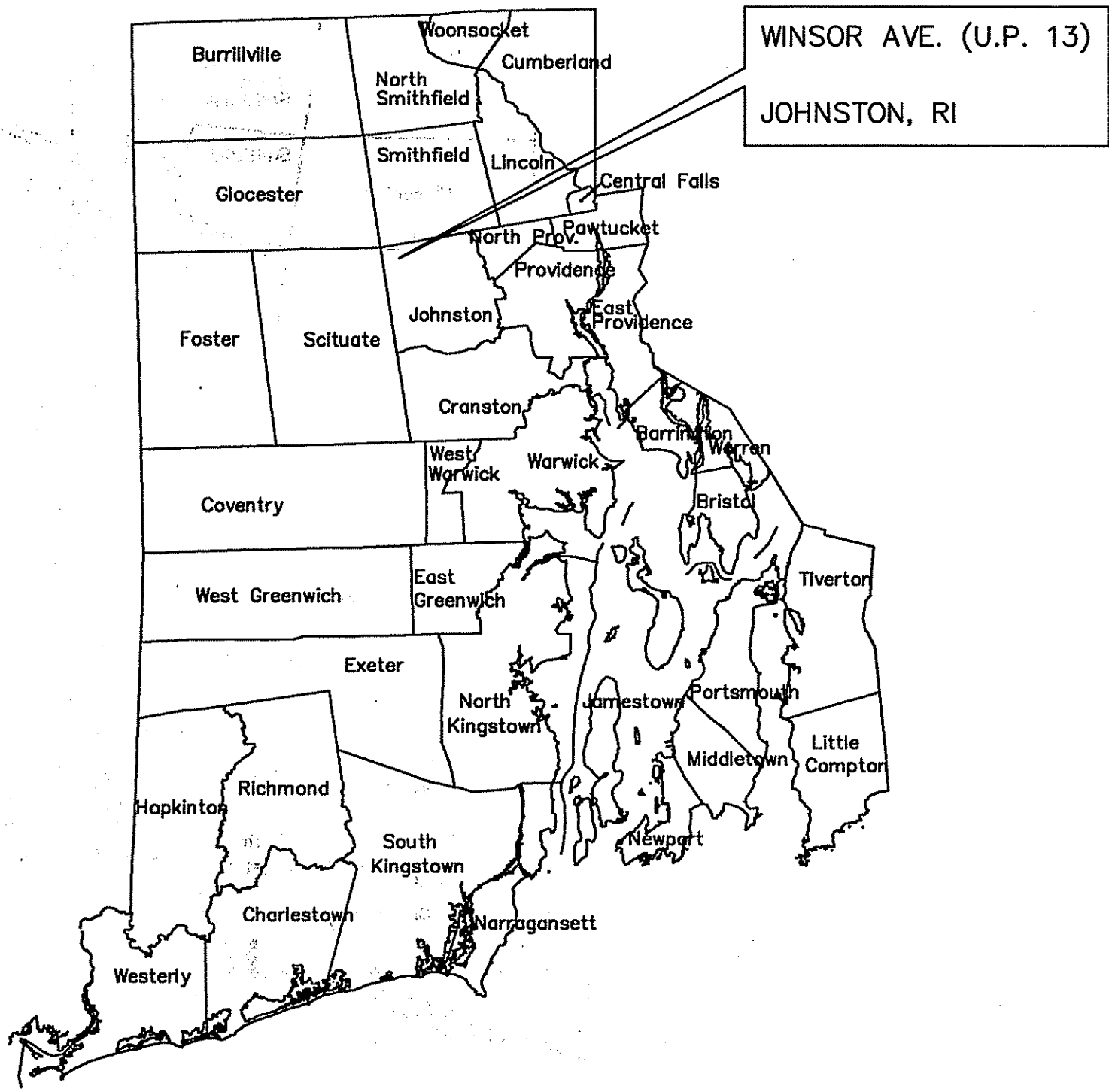
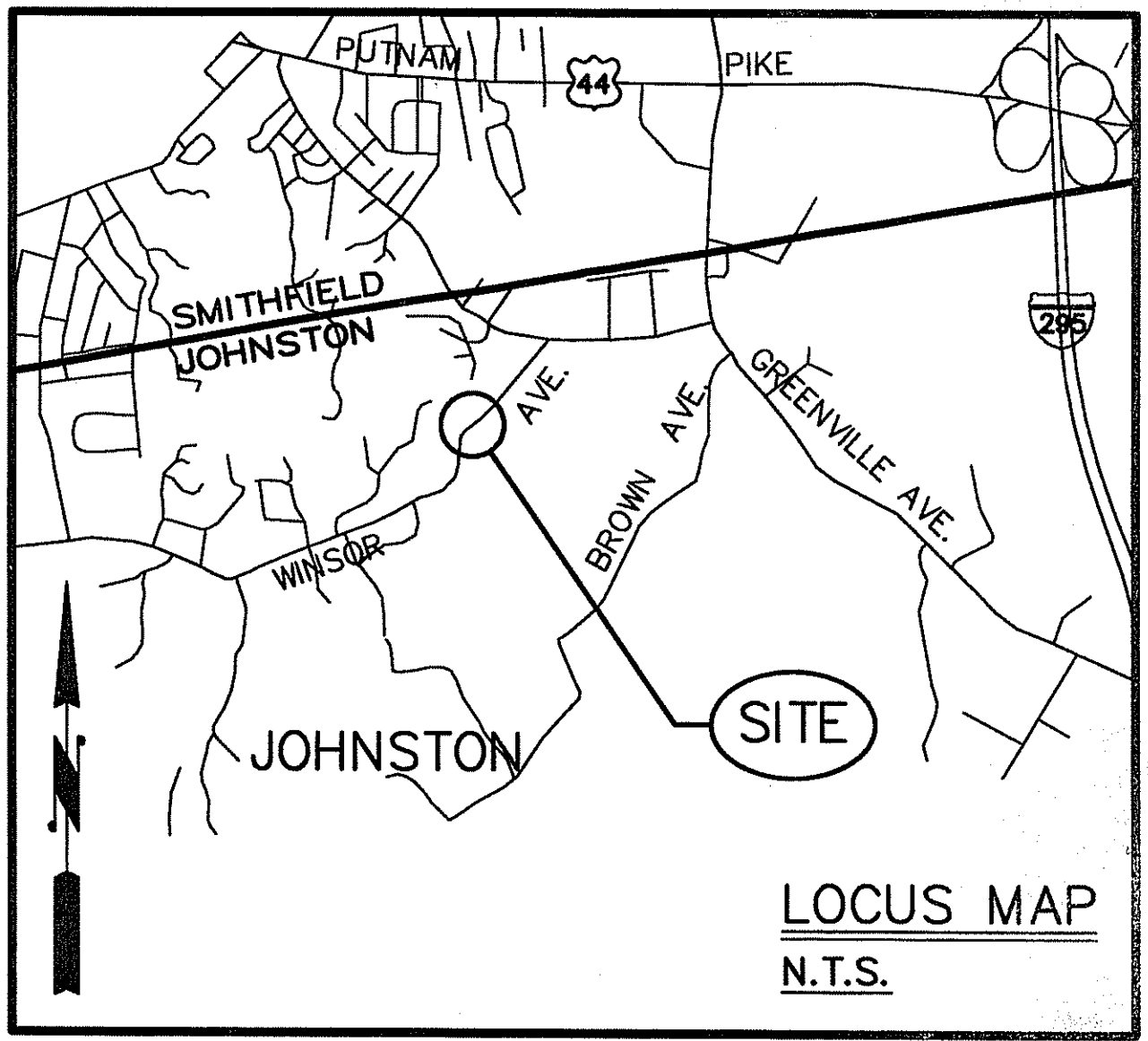

SCALES OF DRAWINGS

Plans	1 inch = 20 feet OR AS NOTED
Profiles	1 inch = 20 feet Horizontal OR AS NOTED
Profiles	1 inch = 4 feet Vertical OR AS NOTED
Cross Sections	1 inch = 4 feet Horizontal OR AS NOTED
Cross Sections	1 inch = 4 feet Vertical OR AS NOTED

BASE OF LEVELS  
NGVD 29

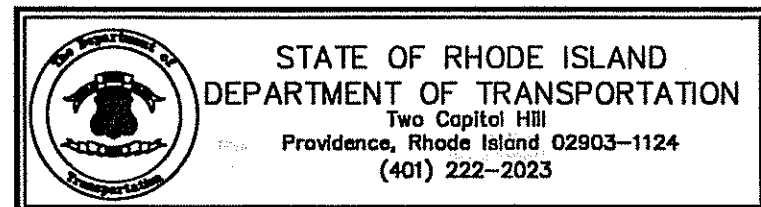

INDEX

SHEET NO.	DESCRIPTION
1	COVER SHEET
2	GENERAL PLAN/NOTES/LEGEND/DETAILS

Kindly be advised that this Permit is not equivalent to a verification of the type or extent of freshwater wetlands on site.

DEPARTMENT OF ENVIRONMENTAL MANAGEMENT  
OFFICE OF WATER RESOURCES  
FRESHWATER WETLANDS PROGRAM  
APPROVED WITH CONDITIONS  
AS SPECIFIED IN THE LETTER OF APPROVAL  
DATED MAY 01 2008 FILE # 08-2002  
NO CHANGES ALLOWED WITHOUT PRIOR APPROVAL  
APPROVED PLANS MUST BE AT CONSTRUCTION SITE.

*W. Joseph Conroy*

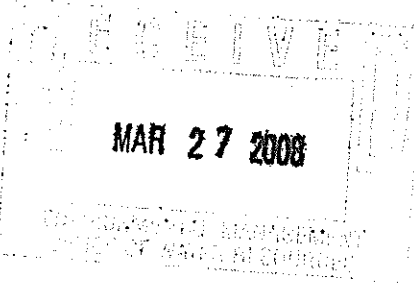

R.I. DEPARTMENT OF TRANSPORTATION	
APPROVED	
DEPUTY CHIEF ENGINEER	DATE
APPROVED	
CHIEF ENGINEER	DATE
APPROVED	
DIRECTOR	DATE
DEPARTMENT OF TRANSPORTATION FEDERAL HIGHWAY ADMINISTRATION	
APPROVED	
DIVISION ADMINISTRATOR	DATE

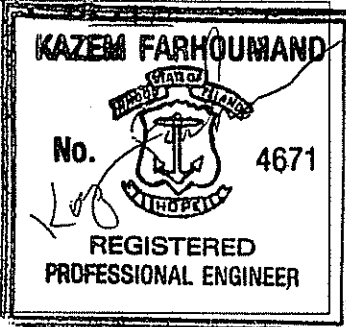

Contract Number 2008-XX-XXX

Number of Sheet 1

Total Sheets 2

R.I. STANDARD SPECIFICATIONS AND STANDARD DETAILS  
SPECIFICATIONS TO GOVERN THIS PROJECT ARE THE R.I. STANDARD SPECIFICATIONS FOR ROAD AND BRIDGE CONSTRUCTION, 2004 EDITION, AND THE STATE AND FEDERAL SPECIAL PROVISIONS INCLUDED IN THE CONTRACT DOCUMENTS. STANDARD DETAILS FOR THIS PROJECT ARE R.I. STANDARD DETAILS, 1998 EDITION, WITH ALL REVISIONS.

C:\LAND PROJECTS\FDREST HILLS-EXETER.dwg Forest Hills-March12.dwg 9/15/2007 14:48 PM EDT

