

Per RIDEM:  
 - Permanent buffer zone markers to be installed in accordance with permit condition ten (10).

AP 165 LOT 7  
 N/F  
 JOSEPH F. & JANET A. RAYMOND

**General Notes**

1. THE SITE IS SERVICED BY A PRIVATE WELL AND SEPTIC.
2. THE OWNER OF THE LOT IS NOW OR FORMERLY DR. HELDO AND JOANNE GOMEZ. THE APPLICANT IS DR. HELDO AND JOANNE GOMEZ, 7109 EAGLE TERRACE, WEST PALM BEACH, FLORIDA.
3. CONTRACTOR TO COORDINATE THE NEW DRIVEWAY AND GRADING WITH THE EXISTING ELECTRICAL AND WATER SERVICE FROM THE WELL TO THE HOUSE AND REPLACE OR RELOCATE AS NEEDED.
4. ONLY THE WETLAND EDGE AND STREAMBANK ADJACENT TO THE PROPOSED IMPROVEMENTS WERE DELINEATED FOR THE PURPOSE OF THIS APPLICATION.
5. THE CONTRACTOR IS RESPONSIBLE FOR DETERMINING FINISH GRADING AND DRAINAGE AROUND THE BUILDING TO ENSURE SURFACE WATER AND/OR GROUND WATER ARE DIRECTED AWAY FROM THE STRUCTURE. THIS PLAN SHOWS GENERAL GRADING ONLY AND ADDITIONAL DETAIL IS LIKELY TO BE REQUIRED AROUND THE BUILDING.

**Dimensional Regulations**

ZONING: F-5 FARMING/RESIDENTIAL  
 TOTAL SITE AREA: 2.80± ACRES  
 MINIMUM LOT AREA: 5 ACRES  
 MINIMUM WIDTH: 450'  
 MINIMUM FRONT YARD: 40'  
 MINIMUM SIDE YARD: 15'  
 MINIMUM REAR YARD: 40'  
 MAXIMUM LOT COVERAGE: 20%  
 MAXIMUM BUILDING HEIGHT: 50'  
 MAXIMUM ACCESSORY BUILDING HEIGHT: 35'  
 ACCESSORY BUILDING SETBACK: 10'

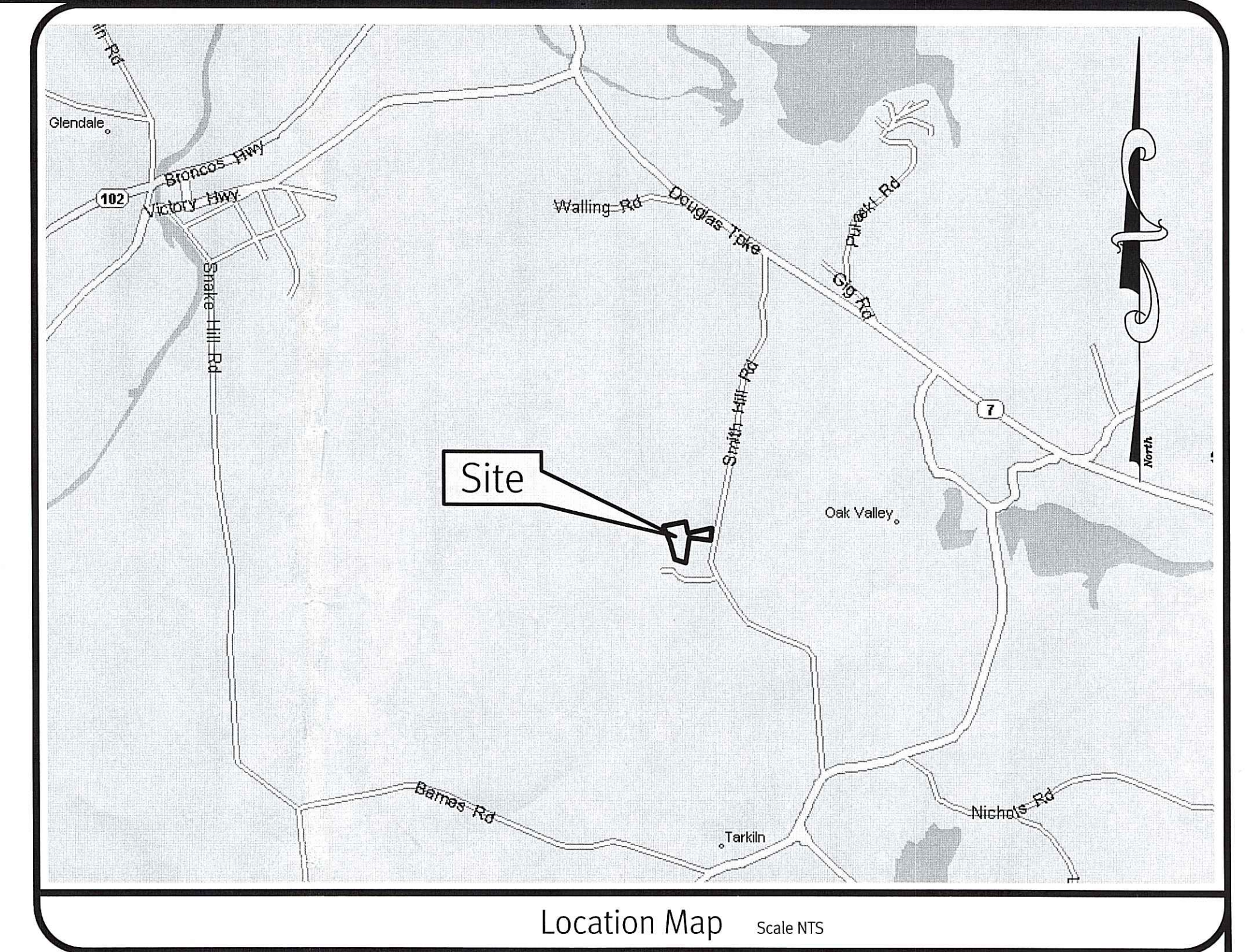
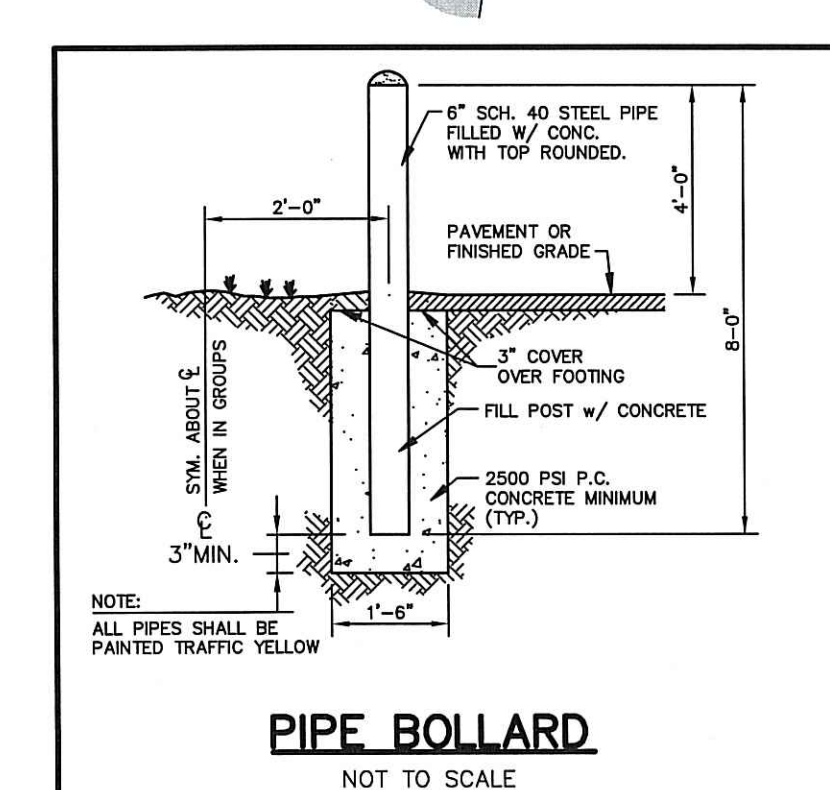
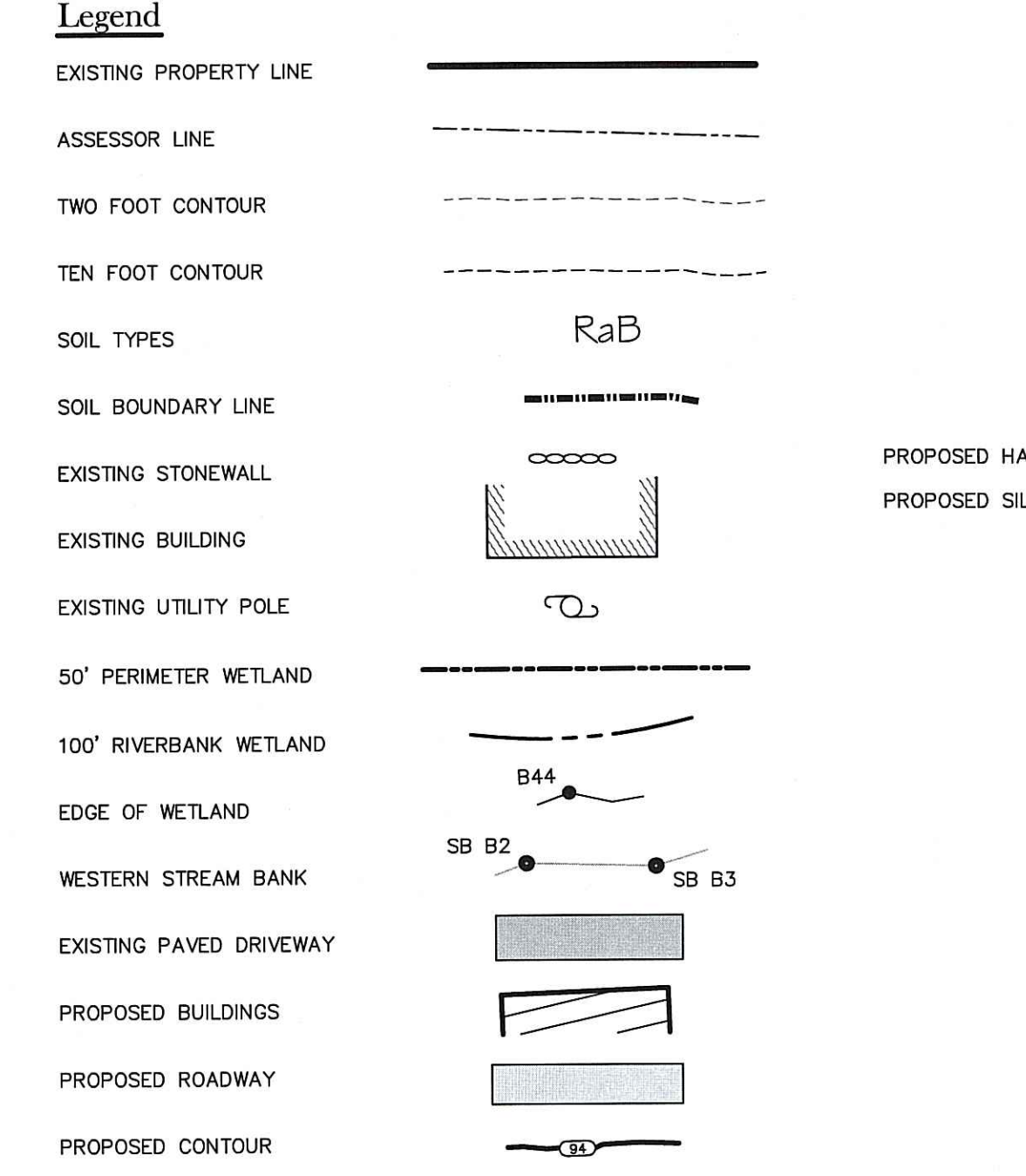

Kindly be advised that this Permit is not equivalent to a verification of the type or extent of freshwater wetlands on site.

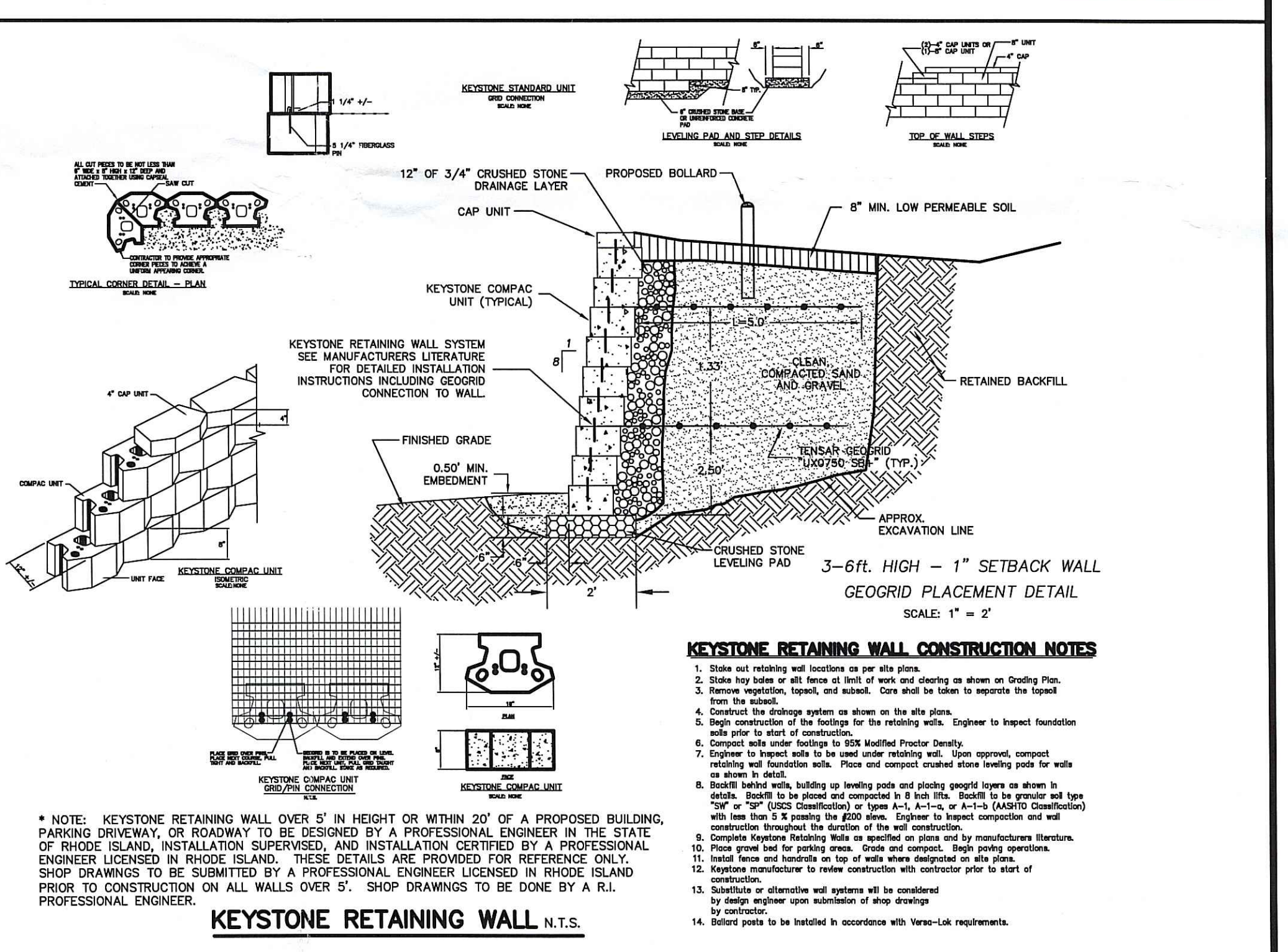

DEPARTMENT OF ENVIRONMENTAL MANAGEMENT  
 OFFICE OF WATER RESOURCES  
 FRESHWATER WETLANDS PROGRAM  
 APPROVED WITH CONDITIONS  
 AS SPECIFIED IN THE LETTER OF APPROVAL  
 DATED SEP 15 2008 FILE # 08-0317  
 NO CHANGES ALLOWED WITHOUT PRIOR APPROVAL  
 APPROVED PLANS MUST BE AT CONSTRUCTION SITE.

THIS REGULATORY SUBMISSION SET SHALL NOT BE USED FOR CONSTRUCTION PURPOSES UNLESS STAMPED 'ISSUED FOR CONSTRUCTION' AND SIGNED BY A DIPRETE ENGINEERING REPRESENTATIVE.

Scale: 1"=30'

**RIDEM Wetlands Preliminary Determination**

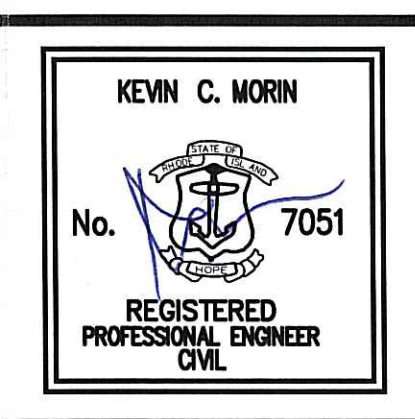

**Site Plan**

**325 Smith Hill Road**  
 Assessor's Plat 165, Lot 6  
 Burrillville, Rhode Island

**DiPrete Engineering**

Two Stafford Court Cranston, RI 02920  
 tel 401-943-1000 fax 401-464-6006 www.DiPrete-Eng.com

Applicant & Owner  
**Dr. & Mrs. Helda Gomez**  
 7109 Eagle Terrace  
 West Palm Beach, Florida  
 tel 561-775-0033

JUL 7 2008

SHEET 1 OF 1

Engineers • Planners • Surveyors