

PER RIDEM
 - - - - - Temporary Limit of Disturbance for Foundation Removal to revert back to a Natural state per Condition No. 15
 - - - - - Permanent Limit of Disturbance per RIDEM

Kindly be advised that this Permit is not equivalent to a verification of the type or extent of freshwater wetlands on site.

Three additional Northern White Cedars per RIDEM (Sec-Condition No. 15)

LEGEND

	84	EXISTING GRADE CONTOUR LINE
		EXISTING FLAGGED WETLAND EDGE
		EXISTING 50 FT. PERIMETER WETLAND
		PROPOSED LIMIT OF DISTURBANCE AND CONTINUOUS LINE OF STAKED HAYBALES
	97	PROPOSED GRADE CONTOUR LINE
		PROPOSED SANITARY SEWER (BY OTHERS)
		PROPOSED WELL
		EXISTING WELL
		PROPOSED TREE, NORTHERN WHITE CEDAR (THUJA OCCIDENTALIS) 12' ON CENTER

DEPARTMENT OF ENVIRONMENTAL MANAGEMENT
 OFFICE OF WATER RESOURCES
 FRESHWATER WETLANDS PROGRAM
 APPROVED WITH CONDITIONS
 AS SPECIFIED IN THE LETTER OF APPROVAL
 DATED OCT 10 2008 FILE # 08-0278
 NO CHANGES ALLOWED WITHOUT PRIOR APPROVAL
 APPROVED PLANS MUST BE AT CONSTRUCTION
 Nancy L. Freeman

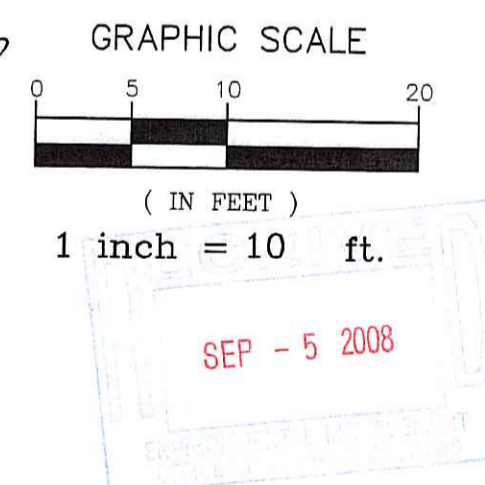
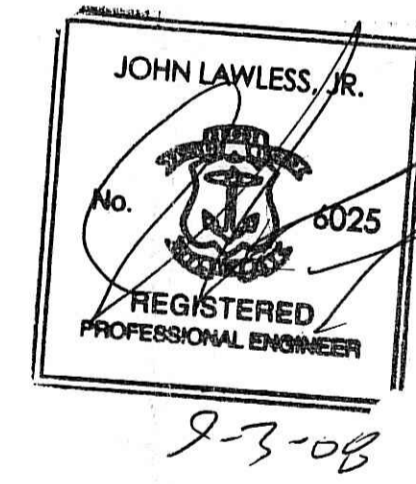

LOCUS PLAN
(NOT TO SCALE)

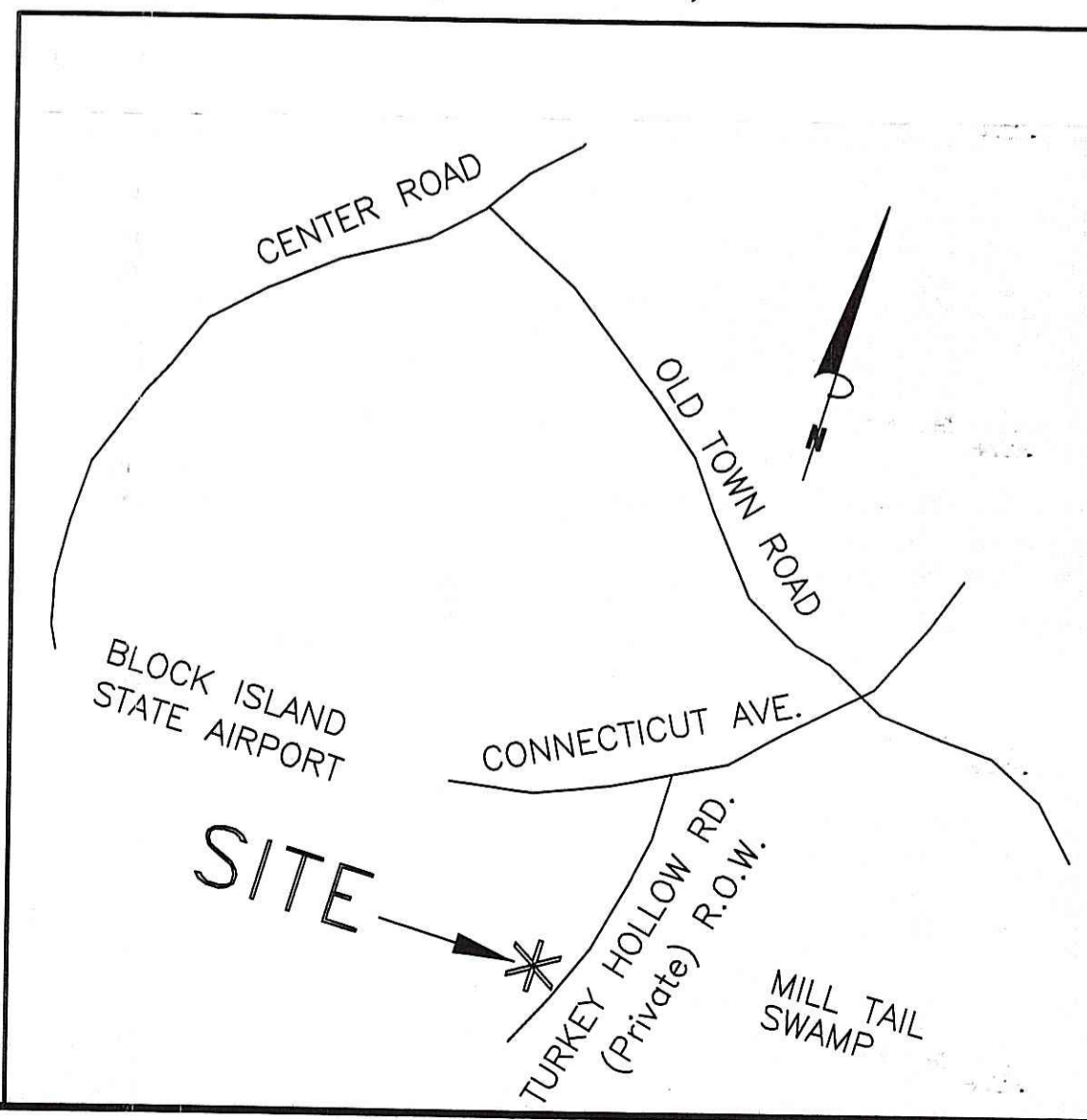

NOTES:

- REFER TO RIDEM WETLAND PERMIT NO. 98-0440 FOR PREVIOUS RIDEM APPROVAL FOR THIS PROPERTY.
- TOPOGRAPHY, BENCHMARK, PLANIMETRIC INFORMATION ARE BASED ON PLAN ENTITLED "WETLAND APPLICATION PLAN PREPARED FOR MR. LEWIS GAFFETT, PLAT 10 LOT 49, BLOCK ISLAND, RI" AS REVISED 1-21-99, BY LAND USE SPECIALISTS, INC.

- FLAGGED WETLAND EDGE WAS DELINEATED BY 'NATURAL RESOURCE SERVICES, INC.'
- FLOOD ZONE INFO: PER FEMA MAP 440036 0004 C, AS REVISED JUNE 16, 1992, THIS PROJECT IS LOCATED WITHIN FEMA ZONE "C", AN AREA OF "MINIMAL FLOOD HAZARD".
- A CONTINUOUS LINE OF STAKED HAYBALES SHALL BE INSTALLED PRIOR TO COMMENCEMENT OF CONSTRUCTION ALONG THE PROPOSED LIMIT OF DISTURBANCE. ALL SUCH HAYBALES SHALL REMAIN AND BE MAINTAINED DURING CONSTRUCTION AND UNTIL VEGETATION IS FULLY ESTABLISHED.
- FOR OVERALL PROPERTY BOUNDARIES, SEE "SURVEY OF LAND PREPARED FOR LEWIS N GAFFETT BEING LOT 49... ASSESSOR'S PLAN 10..." BY HILBERN LAND SURVEYING, DATED 7/20/2006, REVISED 8/12/08. PROPERTY LINES SHOWN ON THIS DRAWING ARE BASED ON SAID PLAN BY HILBERN LAND SURVEYING.
- THIS WETLAND PERMIT PLAN DOES NOT INCLUDE OR CONSTITUTE AND PROPOSED DWELLING DESIGN INFORMATION. PROPOSED DWELLING DESIGN, INCLUDING ACTUAL PROPOSED BASEMENT FLOOR ELEVATION, STRUCTURAL DESIGN, ETC., IS THE RESPONSIBILITY OF THE OWNER/APPLICANT.
 The existing foundation is to be removed (Sec-Condition No. 15).

ENGINEER: JOHN LAWLESS, JR., P.E.
 14 PEMBERTON AVENUE
 JAMESTOWN, RI 02835
 TEL. 401-423-9899

PROJECT: LEWIS GAFFETT: PROPERTY LOCATED AT 10 TURKEY HOLLOW RD., NEW SHOREHAM, RI ASSESSOR'S PLAT 10, LOT 49

DRAWING TITLE: PROPOSED SITE PLAN FOR RIDEM FRESHWATER WETLAND PRELIMINARY DETERMINATION APPLICATION

REVISIONS:

DATE: 9-3-08

SCALE: 1" = 10'

BY: JL

DRAWING NO: PD-1

SHEET 1 OF 1

PROJECT ID: 102