

DYERVILLE DAM REMOVAL PROJECT

PROVIDENCE, RHODE ISLAND

PREPARED FOR
U.S. DEPARTMENT OF AGRICULTURE
NATURAL RESOURCES CONSERVATION SERVICE

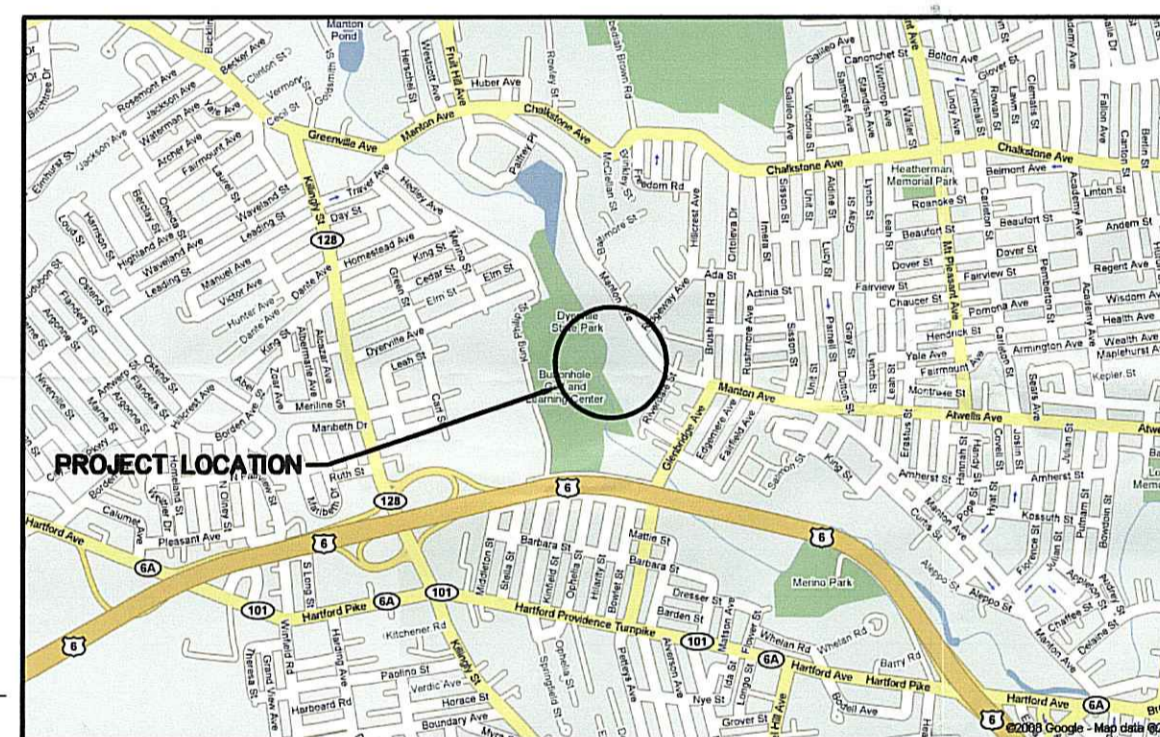

GRAPHIC SCALE IN
2000 1000 0 2000 4000
VICINITY MAP



60 Quaker Lane, Suite 46
Warwick, Rhode Island 02886
(401) 828-1300

PREPARED BY



2350 Post Road
Warwick, Rhode Island 02886
(401) 736-3440

DRAWING NUMBER	SHEET NUMBER	DRAWING TITLE
T-1	1 OF 3	TITLE SHEET
C-1	2 OF 3	EXISTING CONDITIONS PLAN
C-2	3 OF 3	CONSTRUCTION SEQUENCE PLAN

LEGEND	
	RETAINING WALL
	MINOR CONTOUR LINES
	MAJOR CONTOUR LINES
	EDGE OF WATER
	100 YEAR FLOODPLAIN
	WETLAND FLAG
	UTILITY POLE
	LOW
	WORK LIMITS
	WETLAND
	PROPERTY LINES
	FENCE
	BENCHMARK
	TEMP ACCESS ROUTE
	TURBIDITY CURTAIN

Kindly be advised that this Permit is not equivalent to a verification of the type or extent of freshwater wetlands on site.

DEPARTMENT OF ENVIRONMENTAL MANAGEMENT
OFFICE OF WATER RESOURCES
FRESHWATER WETLANDS PROGRAM
APPROVED WITH CONDITIONS
AS SPECIFIED IN THE LETTER OF APPROVAL
DATED MAY 28 2009 FILE # 09-0074
NO CHANGES ALLOWED WITHOUT PRIOR APPROVAL.
APPROVED PLANS MUST BE AT CONSTRUCTION SITE.

W. Joseph Casey



NO.	DATE	BY	DESCRIPTION
1	03/09	EA	60% DESIGN

THOMAS C. COOK
No. 8819
REGISTERED PROFESSIONAL ENGINEER
CIVIL
3/24/09

NATURAL RESOURCES CONSERVATION SERVICE
DYERVILLE DAM REMOVAL
PROVIDENCE, RHODE ISLAND
TITLE SHEET

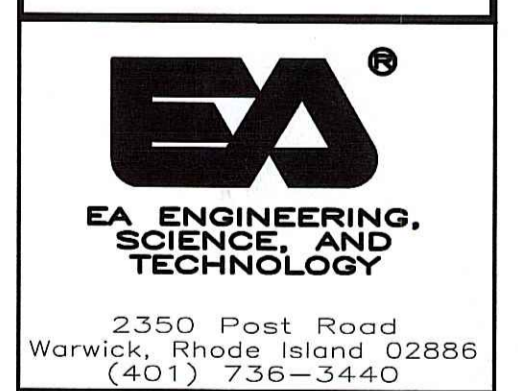

DATE	MARCH 2009
DESIGNED BY	JMT
DRAWN BY	CNS
CHECKED BY	SW
PROJECT MANAGER	SW
PROJECT NUMBER	62130.13
SCALE	AS SHOWN
FILE NAME	TITLE SHEET
DRAWING NUMBER	T-1
SHEET NUMBER	1 OF 3

60% DESIGN
FOR PERMITTING

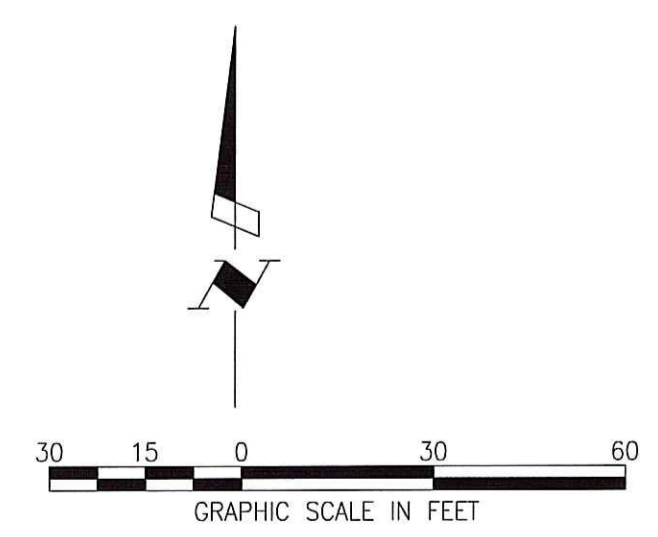

13 LOT 218
GLENBRIDGE AVE
STATE OF RHODE
ISLAND & PROV PLAN

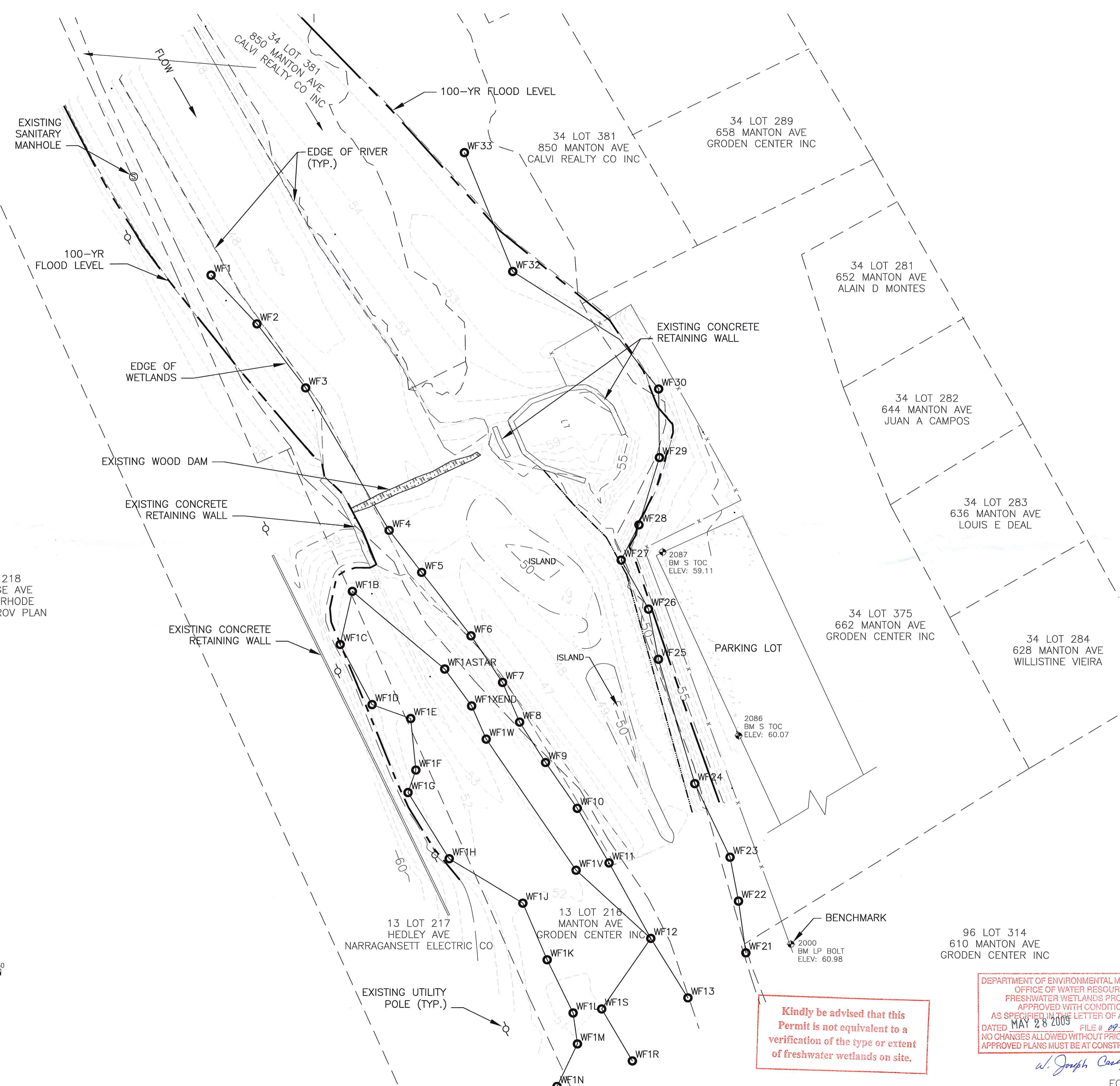

Kindly be advised that this Permit is not equivalent to a verification of the type or extent of freshwater wetlands on site.

DEPARTMENT OF ENVIRONMENTAL MANAGEMENT
OFFICE OF WATER RESOURCES
FRESHWATER WETLANDS PROGRAM
APPROVED WITH CONDITIONS
AS SPECIFIED IN THE LETTER OF APPROVAL
DATED MAY 28 2009 FILE # 09-0074
NO CHANGES ALLOWED WITHOUT PRIOR APPROVAL.
APPROVED PLANS MUST BE AT CONSTRUCTION SITE.

W. Joseph Casey

60% DESIGN
FOR PERMITTING

NO.	1
DATE	03/09
BY	EA
DESCRIPTION	60% DESIGN

SEAL
THOMAS C. COOK
No. 8819
REGISTERED
PROFESSIONAL ENGINEER
CIVIL
3/24/09

NATURAL RESOURCES CONSERVATION SERVICE
DYERVILLE DAM REMOVAL
PROVIDENCE, RHODE ISLAND

EXISTING CONDITIONS



2350 Post Road
Warwick, Rhode Island 02886
(401) 736-3440

DATE	MARCH 2009
DESIGNED BY	JMT
DRAWN BY	CNS
CHECKED BY	SW
PROJECT MANAGER	SW
PROJECT NUMBER	62130.13
SCALE	AS SHOWN
FILE NAME	-
DRAWING NUMBER	C-1
SHEET NUMBER	2 OF 3

EXISTING SANITARY MANHOLE
100-YR FLOOD LEVEL

EDGE OF RIVER (TYP.)

- NOTES:
1. ALL ELEVATIONS REFERENCE NGVD29 DATUM.
 2. SITE IS LOCATED AT 610 MANTON AVE., PROVIDENCE.
 3. WORK IS TO BE PERFORMED OVER A TWO DAY PERIOD DURING LOW FLOW CONDITIONS.
 4. STAGING AND STOCKPILE AREA TO BE LOCATED IN PARKING LOT AREA.
 5. CONSTRUCTION ACCESS SHOULD BE GAINED VIA A BOBCAT OR SIMILAR MACHINERY.
 6. NO TREES GREATER THAN 6" DIAMETER WILL BE REMOVED.
 7. CONTRACTOR RESPONSIBLE FOR ANY DAMAGE OR DESTRUCTION TO THE ENVIRONMENT, EXCEPT AS REQUIRED BY CONTRACT DOCUMENTS, SHALL BE REPAIRED OR REPLACED TO SATISFACTION OF ENGINEER AND APPLICABLE AUTHORITIES AT EXPENSE OF CONTRACTOR.
 8. CONTRACTOR SHALL PERFORM ALL WORK ACTIVITIES IN COMPLIANCE WITH TOWN, STATE, AND FEDERALLY ISSUED PERMITS.
 9. NO CONSTRUCTION VEHICLE (BOBCAT OR SIMILAR) SHALL DISTURB RIVER BOTTOM MATERIAL IN AREAS THAT DO NOT FLOW THROUGH THE TURBIDITY BARRIER.
 10. CONTRACTOR SHALL NOT FUEL EQUIPMENT OR STORE PETROLEUM BASED OR OTHER HAZARDOUS MATERIALS WITHIN RIVER OR SURROUNDING WETLANDS. CONTRACTOR RESPONSIBLE FOR SPILLS OF ALL HAZARDOUS MATERIALS.

- SEQUENCE OF CONSTRUCTION:
1. NOTIFY THE NATURAL RESOURCES CONSERVATION SERVICE (NRCS) AT (401) 822-8842 FOR THE REQUIRED PRE-CONSTRUCTION MEETING SEVEN (7) DAYS BEFORE COMMENCING SITE DISTURBANCE.
 2. MAP AND CLEAR UTILITIES AS NECESSARY.
 3. REMOVE FENCE TO ALLOW CONSTRUCTION OF ACCESS RAMP.
 4. INSTALL TURBIDITY CURTAIN AS SHOWN ON PLAN.
 5. CLEAR AND GRUB FOR THE INSTALLATION OF STABILIZED CONSTRUCTION ENTRANCES.
 6. CONTRACTOR WILL REMOVE TIMBER DAM DOWN TO SURROUNDING GRADE AND PROPERLY DISPOSE OF MATERIALS.
 7. WITH APPROVAL OF THE SEDIMENT CONTROL INSPECTOR, REMOVE PERIMETER EROSION AND SEDIMENTATION CONTROL DEVICES.
 8. RESTORE ALL STAGING, CONSTRUCTION ACCESS, AND STOCKPILE AREAS TO THEIR ORIGINAL CONDITION INCLUDING RIVER BANK SLOPE, FENCE, AND PARKING LOT CURB AND PAVEMENT.

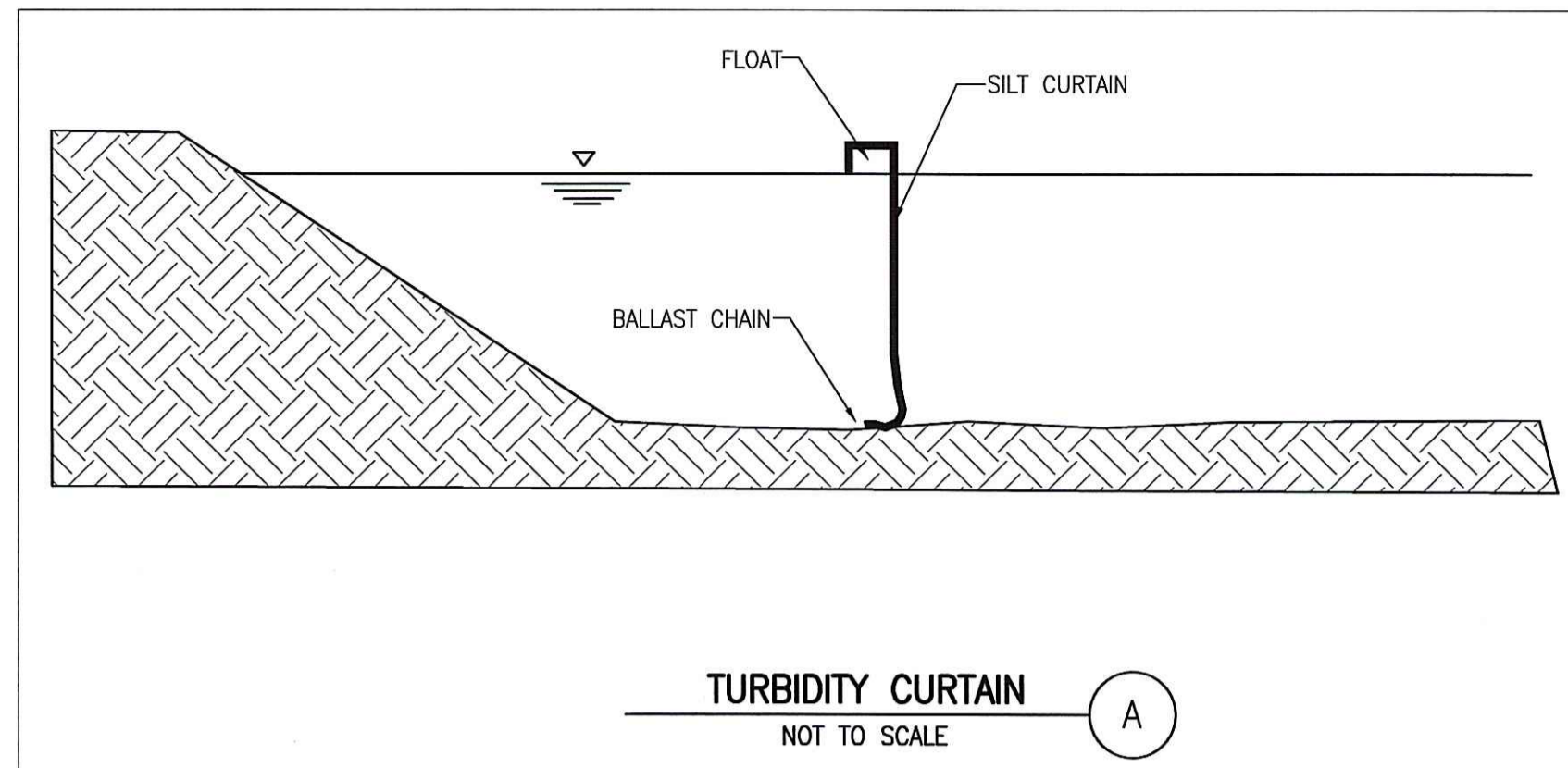
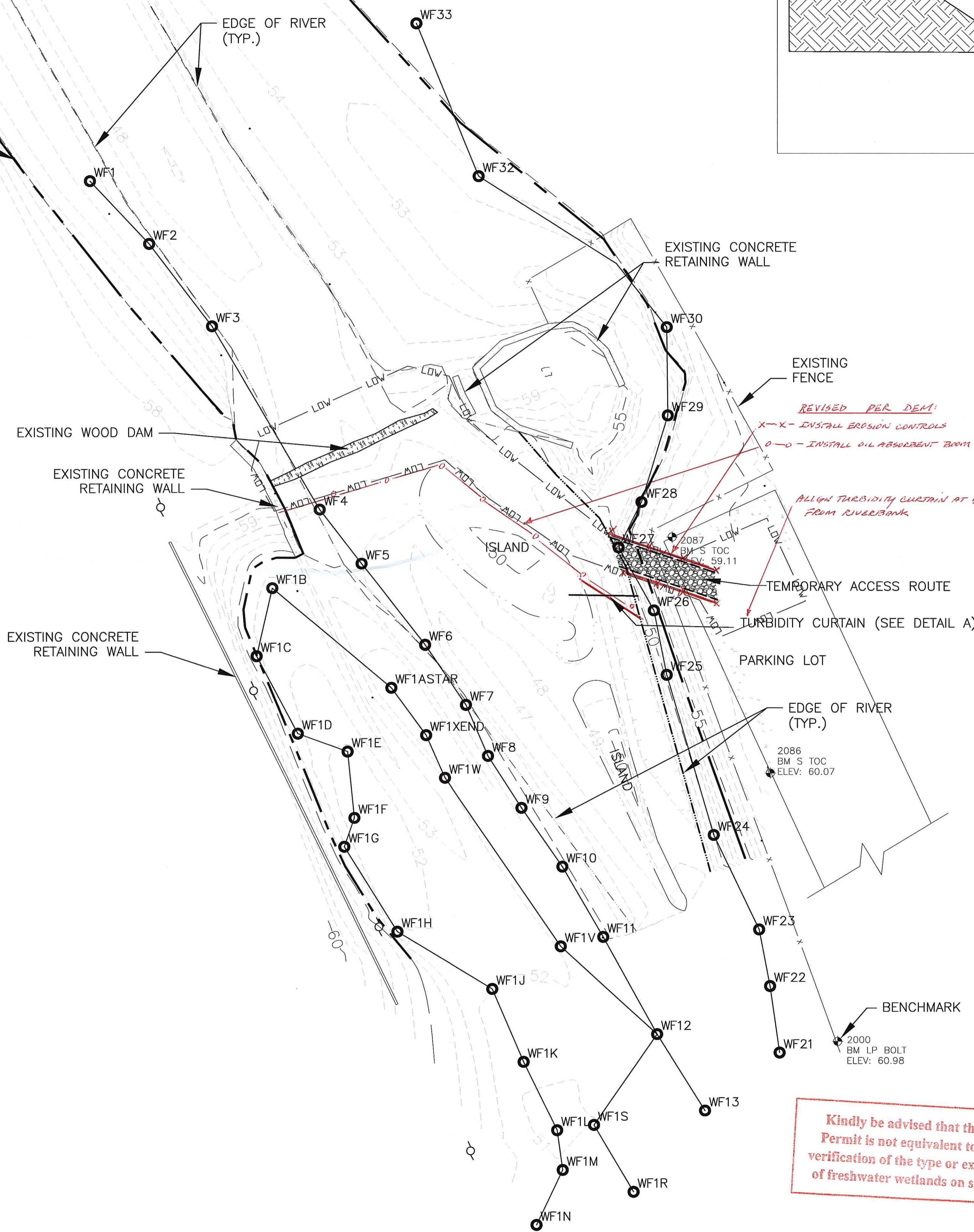
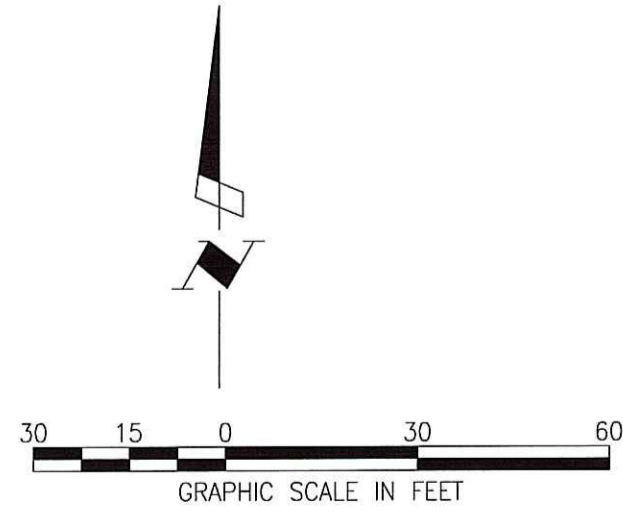

PLANTING PLAN:
The plantings shall appropriately cover the restored river bank to provide for adequate future stabilization and shall contain a total of at least four tree plantings, a variety of shrubs totaling at least ten total plants, and placement of the appropriate native seed mix. Contract shall select plant species from the list provided below. Contractor shall also be responsible for placement of additional measures to provide temporary soil stabilization (coconut fiber mat or similar biodegradable material) prior to the permanent establishment of the planted vegetation.

RIPARIAN FLOODPLAIN PLANTING ZONE

TREES	
COMMON NAME	BOTANICAL NAME
BLACK WILLOW	SALIX NIGRA
RIVER BIRCH	BETULA NIGRA
SYCAMORE	PLATANUS OCCIDENTALIS
SHRUBS	
COMMON NAME	BOTANICAL NAME
SPECKLED ALDER	ALNUS INCANA
SHADBLOW	AMELANCHIER CANADENSIS
WINTERBERRY HOLLY	ILEX VERTICILLATA
NORTHERN ARROWWOOD	VIBURNUM DENTATUM

NEW ENGLAND CONSERVATION/WILDLIFE SEED MIX

COMMON NAME	BOTANICAL NAME
BIG BLUESTEM	ANDROPOGON GERARDII
FRINGED BROME GRASS	BROMUS CILIATUS
CREeping RED FESCUE	FESTUCA RUBRA
CANADA WILD RYE	ELYMUS VIRGINICUS
SWITCHGRASS	PANICUM VIRGATUM
DEER TONGUE	PANICUM CLANDESTINUM
LITTLE BLUESTEM	SCHIZACHYRIUM SCOPARIUM
INDIAN GRASS	SORGHASTRUM NUTANS
COMMON MILKWEED	ASCLEPIAS SYRICA
NEW ENGLAND ASTER	ASTER NOVAE-ANGLIAE
PARTRIDGE PEA	CHAMAECRISTA FASCICULATA
SHOWY TICK-TREFOIL	DESMODIUM CANADENSE
GRASS LEAVED GOLDENROD	EUTHAMIA GRAMINIFOLIA
GRAY GOLDENROD	SOLIDAGE NEMORALIS

Kindly be advised that this Permit is not equivalent to a verification of the type or extent of freshwater wetlands on site.

DEPARTMENT OF ENVIRONMENTAL MANAGEMENT
OFFICE OF WATER RESOURCES
FRESHWATER WETLANDS PROGRAM
APPROVED WITH CONDITIONS
AS SPECIFIED IN THE LETTER OF APPROVAL
DATED MAY 9 2009 FILE # 09-0074
NO CHANGES ALLOWED WITHOUT PRIOR APPROVAL.
APPROVED PLANS MUST BE AT CONSTRUCTION SITE.

W. Joseph Conroy
60% DESIGN
FOR PERMITTING

REVISIONS	DESCRIPTION
NO. 1	60% DESIGN
DATE	03/09
BY	EA

THOMAS C. COOK
Professional Engineer
No. 8819
3/24/09

NATURAL RESOURCES CONSERVATION SERVICE
DYERVILLE DAM REMOVAL
PROVIDENCE, RHODE ISLAND
CONSTRUCTION SEQUENCE PLAN

EA ENGINEERING, SCIENCE, AND TECHNOLOGY
221 Sun Valley Boulevard
Suite D
Lincoln, Nebraska 68528
(402) 476-3766

DATE	MARCH 2009
DESIGNED BY	JMT
DRAWN BY	CNS
CHECKED BY	SW
PROJECT MANAGER	SW
PROJECT NUMBER	62130.13
SCALE	AS SHOWN
FILE NAME	-
DRAWING NUMBER	C-3
SHEET NUMBER	3 OF 3