

PLAN SHOWING EXISTING CONDITIONS
 PREPARED FOR:
MEADOWBROOK PROPERTIES, L.L.C.
 ASSESSOR'S PLAT 6C, LOT 9
 KINGSTOWN ROAD, (R.I. ROUTE 138)
 RICHMOND, RHODE ISLAND

SCALE: 1" = 200' DATE: DEC. 20, 2013

RICHARD A. GREENE & ASSOCIATES, INC.
 220 RICHMOND TOWNHOUSE RD.
 CAROLINA, RHODE ISLAND 02812
 TEL.: 401-364-9405
 FAX: 401-364-9403

Natural Resource Services, Inc.
 PO Box 311 p: (401) 568-7390
 180 Tinkham Lane f: (401) 568-7490
 Harrisville, RI 02830

SHEET 1 OF 9



LEGEND

- These standard symbols will be found in the drawing.
- PROPERTY LINES
 - EDGE OF WETLAND
 - 50' PERIMETER WETLAND
 - BANK OF STREAM
 - 100' RIVERBANK WETLAND
 - FAIRWAY CENTERLINE

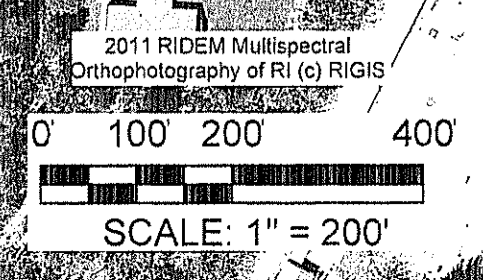

DEPARTMENT OF ENVIRONMENTAL MANAGEMENT
 OFFICE OF ENVIRONMENTAL RESOURCES
 ENVIRONMENTAL IMPACT STATEMENT PROGRAM
 APPROVAL WITH CONDITIONS
 AS SPECIFIED IN THE SYSTEM OF APPROVAL
 DATED: MAR 21 2014 FILE: 09-010
 THIS PROJECT IS ALLOWED WITHOUT PRIOR APPROVAL
 THIS MUST BE AT CONSTRUCTION

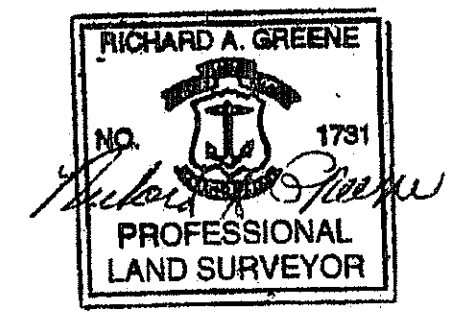

PLAN SHOWING PROPOSED CONDITIONS
 PREPARED FOR:
MEADOWBROOK PROPERTIES, L.L.C.
 ASSESSOR'S PLAT 6C, LOT 9
 KINGSTOWN ROAD, (R.I. ROUTE 138)
 RICHMOND, RHODE ISLAND

SCALE: 1" = 100' DATE: DEC. 20, 2013
 REV.: MARCH 3, 2014
 RICHARD A. GREENE & ASSOCIATES, INC.
 220 RICHMOND TOWNHOUSE RD.
 CAROLINA, RHODE ISLAND 02812
 TEL.: 401-364-9405
 FAX: 401-364-9403

SHEET 2 OF 9

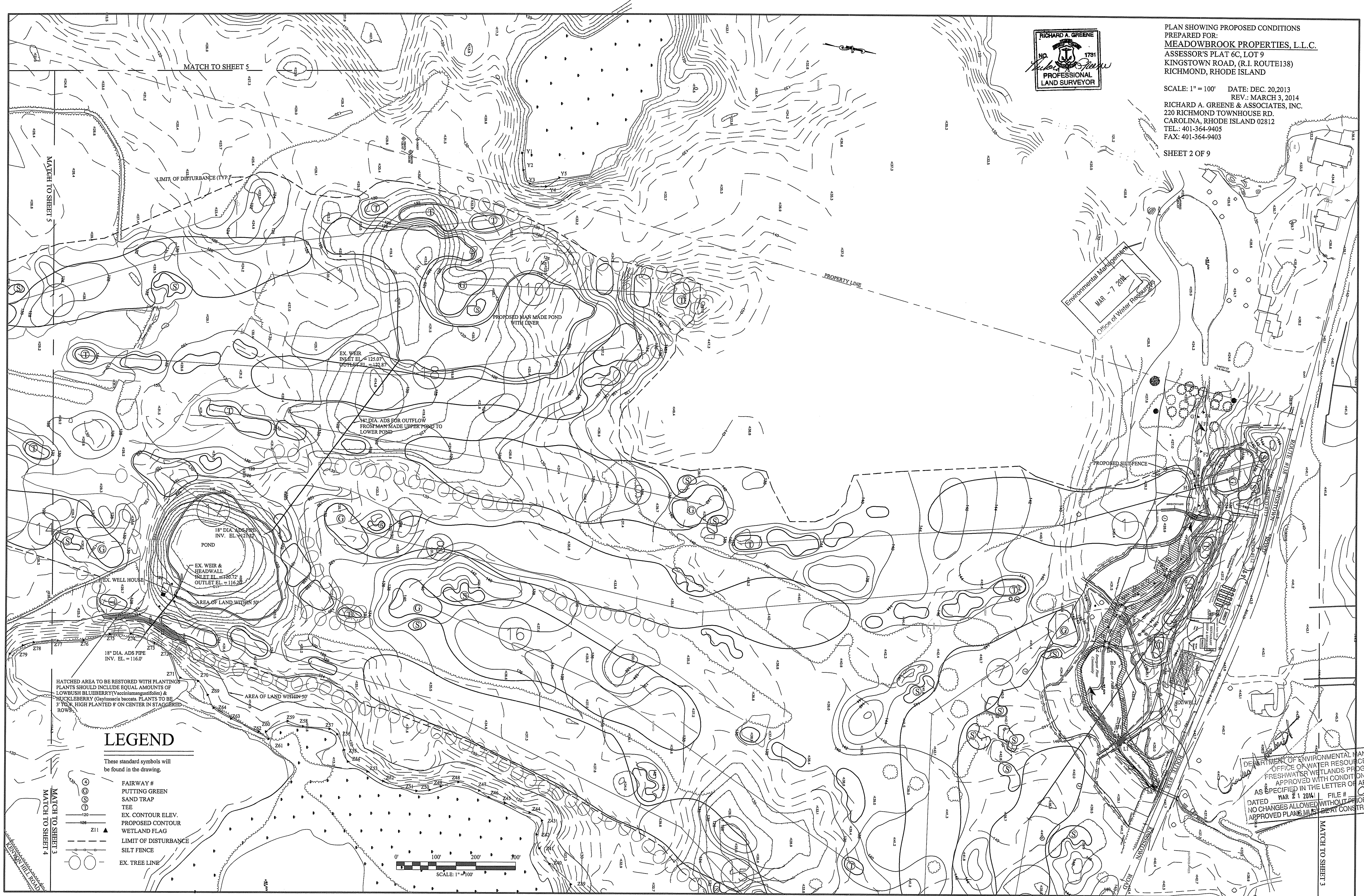

Environmental Management
 MAR - 7 2014
 Office of Water Resources

EX. WEIR
 INLET EL. = 125.07
 OUTLET EL. = 122.87

18" DIA. ADS FOR OUTFLOW
 FROM MAN MADE UPPER POND TO
 LOWER POND

18" DIA. ADS PIPE
 INV. EL. = 116.00

EX. WEIR &
 HEADWALL
 INLET EL. = 120.72
 OUTLET EL. = 116.20

AREA OF LAND WITHIN 50'

LEGEND

These standard symbols will be found in the drawing.

- FAIRWAY #
- PUTTING GREEN
- SAND TRAP
- TEE
- EX. CONTOUR ELEV.
- PROPOSED CONTOUR
- WETLAND FLAG
- LIMIT OF DISTURBANCE
- SILT FENCE
- EX. TREE LINE

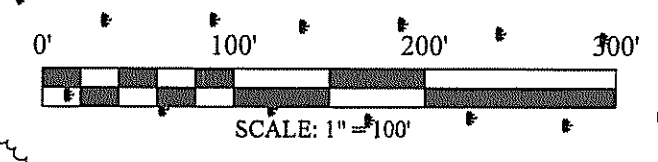

DEPARTMENT OF ENVIRONMENTAL MANAGEMENT
 OFFICE OF WATER RESOURCES
 FRESHWATER WETLANDS PROGRAM
 APPROVED WITH CONDITIONS
 AS SPECIFIED IN THE LETTER OF APPROVAL
 MAR 2 1 2014 FILE # 09-0101
 DATED NO CHANGES ALLOWED WITHOUT PRIOR APPROVAL
 APPROVED PLANS M.L.S. BEAT AT CONSTRUCTION SITE

MATCH TO SHEET 5

MATCH TO SHEET 5

MATCH TO SHEET 3

MATCH TO SHEET 3

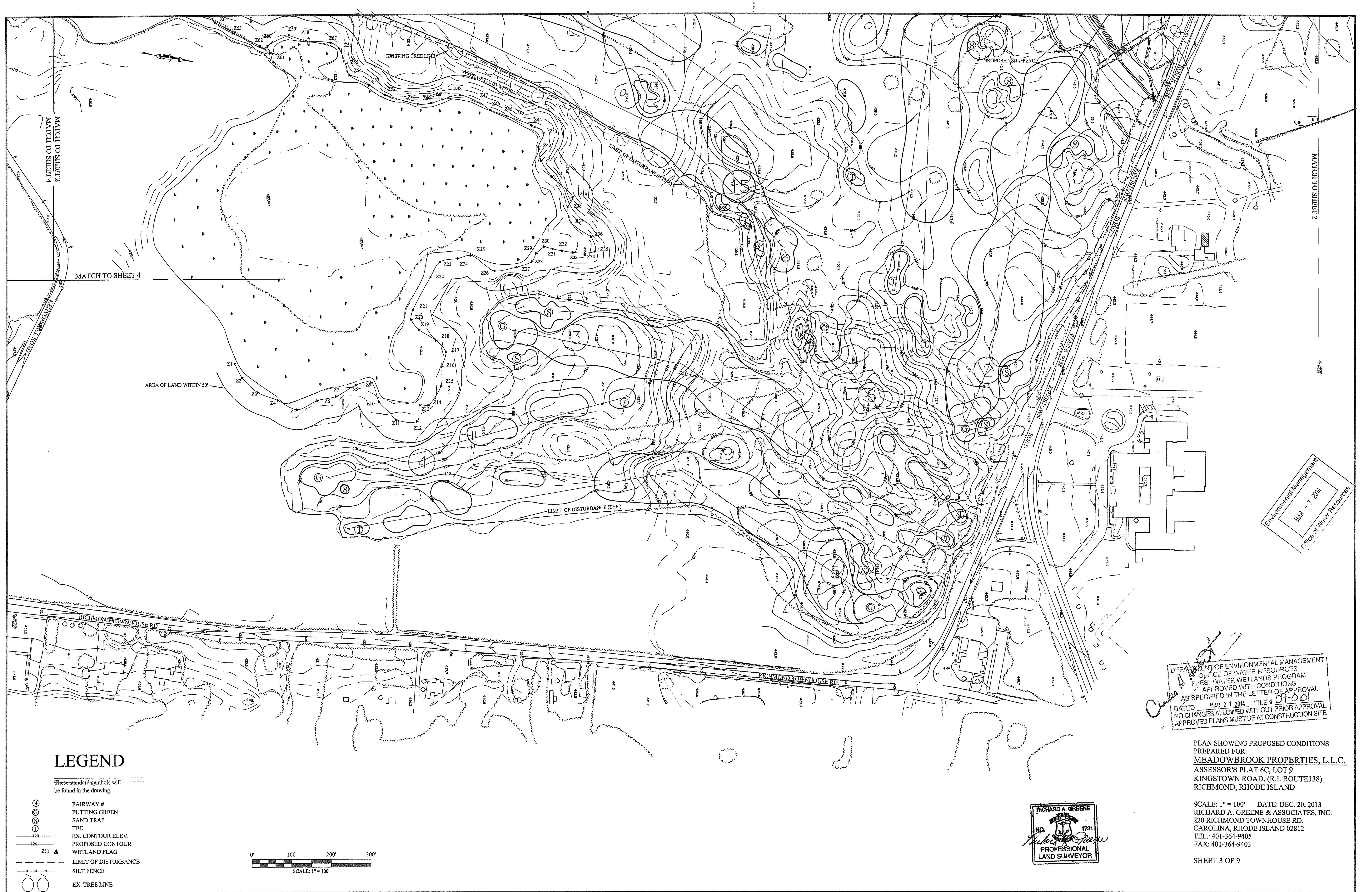

LEGEND

These standard symbols will be found in the drawing.

- ④ FAIRWAY #
- ⊙ PUTTING GREEN
- ⊙ SAND TRAP
- TEE
- EX. CONTOUR ELEV.
- PROPOSED CONTOUR
- ▲ WETLAND FLAG
- LIMIT OF DISTURBANCE
- SILT FENCE
- EX. TREE LINE

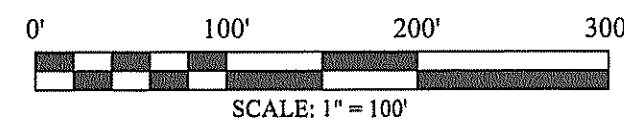

Environmental Management
 MHP - 7 2014
 Office of Water Resources

DEPARTMENT OF ENVIRONMENTAL MANAGEMENT
 OFFICE OF WATER RESOURCES
 FRESHWATER WETLANDS PROGRAM
 APPROVED WITH CONDITIONS
 AS SPECIFIED IN THE LETTER OF APPROVAL
 DATED MAR 21 2014 FILE # 07-0101
 NO CHANGES ALLOWED WITHOUT PRIOR APPROVAL
 APPROVED PLANS MUST BE AT CONSTRUCTION SITE

PLAN SHOWING PROPOSED CONDITIONS
 PREPARED FOR:
MEADOWBROOK PROPERTIES, L.L.C.
 ASSESSOR'S PLAT 6C, LOT 9
 KINGSTOWN ROAD, (R.I. ROUTE138)
 RICHMOND, RHODE ISLAND

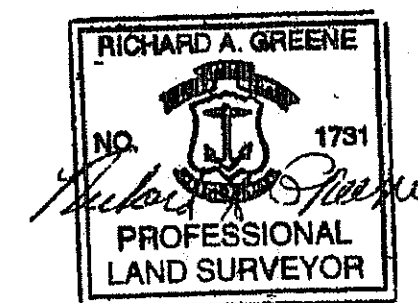

SCALE: 1" = 100' DATE: DEC. 20, 2013
 RICHARD A. GREENE & ASSOCIATES, INC.
 220 RICHMOND TOWNHOUSE RD.
 CAROLINA, RHODE ISLAND 02812
 TEL.: 401-364-9405
 FAX: 401-364-9403

PLAN SHOWING PROPOSED CONDITIONS
 PREPARED FOR:
MEADOWBROOK PROPERTIES, L.L.C.
 ASSESSOR'S PLAT 6C, LOT 9
 KINGSTOWN ROAD, (R.I. ROUTE 138)
 RICHMOND, RHODE ISLAND

SCALE: 1" = 100' DATE: DEC. 20, 2013
 RICHARD A. GREENE & ASSOCIATES, INC.
 220 RICHMOND TOWNHOUSE RD.
 CAROLINA, RHODE ISLAND 02812
 TEL.: 401-364-9405
 FAX: 401-364-9403

SHEET 4 OF 9

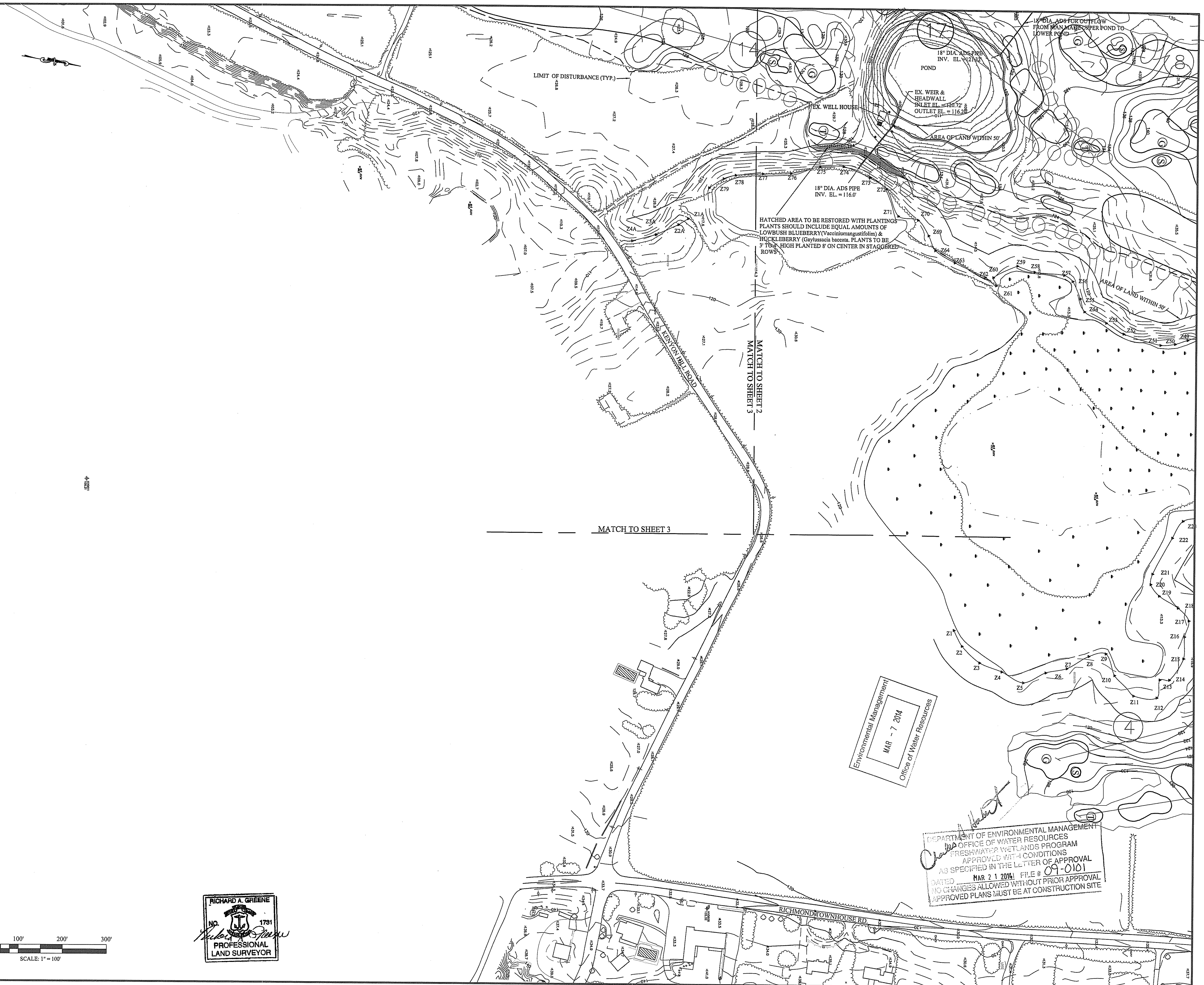

HATCHED AREA TO BE RESTORED WITH PLANTINGS
 PLANTS SHOULD INCLUDE EQUAL AMOUNTS OF
 LOWBUSH BLUEBERRY (*Vaccinium angustifolium*) &
 HUCKLEBERRY (*Gaylussacia baccata*). PLANTS TO BE
 3' TO 4' HIGH PLANTED 8' ON CENTER IN STAGGERED
 ROWS

Environmental Management
 MAR - 7 2014
 Office of Water Resources

DEPARTMENT OF ENVIRONMENTAL MANAGEMENT
 OFFICE OF WATER RESOURCES
 FRESHWATER WETLANDS PROGRAM
 APPROVED WITH CONDITIONS
 AS SPECIFIED IN THE LETTER OF APPROVAL
 DATED MAR 21 2014 FILE # 09-0101
 NO CHANGES ALLOWED WITHOUT PRIOR APPROVAL
 APPROVED PLANS MUST BE AT CONSTRUCTION SITE

LEGEND

These standard symbols will be found in the drawing.

- ④ FAIRWAY #
- ⊙ PUTTING GREEN
- ⊙ SAND TRAP
- ⊙ TEE
- EX. CONTOUR ELEV.
- - - PROPOSED CONTOUR
- Z11 ▲ WETLAND FLAG
- - - LIMIT OF DISTURBANCE
- SILT FENCE
- EX. TREE LINE

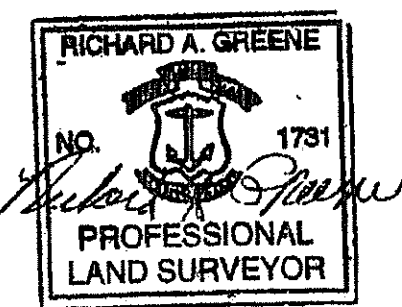
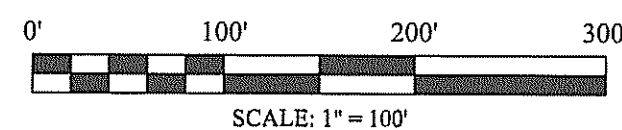

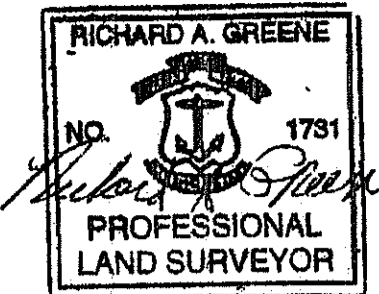

PLAN SHOWING PROPOSED CONDITIONS
 PREPARED FOR:
MEADOWBROOK PROPERTIES, L.L.C.
 ASSESSOR'S PLAT 6C, LOT 9
 KINGSTOWN ROAD, (R.I. ROUTE 138)
 RICHMOND, RHODE ISLAND

SCALE: 1" = 100' DATE: DEC. 20, 2013

RICHARD A. GREENE & ASSOCIATES, INC.
 220 RICHMOND TOWNHOUSE RD.
 CAROLINA, RHODE ISLAND 02812
 TEL.: 401-364-9405
 FAX: 401-364-9403

SHEET 5 OF 9

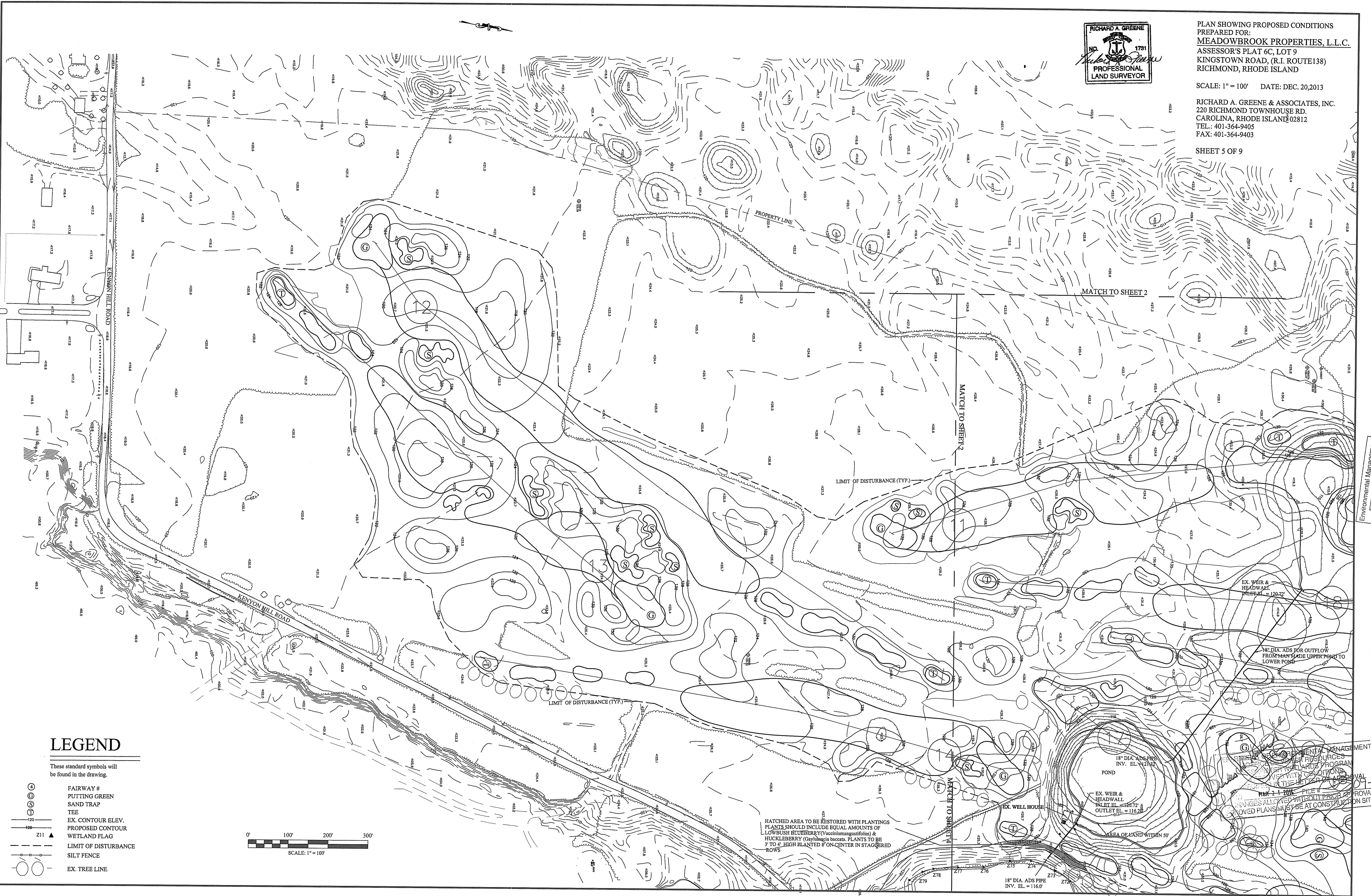

LEGEND

These standard symbols will be found in the drawing.

- ④ FAIRWAY #
- ③ PUTTING GREEN
- ② SAND TRAP
- ① TEE
- 120 EX. CONTOUR ELEV.
- 100 PROPOSED CONTOUR
- ▲ WETLAND FLAG
- - - LIMIT OF DISTURBANCE
- - - SILT FENCE
- EX. TREE LINE

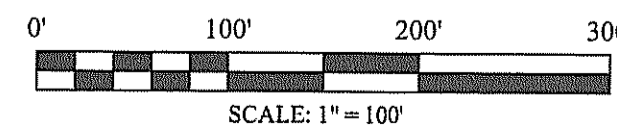

HATCHED AREA TO BE RESTORED WITH PLANTINGS
 PLANTS SHOULD INCLUDE EQUAL AMOUNTS OF
 LOWBUSH BLUEBERRY (*Vaccinium angustifolium*) &
 HUCKLEBERRY (*Gaylussacia baccata*). PLANTS TO BE
 3' TO 4' HIGH PLANTED 8' ON CENTER IN STAGGERED
 ROWS

ENVIRONMENTAL MANAGEMENT
 MAR 2 1 2014
 CHANGES ALLOWED WITHOUT PRIOR APPROVAL
 MOVED PLANTS MUST BE AT CONSTRUCTION SITE

Environmental Management
 MAR - 7 2014

NOTES:
 1. IRRIGATION LINES AS DELINEATED ARE APPROXIMATE.
 2. THE GOLF COURSE WILL BE PLAYED AS SHOWN ON SHEET 1 OF 6.
 NO FURTHER WETLAND ALTERATIONS TO THE COURSE ARE ANTICIPATED.
 ANY FUTURE ALTERATIONS TO THE GOLF COURSE MUST OBTAIN APPROVAL FROM R.I.D.E.M. FRESHWATER WETLANDS.

PROPOSED NEW BRIDGE ELEVATIONS
 BRIDGE #1 TOP OF DECK ELEV. = 131.68'
 BRIDGE #1 LOWEST MEMBER ELEV. = 129.48'
 BRIDGE #2 TOP OF DECK ELEV. = 137.40'
 BRIDGE #2 LOWEST MEMBER ELEV. = 135.23'

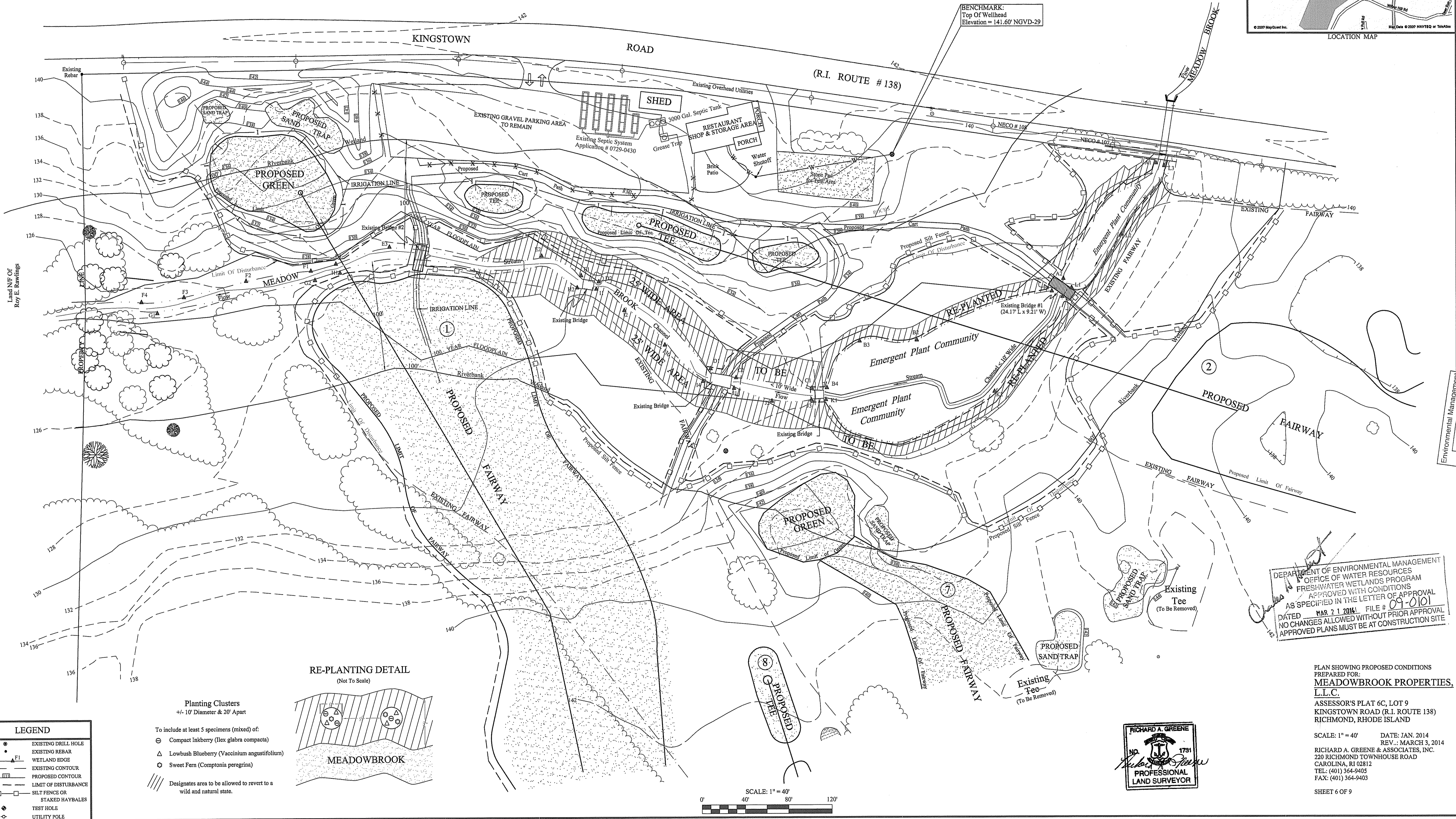
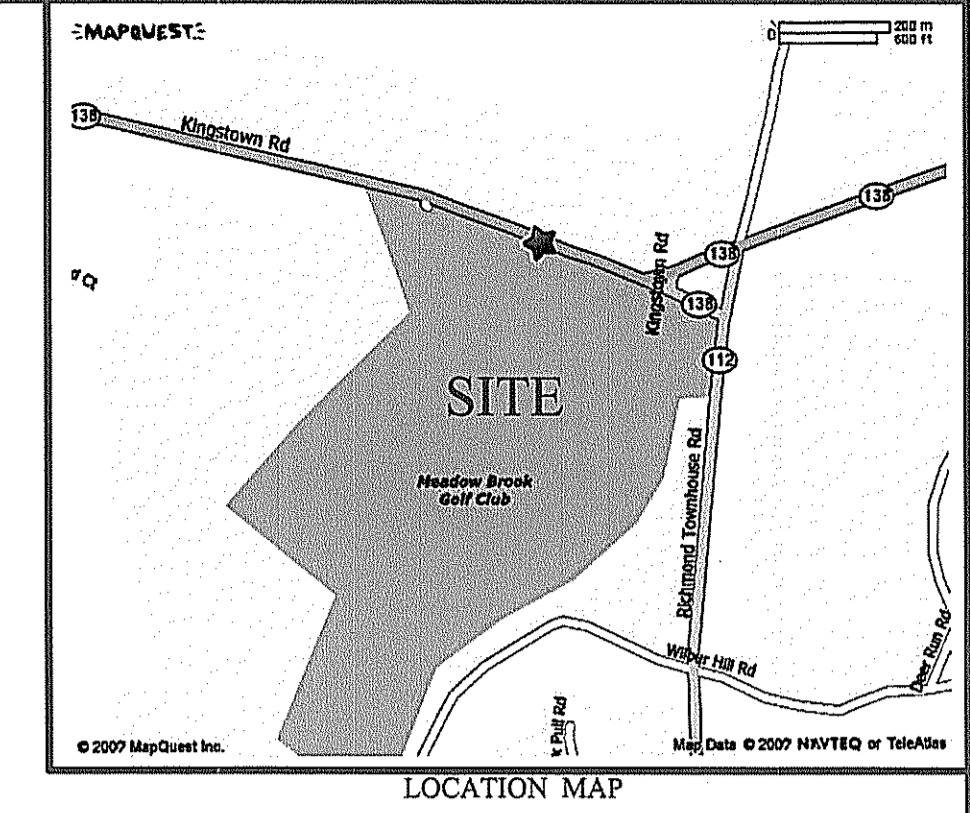

BENCHMARK:
 Top Of Wellhead
 Elevation = 141.60' NGVD-29

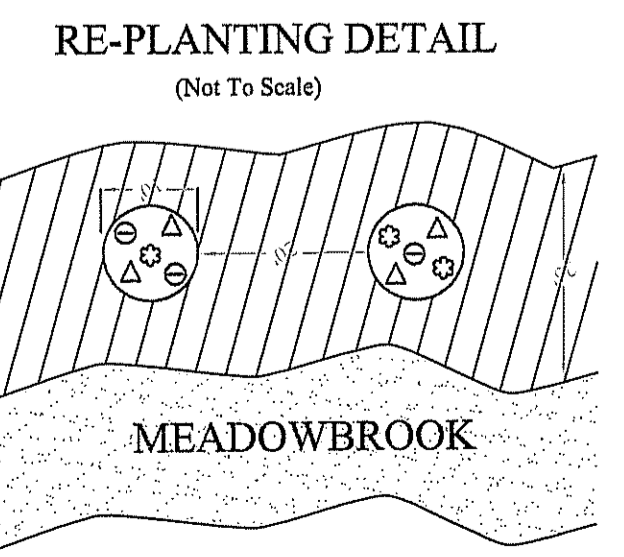

- Planting Clusters
 +/- 10' Diameter & 20' Apart
- To include at least 5 specimens (mixed) of:
- ⊙ Compact Inkberry (*Ilex glabra compacta*)
 - △ Lowbush Blueberry (*Vaccinium angustifolium*)
 - ⊕ Sweet Fern (*Comptonia peregrina*)
- /// Designates area to be allowed to revert to a wild and natural state.

LEGEND

●	EXISTING DRILL HOLE
○	EXISTING REBAR
—	WETLAND EDGE
---	EXISTING CONTOUR
- - -	PROPOSED CONTOUR
---	LIMIT OF DISTURBANCE
---	SILT FENCE OR STAKED HAYBALES
⊙	TEST HOLE
◇	UTILITY POLE

DEPARTMENT OF ENVIRONMENTAL MANAGEMENT
 OFFICE OF WATER RESOURCES
 FRESHWATER WETLANDS PROGRAM
 APPROVED WITH CONDITIONS
 AS SPECIFIED IN THE LETTER OF APPROVAL
 DATED MAR 21 2014 FILE # 09-0101
 NO CHANGES ALLOWED WITHOUT PRIOR APPROVAL
 APPROVED PLANS MUST BE AT CONSTRUCTION SITE

PLAN SHOWING PROPOSED CONDITIONS
 PREPARED FOR:
MEADOWBROOK PROPERTIES, L.L.C.
 ASSESSOR'S PLAT 6C, LOT 9
 KINGSTOWN ROAD (R.I. ROUTE 138)
 RICHMOND, RHODE ISLAND

SCALE: 1" = 40' DATE: JAN. 2014
 REV.: MARCH 3, 2014
 RICHARD A. GREENE & ASSOCIATES, INC.
 220 RICHMOND TOWNHOUSE ROAD
 CAROLINA, RI 02812
 TEL: (401) 364-9403
 FAX: (401) 364-9403
 SHEET 6 OF 9

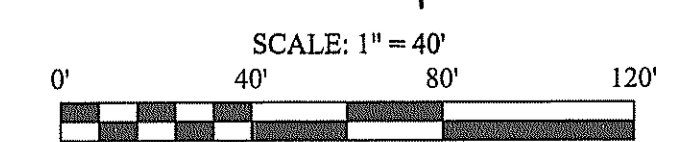
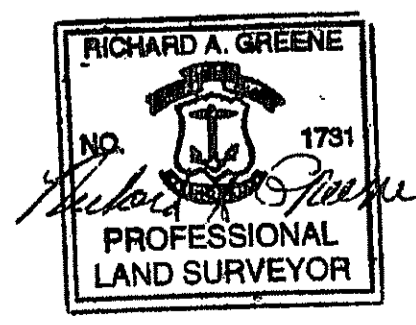

Environmental Management
 MAR - 7 2014
 Office of Water Resources

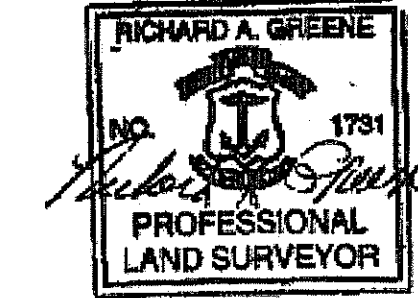

PLAN SHOWING LIMIT OF DISTURBANCE
 PREPARED FOR:
MEADOWBROOK PROPERTIES, L.L.C.
 ASSESSOR'S PLAT 6C, LOT 9
 KINGSTOWN ROAD, (R.I. ROUTE 138)
 RICHMOND, RHODE ISLAND

SCALE: 1" = 100' DATE: MARCH 3, 2014

RICHARD A. GREENE & ASSOCIATES, INC.
 220 RICHMOND TOWNHOUSE RD.
 CAROLINA, RHODE ISLAND 02812
 TEL.: 401-364-9405
 FAX: 401-364-9403

Natural Resource Services, Inc.
 PO Box 311 p: (401) 568-7390
 180 Tinkham Lane f: (401) 568-7490
 Harrisville, RI 02830

SHEET 7 OF 9



LEGEND

- These standard symbols will be found in the drawing.
- PROPERTY LINES
 - EDGE OF WETLAND
 - - - 50' PERIMETER WETLAND
 - PATHWAY
 - FAIRWAY CENTERLINE
 - x-x-x- LIMIT OF DISTURBANCE
 - - - - - LIMIT OF VEGETATION
 - SAND TRAP

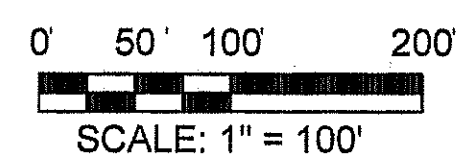

APPROVED FOR ENVIRONMENTAL MANAGEMENT
 OFFICE OF WATER RESOURCES
 STATE OF RHODE ISLAND
 APPROVED WITH CONDITIONS
 AS SET FORTH IN THE LETTER OF APPROVAL
 FILE # 09-0101
 MAR 2 1 2014
 CHANGES ALLOWED WITHOUT PRIOR APPROVAL
 APPROVED PLANS MUST BE AT CONSTRUCTION SITE

Environmental Management
 Office of Water Resources

MATCH TO SHEET 8

MATCH TO SHEET 8

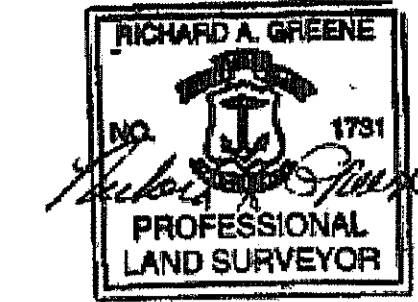

PLAN SHOWING LIMIT OF DISTURBANCE
 PREPARED FOR:
MEADOWBROOK PROPERTIES, L.L.C.
 ASSESSOR'S PLAT 6C, LOT 9
 KINGSTOWN ROAD, (R.I. ROUTE 138)
 RICHMOND, RHODE ISLAND

SCALE: 1" = 100' DATE: MARCH 3, 2014

RICHARD A. GREENE & ASSOCIATES, INC.
 220 RICHMOND TOWNHOUSE RD.
 CAROLINA, RHODE ISLAND 02812
 TEL.: 401-364-9405
 FAX: 401-364-9403

Natural Resource Services, Inc.
 PO Box 311 p: (401) 568-7390
 180 Tinkham Lane f: (401) 568-7490
 Harrisville, RI 02830

SHEET 8 OF 9

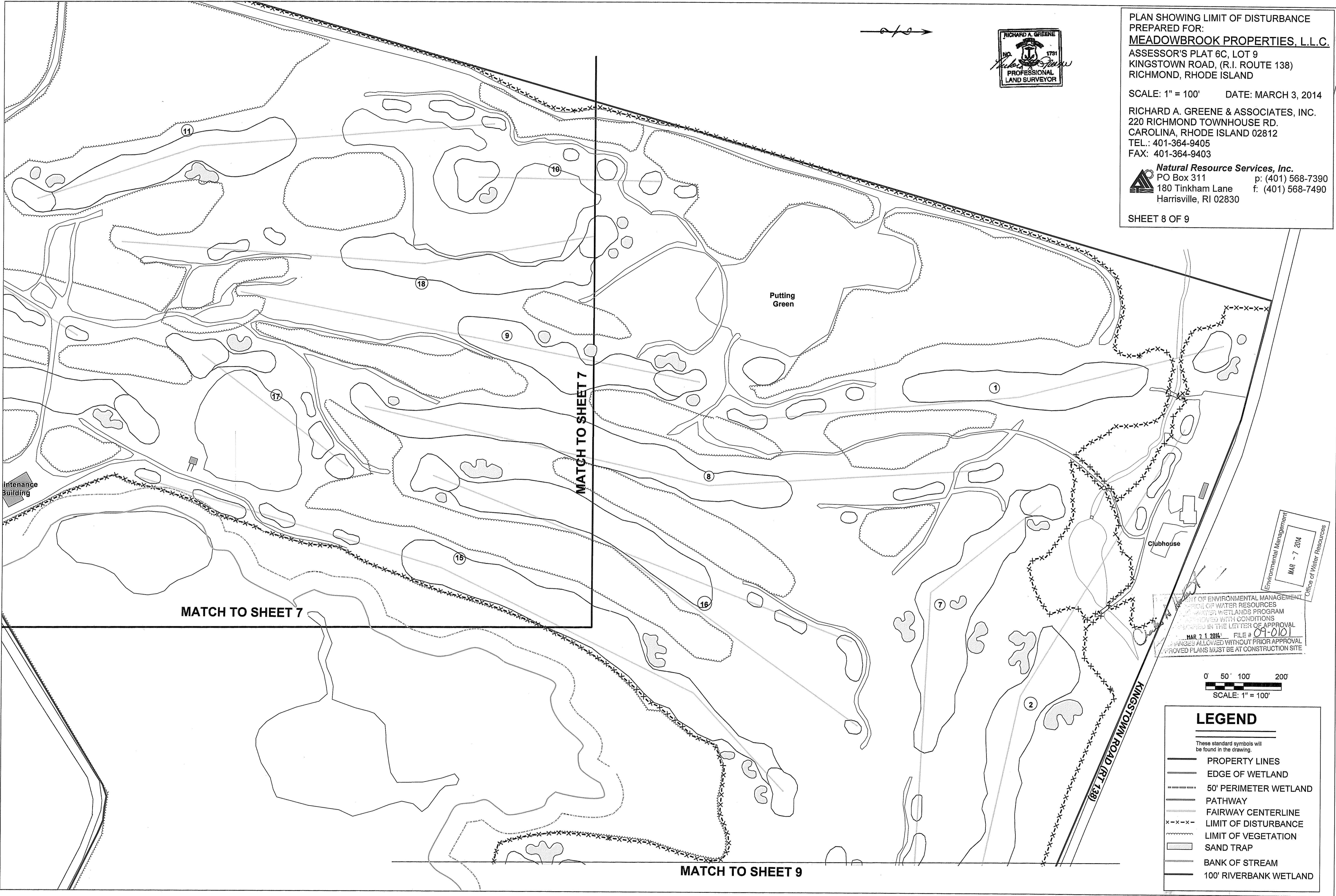

Maintenance Building

Putting Green

Clubhouse

MATCH TO SHEET 7

MATCH TO SHEET 7

MATCH TO SHEET 9

KINGSTOWN ROAD (RT 138)

DEPARTMENT OF ENVIRONMENTAL MANAGEMENT
 OFFICE OF WATER RESOURCES
 WETLANDS PROGRAM
 APPROVED WITH CONDITIONS
 AS SHOWN IN THE LETTER OF APPROVAL
 MAR 21 2014 FILE # 09-0101
 CHANGES ALLOWED WITHOUT PRIOR APPROVAL
 APPROVED PLANS MUST BE AT CONSTRUCTION SITE

Environmental Management
 MAR - 7 2014
 Office of Water Resources

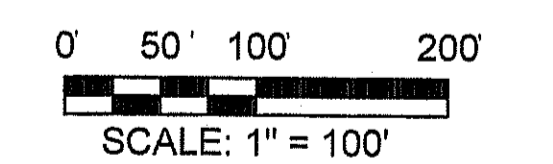

LEGEND

These standard symbols will be found in the drawing.

- PROPERTY LINES
- EDGE OF WETLAND
- 50' PERIMETER WETLAND
- PATHWAY
- FAIRWAY CENTERLINE
- x-x-x-x- LIMIT OF DISTURBANCE
- LIMIT OF VEGETATION
- SAND TRAP
- BANK OF STREAM
- 100' RIVERBANK WETLAND

PLAN SHOWING LIMIT OF DISTURBANCE
 PREPARED FOR:
MEADOWBROOK PROPERTIES, L.L.C.
 ASSESSOR'S PLAT 6C, LOT 9
 KINGSTOWN ROAD, (R.I. ROUTE 138)
 RICHMOND, RHODE ISLAND

SCALE: 1" = 100' DATE: MARCH 3, 2014

RICHARD A. GREENE & ASSOCIATES, INC.
 220 RICHMOND TOWNHOUSE RD.
 CAROLINA, RHODE ISLAND 02812
 TEL.: 401-364-9405
 FAX: 401-364-9403

Natural Resource Services, Inc.
 PO Box 311 p: (401) 568-7390
 180 Tinkham Lane f: (401) 568-7490
 Harrisville, RI 02830

SHEET 9 OF 9

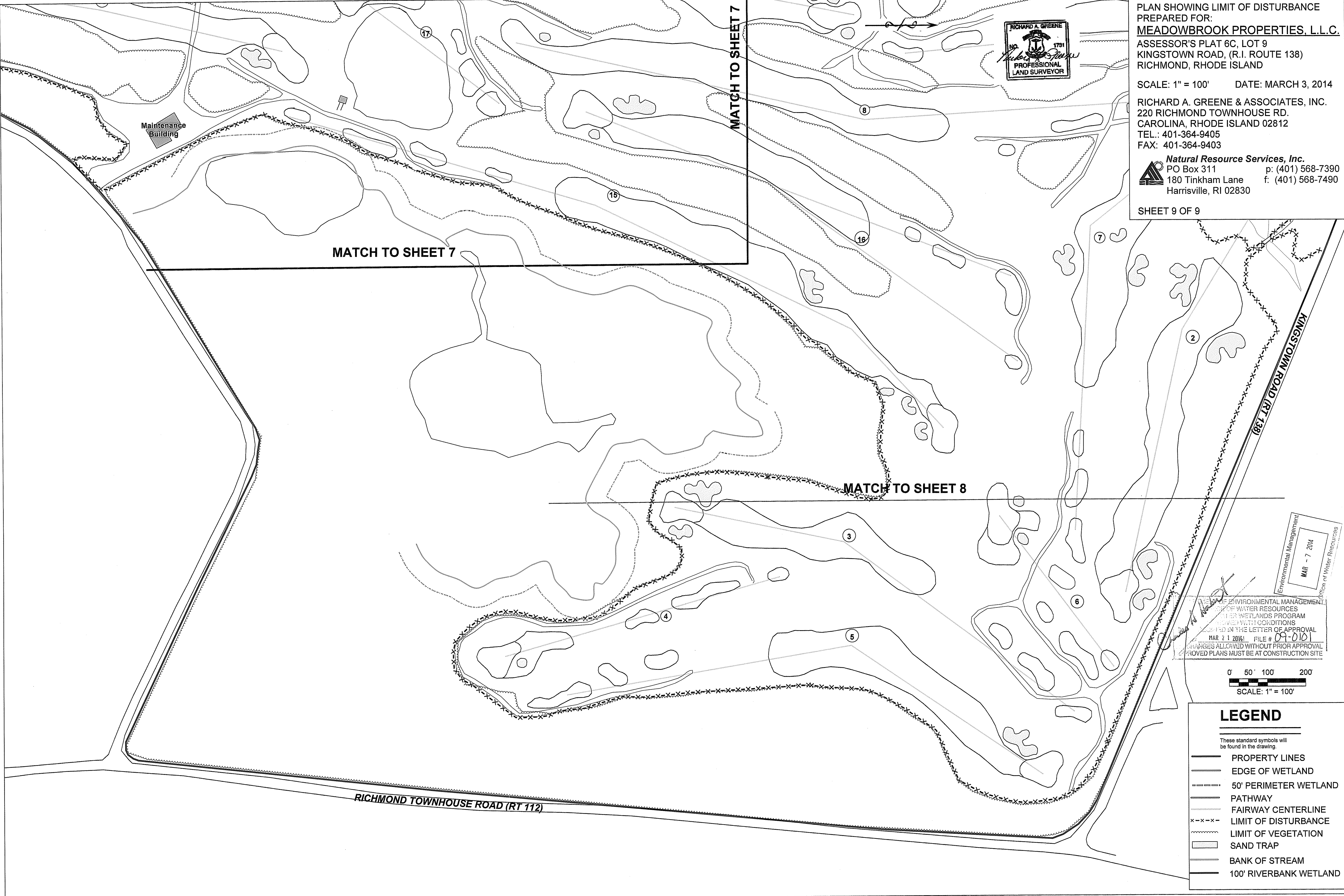

MATCH TO SHEET 7

MATCH TO SHEET 7

MATCH TO SHEET 8

Environmental Management
 MAR - 7 2014
 Office of Water Resources

OFFICE OF ENVIRONMENTAL MANAGEMENT
 DEPARTMENT OF WATER RESOURCES
 RIVER WETLANDS PROGRAM
 APPROVED WITH CONDITIONS
 AS SHOWN IN THE LETTER OF APPROVAL
 MAR 21 2014 FILE # 09-0101
 CHANGES ALLOWED WITHOUT PRIOR APPROVAL
 APPROVED PLANS MUST BE AT CONSTRUCTION SITE

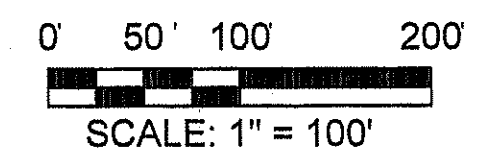

LEGEND

These standard symbols will be found in the drawing.

	PROPERTY LINES
	EDGE OF WETLAND
	50' PERIMETER WETLAND
	PATHWAY
	FAIRWAY CENTERLINE
	LIMIT OF DISTURBANCE
	LIMIT OF VEGETATION
	SAND TRAP
	BANK OF STREAM
	100' RIVERBANK WETLAND

RICHMOND TOWNHOUSE ROAD (RT 112)

KINGSTOWN ROAD (RT 138)