

GENERAL CONSTRUCTION NOTES

1. THE LOCATION AND DEPTH OF EXISTING UTILITIES HAVE BEEN PLOTTED FROM THE LATEST AVAILABLE INFORMATION. THE UTILITY LOCATIONS ARE APPROXIMATE AND MAY NOT BE ALL INCLUSIVE. THE CONTRACTOR SHALL CHECK AND VERIFY THE LOCATIONS OF ALL EXISTING UTILITIES, BOTH OVERHEAD AND UNDERGROUND, AND "DIG-SAFE" MUST BE NOTIFIED PRIOR TO COMMENCING ANY CONSTRUCTION OPERATIONS.
2. ANY DAMAGE TO EXISTING UTILITIES SHALL BE THE RESPONSIBILITY OF THE CONTRACTOR, AND ANY COSTS ASSOCIATED WITH THE REPAIR OF DAMAGED UTILITIES SHALL BE THE CONTRACTOR'S RESPONSIBILITY WITH NO ADDITIONAL COST TO THE OWNER. NO EXCAVATION SHALL COMMENCE UNTIL ALL UTILITY COMPANIES AND/OR TOWN DEPARTMENTS WHOSE FACILITIES MAY BE AFFECTED BY ANY WORK TO BE PERFORMED BY THE CONTRACTOR ARE NOTIFIED AT LEAST 72 HOURS IN ADVANCE.
3. IT SHALL BE THE CONTRACTOR'S SOLE RESPONSIBILITY TO OBTAIN AND PAY FOR ANY AND ALL PERMITS REQUIRED BY THE STATE OF RHODE ISLAND AND THE TOWN OF CUMBERLAND PRIOR TO COMMENCING ANY CONSTRUCTION OPERATIONS.
4. ALL SITE WORK, INCLUDING, BUT NOT LIMITED TO, BITUMINOUS PAVEMENT, GRAVEL, DRAINAGE PIPE AND STRUCTURES, SEWER PIPE AND STRUCTURES, WATER LINE INSTALLATION, PAVEMENT SAWCUTTING, ETC. SHALL CONFORM TO THE STATE OF RHODE ISLAND STANDARD SPECIFICATIONS FOR ROAD AND BRIDGE CONSTRUCTION, 2004 EDITION (WITH LATEST ADDENDA) AND THE REGULATIONS THE TOWN OF CUMBERLAND.
5. THE CONTRACTOR SHALL BE RESPONSIBLE FOR REMOVING AND LEGALLY DISPOSING (R&D) ALL MATERIALS TO INCLUDE BUT NOT LIMITED TO, TREES, STUMPS, UNSUITABLE MATERIAL, BITUMINOUS PAVEMENT, ETC.
6. ALL CONSTRUCTION WORK SHALL BE PERFORMED IN THE DRY. THE CONTRACTOR SHALL PROVIDE, OPERATE, AND MAINTAIN ALL PUMPS, DRAINS, WELL POINTS, SCREENS, OR OTHER FACILITIES NECESSARY TO CONTROL, COLLECT, AND DISPOSE OF ALL SURFACE AND SUBSURFACE WATER ENCOUNTERED IN THE PERFORMANCE OF THE WORK.
7. STOCKPILES OF EARTH MATERIALS SHALL NOT BE LOCATED ADJACENT TO DRAINAGE STRUCTURES AND/OR WETLAND AREAS.
8. ALL DISTURBED SOILS NOT DESIGNATED FOR OTHER SURFACE TREATMENT ARE TO BE LOAMED AND SEEDED IMMEDIATELY FOLLOWING FINAL GRADING. PLANTABLE LOAM SHALL BE APPLIED AT A DEPTH OF SIX INCHES, UNLESS NOTED OTHERWISE.
9. ANY ITEMS OF WORK NOT SPECIFICALLY INDICATED ON THE PLANS BUT REQUIRED FOR THE COMPLETE CONSTRUCTION OF THE PROJECT WILL BE CONSIDERED INCIDENTAL TO THE CONTRACT AND INCLUDED IN THE CONTRACT PRICE. IT WILL BE THE CONTRACTOR'S RESPONSIBILITY TO VERIFY ALL EXISTING SITE CONDITIONS.

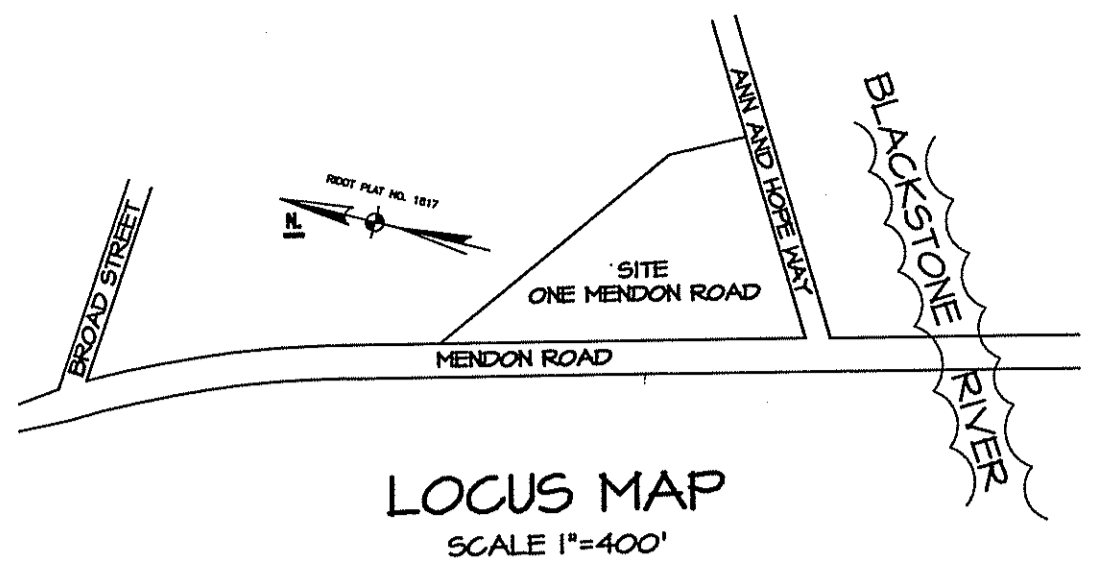

LEGEND

- 100 --- EXISTING CONTOUR
- 100 --- PROPOSED CONTOUR
- R.I. STD. --- RHODE ISLAND D.O.T. STANDARD
- INV. --- INVERT OF PIPE
- C.P. P.F.P. --- CORRUGATED POLYETHYLENE PIPE
- S.D. P.F.P. --- STANDARD DIMENSION RATIO REINFORCED CONCRETE PIPE
- CONC. --- CONCRETE (BIT. OR P. C.)
- BIT. --- BITUMINOUS
- P.C. --- PORTLAND CEMENT
- TYP. --- TYPICAL
- + 100.00 --- FINISHED SPOT GRADE
- 100.00 --- EXISTING SPOT GRADE
- T. C. --- TOP OF CURB
- B. C. --- BOTTOM OF CURB
- E' --- PROPERTY LINE
- x-CLF-x- --- CHAIN LINK FENCE
- --- PROPOSED LIGHT
- --- PROPOSED LIMIT OF DISTURBANCE
- --- EXISTING STORM DRAIN
- --- EXISTING SANITARYSEWER
- --- EXISTING GAS
- --- EXISTING WATER

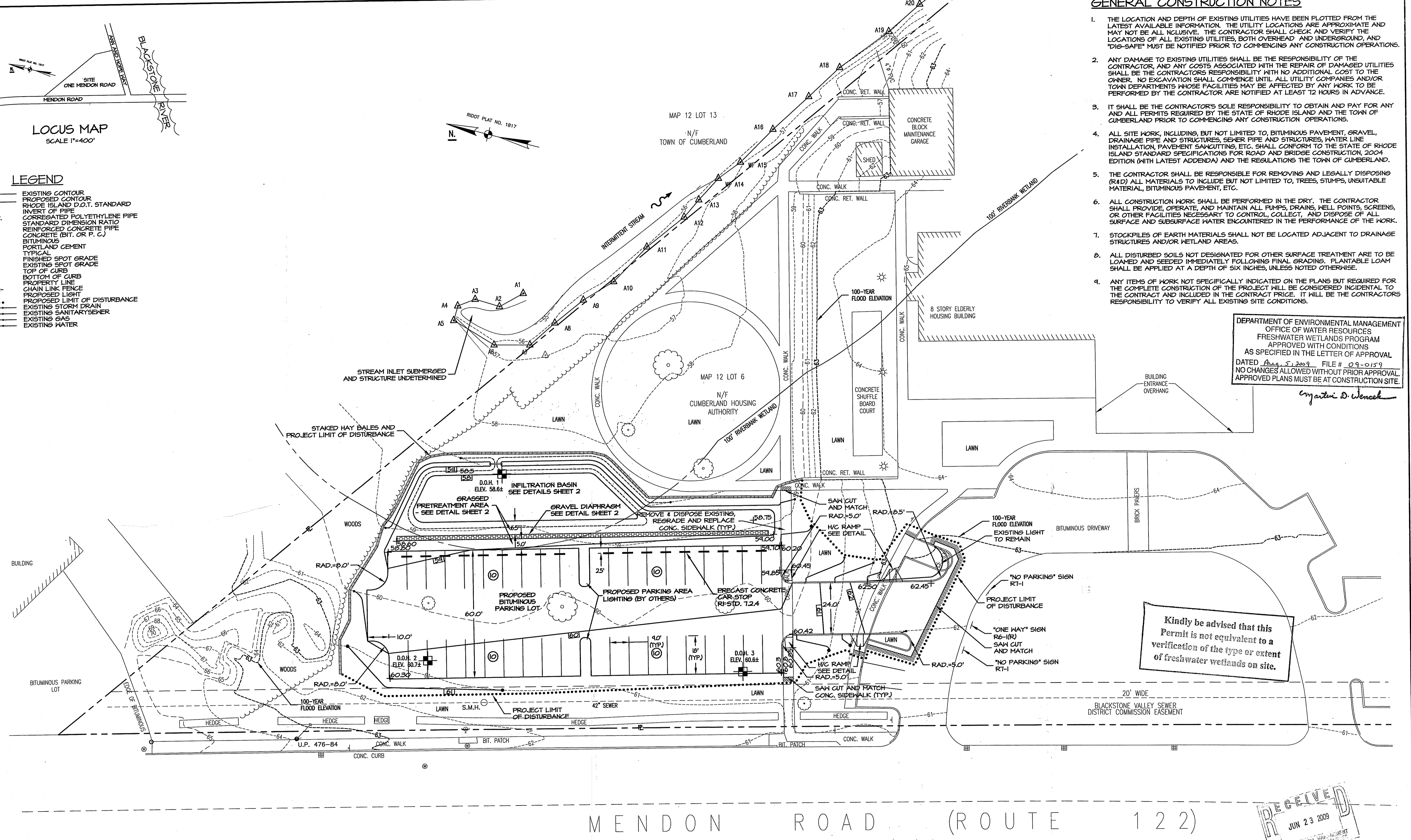

DEPARTMENT OF ENVIRONMENTAL MANAGEMENT
 OFFICE OF WATER RESOURCES
 FRESHWATER WETLANDS PROGRAM
 APPROVED WITH CONDITIONS
 AS SPECIFIED IN THE LETTER OF APPROVAL
 DATED Aug. 5, 2009 FILE # 09-0159
 NO CHANGES ALLOWED WITHOUT PRIOR APPROVAL.
 APPROVED PLANS MUST BE AT CONSTRUCTION SITE.

Matthew D. Wenzel

Kindly be advised that this Permit is not equivalent to a verification of the type or extent of freshwater wetlands on site.

MENDON ROAD (ROUTE 122)



SCALE: 1"=20'
 SCALE IN FEET

NOTES:
 ELEVATIONS SHOWN HEREON ARE REFERENCED TO THE NORTH AMERICAN VERTICAL DATUM OF 1988 (NAVD88). THESE ELEVATIONS ARE BASED ON THE RIM OF THE SEWER MANHOLE ON ANN & HOPE WAY FORMERLY MILL STREET.

	PROPOSED PARKING AND DRAINAGE IMPROVEMENTS CUMBERLAND HOUSING ONE MENDON ROAD CUMBERLAND, RHODE ISLAND	
	CAPUTO AND WICK LTD. 1150 PAWTUCKET AVE. RUMFORD, R.I. 02916 401-434-8880	DATE JUNE 2009 SHEET 1 of 2

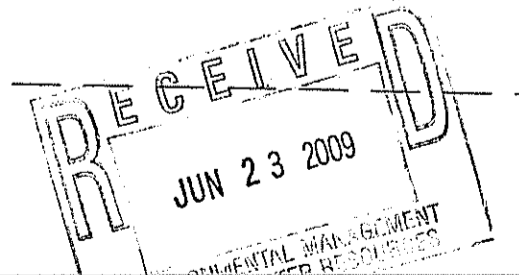

DEEP OBSERVATION HOLE "1" LOG
ORIGINAL GRADE - 58.6

DEPTH	SOIL HORIZON	SOIL TEXTURE	SOIL COLOR	SOIL MOTTLING	OTHER
0 - 11"	FILL	TOPSOIL			
11" - 36"	FILL	SAND			LOOSE, SINGLE GRAIN
36" - 50"	A	SANDY LOAM	10 YR 3/3	45° COMM., DIST. CRS.	MASSIVE, FRIABLE
50" - 54"	B ₁	SANDY LOAM	10 YR 3/4		MASSIVE, FRIABLE
54" - 108"	C	MED.-CRS. SAND	10 YR 4/4		LOOSE, SINGLE GRAIN

OBSERVED STANDING GROUNDWATER - 76"
ESTIMATED HIGH GROUNDWATER - 45" (ELEV.=54.85)

OBSERVED WEeping GROUNDWATER - 72"
REMOVE TO C HORIZON

DEEP OBSERVATION HOLE "2" LOG
ORIGINAL GRADE - 60.7

DEPTH	SOIL HORIZON	SOIL TEXTURE	SOIL COLOR	SOIL MOTTLING	OTHER
0 - 24"	FILL	TOPSOIL			
24" - 68"	FILL	SAND			LOOSE, SINGLE GRAIN
68" - 76"	A	SANDY LOAM	10 YR 3/3	78° COMM., DIST. CRS.	MASSIVE, FRIABLE
76" - 84"	B ₁	SANDY LOAM	10 YR 5/6		MASSIVE, FRIABLE
84" - 132"	C	MED.-CRS. SAND	10 YR 4/4		LOOSE, SINGLE GRAIN

OBSERVED STANDING GROUNDWATER - 105"
ESTIMATED HIGH GROUNDWATER - 78" (ELEV.=54.20)

OBSERVED WEeping GROUNDWATER - 101"

DEEP OBSERVATION HOLE "3" LOG
ORIGINAL GRADE - 60.7

DEPTH	SOIL HORIZON	SOIL TEXTURE	SOIL COLOR	SOIL MOTTLING	OTHER
0 - 13"	FILL	TOPSOIL			
13" - 34"	FILL	LOAMY SAND			MOTTLED GRAVELLY
34" - 64"	FILL	MED. CRS. L.S.			MASSIVE, FIRM
64" - 74"	A	SANDY LOAM	10 YR 2/2	72° COMM., DIST. CRS.	LOOSE, SINGLE GRAIN
74" - 43"	B ₁	SANDY LOAM	10 YR 4/6		MASSIVE, FRIABLE
43" - 104"	C ₁	LOAMY SAND	2.5Y 5/2		LOOSE, SINGLE GRAIN
104" - 132"	C ₂	SAND	5YR 3/4		GRAVELLY, COBBLE

OBSERVED STANDING GROUNDWATER - 105"
ESTIMATED HIGH GROUNDWATER - 78" (ELEV.=54.70)

OBSERVED WEeping GROUNDWATER - 101"

TESTING PERFORMED BY: CAPUTO AND WICK LTD. 6/5/09

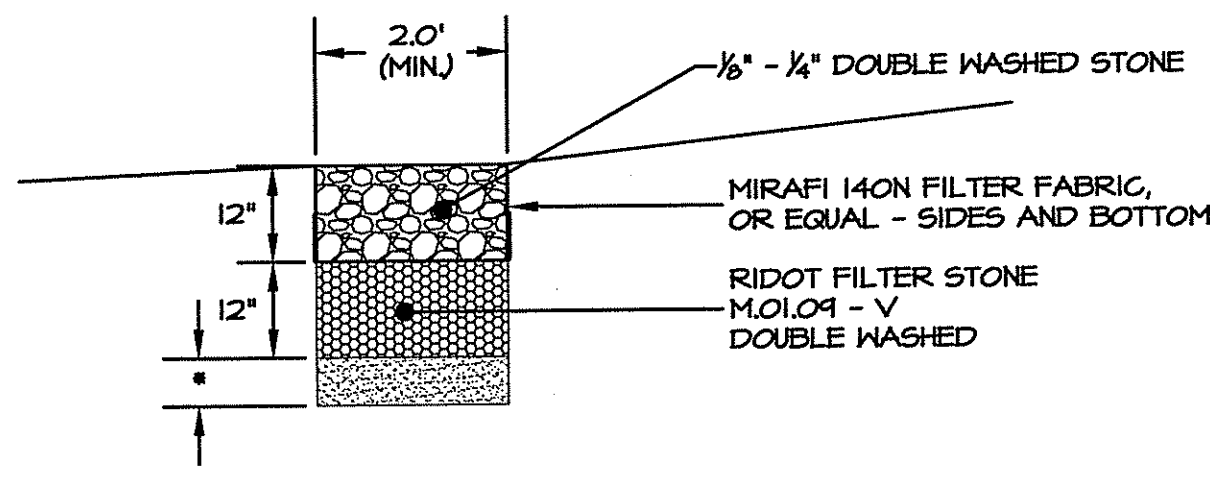

* - REMOVE ALL TOPSOIL AND SUBSOIL WITHIN LIMITS OF GRAVEL DIAPHRAGM. REPLACE WITH BANK RUN GRAVEL CONTAINING LITTLE TO NO FINES TO WITHIN 24" OF FINISHED GRADE.

DETAIL - GRAVEL DIAPHRAGM
SCALE 1"=2'-0"

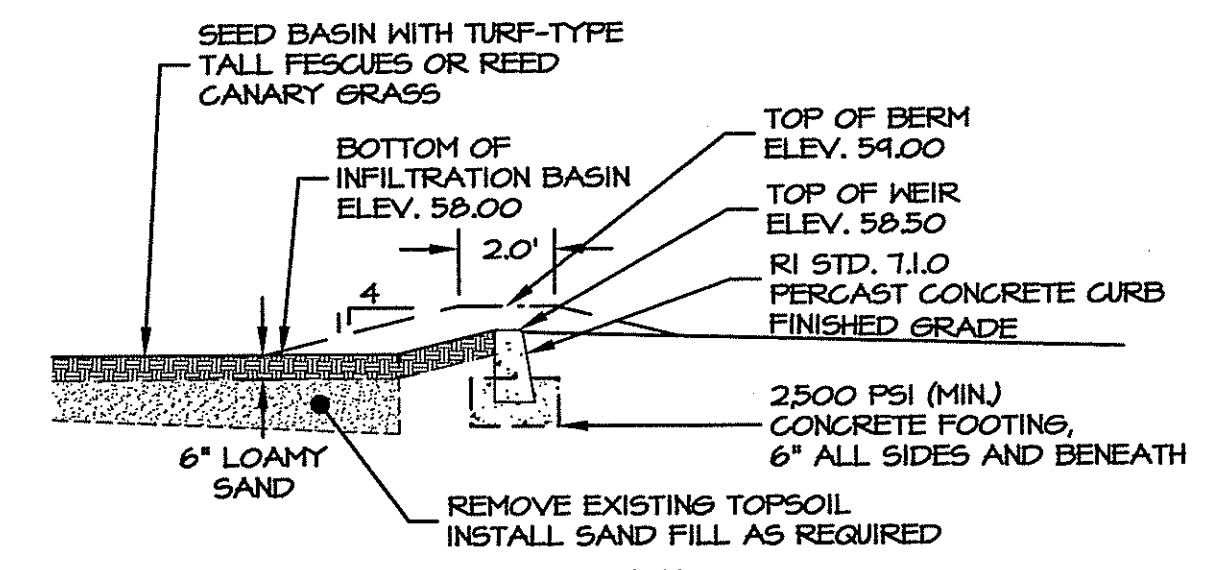

DETAIL WEIR / INFILTRATION BASIN SECTION
SCALE 1"=4"

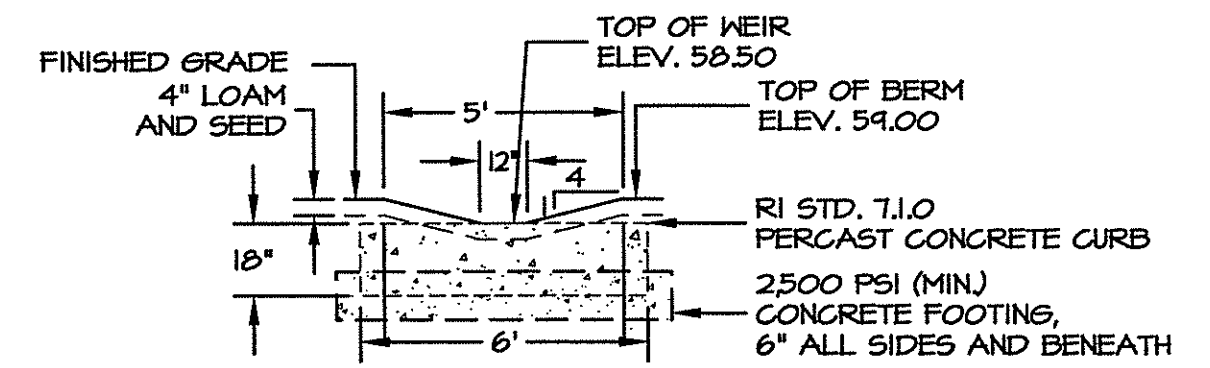

DETAIL - WEIR PROFILE
SCALE 1"=4"

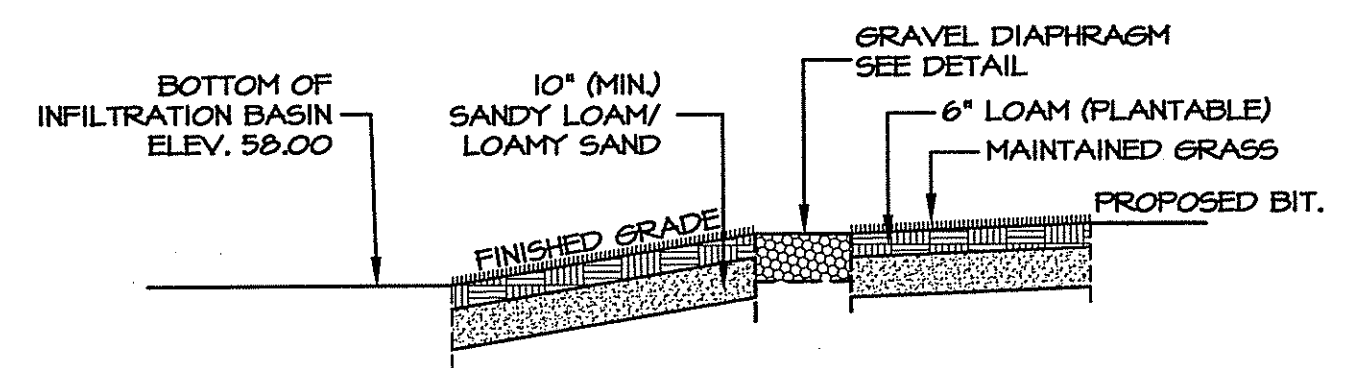

DETAIL GRASSED PRETREATMENT AREA
SCALE 1"=4"

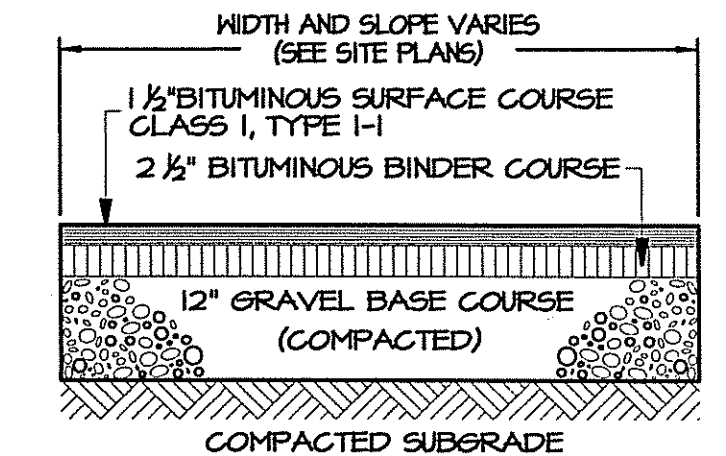

NOTES:

- 1) ALL PAVEMENT, GRAVEL AND GRANULAR FILL TO CONFORM WITH RHODE ISLAND DEPARTMENT OF TRANSPORTATION STANDARD SPECIFICATIONS FOR ROAD AND BRIDGE CONSTRUCTION
- 2) ALL LOAM, TOPSOIL, SUBSOIL, ROOTS, ROCK OR ANY OTHER UNSUITABLE MATERIALS SHALL BE REMOVED FROM WITHIN OF LIMITS OF PAVEMENT. INSTALL CLEAN, GRANULAR FILL PLACED IN 12" MAXIMUM LIFTS AND COMPACTED TO 95% OF MAXIMUM DRY DENSITY.

BITUMINOUS CONCRETE PAVEMENT DETAIL
NOT TO SCALE

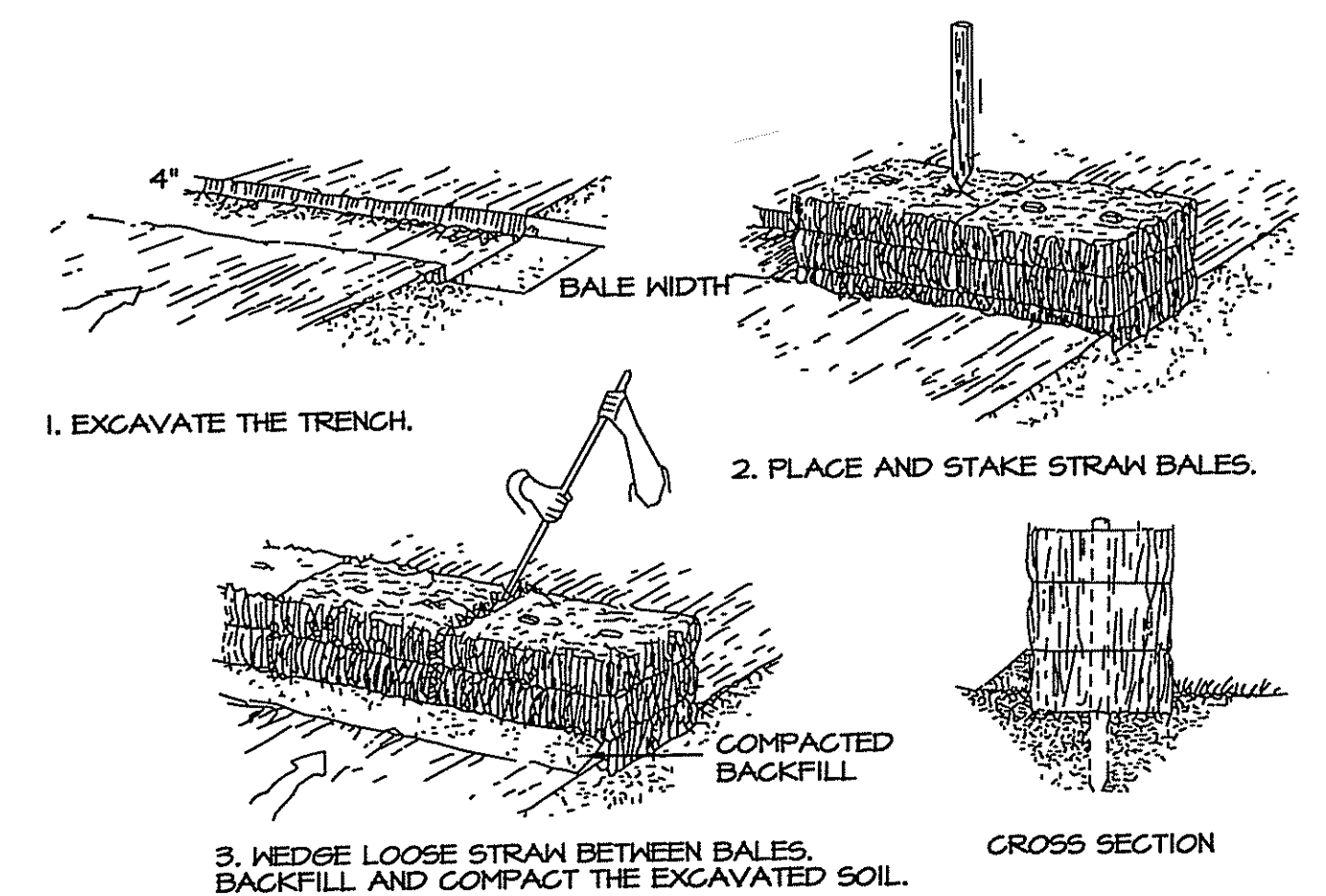

HAY BALE DETAIL

MAINTENANCE

1. CONTRACTOR IS RESPONSIBLE TO INSPECT BALES AFTER EACH STORM EVENT AND IMMEDIATELY REPAIR AND REPLACE ANY DAMAGED BALES.
2. CLEANOUT OF ACCUMULATED SEDIMENT BEHIND BALES IS MANDATORY IF ONE-HALF OF THE ORIGINAL HEIGHT OF THE BALES IS FILLED WITH SEDIMENT.
3. STOCKPILE AND KEEP DRY AT LEAST 10 HAY BALES FOR EMERGENCY PURPOSES, REPAIRS AND REPLACEMENTS.
4. HAY BALES SHALL BE PLACED IN A SINGLE ROW (MINIMUM), LENGTHWISE ON THE CONTOUR, WITH ENDS OF ADJACENT BALES TIGHTLY ABUTTING ONE ANOTHER.
5. ALL BALES SHALL BE EITHER WIRE OR STRING TIED. BALES SHALL BE INSTALLED SO THAT BINDINGS ARE ORIENTED AROUND THE SIDES RATHER THAN ALONG TOPS OR BOTTOMS TO PREVENT DETERIORATION OF THE BINDINGS.
6. THE GAPS BETWEEN BALES SHALL BE CHINKED (FILLED) WITH WEDGINGS) WITH STRAW TO PREVENT WATER FROM FLOWING FREELY BETWEEN THE BALES.
7. IN SLOPING CONDITIONS WHERE SURFACE FLOW FOLLOWS THE BALE LINE, PERPENDICULAR BALE CHECKS SHALL BE INSTALLED AS REQUIRED (100' MAX).

EROSION AND SEDIMENTATION CONTROL NOTES

1. APPROPRIATE PRECAUTIONS SHALL BE TAKEN TO PREVENT THE TRACKING OF SOIL FROM CONSTRUCTION EQUIPMENT ONTO PAVED ROADWAYS, DRIVEWAYS, AND PARKING AREAS LOCATED BEYOND WORK LIMITS.
2. ALL PERIMETER EROSION AND SEDIMENTATION CONTROLS MUST BE INSTALLED PRIOR TO THE COMMENCEMENT OF EARTHWORK.
3. NO WORK IS TO OCCUR ON THE WETLAND SIDE OF THE PERIMETER CONTROLS. ALL PERIMETER CONTROLS SERVE AS THE LIMIT OF CLEARING, SURFACE DISTURBANCE, AND WORK IN GENERAL. ACCORDINGLY, NO STONES, BRUSH, CONSTRUCTION DEBRIS, LITTER, OR OTHER MATERIALS ARE TO BE DEPOSITED ON THE WETLAND SIDE OF THE PERIMETER EROSION AND SEDIMENTATION CONTROLS AND/OR LIMITS OF DISTURBANCE.
4. THE ENGINEER/BIOLOGIST RESERVES THE RIGHT TO SPECIFY ADDITIONAL CONTROLS AS CONDITIONS MAY WARRANT. ACCESSIBLE RESERVES OF HAY BALES AND STAKES ARE TO BE MAINTAINED ON SITE FOR ROUTINE MAINTENANCE AND IN THE EVENT OF UNANTICIPATED PROBLEMS REQUIRING EMERGENCY RESPONSE.
5. HAY BALES SHALL BE INSTALLED IN ACCORDANCE WITH THE DETAILS PROVIDED. ALL HAY BALES ARE TO BE DOUBLE STAKED AND INSTALLED WITH THE LOWER 4 INCHES BURIED AND BACKFILLED WITH COMPACTED SOIL MATERIAL.
6. THE TOE OF FILL SLOPES IS TO REMAIN AT LEAST ONE FOOT INSIDE OF EROSION CONTROLS. UNDER NO CIRCUMSTANCE SHALL THE CONTROLS BE COVERED WITH FILL MATERIAL. ANY FILL MATERIAL THAT IS PLACED AGAINST THE CONTROLS SHALL BE IMMEDIATELY REMOVED.
7. NO MATERIALS STOCKPILES OR CONSTRUCTION VEHICLES ARE TO BE STORED WITHIN THE 100-FOOT RIVERBANK WETLAND.
8. ALL DISTURBED SOILS NOT DESIGNATED FOR OTHER SURFACE TREATMENT ARE TO BE LOAMED AND SEEDING IMMEDIATELY FOLLOWING FINAL GRADING. PLANTABLE LOAM SHALL BE APPLIED AT A DEPTH OF SIX INCHES, UNLESS NOTED OTHERWISE.
9. FOR AREAS TO BE HYDROSEED, THE HYDROSEED MIX SHALL CONTAIN AN APPROPRIATE TACIFYING AGENT. STRAW MULCH SHALL BE SPREAD AFTER SEEDING AS NEEDED AT THE DISCRETION OF THE ENGINEER/BIOLOGIST.
10. ALL EROSION AND SEDIMENTATION CONTROLS MUST BE PROPERLY MAINTAINED, AND THE STRICTEST PRECAUTION MUST BE TAKEN TO AVOID AND MINIMIZE THE TRANSPORT OF SEDIMENTS TO WETLAND AREAS AND CLOSED DRAINAGE SYSTEMS THROUGHOUT ALL PHASES OF CONSTRUCTION. CONTROLS ARE TO BE INSPECTED WEEKLY AND IMMEDIATELY FOLLOWING PRECIPITATION EVENTS RESULTING IN RAINFALL OF >0.25". THE CONTRACTOR IS RESPONSIBLE FOR PROPER EROSION CONTROL ON AND OFF SITE AND SHALL UTILIZE EROSION CONTROL MEASURES WHERE NEEDED, REGARDLESS OF WHETHER THE CONTROLS ARE SPECIFIED ON THESE SITE PLANS.
11. EROSION AND SEDIMENTATION CONTROLS ARE TO REMAIN IN PLACE UNTIL ALL SOILS HAVE STABILIZED AND SHALL BE REMOVED ONLY UPON AUTHORIZATION FROM THE ENGINEER/BIOLOGIST.

PARKING LOT MAINTENANCE:

1. PARKING AREA AND ACCESS WAY SHALL BE SHEPT CLEAN OF DEBRIS AND ACCUMULATION OF SILT OR SAND ON A REGULAR BASIS. A SPRING AND FALL CLEANING SCHEDULE IS RECOMMENDED.
2. ANY VISIBLY-ERODED AREAS SHALL BE REPAIRED IMMEDIATELY.
3. THE GRAVEL DIAPHRAGM SHOULD BE INSPECTED ON A SEMI-ANNUAL BASIS AND AFTER MAJOR STORM EVENTS. A SPRING AND FALL INSPECTION SCHEDULE IS RECOMMENDED. COARSE SEDIMENTS AND DEBRIS SHALL BE REMOVED AS NEEDED. IF FINER SEDIMENTS ACCUMULATE WITHIN THE UPPER STONE LAYER, THE STONE SHALL BE REMOVED AND REPLACED WITH CLEAN STONE FREE OF FINE PARTICLES.
4. THE GRASSED PRETREATMENT AREA SHOULD BE INSPECTED ON A SEMI-ANNUAL BASIS AND AFTER MAJOR STORM EVENTS. A SPRING AND FALL INSPECTION SCHEDULE IS RECOMMENDED. COARSE SEDIMENTS AND DEBRIS SHALL BE REMOVED AS NEEDED. THE GRASSED AREA SHOULD BE MOWED SEVERAL TIMES DURING THE GROWING SEASON, LEAVING A MINIMUM OF 3 INCHES IN HEIGHT, TO ENCOURAGE DENSE GRASS GROWTH AND DISCOURAGE WEEDS.

INFILTRATION BASIN MAINTENANCE:

1. INSPECT BASIN FOR SLOPE STABILITY AND PROPER FUNCTION QUARTERLY AND AFTER MAJOR STORM EVENTS THE FIRST YEAR, AND SEMIANNUALLY THEREAFTER. REMOVE LITTER AND DEBRIS ON AN AS-NEEDED BASIS. ANY VISIBLY-ERODED AREAS SHALL BE REPAIRED IMMEDIATELY.
2. MOW GRASSED AREAS OF BASIN FLOOR AND SIDE SLOPES SHALL BE DONE AT LEAST ONCE PER GROWING SEASON, PREFERABLY AFTER MID AUGUST. REMOVE GRASS CLIPPINGS AND REPAIR ANY BARE SPOTS.
3. CONDUCT AUTUMN RAKING IN GRASSED AREAS ON THE BASIN FLOOR AND SIDE SLOPES AS REQUIRED TO REMOVE ACCUMULATED LEAVES.
4. TILLING OF THE BASIN FLOOR SHOULD BE DONE WHEN THERE IS AN OBVIOUS LOSS OF INFILTRATION, ESPECIALLY IF STANDING WATER IS PRESENT FOR MORE THAN 24 HOURS AFTER A RAINFALL EVENT. TILLING CAN BE ACCOMPLISHED WITH A ROTARY TILLER OR DISC HARROW, AND SAND CAN BE ADDED TO RESTORE INFILTRATION CAPACITY. RESEED THE DISTURBED AREAS AND MAINTAIN UNTIL THE VEGETATION IS WELL ESTABLISHED.
5. IF TILLING THE BOTTOM OF THE BASIN FAILS TO IMPROVE INFILTRATION, REMOVE AT LEAST FOUR INCHES OF SOIL FROM THE BOTTOM OF THE BASIN AND REPLACE WITH LOAMY SAND. RESEED THE DISTURBED AREAS AND MAINTAIN UNTIL THE VEGETATION IS WELL ESTABLISHED.

DEPARTMENT OF ENVIRONMENTAL MANAGEMENT
OFFICE OF WATER RESOURCES
FRESHWATER WETLANDS PROGRAM
APPROVED WITH CONDITIONS
AS SPECIFIED IN THE LETTER OF APPROVAL
DATED Aug. 5, 2009 FILE # 09-0159
NO CHANGES ALLOWED WITHOUT PRIOR APPROVAL.
APPROVED PLANS MUST BE AT CONSTRUCTION SITE.

Emmanuel D. Wenczek

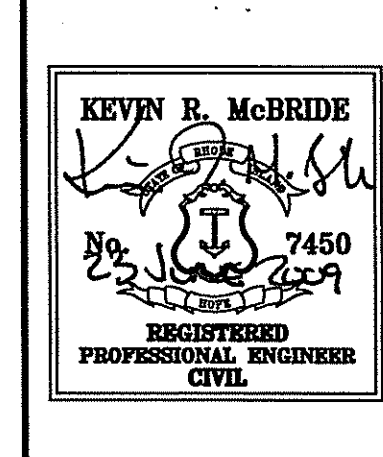
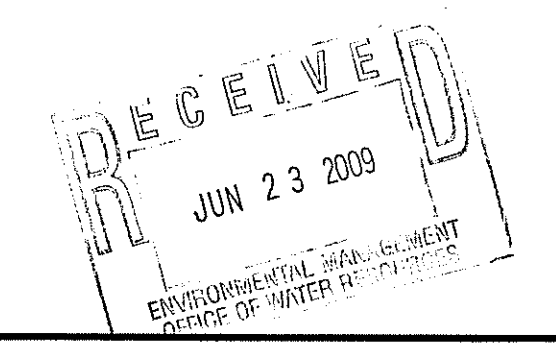

SITE DETAILS AND NOTES
CUMBERLAND HOUSING
ONE MENDON ROAD
CUMBERLAND, RHODE ISLAND

CAPUTO AND WICK LTD. DATE: JUNE 2009
1150 PAWTUCKET AVE. SHEET: 2 of 2
RUMFORD, R.I. 02916
401-434-8880

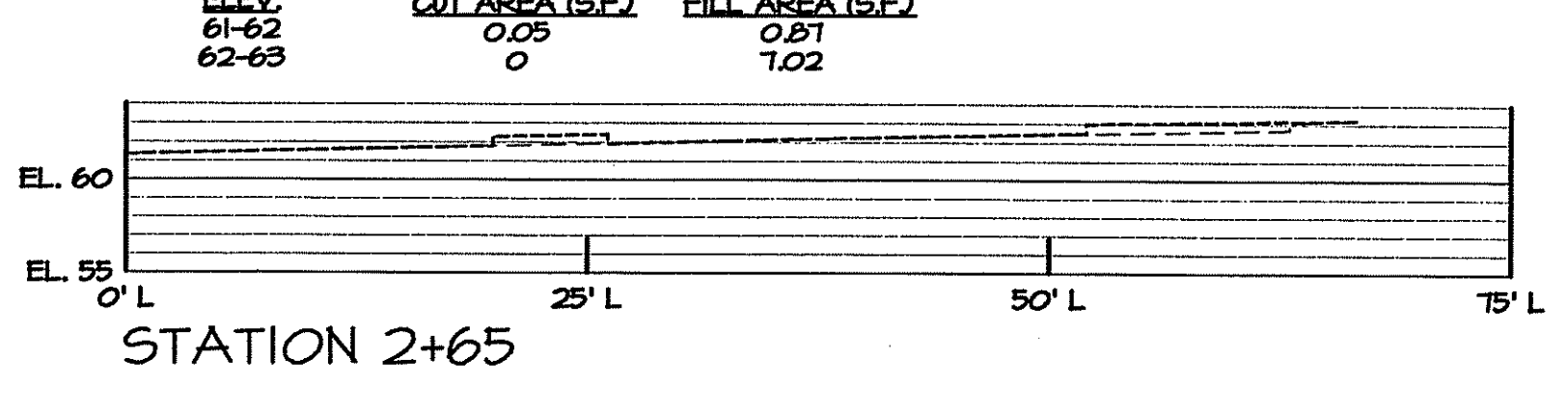
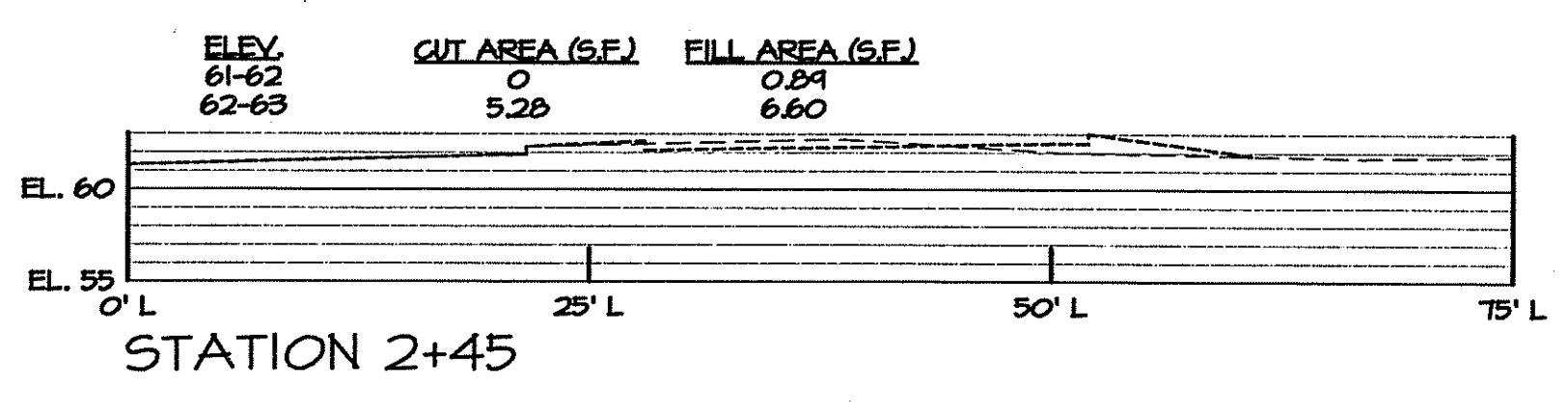
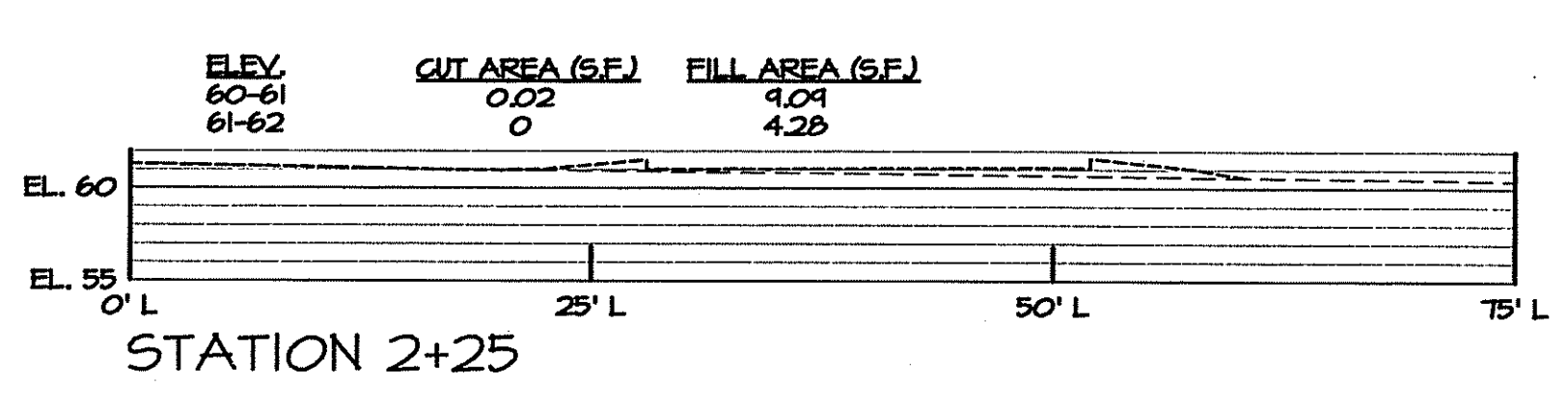
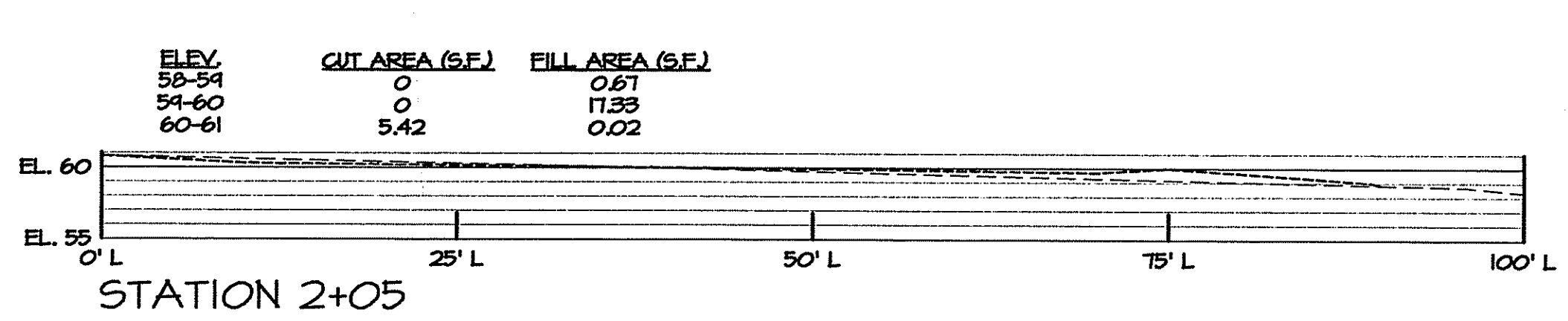
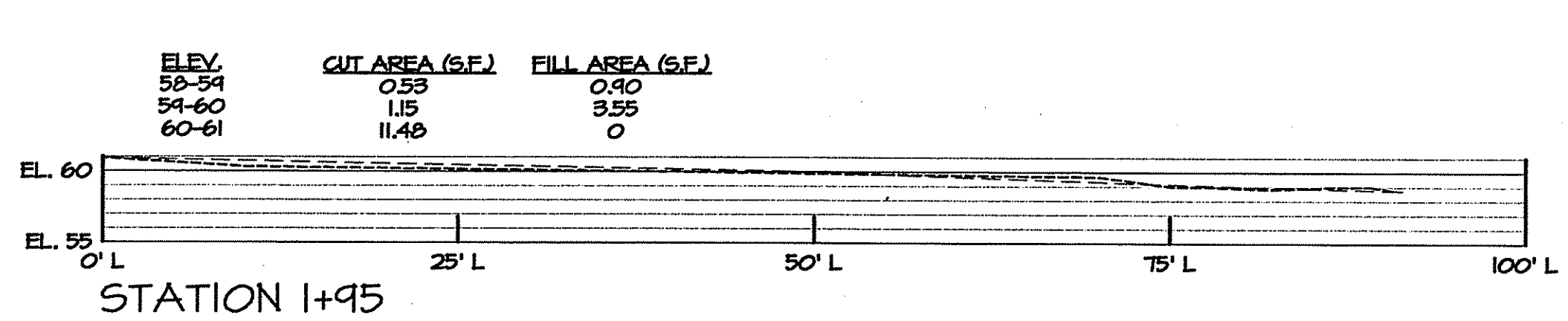
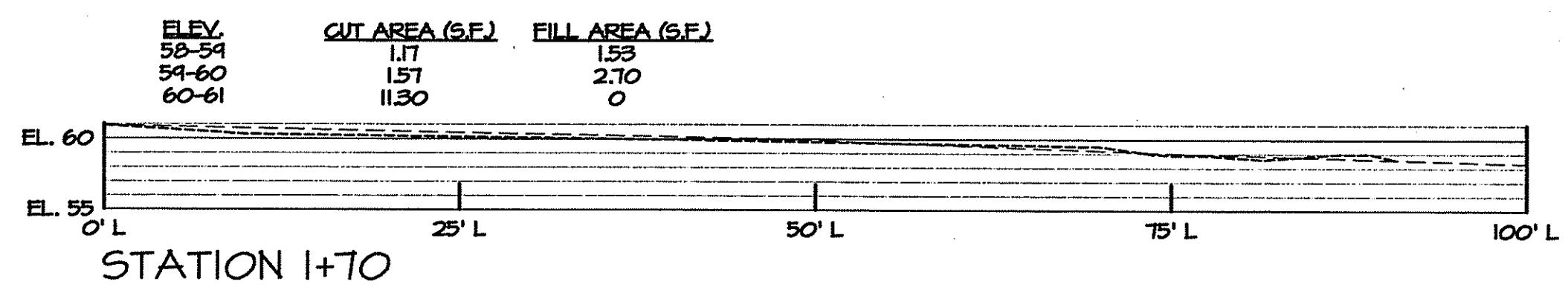
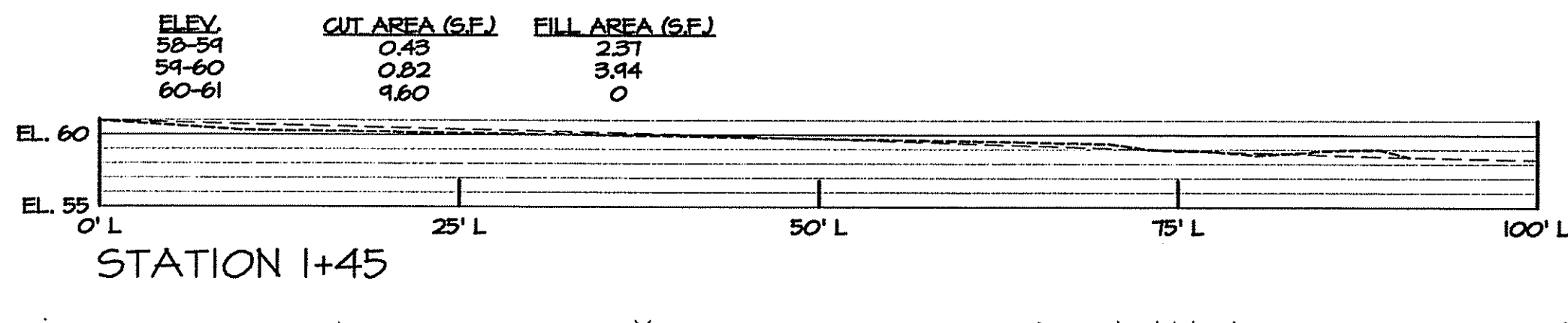
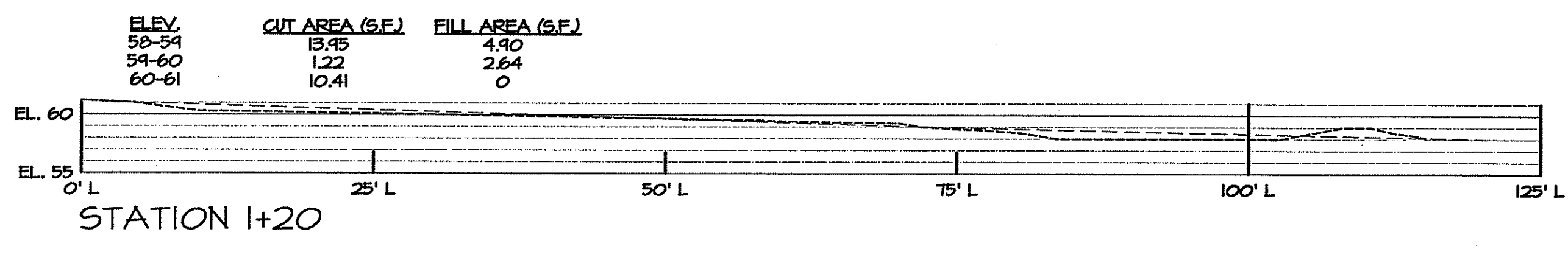
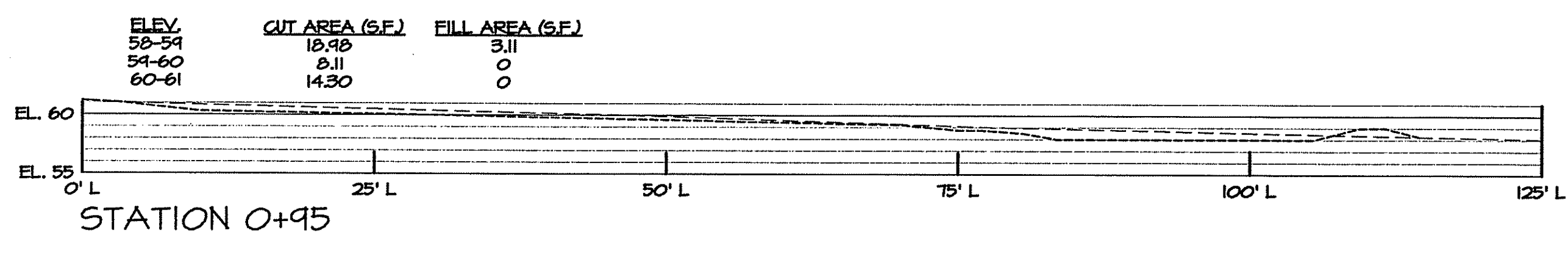
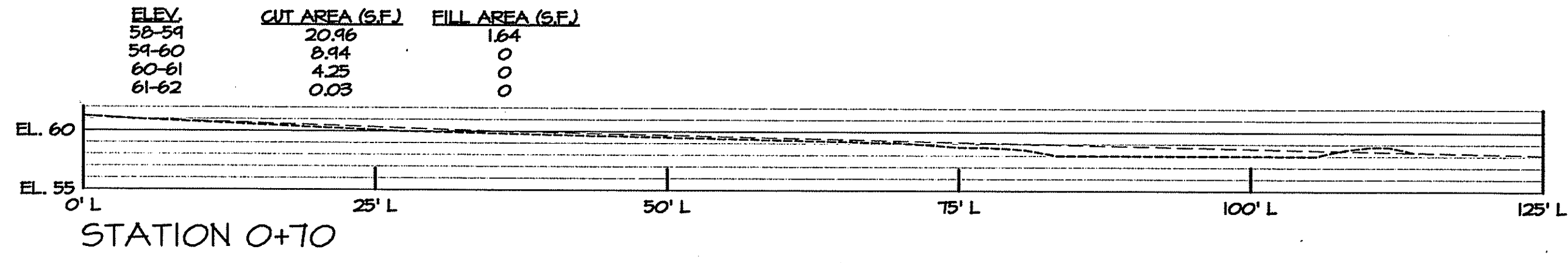
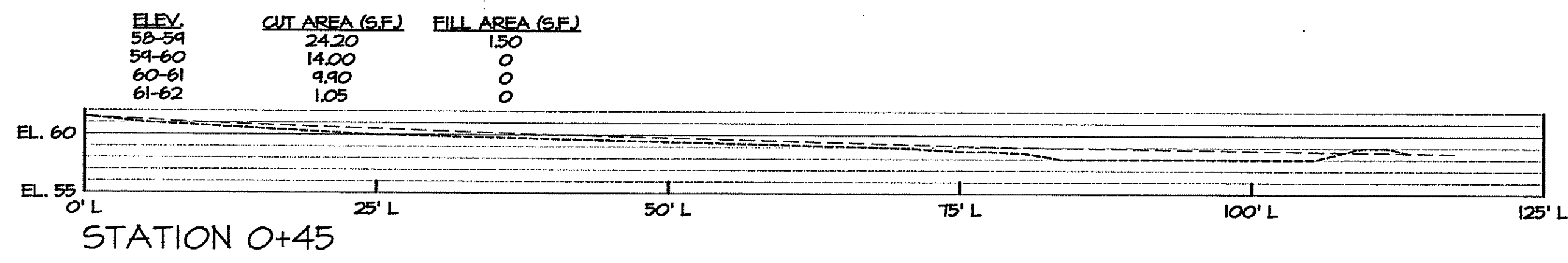
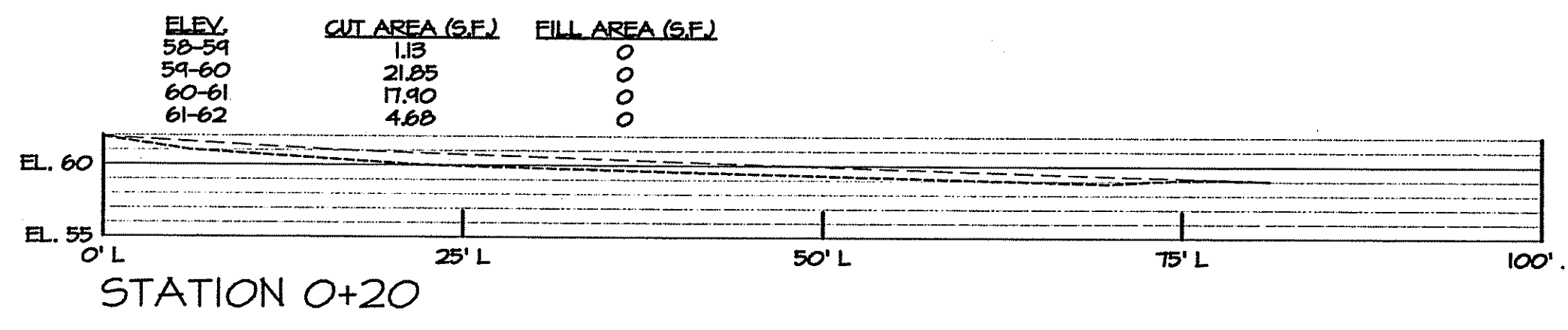

TABLE 1
Volume Calculations of Floodplain Cuts and Fills by Elevation and Station
Cumberland Housing, Cumberland, RI

Elevation (ft)	Plan Station*	Proposed Cut		Proposed Fill		
		Area (ft²)	Volume (ft³)	Area (ft²)	Volume (ft³)	
58-59	0+00	0	0	0	0	
	0+20	1.13	11.3	0	0	
	0+45	24.20	316.6	1.45	18.1	
	0+70	20.96	564.5	1.64	38.6	
	0+95	18.98	499.3	3.11	59.4	
	1+20	13.95	411.6	4.90	100.1	
	1+45	0.43	179.8	2.37	90.9	
	1+70	1.17	20.0	1.53	48.8	
	1+95	0.53	21.2	0.90	30.4	
	2+05	0	2.6	0.67	7.85	
2+25	0	0	0	6.7		
	Total		2026.9		400.9	
59-60	0+00	0	218.5	0	0	
	0+20	21.85	448.1	0	0	
	0+45	14.00	286.8	0	0	
	0+70	8.94	213.1	0	0	
	0+95	8.11	116.6	0	0	
	1+20	1.22	25.5	2.64	33.0	
	1+45	0.82	29.9	3.94	83.0	
	1+70	1.57	34.0	2.70	78.1	
	1+95	1.15	5.7	3.55	104.2	
	2+05	0	0	17.30	173.0	
	2+25	0	0	0	173.0	
		Total		1378.2		553.5
	60-61	0+00	0	173.0	0	0
0+20		17.90	347.5	0	0	
0+45		9.90	176.9	0	0	
0+70		4.25	231.9	0	0	
0+95		14.30	308.9	0	0	
1+20		10.41	250.1	0	0	
1+45		9.60	261.2	0	0	
1+70		11.30	284.8	0	0	
1+95		11.48	84.5	0	0.1	
2+05		5.42	54.4	0.02	91.1	
2+25		0.02	0.2	9.09	90.9	
2+45		0	0	0	182.1	
		Total		2179.4		182.1
61-62	0+00	0	46.8	0	0	
	0+20	4.68	71.6	0	0	
	0+45	1.05	13.5	0	0	
	0+70	0.03	0.4	0	0	
	0+95	0	0	0	0	
	2+05	0	0	0	42.8	
	2+25	0	0	4.28	51.7	
	2+45	0	0	0.89	17.6	
62-63	2+65	0.05	0.5	0.87	8.7	
	2+85	0	0.5	0	0	
		Total		133.3		120.8
	62-63	2+25	0	52.8	0	66.0
		2+45	5.28	52.8	6.60	136.2
2+65		0	0	7.02	70.2	
2+85		0	0	0	0	
	Total		105.6		272.4	

TABLE 2
Comprehensive Summary of Floodplain Cuts and Fills by Elevation
Cumberland Housing, Cumberland, RI

Elevation	Proposed Cuts (ft²)	Proposed Fills (ft²)	Net Change (ft²)
58-59	2026.9	400.9	1626.0 (cut)
59-60	1378.2	553.5	824.7 (cut)
60-61	2179.4	182.1	1997.3 (cut)
61-62	133.3	120.8	12.5 (cut)
62-63	105.6	272.4	166.8 (fill)

DEPARTMENT OF ENVIRONMENTAL MANAGEMENT
OFFICE OF WATER RESOURCES
FRESHWATER WETLANDS PROGRAM
APPROVED WITH CONDITIONS
AS SPECIFIED IN THE LETTER OF APPROVAL
DATED Aug. 5, 2009 FILE # 09-0159
NO CHANGES ALLOWED WITHOUT PRIOR APPROVAL.
APPROVED PLANS MUST BE AT CONSTRUCTION SITE.

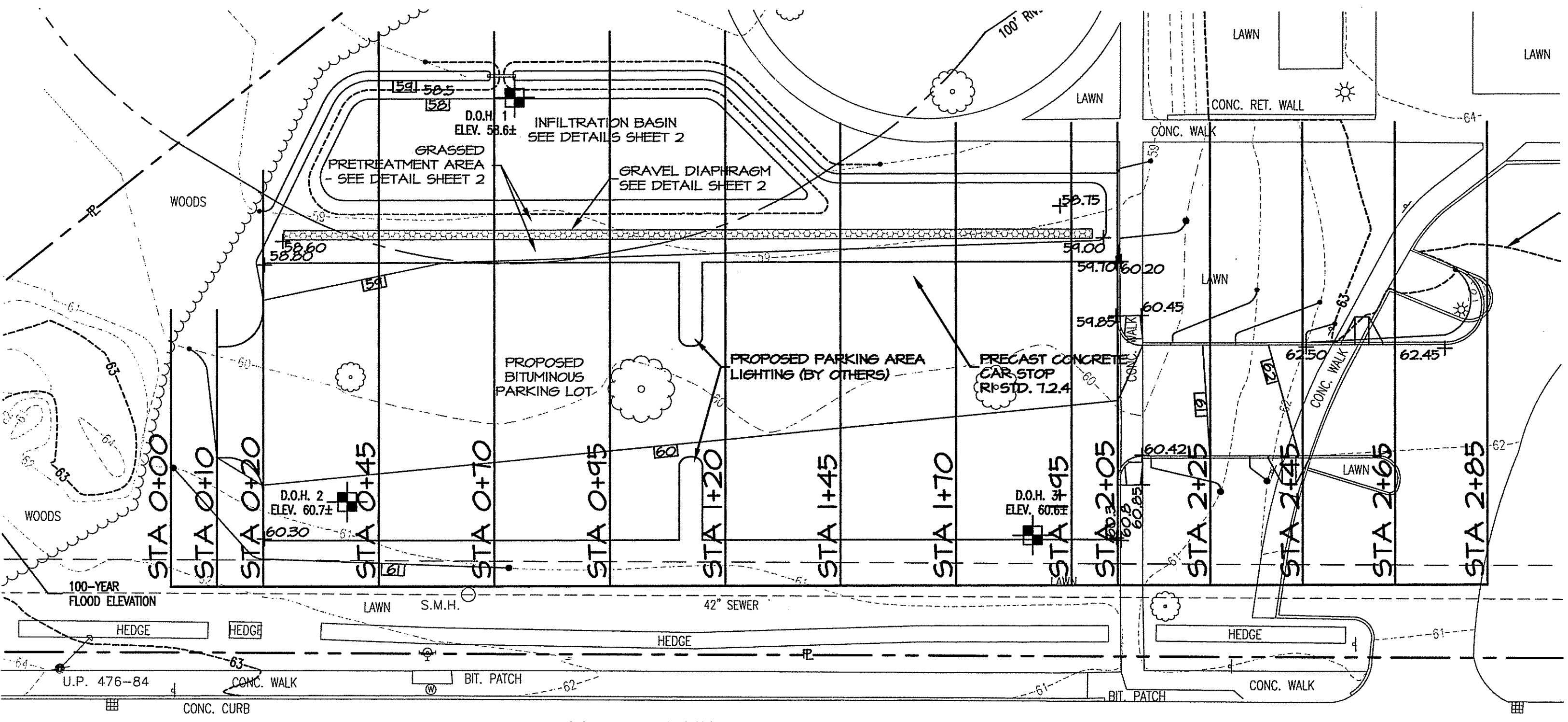

FLOOD PLAIN SECTIONS
SCALE: 1"=20'

RECEIVED
JUN 23 2009

**100-YEAR FLOOD PLAN SECTION
CUMBERLAND HOUSING
ONE MENDON ROAD
CUMBERLAND, RHODE ISLAND**

CAPUTO AND WICK LTD.
1150 PAWTUCKET AVE.
RUMFORD, R.I. 02916
401-434-8880

DATE: JUNE 2009
SHEET: FS-1