

EROSION CONTROL AND SOIL STABILIZATION PROGRAM

1. Denuded slopes shall not be left exposed for excessive periods of time such as the inactive winter seasons.
2. Temporary treatments shall consist of a hay, straw, fiber mulch or protective cover such as a mat or fiber lining (burlap, jute, fiberglass netting, excelsior blankets). They shall be incorporated into the work as warranted or as ordered by the engineer.
3. Hay or straw applications should be in the amount of 2000 lbs/acre.
4. All haybales or temporary protection shall remain in place until an acceptable stand of grass or approved ground cover is established.
5. The topsoil shall have a sandy loam texture relatively free of subsoil material, stones, roots, lumps of soil, tree limbs, trash or construction debris and shall conform with RI Standard Spec M.20.01.
6. The seed mix shall be inoculated within 24 hrs before mixing and planting with appropriate inoculum for each variety.
7. The design mix utilized in all disturbed areas to be seeded shall be comprised of the following:

Type	% by weight
creeping red fescue	70
astoria bentgrass	5
birdfoot trefoil	15
perennial ryegrass	10
- Application rate 100 lbs / acre, liming and fertilizing as required to compliment or upgrade existing conditions.
8. The contractor must repair and/or reseed any areas that do not develop within the period of one year, and shall do so at no additional expense to the client.
9. The normal acceptable seasonal seeding dates are April 1 - October 15
10. Stabilization as described above shall be achieved within 15 days of final grading.
11. Stockpiles of top soil and earth shall not be located near waterways. They shall have side slopes no greater than 30% shall be seeded and or stabilized and shall be completely encircled with staked hay bales and or silt fence. see detail.
12. On both steep and long slopes, consideration should be given to "crimping" or "tracking" to tack down mulch applications.
13. Trees to be retained shall be fenced or roped off to protect them from construction equipment at the drip line.
14. All proposed plantings must be accomplished as early as possible upon completion of grading and construction.
15. All proposed plantings must be maintained by the property owner to ensure survival.
16. All disturbed areas must be seeded or planted within the construction season.
17. Temporary seeding must be done within one month after disturbance.
18. All disturbed areas must be permanently seeded or planted before November 1 if not they must be temporarily seeded.
19. The contractor should initiate appropriate vegetative practices on all disturbed areas as soon as possible but not more than 14 days after the construction activity in that area has temporarily or permanently ceased, unless the activity is to resume within 21 days.

- SEDIMENTATION CONTROL PROGRAM:**
1. Extreme care shall be exercised so as to prevent any unsuitable material from entering downstream water-courses and stormwater systems.
 2. During construction the contractor shall be responsible for maintaining drainage and runoff flow during precipitation.
 3. Sedimentation control devices shall be inspected and maintained immediately after storm events.
 4. Removed sediments shall not be placed in the path of existing, new or proposed watercourses or areas subject to storm flowage.
 5. Additional haybales, sandbags or silt fence shall be located as warranted or as directed by the engineer.
 6. Sediment traps shall be provided at all drainage structures during construction.
 7. Erosion and sedimentation controls shall be installed at the site prior to the start of construction and be properly maintained until all areas are stabilized including:
 - a) An installation of a continuous line of staked haybales or silt fence in all locations shown on the site plan and where otherwise necessary to prevent sediments from entering downstream water-courses and stormwater systems.
 - b) All disturbed areas are to be permanently stabilized with approved ground cover prior to the completion of the project. Areas exposed for extended periods are to be completely covered with cast hay mulch.
 - c) Catch basins will be protected with haybale filters throughout the construction period and until all disturbed areas are thoroughly stabilized.
 - d) Outfalls are to be protected by haybale filters until disturbed areas are permanently stabilized with approved ground cover.
 - e) All control measures will be maintained in effective condition throughout the construction period. The limits of all clearing, grading and disturbance shall be kept to a minimum within the proposed area of disturbance.
 8. All areas outside of the limit of disturbance shall remain totally undisturbed.
 9. As stated in Sec F.A.2/3 of the RI Soil Erosion and Sediment Control Handbook, sediment deposits should be removed when they reach one-half the height of the haybale and/or silt fence.

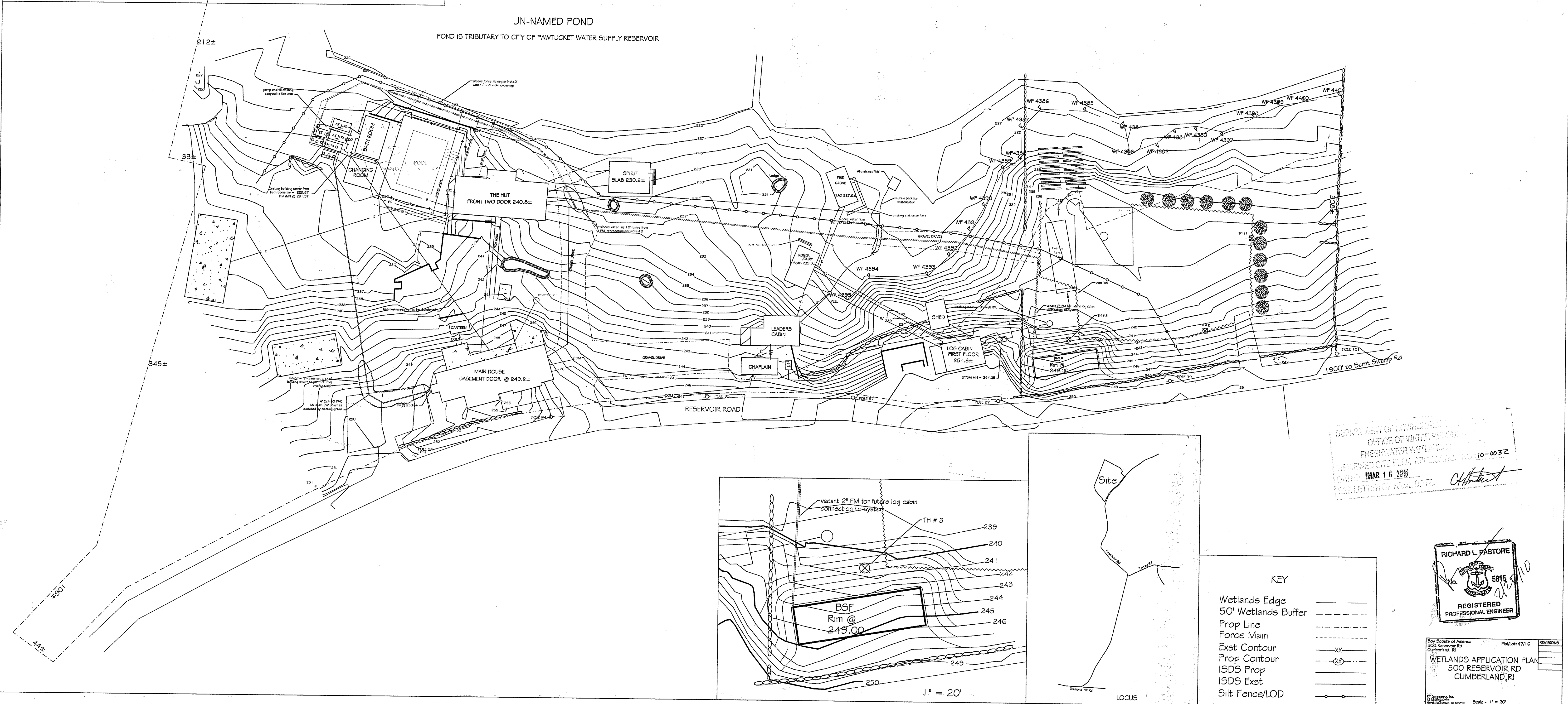

DEPARTMENT OF ENVIRONMENT & PLANNING
OFFICE OF WATER RESOURCES
FRESHWATER WETLANDS
REVIEWED SITE PLAN APPLICATION NO. 10-2032
DATED **MAR 16 2010**
SEE LETTER OF SCALE DATE. *Chatt*

RICHARD L. PASTORE
No. 5815
REGISTERED PROFESSIONAL ENGINEER

KEY

Wetlands Edge	———
50' Wetlands Buffer	- - - - -
Prop Line	—————
Force Main	—————
Exst Contour	- - - - -
Prop Contour	—————
ISDS Prop	—————
ISDS Exst	—————
Silt Fence/LOD	—————

Boy Scouts of America
500 Reservoir Rd
Cumberland, RI
WETLANDS APPLICATION PLAN
500 RESERVOIR RD
CUMBERLAND, RI
Scale - 1" = 20'
Sheet - 1a
1/26/09

212±

UN-NAMED POND

POND IS TRIBUTARY TO CITY OF PAWTUCKET WATER SUPPLY RESERVOIR

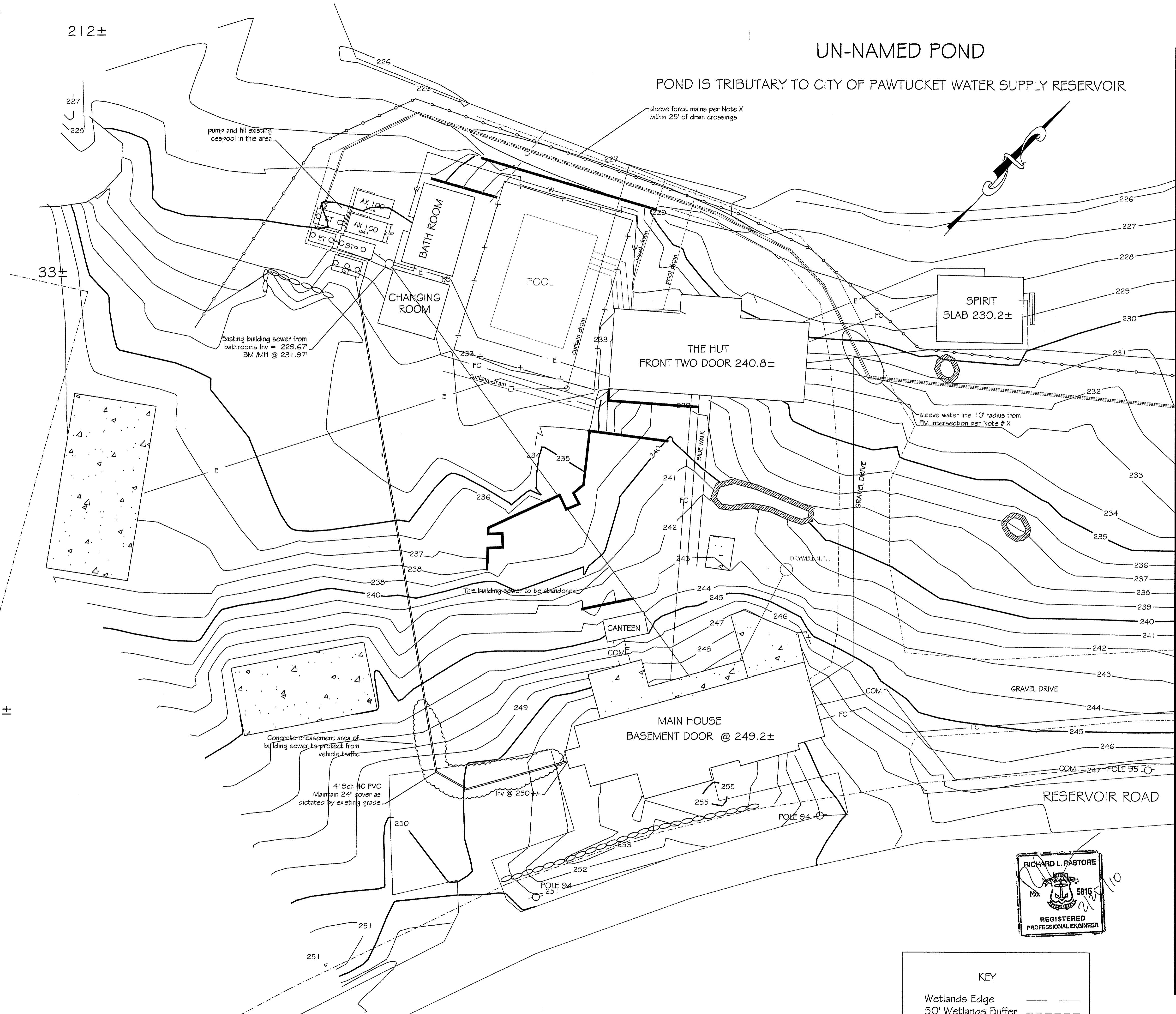

MATCH LINE

MATCH LINE

345±

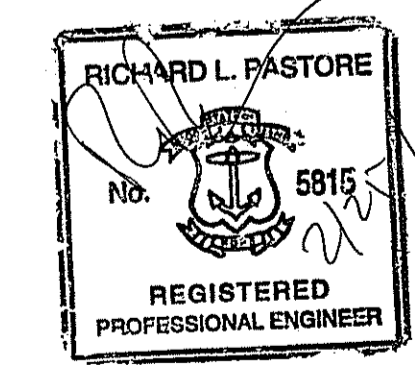

KEY	
Wetlands Edge	---
50' Wetlands Buffer	----
Prop Line	----
Force Main	----
Ext Contour	XX
Prop Contour	XX
ISDS Prop	----
ISDS Ext	----
Silt Fence/LOD	○-○

DEPARTMENT OF ENVIRONMENTAL MANAGEMENT
 OFFICE OF WATER RESOURCES
 FRESHWATER WETLANDS PROGRAM
 REVIEWED SITE PLAN APPLICATION NO.: 10-0052
 DATED MAR 16 2010
 SEE LETTER OF SAME DATE.

Boy Scouts of America
 500 Reservoir Rd
 Cumberland, RI
 FlatLot: 47116
 REVISIONS

WETLANDS APPLICATION PLAN
 500 RESERVOIR RD
 CUMBERLAND, RI

1" = 20'
 1/25/09

UN-NAMED POND

POND IS TRIBUTARY TO CITY OF PAWTUCKET WATER SUPPLY RESERVOIR

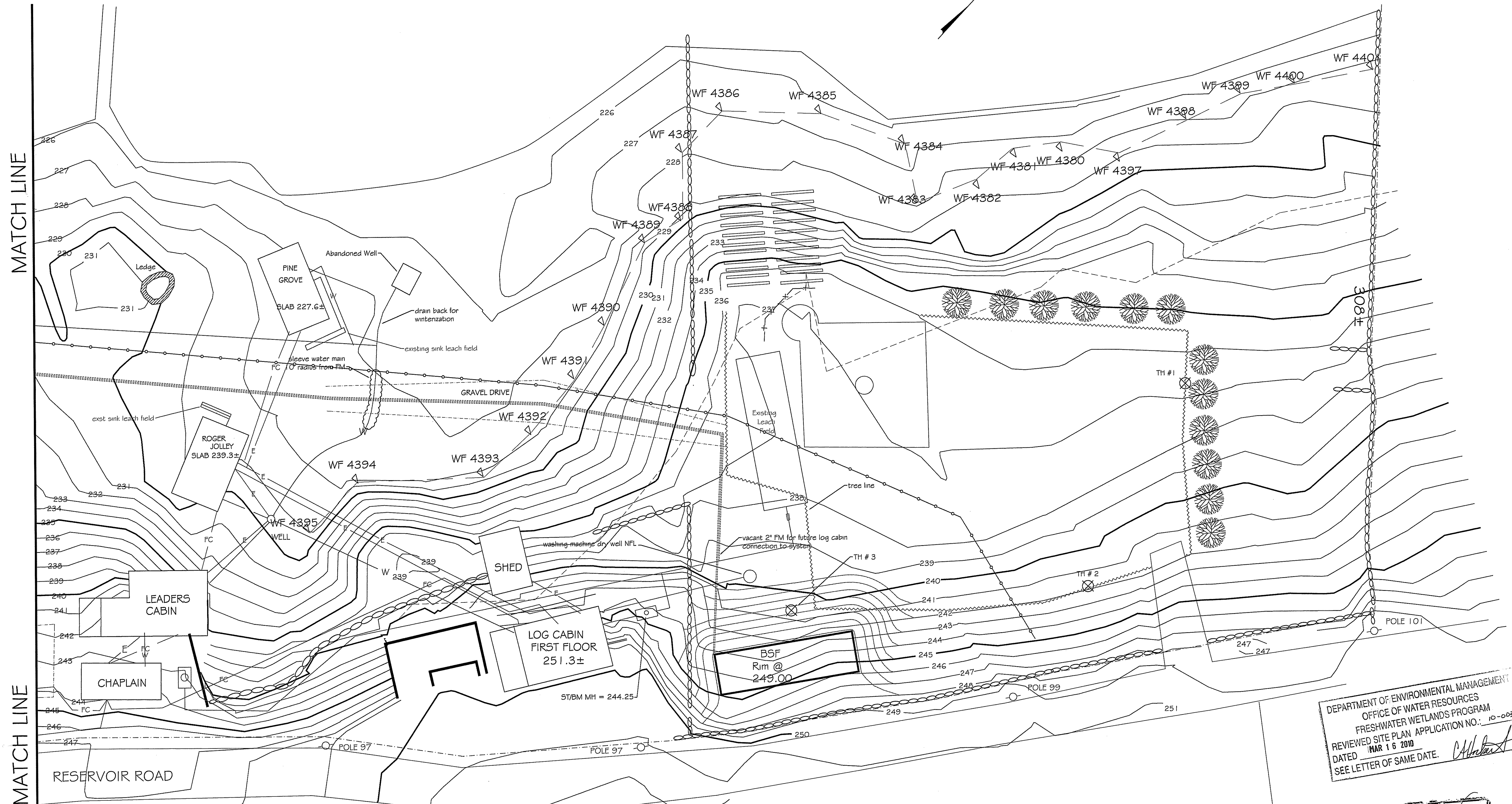
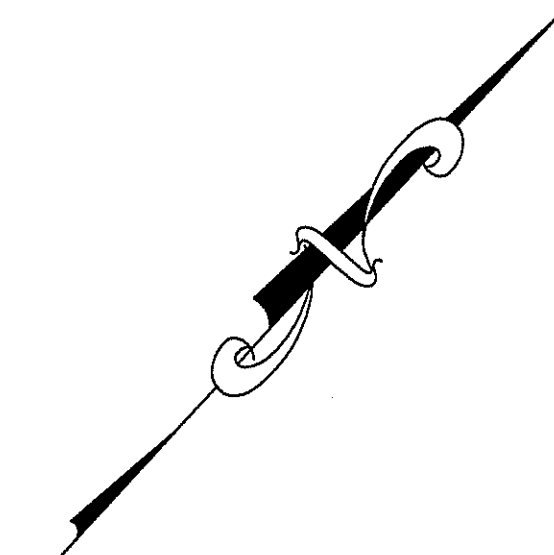

MATCH LINE

MATCH LINE

DEPARTMENT OF ENVIRONMENTAL MANAGEMENT
 OFFICE OF WATER RESOURCES
 FRESHWATER WETLANDS PROGRAM
 REVIEWED SITE PLAN APPLICATION NO. 10-0092
 DATED MAR 16 2010
 SEE LETTER OF SAME DATE. *Richard L. Pastore*



KEY	
Wetlands Edge	———
50' Wetlands Buffer	- - - - -
Prop Line	—————
Force Main	—————
Exst Contour	—XX—
Prop Contour	—(XX)—
ISDS Prop	—————
ISDS Exst	—————
Silt Fence/LOD	—o—o—

Boy Scouts of America
 500 Reservoir Rd
 Cumberland, RI
 WETLANDS APPLICATION PLAN
 500 RESERVOIR RD
 CUMBERLAND, RI
 Scale - 1" = 20'
 Sheet - 1a