

## GENERAL:

THE SUBJECT PROPERTY IS A DEVELOPED RESIDENTIAL PROPERTY WITH A SINGLE FAMILY 2-STORY DWELLING. THE DWELLING IS LOCATED APPROXIMATELY 45' FROM 100 ACRE POND. THE DWELLING IS SERVICED BY AN OWTS THAT LOCATED TO THE SOUTH OF THE DWELLING, A PRIVATE DRINKING WATER WELL AND OVERHEAD ELECTRIC UTILITIES. THE AREA BETWEEN THE DWELLING AND THE POND IS MAINTAINED LAWN AREA WITH A BOULDER RETAINING WALL APPROXIMATELY 3' IN HEIGHT EXTENDING TO THE WATER. THE APPLICANT IS PROPOSING TO CONSTRUCT A RESIDENTIAL BOATING FACILITY CONSISTING OF A 6' x 15' SITTING AREA, 6' x 22' FIXED-PIER SECTION, AND A 10' x 12' FLOAT SECTION. THE FLOAT SHALL BE ACCESSED VIA A LADDER CONNECTED TO THE FIXED-PIER SECTION.

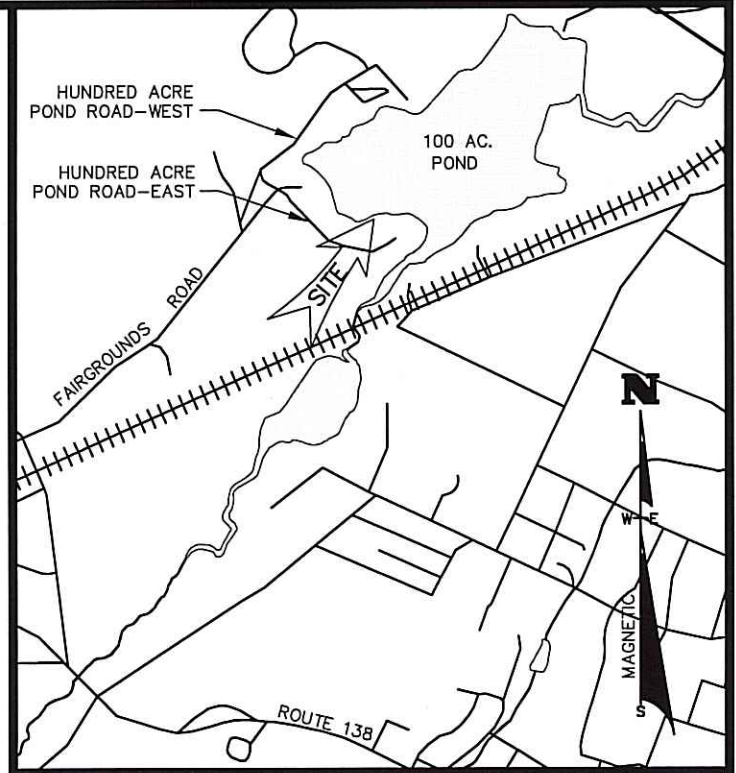

## UTILITIES:

THE LOCATION OF EXISTING UTILITIES SHOWN ON THIS PLAN ARE APPROXIMATE ONLY AND HAVE BEEN SHOWN USING THE BEST AVAILABLE DATA.

THE CONTRACTOR SHALL CONTACT 'DIG-SAFE' AND/OR OTHER APPROPRIATE UTILITY COMPANIES TO ASCERTAIN THE EXACT LOCATION OF THE RESPECTIVE UTILITY PRIOR TO CONSTRUCTION. UTILITIES INCLUDE BUT ARE NOT LIMITED TO GAS, ELECTRIC, WATER, TELEPHONE CABLE TV, ETC.

## DESIGN STANDARDS:

- RESIDENTIAL DOCK DESIGN IN ACCORDANCE WITH TABLE 3 - MINIMUM DESIGN CRITERIA RICRMP SECTION 300.4. FIXED STRUCTURES INCLUDING STAIRWAYS ARE CAPABLE OF SUPPORTING 40 PSF LIVE LOAD + 10 PSF DEAD LOAD.
- FLOATING STRUCTURE CAPABLE OF SUPPORTING A UNIFORM LIVE LOAD OF 20 PSF OR A CONCENTRATED LOAD OF 400 LBS.



## LOCATION PLAN

SCALE: 1" = 2000'

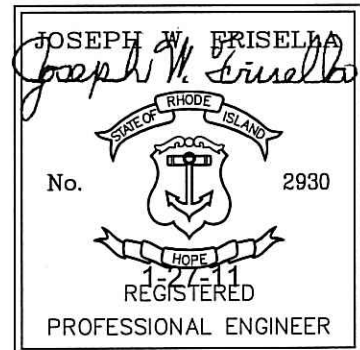

**FRISELLA  
ENGINEERING, INC.**

CIVIL AND ENVIRONMENTAL ENGINEERING  
LAND SURVEYING

23 ARNOLD STREET □ WAKEFIELD, RI  
PHONE (401) 783-5949 □ FAX (401) 783-5997  
www.frisella.com

DRAWING TITLED:  
**LOCUS MAP & GENERAL NOTES**

LOCATED ON:  
**LOT 14 OF ASSESSOR'S MAP: 14**

OWNED BY:  
**KENNETH DIONNE**

ADDRESS:  
**144 HUNDRED ACRE POND RD. EAST  
SOUTH KINGSTOWN, RI**

DATE: **JANUARY 2011**

SCALE: **AS SHOWN**

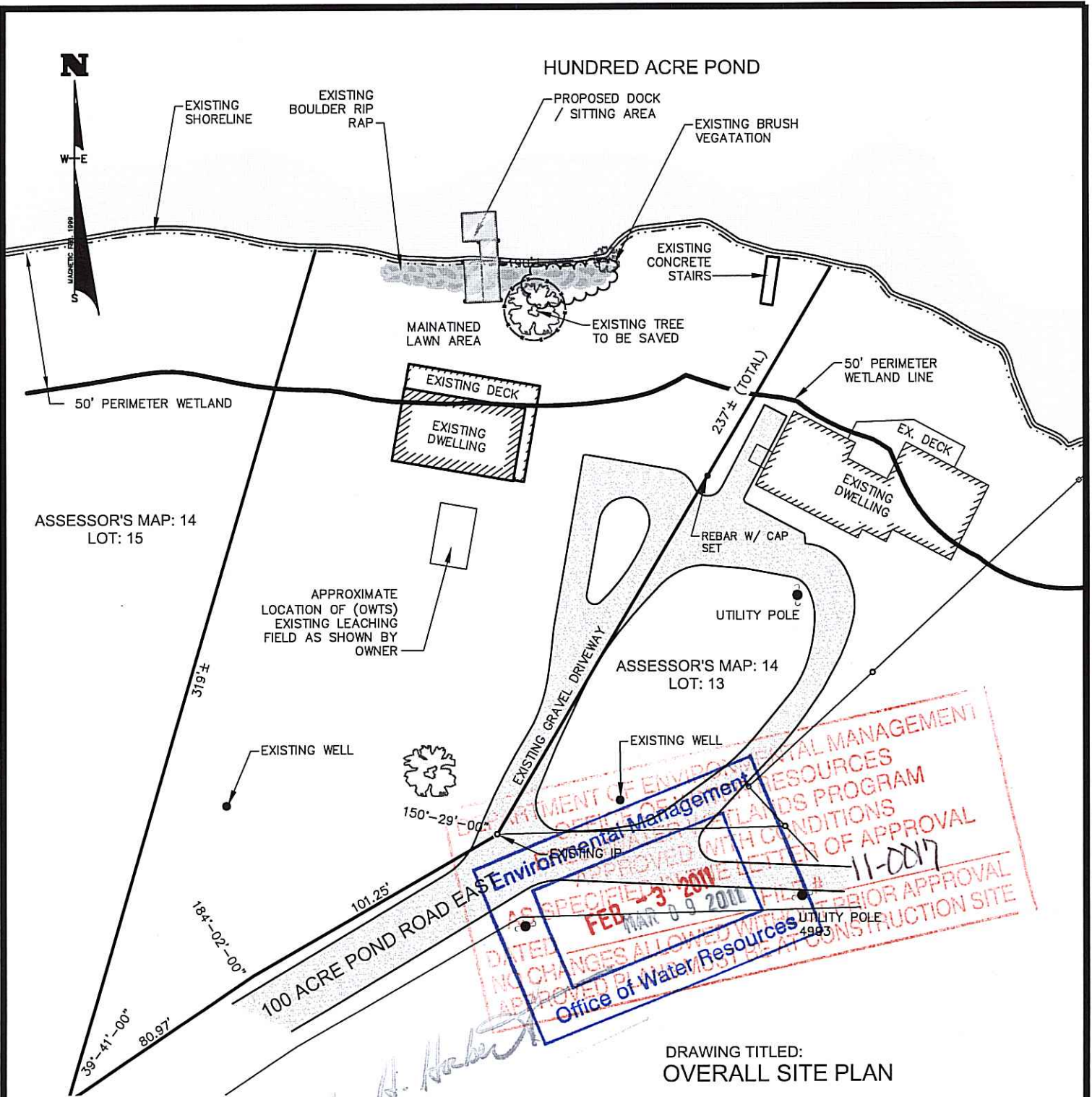

DEPARTMENT OF ENVIRONMENTAL MANAGEMENT  
 OFFICE OF WATER RESOURCES  
 WETLANDS PROGRAM  
 APPROVED WITH CONDITIONS  
 AS SPECIFIED IN PERMIT # 11-0017  
 FEB 23 2011  
 MAR 09 2011  
 NO CHANGES ALLOWED WITHOUT PRIOR APPROVAL  
 APPROVED FOR CONSTRUCTION SITE

*Charles H. Haber*

DRAWING TITLED:  
**OVERALL SITE PLAN**

LOCATED ON:  
 LOT: 14 OF ASSESSOR'S MAP: 14

OWNED BY:  
 KENNETH DIONNE

ADDRESS:  
 144 HUNDRED ACRE POND RD. EAST  
 SOUTH KINGSTOWN, RI

DATE: JANUARY 2011

SCALE: 1" = 50'

**FRISELLA**  
**ENGINEERING, INC.**  
 CIVIL AND ENVIRONMENTAL ENGINEERING  
 LAND SURVEYING

23 ARNOLD STREET □ WAKEFIELD, RI  
 PHONE (401) 783-5949 □ FAX (401) 783-5997  
 www.frisella.com

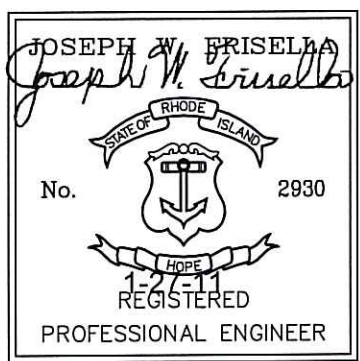

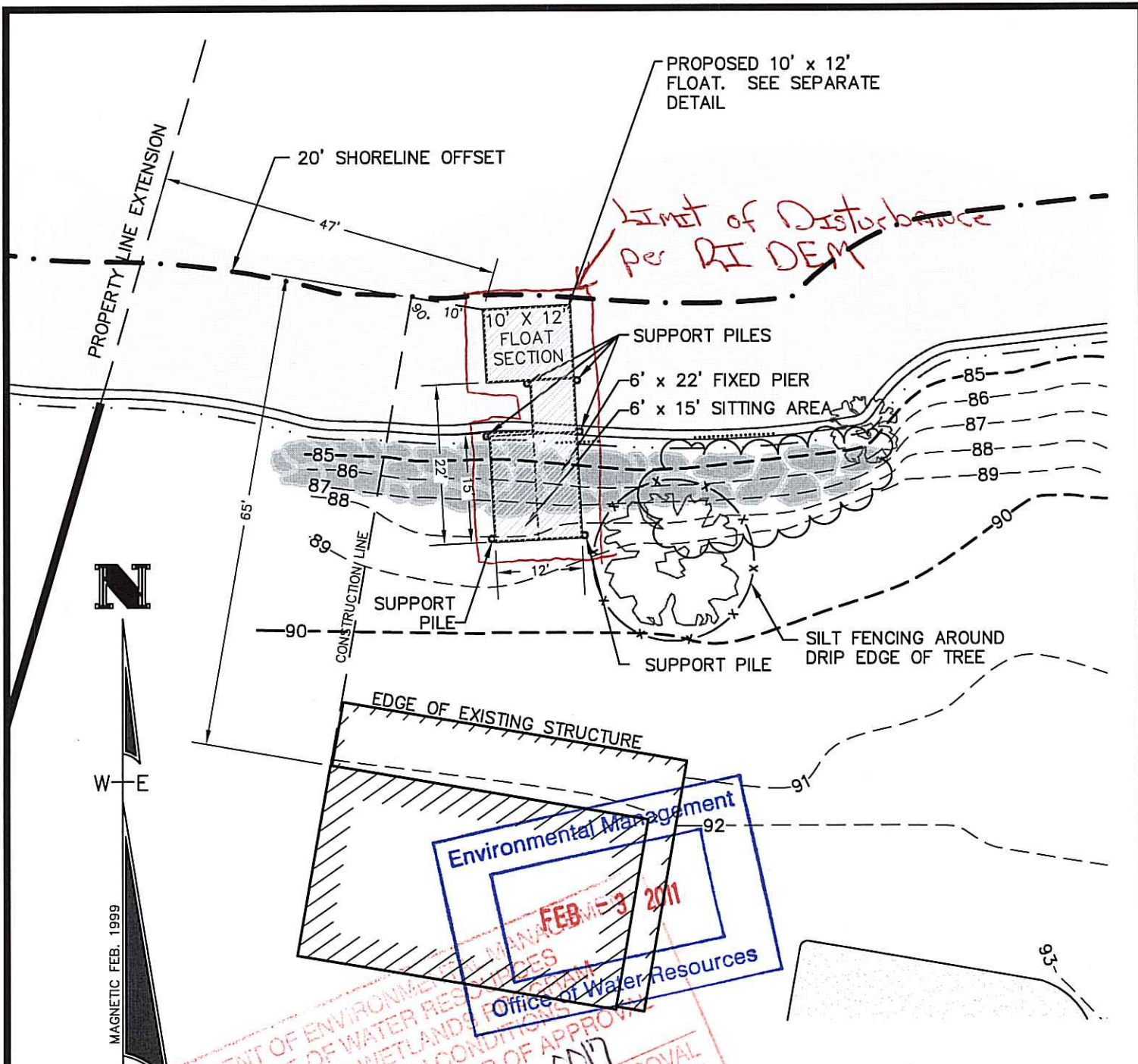

*Limit of Disturbance per RI DEM*



DEPARTMENT OF ENVIRONMENTAL MANAGEMENT  
 OFFICE OF WATER RESOURCES  
 FRESHWATER WETLANDS PERMITS  
 APPROVED WITH CONDITIONS  
 AS SPECIFIED IN THE LETTER OF APPROVAL  
 MAR 09 2011 FILE # 11-0017  
 CHANGES ALLOWED WITHOUT PRIOR APPROVAL  
 PERMITS AND PLANS MUST BE AT CONSTRUCTION SITE

Environmental Management  
 FEB - 3 2011  
 Office of Water Resources

**FRISELLA ENGINEERING, INC.**  
 CIVIL AND ENVIRONMENTAL ENGINEERING  
 LAND SURVEYING

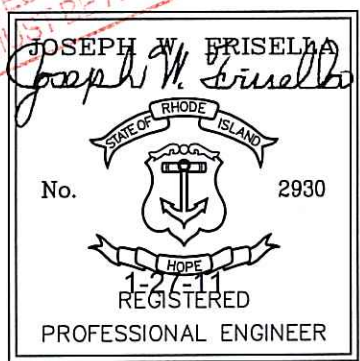

23 ARNOLD STREET □ WAKEFIELD, RI  
 PHONE (401) 783-5949 □ FAX (401) 783-5997  
 www.frisella.com

DRAWING TITLED:  
**PROPOSED DOCK LAYOUT**

LOCATED ON:  
 LOT: 14 OF ASSESSOR'S MAP: 14

OWNED BY:  
 KENNETH DIONNE

ADDRESS:  
 144 HUNDRED ACRE POND RD. EAST  
 SOUTH KINGSTOWN, RI

DATE: JANUARY 2011

SCALE: 1" = 20'

ALL HARDWARE SHALL BE MARINE GRADE STAINLESS STEEL OR HOT DIPPED GALVANIZED.

Environmental Management  
 FEB -3 2011  
 Office of Water Resources

PROPOSED FIXED-PIER DOCK SECTION. STRINGERS TO BE 3" x 10" PRESSURE TREATED, 24" ON CENTER. . FIXED PIER SECTION IS TO BE A MAXIMUM 6' IN OVERALL WIDTH WITH A PROPOSED LENGTH OF 22'±. ADJACENT TO FIXED PIER SECTION IS A 6' x 15' PROPOSED WOODEN SITTING AREA PROPOSED.

PROPOSED DOCK FLOAT SECTION. FLOAT SHALL MEASURE 10' x 12' IN PLAN SIZE, SEE FLOAT DETAIL. FLOAT TO BE ACCESSED BY ATTACHED LADDER TO FIXED-PIER SECTION

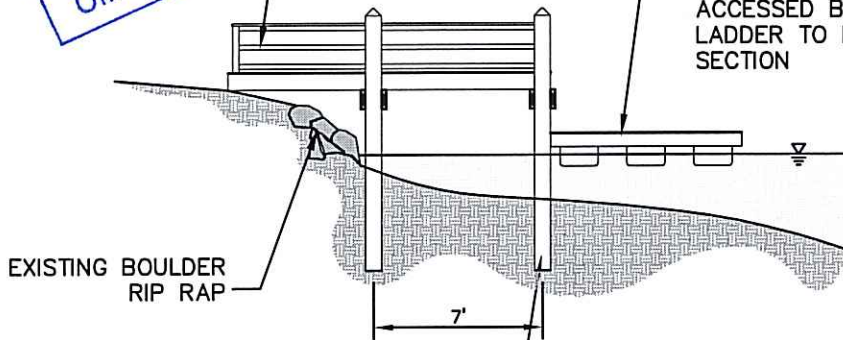

PROPOSED 10" DIAMETER PRESSURE TREATED TIMBER PILES. PILES SHALL HAVE A MINIMUM 10' EMBEDMENT AND SHALL BE SPACED AS NOTED.

PROFILE DETAIL:  
 NOT TO SCALE

STATE OF RHODE ISLAND  
 OFFICE OF ENVIRONMENTAL & WETLANDS PROTECTION  
 FRESHWATER WETLANDS PROTECTION  
 APPLICABLE WITH CONDITIONS  
 AS SPECIFIED IN THE LETTER OF APPROVAL  
 DATED MAR 09 2011 FILE # 11-0017  
 NO CHANGES ALLOWED WITHOUT PRIOR APPROVAL  
 APPROVED PLANS MUST BE AT CONSTRUCTION SITE

**FRISELLA  
 ENGINEERING, INC.**

CIVIL AND ENVIRONMENTAL ENGINEERING  
 LAND SURVEYING

23 ARNOLD STREET □ WAKEFIELD, RI  
 PHONE (401) 783-5949 □ FAX (401) 783-5997  
 www.frisella.com

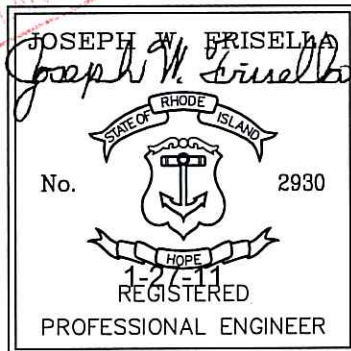

DRAWING TITLED:  
**DOCK PROFILE**

LOCATED ON:  
**LOT: 14 OF ASSESSOR'S MAP: 14**

OWNED BY:  
**KENNETH DIONNE**

ADDRESS:  
**144 HUNDRED ACRE POND RD. EAST  
 SOUTH KINGSTOWN, RI**

DATE: **JANUARY 2011**

SCALE: **AS SHOWN**

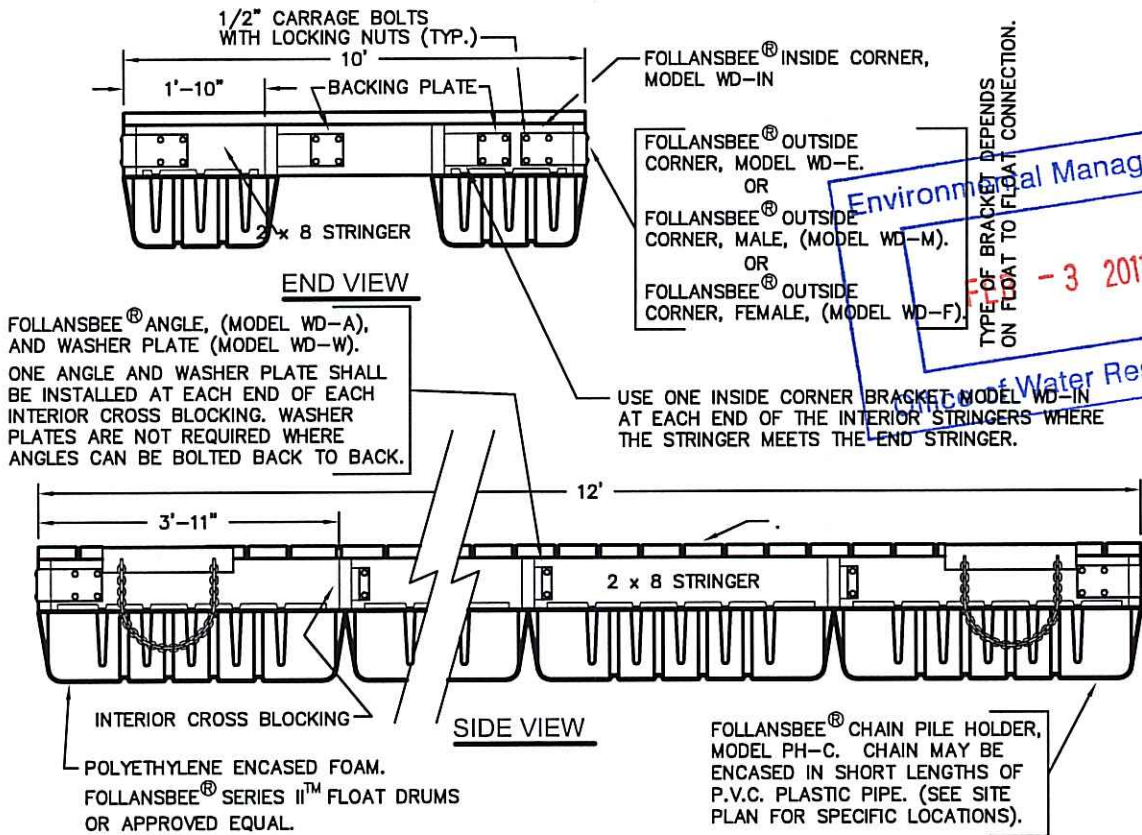

Environmental Management  
- 3 2011  
Department of Water Resources

**FLOAT DETAIL**  
SCALE: NONE

NOTE: ALL HARDWARE IS TO BE HOT-DIPPED GALVANIZED OR STAINLESS STEEL.

OTHER HARDWARE MAY BE SUBSTITUTED IN PLACE OF THE FOLLANSBEE® HARDWARE IF MATERIAL AND DESIGN ARE SIMILAR.

ALL STRINGERS SHALL BE ONE CONTINUOUS LENGTH FOR THE FULL LENGTH SHOWN ON THE PLANS.

CHARLES H. HUBERT

DEPARTMENT OF ENVIRONMENTAL MANAGEMENT  
OFFICE OF FRESHWATER RESOURCES  
APPROVED WITH CONDITIONS  
AS SPECIFIED IN THE LETTER OF APPROVAL  
DATED MAR 09 2011 FILE # 11-0017  
NO CHANGES ALLOWED WITHOUT PRIOR APPROVAL  
APPROVED PLANS MUST BE AT CONSTRUCTION SITE

DRAWING TITLED:  
FLOAT DETAIL

LOCATED ON:  
LOT: 14 OF ASSESSOR'S MAP: 14

OWNED BY:  
KENNETH DIONNE

ADDRESS:  
144 HUNDRED ACRE POND RD. EAST  
SOUTH KINGSTOWN, RI

DATE: JANUARY 2011

SCALE: AS SHOWN

**FRISELLA  
ENGINEERING, INC.**

CIVIL AND ENVIRONMENTAL ENGINEERING  
LAND SURVEYING

23 ARNOLD STREET □ WAKEFIELD, RI  
PHONE (401) 783-5949 □ FAX (401) 783-5997  
www.frisella.com

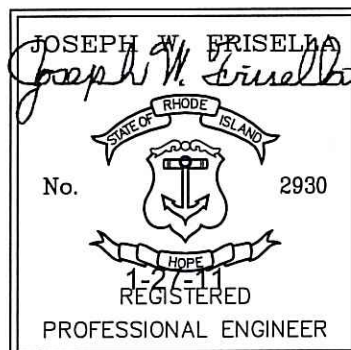

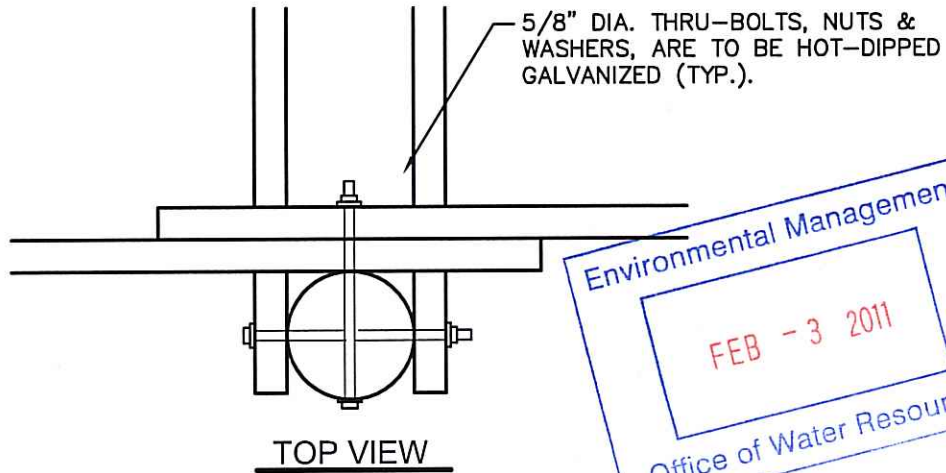

Environmental Management  
 FEB - 3 2011  
 Office of Water Resources

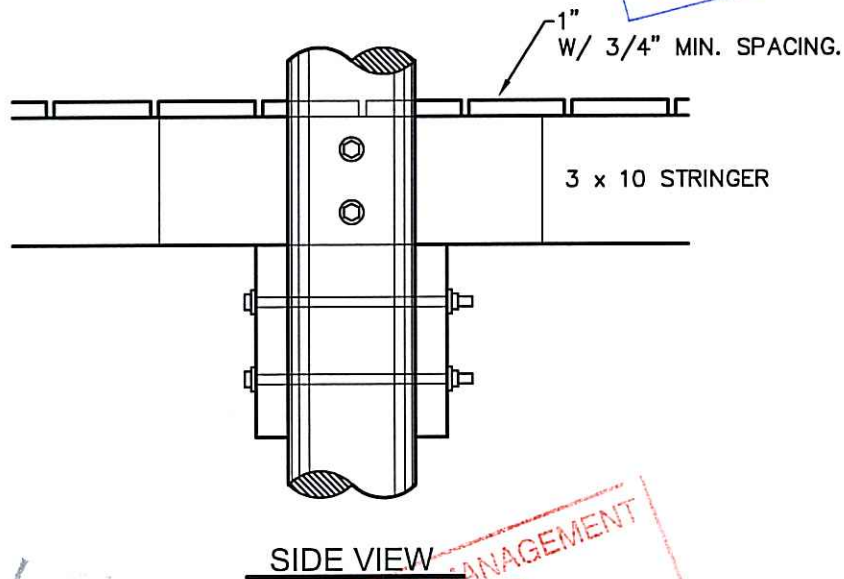

**GUSSET CONNECTION DETAIL**

SCALE: NONE

DEPARTMENT OF ENVIRONMENTAL MANAGEMENT  
 OFFICE OF WATER AND WETLANDS PROGRAM  
 FRESHWATER WETLANDS RESTORATION PROGRAM  
 APPROVED WITH CONDITIONAL APPROVAL  
 AS SPECIFIED IN THE LETTER OF APPROVAL  
 DATED MAR 09 2011 FILE # 11-0017  
 NO CHANGES ALLOWED WITHOUT PRIOR APPROVAL  
 APPROVED PLANS MUST BE AT CONSTRUCTION SITE

DRAWING TITLED:  
**GUSSET CONNECTION DETAIL**

LOCATED ON:  
 LOT: 14 OF ASSESSOR'S MAP: 14

OWNED BY:  
 KENNETH DIONNE

ADDRESS:  
 144 HUNDRED ACRE POND RD. EAST  
 SOUTH KINGSTOWN, RI

DATE: JANUARY 2011

SCALE: AS SHOWN

**FRISELLA  
 ENGINEERING, INC.**

CIVIL AND ENVIRONMENTAL ENGINEERING  
 LAND SURVEYING

23 ARNOLD STREET □ WAKEFIELD, RI  
 PHONE (401) 783-5949 □ FAX (401) 783-5997  
 www.frisella.com

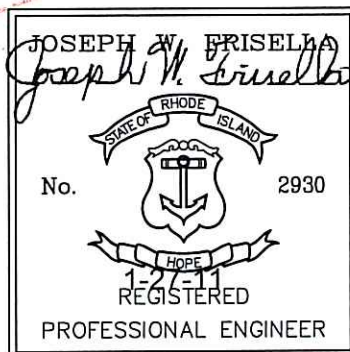

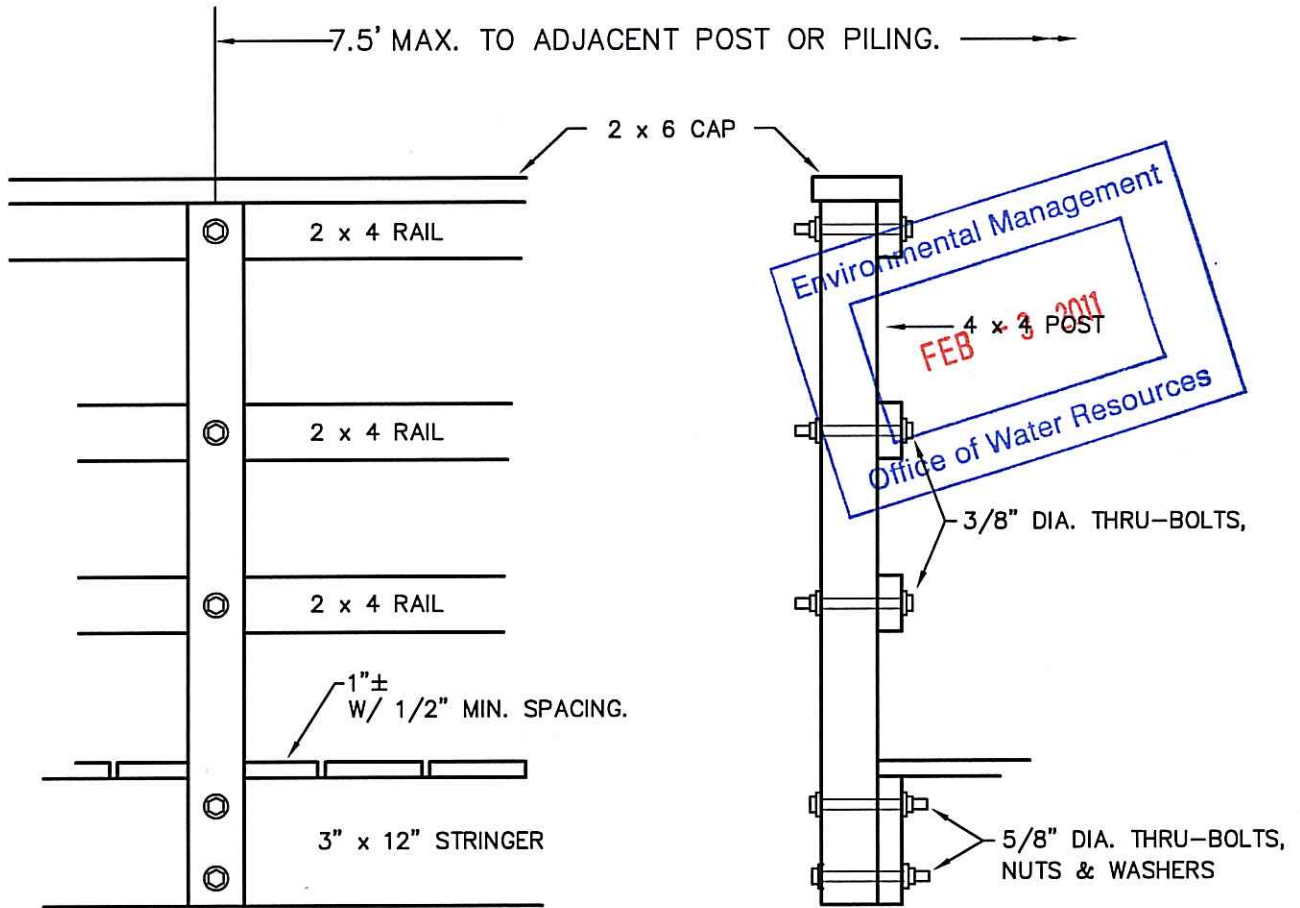

SIDE VIEW

END VIEW

ALL HARDWARE IS TO BE HOT-DIPPED GALVANIZED.

HAND RAIL IS REQUIRED ON ONE SIDE OF DOCK ONLY. 2 x 4 RAILS TO BE FASTENED TO PILES WITH 3/8" DIA. LAG BOLTS AND WASHERS. IT IS RECOMMENDED THAT THE HAND RAIL BE INSTALLED ON BOTH SIDES.

HAND RAILING DETAIL

SCALE: NONE

DRAWING TITLED:  
RAILING DETAIL

LOCATED ON:  
LOT: 14 OF ASSESSOR'S MAP: 14

OWNED BY:  
KENNETH DIONNE

ADDRESS:  
144 HUNDRED ACRE POND RD. EAST  
SOUTH KINGSTOWN, RI

DATE: JANUARY 2011

SCALE: AS SHOWN

PG. 7 OF 10

**FRISELLA  
ENGINEERING, INC.**

CIVIL AND ENVIRONMENTAL ENGINEERING  
LAND SURVEYING

23 ARNOLD STREET □ WAKEFIELD, RI  
PHONE (401) 783-5949 □ FAX (401) 783-5997  
www.frisella.com

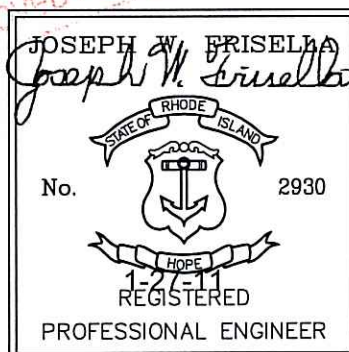

DEPARTMENT OF ENVIRONMENTAL MANAGEMENT  
OFFICE OF WATER RESOURCES  
FRESHWATER METABOLIC MANAGEMENT  
APPROVED FOR THE CONDITION OF APPROVAL  
AS SPECIFIED IN THE PERMIT  
DATED MAR 09 2011  
NO CHANGES ALLOWED WITHOUT PRIOR APPROVAL  
APPROVED PLANS MUST BE AT CONSTRUCTION SITE  
11-0017

BLOCKING SHALL BE LOCATED BETWEEN STRINGERS AND LOCATED TO DIVIDE SPAN IN THIRDS BUT SHALL NOT EXCEED 5' SPACING. ie: IF DECKING IS 15' LONG FROM PILING TO PILING THEN 2 ROWS OF SOLID BLOCKING SHALL BE REQUIRED BETWEEN ALL STRINGERS.

SOLID BLOCKING IS REQUIRED FROM STRINGER TO STRINGER ACROSS THE ENTIRE WIDTH OF THE DECK, RAMP OR FLOAT.

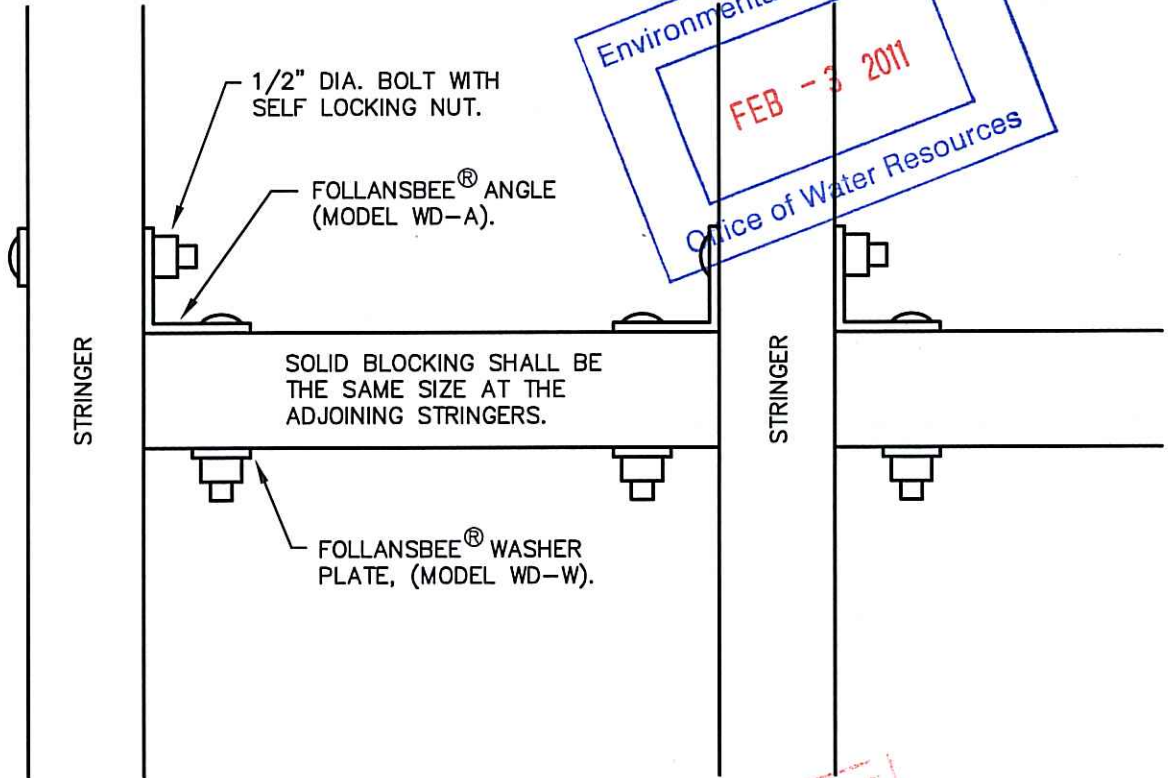

Environmental Management  
 FEB - 3 2011  
 Office of Water Resources

**SOLID BLOCKING DETAIL**

SCALE: NONE

OTHER HARDWARE MAY BE SUBSTITUTED IN PLACE OF THE FOLLANSBEE® HARDWARE IF MATERIAL AND DESIGN ARE SIMILAR.

NOTE: ALL HARDWARE IS TO BE HOT-DIPPED GALVANIZED. OR STAINLESS STEEL.

ENVIRONMENTAL MANAGEMENT  
 OFFICE OF WATER RESOURCES  
 FRESHWATER WETLANDS PROGRAM  
 APPROVED WITH CONDITIONS  
 AS SPECIFIED IN THE LETTER OF APPROVAL  
 MAR 09 2011  
 FILE # 11-0017  
 NO CHANGES ALLOWED WITHOUT PRIOR APPROVAL  
 APPROVED PLANS MUST BE AT CONSTRUCTION SITE

DRAWING TITLED:  
**BLOCKING DETAIL**

LOCATED ON:  
 LOT: 14 OF ASSESSOR'S MAP: 14

OWNED BY:  
 KENNETH DIONNE

ADDRESS:  
 144 HUNDRED ACRE POND RD. EAST  
 SOUTH KINGSTOWN, RI

DATE: JANUARY 2011

SCALE: AS SHOWN

**FRISELLA  
 ENGINEERING, INC.**

CIVIL AND ENVIRONMENTAL ENGINEERING  
 LAND SURVEYING

23 ARNOLD STREET □ WAKEFIELD, RI  
 PHONE (401) 783-5949 □ FAX (401) 783-5997  
 www.frisella.com

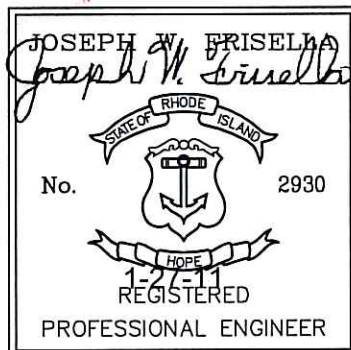

**EROSION AND SEDIMENTATION CONTROL NOTES:**

TEMPORARY AND/OR PERMANENT EROSION CONTROL DEVICES SUCH AS BALED HAY, SILT FENCING, ETC. SHALL BE INSTALLED PRIOR TO ANY CLEARING OR EXCAVATION. HAY BALES OR SILT FENCING SHALL BE PLACED IMMEDIATELY DOWN SLOPE AND ADJOINING AREAS OF SOIL DISTURBANCE AND STOCKPILES. INSTALLATION OF ALL EROSION CONTROL DEVICES SHALL BE CONDUCTED IN ACCORDANCE TO DETAIL SPECIFICATIONS.

CLEARING OF EXISTING VEGETATION SHALL BE DONE IN A CONTROLLED MANNER SO AS TO AVOID EXTENSIVE AREAS OF DEFOLIATED TERRAIN SUBJECT TO EROSION. AREAS SO DISTURBED SHALL BE BROUGHT TO FINAL GRADES AND STABILIZED AS SOON AS POSSIBLE.

DURING CONSTRUCTION THE CONTRACTOR SHALL BE RESPONSIBLE FOR MAINTAINING DRAINAGE AND RUNOFF FLOW DURING STORMS AND PERIODS OF RAINFALL.

ALL EROSION CONTROL DEVICES SHALL BE INSPECTED AND MAINTAINED ON A REGULAR BASIS DURING CONSTRUCTION, ESPECIALLY AFTER EACH RAINFALL.

DUE TO CHANGING CHARACTERISTICS OF THE SITE CAUSED BY AND DURING CONSTRUCTION ADDITIONAL EROSION CONTROL MEASURES MAY BE REQUIRED AS SITE CONDITIONS WARRANT.

IF CONSTRUCTION IS SUSPENDED, ALL DISTURBED AREAS SHALL BE SEEDED AND ALL NECESSARY EROSION CONTROL DEVICES SHALL BE IN PLACE AND IN GOOD WORKING ORDER. IF SEEDING IS NOT POSSIBLE THEN EROSION CONTROL MATS SHALL BE PLACED OVER ALL DISTURBED SOIL.

EROSION CONTROL BLANKETS (MATS) SHALL BE INSTALLED ACCORDING TO THE MANUFACTURER'S RECOMMENDATIONS. EROSION CONTROL BLANKETS (MATS) SHALL BE MANUFACTURED BY NORTH AMERICAN GREEN) OR APPROVED EQUIVALENT AND INSTALLED ACCORDING TO THE MANUFACTURER'S RECOMMENDATIONS.

ALL EROSION CONTROL METHODS, MATERIALS AND MAINTENANCE SHALL BE DONE IN ACCORDANCE WITH THE "RHODE ISLAND SOIL EROSION AND SEDIMENT CONTROL HANDBOOK".

ALL AREAS WHICH ARE DISTURBED DURING CONSTRUCTION ARE TO BE BROUGHT TO FINISHED GRADE WITH AT LEAST 6" MINIMUM DEPTH OF GOOD QUALITY LOAM AND ALL SOIL AMENDMENTS DEEMED NECESSARY. THE AREA SHALL BE SEEDED WITH A QUICK GERMINATING GRASS SEED SUCH AS URI #2 OR APPROVED EQUIVALENT.

THE CONTRACTOR SHALL PROVIDE FOR ALL SEEDED AREAS TO BE WATERED AND IN GOOD CONDITION UNTIL A GOOD HEALTHY AND UNIFORM GROWTH IS ESTABLISHED OVER THE ENTIRE AREA.

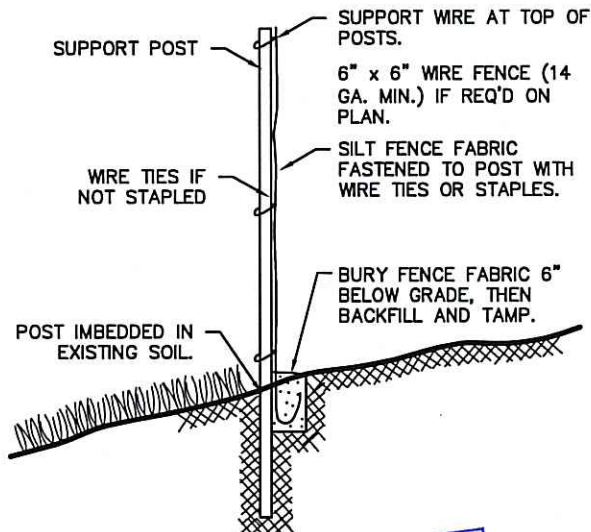

**SILT FENCE DETAIL**  
 NOT TO SCALE  
 FEB - 3 2011  
 Office of Water Resources

STATE OF ENVIRONMENTAL MANAGEMENT  
 OFFICE OF WATER RESOURCES  
 WETLANDS PROGRAM  
 APPROVED WITH CONDITIONS  
 IN THE LETTER OF APPROVAL  
 MAR 09 2011 FILE # 11-0017  
 APPROVED WITHOUT PRIOR APPROVAL  
 PLANS MUST BE AT CONSTRUCTION SITE

**FRISELLA  
 ENGINEERING, INC.**

CIVIL AND ENVIRONMENTAL ENGINEERING  
 LAND SURVEYING

23 ARNOLD STREET □ WAKEFIELD, RI  
 PHONE (401) 783-5949 □ FAX (401) 783-5997  
 www.frisella.com

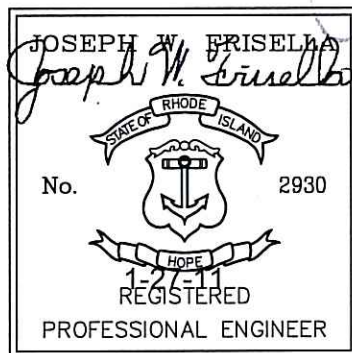

DRAWING TITLED:  
**EROSION CONTROL**

LOCATED ON:  
**LOT: 14 OF ASSESSOR'S MAP: 14**

OWNED BY:  
**KENNETH DIONNE**

ADDRESS:  
**144 HUNDRED ACRE POND RD. EAST  
 SOUTH KINGSTOWN, RI**

DATE: **JANUARY 2011**

SCALE: **AS SHOWN**

## DESIGN STANDARDS:

- RESIDENTIAL DOCK DESIGN IN ACCORDANCE WITH TABLE 3 – MINIMUM DESIGN CRITERIA RICRMP SECTION 300.4. FIXED STRUCTURES INCLUDING STAIRWAYS ARE CAPABLE OF SUPPORTING 40 PSF LIVE LOAD + 10 PSF DEAD LOAD.
- FLOATING STRUCTURE CAPABLE OF SUPPORTING A UNIFORM LIVE LOAD OF 20 PSF OR A CONCENTRATED LOAD OF 400 LBS.

## CONSTRUCTION NOTES:

- DESIGN IS IN ACCORDANCE WITH, AND CONSTRUCTION SHALL CONFORM TO RI STATE BUILDING CODE.
- CONTRACTOR SHALL NOTIFY ENGINEER WHEN UNANTICIPATED OR APPARENTLY DANGEROUS CONDITIONS ARE UNCOVERED DURING CONSTRUCTION.
- CONTRACTOR SHALL VERIFY ALL DIMENSIONS AND CONDITIONS ON THE JOB. DISCREPANCIES SHALL BE BROUGHT TO THE ATTENTION OF THE ENGINEER BEFORE PROCEEDING WITH CONSTRUCTION.
- CONTRACTOR SHALL SHORE, BRACE, SHEETPILE OR OTHERWISE SUPPORT THE STRUCTURE AS NEEDED TO MAINTAIN STRUCTURAL INTEGRITY AT ALL TIMES.
- CONTRACTOR SHALL MAINTAIN CONTINUOUS CONTROL OF SURFACE AND SUBSURFACE WATER TO ENSURE THAT THE WORK IS DONE UNDER DRY CONDITIONS ON COMPACTED FILL.

## FRAMING CONSTRUCTION NOTES:

UNLESS OTHERWISE NOTED, FRAMING LUMBER SHALL BE HEM-FIR, NO.1, PRESSURE TREATED OR APPROVED EQUIVALENT.

FRAMING PLANS INDICATE STRUCTURAL REQUIREMENTS ONLY. ADDITIONAL MEMBERS MAY BE NECESSARY FOR BLOCKING, NAILERS, AND CODE REQUIREMENTS,

NEW TIMBER FOR STRUCTURAL USE SHALL HAVE 19% MOISTURE CONTENT AS SPECIFIED IN THE "NATIONAL SPECIFICATION FOR WOOD CONSTRUCTION" (1982).

ALL NAILING SHALL CONFORM TO APPENDIX C OF THE RI STATE BUILDING CODE.

ANY ANCHOR BOLTS OR BOLTS FOR TIMBER SHALL BE ASTM A307. BOLT HOLES IN TIMBER SHALL BE 1/16 INCHES LARGER THAN THE NOMINAL BOLT DIAMETER.

PROVIDE STANDARD CUT WASHERS BETWEEN WOOD AND BOLT HEAD AND BETWEEN WOOD AND BOLT NUT, UNLESS STEEL PLATES OR PLATE WASHERS ARE CALLED FOR ON DRAWINGS.

ALL CONNECTION HARDWARE SHALL BE HOT-DIPPED GALVANIZED OR APPROVED EQUIVALENT.

**FRISELLA  
ENGINEERING, INC.**

CIVIL AND ENVIRONMENTAL ENGINEERING  
LAND SURVEYING

23 ARNOLD STREET □ WAKEFIELD, RI  
PHONE (401) 783-5949 □ FAX (401) 783-5997  
www.frisella.com

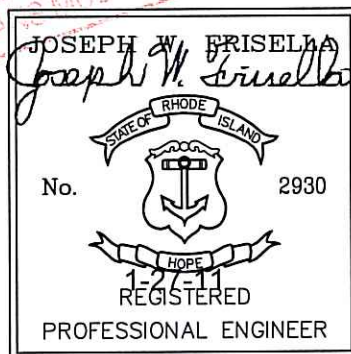

DRAWING TITLED:  
DESIGN NOTES

LOCATED ON:  
LOT: 14 OF ASSESSOR'S MAP: 14

OWNED BY:  
KENNETH DIONNE

ADDRESS:  
144 HUNDRED ACRE POND RD. EAST  
SOUTH KINGSTOWN, RI

DATE: JANUARY 2011

SCALE: AS SHOWN

PG. 10 OF 10

