

GENERAL NOTES:

- ALL DESIGN, FABRICATION AND INSTALLATION SHALL BE IN ACCORDANCE WITH THE REQUIREMENTS OF TITLE 49 PART 192 OF THE CODE OF FEDERAL REGULATIONS, "TRANSPORTATION OF NATURAL AND OTHER GAS BY PIPELINE," INCLUDING SPECIFIC REQUIREMENTS DEFINED BY ASME B31.8 "GAS TRANSMISSION AND DISTRIBUTION PIPING SYSTEMS" (2004).
- ALL WELDS SHALL BE 100% RADIOGRAPHICALLY INSPECTED. ALL WELDING AND NON-DESTRUCTIVE EXAMINATION OF WELDS SHALL MEET THE REQUIREMENTS OF API-1104, 20TH EDITION.
- ALL FABRICATION, INSTALLATION, TESTING AND COMMISSIONING SHALL MEET THE REQUIREMENTS OF THE COMPANY'S SPECIFICATIONS AND DRAWINGS UNLESS OTHERWISE APPROVED BY THE COMPANY'S AUTHORIZED REPRESENTATIVE IN WRITING.
- EXISTING CONDITIONS COMPILED FROM SURVEYS PERFORMED AND PROCESSED BY SGC ENGINEERING LLC
COORDINATE SYSTEM: UTM ZONE 19 /NAD 83
ELEVATION DATUM: NAVD 88
- UNDERGROUND UTILITIES SHOWN ON THIS PLAN ARE BASED UPON FIELD OBSERVATIONS AND INFORMATION OF RECORD. THEY ARE NOT WARRANTED TO BE EXACT, NOR IS IT WARRANTED THAT ALL UNDERGROUND UTILITIES OR OTHER STRUCTURES ARE SHOWN ON THIS PLAN.
- PROPERTY LINES ARE BASED ON TAX MAPS, PLANS/DEEDS OF RECORD AND FIELD SURVEY DATA AND ARE NOT THE RESULT OF A FULL BOUNDARY SURVEY.

CONSTRUCTION NOTES:

- CONTRACTOR RESPONSIBLE FOR REPAIRING EXISTING CATHODIC PROTECTION/CORROSION WIRES, CABLES, ANODES AND OTHER COMPONENTS IF DAMAGED DURING CONSTRUCTION.
- CONTRACTOR RESPONSIBLE FOR FIELD VERIFICATION OF DIMENSIONS, ANGLES AND TRIMMING OF ELLS/PIPE AS NECESSARY.
- ANY NECESSARY TRENCH DEWATERING TO BE DIRECTED TO FILTER BAGS OR EQUIVALENT IN A MANNER SO AS NOT TO CAUSE EROSION/SEDIMENTATION.

ENVIRONMENTAL NOTE:

- CONTRACTOR TO COMPLY WITH ALL APPLICABLE PROVISIONS OF A.G.T.'S ENVIRONMENTAL CONSTRUCTION EROSION/SEDIMENTATION CONTROL PLAN.
- WETLANDS WERE FIELD DELINEATED BY TRC ENVIRONMENTAL ON 11/10/2010 AND FIELD LOCATED BY SGC ENGINEERING LLC USING GPS.
- THE FINAL IMPLEMENTATION AND LOCATION OF EROSION AND SEDIMENT CONTROLS WILL BE DETERMINED BY AN A.G.T. INSPECTOR.
- TEMPORARY WORKSPACE AS DEPICTED ON THIS PLAN IS REQUIRED TO ACCESS EXISTING FACILITIES, PROVIDE CONSTRUCTION VEHICLE PARKING, AND STOCKPILING AND STAGING OF MATERIALS.
- PROPOSED TEMPORARY WORKSPACE CONSISTS OF 0.53 ACRES WITH 0.29 ACRES CONSISTING OF PERMANENT EASEMENT.
- PROPOSED PROJECT AREA IS 0.53 ACRES WITH 0.03 ACRES OF WETLAND LOCATED ON SITE.
- PROJECT WILL RESULT IN 0.03 ACRES OF TEMPORARY WETLAND IMPACT.
- PROJECT SITE CONSISTS OF 0.30 ACRES WITHIN PERIMETER WETLAND BOUNDARY.
- THE PROJECT IS NOT LOCATED WITHIN THE ZONE A FLOOD ZONE, FEMA FLOOD INSURANCE MAP NO. 4454050015C.
- NO CHANGE TO GRADES ARE PROPOSED.

NEWPORT COUNTY, RHODE ISLAND TOWN OF PORTSMOUTH

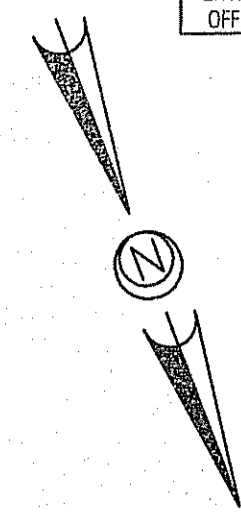
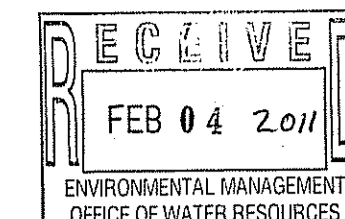

Kindly be advised that this Permit is not equivalent to a verification of the type or extent of freshwater wetlands on site.

Drawing: P:\989035_AGT_2011\MP\OnSiteProd\Work\Drafting\G-2\G-2_Site_Layouts\G-2_Receiver_Site.dwg
 Date: 2/23/11 9:40 AM

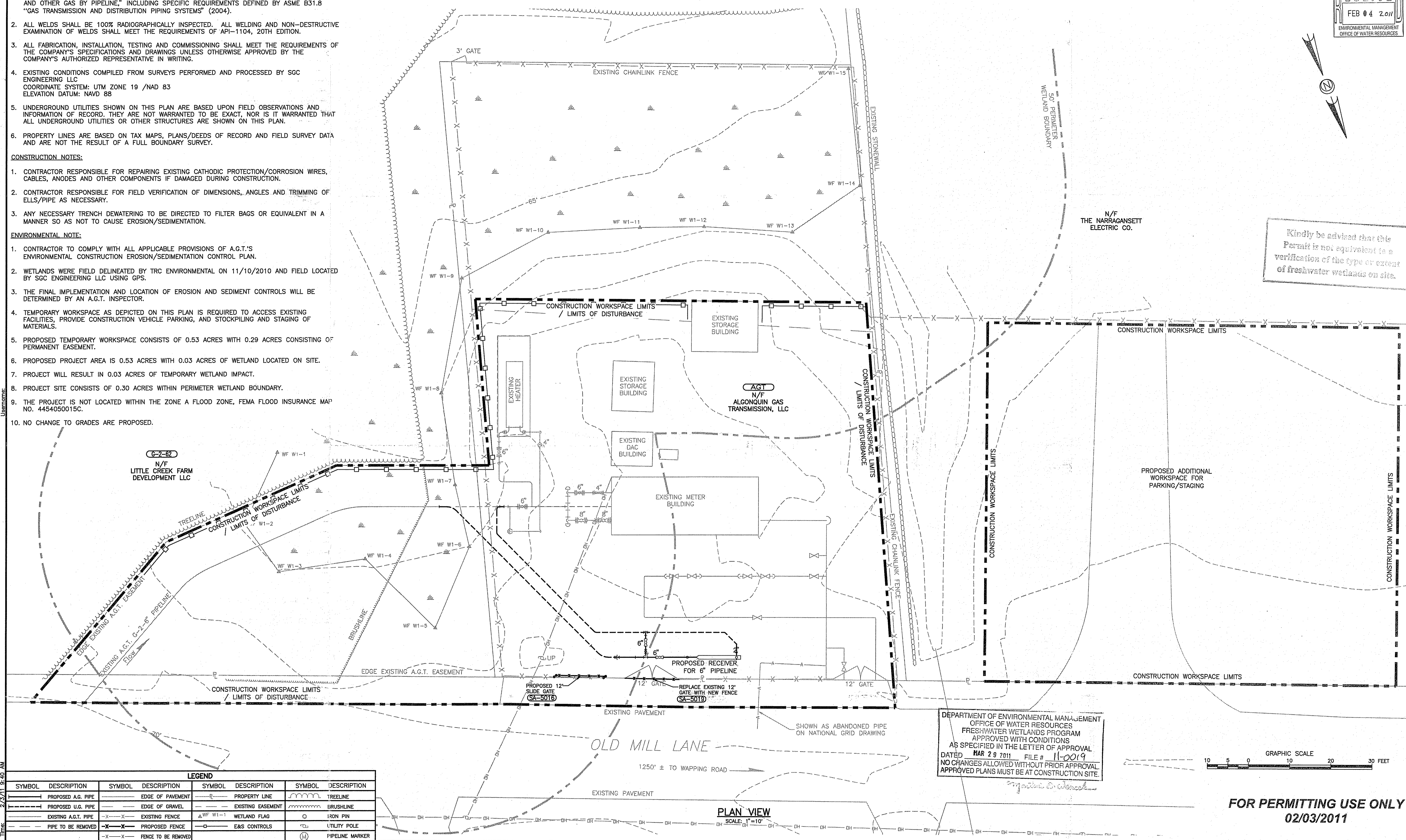

DEPARTMENT OF ENVIRONMENTAL MANAGEMENT
OFFICE OF WATER RESOURCES
FRESHWATER WETLANDS PROGRAM
APPROVED WITH CONDITIONS
AS SPECIFIED IN THE LETTER OF APPROVAL
DATED **MAR 29 2011** FILE # **11-0019**
NO CHANGES ALLOWED WITHOUT PRIOR APPROVAL.
APPROVED PLANS MUST BE AT CONSTRUCTION SITE.

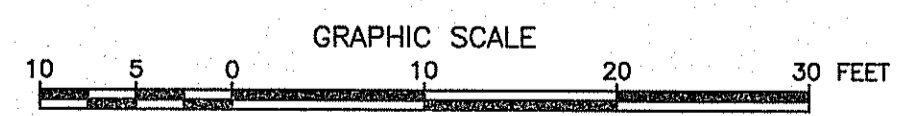

LEGEND			
SYMBOL	DESCRIPTION	SYMBOL	DESCRIPTION
---	PROPOSED A.G. PIPE	---	EDGE OF PAVEMENT
---	PROPOSED U.G. PIPE	---	EDGE OF GRAVEL
---	EXISTING A.G.T. PIPE	---	EXISTING FENCE
---	PIPE TO BE REMOVED	---	PROPOSED FENCE
---	FENCE TO BE REMOVED	---	WETLAND FLAG
---		---	E&S CONTROLS
---		---	UTILITY POLE
---		---	PIPELINE MARKER
---		---	PROPERTY LINE
---		---	EXISTING EASEMENT
---		---	TREELINE
---		---	BRUSHLINE
---		---	IRON PIN
---		---	WETLAND FLAG
---		---	E&S CONTROLS
---		---	UTILITY POLE
---		---	PIPELINE MARKER

PLAN VIEW
SCALE: 1"=10'

FOR PERMITTING USE ONLY
02/03/2011

DWG. NO.	REFERENCE DWG.	REV	DSN	CK	DESCRIPTION	PREPARED BY:	DRAWN BY	PERMITTING	CONSTRUCTION	BURRELLVILLE DISCHARGE 2011 INTEGRITY MANAGEMENT PROGRAM LINE NO. G-2-6" RECEIVER SITE PLAN	Spectra Energy	LOC. 135 OLD MILL LANE, PORTSMOUTH NEWPORT COUNTY, RHODE ISLAND	YEAR: 2011	W.O. 004120167	SCALE: 1" = 10'	DWG. BB-P-1020	REV.
						Hatch Mott MacDonald 150 Lower Westfield Road Holyoke, Massachusetts 01040 Phone (413) 535-0135 Fax (413) 535-0136											