

**LEGEND**

- PROPERTY LINE
- DRAIN LINE
- WATER GATE
- - - - - EXIST. CONTOUR
- - - - - PROP. CONTOUR
- ▲ WF-74A
- STONE WALL
- LIMIT OF DISTURBANCE
- STAKED HAYBALES & LIMIT OF DISTURBANCE

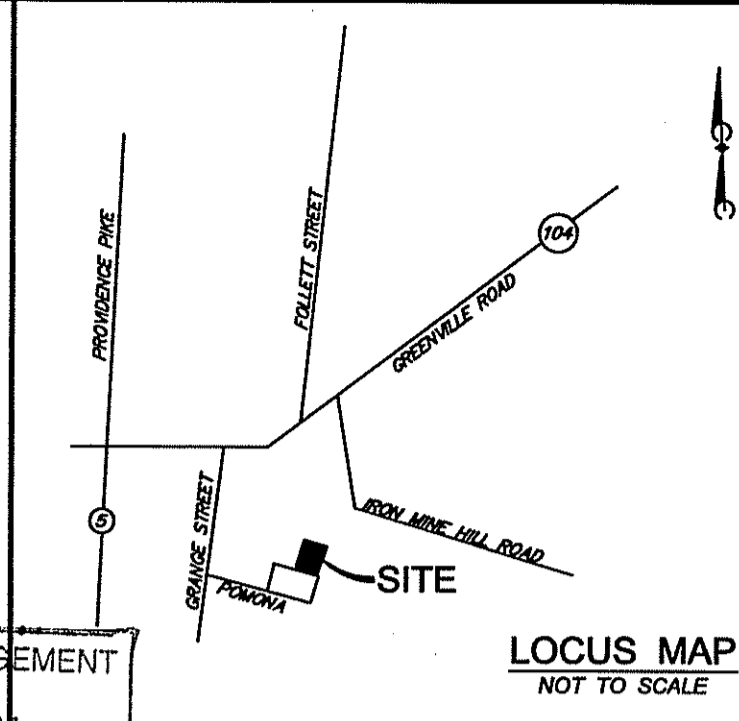

**PROPOSED ONSITE WASTEWATER TREATMENT REDESIGN & WETLANDS PLAN**

Environmental Management  
for **DAVID JARRY**  
POMONA STREET  
NORTH SMITHFIELD, RHODE ISLAND  
DECEMBER, 2010 SCALE 1" = 30'

REVISOR: 2/28/11, 5/10/11, 6/9/11

PLAT 16, LOT 130 UNION HILL SUBLOT 8, AREA: 65,000 SF  
BENCH MARK: TOP OF BOUND, ELEVATION 414.62

LEACHING SYSTEM BY:  
MARC N. NYBERG ASSOCIATES, INC.  
LAND SURVEYORS and PLANNERS  
501 GREAT ROAD, UNIT 104  
NORTH SMITHFIELD, RHODE ISLAND 02896  
TEL: (401) 762-2870  
FAX: (401) 762-2871

MARC N. NYBERG  
No. 1797  
PROFESSIONAL LAND SURVEYOR

THIS SURVEY AND PLAN CONFORM TO CLASS IV STANDARD AS ADOPTED BY THE RHODE ISLAND BOARD OF REGISTRATION FOR PROFESSIONAL LAND SURVEYORS.

*Marc N. Nyberg*  
REG. PROFESSIONAL LAND SURVEYOR

**GENERAL NOTES**

- 1) LEACHING TRENCHES TO BE EXCAVATED IN ACCORDANCE WITH RIDEM REGULATION 32.9 FOR ONSITE WASTEWATER TREATMENT SYSTEMS. A 6 INCH GRAVEL BASE TO BE SET BELOW EACH TRENCH IN ACCORDANCE WITH REGULATION 32.12. TREES, BRUSH AND STUMPS WITHIN AND EXTENDING 10 FEET BEYOND LEACHFIELD TO BE REMOVED. THE LEACHFIELD AND 5 FEET BEYOND THE LEACHFIELD SHALL BE STRIPPED OF ALL TOPSOIL (A HORIZONS) IN ORDER TO AVOID COMPACTION OF THE B SOIL HORIZON, ONLY TRACKED VEHICLES SHALL BE ALLOWED WITHIN THIS AREA.
- 2) USE SDR #35 PVC PIPING OR EQUIVALENT THROUGHOUT SYSTEM AND SCH. 40 UNDER DRIVEWAYS AS SHOWN.
- 3) NO WELL EXISTS WITHIN 100' OF THE PROPOSED LEACHING SYSTEM.
- 4) NO LEACHING SYSTEM EXISTS WITHIN 100' OF THE PROPOSED WELL.
- 5) NO WELLS, EXISTING OR PROPOSED, ARE WITHIN 200' FEET OF ISDS. NO PUBLIC WELLS, EXISTING OR PROPOSED, ARE WITHIN 500' OF THE ISDS UNLESS SHOWN.
- 6) BRING SEPTIC TANK MANHOLE TO GRADE AND D-BOX MANHOLE TO WITHIN 12" OF GRADE.
- 7) SEPTIC TANK TO BE A MINIMUM OF 75' FROM ALL WELLS.
- 8) ENDS OF LINES IN TRENCH TO BE INTERCONNECTED.
- 9) D-BOX TO HAVE A MINIMUM BOTTOM AREA OF 3 SQUARE FEET AND MEET H-20 WHEEL LOADS WITH MARKER SET TO GRADE.
- 10) SANITARY TEES TO BE INSTALLED IN SEPTIC TANK.
- 11) NO DRAINS OF ANY KIND SHALL BE WITHIN 25' UPGRADE OR 50' DOWNGRADE OR SIDE GRADIENT OF THE PROPOSED LEACHING SYSTEM.
- 12) 10' FROM LEACHING AREA NOT TO BE LOWER THAN ELEV.: 412.08.
- 13) COVER OVER SEPTIC TANK TO BE GRADED TO DIVERT SURFACE RUNOFF.
- 14) SYSTEM INSTALLATION TO BE SUPERVISED BY THE DESIGNER.
- 15) WASHING MACHINE LINT FILTER IS STRONGLY RECOMMENDED TO PREVENT PREMATURE FAILURE OF ELJEN SYSTEM.
- 16) ZABEL EFFLUENT FILTER TO BE INSTALLED AT SEPTIC TANK OUTLET.

**1,500 GALLON TWO COMPARTMENT SEPTIC TANK**  
NOT TO SCALE

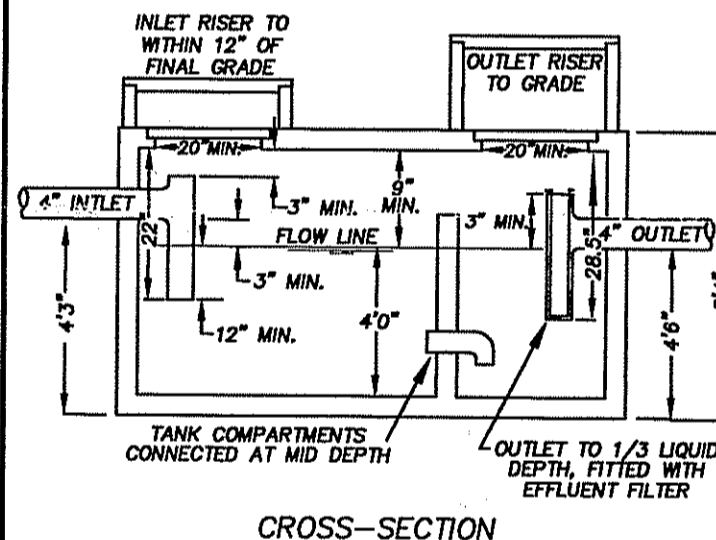
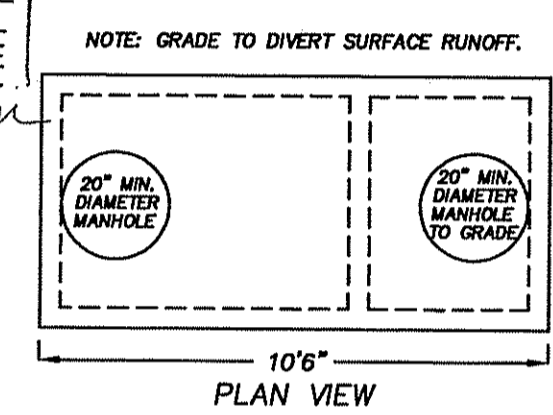

**"DIPPER" TIPPING DISTRIBUTION BOX**  
NOT TO SCALE

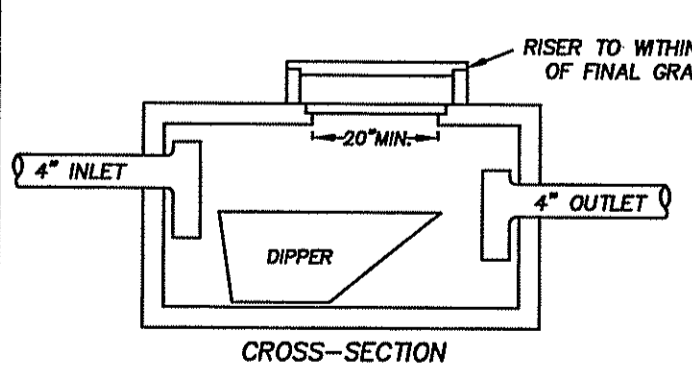
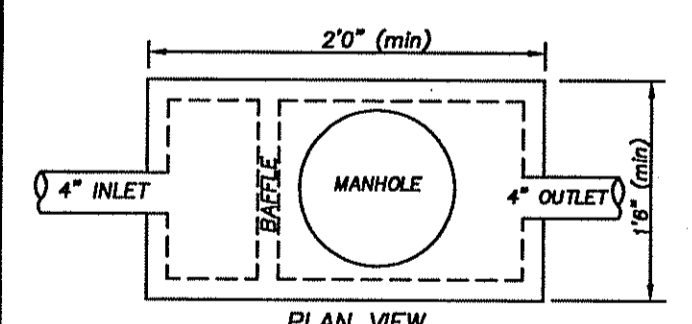

**LEACHING SYSTEM CROSS-SECTION**  
NOT TO SCALE

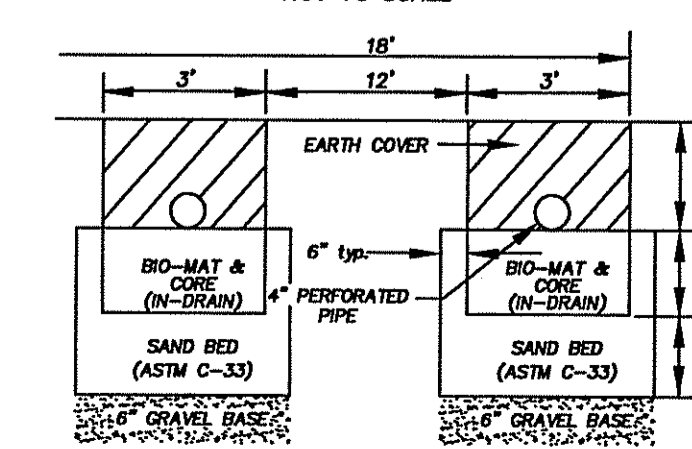

TEST HOLE DATA	DESIGN DATA
DATE: 1/20/99 (BY OTHERS)	PERC RATE: 9 MPI
TH23A - OG ELEV. 410.00	SOIL CATEGORY: 7
0"-12" LM BLK, UC	DESIGN LOADING RATE: 0.52
12"-72" STL BR, LL	FIELD SIZE: ELJENS, TWO LINES
72"-108" SMS, 2B, 2FS, 2ST, GREY, MC	32 TOTAL ELJEN UNITS
TH23B - OG ELEV. 411.00	896 SQUARE FEET
0"-12" LM BLK, UC	
12"-32" STL BR, LL	
32"-111" SMS, 2B, 2FS, 2ST, GREY, MC	
ESHWT: 3'6" PER #25-65R	
LEDGE TESTS - 4/20/05	
LT8A 8'0" LT8C 7'0"	
LT8B 7'0" LT8D 8'0"	

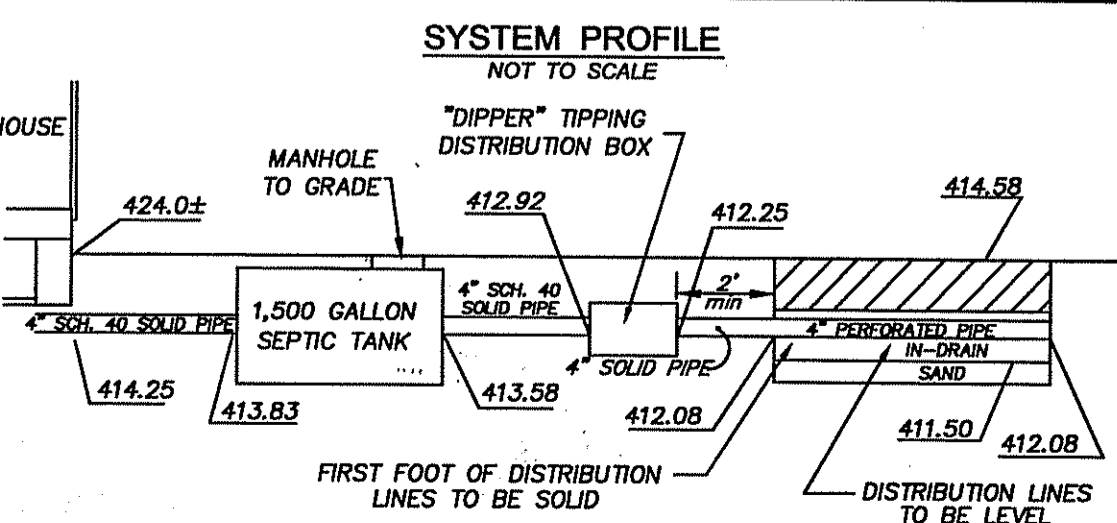

BENCH MARK  
TOP OF BOUND  
ELEV. 414.62

**POMONA STREET**