

DEM Note: IF work is to occur prior to July 1, or if the stream is flowing during construction, flow must be diverted around the work areas so as to prevent downstream sedimentation. See Condition 12 of Permit.

DEPARTMENT OF ENVIRONMENTAL MANAGEMENT
OFFICE OF WATER RESOURCES
FRESHWATER WETLANDS PROGRAM
APPROVED WITH CONDITIONS
AS SPECIFIED IN THE LETTER OF APPROVAL
DATED MAY 3 2011 FILE # 11-0056
NO CHANGES ALLOWED WITHOUT PRIOR APPROVAL
APPROVED PLANS MUST BE AT CONSTRUCTION SITE

R.I.D.E.M. SUBMISSION
2006-SH-003
APRIL 13, 2011

Environmental Management
APR 19 2011
Office of Water Resources



STATE OF RHODE ISLAND
DEPARTMENT OF TRANSPORTATION
Two Capitol Hill
Providence, Rhode Island 02903-1124
(401) 222-2023

REVISION			NO.	DATE	BY	DESCRIPTION
NO.	DATE	BY				
001	7/2/10	MD/MD				
002	3/25/11	MD				

RHODE ISLAND
DEPARTMENT OF TRANSPORTATION
STATEWIDE DRAINAGE IMPROVEMENTS
DANIELSON PIKE (ROUTE 6A)
SCITUATE
RHODE ISLAND
GENERAL PLAN NO. 3

CHECKED BY: M.J.D. DATE: 07-29-10 SCALE: 1"=30'

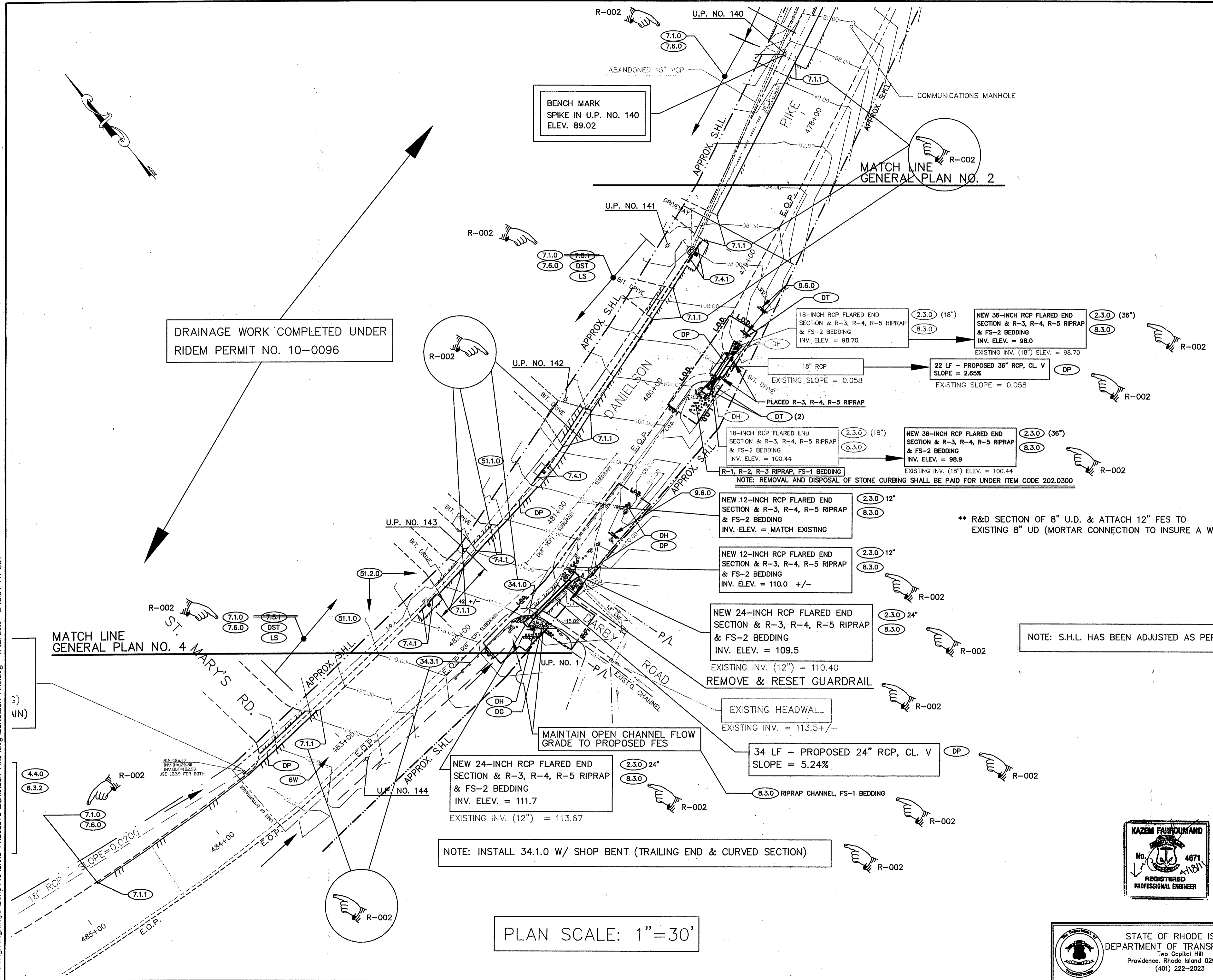

DRAINAGE WORK COMPLETED UNDER RIDEM PERMIT NO. 10-0096

MATCH LINE GENERAL PLAN NO. 4

MATCH LINE GENERAL PLAN NO. 2

BENCH MARK SPIKE IN U.P. NO. 140 ELEV. 89.02

NOTE: INSTALL 34.1.0 W/ SHOP BENT (TRAILING END & CURVED SECTION)

PLAN SCALE: 1"=30'

** R&D SECTION OF 8" U.D. & ATTACH 12" FES TO EXISTING 8" UD (MORTAR CONNECTION TO INSURE A WATERTIGHT SEAL)

NOTE: S.H.L. HAS BEEN ADJUSTED AS PER RI CONTRACTS 3201 & 4602

NOTE: REMOVAL AND DISPOSAL OF STONE CURBING SHALL BE PAID FOR UNDER ITEM CODE 202.0300

MAINTAIN OPEN CHANNEL FLOW GRADE TO PROPOSED FES

S:\Design\Highways\DeRotto\LAND PROJECTS\Danielson Pike.dwg, Danielson Pike.dwg 4/13/2011 3:46:54 PM EDT

