

Plans

Issued for: **Request for Preliminary Determination**

Date Issued: January 17, 2012

Latest Issue: January 17, 2012

Index

No.	Drawing Title	Latest Issue
C-1	Title Sheet	01-17-2012
C-2	General Notes and Details	01-17-2012
C-3	Rhode Island Reliability Project Plan	01-17-2012

National Grid Rhode Island Reliability Project

Structure T172-138B Proposed Work Pad Expansion
Central Avenue
Johnston, Rhode Island

Environmental Management
JAN 17 2012
Office of Water Resources



Vanasse Hangen Brustlin, Inc.
Transportation
Land Development
Environmental Services

10 Dorrance Street, Suite 400
Providence, Rhode Island 02909
401-272-8100 / FAX 401-273-9694

Owner/Applicant:

The Narragansett Electric Company
d/b/a National Grid
280 Melrose Street
Providence, Rhode Island 02907
508-389-2935 / FAX 508-389-2836

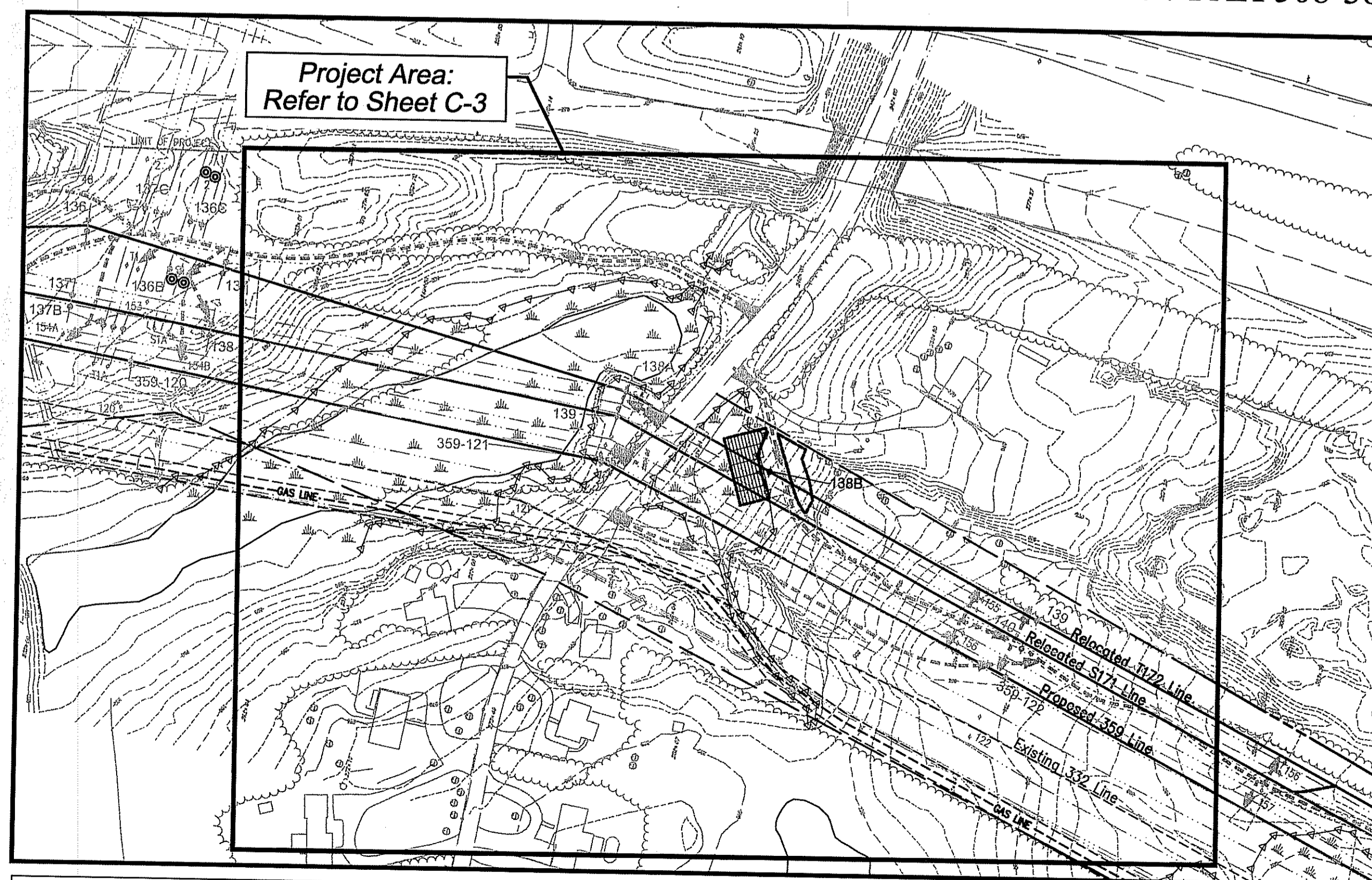

Note:
Plan Depicting the Area also Shown on Sheet C-14 and C-15 of
Application to Alter File No. 09-0163 Plan Set Approved October 15, 2010.

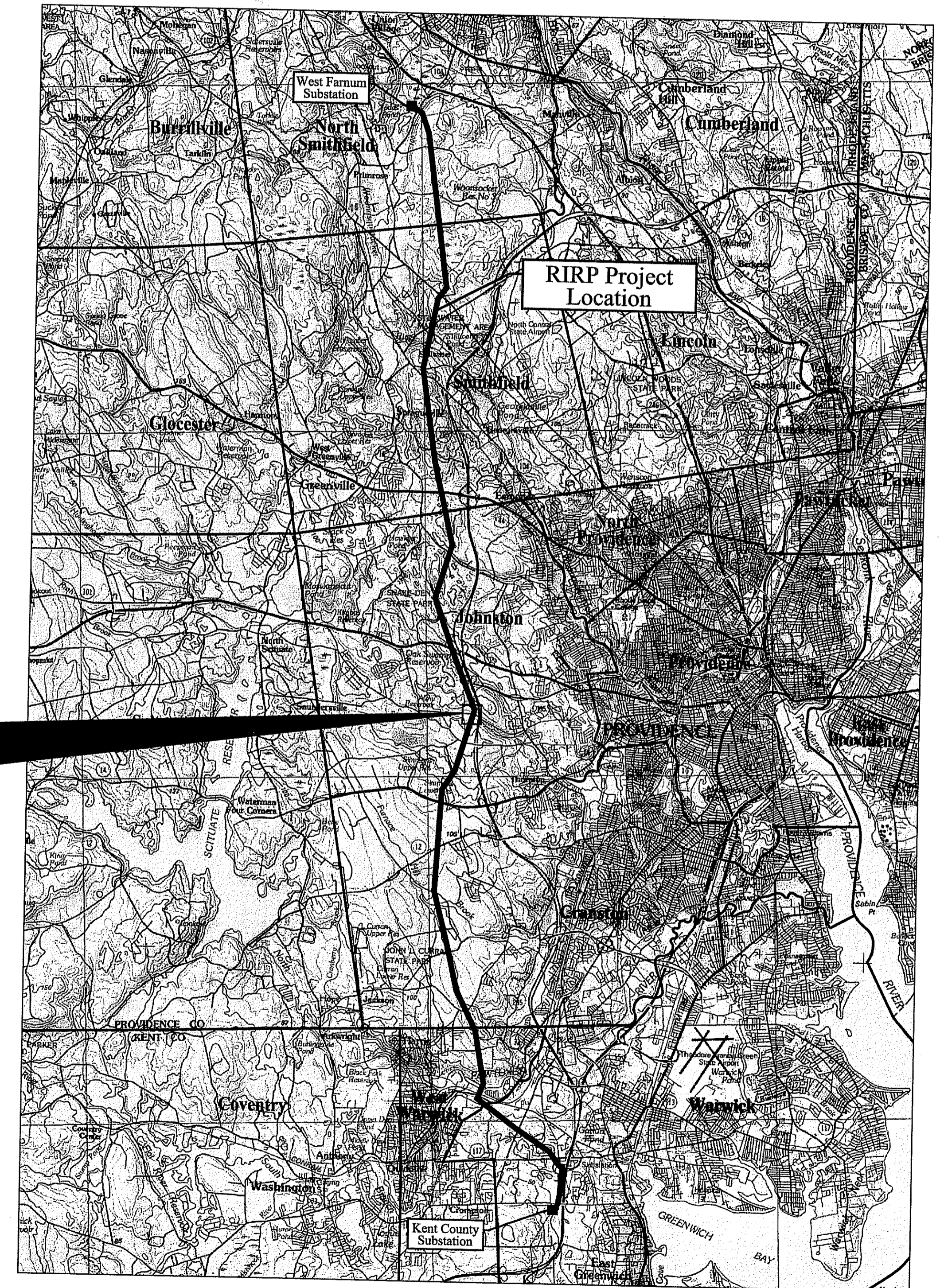

Locus Map

DEPARTMENT OF ENVIRONMENTAL MANAGEMENT
OFFICE OF WATER RESOURCES
FRESHWATER WETLANDS PROGRAM
APPROVED WITH CONDITIONS
AS SPECIFIED IN THE LETTER OF APPROVAL
DATED FEB 1 2012 FILE # 11-0186
NO CHANGES ALLOWED WITHOUT PRIOR APPROVAL
APPROVED PLANS MUST BE AT CONSTRUCTION SITE

