

Locus Map
Not to Scale

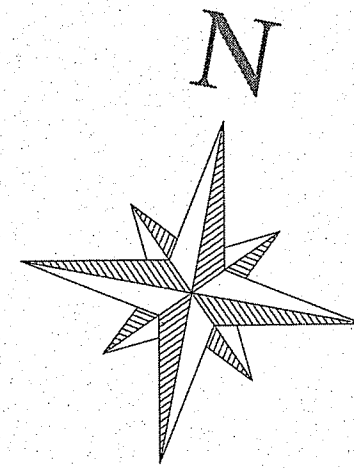

Environmental Management
DEC 20 2011
Office of Water Resources

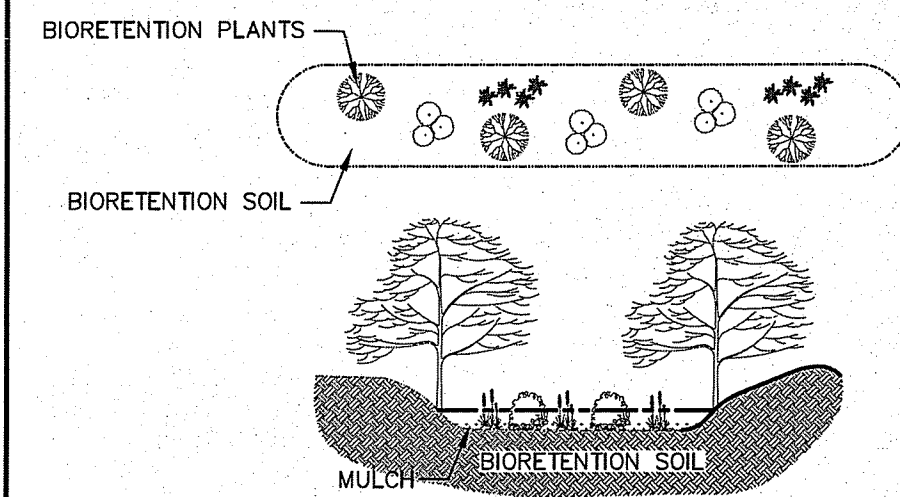
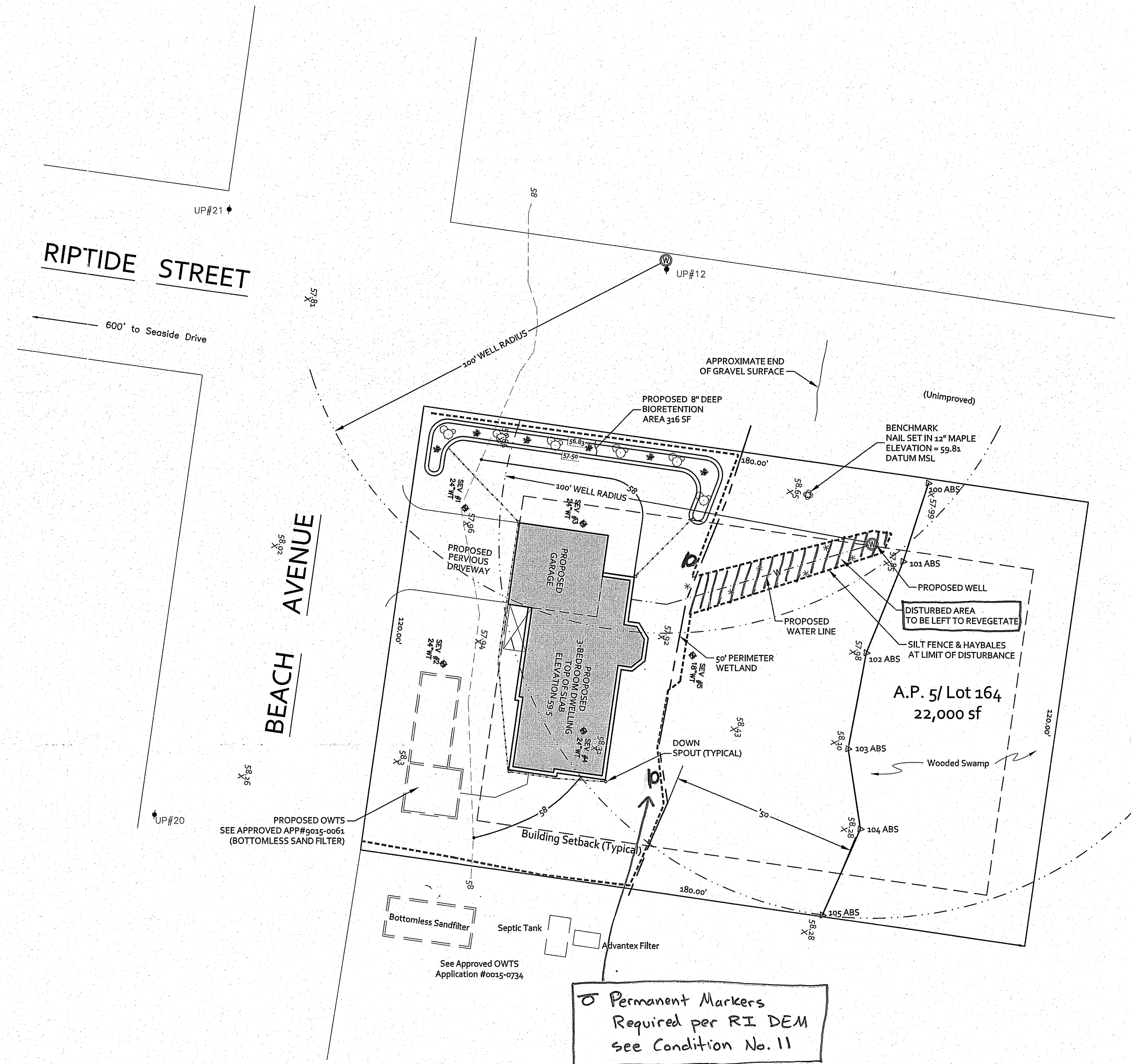

BIORETENTION SOIL MIX

PARAMETER	VALUE
ORGANIC MATERIAL	3 TO 5%
CLAY	0 TO 2%
SILT	8 TO 12%
SAND	85 TO 88%

NOTE:
THE SOIL SHOULD BE FREE STONES, STUMPS, ROOTS, OTHER WOODY MATERIAL OVER 1 INCH IN DIAMETER.

BIORETENTION DETAIL
NOT TO SCALE

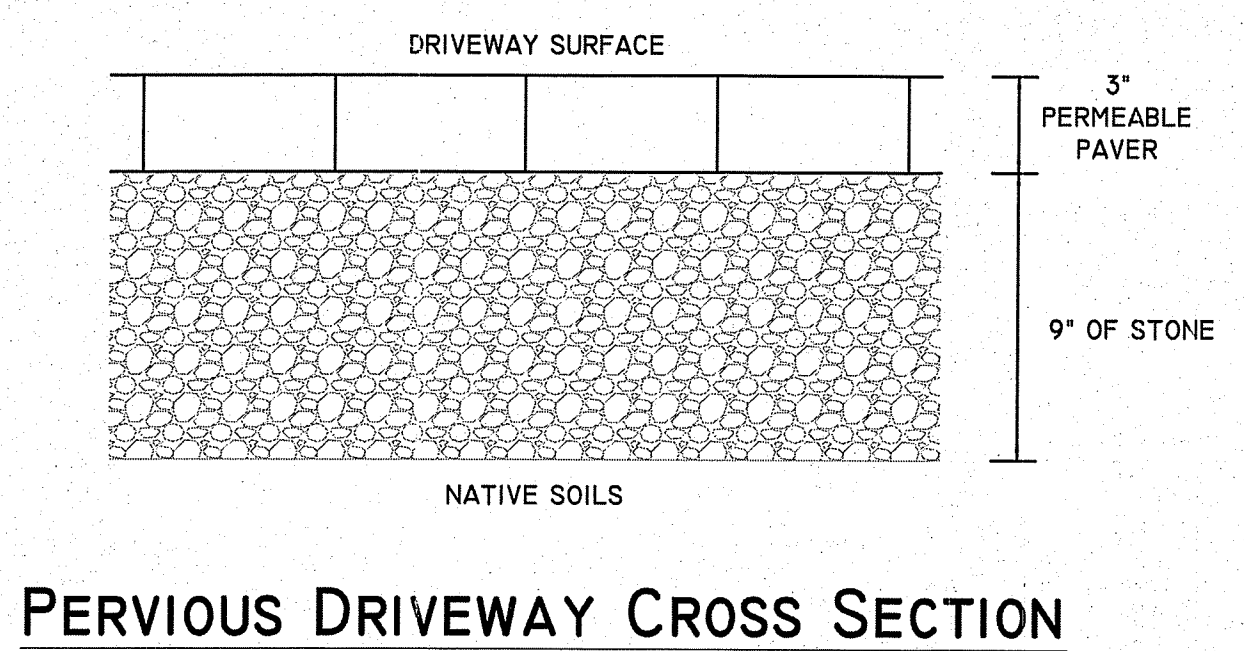
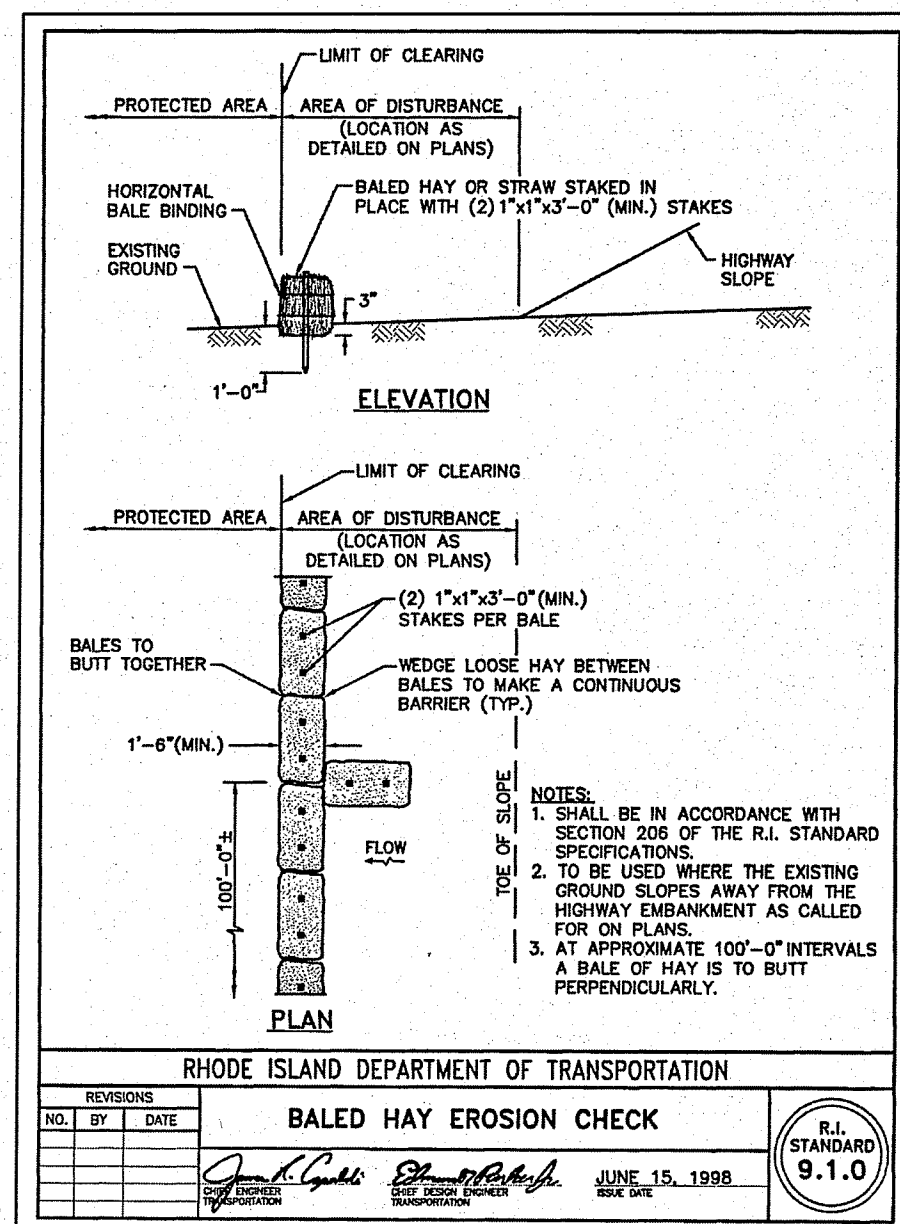

PERVIOUS DRIVEWAY CROSS SECTION

General Notes

- 1.) SITE IS LOCATED WITHIN FLOOD ZONE X ACCORDING TO FLOOD INSURANCE RATE MAP FOR THE CITY OF JAMESTOWN, NEWPORT COUNTY COMMUNITY PANEL NUMBER 44905C006GH. MAP EFFECTIVE DATE APRIL 5, 2010.
- 2.) SUBJECT SITE DOES NOT LIE WITHIN A NATURAL HERITAGE AREA.
- 3.) REFERENCE PLANS ENTITLED:
1. PLAN OF SITE IMPROVEMENTS AT BEACH AVENUE & RIPTIDE STREET IN THE TOWN OF JAMESTOWN, RHODE ISLAND, PREPARED FOR: BARTHOLOMEW CATANZARO, DATE: JUNE 16, 2011, PREPARED BY COVENTRY SURVEY CO., INC, SCALE 1" = 20'.
4.) WETLANDS FLAGGED BY APPLIED BIO SYSTEMS P.O. BOX 985 WEST KINGSTON, RI 02892
- 5.) THE INFORMATION SHOWN ON THIS PLAN WAS OBTAINED BY AN ON-SITE SURVEY. (CLASS III) BY COVENTRY SURVEY CO., PLAN REFERENCED ABOVE "PLAN OF SITE IMPROVEMENTS AT BEACH AVENUE & RIPTIDE STREET."
- 6.) FOOTPRINT OF PROPOSED DWELLING, GARAGE AND PORCH IS 1,961 SQUARE FEET.
- 7.) SEE WETLANDS PERMIT # 03-0564 (EXPIRED)

Suggested Bioretention Area Plantings

	Common Name	Scientific Name
Shrubs:	Low bush blueberry	(<i>Vaccinium angustifolium</i>)
	Red-twig dogwood	(<i>Cornus sericea</i>)
	Arrowwood	(<i>Viburnum dentatum</i>)
Herbaceous:	Black-eyed susan (slope-sun)	(<i>Rudbeckia laciniata</i>)
	New England aster (slope-sun)	(<i>Aster novae-angliae</i>)
	Daylily (slope-sun/partial shade)	(<i>H. hemerocallidaceae</i>)

Shrub plantings will include a variety of the suggested plantings or equivalent 5 feet on center in staggered rows interspersed with a mix of suggested herbaceous plantings. Shrubs will be a minimum of 1 1/2 feet tall / 1 gallon pots or balled and burlapped. All planting areas will be mulched with undyed shredded hardwood mulch after planting. Any shrubs that do not survive within 1 year will be replaced with similar species

R40 Zoning Data

Minimum Lot Area	40,000 SF
Minimum Frontage	150'
Maximum Front Yard	40'
Maximum Side Yard	20'
Minimum Rear Yard	30'
Lot Coverage	25%

DEPARTMENT OF ENVIRONMENTAL MANAGEMENT
OFFICE OF WATER RESOURCES
FRESHWATER WETLANDS PROGRAM
APPROVED WITH CONDITIONS
AS SPECIFIED IN THE LETTER OF APPROVAL
DATED JAN 13 2012 FILE # 11-0199
NO CHANGES ALLOWED WITHOUT PRIOR APPROVAL
APPROVED PLANS MUST BE AT CONSTRUCTION SITE

Nancy L. Freeman

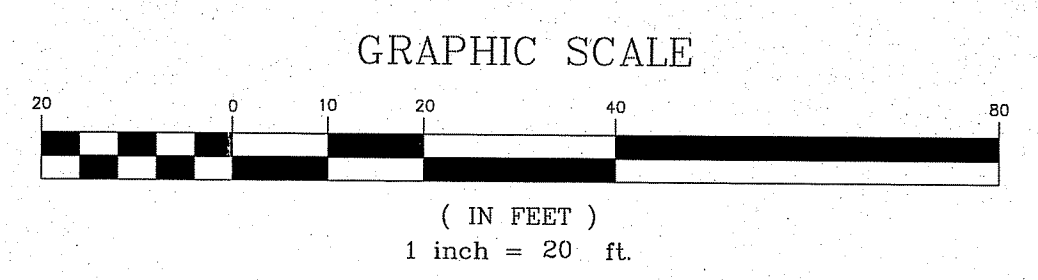

Island Engineering, LLC
ENGINEERING - SURVEYING - ENVIRONMENTAL
P.O. BOX 597
JAMESTOWN, RHODE ISLAND 02835
PHONE: (401) 423-1470
www.islandengineeringri.com

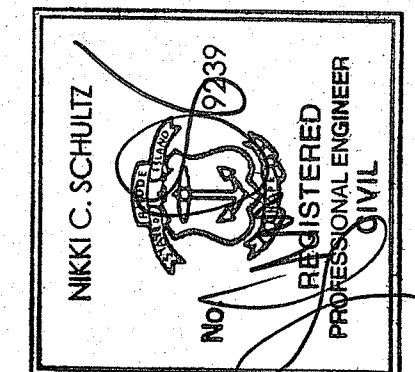

Drainage - Site Plan

Prepared for:
Bartholomew & Marjorie
Catanzaro
3 Woodcrest Drive
Johnston, RI 02919

Property Location:
Bartholomew Catanzaro
AP 5 Lot 164
Beach Avenue
Jamestown, Rhode Island

Revised: 11/29/2011
Job No. 10014.2011.A
Date: 8/15/2011
DRAWN BY: C.A.C.
CHECKED BY:
SCALE: 1" = 20'
SHEET # 1 of 1

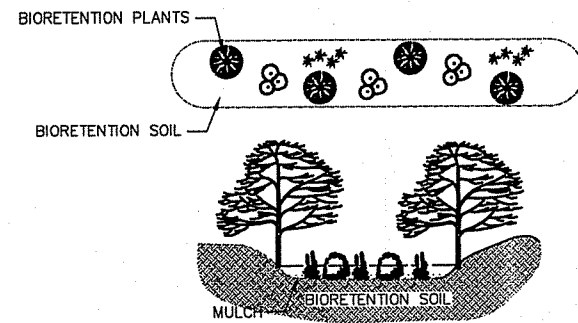
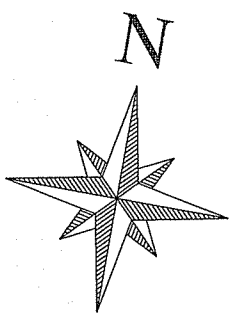
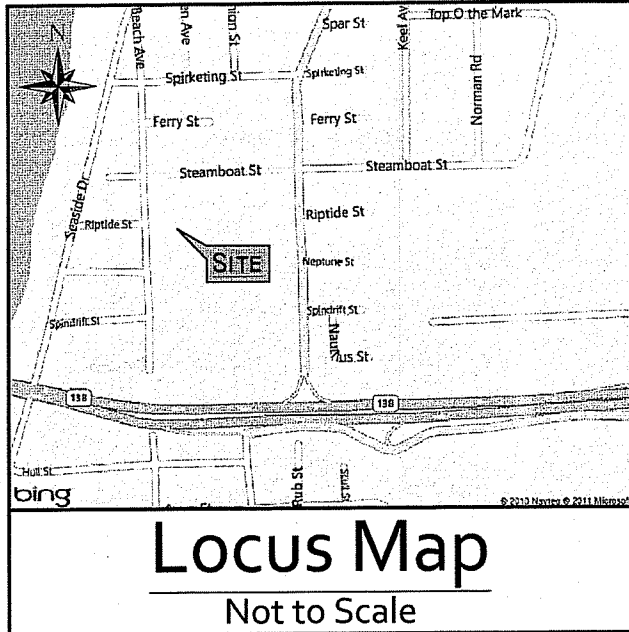

BIORETENTION SOIL MIX

PARAMETER	VALUE
ORGANIC MATERIAL	3 TO 5%
CLAY	0 TO 2%
SILT	8 TO 12%
SAND	85 TO 88%

NOTE: THE SOIL SHOULD BE FREE STONES, STUMPS, ROOTS, OTHER WOODY MATERIAL OVER 1 INCH IN DIAMETER.

BIORETENTION DETAIL
NOT TO SCALE

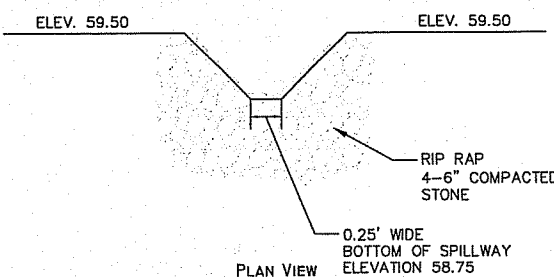
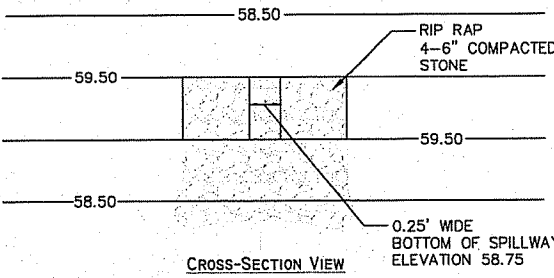

EMERGENCY SPILLWAY DETAIL
NOT TO SCALE

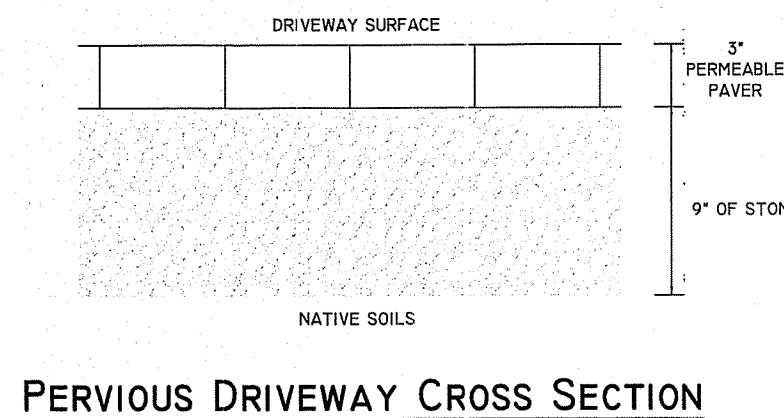
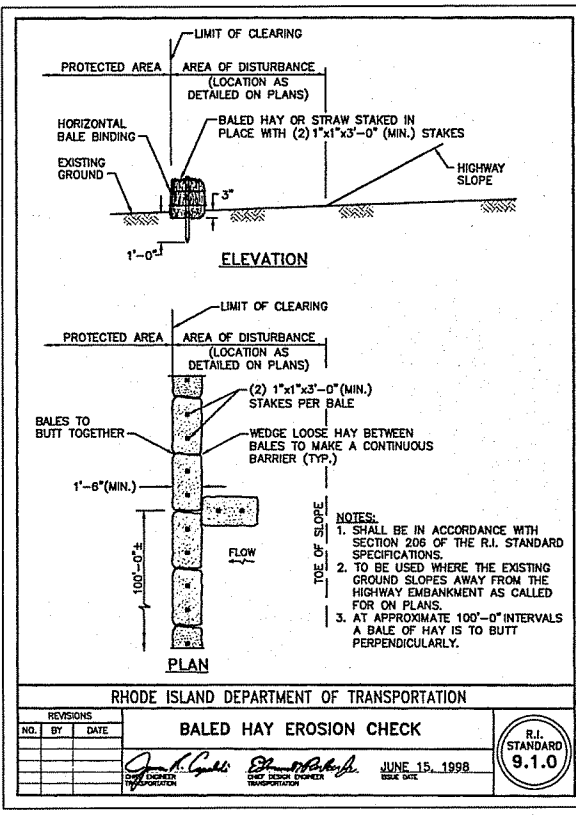

PERVIOUS DRIVEWAY CROSS SECTION

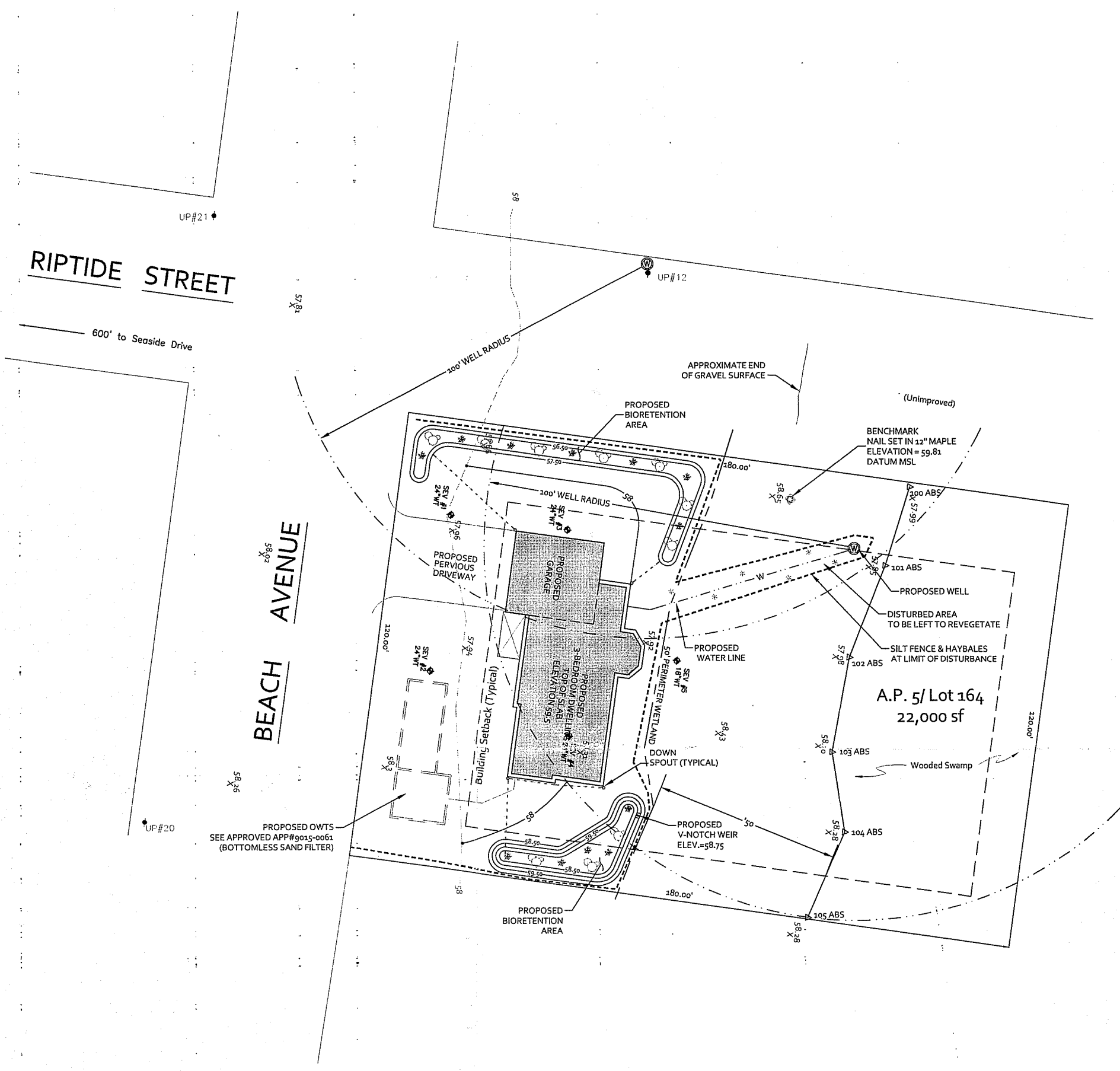

Environmental Management
OCT 19 2011
Office of Water Resources

General Notes

- 1.) SITE IS LOCATED WITHIN FLOOD ZONE X ACCORDING TO FLOOD INSURANCE RATE MAP FOR THE CITY OF JAMESTOWN, NEWPORT COUNTY COMMUNITY PANEL NUMBER 44005C006GH. MAP EFFECTIVE DATE APRIL 5, 2010.
- 2.) SUBJECT SITE DOES NOT LIE WITHIN A NATURAL HERITAGE AREA.
- 3.) REFERENCE PLANS ENTITLED:
1. PLAN OF SITE IMPROVEMENTS AT BEACH AVENUE & RIPTIDE STREET IN THE TOWN OF JAMESTOWN, RHODE ISLAND, PREPARED FOR: BARTHOLOMEW CATANZARO, DATE: JUNE 16, 2011, PREPARED BY COVENTRY SURVEY CO., INC, SCALE 1" = 20'.
- 4.) WETLANDS FLAGGED BY APPLIED BIO SYSTEMS P.O. BOX 985 WEST JONSTON, RI 02892.
- 5.) THE INFORMATION SHOWN ON THIS PLAN WAS OBTAINED BY AN ON-SITE SURVEY. (CLASS III) BY COVENTRY SURVEY CO., PLAN REFERENCED ABOVE "PLAN OF SITE IMPROVEMENTS AT BEACH AVENUE & RIPTIDE STREET."
- 6.) FOOTPRINT OF PROPOSED DWELLING, GARAGE AND PORCH IS 1,961 SQUARE FEET.
- 7.) SEE WETLANDS PERMIT # 03-0564 (EXPIRED)

Suggested Bioretention Area Plantings

Common Name	Scientific Name
Shrubs:	
Low bush blueberry	<i>(Vaccinium angustifolium)</i>
Red-twig dogwood	<i>(Cornus sericea)</i>
Arrowwood	<i>(Viburnum dentatum)</i>

Herbaceous:	
Black-eyed susan (slope-sun)	<i>(Rudbeckia laciniata)</i>
New England aster (slope-sun)	<i>(Aster novae-angliae)</i>
Daylily (slope-sun/partial shade)	<i>(H. hemerocallidaceae)</i>

Shrub plantings will include a variety of the suggested plantings or equivalent 5 feet on center in staggered rows interspersed with a mix of suggested herbaceous plantings. Shrubs will be a minimum of 1 1/4 feet tall / 1 gallon pots or balled and burlapped. All planting areas will be mulched with undyed shredded hardwood mulch after planting. Any shrubs that do not survive within 1 year will be replaced with similar species

R40-Zoning Data

Minimum Lot Area	40,000 SF
Minimum Frontage	150'
Maximum Front Yard	40'
Maximum Side Yard	20'
Minimum Rear Yard	30'
Lot Coverage	25%

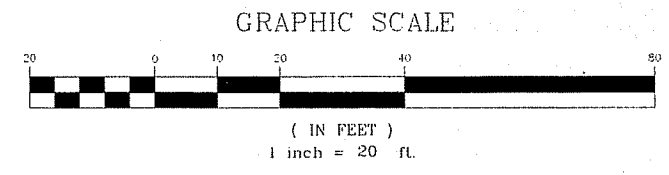

Island Engineering, LLC
ENGINEERING - SURVEYING - ENVIRONMENTAL
P.O. BOX 597
JAMESTOWN, RHODE ISLAND 02835
PHONE: (401) 423-1470
www.islandengineeringri.com

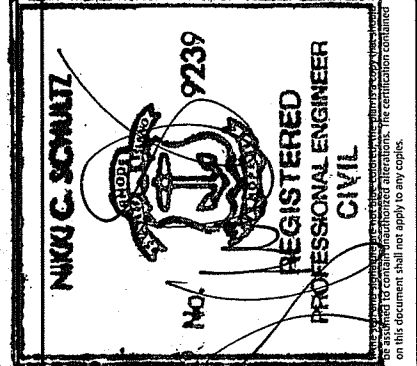

Drainage - Site Plan

Prepared for:
Bartholomew & Marjorie
Catanzaro
3 Woodcrest Drive
Johnston, RI 02919

Property Location:
Bartholomew Catanzaro
AP 5 Lot 164
Beach Avenue
Jamestown, Rhode Island

Job No. 10014.2011.A

Date: 8/15/2011

DRAWN BY: C.A.C.
CHECKED BY:

SCALE: 1" = 20'

SHEET # 1 of 1

76-7-11