

Map of the study area

The map shows the location of the site, which is marked with a black box and labeled "SITE". The site is located on the east side of the map, near the intersection of Carson Ave and Ruthenford Ave. The map includes a north arrow and a scale bar (0 to 100 feet). Various streets are labeled, including Old East Ave, Greenfield Ave, Thomas Ave, Main St, Greene Ln, Carson Ave, Ruthenford Ave, Lancaster Ave, Montgomery St, Ontario Ave, Central St, and Conville St. A building labeled "Environmental Management Office of Water Resources" is shown with a date stamp "NOV 4 2011". A large body of water is labeled "Gorton Lake".

INDEX OF DRAWINGS

<u>DRAWING No.</u>	<u>PLAN</u>
C0	COVER SHEET
C1	GENERAL NOTES and LEGEND
C2	EXISTING CONDITIONS PLAN
C3	DRAINAGE and UTILITY PLAN
C4	PROFILE PLAN No. 1
C5	PROFILE PLAN No. 2
C6	SOIL EROSION and SEDIMENT CONTROL PLAN
C7	MISCELLANEOUS DETAILS No. 1
C8	MISCELLANEOUS DETAILS No. 2
C9	MISCELLANEOUS DETAILS No. 3
C10	MISCELLANEOUS DETAILS No. 4

DEPARTMENT OF ENVIRONMENTAL MANAGEMENT
OFFICE OF WATER RESOURCES
FRESHWATER WETLANDS PROGRAM
APPROVED WITH CONDITIONS
AS SPECIFIED IN THE LETTER OF APPROVAL
NOV 17 2011. FILE # 11-0709
DATED
NO CHANGES ALLOWED WITHOUT PRIOR APPROVAL
APPROVED PLANS MUST BE AT CONSTRUCTION SITE.

STEVEN M. CABRAL

No. 4847

REGISTERED
PROFESSIONAL ENGINEER

PREPARED FOR:

- Civil
- Transportation
- Environmental
- Site Planning
- Land Surveying

CROSSMAN ENGINEERING
| a division of Crossman Corporation |

151 Centerville Road | Warwick, Rhode Island 02886
Phone: (401) 738-5660 | Fax: (401) 738-8157

Email: cei@crossmaneng.com

OCTOBER 2011
SHEET 1 of 11

AGENCY REVIEW SUBMISSION

REVISIONS:

[illegible]

NOTES:
 BASE PLANS COMPILED FROM CAD DRAWING FILES PROVIDED BY THE CITY OF WARWICK DEPARTMENT OF PUBLIC WORKS. SUPPLEMENTAL GROUND SURVEY PERFORMED BY CROSSMAN ENGINEERING ALONG PORTIONS OF BANGOR STREET, LANCASTER AVENUE AND GREENWICH AVENUE IN JULY OF 2010.



GRAPHIC SCALE
 (IN FEET)
 1 inch = 40 ft.

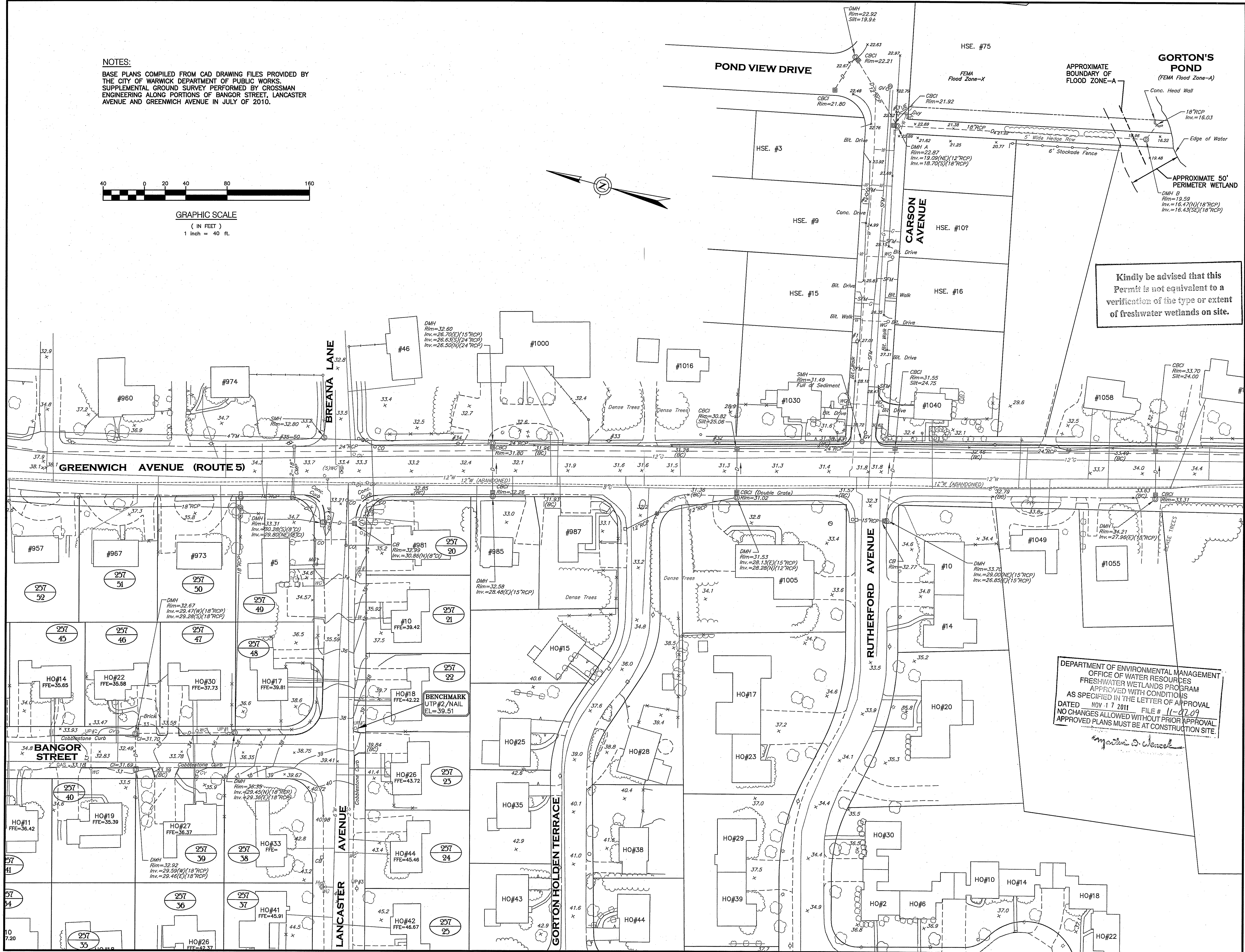
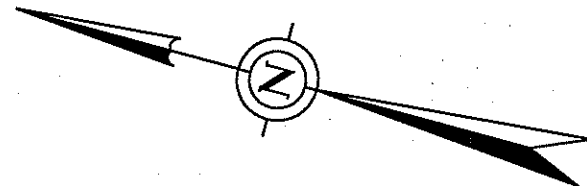

Kindly be advised that this Permit is not equivalent to a verification of the type or extent of freshwater wetlands on site.

DEPARTMENT OF ENVIRONMENTAL MANAGEMENT
 OFFICE OF WATER RESOURCES
 FRESHWATER WETLANDS PROGRAM
 APPROVED WITH CONDITIONS
 AS SPECIFIED IN THE LETTER OF APPROVAL
 DATED NOV 17 2011 FILE # 11-0209
 NO CHANGES ALLOWED WITHOUT PRIOR APPROVAL
 APPROVED PLANS MUST BE AT CONSTRUCTION SITE.

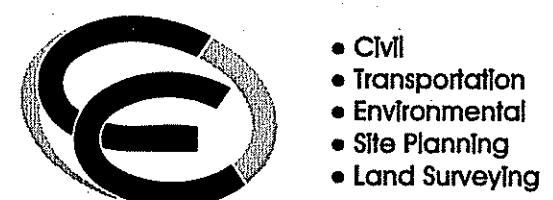

CROSSMAN ENGINEERING
 a division of Crossman Corporation
 151 Centerville Road | Warwick, Rhode Island, 02886
 Phone: (401) 738-5660 | Fax: (401) 738-5157
 Email: cel@crossmaneng.com

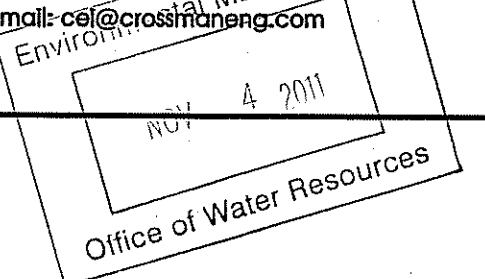

PROJECT TITLE:
 DRAINAGE IMPROVEMENTS
 TO
 BANGOR STREET
 WARWICK, RHODE ISLAND

PREPARED FOR:
 DAVID PICOZZI
 PUBLIC WORKS DIRECTOR
 CITY OF WARWICK
 925 SANDY LANE
 WARWICK, RHODE ISLAND
 02889

DRAWING TITLE:
 EXISTING CONDITIONS PLAN

DATE: OCTOBER 2011 SCALE: 1"=40'
 DWG. NAME: 1624.19-C02-EXCN.dwg

REVISIONS	NUMBER	REMARKS	DATE

DRAWING NUMBER
C2
 SHEET: 3 OF 11
 AGENCY REVIEW SUBMISSION

NOTES:

1. ALL WATER SYSTEM INSTALLATION, JOINTS, CONSTRUCTION METHODS AND MATERIALS SHALL CONFORM TO THE CURRENT RULES AND REGULATIONS OF THE KENT COUNTY WATER AUTHORITY, ANSI/AWWA C600 STANDARDS, THE DUCTILE IRON PIPE RESEARCH ASSOCIATIONS INSTALLATION MANUAL AND GOVERNMENTAL REQUIREMENTS.
2. ANY CONFLICT WITH THE EXISTING WATER SYSTEM MUST BE BROUGHT TO THE ATTENTION OF THE ENGINEER PRIOR TO ANY CONSTRUCTION.
3. BOLTED COVERS FOR CATCH BASINS CONVERTED TO MANHOLES SHALL BE NEENAH FOUNDRY R-1915-H SERIES HEAVY DUTY WATERTIGHT MANHOLE FRAME AND BOLTED LID OR EQUAL.
4. ALL DRAINAGE AND UTILITY COVERS AND GRATES NOT WITHIN THE COLD PLANE AREAS SHALL BE ADJUSTED PRIOR TO PAVING PLACED ELASTOMERIC SURFACE TREATMENT (PPEST).
5. ANY CONFLICT WITH THE EXISTING SEWER SYSTEM MUST BE BROUGHT TO THE ATTENTION OF THE ENGINEER PRIOR TO ANY CONSTRUCTION.
6. ALL SEWER SYSTEM CONSTRUCTION MUST CONFORM TO THE CURRENT RULES AND REGULATIONS OF THE WARWICK SEWER AUTHORITY.



GRAPHIC SCALE
(IN FEET)
1 inch = 40 ft.

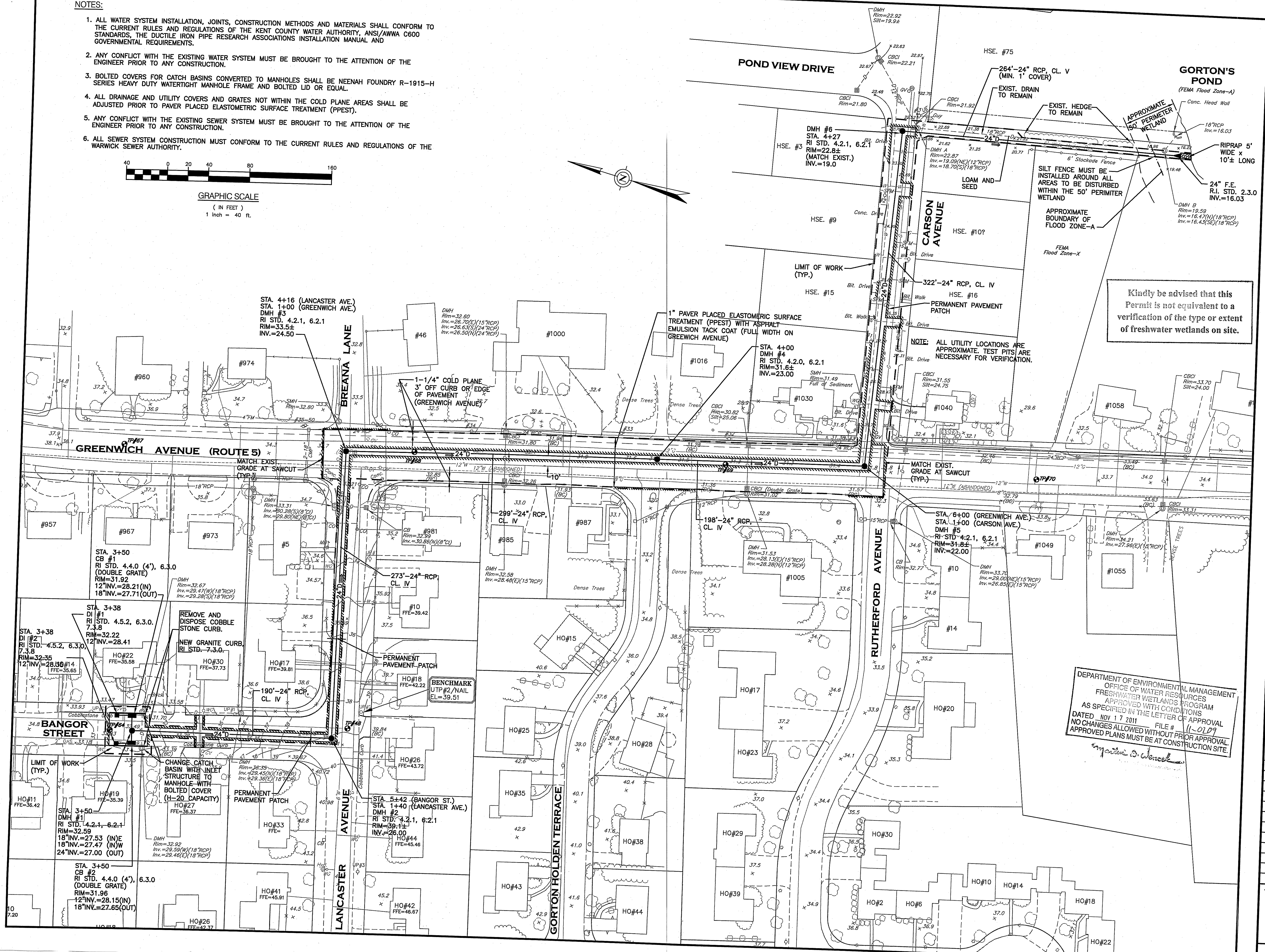

CROSSMAN ENGINEERING
a division of Crossman Corporation

151 Centerville Road | Warwick, Rhode Island 02886
Phone: (401) 738-5660 | Fax: (401) 738-5177
Email: ce@crossmaneng.com

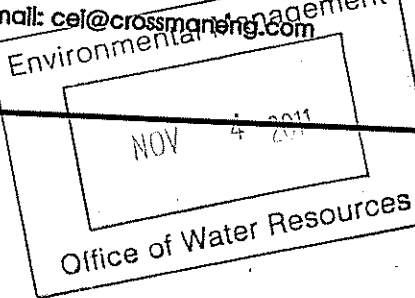

STEVEN M. CABRAL

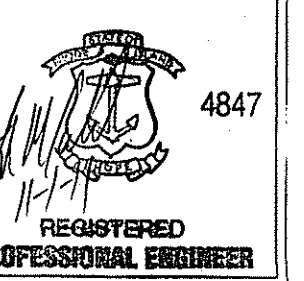

PROJECT TITLE:

**DRAINAGE IMPROVEMENTS
TO
BANGOR STREET
WARWICK, RHODE ISLAND**

PREPARED FOR:

**DAVID PICOZZI
PUBLIC WORKS DIRECTOR
CITY OF WARWICK
925 SANDY LANE
WARWICK, RHODE ISLAND
02889**

DRAWING TITLE:

DRAINAGE AND UTILITY PLAN

DATE:

OCTOBER 2011

SCALE:

1"=40'

DWG. NAME:

1624.19-C03-UTILITY.dwg

REVISIONS

NUMBER

REMARKS

DATE

DRAWING NUMBER

C3

SHEET: 4 OF 11

AGENCY REVIEW SUBMISSION

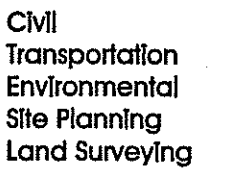

51 Centerville Road | Warwick, Rhode Island 02886
Phone: (401) 738-5660 | Fax: (401) 738-8157

mail: cel@crossmaneng.com

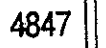
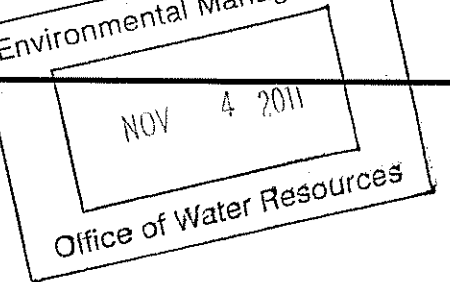

PREPARED FOR:

DRAWING TITLE:

DATE: _____

OCTOBER 2011

SALE:

AS SHOWN

WG. NAME: 1884

24.19-C04-PROFILE1.dwg

REVISIONS

[illegible]

RAWING NUMBER

C4

PAGE: 5 OF 11

AGENCY REVIEW SUBMISSION

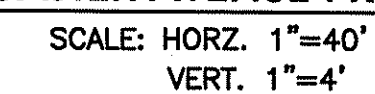

DEPARTMENT OF ENVIRONMENTAL MANAGEMENT
OFFICE OF WATER RESOURCES
FRESHWATER WETLANDS PROGRAM
APPROVED WITH CONDITIONS
AS SPECIFIED IN THE LETTER OF APPROVAL
DATED NOV 17 2011 FILE # 11-0209
NO CHANGES ALLOWED WITHOUT PRIOR APPROVAL.
APPROVED PLANS MUST BE AT CONSTRUCTION SITE.

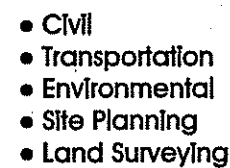

151 Centerville Road | Warwick, Rhode Island 0288
Phone: (401) 738-5660 | Fax: (401) 738-8157

151 Centerville Road | Warwick, Rhode Island 0288
Phone: (401) 738-5660 | Fax: (401) 738-8157

Email: cel@crossmaneng.com

Environmental Management

MON 4 20

Office of Water Resources

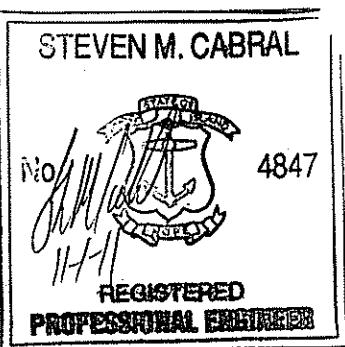

PROJECT TITLE:

DRAINAGE IMPROVEMENTS
TO
BANGOR STREET
WARWICK, RHODE ISLAND

PREPARED FOR

DAVID PICOZZI
PUBLIC WORKS DIRECTOR
CITY OF WARWICK
925 SANDY LANE
WARWICK, RHODE ISLAND
02889

DRAWING TITLE

PROFILE PLAN No. 2

DATE:
OCTOBER 2011

SCALE:
AS SHOWN

DWG. NAME:
1624.19-C05-PROFILE2.dwg

REVISIONS

DEPARTMENT OF ENVIRONMENTAL MANAGEMENT
OFFICE OF WATER RESOURCES
FRESHWATER WETLANDS PROGRAM
APPROVED WITH CONDITIONS
AS SPECIFIED IN THE LETTER OF APPROVAL
DATED NOV 17 2011 FILE # 11-0209
NO CHANGES ALLOWED WITHOUT PRIOR APPROVAL
APPROVED PLANS MUST BE AT CONSTRUCTION SITE

Martin D. Wenzel

DRAWING NUMBER

C5

SHEET: 6 OF: 11

AGENCY REVIEW SUBMISSION

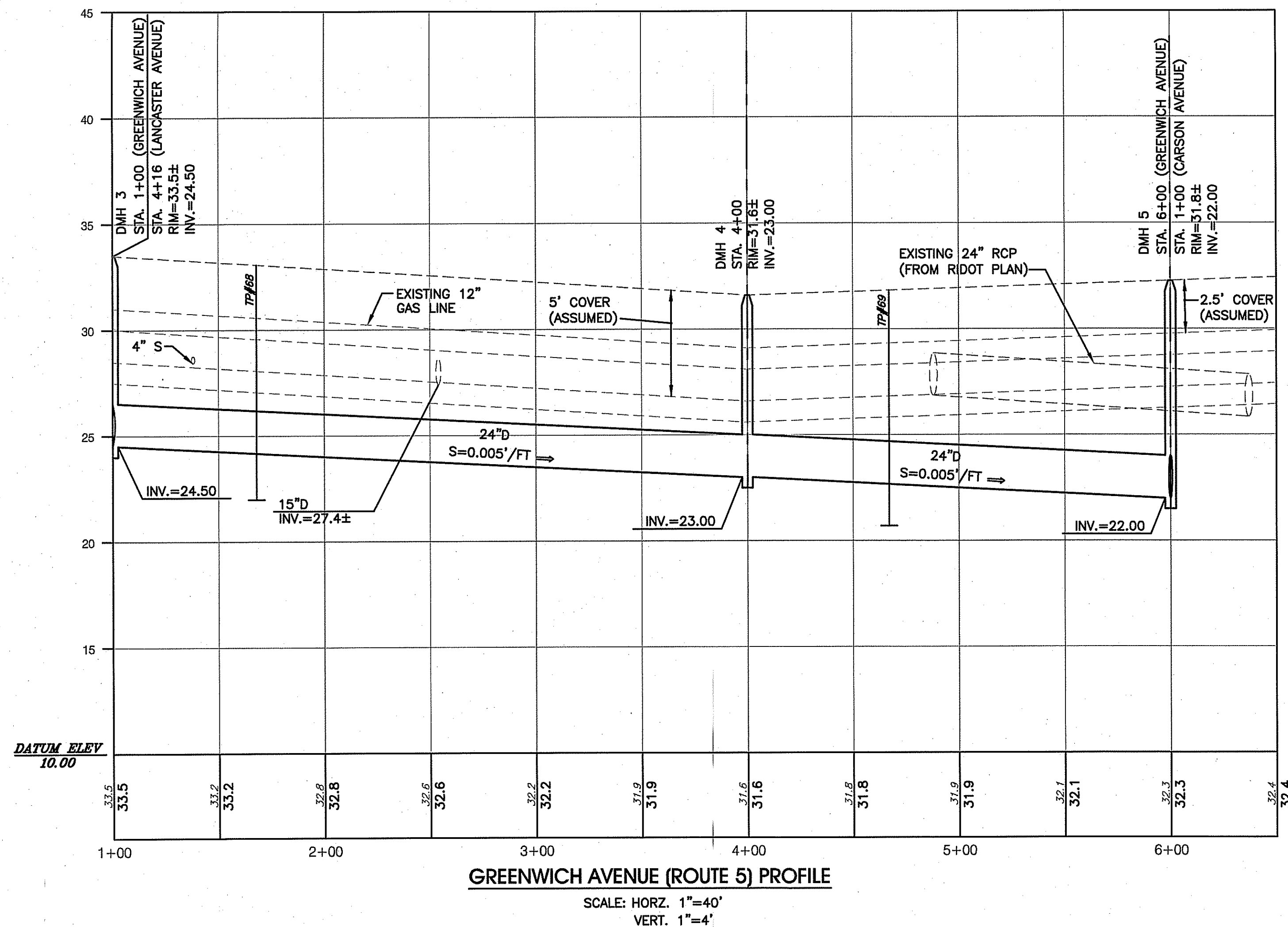

Kindly be advised that this Permit is not equivalent to a verification of the type or extent of freshwater wetlands on site.

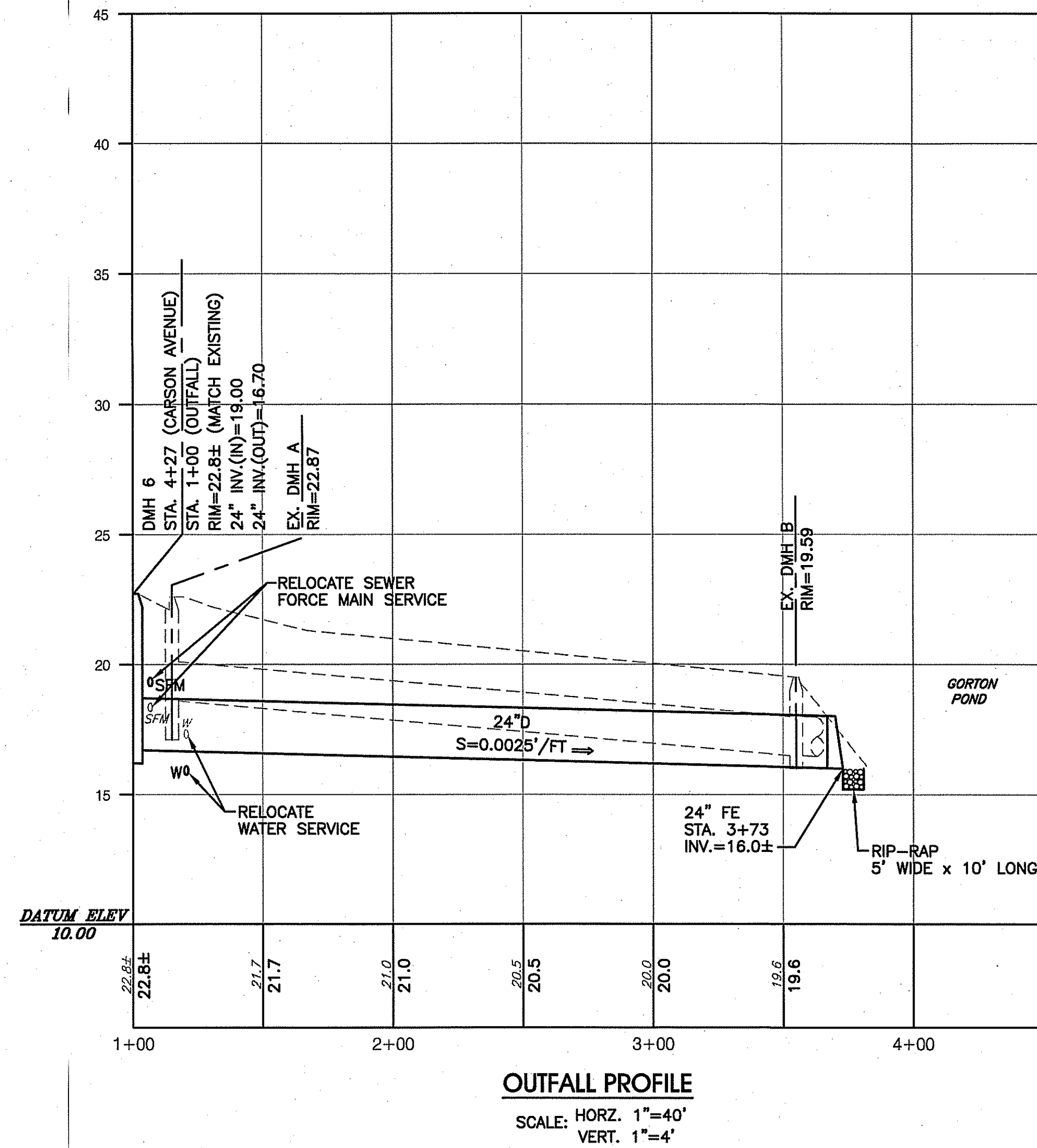
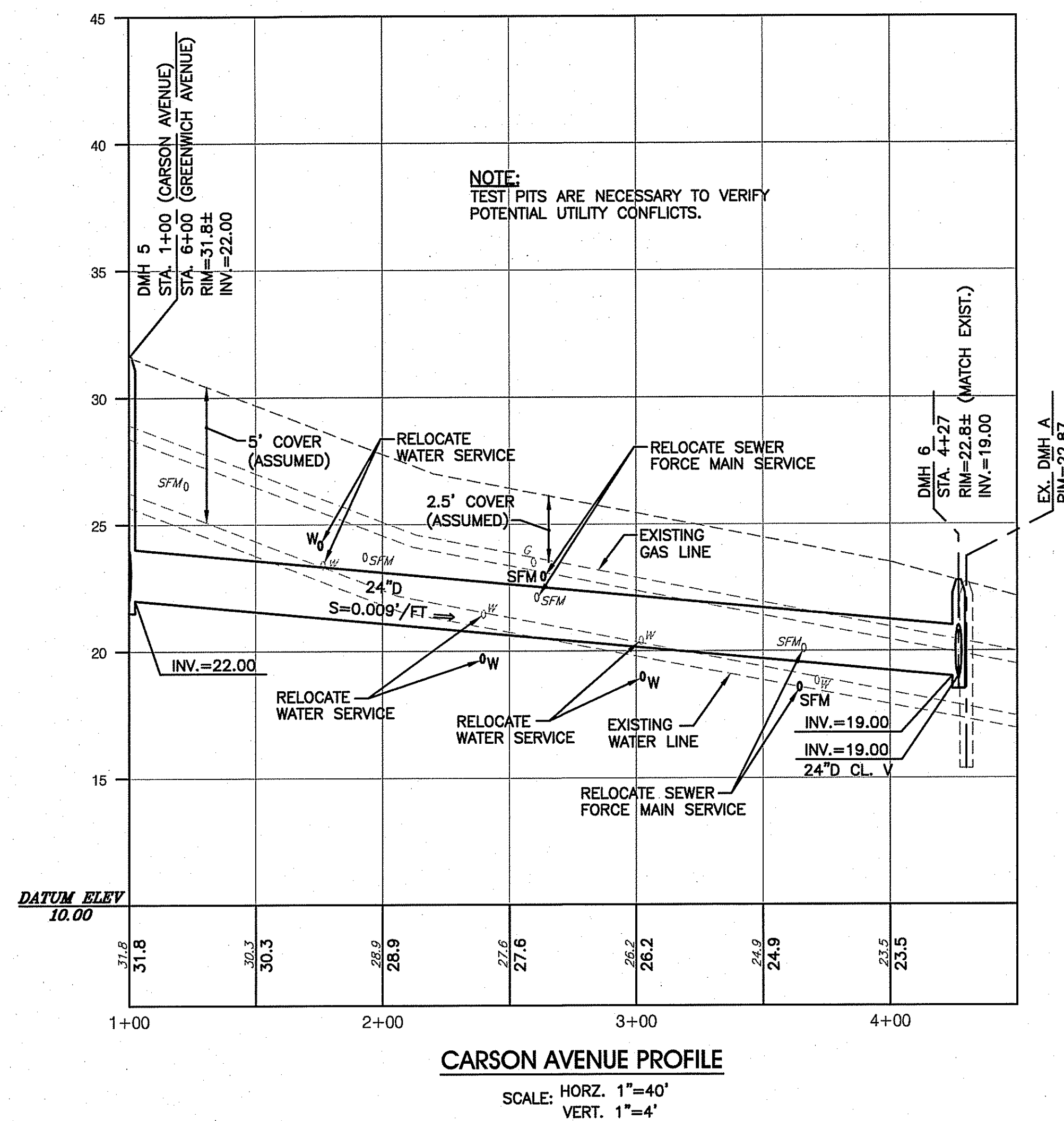

1. EROSION CONTROLS SHALL BE INSTALLED PRIOR TO THE COMMENCEMENT OF CONSTRUCTION, MAINTAINED ON A REGULAR BASIS, AND SHALL BE PLACED TO PREVENT SEDIMENTATION ONTO ADJACENT PROPERTY, FROM ENTERING THE EXISTING DRAINAGE SYSTEM OR REGULATED CREEK OR WATERWAY.
2. THE CONTRACTOR MUST REPLACE AND/OR RESEED ANY VEGETATION THAT DOES NOT DEVELOP/SURVIVE WITHIN THE PERIOD OF ONE YEAR AND HE SHALL DO SO AT NO ADDITIONAL EXPENSE TO THE OWNER.
3. THE NORMAL ACCEPTABLE SEASONAL SEEDING DATES ARE APRIL 1 - OCTOBER 15.
4. ALL TEMPORARY PROTECTION SHALL REMAIN IN PLACE UNTIL AN ACCEPTABLE STAND OF GRASS OR APPROVED GROUND COVER IS ESTABLISHED AND POTENTIAL SEDIMENTATION SOURCES ARE REMOVED.
5. TREES AND OTHER EXISTING VEGETATION SHALL BE RETAINED WHENEVER FEASIBLE. THE AREA BEYOND THE DRUMLINE SHALL BE FENCED OR ROPED OFF TO PROTECT TREES FROM CONSTRUCTION EQUIPMENT.
6. AREAS DAMAGED DURING CONSTRUCTION SHALL BE RESEDED, RESEEDDED, OR OTHERWISE RESTORED AT THE CONTRACTOR'S EXPENSE.
7. STOCKPILES SHALL HAVE A NO SLOPE STEEPER THAN 3:1 AND SHALL BE SURROUNDED BY STAKED HAY BALES, SILT FENCING, SAND BAGS OR COVERED WITH POLY TARP.
8. STOCKPILES EXPOSED FOR EXCESSIVE PERIODS (ONE MONTH) SHALL RECEIVE TEMPORARY TREATMENT CONSISTING OF HAY, STRAW, FIBER MATTING OR COVERED WITH POLY TARPS.
9. ALL CATCH BASINS RECEIVING RUNOFF FROM DISTURBED AREAS SHALL BE PROTECTED BY STAKED HAY BALES, SAND BAGS OR W/RAIP THE GRATES WITH FILTER FABRIC.
10. DURING CONSTRUCTION STOCKPILE LOCATIONS MAY VARY.
11. ALL LANDSCAPED AND SEEDED AREAS SHALL BE APPROPRIATELY WATERED AFTER INSTALLATION. THE CONTRACTOR IS REQUIRED TO INSTALL APPROPRIATE MULCHING METHODS TO AVOID POSSIBLE EROSION DURING THESE WATERING PROCEDURES.
12. THE TOPSOIL SHALL HAVE A SANDY LOAM TEXTURE RELATIVELY FREE OF SUBSOIL, MUD, STONES, ROOTS, LUMPS OF SOIL, TRUCK LUMPS, TRASH OR CONSTRUCTION DEBRIS AND SHALL CONFORM WITH R.I. STANDARD SPECIFICATION M.20.
13. THE SEED MIX SHALL BE INCULCATED WITHIN 24 HOURS, BEFORE MIXING AND PLANTING, WITH APPROPRIATE INOCULUM FOR EACH VARIETY.
14. THE DESIGN MIX SHALL BE COMPRISED OF THE FOLLOWING:

A. - UPLAND AREA:		
MIXTURE	% BY WT.	SEEDING DATES
RED FESCUE	70	APRIL 1 - MAY 30
KENTUCKY BLUEGRASS	15	AUG. 15 - OCT. 15
COLONIAL BENTGRASS	5	
PERENNIAL RYEGRASS	10	

TEMPORARY MULCH MATERIALS AND APPLICATION RATES

ALL HAYBALES, SILT FENCES OR TEMPORARY PROTECTION SHALL REMAIN IN PLACE UNTIL AN ACCEPTABLE STAND OF GRASS OR APPROVED GROUND IS ESTABLISHED. IF NEEDED, TEMPORARY SEEDING CAN HELP TO MINIMIZE EROSION. A TEMPORARY SEEDING GUIDE MUST BE INCLUDED AS A REFERENCE. THE FOLLOWING SPECIES ARE RECOMMENDED:

THE METHODS SHOULD BE REPEATED AS NEEDED, AND SPECIAL ATTENTION MUST BE GIVEN TO THE ACCESS DRIVES.

1. TOTAL AREA OF DISTURBANCE= 1.74+ ACRES.
2. THE PROJECT WILL NOT INCREASE THE AREA OF IMPERVIOUS SURFACES ON THE SITE, AND WILL NOT INCREASE THE STORMWATER RUNOFF FROM THE SITE.
3. NEW BITUMINUMOUS PAVEMENT WILL BE WITHIN EXISTING BITUMINUMOUS PAVEMENT LIMITS. THERE IS NO ADDITIONAL PAVEMENT OR IMPERVIOUS AREAS PROPOSED.
4. NO NEW STORMWATER SOURCES ARE ANTICIPATED TO ENTER THE PROPOSED DRAINAGE SYSTEM.
5. THERE ARE NO KNOWN SEPTIC SYSTEMS LOCATED WITHIN 25 FEET OF THE PROPOSED DRAINAGE SYSTEM.
6. ALL EXCESS MATERIAL FROM THE PROJECT SHALL BE DISPOSED OUT OF R.I.D.E.M. JURISDICTION.

1. PRIOR TO COMMENCING CLEARING AND GRUBBING OPERATIONS, SILT FENCING SHALL BE PLACED SO AS TO PREVENT SEDIMENT FROM ENTERING EXISTING ROADWAY DRAINAGE SYSTEM, ADJUTING PROPERTIES, OR WETLANDS.
2. EXTREME CARE SHALL BE EXERCISED SO AS TO PREVENT ANY UNSUITABLE MATERIAL FROM ENTERING THE ROADWAY DRAINAGE SYSTEM, ADJACENT PROPERTIES, OR WETLANDS.
3. ALL DISTURBED AREAS WHICH BECOME SUBJECT TO EROSION TENDENCIES WHETHER THEY BE NEWLY FILLED OR EXCAVATED SHALL RECEIVE SLOPE PROTECTION, SUCH AS RIP-RAP.
4. DURING CONSTRUCTION, THE CONTRACTOR SHALL BE RESPONSIBLE FOR MAINTAINING DRAINAGE AND RUNOFF FLOW DURING PERIODS OF RAINFALL.
5. DURING CONSTRUCTION, THE CONTRACTOR SHALL BE RESPONSIBLE FOR ALL EROSION CONTROL MAINTENANCE AND SHALL INSPECT / REPLACE DURING CONSTRUCTION, FOLLOWING RAINFALL AND WEEKLY DURING NON CONSTRUCTION PERIODS.
6. ADDITIONAL EROSION CONTROLS SUCH AS SILT FENCING, HAY BALES OR SAND BAGS SHALL BE LOCATED AS CONDITIONS WARRANT OR AS DIRECTED BY THE TOWN, THE CITY, OR ENGINEER.
7. THE "SILT EROSION AND SEDIMENT CONTROL HANDBOOK" PREPARED BY THE U.S. DEPARTMENT OF AGRICULTURE, SOIL CONSERVATION SERVICE, 1989, MUST BE UTILIZED BY THE CONTRACTOR AS A GUIDE.
8. THE CONTRACTOR IS RESPONSIBLE FOR ALL DUST CONTROL AND FOR THE ENTIRE PROJECT DURATION, INCLUDING TEMPORARY SHUT-DOWN PERIODS, MUST MONITOR AND REPAIR, AS NEEDED, ALL SLOPES TO ENSURE A STABLE PRODUCT.
9. THE CONTRACTOR SHALL REMOVE SEDIMENT DEPOSITS ON ALL HAYBALES AND SILT FENCE WHEN DEPOSITS ARE AT ONE-HALF THE HEIGHT OF THE BARRIER.
10. DENUDED SLOPES SHALL NOT BE UNATTENDED OR EXPOSED FOR EXCESSIVE PERIODS OF TIME SUCH AS THE INACTIVE WINTER SEASON.
11. ALL DISTURBED SLOPES EITHER NEWLY CREATED OR EXPOSED PRIOR TO OCTOBER 15, SHALL BE SEED PROTECTED BY THAT DATE FOR ANY WORK COMPLETED DURING EACH CONSTRUCTION YEAR.
12. HAYBALES AND SILT FENCES MUST BE MAINTAINED AND REMAIN IN PLACE UNTIL SUCH A TIME THAT DESIRABLE STAND OF GRASS OR GROUND COVER HAS BEEN ESTABLISHED AND THE PROJECT RECEIVES A FAVORABLE APPROVAL FOR FINAL ACCEPTANCE FROM THE ENGINEER.
13. DURING CONSTRUCTION, THE OPERATOR AND CONTRACTOR ARE REQUIRED TO INSPECT ALL EROSION CONTROLS ON THE SITE AT LEAST EVERY SEVEN (7) CALENDAR DAYS AND WITHIN TWENTY FOUR (24) HOURS AFTER AN EVENT WHICH GENERATES A SIGNIFICANT AMOUNT OF RUNOFF (ONE INCH OR MORE) DURING ANY FOUR (24) HOUR PERIOD AND/OR AFTER A SIGNIFICANT AMOUNT OF RUNOFF.

ON AN AS-NEEDED BASIS OR AS DIRECTED BY THE CITY,
THE CONTRACTOR SHALL UTILIZE ONE OF THE FOLLOWING METHODS (AS
RECOMMENDED BY THE "R.I. EROSION AND SEDIMENT CONTROL HANDBOOK")
TO CONTROL DUST:

B. CALCIUM CHLORIDE SHOULD BE EITHER LOOSE DRY GRANULES OR FLAKES FINE ENOUGH TO FEED THROUGH A SPREADER AT A RATE THAT WILL KEEP SURFACE MOIST BUT NOT CAUSE POLLUTION OR PLANT DAMAGE.

THE METHODS SHOULD BE REPEATED AS NEEDED, AND SPECIAL ATTENTION MUST BE GIVEN TO THE ACCESS DRIVES.

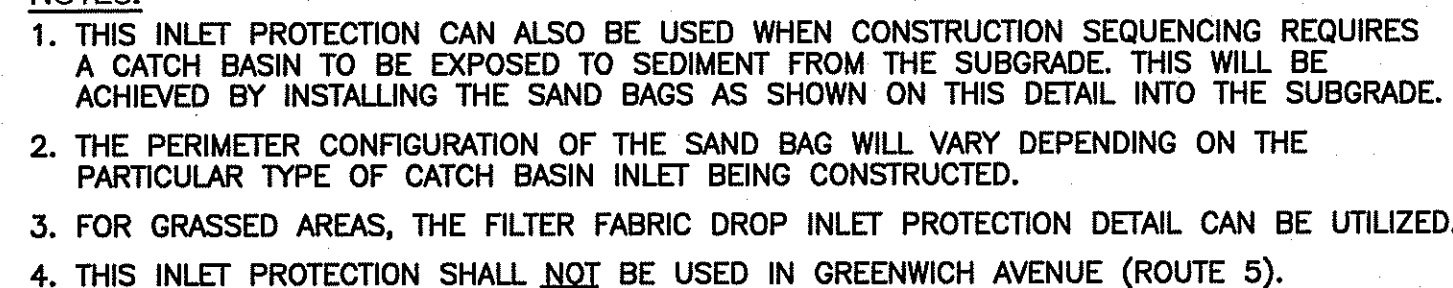

ELEVATION

PLAN

NOTES:

1. SHALL BE IN ACCORDANCE WITH SECTION 208 OF THE R.I. SPECIFICATIONS.
2. TO BE USED WHERE THE EMBANKMENT SLOPES AWAY FROM THE HIGHWAY EMBANKMENT AS SHOWN FOR ON PLANS.
3. AT APPROXIMATE 100'-0" MIN. A BALE OF HAY IS TO BE BUTT PERPENDICULARLY.
4. SILT FENCE MAY BE USED INSTEAD.

BALED HAY EROSION CHECK
NOT TO SCALE

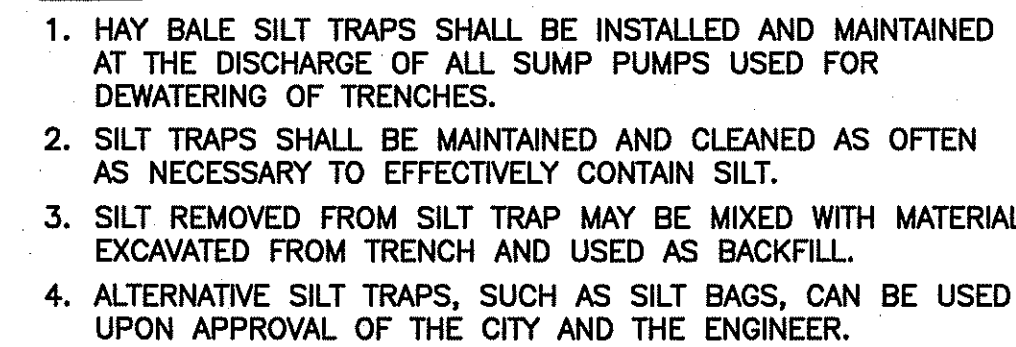

The diagram consists of two parts. The top part shows a perspective view of a rectangular drop inlet with a grate on top, situated in a stream. The bottom part is a cross-sectional view of a wire fence filter. It shows a vertical wire fence supported by stakes. Stakes are also shown on the upstream side. Filter fabric is attached to the stakes on both sides of the fence. Sediment is shown accumulating behind the filter fabric on the upstream side. Filtered runoff is shown passing through the fence and fabric into the downstream channel.

Labels for the top diagram:

- Drop inlet with grate

Labels for the bottom diagram:

- Stakes
- Filter fabric
- Runoff with sediment
- Wire fence
- Filtered runoff
- Buried filter fabric

NOTE: THIS INLET PROTECTION SHALL NOT BE USED IN GREENWICH AVENUE (ROUTE 5).

FIGURE 5-10 * FILTER FABRIC DROP INLET PROTECTION
R.I. SOIL EROSION and SEDIMENT CONTROL HANDBOOK

K
Pe
ver
of f

Kindly be advised that this Permit is not equivalent to a verification of the type or extent of freshwater wetlands on site.

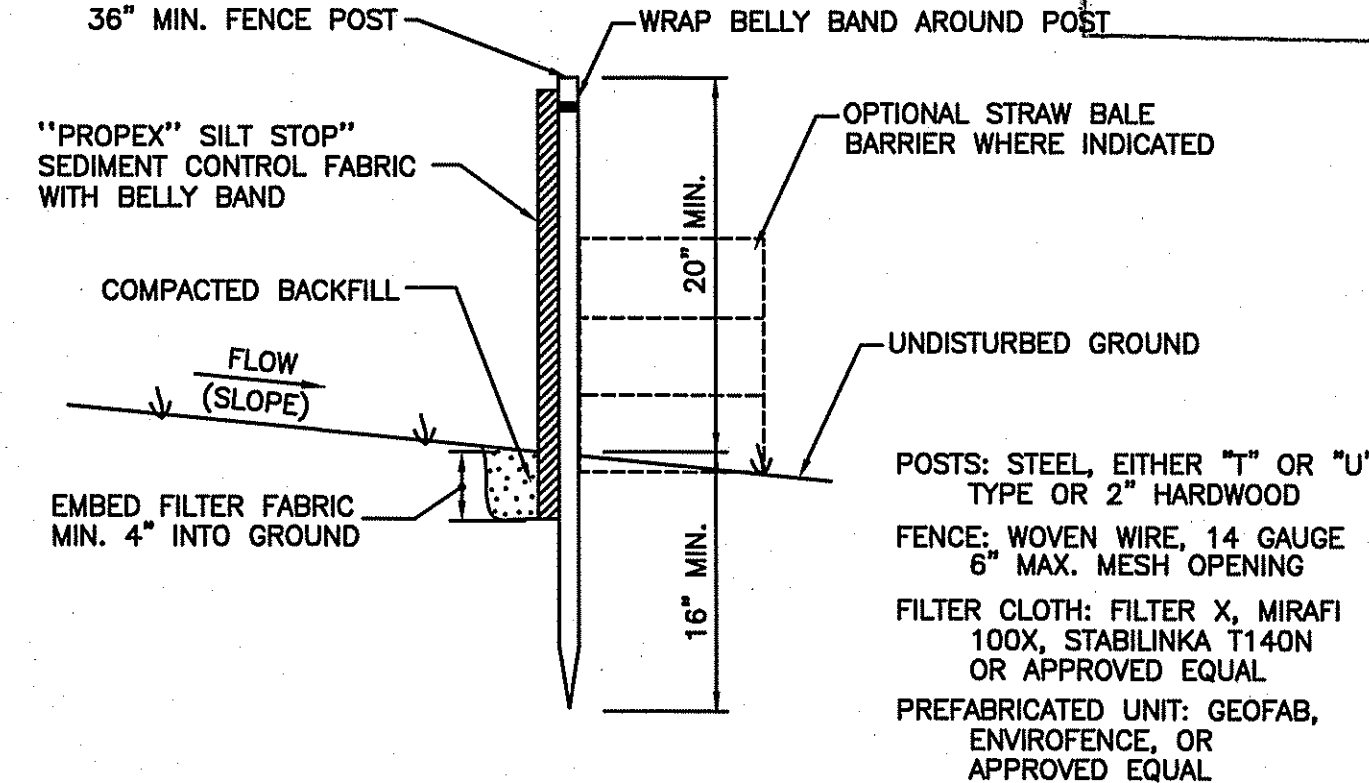

1. WOVEN WIRE FENCE TO BE FASTENED SECURELY TO FENCE POSTS WITH WIRE TIES OR STAPLES.
2. FILTER CLOTH TO BE FASTENED SECURELY TO WOVEN WIRE FENCE WITH TIES SPACED EVERY 24" AT TOP AND MID SECTION.
3. WHEN TWO SECTIONS OF FILTER CLOTH ADJOIN EACH OTHER, THEY SHALL BE OVERLAPPED BY SIX INCHES AND FOLDED.
4. MAINTENANCE SHALL BE PERFORMED AS NEEDED AND MATERIAL REMOVED WHEN "BULGES" DEVELOP IN THE SILT FENCE OR DEPTH OF ACCUMULATED SEDIMENT REACHES 6".
5. BALED HAY EROSION CHECK MAY BE USED IN LIEU OF SILT FENCE.

SILT FENCE DETAIL
NOT TO SCALE

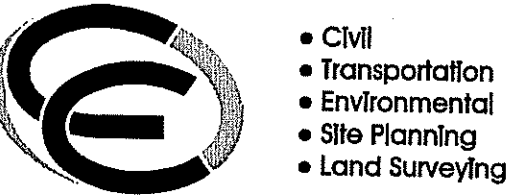

CROSSMAN ENGINEERING
a division of Crossman Corporation
151 Centerville Road | Warwick, Rhode Island 02886
Phone: (401) 738-5560 | Fax: (401) 738-8157
Email: cel@crossmaneng.com

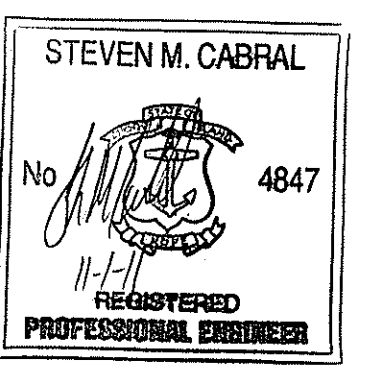
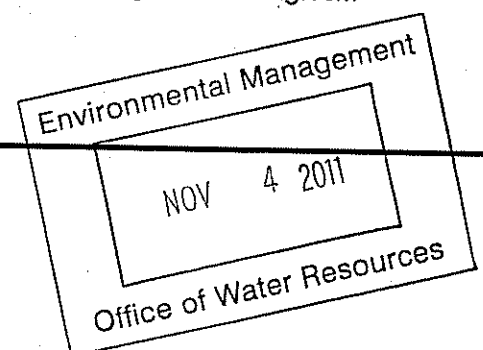

PROJECT TITLE:
**DRAINAGE IMPROVEMENTS
TO
BANGOR STREET
WARWICK, RHODE ISLAND**

PREPARED FOR:
**DAVID PICOZZI
PUBLIC WORKS DIRECTOR
CITY OF WARWICK
925 SANDY LANE
WARWICK, RHODE ISLAND
02889**

DRAWING TITLE:
**MISCELLANEOUS DETAILS
PLAN No. 1**

DATE: OCTOBER 2011 SCALE: AS SHOWN
DWG. NAME: 1624.19-C10-DET2.dwg

REVISIONS		
NUMBER	REMARKS	DATE

DRAWING NUMBER
C7
SHEET: 8 OF 11
AGENCY REVIEW SUBMISSION

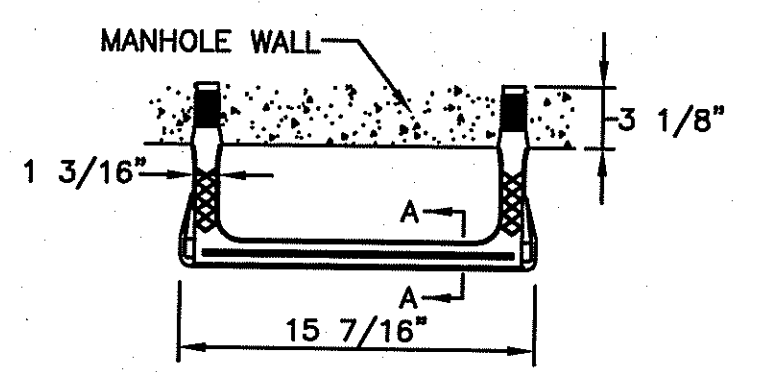

PLAN

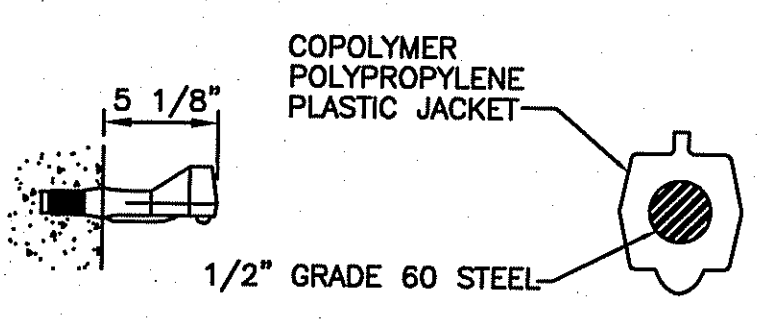

SECTIONAL SIDE VIEW

SECTION A-A

MANHOLE STEP DETAIL
NOT TO SCALE

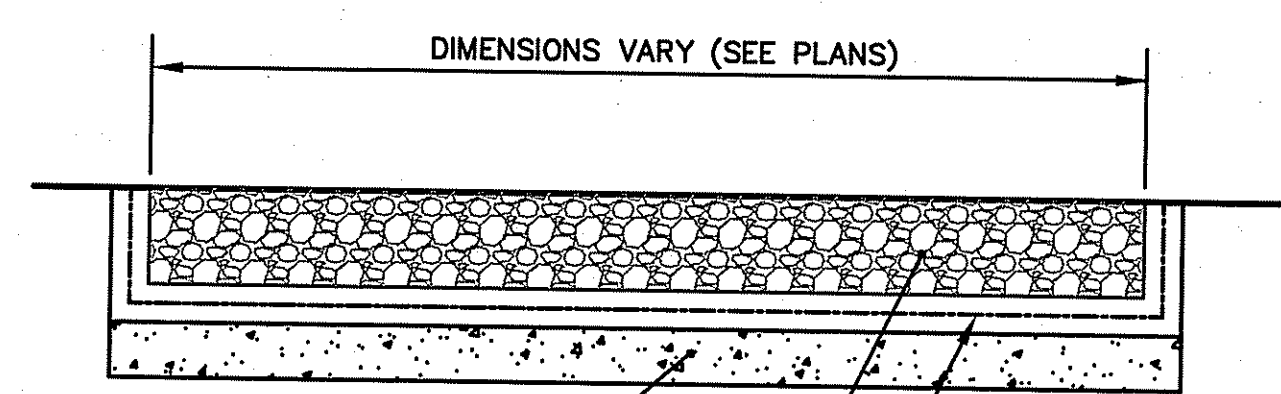

6" FS-3 FILTER
STONE BEDDING
15" NSA PLACED R-5
RIP-RAP STONE
FILTER FABRIC

TYPICAL SECTION RIP-RAP OUTLET PROTECTION
NOT TO SCALE

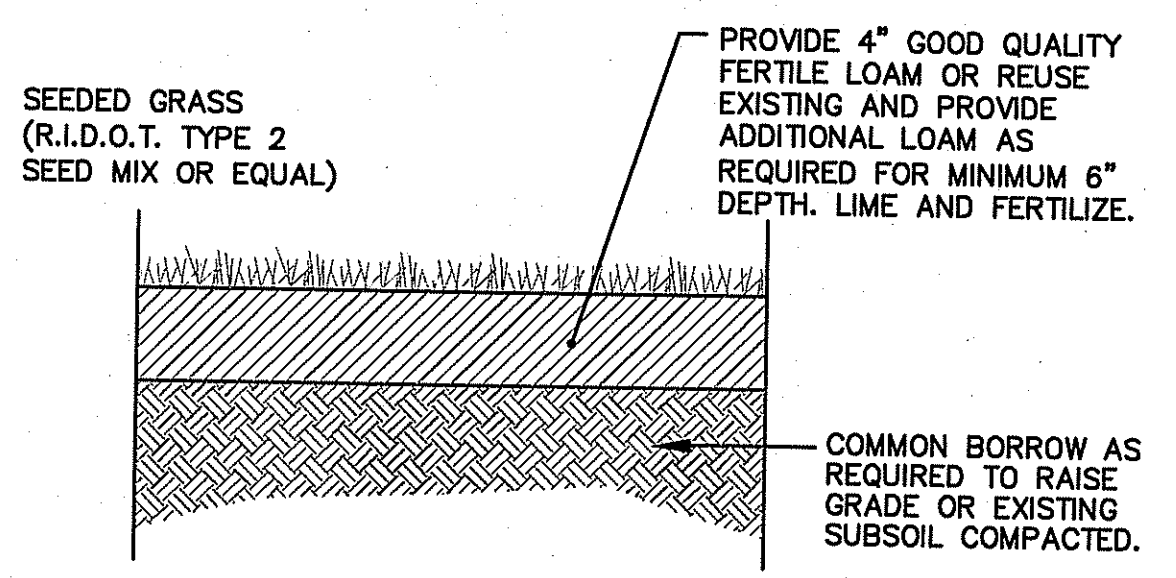

LOAM-SEED DETAIL
NOT TO SCALE

DEPARTMENT OF ENVIRONMENTAL MANAGEMENT
OFFICE OF WATER RESOURCES
FRESHWATER WETLANDS PROGRAM
APPROVED WITH CONDITIONS
AS SPECIFIED IN THE LETTER OF APPROVAL
DATED NOV 17 2011 FILE # 11-0209
NO CHANGES ALLOWED WITHOUT PRIOR APPROVAL.
APPROVED PLANS MUST BE AT CONSTRUCTION SITE

Signature

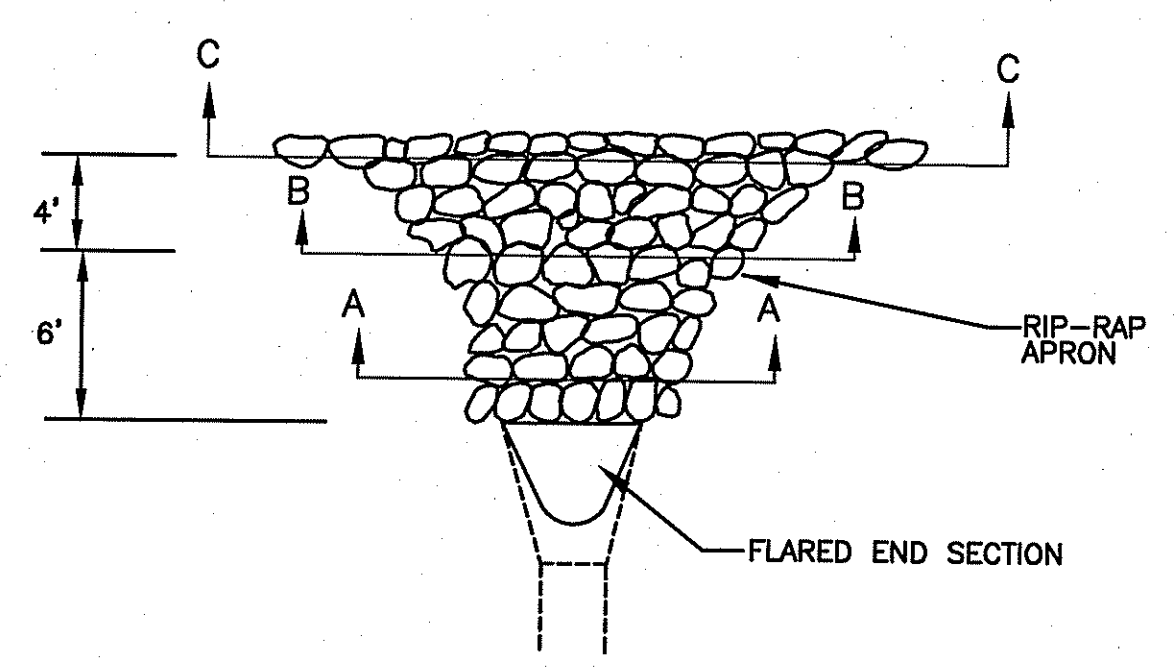

SECTION C-C

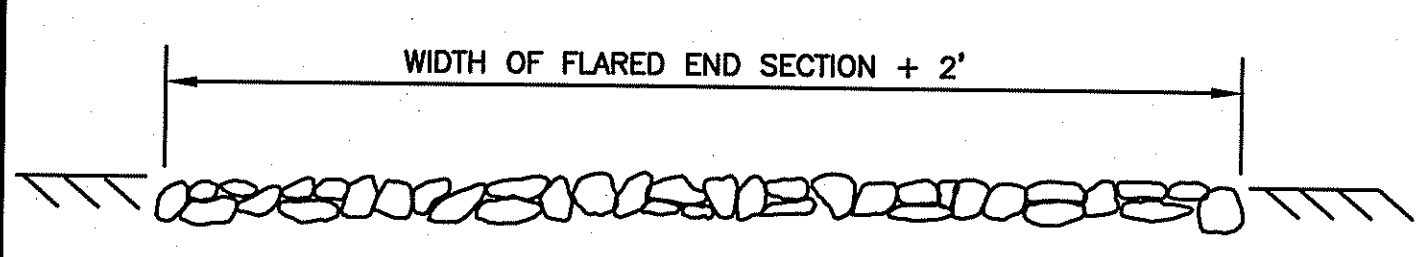

SECTION B-B

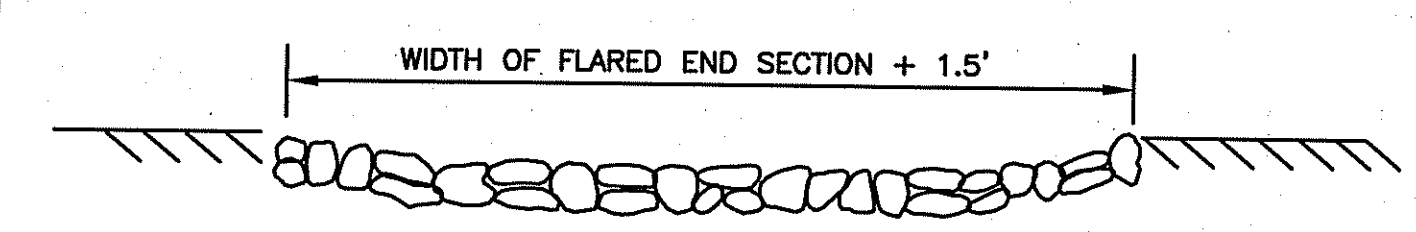

SECTION A-A

- NOTES:
1. UNLESS OTHERWISE SPECIFIED, DUMPED RIP-RAP SHALL BE USED.
 2. DIMENSIONS MAY BE MODIFIED BY ENGINEER TO MEET FIELD CONDITIONS.
 3. SEE TYPICAL SECTION DETAIL.

TYPICAL LAYOUT OF RIP-RAP OUTLET
PROTECTION AT FLARED END SECTIONS
NOT TO SCALE

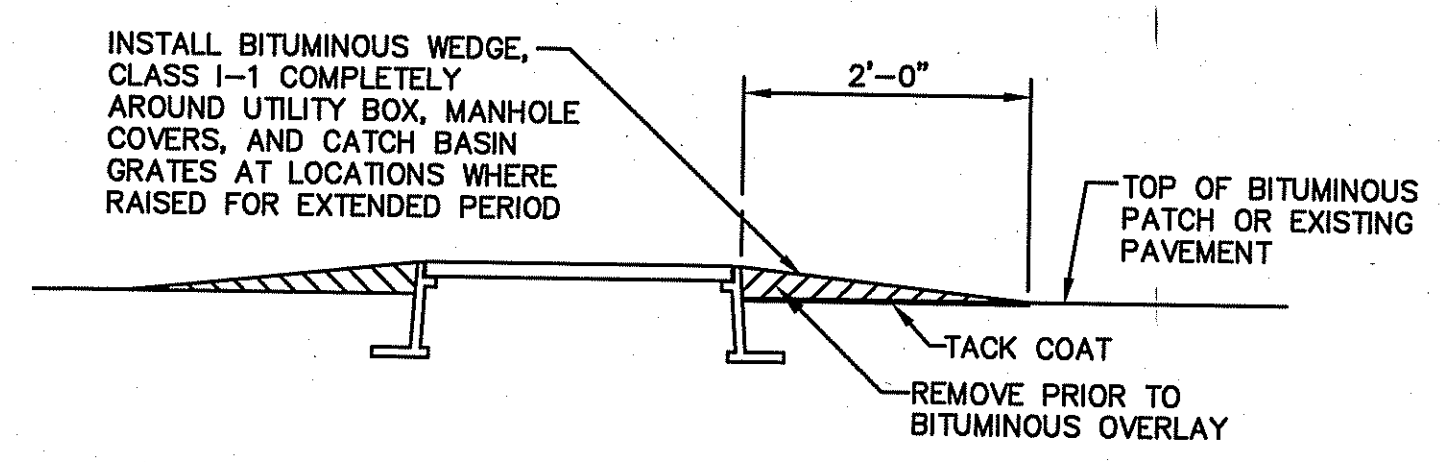

BITUMINOUS WEDGE DETAIL
NOT TO SCALE

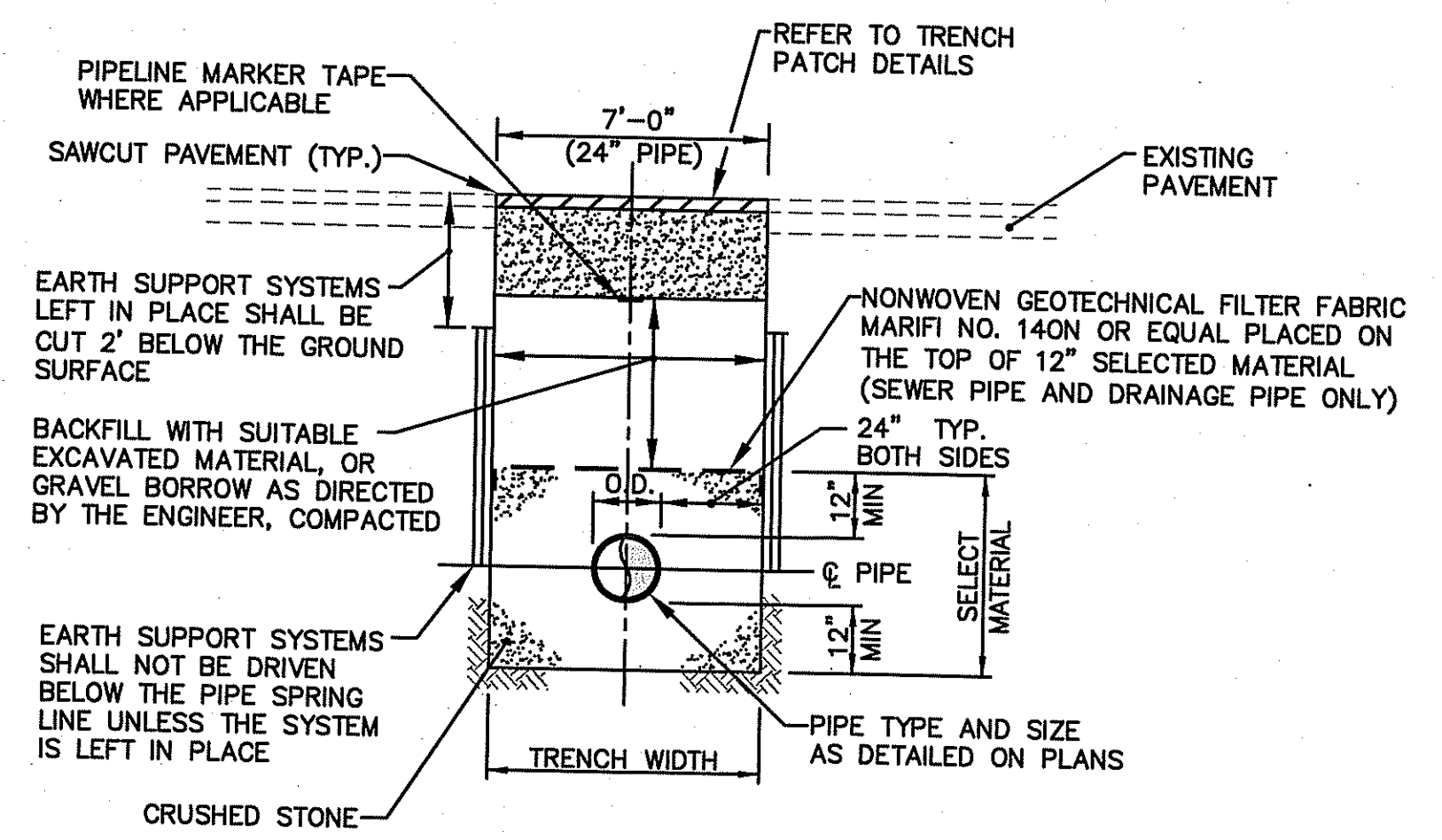

TYPICAL DRAIN LINE
TRENCH DETAIL
NOT TO SCALE

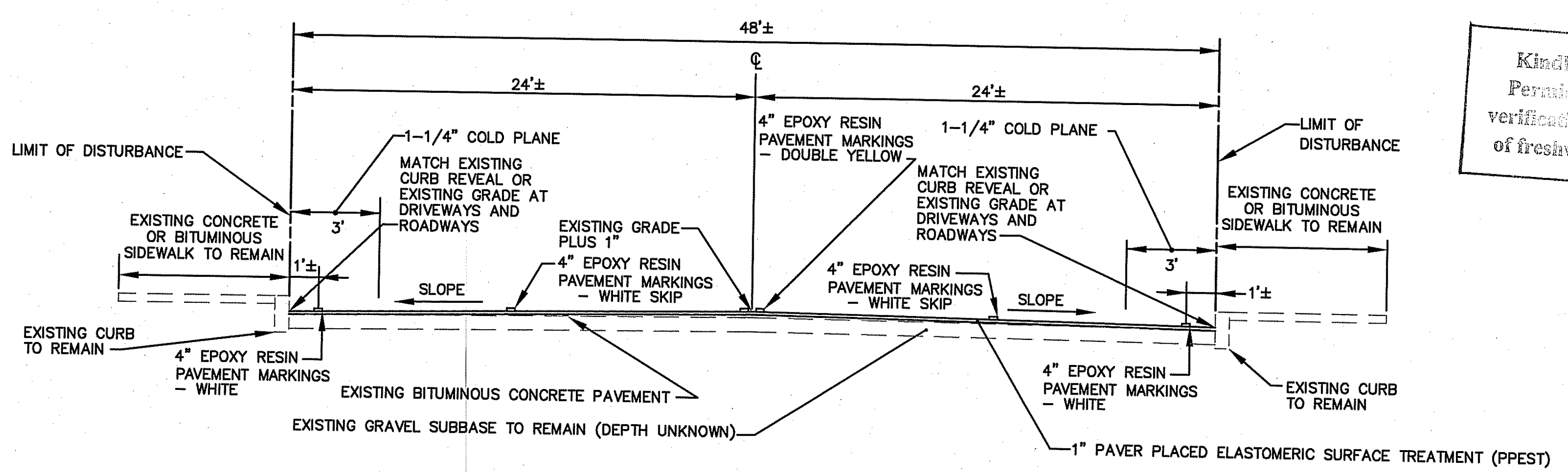

TYPICAL SECTION - GREENWICH AVENUE (ROUTE 5)
NOT TO SCALE

- NOTES:
1. CUT AND MATCH PAVEMENT AT ALL BITUMINOUS DRIVEWAYS, SIDE STREETS AND AT THE PROJECT LIMITS.
 2. APPLY A TACK COAT IN BETWEEN PAVEMENT COURSES.

Kindly be advised that this
Permit is not equivalent to a
verification of the type or extent
of freshwater wetlands on site.



CROSSMAN ENGINEERING
a division of Crossman Corporation
151 Centerville Road | Warwick, Rhode Island 02886
Phone: (401) 738-5660 | Fax: (401) 738-8157
Email: cel@crossmaneng.com

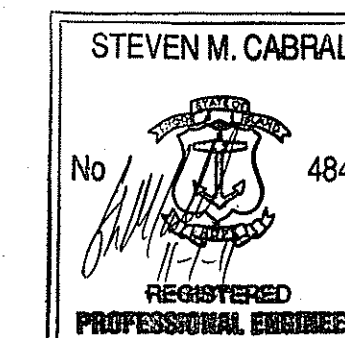
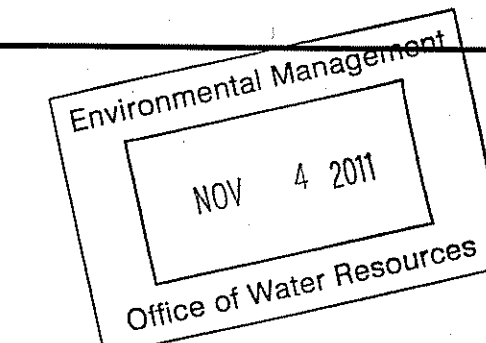

DEPARTMENT OF ENVIRONMENTAL MANAGEMENT
OFFICE OF WATER RESOURCES
FRESHWATER WETLANDS PROGRAM
APPROVED WITH CONDITIONS
AS SPECIFIED IN THE LETTER OF APPROVAL
DATED NOV 17 2011 FILE # 11-0289
NO CHANGES ALLOWED WITHOUT PRIOR APPROVAL
APPROVED PLANS MUST BE AT CONSTRUCTION SITE

PROJECT TITLE:
**DRAINAGE IMPROVEMENTS
TO
BANGOR STREET
WARWICK, RHODE ISLAND**

PREPARED FOR:
**DAVID PICOZZI
PUBLIC WORKS DIRECTOR
CITY OF WARWICK
925 SANDY LANE
WARWICK, RHODE ISLAND
02889**

DRAWING TITLE:
**MISCELLANEOUS DETAILS
PLAN No. 2**

DATE: OCTOBER 2011 SCALE: AS SHOWN
DWG. NAME: 1624.19-C08-DET2.dwg

REVISIONS		
NUMBER	REMARKS	DATE

DRAWING NUMBER
C8
SHEET: 9 OF: 11
AGENCY REVIEW SUBMISSION

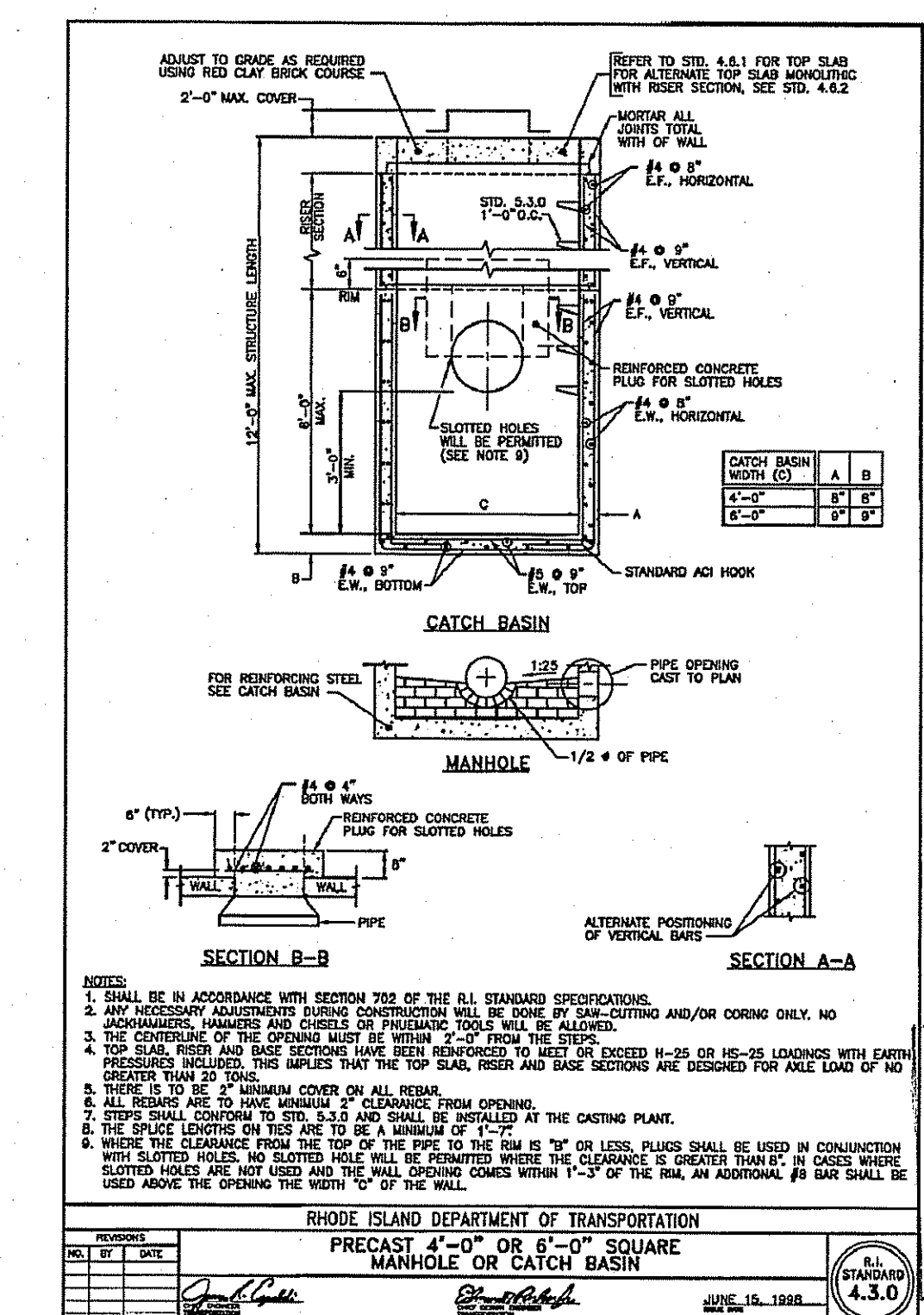
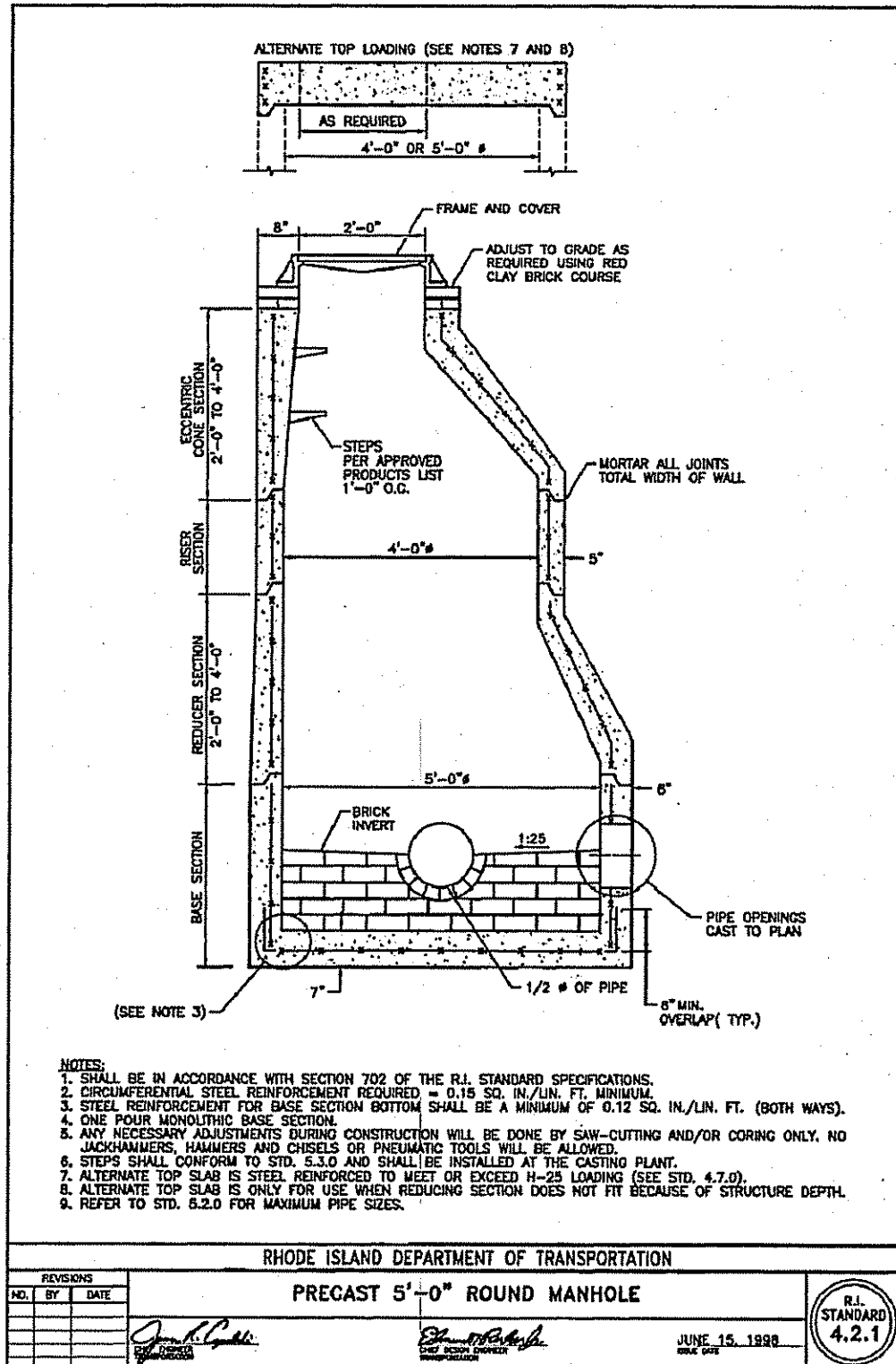
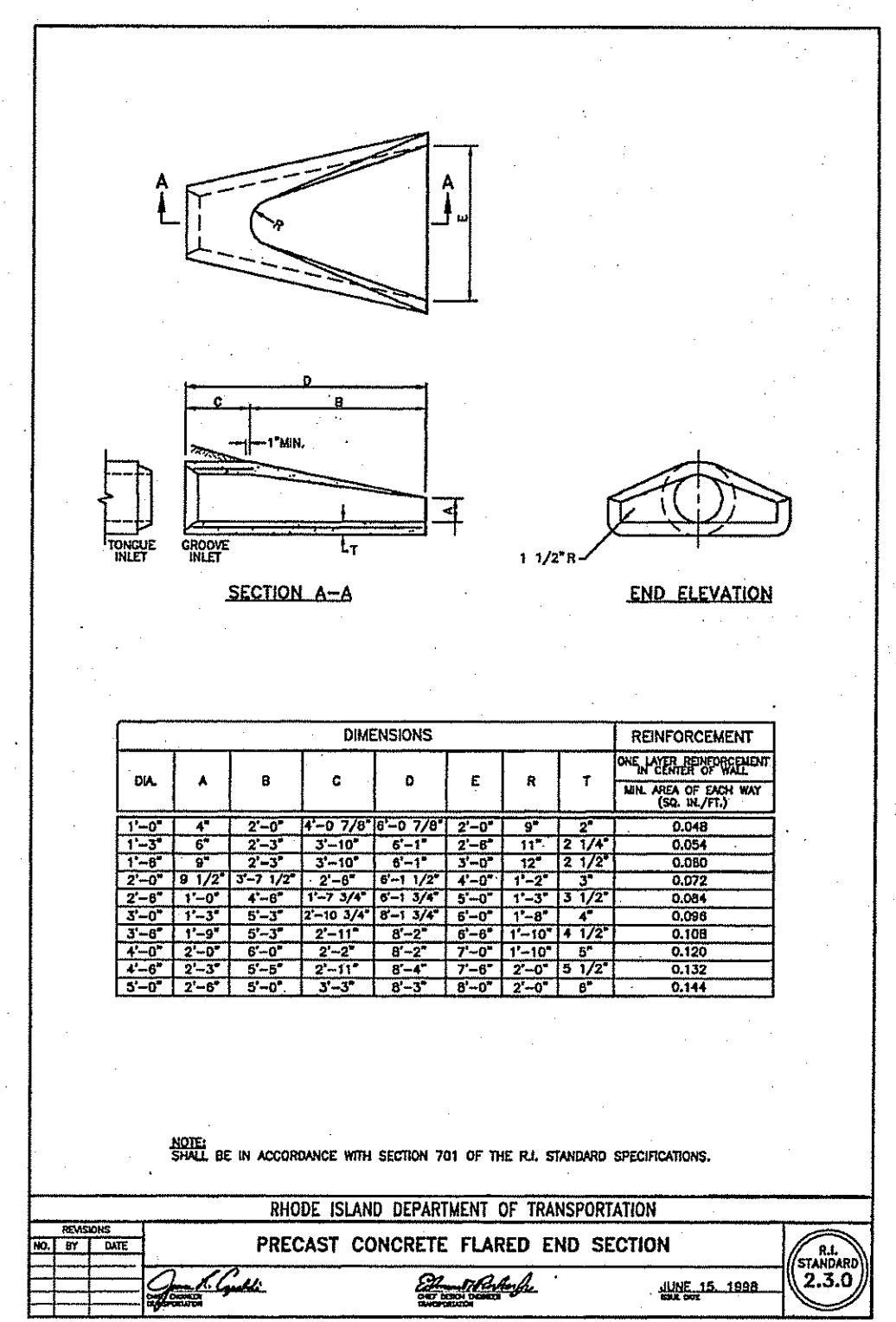

Kindly be advised that this
Permit is not equivalent to a
verification of the type or extent
of freshwater wetlands on site.

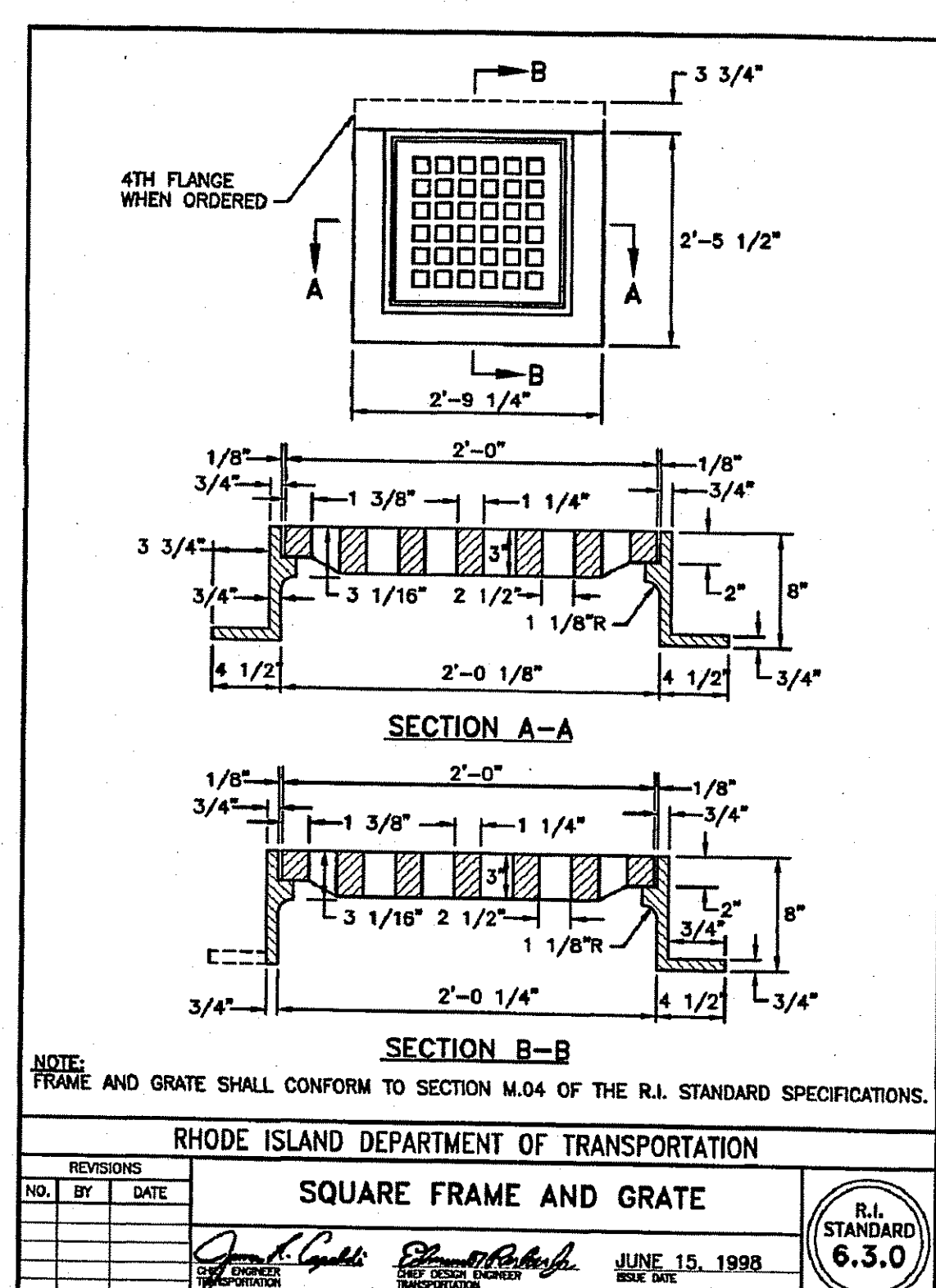
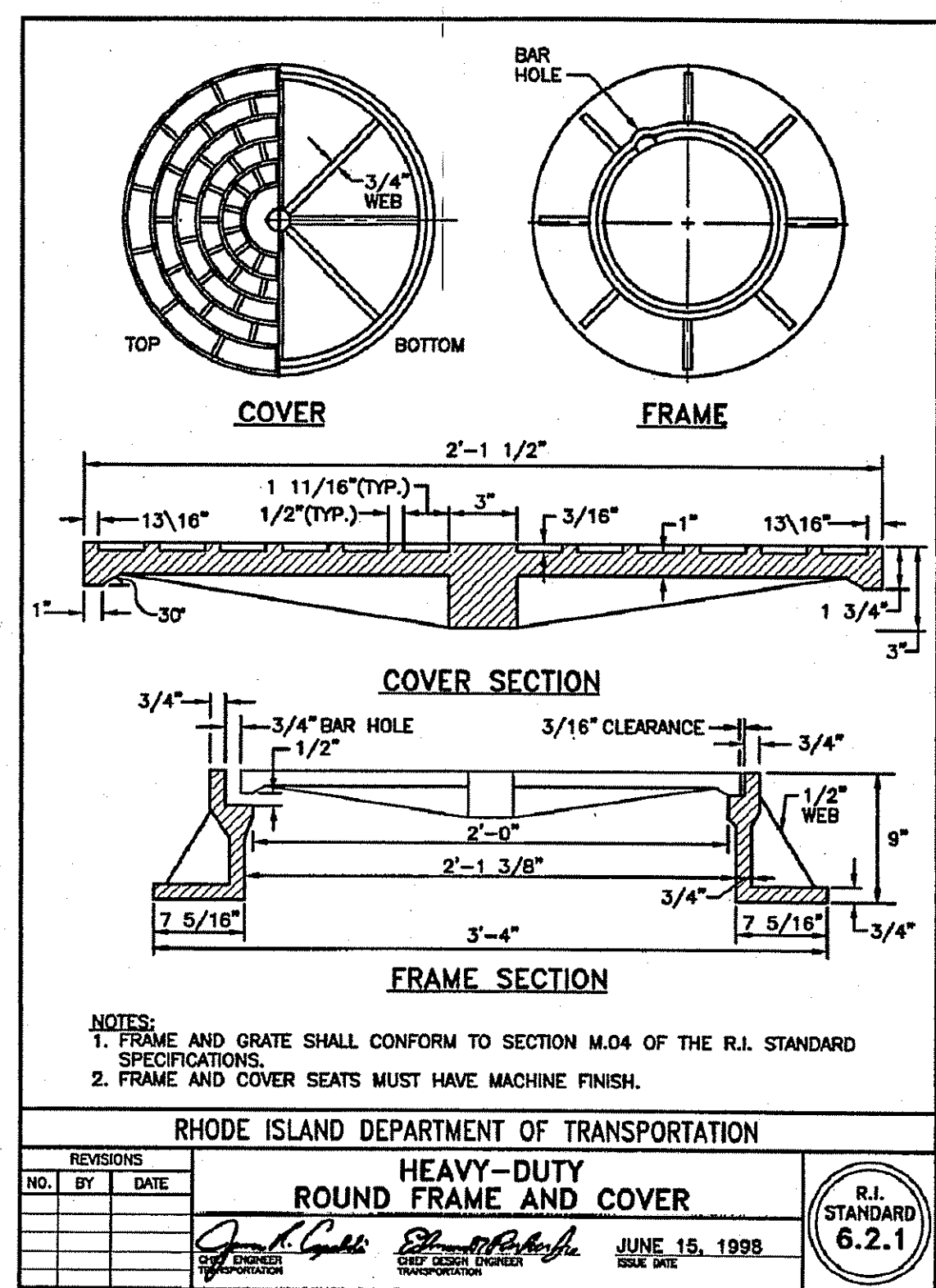
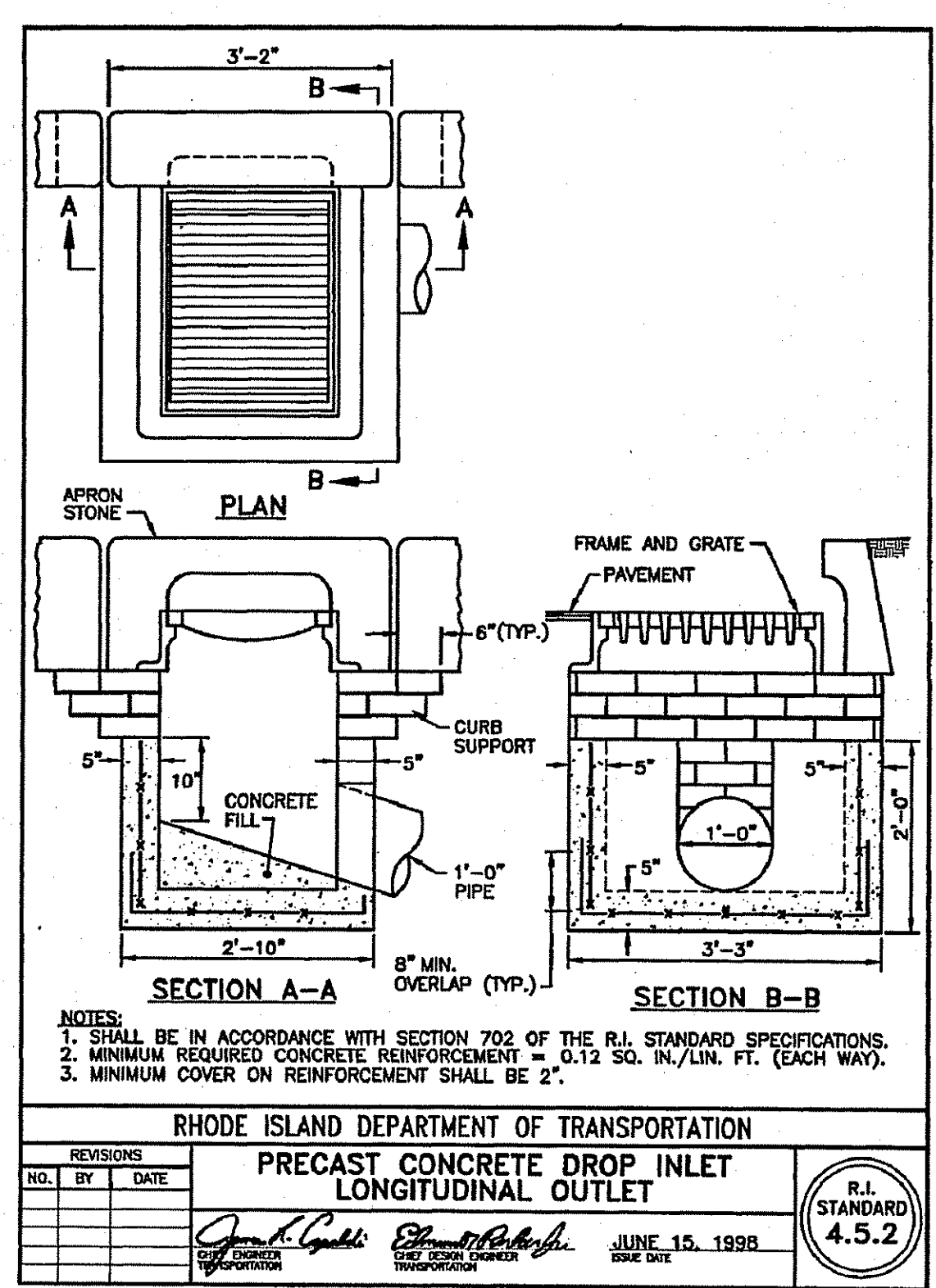

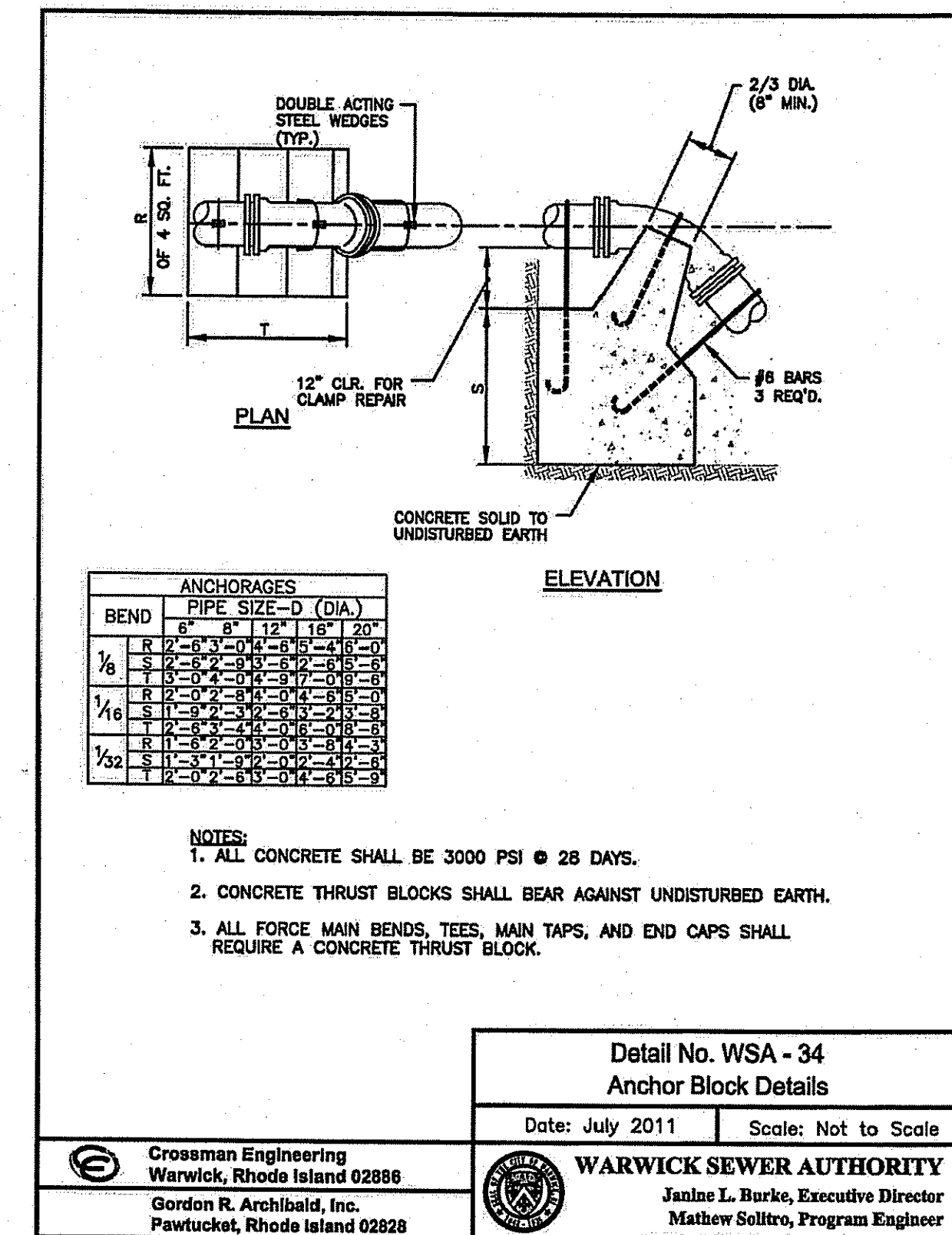
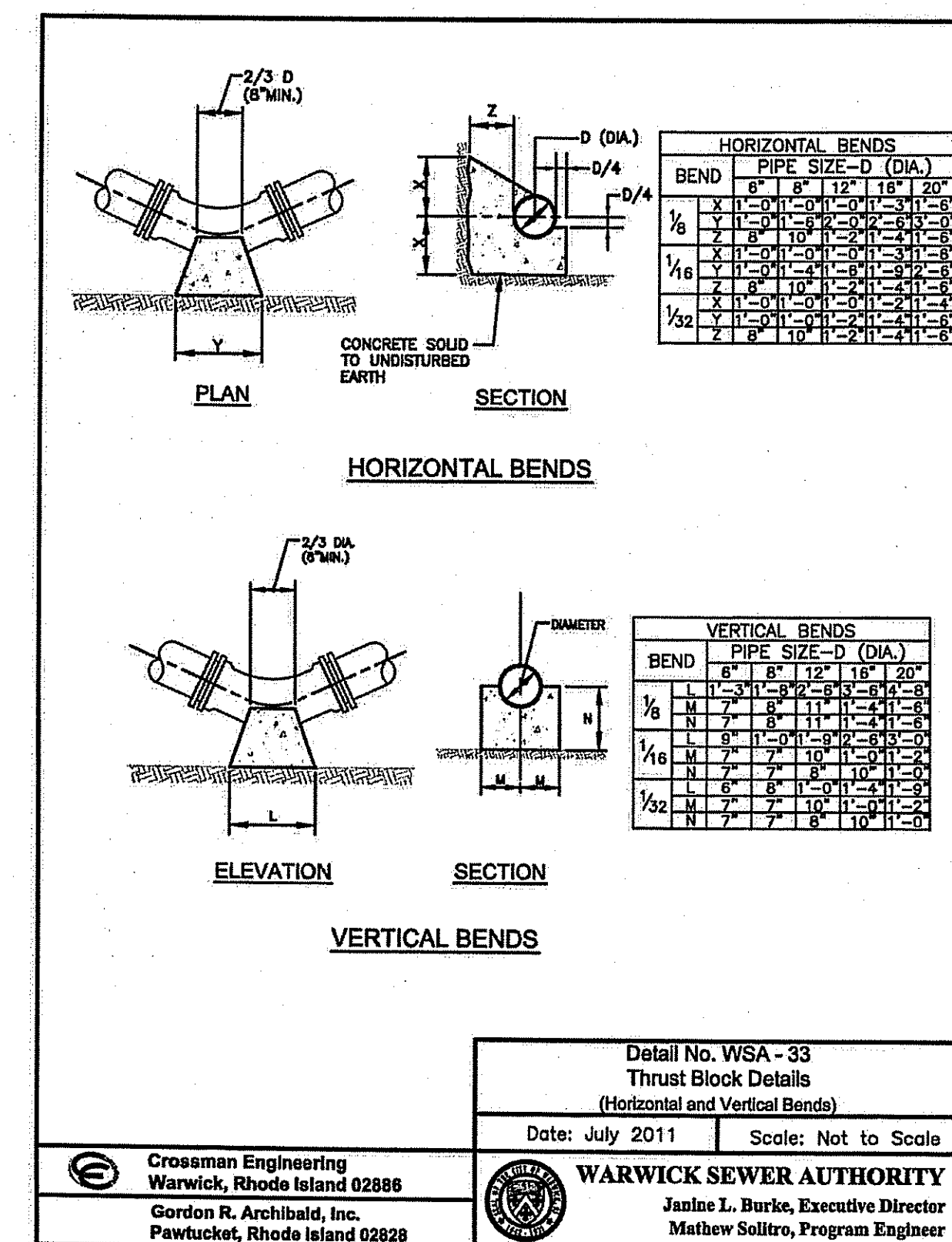
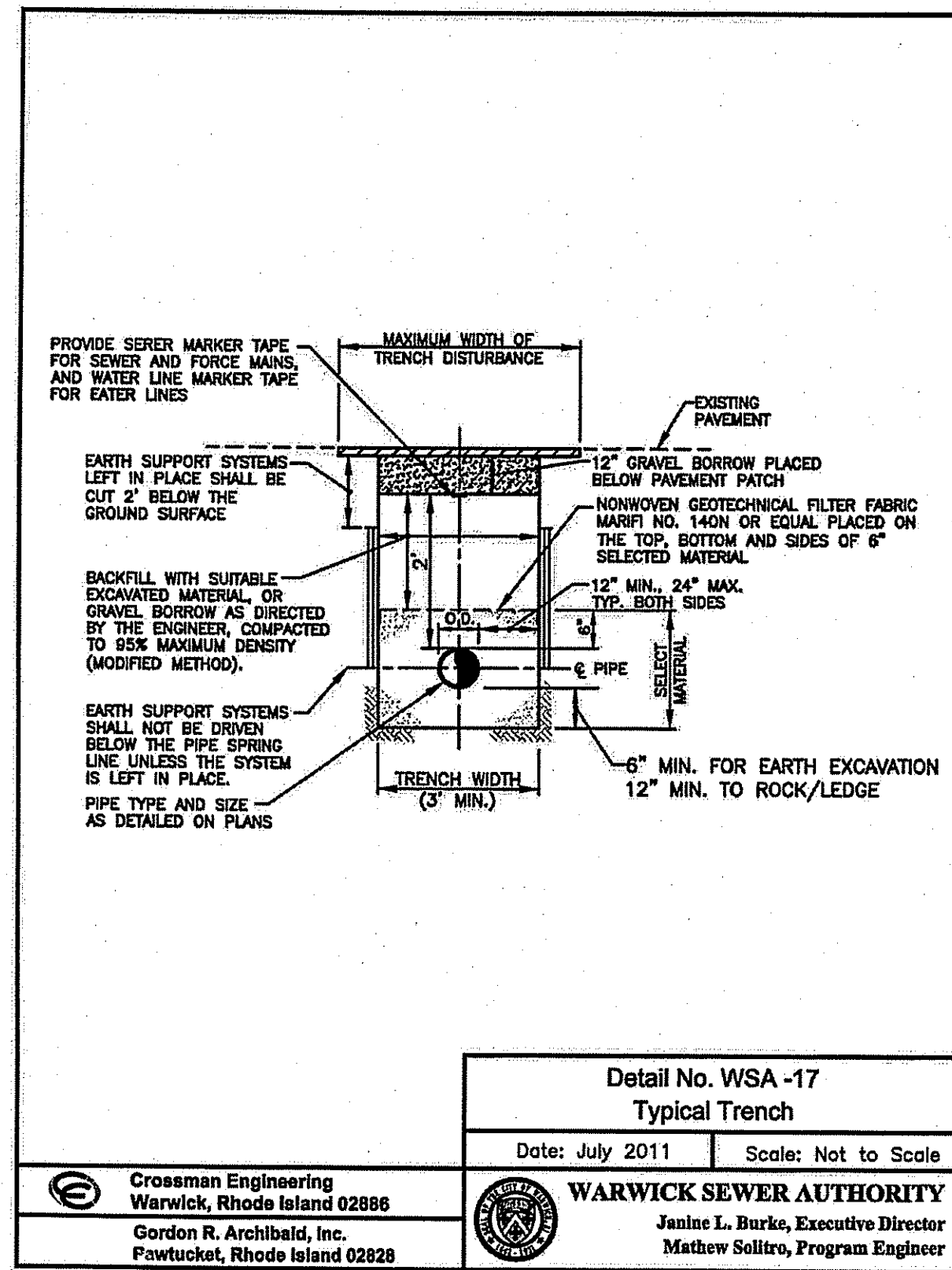
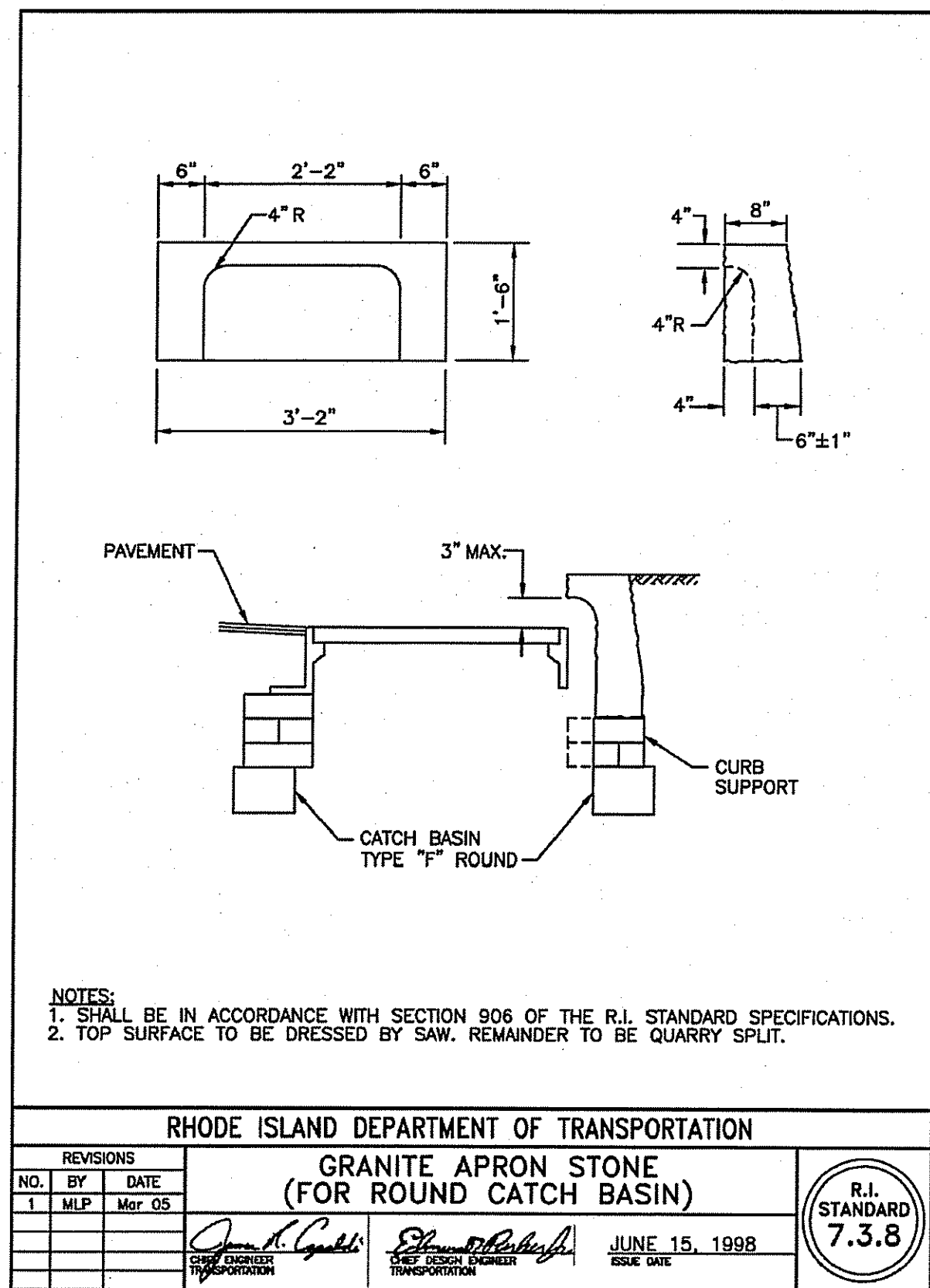
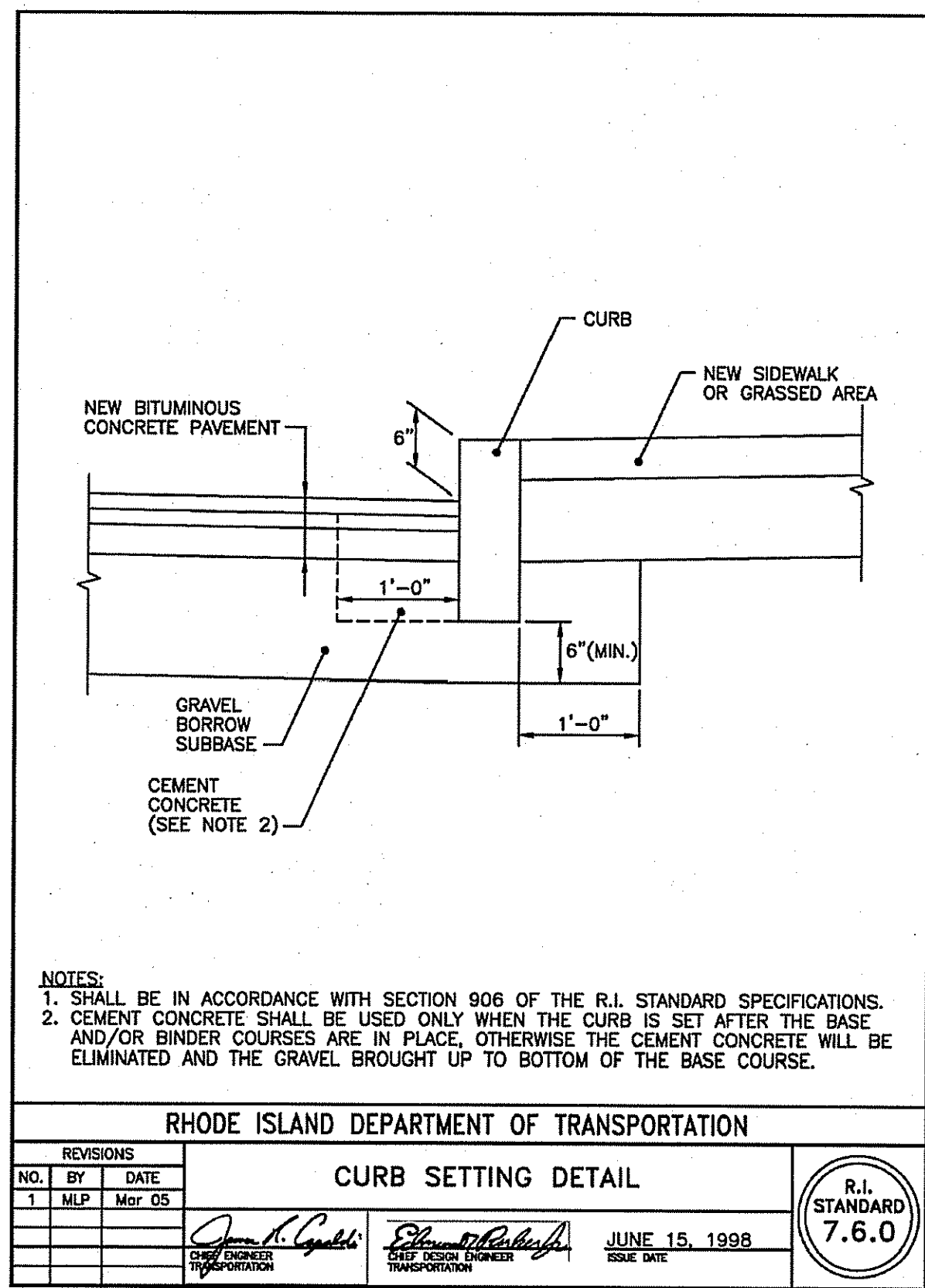
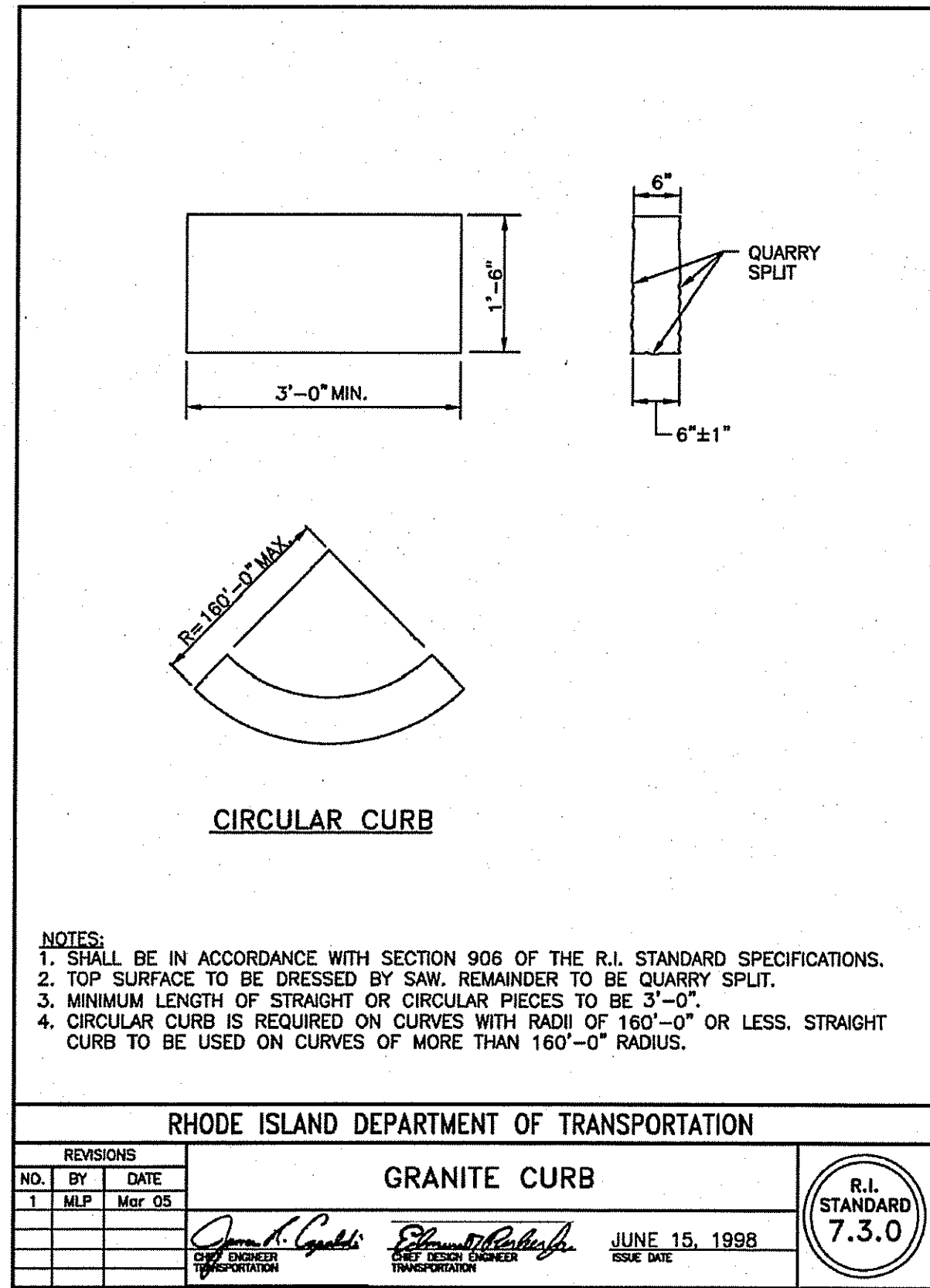

DEPARTMENT OF ENVIRONMENTAL MANAGEMENT
 OFFICE OF WATER RESOURCES
 FRESHWATER WETLANDS PROGRAM
 APPROVED WITH CONDITIONS
 AS SPECIFIED IN LETTER OF APPROVAL
 DATED NOV 17 2011 FILE # 11-0229
 NO CHANGES ALLOWED WITHOUT PRIOR APPROVAL.
 APPROVED PLANS MUST BE AT CONSTRUCTION SITE

Kindly be advised that this
 Permit is not equivalent to a
 verification of the type or extent
 of freshwater wetlands on site.

TYPICAL LOW PRESSURE
 SANITARY SEWER FORCE MAIN DETAILS
 NOT TO SCALE

Environmental Management
 NOV 4 2011
 Office of Water Resources

STEVEN M. CABRAL
 No. 4847
 REGISTERED
 PROFESSIONAL ENGINEER

PROJECT TITLE:
 DRAINAGE IMPROVEMENTS
 TO
 BANGOR STREET
 WARWICK, RHODE ISLAND

PREPARED FOR:
 DAVID PICOZZI
 PUBLIC WORKS DIRECTOR
 CITY OF WARWICK
 925 SANDY LANE
 WARWICK, RHODE ISLAND
 02889

DRAWING TITLE:
 MISCELLANEOUS DETAILS
 PLAN No. 3

DATE:
 OCTOBER 2011
 SCALE:
 AS NOTED

DWG. NAME:
 1624.19-C11-DET3.dwg

REVISIONS	NUMBER	REMARKS	DATE
1	1		
2	2		
3	3		
4	4		
5	5		
6	6		
7	7		
8	8		
9	9		
10	10		

DRAWING NUMBER
 C9
 SHEET: 10 OF 11

AGENCY REVIEW SUBMISSION

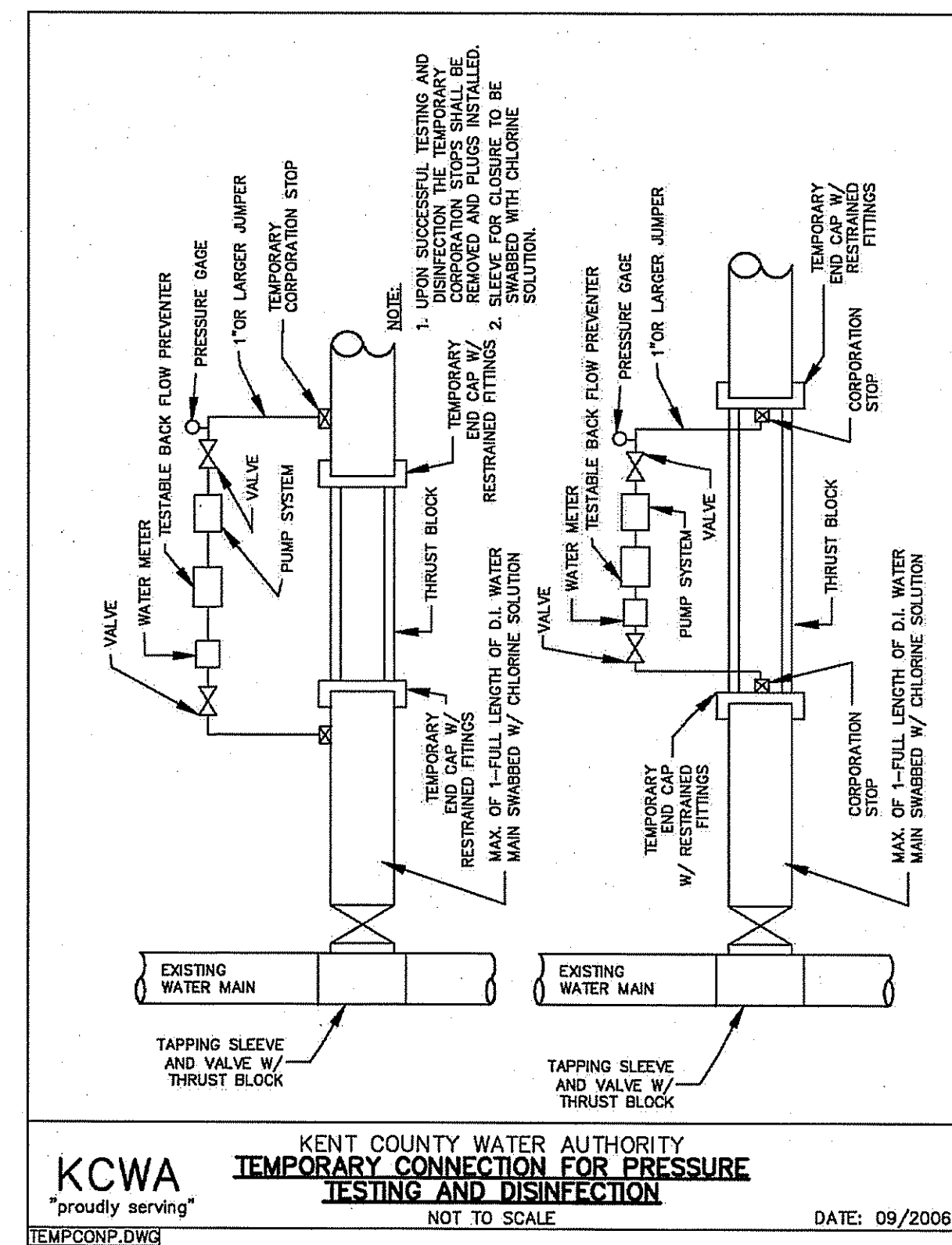
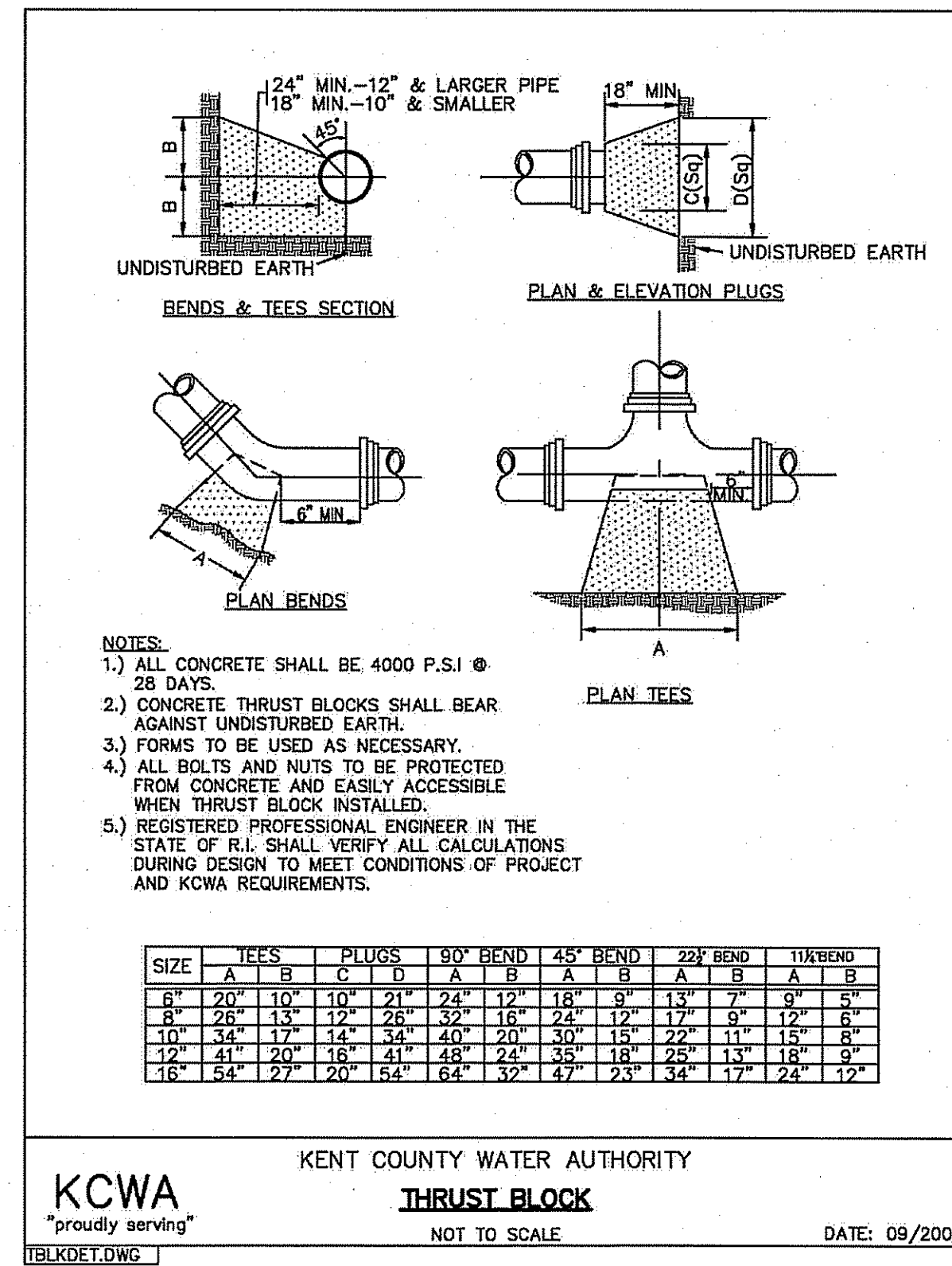
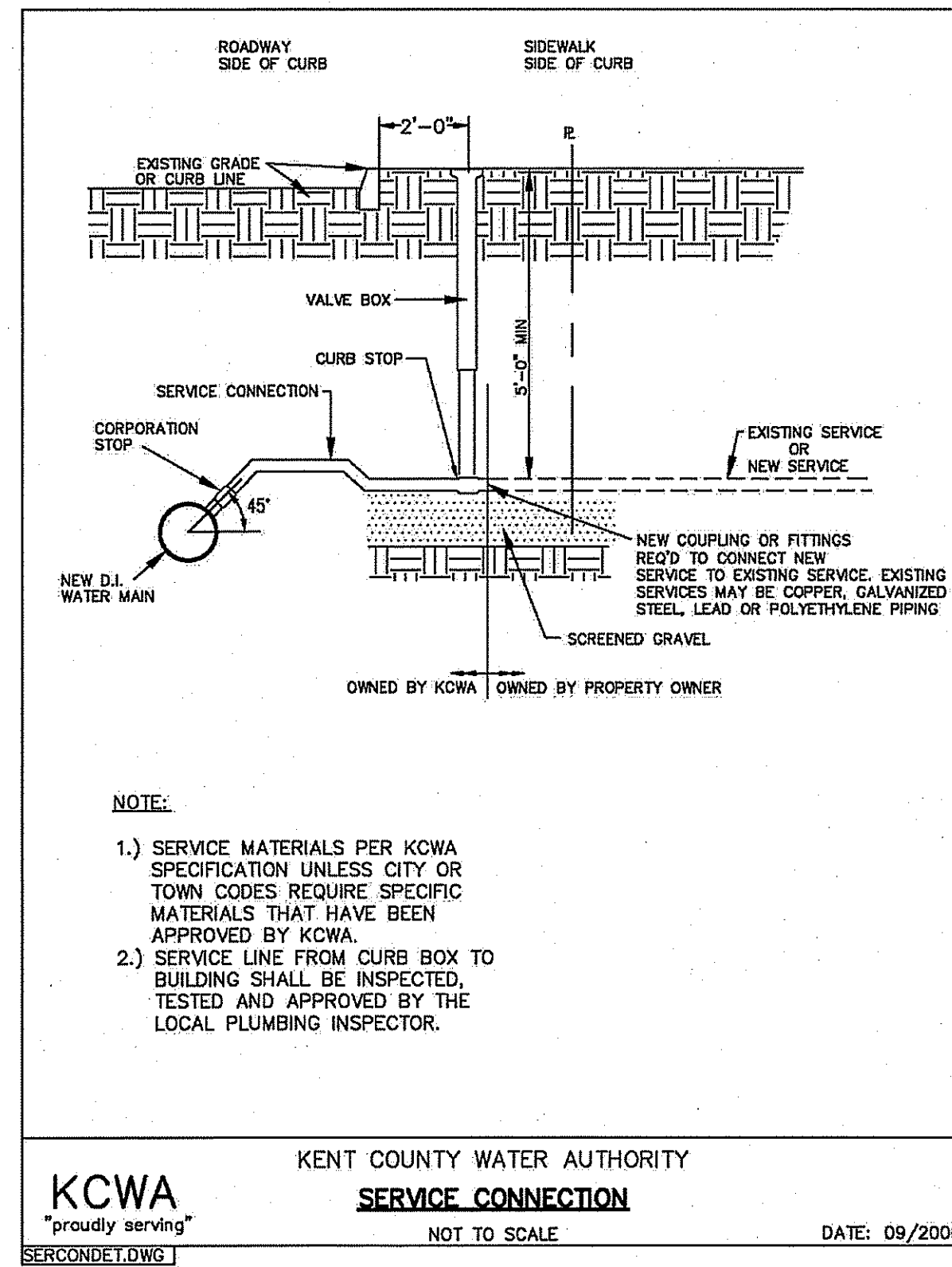
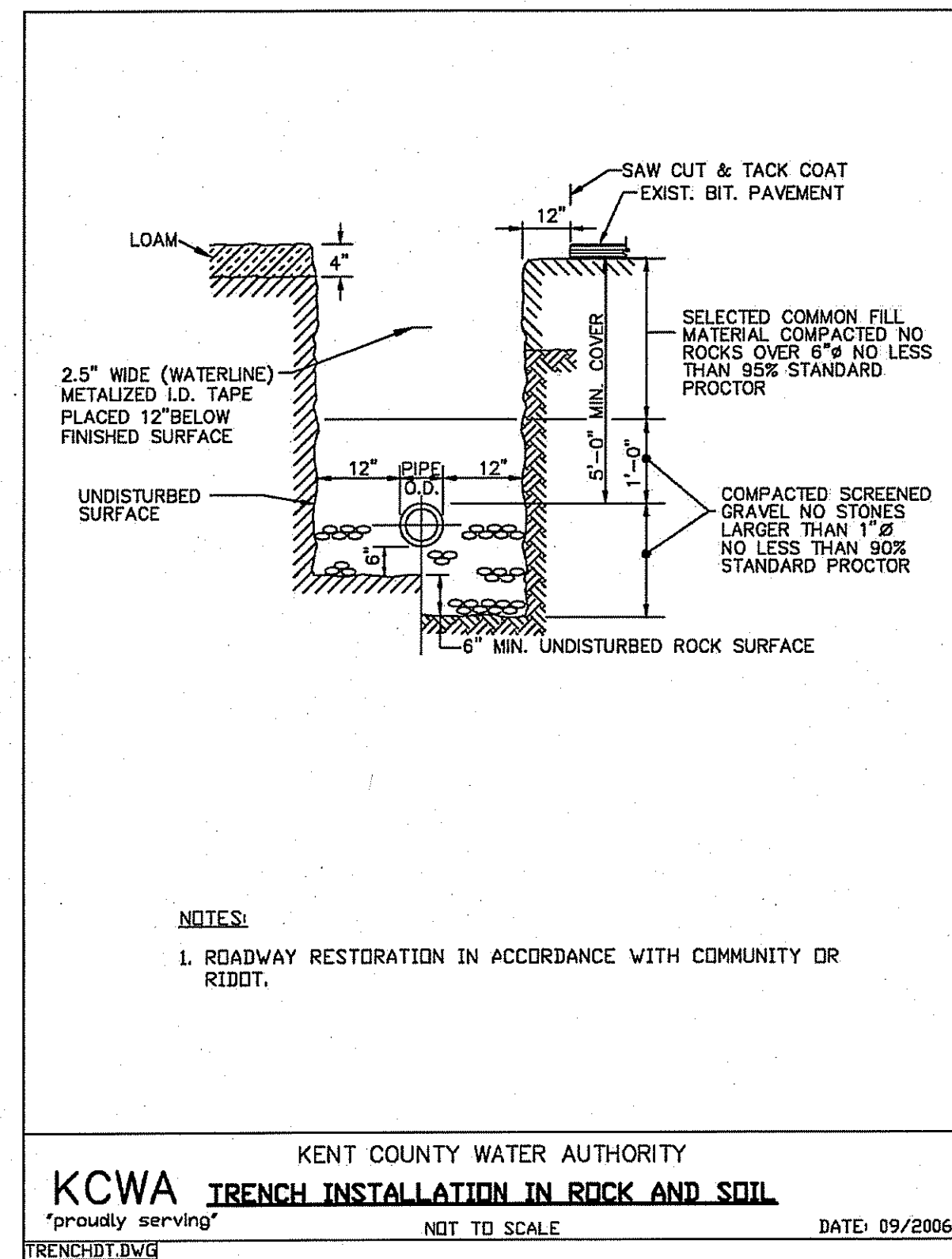

TYPICAL WATER SYSTEM DETAILS
 SCALE AS NOTED

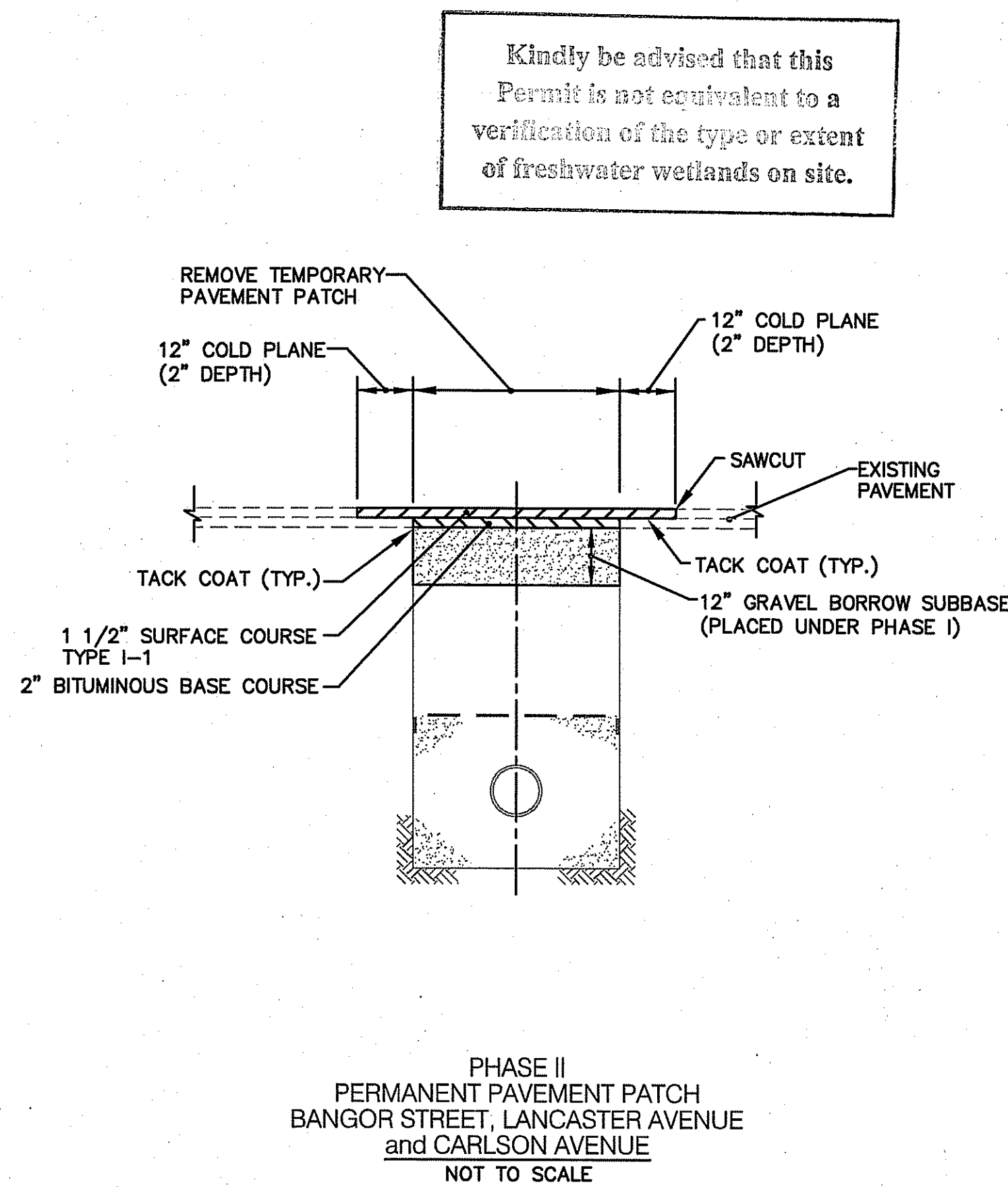
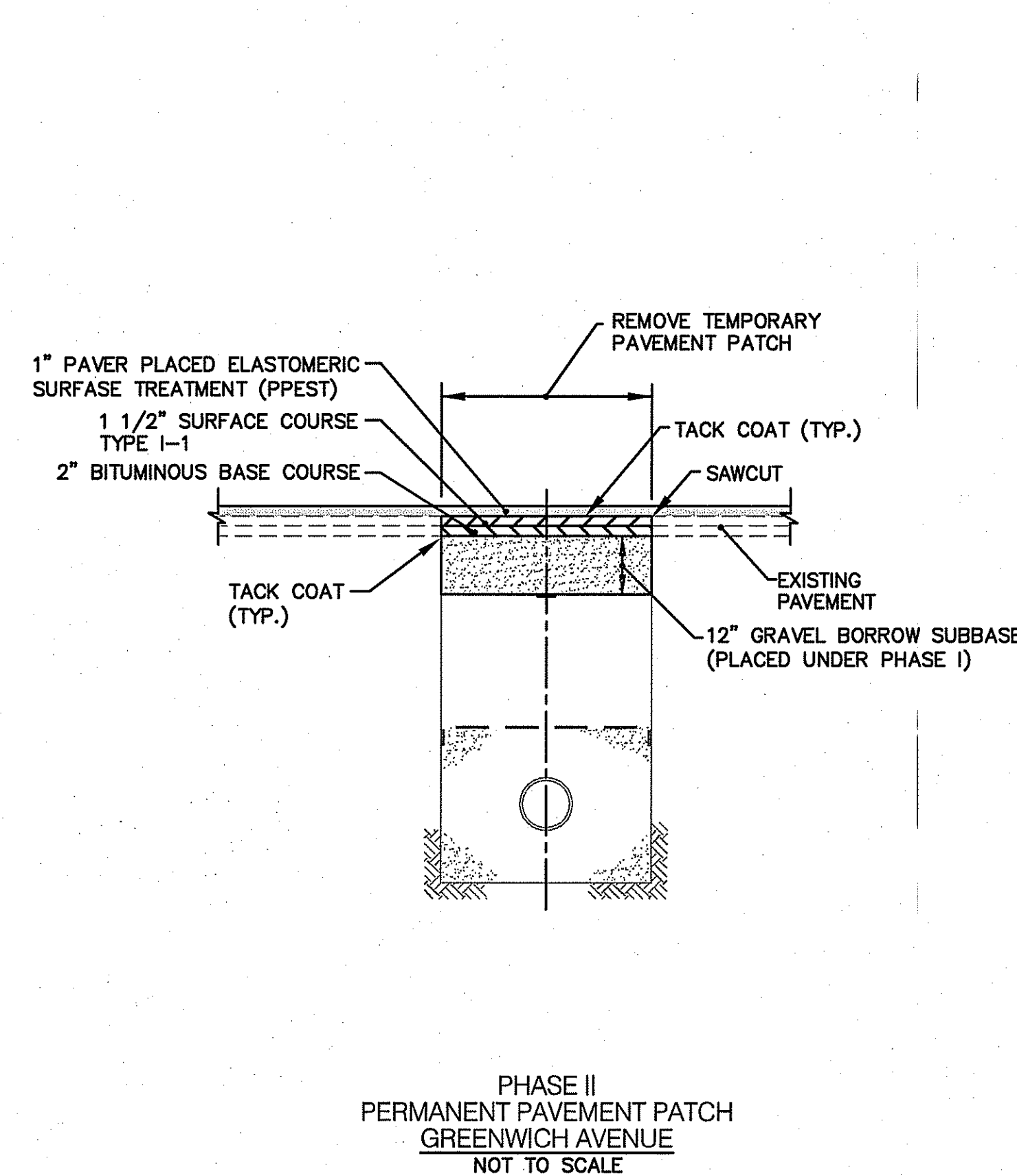
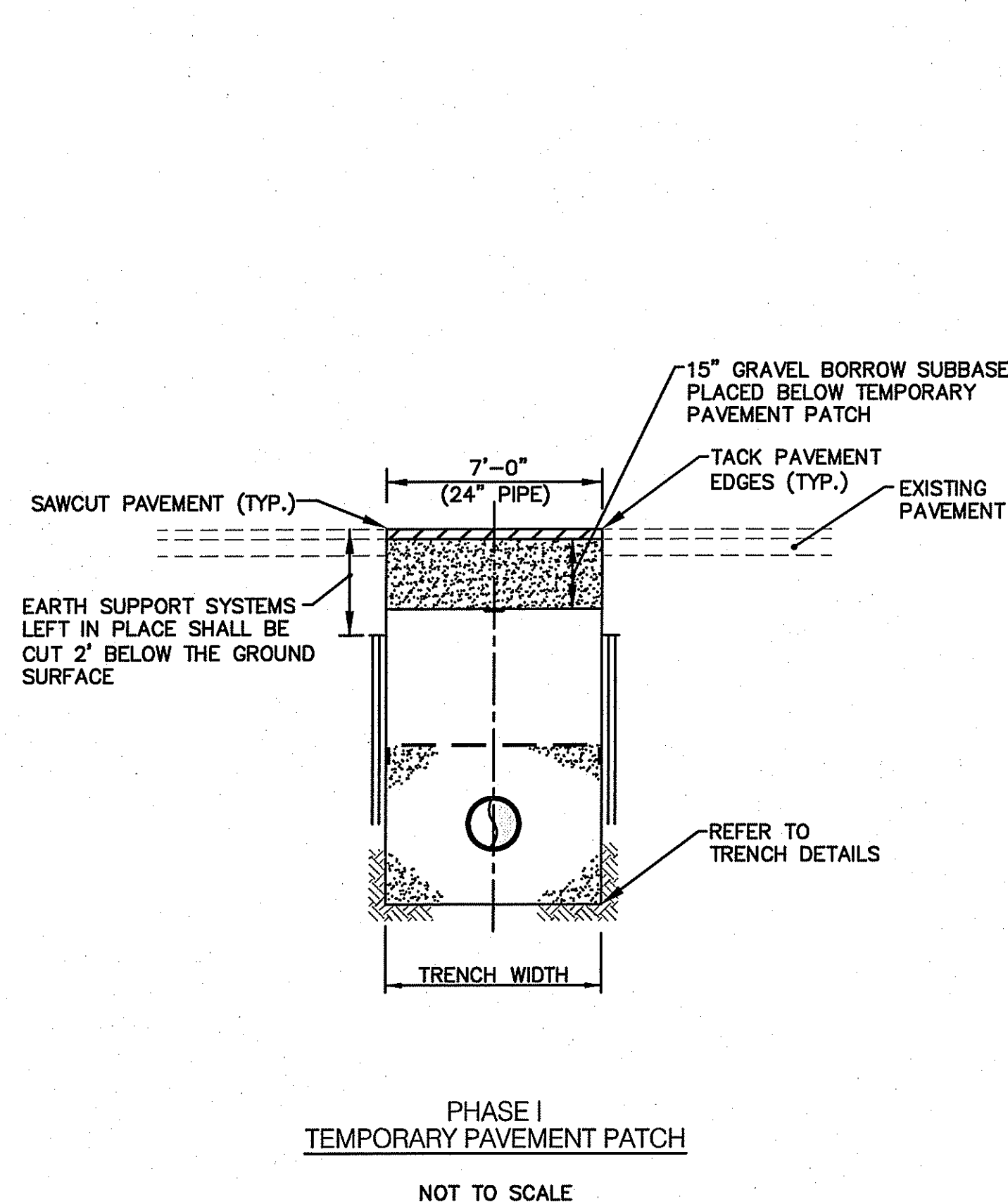

TRENCH PATCH DETAILS
 SCALE AS NOTED

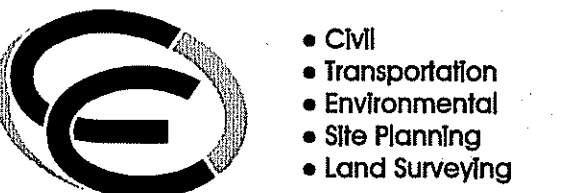

CROSSMAN ENGINEERING
 | a division of Crossman Corporation |
 151 Centerville Road | Warwick, Rhode Island 02886
 Phone: (401) 738-5660 | Fax: (401) 738-8157
 Email: cel@crossmaneng.com

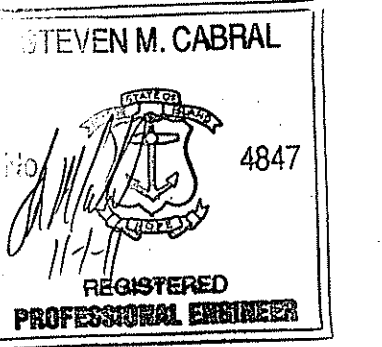
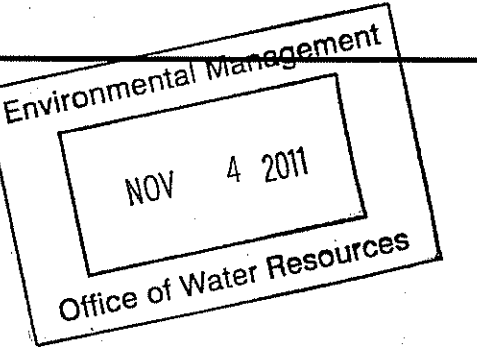

PROJECT TITLE:
DRAINAGE IMPROVEMENTS TO BANGOR STREET
WARWICK, RHODE ISLAND

PREPARED FOR:
DAVID PICOZZI
PUBLIC WORKS DIRECTOR
CITY OF WARWICK
925 SANDY LANE
WARWICK, RHODE ISLAND
02889

DRAWING TITLE:
MISCELLANEOUS DETAILS
PLAN No. 4

DATE: OCTOBER 2011 SCALE: AS SHOWN

DWG. NAME: 1624.19-C12-DET4.dwg

REVISIONS		
NUMBER	REMARKS	DATE
1		
2		
3		
4		
5		
6		
7		
8		
9		
10		

DRAWING NUMBER

C10

SHEET: 11 OF 11

AGENCY REVIEW SUBMISSION