

MAGNETIC - 2012

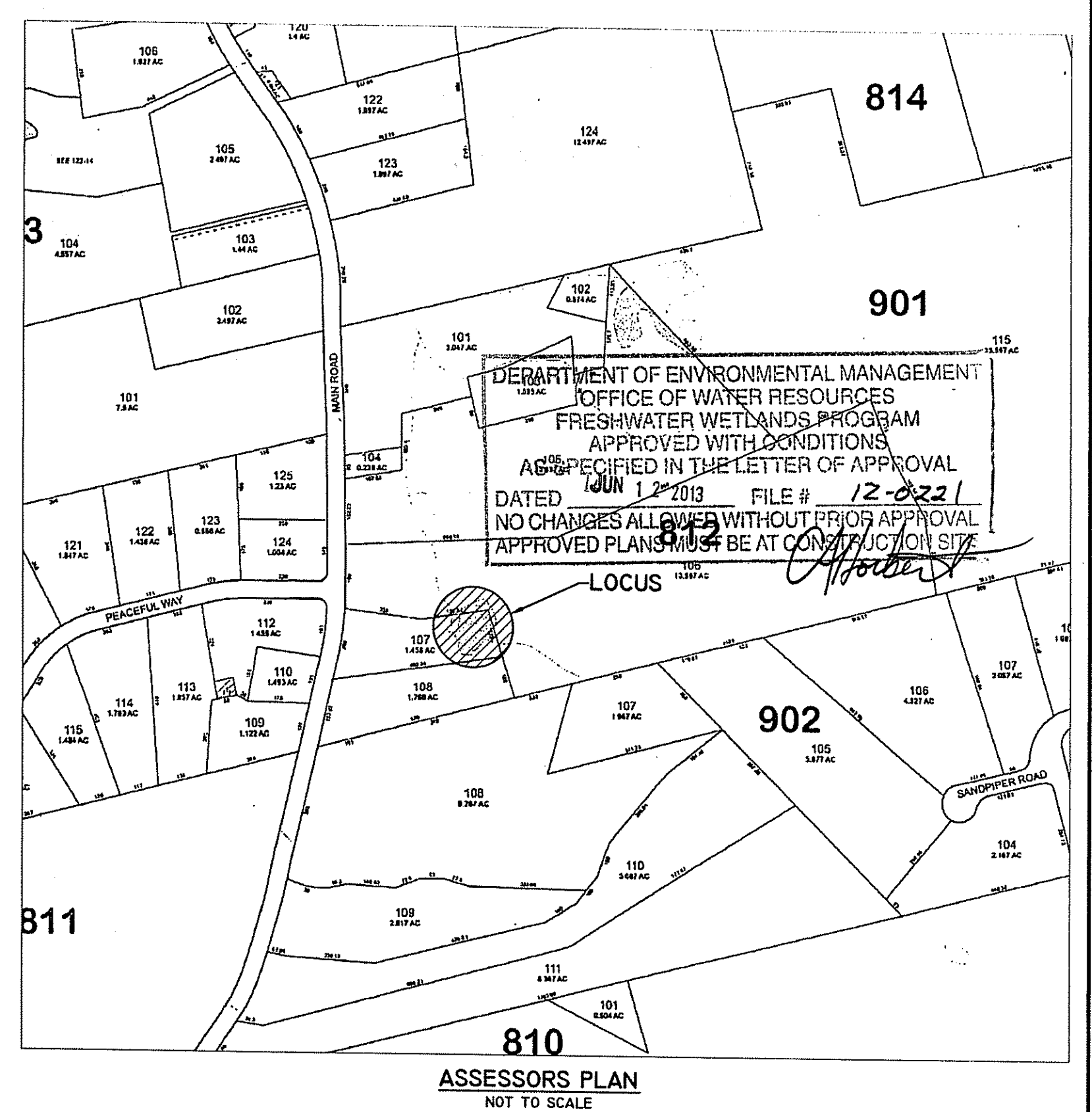

- LEGEND**
- 100--- EXISTING CONTOUR (ASSUMED DATUM)
  - 50'--- PERIMETER WETLAND
  - 100'--- RIVERBANK WETLAND
  - ▲ WETLAND FLAG BY APPLIED BIOSYSTEMS
  - DELINEATED WETLAND EDGE BY APPLIED BIO-SYSTEMS
  - EDGE OF EXISTING GRAVEL DRIVEWAY
  - STONEWALL
  - UTILITY POLE
  - APPROXIMATE EDGE OF VEGETATION
  - APPROXIMATE STREAM (LESS THAN 2' WIDE)
  - APPROXIMATE EDGE OF POND
  - PROPOSED HAYBALES EROSION CONTROL (RI STANDARD 9.1.0)
  - PROPOSED HAYBALE AND SILT FENCE EROSION CHECK (RI STANDARD 9.3.0)
  - PROPOSED BALED HAY DITCH AND SWALE EROSION CHECK (RI STANDARD 9.4.0)
  - PROPOSED CONTOUR
  - PROPOSED SILT BARRIER CURTAIN = LIMITS OF DISTURBANCE WITHIN POND
  - PROPOSED SILT FENCE

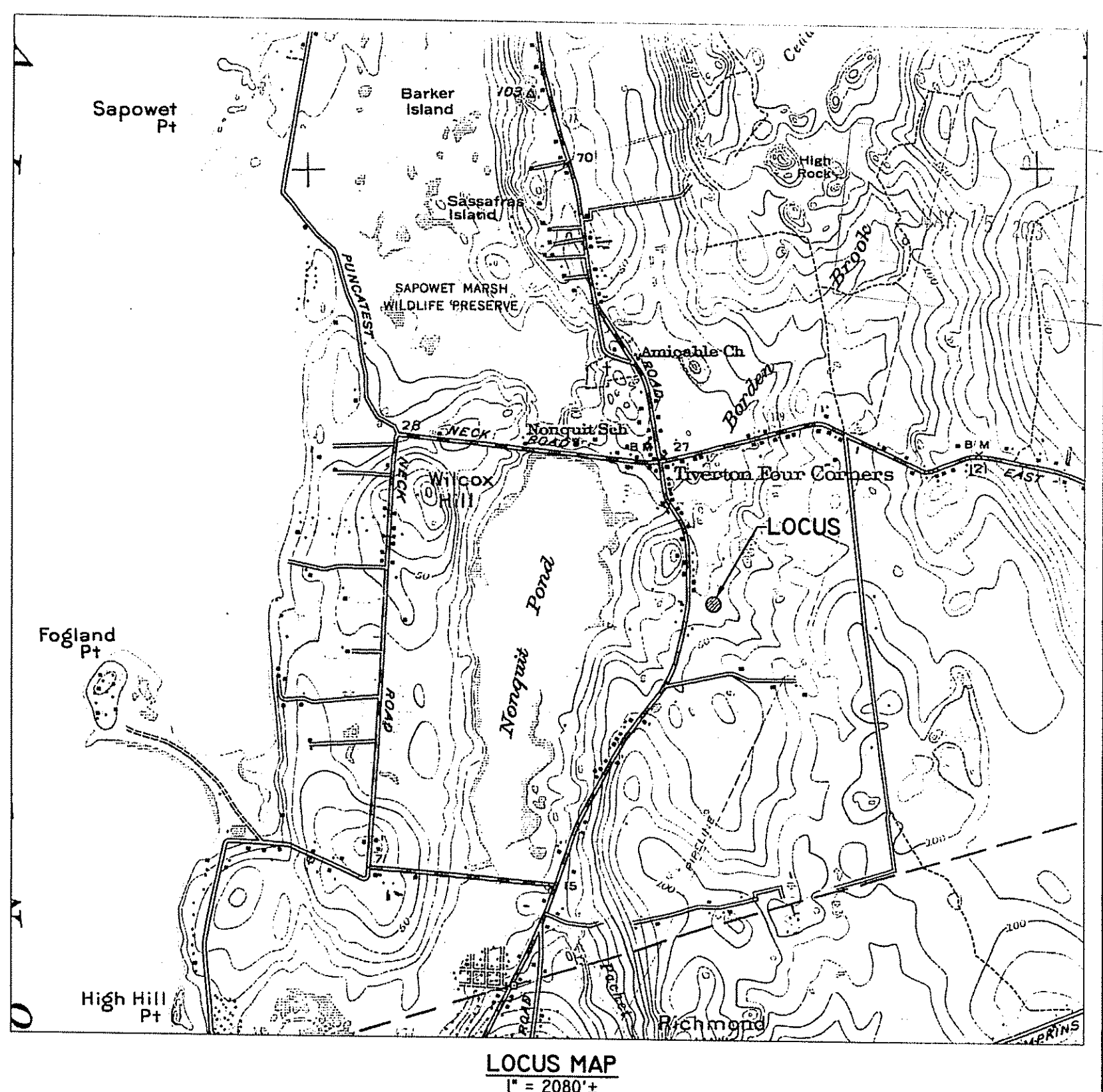
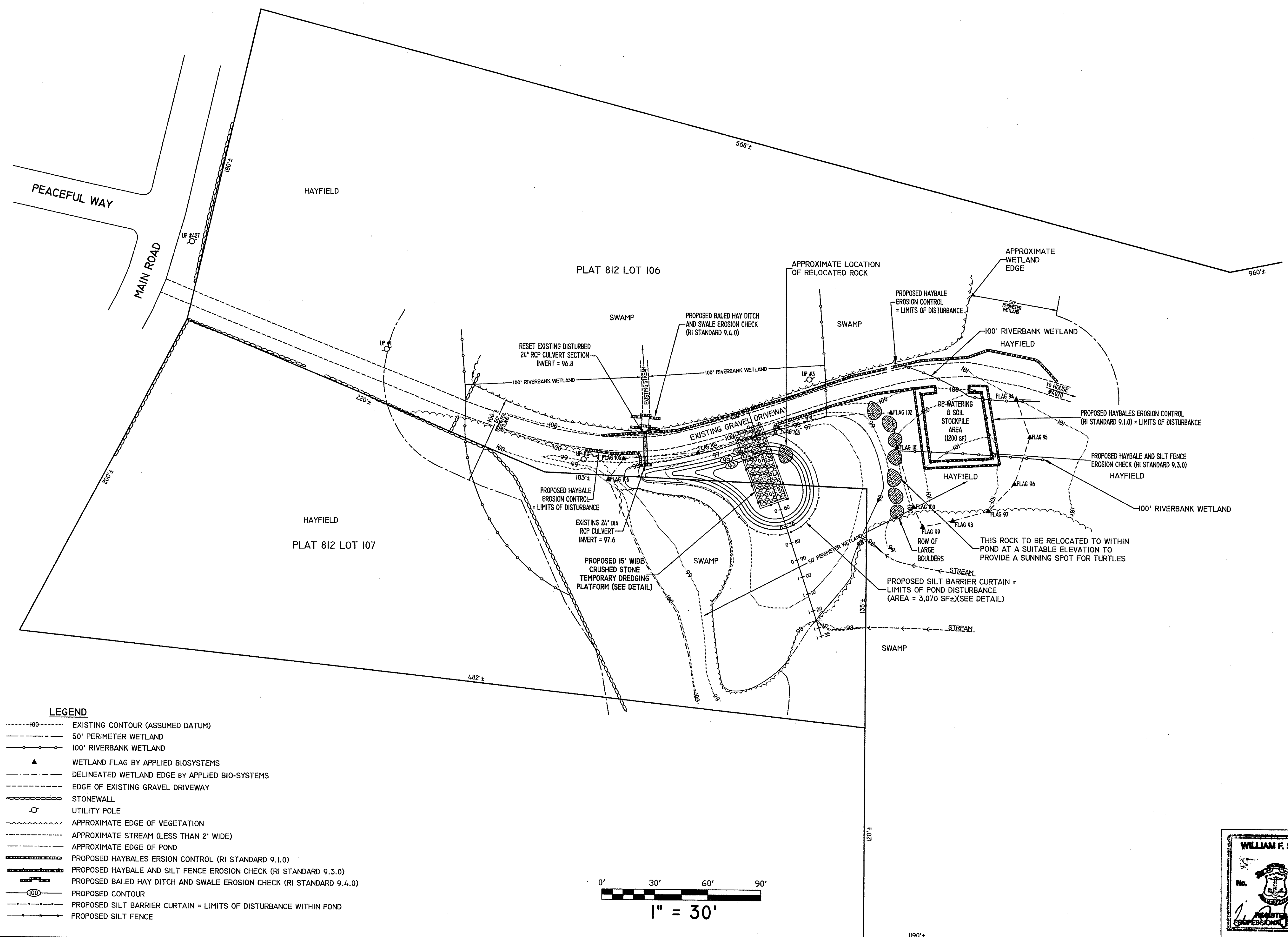
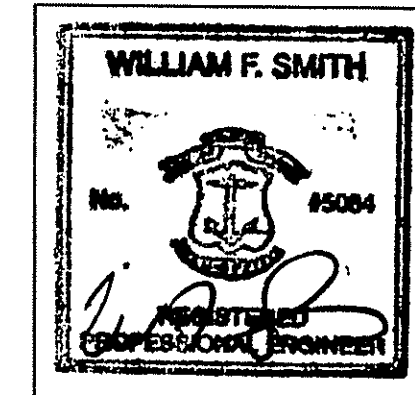
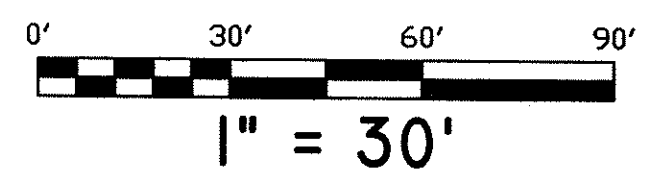

- #3: 4/12/13: PER RIDEM COMMENTS
  - #2: 12/04/12: PER APPLIED BIO-SYSTEMS COMMENTS
  - #1: 7/27/12: PER APPLIED BIO-SYSTEMS COMMENTS
- REVISIONS:

PROPOSED POND DREDGING PLAN  
PREPARED FOR  
**JIM & CYNTHIA PATTERSON**  
ASSESSOR'S PLAT 812 LOTS 106 & 107  
4070 MAIN ROAD  
TIVERTON, RHODE ISLAND

SCALE: 1" = 30' DATE: JULY 12, 2012

**Civil Engineering Concepts, Inc.**  
34A MAIN STREET P.O. BOX 5325  
LITTLE COMPTON, RI 02887 NEW BEDFORD, MA. 02742  
PH: (401) 592-0177 FAX: (401) 592-0178 (508) 990-4900  
EMAIL: wsmithccc@aol.com

SHEET 1 OF 2 WEB SITE: www.ri-engineer.com JOB#: 07-153

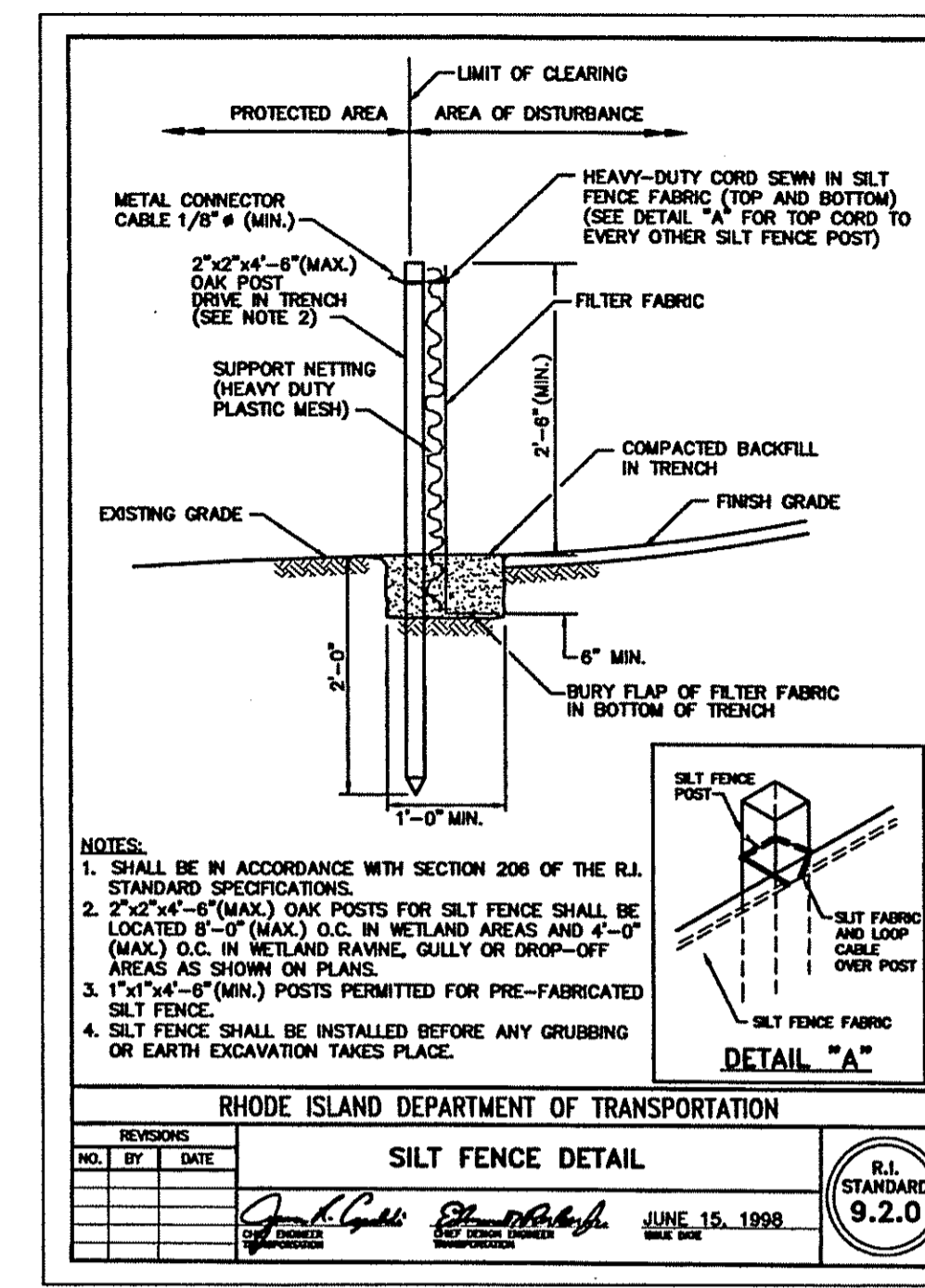
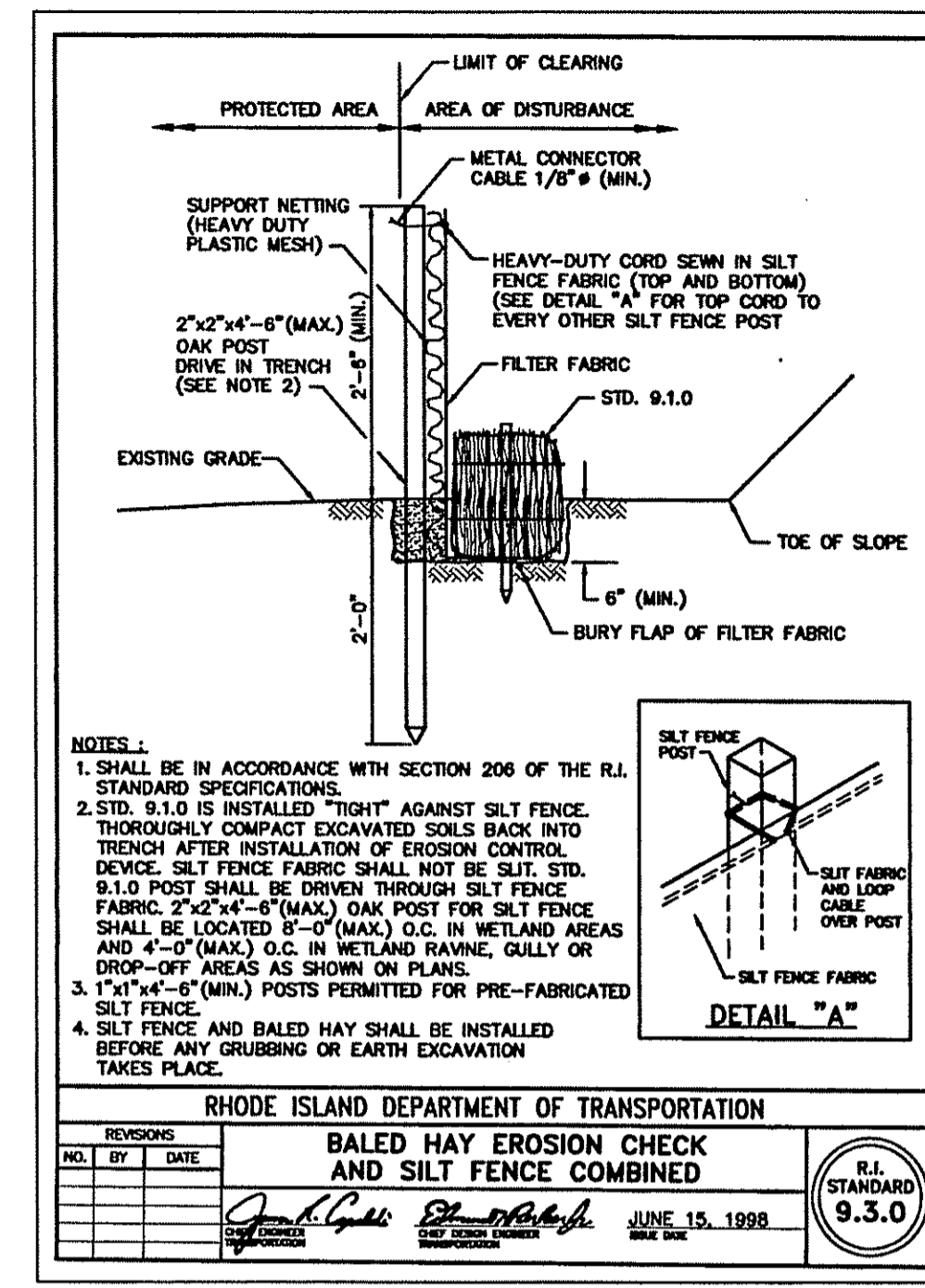
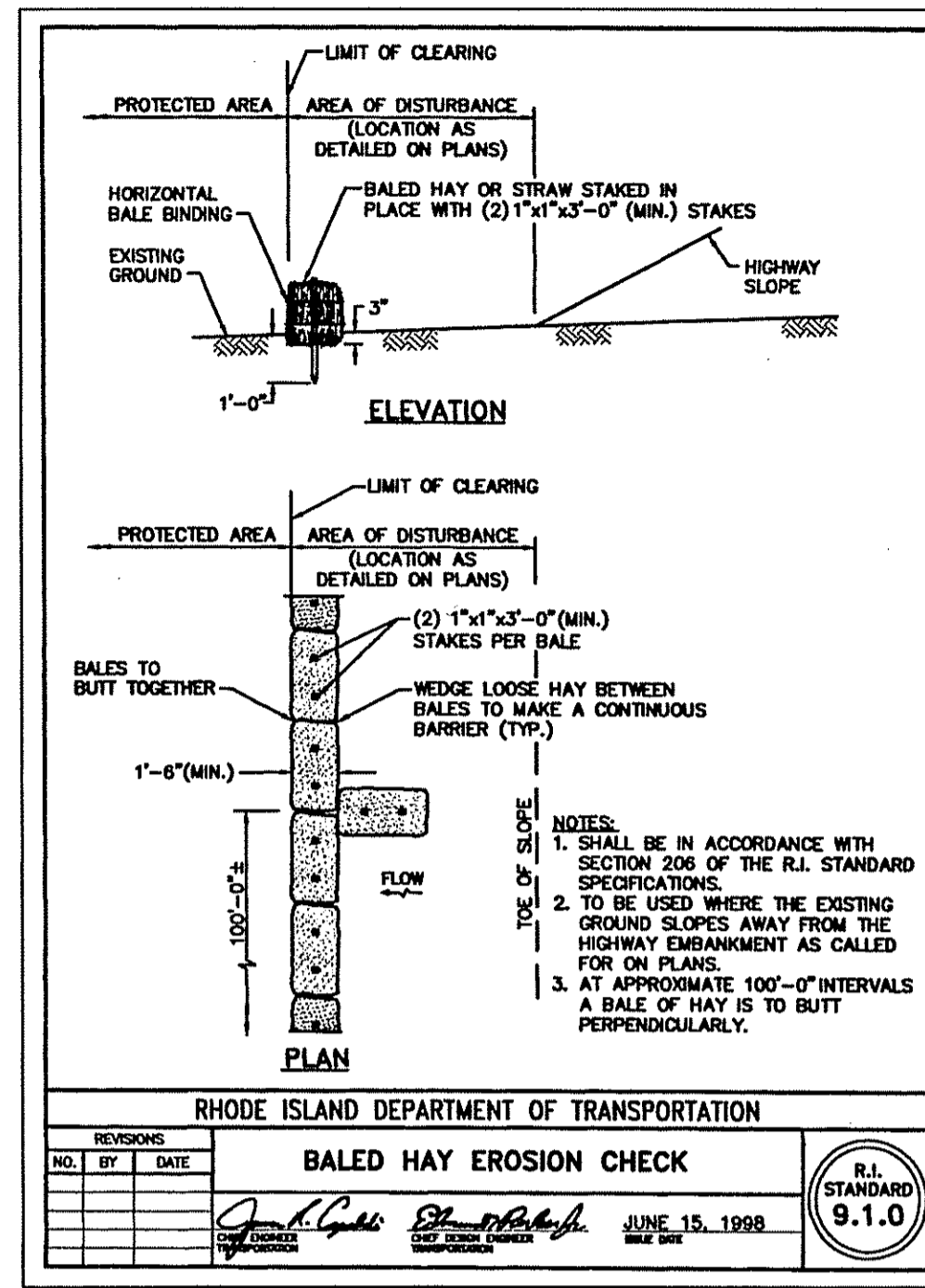
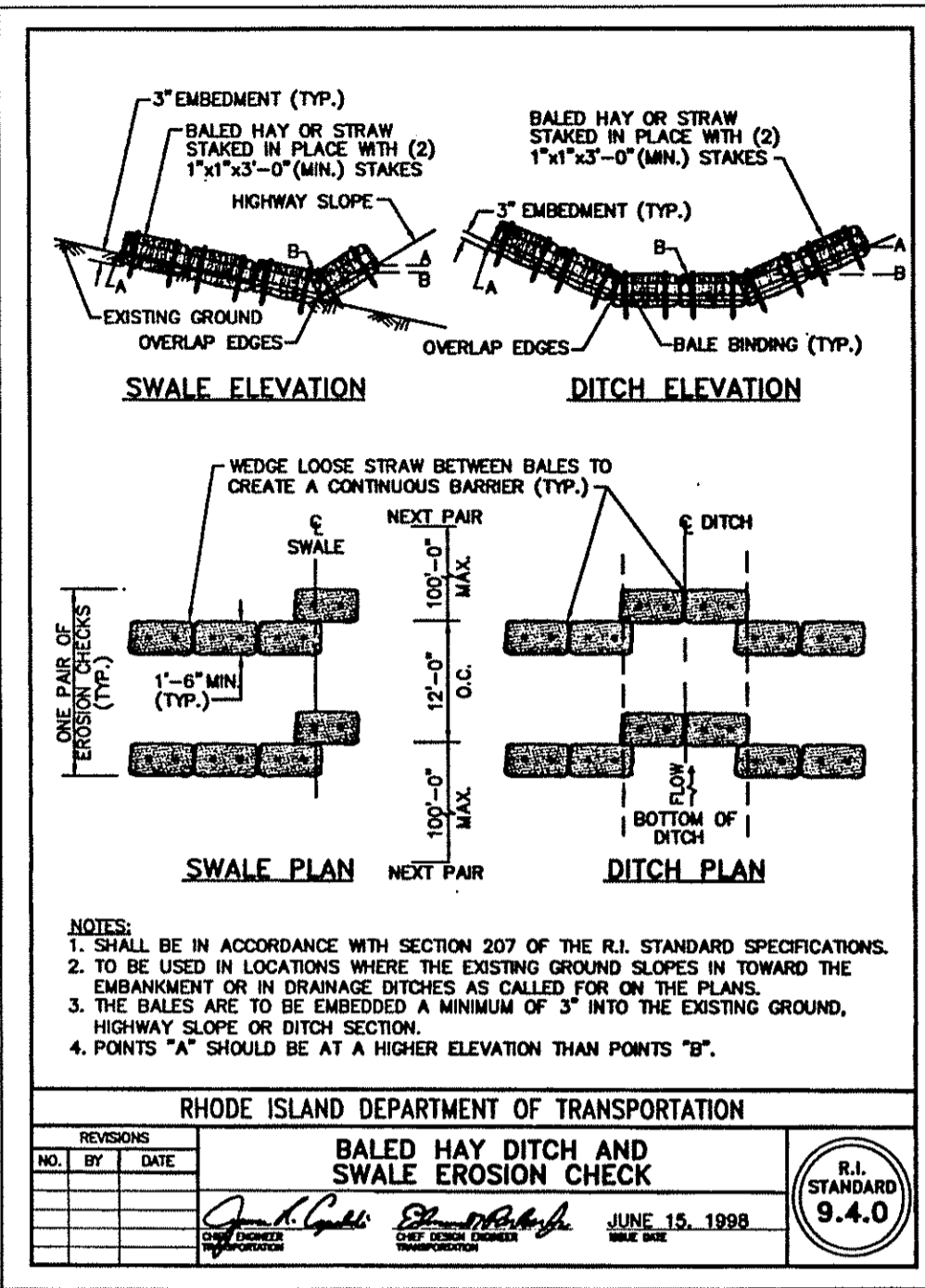

**NOTES:**

- 1) THE EXISTING FARM POND IS LOCATED MOSTLY ADJACENT TO A SWAMP AND AN OPEN HAYFIELD.
- 2) THE RE-EXCAVATION WILL NOT RESULT IN THE DIVERSION, DAMMING, OR DIKING OF ANY WATERCOURSE.
- 3) THE RE-EXCAVATION IS FOR MAINTENANCE PURPOSES TO REMOVE ACCUMULATED INORGANIC AND ORGANIC SEDIMENT. THE EXCAVATION WILL BE LIMITED TO A CENTRAL PROBLEM AREA.
- 4) ALL PROPER BMP'S AND OTHER CONTROLS WILL BE UTILIZED TO PROTECT THE ADJACENT WETLAND ENVIRONMENT.
- 5) ALL EXCAVATION WILL OCCUR DURING THE LOW WATER FLOW PERIOD OF THE YEAR (JULY 31 THROUGH SEPTEMBER 30).
- 6) NO WETLAND VEGETATION WILL BE DISTURBED. ALL WORK IS WITHIN THE AREA OF THE THREAD OF THE STREAM WITHIN THE OPEN WATER PORTION OF THE POND.
- 7) ALL WORK WILL BE DONE WITH EITHER AN EXCAVATOR OR DRAGLINE FROM THE EXISTING GRAVEL DRIVEWAY AND PROPOSED TEMPORARY DREDGING PLATFORM.
- 8) ALL SPOILS WILL BE DE-WATERED WITHIN A STAKED HAYBALE/SILT FENCE RING LOCATED IN THE UPLAND EDGE OF THE HAYFIELD. AFTER DE-WATERING THESE SEDIMENTS WILL BE REMOVED TO A SITE LOCATED OUTSIDE ANY WETLANDS OR PERIMETER WETLANDS ON THE PATTERSON PROPERTY.
- 9) THE DAMAGED RCP CULVERT PIPE ON THE NORTHWEST SIDE OF THE POND WILL BE REPLACED IN KIND MATCHING THE EXISTING INVERTS.
- 10) NO REFUELING OF VEHICLES IS PERMITTED WITHIN 150 FEET OF THE POND OR EXISTING WETLANDS.
- 11) THE HAYBALE, SILT FENCE, AND SILT BARRIER CURTAIN EROSION CONTROL MEASURES SHALL BE INSPECTED DAILY AND SHALL BE MAINTAINED AND REPLACED AS NECESSARY FOR THE DURATION OF THE PROJECT.
- 12) A COPY OF THE APPROVED POND DREDGING PLAN AND PERMIT SHALL BE KEPT ON-SITE FOR THE DURATION OF CONSTRUCTION ACTIVITIES.
- 13) IT IS THE CONTRACTORS RESPONSIBILITY TO NOTIFY DIG SAFE, AS REQUIRED BY LAW, PRIOR TO THE START OF CONSTRUCTION ACTIVITIES.
- 14) WHENEVER EXCAVATION RESULTS IN THE REMOVAL OF GRANULAR MATERIAL, THE EXCAVATOR SHALL LINE THE POND BOTTOM WITH 6" MINIMUM OF SILT LOAM TO INSURE THE POND DOES NOT BECOME DRAINED.

MAY 15 2013

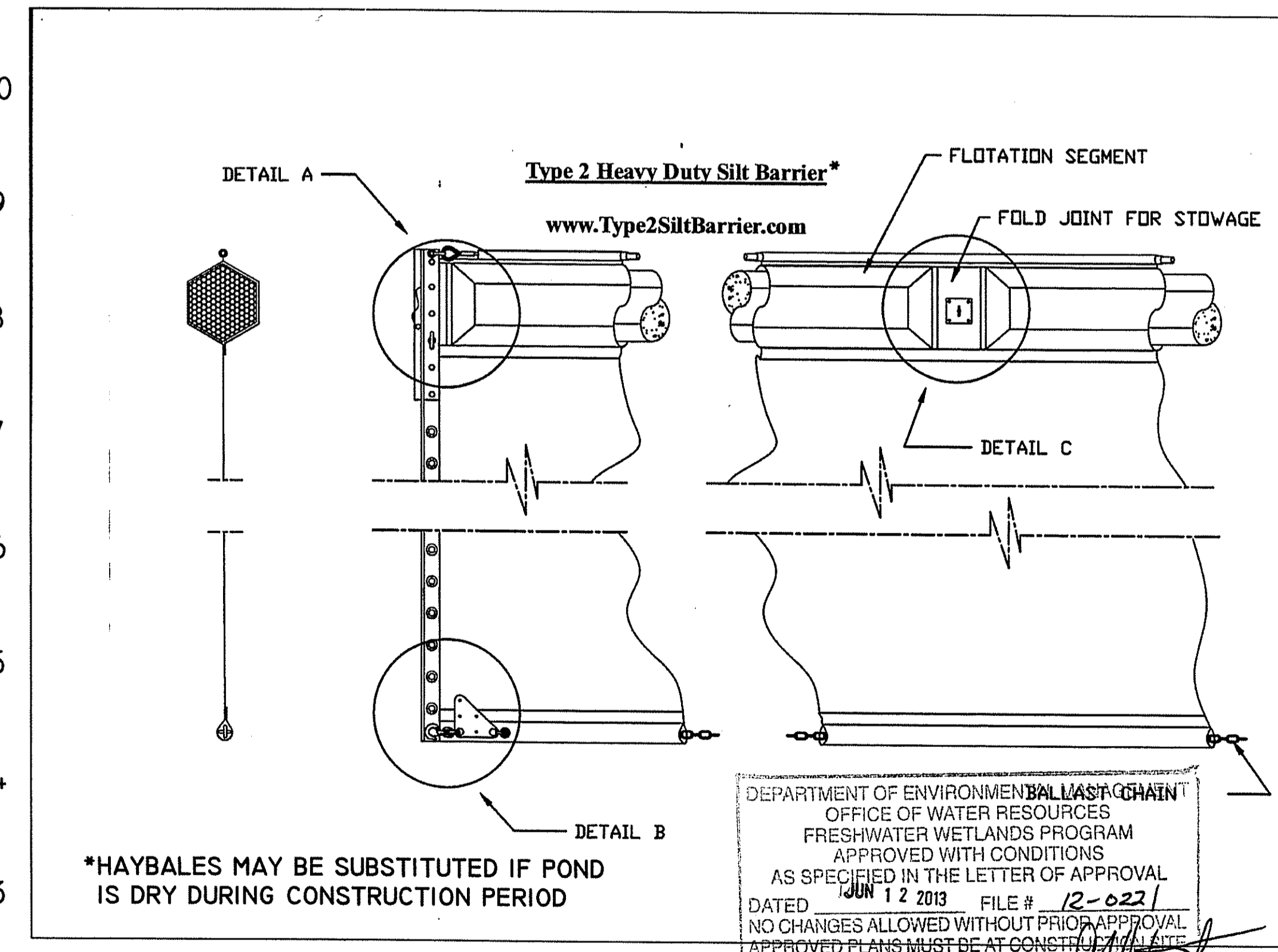
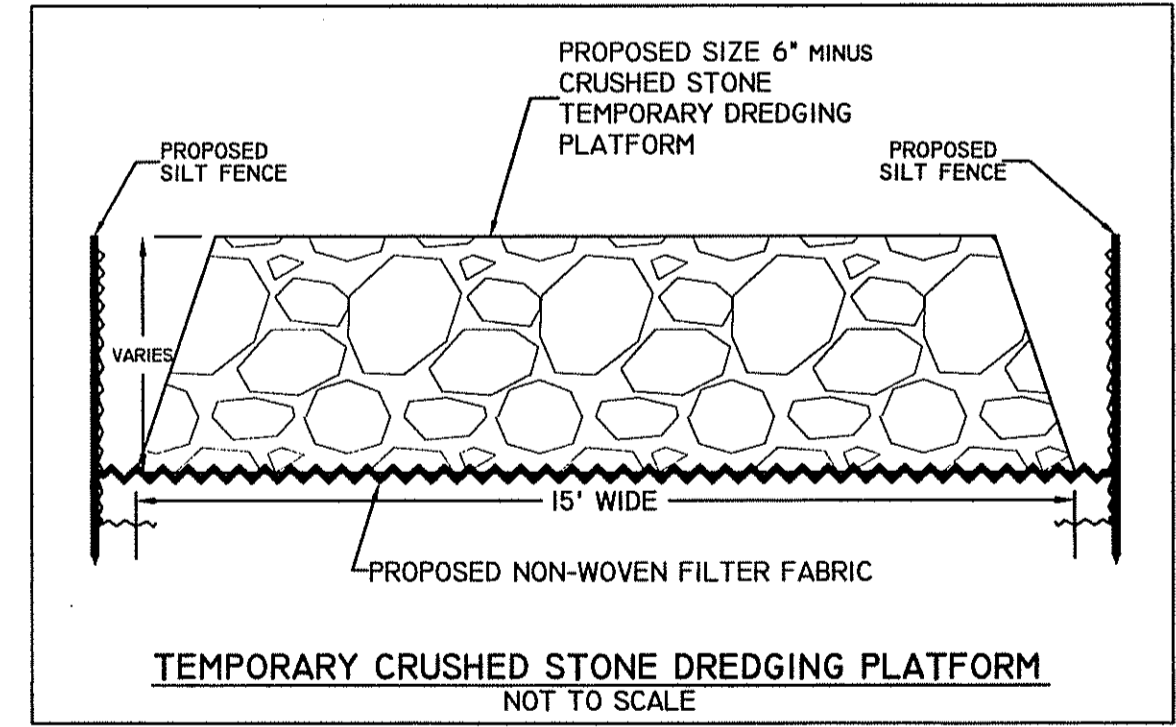
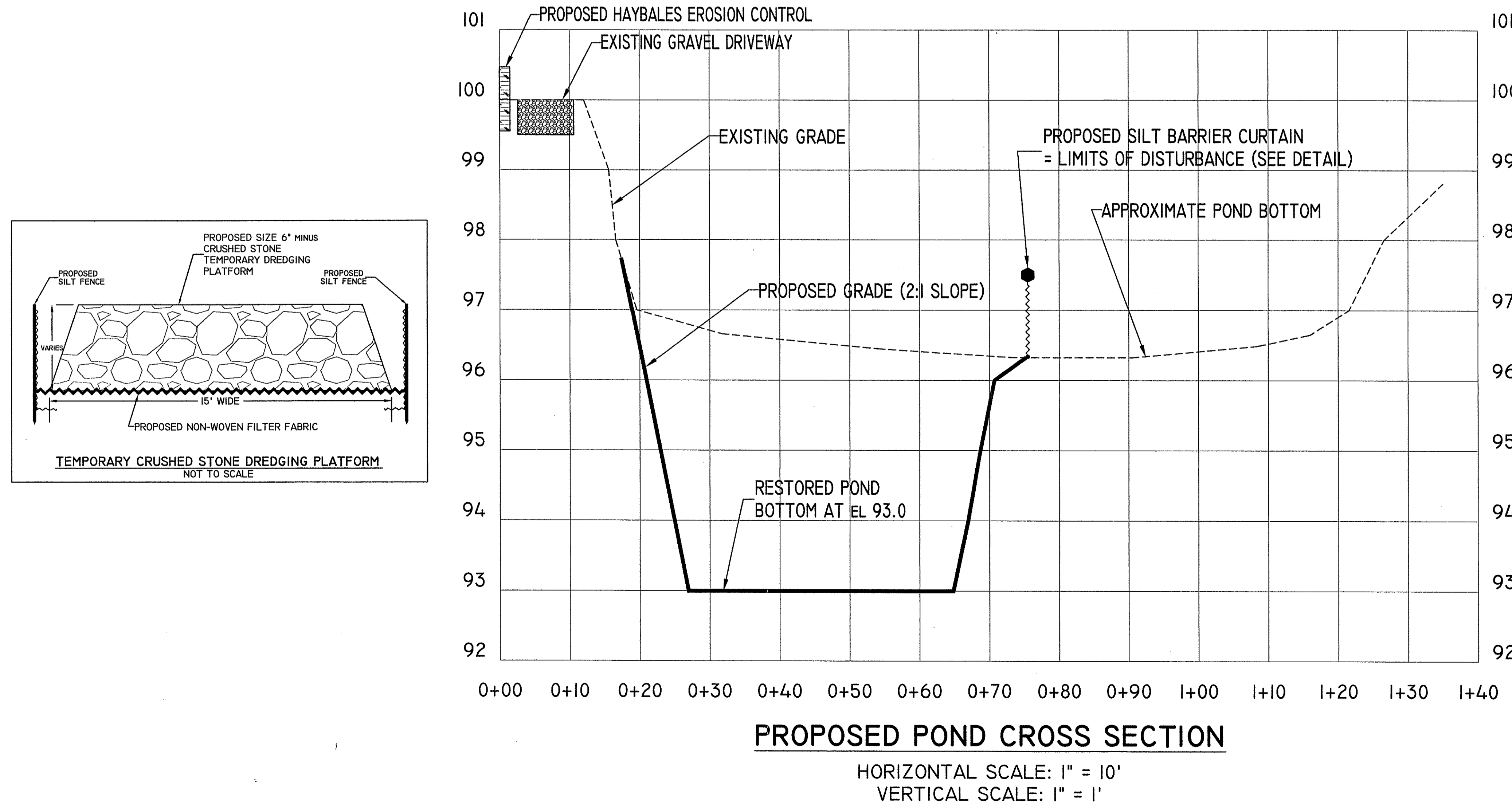

DEPARTMENT OF ENVIRONMENTAL MANAGEMENT  
 OFFICE OF WATER RESOURCES  
 FRESHWATER WETLANDS PROGRAM  
 APPROVED WITH CONDITIONS  
 AS SPECIFIED IN THE LETTER OF APPROVAL  
 DATED JUN 12 2013 FILE # 12-022  
 NO CHANGES ALLOWED WITHOUT PRIOR APPROVAL  
 APPROVED PLANS MUST BE AT CONSTRUCTION SITE

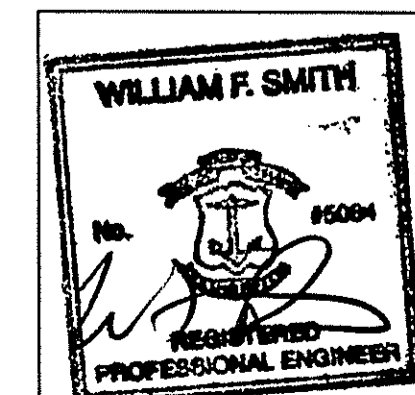

REVISIONS:

#3: 4/12/13: PER RIDEM COMMENTS
#2: 12/04/12: NO REVISIONS THIS SHEET
#1: 7/27/12: PER APPLIED BIO-SYSTEMS COMMENTS

PROPOSED POND DREDGING PLAN  
 PREPARED FOR  
**JIM & CYNTHIA PATTERSON**  
 ASSESSOR'S PLAT 812 LOTS 106 & 107  
 4070 MAIN ROAD  
 TIVERTON, RHODE ISLAND

SCALE: AS NOTED DATE: JULY 12, 2012

**Civil Engineering Concepts, Inc.**  
 34A MAIN STREET P.O. BOX 5323  
 LITTLE COMPTON, RI 02883 NEW BEDFORD, MA 02742  
 PH: (401) 592-0177 FAX: (508) 990-4900  
 FAX: (401) 592-0178 EMAIL: wsmthcecc@aol.com

REVISIONS: SHEET 2 OF 2 WEB SITE: www.ri-engineer.com JOB#: 07-153