

LOCUS
NOT TO SCALE

TEST HOLE DATA:
 DATE DUG - 4-9-13
 TEST HOLE - TH#3
 TEST HOLE - TH#4

GROUND WATER TABLE DATA: 1315-0282
 DETERMINED BY: SOIL EVALUATION
 WATER TABLE DEPTH = 22'
 WATER TABLE DEPTH = 24'

REQUIRED CAPACITY OF LEACHING SYSTEM:
 6 BEDROOMS X 115 GALLONS PER BEDROOM = 690 GALLONS PER DAY

DESIGN BOTTOMLESS SAND FILTER ON CATEGORY 9 SOILS
 BOTTOMLESS SAND FILTER DESIGN RATE = 1.5 GAL/S.F./DAY
 BOTTOMLESS SAND FILTER SIZE PROPOSED: 460 SQUARE FEET
 BOTTOMLESS SAND FILTER SIZE PROPOSED: 460 SQUARE FEET

TEMPORARY DISTURBANCE NOTES:
 1. THE LIMIT OF TEMPORARY DISTURBANCE ASSOCIATED WITH THE DWELLING IS FOR RENOVATIONS TO THE DWELLING AND CONSTRUCTION OF THE SECOND FLOOR ADDITION. NO EXCAVATION IS TO OCCUR IN THIS AREA EXCEPT FOR THE SEPTIC SYSTEM CONNECTION TO THE DWELLING. ALL AREAS WITHIN THE LIMIT OF TEMPORARY DISTURBANCE SHALL BE RETURNED TO THEIR EXISTING CONDITION ONCE CONSTRUCTION IS FINISHED.
 2. THE LIMIT OF TEMPORARY DISTURBANCE ASSOCIATED WITH THE SEPTIC SYSTEM WILL HAVE SOIL EROSION CONTROL MEASURES DURING CONSTRUCTION. ONCE CONSTRUCTION IS COMPLETE THE AREA WITHIN THE LIMIT OF TEMPORARY DISTURBANCE SHALL BE REGRADED AND LOAM AND SEEDED AS NEEDED.

- GENERAL NOTES:**
- THE SLOPE OF BUILDING SEWER FROM DWELLING TO SEPTIC TANK SHALL NOT BE LESS THAN 1 PERCENT AND NOT GREATER THAN 5 PERCENT.
 - THE OUTLET AND INLET PIPES SHALL BE CONNECTED TO THE SEPTIC TANK WITH A WATERTIGHT SEALED FLEXIBLE JOINT. THE PIPE GASKET SHALL BE AN INTEGRAL PART OF ALL TANKS AND THE PIPE GASKET SHALL BE FASTENED TO THE PIPE WITH A STAINLESS STEEL RETRACTABLE CLAMP. A FRICTION FIT CONNECTION IS ONLY ALLOWED IF THE TANK IS PERFORMANCE TESTED.
 - SURFACE WATER SHALL BE DIVERTED AWAY FROM THE SEPTIC TANK OPENING.
 - ACCESSIBILITY TO SEPTIC TANKS SHALL BE LOCATED ON THE LOT AS TO BE ACCESSIBLE FOR SERVICING AND CLEANING.
 - INSTALLATION OF ALL SEPTIC TANKS SHALL BE INSTALLED IN ACCORDANCE WITH THE MANUFACTURER'S MINIMUM REQUIREMENTS. IN ADDITION, ALL SEPTIC TANKS MUST MEET THE INSTALLATION REQUIREMENTS SPECIFIED.
 - BACKFILL SHALL BE PLACED AROUND THE SEPTIC TANK IN SUCH A MANNER AS TO AVOID DAMAGE TO IT. ALL BACKFILL PLACED AROUND THE SEPTIC TANK SHALL BE FREE OF LARGE STONES, STUMPS, WASTE, CONSTRUCTION MATERIAL AND RUBBISH.
 - USE SCHED 40 PVC PIPING OR EQUIVALENT THROUGHOUT SEWAGE SYSTEM, EXCEPT AS NOTED.
 - NO WELL EXISTS WITHIN 200 FEET OF THE PROPOSED SEWAGE SYSTEM EXCEPT AS SHOWN.
 - IF A WELL IS PROPOSED, NO SEWAGE SYSTEM EXISTS WITHIN 200 FEET OF THE SEWAGE SYSTEM WELL EXCEPT AS SHOWN.
 - ALL WELLS, EXISTING AND PROPOSED, WITHIN 200 FEET OF THE SEWAGE SYSTEM ARE SHOWN. ALL PUBLIC WELLS, EXISTING AND PROPOSED, WITHIN 500 FEET OF THE SEWAGE SYSTEM AREA ARE SHOWN.
 - IF A DRIVEWAY OR PAVEMENT IS TO BE NEAR THE SEWAGE SYSTEM, A PROTECTIVE BERM IS TO BE PLACED AROUND THE SEWAGE SYSTEM IN THE AREA OF THE DRIVEWAY OR PAVEMENT TO PREVENT VEHICULAR TRAFFIC TRAVELING OVER THE SEWAGE SYSTEM.
 - INSTALLER TO MEET ALL O.W.T.S. SPECIFICATIONS AND REQUIREMENTS.
 - NO DRAINS OF ANY KIND SHALL BE LOCATED WITHIN 25 FEET OF THE PROPOSED SEWAGE SYSTEM.
 - THE FINISH GRADE AT 5 FEET FROM ALL SIDES OF LEACHING FIELD SHALL NOT BE LOWER THAN ELEVATION OF 94.0 WITH 3:1 SLOPE.
 - OWNER AND/OR BUILDER IS RESPONSIBLE FOR BUILDING AND LEACHING FIELD MEETING LOCAL ZONING SETBACK REQUIREMENTS.
 - ALL UNDERGROUND UTILITIES AND STRUCTURES ARE APPROXIMATE AND MUST BE FIELD VERIFIED BEFORE THE START OF ANY CONSTRUCTION OR EXCAVATION.
 - THE PROPOSED SILT FENCE IS TO BE INSTALLED BEFORE THE START OF ANY CONSTRUCTION AND REMAIN IN PLACE UNTIL ALL DISTURBED AREAS ARE REVEGETATED.
 - THE SILT FENCE IS TO BE INSPECTED ONCE A MONTH OR AFTER ALL STORM EVENTS AND REPAIRED AS NEEDED.
 - THE PARCEL ASSESSOR'S PLAT AT 10, LOT 119.
 - THE PARCEL AREA EQUALS 57,120± S.F. OR 1.31± ACRES.

- SEPTIC TANK NOTES:**
- ONE INLET AND ONE OUTLET SHALL BE PROVIDED THROUGH THE APPROPRIATE END OR SIDE WALL OF EACH TANK. WHERE MORE THAN ONE INLET IS REQUIRED FOR MULTIPLE BUILDING SEWERS, THE TANK SHALL BE MANUFACTURED WITH THE APPROPRIATE NUMBER OF INLETS.
 - THE INVERT ELEVATION OF THE OUTLET SHALL BE AT LEAST 3 INCHES BELOW THE INVERT ELEVATION OF THE INLET, AND ABOVE THE SEASONAL HIGH GROUNDWATER TABLE.
 - THE OUTLET AND INLET PIPES SHALL BE CONNECTED TO THE SEPTIC TANK WITH A WATERTIGHT SEALED FLEXIBLE JOINT. THE PIPE GASKET SHALL BE AN INTEGRAL PART OF ALL TANKS AND THE PIPE GASKET SHALL BE FASTENED TO THE PIPE WITH A STAINLESS STEEL RETRACTABLE CLAMP. A FRICTION FIT CONNECTION IS ONLY ALLOWED IF THE TANK IS PERFORMANCE TESTED.
 - SEPTIC TANKS SHALL BE PROVIDED WITH AN INLET SANITARY TEE AND OUTLET TEES OR OTHER NON-CORRODING EQUIVALENT DEVICE APPROVED BY THE SYSTEM. THE INLET AND OUTLET TEES SHALL BE MINIMUM SDR 35 PVC SOLVENT WELDED. THE TOPS OF THE TEES SHALL EXTEND A MINIMUM OF 6 INCHES ABOVE THE FLOW LINE, AND SHALL BE LEFT OPEN TO PROVIDE VENTILATION. THERE SHALL BE AN AIR SPACE OF AT LEAST 3 INCHES BETWEEN THE TOP OF THE TEES AND TOP INTERIOR OF THE TANK.
 - THE INLET SANITARY TEE SHALL EXTEND DOWNWARD AT LEAST 12 INCHES BELOW THE FLOW LINE.
 - THE OUTLET TEE SHALL EXTEND DOWNWARD 1/3 OF THE DEPTH BELOW THE FLOW LINE. ALL OUTLET TEES OR OTHER APPROVED OUTLET DEVICES SHALL BE EQUIPPED WITH AN EFFLUENT SCREEN.
 - SPECIFICATIONS FOR INLET TEES AND OUTLET TEES ARE FOR NORMAL, LOW-FLOW CONDITIONS. HIGH-FLOW CONDITIONS, CREATED WITH LIQUID IS PUMPED FROM ANOTHER TANK, MAY REQUIRE OTHER DIMENSIONS AND CONSIDERATIONS.
 - A MINIMUM 20 INCHES INSIDE DIAMETER ACCESS OPENING SHALL BE LOCATED OVER BOTH THE INLET TEE AND OUTLET TEE. ALL SEPTIC TANK OPENINGS SHALL MEET THE FOLLOWING REQUIREMENTS:
 - THE ACCESS OPENING OVER THE OUTLET TEE SHALL BE BROUGHT TO FINISHED GRADE. OTHER ACCESS OPENINGS SHALL EITHER BE BROUGHT TO FINISHED GRADE OR WITHIN 12 INCHES OF FINISHED GRADE. WHERE A RISER IS REQUIRED, IT SHALL BE WATERTIGHT.
 - LIDS ON TOP OF THE SEPTIC TANK SHOULD REMAIN IN PLACE WHERE PRACTICAL. LIDS FOR THE OPENING AT FINISHED GRADE SHALL PREVENT UNAUTHORIZED ENTRY BY MEETING EITHER OF THE FOLLOWING: (A) LID SHALL WEIGH A MINIMUM OF 59 POUNDS AND FIT TIGHTLY ONTO THE RISER OR (B) LID SHALL BE TAMPER RESISTANT AND MECHANICALLY FASTENED.
 - THE SEPTIC TANK MANUFACTURERS SHALL PROVIDE AND LICENSED OWTS INSTALLERS SHALL ATTACH A LABEL OF NON-CORROSIVE MATERIAL IN A PROMINENT LOCATION AT EACH ACCESS OPENING TO WARN THAT "ENTRANCE INTO THE TANK COULD BE FATAL."
 - SURFACE WATER SHALL BE DIVERTED AWAY FROM THE SEPTIC TANK OPENING.
 - ACCESSIBILITY TO SEPTIC TANKS SHALL BE LOCATED ON THE LOT AS TO BE ACCESSIBLE FOR SERVICING AND CLEANING.
 - INSTALLATION OF ALL SEPTIC TANKS SHALL BE INSTALLED IN ACCORDANCE WITH THE MANUFACTURER'S MINIMUM REQUIREMENTS. IN ADDITION, ALL SEPTIC TANKS MUST MEET THE INSTALLATION REQUIREMENTS SPECIFIED.
 - THE SEPTIC TANK SHALL BE INSTALLED ON A LEVEL, STABLE BASE THAT WILL NOT SETTLE.
 - BACKFILL SHALL BE PLACED AROUND THE SEPTIC TANK IN SUCH A MANNER AS TO AVOID DAMAGE TO IT. ALL BACKFILL PLACED AROUND THE SEPTIC TANK SHALL BE FREE OF LARGE STONES, STUMPS, WASTE, CONSTRUCTION MATERIAL AND RUBBISH.
 - WHERE ANY PORTION OF A SEPTIC TANK IS INSTALLED BELOW THE SEASONAL HIGH GROUNDWATER TABLE, THE TANK'S SUSCEPTIBILITY TO FLOATION SHALL BE DETERMINED, AND PROVISIONS SHALL BE MADE TO PREVENT FLOATION, WHERE NECESSARY AS DETERMINED BY THE FLOATION CALCULATIONS.
 - WHENEVER MORE THAN 25 PERCENT OF THE DAILY DESIGN FLOW IS PUMPED INTO A SEPTIC TANK, THE TANK CAPACITY SHALL BE INCREASED BY 50 PERCENT BEYOND THE MINIMUM CAPACITIES.
 - THE MINIMUM COVER OVER THE INVERT OF THE OUTLET SHALL BE 18 INCHES. IF THE DEPTH OF COVER EXCEEDS 42 INCHES, THE OWTS APPLICATION SHALL INCLUDE DOCUMENTATION OF THE TANK'S ABILITY TO STRUCTURALLY WITHSTAND THE LOADING, AND THE TANK'S DESIGN SHALL ALLOW FOR PROPER MAINTENANCE AND ACCESS.
 - THE SEPTIC TANK SHALL BE A MINIMUM OF 75 FEET FROM ALL WELLS.

- SEPTITECH NOTES**
- Tank(s) shall not be installed at a depth any greater than 24-inches. Tank installations requiring a depth greater than 24-inches shall do so with prior approval by SeptiTech only.
 - Tank(s) shall be installed with a minimum of 12-inches of compacted crushed stone bedding. Select fill shall be used for back filling around tanks. Native material may be used if approved by the design engineer.
 - Water Testing: Contractor is responsible for water testing the concrete tank(s) once the tank(s) installation has been completed and allowed to set overnight. Water testing shall be conducted in accordance with ASTM C1227.9.2. Installing contractor shall be responsible for providing clean water for the testing, filling the tanks, and pumping the tanks dry once testing is completed.
 - Exterior Piping: Contractor is responsible for supplying and installing all exterior piping per SeptiTech installation drawings.
 - Air Intake Piping: Air intake snorkel shall be installed within 100 feet of the processor tank. Air intake piping shall be installed such that a positive pitch is provided back towards the processor tank such that any condensation build up is free to drain.
 - Pipe Insulation: Contractor is responsible for insulating all piping exterior to the SeptiTech processor including the discharge line from the processor to the disposal field.
 - Tank Insulation: After concrete tanks have been installed and water testing is completed, contractor shall insulate the top and sides of the processor tank below frost depth (4-foot minimum) down the sides of the tank with 2" rigid foam (blue) board insulation and then complete backfilling. Contractor is also responsible for installing insulation over the top of the force main from the SeptiTech system to the disposal field if not buried below frost level in order to prevent freezing. The Contractor is also responsible for installing insulation over the top of the return line from the processor tank back to the septic tank in order to prevent freezing.
 - Electrical: All electrical work is the responsibility of the contractor's licensed electrician and is not provided by SeptiTech.
 - SeptiTech processors can also be built to 3-phase power requirements. If 3-phase is required, please notify SeptiTech at the time of contract signing.

TABLE OF ELEVATIONS:

GROUND AT TH#3.....	93.5
WATER TABLE AT TH#3.....	93.5
GROUND AT TH#4.....	94.8
WATER TABLE AT TH#4.....	92.8
INV. OUT HOUSE.....	94.8 (EXISTING)
INV. IN SEPTIC TANK.....	93.60
INV. OUT SEPTIC TANK.....	93.35
INV. IN SEPTITECH.....	93.10
BOTTOMLESS SAND FILTER ELEVATIONS:	
SAND/PEA STONE INTERFACE.....	96.00
INV. ELEVATION OF LATERALS.....	96.25
TOP OF PEA STONE.....	96.75
TOP OF TIMBER ENCLOSURE.....	96.75
FINISHED GRADE AT BSF.....	94.00 (MIN)

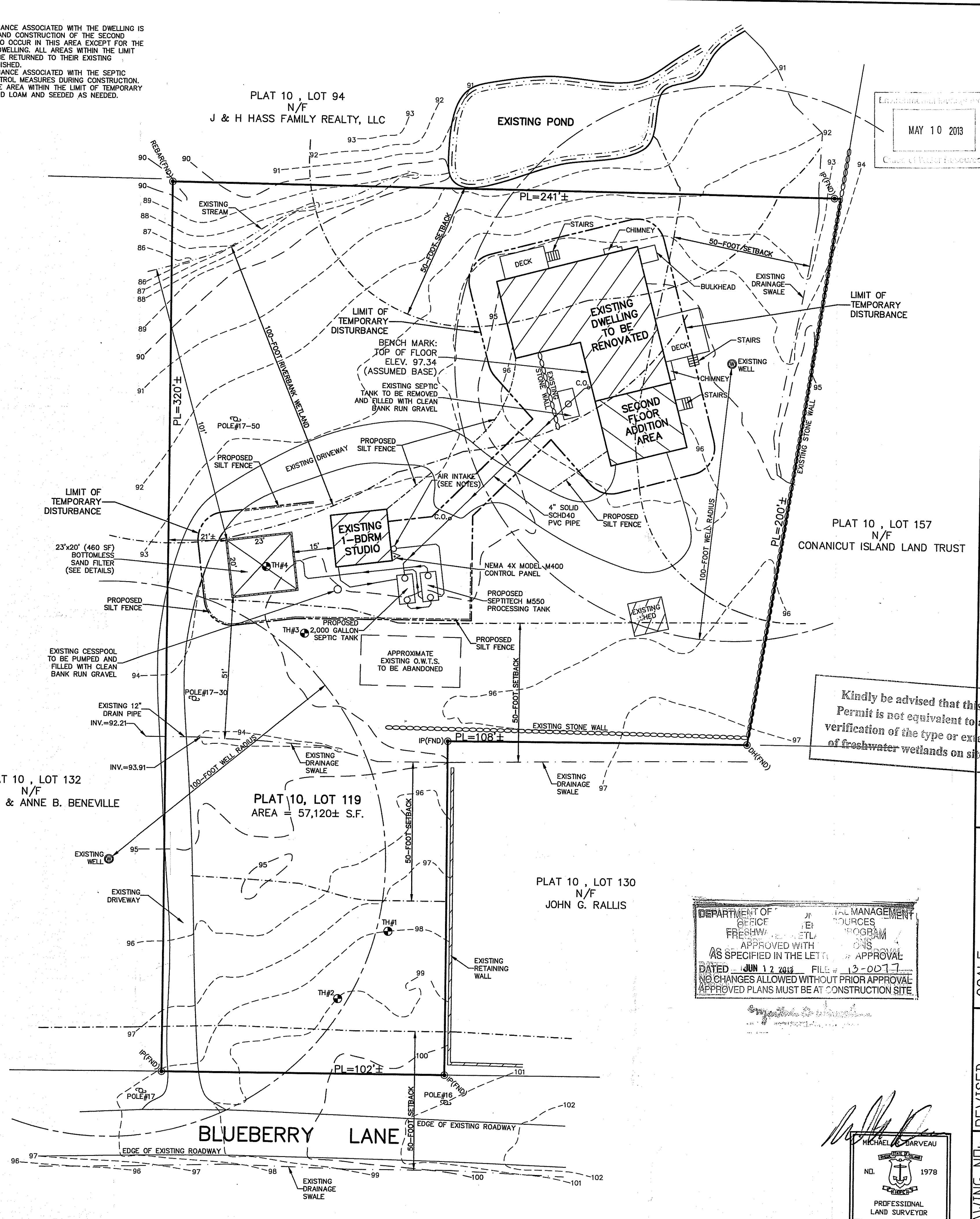

MAY 10 2013

Kindly be advised that this Permit is not equivalent to verification of the type or extent of freshwater wetlands on site.

DEPARTMENT OF ENVIRONMENTAL MANAGEMENT
 OFFICE OF WATER RESOURCES
 FRESHWATER WETLANDS PROGRAM
 APPROVED WITH CONDITIONS
 AS SPECIFIED IN THE LETTER OF APPROVAL
 DATED - JUN 12 2013 FILE # 13-0017
 NO CHANGES ALLOWED WITHOUT PRIOR APPROVAL
 APPROVED PLANS MUST BE AT CONSTRUCTION SITE

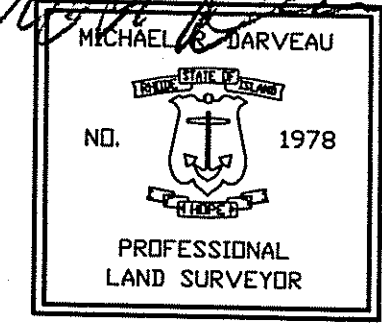

DARVEAU LAND SURVEYING, INC.
 P.O. BOX 7918
 CUMBERLAND, R.I. 02864
 PHONE 401-475-5700
 E-MAIL: DARVEAUSURVEY@COX.NET

PROPOSED LEACHING FIELD DESIGN FOR
NOREEN DREXEL
 PLAT 10, LOT 119
 90 BLUEBERRY LANE
 JAMESTOWN, RHODE ISLAND

SCALE: 1" = 20'

DRAWN BY: S.A.K.

DATE: APR. 24, 2013

DRAWING NO: 2013_012
 SHEET NO: 1 OF 2

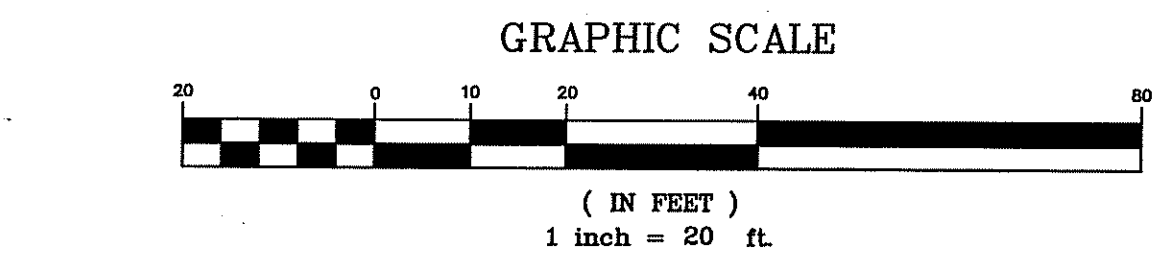

LEGEND

TH	SOIL EVALUATION TEST HOLE
IP	IRON PIPE
DH	DRILL HOLE

