

**REFERENCES:**

AERIAL IMAGERY TAKEN FROM GOOGLE EARTH, EUROPA TECHNOLOGY 2013 IMAGERY.

PROPERTY INFORMATION SHOWN APPROXIMATE FOR PLANNING PURPOSES TAKEN FROM BEST AVAILABLE INFORMATION INCLUDING MARKED ONSITE BOUNDARY MARKERS & A DEED RECORDED IN THE TOWN OF EAST GREENWICH LAND EVIDENCE RECORDS AT BOOK 40, PAGE 520.

**FLOOD ZONE NOTE:**

THE STREAM CHANNEL HAS AN ASSOCIATED 100-YEAR FLOOD PLAIN, CLASSIFIED BY FEMA AS ZONE A2, BASE FLOOD ELEVATIONS AND HAZARDS DETERMINED, ACCORDING TO (F.I.R.M) FLOOD INSURANCE RATE MAP FOR THE TOWN OF EAST GREENWICH, RHODE ISLAND KENT COUNTY, PANEL 2 OF 7 ON COMMUNITY PANEL NUMBER 44537 0002 C, MAP REVISED: FEBRUARY 16, 1983. THE FLOOD PLAIN IS CONFINED WITHIN THE BANKS OF THE CHANNEL ON THE SOUTHERN SIDE OF THE STREAM, IN THE VICINITY OF THE WORK ZONE AND DWELLING.

FEMA COMPLETED A PRELIMINARY FLOOD INSURANCE STUDY, ON JUNE 5, 2009 44003CV001A OF THE MASKERCHUGG RIVER. THE 100-YEAR FLOOD ELEVATION AS DEPICTED BY THIS STUDY IS APPROXIMATELY 2.9 DEEP AT THIS LOCATION.

**LEGEND**

- 101 — EXISTING CONTOURS
- 101 — PROPOSED CONTOUR
- — EXISTING SITE CONDITIONS
- — PROPOSED CONDITIONS
- — PROPERTY LINE
- U.P.# — EXISTING UTILITY POLE
- — — — — EDGE OF STREAM BANK
- — — — — STREAM CENTERLINE
- — — — — TREELINE
- — — — — STONEWALL
- — — — — FENCE (STOCKADE)

DEPARTMENT OF ENVIRONMENTAL MANAGEMENT  
 OFFICE OF WATER RESOURCES  
 FRESHWATER WETLANDS PERMIT  
 APPROVED WITH CONDITIONS  
 AS SPECIFIED IN THE LETTER  
 DATED SEP 04 2013 FILE # 13-0130  
 NO CHANGES ALLOWED WITHOUT PERMIT  
 APPROVED PLANS MUST BE AT CONSTRUCTION SITE

**TERRI A. GENTES**  
 No. 8672  
 REGISTERED PROFESSIONAL ENGINEER  
 CIVIL

*Nancy L. Freeman*

PREPARED FOR:  
**HOWARD & CAROLINA GOLDMAN**  
 115 MIDDLE ROAD  
 EAST GREENWICH, RHODE ISLAND

PREPARED BY:  
**JEFFREY J. CAMPOPIANO, P.E.**  
 16 WEST MAIN STREET  
 WICKFORD, RHODE ISLAND 02852  
 PHONE: (401) 295-3037 / FAX: 295-1118

**PROJECT OVERVIEW PLAN**  
**POND RESTORATION**  
 115 MIDDLE ROAD  
 MAP 64 / PLAT 9 / LOT 3  
 EAST GREENWICH, RHODE ISLAND

NO.	DATE	REVISIONS / LOG / NOTES
1	7/22/13	

DATE: 7/22/13  
 SCALE: 1"=50'

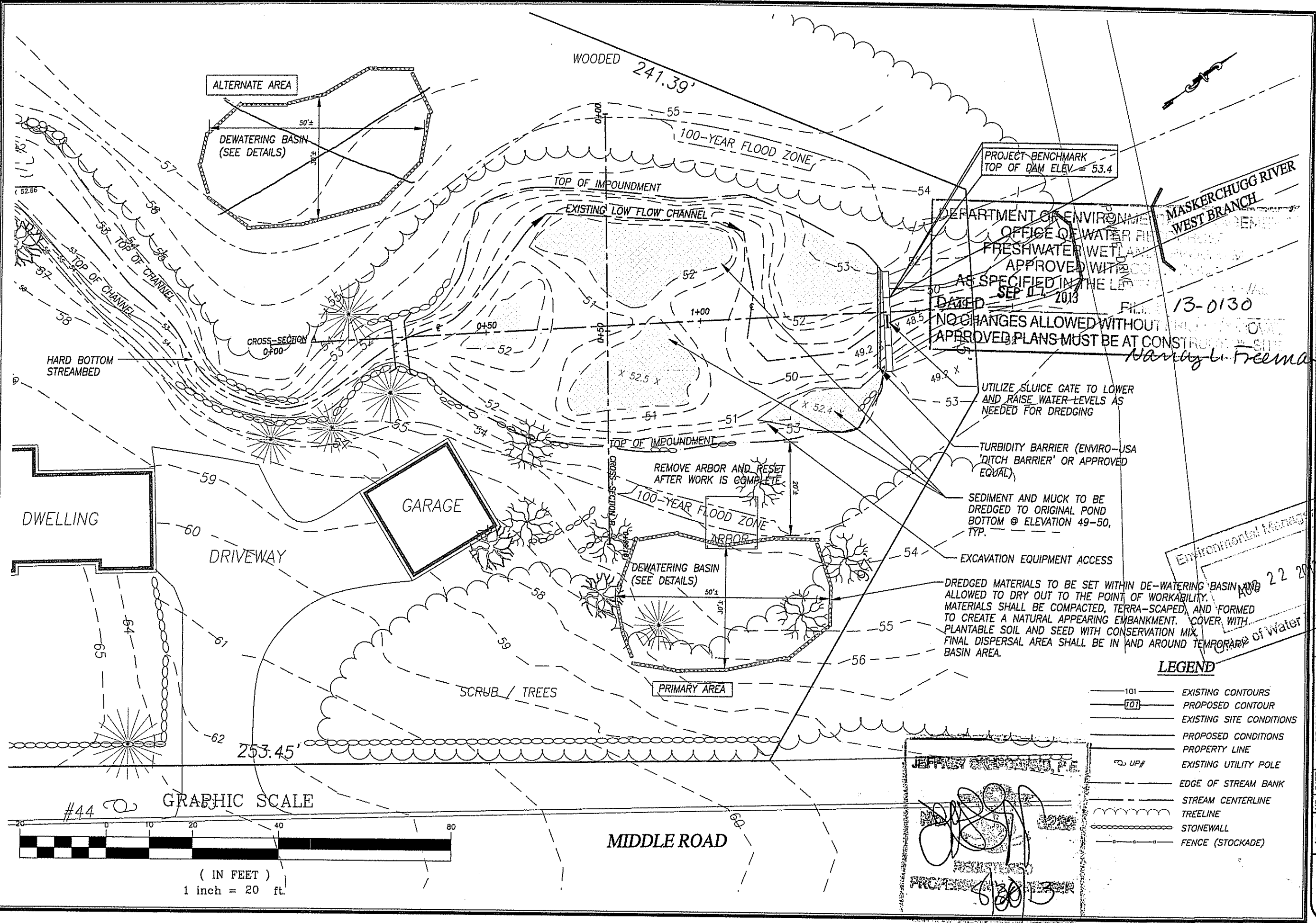

DEPARTMENT OF ENVIRONMENTAL MANAGEMENT  
 OFFICE OF WATER RESOURCES  
 FRESHWATER WETLANDS  
 APPROVED WITH CONDITIONS  
 AS SPECIFIED IN THE LETTER DATED SEP 07, 2013  
 FILE 13-0130  
 NO CHANGES ALLOWED WITHOUT APPROVED PLANS MUST BE AT CONSTRUCTION SITE

- UTILIZE SLUICE GATE TO LOWER AND RAISE WATER LEVELS AS NEEDED FOR DREDGING
- TURBIDITY BARRIER (ENVIRO-USA 'DITCH BARRIER' OR APPROVED EQUAL)
- SEDIMENT AND MUCK TO BE DREDGED TO ORIGINAL POND BOTTOM @ ELEVATION 49-50, TYP.
- EXCAVATION EQUIPMENT ACCESS
- DREDGED MATERIALS TO BE SET WITHIN DE-WATERING BASIN AND ALLOWED TO DRY OUT TO THE POINT OF WORKABILITY. MATERIALS SHALL BE COMPACTED, TERRA-SCAPED, AND FORMED TO CREATE A NATURAL APPEARING EMBANKMENT. COVER WITH PLANTABLE SOIL AND SEED WITH CONSERVATION MIX. FINAL DISPERSAL AREA SHALL BE IN AND AROUND TEMPORARY BASIN AREA.

**LEGEND**

- 101 EXISTING CONTOURS
- 101 PROPOSED CONTOUR
- EXISTING SITE CONDITIONS
- PROPOSED CONDITIONS
- PROPERTY LINE
- EXISTING UTILITY POLE
- EDGE OF STREAM BANK
- STREAM CENTERLINE
- TREELINE
- STONEWALL
- FENCE (STOCKADE)

JEFFREY CAMPOPIANO, P.E.  
 PROFESSIONAL ENGINEER  
 8/20/13

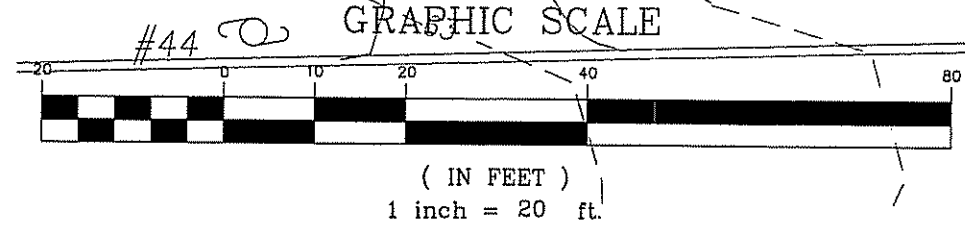

PREPARED FOR:  
**HOWARD & CAROLINA GOLDMAN**  
 115 MIDDLE ROAD  
 EAST GREENWICH, RHODE ISLAND

PREPARED BY:  
**JEFFREY J. CAMPOPIANO, P.E.**  
 16 WEST MAIN STREET  
 WICKFORD, RHODE ISLAND 02832  
 PHONE: (401) 295-3037 / FAX: 295-1118

**SITE PLAN**  
**POND RESTORATION**  
 115 MIDDLE ROAD  
 MAP 64 - PLAT 9 / LOT 3  
 EAST GREENWICH, RHODE ISLAND

NO.	DATE	REVISIONS
1	8/13	PRIMARY DISPERSAL AREA

DATE: 7/22/13  
 SCALE: 1"=20'

**2**  
 SHEET 2 OF 5

CROSS SECTION A-A

1" = 10' HORZ.  
1" = 1' VERT.

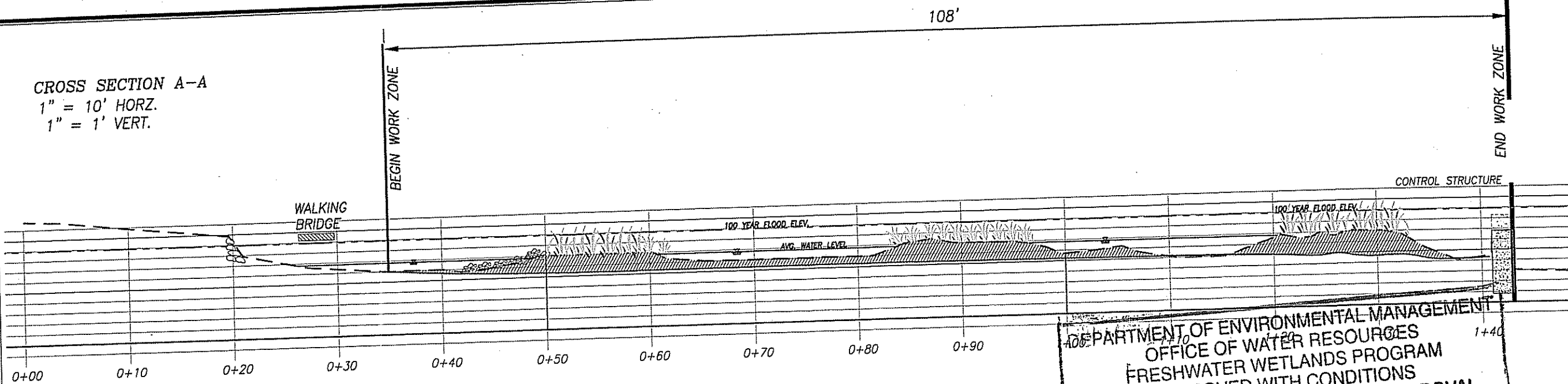

DEPARTMENT OF ENVIRONMENTAL MANAGEMENT  
OFFICE OF WATER RESOURCES  
FRESHWATER WETLANDS PROGRAM  
APPROVED WITH CONDITIONS  
AS SPECIFIED IN THE LETTER OF APPROVAL  
DATED SEP 04 2013 FILE # 13-0130  
NO CHANGES ALLOWED WITHOUT PRIOR APPROVAL  
APPROVED PLANS MUST BE AT CONSTRUCTION SITE  
*Wanda L. Freeman*

CROSS SECTION B-B

1" = 10' HORZ.  
1" = 1' VERT.

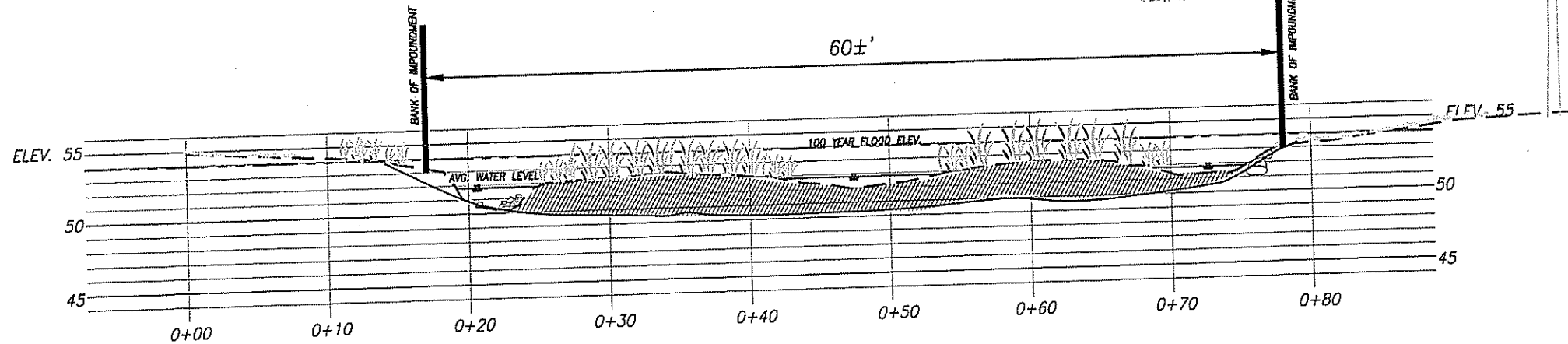

CONTROL STRUCTURE

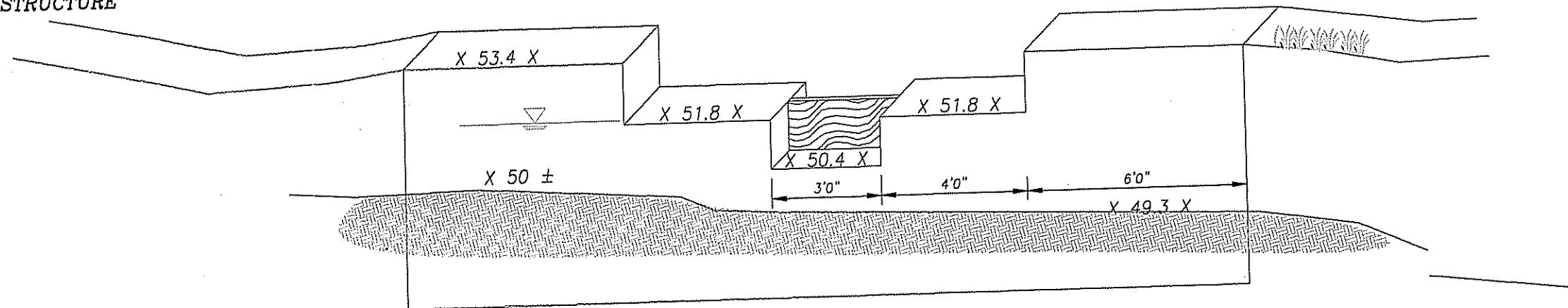

PREPARED FOR:  
**HOWARD & CAROLINA GOLDMAN**  
115 MIDDLE ROAD  
EAST GREENWICH, RHODE ISLAND

PREPARED BY:  
**JEFFREY J. CAMPOPIANO, P.E.**  
16 WEST MAIN STREET  
WICKFORD, RHODE ISLAND 02852  
PHONE: (401) 295-3037 / FAX: 295-1118

RIVER CROSS SECTIONS  
POND RESTORATION PLAN  
115 MIDDLE ROAD  
MAP 64 / PLAT 9 / LOT 3  
EAST GREENWICH, RHODE ISLAND

NO.	DATE	REVISIONS

DATE: 7/22/13  
SCALE: VARIES'

# CONSTRUCTION NOTES

## JOB PREPARATION / BEST MANAGEMENT PRACTICES

1. CONTRACTOR SHALL TAKE CARE TO PROPERLY PLAN & SCHEDULE WORK. CONSTRUCTION MUST BE SEQUENCED SO THAT THE DE-WATERING BASINS AND SEDIMENT CONTROLS ARE FULLY FUNCTIONING PRIOR TO ANY IN-STREAM WORK.
2. ALL EQUIPMENT WILL HAVE A MAINTENANCE CHECK PRIOR TO DELIVERY TO THE SITE, TO ENSURE THE EQUIPMENT IS RUNNING PROPERLY AND NOT LEAKING FLUIDS OR FUEL. EQUIPMENT WILL BE INSPECTED DAILY.
3. CONTROL OF INVASIVE SPECIES: BUCKETS AND EQUIPMENT SHOULD BE CLEANED SO AS TO CONTAIN PREVENT THE SPREAD OF INVASIVE SPECIES TO OR FROM THE SITE. DREDGED MATERIAL CONTAINS INVASIVE SPECIES, SHALL BE DISPOSED OF IN A MANNER THAT DOES NOT SPREAD THE INVASIVE SPECIES TO NEW AREAS.
4. AS THIS IS A NATURAL ENVIRONMENT, IT MAY BE NECESSARY TO ADJUST THE TIMING AND METHOD OF OPERATING THE DREDGE, BASED ON CHANGING SITE CONDITIONS SUCH AS STREAM FLOW, WIND AND INCLEMENT WEATHER.

## SEQUENCING OF EVENTS

1. CONSTRUCT / INSTALL THE DEWATERING BASIN AS SHOWN ON THE PROJECT PLANS.
2. INSTALL UPLAND EROSION CONTROLS, HAYBALES AROUND THE DEWATERING BASIN, CONSTRUCTION AND DOWN-GRADIENT OF ALL EQUIPMENT ACCESS PATHS.
3. INSTALL IN-STREAM TURBIDITY CONTROLS - TEMPORARY SILT FENCE, OR ENVIRO-BARRIER SHALL BE INSTALLED ACROSS THE WATERCOURSE AND PERPENDICULAR TO THE WATER FLOW.
4. BEGIN THE TEMPORARY DRAW-DOWN OF WATER IN THE IMPOUNDMENT.
5. DIVERT FLOWS AROUND THE IMMEDIATE WORK ZONE BY CONSTRUCTING A TEMPORARY WEIRS, OR J-HOOK VANES, AS DETAILED ON THE PLANS.
6. WORK SHALL BEGIN IN THE SOUTH-EAST PORTION OF THE IMPOUNDMENT, WHICH IS FURTHEST FROM THE MAINSTREAM FLOW, THEN PROGRESS TO THE NORTHERN BANKS BEFORE MOVING DOWNSTREAM.
7. UTILIZE DREDGING PRACTICES WHICH LIMIT SPILLAGE AND UNNECESSARY TRACKING.
8. CONTINUE WORK ALONG THE DOWNSTREAM BANKS, RECONSTRUCT BERMS AND FLOW DEFLECTORS TO DIRECT STREAM-FLOW AWAY FROM THE WORK ZONE.
9. STABILIZE THE RIVER BANKS AS REQUIRED; SLOPES GREATER THAN 3:1 SHALL BE REINFORCED WITH ON-SITE RIP-RAP.
10. ONCE ALL WORK IS COMPLETE AND THE AREA IS STABILIZED REMOVE THE IN-STREAM DIVERSIONS.
11. DEWATERED MATERIAL SHALL BE SPREAD ONSITE OUTSIDE OF THE 100-YEAR FLOOD ZONE, AND IMMEDIATELY SEEDED.
12. ONLY AFTER THIS DREDGED MATERIAL IS STABILIZED SHALL UPLAND EROSION CONTROLS BE REMOVED.

## LIMITS OF DREDGING:

1. THIS PROJECT DOES NOT INVOLVE DREDGING BEYOND THE ORIGINAL CONTOURS OF THE IMPOUNDMENT OR EXPANDING THE IMPOUNDMENT BEYOND ITS ORIGINAL SHORELINE CONFIGURATION. NO DREDGING SHALL OCCUR DOWNSTREAM OF THE CONTROL GATE OR UPSTREAM OF THE FOOT BRIDGE; OR, IN AREA'S RESTRICTED BY THE DEPARTMENT.
2. SEDIMENT WITHIN DESIGNATED DREDGING AREAS SHALL BE DREDGED DOWN TO THE IMPOUNDMENT'S ORIGINAL CONTOURS (HARD BOTTOM) OR OTHER OVERLYING HARD LAYER INCLUDING COMPACTED SEDIMENT, ROCK, STUMPS OR OTHER OBSTRUCTION. ALL OBJECTIONABLE AND ORGANIC MATERIAL SHALL BE REMOVED. SLOPES SHALL BE GRADED TO AN APPROXIMATE SLOPE OF 3:1 (HORIZONTAL: VERTICAL).

## UPLAND EROSION CONTROLS

1. PROPER EROSION AND SEDIMENTATION CONTROL MUST BE MAINTAINED AT ALL TIMES DURING THE PROJECT TO PREVENT SEDIMENT TRANSPORT DOWNSTREAM. THIS INCLUDES INSTALLING SILT FENCING DOWN-GRADIENT OF ALL DISTURBED AREAS, PROVIDING HAYBALE AND/OR BERM CONTROLS AROUND THE DEWATERING BASIN, PROVIDING A STABILIZED CONSTRUCTION ENTRANCE, AND ENSURING STABILIZATION OF DISTURBED AREAS ALONG THE POND EDGES.

## FLOW CONTROLS / DIVERSIONS

1. THE CONSTRUCTION OF ANY SPECIFIC TEMPORARY STREAM DIVERSION SHALL NOT CAUSE A SIGNIFICANT WATER LEVEL DIFFERENCE BETWEEN THE UPSTREAM AND DOWNSTREAM WATER SURFACE ELEVATIONS (NOT TO EXCEED 1%) AND THE VELOCITY SHOULD BE MAINTAINED AT A RATE SIMILAR TO EXISTING FLOW CONDITIONS. BOTH INLET AND OUTLET AREAS NEED TO BE UNOBSTRUCTED ON BOTH ENDS TO ENSURE PROPER WATER FLOW DOWNSTREAM.
2. CONTRACTOR SHALL BE RESPONSIBLE FOR A CONTROLLED DRAWDOWN OF THE SLUICE GATE TO ALLOW FOR WORK. IN NO CASE, THE WATER LEVEL FLUCTUATION SHOULD BE NO GREATER THAN ONE (1) FOOT DURING THE TIME PERIOD FROM MAY 1ST - JULY 1ST.
3. ALL TEMPORARY STREAM DIVERSIONS SHALL BE REMOVED WITHIN 2 CALENDAR DAYS AFTER THE STRUCTURE IS NO LONGER NEEDED. UNLESS PRIOR WRITTEN APPROVAL IS OBTAINED, ALL STRUCTURES SHALL BE REMOVED AND THE AREA STABILIZED BEFORE WINTER.
4. IN-STREAM TEMPORARY BERMS SHALL ONLY BE CONSTRUCTION OF MATERIALS MEETING THE FOLLOWING REQUIREMENTS:
5. **AGGREGATE:** THERE SHALL BE NO EARTH, SANDS, SILTS, CLAYS OR ORGANIC MATERIAL USED FOR CONSTRUCTION WITHIN THE WATERWAY CHANNEL. WASHED COARSE AGGREGATE (3/4 INCH TO 4 INCHES) REFERENCED, AS AASHTO DESIGNATION NO. 1 SHALL BE THE MINIMUM ACCEPTABLE AGGREGATE SIZE FOR TEMPORARY STREAM DIVERSIONS. LARGER CLEAN AGGREGATES WILL BE ALLOWED.
6. **SANDBAGS:** SANDBAGS SHALL CONSIST OF MATERIALS, WHICH ARE RESISTANT TO ULTRA-VIOLET RADIATION, TEARING AND PUNCTURE, AND WOVEN TIGHTLY ENOUGH TO PREVENT LEAKAGE OF FILL MATERIAL (I.E., SAND, FINE GRAVEL, ETC.).

## DEWATERING/ SEDIMENT DISPOSAL

1. THE DREDGED MATERIAL SHALL BE DEWATERED AS REQUIRED FOR FINAL PLACEMENT ON-SITE. THE EXACT TYPE AND EXTENT OF DEWATERING SHALL BE DETERMINED BY THE DREDGING CONTRACTOR. THE DREDGING CONTRACTOR SHALL MAKE ALL REPAIRS, STRENGTHENING, EXTENSIONS AND MODIFICATIONS TO STAGING AREA FACILITIES AS ARE NECESSARY FOR CONFINING THE DREDGED MATERIAL UNTIL ACCEPTANCE OF ALL WORK AS SPECIFIED HEREIN.
2. AS AN ALTERNATIVE TO THE PROPOSED DEWATERING BASIN, ALTERNATIVE DESIGNS MAY CONSIST OF
  - AN ENCLOSURE OF CONCRETE MASONRY BLOCK, LINED WITH A LARGE PIECE OF SILT TAPE GEOTEXTILE FABRIC.
  - DISCHARGE TO A MANUFACTURED / PRE-MADE STRUCTURE SPECIFICALLY DESIGNED FOR SEDIMENT REMOVAL, (SILT SAK, SILT BAG, OR OTHER SIMILAR PRODUCT).
  - EXCAVATED OR BERMED SEDIMENTATION PONDS OR STRUCTURES. SIDE SLOPES NO GREATER THAN 2 TO 1, OR WITH A COMBINED INTERIOR AND EXTERIOR SLOPE OF NO GREATER THAN 5 TO 1.
3. DREDGED MATERIAL WILL BE PLACED IN THE DEWATERING BASIN IN LIFTS OF APPROXIMATELY 3 FEET. SUCH LIMITED LIFTS WILL PROMOTE GREATER EFFICIENCY OF THE NATURAL DRAINAGE/DRYING PROCESSES AND GREATLY ENHANCE POTENTIAL GAINS IN THE BASIN CAPACITY THROUGH CONSOLIDATION. TO ALLOW FOR NATURAL DRYING/DRAINAGE, NOT MORE THAN ONE 3-FOOT LIFT WILL BE PLACED IN A CELL DURING ANY PLACEMENT PERIOD.

## TURBIDITY CONTROLS

1. PRIOR TO INITIATING MAINTENANCE DREDGING ACTIVITIES, A TEMPORARY SILT FENCE, OR ENVIRO-USA "DITCH-BARRIER" SHALL BE INSTALLED IMMEDIATELY DOWNSTREAM OF THE WATERCOURSE REACH TO BE DREDGED.
2. THE TEMPORARY SILT FENCE SHALL BE INSTALLED ACROSS THE WATERCOURSE AND PERPENDICULAR TO THE WATER FLOW.
3. THE TEMPORARY SILT FENCE SHALL REMAIN IN PLACE FOR THE DURATION OF THE MAINTENANCE DREDGING ACTIVITY.
4. IF WATERCOURSE FLOWS ARE ENCOUNTERED THAT EXCEED THE DESIGN CAPACITY OF THE SILT FENCE, THE MAINTENANCE DREDGING ACTIVITY SHALL STOP UNTIL THE WATERCOURSE FLOWS SUBSIDE.
5. PRIOR TO THE REMOVAL OF THE TEMPORARY SILT FENCE FROM THE WATERCOURSE, SILT THAT HAS ACCUMULATED BEHIND THE SILT FENCE SHALL BE REMOVED TO THE GREATEST EXTENT POSSIBLE.
6. IF FILTER FABRIC IS TO BE USED AS A TURBIDITY CONTROL, IT SHALL BE INSTALLED AS FOLLOWS:
  - THE FABRIC SHALL HAVE A MINIMUM WIDTH SUCH THAT IT IS KEYED IN AND ANCHORED AT THE TOP OF THE STREAM BANK. THE FABRIC SHALL BE PLACED SO THAT IT RESTS FLUSH WITH THE CHANNEL AT ALL POINTS OF CONTACT.
  - THE FABRIC SHALL BE PLACED SUCH THAT ONE PIECE WILL LINE THE ENTIRE CHANNEL.
  - THE FABRIC SHALL BE KEYED INTO 2 X 2-FOOT TRENCHES LOCATED AT THE UPSTREAM EDGE AND AT 50 FEET INTERVALS (THE OVERLAP NEAREST TO EACH 50-FOOT INCREMENT). THE KEY-IN SHALL BE FROM TOP OF CHANNEL TO TOP OF CHANNEL. RIPRAP SHALL BE CAREFULLY PLACED INTO THE TRENCH (WITHOUT DROPPING ONTO THE FABRIC).
7. ALL IN-STREAM TURBIDITY CONTROLS SHALL BE REMOVED WITHIN 2 DAYS OF COMPLETING THE MAINTENANCE DREDGING ACTIVITY.

## DREDGING REQUIREMENTS

1. DREDGING SHALL BE CONDUCTED WITH HAND TOOLS AND/ OR A TRACKED EXCAVATOR EQUIPPED WITH A CLAM SHELL OR LIDDED BUCKET TO MINIMIZE FALLBACK. CONTRACTOR SHALL REDUCE BUCKET OVER-PENETRATION, THAT CAN CAUSE SEDIMENT TO BE EXPELLED FROM THE VENTS IN THE BUCKET OR CAUSE SEDIMENT TO BECOME PILED ON TOP OF THE BUCKET, AND THEN ERODED DURING BUCKET RETRIEVAL.
2. EACH PASS WITH THE EXCAVATOR BUCKET IN THE CHANNEL SHALL BE COMPLETE.
3. DREDGING SHALL BE HELD TO THE ABSOLUTE MINIMUM NECESSARY TO REMOVE INVASIVE SPECIES AND ACHIEVE THE TARGET WIDTH, DEPTH AND GRADIENT.
4. THE IMPOUNDMENT BANKS SHALL BE SLOPED SUCH THAT THE RESULTING CHANNEL BANKS ARE STABLE; TYPICALLY AT A 5:1 SLOPE, BUT NO GREATER THAN 3:1.
5. SEQUENCING THE DREDGING BY MOVING UPSTREAM TO DOWNSTREAM, BEGINNING ON THE SOUTHERN BANK.

## BANK RESTORATION

IF NATURAL BANKS CANNOT BE MAINTAINED AT 3:1, PLACEMENT OF ROCK ARMORMENT SHALL BE REQUIRED ALONG THE IMPOUNDMENT EDGES.

1. **STONE PLACEMENT:** INDIVIDUAL PLACEMENT OF DISTURBED STONES AROUND THE PERIMETER.
2. STONE SHALL BE PLACED SO THAT IT PRODUCES A DENSE WELL-GRADED MASS OF STONE WITH A MINIMUM OF VOIDS. THE STONE SHOULD BE PLACED TO ITS FULL THICKNESS IN ONE OPERATION. THE STONE SHALL NOT BE PLACED IN LAYERS NOR DUMPED. THE FINISHED SLOPE SHALL BE FREE OF POCKETS OR SMALL STONES OR CLUSTERS OF LARGE STONES.
3. STONE PLACEMENT SHOULD START AT THE TOE TRENCH AND WORK UPWARDS, MAKING SURE THE ARMOR LAYER COMPLETELY COVERS THE EXPOSED SOILS AND/OR STONE FILTER. AN EXCAVATOR BUCKET MAY BE USED TO COMPACT THE STONE INTO A SOLID INTERLOCKING MASS.

## UPPER BANK RESTORATION

1. SEED AND INSTALL VEGETATIVE MEASURES ON UPPER BANK IMMEDIATELY FOLLOWING DISTURBANCE. A 4" LAYER OF LOAM SHALL BE PLACED ON SLOPE, FOLLOWED IMMEDIATELY BY MULCH AND EROSION CONTROL BLANKETS. THE ROOT-MASS OF NATIVE PLANTS ARE THE MOST EFFECTIVE MEANS OF VEGETATIVE CONTROL; BUT WILL REQUIRE SEVERAL SEASONS TO BECOME EFFECTIVE. SEED ALL DISTURBED AREAS WITH A TEMPORARY FAST GROWING CONSERVATION GRASS MIXTURE.
2. ALL DISTURBED SLOPES SHALL BE RESEEDED OR PROTECTED PRIOR TO OCTOBER 15. AFTER THIS DATE, WINTER MULCHING SHALL BE PROVIDED IN AREAS WHERE VEGETATION HAS NOT BEEN ESTABLISHED.

3. TEMPORARY WINTER MULCHING TREATMENTS SHALL CONSIST OF HAY, STRAW, OR FIBER MULCH OR OTHER PROTECTIVE COVERS, SUCH AS A JUTE MESH, MATS, OR OTHER WOVEN FIBER MATS OR MATS MULCHES SHALL BE APPLIED AT THE RATE OF 2 TONS/ACRE.

DEPARTMENT OF ENVIRONMENTAL MANAGEMENT  
OFFICE OF WATER RESOURCES  
MAINTENANCE WATER WETLANDS PROGRAM  
APPROVED WITH CONDITIONS  
REPAIRS MAY BE REQUIRED PERIODICALLY UNTIL THE "SPOIL" AREA IS FULLY STABILIZED. SLOPES SHALL BE INSPECTED QUARTERLY AND AFTER SEVERE STORMS OR DRAINAGE PROBLEMS. 13-0138  
DATED SEP 10 2013  
NO CHANGES ALLOWED WITHOUT PRIOR APPROVAL  
APPROVED PLANS MUST BE AT CONSTRUCTION SITE.

*Nancy L. Freeman*

PREPARED FOR:  
**HOWARD & CAROLINA GOLDMAN**  
115 MIDDLE ROAD  
EAST GREENWICH, RHODE ISLAND

PREPARED BY:  
**JEFFREY J. CAMPOPIANO, P.E.**  
16 WEST MAIN STREET  
WICKFORD, RHODE ISLAND 02852  
PHONE: (401) 295-3077 / FAX: 295-1118

CONSTRUCTION NOTES  
POND RESTORATION  
115 MIDDLE ROAD  
MAP 64 / PLAT 9 / LOT 3  
EAST GREENWICH, RHODE ISLAND

NO.	DATE	REVISIONS

DATE: 7/22/13  
SCALE: NONE

# TURBIDITY BARRIER

ALTERNATIVE TURBIDITY BARRIER TO BE USED IN PLACE OF ENVIRO-DITCH BARRIER

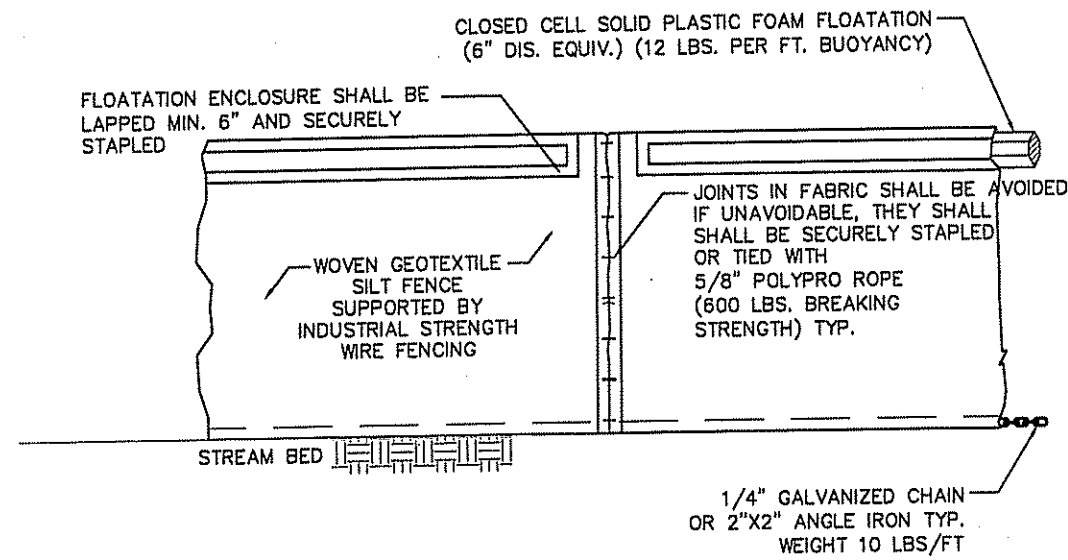

IN-STREAM TURBIDITY BARRIER DETAIL

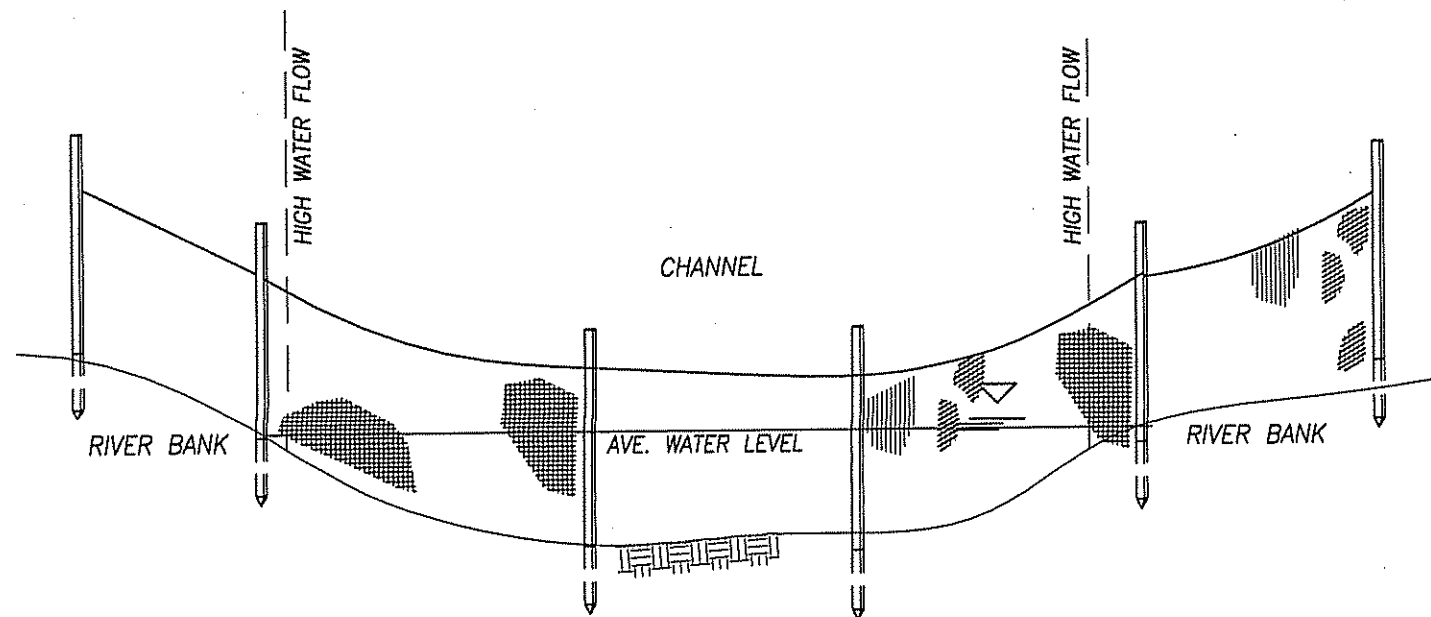

IN-STREAM TURBIDITY BARRIER - ELEVATION VIEW

# DE-WATERING / SEDIMENT RETENTION

SEDIMENT RETENTION AND FINAL PLACEMENT TO BE OUT-SITE OF 100-YEAR FLOOD PLAIN

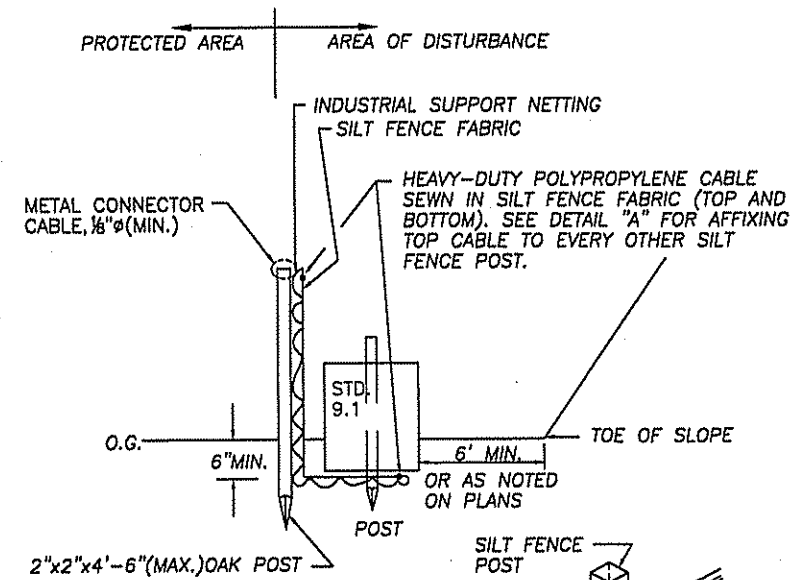
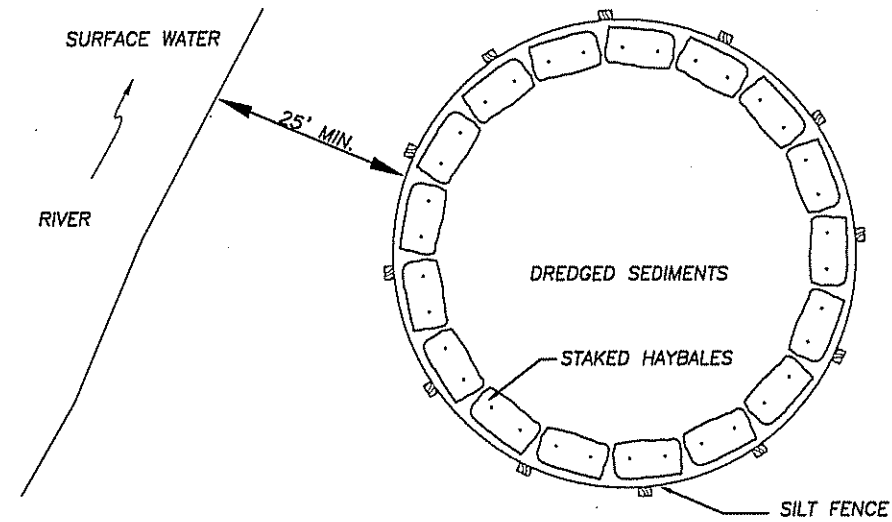

**NOTES:**

- STD. 9.1 IS INSTALLED "TIGHT" AGAINST SILT FENCE. THOROUGHLY COMPACT EXCAVATED SOILS BACK INTO TRENCH AFTER INSTALLATION OF EROSION CONTROL DEVICES. SILT FENCE FABRIC SHALL NOT BE SUT-STD. 9.1 POST SHALL BE DRIVEN THROUGH SILT FENCE FABRIC. 2"x2"x4'-6"(MAX.) OAK POST FOR SILT FENCE SHALL BE LOCATED ON 8'-0"(MAX.) CENTERS IN WETLAND AREAS AND LOCATED ON 4'-0"(MAX.) CENTERS IN WETLAND RAVINE, GULLY OR DROPOFF AREAS AS SHOWN ON PLANS
- R.I. STD. 9.1 AND SILT FENCE WILL BE PAID FOR UNDER THE APPROPRIATE PAY ITEMS, COMPLETE IN-PLACE.

DEPARTMENT OF ENVIRONMENTAL MANAGEMENT  
 OFFICE OF WAVER POST CONTROL  
 FRESHWATER WETLANDS PROGRAM  
 APPROVED WITH CONDITIONS  
 AS SPECIFIED IN LETTER OF APPROVAL  
 DATED SEP 04 2013 FILE # 13-0130  
 NO CHANGES ALLOWED WITHOUT PRIOR APPROVAL  
 APPROVED PLANS MUST BE AT CONSTRUCTION SITE

HAYBALE WITH SILT FENCE

*Nancy L. Freeman*

PREPARED FOR:  
 HOWARD & CAROLINA GOLDMAN  
 115 MIDDLE ROAD  
 EAST GREENWICH, RHODE ISLAND

PREPARED BY:  
 JEFFREY J. CAMPOPIANO, P.E.  
 16 WEST MAIN STREET  
 WICKFORD, RHODE ISLAND 02852  
 PHONE: (401) 295-3037 / FAX: 295-1118

EROSION CONTROL DETAILS  
 POND RESTORATION  
 115 MIDDLE ROAD  
 MAP 64 / PLAT 9 / LOT 3  
 EAST GREENWICH, RHODE ISLAND

NO.	DATE	REVISIONS

DATE: 7/22/13  
 SCALE: NTS