

# Plans

Issued for: **RIDEM Request for Preliminary Determination**

Date Issued: March 7, 2014

Latest Issue: March 7, 2014

## Index

No.	Drawing Title	Latest Issue
C-1	Title Sheet	3-7-2014
C-2	General Notes and Details	3-7-2014
C-3	Key Plan	3-7-2014
C-4 to C-5	Soil Erosion and Sediment Control Plans 1 and 2	3-7-2014
C-6 to C-7	Donetelli Easement Soil and Sediment Control Plans 1 and 2	3-7-2014
C-8 to C-9	Soil Erosion and Sediment Control Plans 3 and 4	3-7-2014

# National Grid Proposed Gas Main Extension Project

South Main Street, Steere Farm Road and Lapham Farm Road  
Burrillville, Rhode Island



*Vanasse Hangen Brustlin, Inc.*  
Transportation  
Land Development  
Environmental Services

10 Dorrance Street, Suite 400  
Providence, Rhode Island 02903  
401-272-8100 / FAX 401-273-9694

Owner/Applicant:

The Narragansett Electric Company  
d/b/a National Grid  
280 Melrose Street  
Providence, Rhode Island 02907  
401-784-7490

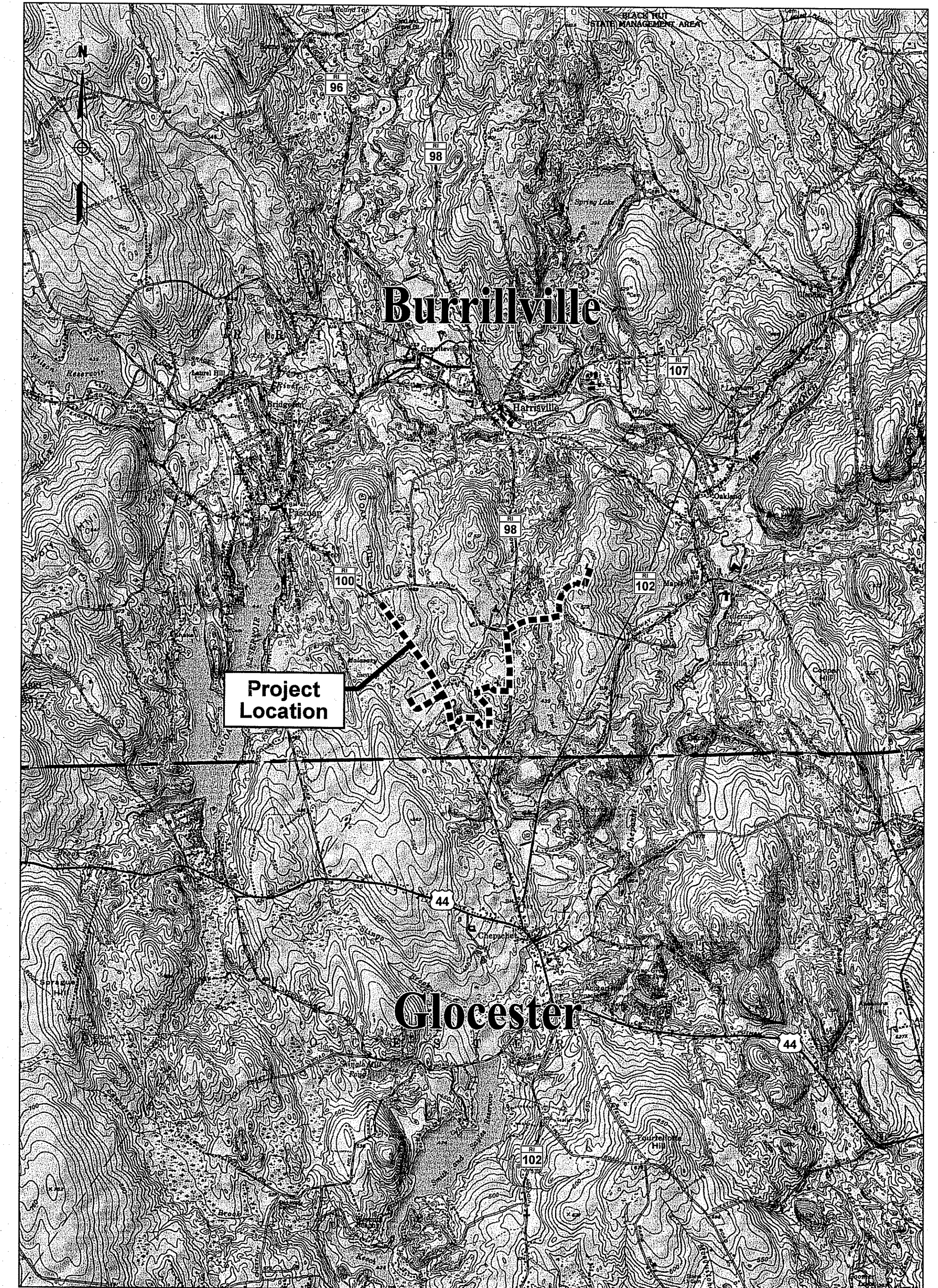

Locus Map

DEPARTMENT OF ENVIRONMENTAL MANAGEMENT  
OFFICE OF WATER RESOURCES  
FRESHWATER WETLANDS PROGRAM  
APPROVED WITH CONDITIONS  
AS SPECIFIED IN THE LETTER OF APPROVAL  
DATED APR 04 2014 FILE # 14-0047  
NO CHANGES ALLOWED WITHOUT PRIOR APPROVAL  
APPROVED PLANS MUST BE AT CONSTRUCTION SITE

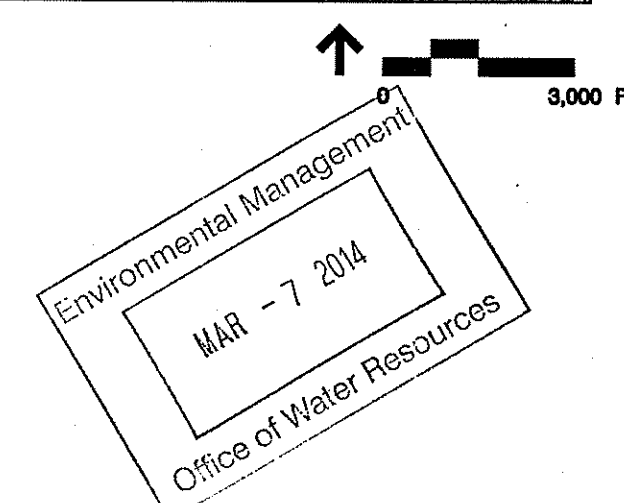

**Notes**

**Existing Conditions Information:**

**References:**

1. Intersection of South Main Street and Davis Drive is located approximately 1,250 feet north of the Project Site.
2. Base plan information from plans entitled "National Grid 6" Main Extension-Phase II South Main Street/Steere Farm Road/ Lapham Farm Road-Daniele Feeds Burrillville, RI" dated 02-07-2014 by EN Engineering.

**Erosion and Sediment Control Notes:**

1. Prior to starting any Site work, the contractor shall notify appropriate agencies and shall install erosion control measures as shown on the plans and as identified in Federal, State and Local approval documents pertaining to this Project.
2. A soil erosion and sedimentation control plan has been designed to protect on-Site wetlands and watercourses and off-Site areas during and after construction.
3. In areas where high runoff velocities or high sediment loads are expected, straw wattles or bale barriers will be backed with silt fencing.
4. Once work is complete, final surface treatment consisting of straw or cellulose mulch will be applied to stabilize the disturbed areas. Any soil disturbance associated with equipment access to structures or structure excavations should be mulched with hay on all disturbed areas as soon as possible but not more than 14 days after the construction activity in that area has temporarily or permanently ceased, unless the activity is to resume within 21 days.
5. In accordance with the RIPDES General Permit, all stormwater control measures, disturbed areas, areas used for the storage of materials that are exposed to precipitation (including unstabilized soil stockpiles), discharge locations and locations where vehicles enter or exit the site, as outlined in Part IV of this permit, must be inspected by or under the supervision of the applicant at least once every seven (7) calendar days and within twenty-four (24) hours after any storm event which generates at least 0.25 inches of rainfall per twenty-four (24) hour period and/or after a significant amount of runoff. Such areas shall be inspected for evidence of, or the potential for, pollutants entering the waters of the State or a separate storm sewer system. All BMPs shall be maintained to prevent uncontrolled releases of measurable amounts of sediment or sediment laden water from traveling beyond the limits of disturbance.
6. Sediment shall be removed from behind barriers if greater than 6 inches deep or as needed.
7. Damaged or deteriorated erosion/sedimentation control items will be repaired immediately after identification.
8. Erosion control measures shall remain in place until all disturbed earth has been securely stabilized. Once the Site is stabilized, the hay bales will be removed or broken up and spread as mulch. All other controls shall be removed and properly disposed of by the contractor.
9. In the event of a fuel spill or equipment malfunction resulting in a release of hazardous material, all work will be stopped in this area until the release/spill is cleaned up.
10. Equipment used for construction will be properly maintained and operated to reduce the chances of spill occurrences of petroleum products. Refueling of equipment will be required to carry spill containment and prevention devices (i.e., absorbent pads, clean up rags, five gallon containers, absorbent material, etc.) at all times. In addition, maintenance equipment and replacement parts for construction equipment will be on hand to repair failures and stop a spill in the event of equipment malfunction.
11. Any hazardous waste spills shall be cleaned up immediately, and if the spill amount is equal to or exceeds the EPA Reportable Quantity (RQ) for that substance in accordance with 40 CFR Parts 1010, 117, or 302, the contractor shall immediately contact the National Response Center at 1-800-424-9802. The contractor will also be responsible for submitting in writing a description of the release to the EPA Regional Office and RIDEM providing the date and circumstances of the release and the steps to be taken to prevent another release. Directions for cleaning up spills shall be clearly posted at a designated on-site location, and construction personnel shall be made aware of the procedures and location of cleanup supplies. Personnel shall wear appropriate protective gear and have proper training to prevent injury from contact with any hazardous substances.
12. No grade changes are proposed.

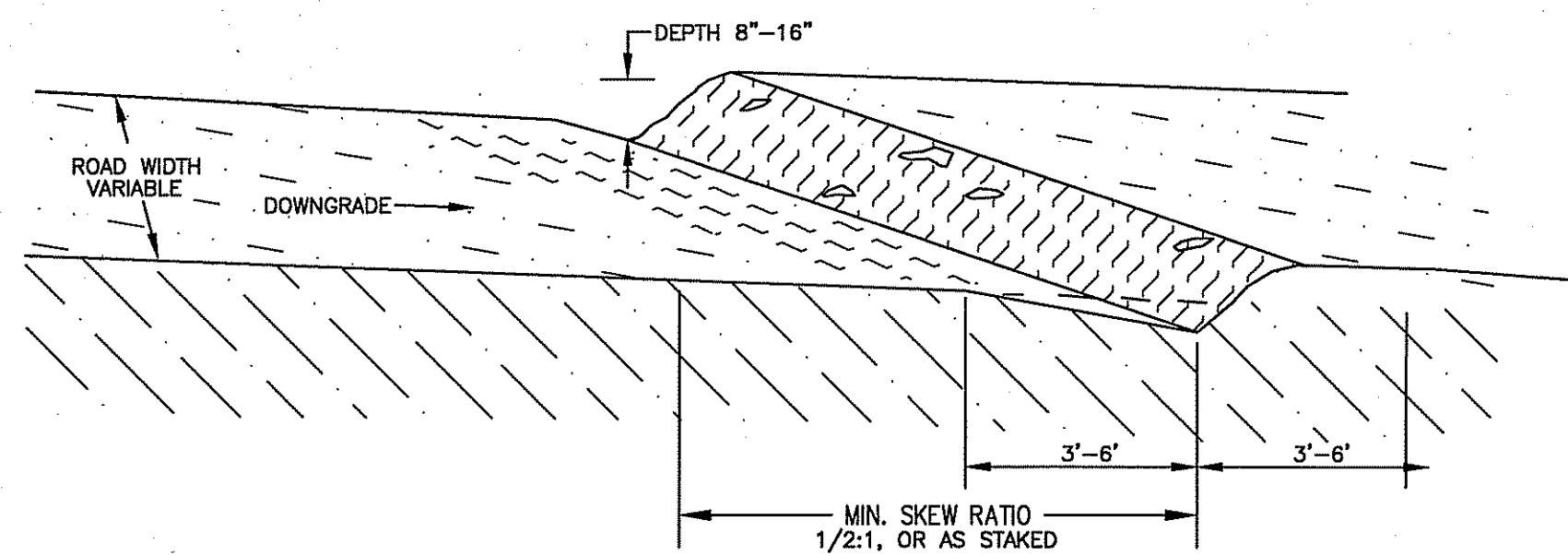

- NOTES**
1. ALL WATER BARS SHALL BEGIN AT THE INTERSECTION OF THE ROADBED AND CUT SLOPE AND RUN ACROSS THE ENTIRE WIDTH OF THE ROADBED.
  2. ALL WATER BARS SHALL HAVE FREE FLOWING OUTLETS.
  3. WHEN STAKES ARE USED, THEY DESIGNATE THE OUTLET LOCATION.

**Water Bar**

N.T.S. REV

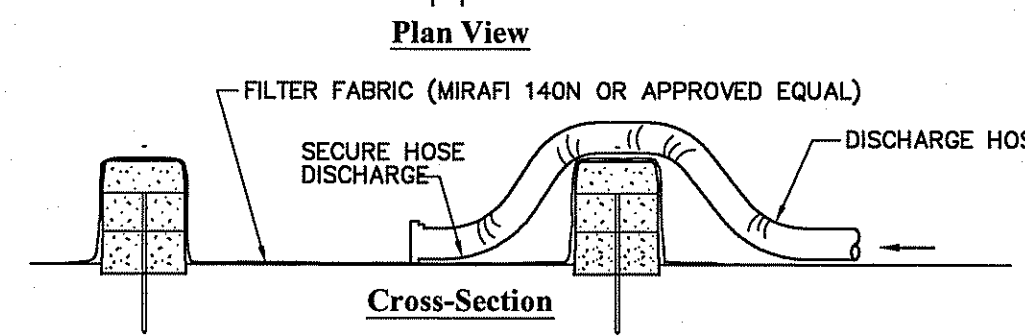
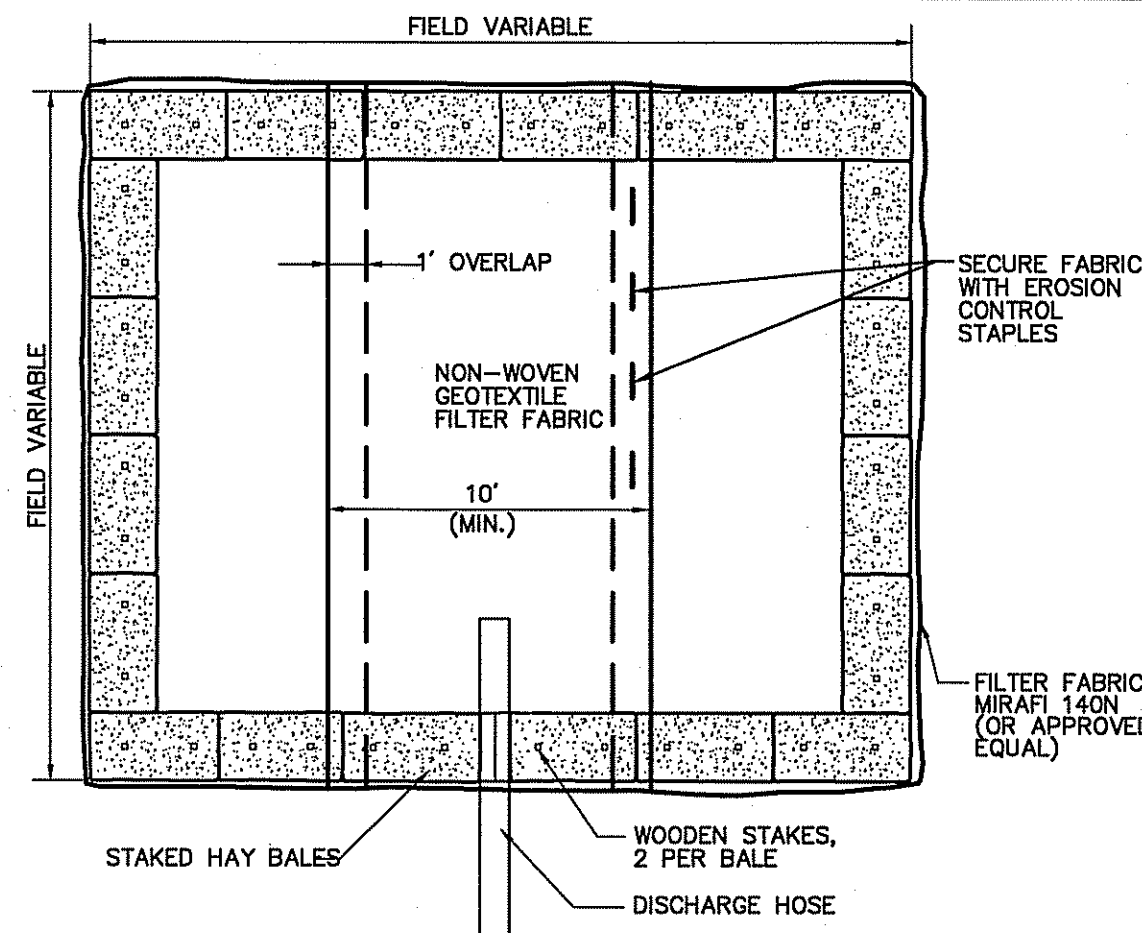

- Notes:**
1. NUMBER OF BALES MAY VARY DEPENDING ON SITE CONDITIONS.
  2. THE BASIN TO BE SIZED TO PREVENT DISCHARGE WATER FROM OVERTOPPING BASIN.

**Dewatering Haybale Basin**

N.T.S. Source: VHB 3/02 LD\_690

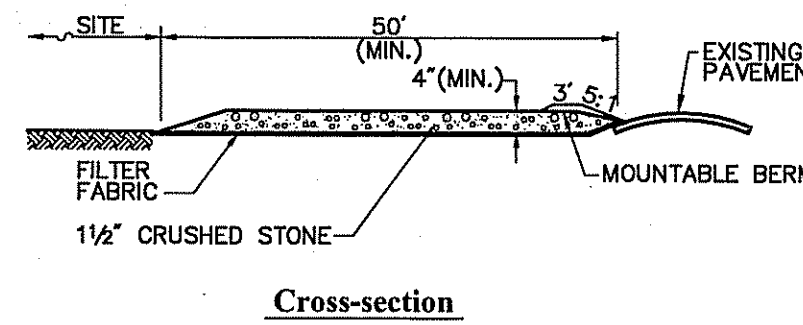
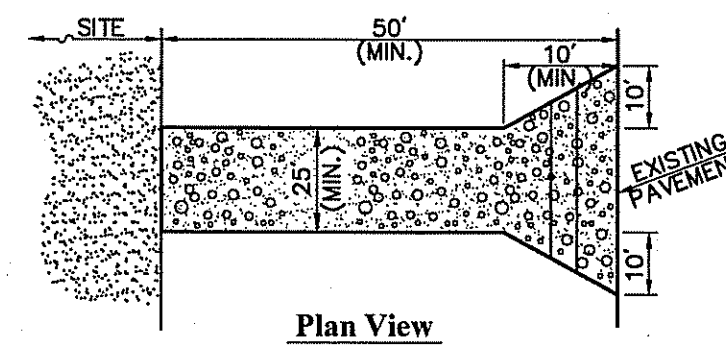

- Notes:**
1. ENTRANCE WIDTH SHALL BE A TWENTY-FIVE (25) FOOT MINIMUM, BUT NOT LESS THAN THE FULL WIDTH AT POINTS WHERE INGRESS OR EGRESS OCCURS.
  2. THE ENTRANCE SHALL BE MAINTAINED IN A CONDITION WHICH SHALL PREVENT TRACKING OR FLOWING OF SEDIMENT ONTO PUBLIC RIGHTS-OF-WAY. THIS MAY REQUIRE PERIODIC TOP DRESSING WITH ADDITIONAL STONE AS CONDITIONS DEMAND AND REPAIR OR CLEANOUT OF ANY MEASURES USED TO TRAP SEDIMENT. ALL SEDIMENT SPILLED, DROPPED, WASHED OR TRACKED ONTO PUBLIC RIGHTS-OF-WAY MUST BE REMOVED IMMEDIATELY. BERM SHALL BE PERMITTED. PERIODIC INSPECTION AND MAINTENANCE SHALL BE PROVIDED AS NEEDED.
  3. STABILIZED CONSTRUCTION EXIT SHALL BE REMOVED PRIOR TO FINAL FINISH MATERIALS BEING INSTALLED.

**Stabilized Construction Exit**

N.T.S. Source: VHB 6/08 LD\_662

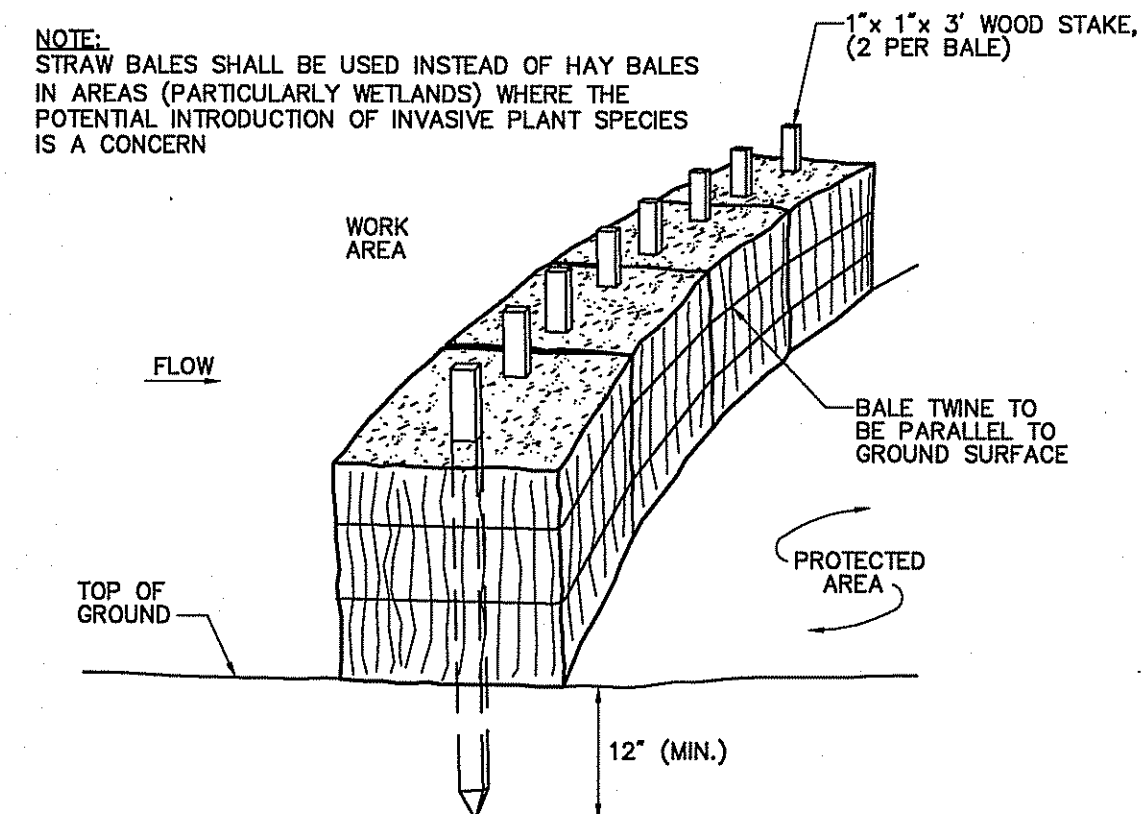

**Straw Bale Barrier (Non-Embedded)**

N.T.S. Source: VHB/NGRID EG-303 12/08 LD\_653

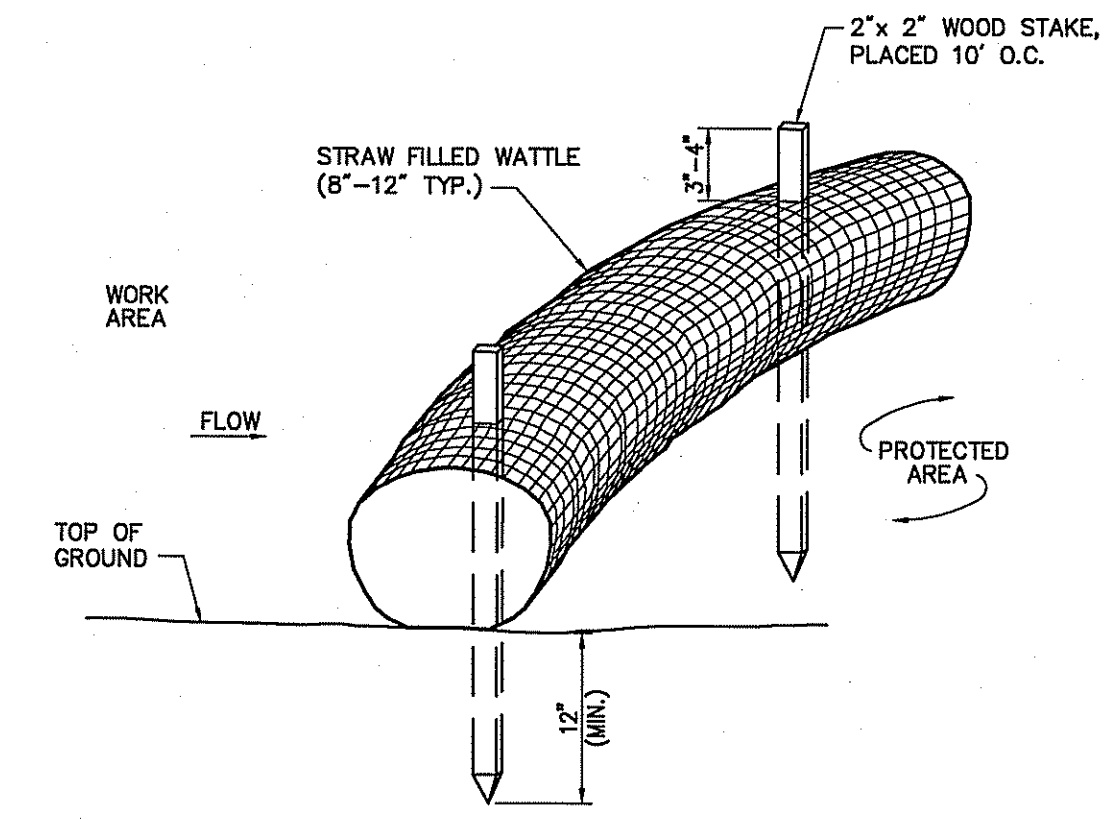

- Notes:**
1. STRAW WATTLE SHALL BE AS MANUFACTURED BY EARTHSAVER OR APPROVED EQUAL.
  2. STRAW WATTLES SHALL OVERLAP A MINIMUM OF 12 INCHES.
  3. STRAW WATTLE SHALL BE INSPECTED PERIODICALLY AND AFTER ALL STORM EVENTS, AND REPAIR OR REPLACEMENT SHALL BE PERFORMED PROMPTLY AS NEEDED.
  4. TEMPORARY STRAW WATTLES TO BE REMOVED BY CONTRACTOR. ALL OTHERS TO REMAIN IN PLACE UNLESS DIRECTED OTHERWISE BY ENGINEER.
  5. IF NON BIODEGRADABLE NETTING IS USED THE NETTING SHALL BE COLLECTED AND DISPOSED OF OFFSITE.

**Straw Wattle - Erosion Control Barrier**

N.T.S. Source: VHB 8/12 LD\_659

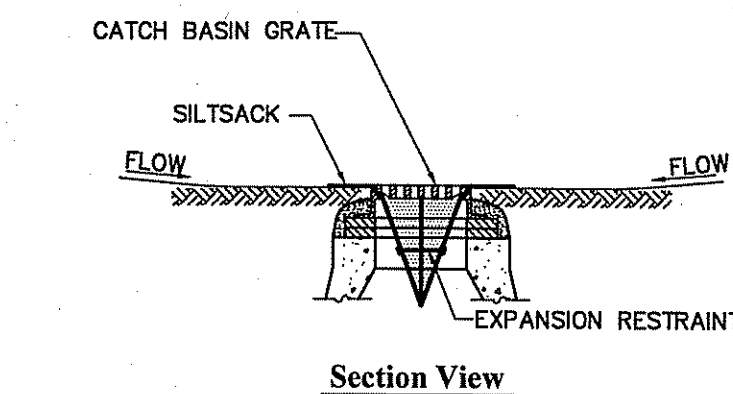
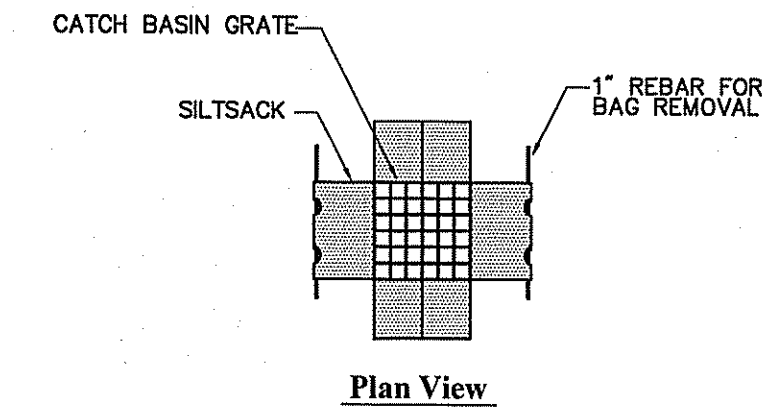

- Notes:**
1. INSTALL SILTSACK IN ALL CATCH BASINS WHERE INDICATED ON THE PLAN BEFORE COMMENCING WORK OR IN PAVED AREAS AFTER BINDER COURSE IS PLACED AND HAY BALES HAVE BEEN REMOVED.
  2. GRATE TO BE PLACED OVER SILTSACK.
  3. SILTSACK SHALL BE INSPECTED PERIODICALLY AND AFTER ALL STORM EVENTS AND CLEANING OR REPLACEMENT SHALL BE PERFORMED PROMPTLY AS NEEDED. MAINTAIN UNTIL UPSTREAM AREAS HAVE BEEN PERMANENTLY STABILIZED.

**Siltsack Sediment Trap**

N.T.S. Source: VHB 6/08 LD\_674

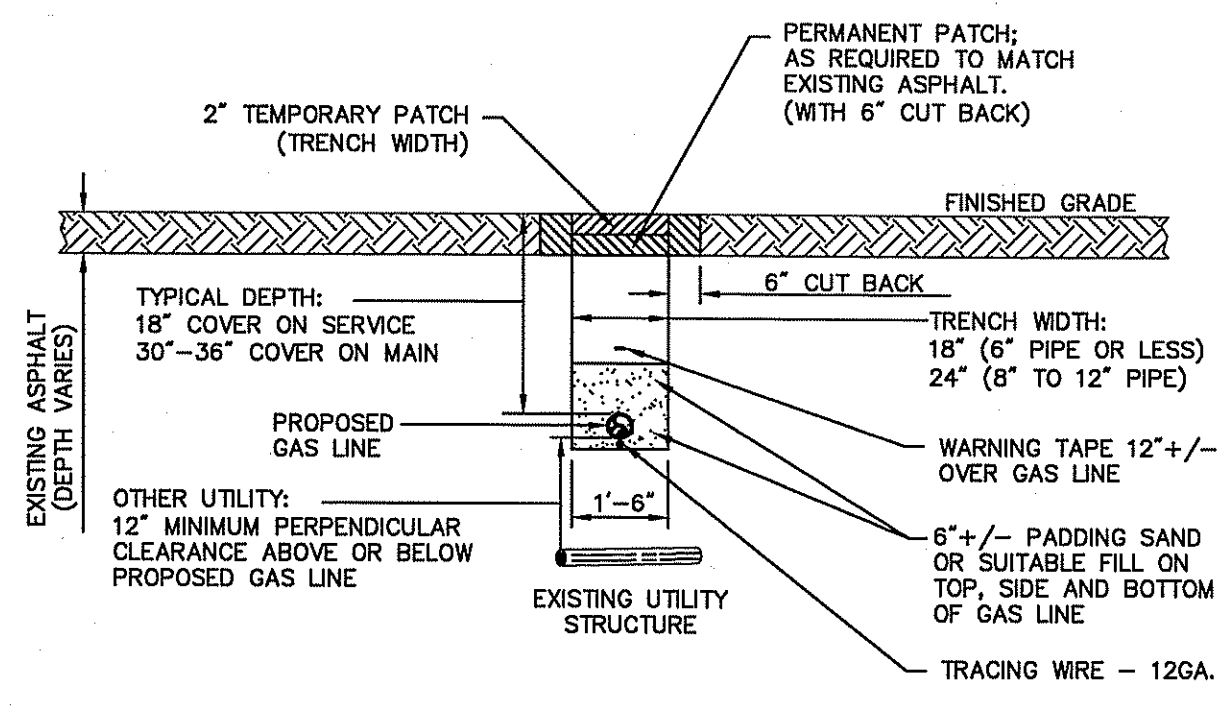

**Typical Trench Section**

N.T.S. Source: National Grid



Vanasse Hangen Brustlin, Inc.

Transportation  
Land Development  
Environmental Services

10 Dorrance Street, Suite 400  
Providence, Rhode Island 02903  
401.272.8100 • FAX 401.273.9694

DEPARTMENT OF ENVIRONMENTAL MANAGEMENT  
OFFICE OF WATER RESOURCES  
FRESHWATER WETLANDS PROGRAM  
APPROVED WITH CONDITIONS  
AS SPECIFIED IN THE LETTER OF APPROVAL  
DATED APR 04 2014 FILE # 14-0047  
NO CHANGES ALLOWED WITHOUT PRIOR APPROVAL  
APPROVED PLANS MUST BE AT CONSTRUCTION SITE

No.	Revision	Date	Appr.

Designed by \_\_\_\_\_ Drawn by \_\_\_\_\_ Checked by \_\_\_\_\_  
CAD checked by \_\_\_\_\_ Approved by \_\_\_\_\_  
Scale As Noted Date March 7, 2014  
Project Title

**National Grid  
Extension Gas Main  
Proposed Project**

South Main Street, Steere Farm Road  
and Lapham Farm Road  
Burrillville, Rhode Island

Issued for  
RIDEM Request for  
Preliminary Determination

Not Approved for Construction  
Drawing Title

**General Notes and Details**

Environmental Management  
MAR - 7 2014  
City of Burrillville  
Division of Water Resources  
C-2  
Sheet of 29  
Project Number 72198.03

Saved Thursday, March 06, 2014 5:26:04 PM DWIHITE Plotted Thursday, March 06, 2014 5:35:50 PM White, Dove

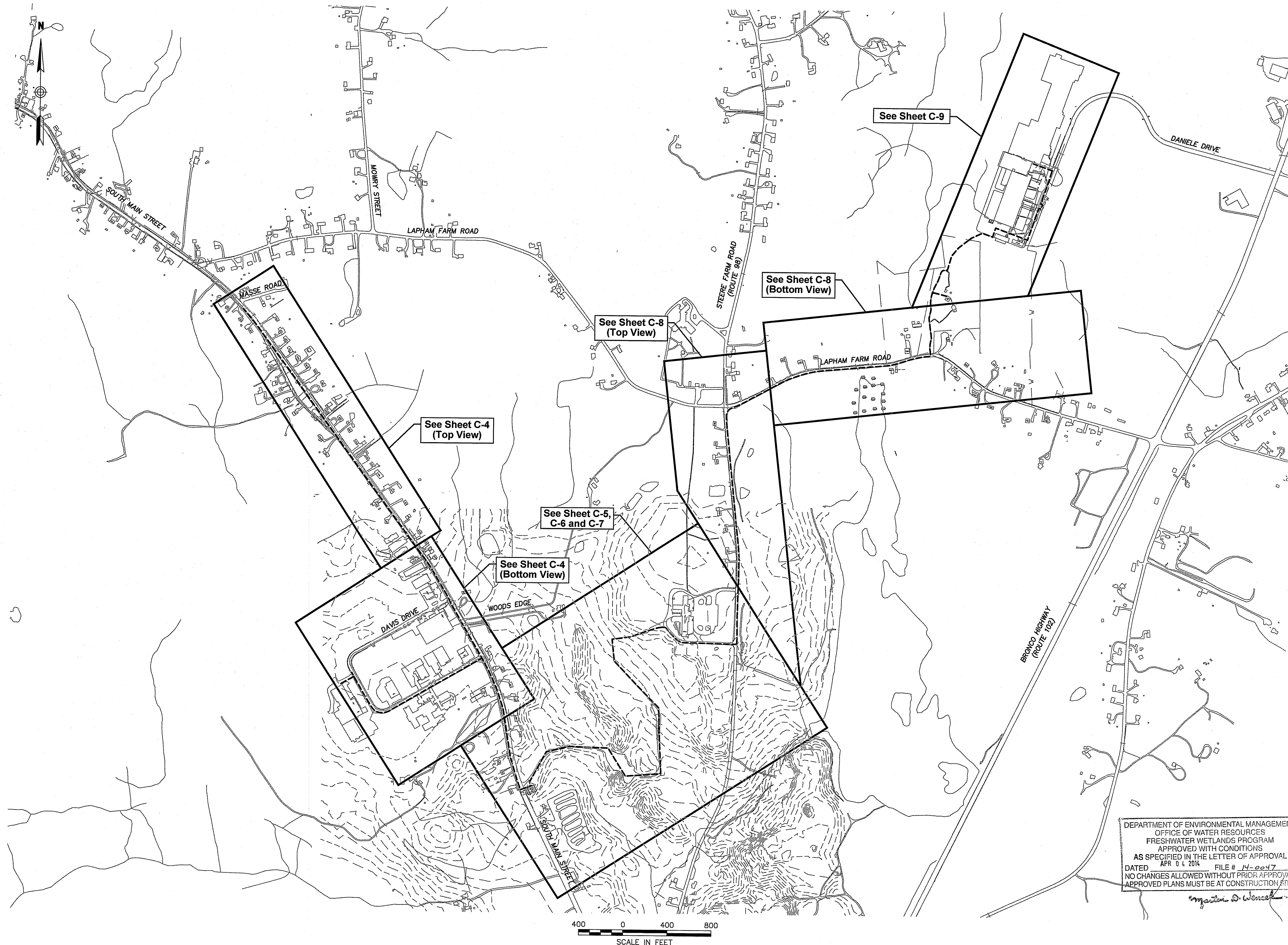

**Vanasse Hangen Brustlin, Inc.**

Transportation  
Land Development  
Environmental Services

10 Dorrance Street, Suite 400  
Providence, Rhode Island 02903  
401.272.8100 • FAX 401.273.9694

No.	Revision	Date	Appv.

Scale: As Noted Date: March 7, 2014  
Project Title:  
**National Grid  
Proposed Gas Main  
Extension Project**

South Main Street, Steere Farm Road  
and Lapham Farm Road  
Burrillville, Rhode Island

Issued for:  
**RIDEM Request for  
Preliminary Determination**

Not Approved for Construction  
Drawing Title:

**Key Plan**

DEPARTMENT OF ENVIRONMENTAL MANAGEMENT  
OFFICE OF WATER RESOURCES  
FRESHWATER WETLANDS PROGRAM  
APPROVED WITH CONDITIONS  
AS SPECIFIED IN THE LETTER OF APPROVAL  
DATED APR 04 2014 FILE # 14-0047  
NO CHANGES ALLOWED WITHOUT PRIOR APPROVAL  
APPROVED PLANS MUST BE AT CONSTRUCTION SITE

*Martin D. Wenczel*

Environmental Management  
MAR - 7 2014  
Drawing Number  
**C-3**  
Sheet  
3 9  
Project Number  
72198.03



Saved Thursday, March 06, 2014 5:31:04 PM DWIATE Plotted Thursday, March 06, 2014 6:32:56 PM White Dove



**Vanasse Hangen Brustlin, Inc.**

Transportation  
Land Development  
Environmental Services

10 Dorrance Street, Suite 400  
Providence, Rhode Island 02903  
401.272.8100 • FAX 401.273.9694

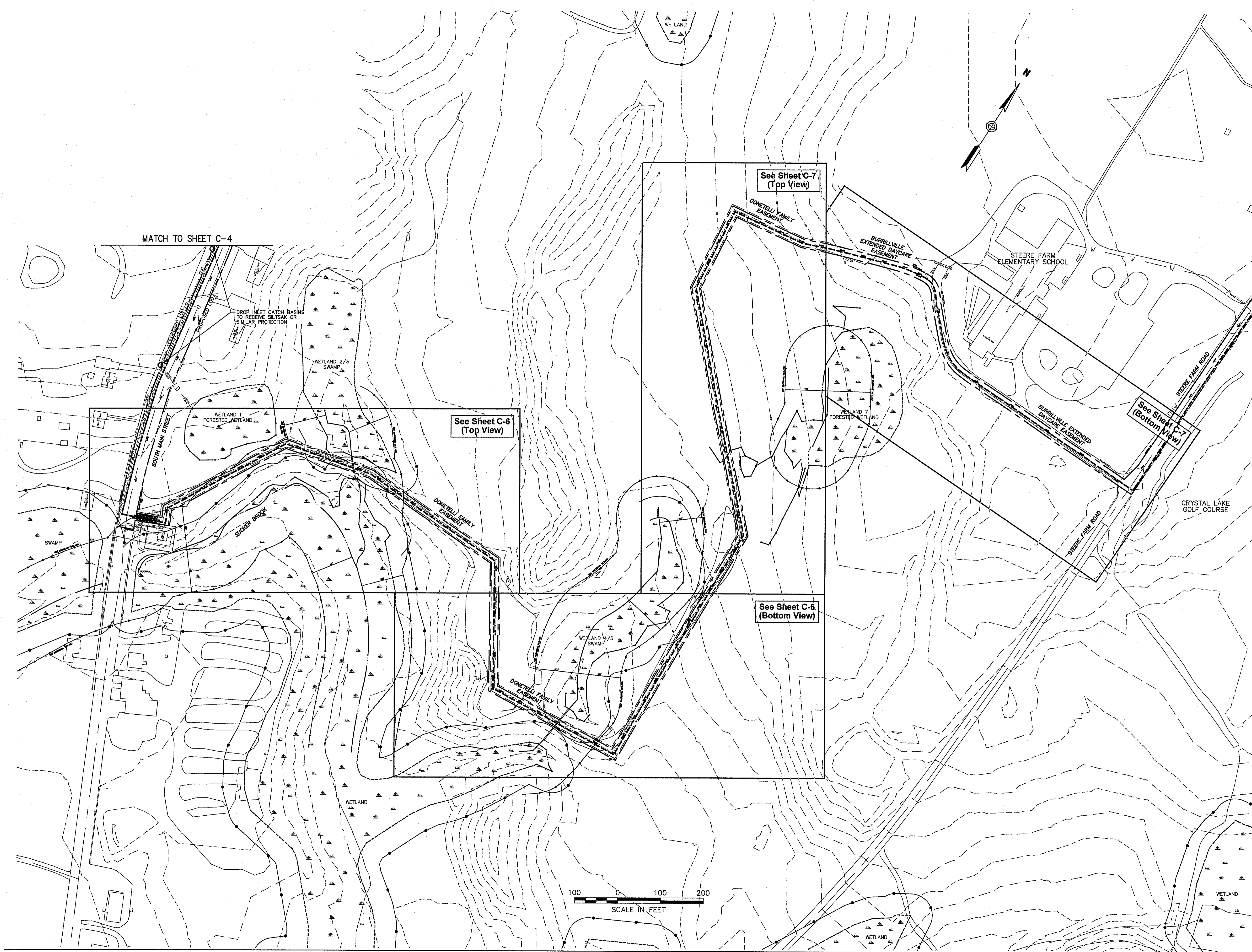

Legend	
	Proposed Gas Line
	Proposed Limit of Disturbance
	Gas Line Easement/Proposed LOD
	Existing Sewer Easement
	50' Perimeter Wetland
	100' Riverbank Wetland
	Delineated Wetland Edge
	Approximate Wetland Edge
	ASSF
	Stream

Kindly be advised that this Permit is not equivalent to a verification of the type or extent of freshwater wetlands on site.

DEPARTMENT OF ENVIRONMENTAL MANAGEMENT  
OFFICE OF WATER RESOURCES  
FRESHWATER WETLANDS PROGRAM  
APPROVED WITH CONDITIONS  
AS SPECIFIED IN THE LETTER OF APPROVAL  
APR 04 2014 FILE # 14-0047  
NO CHANGES ALLOWED WITHOUT PRIOR APPROVAL  
APPROVED PLANS MUST BE AT CONSTRUCTION SITE

No.	Revision	Date	Appvd.

Designed by	Drawn by	Checked by
CAD checked by	Approved by	
Scale	As Noted	Date March 7, 2014

**National Grid  
Proposed Gas Main  
Extension Project**

South Main Street, Steere Farm Road  
and Lapham Farm Road  
Burrillville, Rhode Island

RIDEM Request for  
Preliminary Determination

Not Approved for Construction  
Drawing Title

**Soil Erosion and  
Sediment Control Plan 2**

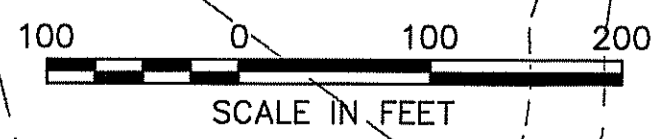

Environmental Management  
MAR - 7 2014  
Drawing Number  
**C-5**  
Sheet 5 of 9  
Project Number  
72198.03





**Vanasse Hangen Brustlin, Inc.**

Transportation  
Land Development  
Environmental Services

10 Dorrance Street, Suite 400  
Providence, Rhode Island 02903  
401.272.8100 • FAX 401.273.9694

Legend	
	Proposed Gas Line
	Proposed Limit of Disturbance
	Gas Line Easement/Proposed LOD
	Existing Sewer Easement
	50' Perimeter Wetland
	100' Riverbank Wetland
	Delineated Wetland Edge
	Approximate Wetland Edge
	ASSF
	Stream

Kindly be advised that this Permit is not equivalent to a verification of the type or extent of freshwater wetlands on site.

DEPARTMENT OF ENVIRONMENTAL MANAGEMENT  
OFFICE OF WATER RESOURCES  
FRESHWATER WETLANDS PROGRAM  
APPROVED WITH CONDITIONS  
AS SPECIFIED IN THE LETTER OF APPROVAL  
DATED APR. 04, 2014 FILE # 14-0047  
NO CHANGES ALLOWED WITHOUT PRIOR APPROVAL  
APPROVED PLANS MUST BE AT CONSTRUCTION SITE

*Martin D. Wenzel*

No.	Revision	Date	Appr.

Designed by \_\_\_\_\_ Drawn by \_\_\_\_\_ Checked by \_\_\_\_\_  
CAD checked by \_\_\_\_\_ Approved by \_\_\_\_\_  
Scale As Noted Date March 7, 2014

**National Grid  
Proposed Gas Main  
Extension Project**

South Main Street, Steere Farm Road  
and Lapham Farm Road  
Burrillville, Rhode Island

Issued for  
**RIDEM Request for  
Preliminary Determination**

Not Approved for Construction  
Drawing Title

**Donetelli Easement  
Soil Erosion and Sediment  
Control Plan 2**

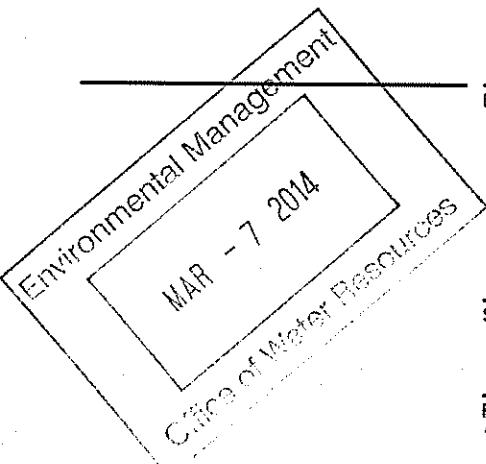

Drawing Number  
**C-7**  
Sheet 7 of 9  
Project Number  
72198.03

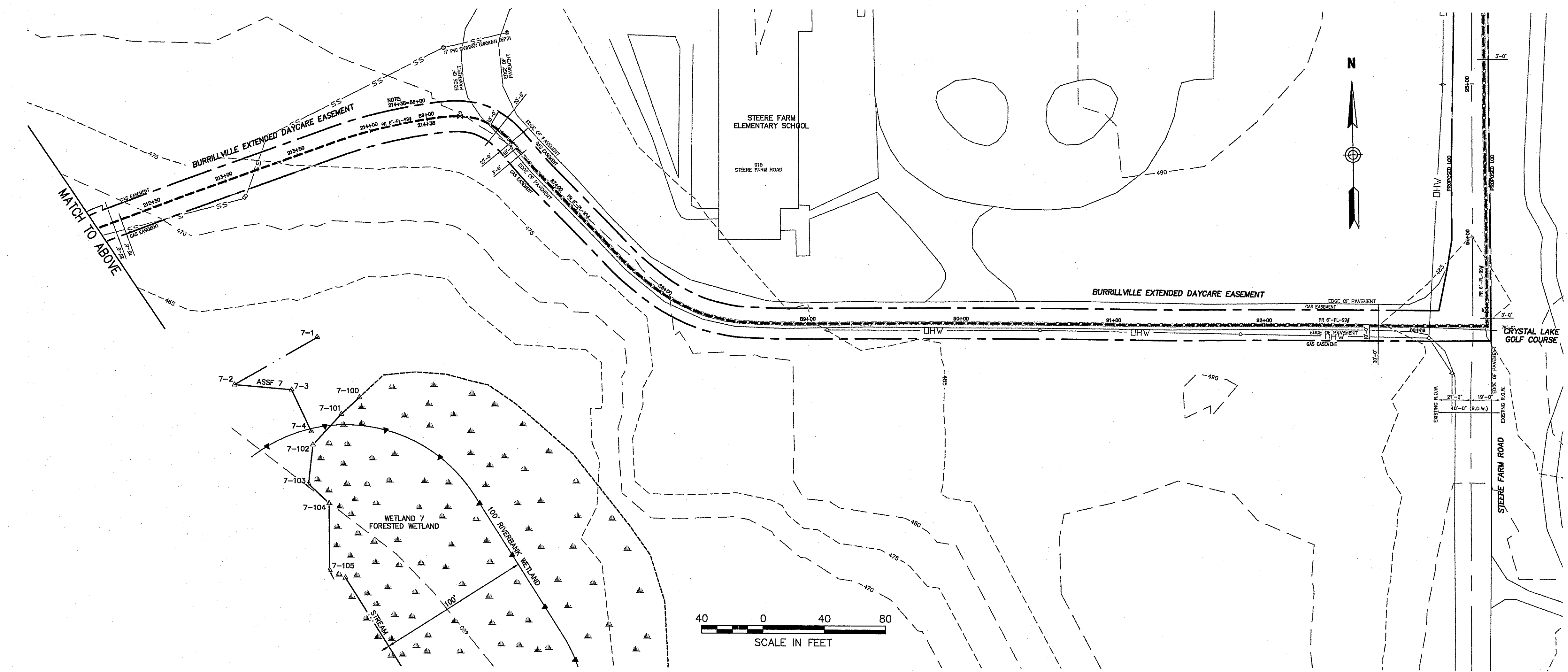
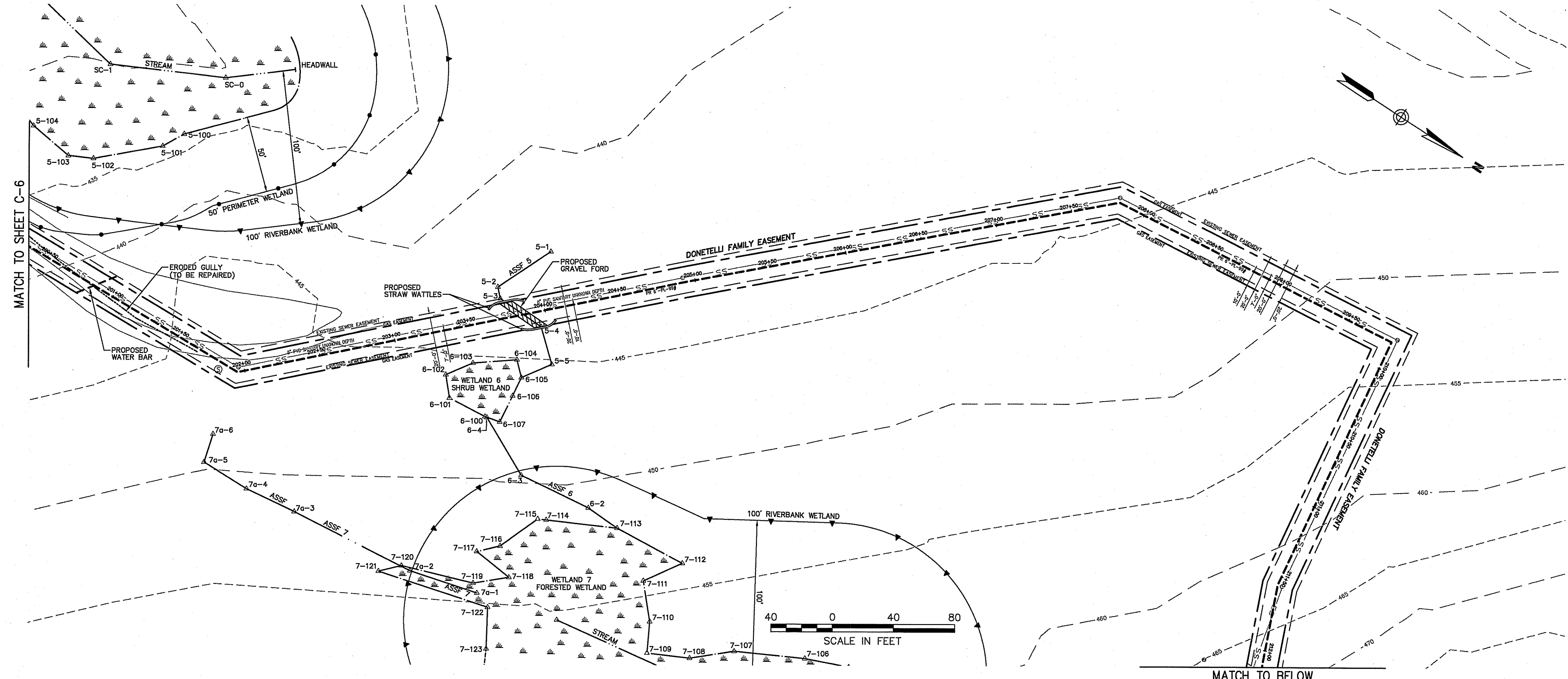



Vanasse Hangen Brustlin, Inc.

Transportation  
 Land Development  
 Environmental Services

10 Dorrance Street, Suite 400  
 Providence, Rhode Island 02903  
 401.272.8100 • FAX 401.273.9694

Legend	
	Proposed Gas Line
	Proposed Limit of Disturbance
	Gas Line Easement/Proposed LOD
	Existing Sewer Easement
	50' Perimeter Wetland
	100' Riverbank Wetland
	Delineated Wetland Edge
	Approximate Wetland Edge
	ASSF
	Stream

Kindly be advised that this Permit is not equivalent to a verification of the type or extent of freshwater wetlands on site.

DEPARTMENT OF ENVIRONMENTAL MANAGEMENT  
 OFFICE OF WATER RESOURCES  
 FRESHWATER WETLANDS PROGRAM  
 APPROVED WITH CONDITIONS  
 AS SPECIFIED IN THE LETTER OF APPROVAL  
 DATED APR 04 2014 FILE # 14-0047  
 NO CHANGES ALLOWED WITHOUT PRIOR APPROVAL  
 APPROVED PLANS MUST BE AT CONSTRUCTION SITE

*Martin D. Wenzel*

No.	Revision	Date	Appr.

Designed by	Drawn by	Checked by
CAD checked by	Approved by	
Scale As Noted	Date March 7, 2014	

**National Grid  
 Proposed Gas Main  
 Extension Project**

South Main Street, Steere Farm Road  
 and Lapham Farm Road  
 Burrillville, Rhode Island

RIDEM Request for  
 Preliminary Determination

Not Approved for Construction  
 Drawing Title

**Soil Erosion and  
 Sediment Control Plan 3**

Environmental Management  
 MAR - 7 2014  
 Office of Water Resources

Drawing Number  
**C-8**  
 Sheet  
 8 of 9  
 Project Number  
 72198.03

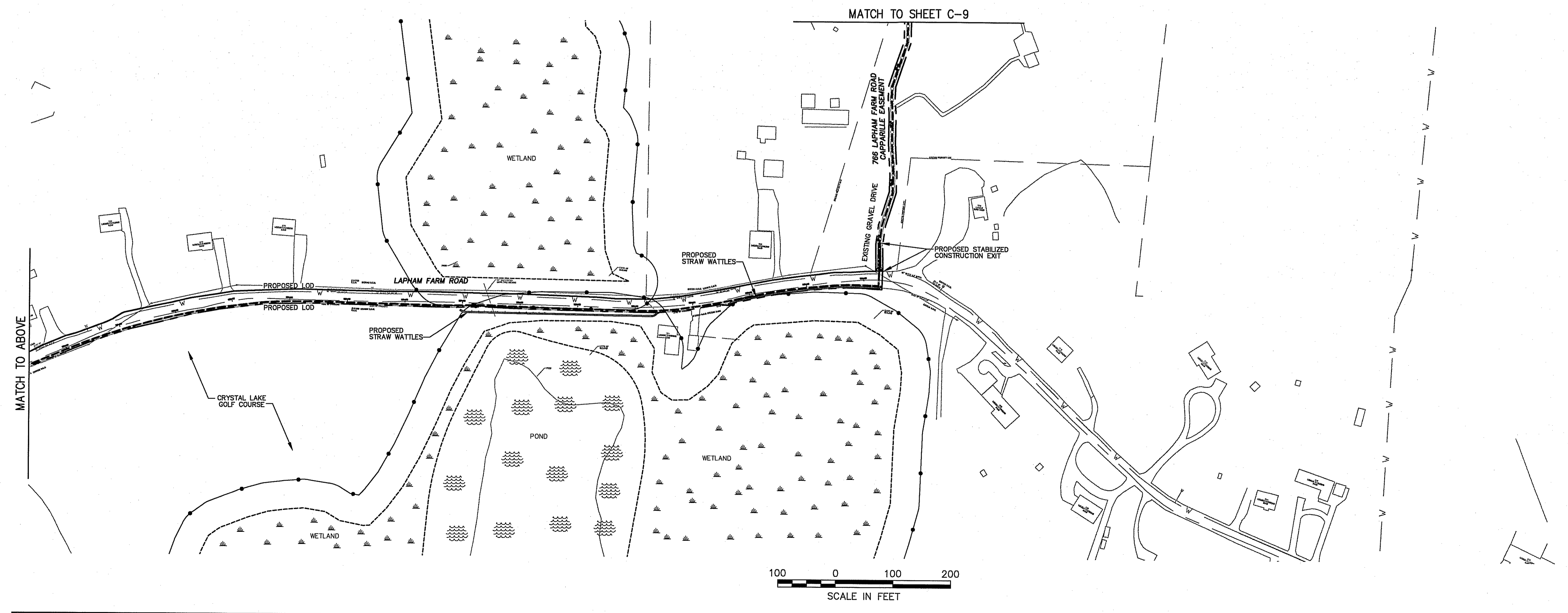
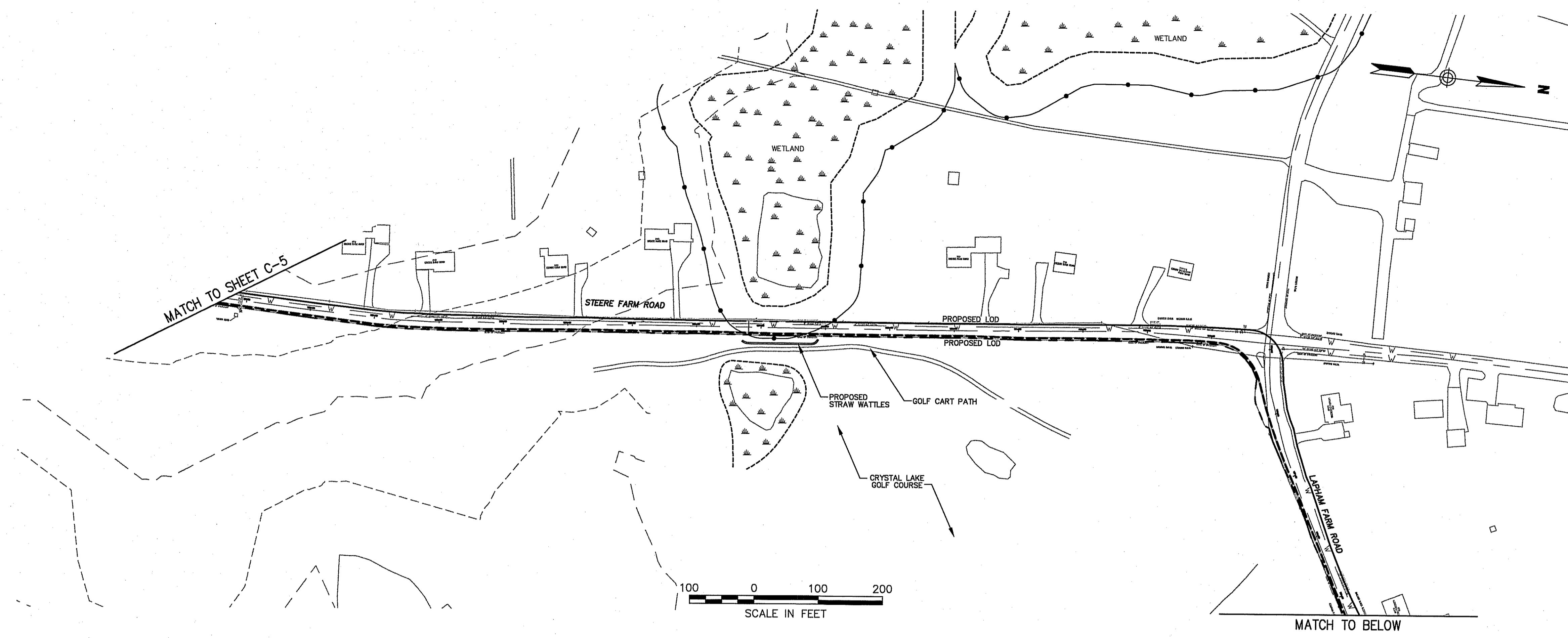

Saved Thursday, March 06, 2014 5:26:04 PM DWG: WHITE Plotted Thursday, March 06, 2014 5:27:14 PM White, Dove



**Vanasse Hangen Brustlin, Inc.**

Transportation  
Land Development  
Environmental Services

10 Dorrance Street, Suite 400  
Providence, Rhode Island 02903  
401.272.8100 • FAX 401.273.9694

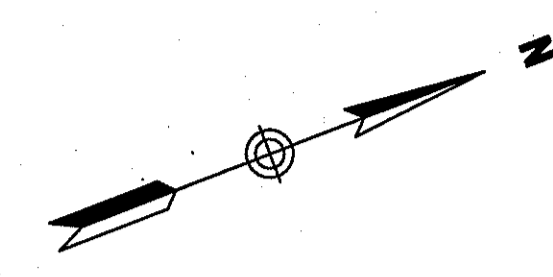
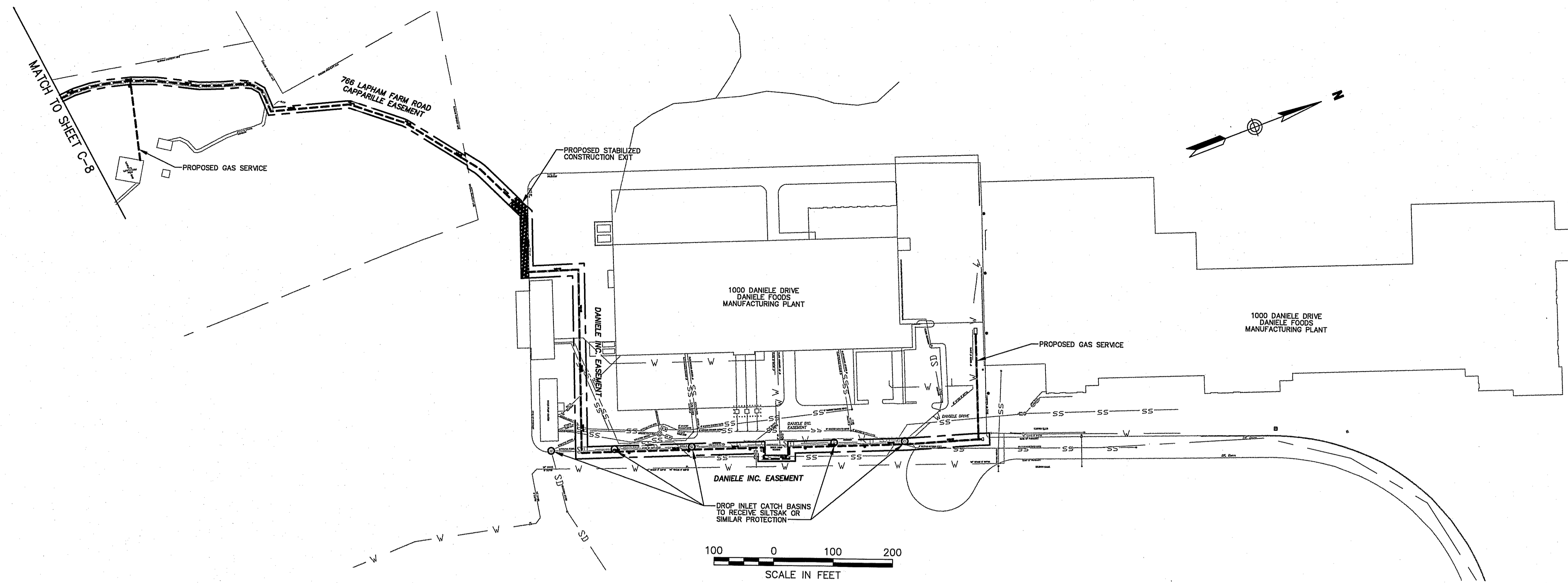

Legend	
	Proposed Gas Line
	Proposed Limit of Disturbance
	Gas Line Easement/Proposed LOD
	Existing Sewer Easement
	50' Perimeter Wetland
	100' Riverbank Wetland
	Delineated Wetland Edge
	Approximate Wetland Edge
	ASSF
	Stream

Kindly be advised that this Permit is not equivalent to a verification of the type or extent of freshwater wetlands on site.

DEPARTMENT OF ENVIRONMENTAL MANAGEMENT  
OFFICE OF WATER RESOURCES  
FRESHWATER WETLANDS PROGRAM  
APPROVED WITH CONDITIONS  
AS SPECIFIED IN THE LETTER OF APPROVAL  
DATED APR 04 2014 FILE # 14-0047  
NO CHANGES ALLOWED WITHOUT PRIOR APPROVAL  
APPROVED PLANS MUST BE AT CONSTRUCTION SITE

No.	Revision	Date	Appvd.

Designed by \_\_\_\_\_ Drawn by \_\_\_\_\_ Checked by \_\_\_\_\_  
CAD checked by \_\_\_\_\_ Approved by \_\_\_\_\_  
Scale: As Noted Date: March 7, 2014  
Project Title: National Grid Proposed Gas Main Extension Project

South Main Street, Steere Farm Road and Lapham Farm Road  
Burrillville, Rhode Island

Issued for: RIDEM Request for Preliminary Determination

Not Approved for Construction  
Drawing Title: Soil Erosion and Sediment Control Plan 4

Environmental Management  
MAR - 7 2014

Drawing Number: C-9  
Sheet of: 9 9  
Project Number: 72198.03