

COMPOSTING AREA EXPANSION

CENTRAL LANDFILL

JOHNSTON, RHODE ISLAND

PREPARED FOR:

Rhode Island Resource Recovery Corporation

65 Shun Pike, Johnston, Rhode Island 02919



MAR -7 2014

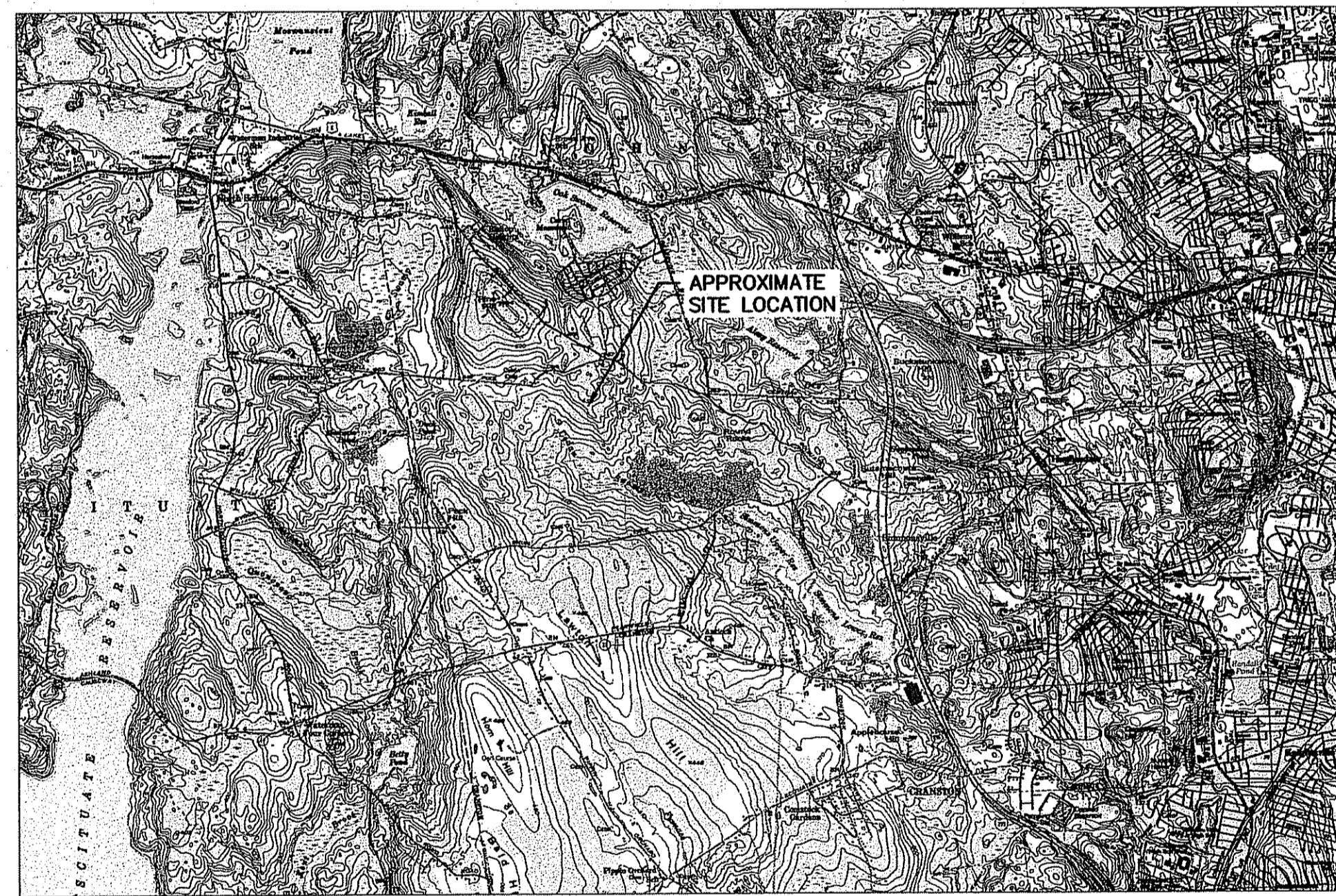

SITE LOCUS

DRAWING INDEX:

- C000 COVER SHEET
- C100 SITE VICINITY PLAN
- C101 EXISTING CONDITIONS PLAN
- C200 PROPOSED SITE PLAN
- C800 DETAIL SHEET - I
- C801 DETAIL SHEET - II

PREPARED BY:



**Civil & Environmental
Consultants, Inc.**

31 BELLOWS ROAD - RAYNHAM, MA 02767
774-501-2176 · 866-312-2024
www.cecinc.com

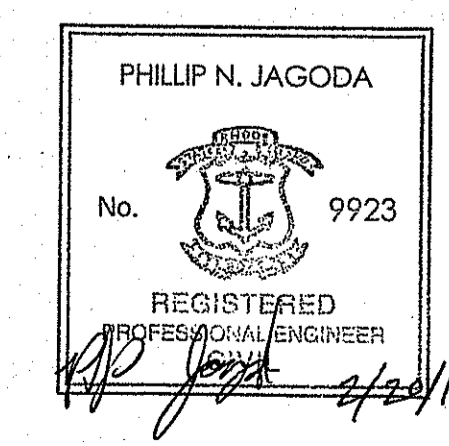

FEBRUARY 2014

DEPARTMENT OF ENVIRONMENTAL MANAGEMENT
OFFICE OF WATER RESOURCES
FRESHWATER WETLANDS PROGRAM
APPROVED WITH CONDITIONS
AS SPECIFIED IN THE LETTER OF APPROVAL
DATED MAR 16 2015 FILE # 14-0048
NO CHANGES ALLOWED WITHOUT PRIOR APPROVAL
APPROVED PLANS MUST BE AT CONSTRUCTION SITE

Matthew D. Wanch

P:\2013\12-2013\1-0001\Draw\1501-Compast_Area_Expanding_Plan\1501-Compast_Area_Expanding_Plan.dwg (1/20/14) 12:57:20 2/14 - 8:45 AM

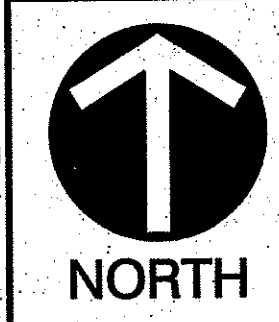

SUBMITTAL RECORD		
NO	DATE	DESCRIPTION

REVISION RECORD		
NO	DATE	DESCRIPTION

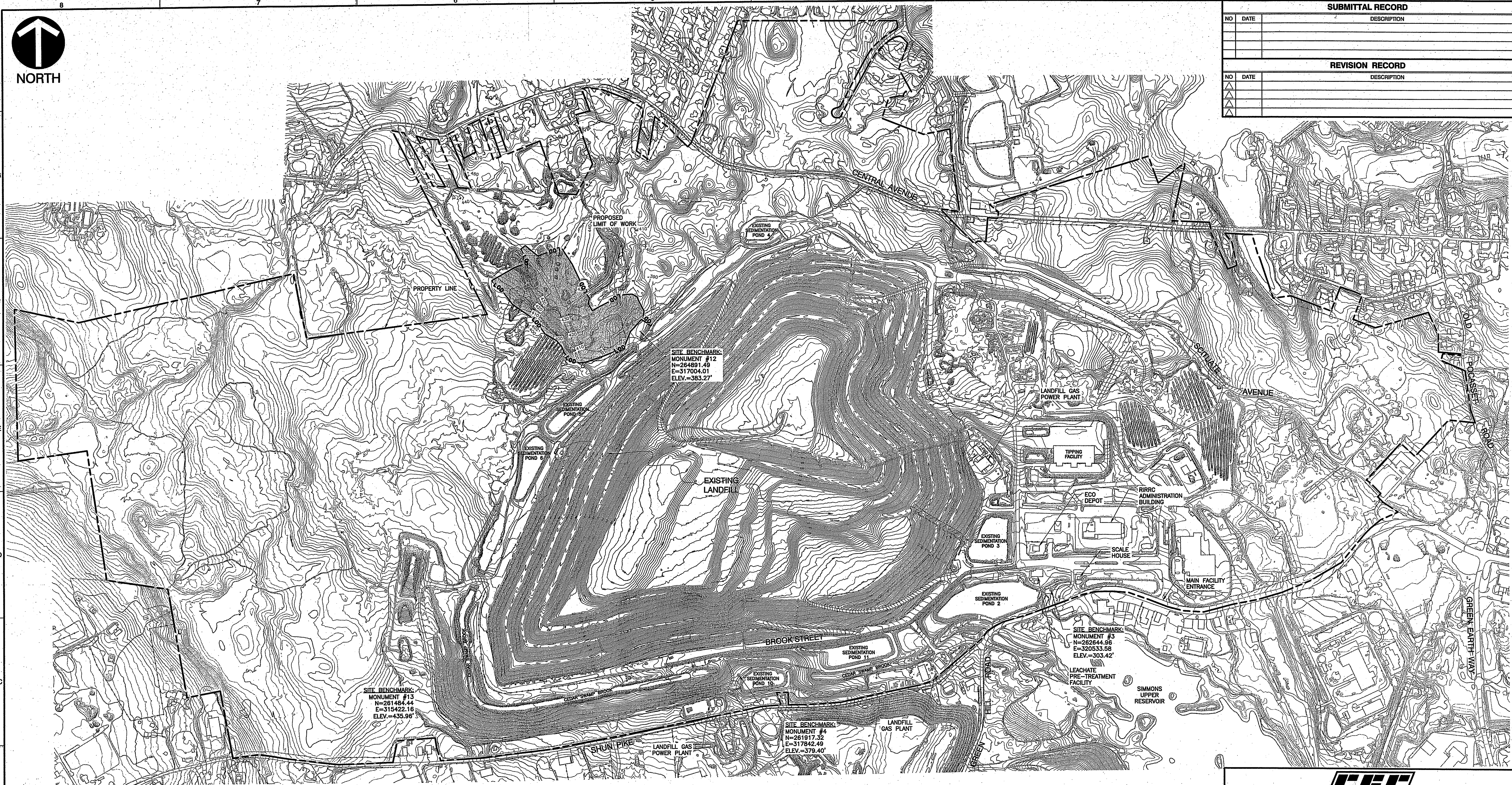

SITE BENCHMARK:
MONUMENT #13
N=261464.44
E=315422.16
ELEV.=435.96'

SITE BENCHMARK:
MONUMENT #12
N=264891.49
E=317004.01
ELEV.=383.27'

SITE BENCHMARK:
MONUMENT #5
N=262644.96
E=320533.58
ELEV.=303.42'

SITE BENCHMARK:
MONUMENT #4
N=261917.32
E=317842.49
ELEV.=379.40'

LEGEND:

- EXISTING MAJOR CONTOUR
- TREE LINE
- EXISTING EDGE OF ROAD
- PROPERTY LINE
- LIMIT OF DISTURBANCE

NOTES:

1. INFORMATION ON THIS DRAWING WAS COMPILED FROM AN ELECTRONIC PLAN ENTITLED "MARCH 11, 2012 TOPOGRAPHIC MAPPING, PREPARED BY COOPER AERIAL SURVEYS CO.," AND WAS GENERATED BY PHOTOGRAMMETRIC METHODS COMPILED ON DIGITAL STEREO WORKSTATIONS USING AERIAL PHOTOGRAPHY TAKEN ON MARCH 11, 2012.
2. THE HORIZONTAL COORDINATES AND BEARING SYSTEM SHOWN HEREON IS BASED ON THE NORTH AMERICAN DATUM OF 1983 (RHODE ISLAND STATE PLANE) COORDINATE SYSTEM. THE VALUES SHOWN HEREON ARE IN U.S. SURVEY FEET.
3. THE ELEVATIONS SHOWN HEREON ARE BASED ON VERTICAL DATUM NAVD 88.

DEPARTMENT OF ENVIRONMENTAL MANAGEMENT
OFFICE OF WATER RESOURCES
FRESHWATER WETLANDS PROGRAM
APPROVED WITH CONDITIONS
AS SPECIFIED IN THE LETTER OF APPROVAL
DATED MAR 16 2015 FILE # 14-0048
NO CHANGES ALLOWED WITHOUT PRIOR APPROVAL
APPROVED PLANS MUST BE AT CONSTRUCTION SITE

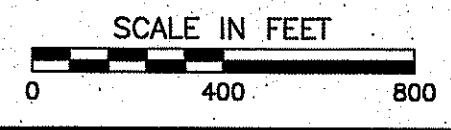

PHILLIP N. JAGODA
No. 9923
REGISTERED PROFESSIONAL ENGINEER
2/2/15

CEC
Civil & Environmental Consultants, Inc.
31 Bellows Road - Raynham, MA 02767
Ph: 774.501.2176 • 866.312.2024 • Fax: 774.501.2669
www.cecinc.com

**RHODE ISLAND
RESOURCE RECOVERY CORPORATION
JOHNSTON, RHODE ISLAND**

DRAWN BY: TLM CHECKED BY: APPROVED BY:
DATE: FEBRUARY 2014 DWG SCALE: 1"=400' PROJECT NO: 132-269

COMPOSTING AREA EXPANSION
SITE VICINITY PLAN
C100
SHEET 1 OF 5

P:\2013\12-2691-0001\Draw\13071-0001.dwg - Computer Area - 12/26/2014 8:48 AM - 12/26/2014 8:48 AM



SUBMITTAL RECORD	
NO	DATE

REVISION RECORD	
NO	DATE

LEGEND:

- EXISTING MAJOR CONTOUR
- TREE LINE
- EXISTING ACCESS ROAD
- WETLAND LINE
- PROPERTY LINE
- 200-FOOT SURFACE WATER BUFFER
- 100-FOOT RIVERBANK WETLAND
- LOD - LIMIT OF DISTURBANCE
- WETLAND FLAG
- RIVERBANK WETLAND FLAG
- AREA SUBJECT TO STORM FLOWAGE
- RB FLOW PATH
- ASSF FLOW PATH
- EXISTING GROUNDWATER MONITORING WELL

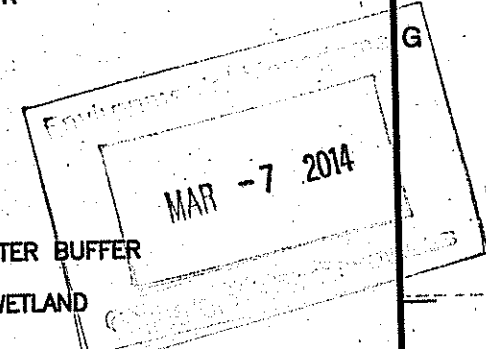

- NOTES:**
- INFORMATION ON THIS DRAWING WAS COMPILED FROM AN ELECTRONIC PLAN ENTITLED "MARCH 11, 2012 TOPOGRAPHIC MAPPING, PREPARED BY COOPER AERIAL SURVEYS CO.," AND WAS GENERATED BY PHOTOGRAMMETRIC METHODS COMPILED ON DIGITAL STEREO WORKSTATIONS USING AERIAL PHOTOGRAPHY TAKEN ON MARCH 11, 2012.
 - THE HORIZONTAL COORDINATES AND BEARING SYSTEM SHOWN HEREON IS BASED ON THE NORTH AMERICAN DATUM OF 1983 (RHODE ISLAND STATE PLANE) COORDINATE SYSTEM. THE VALUES SHOWN HEREON ARE IN U.S. SURVEY FEET.
 - THE ELEVATIONS SHOWN HEREON ARE BASED ON VERTICAL DATUM NAVD 88.
 - WETLAND RESOURCE AREAS WERE DELINEATED BY ECOSYSTEM SOLUTIONS, INC. ON SEPTEMBER 13, 2013. LOCATIONS OF WETLAND FLAGS WERE SURVEYED BY CIVIL & ENVIRONMENTAL CONSULTANTS, INC. ON SEPTEMBER 18 & 19, 2013 USING A TRIMBLE GPS UNIT AND REFERENCING SITE BENCHMARKS.
 - RIVERBANK WETLAND SURVEY POINTS RB-100 TO RB-120 WERE SURVEYED BY CIVIL & ENVIRONMENTAL CONSULTANTS, INC. ON DECEMBER 12, 2013 WITH A TRIMBLE GPS UNIT AND REFERENCING SITE BENCHMARKS. QUARRY STREAM WAS PART OF A RESTORATION PROJECT COMPLETED BY RIRRC IN 1997 AS PART OF A RIDEWY CONSENT AGREEMENT DATED AUGUST 20, 1006 AND WAS DESIGNED AND CONSTRUCTED WITH A WIDTH LESS THAN 10 FEET WIDE.

DEPARTMENT OF ENVIRONMENTAL MANAGEMENT
 OFFICE OF WATER RESOURCES
 FRESHWATER WETLANDS PROGRAM
 APPROVED WITH CONDITIONS
 AS SPECIFIED IN THE LETTER OF APPROVAL
 DATED MAR 16 2015 FILE # 14-0048
 NO CHANGES ALLOWED WITHOUT PRIOR APPROVAL
 APPROVED PLANS MUST BE AT CONSTRUCTION SITE.

Matthew D. Wozniak

Kindly be advised that this Permit is not equivalent to a verification of the type or extent of freshwater wetlands on site.

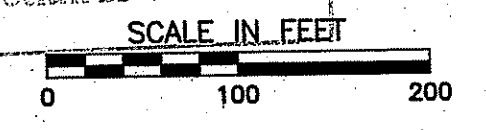

SITE BENCHMARK
 MONUMENT #12
 N=284591.40
 E=317004.01
 ELEV.=383.27'

PHASE II

EXISTING LANDFILL

EXISTING SEDIMENTATION POND 5

PHASE III

PHILLIP N. JAGODA
 No. 9923
 REGISTERED PROFESSIONAL ENGINEER
 CIVIL
 2/29/14

CEC
 Civil & Environmental Consultants, Inc.
 31 Bellows Road - Raynham, MA 02767
 Ph: 774.501.2176 - 866.312.2024 - Fax: 774.501.2669
 www.ceclinc.com

RHODE ISLAND RESOURCE RECOVERY CORPORATION JOHNSTON, RHODE ISLAND

DRAWN BY: TLM CHECKED BY: APPROVED BY:
 DATE: FEBRUARY 2014 DWG SCALE: 1"=100' PROJECT NO: 132-269

COMPOSTING AREA EXPANSION EXISTING CONDITIONS PLAN

DRAWING NO: **C101**
 SHEET 2 OF 5

P:\2014\132-269\132-269.dwg (132-269.dwg) - LF: 2/29/2014 3:34 PM
 P:\2014\132-269\132-269.dwg (132-269.dwg) - LF: 2/29/2014 3:34 PM
 P:\2014\132-269\132-269.dwg (132-269.dwg) - LF: 2/29/2014 3:34 PM

REVISION RECORD		
NO	DATE	DESCRIPTION
1	11/21/14	REVISED WET VEGETATED TREATMENT SYSTEM BASIN, VARIOUS DESIGN CHANGES.



- LEGEND:**
- EXISTING MAJOR CONTOUR
 - TREE LINE
 - EXISTING ACCESS ROAD
 - WETLAND LINE
 - PROPERTY LINE
 - 200-FOOT SURFACE WATER BUFFER
 - 100-FOOT RIVERBANK WETLAND
 - LOD — LIMIT OF DISTURBANCE
 - WETLAND FLAG
 - X WF-2, BF — RIVERBANK WETLAND FLAG
 - X RB-4 — AREA SUBJECT TO STORM FLOWAGE
 - X ASSF-6 — RB FLOW PATH
 - ASSF FLOW PATH
 - X WER-17 — EXISTING GROUNDWATER MONITORING WELL
 - 500 — PROPOSED CONTOUR
 - SF — PROPOSED EROSION BARRIER
 - PROPOSED ACCESS ROAD
 - PROPOSED SWALE
 - PROPOSED DIVERSION BERM

Kindly be advised that this Permit is not equivalent to a verification of the type or extent of freshwater wetlands on site.

- NOTES:**
- INFORMATION ON THIS DRAWING WAS COMPILED FROM AN ELECTRONIC PLAN ENTITLED "MARCH 11, 2012 TOPOGRAPHIC MAPPING, PREPARED BY COOPER AERIAL SURVEYS CO.," AND WAS GENERATED BY PHOTOGRAMMETRIC METHODS COMPILED ON DIGITAL STEREO WORKSTATIONS USING AERIAL PHOTOGRAPHY TAKEN ON MARCH 11, 2012.
 - THE HORIZONTAL COORDINATES AND BEARING SYSTEM SHOWN HEREON IS BASED ON THE NORTH AMERICAN DATUM OF 1983 (RHODE ISLAND STATE PLANE) COORDINATE SYSTEM. THE VALUES SHOWN HEREON ARE IN U.S. SURVEY FEET.
 - THE ELEVATIONS SHOWN HEREON ARE BASED ON VERTICAL DATUM NAVD 89.
 - WETLAND RESOURCE AREAS WERE DELINEATED BY ECOSYSTEM SOLUTIONS, INC. ON SEPTEMBER 13, 2013. LOCATIONS OF WETLAND FLAGS WERE SURVEYED BY CIVIL & ENVIRONMENTAL CONSULTANTS, INC. ON SEPTEMBER 18 & 19, 2013 USING A TRIMBLE GPS UNIT.
 - RIVERBANK WETLAND SURVEY POINTS RB-100 TO RB-120 WERE SURVEYED BY CIVIL & ENVIRONMENTAL CONSULTANTS, INC. ON DECEMBER 12, 2013 WITH A TRIMBLE GPS UNIT AND REFERENCING SITE BENCHMARKS. QUARRY STREAM WAS PART OF A RESTORATION PROJECT COMPLETED BY RIRCO IN 1997 AS PART OF A RIDEW CONSENT AGREEMENT DATED AUGUST 20, 1008 AND WAS DESIGNED AND CONSTRUCTED WITH A WIDTH LESS THAN 10 FEET WIDE.

DEPARTMENT OF ENVIRONMENTAL MANAGEMENT
OFFICE OF WATER RESOURCES
FRESHWATER WETLANDS PROGRAM
APPROVED WITH CONDITIONS
AS SPECIFIED IN THE LETTER OF APPROVAL
DATED MAR 16 2015 FILE # 14-0048
NO CHANGES ALLOWED WITHOUT PRIOR APPROVAL
APPROVED PLANS MUST BE AT CONSTRUCTION SITE

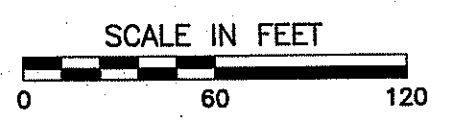
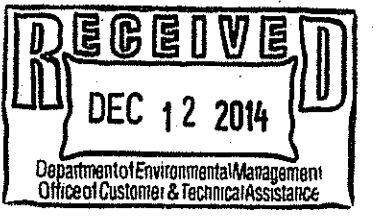

CEC
Civil & Environmental Consultants, Inc.
31 Bellows Road - Raynham, MA 02767
Ph: 774.501.2176 • 866.312.2024 • Fax: 774.501.2669
www.cecinc.com

**RHODE ISLAND
RESOURCE RECOVERY CORPORATION
JOHNSTON, RHODE ISLAND**

PHILLIP N. JAGODA
No. 9223
REGISTERED PROFESSIONAL ENGINEER
1/1/14

DRAWN BY: RJF CHECKED BY: PNJ APPROVED BY: PNJ
DATE: FEBRUARY 2014 DWG SCALE: 1"=60' PROJECT NO.: 132-269

COMPOSTING AREA EXPANSION
PROPOSED SITE PLAN
DRAWING NO.: **C200**
SHEET 3 OF 5

A:\2014\132-269\132-269.dwg (132-269) Compost Area Expanding Rhody July 2014 12:29:30 REV JUL2014.dwg (132-269) LS(11/21/2014 - 10:00 AM) - LP 12/9/2014 10:37 PM

REVISION RECORD		
NO	DATE	DESCRIPTION
1	11/21/14	REVISED DETAILS 6/5, 7/5, 8/5, AND ADDED DETAIL 11/5.

EROSION AND SEDIMENT CONTROL NOTES:

1. THE CONTRACTOR'S ATTENTION IS DIRECTED TO THE WETLAND AREA THAT EXISTS ON SITE. WETLANDS DOWNGRADE OF CONSTRUCTION AREAS SHALL BE PROTECTED WITH SILT FENCE, STRAW BALE BARRIER, OR OTHER MEANS NECESSARY AS DIRECTED BY OWNER PRIOR TO DISTURBANCE. NO DIRECT DISCHARGE OF SEDIMENT TO WETLANDS SHALL BE PERMITTED. CONTRACTOR SHALL COMPLY WITH THE WETLANDS APPROVAL BY RIDEM TO RIRRC.
2. CLEAR ONLY WHAT IS REQUIRED FOR IMMEDIATE CONSTRUCTION ACTIVITY. AREAS SHOULD ONLY BE CLEARED AND GRADED AS CONSTRUCTION PROGRESSES. ALL SOIL EROSION AND SEDIMENT CONTROL PRACTICES SHALL BE INSTALLED PRIOR TO ANY MAJOR SOIL DISTURBANCE AND MAINTAINED UNTIL PERMANENT PROTECTION IS ESTABLISHED.
3. ALL DISTURBED AREAS SHALL RECEIVE 6-INCHES OF LOAM AND SEEDING. PROVIDE OBSERVATION AND MAINTENANCE OF SOIL EROSION AND SEDIMENT CONTROLS UNTIL SOILS ARE STABILIZED.
4. LIMIT WORK SUCH THAT TRENCHING IS BACKFILLED AND PROTECTED AT THE COMPLETION OF EACH DAYS WORK.
5. THE CONTRACTOR SHALL MAINTAIN EXISTING PERIMETER CHANNELS SUCH THAT NO ERODED SOIL IS ALLOWED TO ACCUMULATE IN OR DRAIN TO SEDIMENT PONDS. COORDINATE WORK IN EXISTING CHANNELS SUCH THAT THE SITE IS PROTECTED DURING RAIN STORM EVENTS. THE CONTRACTOR SHALL BE RESPONSIBLE FOR DAMAGE TO DOWNSTREAM STRUCTURES AS A RESULT OF EROSION DUE TO THE CONTRACTOR'S WORK.

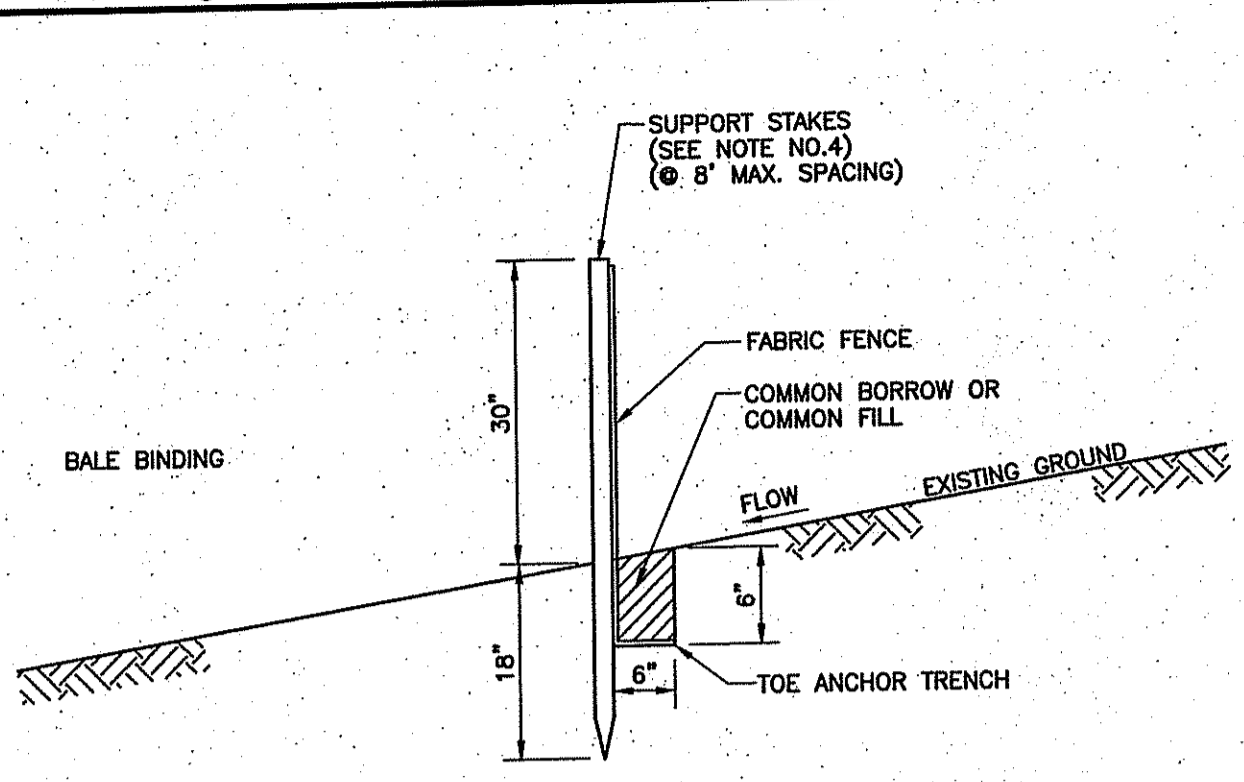

NOTES:

1. FILTER FABRIC FENCE MUST BE INSTALLED AT EXISTING LEVEL GRADE. BOTH ENDS OF EACH SECTION MUST BE EXTENDED AT LEAST 8 FEET UPSLOPE AT 45 DEGREES TO THE MAIN SECTION ALIGNMENT.
2. SEDIMENT MUST BE REMOVED WHERE ACCUMULATIONS REACH 1/2 THE ABOVE GROUND HEIGHT OF THE FENCE.
3. USE 2"x2" WOOD OR EQUIVALENT STEEL STAKES.

1 FILTER FABRIC FENCE
NOT TO SCALE

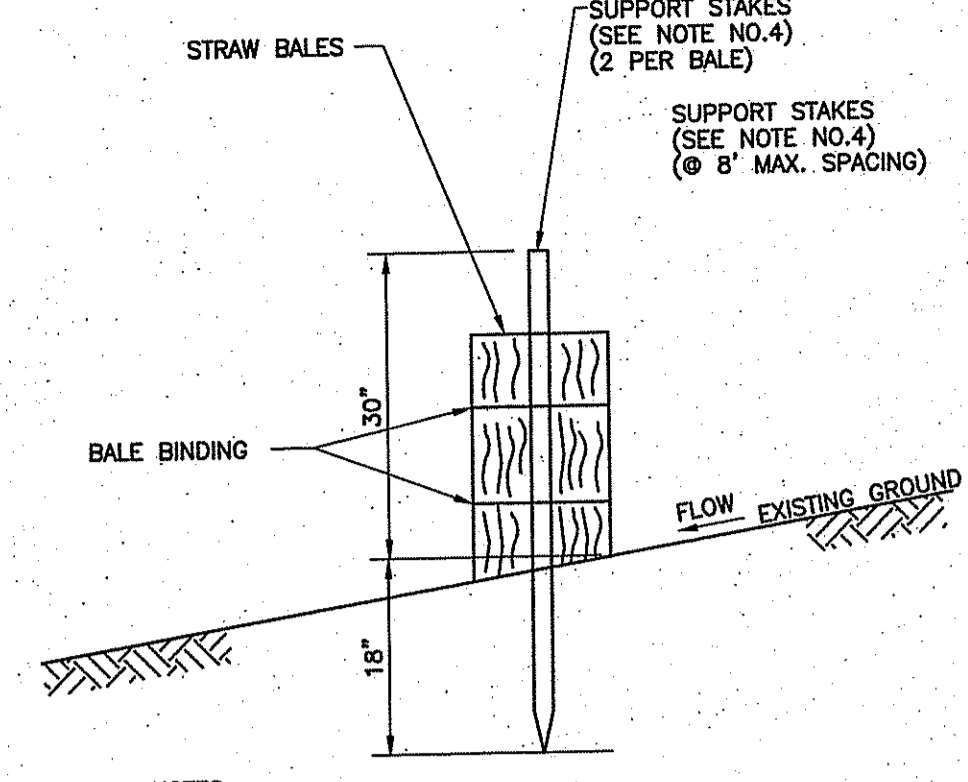

NOTES:

1. STRAW BALE FENCE MUST BE INSTALLED AT EXISTING LEVEL GRADE. BOTH ENDS OF EACH SECTION MUST BE EXTENDED AT LEAST 8 FEET UPSLOPE AT 45 DEGREES TO THE MAIN SECTION ALIGNMENT.
2. SEDIMENT MUST BE REMOVED WHERE ACCUMULATIONS REACH 1/2 THE ABOVE GROUND HEIGHT OF THE BALES.
3. USE 2"x2" WOOD OR EQUIVALENT STEEL STAKES.

2 STRAW BALE EROSION BARRIER
NOT TO SCALE

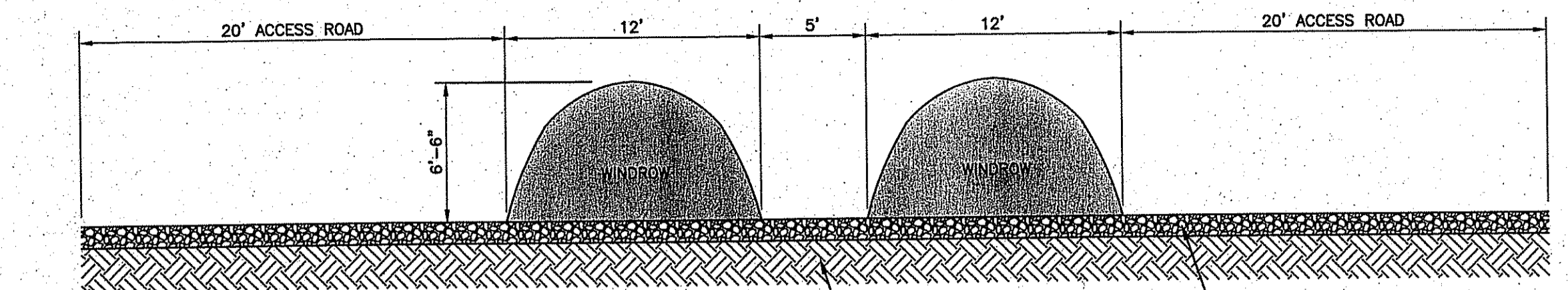

NOTE:

1. DETAIL PROVIDED IS TYPICAL AS SHOWN, WINDROWS MAXIMUM DIMENSION SHALL BE 24-FOOT WIDE x 12-FOOT HIGH, PER RIDEM COMPOSTING REGULATIONS AND APPROVED RIRRC COMPOSTING OPERATIONS PLAN DATED OCTOBER 2012.

3 WINDROW SECTION
SCALE: 1" = 6'

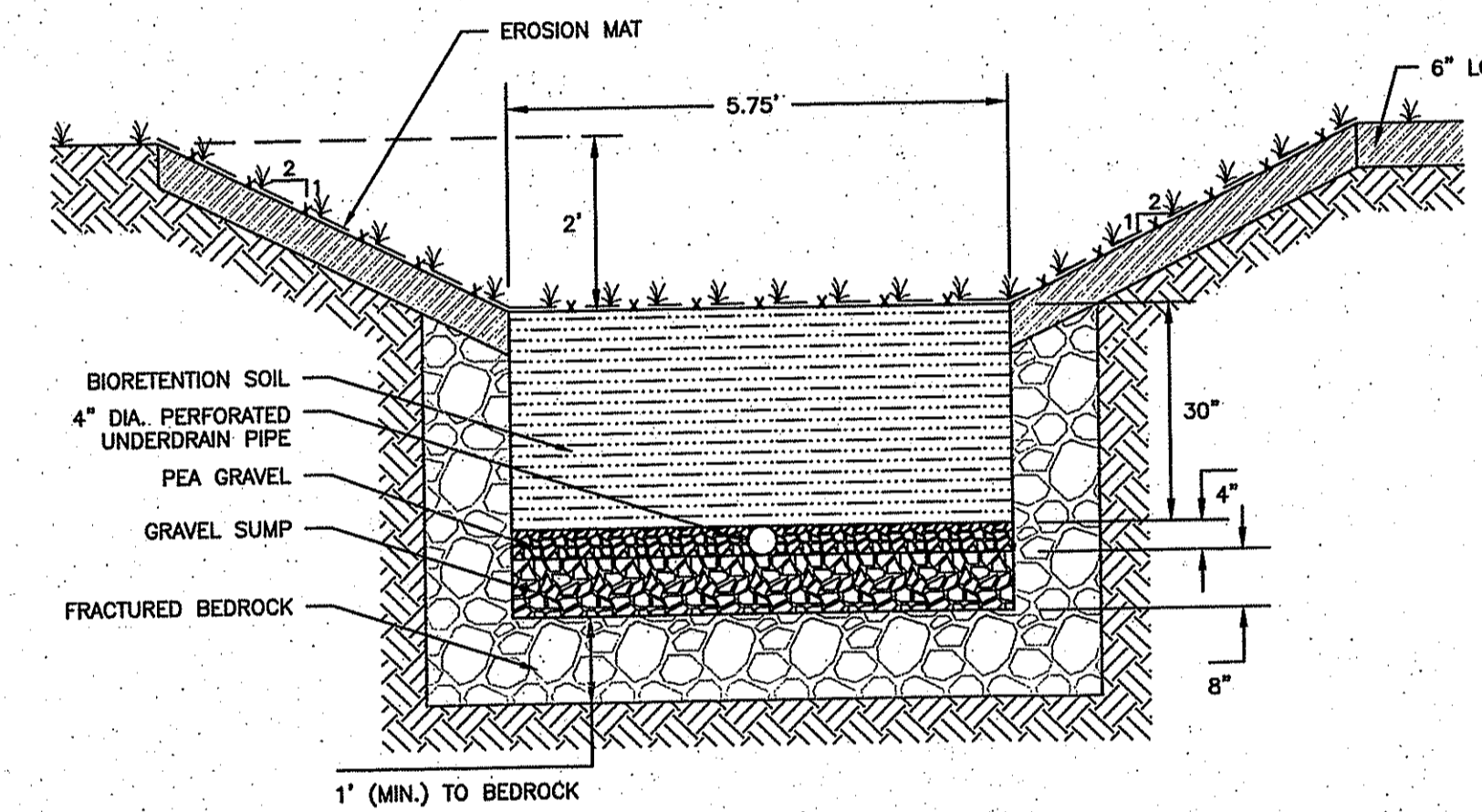

4 PERIMETER ACCESS ROAD DETAIL
SCALE: 1" = 2'

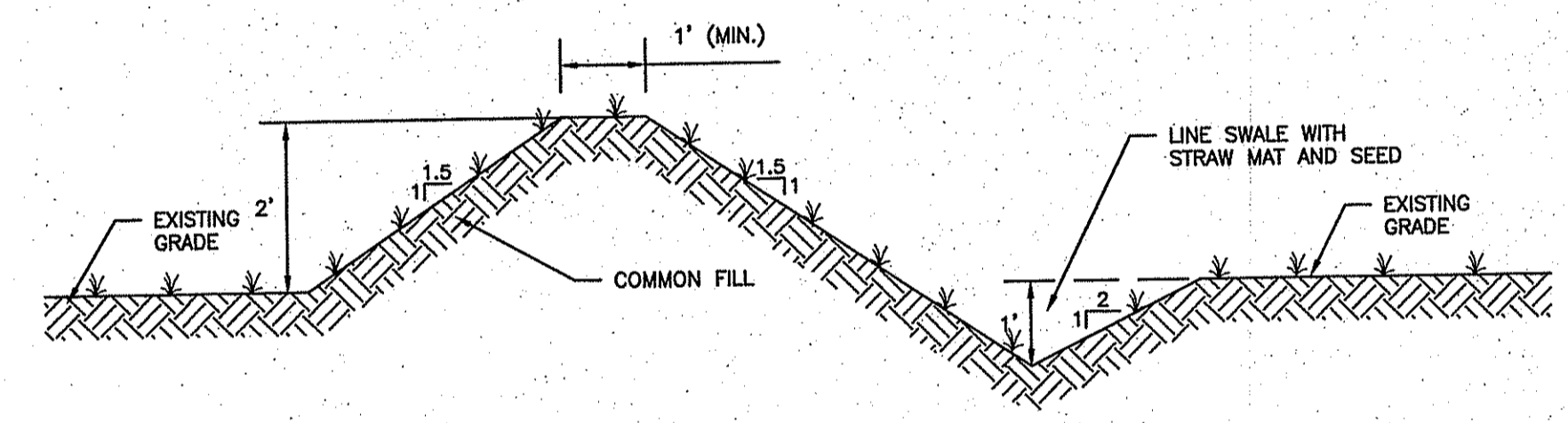

5 RIP-RAP SPILLWAY DETAIL
SCALE: 1" = 2'

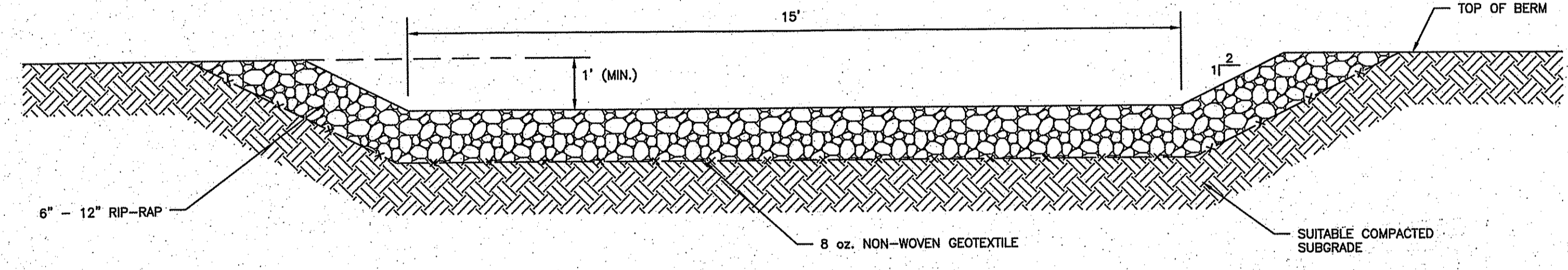

10 RIP-RAP V-BOTTOM DRAINAGE SWALE
SCALE: 1" = 2'

NOTES:

1. DRAINAGE SWALE TO BE LINED WITH EROSION MAT AND SEEDED.
2. SEED MIXTURE SHALL CONSIST OF 0.45lbs/1,000 ft² CREEPING RED FESCUE AND 0.45lbs/1,000 ft² OF TALL FESCUE OR REED CANARY GRASS.
3. RIP-RAP (6"-12") SHALL BE PLACED IN AREAS AS INDICATED ON DRAWINGS, WITH AN 8oz. NON-WOVEN GEOTEXTILE BENEATH.

BIORETENTION SOIL:

1. THE SOIL SHOULD BE A UNIFORM MIX, FREE OF STONES, STUMPS, ROOTS OR OTHER SIMILAR OBJECTS LARGER THAN 2-INCHES.

THE BIORETENTION SOIL SHALL CONSIST OF:

SAND: 85-88%

SOIL FINES: 8-12% (NO MORE THAN 2% CLAY)

ORGANIC MATTER: 3-5%

THE BIORETENTION SOIL SHALL ALSO MEET THE FOLLOWING:

PH RANGE: <5.2-7.0

MAGNESIUM: <32 ppm

PHOSPHORUS P₂O₅: <69 ppm

POTASSIUM K₂O: <78 ppm

SOLUBLE SALTS: <500 ppm

6 VEGETATED TRAPEZOIDAL DRY SWALE
NOT TO SCALE

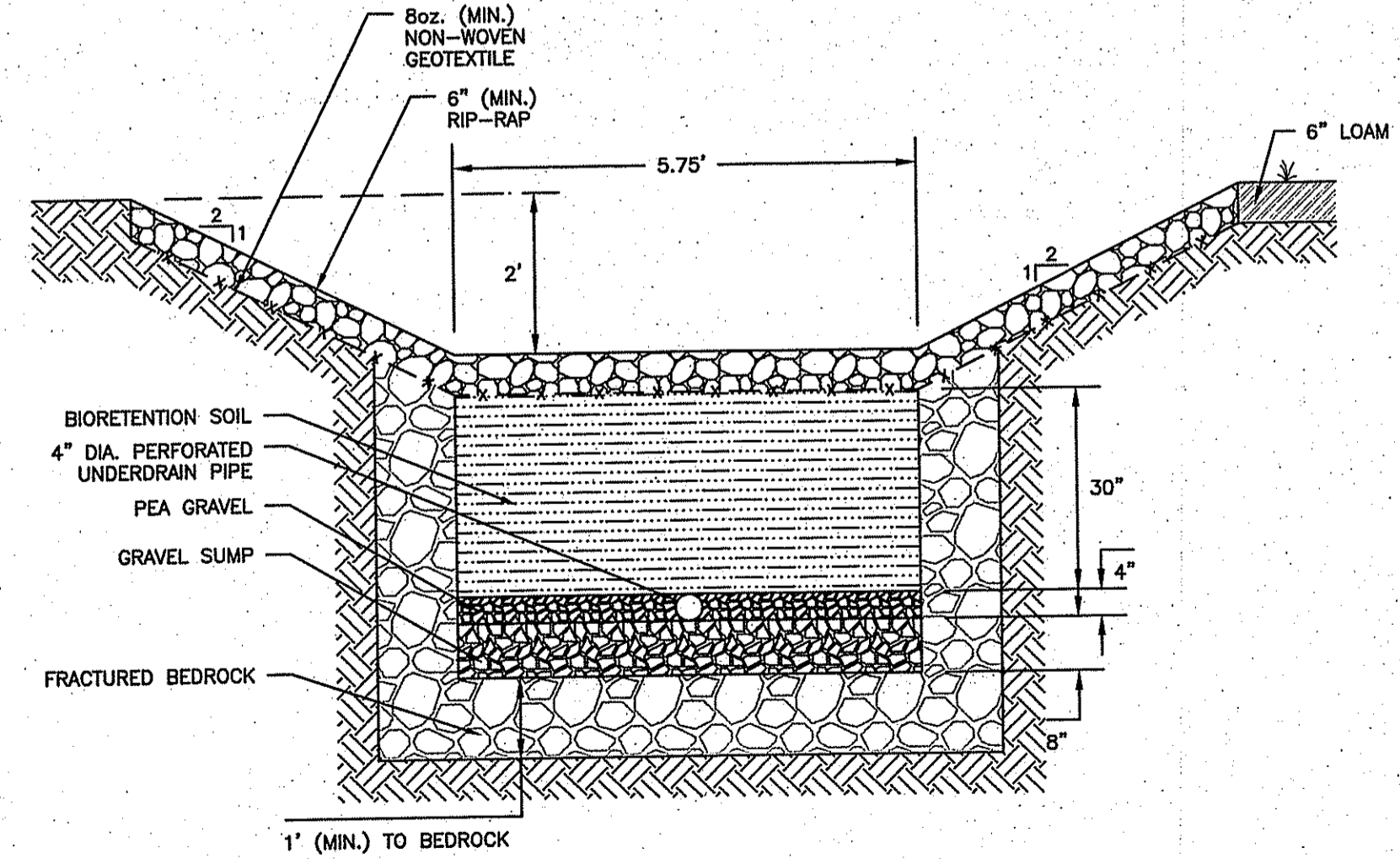

9 RIP-RAP TRAPEZOIDAL DRY SWALE
NOT TO SCALE

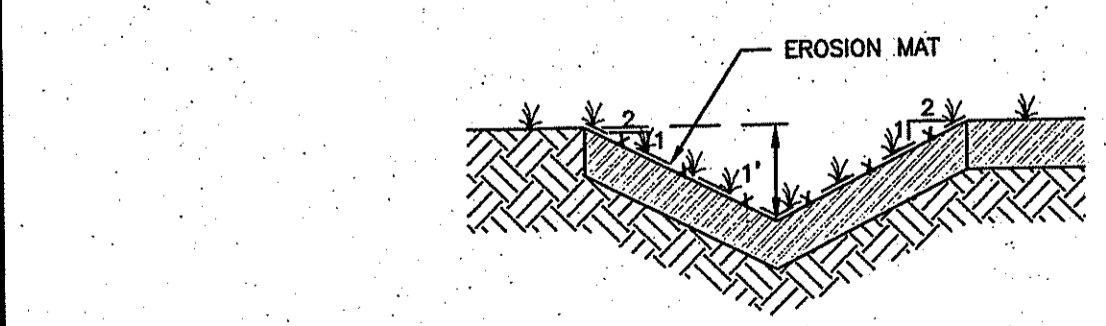

8 DIVERSION BERM DETAIL
SCALE: 1" = 2'

NOTES:

1. DRAINAGE SWALE TO BE LINED WITH EROSION MAT AND SEEDED.
2. SEED MIXTURE SHALL CONSIST OF 0.45lbs/1,000 ft² CREEPING RED FESCUE AND 0.45lbs/1,000 ft² OF TALL FESCUE OR REED CANARY GRASS.
3. RIP-RAP (6"-12") SHALL BE PLACED IN AREAS AS INDICATED ON DRAWINGS, WITH AN 8oz. NON-WOVEN GEOTEXTILE BENEATH.

7 VEGETATED V-BOTTOM DRAINAGE SWALE
SCALE: 1" = 2'

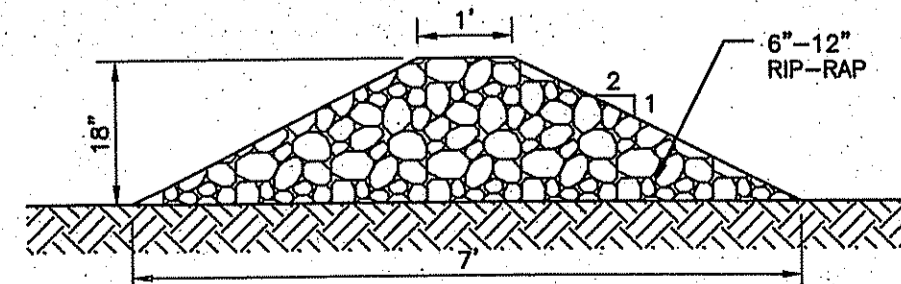

11 TYPICAL CHECK DAM DETAIL
SCALE: 1" = 2'

DEPARTMENT OF ENVIRONMENTAL MANAGEMENT
OFFICE OF WATER RESOURCES
FRESHWATER WETLANDS PROGRAM
APPROVED WITH CONDITIONS
AS SPECIFIED IN THE LETTER OF APPROVAL
DATED MAR 16 2015 FILE # 14-3049
NO CHANGES ALLOWED WITHOUT PRIOR APPROVAL
APPROVED PLANS MUST BE AT CONSTRUCTION SITE

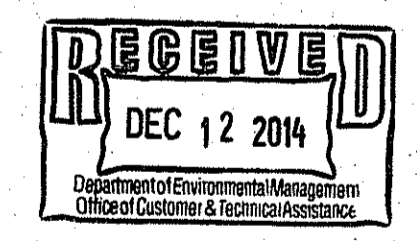

CEC
Civil & Environmental Consultants, Inc.
31 Bellows Road - Raynham, MA 02767
Ph: 774.501.2176 · 866.312.2024 · Fax: 774.501.2669
www.cecinc.com

RHODE ISLAND
RESOURCE RECOVERY CORPORATION
JOHNSTON, RHODE ISLAND

PHILLIP N. JAGODA
No. 9923
REGISTERED PROFESSIONAL ENGINEER
CIVIL
12/08/13

DRAWN BY: TLM CHECKED BY: APPROVED BY:
DATE: FEBRUARY 2014 DWG SCALE: AS SHOWN PROJECT NO: 132-269

COMPOSTING AREA EXPANSION
DETAIL SHEET - II
DRAWING NO: **C801**
SHEET 5 OF 5

P:\2013\132-269\CADD\DWG\SWALE-REVISED Compast Area Expanding Plans-July 2014\132269-SWALE-REVISED.dwg (12/19/2014 12:54 PM - Anonymous)

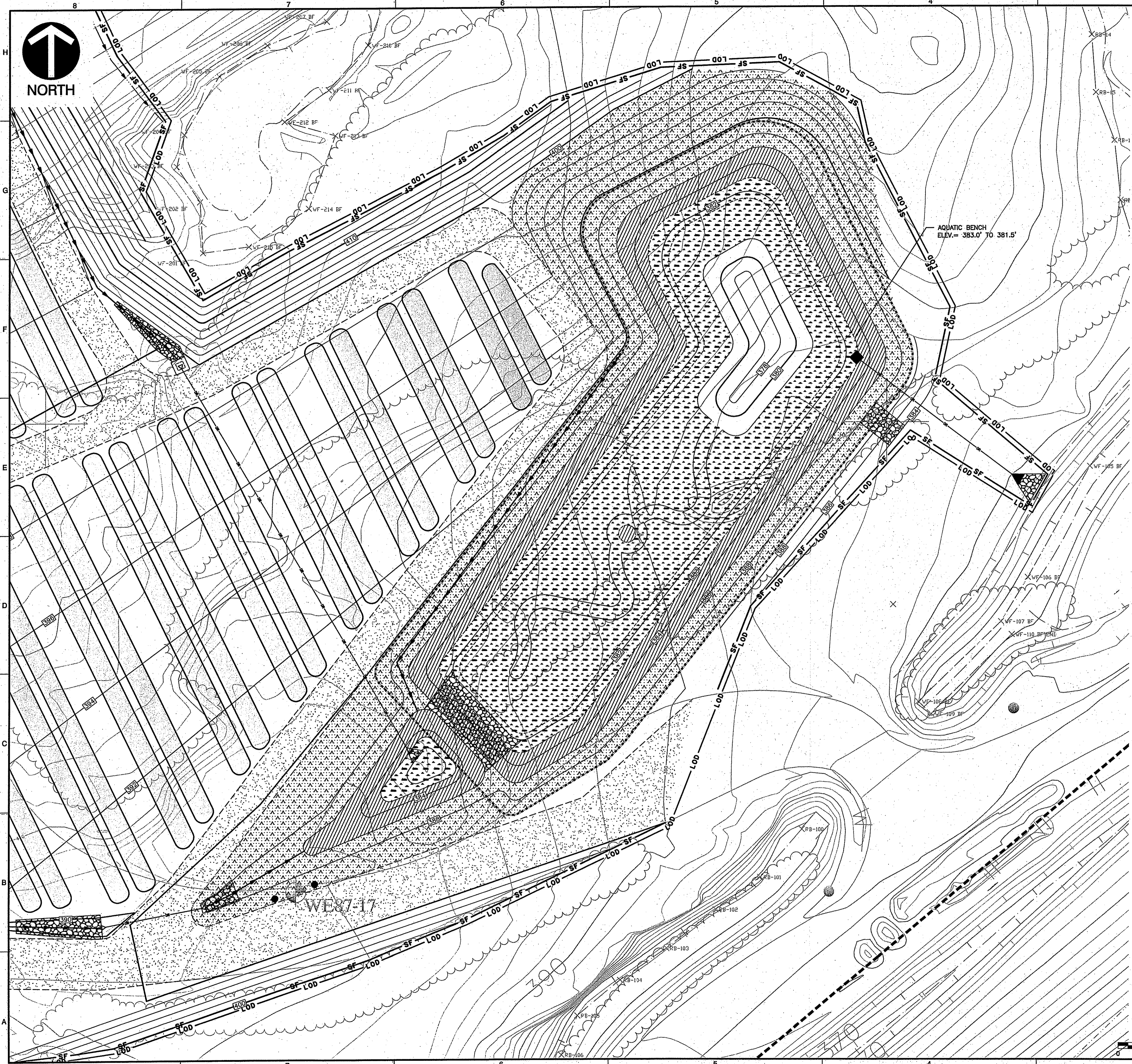

AQUATIC BENCH AND BOTTOM

Emergent Wetland Seed Mix	
Botanical Name	Common Name
Permanent Grasses/Sedges/Rushes:	
<i>Carex comosa</i>	Bristly Sedge
<i>Carex lacustris</i>	Common Lake Sedge
<i>Carex lurida</i>	Bottlebrush Sedge
<i>Carex vulpinoidea</i>	Brown Fox Sedge
<i>Eleocharis ovalis</i>	Blunt Spike Rush
<i>Eleocharis acicularis</i>	Rice Cut Grass
<i>Juncus effusus</i>	Common Rush
<i>Scirpus acutus</i>	Hard-stemmed Bulrush
<i>Scirpus pungens</i>	Chalmaker's Rush
<i>Scirpus validus</i>	Great Bulrush
Temporary Cover:	
<i>Avena sativa</i>	Common Oat
<i>Lolium multiflorum</i>	Annual Rye
Forbs:	
<i>Acorus calamus</i>	Sweet Flag
<i>Alisma spp.</i>	Water Plantain (Various Mix)
<i>Asclepias incarnata</i>	Swamp Milkweed
<i>Cephalanthus occidentalis</i>	Butterbush
<i>Decodon verticillatus</i>	Swamp Loosestrife
<i>Eupatorium maculatum</i>	Spotted Joe-Pye Weed
<i>Hibiscus spp.</i>	Rosemallow (Various Mix)
<i>Iris virginica</i>	Blue Flag
<i>Lobelia cardinalis</i>	Cardinal Flower
<i>Lobelia siphilitica</i>	Great Blue Lobelia
<i>Lycopus americanus</i>	Common Water Horehound
<i>Mimulus ringens</i>	Monkey Flower
<i>Peltandra virginica</i>	Arrow Arum
<i>Penthorum sedoides</i>	Ditch Stonewort
<i>Polygonum spp.</i>	Pinkweed (Various Mix)
<i>Pontederia cordata</i>	Pickering Weed
<i>Sagittaria latifolia</i>	Common Arrowhead
<i>Sparganium americanum</i>	American Bur Reed
<i>Sparganium eurycarpum</i>	Common Bur Reed
<i>Verbena hastata</i>	Blue Vervain
<i>Veronica hastata</i>	Blue Vervain

(BASE - TO ELEV. 383')

AREA: 28,500 S.F.

SHORELINE FRINGE

Wetland Edge Seed Mix	
Botanical Name	Common Name
Permanent Grasses/Sedges:	
<i>Carex comosa</i>	Bristly Sedge
<i>Carex cristatella</i>	Crested Owl Sedge
<i>Carex frankii</i>	Bristly Cattail Sedge
<i>Carex vulpinoidea</i>	Brown Fox Sedge
<i>Eleocharis palustris</i>	Great Spike Rush
<i>Elymus virginicus</i>	Virginia Wild Rye
<i>Glyceria striata</i>	Fowl Manna Grass
<i>Leersia oryzoides</i>	Rice Cut Grass
<i>Scirpus atrovirens</i>	Dark Green Rush
<i>Scirpus cyperinus</i>	Wool Grass
<i>Scirpus pungens</i>	Chalmaker's rush
<i>Scirpus validus</i>	Great Bulrush
<i>Sparganium eurycarpum</i>	Common Bur Reed
Temporary Cover:	
<i>Avena sativa</i>	Common Oat
<i>Lolium multiflorum</i>	Annual Rye
Forbs:	
<i>Acorus calamus</i>	Sweet Flag
<i>Alisma spp.</i>	Water Plantain (Various Mix)
<i>Asclepias incarnata</i>	Swamp Milkweed
<i>Aster purpureus</i>	Bristly Aster
<i>Bidens spp.</i>	Bidens (Various Mix)
<i>Eupatorium perfoliatum</i>	Common Boneset
<i>Helenium autumnale</i>	Sneezeweed
<i>Iris virginica</i>	Blue Flag
<i>Lobelia siphilitica</i>	Great Blue Lobelia
<i>Lycopus americanus</i>	Common Water Horehound
<i>Mimulus ringens</i>	Monkey Flower
<i>Penthorum sedoides</i>	Ditch Stonewort
<i>Polygonum spp.</i>	Pinkweed (Various Mix)
<i>Rudbeckia laciniata</i>	Wild Golden Glow
<i>Sagittaria latifolia</i>	Common Arrowhead
<i>Senna hebecarpa</i>	Wild Senna
<i>Thalictrum dasycarpum</i>	Purple Meadow Rue
<i>Verbena hastata</i>	Blue Vervain
<i>Vernonia spp.</i>	Ironweed (Various Mix)

(1-FOOT ABOVE NORMAL POOL - TO ELEV. 386')

AREA: 16,000 S.F.

Kindly be advised that this Permit is not equivalent to a verification of the type or extent of freshwater wetlands on site.

- NOTES:**
- SEEDING SHALL BE DONE IN LATE FALL TO FAVOR FORBES.
 - SEEDS SHOULD BE IN DORMANT PHASE.
 - SEED MIX SHALL BE FROM CARDNO JFNEW OR NEW ENGLAND WETLAND PLANTS, INC., OR APPROVED EQUAL.

DEPARTMENT OF ENVIRONMENTAL MANAGEMENT
OFFICE OF WATER RESOURCES
FRESHWATER WETLANDS PROGRAM
APPROVED WITH CONDITIONS
AS SPECIFIED IN THE LETTER OF APPROVAL
DATED MAR 16 2015 FILE # 19-0047
NO CHANGES ALLOWED WITHOUT PRIOR APPROVAL
APPROVED PLANS MUST BE AT CONSTRUCTION SITE

Martin D. Connech

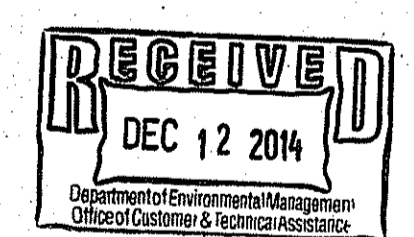

RIPARIAN FRINGE AND UPLAND SLOPES

Conservation/Wildlife Mix	
Botanical Name	Common Name
<i>Elymus virginicus</i>	Virginia Wild Rye
<i>Schizachyrium scoparium</i>	Little Bluestem
<i>Festuca rubra</i>	Creeping Red Fescue
<i>Andropogon gerardii</i>	Big Bluestem
<i>Chamaecrista fasciculata</i>	Partridge Pea
<i>Panicum clandestinum</i>	Deer Tongue
<i>Panicum virgatum</i>	Switch Grass
<i>Sorghastrum nutans</i>	Indian Grass
<i>Helenium autumnale</i>	Common Sneezeweed
<i>Helopsis helianthoides</i>	Ox Eye Sunflower
<i>Verbena hastata</i>	Blue Vervain
<i>Asclepias syriaca</i>	Common Milkweed
<i>Aster umbellatus</i>	Flat Topped/Umbrella Aster
<i>Eupatorium purpureum</i>	Purple Joe Pye Weed
<i>Solidago juncea</i>	Early Goldenrod
<i>Zizia aurea</i>	Golden Alexanders

(ELEV. 386' AND ABOVE, INCLUDES 25-FOOT SETBACK)

AREA: 35,500 S.F.

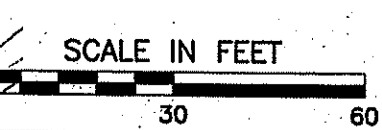

PHILIP N. JAGODA
No. 9923
REGISTERED PROFESSIONAL ENGINEER
CIVIL 12/18/14

CEC
Civil & Environmental Consultants, Inc.
31 Bellows Road - Raynham, MA 02767
Ph: 774.501.2176 · 866.312.2024 · Fax: 774.501.2669
www.cecinc.com

**RHODE ISLAND
RESOURCE RECOVERY CORPORATION
JOHNSTON, RHODE ISLAND**

DRAWN BY: RJF CHECKED BY: [] APPROVED BY: []
DATE: AUGUST 2014 DWG SCALE: 1"=30' PROJECT NO: 132-269

WET VEGETATED TREATMENT SYSTEM
PLANTING PLAN
C700
SHEET 1 OF 1

P:\2013\132-269\0201\DWG\132-269-REvised Compans Area Quality Plan-July 2014\132-269-WFS PLANTING PLAN.dwg(1/12/2014 - RJF) - LF: 12/8/2014 1:10 PM