

PLAT 506 LOT 103
DAVID Q. SIMPSON
BK 1532 PG 73
(10.73 ACRES±)

PLAT 506 LOT 102
OTHER LAND OF
DAVID Q. SIMPSON
BK 889 PG 18

"JURISDICTIONAL WETLAND EDGE" PER APPLICATION #90-0295D (SEE LETTER DATED 5/14/91)
SHOWN FOR INFORMATIONAL PURPOSES ONLY

- LEGEND
- ▲ WF A-14 WETLAND FLAG
 - IRON PIN FOUND
 - STONE WALL
 - ◆ GAS LINE MARKER
 - GATE POST
 - UTILITY POLE
 - ⊙ WELL
 - ~ EDGE OF WOODS



THIS PLAN CONFORMS TO A CLASS III SURVEY STANDARD AS ADOPTED BY THE RHODE ISLAND BOARD OF REGISTRATION FOR PROFESSIONAL LAND SURVEYORS AND IS BASED ON A CLASS I SURVEY.
Donald J. Medeiros 8/15/14
DONALD J. MEDEIROS PLS #1925

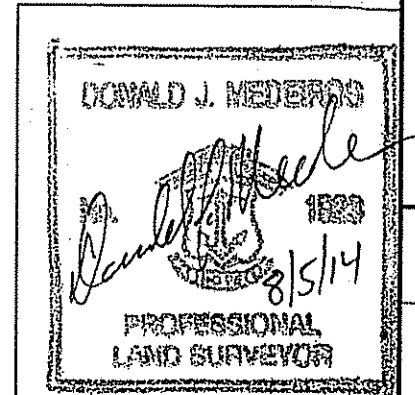

- NOTES:
- 1) RECORD OWNER: DAVID Q. SIMPSON
825 BRAYTON ROAD
TIVERTON, RI 02878
 - 2) ASSESSOR'S REF: PLAT 506 LOT 103
 - 3) PLAN REF: PLAN BOOK 19 PG 173
 - 4) JURISDICTIONAL WETLAND EDGE DETERMINED BY RIDEM PER APP. #90-0295D 5/14/91.
 - 5) WETLAND FLAGS BY NATURAL RESOURCES SERVICES, INC. NOVEMBER, 2011
 - 6) ENTIRE PROPERTY IS IN ADAMSVILLE BROOK WATERSHED.

WETLAND EDGE VERIFICATION PLAN
PREPARED FOR
DAVID Q. SIMPSON
ASSESSOR'S PLAT 506 LOT 103
BRAYTON ROAD
TIVERTON, RHODE ISLAND

SCALE: 1"=50' DATE: AUGUST 5, 2014

JOB #11-051

291 LONG HIGHWAY
LITTLE COMPTON, RI 02837
(401) 592-1502

