

INDEX

SHEET NO.	DESCRIPTION
1	COVER SHEET
2	STANDARD PLAN SYMBOLS AND STANDARD LEGEND
3-4	STANDARD NOTES - 1-2
5	JOB SPECIFIC LEGEND, NOTES AND MISCELLANEOUS DETAILS
6	TYPICAL SECTION
7-18	GENERAL PLAN NO. 1-12
19-30	PROFILE NO. 1-12
31-43	DRAINAGE AND UTILITY PLAN NO. 1-13
44-52	LOCATION PLAN NO. 1-9
53-61	SIGNING AND STRIPING PLAN NO. 1-9
62	MAINTENANCE AND PROTECTION OF TRAFFIC PLAN
63-115	CROSS-SECTION NO. 1-53

STATE OF RHODE ISLAND

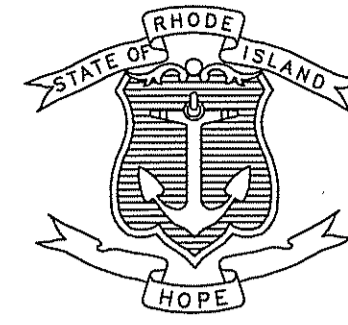

DEPARTMENT OF TRANSPORTATION

PLAN OF PROPOSED IMPROVEMENTS TO HIGH STREET AND ROUTE 108 MAIN STREET (U.S. ROUTE 1A) TO NORTH ROAD TOWN OF SOUTH KINGSTOWN COUNTY OF WASHINGTON

R.I. CONTRACT NO. 20xx-xx-xxx F.A. PROJECT NO. xxx-xxxx(xxx)
PAVEMENT STRUCTURE
2" SUPERPAVE HOT MIX ASPHALT SURFACE COURSE CLASS 9.5
4" SUPERPAVE HOT MIX ASPHALT BASE COURSE CLASS 12.5
2" GRAVEL BORROW SUBBASE COURSE
1.30 MILES

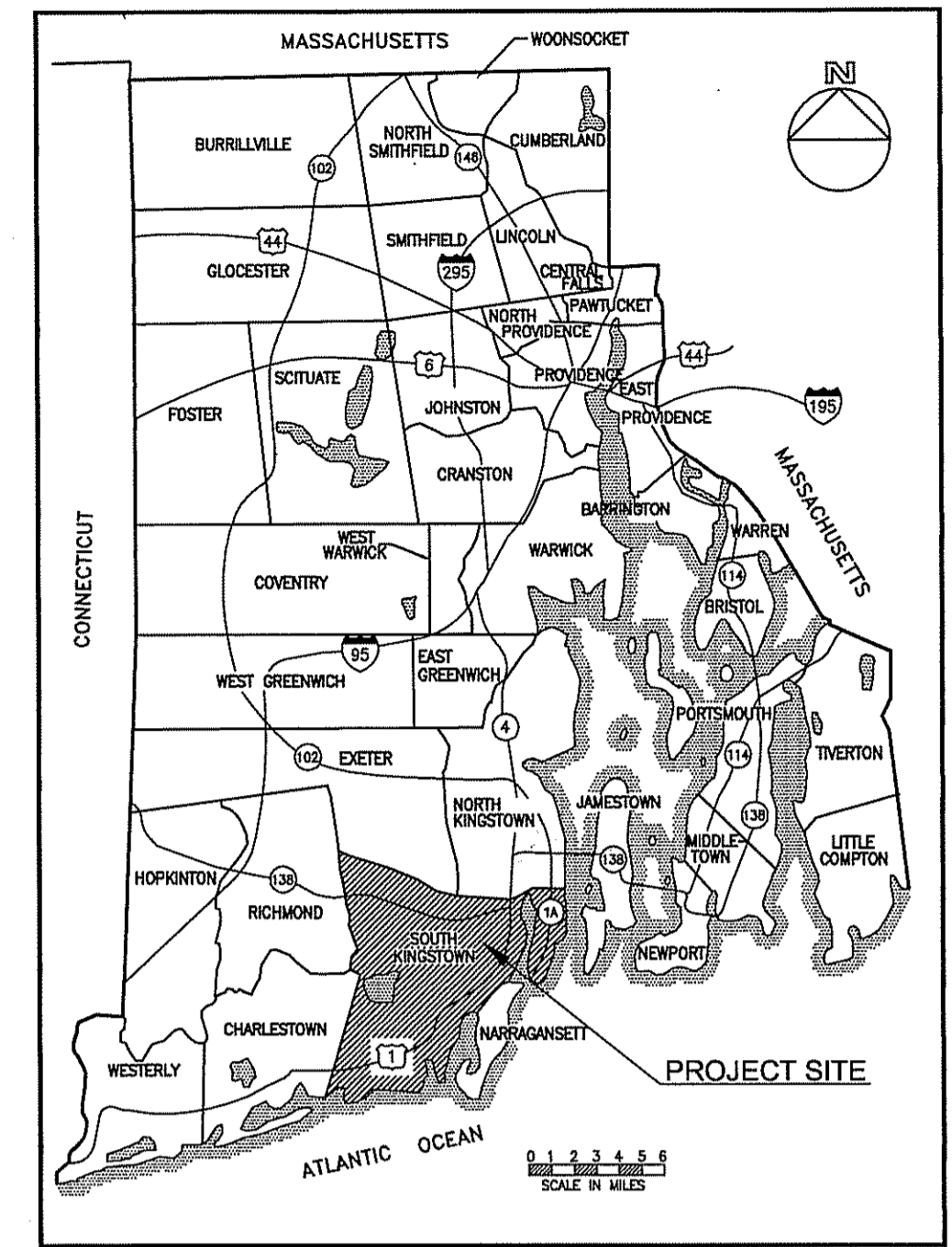

LOCATION MAP

DESIGN	DESIGNATION
AADT (2011)	4,375 V.P.D.
AADT (2031)	5,290 V.P.D.
D	50% NB/50% SB
K	7.8%
T	-
DDHV	170 V.P.H.
DHV	340 V.P.H.
DESIGN SPEED	30 M.P.H.

HURRICANE EVACUATION ROUTE

This project includes work on a designated Hurricane Evacuation and Diversionary Route as follows:
High Street between Main Street (U.S. Route 1A) and Kingstown Road (Route 108).
Refer to General Note 18 on Sheet 3.

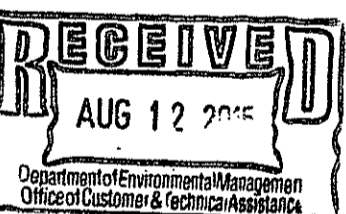

RIDEM WETLANDS SUBMISSION REVISED JULY 2015

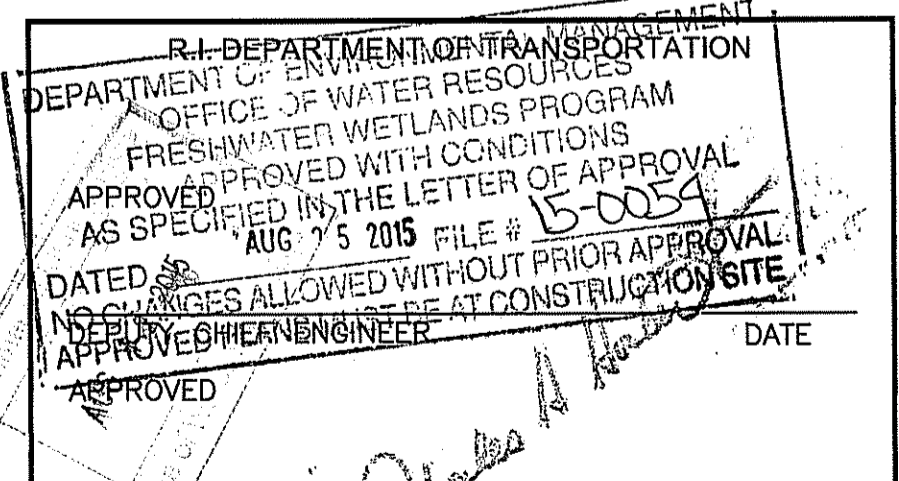

CHIEF ENGINEER	DATE
APPROVED	
DIRECTOR	DATE
APPROVED	
DIVISION ADMINISTRATOR	DATE

BEGIN STA. 100+65±

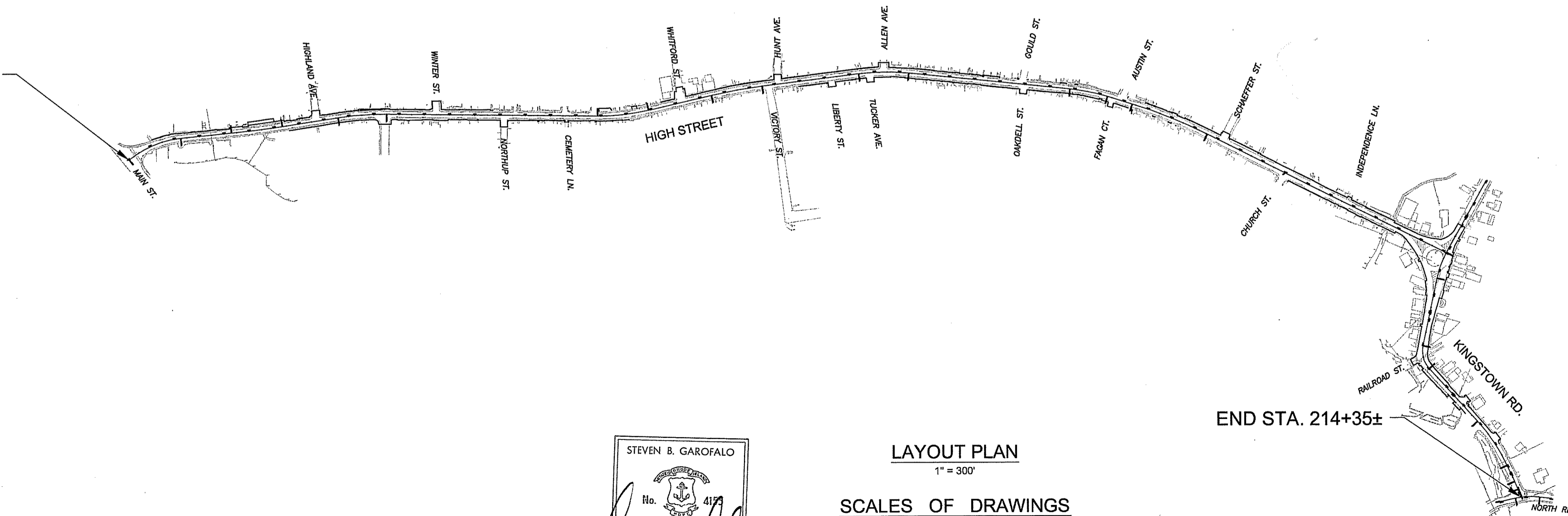

END STA. 214+35±

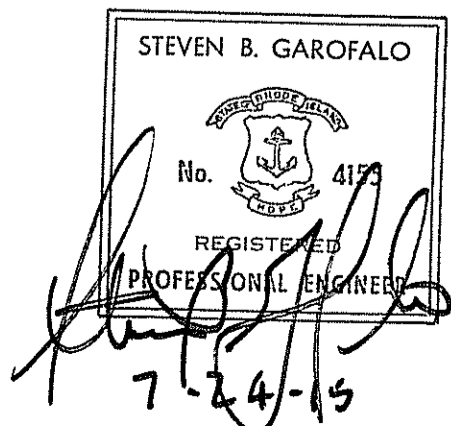

LAYOUT PLAN 1" = 300'

SCALES OF DRAWINGS

Plans	1 inch = 20 feet
Profiles	1 inch = 20 feet Horizontal
Profiles	1 inch = 4 feet Vertical
Cross Sections	1 inch = 4 feet Horizontal
Cross Sections	1 inch = 4 feet Vertical

BASE OF LEVELS
NGVD 29

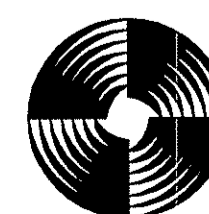

GAROFALO
GAROFALO & ASSOCIATES, INC.
85 CORLISS STREET \ P.O. BOX 6145
PROVIDENCE, RHODE ISLAND 02940

Contract Number 20xx-xx-xxx
Number of Sheet 1
Total Sheets 115

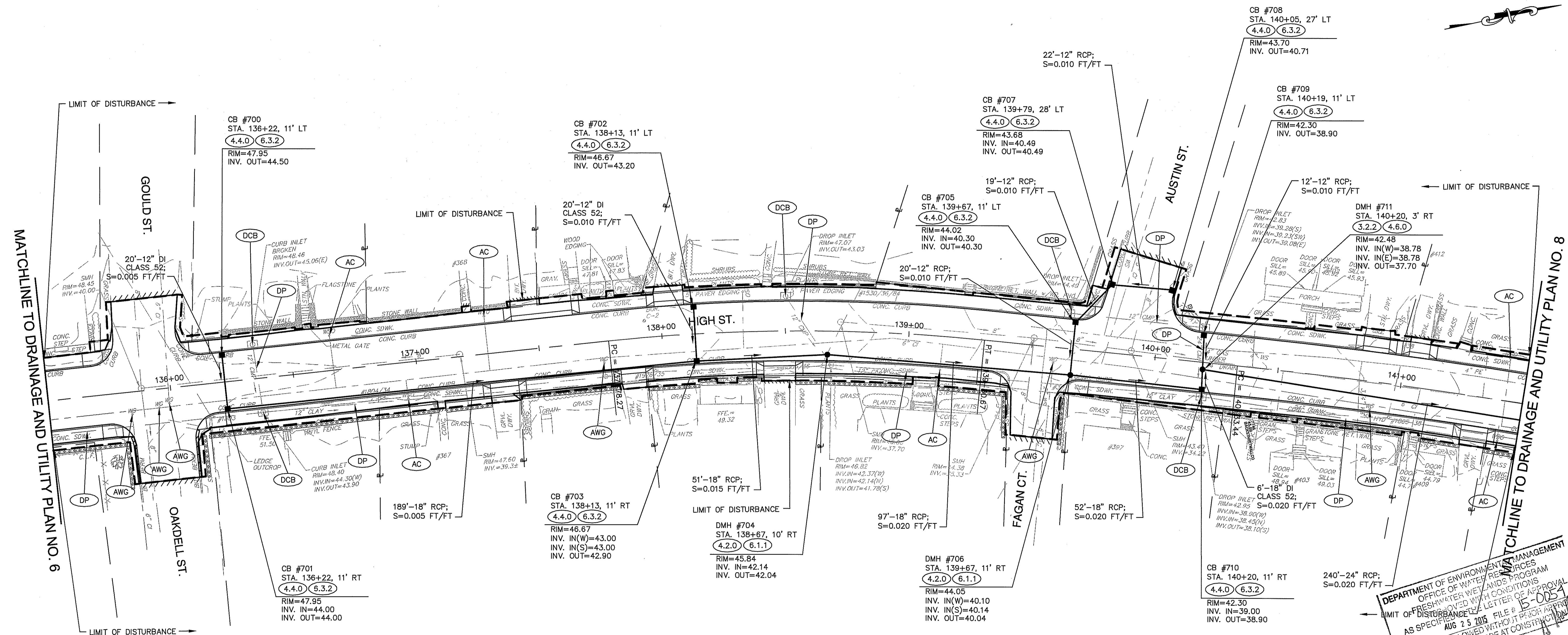

DEPARTMENT OF ENVIRONMENTAL MANAGEMENT
 OFFICE OF WATER RESOURCES
 OFFICE OF FRESHWATER WETLANDS PROGRAM
 LIMIT OF DISTURBANCE LETTER OF APPROVAL
 AS SPECIFIED IN FILE # B-0054
 AUG 25 2015
 NO CHANGES ALLOWED WITHOUT PRIOR APPROVAL
 APPROVED PLANS MUST BE AT CONSTRUCTION SITE
 AUG 12 2015

REVISIONS		
NO.	DATE	BY

RHODE ISLAND
 DEPARTMENT OF TRANSPORTATION
 SOUTH KINGSTOWN, RHODE ISLAND

**IMPROVEMENTS TO
 HIGH STREET
 DRAINAGE AND UTILITY
 PLAN NO. 7**

GAROFALO
 GAROFALO & ASSOCIATES, INC.
 85 CORLISS STREET \ P.O. BOX 6145
 PROVIDENCE, RHODE ISLAND 02940

CHECKED BY: P.M.F. DATE: 09/11/12 SCALE: 1"=20'

