

DEPARTMENT OF ENVIRONMENTAL MANAGEMENT
 OFFICE OF WATER RESOURCES
 FRESHWATER WETLANDS PROGRAM
 APPROVED WITH CONDITIONS
 AS SPECIFIED IN THE LETTER OF APPROVAL
 DATED JUN 23 2015 FILE # 15-0100
 NO CHANGES ALLOWED WITHOUT PRIOR APPROVAL
 APPROVED PLANS MUST BE AT CONSTRUCTION SITE

Imogene A. Cabral

ZONING R-20

MINIMUMS:	
AREA	20,000 S.F.
FRONTAGE	125 FT.
SETBACKS:	
FRONT	30 FT.
SIDE	15 FT.
REAR	30 FT.

2/6/2015 11:54 AM



REFERENCE:
 1) SEE PLAN ENTITLED: "LAKE VIEW TERRACE, GREENVILLE, R.I.",
 DATED JANUARY, 1913, PREPARED BY WALTER J. GRADY, ENGR.,
 AND FILED IN THE TOWN OF SMITHFIELD, RI ON PLAT CARD NO. 42.

CERTIFICATION:
 THIS SURVEY AND PLAN CONFORM TO THE FOLLOWING
 CLASS STANDARDS AS ADOPTED BY THE RHODE ISLAND
 BOARD OF REGISTRATION FOR PROFESSIONAL LAND
 SURVEYORS.
 BOUNDARY SURVEY CLASS I
 PLANIMETRICS CLASS III
 BY: _____ DATE _____
 REGISTERED PROFESSIONAL LAND SURVEYOR

Environmental Mapping & Surveying	INTERNATIONAL MAPPING & SURVEYING C		
	LAND SURVEYING	CIVIL ENGINEERING	PHOTOGRAMMETRIC I
19 INDUSTRIAL DRIVE, SMITHFIELD, R.I. 02917 (401) 231-1111			
SURVEY PLAN OF LAND for COREY K. MARTINEAU at 20 LAKEVIEW DRIVE in SMITHFIELD, RI A.P. 2 LOT 24A			
MAY 26 2015			
Office of Water Resources			

1 of 3

N/F DONALD R. HANSON

SM11
SS
SS

SLACKS RESERVOIR

existing property

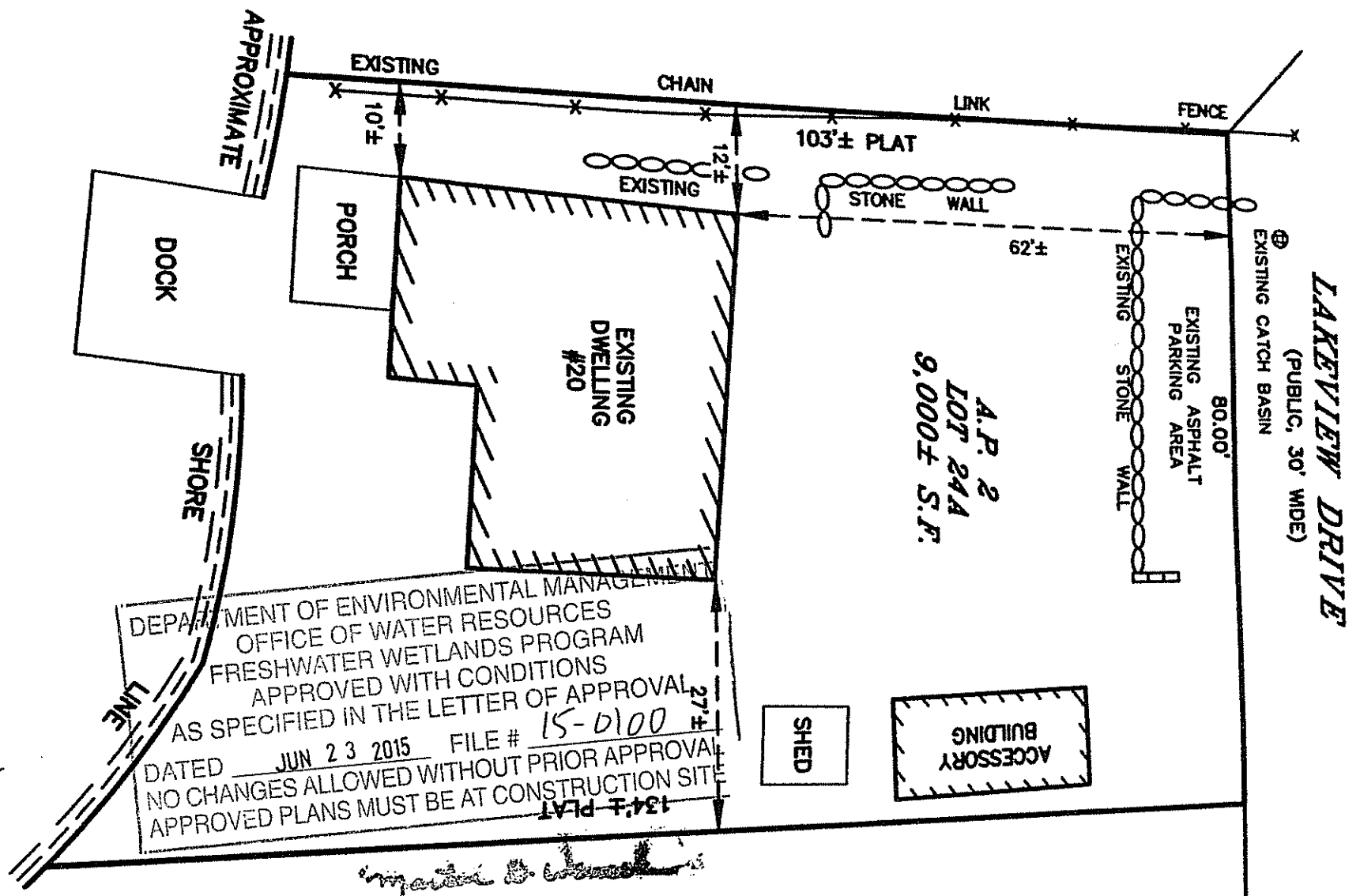

DEPARTMENT OF ENVIRONMENTAL MANAGEMENT
 OFFICE OF WATER RESOURCES
 FRESHWATER WETLANDS PROGRAM
 APPROVED WITH CONDITIONS
 AS SPECIFIED IN THE LETTER OF APPROVAL
 DATED JUN 23 2015 FILE # 15-0100
 NO CHANGES ALLOWED WITHOUT PRIOR APPROVAL
 APPROVED PLANS MUST BE AT CONSTRUCTION SITE

134'± PLAT

27'±

imposed by contract

A.P. 2 LOT 153
 N/F CAROLE L. GIROUX

Environmental Management
 MAY 26 2015
 Office of Water Resources

2073

