

SYMBOL LEGEND

- PROPERTY LINE
- EASEMENT LINE
- EDGE OF STREAM
- APPROX. TREE LINE
- STONE WALLS
- STAKED HAY BALES & LIMIT OF DISTURBANCE, per RIDEM. 100 FT. RIVERBANK WETLAND
- 100 YR. FLOOD PLAIN

GENERAL NOTES

1. THE PLAN HAS BEEN PREPARED WITH INFORMATION FROM A CLASS B SURVEY BY SCITUATE SURVEYS, INC., 3-28-90, RECORDED IN THE SCITUATE LAND EVIDENCE RECORDS - ENV. 131-MAP NO. 423; G.I.S. MAPPING; FIELD MEASUREMENTS; PLATOMETRY
2. PROVIDE BALED HAY EROSION CONTROL ALONG BOTH SIDES OF CULVERT PATH - FOR TASK NO. 2.
3. ALL ACTIVITIES TO BE IN COMPLIANCE W/ R.I. DEW WETLAND REGULATIONS RULE 6. EXCEPT ACTIVITIES, WHERE APPLICABLE.



LOCATION MAP - 1" = 400'

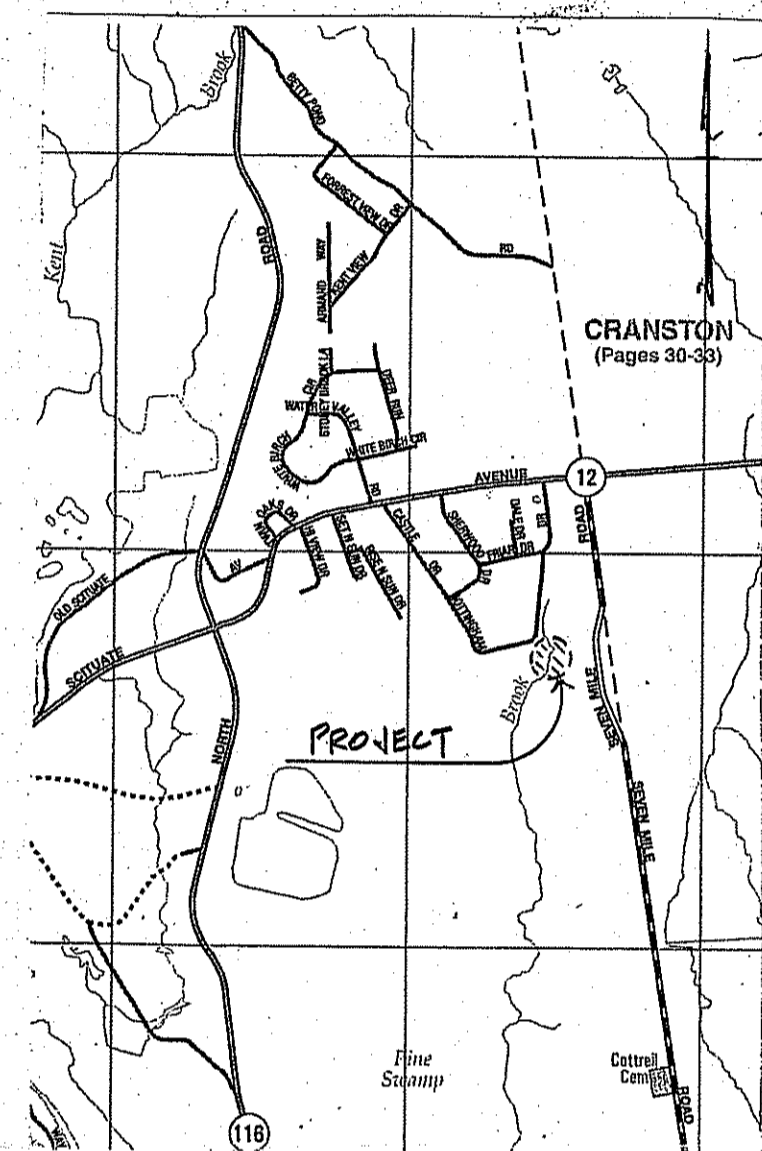

LOCUS MAP - 1" = 1/2 MI.

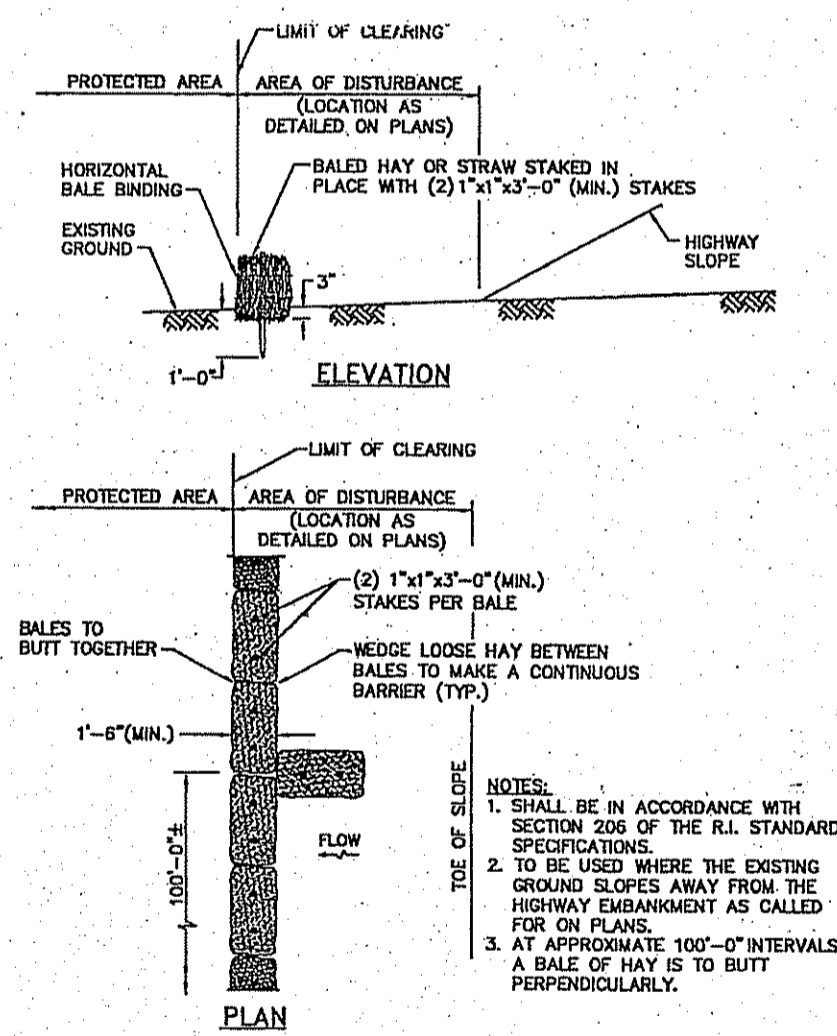

BALED HAY EROSION CHECK
N.T.S.

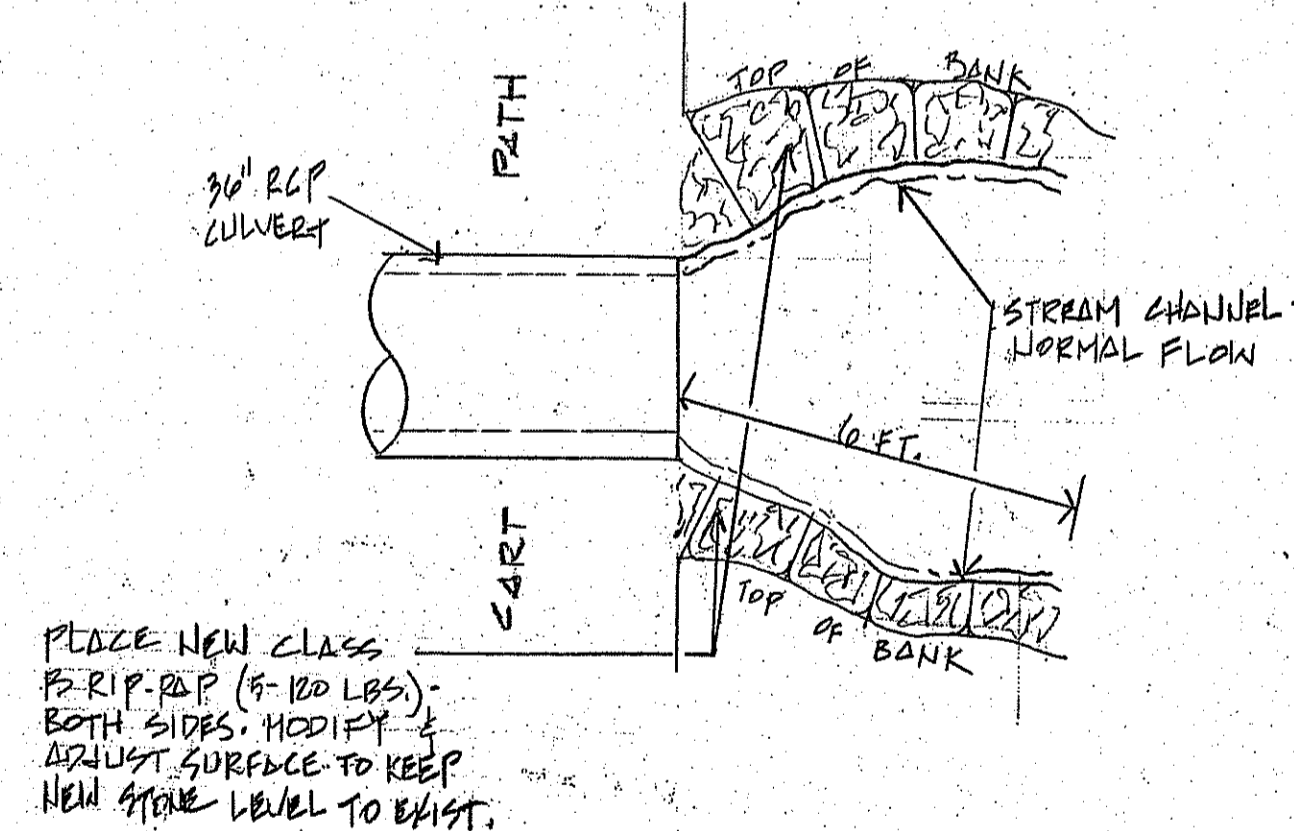

RIP-RAP DETAIL
NOT TO SCALE

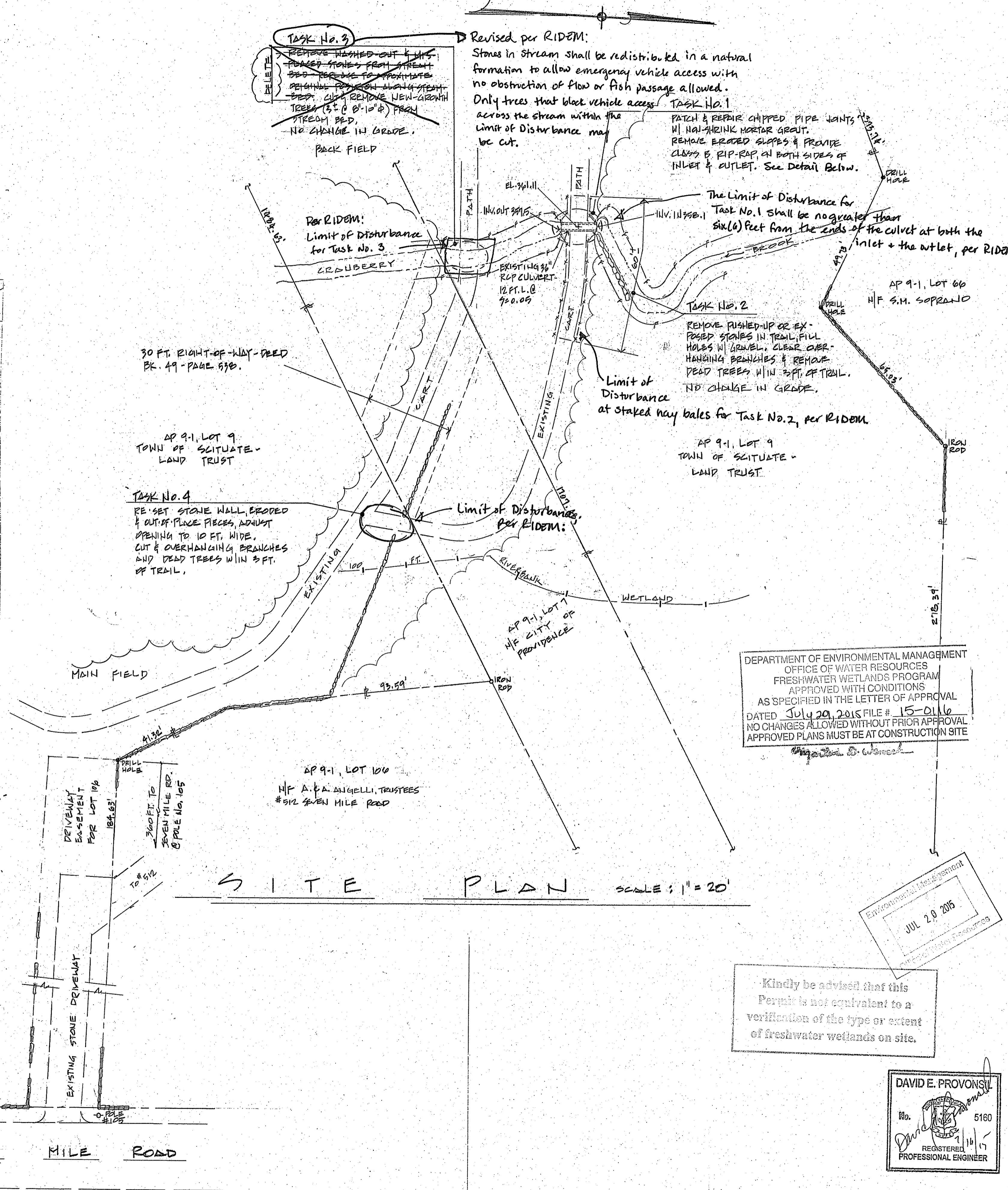

DEPARTMENT OF ENVIRONMENTAL MANAGEMENT
OFFICE OF WATER RESOURCES
FRESHWATER WETLANDS PROGRAM
APPROVED WITH CONDITIONS
AS SPECIFIED IN THE LETTER OF APPROVAL
DATED July 20, 2015 FILE # 15-0116
NO CHANGES ALLOWED WITHOUT PRIOR APPROVAL
APPROVED PLANS MUST BE AT CONSTRUCTION SITE

Environmental Management
JUL 20 2015
Professional Engineering

Kindly be advised that this Permit is not equivalent to a verification of the type or extent of freshwater wetlands on site.

DAVID E. PROVONSIL
No. 5160
REGISTERED PROFESSIONAL ENGINEER

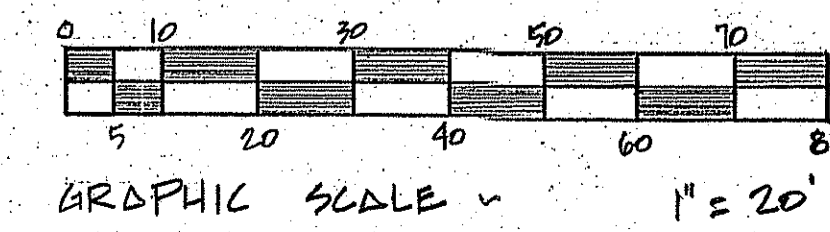

RECEIVED
JUL 20 2015
Department of Environmental Management
Office of Water Resources - Wetlands Program

NO.	REVISIONS	DATE
1	TASK 3: RIP-RAP DETAIL	7-16-15

LAWTON FARM
NORTH STREAM CROSSINGS
REPAIRS & MAINTENANCE
BALE #105 SEVEN MILE ROAD
AP 9-1, LOT 9 SCITUATE, RI

DATE: MAY 2015
DRAWN BY: D.E. PROVONSIL
SCALE: AS NOTED
DWG. No. C-1
1 of 1

OWNER: TOWN OF SCITUATE LAND TRUST
CHAR THOMAS ANGELL (647-2882)
TOWN HALL - 195 DANIELSON PIKE
NORTH SCITUATE, RI 02851
ENGINEER: DAVID E. PROVONSIL, PE, TOWN ENGINEER
TOWN HALL - 195 DANIELSON PIKE (647-2882)
NORTH SCITUATE, RI 02851 (PROVONSIL@SCITUATE.RI.GOV)