

Legend
NOT ALL ITEMS SHOWN WILL APPEAR ON THE SURVEY

BUILDING	▲/△	NAIL FOUND/SET
ASPHALT	○/◎	DRILL HOLE FOUND/SET
AP	□/⊠	IRON ROD/PIPE FOUND/SET
N/F	⊙/⊚	BOUND FOUND/SET
(D)	⊛	SIGN
(M)	⊜	BOLLARD
(C)	⊝	SOIL EVALUATION
(CA)	⊞	CATCH BASIN
HC	⊠	DOUBLE CATCH BASIN
ASSESSOR'S PLAT	⊡	DRAINAGE MANHOLE
NOW OR FORMERLY	⊢	FLARED END SECTION
DEED	⊣	GUY POLE
MEASURED	⊤	EMH
CALCULATED	⊥	ELECTRIC MANHOLE/HANDHOLE
CHORD ANGLE	⊦	UTILITY/POWER POLE
HANDICAPPED	⊧	LIGHTPOST
PROPERTY LINE	⊨	SEWER/SEPTIC MANHOLE
ASSESSOR'S LINE	⊩	SEWER VALVE
TREELINE	⊪	CLEANOUT
GUARDRAIL	⊫	HYDRANT
FENCE	⊬	IRRIGATION VALVE
RETAINING WALL	⊭	WATER VALVE
STONE WALL	⊮	WELL
MINOR CONTOUR LINE	⊯	MONITORING WELL
MAJOR CONTOUR LINE	⊰	UNKNOWN MANHOLE
W	⊱	GAS VALVE
S	⊲	WETLAND FLAG
SW	⊳	BENCH MARK
G	⊴	BUSH
SF	⊵	TREE
E	⊶	
CHW	⊷	
D	⊸	
▲ A5	⊹	
50' PERIMETER WETLAND	⊺	

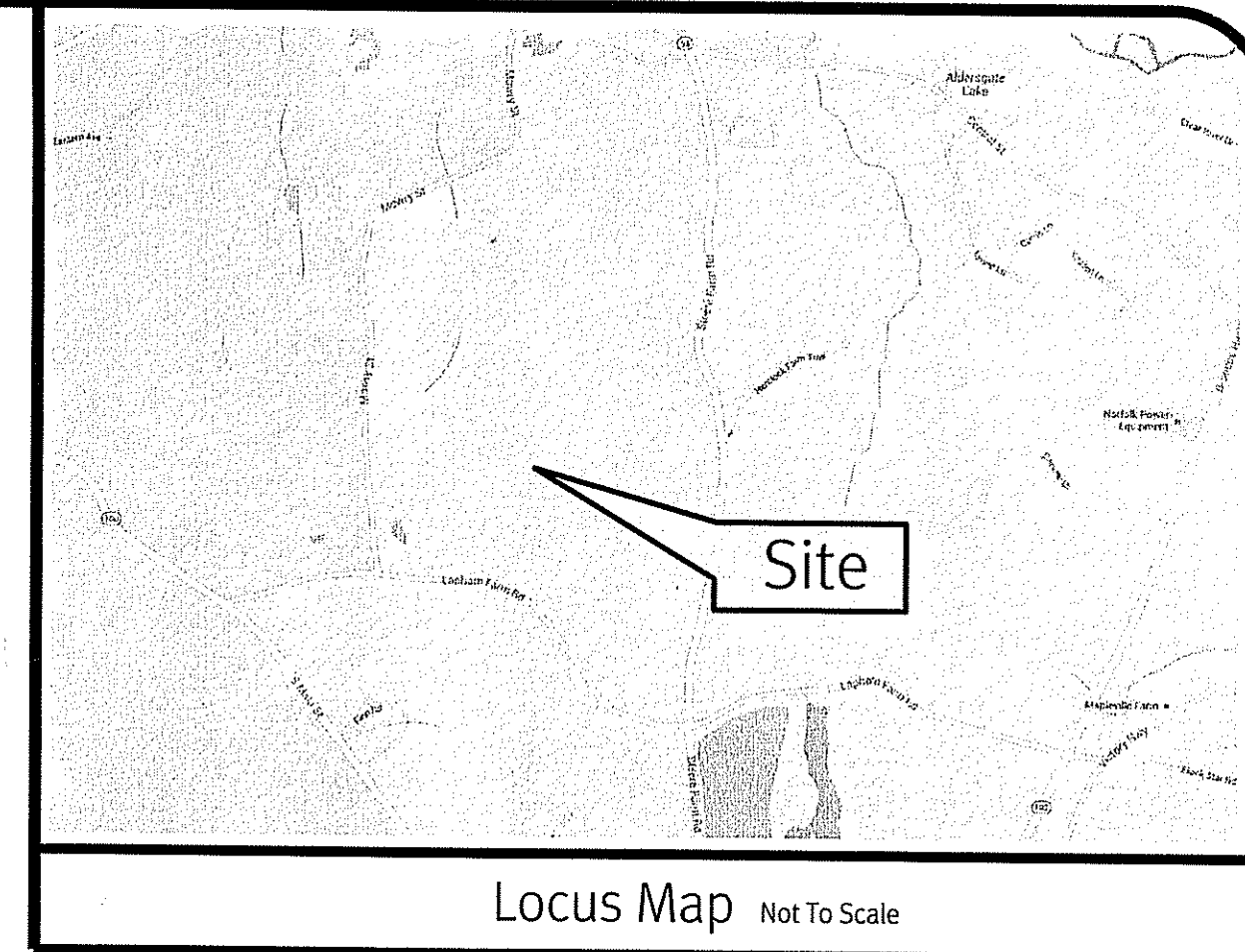

- General Notes**
- THE PARCEL IS FOUND ON ASSESSOR'S PLAT 211, LOT 2 IN THE TOWN OF BURRILLVILLE, PROVIDENCE COUNTY, RHODE ISLAND.
 - THE OWNERS PER DEED BOOK 230, PAGE 630 ARE JAMES H. & JUDITH A. FARRELL AND JOSEPH M. & MURIEL J. FARRELL.
 - THE PARCEL IS LOCATED IN ZONE X PER FEDERAL EMERGENCY MANAGEMENT AGENCY FLOOD INSURANCE RATE MAP 44007C0135G, DATED MARCH 2, 2009.
 - THE PARCEL IS ZONED R-40 PER THE ASSESSOR'S ONLINE DATABASE. PLEASE CONTACT THE ZONING DEPARTMENT FOR ANY ADDITIONAL INFORMATION OR FOR A CERTIFICATE OF ZONING.
 - THERE WERE NO CEMETERIES, GRAVE SITES AND OR BURIAL GROUNDS OBSERVED WITHIN THE LIMITS OF THE SURVEY.
 - FIELD SURVEY PERFORMED BY DIPRETE ENGINEERING ON JULY 22 & 23, 2015. THIS PLAN REFLECTS ON THE GROUND CONDITIONS AS OF THAT DATE.
 - ALL UNDERGROUND UTILITIES SHOWN ON THIS PLAN HAVE BEEN LOCATED FROM FIELD SURVEY OBSERVATIONS ONLY TOGETHER WITH EXISTING PLANS BY OTHERS. DIPRETE ENGINEERING IS NOT RESPONSIBLE FOR MISSING UNDERGROUND UTILITIES, EITHER IN SERVICE OR ABANDONED, NOT OBSERVED AT THE TIME OF THE SURVEY. (PLEASE CONTACT DIGSAFE 72 WORKING HOURS PRIOR TO ANY CONSTRUCTION AT 1-888-344-7233).
 - THIS SURVEY WAS PREPARED WITHOUT THE BENEFIT OF A TITLE REPORT. DIPRETE ENGINEERING IS NOT RESPONSIBLE FOR ANY UNKNOWN OR UNRECORDED EASEMENTS, DEEDS OR CLAIMS THAT A TITLE REPORT WOULD DISCLOSE.
 - PARCEL IS SUBJECT TO A 50' WIDE RIGHT OF WAY EXTENDING FROM LAPHAM FARM ROAD NORTHWESTERLY TO MOWRY STREET. IN ADDITION, PARCEL BENEFITS FROM RIGHTS TO USE WATER IN SHALLOW POND AND FROM A CERTAIN WELL. THESE EASEMENTS AND RIGHTS ARE RECORDED IN DEED BOOK 230, PAGE 630 AND SHOWN ON PLAN REFERENCE #1.
- Plan References:**
- "MAP OF LAND IN BURRILLVILLE, R.I. AT MOWRY STREET AND LAPHAM FARM ROAD OWNED BY GEORGE F. BLIGH SURVEYED FOR PAUL AND ROBIN BOISVERT BY ALFRED E. HANSEN ASSOCIATES, INC. SURVEYORS AND MAPPERS APRIL 23, 1981 SCALE 1"=100" RECORDED IN LAND EVIDENCE RECORDS TOWN OF BURRILLVILLE IN PLAT BOOK 13 AT PAGE 10.
 - "PLAN OF LAND OWNED BY THOMAS V. & MICHELLE M. BLISS BURRILLVILLE, RHODE ISLAND JUNE, 1989". RECORDED IN LAND EVIDENCE RECORDS TOWN OF BURRILLVILLE IN PLAT BOOK 20 AT PAGE 25 & 26.
 - "BURRILLVILLE, R.I. DIVISION OF LAND FOR DANA S. & GAY S. EVANS" RECORDED IN LAND EVIDENCE RECORDS TOWN OF BURRILLVILLE IN PLAT BOOK 21 AT PAGE 26.
- Datum Note:**
- ELEVATIONS SHOWN HEREON, ARE BASED ON ASSUMED SYSTEM.

***Zoning Note**
General note 4 is based on information from the Town of Burrillville's assessor's database and their zoning ordinance only. Any special permits or variances specific to this site are not taken into consideration. Please contact the Town of Burrillville's Zoning Department for any additional information or for a certificate of zoning.

This Plan Should Be Indexed By The Following Streets:

- Lapham Road

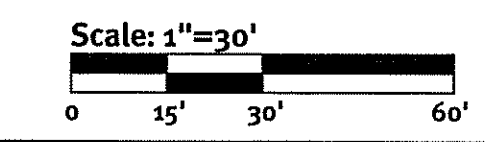

z:\dmain\project\0312-001 Lapham Farm Road\autocad drawings\0312-001-exco.dwg Plotset: 8/31/2015

DiPrete Engineering
Two Stafford Court, Cranston, RI 02920
tel: 401-943-1000 fax: 401-464-6066 www.diprete-eng.com

Boston • Providence • Newport

KEVIN C. MORIN
REGISTERED PROFESSIONAL ENGINEER
CIVIL

CERTIFICATION:
THIS SURVEY AND PLAN CONFORMS TO THE FOLLOWING CLASS STANDARDS AS ADOPTED BY THE RHODE ISLAND BOARD OF REGISTRATION FOR PROFESSIONAL LAND SURVEYORS EFFECTIVE APRIL 1, 1994.
BOUNDARY SURVEY: CLASS III
TOPOGRAPHIC SURVEY: CLASS III

No.	Date	Description	JAR	DP
1	8/31/2015	Wetland Edge Verification Plan		

Drawn By: E.L.T.

Wetland Edge Verification Plan
Lapham Farm Road
Burrillville, Rhode Island

Owner: **James, Judith, Joseph, and Muriel Farrell**
c/o **KLMB Properties**
P.O. Box 805, Chepachet, Rhode Island 02864

DE Job No: 8312-001 Copyright 2015 by DiPrete Engineering Associates, Inc.

SHEET 1 OF 1