

**EROSION CONTROL & SOIL STABILIZATION:**  
 1. DISTURBED SLOPES SHALL NOT BE UNATTENDED OR EXPOSED FOR GREATER THAN 7 DAYS OF TIME, SUCH AS THE INACTIVE WINTER SEASON.  
 2. DURING EACH CONSTRUCTION YEAR ALL DISTURBED SLOPES, EITHER NEWLY CREATED OR EXPOSED PRIOR TO OCTOBER 15, SHALL BE HYDRO-SEEDING OR PROTECTED BY THAT DATE.  
 3. TEMPORARY TREATMENTS SHALL CONSIST OF A HAY, STRAW OR FIBER MULCH OR PROTECTIVE COVERS SUCH AS A MAT OR FIBER LINING (BURLAP, JUTE, FIBERGLASS NETTING, EXCELOR BLANKETS). THEY SHALL BE INCORPORATED INTO THE WORK AS WARRANTED OR AS ORDERED BY THE ENGINEER.  
 4. HAY OR STRAW APPLICATIONS SHOULD BE IN THE AMOUNT OF 3,000 - 4,000 lbs/ac.  
 5. THE CONTRACTOR MUST REPAIR AND/OR RE-SEED ANY AREAS THAT DO NOT DEVELOP WITHIN THE PERIOD OF ONE YEAR AND HE SHALL DO SO AT NO ADDITIONAL EXPENSE.  
 6. ALL FILL SHALL BE THOROUGHLY COMPACTED UPON PLACEMENT IN STRICT CONFORMANCE WITH THE RIDOT STANDARD SPECIFICATIONS SECTION 202.  
 7. ON BOTH STEEP AND LONG SLOPES CONSIDERATION SHALL BE GIVEN TO "CRIMPING" OR "TRACKING" TO TACK DOWN MULCH APPLICATIONS.  
 8. REFERENCE THE SEDIMENTATION CONTROL PROGRAM AND ORDER OF PROCEDURE FOR PROPER COORDINATION.  
 9. THE OWNER AGREES TO ALLOW THE BUILDING INSPECTOR TO INITIATE ANY ADDITIONAL EROSION OR SEDIMENT CONTROL MEASURES NECESSARY TO MINIMIZE SILTATION OR SEDIMENTATION.  
 10. EXTREME CARE SHALL BE EXERCISED SO AS TO PREVENT ANY UNSUITABLE MATERIAL EXITING THE PROJECT SITE.  
 11. DURING CONSTRUCTION THE CONTRACTOR AND/OR DEVELOPER SHALL BE RESPONSIBLE FOR MAINTAINING DRAINAGE AND RUNOFF FLOW DURING STORMS AND PERIODS OF RAINFALL.  
 12. SEDIMENTATION CONTROL DEVICES SHALL BE INSPECTED CLOSELY AND MAINTAINED PROMPTLY AFTER EACH RAINFALL.  
 13. ADDITIONAL HAY BALES OR SANDBAGS SHALL BE LOCATED AS CONDITIONS WARRANT OR AS DIRECTED BY THE ENGINEER.  
 14. ALL SEDIMENTS SHALL BE REMOVED FROM THE DRAINAGE AND DETENTION FACILITIES WHEN DIRECTED BY THE ENGINEER.  
 15. REFERENCE THE "R.I. SOIL EROSION AND SEDIMENT CONTROL HANDBOOK" PREPARED BY THE U.S. DEPT. OF AGRICULTURE, SOIL CONSERVATION SERVICE, 1989 REV. 2014, AS A GUIDE.  
 16. IMMEDIATELY UPON COMPLETION OF THE CLEARING AND GRUBBING OPERATION AND PRIOR TO ANY ROUGH GRADING, CONTINUOUS COMPOST FILTER SOCKS SHALL BE PLACED OUTSIDE THE LIMITS OF CONSTRUCTION AS PER THE PLANS.  
 17. ALL EROSION AND SEDIMENTATION CONTROL STRUCTURES SHALL BE PERIODICALLY MAINTAINED AS PER THE RESPECTIVE PROGRAMS FOR TEMPORARY CONTROL.  
 18. STRIP AND STOCK PILES AS SHOWN ON THE PLAN.  
 19. DUST CONTROL:  
 A. EXPOSED SOIL SURFACES SHOULD BE MOISTENED PERIODICALLY WITH ADEQUATE WATER TO CONTROL DUST.  
 B. CALCIUM CHLORIDE SHALL ONLY BE USED AFTER SEEKING APPROVAL FROM THE PUBLIC WORKS DEPT.  
 20. TRUCK TIRE CLEANING:  
 CONTRACTOR MUST CLEAN ALL STICKY SOIL FROM TRUCK TIRES BEFORE ALLOWING TRUCKS TO EXIT THE SITE.  
 21. IF WORK PROGRESS IS TO BE INTERRUPTED AT ANY TIME, REFERENCE THE EROSION AND SEDIMENTATION PROGRAMS FOR TEMPORARY CONTROL.

**GENERAL NOTES:**  
 1. IT SHALL BE THE CONTRACTOR'S SOLE RESPONSIBILITY TO OBTAIN ANY AND ALL PERMITS REQUIRED BY THE MUNICIPALITY PRIOR TO COMMENCING ANY WORK.  
 2. IT SHALL ALSO BE THE CONTRACTOR'S SOLE RESPONSIBILITY TO MAINTAIN THE INTEGRITY OF ALL EXISTING UTILITIES, STRUCTURES, AND ADJUTING PROPERTIES. THE COST OF ANY REPAIR OR REPLACEMENT OF DAMAGED ITEMS SHALL BE BORNE BY THE CONTRACTOR.  
 3. ALL WORK PERFORMED HEREIN SHALL BE CONFORMANT WITH THE "RIDOT STANDARD SPECIFICATIONS FOR ROAD AND BRIDGE CONSTRUCTION AMENDED 2010" WITH ALL COMPLETION OF APPROVED SPECIFICATIONS AND THE OCTOBER 12, 2012 STANDARD DETAILS.  
 4. THE CONTRACTOR SHALL BE SOLELY RESPONSIBLE FOR QUANTITY TAKE-OFF IN COMPUTING ANY ESTIMATES.  
 5. THE CONTRACTOR IS RESPONSIBLE FOR ALL CONSTRUCTION INDICATED ON THESE PLANS, THAT INCLUDES ANY UTILITY REPAIR REQUIRED.  
 6. THE CONTRACTOR SHALL BE RESPONSIBLE FOR ESTABLISHING AND MAINTAINING ALL TEMPORARY SEDIMENTATION AND EROSION CONTROLS.  
 7. THE LOCATION OF EXISTING UTILITIES AS SHOWN ARE APPROXIMATE AND SHALL BE VERIFIED BY THE CONTRACTOR. "DIG SAFE" SHALL BE CONTACTED BY THE CONTRACTOR AS PART OF THIS VERIFICATION.  
 8. IN ALL EXCAVATION AND PLACEMENT OF FILL, THE CONTRACTOR SHALL PERFORM THE WORK IN FULL COMPLIANCE WITH THE R.I. STANDARD SPECIFICATION SECTION 202.  
 9. ALL EXCESS SOIL, STUMPS, TREES, ROCKS, BouldERS, AND OTHER REFUSE SHALL BE DISCARDED OFF SITE, OUTSIDE OF PROJECT AREA.  
 10. DATUM IS NAVD83 / COORDINATE SYSTEM IS RI STATE PLANE (RI 3800)  
 11. CARE SHALL BE UNDERTAKEN IN FINAL GRADING, GRADES SHALL SLOPE AWAY FROM STRUCTURE FOR A MINIMUM OF 10' - AT 1% SLOPE - AWAY FROM FOUNDATION.

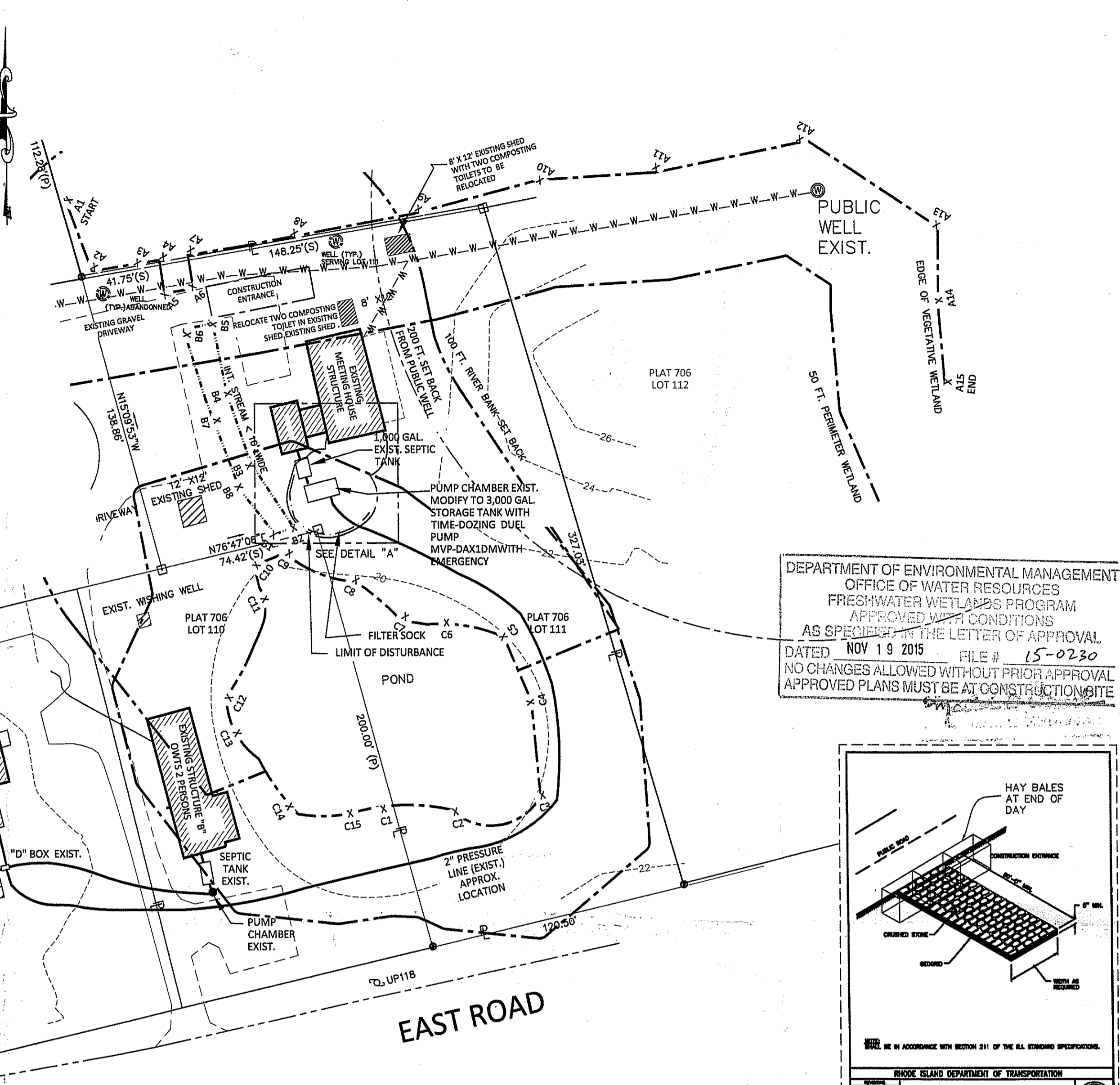

DEPARTMENT OF ENVIRONMENTAL MANAGEMENT  
 OFFICE OF WATER RESOURCES  
 FRESHWATER WETLANDS PROGRAM  
 APPROVED WITH 2025 PROGRAM  
 AS SPECIFIED IN THE LETTER OF APPROVAL  
 DATED NOV 19 2015 FILE # 15-0230  
 NO CHANGES ALLOWED WITHOUT PRIOR APPROVAL  
 APPROVED PLANS MUST BE AT CONSTRUCTION SITE

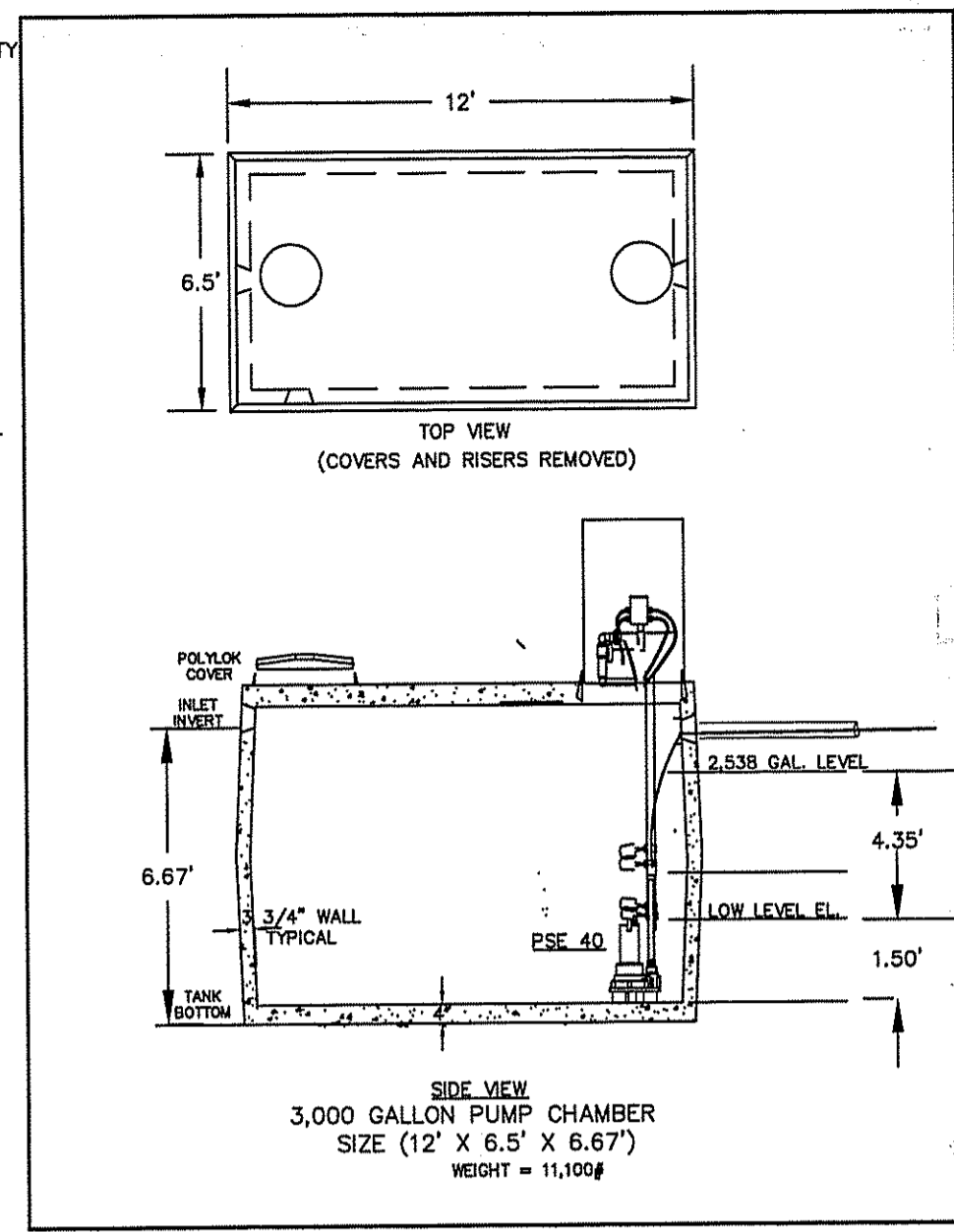
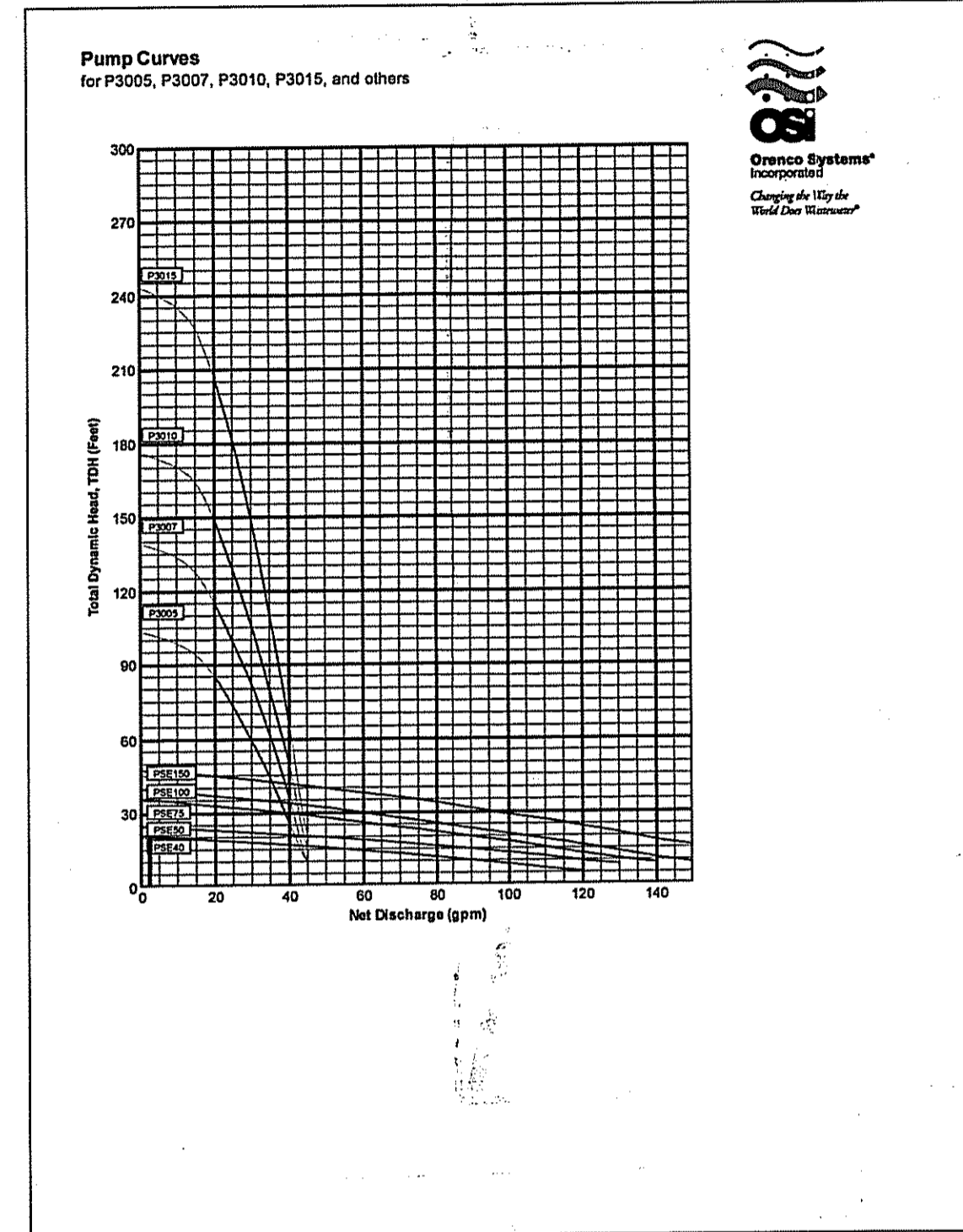
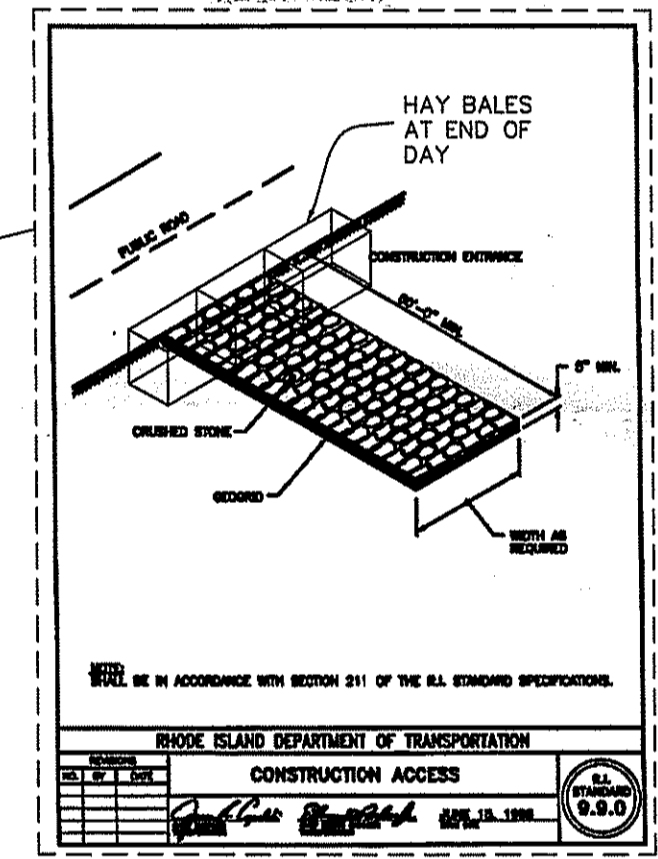

**SEQUENCE OF CONSTRUCTION:**  
 1. INSTALL CONTINUOUS COMPOST FILTER SOCK AS SHOWN ON THE PLAN  
 2. STRIP AND STOCK PILE OR REMOVE LOAM FROM PROPERTY.  
 3. INSTALL CONSTRUCTION ENTRANCE AND SEDIMENT CONTROL.  
 4. INSTALL OWTS PER APPROVED PLAN  
 5. GRADE, LOAM AND SEED ALL DISTURBED AREAS.

**MVP-DAX1DMs DUPLEX CONTROL PANEL FOR TIME DOSE**

MVP-DAX1DMs Duplex Control Panels MVP Series duplex panels are digital, programmable panels used to control two alternating pumps and provide alarm functions in onsite septic systems, drainfields, Effluent Sewers (aka STEP sewers or Septic Tank Effluent Pumping Systems), and pressure sewers that require the use of two alternating pumps. Built-in alternating logic switches the "lead" and "lag" positions each pump cycle, and allows one pump to be manually selected and locked in for lead operation. MVP duplex panels offer several functions as standard, including elapsed time meters, counters, digital indication of float switch status, different alarm/light signals for varying alarm conditions, and the ability to use one type of float switch for all functions.  
 120-VAC controls circuit breaker  
 120- or 120/240-VAC pump circuit breakers  
 Motor-start controllers for pump circuits  
 Automatic/Off/Manual (Auto/Off/Man) toggle switch  
 7/8-in (22-mm) red visible alarm  
 95 dB audible alarm  
 Automatic alarm silence reset  
 Built-in elapsed time meter  
 Built-in event counter  
 Type 4X (IP 66) rated enclosure

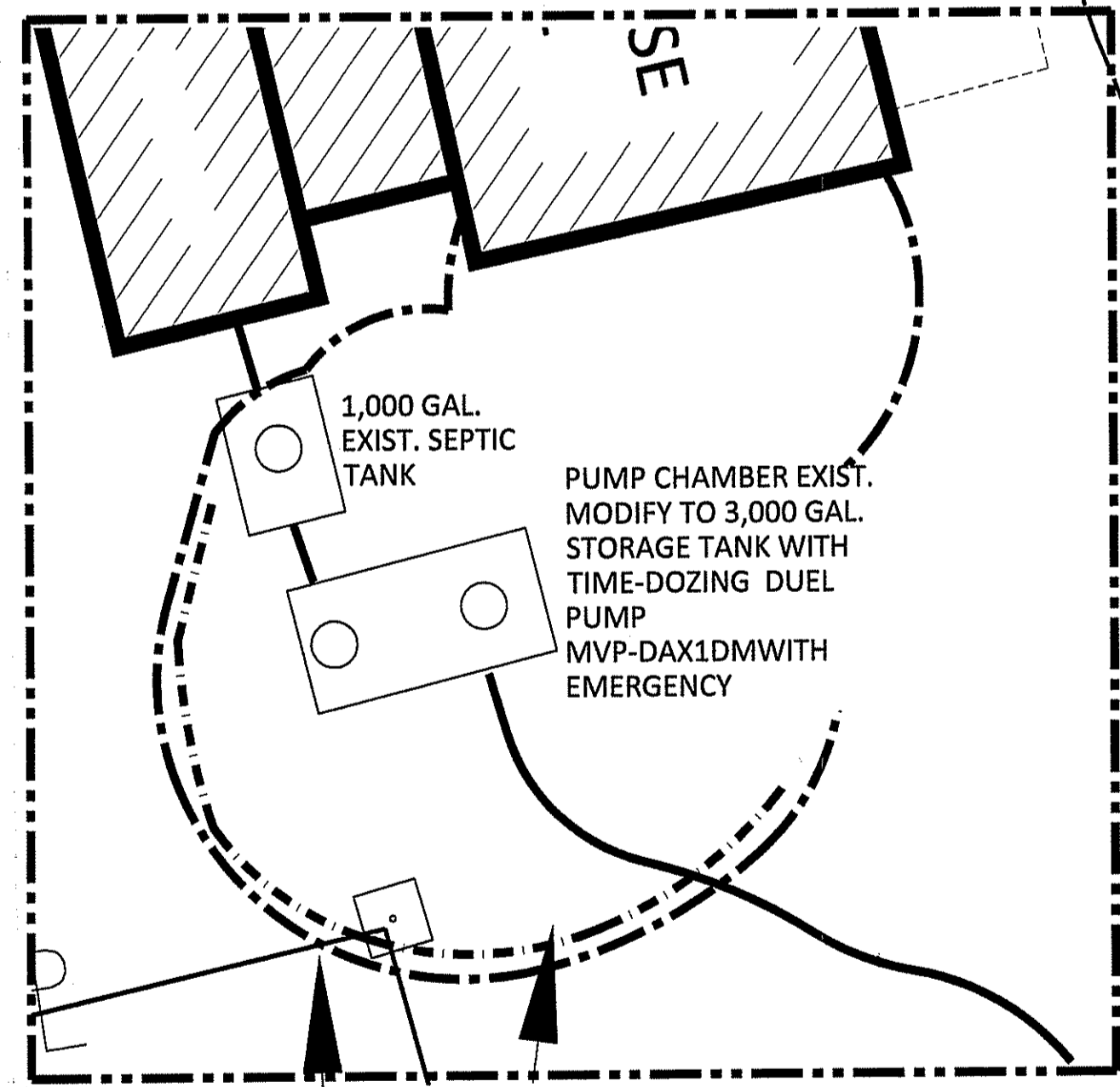

**DESIGN**  
 APPROVED APPLICATION 9533-254  
 27 PERSONS @ 15 GAL/DAY = 405 GAL/DAY  
 MEETING HOUSE 20 PERSONS+ STRUCTURE A 5 PERSONS + STRUCTURE B 2 PERSONS = STRUCTURE A 5 PERSONS = 27 PERSONS  
 ADDED TWO COMPOSTING TOILETS EXCEL FROM SUNMAR 5 PERSONS = 10 PERSONS  
 MEETING HOUSE DAILY FLOW 20 + 10 = 30 PERSONS FLOW 300 GAL. PER DAY  
 DAILY PUMP OUT 300/7 = 42.85 GAL. FROM 6:00 P.M. TO 6:00 A.M.  
 ONE WEEK USE 20 X 7 = 140 PERSONS  
 PROPOSED USE 150 PERSONS < CALCULATED USE 20X7 L.F.+ 10 COMPOSTING = 150 PERSON AVAILABLE CAPACITY  
 4 DOSES PER HOUR, TOTAL 48 DOSES PER DAY  
 42.85/48 = 0.90 GAL. PER DAY.

**LEGEND:**

- - - - - PROPERTY LINE
- - - - - EDGE OF PAVEMENT
- - - - - STONE WALL
- EXISTING WELL (TYP.)
- UTILITY POLE
- GRANITE BOUND PROPOSED
- WETLAND FLAG
- - - - - EDGE OF VEGETATIVE WETLAND
- - - - - 50 FT. PERMEABLE WETLAND
- - - - - INTERMITTENT STREAM < 10' WIDE
- - - - - 100 FT. RIVERBANK WETLAND
- - - - - EXISTING WATER LINE
- - - - - EXISTING GRADE

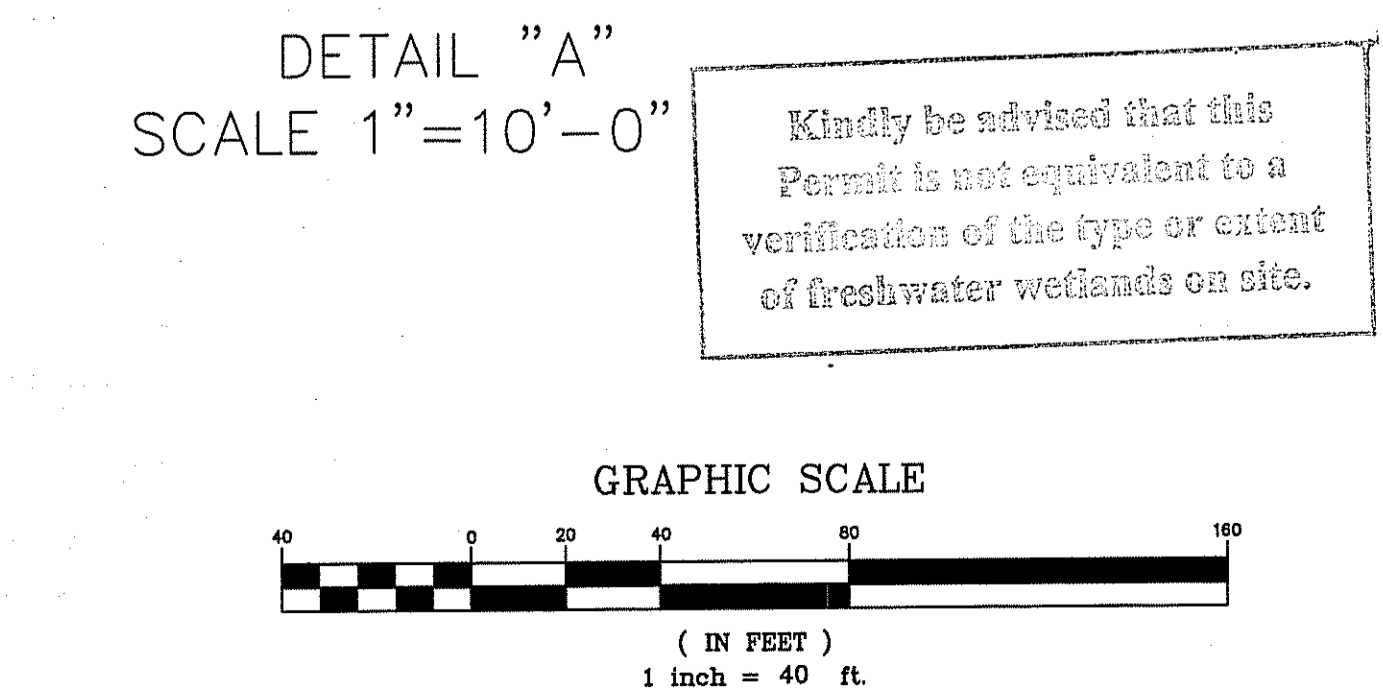
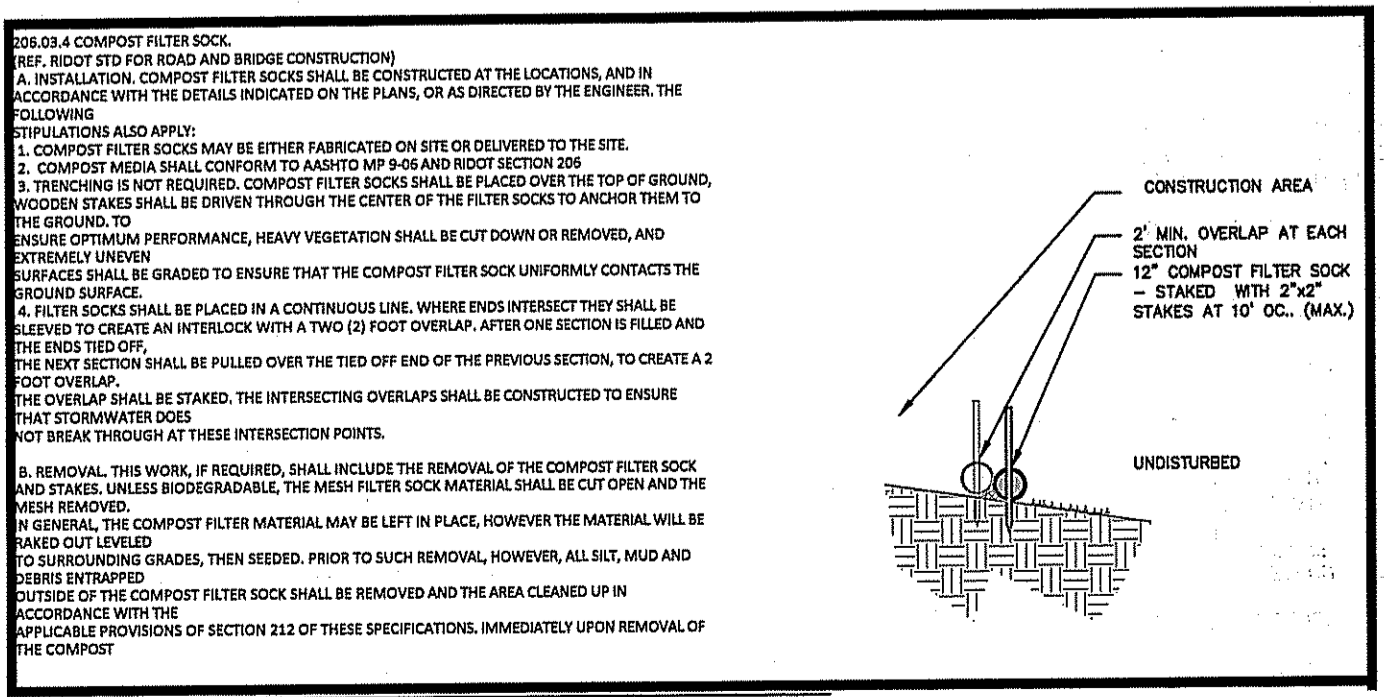

APPROVED APPLICATION 9533-254

NO.	DATE	DESCRIPTION
1	10/23/2015	APPROVED
2	11/19/2015	NO CHANGES ALLOWED WITHOUT PRIOR APPROVAL

DEPARTMENT OF ENVIRONMENTAL MANAGEMENT

**SUN-MAR**

PRODUCTS

- SELF-CONTAINED
- CENTRAL FLUSH
- ACCESSORIES
- QUESTION PROCESS
- MODEL SELECTOR
- CONTRACTOR LIST

Call Toll Free: 1-888-241-0792

**EXCEL**

SELF-CONTAINED: EXCEL

\$1845.00 USD\*

Find a Dealer

Features: Electric, High Capacity, Central Flush, Accessories, Question Process, Model Selector, Composting Capacity: 3.5 Residential & 6.5 Commercial and Vacation Use.

Related Products: EXCEL NE, EXCEL ACDC, SPACESAVER, BURNHAM WARE, COMPACT.

product info | specs | rough-in diagram | testimonials

The Excel is the bestselling unit in North America and for good reason. It is a high capacity 30-gallon toilet that is very simple to operate, features well-proven technology and is extremely reliable. The Excel was the first ever self-contained composting toilet to be certified by the National Sanitation Foundation (NSF). So, when you purchase an Excel, you are buying a composting toilet that sets the standard.

The Excel has enough capacity that it can be used just about anywhere. In residences, cottages and even in light commercial applications.

To ensure residential use the Excel was tested by the National Sanitation Foundation (NSF) at maximum capacity for 6 continuous months, during which the Excel produced no odor and produced a clean, safe compost. Only Sun-Mar self-contained units are listed for residential and cottage use by NSF, whose Standard 411 is the toughest composting performance standard in the world.

The 2" vent is attached at the top back of the Excel and can be installed invisibly by routing it through the wall and up the outside wall. For comfort the Excel has a handy detachable footstool which can be removed to put out the finishing drawer.

In normal use the Excel can normally evaporate all liquids, however a 1" emergency drain is fitted at the rear and this should be connected if the unit is to be used residentially or heavily, as it prolonged power outages are expected.

**NSF**

Tested at: This system is Certified and Listed by NSF.

\* Pricing is suggested list price only. Quotes may vary by region.

For Canadian prices visit our website: [www.sun-mar.com](http://www.sun-mar.com)

**NARRAGANSETT ENGINEERING INC.**

MAIN OFFICE: 3102 EAST MAIN ROAD, PORTSMOUTH, RI 02871  
 TEL : (401) 883-8630

www.nel-cds.com

SHEET TITLE: OWTS MODIFICATIONS PLAN

OWNER OF RECORD: WEIR, ROSALIND M., 28 RIVER ROAD, WESTPORT, MA 02790

LOCATION: 28 EAST ROAD, TIVERTON RI 02878

PLAT: 706 LOTS: 111

PROJECT #	DATE	DRAWN	CHECK
12.0199	10.16.15	KH	DH

NO.	DATE	DESCRIPTION	BY

LOCUS

SHEET 1 OF 1 SCALE 1"=40'