

**www.nitscheng.com**  
 2 Center Plaza, Suite 430  
 Boston, MA 02108  
 T: (617) 338-0063  
 F: (617) 338-6472

- ▶ Civil Engineering
- ▶ Land Surveying
- ▶ Transportation Engineering
- ▶ Sustainable Site Consulting
- ▶ Planning
- ▶ GIS

**DRAINAGE OUTFALL IMPROVEMENT PROJECT**

RAYTHEON PORTSMOUTH FACILITY  
 PLAT 51, LOT 1  
 1847 WEST MAIN ROAD  
 PORTSMOUTH, RHODE ISLAND

PREPARED FOR:  
**RAYTHEON COMPANY**  
 870 Winter Street,  
 Waltham MA 02451 USA

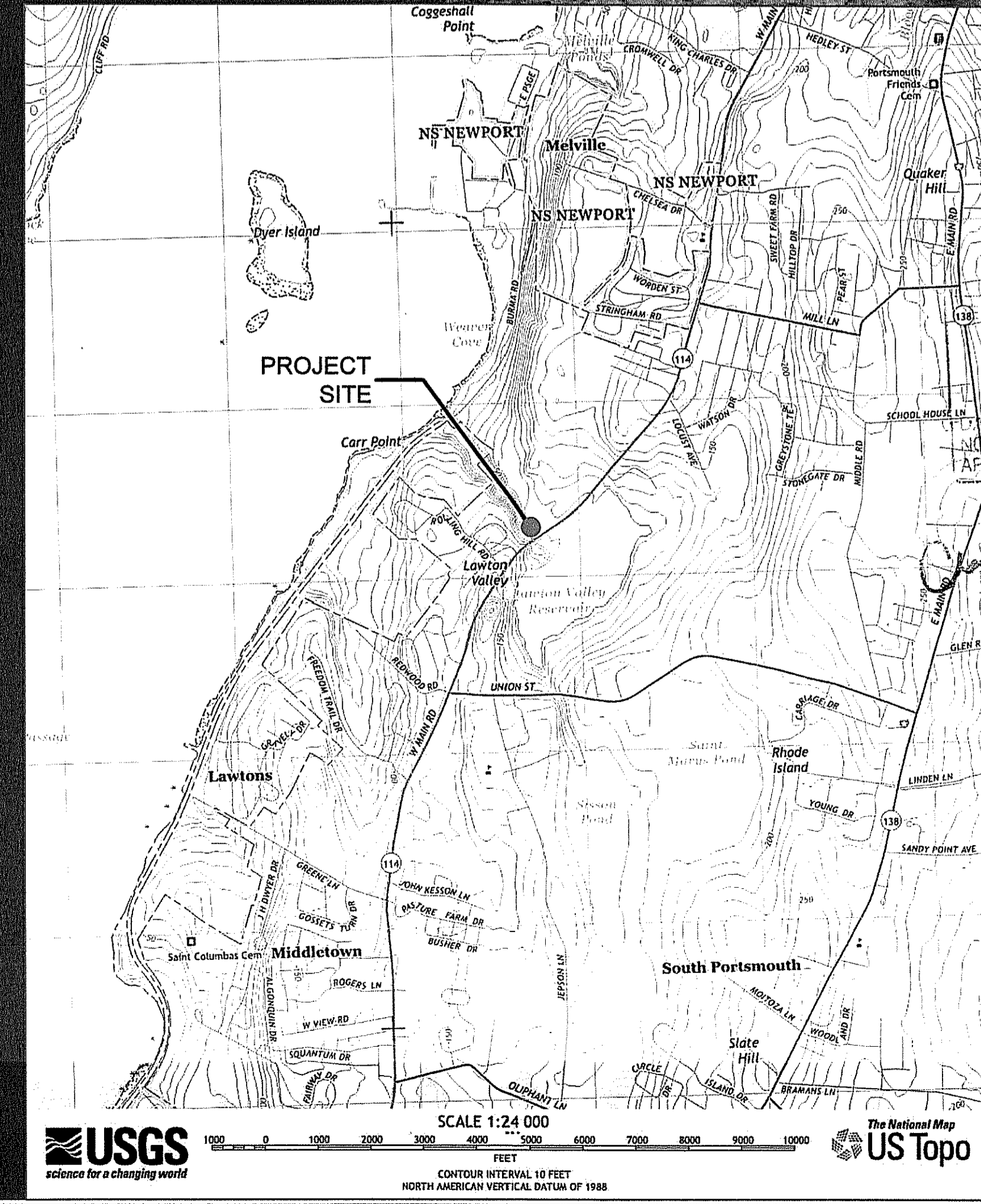

DEPARTMENT OF ENVIRONMENTAL MANAGEMENT  
 DIVISION OF WATER RESOURCES  
 RIVERS AND WETLANDS PROGRAM  
 APPROVED WITH CONDITIONS  
 AS SHOWN IN THE LETTER OF APPROVAL  
 DATED NOV 23 2015 FILE # 15-0248  
 NO CHANGES ALLOWED WITHOUT PRIOR APPROVAL  
 APPROVED PLANS MUST BE AT CONSTRUCTION SITE

REV.	COMMENTS	DATE

NITSCH PROJECT # \_\_\_\_\_  
 FILE: \_\_\_\_\_  
 SCALE: \_\_\_\_\_  
 DATE: \_\_\_\_\_  
 PROJECT MANAGER: \_\_\_\_\_  
 SURVEYOR: \_\_\_\_\_  
 DRAFTED BY: \_\_\_\_\_  
 CHECKED BY: \_\_\_\_\_

**EX-1.0**  
 LOCUS & CONTEXT  
 PALMS

SHEET 1 OF 4  
 SCALE: AS-SHOWN  
 DRAWING NO: RI-027-1001.01 400A

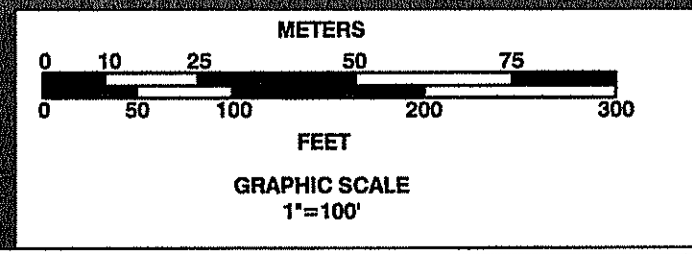

- LEGEND:**
- Bituminous
  - Catch Basin
  - Chain Link Fence
  - Drain
  - Drain Manhole
  - Electric Manhole
  - Gas
  - Gas Gate
  - Hydrant
  - Light Pole
  - Metal Cover Plate
  - Overhead Wires
  - Post Indicator Valve
  - Sewer
  - Sewer Manhole
  - Stone Wall
  - Telephone Manhole
  - Underground Electric
  - Underground Telephone
  - Utility Pole
  - Water
  - Water Gate
  - Edge of Trees/Brush
  - Proposed Contour per Construction Plans
  - Concrete

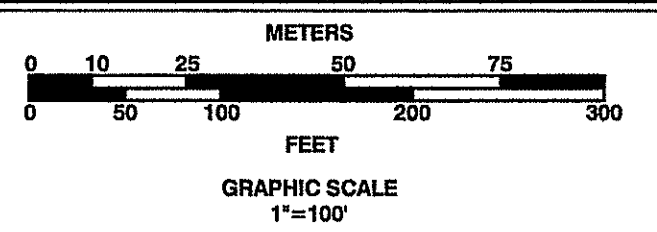

**NOTE:** All underground utilities shown were compiled according to available record plans from the various utility companies, public agencies, and various other data and are approximate only. Locations must be determined in the field before designing, excavating, blasting, installing, backfilling, grading, pavement restoration or repairing. All utility companies, public and private, must be contacted including those in control of utilities not shown on this plan. We assume no responsibility for damages incurred as a result of utilities omitted or inaccurately shown. Before planning future connections the appropriate public utility engineering department must be consulted.

CONTOURS ARE BASED ON MEAN SEA LEVEL.

Property line information is compiled from plans and deeds.

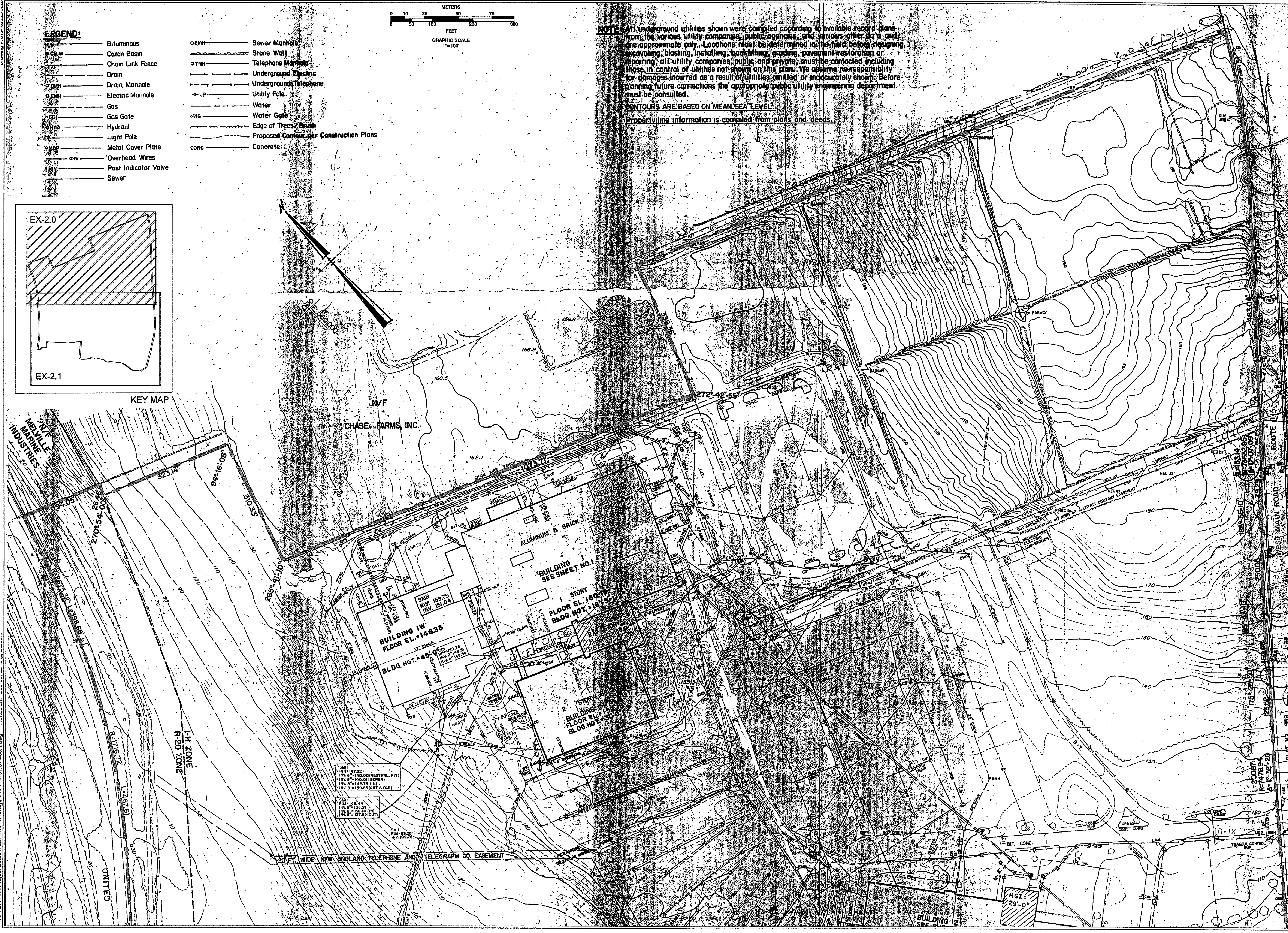
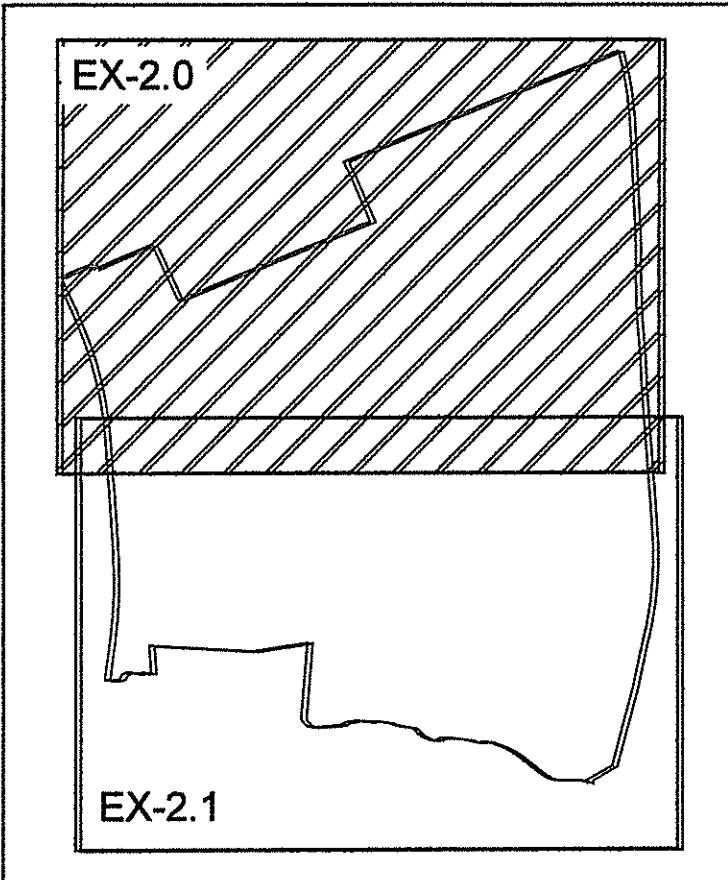

**www.nitscheng.com**  
 2 Center Plaza, Suite 430  
 Boston, MA 02108  
 T: (617) 338-0063  
 F: (617) 338-6472

- ▶ Civil Engineering
- ▶ Land Surveying
- ▶ Transportation Engineering
- ▶ Sustainable Site Consulting
- ▶ Planning
- ▶ GIS

**DRAINAGE OUTFALL IMPROVEMENT PROJECT**

RAYTHEON PORTSMOUTH FACILITY  
 PLAT 51, LOT 1  
 1847 WEST MAIN ROAD  
 PORTSMOUTH, RHODE ISLAND

PREPARED FOR:  
**RAYTHEON COMPANY**  
 870 Winter Street,  
 Waltham MA 02451 USA

OFFICE OF ENVIRONMENTAL MANAGEMENT  
 DEPARTMENT OF WATER RESOURCES  
 RIVER WETLANDS PROGRAM  
 APPROVED WITH CONDITIONS  
 AS SHOWN IN THE LETTER OF APPROVAL  
 NOV 23 2015 FILE # 15-0248  
 REVISIONS ALLOWED WITHOUT PRIOR APPROVAL  
 REVISIONS MUST BE AT CONSTRUCTION SITE

REV.	COMMENTS FOR REVISIONS	DATE

NITSCH PROJECT #  
 FILE: 15-0248  
 SCALE: 1"=100'-0"  
 DATE: 11/23/15  
 PROJECT MANAGER:  
 SURVEYOR:  
 DRAFTED BY:  
 CHECKED BY:

**EX-2.0**  
 EXISTING  
 CONDITIONS PLAN

SHEET 2 OF 4  
 SCALE: 1"=100'-0"  
 DRAWING NO: RI-027-1001.01 405A

- ▶ Civil Engineering
- ▶ Land Surveying
- ▶ Transportation Engineering
- ▶ Sustainable Site Consulting
- ▶ Planning
- ▶ GIS

**DRAINAGE OUTFALL IMPROVEMENT PROJECT**  
 RAYTHEON PORTSMOUTH FACILITY  
 PLAT 51, LOT 1  
 1847 WEST MAIN ROAD  
 PORTSMOUTH, RHODE ISLAND

PREPARED FOR:  
**RAYTHEON COMPANY**  
 870 Winter Street  
 Waltham MA 02451 USA

DEPARTMENT OF ENVIRONMENTAL MANAGEMENT  
 DIVISION OF WATER RESOURCES  
 FROM THE WETLANDS PROGRAM  
 REVIEWED WITH COMMENTS  
 INDICATED IN THE LETTER  
 OF APPROVAL  
 NOV 23 2015 FILE # 15-0228  
 NO CHANGES ALLOWED WITHOUT PRIOR APPROVAL  
 APPROVED PLANS MUST BE AT CONSTRUCTION

REV.	COMMENTS	DATE

NITSCH PROJECT # \_\_\_\_\_  
 FILE: \_\_\_\_\_  
 SCALE: \_\_\_\_\_  
 DATE: \_\_\_\_\_  
 PROJECT MANAGER: \_\_\_\_\_  
 SURVEYOR: \_\_\_\_\_  
 DRAFTED BY: \_\_\_\_\_  
 CHECKED BY: \_\_\_\_\_

**EX-2.1**  
 EXISTING  
 CONDITIONS PLAN

SHEET 3 OF 4  
 SCALE: 1"=100'-0"  
 DRAWING NO: RI-027-1001.01 405A

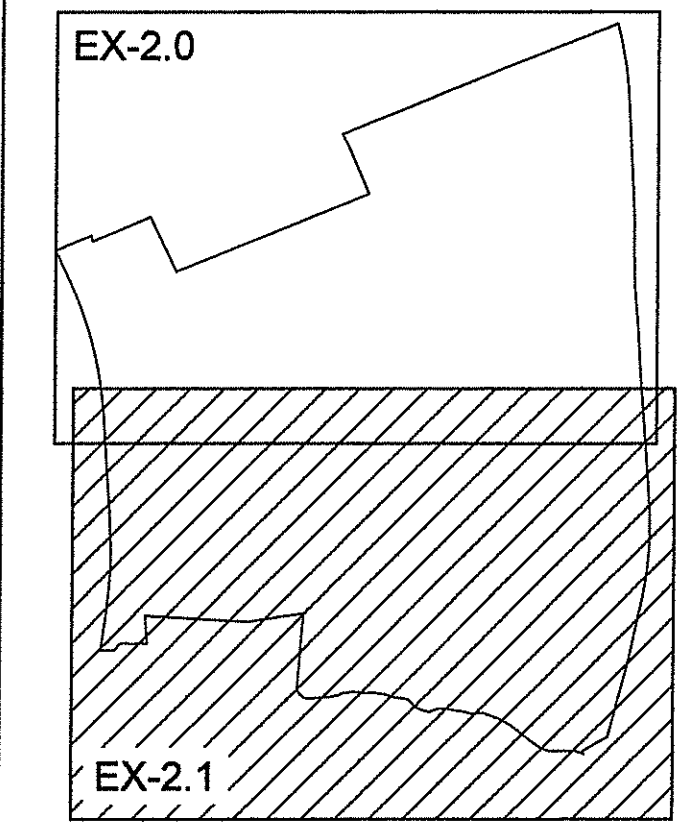
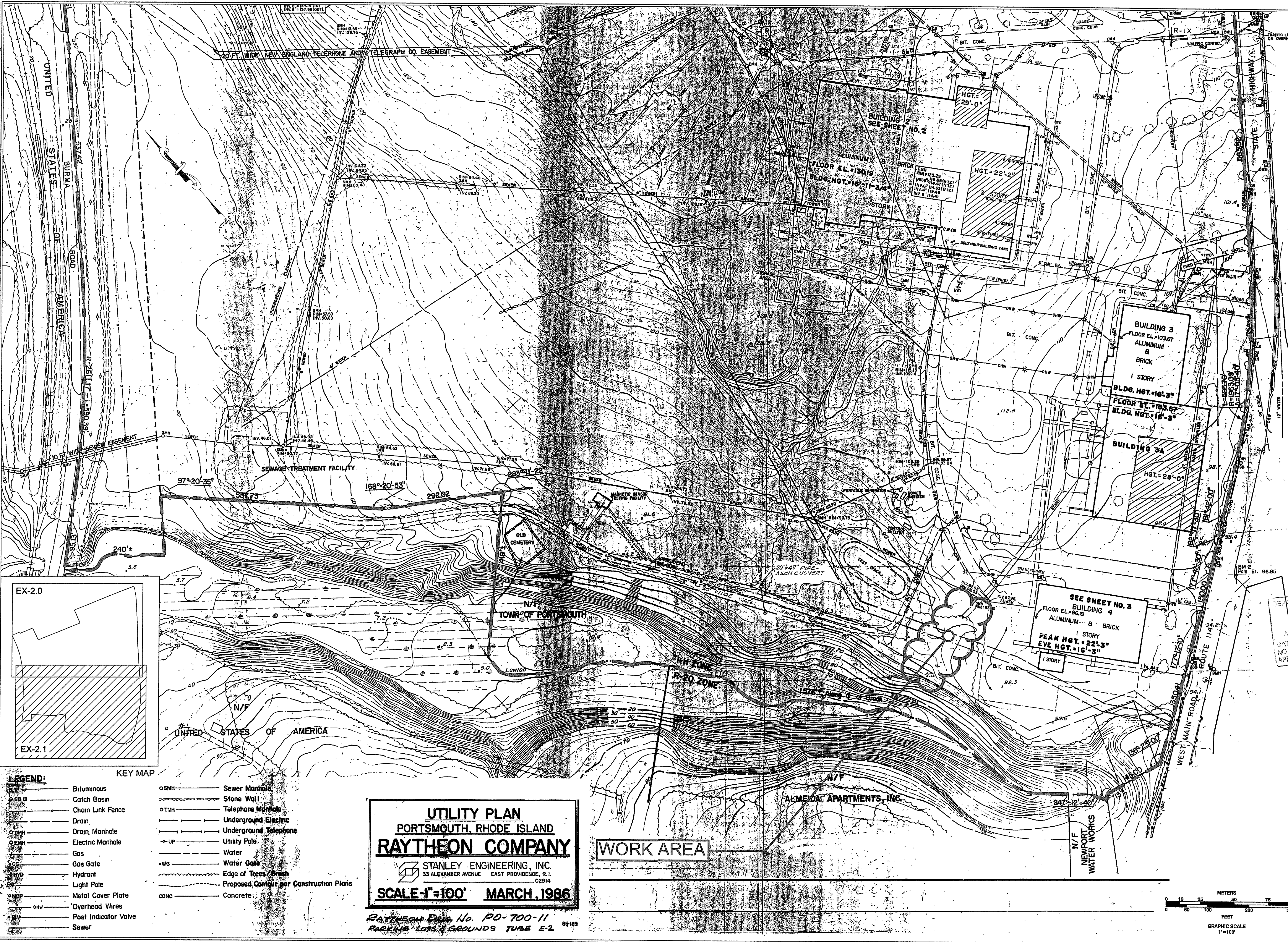

- LEGEND:**
- Bituminous
  - Catch Basin
  - Chain Link Fence
  - Drain
  - Drain Manhole
  - Electric Manhole
  - Gas
  - Gas Gate
  - Hydrant
  - Light Pole
  - Metal Cover Plate
  - Overhead Wires
  - Post Indicator Valve
  - Sewer
  - Sewer Manhole
  - Stone Wall
  - Telephone Manhole
  - Underground Electric
  - Underground Telephone
  - Utility Pole
  - Water
  - Water Gate
  - Edge of Trees/Brush
  - Proposed Contour per Construction Plans
  - Concrete

**UTILITY PLAN**  
 PORTSMOUTH, RHODE ISLAND  
**RAYTHEON COMPANY**  
 STANLEY ENGINEERING, INC.  
 33 ALEXANDER AVENUE EAST PROVIDENCE, R.I. 02914  
**SCALE 1"=100' MARCH, 1986**

**WORK AREA**

RAYTHEON Dwg No. PD-700-11  
 PARKING LOTS & GROUNDS TUBE E-2

