

LOCUS MAP (NOT TO SCALE)

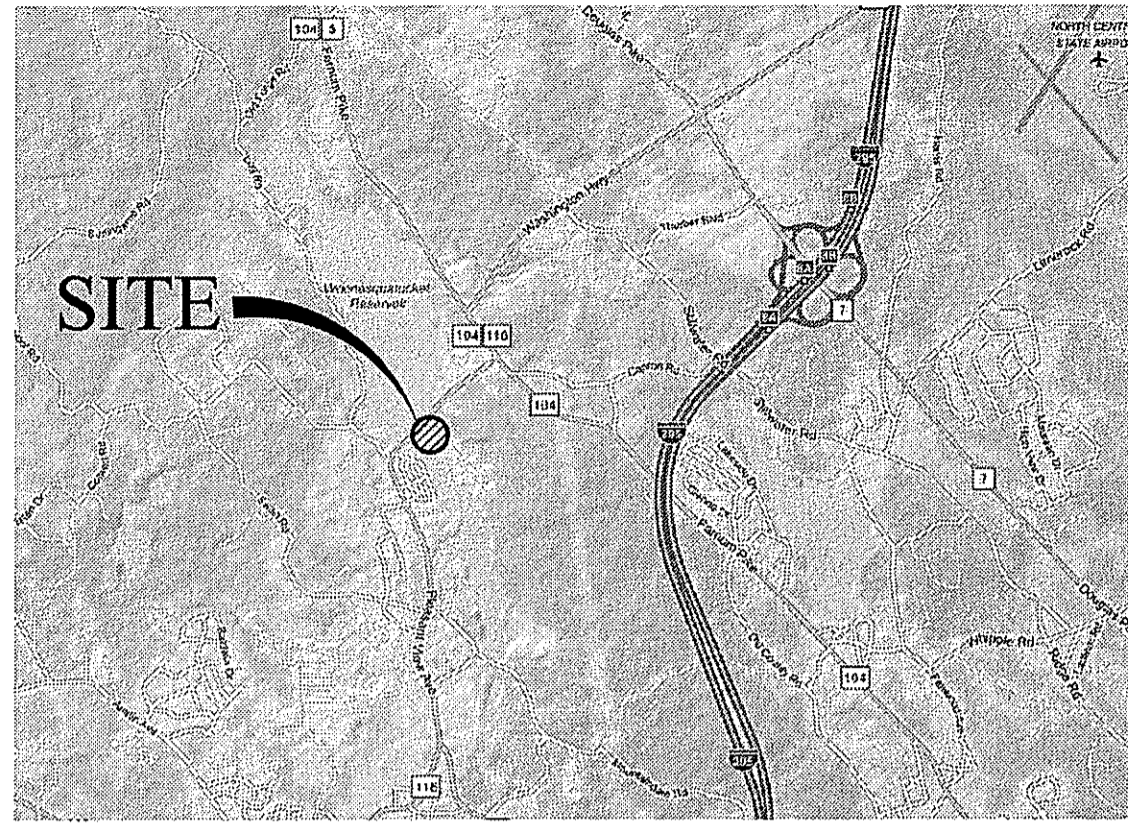

STATE WIDE MAP

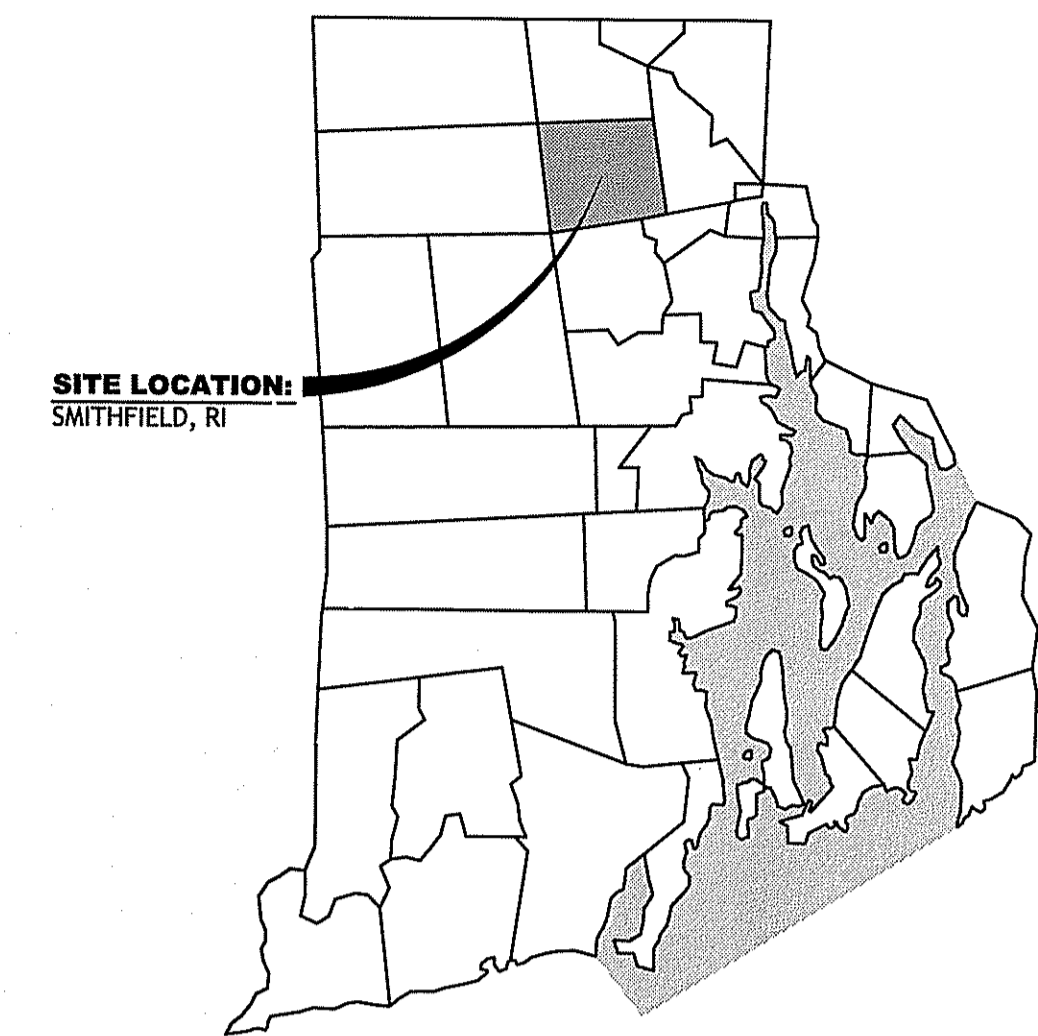

PERMIT APPLICATION PLANS RENOVATIONS

TO THE

SMITHFIELD POLICE STATION

A.P 46, LOT 182

215 PLEASANT VIEW AVE.
SMITHFIELD, RHODE ISLAND

ZONING DISTRICT - R-80

Kindly be advised that this Permit is not equivalent to a verification of the type or extent of freshwater wetlands on site.

DEPARTMENT OF ENVIRONMENTAL MANAGEMENT
OFFICE OF WATER RESOURCES
FRESHWATER WETLANDS PROGRAM
APPROVED WITH CONDITIONS
AS SPECIFIED IN THE LETTER OF APPROVAL
DATED JAN 06 2016 FILE # 15-0250
NO CHANGES ALLOWED WITHOUT PRIOR APPROVAL
APPROVED PLANS MUST BE AT CONSTRUCTION SITE

INDEX OF DRAWINGS

SHEET NO.	PLAN
CV1.0	COVER SHEET
C1.0	GENERAL NOTES & LEGEND
C2.0	EXISTING CONDITIONS PLAN
C3.0	SITE PLAN
C4.0	GRADING, DRAINAGE AND UTILITY PLAN
C4.1	SOIL EROSION AND SEDIMENT CONTROL PLAN
C5.0	SITE DETAILS NO. 1
C5.1	SITE DETAILS NO. 2

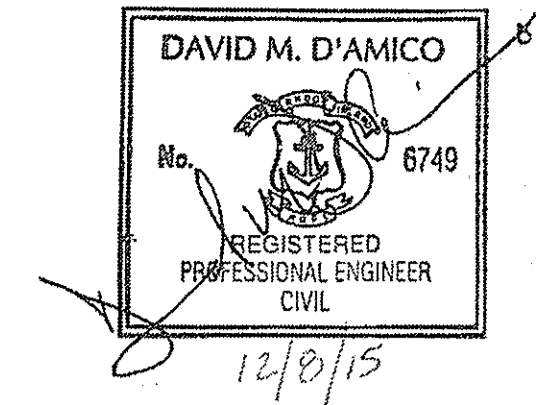

Saccoccio & Associates, Inc.
1085 Park Avenue Cranston, Rhode Island 02910
tel 401.942.7970 fax 401.942.7975



RENOVATIONS TO SMITHFIELD POLICE STATION

215 PLEASANT VIEW SMITHFIELD, RI 02917

TOWN OF SMITHFIELD, RHODE ISLAND

NOTES:
REVISION NO. 1 - RIDEM COMMENTS OF 12-4-15

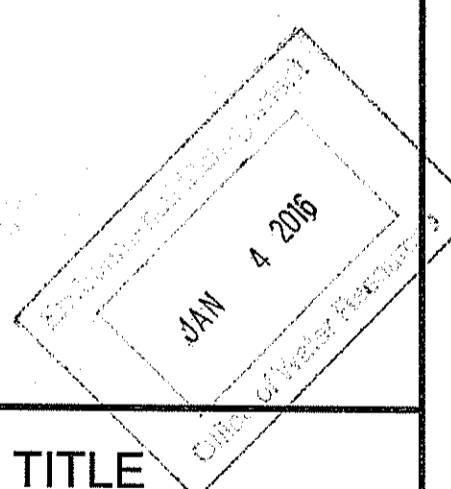

SHEET TITLE

COVER

DRAWN BY: DMD JOB NUMBER: 15107
CHECKED BY: DMD DATE: 07-13-2015

CV1.0

SCALE:

GENERAL NOTES:

1. THE LOCATION AND DEPTH OF EXISTING UTILITIES ARE APPROXIMATE AND HAVE BEEN PLOTTED FROM THE LATEST AVAILABLE INFORMATION. THE UTILITY LOCATIONS ARE APPROXIMATE AND MAY NOT BE ALL INCLUSIVE. THE CONTRACTOR SHALL CHECK AND VERIFY THE LOCATIONS OF ALL EXISTING UTILITIES, BOTH OVERHEAD AND UNDERGROUND, AND "DIG-SAFE" MUST BE NOTIFIED PRIOR TO COMMENCING ANY CONSTRUCTION OPERATIONS. RESTORATION AND REPAIR OF DAMAGE TO EXISTING UTILITIES SHALL BE THE RESPONSIBILITY OF THE CONTRACTOR WITH NO ADDITIONAL COST TO THE OWNER. NO EXCAVATION SHALL COMMENCE UNTIL ALL INVOLVED UTILITY COMPANIES AND/OR CITY WHOSE FACILITIES MIGHT BE AFFECTED BY ANY WORK TO BE PERFORMED BY THE CONTRACTOR ARE NOTIFIED AT LEAST 72 HOURS IN ADVANCE.

SITE NOTES:

1. CONTRACTOR SHALL BE RESPONSIBLE FOR REMOVING AND LEGALLY DISPOSING (R&D) OF ALL MATERIALS INDICATED ON THE PLANS.
2. STOCKPILES OF EARTH MATERIALS SHALL NOT BE LOCATED ADJACENT TO DRAINAGE STRUCTURES.
3. ALL DISTURBED AREAS OUTSIDE OF THE PAVED AREAS WILL RECEIVE A MINIMUM OF 4" OF LOAM AND SEED.
4. THE CONTRACTOR SHALL PROVIDE AND MAINTAIN SURVEY LAYOUT SERVICES FOR THE WORK AND SHALL SUBMIT "AS-BUILT" DRAWINGS OF ALL WORK, WHICH SHALL BE STAMPED AND CERTIFIED BY A RHODE ISLAND REGISTERED PROFESSIONAL LAND SURVEYOR.
5. ANY ITEM OF SITE WORK NOT SPECIFICALLY INDICATED ON THE PLANS BUT IS REQUIRED FOR THE COMPLETE CONSTRUCTION OF THE PROJECT WILL BE CONSIDERED INCIDENTAL TO THE CONTRACT AND INCLUDED IN THE CONTRACT BID PRICE. IT WILL BE THE CONTRACTOR'S RESPONSIBILITY TO VERIFY ALL EXISTING SITE CONDITIONS.
6. REFER TO ARCHITECTURAL AND STRUCTURAL PLANS FOR ACTUAL SIZE OF THE PROPOSED BUILDING.
7. WHERE NECESSARY TO REMOVE CURBS, CATCH BASINS OR DRAINS TO COMPLETE WORK, THE CONTRACTOR SHALL REPLACE SUCH ITEMS TO THE SATISFACTION OF THE ENGINEER AT NO ADDITIONAL COST TO THE OWNER.
8. ANY EXISTING PIPE OR UTILITY DAMAGED BY THE CONTRACTOR'S OPERATIONS SHALL BE REPAIRED IMMEDIATELY BY THE CONTRACTOR AT NO COST TO THE OWNER OR ENGINEER.
9. THE CONTRACTOR SHALL RESTORE TO ITS ORIGINAL CONDITION OR REPLACE TREES, SHRUBS, FENCES, SIGNS, GUARDRAILS, DRIVEWAYS, SIDEWALKS AND ANY OTHER OBJECT AFFECTED BY THIS OPERATION.
10. THE TOPS OF ALL VALVE BOXES AND CURB BOXES SHALL BE FLUSH WITH GROUND OR PAVEMENT SURFACE LEVEL AND PLUMB, UNLESS OTHERWISE DIRECTED.
11. ROADWAYS SHALL BE LEFT PASSABLE AT ALL TIMES. CLOSURE OF ROADWAY IS NOT PERMITTED.
12. THE CONTRACTOR SHALL PROVIDE ACCESS TO ALL DRIVEWAYS AT COMPLETION OF EACH DAYS WORK.
13. WATER SERVICE SHALL BE MAINTAINED AT ALL TIMES.
14. ALL LEDGE TO BE REMOVED BY MECHANICAL MEANS.
15. ALL CONSTRUCTION WORK SHALL BE PERFORMED IN THE DRY. THE CONTRACTOR SHALL PROVIDE, OPERATE AND MAINTAIN ALL PUMPS, DRAINS, WET POINTS, SCREENS, OR OTHER FACILITIES NECESSARY TO CONTROL, COLLECT AND DISPOSE OF ALL SURFACE AND SUBSURFACE WATER ENCOUNTERED IN THE PERFORMANCE OF THE WORK.
16. REFER TO PLUMBING PLANS FOR CONTINUATION OF ALL UTILITIES WITHIN 5' (FIVE) FEET OF THE BUILDING.
17. ALL SITE WORK, INCLUDING BUT NOT LIMITED TO, BITUMINOUS PAVEMENT, ROADWAY CONSTRUCTION, AGGREGATE MATERIALS, DRAINAGE STRUCTURES, CURBING, SIDEWALK, LANDSCAPING, SAW CUTTING, ETC. SHALL CONFORM TO THE RHODE ISLAND DEPARTMENT OF TRANSPORTATION STANDARD SPECIFICATIONS FOR ROADWAY AND BRIDGE CONSTRUCTION, 2004 EDITION (WITH LATEST ADDENDA) AND THE RIDOT STANDARD DETAILS, 1998 EDITION (WITH LATEST ADDENDA).

MISCELLANEOUS UTILITY NOTES:

1. PRIOR TO CONSTRUCTION ALL POTENTIAL UTILITY/DRAINAGE CONFLICTS MUST BE IDENTIFIED BY THE CONTRACTOR. ANY MODIFICATIONS TO THE PROPOSED UTILITIES TO AVOID CONFLICTS MUST BE APPROVED BY THE ENGINEER PRIOR TO CONSTRUCTION. NO EXTRA PAYMENT TO THE CONTRACTOR DUE TO RELOCATIONS WILL BE AUTHORIZED.
2. THE UTILITY PLAN DOES NOT DEPICT THE NECESSARY ELECTRICAL CONDUIT/WIRING TO SERVICE THE PROPOSED LIGHTING AND SIGNS, WHICH WILL BE PERFORMED BY THE CONTRACTOR FOR NO ADDITIONAL COST.
3. OVERHEAD ELECTRIC AND TELEPHONE SERVICES ARE TO BE REMOVED BY THE APPROPRIATE UTILITY COMPANY AND COORDINATED BY THE CONTRACTOR.
4. THE CONTRACTOR SHALL AT ALL TIMES PROVIDE A SUFFICIENT NUMBER OF WORKMEN AND GUARDS AS MAY BE NECESSARY TO PROPERLY SAFEGUARD THE PUBLIC FROM THESE OPERATIONS.
5. THE CONTRACTOR SHALL TAKE PRECAUTIONS AGAINST DAMAGING OF PAVING, SIDEWALKS, UTILITIES, OR PRIVATE PROPERTIES AND SHALL PROMPTLY REPAIR AT HIS OWN EXPENSE ANY DAMAGE TO SUCH PAVING, SIDEWALKS, UTILITIES, OR PRIVATE PROPERTIES TO THE SATISFACTION OF THE OWNER OR TOWN.
6. EXISTING UTILITY FRAMES AND COVERS FOR SANITARY SEWER, WATER, GAS, STORM DRAINAGE AND OTHER UTILITIES SHALL BE ADJUSTED TO GRADE AS REQUIRED IN NEW PAVING AND PAVEMENT OVERLAY AREAS.

DRAINAGE SYSTEM NOTES:

1. ALL RIM ELEVATIONS SHOWN ARE APPROXIMATE AND ARE TO BE SET FLUSH WITH FINAL GRADES
2. THE DESIGN ENGINEER MUST SUBMIT AN AS BUILT PLAN AND A CERTIFICATION TO THE TOWN ENGINEER THAT THE CONSTRUCTION IS IN COMPLIANCE WITH THE DESIGN PLANS FOR ALL ELEMENTS OF THE STORM OR DRAINAGE SYSTEM PRIOR TO THE ISSUANCE OF THE CERTIFICATE OF OCCUPANCY.

PROPOSED PAVEMENT STRUCTURE:

- ON-SITE - IMPERVIOUS
- 1.5" BITUMINOUS CONCRETE SURFACE COURSE CLASS I-1
- 1.5" BITUMINOUS CONCRETE BINDER COURSE
- 12" GRAVEL BORROW SUBBASE

ASPHALT EMULSION TACK COAT TO BE PLACED PRIOR TO SURFACE COURSE PAVING IF BINDER COURSE IS OPENED TO VEHICULAR USE, OR IF BINDER COURSE IS GREATER THAN 30 DAYS OLD.

PROPOSED PAVEMENT STRUCTURE:

- ON-SITE - PERVIOUS (POROUS PAVEMENT)
- 3" POROUS BITUMINOUS CONCRETE PLACED IN 2 - 1.5" COURSES
- 8" TO 12" FILTER FINE AGGREGATE COURSE
- NON-WOVEN GEOTEXTILE FILTER FABRIC (MIRAFI 160N OR APPROVED EQUAL)
- 3" PEA STONE GRAVEL (#8 MINUS)
- 5" 3/4" WASHED CRUSHED STONE RESERVOIR

PROPOSED PAVEMENT STRUCTURE:

- TOWN/STATE RIGHT-OF-WAY
- 2" BITUMINOUS CONCRETE SURFACE COURSE CLASS TYPE I-1
- 2" BITUMINOUS CONCRETE BINDER COURSE
- 12" GRAVEL BORROW SUBBASE COURSE

ASPHALT EMULSION TACK COAT TO BE PLACED ON ALL BITUMINOUS COURSES PRIOR TO PAVING.

RIDOT

1. ALL WORK, INCLUDING BUT NOT LIMITED TO, BITUMINOUS PAVEMENT, ROADWAY CONSTRUCTION, AGGREGATE MATERIALS, DRAINAGE STRUCTURES, CURBING, SIDEWALK, LANDSCAPING, SAW CUTTING, ETC. SHALL CONFORM TO THE RHODE ISLAND DEPARTMENT OF TRANSPORTATION STANDARD SPECIFICATIONS FOR ROADWAY AND BRIDGE CONSTRUCTION, 2004 EDITION (WITH LATEST ADDENDA) AND THE RIDOT STANDARD DETAILS, 1998 EDITION (WITH LATEST ADDENDA).

LAYOUT NOTE:

THE LAYOUT SHOWN REPRESENTS A GRAPHICAL DESIGN, AND PRIOR TO THE CONSTRUCTION, THE CONTRACTOR SHALL ENGAGE A PROFESSIONAL LAND SURVEYOR (PLS) REGISTERED IN THE STATE OF RHODE ISLAND TO SET AND VERIFY ALL LINES AND GRADES. ALL EXISTING UTILITY LOCATIONS AND ELEVATIONS ARE TO BE CONFIRMED BY THE CONTRACTOR PRIOR TO CONSTRUCTION. ANY ITEMS FOUND WHICH DO NOT MATCH THE PLANS MUST BE BROUGHT TO THE ENGINEERS ATTENTION PRIOR TO CONSTRUCTION FOR REVIEW. NO WORK SHALL PROCEED UNTIL AUTHORIZED BY THE ENGINEER.

MAINTENANCE AND PROTECTION OF TRAFFIC NOTES:

1. THE CONTRACTOR SHALL BE RESPONSIBLE FOR ALL MAINTENANCE AND PROTECTION OF PEDESTRIAN AND VEHICULAR TRAFFIC INCLUDING POLICE PROTECTION. ALL TEMPORARY AND VEHICULAR SIGNS, BARRICADES AND LANE CLOSURES SHALL BE IN CONFORMANCE WITH THE LATEST REVISIONS OF MANUAL OF UNIFORM TRAFFIC CONTROL DEVICES (M.U.T.C.D.)
2. TEMPORARY CONSTRUCTION SIGNS AND ALL APPLICABLE TRAFFIC CONTROL DIVIDES SHALL BE IN PLACE PRIOR TO THE START OF WORK IN ANY AREA OPEN TO TRAFFIC.
3. THE PRIVATE VEHICLES OF CONSTRUCTION WORKERS SHALL NOT BE PARKED IN THE STATE OR TOWN ROADWAY RIGHT-OF-WAY.
4. ALL MAINTENANCE AND PROTECTION OF TRAFFIC CONTROL SETUPS, SIGNS CHANNELING DEVICES, ETC., SHALL BE IN ACCORDANCE WITH THE MANUAL OF UNIFORM TRAFFIC CONTROL DEVICES. 1988 EDITION, INCLUDING REVISION 3, SEPTEMBER 3, 1993 AND SUBSEQUENT ADDENDA.
5. SIGN MOUNTINGS SHALL BE IN ACCORDANCE WITH THE R.I.D.O.T. SPECIFICATIONS FOR TEMPORARY CONSTRUCTION SIGNS.

DRAINAGE AND SUBSURFACE DRAINAGE SYSTEM MAINTENANCE SCHEDULE:

UPON PROJECT COMPLETION, THE PROPERTY OWNER SHALL ADHERE TO THE FOLLOWING MAINTENANCE PLAN AND SCHEDULE:

1. CATCH BASINS, MANHOLES AND DRAIN LINES: AN INSPECTION MUST OCCUR ON AN ANNUAL BASIS BY QUALIFIED PERSONAL TO ENSURE PROPER OPERATION. ANY DEFICIENCY NOTED DURING THE INSPECTION WILL BE IMMEDIATELY REPAIRED OR REPLACED. THE INSPECTION SHOULD, AS A MINIMUM, CONCENTRATE ON THE FOLLOWING:
 - * DAMAGE TO GRATE/ COVERS
 - * EVIDENCE OF STANDING WATER
 - * DEBRIS REMOVAL
 - * STRUCTURAL ALIGNMENT/ INTEGRITY
 - * OIL/WATER SEPARATORS
2. IF SEDIMENT OR ORGANIC DEBRIS BUILD-UP HAS LIMITED THE INFILTRATION CAPABILITIES OF THE UNDERGROUND INFILTRATION CHAMBERS OR TRENCHES TO BELOW THE DESIGN RATE THE SYSTEM MUST BE REMOVED AND RE-CONSTRUCTED. THE SYSTEMS BOTTOM SHOULD BE RESTORED ACCORDING TO ORIGINAL DESIGN SPECIFICATIONS.
3. SEDIMENT REMOVAL: ALL REMOVED SEDIMENT IS TO BE TESTED TO DETERMINE POLLUTANT CONTENT. THE SEDIMENT IS TO BE PROPERLY DISPOSED IN UPLAND AREAS BASED UPON THE TEST RESULTS AND LOCAL, STATE, AND FEDERAL REGULATIONS.
4. THE PROPERTY OWNER IS RESPONSIBLE FOR ANY SOIL AND GROUNDWATER CONTAMINATION RESULTING FROM THE USE OF THE STORMWATER RUNOFF SUBSURFACE DRAINAGE SYSTEM.
5. THE EXISTENCE OF THE SUBSURFACE DRAINAGE SYSTEM SHOULD BE RECORDED ON THE PROPERTY DEED AT THE LOCAL MUNICIPAL OFFICE. ALL OPERATIONAL AND MAINTENANCE REQUIREMENTS, INCLUDING LEGAL RESPONSIBILITIES, WHERE APPLICABLE, SHOULD ALSO BE RECORDED ON THE TITLE.
6. UNDERGROUND INFILTRATION CHAMBERS AND TRENCHES SHALL BE INSPECTED ANNUALLY AND AFTER STORMS EQUAL TO OR GREATER THAN THE 1-YEAR, 24 HOUR TYPE III STORM EVENT (APPROXIMATELY 2.7").
7. THE SUBSURFACE DRAINAGE SYSTEM SHOULD BE INSPECTED OFTEN DURING THE FIRST MONTHS OF OPERATION AND CLEANED AT LEAST YEARLY THEREAFTER WITH ALL OIL AND DEBRIS REMOVED AND DISPOSED OF PROPERLY IN ACCORDANCE WITH STATE AND FEDERAL REGULATIONS. CLEANING OF THE CULTEC SYSTEM WILL BE CONDUCTED BY VACUUM TRUCK DESIGN SPECIFICALLY TO REMOVE STORMWATER RUNOFF SEDIMENT. IN THE CASE OF AN OIL OR BULK POLLUTANT RELEASE, THE SYSTEM SHOULD BE CLEANED IMMEDIATELY FOLLOWING THE SPILL AND THE RIDEM DIVISION OF SITE REMEDIATION SHOULD BE NOTIFIED. FOR THE PURPOSE OF OIL REMOVAL A LICENSED CONTRACTOR MAY BE NECESSARY FOR THE REMOVAL, TRANSPORT, AND DISPOSAL OF WASTE OIL PRODUCTS TO A PROPERLY LICENSED FACILITY.

WATER NOTES:

1. ALL INSTALLATIONS, JOINTS, CONSTRUCTION METHODS AND MATERIALS SHALL BE ACCORDING TO THE GREENVILLE WATER DISTRICT REQUIREMENTS, AWWA STANDARDS AND GOVERNMENTAL REQUIREMENTS.
2. INSTALLATION OF ALL WATER CONVEYANCES, MAINS, PIPES OR LINES SHALL BE IN ACCORDANCE WITH THE DUCTILE IRON PIPE RESEARCH ASSOCIATION'S INSTALLATION MANUAL AND ANSI/AWWA C600 AND ALL OTHER REQUIREMENTS OF THE GREENVILLE WATER DISTRICT.
3. WATER PIPES SHALL TYPICALLY BE LOCATED AT LEAST TEN (10) FEET HORIZONTALLY FROM SEWER PIPES, AND AT A MINIMUM DEPTH OF COVER EQUAL TO 5'. WHERE A NEW WATER PIPE IS LESS THAN 18 INCHES CLEAR DISTANCE ABOVE A SEWER OR WHERE A WATER PIPE PASSES BENEATH A SEWER OR STORM DRAIN, ENCASE THE SEWER OR DRAIN IN 6" OF CONCRETE FOR A DISTANCE OF 10 FEET ON EACH SIDE OF THE CROSSING WATER PIPE.
4. ALL SYSTEM COMPONENTS AND CONSTRUCTION METHODS; SUCH AS PIPE, THRUST BLOCKS, FITTINGS, CASTINGS, ETC. SHALL BE SUBMITTED TO THE ENGINEER FOR APPROVAL PRIOR TO PURCHASE AND INSTALLATION. THIS SUBMISSION SHALL INCLUDE MANUFACTURER'S LITERATURE, SHOP DRAWINGS, PROPOSED CONSTRUCTION METHODS, ETC.
5. WATER LINE TRENCH TO BE AWWA TYPE 5 A METALIZED DETECTABLE IDENTIFICATION TAPE 2" IN WIDTH, BLUE IN COLOR AND PRINTED WITH "CAUTION WATERLINE BURIED BELOW" SHALL BE UTILIZED OVER ALL MAINS. TAPE SHALL BE SET AT APPROXIMATELY 1' BELOW FINISHED GRADE.
6. THE CONTRACTOR SHALL RECEIVE VERIFICATION FROM THE ENGINEER AS TO THE APPROPRIATE SIZE OF THE DOMESTIC WATER AND FIRE PROTECTION LINE SHOWN ON THE PLANS PRIOR TO ORDERING WATER PIPE RELATED ITEMS.
7. ALL SITE WORK, INCLUDING BUT NOT LIMITED TO, BITUMINOUS PAVEMENT, GRAVEL, STONE, DRAINAGE PIPE AND RELATED STRUCTURES, WATER, SEWER, AND DRAIN LINE INSTALLATION, PAVEMENT SAW CUTTING, ETC. SHALL CONFORM TO THE RHODE ISLAND DEPARTMENT OF TRANSPORTATION (RIDOT) STANDARD SPECIFICATIONS FOR ROAD AND BRIDGE CONSTRUCTION, 1997 EDITION (WITH LATEST ADDENDA) AND THE RIDOT STANDARD DETAILS, 1998 EDITION (WITH LATEST ADDENDA).
8. SPECIFIC BENDS ARE SHOWN ON THE DRAWINGS. THE CONTRACTOR SHALL PROVIDE ADDITIONAL BENDS AS NECESSARY TO INSTALL THE PIPE AT THE REQUIRED DEPTH AND ALIGNMENT.

LEGEND

- EXISTING PROPERTY LINE
- ABUTTING PROPERTY LINE
- BUILDING SETBACK LINE
- WETLAND EDGE
- 100' EXISTING CONTOUR
- 100' PROPOSED CONTOUR
- EXISTING STONE WALL
- IRON ROD
- DRILL HOLE
- CONCRETE BOUND
- EXISTING CURB
- CHAIN LINK FENCE
- DRAIN LINE
- DRAINAGE MANHOLE
- CATCH BASIN
- UTILITY POLE
- OVERHEAD WIRES
- UNDERGROUND ELECTRIC
- GAS LINE
- WATER LINE
- WATER SHUT OFF VALVE
- GAS VALVE
- SEWER
- SMH
- N/F NOW OR FORMERLY
- 128°32'22"(AS) LOT DIM. "AS SURVEYED" IN THE FIELD
- 128°49'00"(D) LOT DIM. "AS PROVIDED" BY DEED
- LIMIT OF DISTURBANCE
- SOIL EVALUATION
- BUILDING DOOR LOCATION
- CUT AND MATCH LINE (SAW CUT)
- HANDICAPPED PARKING
- STOP SIGN
- ELECTRIC SIGN
- PAINTED TRAFFIC ARROW
- LIGHT POLE
- CLEAN OUT
- R & D REMOVE AND DISPOSE

Kindly be advised that this Permit is not equivalent to a verification of the type or extent of freshwater wetlands on site.

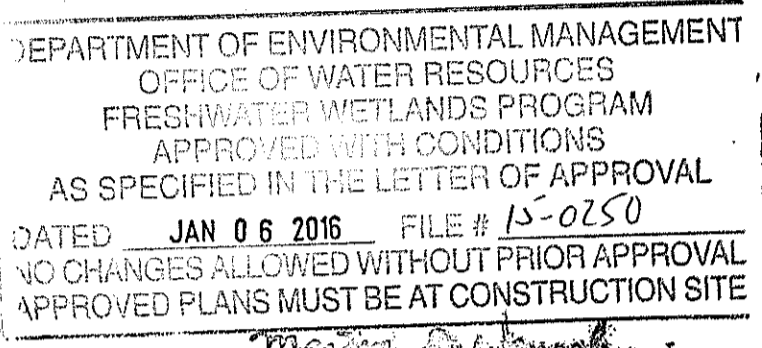

SOIL EROSION AND SEDIMENTATION CONTROL NOTES

1. THE HAYBALE AND SILT FENCE LINE ILLUSTRATED ON THESE PLANS SHALL SERVE AS THE STRICT LIMIT OF DISTURBANCE FOR THE PROJECT WITHIN OR ADJACENT TO REGULATED FRESHWATER WETLAND AREAS.
2. THE LIMITS OF CLEARING, GRADING, AND DISTURBANCE SHALL BE KEPT TO A MINIMUM WITHIN THE PROPOSED AREA OF CONSTRUCTION. ALL AREAS OUTSIDE OF THESE LIMITS, AS DEPICTED ON THE PLAN SHALL BE TOTALLY UNDISTURBED, TO REMAIN IN NATURAL CONDITION.
3. ALL CATCH BASINS AND CULVERTS SHALL BE PROTECTED WITH STAKED HAYBALES (R.I. STD. 9.8.0) DURING CONSTRUCTION ACTIVITIES. ALL PROPOSED STORM WATER DISCHARGE AREAS SHALL BE LINED WITH A RIPRAP SPLASH PAD AND PROTECTED WITH STAKED HAYBALE OUTLET PROTECTION (R.I. STD. 9.1.0), OR STAKED HAYBALE WITH SILT FENCE (R.I. STD. 9.3.0) SHALL ALSO BE INSTALLED AT ALL EXISTING STORMWATER DISCHARGE LOCATIONS WHERE DISTRIBUTING PIPES, CATCH BASINS, AND MANHOLES ARE TO BE CLEANED AND FLUSHED.
4. ALL DISTURBED SLOPES EITHER NEWLY CREATED OR CURRENTLY EXPOSED SHALL BE SEEDED, PROTECTED AND MAINTAINED BY THE CONTRACTOR. THE CONTRACTOR SHALL REGULARLY CHECK ALL SEEDED AREAS TO ENSURE THAT A GOOD STAND IS MAINTAINED.
5. ALL HAYBALES, TEMPORARY TREATMENT (HAY, STRAW, ETC.) AND TEMPORARY EROSION PROTECTION SHALL BE MAINTAINED BY THE CONTRACTOR THROUGHOUT CONSTRUCTION AND SHALL REMAIN IN PLACE UNTIL AN ACCEPTABLE STAND OF GRASS OR APPROVED GROUND COVER IS ESTABLISHED.
6. STOCKPILES OF TOPSOIL SHALL NOT BE LOCATED NEAR WATERWAYS. THEY SHALL HAVE SIDE SLOPES OF NO GREATER THAN 2:1 AND SHALL BE TEMPORARILY SEEDED AND/OR STABILIZED PER CONTRACT SPECIFICATIONS.
7. THE HAYBALES SHALL BE CHECKED BY THE CONTRACTOR ON A WEEKLY BASIS AND AFTER EACH STORM FOR UNDERMINING OR DETERIORATION. THE CONTRACTOR SHALL REPAIR OR REPLACE ANY HAYBALES AS NEEDED. THE CONTRACTOR SHALL CLEAN THE ACCUMULATED SEDIMENT IF HALF OF THE ORIGINAL HEIGHT OF THE HAY-BALES BECOMES FILLED WITH SEDIMENTS.
8. IT SHALL BE THE RESPONSIBILITY OF THE CONTRACTOR TO MAINTAIN ALL SOIL EROSION AND SEDIMENT CONTROLS ON THE PROJECT SITE FOR THE ENTIRE DURATION OF THE CONSTRUCTION PERIOD. THE CONTRACTOR SHALL FOLLOW THE DIRECTION OF THE RESIDENT ENGINEER WITH REGARD TO INSTALLATION, MAINTENANCE, AND REPAIR OF ALL SOIL EROSION AND SEDIMENTATION CONTROLS ON THE PROJECT SITE. TEMPORARY SOIL EROSION AND SEDIMENTATION CONTROLS (HAYBALES, SILT FENCE, ETC.) SHALL BE MAINTAINED UNTIL ALL EXPOSED SOILS ARE SATISFACTORILY STABILIZED. THE CONTRACTOR SHALL BE RESPONSIBLE FOR REPAIRING AND/OR RESEEDING ALL AREAS THAT DO NOT DEVELOP WITHIN ONE YEAR FROM THE COMPLETION OF CONSTRUCTION.
9. ALL REFERENCED SOIL EROSION AND SEDIMENTATION CONTROLS INCLUDING MATERIALS USED, APPLICATION RATES AND THE INSTALLATION PROCEDURES SHALL BE PERFORMED PER THE "RHODE ISLAND EROSION AND SEDIMENTATION HANDBOOK", DATED 1993.

BMP MAINTENANCE SCHEDULE

1. ALL MAINTENANCE (INCLUDING CLEANING) REQUIRED DURING THE CONSTRUCTION PHASE OF THE PROJECT SHALL BE THE RESPONSIBILITY OF THE CONTRACTOR.
2. CONSTRUCTION EQUIPMENT AND TRAFFIC SHALL BE RESTRICTED FROM TRAVELING OVER THE INFILTRATION TRENCH AND/OR SUBSURFACE CHAMBER AREAS TO MINIMIZE COMPACTION OF THE SOIL.
3. MEASURES NEEDED TO ENSURE THE PROPER OPERATION OF THE STORMWATER DRAINAGE SYSTEMS AND WATER QUALITY CONTROL SYSTEMS TO INCLUDE INSPECTION, CLEANING AND REPAIRS TO ALL PIPES, INTAKE AND DISCHARGE STRUCTURES (INCLUDING RIP-RAP SPLASH PADS), CATCH BASIN SUMPS, AND MANHOLES.
4. INSPECTION OF ALL SLOPES, BERMS, AND OTHER CONTROL STRUCTURES (INCLUDING ROADWAY SIDE SLOPES, FOR STRUCTURAL INTEGRITY, STABILITY AND EVIDENCE OF SOIL EROSION, SHALL INCLUDE MAINTENANCE OF THESE STRUCTURES IF NECESSARY. INSPECTIONS SHALL BE PERFORMED FOLLOWING ALL RAIN EVENTS OF 1/2" INCH RAINFALL OR MORE IN A 24-HOUR PERIOD, OR BIMONTHLY IF NO RAINFALL EVENT OCCURS.
5. UPON COMPLETION OF PROJECT CONSTRUCTION, AND PRIOR TO VACATING THE SITE, THE CONTRACTOR SHALL CONDUCT A FINAL INSPECTION, REPAIR ANY VEGETATIVE SOIL EROSION AND SEDIMENTATION CONTROL MEASURES, (SEEDING, PLANTING, ETC.) WHERE REQUIRED, AND REPAIR (OR REMOVE WHERE APPROPRIATE) ANY TEMPORARY SOIL EROSION AND SEDIMENTATION CONTROL DEVICES. AFTER PERMANENT SOIL STABILIZATION ON THE ENTIRE SITE HAS OCCURRED, ALL TEMPORARY CONTROL MEASURES MUST BE REMOVED.
6. AFTER THE COMPLETION OF PROJECT CONSTRUCTION AND THE FINAL STABILIZATION OF THE ENTIRE SITE, THE INSPECTION AND MAINTENANCE OF ALL STORMWATER FACILITIES MUST BE PERFORMED.
7. REPLANTING, REGRADING, OR OTHER REPAIRS NEEDED AS A RESULT OF SOIL EROSION AND SEDIMENTATION PROCESSES SHALL BE DONE PROMPTLY TO ENSURE PROPER FUNCTIONING OF THE ENTIRE SYSTEM.
8. ANY TRASH, DEBRIS, ETC. SHOULD BE REMOVED FROM ANY WETLAND AREAS, SWALE, AND PIPE OUTLETS.

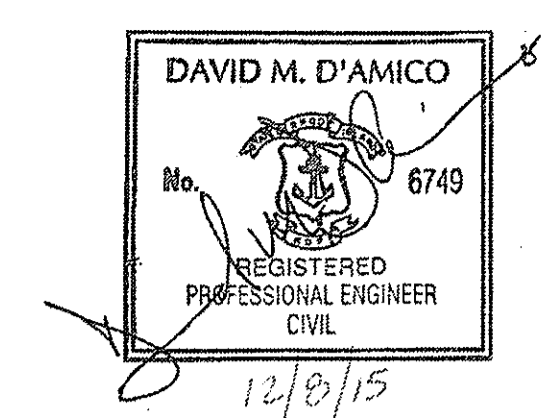

Saccoccio & Associates, Inc.
1085 Park Avenue
Cranston, Rhode Island 02910
tel 401.942.7970
fax 401.942.7975

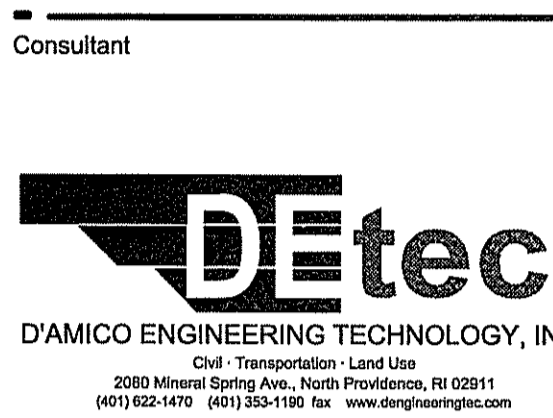

RENOVATIONS TO SMITHFIELD POLICE STATION

215 PLEASANT VIEW
SMITHFIELD, RI 02917

TOWN OF SMITHFIELD, RHODE ISLAND

NOTES:
REVISION NO. 1 - RIDEM COMMENTS OF 12-4-15

SHEET TITLE

GENERAL NOTES AND LEGEND

DRAWN BY: DMD JOB NUMBER: 15107
CHECKED BY: DMD DATE: 10-9-2015

C1.0

SCALE:

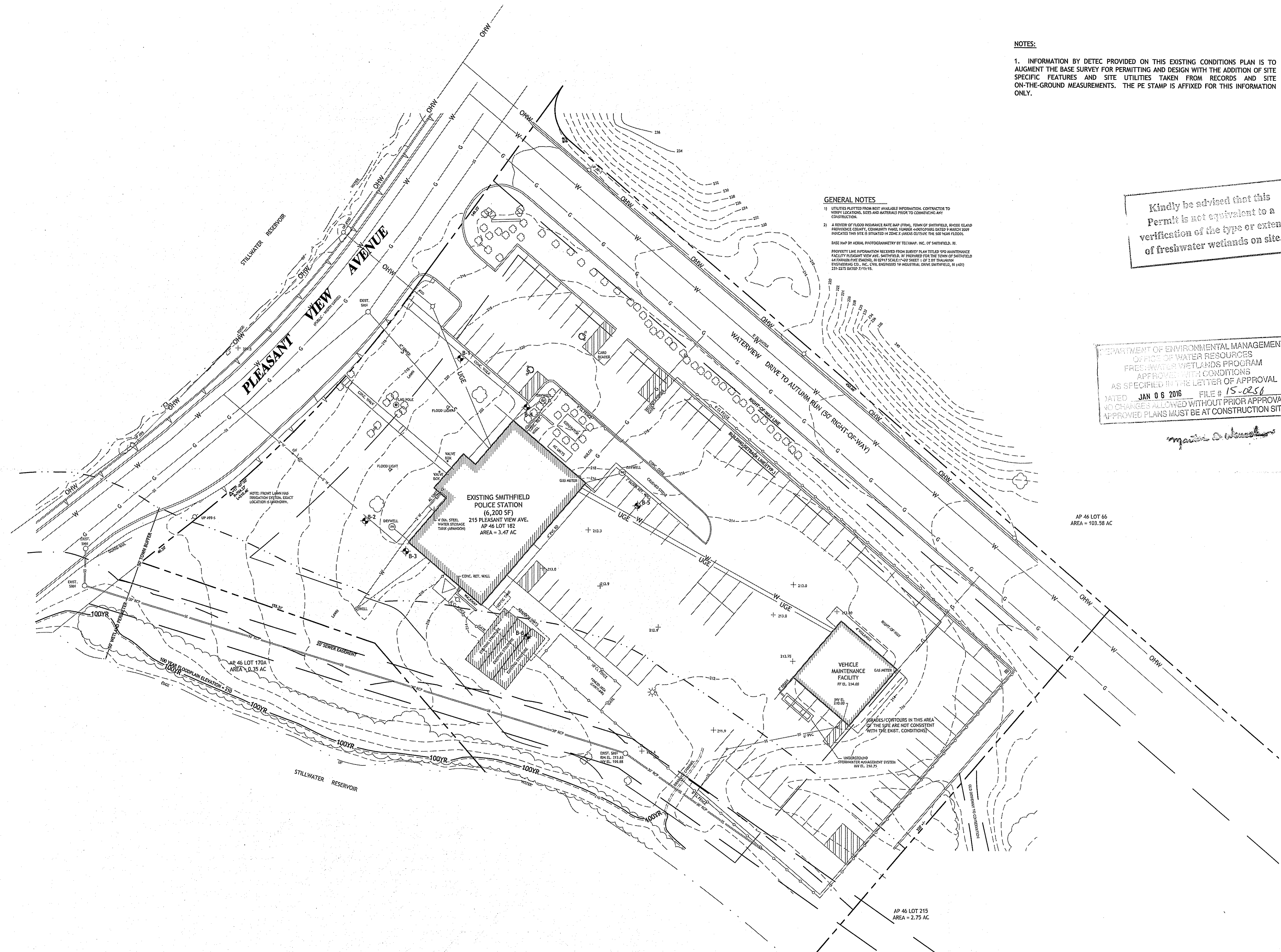

NOTES:
 1. INFORMATION BY DETEC PROVIDED ON THIS EXISTING CONDITIONS PLAN IS TO AUGMENT THE BASE SURVEY FOR PERMITTING AND DESIGN WITH THE ADDITION OF SITE SPECIFIC FEATURES AND SITE UTILITIES TAKEN FROM RECORDS AND SITE ON-THE-GROUND MEASUREMENTS. THE PE STAMP IS AFFIXED FOR THIS INFORMATION ONLY.

GENERAL NOTES
 1) UTILITIES PLOTTED FROM BEST AVAILABLE INFORMATION. CONTRACTOR TO VERIFY LOCATIONS, SIZES AND MATERIALS PRIOR TO COMMENCING ANY CONSTRUCTION.
 2) A REVIEW OF FLOOD INSURANCE RATE MAP (FIRM), TOWN OF SMITHFIELD, SHOOS (SLAD) PROVISIONS, COUNTY COMMUNITY PANEL NUMBER AND OTHERS DATED 9 MARCH 2007 INDICATES THIS SITE IS SITUATED IN ZONE X AREAS OUTSIDE THE 500 YEAR FLOOD.
 BASE MAP BY AERIAL PHOTOGRAMMETRY BY TECHMAP, INC. OF SMITHFIELD, RI.
 PROPERTY LINE INFORMATION RECEIVED FROM SURVEY PLAN TITLED "VEHICLE MAINTENANCE FACILITY PLANNING AND SITE LAYOUT" IN SMITHFIELD, RI DATED 12/15/15 BY THOMAS INCORPORATED, INC. CIVIL ENGINEER 19 INDUSTRIAL DRIVE SMITHFIELD, RI 02876 231-2275 DATED 12/15/15.

Kindly be advised that this Permit is not equivalent to a verification of the type or extent of freshwater wetlands on site.

DEPARTMENT OF ENVIRONMENTAL MANAGEMENT
 OFFICE OF WATER RESOURCES
 FRESHWATER WETLANDS PROGRAM
 APPROVED WITH CONDITIONS
 AS SPECIFIED IN THE LETTER OF APPROVAL
 DATED JAN 06 2016 FILE # 15-0251
 NO CHANGES ALLOWED WITHOUT PRIOR APPROVAL
 APPROVED PLANS MUST BE AT CONSTRUCTION SITE

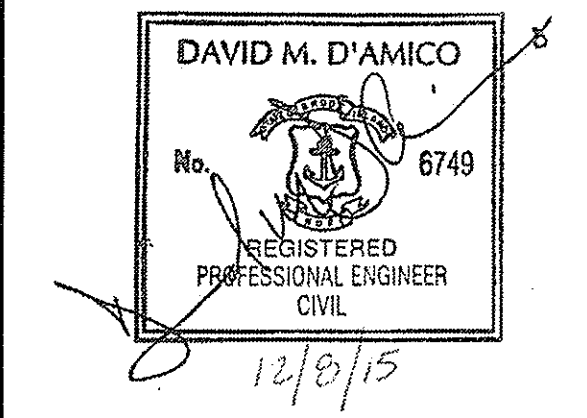

Saccoccio & Associates, Inc.
 1085 Park Avenue Cranston, Rhode Island 02910
 Tel 401.942.7970 Fax 401.942.7975



RENOVATIONS TO SMITHFIELD POLICE STATION

215 PLEASANT VIEW SMITHFIELD, RI 02917

TOWN OF SMITHFIELD, RHODE ISLAND

NOTES:
 REVISION NO. 1 - RIDEM COMMENTS OF 12-4-15

SHEET TITLE

EXISTING CONDITIONS

DRAWN BY: DMD JOB NUMBER: 15107
 CHECKED BY: DMD DATE: 10-9-2015

C2.0

SCALE:

ZONING CRITERIA	REQUIRED	EXISTING
ZONING DISTRICT	R-80	R-80*
MINIMUM LOT AREA	80,000 SF	151,153.2 SF
MINIMUM LOT FRONTAGE/WIDTH	200'	399.91'
MINIMUM FRONT YARD SETBACK	40'	88'
MINIMUM SIDE YARD SETBACK	25'	61.4'
MINIMUM REAR YARD SETBACK	75'	300'
MAXIMUM BUILDING HEIGHT	39'	30.83'
MAXIMUM LOT COVERAGE	10%	5.6%

*EXISTING NONCONFORMING USE.
 **PRIMARY STRUCTURE SETBACK.

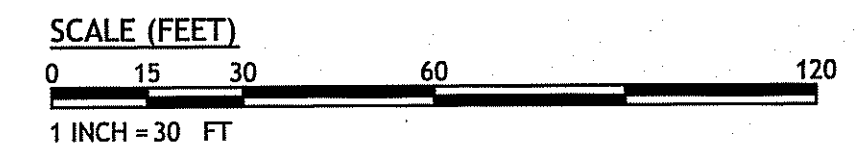

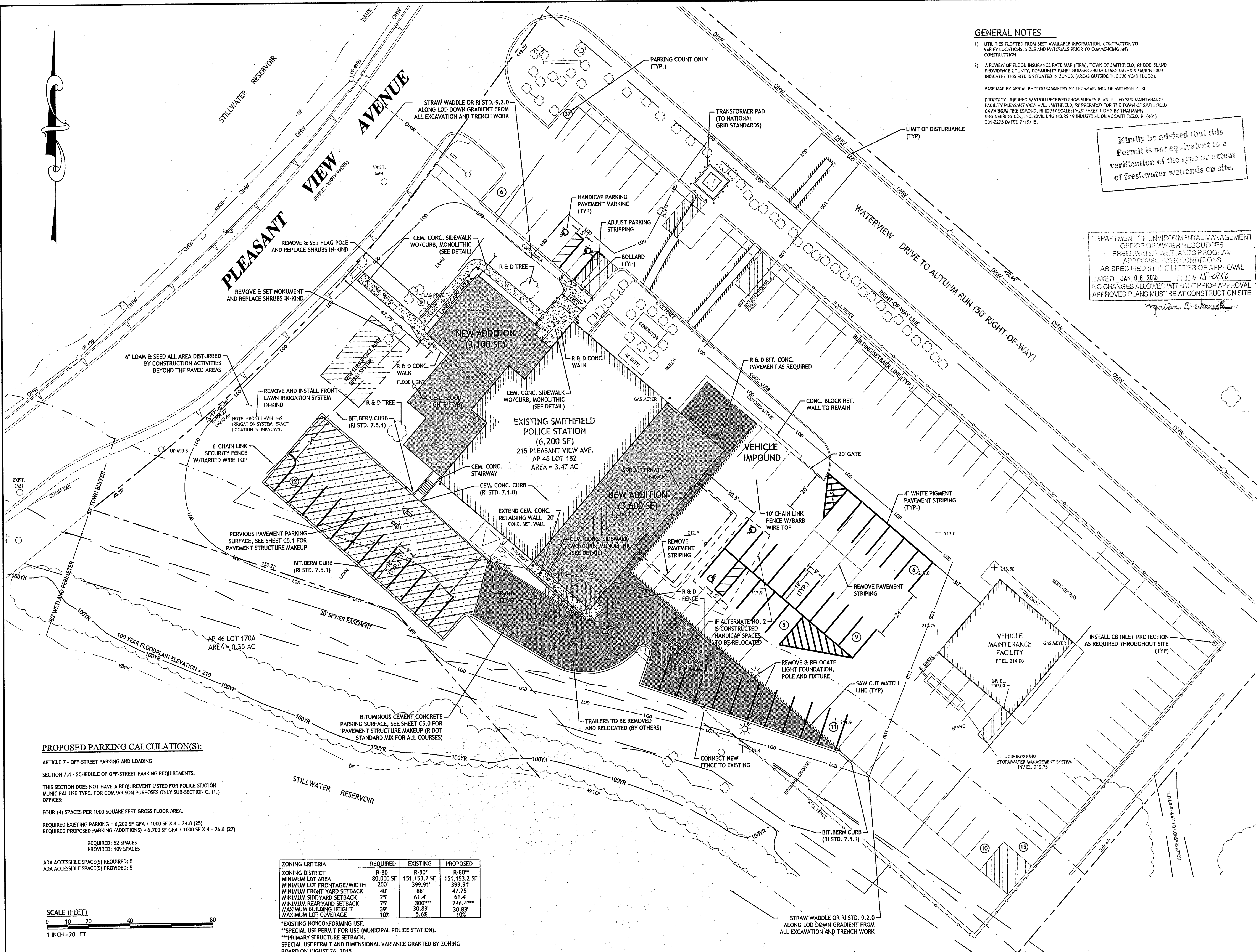

GENERAL NOTES

- UTILITIES PLOTTED FROM BEST AVAILABLE INFORMATION. CONTRACTOR TO VERIFY LOCATIONS, SIZES AND MATERIALS PRIOR TO COMMENCING ANY CONSTRUCTION.
- A REVIEW OF FLOOD INSURANCE RATE MAP (FIRM), TOWN OF SMITHFIELD, RHODE ISLAND PROVIDENCE COUNTY, COMMUNITY PANEL NUMBER 44007CD168G DATED 9 MARCH 2009 INDICATES THIS SITE IS SITUATED IN ZONE X (AREAS OUTSIDE THE 500 YEAR FLOOD).

BASE MAP BY AERIAL PHOTOGRAMMETRY BY TECHMAP, INC. OF SMITHFIELD, RI.

PROPERTY LINE INFORMATION RECEIVED FROM SURVEY PLAN TITLED SPD MAINTENANCE FACILITY PLEASANT VIEW AVE. SMITHFIELD, RI PREPARED FOR THE TOWN OF SMITHFIELD 64 FARNHAM PIKE ESMOND, RI 02917 SCALE: 1"=20' SHEET 1 OF 2 BY THALMANN ENGINEERING CO., INC. CIVIL ENGINEERS 19 INDUSTRIAL DRIVE SMITHFIELD, RI (401) 231-2275 DATED 7/15/15.

Kindly be advised that this Permit is not equivalent to a verification of the type or extent of freshwater wetlands on site.

DEPARTMENT OF ENVIRONMENTAL MANAGEMENT
OFFICE OF WATER RESOURCES
FRESHWATER WETLANDS PROGRAM
APPROVED WITH CONDITIONS
AS SPECIFIED IN THE LETTER OF APPROVAL
DATED JAN 06 2016 FILE # 15-0250
NO CHANGES ALLOWED WITHOUT PRIOR APPROVAL
APPROVED PLANS MUST BE AT CONSTRUCTION SITE

PROPOSED PARKING CALCULATION(S):

ARTICLE 7 - OFF-STREET PARKING AND LOADING
SECTION 7.4 - SCHEDULE OF OFF-STREET PARKING REQUIREMENTS.
THIS SECTION DOES NOT HAVE A REQUIREMENT LISTED FOR POLICE STATION MUNICIPAL USE TYPE. FOR COMPARISON PURPOSES ONLY SUB-SECTION C. (1.) OFFICES:
FOUR (4) SPACES PER 1000 SQUARE FEET GROSS FLOOR AREA.
REQUIRED EXISTING PARKING = 6,200 SF GFA / 1000 SF X 4 = 24.8 (25)
REQUIRED PROPOSED PARKING (ADDITIONS) = 6,700 SF GFA / 1000 SF X 4 = 26.8 (27)
REQUIRED: 52 SPACES
PROVIDED: 109 SPACES
ADA ACCESSIBLE SPACE(S) REQUIRED: 5
ADA ACCESSIBLE SPACE(S) PROVIDED: 5

ZONING CRITERIA	REQUIRED	EXISTING	PROPOSED
ZONING DISTRICT	R-80	R-80*	R-80**
MINIMUM LOT AREA	80,000 SF	151,153.2 SF	151,153.2 SF
MINIMUM LOT FRONTAGE/WIDTH	200'	399.91'	399.91'
MINIMUM FRONT YARD SETBACK	40'	88'	47.75'
MINIMUM SIDEYARD SETBACK	25'	61.4'	61.4'
MINIMUM REARYARD SETBACK	75'	300***	246.4***
MAXIMUM BUILDING HEIGHT	39'	30.83'	30.83'
MAXIMUM LOT COVERAGE	10%	5.6%	10%

*EXISTING NONCONFORMING USE.
**SPECIAL USE PERMIT FOR USE (MUNICIPAL POLICE STATION).
***PRIMARY STRUCTURE SETBACK.
SPECIAL USE PERMIT AND DIMENSIONAL VARIANCE GRANTED BY ZONING BOARD ON AUGUST 26, 2015.

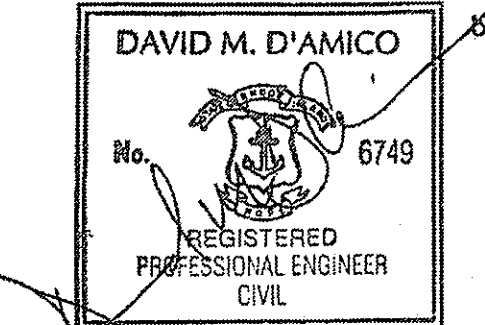
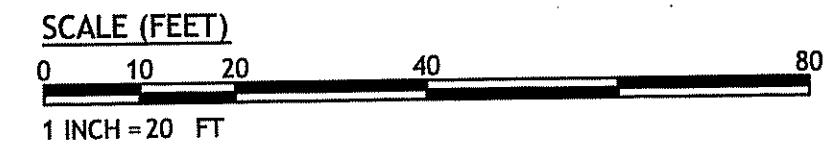

Saccoccio & Associates, Inc.
1085 Park Avenue
Cranston, Rhode Island 02910
tel 401.942.7970
fax 401.942.7975

Consultant



RENOVATIONS TO SMITHFIELD POLICE STATION

215 PLEASANT VIEW
SMITHFIELD, RI 02917

TOWN OF
SMITHFIELD,
RHODE ISLAND

NOTES:
REVISION NO. 1 - RIDEM COMMENTS OF 12-4-15

SHEET TITLE

SITE PLAN

DRAWN BY: DMD JOB NUMBER: 15107
CHECKED BY: DMD DATE: 10-9-2015

C3.0

SCALE:

Kindly be advised that this Permit is not equivalent to a verification of the type or extent of freshwater wetlands on site.

DEPARTMENT OF ENVIRONMENTAL MANAGEMENT
OFFICE OF WATER RESOURCES
FRESHWATER WETLANDS PROGRAM
APPROVED WITH CONDITIONS
AS SPECIFIED IN THE LETTER OF APPROVAL
DATED JAN. 06, 2016 FILE # 15-0250
CHANGES ALLOWED WITHOUT PRIOR APPROVAL
REVISED PLANS MUST BE AT CONSTRUCTION SITE

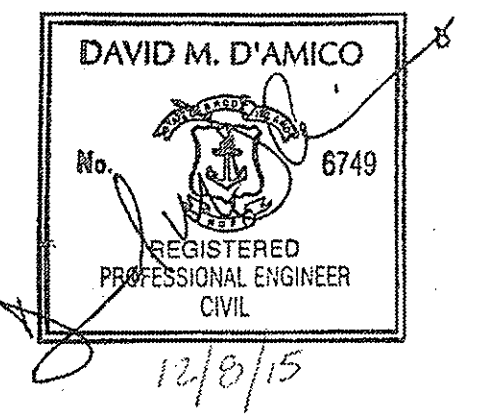

Saccoccio & Associates, Inc.
1085 Park Avenue Cranston, Rhode Island 02910 tel 401.942.7970 fax 401.942.7975



RENOVATIONS TO SMITHFIELD POLICE STATION

215 PLEASANT VIEW SMITHFIELD, RI 02917

TOWN OF SMITHFIELD, RHODE ISLAND

NOTES:
REVISION NO. 1 - RIDEM COMMENTS OF 12-4-15

SHEET TITLE

GRADING, DRAINAGE AND UTILITY PLAN

DRAWN BY: DMD JOB NUMBER: 15107
CHECKED BY: DMD DATE: 10-9-2015

C4.0

SCALE:

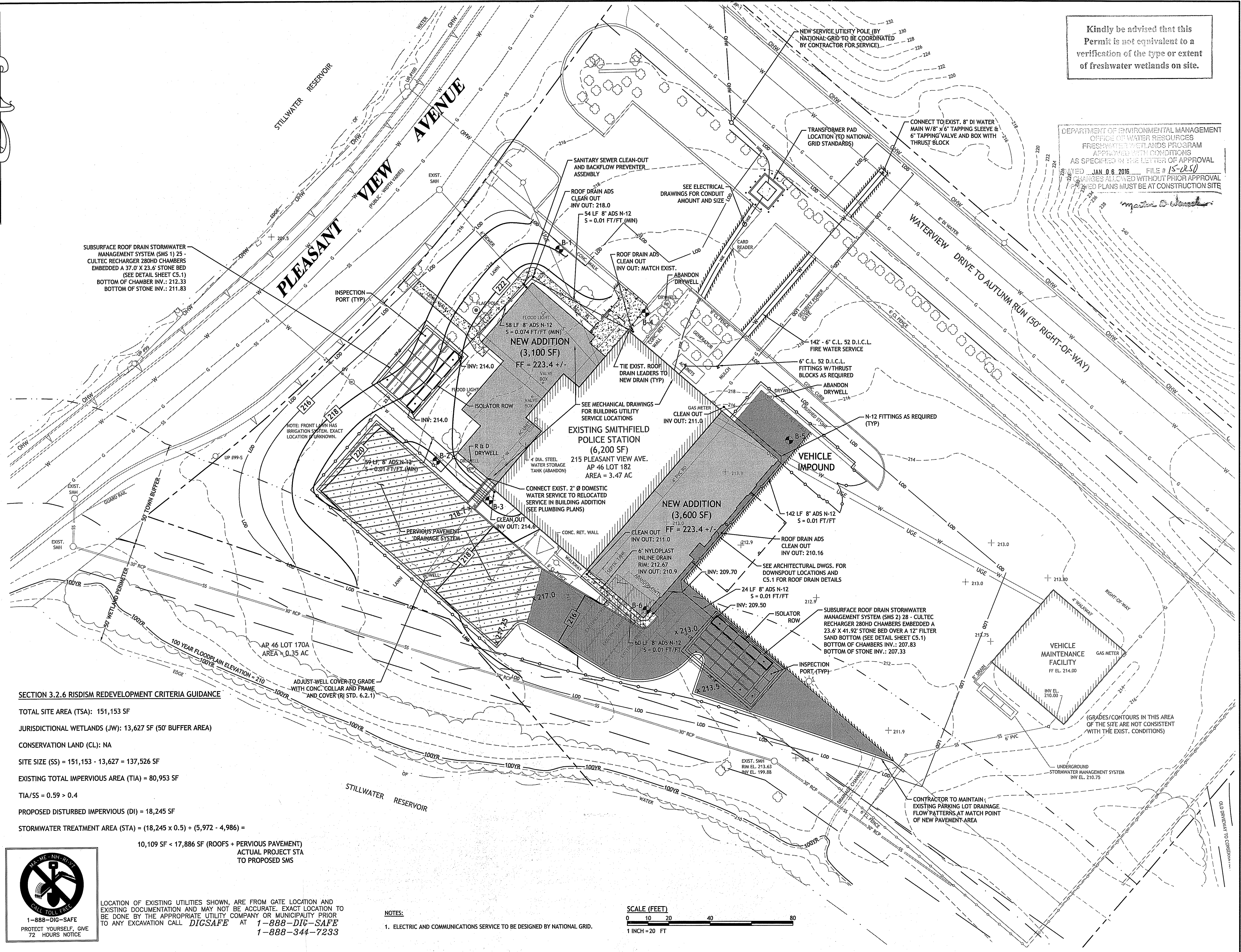

SECTION 3.2.6 RISIDM REDEVELOPMENT CRITERIA GUIDANCE

- TOTAL SITE AREA (TSA): 151,153 SF
- JURISDICTIONAL WETLANDS (JW): 13,627 SF (50' BUFFER AREA)
- CONSERVATION LAND (CL): NA
- SITE SIZE (SS) = 151,153 - 13,627 = 137,526 SF
- EXISTING TOTAL IMPERVIOUS AREA (TIA) = 80,953 SF
- TIA/SS = 0.59 > 0.4
- PROPOSED DISTURBED IMPERVIOUS (DI) = 18,245 SF
- STORMWATER TREATMENT AREA (STA) = (18,245 x 0.5) + (5,972 - 4,986) =

10,109 SF < 17,886 SF (ROOFS + PERVIOUS PAVEMENT)
ACTUAL PROJECT STA TO PROPOSED SMS



LOCATION OF EXISTING UTILITIES SHOWN, ARE FROM GATE LOCATION AND EXISTING DOCUMENTATION AND MAY NOT BE ACCURATE. EXACT LOCATION TO BE DONE BY THE APPROPRIATE UTILITY COMPANY OR MUNICIPALITY PRIOR TO ANY EXCAVATION CALL **DIGSAFE** AT **1-888-DIG-SAFE** OR **1-888-344-7233**

- NOTES:
1. ELECTRIC AND COMMUNICATIONS SERVICE TO BE DESIGNED BY NATIONAL GRID.

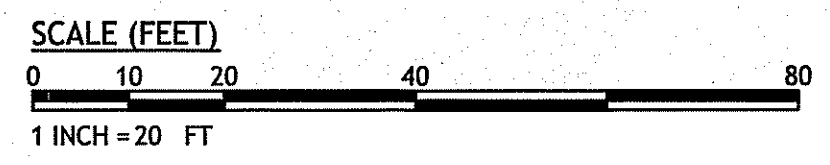

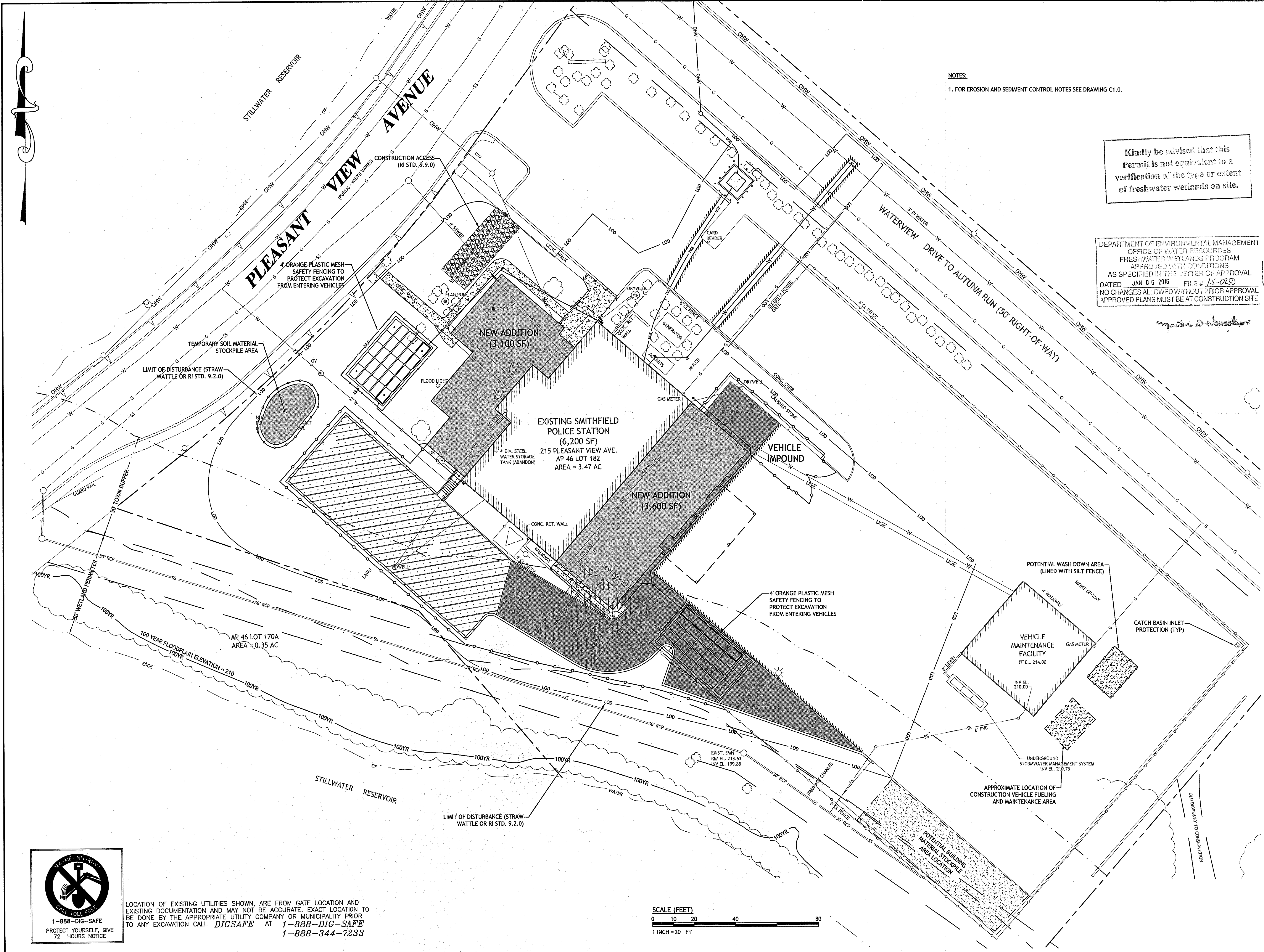

NOTES:
1. FOR EROSION AND SEDIMENT CONTROL NOTES SEE DRAWING C1.0.

Kindly be advised that this Permit is not equivalent to a verification of the type or extent of freshwater wetlands on site.

DEPARTMENT OF ENVIRONMENTAL MANAGEMENT
OFFICE OF WATER RESOURCES
FRESHWATER WETLANDS PROGRAM
APPROVED WITH CONDITIONS
AS SPECIFIED IN THE LETTER OF APPROVAL
DATED JAN 06 2016 FILE # 15-0250
NO CHANGES ALLOWED WITHOUT PRIOR APPROVAL
APPROVED PLANS MUST BE AT CONSTRUCTION SITE

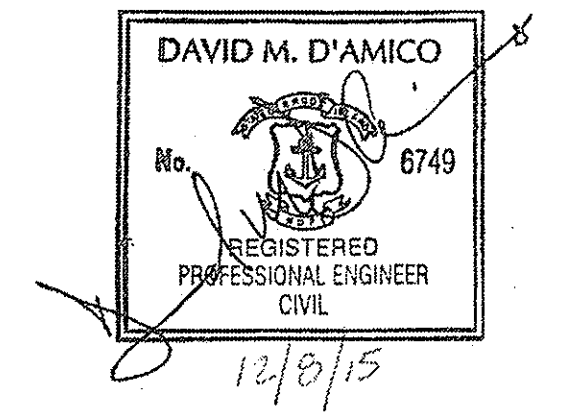

Saccoccio & Associates, Inc.
1085 Park Avenue Cranston, Rhode Island 02910 tel 401.942.7970 fax 401.942.7975

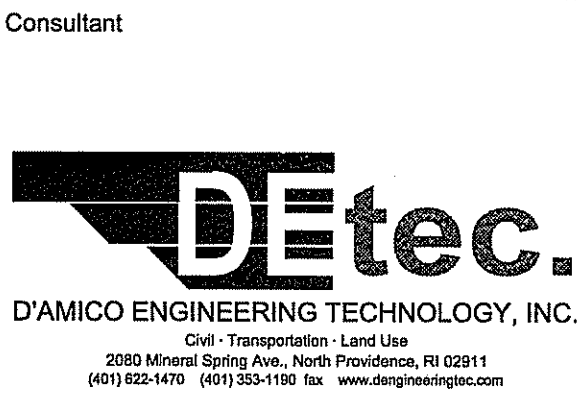

RENOVATIONS TO SMITHFIELD POLICE STATION

215 PLEASANT VIEW SMITHFIELD, RI 02917

TOWN OF SMITHFIELD, RHODE ISLAND

NOTES:
REVISION NO. 1 - RIDEM COMMENTS OF 12-4-15

SHEET TITLE

SOIL EROSION AND SEDIMENT CONTROL PLAN

DRAWN BY: DMD JOB NUMBER: 15107
CHECKED BY: DMD DATE: 10-9-2015

C4.1

SCALE:



LOCATION OF EXISTING UTILITIES SHOWN, ARE FROM GATE LOCATION AND EXISTING DOCUMENTATION AND MAY NOT BE ACCURATE. EXACT LOCATION TO BE DONE BY THE APPROPRIATE UTILITY COMPANY OR MUNICIPALITY PRIOR TO ANY EXCAVATION CALL DIGSAFE AT 1-888-DIG-SAFE 1-888-344-7233

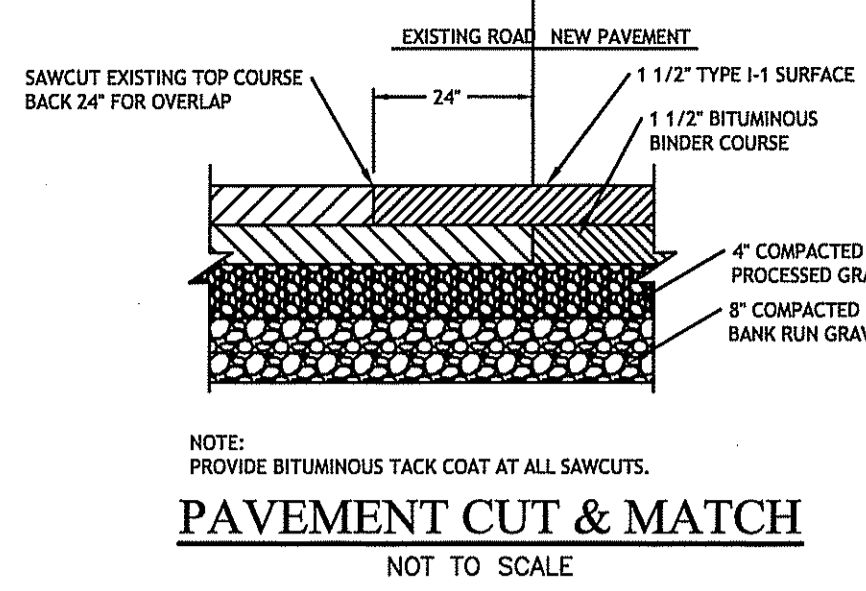

PAVEMENT CUT & MATCH
NOT TO SCALE

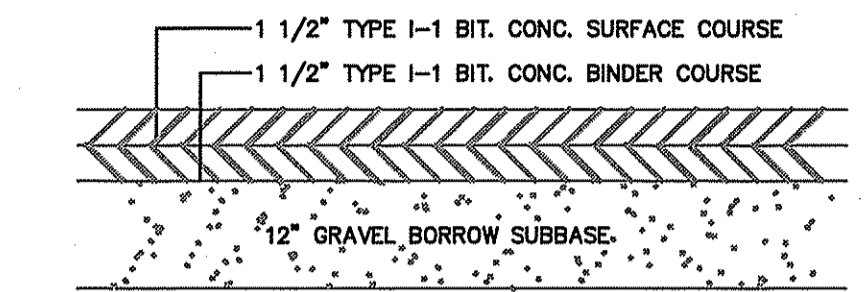

PAVEMENT CROSS SECTION
NOT TO SCALE

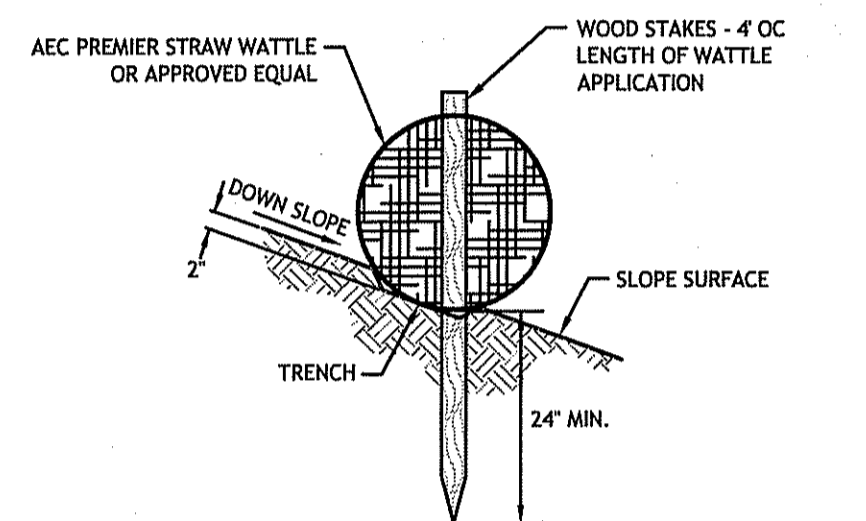

**STRAW WATTLE STAKE
DETAIL ON SOIL**
N.T.S.

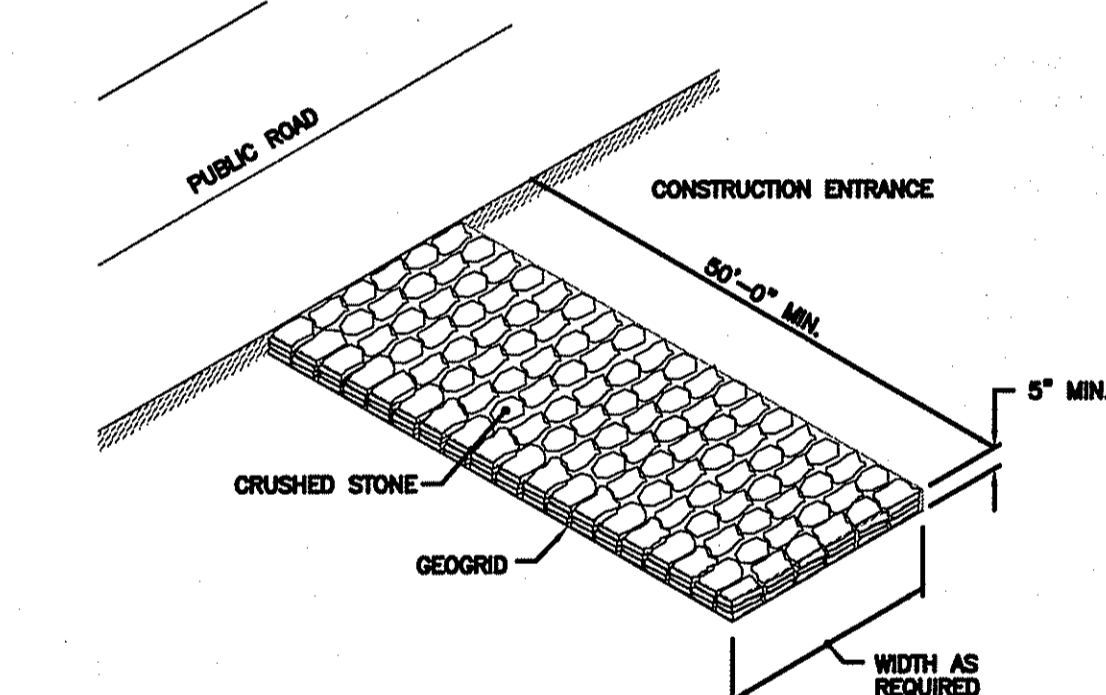

CONSTRUCTION ACCESS
N.T.S. R.I. STANDARD 9.9.0

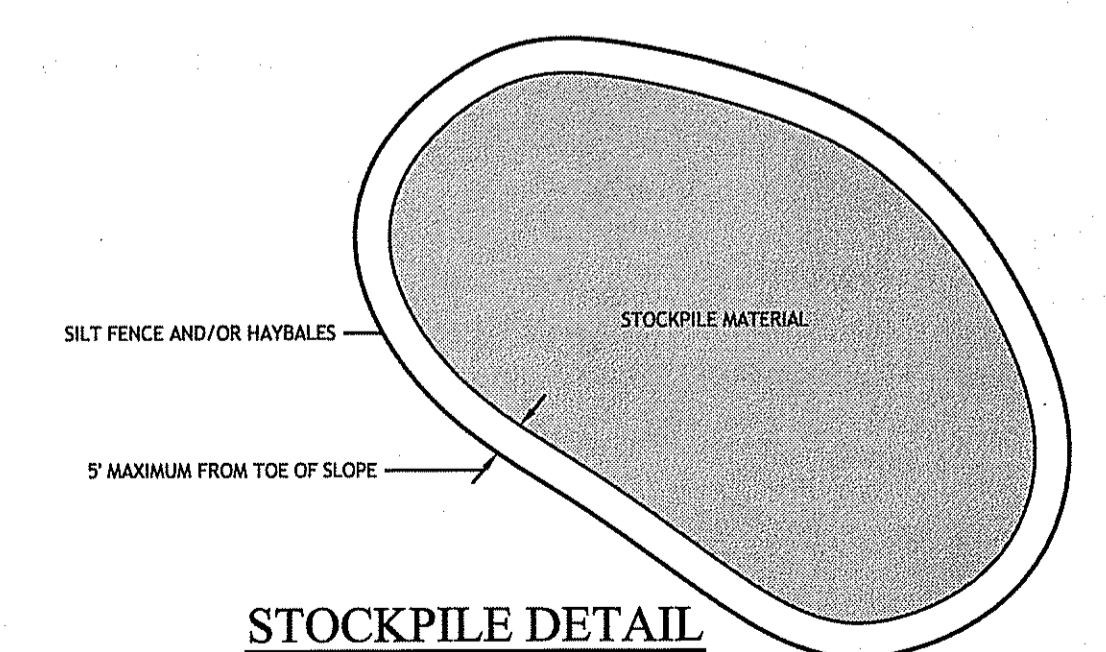

STOCKPILE DETAIL

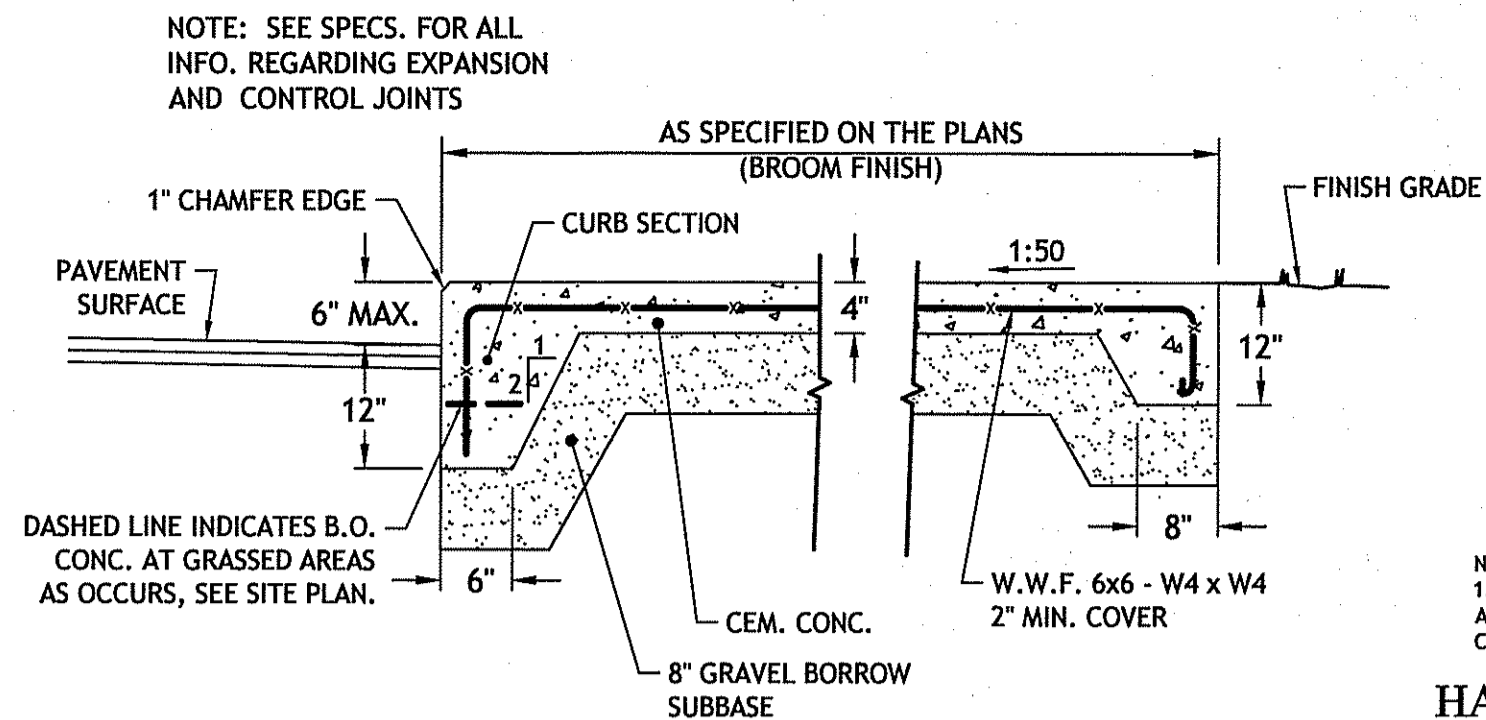

**CEMENT CONCRETE SIDEWALK AND CURB,
PAD OR WALKWAY - MONOLITHIC POUR**
N.T.S.

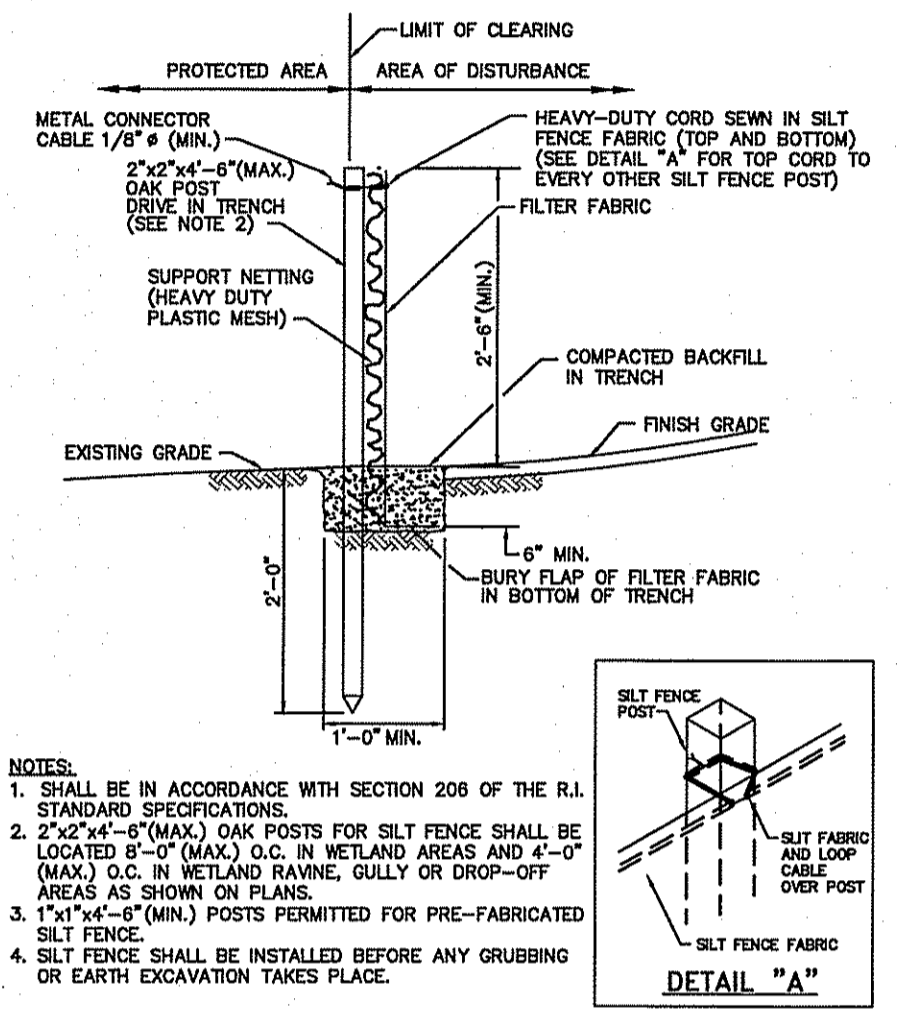

SILT FENCE DETAIL
R.I. STANDARD 9.2.0

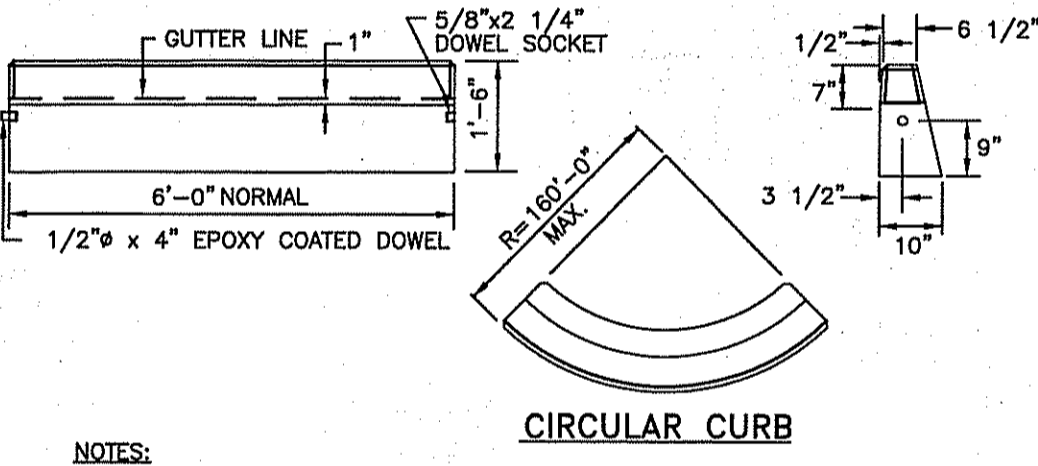

CIRCULAR CURB
NOTES:
1. SHALL BE IN ACCORDANCE WITH SECTION 906 OF THE R.I. STANDARD SPECIFICATIONS.
2. MINIMUM LENGTH OF STRAIGHT OR CIRCULAR FILLER PIECES TO BE 3'-0\"/>
3. EXPOSED SURFACES TO HAVE A SPONGE FLOAT FINISH.
4. CIRCULAR CURB IS REQUIRED ON CURVES WITH RADII OF 160'-0\"/>
5. EXPOSED EDGES TO HAVE A 3/4\"/>

PRECAST CONCRETE CURB
STANDARD 7.1.0

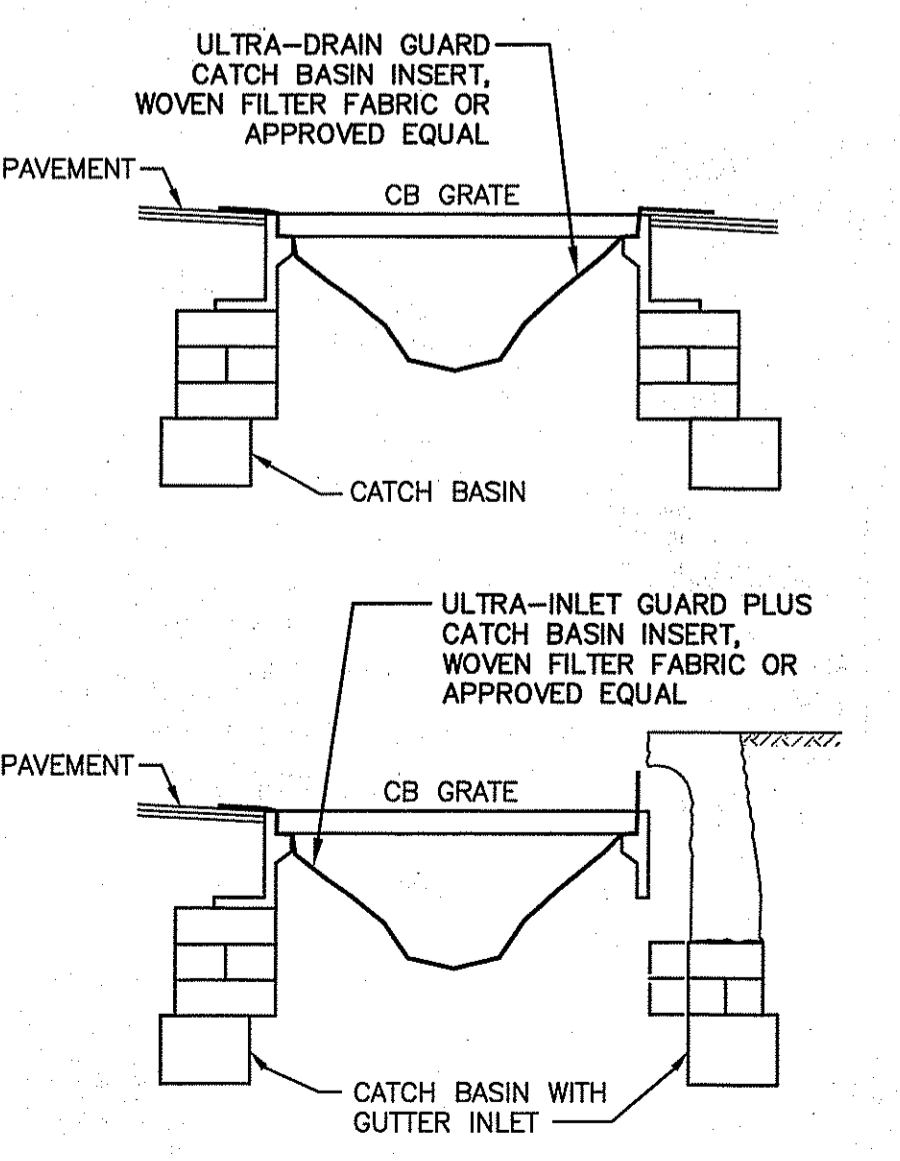

**CATCH BASIN INLET PROTECTION
IN CONSTRUCTION AREA**
NOT TO SCALE

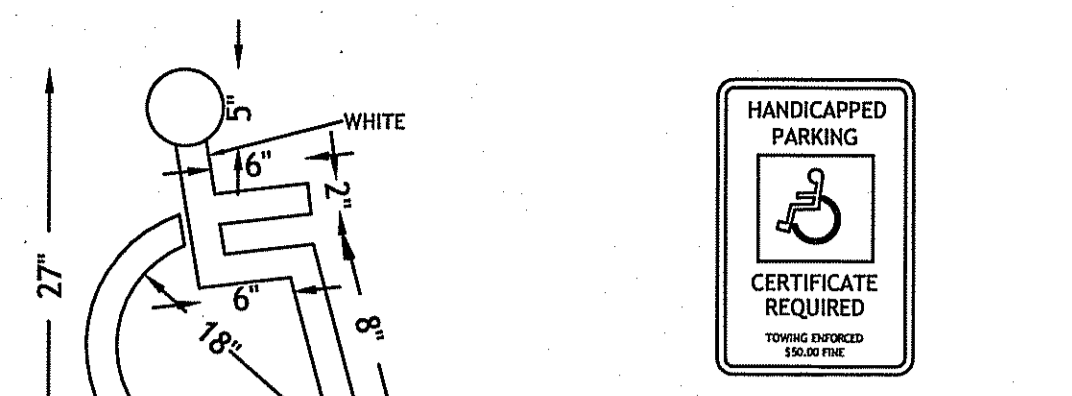

HANDICAP PAVEMENT MARKING
NOT TO SCALE

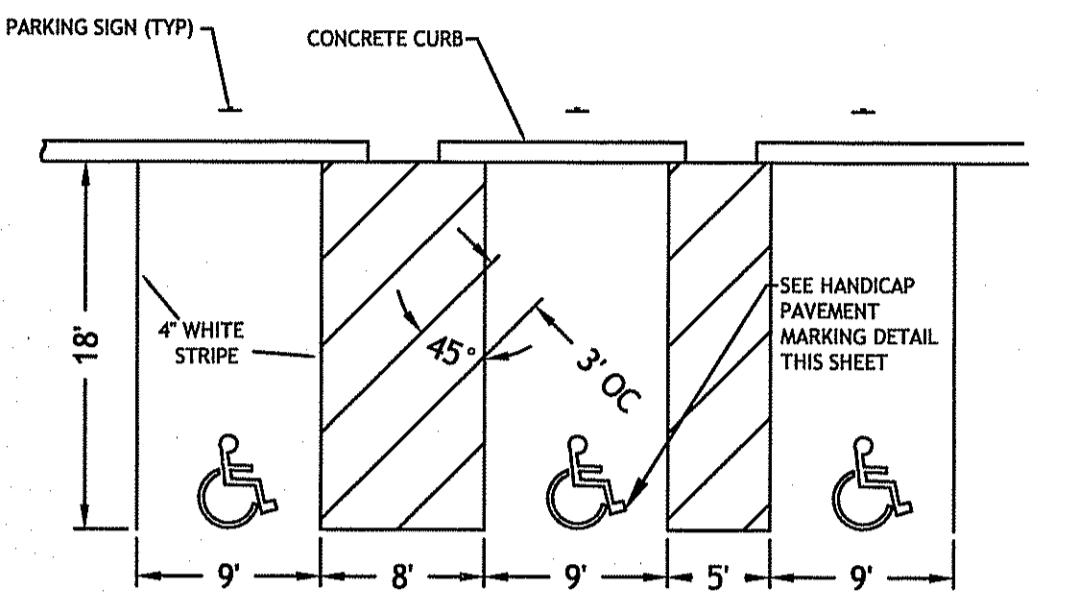

HANDICAP PARKING STALLS
NOT TO SCALE

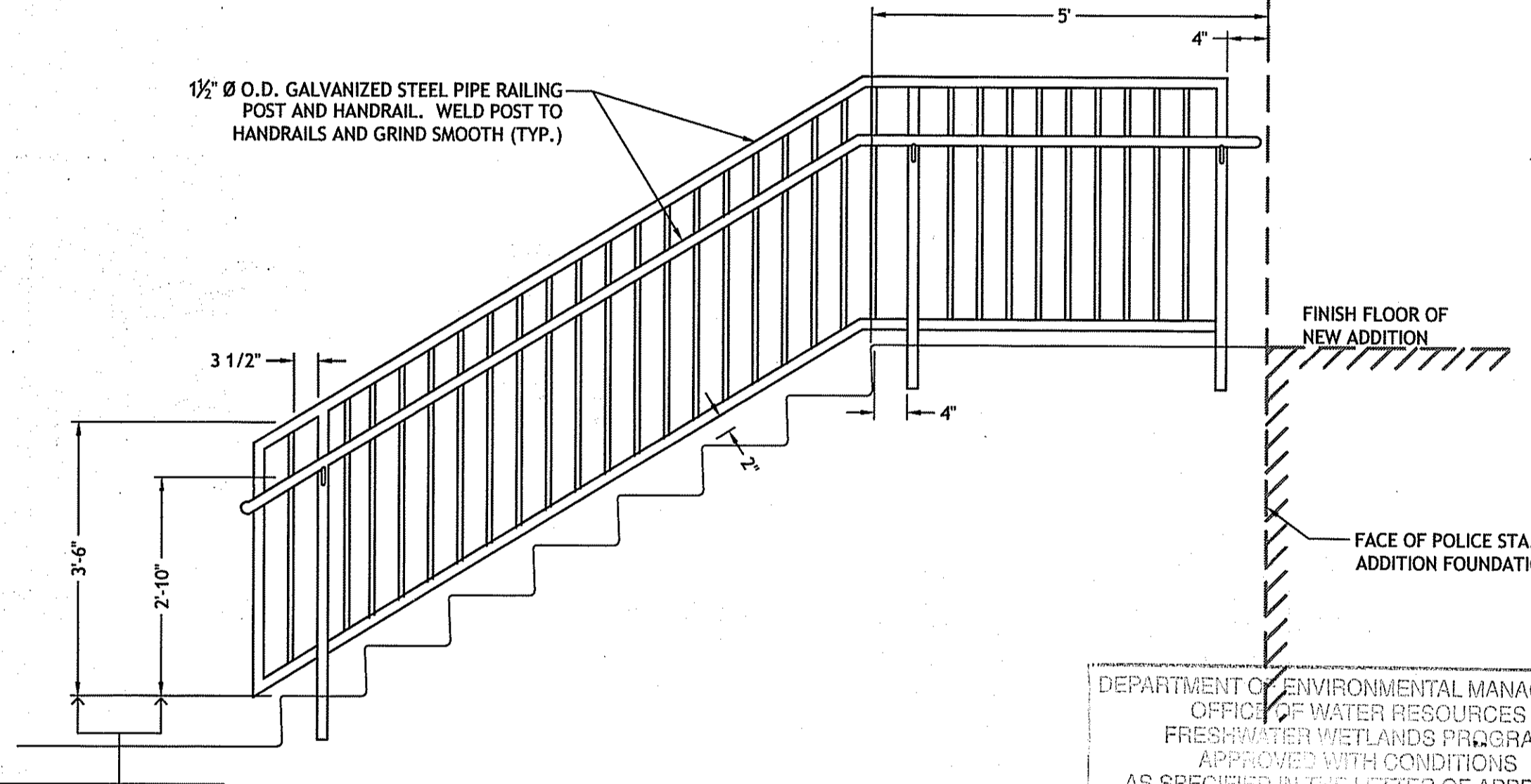

TYPICAL STAIR RAILING DETAIL
NOT TO SCALE

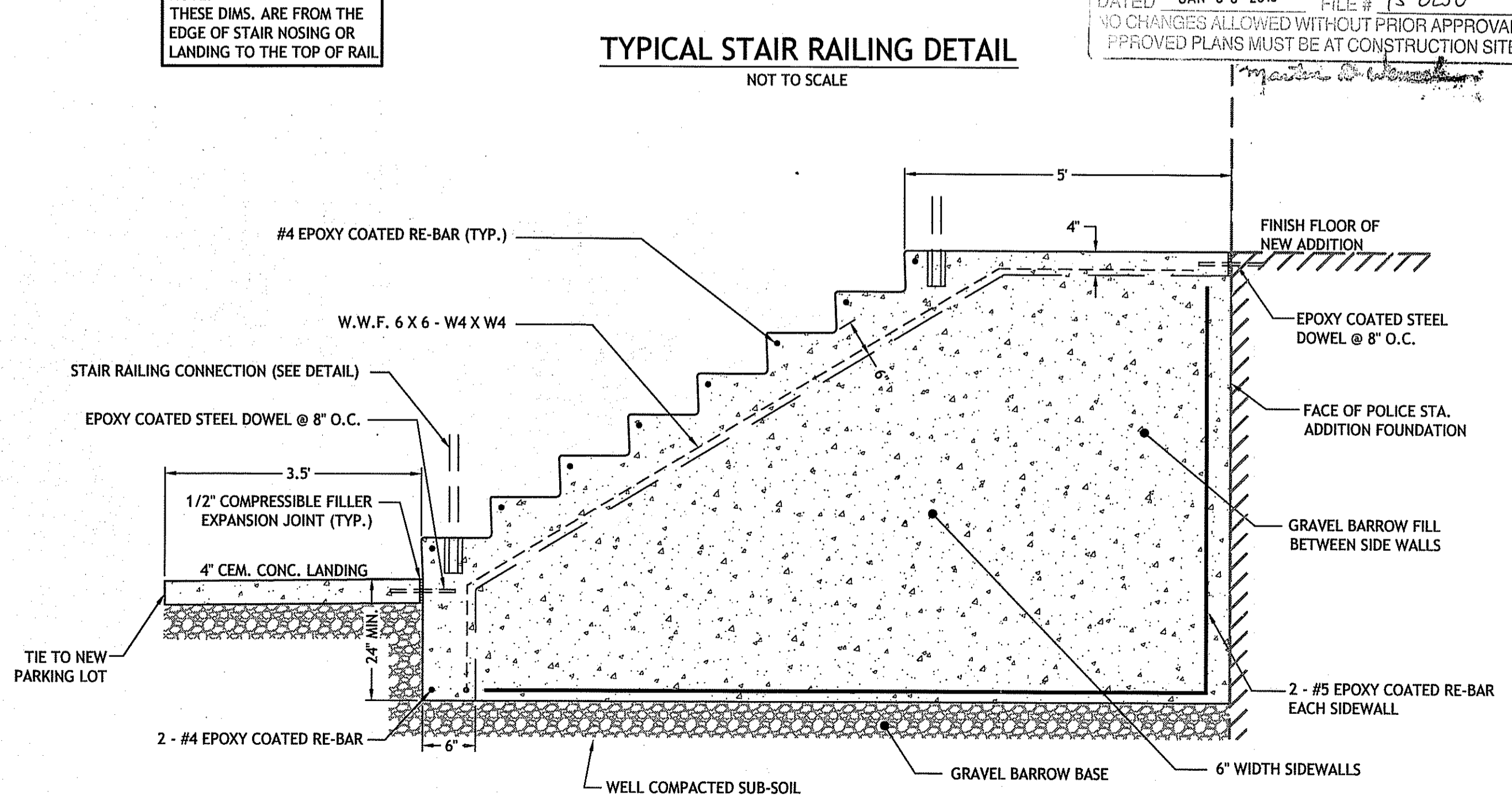

TYPICAL STAIRWAY CROSS SECTION DETAIL
NOT TO SCALE



HANDICAPPED PARKING SIGNS
NOT TO SCALE

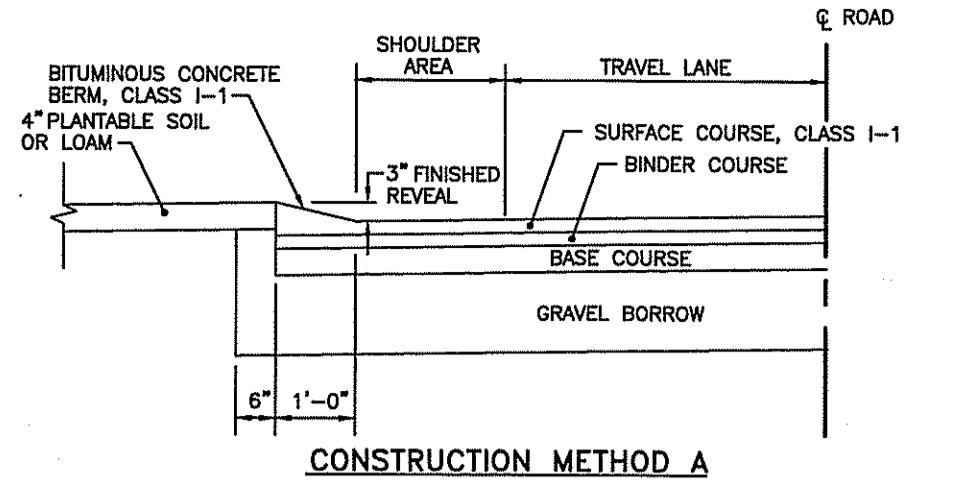

CONSTRUCTION METHOD A

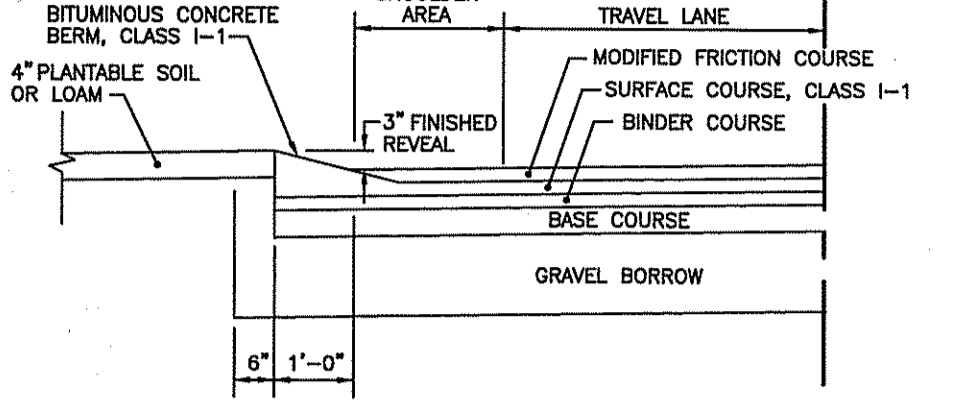

CONSTRUCTION METHOD B

BITUMINOUS BERM
R.I. STANDARD 7.5.1

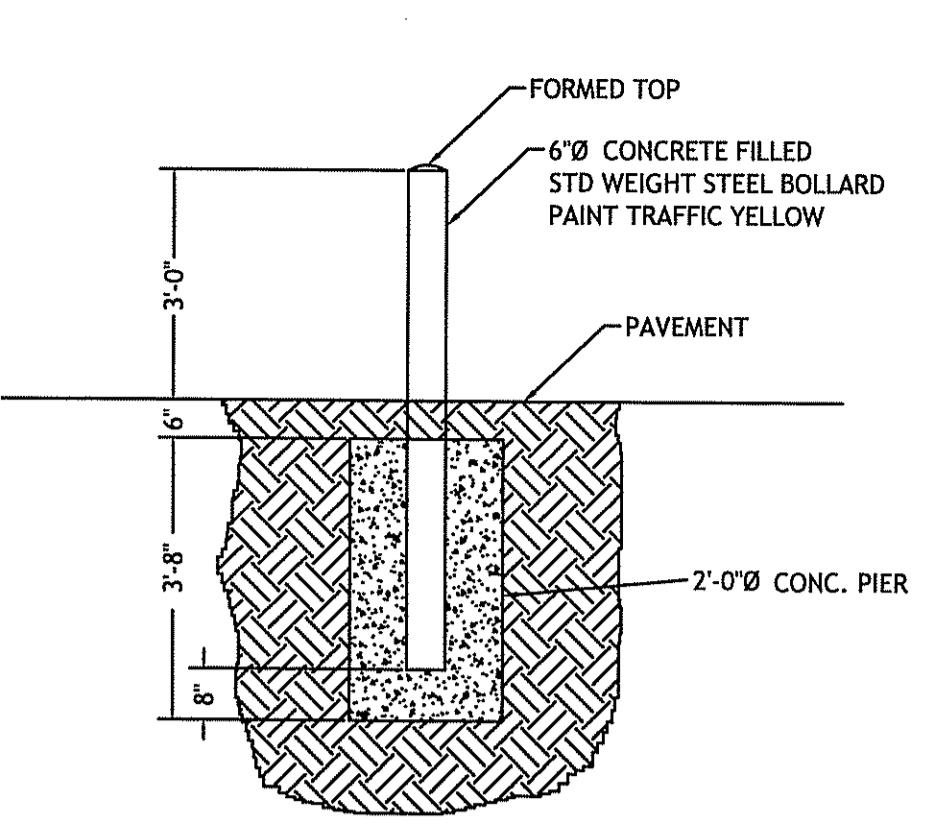

TYPICAL BOLLARD DETAIL
NOT TO SCALE

NOTES:
1. SHALL BE IN ACCORDANCE WITH SECTION 906 OF THE R.I. STANDARD SPECIFICATIONS.
2. BITUMINOUS BERM CAN BE PLACED AT THE SAME TIME THAT THE SURFACE COURSE LAYER IS PLACED ON THE PROJECT ROADWAY, OR IT CAN BE INSTALLED IN A SEPARATE OPERATION.

Kindly be advised that this Permit is not equivalent to a verification of the type or extent of freshwater wetlands on site.

DEPARTMENT OF ENVIRONMENTAL MANAGEMENT
OFFICE OF WATER RESOURCES
FRESHWATER WETLANDS PROGRAM
APPROVED WITH CONDITIONS
AS SPECIFIED IN THE LETTER OF APPROVAL
DATED JAN 06 2016 FILE # 15-0150
NO CHANGES ALLOWED WITHOUT PRIOR APPROVAL
APPROVED PLANS MUST BE AT CONSTRUCTION SITE

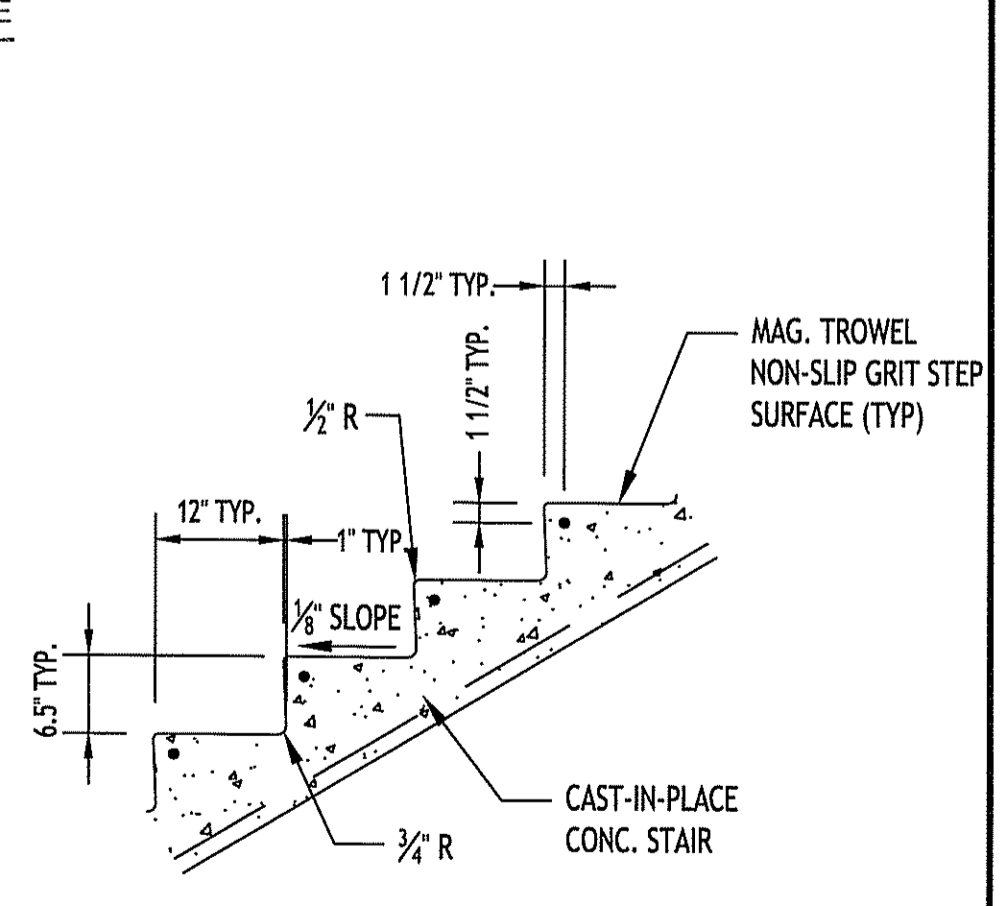
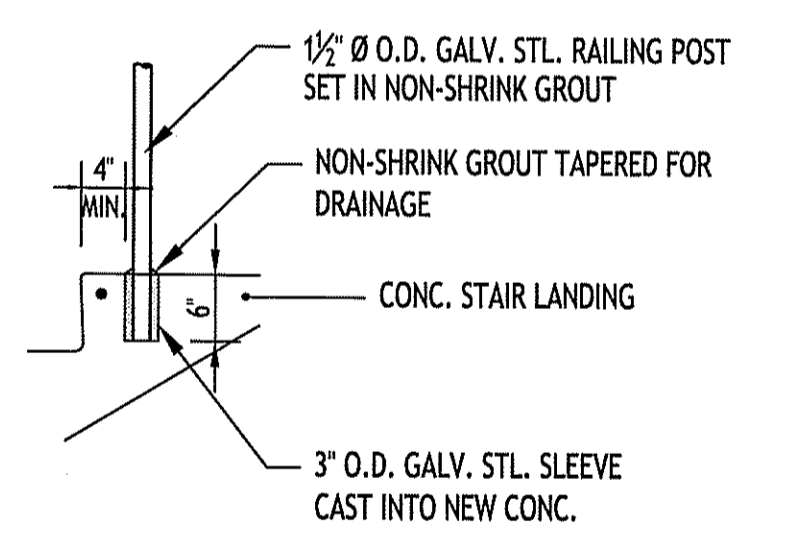
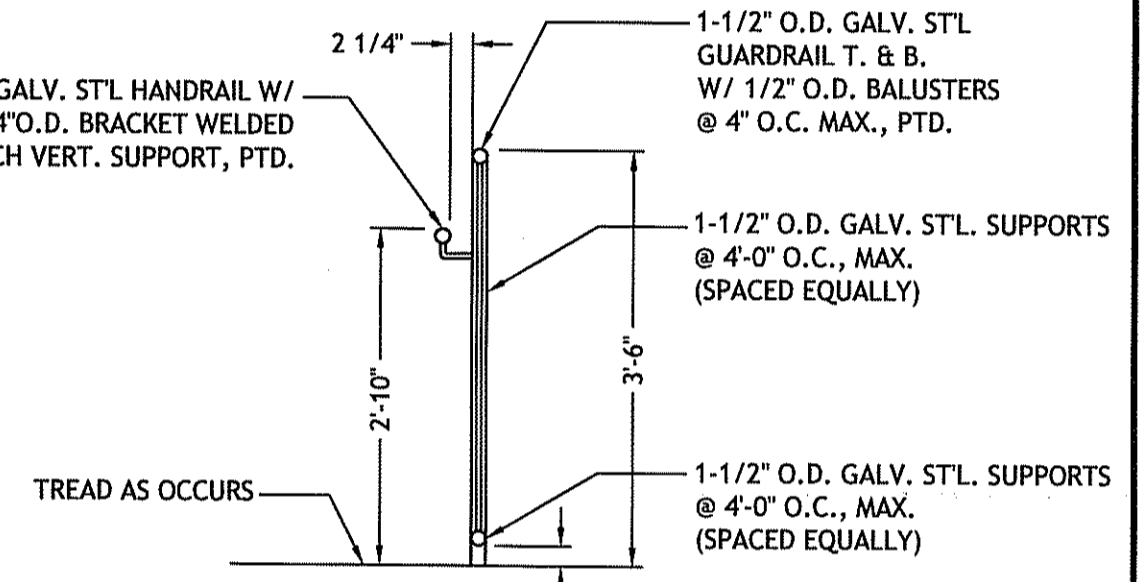

TYPICAL CONCRETE STAIR DETAIL
NOT TO SCALE

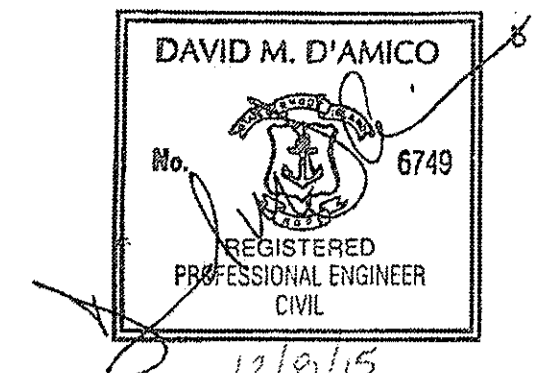

Saccoccio & Associates, Inc.
1085 Park Avenue Cranston, Rhode Island 02910
tel 401.942.7970 fax 401.942.7975



RENOVATIONS TO SMITHFIELD POLICE STATION

215 PLEASANT VIEW SMITHFIELD, RI 02917

TOWN OF SMITHFIELD, RHODE ISLAND

NOTES:
REVISION NO. 1 - RIDEM COMMENTS OF 12-4-15

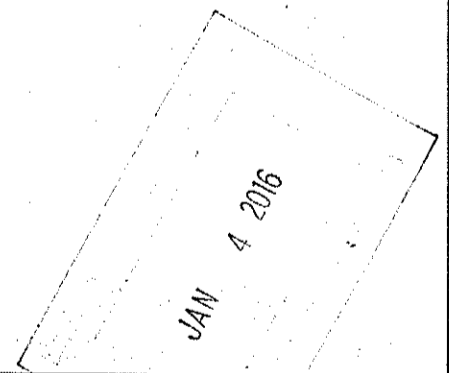

SHEET TITLE

SITE DETAILS NO. 1

DRAWN BY: DMD JOB NUMBER: 15107
CHECKED BY: DMD DATE: 10-9-2015

C5.0

SCALE:

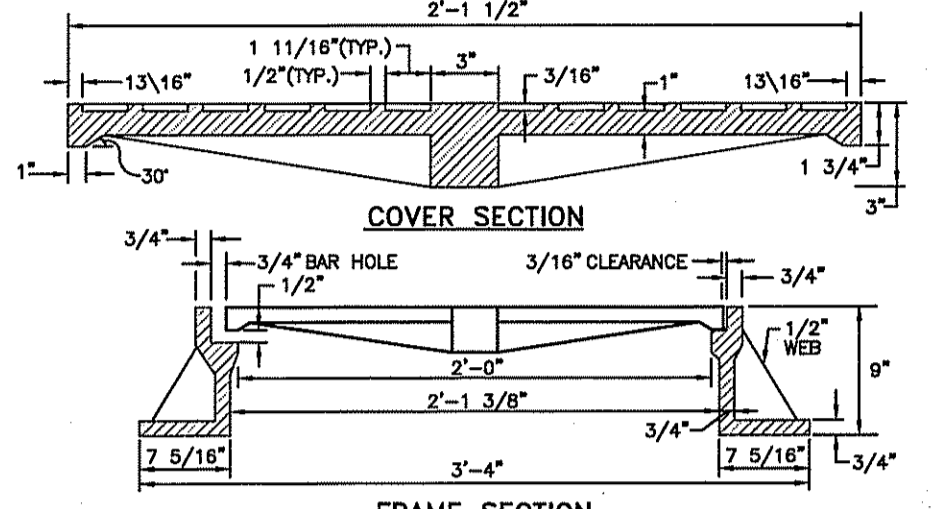
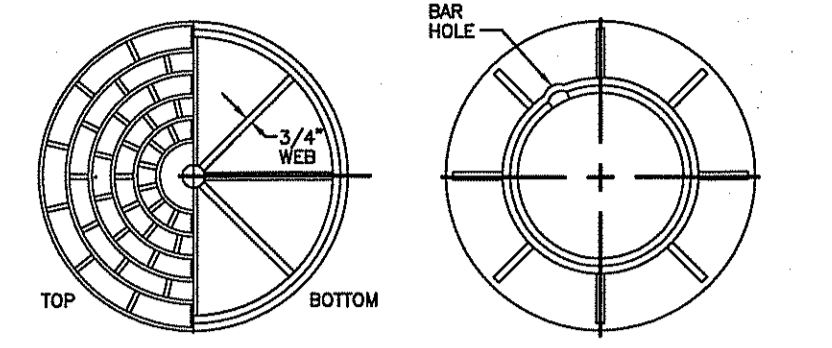

NOTES:
 1. FRAME AND GRATE SHALL CONFORM TO SECTION M.04 OF THE R.I. STANDARD SPECIFICATIONS.
 2. FRAME AND COVER SEATS MUST HAVE MACHINE FINISH.
HEAVY-DUTY ROUND FRAME AND COVER
 ALL STANDARD **6.2.1**

3" POROUS BITUMINOUS CONCRETE (2 - 1-1/2" LIFTS)
 (POROUS ASPHALT MIX DESIGN - SEE RI STORMWATER DESIGN MANUAL, APPENDIX F: PAGE F-48, TABLE F-10)

8" MIN. TO 12" FILTER FINE AGGREGATE LEVELING COURSE (AASHTO M-6 - SEE RI STORMWATER DESIGN MANUAL, APPENDIX F: PAGE F-42, TABLE F-7)

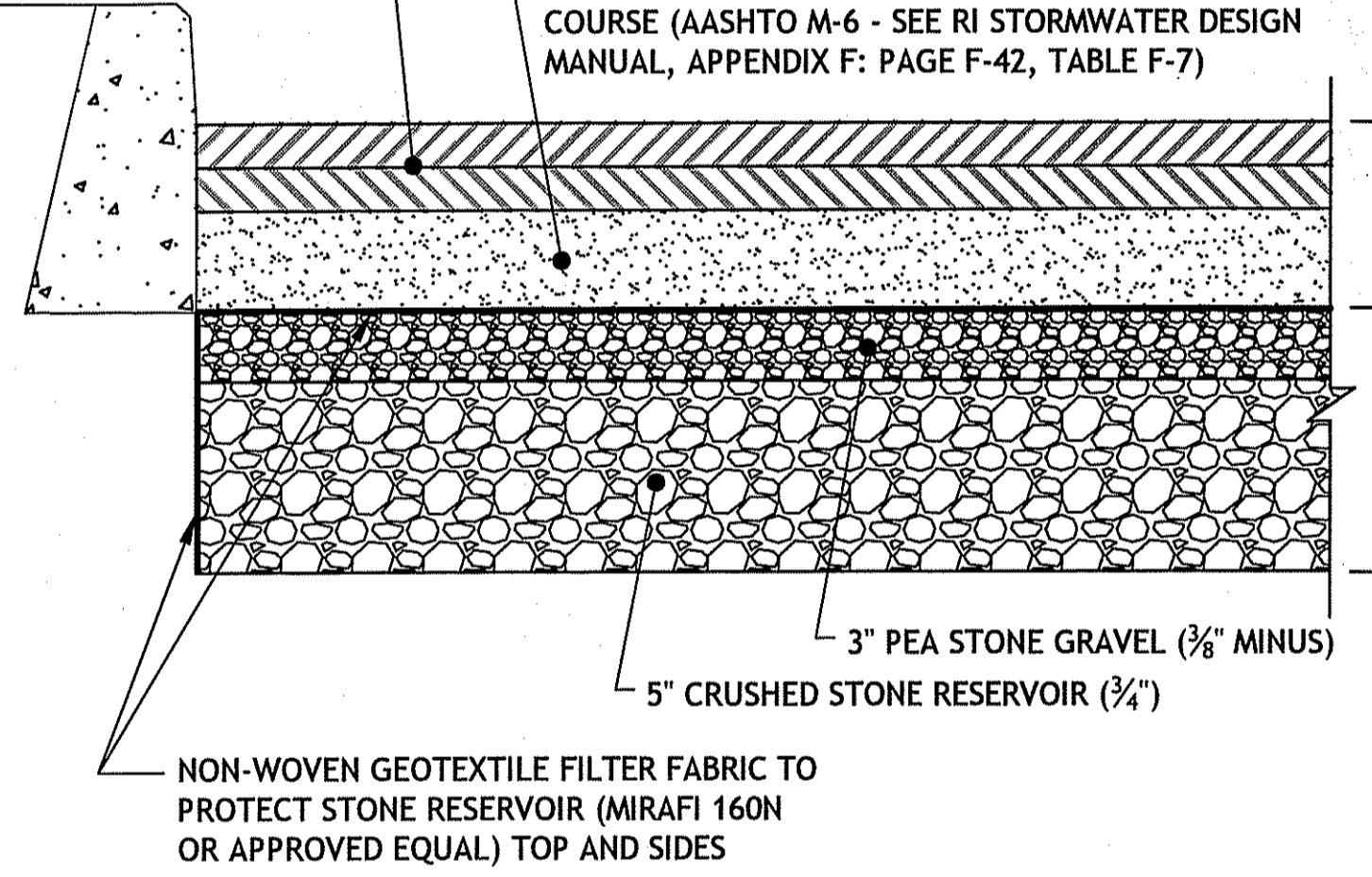

PERVIOUS PAVEMENT CROSS SECTION
 NOT TO SCALE

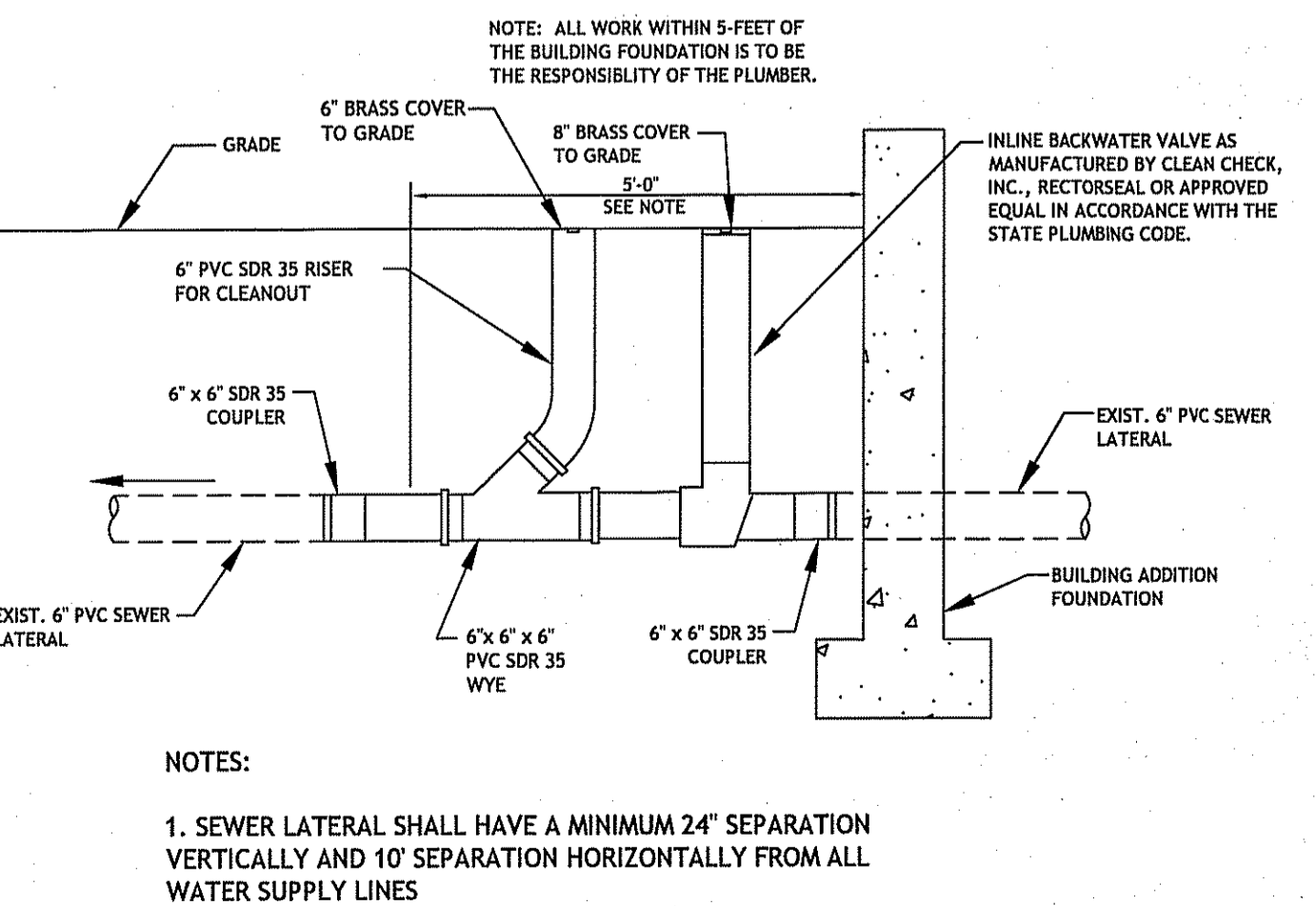

SEWER SERVICE LATERAL AT BUILDING DETAIL
 NOT TO SCALE

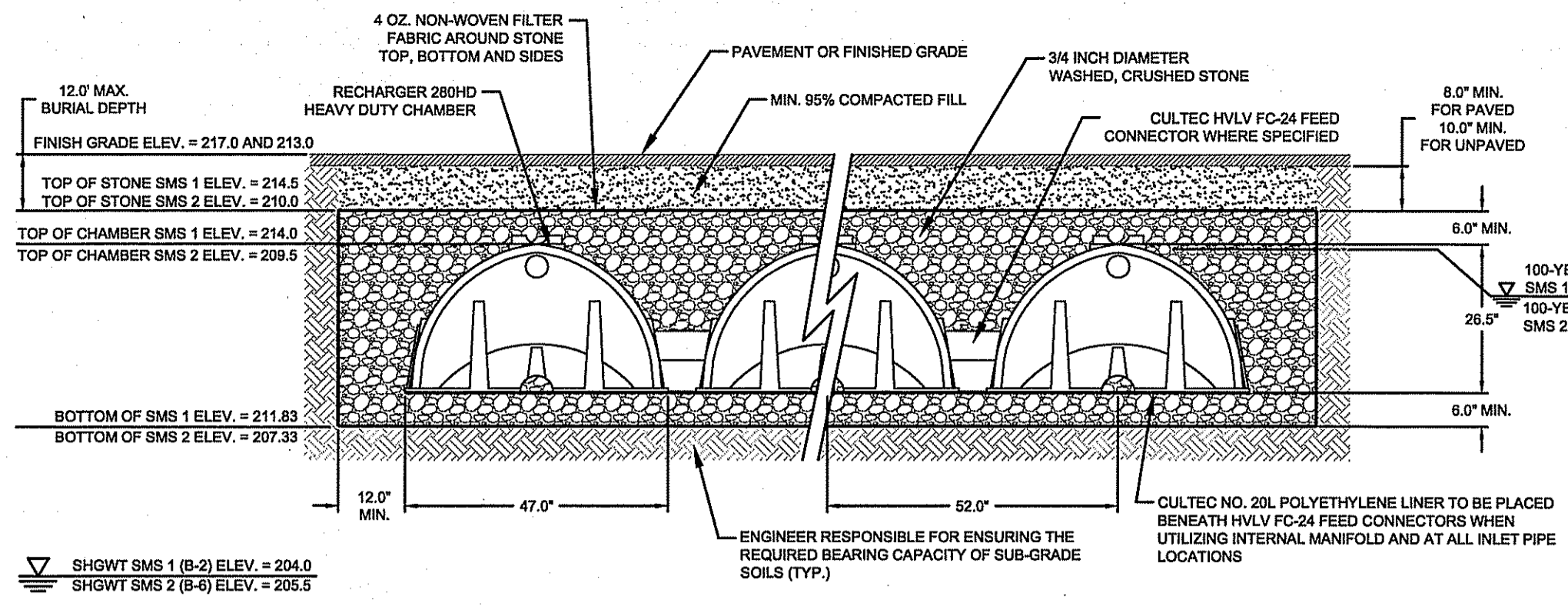

GENERAL NOTES BY CULTEC, INC. OF BROOKFIELD, CT. RECHARGER 280HD HEAVY DUTY UNITS ARE MARKED WITH A COLOR STRIPE FORMED INTO THE PART ALONG THE LENGTH OF THE CHAMBER. REFER TO CULTEC, INC.'S CURRENT RECOMMENDED INSTALLATION GUIDELINES. MAXIMUM ALLOWED COVER OVER TOP OF UNIT SHALL BE 12". THE CHAMBER WILL BE DESIGNED TO WITHSTAND TRAFFIC LOADS WHEN INSTALLED ACCORDING TO CULTEC'S RECOMMENDED INSTALLATION GUIDELINES.

ALL RECHARGER 280HD HEAVY DUTY UNITS ARE MARKED WITH A COLOR STRIPE FORMED INTO THE PART ALONG THE LENGTH OF THE CHAMBER. ALL RECHARGER 280HD CHAMBERS MUST BE INSTALLED IN ACCORDANCE WITH ALL APPLICABLE LOCAL, STATE AND FEDERAL REGULATIONS.

CROSS SECTION VIEW FOR SMS 1 AND 2
 NOT TO SCALE

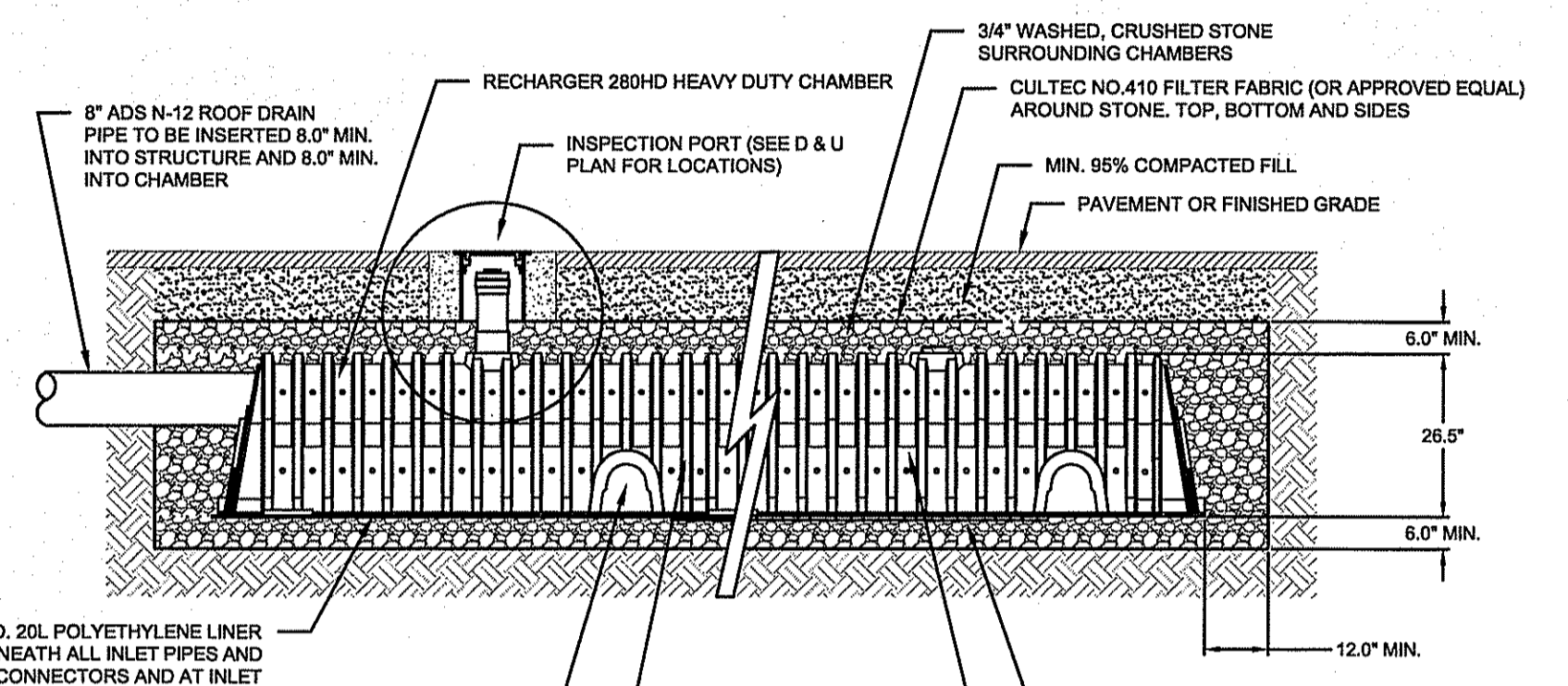

WQV BMP ISOLATOR ROW
 NOT TO SCALE

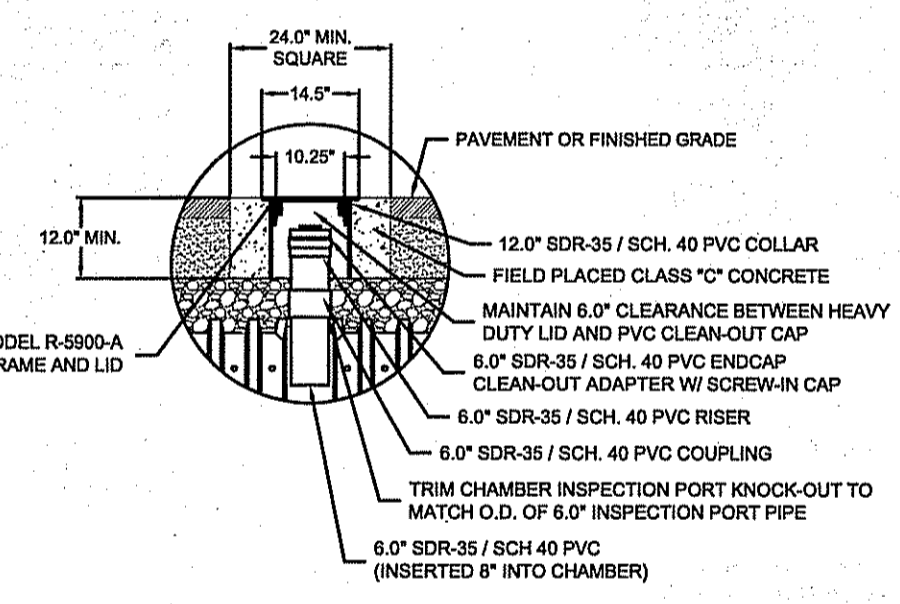

INSPECTION PORT DETAIL
 NOT TO SCALE

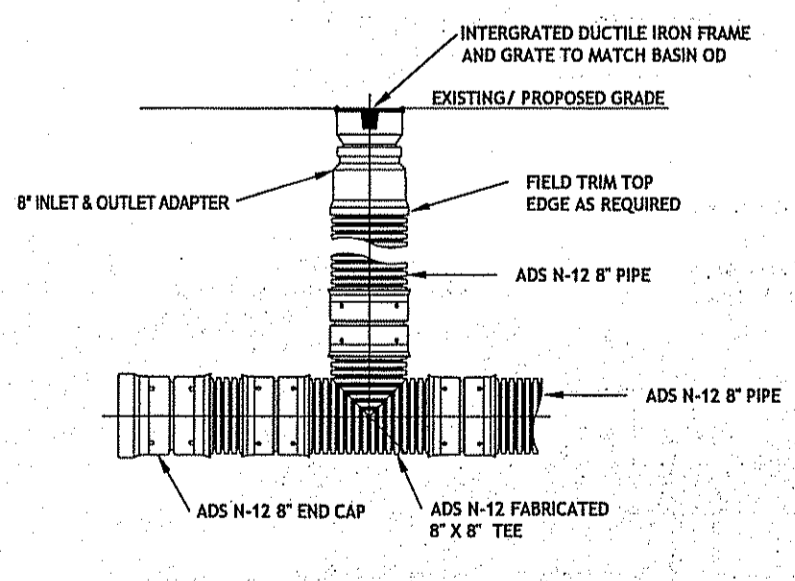

8" INLINE DRAIN (NYLOPLAST)
 N.T.S.

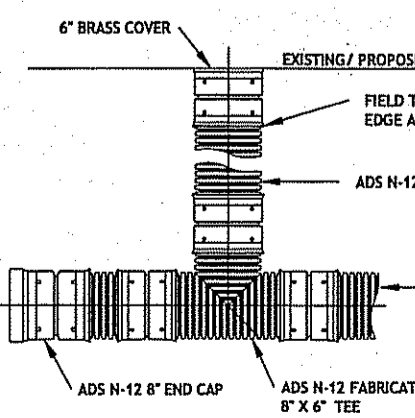

ADS CLEANOUT
 N.T.S.

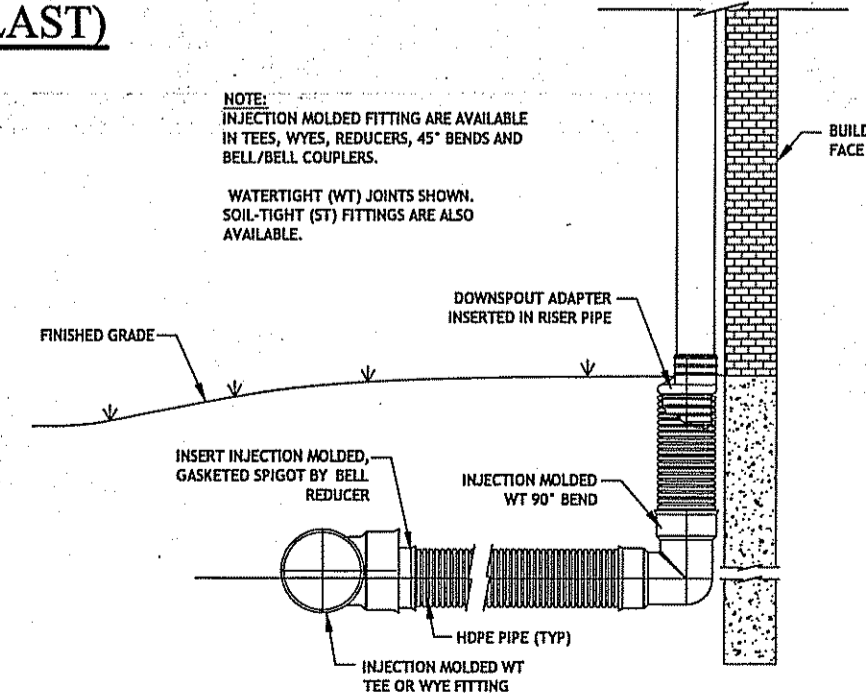

ROOF DRAIN DETAIL
 N.T.S.

CULTEC RECHARGER 280HD SPECIFICATIONS

- GENERAL**
 CULTEC RECHARGER 280HD CHAMBERS ARE DESIGNED FOR UNDERGROUND STORMWATER MANAGEMENT. THE CHAMBERS MAY BE USED FOR RETENTION, RECHARGING, DETENTION OR CONTROLLING THE FLOW OF ON-SITE STORMWATER RUNOFF.
- CHAMBER PARAMETERS**
- THE CHAMBERS WILL BE MANUFACTURED BY CULTEC, INC. OF BROOKFIELD, CT. (203-775-4416 OR 1-800-428-5832)
 - THE CHAMBER WILL BE VACUUM THERMOFORMED OF BLACK POLYETHYLENE.
 - THE CHAMBER WILL BE ARCHED IN SHAPE.
 - THE CHAMBER WILL BE OPEN-BOTTOMED.
 - THE CHAMBER WILL BE JOINED USING AN INTERLOCKING OVERLAPPING RIB METHOD. CONNECTIONS MUST BE FULLY SHOULDERED WITH NO SEPARATE END WALLS OR SEPARATE END WALLS.
 - THE NOMINAL CHAMBER DIMENSIONS OF THE CULTEC RECHARGER 280HD SHALL BE 28.5 INCHES TALL, 47 INCHES WIDE AND 8 FEET LONG. THE INSTALLED LENGTH OF A JOINED RECHARGER 280HD SHALL BE 7 FEET.
 - MAXIMUM INLET OPENING ON THE CHAMBER END WALL IS 18 INCHES.
 - THE CHAMBER WILL HAVE TWO SIDE PORTALS TO ACCEPT CULTEC HVLV FC-24 FEED CONNECTORS TO CREATE AN INTERNAL MANIFOLD. NOMINAL INSIDE DIMENSIONS OF THE SIDE PORTAL SHALL HAVE A WIDTH OF 11.0" AND HEIGHT OF 11.5". THE SIDE PORTAL CAN ACCEPT A MAXIMUM OUTER DIAMETER (O.D.) PIPE SIZE OF 12.25 INCHES.
 - THE NOMINAL CHAMBER DIMENSIONS OF THE CULTEC HVLV FC-24 FEED CONNECTOR SHALL BE 12 INCHES TALL, 16 INCHES WIDE AND 24.2 INCHES LONG.
 - THE NOMINAL STORAGE VOLUME OF THE RECHARGER 280HD CHAMBER WILL BE 6.079 FT³/FT - WITHOUT STONE. THE NOMINAL STORAGE VOLUME OF A JOINED RECHARGER 280HD SHALL BE 42.553 FT³/UNIT - WITHOUT STONE.
 - THE NOMINAL STORAGE VOLUME OF THE HVLV FC-24 FEED CONNECTOR WILL BE 0.913 FT³/FT - WITHOUT STONE.
 - THE RECHARGER 280HD CHAMBER WILL HAVE EIGHTY-TWO (82) DISCHARGE HOLES BORED INTO THE SIDEWALLS OF THE UNITS' CORE TO PROMOTE LATERAL CONVEYANCE OF WATER.
 - THE RECHARGER 280HD CHAMBER SHALL HAVE 15 CORRUGATIONS.
 - THE ENDWALL OF THE CHAMBER, WHEN PRESENT, WILL BE AN INTEGRAL PART OF THE CONTINUOUSLY FORMED UNIT. SEPARATE END PLATES CANNOT BE USED WITH THIS UNIT.
 - THE RECHARGER 280HD STAND ALONE UNIT MUST BE FORMED AS A WHOLE CHAMBER HAVING TWO FULLY FORMED INTEGRAL END WALLS AND HAVING NO SEPARATE END WALLS.
 - THE RECHARGER 280HD STARTER UNIT MUST BE FORMED AS A WHOLE CHAMBER HAVING ONE FULLY FORMED INTEGRAL END WALL AND ONE PARTIALLY FORMED INTEGRAL END WALL WITH A LOWER TRANSFER OPENING OF 9 INCHES HIGH X 35 INCHES WIDE.
 - THE RECHARGER 280HD INTERMEDIATE UNIT MUST BE FORMED AS A WHOLE CHAMBER HAVING ONE FULLY FORMED INTEGRAL END WALL AND ONE PARTIALLY FORMED INTEGRAL END WALL WITH A LOWER TRANSFER OPENING OF 9 INCHES HIGH X 35 INCHES WIDE.
 - THE RECHARGER 280HD END UNIT MUST BE FORMED AS A WHOLE CHAMBER HAVING ONE FULLY FORMED INTEGRAL END WALL AND ONE FULLY FORMED INTEGRAL END WALL WITH NO SEPARATE END WALLS.
 - THE HVLV FC-24 FEED CONNECTOR MUST BE FORMED AS A WHOLE CHAMBER HAVING TWO OPEN END WALLS AND HAVING NO SEPARATE END PLATES OR SEPARATE END WALLS. THE UNIT WILL FIT INTO THE SIDE PORTALS OF THE RECHARGER 280HD AND ACT AS CROSS FEED CONNECTIONS.
 - CHAMBERS MUST HAVE HORIZONTAL STIFFENING FLEX REDUCTION STEPS BETWEEN THE RIBS.
 - HEAVY DUTY UNITS ARE DESIGNATED BY A COLORED STRIPE FORMED INTO THE PART ALONG THE LENGTH OF THE CHAMBER.
 - THE CHAMBER WILL HAVE A RAISED INTEGRAL CAP LOCATED ON TOP OF THE ARCH IN THE CENTER OF EACH UNIT TO BE USED AS AN OPTIONAL INSPECTION PORT OR CLEAN-OUT.
 - THE UNITS MAY BE TRIMMED TO CUSTOM LENGTHS BY CUTTING BACK TO ANY CORRUGATION.
 - THE CHAMBER SHALL BE MANUFACTURED IN AN ISO 9001:2008 CERTIFIED FACILITY.
 - THE CHAMBER WILL BE DESIGNED TO WITHSTAND TRAFFIC LOADS WHEN INSTALLED ACCORDING TO CULTEC'S INSTALLATION INSTRUCTIONS.

CULTEC HVLV FC-24 FEED CONNECTOR PRODUCT SPECIFICATIONS

- GENERAL**
 CULTEC HVLV FC-24 FEED CONNECTORS ARE DESIGNED TO CREATE AN INTERNAL MANIFOLD FOR CULTEC RECHARGER 280HD STORMWATER CHAMBERS.
- CHAMBER PARAMETERS**
- THE CHAMBERS WILL BE MANUFACTURED BY CULTEC, INC. OF BROOKFIELD, CT. (203-775-4416 OR 1-800-428-5832)
 - THE CHAMBER WILL BE VACUUM THERMOFORMED OF BLACK HIGH MOLECULAR WEIGHT HIGH DENSITY POLYETHYLENE (HDPE).
 - THE CHAMBER WILL BE ARCHED IN SHAPE.
 - THE CHAMBER WILL BE OPEN-BOTTOMED.
 - THE NOMINAL CHAMBER DIMENSIONS OF THE CULTEC HVLV FC-24 FEED CONNECTOR SHALL BE 12 INCHES TALL, 16 INCHES WIDE AND 24.2 INCHES LONG.
 - THE NOMINAL STORAGE VOLUME OF THE HVLV FC-24 FEED CONNECTOR WILL BE 0.913 FT³/FT - WITHOUT STONE.
 - THE HVLV FC-24 FEED CONNECTOR CHAMBER SHALL HAVE 2 CORRUGATIONS.
 - THE HVLV FC-24 FEED CONNECTOR MUST BE FORMED AS A WHOLE CHAMBER HAVING TWO OPEN END WALLS AND HAVING NO SEPARATE END PLATES OR SEPARATE END WALLS. THE UNIT WILL FIT INTO THE SIDE PORTALS OF THE CULTEC RECHARGER 280HD CHAMBER AND ACT AS CROSS FEED CONNECTIONS CREATING AN INTERNAL MANIFOLD.
 - THE CHAMBER WILL BE DESIGNED TO WITHSTAND TRAFFIC LOADS WHEN INSTALLED ACCORDING TO CULTEC'S RECOMMENDED INSTALLATION INSTRUCTIONS.
 - THE CHAMBER SHALL BE MANUFACTURED IN AN ISO 9001:2008 CERTIFIED FACILITY.

CULTEC NO. 20L™ POLYETHYLENE LINER

- GENERAL**
 CULTEC NO. 20L™ POLYETHYLENE LINER IS DESIGNED AS AN IMPERVIOUS UNDERLAYMENT TO PREVENT SCOURING OF THE STONE BASE CAUSED BY WATER MOVEMENT WITHIN THE CULTEC SYSTEM. CULTEC NO. 20L™ POLYETHYLENE LINER IS TO BE PLACED BENEATH HVLV FC-24 FEED CONNECTORS WHEN UTILIZING INTERNAL MANIFOLD AND BENEATH ALL INLET PIPES.
- LINER PARAMETERS**
- THE LINER WILL BE PROVIDED BY CULTEC, INC. OF BROOKFIELD, CT. (203-775-4416 OR 1-800-428-5832)
 - THE LINER WILL BE BLACK IN APPEARANCE.
 - THE LINER WILL HAVE A NOMINAL THICKNESS OF 20 MIL (0.51 mm).
 - THE LINER WILL HAVE A WEIGHT OF 99 LBS/SF.
 - THE LINER WILL HAVE A TENSILE STRENGTH @ BREAK 1" OF 75 LBS PER ASTM D6693 TESTING METHOD.
 - THE LINER WILL HAVE AN ELONGATION AT BREAK OF 800% PER ASTM D6683 TESTING METHOD.
 - THE LINER WILL HAVE A TEAR RESISTANCE OF 11 LBF PER ASTM D1004 TESTING METHOD.
 - THE LINER WILL HAVE A HYDROSTATIC RESISTANCE OF 100 PSI PER ASTM D751 TESTING METHOD.
 - THE LINER WILL HAVE A PUNCTURE RESISTANCE OF 30 LBF PER ASTM D4533 TESTING METHOD.
 - THE LINER WILL HAVE A VOLATILE LOSS OF <1% PER ASTM D2033 TESTING METHOD.
 - THE LINER WILL HAVE A DIMENSIONAL STABILITY OF <2% PER ASTM D1204 TESTING METHOD.
 - THE LINER WILL HAVE A MAXIMUM USE TEMPERATURE OF 180° F (82° C).
 - THE LINER WILL HAVE A MINIMUM USE TEMPERATURE OF 0° F (32° F).
 - THE LINER WILL HAVE A PERMITS PER AASHTO M-2881 PER ASTM D6693 TESTING METHOD.
 - THE LINER WILL CONSIST OF A BLACK POLYETHYLENE.
 - THE LINER WILL NOT CONTAIN FLAMMABLE MATERIALS.

Kindly be advised that this permit is not to be used for any type or extent of freshwater wetlands on site.

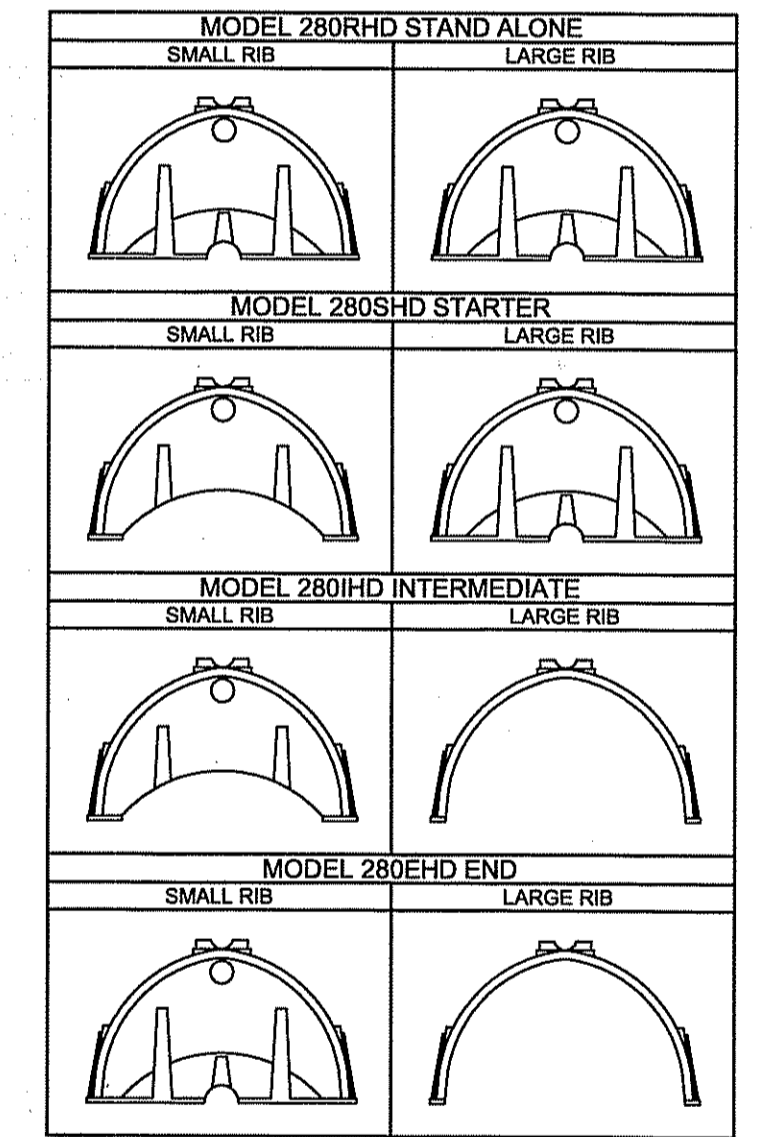

CULTEC RECHARGER 280HD CHAMBER DETAILS
 NOT TO SCALE

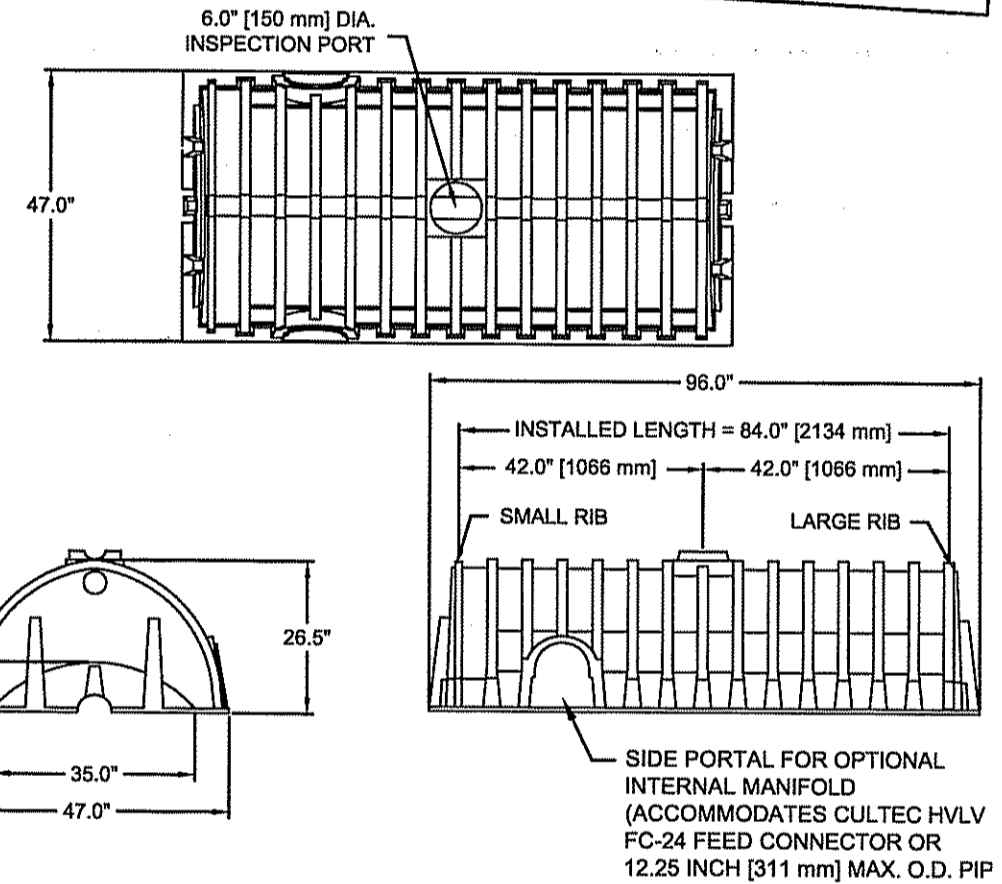

CULTEC RECHARGER 280HD CHAMBER STORAGE = 6.079 CF/FT [0.585 m³/m]
 INSTALLED LENGTH ADJUSTMENT = 1.0' [0.3048 m]
 ALL RECHARGER 280HD HEAVY DUTY UNITS ARE MARKED WITH A COLORED STRIPE FORMED INTO THE PART ALONG THE LENGTH OF THE CHAMBER. SIDE PORTAL ACCEPTS CULTEC HVLV FC-24 FEED CONNECTOR.

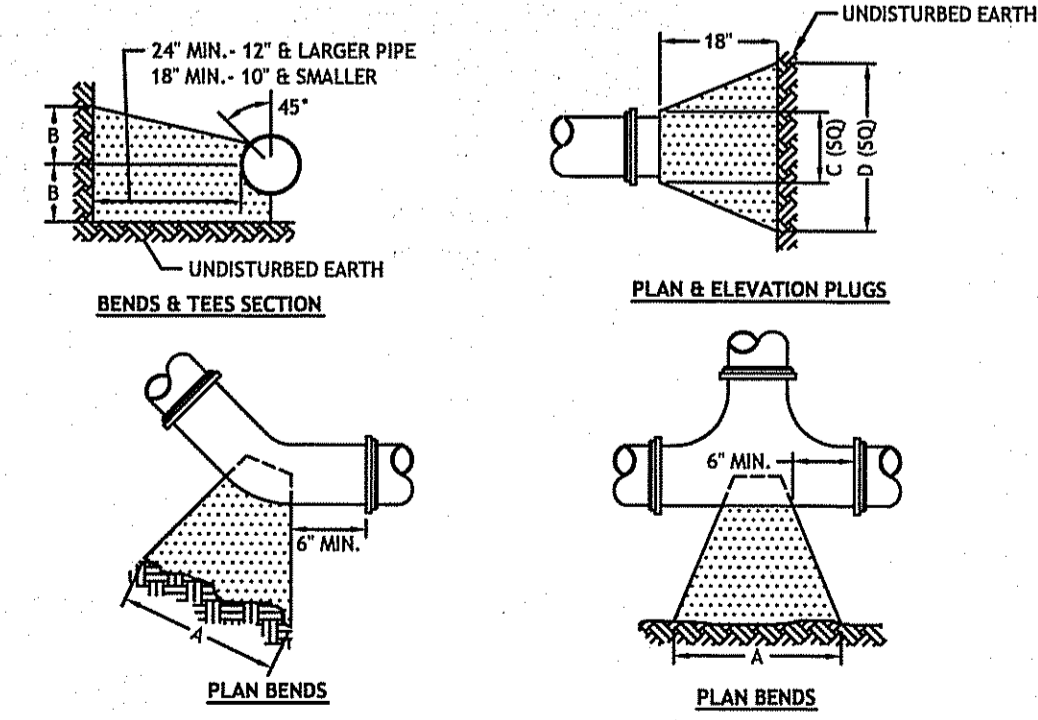

TAPPING SLEEVE AND VALVE
 NOT TO SCALE

THRUST BLOCK
 NO SCALE

SIZE	TEES			PLUGS			90° BEND			22 1/2° BEND			11 1/4° BEND		
	A	B	C	A	B	C	A	B	C	A	B	C	A	B	C
4"	22	12	22	12	24	16	20	10	14	7	11	5"			
6"	30	18	30	18	35	22	27	15	19	12	13	8"			
8"	38	24	38	24	46	29	33	22	25	14	19	10"			

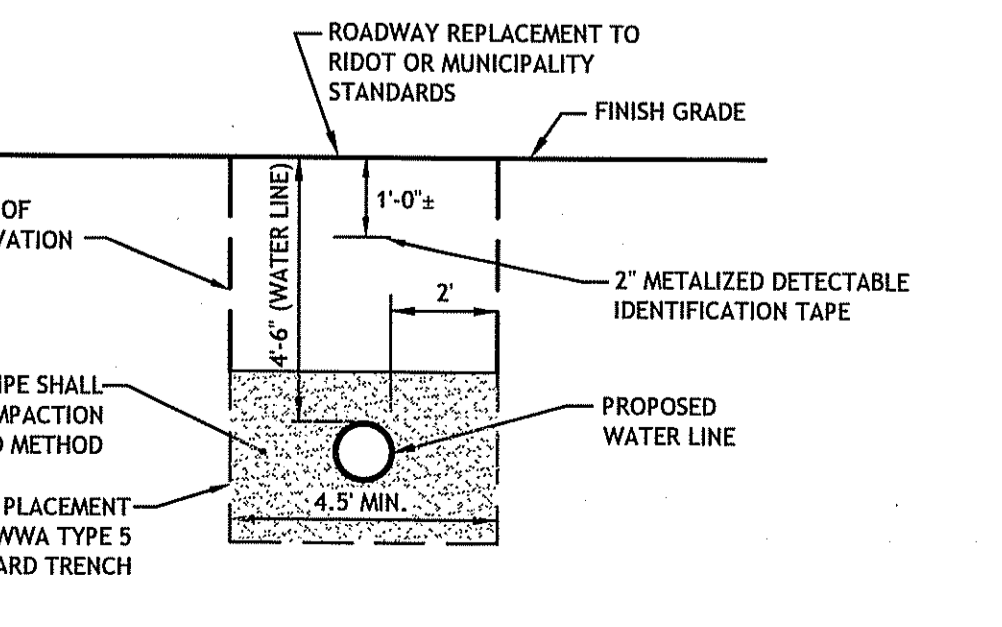

TYPICAL WATER LINE TRENCH
 N.T.S.

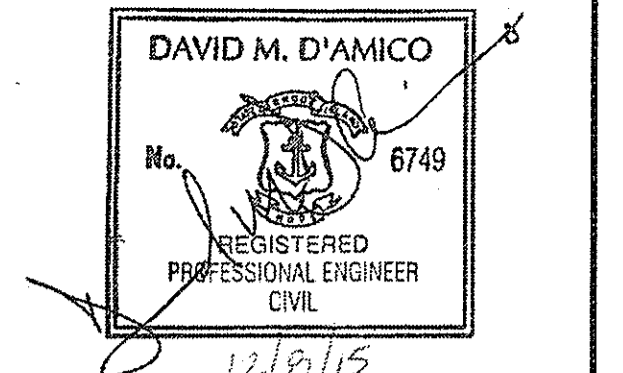

Saccocio & Associates, Inc.
 1085 Park Avenue
 Cranston, Rhode Island 02910
 tel 401.942.7970
 fax 401.942.7975

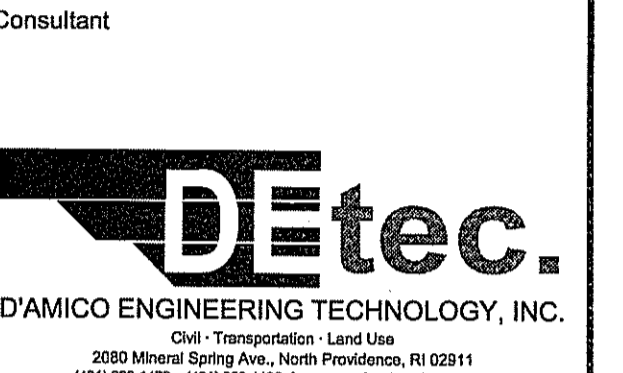

RENOVATIONS TO SMITHFIELD POLICE STATION

215 PLEASANT VIEW SMITHFIELD, RI 02917

TOWN OF SMITHFIELD, RHODE ISLAND

NOTES
 ENVIRONMENTAL MANAGEMENT
 WATER RESOURCES
 WETLANDS PROGRAM
 WITH CONDITIONS
 LETTER OF APPROVAL
 JAN 06 2016 FILE # 15-0250
 APPROVED WITHOUT PRIOR APPROVAL
 PERMITS MUST BE AT CONSTRUCTION SITE

SHEET TITLE

SITE DETAILS NO. 2

DRAWN BY: DMD JOB NUMBER: 15107
 CHECKED BY: DMD DATE: 10-9-2015

C5.1

SCALE: