

XREF Files: IMAGE Files: WOONSOCKET RI TOPO 2.jpg

File: T:\MISC\CVS\WOONSOCKET, RI\108 MASON ST\153135-02SITELOC.dwg

Plot Date/Time: Nov 24, 2015 - 12:33pm

Plotted By: chris.dasiata

OFFICE	DRAWN BY	CHECKED BY	APPROVED BY	DRAWING NUMBER
CANTON, MA	CD	MD		153135-01SITELOC
	10/30/14	10/30/14		

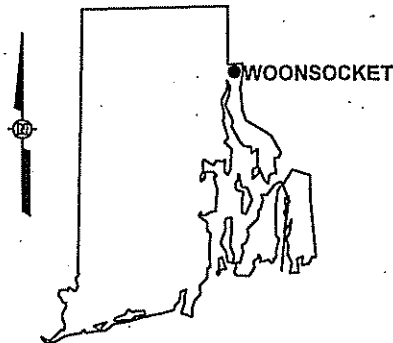
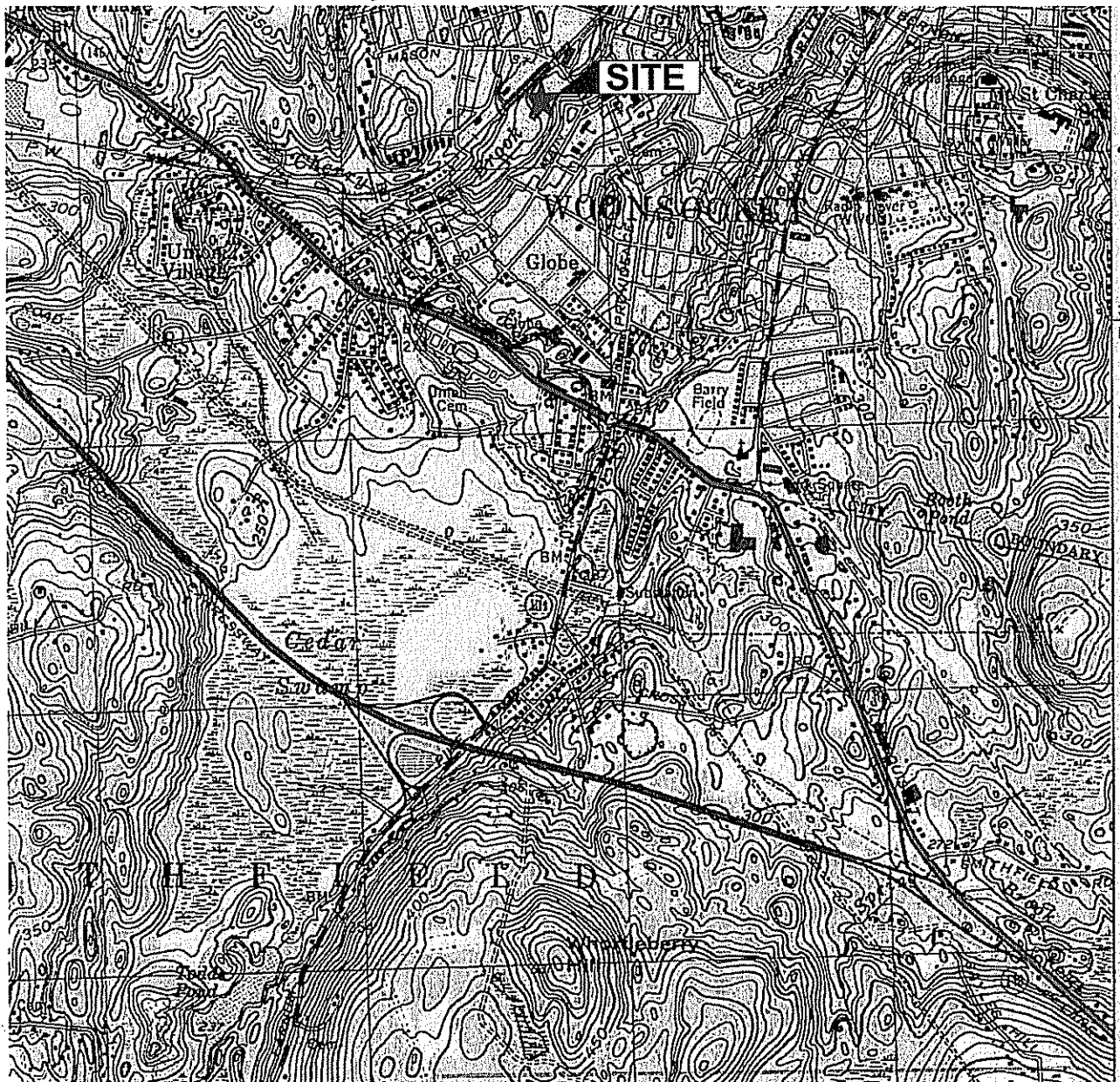

**RHODE ISLAND**

SOURCE:  
USGS 7.5 MIN. SERIES TARGET QUAD, 1999  
SCALE: 1:24,000

DEPARTMENT OF ENVIRONMENTAL MANAGEMENT  
 OFFICE OF WATER RESOURCES  
 FRESHWATER WETLANDS PROGRAM  
 APPROVED WITH CONDITIONS  
 AS SPECIFIED IN THE LETTER OF APPROVAL  
 DATED JAN 25 2016 FILE # 15-0287  
 NO CHANGES ALLOWED WITHOUT PRIOR APPROVAL  
 APPROVED PLANS MUST BE AT CONSTRUCTION SITE



CB&I ENVIRONMENTAL  
 & INFRASTRUCTURE, INC.  
 150 ROYALL STREET  
 CANTON, MASSACHUSETTS  
 (617) 589-5111

FIGURE 1  
 SITE LOCATION PLAN  
 CVS HEALTH  
 108 MASON STREET  
 WOONSOCKET, RHODE ISLAND

XREF Files: IMAGE Files: Mason St Woonsocket RI Aerial.jpg  
 File: T:\MISC\CVS\WOONSOCKET, RI\108 MASON ST\153135-02AERIAL.dwg  
 Plot Date/Time: Nov 24, 2015 - 12:40pm  
 Plotted By: chris.destaia

OFFICE	DRAWN BY	CHECKED BY	APPROVED BY	DRAWING NUMBER
Canton, MA	CD	MD	--	153135-02AERIAL

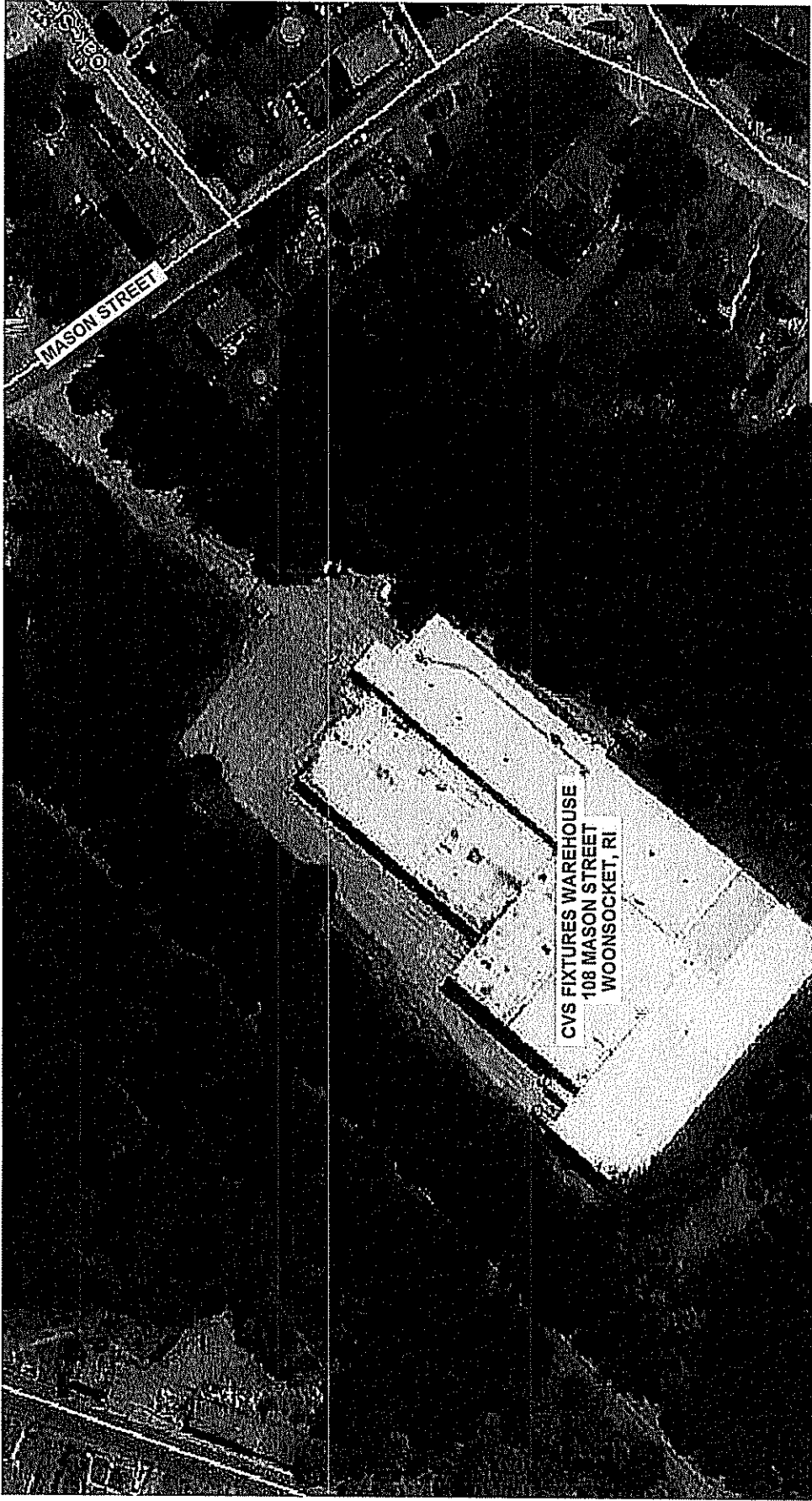

CB&I ENVIRONMENTAL  
 & INFRASTRUCTURE, INC.  
 150 ROYALL STREET  
 CANTON, MASSACHUSETTS  
 (617) 589-5111

FIGURE 2  
 SITE LOCATION (AERIAL)  
 CVS HEALTH  
 108 MASON STREET  
 WOONSOCKET, RHODE ISLAND

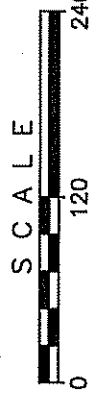

© 2015 Google

REFERENCE:

PLAN DERIVED FROM GOOGLE EARTH AERIAL IMAGERY DATED 06/06/15, AND CB&I ENVIRONMENTAL & INFRASTRUCTURE, INC. FIELD RECONNAISSANCE.

DRAWING NUMBER 153135-02SITE  
 APPROVED BY 12/14/15  
 CHECKED BY MD 12/14/15  
 DRAWN BY CD 12/14/15  
 OFFICE CANTON, MA

File: T:\MISC\CVS\WOOSOCKET, RI\108 MASON ST\153135-02SITE.dwg  
 Plot Date/Time: Dec 16, 2015 - 3:20pm  
 Plotted by: chris.desiata

Kindly be advised that this Permit is not equivalent to a verification of the type or extent of freshwater wetlands on site.

DEPARTMENT OF ENVIRONMENTAL MANAGEMENT  
 OFFICE OF WATER RESOURCES  
 FRESHWATER WETLANDS PROGRAM  
 APPROVED WITH CONDITIONS  
 AS SPECIFIED IN THE LETTER OF APPROVAL  
 DATED JAN 25 2016 FILE # 15-0287  
 CVS FIXTURES WAREHOUSE 108 MASON STREET WOOSOCKET, RI  
 CHANGES ALLOWED WITHOUT PRIOR APPROVAL  
 APPROVED PLANS MUST BE AT CONSTRUCTION SITE

MBLU 3/B/35/14  
 MBLU 3/B/42/13

Existing fence is the limits of disturbance

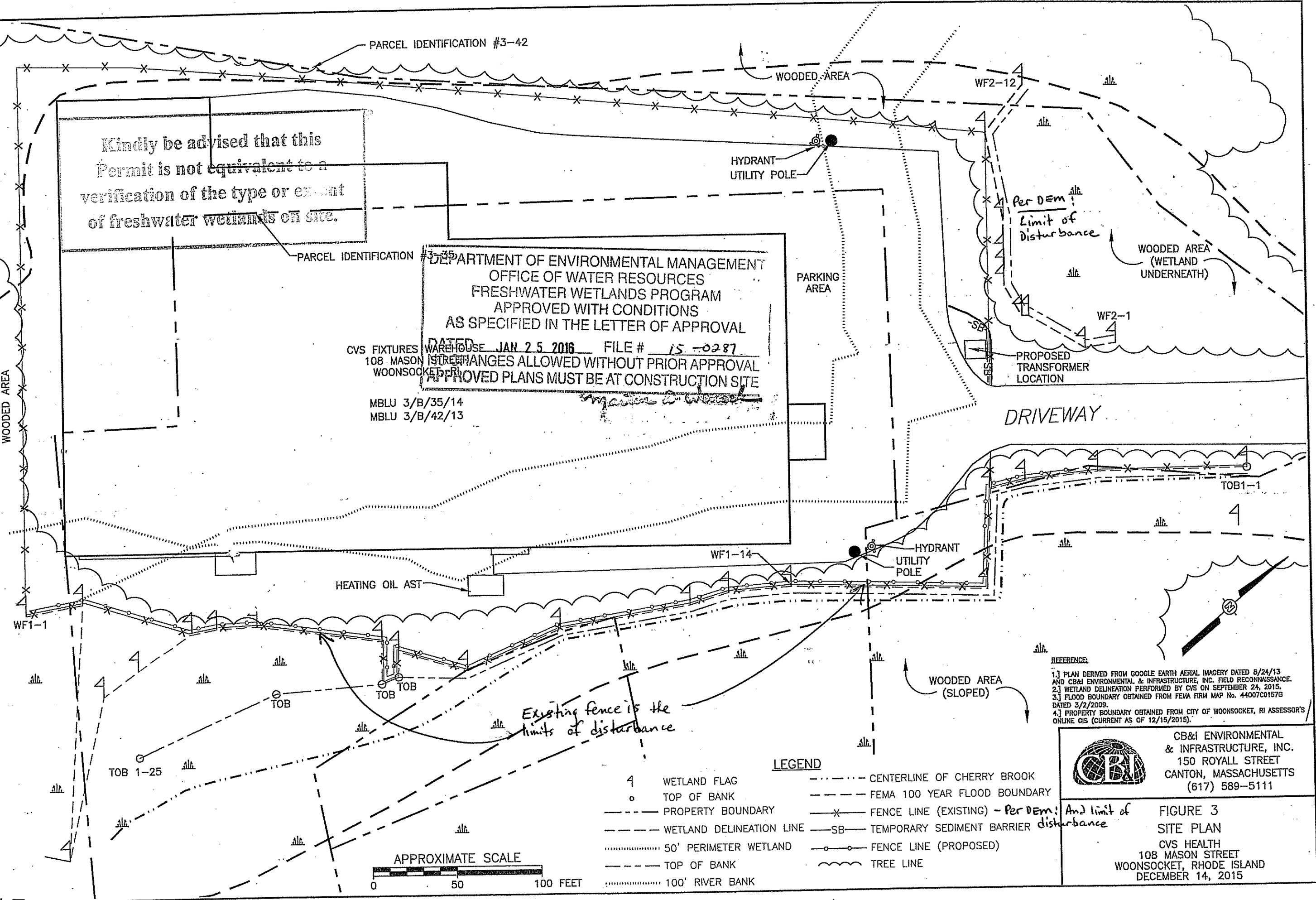

- REFERENCE:
- 1.] PLAN DERIVED FROM GOOGLE EARTH AERIAL IMAGERY DATED 8/24/13 AND CB&I ENVIRONMENTAL & INFRASTRUCTURE, INC. FIELD RECONNAISSANCE.
  - 2.] WETLAND DELINEATION PERFORMED BY CVS ON SEPTEMBER 24, 2015.
  - 3.] FLOOD BOUNDARY OBTAINED FROM FEMA FIRM MAP No. 44007C0157G DATED 3/2/2009.
  - 4.] PROPERTY BOUNDARY OBTAINED FROM CITY OF WOOSOCKET, RI ASSESSOR'S ONLINE GIS (CURRENT AS OF 12/15/2015).



CB&I ENVIRONMENTAL & INFRASTRUCTURE, INC.  
 150 ROYALL STREET  
 CANTON, MASSACHUSETTS  
 (617) 589-5111

**LEGEND**

- |       |                          |       |  |
|-------|--------------------------|-------|--|
| 4     | WETLAND FLAG             | ..... | CENTERLINE OF CHERRY BROOK                   |
| o     | TOP OF BANK              | ---   | FEMA 100 YEAR FLOOD BOUNDARY                 |
| ---   | PROPERTY BOUNDARY        | -x-   | FENCE LINE (EXISTING) - Per Dem: disturbance |
| ---   | WETLAND DELINEATION LINE | -SB-  | TEMPORARY SEDIMENT BARRIER                   |
| ..... | 50' PERIMETER WETLAND    | -o-   | FENCE LINE (PROPOSED)                        |
| ---   | TOP OF BANK              | ~~~~~ | TREE LINE                                    |
| ..... | 100' RIVER BANK          |       |  |

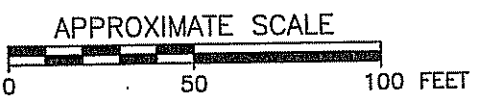

**FIGURE 3**  
**SITE PLAN**  
 CVS HEALTH  
 108 MASON STREET  
 WOOSOCKET, RHODE ISLAND  
 DECEMBER 14, 2015

File: T:\MISC\CVS\WOONSOCKET, RI\108 MASON ST\153135-02SITE\_b.dwg  
 Plot Date/Time: Dec 16, 2015 - 3:04pm  
 Plotted By: chris.deisiata

OFFICE: CANTON, MA  
 DRAWN BY: CD  
 CHECKED BY: AS  
 APPROVED BY: [Signature]  
 DRAWING NUMBER: 153135-02SITE\_b

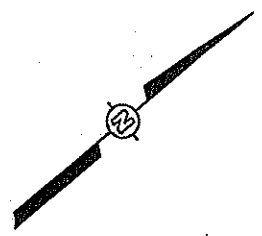
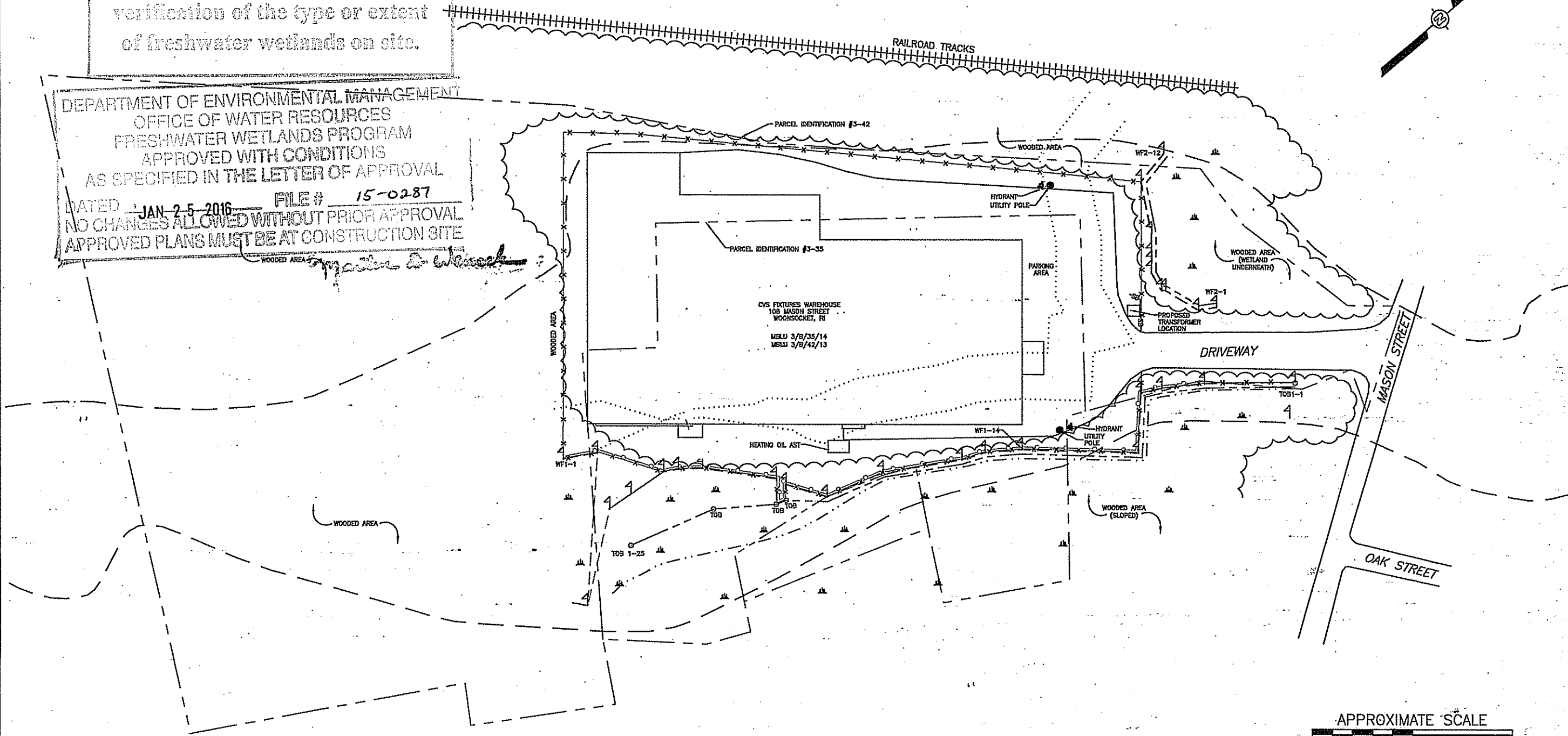

Kindly be advised that this Permit is not equivalent to a verification of the type or extent of freshwater wetlands on site.

DEPARTMENT OF ENVIRONMENTAL MANAGEMENT  
 OFFICE OF WATER RESOURCES  
 FRESHWATER WETLANDS PROGRAM  
 APPROVED WITH CONDITIONS  
 AS SPECIFIED IN THE LETTER OF APPROVAL  
 DATED JAN 25 2016 FILE # 15-0287  
 NO CHANGES ALLOWED WITHOUT PRIOR APPROVAL  
 APPROVED PLANS MUST BE AT CONSTRUCTION SITE

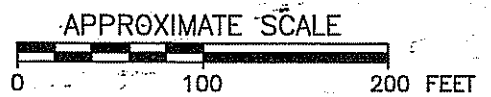

- REFERENCE:
- 1.] PLAN DERIVED FROM GOOGLE EARTH AERIAL IMAGERY DATED 8/24/13 AND CB&I ENVIRONMENTAL & INFRASTRUCTURE, INC. FIELD RECONNAISSANCE.
  - 2.] WETLAND DELINEATION PERFORMED BY CVS ON SEPTEMBER 24, 2015.
  - 3.] FLOOD BOUNDARY OBTAINED FROM FEMA FIRM MAP No. 44007C0157G DATED 3/2/2009.
  - 4.] PROPERTY BOUNDARY OBTAINED FROM CITY OF WOONSOCKET, RI ASSESSOR'S ONLINE GIS (CURRENT AS OF 12/15/2015).

- LEGEND
- 4 WETLAND FLAG
  - o TOP OF BANK
  - PROPERTY BOUNDARY
  - WETLAND DELINEATION LINE
  - ..... 50' PERIMETER WETLAND
  - TOP OF BANK
  - ..... 100' RIVER BANK
  - CENTERLINE OF CHERRY BROOK
  - FEMA 100 YEAR FLOOD BOUNDARY
  - x- FENCE LINE (EXISTING) - also limit of disturbance per Dem
  - SB- TEMPORARY SEDIMENT BARRIER
  - o-o- FENCE LINE (PROPOSED)
  - ~~~ TREE LINE

CB&I ENVIRONMENTAL & INFRASTRUCTURE, INC.  
 150 ROYALL STREET  
 CANTON, MASSACHUSETTS  
 (617) 589-5111

FIGURE 4  
 SITE PLAN  
 CVS HEALTH  
 108 MASON STREET  
 WOONSOCKET, RHODE ISLAND  
 DECEMBER 14, 2015