

LOCATION PLAN NOT TO SCALE

Notes:

1. Refer to OWTS application #1630-0733
2. This plan is a result of an on-site survey.
3. Location of underground utilities is approximate.
4. FEMA SFHA zone AE 204 follows contour 82 on this plan.
5. All OWTS components shown are proposed.
6. Existing silt fence that falls within Proposed Limit of Disturbance (LOD) is to be removed.

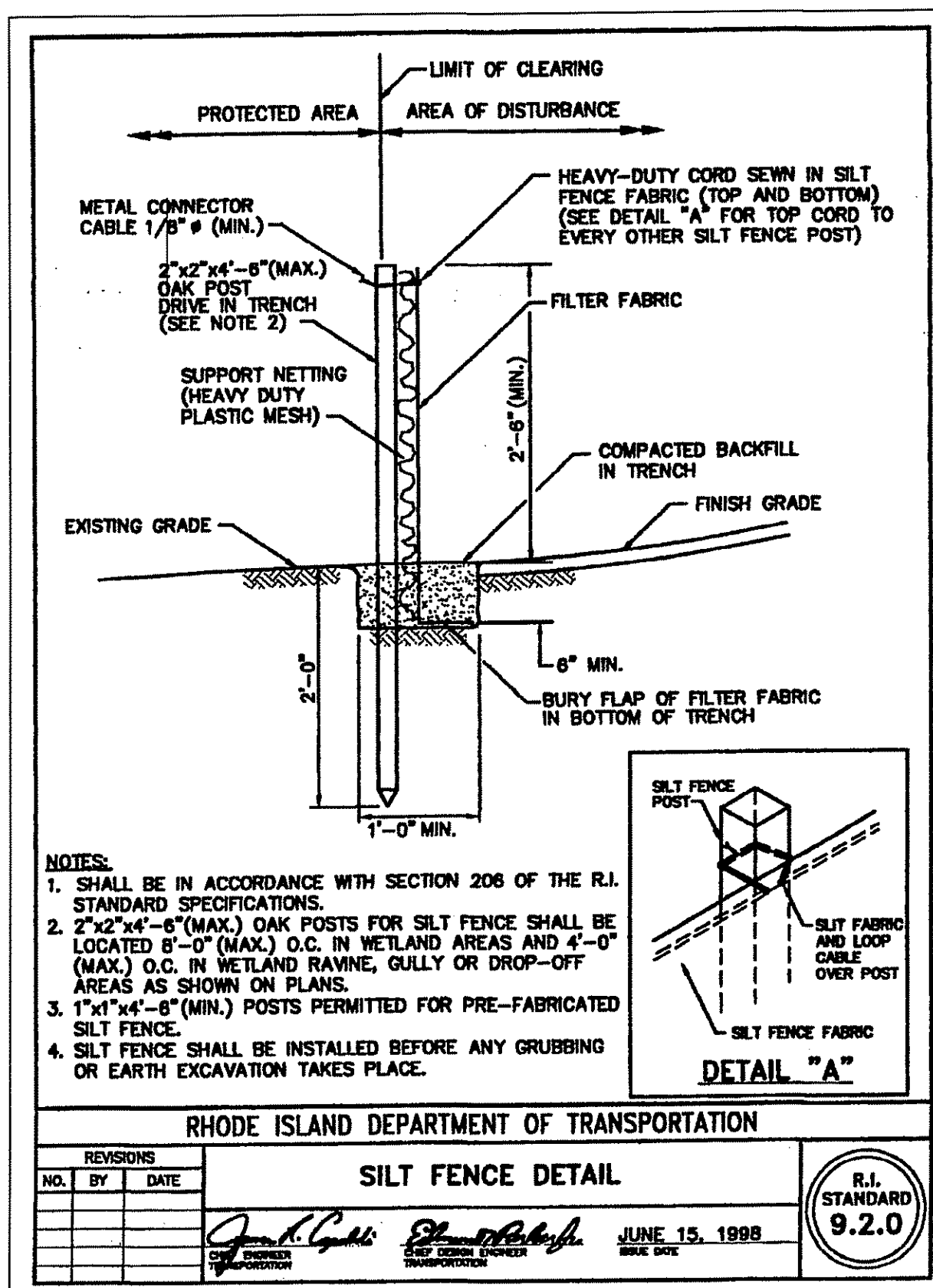

Legend:

- AP Assessor's Plat
- WT Watertable
- LOD Limit of Disturbance
- UP Utility Pole
- ECB Existing Concrete Bound
- Proposed Silt Fence
- Existing Silt Fence
- High Bush Blueberry and/or Sweet Pepperbush (Proposed Planting)
- Red Maple (Proposed Planting)

CERTIFICATION
 THIS SURVEY HAS BEEN CONDUCTED AND THE PLAN HAS BEEN PREPARED PURSUANT TO SECTION 9 OF THE RULES AND REGULATIONS ADOPTED BY THE RHODE ISLAND STATE BOARD OF REGISTRATION FOR PROFESSIONAL LAND SURVEYORS ON JANUARY 1, 2016, AS FOLLOWS:

(A) TYPE OF BOUNDARY SURVEY: NOT A BOUNDARY SURVEY. MEASUREMENT SPECIFICATION IV
 THIS COMPILATION PLAN HAS BEEN PREPARED FROM SOURCES OF INFORMATION AND DATA WHOSE POSITIONAL ACCURACY AND RELIABILITY HAS NOT BEEN VERIFIED. THE PROPERTY LINES DEPICTED HEREON DO NOT REPRESENT A BOUNDARY OPINION, AND OTHER INFORMATION DEPICTED IS SUBJECT TO SUCH CHANGES AS AN AUTHORITY FIELD SURVEY MAY DISCLOSE.

(B) OTHER TYPE OF SURVEY: DATA ACCUMULATION SURVEY - LOCATION OF SITE FEATURES & TOPOGRAPHY III

(C) STATEMENT OF PURPOSE: THE PURPOSE OF THIS SURVEY AND PLAN IS TO SHOW EXISTING SITE FEATURES SUFFICIENT TO DESIGN & INSTALL A SEPTIC SYSTEM.

BY: *John Rockwell*
 REGISTERED PROFESSIONAL LAND SURVEYOR SIGNATURE
 JOHN ROCKWELL
 REGISTERED PROFESSIONAL LAND SURVEYOR PRINTED NAME
 A-68
 CERTIFICATE OF AUTHORIZATION NO.

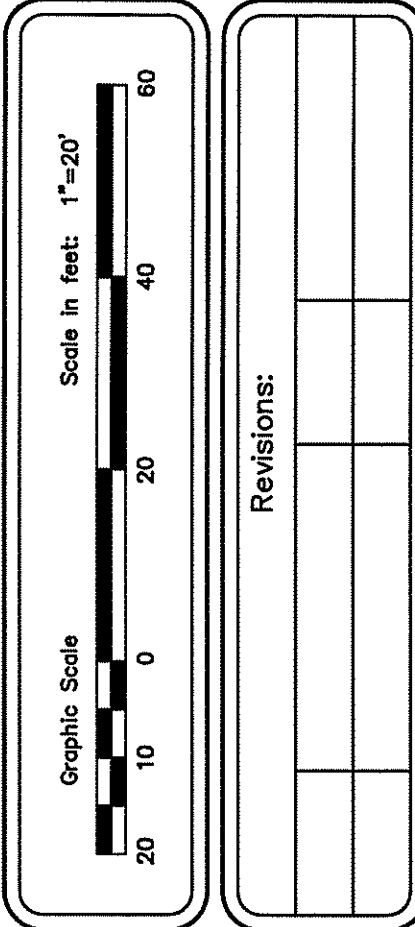
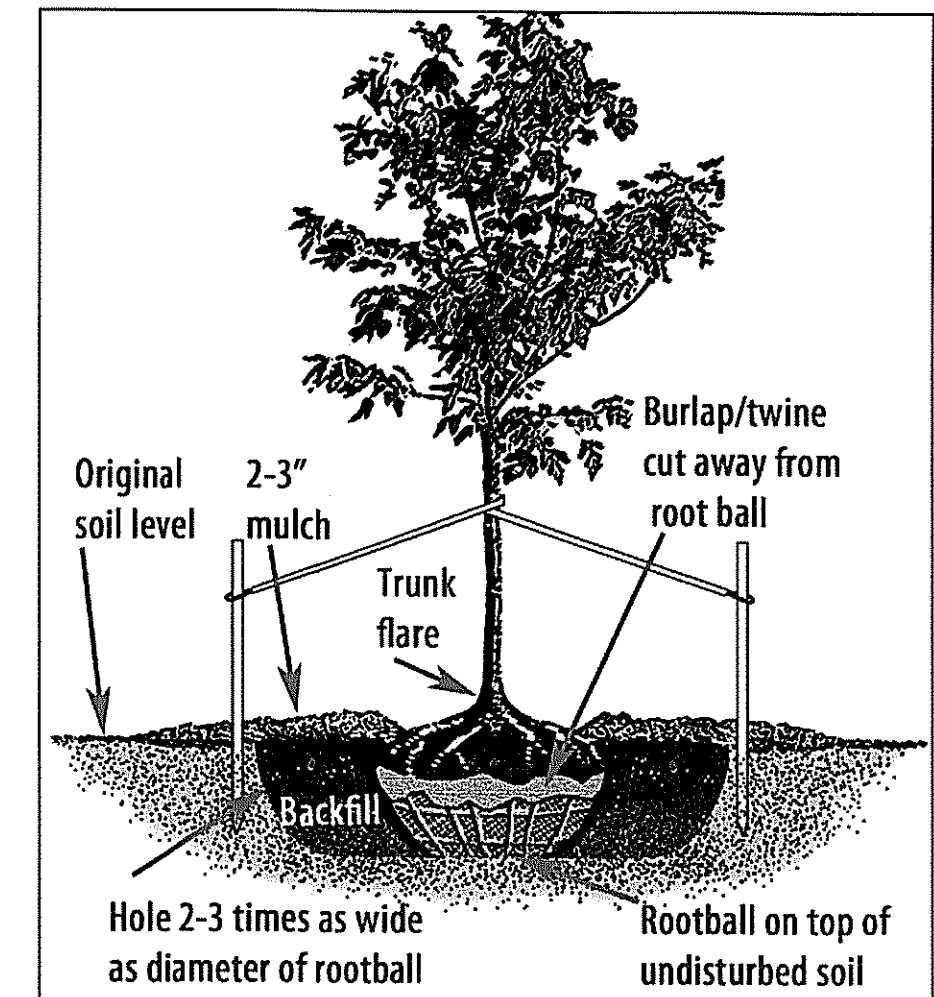
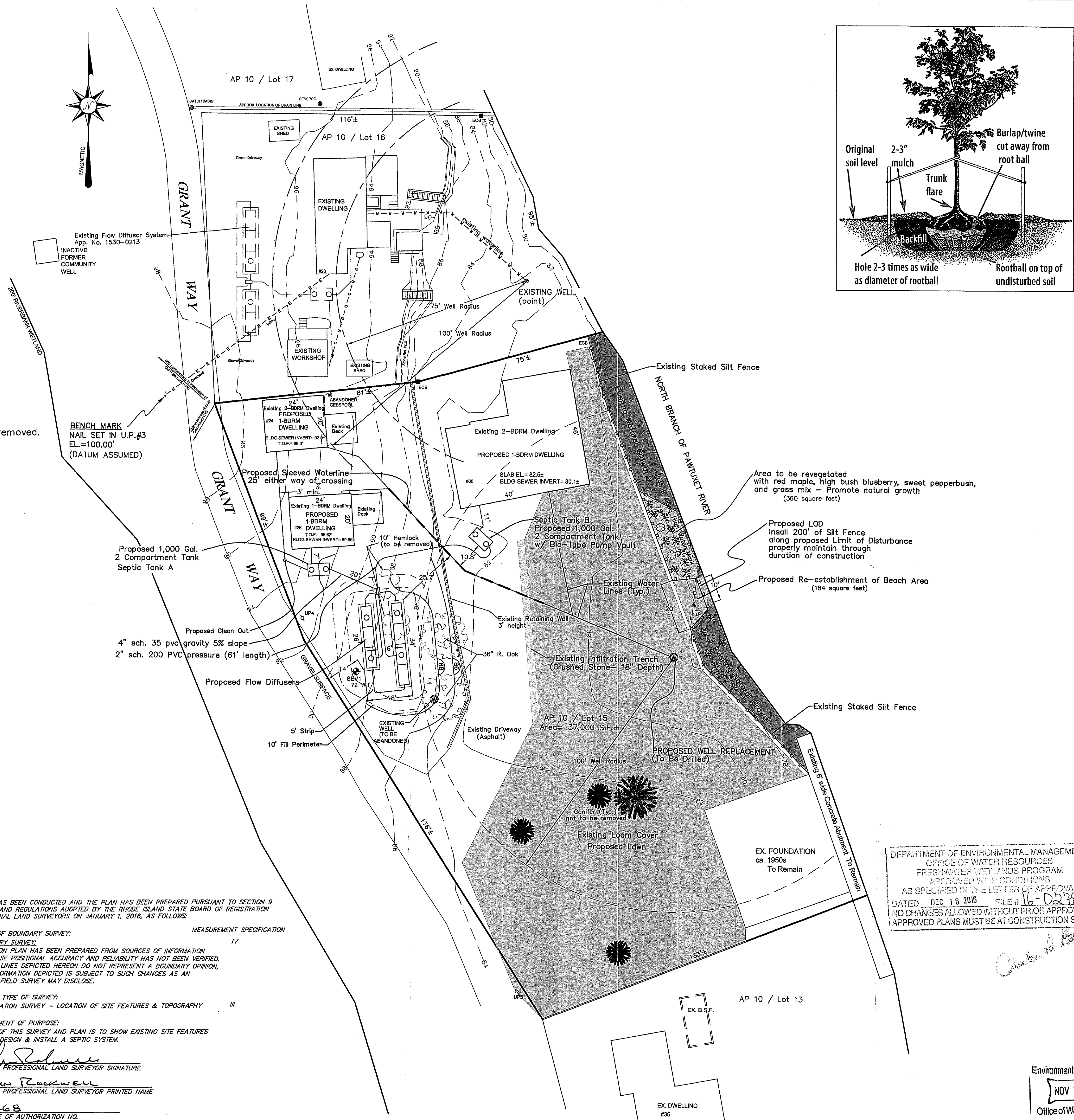

JOHN E. ROCKWELL
 No. 1959
 PROFESSIONAL LAND SURVEYOR
 11/2/16

Coventry Survey Co., Inc.
 46 South Main Street
 Coventry, Rhode Island 02816
 (401) 823-5028
 coventrysurvey.com
 Land Surveying / Mapping / OWTS Designs

Wetland Preliminary Determination Submission
 Proposed Alteration
 of On-site Wastewater Treatment System
 at 24-30 Grant Way in Scituate, Rhode Island
 Assessor's Plat 10 / Lot 15
 Prepared for: Richard A. Cardello
 36 Grant Way, Hope, RI 02831

DEPARTMENT OF ENVIRONMENTAL MANAGEMENT
 OFFICE OF WATER RESOURCES
 FRESHWATER WETLANDS PROGRAM
 APPROVED WITH CONDITIONS
 AS SPECIFIED IN THE LETTER OF APPROVAL
 DATED DEC 16 2016 FILE # 16-0278
 NO CHANGES ALLOWED WITHOUT PRIOR APPROVAL
 APPROVED PLANS MUST BE AT CONSTRUCTION SITE

Date:
 November 1, 2016

Environmental Management
 NOV 07 2016
 Office of Water Resources