

Limit of Disturbance per RIDEM.

White Pine (*Pinus strobus*) or White Cedar (*Thuja occidentalis*) trees, 10-foot apart on-center, 3-4 feet in height after planting, along the limit of disturbance as depicted per RIDEM.

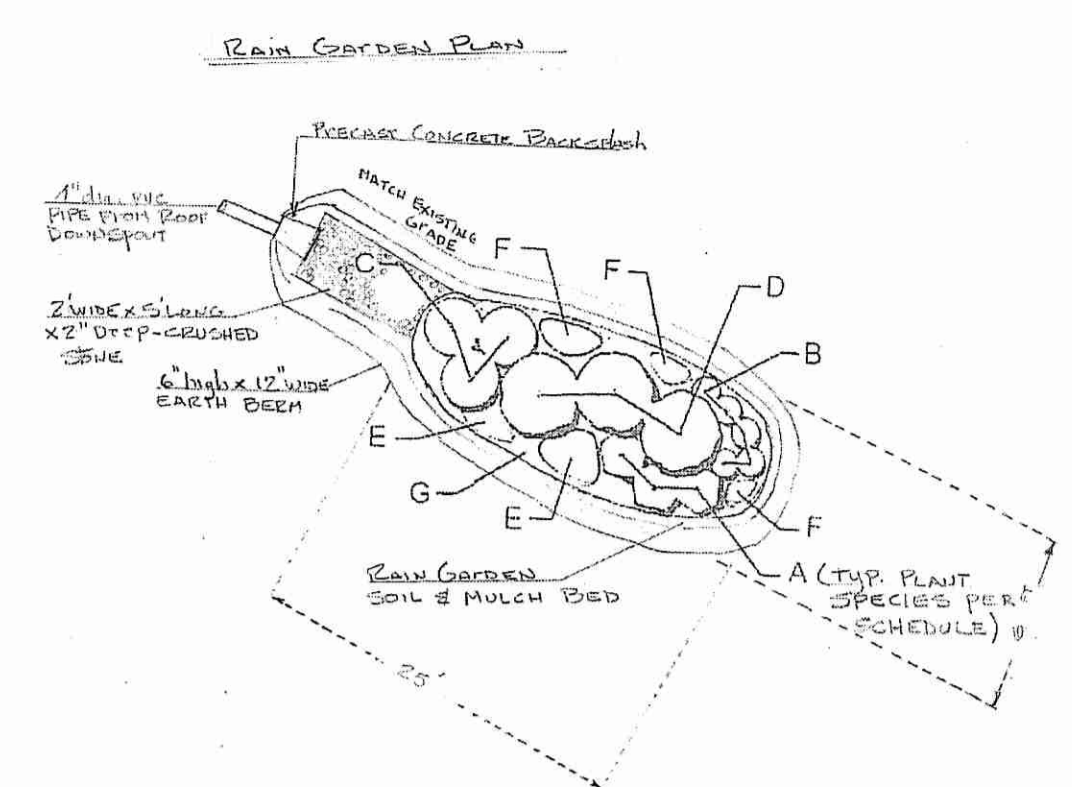

- RAIN GARDEN CONSTRUCTION**
- Install a 2 ft. wide 5 ft long x 2" layer of crushed stone at the end of the roof gutter piping at the entrance to the rain garden.
  - Grade the bottom of the rain garden level per details.
  - Install a 2" inch layer of 50% native topsoil and 50% mature organic compost, and a 3" layer of aged shredded mulch.
  - Create a 4" high soil berm around the entire area of the rain garden.
  - Ensure that the area is not compacted prior to installing the plants per the planting detail.
- RAIN GARDEN MAINTENANCE**
- Inspect the rain garden following at least the first two precipitation events of at least 1.0 inch to ensure that the garden is functioning.
  - Monitor and maintain the plants during the growing season and replace dead as necessary.
  - Remove any silts or sediments to prevent ponding. The garden should drain effectively within 48 hrs.
  - Replace the top few inches and replace with fresh soil and mulch as necessary.
  - Repair any erosion gullies they occur.
  - Prune all plants as necessary.
  - Do not fertilize or add pesticides to plants within the garden.
  - Perennial plants and ground cover shall be replaced as necessary to maintain adequate vegetated ground cover. Annual plants may also be used to maintain ground cover.

**PLANTING SCHEDULE**

LETTER	QUANTITY	PLANT SPECIES
A	3	SWEET PEPPERBUSH
B	5	SWEET FERN
C	3	BAYBERRY
D	3	HIGHBUSH BLUEBERRY
E	1	BUTTERFLY MILKWEED
F	1	BLUEFLAG IRIS
G	1	BEARBERRY

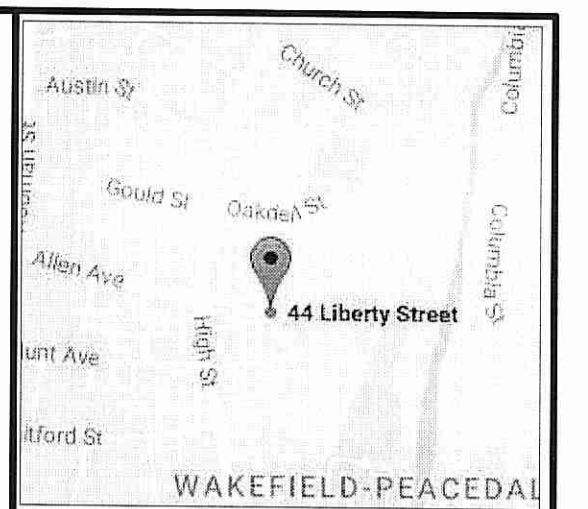

**NOTES / REFERENCES**

- REFERENCE IS MADE TO THE FOLLOWING MAPS AND PLANS OF RECORD:  
A.) PLAN ENTITLED "MIDWAY PARK PLAT IN SOUTH KINGSTOWN, R.I., SURVEYED AND DRAWN BY EDWARD E. GOFF, MARCH, 1919" WHICH IS LOCATED IN THE LAND EVIDENCE RECORDS OF THE TOWN OF SOUTH KINGSTOWN IN LAND EVIDENCE BOOK 40 PAGE 414.
- ANY UTILITIES SHOWN ON THIS PLAN HAVE BEEN LOCATED FROM FIELD SURVEY INFORMATION AND EXISTING PLANS. THIS OFFICE MAKES NO GUARANTEE THAT THE UTILITIES SHOWN COMPRISE ALL SUCH OR ABANDONED. THE SURVEYOR DOES NOT WARRANT THAT THE UTILITIES SHOWN ARE IN THE EXACT LOCATION INDICATED ALTHOUGH THEY ARE LOCATED AS ACCURATELY AS POSSIBLE FROM ALL AVAILABLE INFORMATION. (CONTACT DIG-SAFE PRIOR TO ANY CONSTRUCTION (1-888-DIG-SAFE) AND/OR ALL LOCAL UTILITY COMPANIES.
- WETLAND EDGE FLAGGED BY KATHLEEN MANGAN.
- PROPOSED ALTERATION OF PERIMETER WETLAND IS 1966 s.f.

**EROSION CONTROL NOTES**

- Prior to any construction activity, a line of silt fence or hay bales shall be placed as shown and maintained throughout the construction process.
- All disturbance is to be limited to the areas shown.
- All excavated materials to be used for grading operations shall be stockpiled and surrounded by silt fence.
- All excess unwanted materials shall be removed from the site.
- All disturbed areas, shall be loamed and seeded as soon as possible. All slopes shall be stabilized using appropriate methods.
- All silt fencing, hay bales, and mulch shall remain in place until after the grass or sod has properly rooted. (About 6 to 8 weeks)
- The following seed mix is to be used in all disturbed and exposed areas. Before seeding, a minimum of 4 inches of compacted loam shall be installed.

**SEED MIXTURE-GENERAL PURPOSE**

SEED MIXTURE	Lbs/acre	Lbs/1000sf
Red Fescue	75	1.75
Kentucky Bluegrass	15	.35
Colonial Bentgrass	5	.11
Perennial Ryegrass	5	.11

**DRIVEWAY SPECIFICATIONS:**

Use 3/4" to 1 1/2" diameter washed, angular crushed stone installed to a minimum depth of three (3) inches.  
Refer to Rhode Island Stormwater Management Guidance for Individual Single-Family Residential Lot Development.

**RAIN GARDEN DESIGN**

- Roof Area = 24'x32' = 768 sf
- Per the table below: a 6" deep rain garden requires 120 sf for an 800 sf area.
- Provide a rain garden size of 6'x25' per the detail.

Table 7 and 8 Rain Garden Sizing Guidelines

Drainage Area (Square feet)	for 4 inch deep garden	for 6 inch deep garden	for 8 inch deep garden
100	19	13	8
200	36	20	16
300	52	33	24
400	68	40	32
500	84	47	40
600	100	54	48
700	116	61	56
800	132	68	64
900	148	75	72
1000	164	82	80

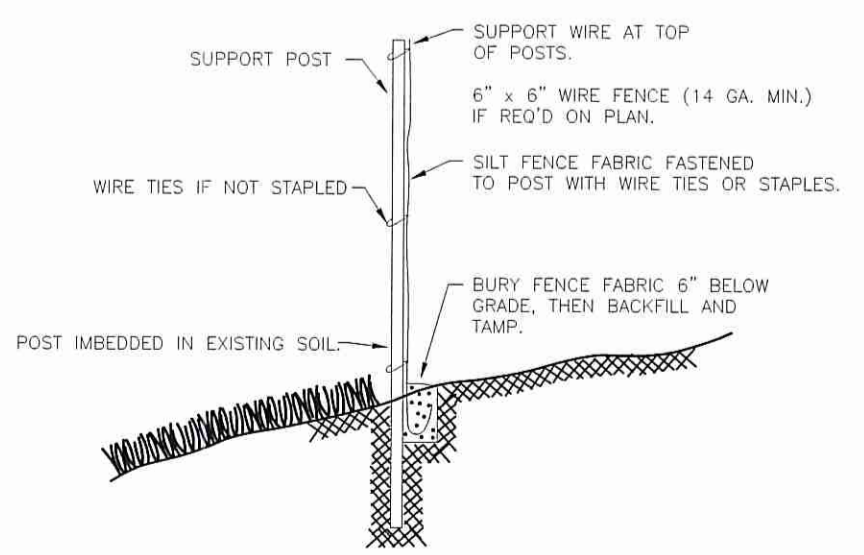

**SILT FENCE DETAIL**

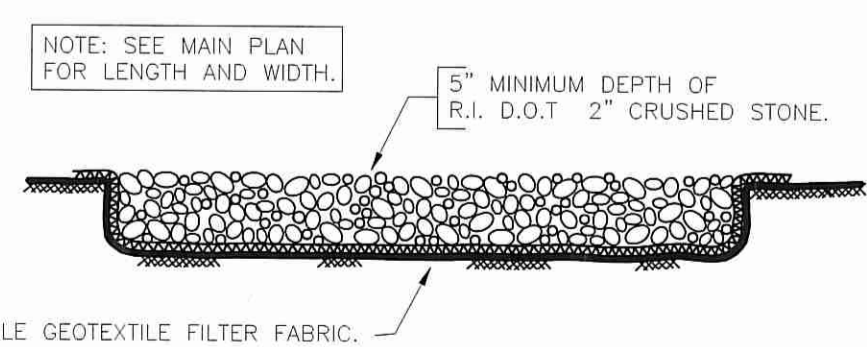

**CONSTRUCTION ENTRANCE SECTION**

**CERTIFICATION**

THIS SURVEY HAS BEEN CONDUCTED AND THE PLAN HAS BEEN PREPARED PURSUANT TO SECTION 9 OF THE RULES AND REGULATIONS ADOPTED BY THE RHODE ISLAND STATE BOARD OF REGISTRATION FOR PROFESSIONAL LAND SURVEYORS ON NOVEMBER 25, 2015, AS FOLLOWS:

TYPE OF BOUNDARY SURVEY: MEASUREMENT SPEC.:  
COMPREHENSIVE BOUNDARY SURVEY I  
OTHER TYPE OF SURVEY: MEASUREMENT SPEC.:  
DATA ACCUMULATION SURVEY III  
STATEMENT OF PURPOSE:  
LOCATION OF EXISTING CONDITIONS ON SAID PARCEL:

BY STEVEN M. PINCH R.P.L.S #1909

ZONING: R-10

BUILDING SETBACKS:  
FRONT YARD - 25'  
REAR YARD - 30'  
SIDE YARD - 10'

PINCH LAND SURVEYING  
P.O. Box 352  
Wakefield, RI 02879  
401-789-8087  
www.pinchsurveying.com  
pinchsurveying@verizon.net

DEPARTMENT OF ENVIRONMENTAL MANAGEMENT  
OFFICE OF WATER RESOURCES  
FRESHWATER WETLANDS PROGRAM  
APPROVED WITH CONDITIONS  
AS SPECIFIED IN THE LETTER OF APPROVAL  
DATED OCT 19 2017 FILE # 17-0157  
NO CHANGES ALLOWED WITHOUT PRIOR APPROVAL  
APPROVED PLANS MUST BE AT CONSTRUCTION SITE

REVISION:  
8/11/17 RAIN GARDEN  
9/28/17 MOVE RAIN GARDEN, DRIVEWAY SPECS

PROPOSED CONDITIONS PLAN  
LOT 104 ASSESSOR'S MAP 56-2  
OWNED BY:  
JULIE SMITH  
IN THE TOWN OF:  
SOUTH KINGSTOWN, RI.  
STEVEN M. PINCH P.L.S.  
SCALE: 1" = 20' JUNE, 2017

