

Construction Sequencing

Phase 1 - Grass Swale, Level Spreader, Compensatory Flood Storage, Stone Wall, Fence Expansion and New Driveway

Phase 2 - New Transmission Line Structures and Conductor Re-alignment

Phase 3 - Installation of Electrical Equipment within Substation

Source: NationalGrid Over All Site Plan, H64752-5A, Progress 5/19/2017; National Grid Existing Conditions Plan, 900001838836, 5/25/2017; FEMA, 2009 Service Layer Credits: © 2017 DigitalGlobe © CNES (2017) Distribution Airbus DS © 2017 Microsoft Corporation © 2010

- Q143S Line and Proposed Structures
- R144 Line and Proposed Structures
- S171N Line and Proposed Structures
- T172N Line and Proposed Structures
- Proposed Driveway
- Proposed Fence
- Delineated Wetland
- Delineated Stream
- Existing Structure
- Limit of Disturbance (LOD)
- Proposed Access Route
- ▨ Proposed Wetland Matting
- Proposed Work Pad
- Existing Gravel
- 50-foot Perimeter Wetland Buffer
- 100-foot Riverfront Buffer
- ▨ Temporary Wetland Buffer Impact
- ▨ Permanent Wetland Buffer Impact
- Concrete Washout
- Silt Fence
- ▲ Straw Wattles
- Construction Entrance
- Proposed Contour Line
- Existing Substation Components

Wetland Impact Table	
Impact Type	Square Feet
Permanent wetland impacts (new pole installation)	432
Temporary wetland impacts (construction access mats)	26,769
Permanent perimeter wetland buffer-(substation expansion and access road)	15,419
Temporary perimeter wetland buffer	19,564

DEPARTMENT OF ENVIRONMENTAL MANAGEMENT
 OFFICE OF WATER RESOURCES
 FRESHWATER WETLANDS PROGRAM
 APPROVED WITH CONDITIONS
 AS SPECIFIED IN THE LETTER OF APPROVAL
 DATED NOV 03 2017 FILE # 17-0169
 NO CHANGES ALLOWED WITHOUT PRIOR APPROVAL
 APPROVED PLANS MUST BE AT CONSTRUCTION SITE

Kindly be advised that this Permit is not equivalent to a verification of the type or extent of freshwater wetlands on site.

200 Feet

Warrantville Mills
 650 Suffolk Street
 Taunton, MA 01854
 978-970-5600

TRC
 TRC CONSULTANTS

PROPOSED WETLAND IMPACTS AND SESC PLAN
 NARRANGANSETT ELECTRIC COMPANY
 WOONSOCKET SUBSTATION RECONFIGURATION
 TAX PLAT 9, LOTS 599, 633, 640 AND 641
 NORTH SMITHFIELD, RI

FIGURE 3 SEPTEMBER 2017

Martin D. Wencsek

R:\Projects\GIS\2017\273423_NGrid_WoonsocketSubstation\SESC\Wetlands\17-17_20170925.mxd

WOONSOCKET SUBSTATION 26

GRADING & DRAINAGE PLANS

76 GREENVILLE ROAD

NORTH SMITHFIELD, RHODE ISLAND 02896

LEGEND	
ABAND	ABANDONED
ALT	ALTERNATE ROUTE
AC	ASBESTOS CONCRETE
BIT CONC	BITUMINOUS CONCRETE
BCC	BITUMINOUS CONCRETE CURB
BCD	BITUMINOUS CONCRETE DRIVE
BCW	BITUMINOUS CONCRETE WALK
BS	BORING LOCATION
BS	BRUSHED STEEL PIPE
BS	BUSH
CATV	CABLE TELEVISION LINE
CI	CAST IRON
CICL	CAST IRON-CEMENT LINED PIPE
CIP	CAST IRON PIPE
CB	CATCH BASIN
oCP TEST	CATHODIC PROTECTION TEST
CLF	CHAIN LINK FENCE
CS	CONDUIT MANHOLE OR PULL BOX
CS	COATED STEEL
CC	CONCRETE CURB
CW	CONCRETE WALK
CU	CONTINUATION UNDETERMINED
CMP	CORRUGATED METAL PIPE
CPP	CORRUGATED PLASTIC PIPE
DIA	DIAMETER
D	DECIDUOUS TREE
DMH	DRAIN MANHOLE
DI	DUCTILE IRON
DICL	DUCTILE IRON-CEMENT LINED
EOP	EDGE OF PAVEMENT
EHH	ELECTRIC HANDHOLE
EL	ELECTRIC LINE
EMH	ELECTRIC MANHOLE
EP/LP	ELEVATION
EL	ESCUTCHEON PIN IN LEAD PLUG
EL	EVERGREEN TREE
230	EXISTING MAJOR CONTOUR
231	EXISTING MINOR CONTOUR
FND	FENCE
GG	FOUND
G	GAS GATE
G	GAS LINE
GRAN	GRANITE
GC	GRANITE CURB
GP	GUARD POST (BOLLARD)
HH	GUY WIRE
HH	HANDHOLE
HYD	HYDRANT
IP	INVERT
IP	IRON PIPE
LP	LIGHT POLE
(M)	MARKED IN FIELD
NPV	NO PIPE VISIBLE
PCI	PIT CAST IRON PIPE
PIF	PICKET FENCE
PL	PLASTIC PIPE
PK, NAIL SPIKE	PK., NAIL SPIKE
PVC	POLYVINYL CHLORIDE
230	PROPERTY LINE
231	PROPOSED MAJOR CONTOUR
(R)	PROPOSED MINOR CONTOUR
RCP	RECORD
R	REINFORCED CONCRETE PIPE
R	RIM
S	100' RIPARIAN
SMH	SEWER LINE
S	SEWER MANHOLE
SBCC	SIGN
+100.0	SLOPED BITUMINOUS CONCRETE CURB
SB	SPOT ELEVATION
SB/DH	STONE BOUND
TMH	STONE BOUND WITH DRILL HOLE
TOS	TELEPHONE LINE
TOW	TELEPHONE MANHOLE
TRANSF	TOP OF SILT
U/G	TOP OF WATER
UNKG	TRANSFORMER
UP#	TREE LINE
UP/LP	UNDERGROUND
VCP	UNKNOWN GATE
WG	UTILITY POLE
W	UTILITY POLE/LIGHT POLE
W	VITRIFIED CONCRETE PIPE
W	WATER GATE
W	WATER LINE
W	WETLAND AREA
W	WETLAND FLAG
W	WETLAND LINE
W	50' WETLAND BUFFER
W/	WITH
WRIF	WROUGHT IRON FENCE

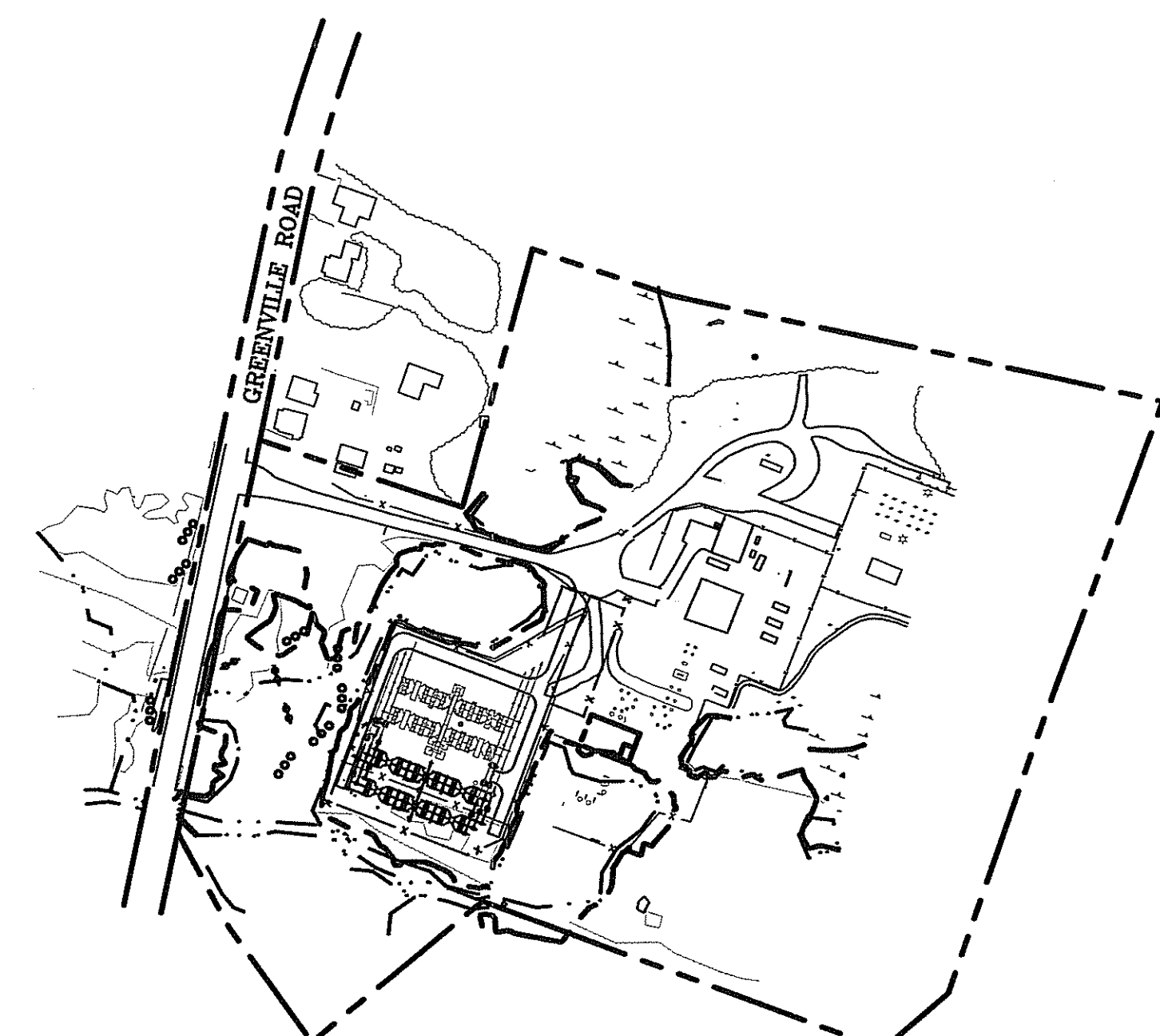
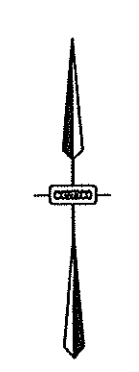

SCALE: 1" = 200'

DESCRIPTION	SHEET
COVER SHEET	1
EXISTING CONDITIONS & DEMOLITION PLAN	2
PROPOSED SITE GRADING & DRAINAGE PLAN	3
QUALIFYING PVIOUS AREA PLAN	4
DETAIL & NOTES SHEETS	5-6

PREPARED FOR:
NATIONAL GRID
 40 SYLVAN ROAD
 WALTHAM,
 MASSACHUSETTS 02451



4 FIRST STREET, BRIDGEWATER, MASSACHUSETTS 02324
 PHONE: 508.697.3191, FAX: 508.697.5996
 WEBSITE: www.coneco.com

PREPARED ON:
JULY 12, 2017
 REVISED SEPTEMBER 22, 2017

ENGINEER:
 DAVID A. HARRINGTON, P.E.
 CONECO ENGINEERS & SCIENTISTS, INC.
 BRIDGEWATER, MA 02324

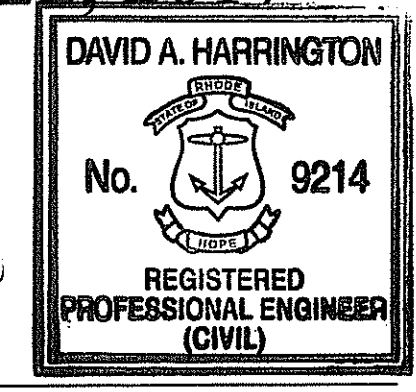

RHODE ISLAND REGISTERED PROFESSIONAL ENGINEER #9214
 DATE: 9/22/17

DEPARTMENT OF ENVIRONMENTAL MANAGEMENT
 OFFICE OF WATER RESOURCES
 FRESHWATER WETLANDS PROGRAM
 APPROVED WITH CONDITIONS
 AS SPECIFIED IN THE LETTER OF APPROVAL
 DATED NOV 03 2017 FILE # 17-0169
 NO CHANGES ALLOWED WITHOUT PRIOR APPROVAL
 APPROVED PLANS MUST BE AT CONSTRUCTION SITE

Martin D. Senack

REVISIONS			
NO.	DATE	DESCRIPTION	DR/CK
1	09/22/2017	CHANGES PER RIDEM COMMENTS	DJD/DAH

9/22/17

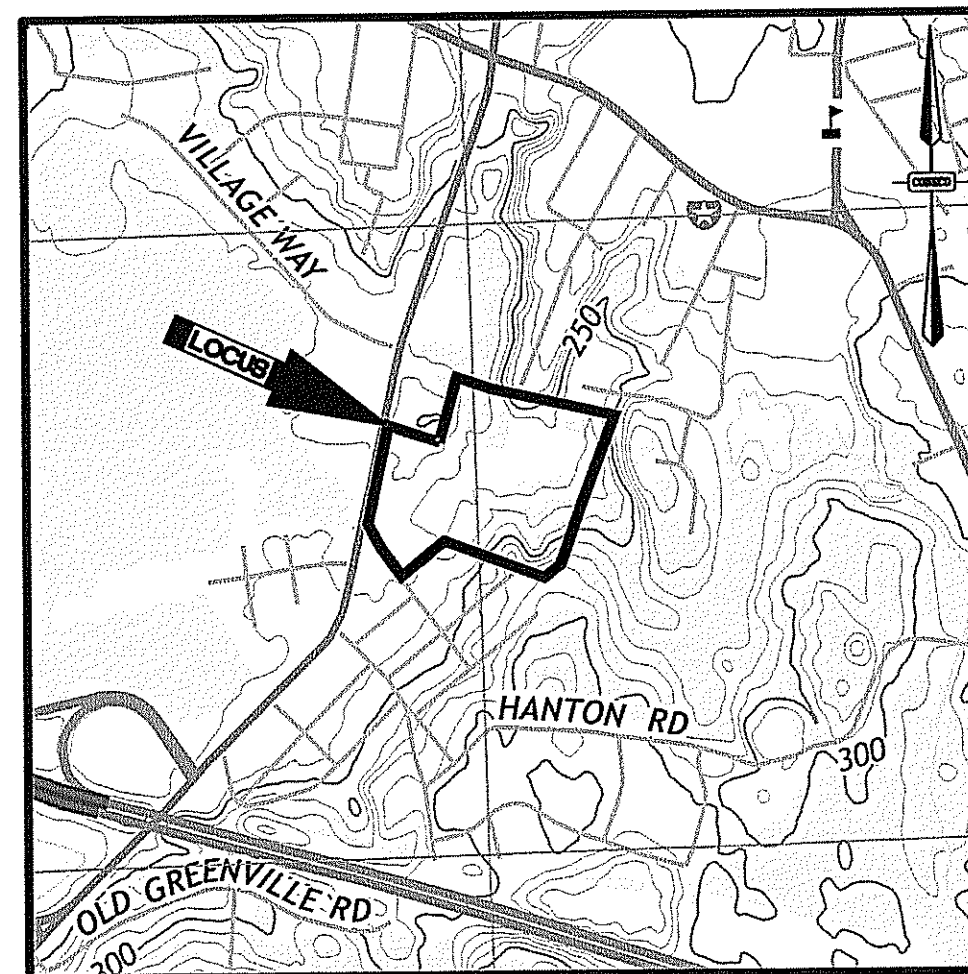
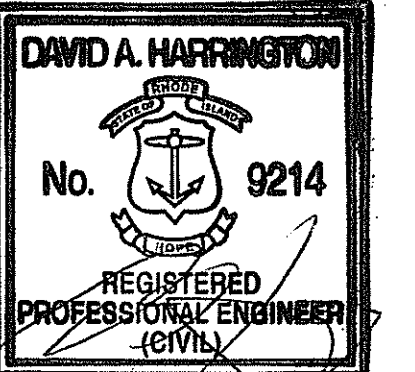

LOCUS MAP
Scale: 1" = 1000'

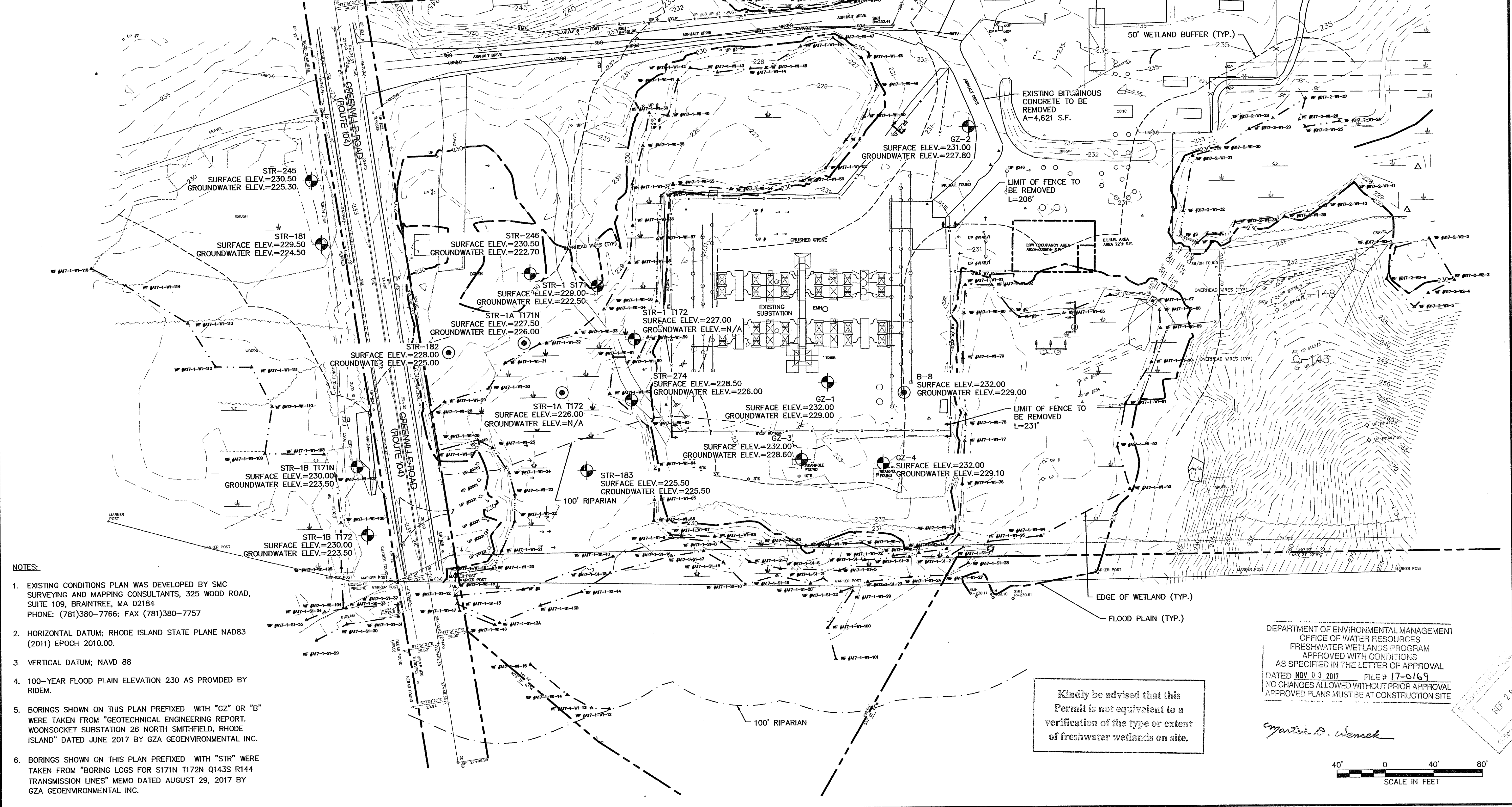

- NOTES:
- EXISTING CONDITIONS PLAN WAS DEVELOPED BY SMC SURVEYING AND MAPPING CONSULTANTS, 325 WOOD ROAD, SUITE 109, BRAINTREE, MA 02184
PHONE: (781)380-7766; FAX (781)380-7757
 - HORIZONTAL DATUM; RHODE ISLAND STATE PLANE NAD83 (2011) EPOCH 2010.00.
 - VERTICAL DATUM; NAVD 88
 - 100-YEAR FLOOD PLAIN ELEVATION 230 AS PROVIDED BY RIDEM.
 - BORINGS SHOWN ON THIS PLAN PREFIXED WITH "GZ" OR "B" WERE TAKEN FROM "GEOTECHNICAL ENGINEERING REPORT. WOONSOCKET SUBSTATION 26 NORTH SMITHFIELD, RHODE ISLAND" DATED JUNE 2017 BY GZA GEOENVIRONMENTAL INC.
 - BORINGS SHOWN ON THIS PLAN PREFIXED WITH "STR" WERE TAKEN FROM "BORING LOGS FOR S171N T172N Q143S R144 TRANSMISSION LINES" MEMO DATED AUGUST 29, 2017 BY GZA GEOENVIRONMENTAL INC.

Kindly be advised that this Permit is not equivalent to a verification of the type or extent of freshwater wetlands on site.

DEPARTMENT OF ENVIRONMENTAL MANAGEMENT
OFFICE OF WATER RESOURCES
FRESHWATER WETLANDS PROGRAM
APPROVED WITH CONDITIONS
AS SPECIFIED IN THE LETTER OF APPROVAL
DATED NOV 03 2017 FILE # 17-0169
NO CHANGES ALLOWED WITHOUT PRIOR APPROVAL
APPROVED PLANS MUST BE AT CONSTRUCTION SITE

Martin D. Senack

NO.	DATE	DESCRIPTION	DR/CK	DJD/DAT
1	09/22/2017	CHANGES PER RIDEM COMMENTS		

NATIONAL GRID
40 SYLVAN ROAD
WALTHAM, MASSACHUSETTS 02451

WOONSOCKET SUBSTATION 26
76 GREENVILLE ROAD
ASSASSOR'S PLAT 9
LOTS 599, 639, 640 & 641
NORTH SMITHFIELD, RHODE ISLAND 02886

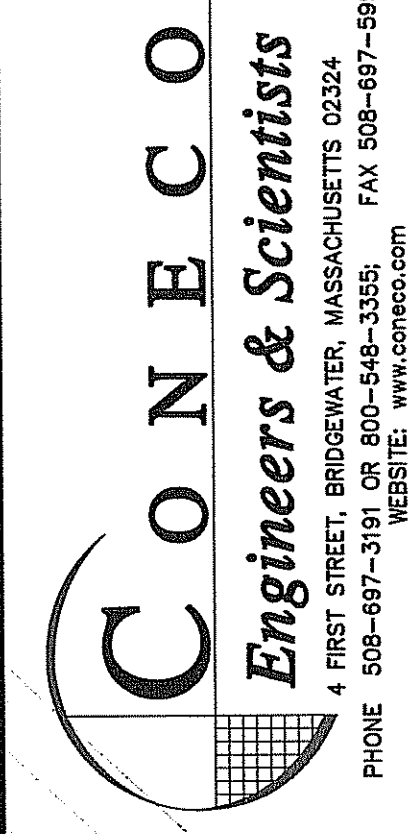

DATE	07/12/2017
DESIGNED:	N/A
CHECKED:	DAH
DRAFTED:	DJD
IN CHARGE:	RTL
SCALE:	1" = 40'
PROJECT NO.	6144.1
SHEET NO.	2

DAVID A. HARRINGTON
No. 9214
REGISTERED PROFESSIONAL ENGINEER (CIVIL)

NO.	DATE	DESCRIPTION
1	08/22/2017	CHANGES PER RIEM COMMENTS

NATIONAL GRID
40 SYLVAN ROAD
WALTHAM, MASSACHUSETTS 02451

WOOSOCKET SUBSTATION 26
76 GREENVILLE ROAD
ASSESSOR'S PLAT 9
LOTS 599, 633, 640 & 641
NORTH SMITHTFIELD, RHODE ISLAND 02896

CONECO
Engineers & Scientists
4 FIRST STREET, BRIDGEWATER, MASSACHUSETTS 02224
PHONE 508-697-3181 OR 800-548-3355 FAX 508-697-5996
WEBSITE: www.coneco.com

DATE	07/12/2017
DESIGNED: DJD	CHECKED: DAH
DRAFTED: DJD	IN CHARGE: RTL
SCALE:	1" = 40'
PROJECT NO.	6144.1
SHEET NO.	3 OF 06

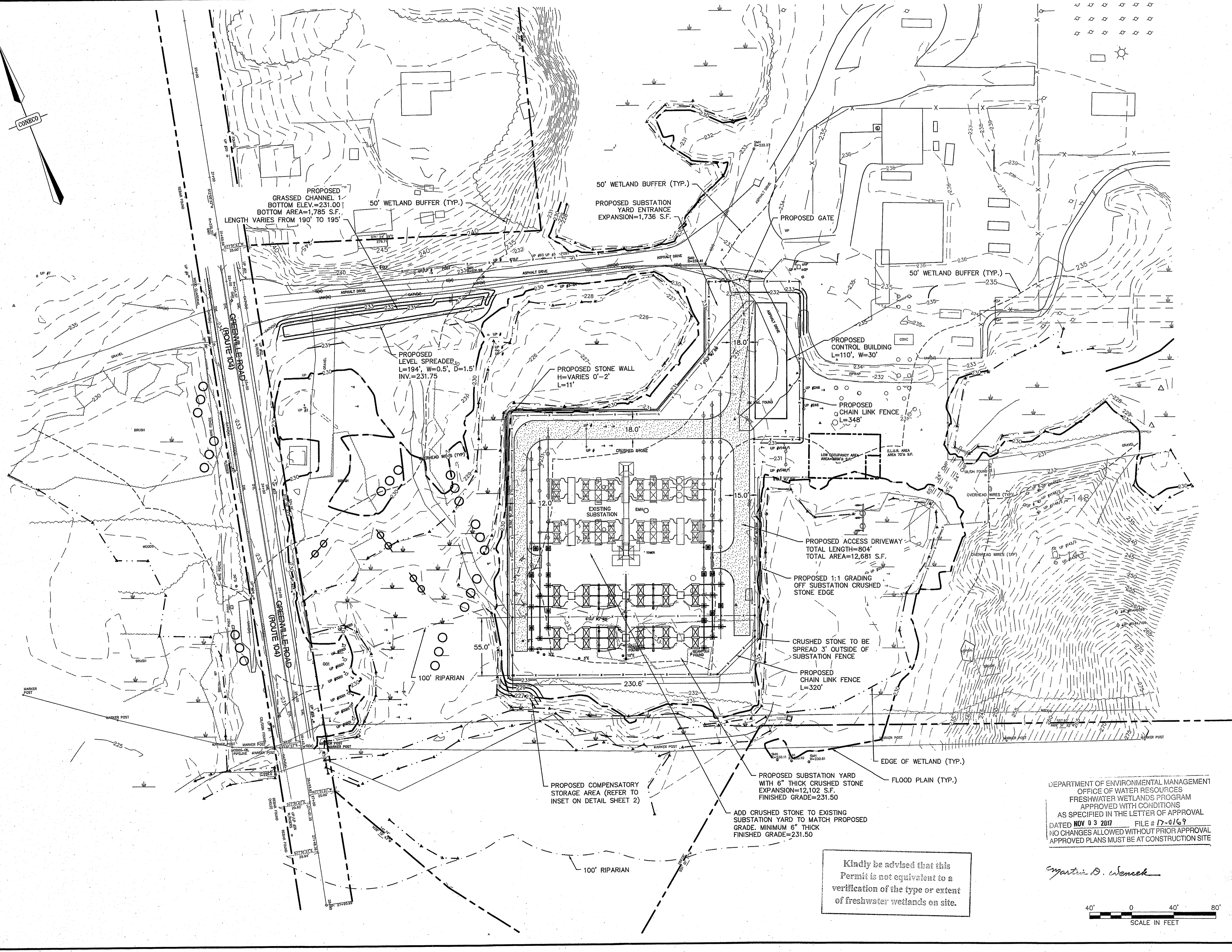
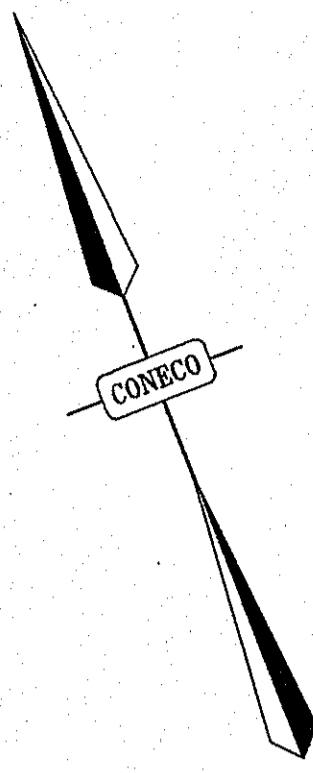

DEPARTMENT OF ENVIRONMENTAL MANAGEMENT
OFFICE OF WATER RESOURCES
FRESHWATER WETLANDS PROGRAM
APPROVED WITH CONDITIONS
AS SPECIFIED IN THE LETTER OF APPROVAL
DATED NOV 03 2017 FILE # 17-0167
NO CHANGES ALLOWED WITHOUT PRIOR APPROVAL
APPROVED PLANS MUST BE AT CONSTRUCTION SITE

Martin D. Wencel

Kindly be advised that this Permit is not equivalent to a verification of the type or extent of freshwater wetlands on site.

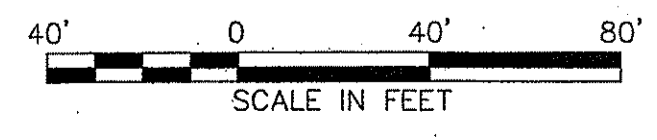

NO.	DATE	DESCRIPTION	DR/CK

PREPARED FOR:
NATIONAL GRID
 40 SYLVAN ROAD
 WALTHAM, MASSACHUSETTS 02451

DRAWING:
QUALIFYING PERVIOUS AREA PLAN

PROJECT:
WOONSOCKET SUBSTATION 26
 76 GREENVILLE ROAD
 ASSESSOR'S PLAT 9
 LOTS 699, 633, 640 & 641
 NORTH SMITHFIELD, RHODE ISLAND 02896

PLAN SET:
GRADING & DRAINAGE PLANS

CONECO
Engineers & Scientists
 4 FIRST STREET, BRIDGEWATER, MASSACHUSETTS 02924
 PHONE: 508-697-3191 OR 800-548-1355 FAX: 508-697-5996
 WEBSITE: www.coneco.com

DATE	09/22/2017
DESIGNED: D.J.D.	CHECKED: DAH
DRAFTED: D.J.D.	IN CHARGE: RTL
SCALE:	1" = 40'
PROJECT NO.	6144.1
SHEET NO.	4

OF 06

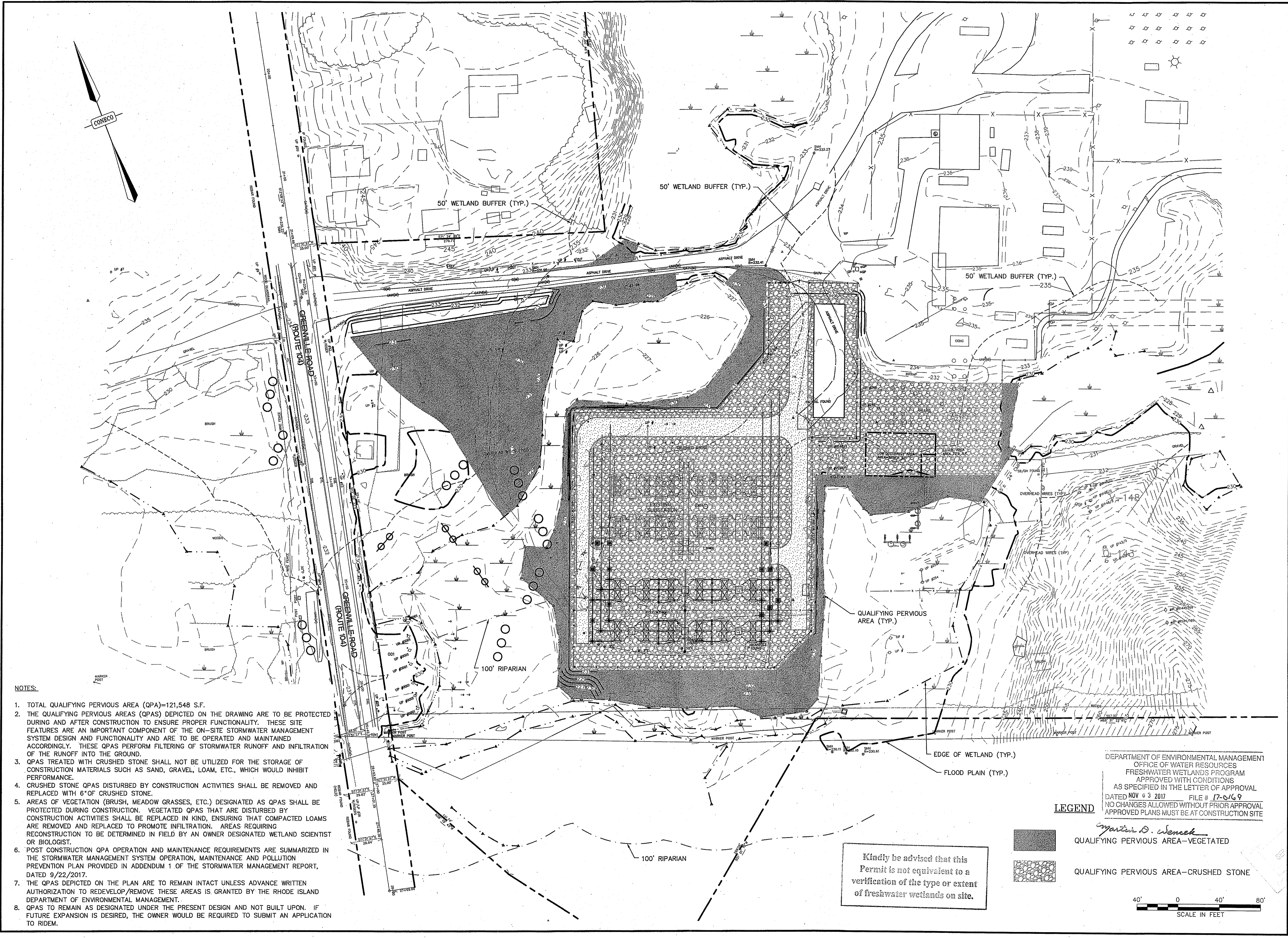

- NOTES:**
- TOTAL QUALIFYING PERVIOUS AREA (QPA)=121,548 S.F.
 - THE QUALIFYING PERVIOUS AREAS (QPAS) DEPICTED ON THE DRAWING ARE TO BE PROTECTED DURING AND AFTER CONSTRUCTION TO ENSURE PROPER FUNCTIONALITY. THESE SITE FEATURES ARE AN IMPORTANT COMPONENT OF THE ON-SITE STORMWATER MANAGEMENT SYSTEM DESIGN AND FUNCTIONALITY AND ARE TO BE OPERATED AND MAINTAINED ACCORDINGLY. THESE QPAS PERFORM FILTERING OF STORMWATER RUNOFF AND INFILTRATION OF THE RUNOFF INTO THE GROUND.
 - QPAS TREATED WITH CRUSHED STONE SHALL NOT BE UTILIZED FOR THE STORAGE OF CONSTRUCTION MATERIALS SUCH AS SAND, GRAVEL, LOAM, ETC., WHICH WOULD INHIBIT PERFORMANCE.
 - CRUSHED STONE QPAS DISTURBED BY CONSTRUCTION ACTIVITIES SHALL BE REMOVED AND REPLACED WITH 6" OF CRUSHED STONE.
 - AREAS OF VEGETATION (BRUSH, MEADOW GRASSES, ETC.) DESIGNATED AS QPAS SHALL BE PROTECTED DURING CONSTRUCTION. VEGETATED QPAS THAT ARE DISTURBED BY CONSTRUCTION ACTIVITIES SHALL BE REPLACED IN KIND, ENSURING THAT COMPACTED LOAMS ARE REMOVED AND REPLACED TO PROMOTE INFILTRATION. AREAS REQUIRING RECONSTRUCTION TO BE DETERMINED IN FIELD BY AN OWNER DESIGNATED WETLAND SCIENTIST OR BIOLOGIST.
 - POST CONSTRUCTION QPA OPERATION AND MAINTENANCE REQUIREMENTS ARE SUMMARIZED IN THE STORMWATER MANAGEMENT SYSTEM OPERATION, MAINTENANCE AND POLLUTION PREVENTION PLAN PROVIDED IN ADDENDUM 1 OF THE STORMWATER MANAGEMENT REPORT, DATED 9/22/2017.
 - THE QPAS DEPICTED ON THE PLAN ARE TO REMAIN INTACT UNLESS ADVANCE WRITTEN AUTHORIZATION TO REDEVELOP/REMOVE THESE AREAS IS GRANTED BY THE RHODE ISLAND DEPARTMENT OF ENVIRONMENTAL MANAGEMENT.
 - QPAS TO REMAIN AS DESIGNATED UNDER THE PRESENT DESIGN AND NOT BUILT UPON. IF FUTURE EXPANSION IS DESIRED, THE OWNER WOULD BE REQUIRED TO SUBMIT AN APPLICATION TO RIDEM.

Kindly be advised that this Permit is not equivalent to a verification of the type or extent of freshwater wetlands on site.

DEPARTMENT OF ENVIRONMENTAL MANAGEMENT
 OFFICE OF WATER RESOURCES
 FRESHWATER WETLANDS PROGRAM
 APPROVED WITH CONDITIONS
 AS SPECIFIED IN THE LETTER OF APPROVAL
 DATED NOV 6 3 2017 FILE # 17-0169
 NO CHANGES ALLOWED WITHOUT PRIOR APPROVAL
 APPROVED PLANS MUST BE AT CONSTRUCTION SITE

Matthew D. Senneker
 QUALIFYING PERVIOUS AREA-VEGETATED

QUALIFYING PERVIOUS AREA-CRUSHED STONE

LEGEND

SCALE IN FEET
 0 40 80

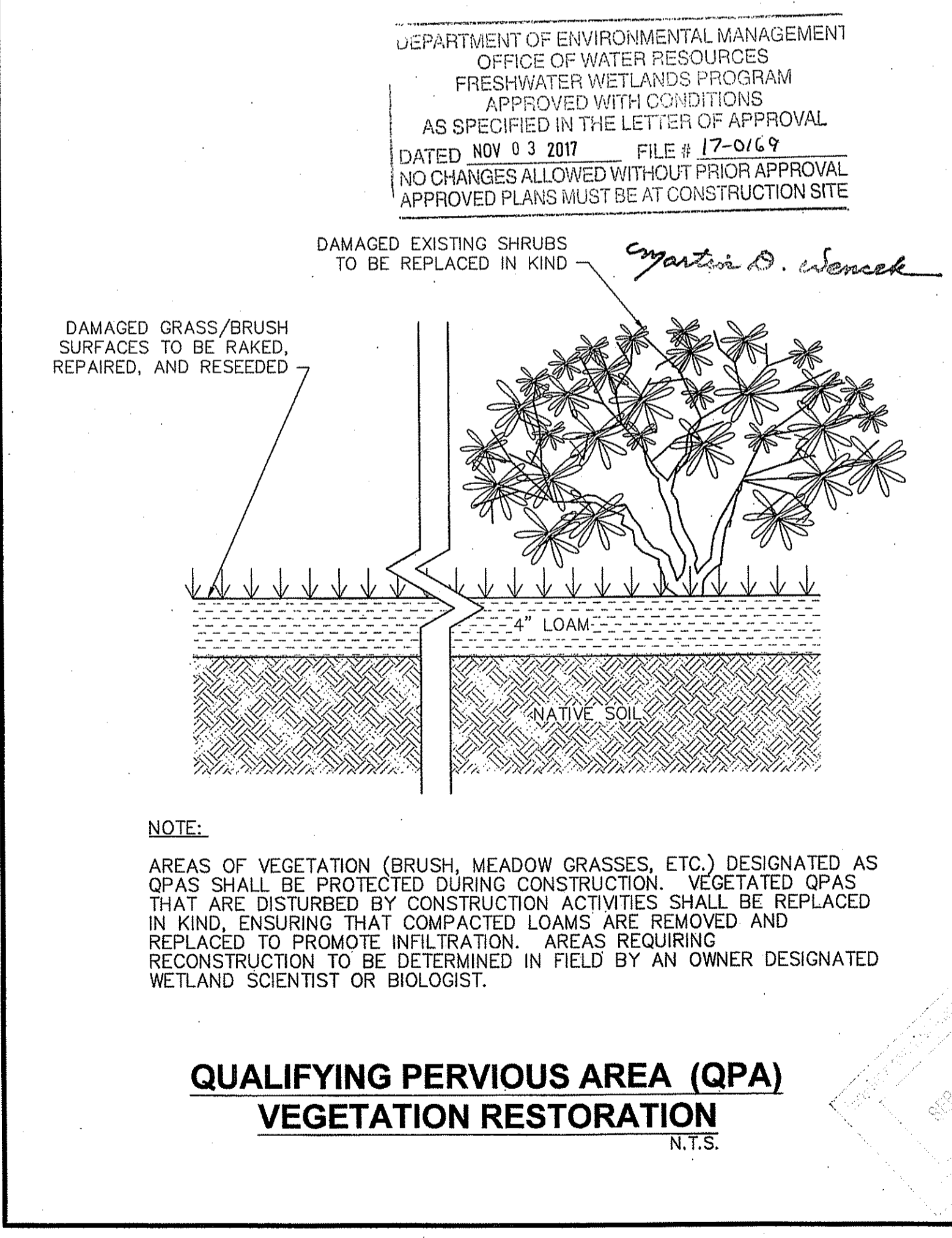
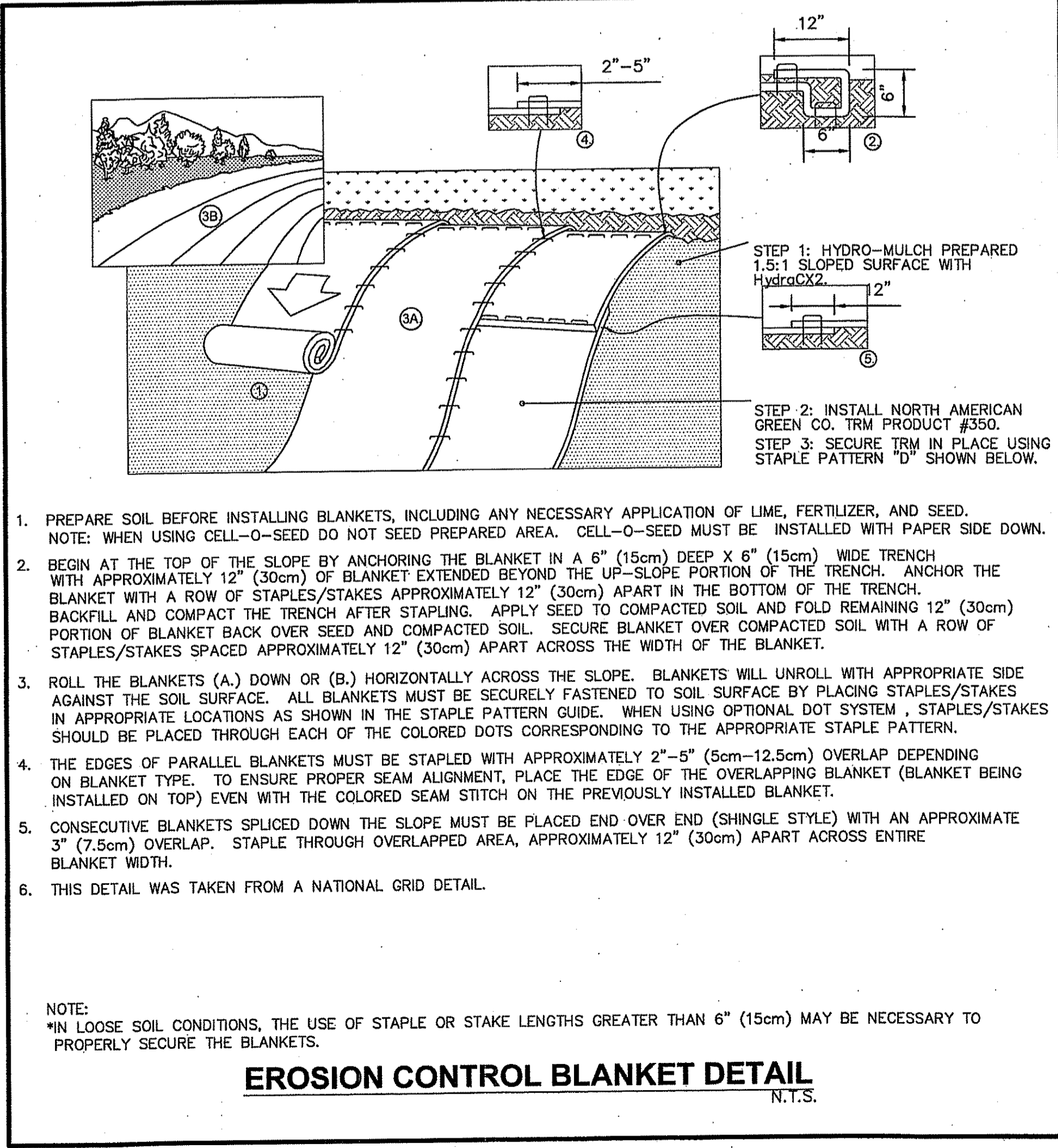
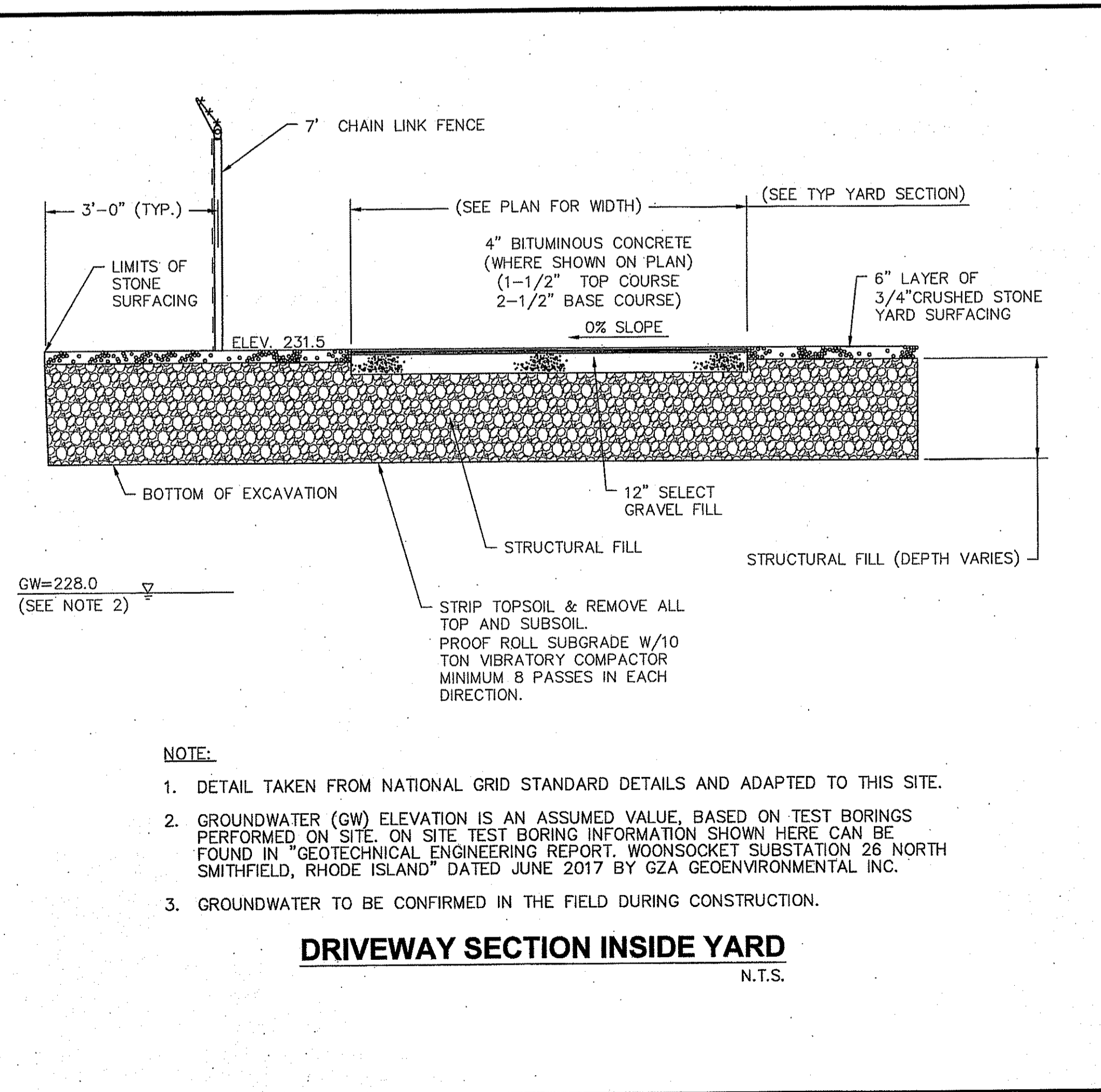
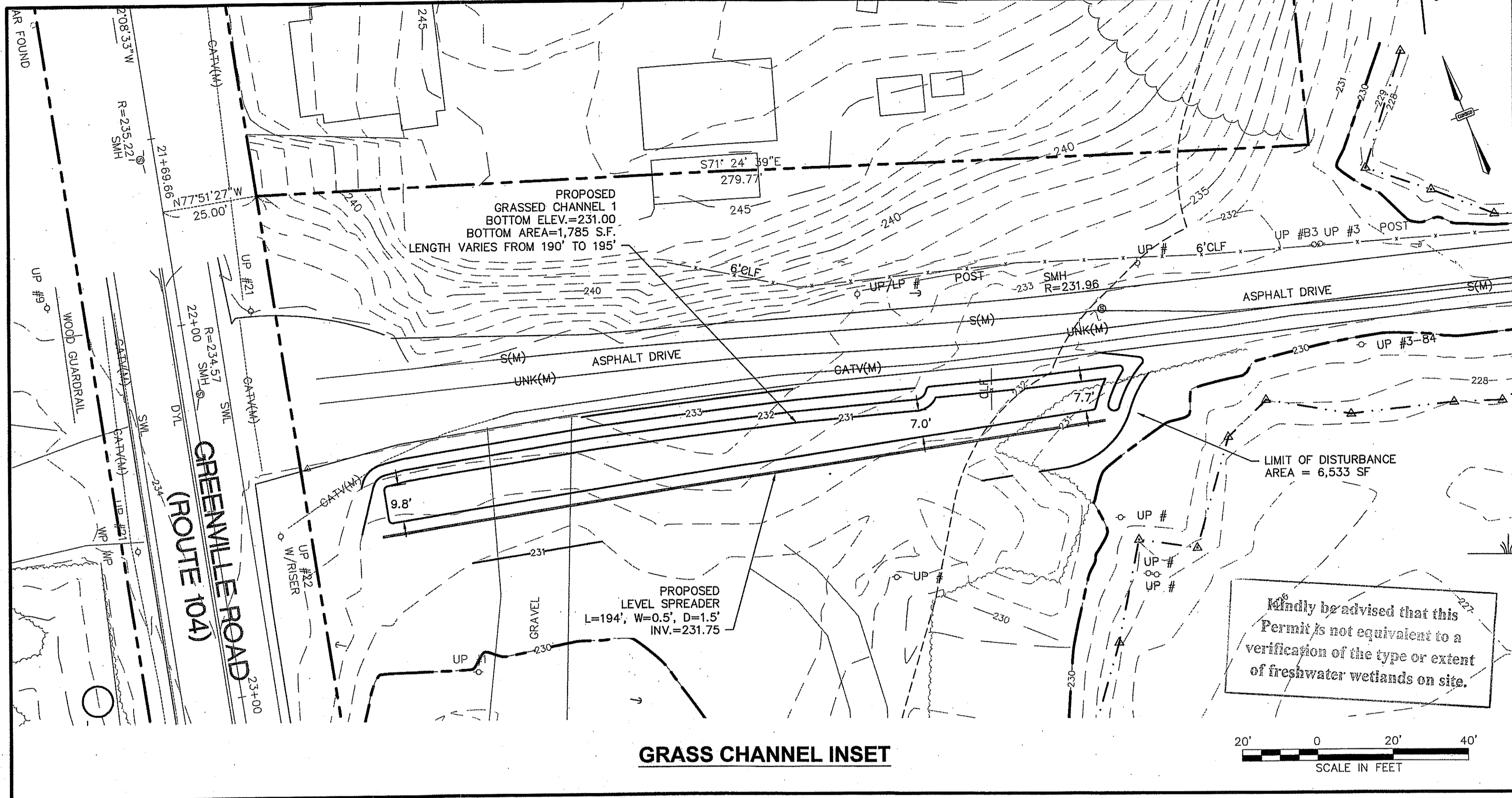
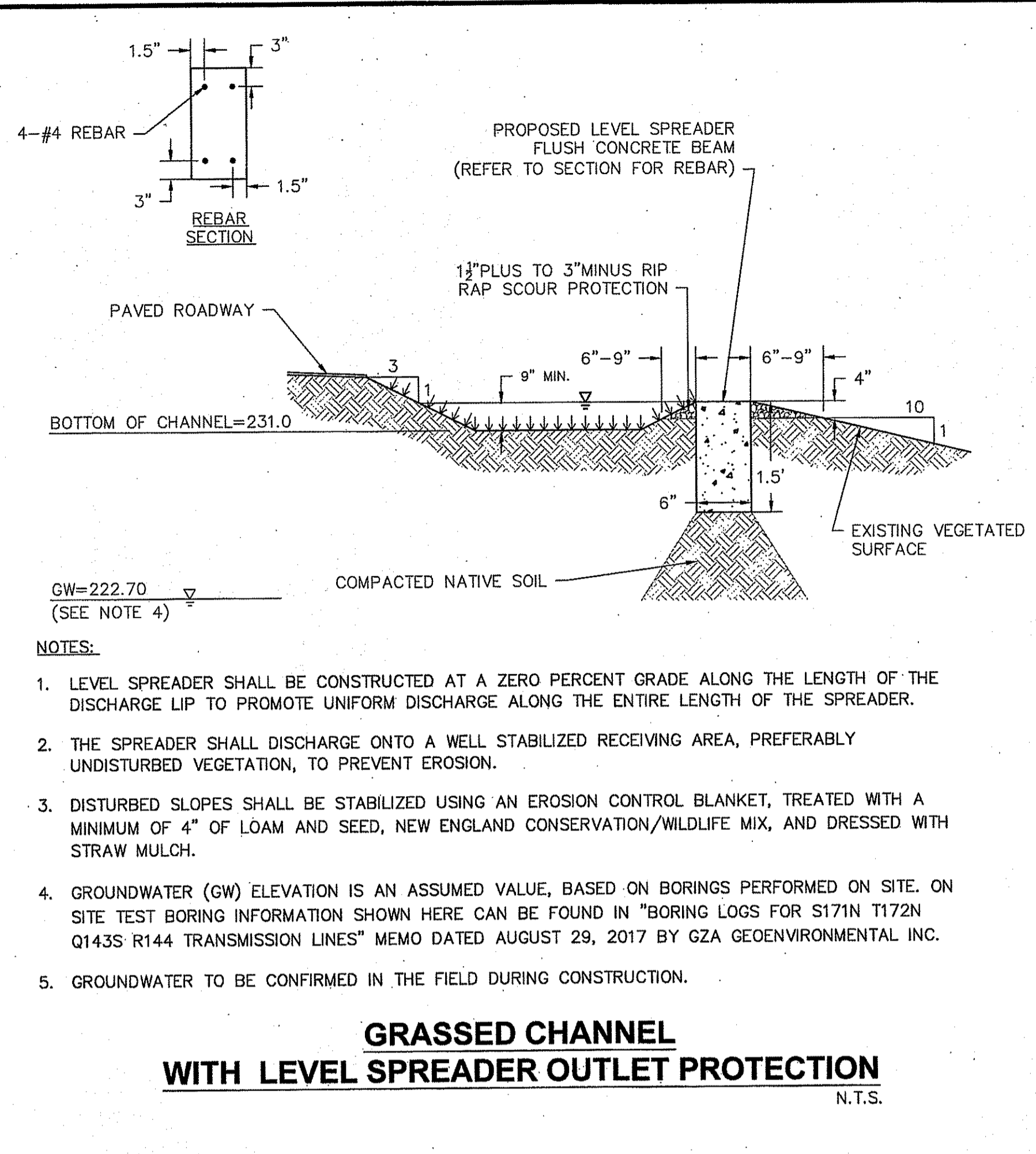

NO.	DATE	DESCRIPTION	DR/CHK	DJP/DAH
1	08/22/2017	CHANGES PER RIDEK COMMENTS		

PREPARED FOR:
 NATIONAL GRID
 40 SYLVAN ROAD
 WALTHAM, MASSACHUSETTS 02451

DRAWING:
 DETAIL & NOTES SHEET
 1 OF 2

PROJECT:
 WOONSOCKET SUBSTATION 26
 76 GREENVILLE ROAD
 ASSESSOR'S PLAT 9
 LOTS 599, 633, 640 & 641
 NORTH SMITHFIELD, RHODE ISLAND 02896

PLAN SET:
 GRADING & DRAINAGE PLANS

CONECO
 Engineers & Scientists
 4 FIRST STREET, BRIDGEWATER, MASSACHUSETTS 02224
 PHONE: 508-697-3181 OR 800-548-3555 FAX: 508-697-5996
 WEBSITE: www.coneco.com

DATE	07/12/2017
DESIGNED: DJD	CHECKED: DAH
DRAFTED: DJD	IN CHARGE: RTL
SCALE:	AS SHOWN
PROJECT NO.	6144.1
SHEET NO.	5

OF 06

9/22/17

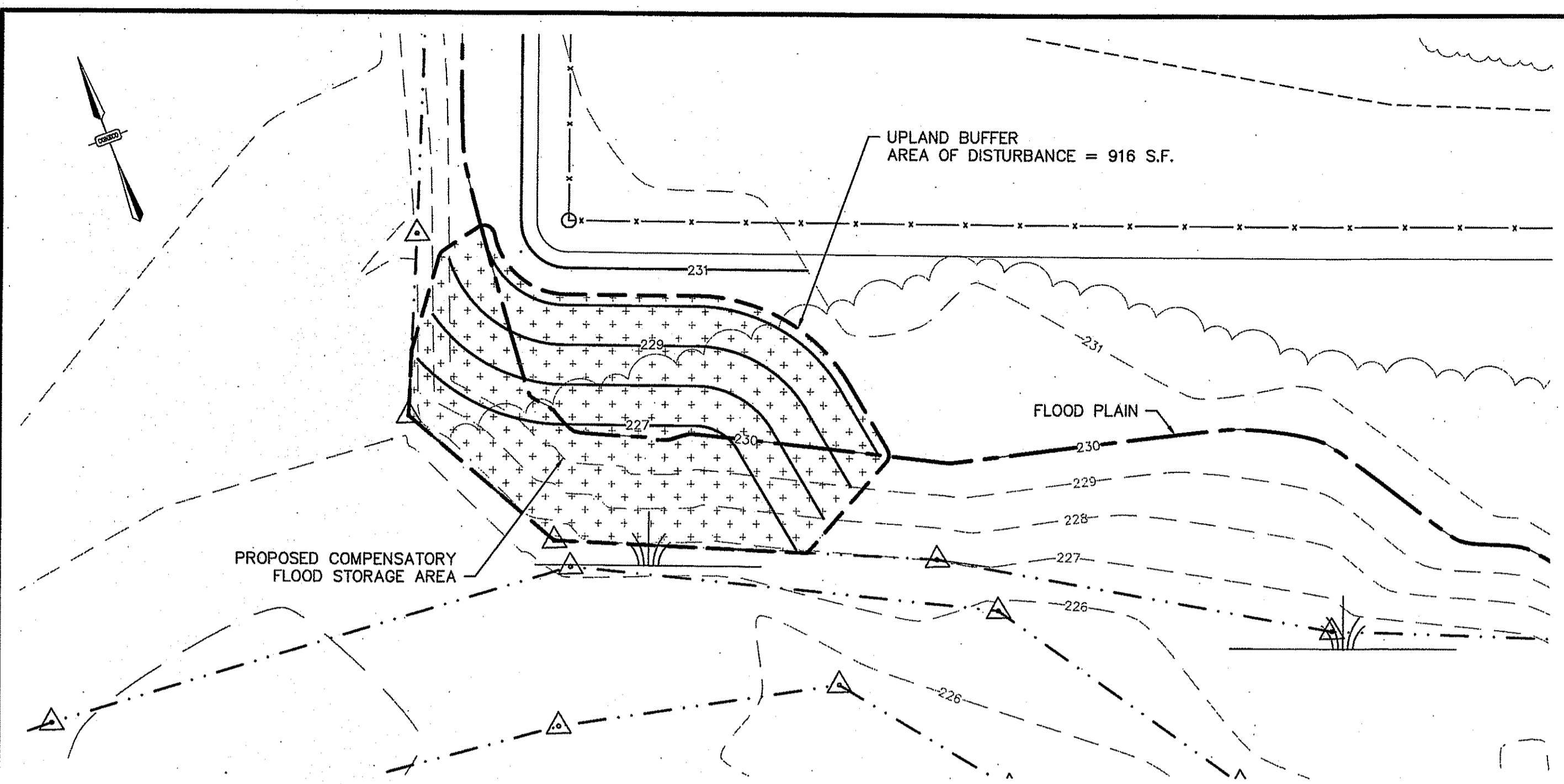
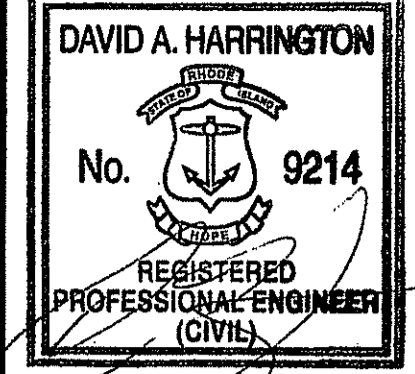

PROPOSED COMPENSATORY FLOOD STORAGE INSET

INCREMENTAL ELEVATION	PROPOSED VOLUME OF FILLED FLOOD PLAIN (CF)	PROPOSED COMPENSATORY VOLUME (CF)
225 TO 226	154	0
226 TO 227	75	149
227 TO 228	236	313
228 TO 229	268	346
229 TO 230	392	360
TOTAL	1,126	1,168

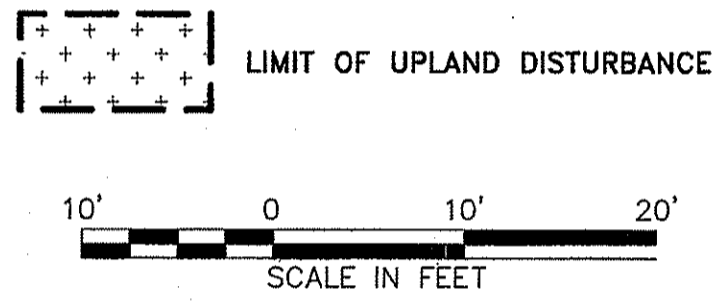

100-YEAR COMPENSATORY FLOOD STORAGE EXCAVATION & RESTORATION NOTES:

1. THIS WORK IS BEING PERFORMED TO PROVIDE COMPENSATION FOR FLOOD STORAGE LOST DUE TO THE CONSTRUCTION OF NEW FOUNDATIONS FOR THE ELECTRICAL TRANSMISSION LINES WITHIN THE 100-YEAR FLOOD PLAIN.
2. ON-SITE ENVIRONMENTAL COMPLIANCE MONITORING WILL BE PERFORMED BY A QUALIFIED WETLAND SCIENTIST OR CPESC FROM TRC SOLUTIONS, INC.
3. TOTAL UPLAND AREA TO BE DISTURBED TO CREATE COMPENSATORY FLOOD STORAGE IS +/- 916 SQUARE FEET.
4. TOP SOIL WITHIN THIS AREA WILL BE STOCKPILED FOR REUSE IN RESTORATION.
5. CARE SHOULD BE TAKEN TO REMOVE, STORE, AND REPLANT EXISTING VEGETATION WHERE FEASIBLE.
6. AFTER ROUGH GRADE IS ACHIEVED, APPLY ONE (1) FOOT OF TOPSOIL TO THE UPLAND BUFFER AREA AND TAPER OFF TO MATCH ADJACENT ELEVATIONS.
7. PLANTINGS TO BE INSTALLED AFTER LOAM IS SPREAD. OPTIMAL PLANTING WINDOW IS FROM APRIL 1 TO MAY 15 AND SEPTEMBER 1 TO OCTOBER 15. PLANTING OUTSIDE THIS WINDOW MAY OCCUR UNDER SUITABLE ENVIRONMENTAL CONDITIONS AND THROUGH APPROVAL OF THE SUPERVISORY WETLAND SCIENTIST.
8. THE SUPERVISORY WETLAND SCIENTIST SHALL RESERVE THE RIGHT TO REJECT ACCEPTANCE OF THE PLANT SPECIES UPON DELIVERY BASED ON PLANT VIGOR/CONDITION/UNAUTHORIZED SUBSTITUTIONS AND/OR NON-CONFORMANCE WITH THE PLANTING PLAN AND SPECIFICATIONS.
9. INSTALL TREES AND SHRUBS (EXISTING IF SAVED OR MATCHING EXISTING).
10. APPLY NEW ENGLAND CONSERVATION/WILDLIFE MIX. APPLY MULCH FOLLOWING SEEDING.
11. PLANTINGS SHALL BE IRRIGATED AS NECESSARY TO PROMOTE SUCCESSFUL ESTABLISHMENT.
12. FOLLOWING CONSTRUCTION, TRC SOLUTIONS, INC. SHALL PROVIDE RIDEM A STATEMENT THAT RESTORATION HAS BEEN COMPLETED AND COLOR PHOTOGRAPHS OF THE ENTIRE AREA TO DOCUMENT THAT THE RESTORATION PLAN HAS BEEN FULLY IMPLEMENTED, BASED UPON AN 80% PLANTING / RE-VEGETATION SUCCESS RATE.

100-YEAR FLOOD IMPACT AVOIDANCE NOTES:

1. THE 100-YEAR FLOOD ELEVATION OF 230 FT. WAS PROVIDED BY RIDEM.
2. TOTAL 100-YEAR FLOOD PROJECT IMPACT IS 1,126 CUBIC FEET, WHICH IS THE RESULT OF TRANSMISSION LINE POLE REPLACEMENTS WITHIN THE EXISTING FLOOD PLAIN.
3. THE PROPOSED SUBSTATION EXPANSION DOES NOT IMPACT THE 100-YEAR FLOOD PLAIN.
4. THE COMPENSATORY STORAGE IS PROPOSED IN AN AREA ADJACENT TO A PREVIOUSLY DISTURBED AREA THAT WILL BE REDEVELOPED AS PART OF THIS PROJECT.
5. THE PROPOSED COMPENSATORY FLOOD STORAGE IS IN AN AREA THAT ALLOWS THE PROJECT TO GRADE DOWN TO ELEVATION 227 WITHOUT DISTURBING WETLANDS, WHILE LIMITING TREE DISTURBANCE.
6. THE COMPENSATORY STORAGE WAS CALCULATED USING THE AVERAGE END AREA METHOD WHICH IS A METHOD FOR CALCULATING MATERIAL AREAS UTILIZING THE AREA OF THE TWO ENDS AND THE PERPENDICULAR DISTANCE BETWEEN THE TWO AREA-FACES.
7. THE PROPOSED EXPANSION OF THE SUBSTATION DOES NOT ALTER THE 100 YEAR FLOOD PLAIN. FLOOD PLAIN IMPACTS ARE THE RESULT OF PROPOSED TRANSMISSION LINE POLE FOUNDATION REMOVALS AND INSTALLATIONS.
8. WITH A FLOOD PLAIN VOLUME LOSS OF 1,126 CUBIC FEET AND A COMPENSATORY STORAGE VOLUME 1,168 CUBIC FEET, THE RESULTING GAIN IN FLOOD STORAGE IS 42 CUBIC FEET; THEREFORE THE PROJECT DOES NOT ADVERSELY IMPACT THE 100-YEAR FLOOD PLAIN.

PROPOSED 100-YEAR COMPENSATORY FLOOD STORAGE NOTES & DETAILS

Kindly be advised that this Permit is not equivalent to a verification of the type or extent of freshwater wetlands on site.

DEPARTMENT OF ENVIRONMENTAL MANAGEMENT
OFFICE OF WATER RESOURCES
FRESHWATER WETLANDS PROGRAM
APPROVED WITH CONDITIONS
AS SPECIFIED IN THE LETTER OF APPROVAL
DATED NOV 03 2017 FILE # 17-S/69
NO CHANGES ALLOWED WITHOUT PRIOR APPROVAL
APPROVED PLANS MUST BE AT CONSTRUCTION SITE

Christopher D. Seneseck

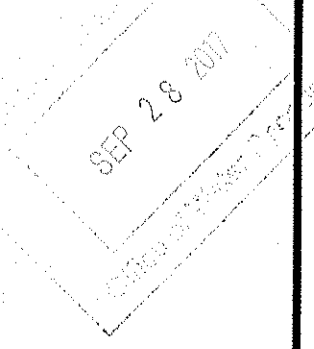

NO.	DATE	DESCRIPTION	DR/CK

PROJECT FOR: NATIONAL GRID, 40 SILVAN ROAD, WALTHAM, MASSACHUSETTS 02451

PREPARED BY: WOONSOCKET SUBSTATION 26, 76 GREENVILLE ROAD, ASSESSOR'S PLAT 9, LOTS 599, 633, 640 & 641, NORTH SMITHFIELD, RHODE ISLAND 02896

DATE: 09/22/2017

SCALE: AS SHOWN

PROJECT NO.: 6144.1

SHEET NO.: 6 OF 06

PROJECT: WOONSOCKET SUBSTATION 26, 76 GREENVILLE ROAD, ASSESSOR'S PLAT 9, LOTS 599, 633, 640 & 641, NORTH SMITHFIELD, RHODE ISLAND 02896

DATE: 09/22/2017

SCALE: AS SHOWN

PROJECT NO.: 6144.1

SHEET NO.: 6 OF 06

CONECO
Engineers & Scientists
4 FIRST STREET, BRIDGEWATER, MASSACHUSETTS 02324
PHONE: 508-697-3191 OR 800-548-3355; FAX: 508-697-5996
WEBSITE: www.coneco.com

DATE: 09/22/2017

DESIGNED: DJD CHECKED: DAH

DRAFTED: DJD IN CHARGE: RTL

SCALE: AS SHOWN

PROJECT NO.: 6144.1

SHEET NO.: 6 OF 06