

# INDEX

SHEET NO.	DESCRIPTION
1	COVER SHEET
2	JOB SPECIFIC PLAN SYMBOLS, LEGEND & NOTES
3	TYPICAL SECTION AND DETAILS
4	GENERAL PLAN
5	LOCATION PLAN
6	PROFILE
7	CULVERT PLAN
8	CULVERT EXTENTION DETAILS 1
9	CULVERT EXTENTION DETAILS 2
10	CULVERT EXTENTION DETAILS 3
11	GUARDRAIL DETAILS
12	CONSTRUCTION PHASING PLAN
13	DETOUR PLAN

## TOWN OF SOUTH KINGSTOWN



# PUBLIC SERVICES DEPARTMENT

## PLANS OF PROPOSED SAUGATUCKET ROAD CULVERT AND ROAD WIDENING

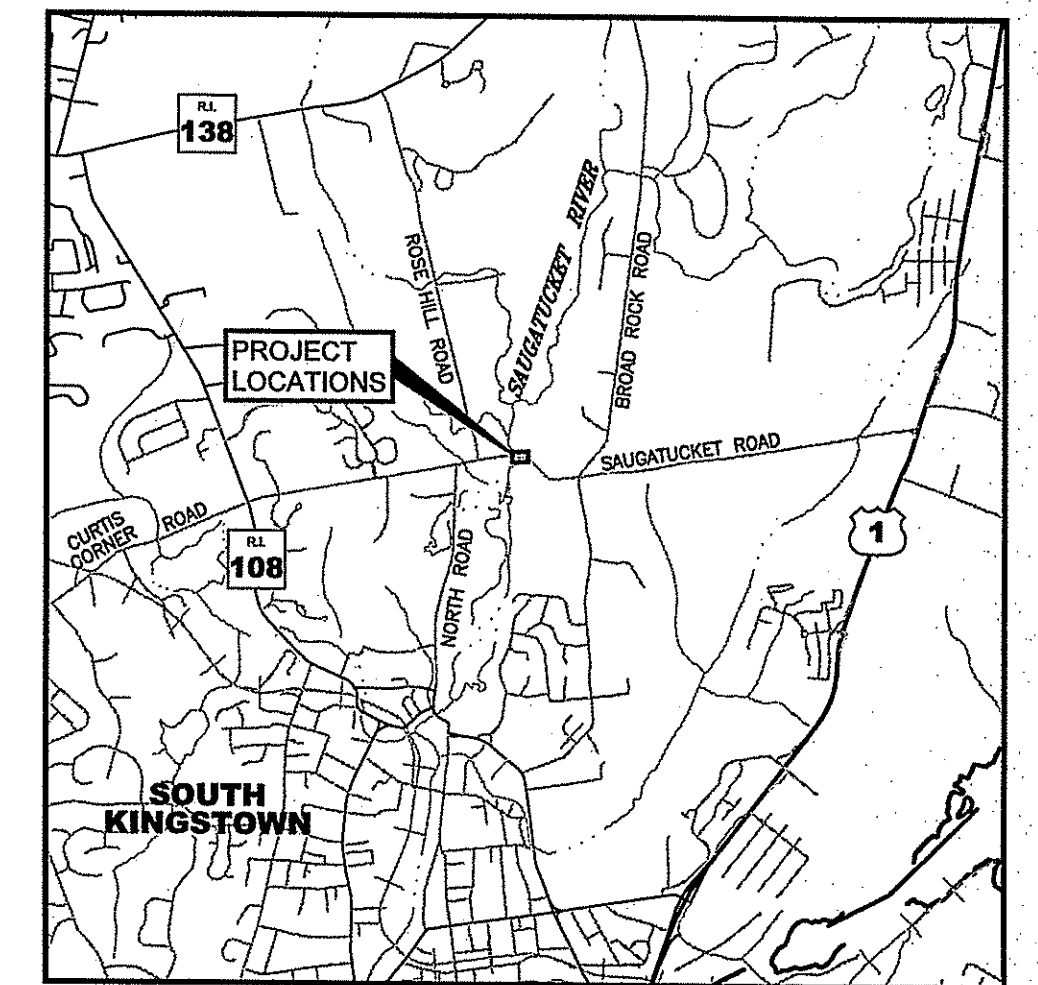

LOCATION MAP  
SCALE

Kindly be advised that this Permit is not equivalent to a verification of the type or extent of freshwater wetlands on site.

DEPARTMENT OF ENVIRONMENTAL MANAGEMENT  
OFFICE OF WATER RESOURCES  
FRESHWATER WETLANDS PROGRAM  
APPROVED WITH CONDITIONS  
AS SPECIFIED IN THE LETTER OF APPROVAL  
DATED JUN 04 2018 FILE # 17-0291  
NO CHANGES ALLOWED WITHOUT PRIOR APPROVAL  
APPROVED PLANS MUST BE AT CONSTRUCTION SITE

*Christopher D. Wemch*

ENVIRONMENTAL PLANS  
MAY 2018

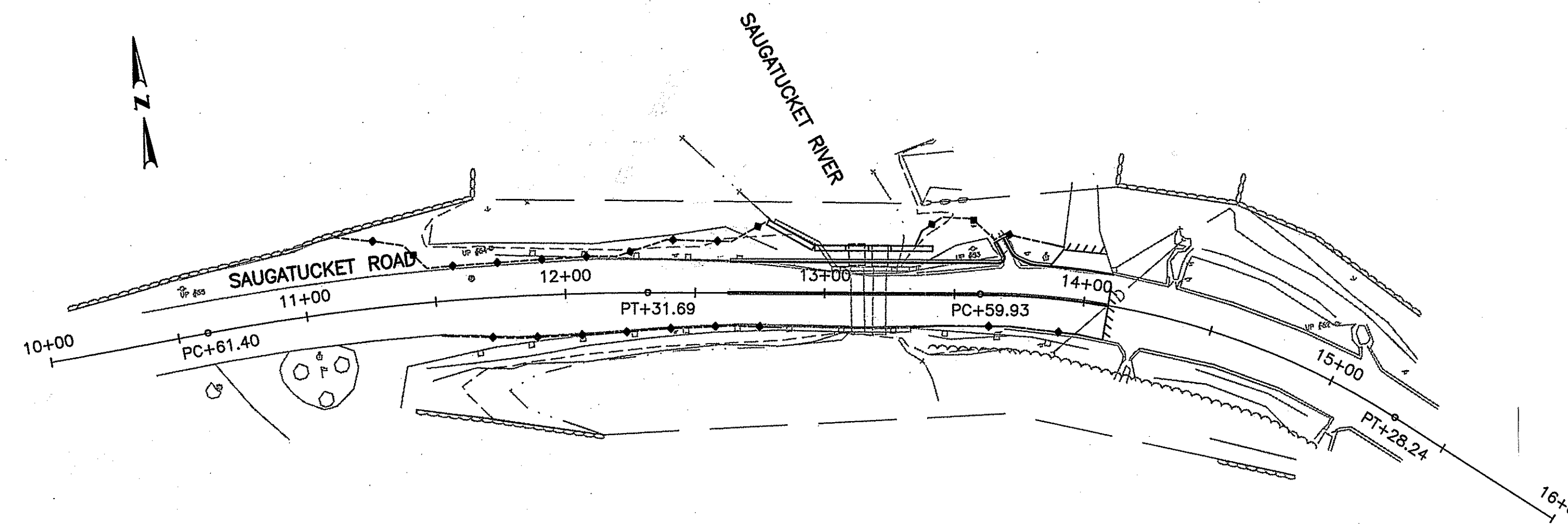
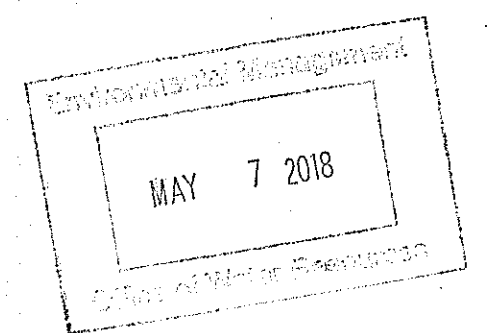
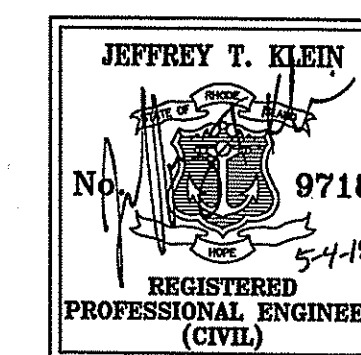

LAYOUT PLAN  
SCALE: 1"=40'

R.I. STANDARD SPECIFICATIONS AND STANDARD DETAILS  
SPECIFICATIONS TO GOVERN THIS PROJECT ARE THE R.I. STANDARD SPECIFICATIONS FOR ROAD AND BRIDGE CONSTRUCTION, AMENDED AUGUST 2013, WITH ALL REVISIONS AND THE STATE AND FEDERAL SPECIAL PROVISIONS INCLUDED IN THE CONTRACT DOCUMENTS. STANDARD DETAILS FOR THIS PROJECT ARE R.I. STANDARD DETAILS, 1998 EDITION, WITH ALL REVISIONS.

SCALES OF DRAWINGS  
AS SHOWN

BASE OF LEVELS  
NAVD 88±

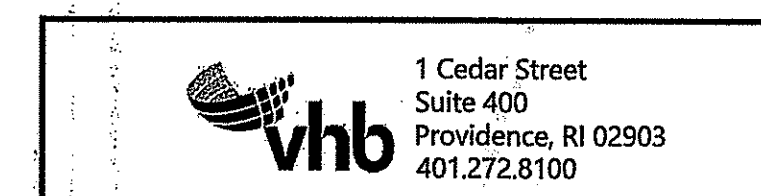

Number of Sheet 1  
Total Sheets 13



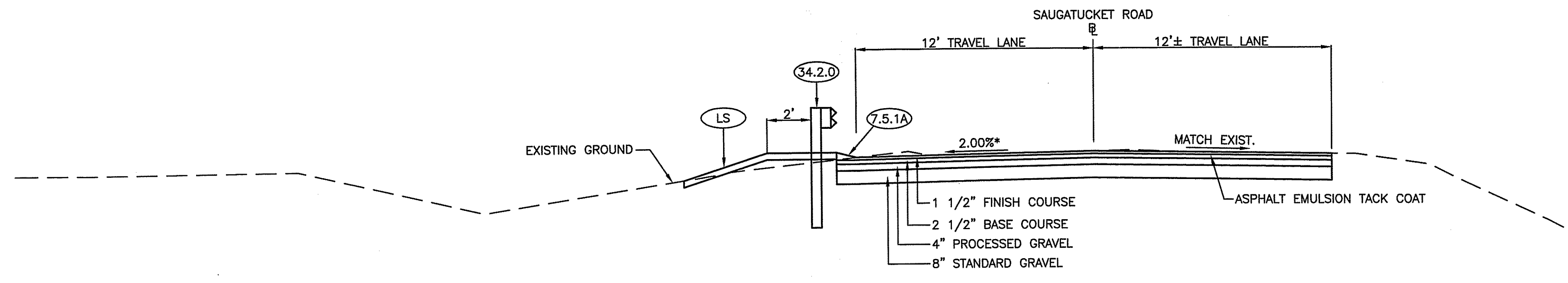

STATION 12+63 TO STATION 13+50  
SAUGATUCKET ROAD  
SCALE: 1"=4'

\* TRANSITION FROM EXISTING TO 2% CROSS SLOPE FROM STATION 12+63 TO STATION 13+10

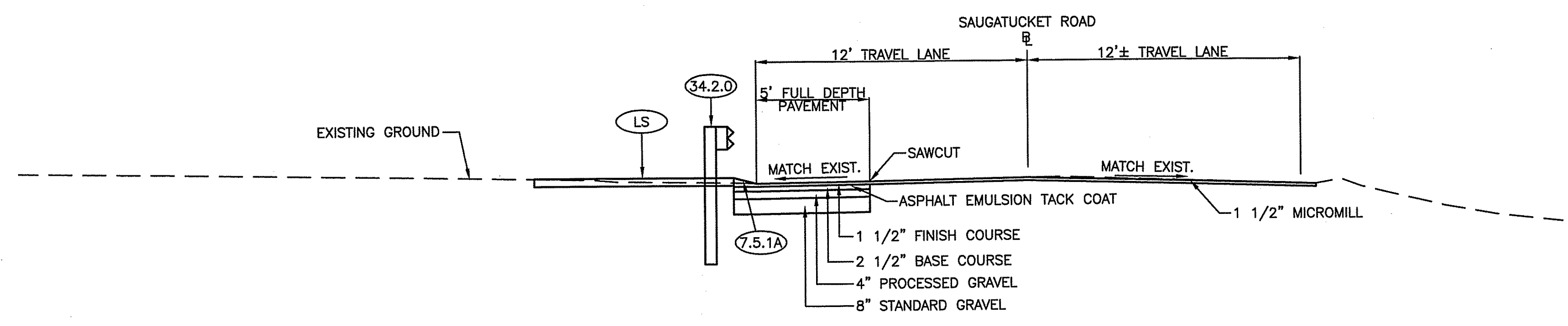

STATION 13+50 TO STATION 14+10  
SAUGATUCKET ROAD  
SCALE: 1"=4'

Kindly be advised that this Permit is not equivalent to a verification of the type or extent of freshwater wetlands on site.

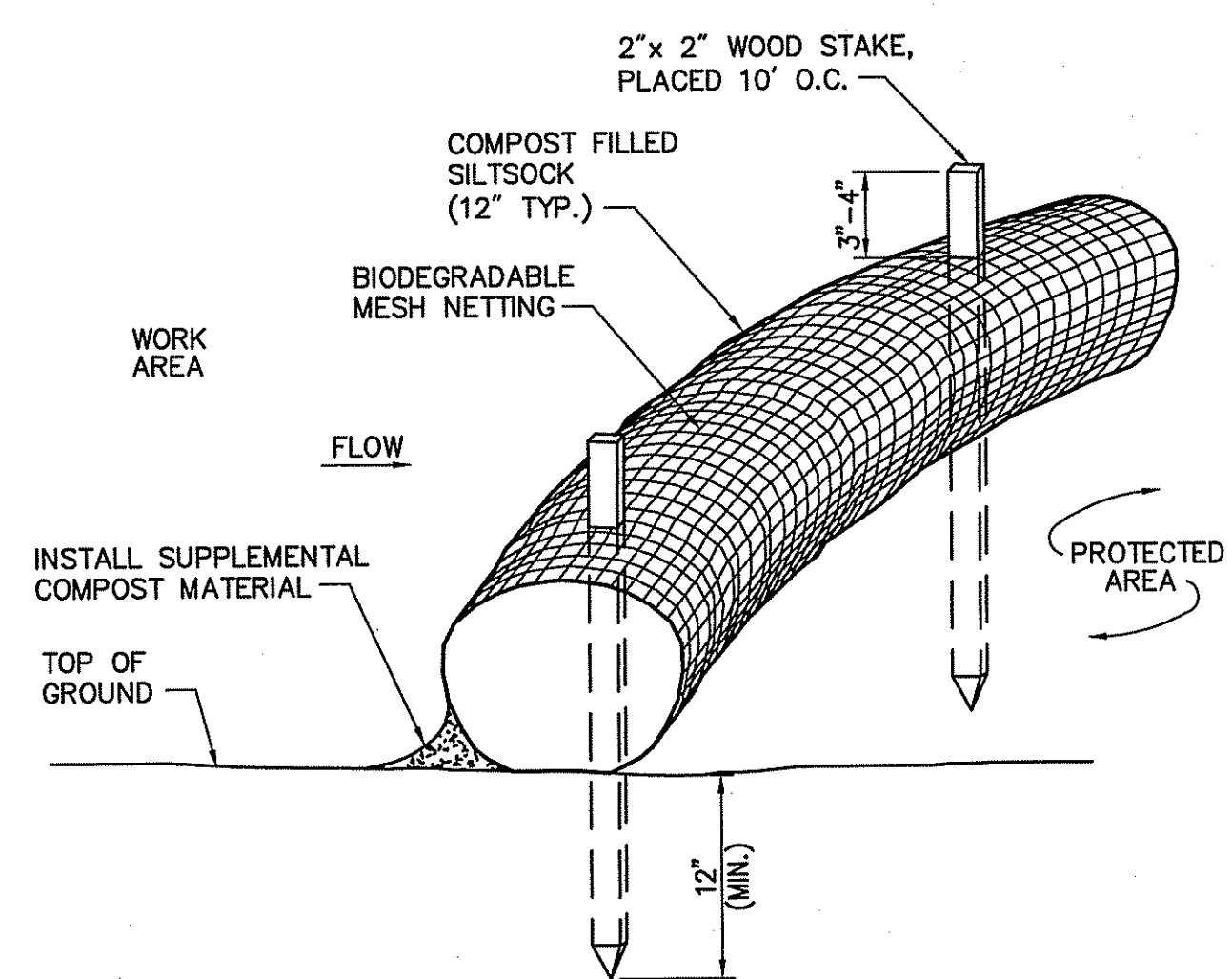

- Notes:**
1. SILT SOCK SHALL BE FILTREXX SILT SOCK, OR APPROVED EQUAL.
  2. SILT SOCKS SHALL OVERLAP A MINIMUM OF 12 INCHES.
  3. SILT SOCK SHALL BE INSPECTED PERIODICALLY AND AFTER ALL STORM EVENTS, AND REPAIR OR REPLACEMENT SHALL BE PERFORMED PROMPTLY AS NEEDED.
  4. COMPOST MATERIAL SHALL BE DISPERSED ON SITE, AS DETERMINED BY THE ENGINEER.
  5. IF NON BIODEGRADABLE NETTING IS USED THE NETTING SHALL BE COLLECTED AND DISPOSED OF OFF SITE.

DEPARTMENT OF ENVIRONMENTAL MANAGEMENT  
OFFICE OF WATER RESOURCES  
FRESHWATER WETLANDS PROGRAM  
APPROVED WITH CONDITIONS  
AS SPECIFIED IN THE LETTER OF APPROVAL  
DATED JUN. 01, 2018 FILE # 17-0291  
NO CHANGES ALLOWED WITHOUT PRIOR APPROVAL  
APPROVED PLANS MUST BE AT CONSTRUCTION SITE

*Martin D. Wenczek*

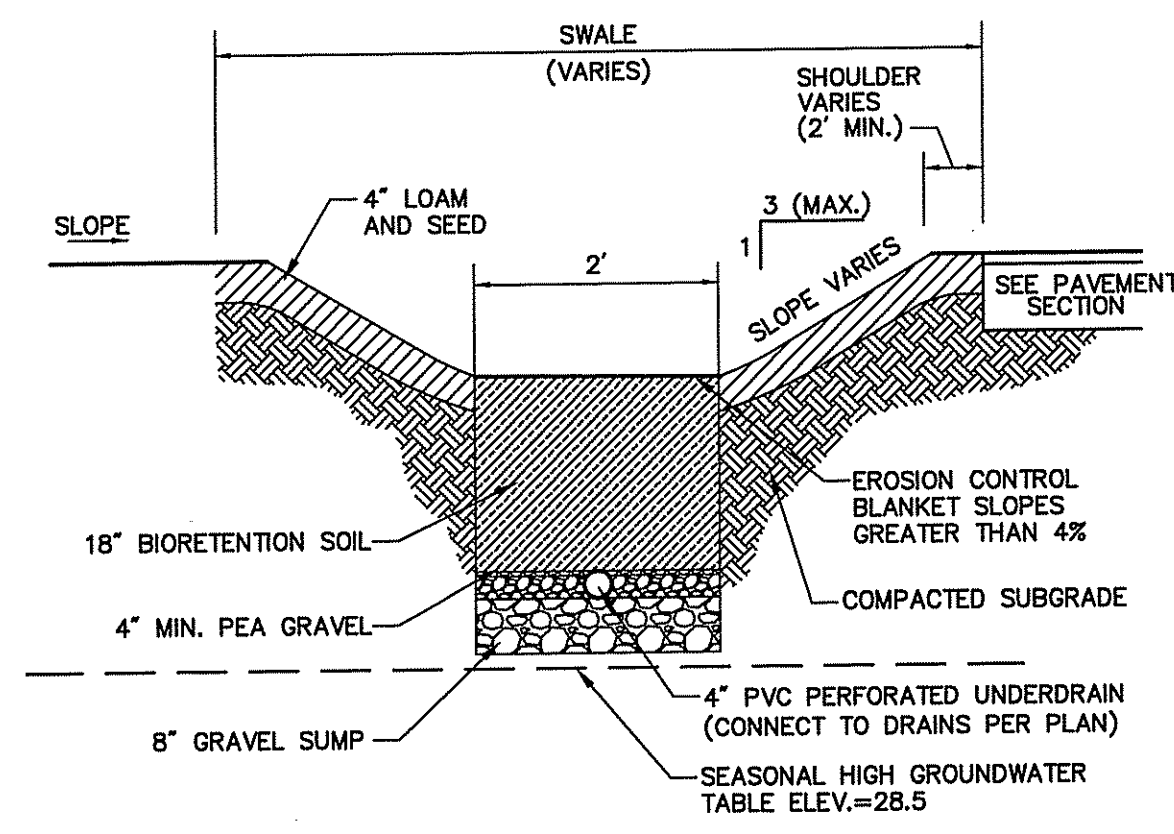

Proposed Drainage Swale W/ 4" Underdrain  
N.T.S. Source: VHB 5/16

Siltsock - Erosion Control Barrier  
N.T.S. Source: VHB 8/12 CFS LD\_658

REVISIONS			TOWN OF SOUTH KINGSTOWN PUBLIC SERVICES DEPARTMENT
NO.	DATE	BY	
			SAUGATUCKET ROAD CULVERT AND ROAD WIDENING
			SOUTH KINGSTOWN, RHODE ISLAND
			TYPICAL SECTION AND DETAILS
			CHECKED BY _____ DATE _____ SCALE _____

**vhb**  
1 Cedar Street  
Suite 400  
Providence, RI 02903  
401.272.8100





Kindly be advised that this Permit is not equivalent to a verification of the type or extent of freshwater wetlands on site.

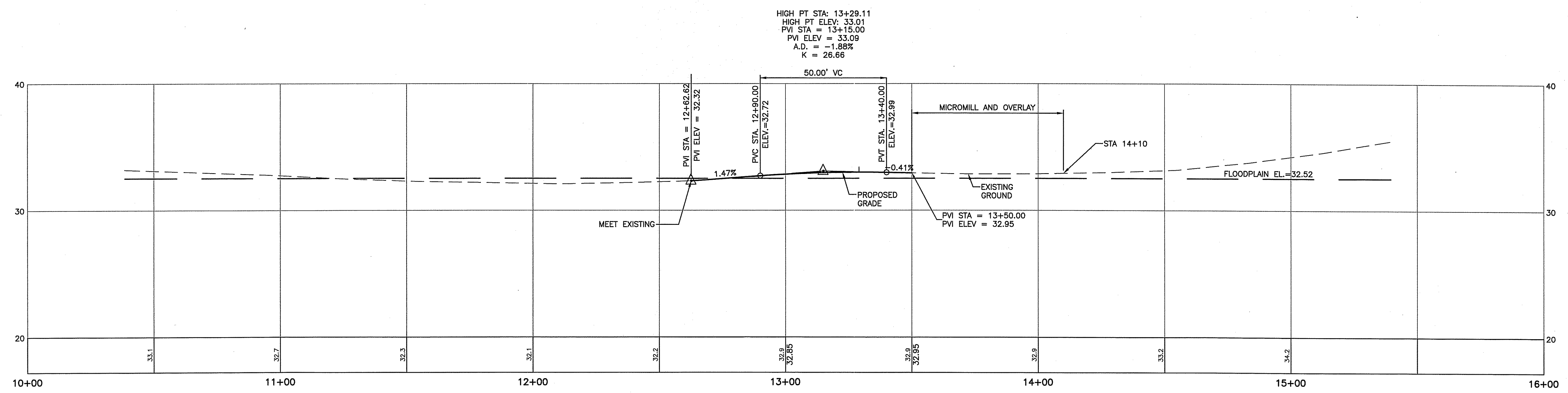

DEPARTMENT OF ENVIRONMENTAL MANAGEMENT  
 OFFICE OF WATER RESOURCES  
 FRESHWATER WETLANDS PROGRAM  
 APPROVED WITH CONDITIONS  
 AS SPECIFIED IN THE LETTER OF APPROVAL  
 DATED JUN 04 2018 FILE # 17-091  
 NO CHANGES ALLOWED WITHOUT PRIOR APPROVAL  
 APPROVED PLANS MUST BE AT CONSTRUCTION SITE

*Christopher D. Wenczek*

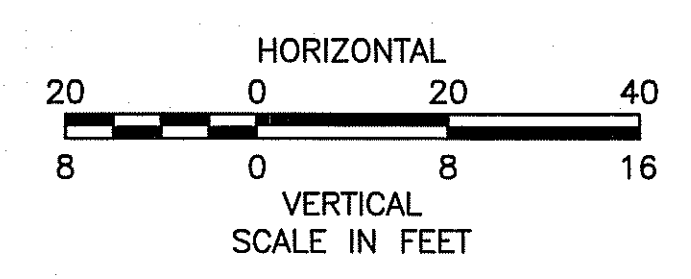

REVISIONS			TOWN OF SOUTH KINGSTOWN PUBLIC SERVICES DEPARTMENT
NO.	DATE	BY	
			SAUGATUCKET ROAD CULVERT AND ROAD WIDENING SOUTH KINGSTOWN, RHODE ISLAND

**PROFILE**

CHECKED BY \_\_\_\_\_ DATE \_\_\_\_\_ SCALE \_\_\_\_\_

**vhb**  
 1 Cedar Street  
 Suite 400  
 Providence, RI 02903  
 401.272.8100













