

SITE IMPROVEMENT PLANS FOR THE

RI DEPARTMENT OF CORRECTIONS DIX PARKING LOT IMPROVEMENTS

18 WILMA SCHESLER LANE
CRANSTON, RHODE ISLAND
AP 15, LOT 50

ZONING DISTRICT: OPEN SPACE DISTRICT (S1)

FILINGS:

RHODE ISLAND DEPARTMENT OF ENVIRONMENTAL MANAGEMENT - OFFICE OF WATER RESOURCES - PRELIMINARY DETERMINATION

RHODE ISLAND BUILDING CODE COMMISSION

RHODE ISLAND STATE FIRE MARSHAL'S OFFICE

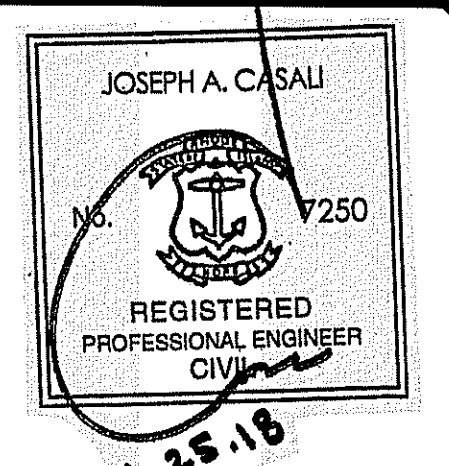
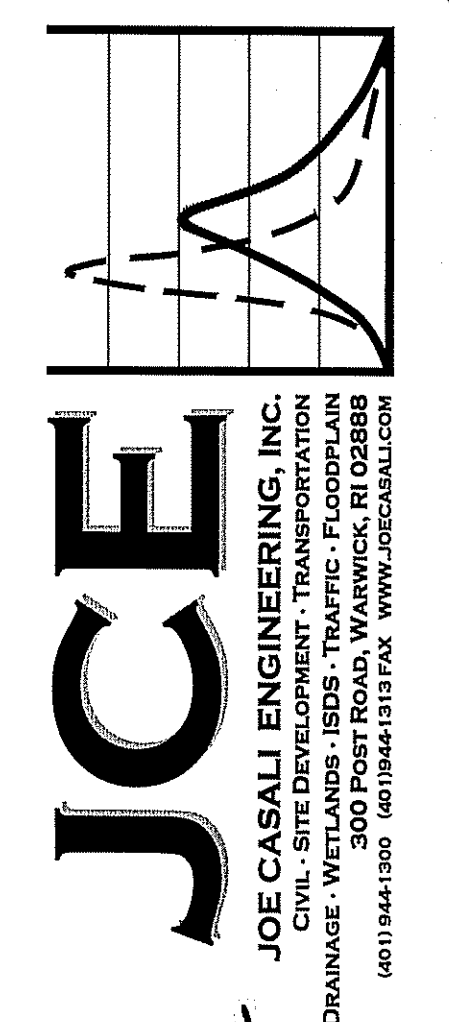

DEPARTMENT OF ENVIRONMENTAL MANAGEMENT
OFFICE OF WATER RESOURCES
FRESHWATER WETLANDS PROGRAM
APPROVED WITH CONDITIONS
AS SPECIFIED IN THE LETTER OF APPROVAL
DATED AUG 07 2018 FILE # 18-0108
NO CHANGES ALLOWED WITHOUT PRIOR APPROVAL
APPROVED PLANS MUST BE AT CONSTRUCTION SITE

PARKING LOT IMPROVEMENT
18 WILMA SCHESLER LANE
CRANSTON, RHODE ISLAND
AP 15, LOT 50

Q:\13-57 RI DDC\13-57b RIDDC Parking Lot Improvements\RIDEM RTCL.dwg Jun. 25, 2018 3:27pm

PROJECT TEAM			
OWNER/ APPLICANT:	RI DEPT. OF CORRECTIONS FACILITIES & MAINTENANCE 1375 PONTIAC AVENUE CRANSTON, RI 02890 PHONE: 401-462-3791	LAND SURVEYOR:	INTERNATIONAL MAPPING & SURVEYING CORP. 19 INDUSTRIAL DRIVE SMITHFIELD, RI 02917 PHONE: 401-232-2620
CIVIL ENGINEER:	JOE CASALI ENGINEERING, INC. 300 POST ROAD WARWICK, RI 02888 PHONE: 401-944-1300 FAX: 401-944-1313 JOECASALI.COM	WETLAND BIOLOGIST:	LEC ENVIRONMENTAL CONSULTANTS, INC. 12 RESNIK ROAD, SUITE 1 PLYMOUTH, MA 02360 PHONE: (508) 736-8481
ELECTRICAL ENGINEER:	ENGINEERING DESIGN SERVICES, INC. 141 INDUSTRIAL DRIVE SLATERSVILLE, RI 02876 PHONE: 401-765-7659		

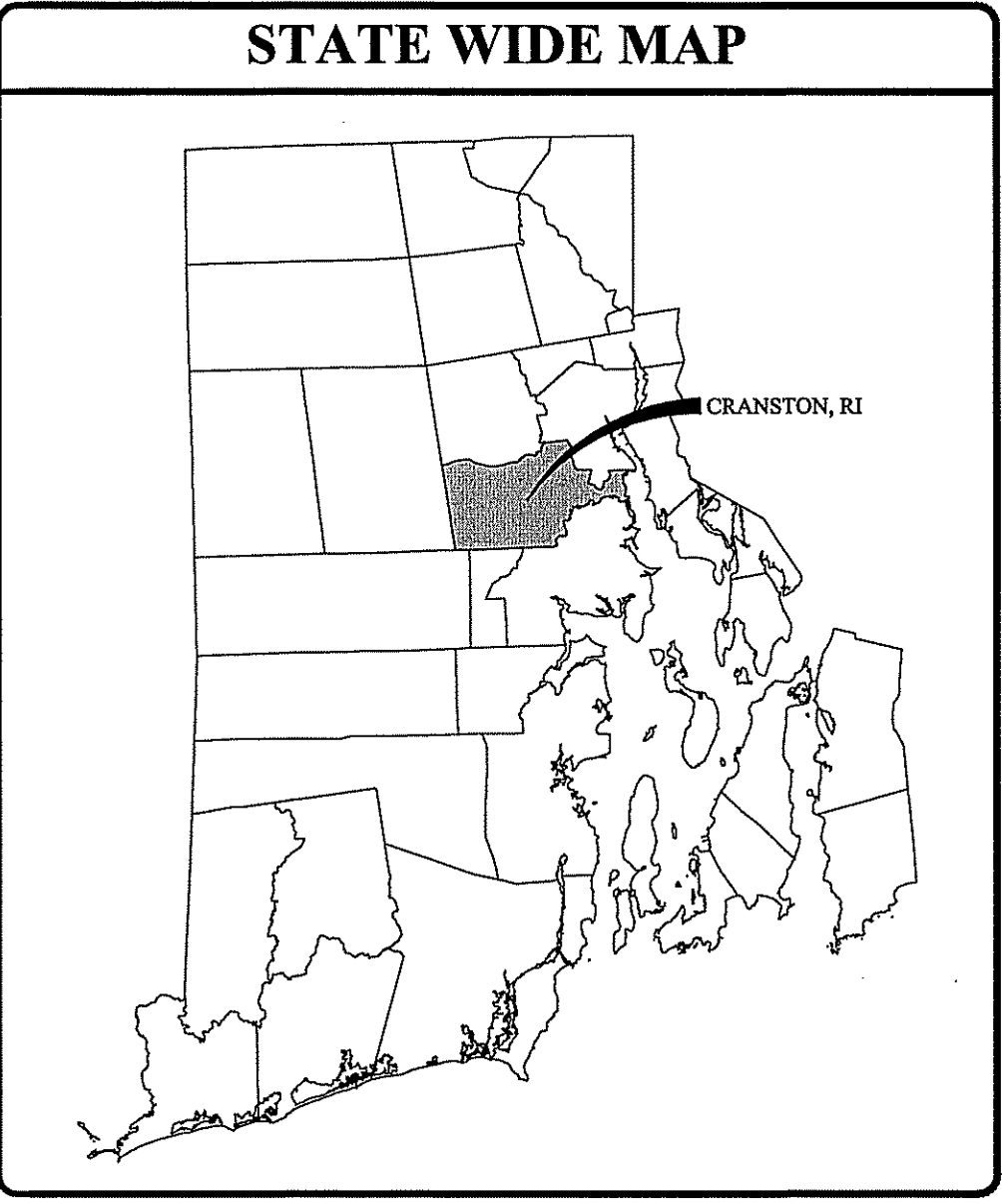
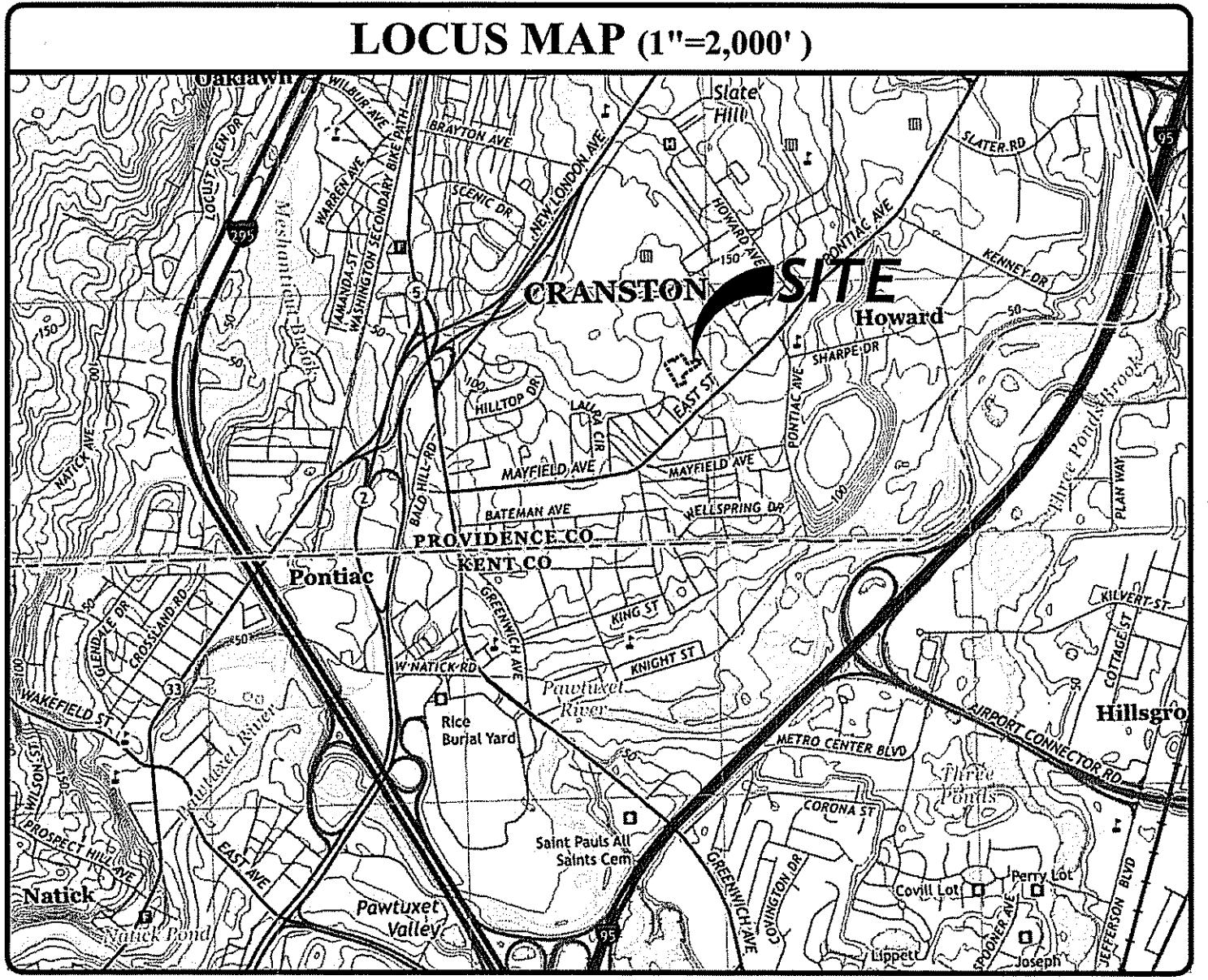

INDEX OF DRAWINGS	
SHEET NO.	PLAN
1	COVER SHEET
2	GENERAL NOTES & LEGEND
3	EXISTING CONDITIONS & SITE PREPARATION PLAN
4	SITE PLAN, GRADING AND DRAINAGE PLAN
5	RI STANDARD DETAILS
6	DETAILS SHEET
REFERENCE PLAN:	
7	PARTIAL EXISTING CONDITIONS SURVEY PLAN, PREPARED BY INTERNATIONAL MAPPING & SURVEYING CORP., DATED MAY 24, 2017

REVISIONS:		
NO.	DATE	DESCRIPTION
1	6/25/18	RIDEM COMMENTS

DESIGNED BY:	DRD
DRAWN BY:	SD/SEP
CHECKED BY:	JAC
DATE:	MAY 2018
PROJECT NO.:	13-57b

PRELIMINARY, NOT FOR CONSTRUCTION

COVER SHEET

SHEET 1 OF 7

JUN 26 2018

GENERAL NOTES:

1. A PARTIAL EXISTING CONDITIONS AND CLASS III TOPOGRAPHIC SURVEY WAS COMPLETED BY INTERNATIONAL MAPPING & SURVEYING CORPORATION, 19 INDUSTRIAL DRIVE, SMITHFIELD, RI 02917, IN MAY 2017.
2. FRESHWATER WETLAND DELINEATION PERFORMED BY LEC ENVIRONMENTAL CONSULTANTS, INC. IN NOVEMBER 2017.
3. THE SITE LIES WITHIN ZONE X (AREAS DETERMINED TO BE OUTSIDE THE 0.2% ANNUAL CHANCE FLOODPLAIN) AS SHOWN ON THE FIRM MAP FOR PROVIDENCE COUNTY, RHODE ISLAND, MAP NUMBER 44007C0427H, EFFECTIVE DATE OCTOBER 2, 2015.
4. ACCORDING TO THE WEB SOIL SURVEY BY THE NRCS, EXISTING SOILS ON THE SITE HAVE BEEN CLASSIFIED AS PAXTON-URBAN LAND COMPLEX, 3 TO 15 PERCENT SLOPES (PD) AND WOODBRIDGE FINE SANDY LOAM, 3 TO 8 PERCENT SLOPES (WhB).

SITE NOTES:

1. ALL WORK SHALL BE IN ACCORDANCE WITH ALL RHODE ISLAND DEPARTMENT OF CORRECTIONS (RIDOC) POLICIES. RIDOC POLICIES ARE AVAILABLE ON THE RIDOC WEBSITE (WWW.DOC.RI.GOV/ADMINISTRATION/POLICY/ALL.PHP).
2. CONTRACTOR SHALL BE RESPONSIBLE FOR REMOVING AND LEGALLY DISPOSING (R&D) OF ALL MATERIALS INDICATED ON THE PLANS.
3. ACCESSIBLE ROUTES, PARKING SPACES, RAMPS, SIDEWALKS, AND WALKWAYS SHALL BE CONSTRUCTED IN CONFORMANCE WITH THE FEDERAL AMERICAN WITH DISABILITIES ACT AND WITH ALL APPLICABLE STATE AND LOCAL LAWS AND REGULATIONS, WHICHEVER IS MORE STRINGENT.
4. STOCKPILES OF EARTH MATERIALS SHALL NOT BE LOCATED ADJACENT TO DRAINAGE STRUCTURES.
5. ALL DISTURBED AREAS OUTSIDE OF THE PAVED AREAS WILL RECEIVE A MINIMUM OF 6" OF LOAM AND SEED.
6. THE LAYOUT SHOWN REPRESENTS A GRAPHICAL DESIGN, AND PRIOR TO THE CONSTRUCTION, THE CONTRACTOR SHALL ENGAGE A PROFESSIONAL LAND SURVEYOR (PLS) REGISTERED IN THE STATE OF RHODE ISLAND TO SET AND VERIFY ALL LINES AND GRADES. ALL EXISTING UTILITY LOCATIONS AND ELEVATIONS ARE TO BE CONFIRMED BY THE CONTRACTOR PRIOR TO CONSTRUCTION. ANY ITEMS FOUND WHICH DO NOT MATCH THE PLANS MUST BE BROUGHT TO THE ENGINEERS ATTENTION PRIOR TO CONSTRUCTION FOR REVIEW. NO WORK SHALL PROCEED UNTIL AUTHORIZED BY THE ENGINEER.
7. THE CONTRACTOR SHALL PROVIDE AND MAINTAIN SURVEY LAYOUT SERVICES FOR THE WORK AND SHALL SUBMIT "AS-BUILT" DRAWINGS OF ALL WORK, WHICH SHALL BE STAMPED AND CERTIFIED BY A RHODE ISLAND REGISTERED PROFESSIONAL LAND SURVEYOR.
8. ANY ITEM OF WORK NOT SPECIFICALLY INDICATED ON THE PLANS BUT IS REQUIRED FOR THE COMPLETE CONSTRUCTION OF THE PROJECT WILL BE CONSIDERED INCIDENTAL TO THE CONTRACT AND INCLUDED IN THE CONTRACT BID PRICE. IT WILL BE THE CONTRACTOR'S RESPONSIBILITY TO VERIFY ALL EXISTING SITE CONDITIONS.
9. WHERE NECESSARY TO REMOVE CURBS, CATCH BASINS OR DRAINS TO COMPLETE WORK, THE CONTRACTOR SHALL REPLACE SUCH ITEMS TO THE SATISFACTION OF THE ENGINEER AND THE STATE OF RHODE ISLAND AT NO ADDITIONAL COST TO THE OWNER.
10. ANY EXISTING PIPE OR UTILITY DAMAGED BY THE CONTRACTOR'S OPERATIONS SHALL BE REPAIRED IMMEDIATELY BY THE CONTRACTOR AT NO COST TO THE OWNER.
11. THE CONTRACTOR SHALL RESTORE TO ITS ORIGINAL CONDITION OR REPLACE TREES, SHRUBS, FENCES, SIGNS, GUARDRAILS, DRIVEWAYS, SIDEWALKS AND ANY OTHER OBJECT AFFECTED BY THIS OPERATION, UNLESS OTHERWISE NOTED ON THE SITE PLANS.
12. THE TOPS OF ALL VALVE BOXES AND CURB BOXES SHALL BE FLUSH WITH GROUND OR PAVEMENT SURFACE LEVEL AND PLUMB, UNLESS OTHERWISE DIRECTED.
13. ROADWAYS SHALL BE LEFT PASSABLE AT ALL TIMES. CLOSURE OF ROADWAY IS NOT PERMITTED.
14. WATER SERVICE SHALL BE MAINTAINED AT ALL TIMES.
15. ALL LEDGE TO BE REMOVED BY MECHANICAL MEANS.
16. ALL CONSTRUCTION WORK SHALL BE PERFORMED IN THE DRY. THE CONTRACTOR SHALL PROVIDE, OPERATE AND MAINTAIN ALL PUMPS, DRAINS, WET POINTS, SCREENS, OR OTHER FACILITIES NECESSARY TO CONTROL, COLLECT AND DISPOSE OF ALL SURFACE AND SUBSURFACE WATER ENCOUNTERED IN THE PERFORMANCE OF THE WORK.
17. ALL SITE WORK, INCLUDING BUT NOT LIMITED TO, BITUMINOUS PAVEMENT, AGGREGATE MATERIALS, DRAINAGE STRUCTURES, CURBING, SIDEWALK, LANDSCAPING, SAW CUTTING, ETC. SHALL CONFORM TO THE RHODE ISLAND DEPARTMENT OF TRANSPORTATION STANDARD SPECIFICATIONS FOR ROADWAY AND BRIDGE CONSTRUCTION, 2004 EDITION (WITH LATEST ADDENDA) AND THE RIDOT STANDARD DETAILS, 1998 EDITION (WITH LATEST ADDENDA).

DRAINAGE SYSTEM NOTES:

1. THE PROPOSED DRAINAGE LINES SHALL BE ADS N-12 HDPE PIPE OR AN APPROVED EQUAL UNLESS OTHERWISE NOTED ON THE SITE PLANS.
2. ALL RIM ELEVATIONS SHOWN ARE APPROXIMATE AND ARE TO BE SET FLUSH WITH FINAL GRADES.

SOIL EROSION AND SEDIMENTATION CONTROL NOTES:

1. THE SILT FENCE / HAY BALE LINE ILLUSTRATED ON THESE PLANS SHALL SERVE AS THE STRICT LIMIT OF DISTURBANCE FOR THE PROJECT WITHIN OR ADJACENT TO REGULATED FRESHWATER WETLAND AREAS.
2. THE LIMITS OF CLEARING, GRADING, AND DISTURBANCE SHALL BE KEPT TO A MINIMUM WITHIN THE PROPOSED AREA OF CONSTRUCTION. ALL AREAS OUTSIDE OF THESE LIMITS, AS DEPICTED ON THE PLAN SHALL BE TOTALLY UNDISTURBED, TO REMAIN IN NATURAL CONDITION.
3. NO CONSTRUCTION ACTIVITY SHALL TAKE PLACE IN THE AREA OF THE STORMWATER MITIGATION AREAS ONCE THE SUBGRADE IS EXPOSED.
4. ALL DISTURBED SLOPES EITHER NEWLY CREATED OR CURRENTLY EXPOSED SHALL BE SEEDED, PROTECTED AND MAINTAINED BY THE CONTRACTOR. THE CONTRACTOR SHALL REGULARLY CHECK ALL SEEDED AREAS TO ENSURE THAT A GOOD STAND IS MAINTAINED.
5. ALL SILT FENCE, TEMPORARY TREATMENT (HAY, STRAW, ETC.) AND TEMPORARY EROSION PROTECTION SHALL BE MAINTAINED BY THE CONTRACTOR THROUGHOUT CONSTRUCTION AND SHALL REMAIN IN PLACE UNTIL AN ACCEPTABLE STAND OF GRASS OR APPROVED GROUND COVER IS ESTABLISHED.
6. STOCKPILES OF TOPSOIL SHALL NOT BE LOCATED NEAR WATERWAYS. THEY SHALL HAVE SIDE SLOPES OF NO GREATER THAN 2:1 AND SHALL BE TEMPORARILY SEEDED AND/OR STABILIZED PER CONTRACT SPECIFICATIONS.
7. THE SILT FENCE SHALL BE CHECKED BY THE CONTRACTOR ON A WEEKLY BASIS AND AFTER EACH STORM FOR UNDERMINING OR DETERIORATION. THE CONTRACTOR SHALL CLEAN THE ACCUMULATED SEDIMENT IF HALF OF THE ORIGINAL HEIGHT OF THE HAY-BALES BECOMES FILLED WITH SEDIMENTS.
8. IT SHALL BE THE RESPONSIBILITY OF THE CONTRACTOR TO MAINTAIN ALL SOIL EROSION AND SEDIMENT CONTROLS ON THE PROJECT SITE FOR THE ENTIRE DURATION OF THE CONSTRUCTION PERIOD. THE CONTRACTOR SHALL FOLLOW THE DIRECTION OF THE RESIDENT ENGINEER WITH REGARD TO INSTALLATION, MAINTENANCE, AND REPAIR OF ALL SOIL EROSION AND SEDIMENTATION CONTROLS ON THE PROJECT SITE. TEMPORARY SOIL EROSION AND SEDIMENTATION CONTROLS SHALL BE MAINTAINED UNTIL ALL EXPOSED SOILS ARE SATISFACTORILY STABILIZED. THE CONTRACTOR SHALL BE RESPONSIBLE FOR REPAIRING AND/OR RESEEDING ALL AREAS THAT DO NOT DEVELOP WITHIN ONE YEAR FROM THE COMPLETION OF CONSTRUCTION.
9. ALL REFERENCED SOIL EROSION AND SEDIMENTATION CONTROLS INCLUDING MATERIALS USED, APPLICATION RATES AND THE INSTALLATION PROCEDURES SHALL BE PERFORMED PER THE "RHODE ISLAND EROSION AND SEDIMENTATION HANDBOOK", DATED 1993.

BMP MAINTENANCE SCHEDULE:

1. PRIOR TO THE START OF CONSTRUCTION, THE SITE CONTRACTOR SHALL STAKE OUT AND PROTECT ALL SURFICIAL STORMWATER INFILTRATION AREAS, INCLUDING THE SEDIMENT FOREBAY AND SAND FILTER BASIN. CONSTRUCTION TRAFFIC IS NOT ALLOWED WITHIN THE INFILTRATION AREAS. CONSTRUCTION FENCING SHALL BE USED TO PROTECT AREA FROM CONSTRUCTION TRAFFIC. STORMWATER INFILTRATION AREAS SHALL BE PROTECTED FROM RUNOFF DURING CONSTRUCTION AND MAY NOT BE USED AS TEMPORARY SEDIMENTATION AREAS DURING CONSTRUCTION. SILT FENCE SHALL BE USED TO PROTECT THESE AREAS FROM RUNOFF.
2. ALL MAINTENANCE (INCLUDING CLEANING) REQUIRED DURING THE CONSTRUCTION PHASE OF THE PROJECT SHALL BE THE RESPONSIBILITY OF THE CONTRACTOR AND SHALL INCLUDE:
 - A. MEASURES NEEDED TO ENSURE THE PROPER OPERATION OF THE STORMWATER RUNOFF (DRAINAGE) AND WATER QUALITY CONTROL SYSTEMS TO INCLUDE INSPECTION, CLEANING AND REPAIRS ALL PIPES, INTAKE AND DISCHARGE STRUCTURES, CATCH BASIN SUMPS, AND MANHOLES.
 - B. INSPECTION OF ALL SLOPES, BERMS, AND OTHER CONTROL STRUCTURES FOR STRUCTURAL INTEGRITY/STABILITY AND EVIDENCE OF SOIL EROSION PROCESSES, AND MAINTENANCE OF THESE STRUCTURES IF NECESSARY. INSPECTIONS SHALL BE PERFORMED FOLLOWING ALL RAIN EVENTS OF 1/2 INCH RAINFALL OR MORE IN A 24-HOUR PERIOD, OR BI-MONTHLY IF NO RAINFALL EVENT OCCURS.
3. UPON COMPLETION OF THE PROJECT CONSTRUCTION, AND PRIOR TO VACATING THE SITE, THE CONTRACTOR SHALL CONDUCT A FINAL INSPECTION AND CLEANING OF THE DRAINAGE SYSTEM AND ALL ASSOCIATED STRUCTURES.
4. ALL INSTALLATION, CLEANING, AND MAINTENANCE OF THE STORMWATER DRAINAGE SYSTEM SHALL FOLLOW AT LEAST THE RHODE ISLAND DEPARTMENT OF TRANSPORTATION MINIMUM STANDARDS, SECTION 212 AND SECTION 708. WHERE APPROPRIATE, PROCEDURES REGARDING THE DRAINAGE INSTALLATION, CLEANING, INSPECTION, AND MAINTENANCE OF THE STORMWATER DRAINAGE SYSTEM SHALL BE FOLLOWED AS OUTLINED IN THE "RHODE ISLAND STORMWATER DESIGN AND INSTALLATION STANDARDS MANUAL" (RIDEM/RICRMC, 2010).
5. STORMWATER BMPs SHALL BE INSPECTED AND MAINTAINED BY THE OWNER AS FOLLOWS:

CATCH BASINS

 - INSPECTIONS SHALL BE PERFORMED A MINIMUM OF 2 TIMES PER YEAR (SPRING/FALL). INSPECTIONS SHOULD, AS A MINIMUM, CONCENTRATE ON DAMAGE TO GRATES AND COVERS, EVIDENCE OF STANDING WATER, DEBRIS REMOVAL AND STRUCTURAL INTEGRITY. UNITS SHALL BE CLEANED WHENEVER THE DEPTH OF SEDIMENT IS GREATER THAN OR EQUAL TO 2-FEET (LESS THAN 2-FEET FROM THE BOTTOM OF PIPE).

PEA GRAVEL DIAPHRAGMS

 - PEA GRAVEL DIAPHRAGMS SHALL BE INSPECTED BI-ANNUALLY FOR SEDIMENT BUILDUP AND SDEIMENT SHOULD BE REMOVED WHEN IT REACHES 25% OF TOTAL STORAGE VOLUME.
 - PEA GRAVEL DIAPHRAGMS SHALL BE KEEP FREE FROM FLOATING DEBRIS.
 - SNOW STORAGE IS PROHIBITED WITH IN PEA GRAVEL DIAPHRAGMS

PRE-TREATMENT SEDIMENT FOREBAY

 - AFTER CONSTRUCTION, THE SEDIMENT FOREBAY SHALL BE INSPECTED AND CLEANED WHEN SEDIMENT BUILD UP IS IN EXCESS OF 6" OR 25% OF THE SEDIMENT STORAGE VOLUME.

SAND FILTER SYSTEM

 - DURING THE SIX MONTHS IMMEDIATELY AFTER CONSTRUCTION, THE SAND FILTER SHALL BE INSPECTED AFTER THE FIRST TWO RAINFALL EVENTS OF AT LEAST 1.0 INCH TO ENSURE THE SYSTEM IS FUNCTIONING PROPERLY. THEREAFTER INSPECTIONS SHALL BE CONDUCTED ON AN ANNUAL BASIS AND AFTER STORM EVENTS OF GREATER THAN OR EQUAL TO 2 INCHES.
 - SILT/SEDIMENT SHALL BE REMOVED FROM THE FILTER BED WHEN THE ACCUMULATION EXCEEDS ONE INCH. WHEN THE FILTERING CAPACITY OF THE SAND FILTER DIMINISHES SUBSTANTIALLY (I.E. WHEN WATER PONDS ON THE SURFACE OF THE FILTER BED FOR MORE THAN 48 HOURS), THE TOP FEW INCHES OF DISCOLORED MATERIAL SHALL BE REMOVED AND SHALL BE REPLACED WITH FRESH MATERIAL. THE REMOVED SEDIMENTS SHALL BE DISPOSED IN AN ACCEPTANCE MANNER AT AN APPROVED AND PERMITTED LOCATION.
6. ALL REMOVED SEDIMENT IS TO BE TESTED TO DETERMINE POLLUTANT CONTENT. THE SEDIMENT IS TO BE PROPERLY DISPOSED OF BASED UPON THE TEST RESULTS AND LOCAL, STATE, AND FEDERAL REGULATIONS.

LOAM

1. ALL DISTURBED AREAS AND AREAS LABELED AS 'LOAM AND SOD' ARE TO BE BROUGHT TO AN ELEVATION OF 5" BELOW THE PROPOSED FINISHED GRADE. SCARIFY THE SUBGRADE SURFACE WITH THE TEETH OF A BACKHOE OR A POWER RAKE TO RESULT IN AN UNCOMPACTED SUBSOIL. 4" OF GOOD QUALITY TOPSOIL IS TO BE APPLIED AND RAKED TO FINISHED GRADE.
2. THE TOPSOIL IS TO BE GOOD QUALITY LOAM, FERTILE AND FREE OF WEEDS, STICKS AND STONES OVER 3/4" IN SIZE AND OTHERWISE COMPLYING WITH SECTION M.18.01 OF THE RHODE ISLAND DEPARTMENT OF TRANSPORTATION STANDARD SPECIFICATIONS FOR ROADWAY AND BRIDGE CONSTRUCTION, 2010 EDITION (WITH LATEST ADDENDA).
3. PRIOR TO SEEDING OR SODDING, FERTILIZE WITH 10-10-10 OR EQUIVALENT ANALYSIS. AT LEAST 40% OF THE FERTILIZER NITROGEN SHALL BE IN SLOW RELEASE FORM. INCORPORATE THE FERTILIZER INTO THE TOP 1-2" OF THE PLANTING SOIL. APPLY AT A RATE OF 8 LBS. PER 1000 SQUARE FEET.
4. APPLY LIME AT A RATE OF ONE TON PER ACRE AND UNIFORMLY INCORPORATE INTO THE TOP 1-2" OF TOPSOIL.

LEGEND

- PROPOSED PROPERTY LINE
- ABUTTING PROPERTY LINE
- - - BUILDING SETBACK LINE
- - - WETLAND EDGE
- △ WF WETLAND FLAG
- 50' PERIMETER WETLAND
- 100' EXISTING CONTOUR
- 100' PROPOSED CONTOUR
- SLOPES > 15%
- ○ ○ ○ ○ EXISTING STONE WALL
- ○ ○ ○ ○ IRON PIN
- ○ ○ ○ ○ DRILL HOLE
- □ □ □ □ CONCRETE BOUND
- - - FENCE
- ○ ○ ○ ○ UTILITY POLE
- ○ ○ ○ ○ PROPOSED UTILITY POLE
- OHW OVERHEAD WIRES
- UGE UNDERGROUND ELECTRIC
- ○ ○ ○ ○ WELL
- - - N/F NOW OR FORMERLY
- TREELINE
- LOD LIMIT OF DISTURBANCE
- THI SOIL EVALUATION

DEPARTMENT OF ENVIRONMENTAL MANAGEMENT
OFFICE OF WATER RESOURCES
FRESHWATER WETLANDS PROGRAM
APPROVED WITH CONDITIONS
AS SPECIFIED IN THE LETTER OF APPROVAL
DATED AUG 07 2018 FILE # 18-0108
NO CHANGES ALLOWED WITHOUT PRIOR APPROVAL
APPROVED PLANS MUST BE AT CONSTRUCTION SITE.

Joseph D. Wonsch

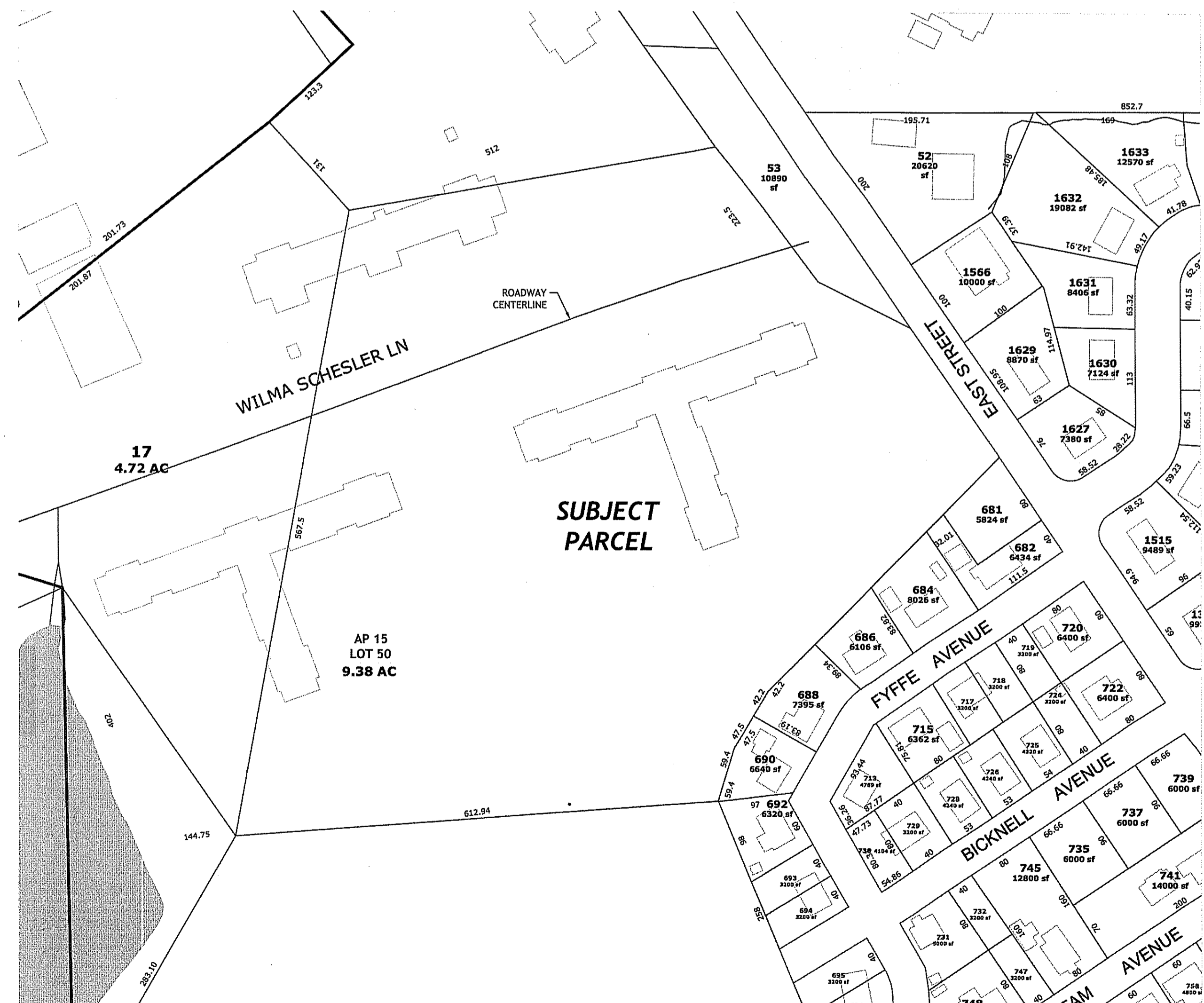

CRANSTON TAX ASSESSOR'S PLAT MAP EXCERPT

SCALE: 1 INCH = 100 FEET

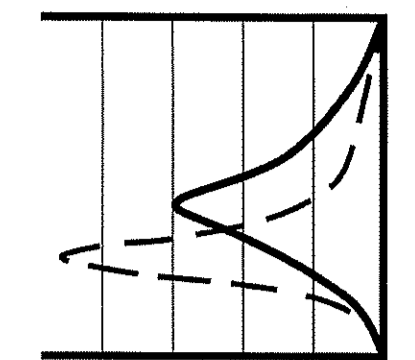

JOE CASALI ENGINEERING, INC.
DRAINAGE, WETLANDS, ISDS, TRAFFIC, FLOODPLAIN
300 POST ROAD, WARWICK, RI 02886
(401) 944-1300 (401) 944-1313 FAX WWW.JOECASALI.COM

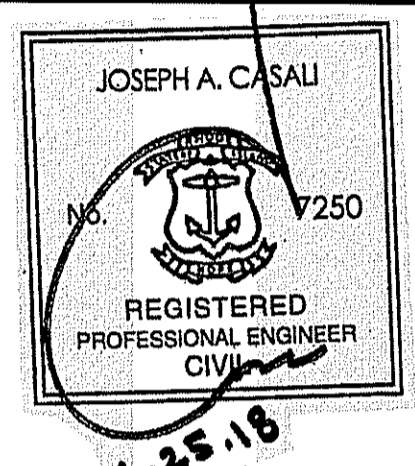

PARKING LOT IMPROVEMENT
18 WILMA SCHESSLER LANE
CRANSTON, RHODE ISLAND
AP 15, LOT 50

REVISIONS:

NO.	DATE	DESCRIPTION
1	6/25/18	RIDEM COMMENTS

DESIGNED BY: DRD
DRAWN BY: SD/SEP
CHECKED BY: JAC
DATE: MAY 2018
PROJECT NO: 13-57b

PRELIMINARY, NOT FOR CONSTRUCTION

GENERAL NOTES & LEGEND

SHEET 2 OF 7

SOIL EVALUATION TEST PIT DATA		
	SURFACE EL.	SHGWT / EL.
TH-1	113.85	46" / 110.00
TH-2	115.50	72" / 109.50
TH-3	116.65	44" / 112.98

NOTE TO CONTRACTOR:
CONTRACTOR TO COORDINATE WITH THE OWNER ON LOCATION OF CONSTRUCTION TRAILER AND STAGING AREAS

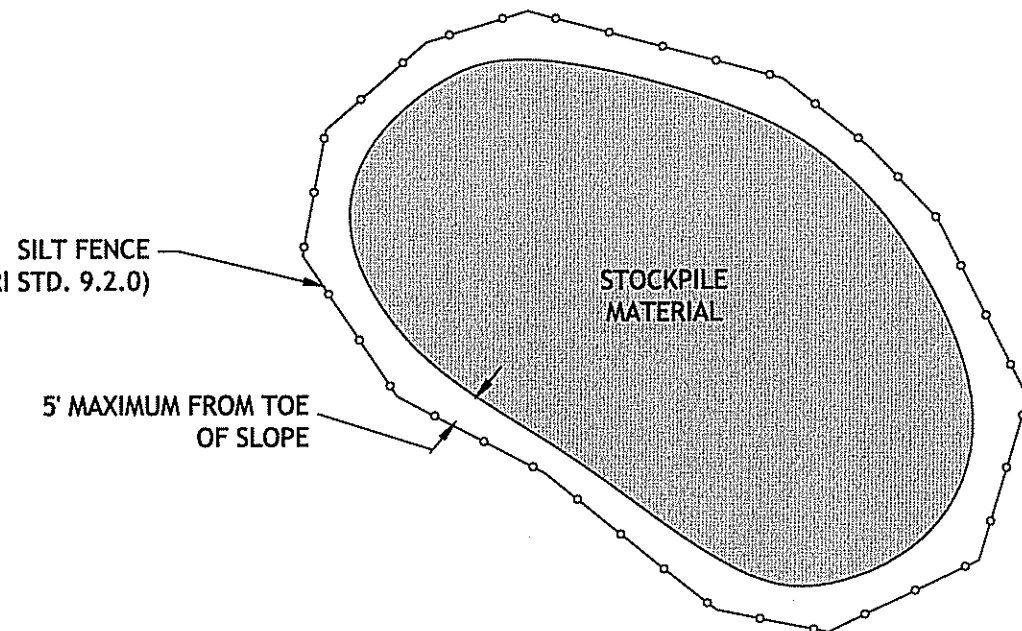

1 MATERIAL STOCKPILE DETAIL
NOT TO SCALE

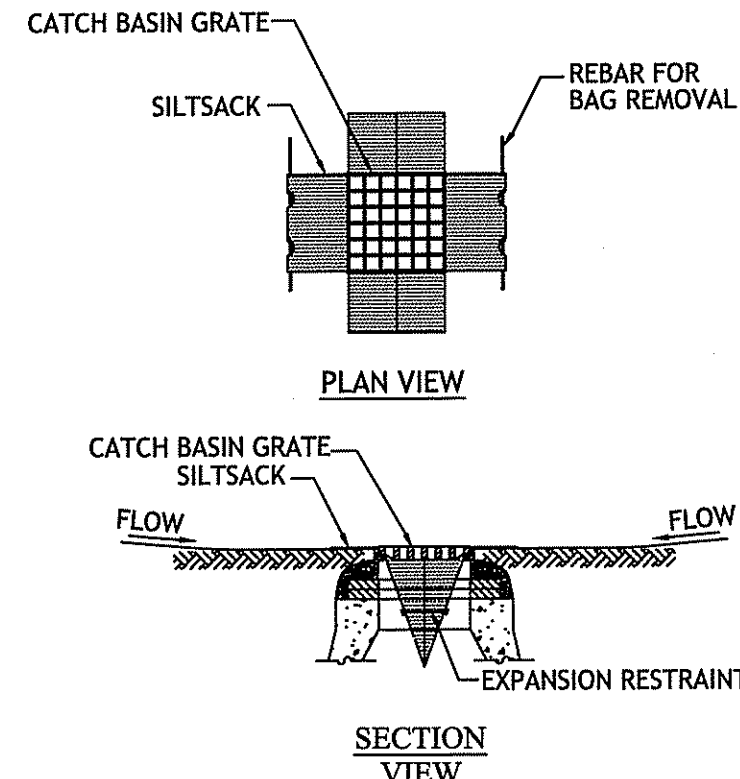

NOTES:
1. INSTALL SILTSACK IN CATCH BASIN AT THE SOUTHEASTERN CORNER OF WASHINGTON AND DEAN STREET AND BOTH CATCH BASINS ALONG SERVICE ROAD 7 BEFORE COMMENCING WORK.
GRATE TO BE PLACED OVER SILTSACK. SILTSACK SHALL BE INSPECTED PERIODICALLY AND AFTER ALL STORM EVENTS AND CLEANING OR REPLACEMENT SHALL BE PERFORMED PROMPTLY AS NEEDED. MAINTAIN UNTIL UPSTREAM AREAS HAVE BEEN PERMANENTLY STABILIZED

2 SILTSACK SEDIMENT TRAP
NOT TO SCALE

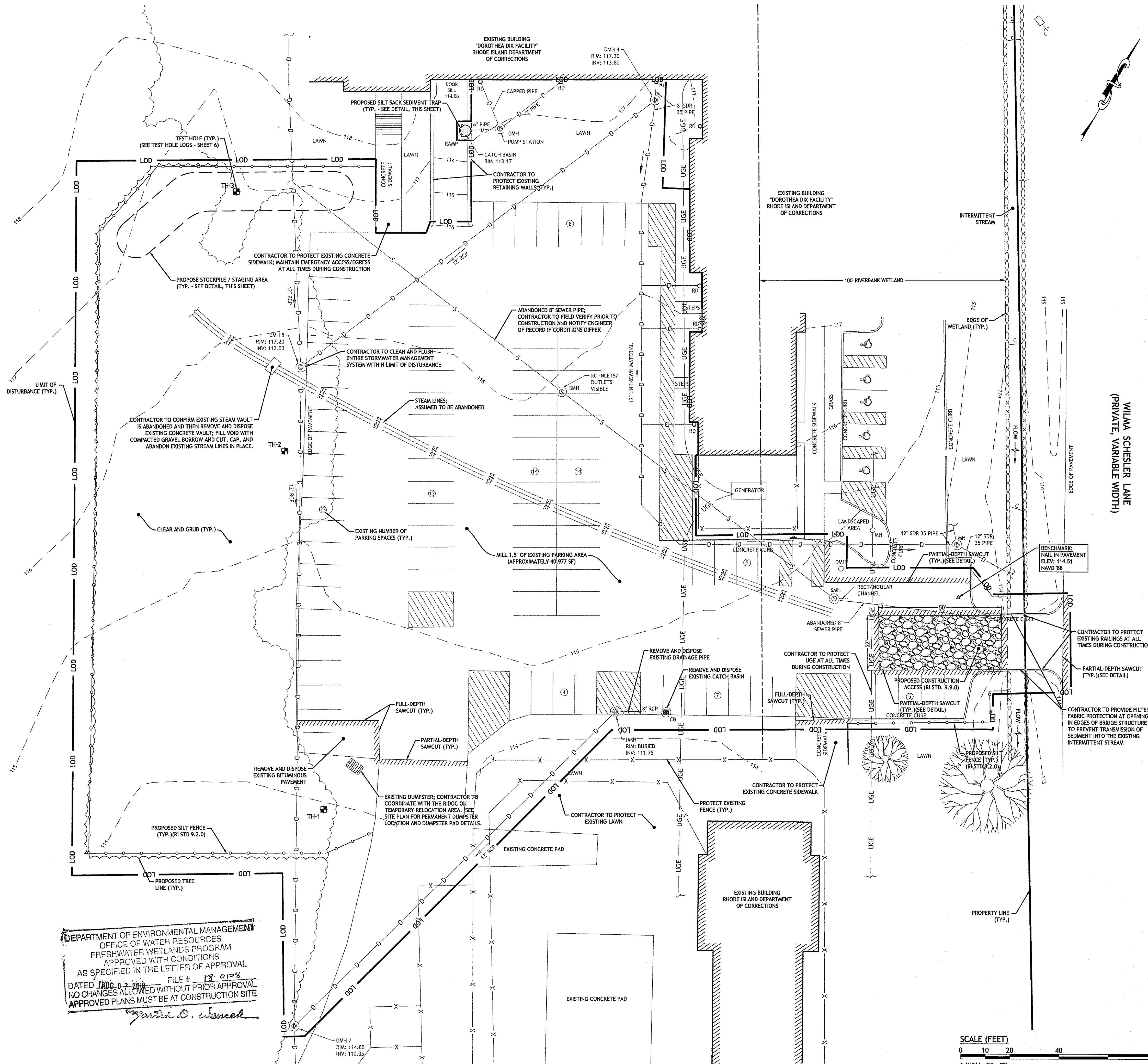

DEPARTMENT OF ENVIRONMENTAL MANAGEMENT
OFFICE OF WATER RESOURCES
FRESHWATER WETLANDS PROGRAM
APPROVED WITH CONDITIONS
AS SPECIFIED IN THE LETTER OF APPROVAL
DATED Aug 07 2018 FILE # 18-0103
NO CHANGES ALLOWED WITHOUT PRIOR APPROVAL
APPROVED PLANS MUST BE AT CONSTRUCTION SITE
Antonia D. Wenczek

Kindly be advised that this Permit is not equivalent to a verification of the type or extent of freshwater wetlands on site.

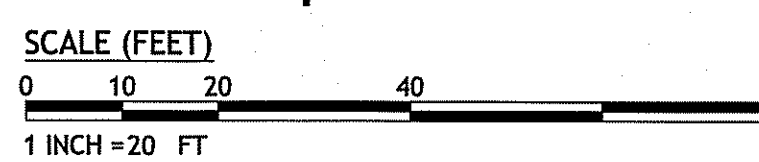

JCE
JOE CASALI ENGINEERING, INC.
CIVIL, SITE DESIGN, TRANSPORTATION, LANDSCAPE ARCHITECTURE, SURVEYING, ENVIRONMENTAL ENGINEERING
300 POST ROAD, WARWICK, RI 02888
(401) 944-1300 FAX (401) 944-1301 WWW.JCEONLINE.COM

JOSEPH A. CASALI
No. 00000000 7250
REGISTERED PROFESSIONAL ENGINEER
CIVIL
6/25/18

PARKING LOT IMPROVEMENT
18 WILMA SCHESSLER LANE
CRANSTON, RHODE ISLAND
AP 15, LOT 50

REVISIONS:

NO.	DATE	DESCRIPTION
1	6/25/18	RIDEM COMMENTS

DESIGNED BY: DRD
DRAWN BY: SD/SEP
CHECKED BY: JAC
DATE: MAY 2018
PROJECT NO: 13-57b

PRELIMINARY, NOT FOR CONSTRUCTION

EXISTING CONDITIONS & SITE PREP. PLAN

SHEET 3 OF 7

Q:\13-57 RI DOCC\13-57b RIDOC Parking Lot Improvements\CADD\Bldg Parking Lot Improvements\RIDEM RTCL.dwg Jun. 25, 2018 5:28pm

PARKING CALCULATIONS FOR DOROTHEA DIX FACILITY:

TOTAL EXISTING SPACES: 107
 TOTAL PROPOSED SPACES: 157
 NET INCREASE: 50

ADA ACCESSIBLE PARKING SPACES REQUIRED: 6 SPACES
 ADA ACCESSIBLE PARKING SPACES PROPOSED: 6 SPACES

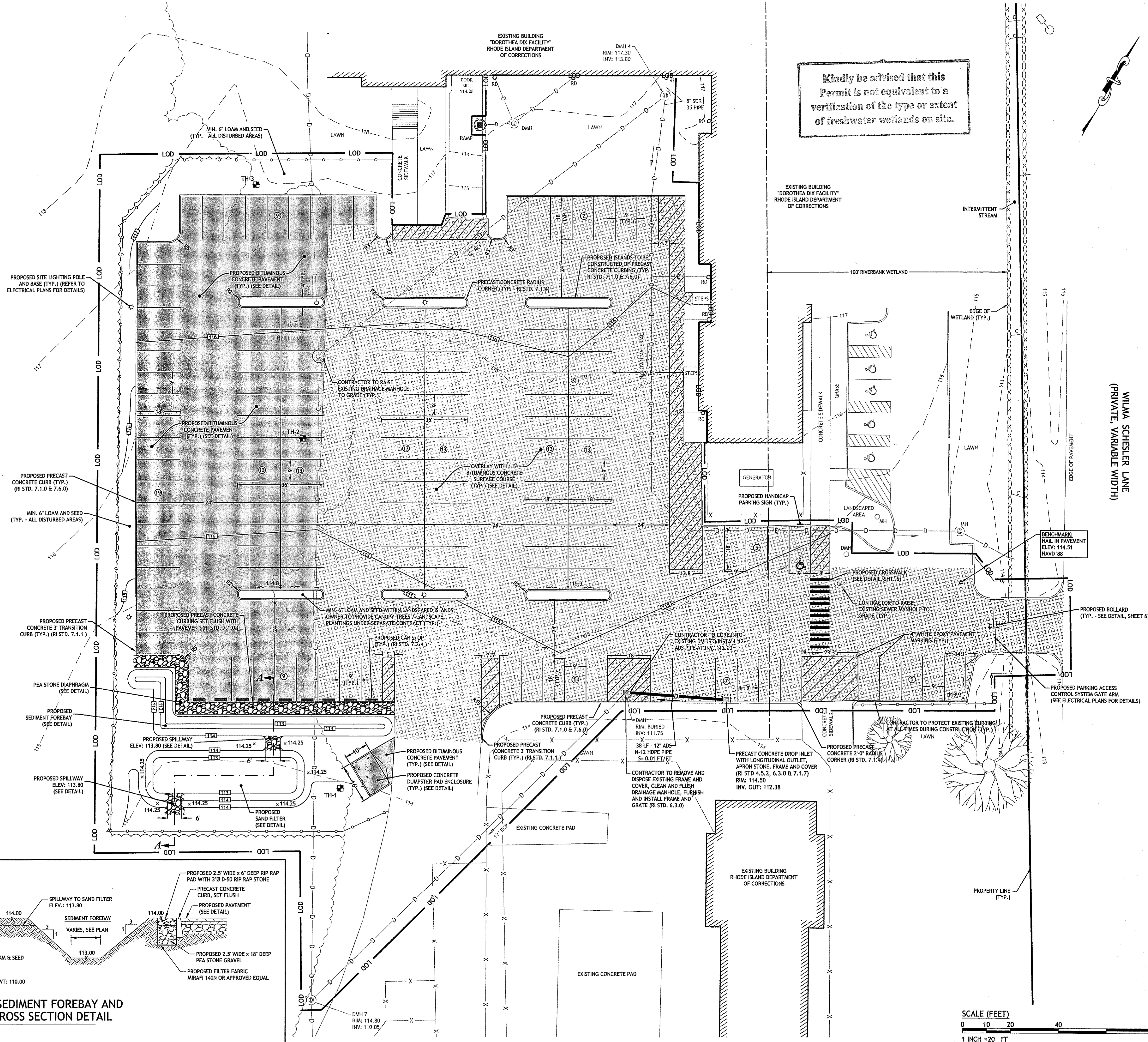
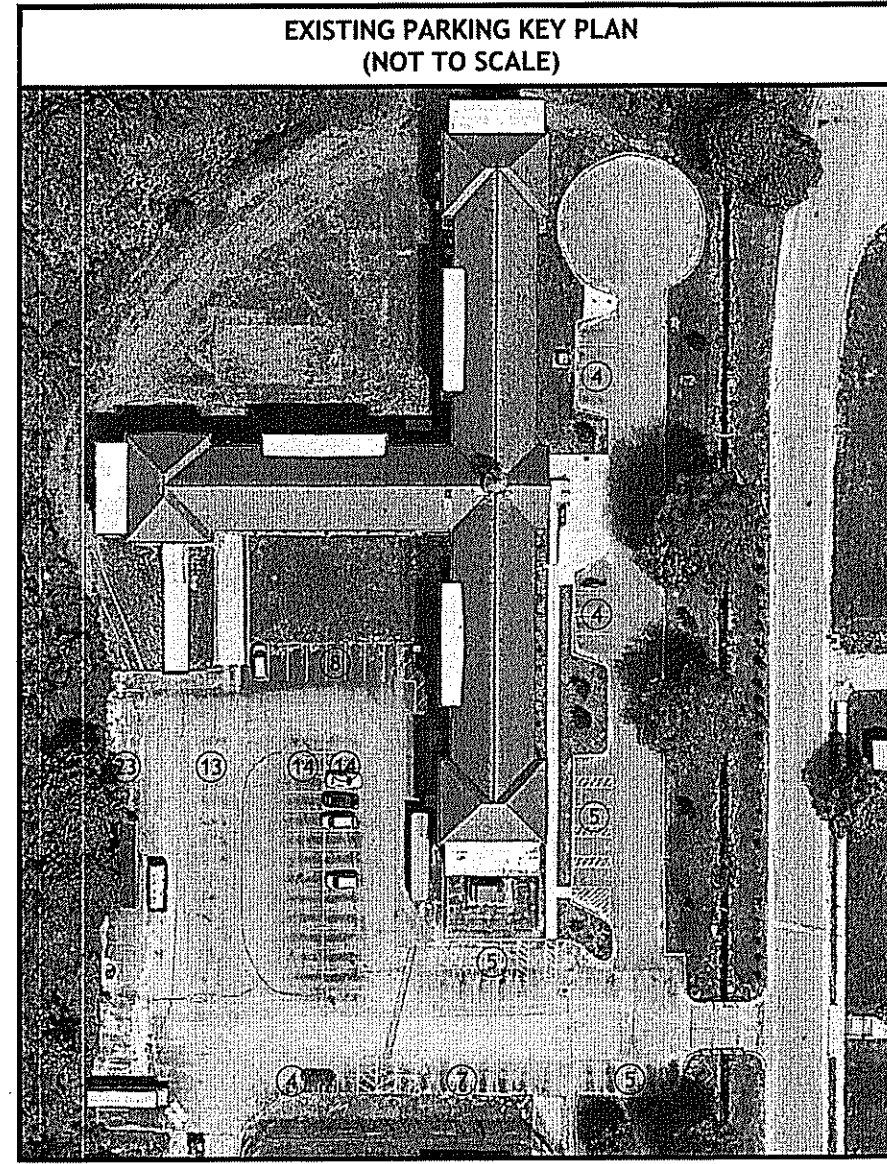

Kindly be advised that this Permit is not equivalent to a verification of the type or extent of freshwater wetlands on site.

DEPARTMENT OF ENVIRONMENTAL MANAGEMENT
 OFFICE OF WATER RESOURCES
 FRESHWATER WETLANDS PROGRAM
 APPROVED WITH CONDITIONS
 AS SPECIFIED IN THE LETTER OF APPROVAL
 DATED 6/7/2018 FILE # 18-0103
 NO CHANGES ALLOWED WITHOUT PRIOR APPROVAL
 APPROVED PLANS MUST BE AT CONSTRUCTION SITE

Joseph A. Casali

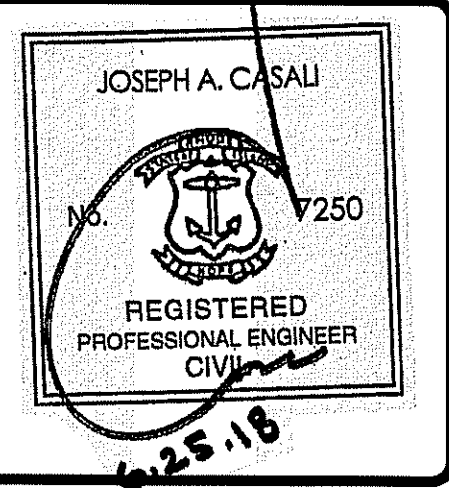
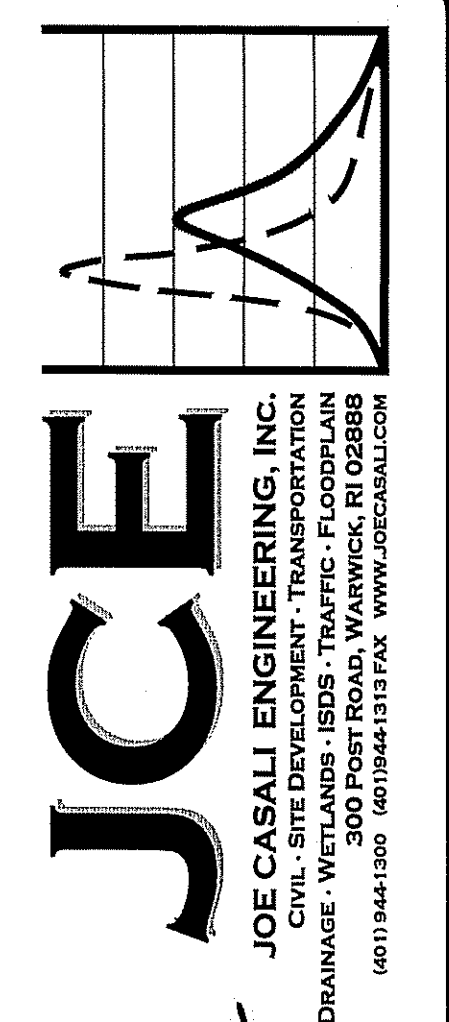
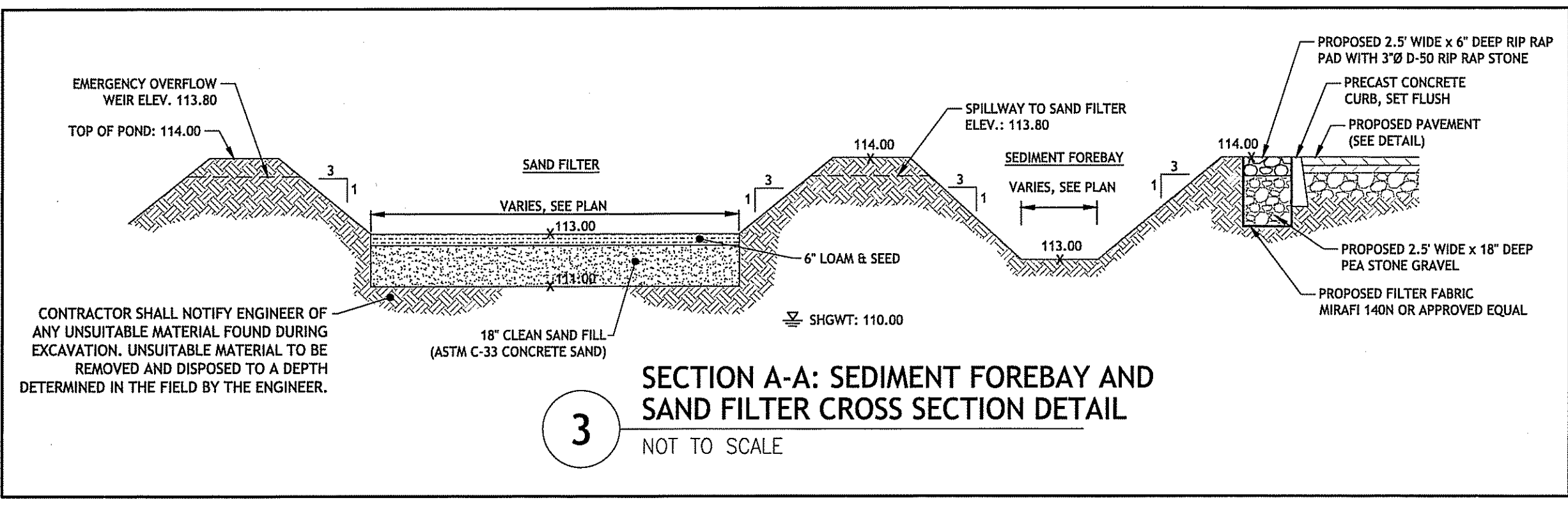

PARKING LOT IMPROVEMENT
18 WILMA SCHESSLER LANE
CRANSTON, RHODE ISLAND
AP 15, LOT 50

REVISIONS:

NO.	DATE	DESCRIPTION
1	6/25/18	RIDEM COMMENTS

DESIGNED BY: DRD
 DRAWN BY: SD/SEP
 CHECKED BY: JAC
 DATE: MAY 2018
 PROJECT NO: 13-57b

PRELIMINARY, NOT FOR CONSTRUCTION

SITE PLAN, GRADING AND DRAINAGE PLAN

SHEET 4 OF 7

C:\13-57 RI DDC\13-57b RIDDC Parking Lot Improvements\CADD\DWG Parking Lot Improvements [RIDEM, RTCI].dwg Jun. 25, 2018 3:28pm



NOTE: SIGNS ARE TO CONFORM WITH THE MOST RECENT EDITION OF THE MANUAL ON UNIFORM TRAFFIC CONTROL DEVICES.

* VAN ACCESSIBLE SIGNS FOR SPACES ADJACENT TO THE 8' STRIPED ISLE.

SIGN NOTES:

- SIGN POSTS SHALL BE GALVANIZED STEEL U-CHANNEL (3 1/2" WIDE-MIN) AND INSTALLED IN CONFORMANCE TO M.U.T.C.D. AND RHODE ISLAND STANDARD SPECIFICATIONS.
- POSTS SHALL BE DRIVEN TO A DEPTH OF 4 FEET (MIN).
- THE EDGE OF THE SIGN SHALL BE 18" FROM THE FACE OF THE CURB.
- WITHIN SIDEWALK LOCATIONS THE SIGN POST WILL BE INSTALLED WITHIN A 8'X8' SQUARE BOX FORM.

4 HANDICAP PARKING SIGNS
NOT TO SCALE

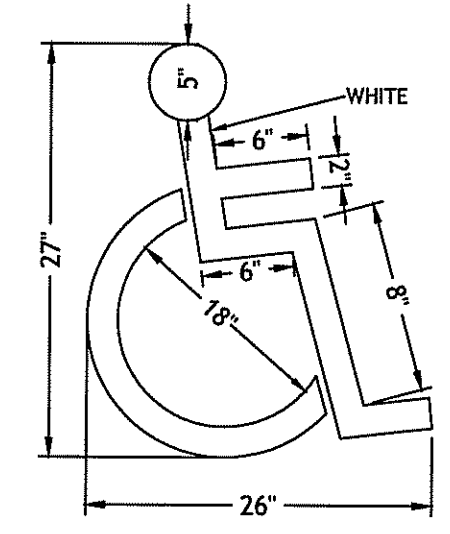

NOTE: 1. ALL HANDICAP PARKING AND SIGNAGE SHALL BE IN ACCORDANCE WITH THE RHODE ISLAND STATE BUILDING CODE.

5 HANDICAP PAVEMENT MARKING
NOT TO SCALE

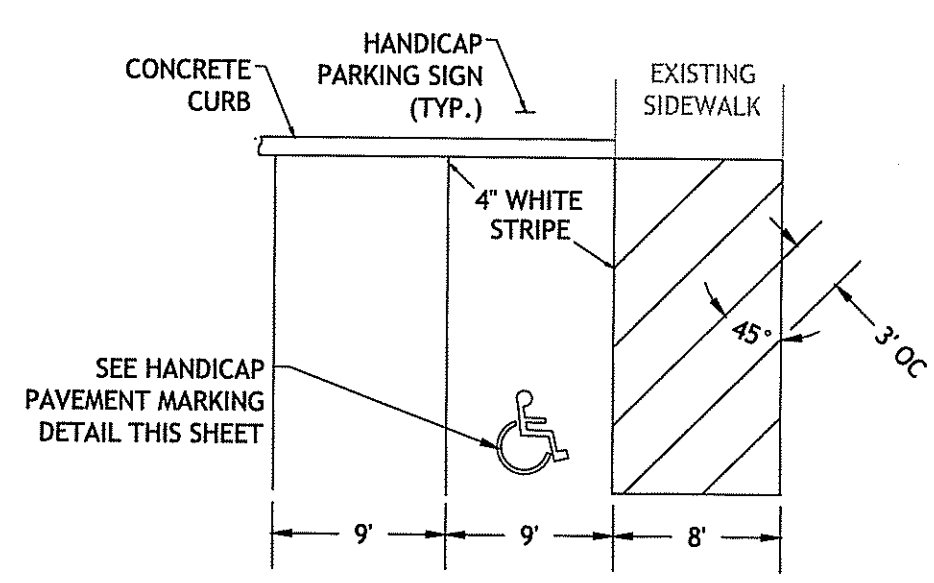

6 HANDICAP PARKING STALLS
NOT TO SCALE

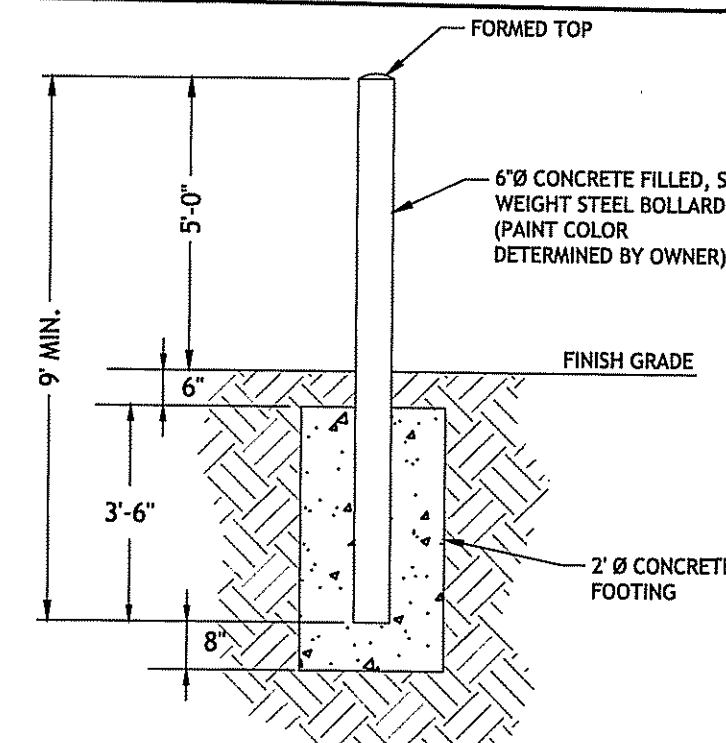

7 TYPICAL BOLLARD DETAIL
NOT TO SCALE

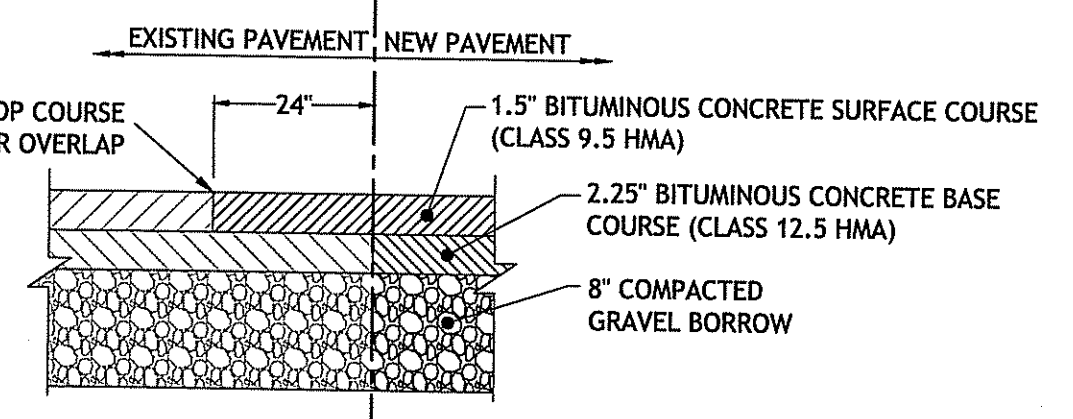

NOTE: PROVIDE BITUMINOUS TACK COAT AT ALL SAWCUTS.

8 PAVEMENT CUT AND MATCH DETAIL
NOT TO SCALE

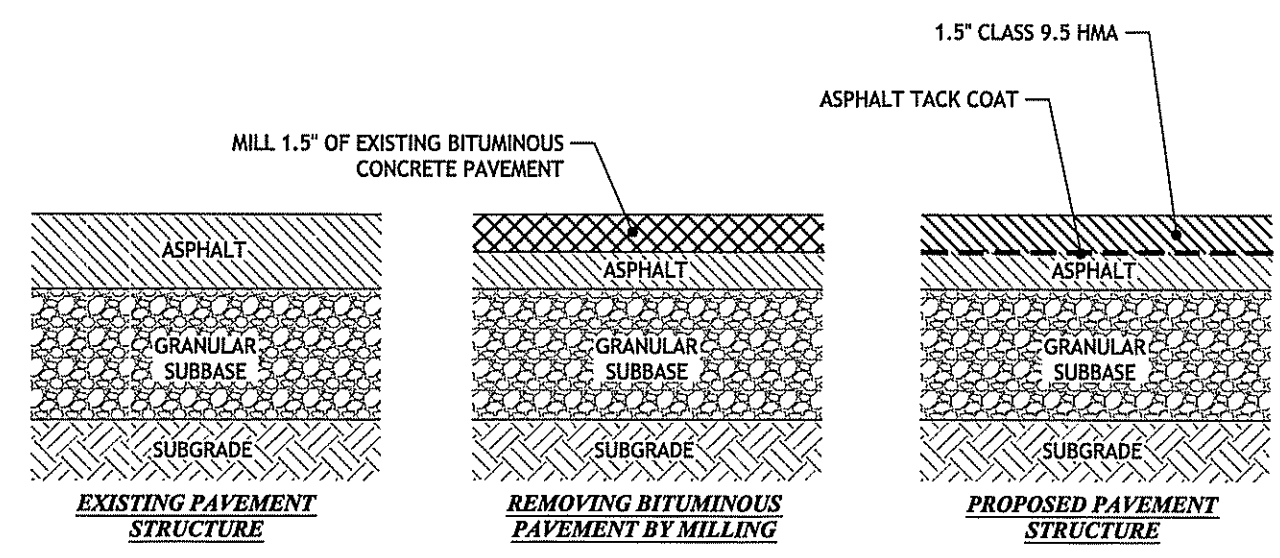

NOTE:

- PAVEMENT MILLING SHALL BE IN ACCORDANCE WITH SECTION 935 OF THE RHODE ISLAND STANDARD SPECIFICATIONS WITH ALL LATEST REVISIONS AND ADDENDA.
- ASPHALT TACK COAT SHALL BE IN ACCORDANCE WITH SECTION 403 OF THE RHODE ISLAND STANDARD SPECIFICATIONS WITH ALL LATEST REVISIONS AND ADDENDA.
- CLASS 9.5 HOT MIX ASPHALT (HMA) SHALL BE IN ACCORDANCE WITH SECTION 401 OF THE RHODE ISLAND STANDARD SPECIFICATIONS WITH ALL LATEST REVISIONS AND ADDENDA.

9 MILLING AND ASPHALT REPAIR DETAIL
NOT TO SCALE

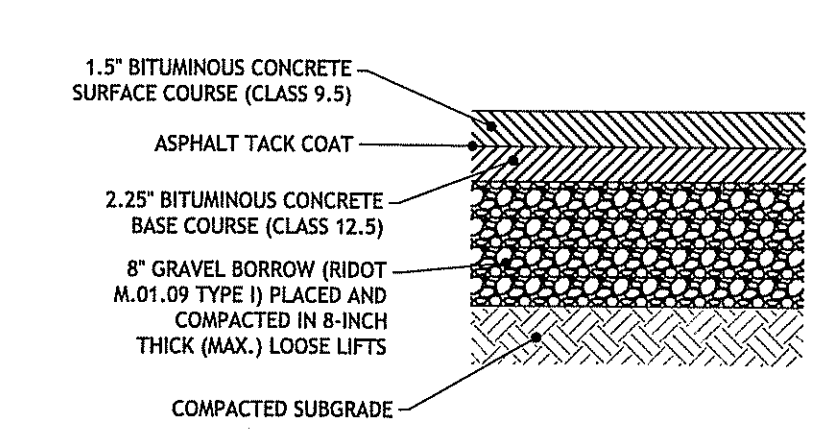

NOTES:

- IF UNSUITABLE MATERIALS ARE ENCOUNTERED AT SUBGRADE ELEVATION, THE CONTRACTOR SHALL NOTIFY THE ENGINEER. THE DEPTH OF UNSUITABLE MATERIAL TO BE REMOVED WILL BE DETERMINED IN THE FIELD. THE CONTRACTOR SHALL REMOVE AND PROPERLY DISPOSE THE UNSUITABLE MATERIALS AND REPLACE WITH SUITABLE MATERIAL APPROVED BY THE ENGINEER.
- MINIMUM COMPACTION FOR GRAVEL BORROW SUB-BASE AND SUBGRADE: 95% MODIFIED PROCTOR.

10 BITUMINOUS CONCRETE PAVEMENT
NOT TO SCALE

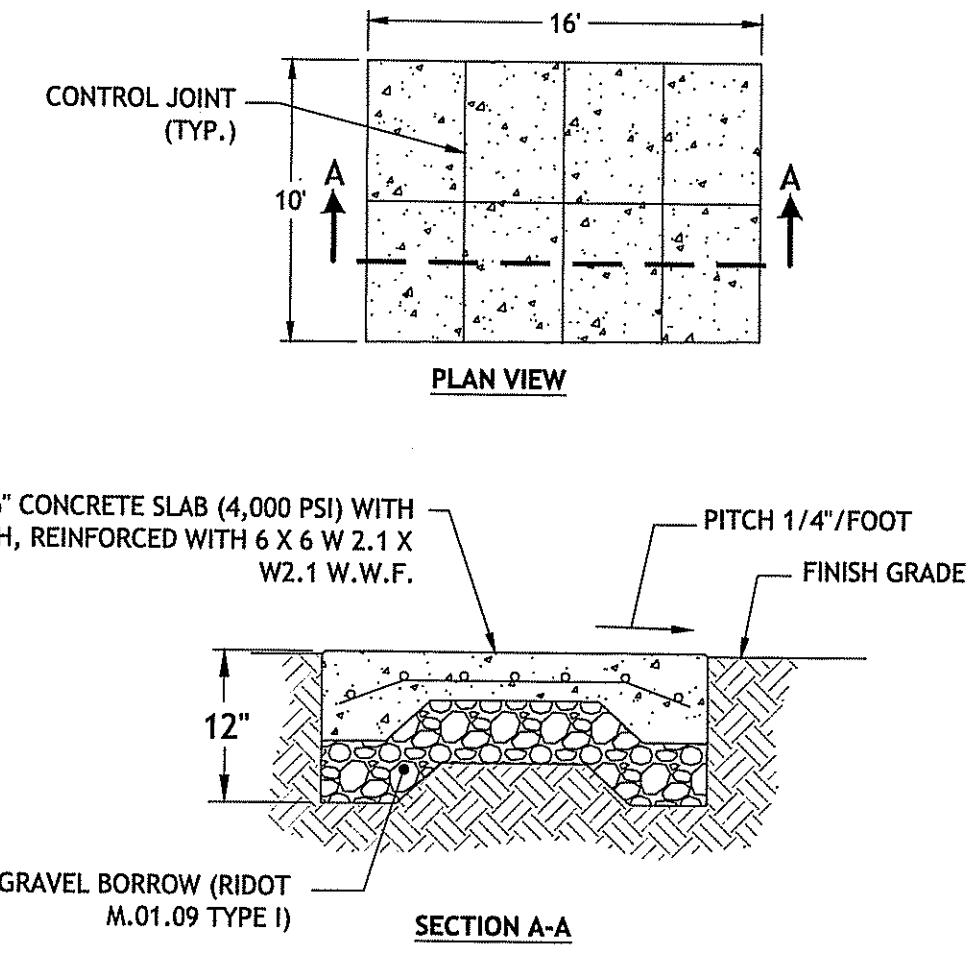

11 DUMPSTER PAD DETAIL
NOT TO SCALE

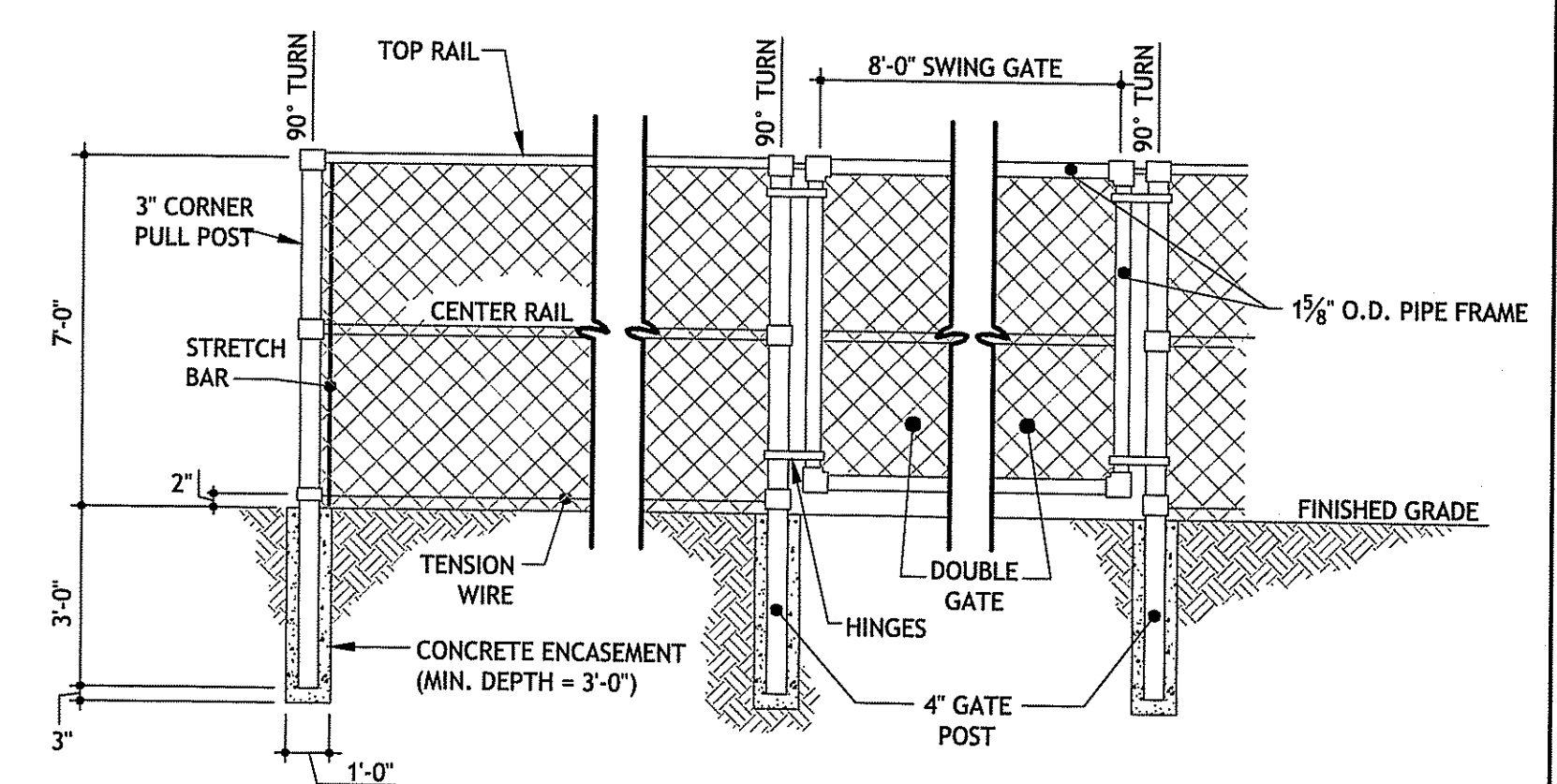

NOTES:

- DOUBLE GATE SHALL HAVE A LOCKING MECHANISM, DROP ROD, AND TRUSS ROD.
- ALL FENCING MATERIALS SHALL BE IN ACCORDANCE WITH SECTION 902 OF THE RHODE ISLAND STANDARD SPECIFICATIONS.
- FENCE MESH TO BE SECURED TO TOP RAIL AND CORNER POSTS USING THE WIRES SPACED 12" ON CENTER.
- PRIVACY SLATS TO BE INSTALLED AT THE COMPLETION OF CONSTRUCTION. PRIVACY SLATS SHALL BE GREEN AND SHALL BE BOTTOM-LOCKING AS MANUFACTURED BY PDS FENCE PRODUCTS INC. OR APPROVED EQUAL.

12 CHAIN-LINK FENCE DETAIL
NOT TO SCALE

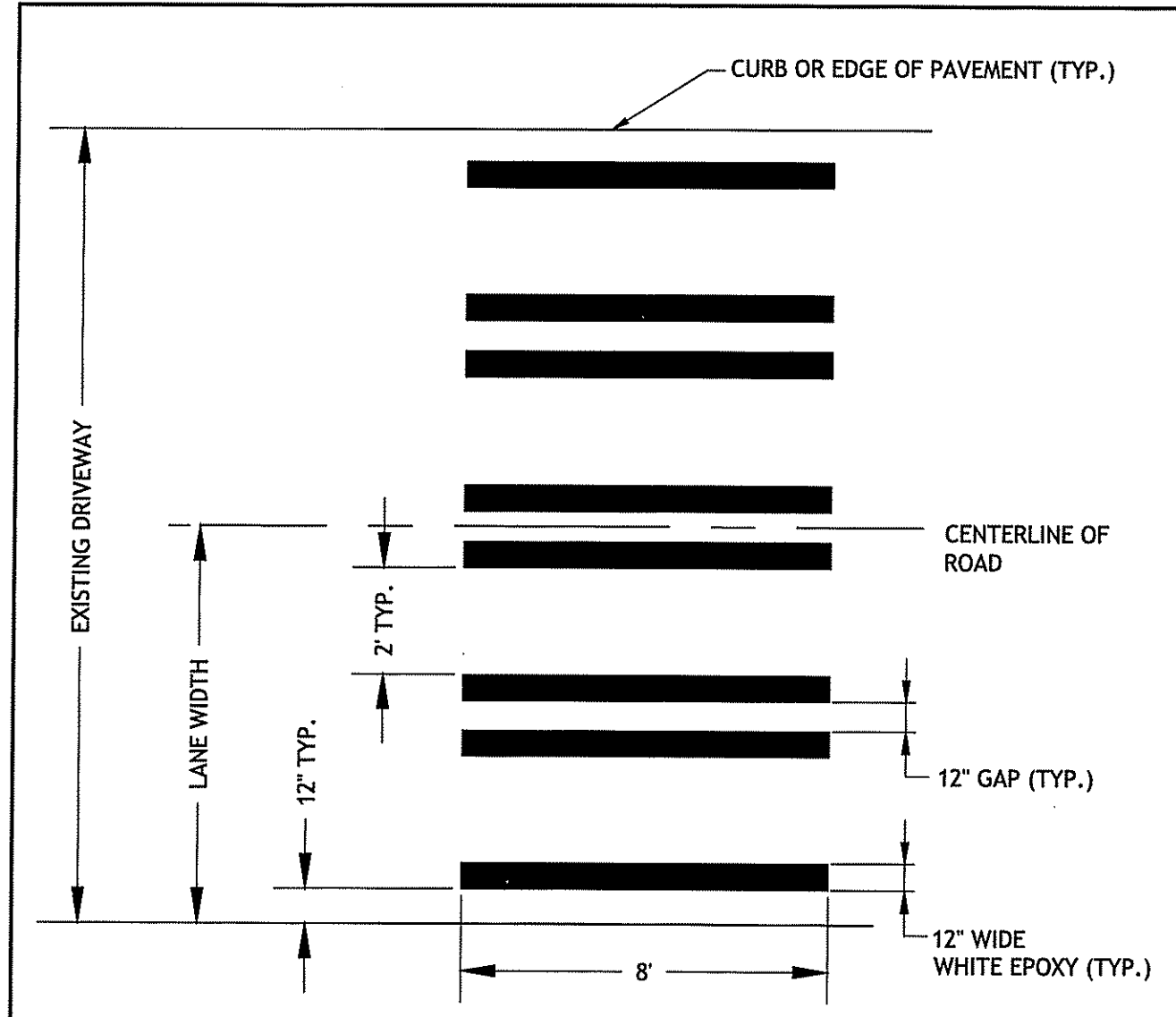

- TWELVE INCH (12") LINES SHALL BE APPLIED IN ONE APPLICATION, NO COMBINATION OF LINES (TWO - 6 INCH LINES) WILL BE ACCEPTED.
- CROSSWALK SIDE SLOPE SHALL NOT EXCEED 1.5%.
- PAVEMENT MARKINGS TO BE PLACED TO AVOID WHEEL PATHS.
- PAVEMENT MARKINGS TO BE WHITE EPOXY PAINT.

13 CONTINENTAL CROSSWALK DETAIL
NOT TO SCALE

Depth (ft)	Sample Type/No.	Remarks	Soil and Rock Description	Estimated Hydraulic Conductivity
0-1'	15	(P-17) SILTY SAND (SM); dark brown, non-through, TOPSOIL.	(P-17) SILTY SAND (SM); dark brown, non-through, TOPSOIL.	
1-2'	16	(P-18) SILTY SAND WITH GRAVEL (SM); fine to medium sand, 10% nonplastic fines, 10% fine to coarse gravel, dark brown, loamy sand.	(P-18) SILTY SAND WITH GRAVEL (SM); fine to medium sand, 10% nonplastic fines, 10% fine to coarse gravel, dark brown, loamy sand.	
2-3'	17	(P-19) SILTY SAND (SM); fine to medium sand, 10% nonplastic fines, 10% fine to coarse gravel, dark brown, loamy sand.	(P-19) SILTY SAND (SM); fine to medium sand, 10% nonplastic fines, 10% fine to coarse gravel, dark brown, loamy sand.	
3-4'	18	(P-20) SILTY SAND WITH GRAVEL (SM); fine to medium sand, 10% nonplastic fines, 10% fine to coarse gravel, dark brown, loamy sand.	(P-20) SILTY SAND WITH GRAVEL (SM); fine to medium sand, 10% nonplastic fines, 10% fine to coarse gravel, dark brown, loamy sand.	
4-5'	19	(P-21) SILTY SAND WITH GRAVEL (SM); fine to medium sand, 10% nonplastic fines, 10% fine to coarse gravel, dark brown, loamy sand.	(P-21) SILTY SAND WITH GRAVEL (SM); fine to medium sand, 10% nonplastic fines, 10% fine to coarse gravel, dark brown, loamy sand.	
5-6'	20	(P-22) SILTY SAND WITH GRAVEL (SM); fine to medium sand, 10% nonplastic fines, 10% fine to coarse gravel, dark brown, loamy sand.	(P-22) SILTY SAND WITH GRAVEL (SM); fine to medium sand, 10% nonplastic fines, 10% fine to coarse gravel, dark brown, loamy sand.	
6-7'	21	(P-23) SILTY SAND WITH GRAVEL (SM); fine to medium sand, 10% nonplastic fines, 10% fine to coarse gravel, dark brown, loamy sand.	(P-23) SILTY SAND WITH GRAVEL (SM); fine to medium sand, 10% nonplastic fines, 10% fine to coarse gravel, dark brown, loamy sand.	
7-8'	22	(P-24) SILTY SAND WITH GRAVEL (SM); fine to medium sand, 10% nonplastic fines, 10% fine to coarse gravel, dark brown, loamy sand.	(P-24) SILTY SAND WITH GRAVEL (SM); fine to medium sand, 10% nonplastic fines, 10% fine to coarse gravel, dark brown, loamy sand.	
8-9'	23	(P-25) SILTY SAND WITH GRAVEL (SM); fine to medium sand, 10% nonplastic fines, 10% fine to coarse gravel, dark brown, loamy sand.	(P-25) SILTY SAND WITH GRAVEL (SM); fine to medium sand, 10% nonplastic fines, 10% fine to coarse gravel, dark brown, loamy sand.	
9-10'	24	(P-26) SILTY SAND WITH GRAVEL (SM); fine to medium sand, 10% nonplastic fines, 10% fine to coarse gravel, dark brown, loamy sand.	(P-26) SILTY SAND WITH GRAVEL (SM); fine to medium sand, 10% nonplastic fines, 10% fine to coarse gravel, dark brown, loamy sand.	
10-11'	25	(P-27) SILTY SAND WITH GRAVEL (SM); fine to medium sand, 10% nonplastic fines, 10% fine to coarse gravel, dark brown, loamy sand.	(P-27) SILTY SAND WITH GRAVEL (SM); fine to medium sand, 10% nonplastic fines, 10% fine to coarse gravel, dark brown, loamy sand.	
11-12'	26	(P-28) SILTY SAND WITH GRAVEL (SM); fine to medium sand, 10% nonplastic fines, 10% fine to coarse gravel, dark brown, loamy sand.	(P-28) SILTY SAND WITH GRAVEL (SM); fine to medium sand, 10% nonplastic fines, 10% fine to coarse gravel, dark brown, loamy sand.	

Depth (ft)	Sample Type/No.	Remarks	Soil and Rock Description	Estimated Hydraulic Conductivity
0-1'	15	(P-17) SILTY SAND (SM); dark brown, non-through, TOPSOIL.	(P-17) SILTY SAND (SM); dark brown, non-through, TOPSOIL.	
1-2'	16	(P-18) SILTY SAND (SM); fine to medium sand, 10% nonplastic fines, 10% fine to coarse gravel, dark brown, loamy sand.	(P-18) SILTY SAND (SM); fine to medium sand, 10% nonplastic fines, 10% fine to coarse gravel, dark brown, loamy sand.	
2-3'	17	(P-19) SILTY SAND (SM); fine to medium sand, 10% nonplastic fines, 10% fine to coarse gravel, dark brown, loamy sand.	(P-19) SILTY SAND (SM); fine to medium sand, 10% nonplastic fines, 10% fine to coarse gravel, dark brown, loamy sand.	
3-4'	18	(P-20) SILTY SAND WITH GRAVEL (SM); fine to medium sand, 10% nonplastic fines, 10% fine to coarse gravel, dark brown, loamy sand.	(P-20) SILTY SAND WITH GRAVEL (SM); fine to medium sand, 10% nonplastic fines, 10% fine to coarse gravel, dark brown, loamy sand.	
4-5'	19	(P-21) SILTY SAND WITH GRAVEL (SM); fine to medium sand, 10% nonplastic fines, 10% fine to coarse gravel, dark brown, loamy sand.	(P-21) SILTY SAND WITH GRAVEL (SM); fine to medium sand, 10% nonplastic fines, 10% fine to coarse gravel, dark brown, loamy sand.	
5-6'	20	(P-22) SILTY SAND WITH GRAVEL (SM); fine to medium sand, 10% nonplastic fines, 10% fine to coarse gravel, dark brown, loamy sand.	(P-22) SILTY SAND WITH GRAVEL (SM); fine to medium sand, 10% nonplastic fines, 10% fine to coarse gravel, dark brown, loamy sand.	
6-7'	21	(P-23) SILTY SAND WITH GRAVEL (SM); fine to medium sand, 10% nonplastic fines, 10% fine to coarse gravel, dark brown, loamy sand.	(P-23) SILTY SAND WITH GRAVEL (SM); fine to medium sand, 10% nonplastic fines, 10% fine to coarse gravel, dark brown, loamy sand.	
7-8'	22	(P-24) SILTY SAND WITH GRAVEL (SM); fine to medium sand, 10% nonplastic fines, 10% fine to coarse gravel, dark brown, loamy sand.	(P-24) SILTY SAND WITH GRAVEL (SM); fine to medium sand, 10% nonplastic fines, 10% fine to coarse gravel, dark brown, loamy sand.	
8-9'	23	(P-25) SILTY SAND WITH GRAVEL (SM); fine to medium sand, 10% nonplastic fines, 10% fine to coarse gravel, dark brown, loamy sand.	(P-25) SILTY SAND WITH GRAVEL (SM); fine to medium sand, 10% nonplastic fines, 10% fine to coarse gravel, dark brown, loamy sand.	
9-10'	24	(P-26) SILTY SAND WITH GRAVEL (SM); fine to medium sand, 10% nonplastic fines, 10% fine to coarse gravel, dark brown, loamy sand.	(P-26) SILTY SAND WITH GRAVEL (SM); fine to medium sand, 10% nonplastic fines, 10% fine to coarse gravel, dark brown, loamy sand.	
10-11'	25	(P-27) SILTY SAND WITH GRAVEL (SM); fine to medium sand, 10% nonplastic fines, 10% fine to coarse gravel, dark brown, loamy sand.	(P-27) SILTY SAND WITH GRAVEL (SM); fine to medium sand, 10% nonplastic fines, 10% fine to coarse gravel, dark brown, loamy sand.	
11-12'	26	(P-28) SILTY SAND WITH GRAVEL (SM); fine to medium sand, 10% nonplastic fines, 10% fine to coarse gravel, dark brown, loamy sand.	(P-28) SILTY SAND WITH GRAVEL (SM); fine to medium sand, 10% nonplastic fines, 10% fine to coarse gravel, dark brown, loamy sand.	

14 TEST HOLE LOGS
NOT TO SCALE

Depth (ft)	Sample Type/No.	Remarks	Soil and Rock Description	Estimated Hydraulic Conductivity
0-1'	15	(P-17) SILTY SAND (SM); dark brown, non-through, TOPSOIL.	(P-17) SILTY SAND (SM); dark brown, non-through, TOPSOIL.	
1-2'	16	(P-18) SILTY SAND (SM); fine to medium sand, 10% nonplastic fines, 10% fine to coarse gravel, dark brown, loamy sand.	(P-18) SILTY SAND (SM); fine to medium sand, 10% nonplastic fines, 10% fine to coarse gravel, dark brown, loamy sand.	
2-3'	17	(P-19) SILTY SAND (SM); fine to medium sand, 10% nonplastic fines, 10% fine to coarse gravel, dark brown, loamy sand.	(P-19) SILTY SAND (SM); fine to medium sand, 10% nonplastic fines, 10% fine to coarse gravel, dark brown, loamy sand.	
3-4'	18	(P-20) SILTY SAND WITH GRAVEL (SM); fine to medium sand, 10% nonplastic fines, 10% fine to coarse gravel, dark brown, loamy sand.	(P-20) SILTY SAND WITH GRAVEL (SM); fine to medium sand, 10% nonplastic fines, 10% fine to coarse gravel, dark brown, loamy sand.	
4-5'	19	(P-21) SILTY SAND WITH GRAVEL (SM); fine to medium sand, 10% nonplastic fines, 10% fine to coarse gravel, dark brown, loamy sand.	(P-21) SILTY SAND WITH GRAVEL (SM); fine to medium sand, 10% nonplastic fines, 10% fine to coarse gravel, dark brown, loamy sand.	
5-6'	20	(P-22) SILTY SAND WITH GRAVEL (SM); fine to medium sand, 10% nonplastic fines, 10% fine to coarse gravel, dark brown, loamy sand.	(P-22) SILTY SAND WITH GRAVEL (SM); fine to medium sand, 10% nonplastic fines, 10% fine to coarse gravel, dark brown, loamy sand.	
6-7'	21	(P-23) SILTY SAND WITH GRAVEL (SM); fine to medium sand, 10% nonplastic fines, 10% fine to coarse gravel, dark brown, loamy sand.	(P-23) SILTY SAND WITH GRAVEL (SM); fine to medium sand, 10% nonplastic fines, 10% fine to coarse gravel, dark brown, loamy sand.	
7-8'	22	(P-24) SILTY SAND WITH GRAVEL (SM); fine to medium sand, 10% nonplastic fines, 10% fine to coarse gravel, dark brown, loamy sand.	(P-24) SILTY SAND WITH GRAVEL (SM); fine to medium sand, 10% nonplastic fines, 10% fine to coarse gravel, dark brown, loamy sand.	
8-9'	23	(P-25) SILTY SAND WITH GRAVEL (SM); fine to medium sand, 10% nonplastic fines, 10% fine to coarse gravel, dark brown, loamy sand.	(P-25) SILTY SAND WITH GRAVEL (SM); fine to medium sand, 10% nonplastic fines, 10% fine to coarse gravel, dark brown, loamy sand.	
9-10'	24	(P-26) SILTY SAND WITH GRAVEL (SM); fine to medium sand, 10% nonplastic fines, 10% fine to coarse gravel, dark brown, loamy sand.	(P-26) SILTY SAND WITH GRAVEL (SM); fine to medium sand, 10% nonplastic fines, 10% fine to coarse gravel, dark brown, loamy sand.	
10-11'	25	(P-27) SILTY SAND WITH GRAVEL (SM); fine to medium sand, 10% nonplastic fines, 10% fine to coarse gravel, dark brown, loamy sand.	(P-27) SILTY SAND WITH GRAVEL (SM); fine to medium sand, 10% nonplastic fines, 10% fine to coarse gravel, dark brown, loamy sand.	
11-12'	26	(P-28) SILTY SAND WITH GRAVEL (SM); fine to medium sand, 10% nonplastic fines, 10% fine to coarse gravel, dark brown, loamy sand.	(P-28) SILTY SAND WITH GRAVEL (SM); fine to medium sand, 10% nonplastic fines, 10% fine to coarse gravel, dark brown, loamy sand.	

DEPARTMENT OF ENVIRONMENTAL MANAGEMENT
OFFICE OF WATER RESOURCES
FRESHWATER WETLANDS PROGRAM
APPROVED WITH CONDITIONS
AS SPECIFIED IN THE LETTER OF APPROVAL
DATED AUG 07 2018 FILE # 18-0108
NO CHANGES ALLOWED WITHOUT PRIOR APPROVAL
APPROVED PLANS MUST BE AT CONSTRUCTION SITE.

PARKING LOT IMPROVEMENT
18 WILMA SCHESLER LANE
CRANSTON, RHODE ISLAND
AP 15, LOT 50

REVISIONS:

NO.	DATE	DESCRIPTION
1	6/25/18	RIDEM COMMENTS

DESIGNED BY: DRD
DRAWN BY: SD/SEP
CHECKED BY: JAC
DATE: MAY 2018
PROJECT NO: 13-57b

PRELIMINARY, NOT FOR CONSTRUCTION

DETAILS SHEET

SHEET 6 OF 7

JCE
JOE CASALI ENGINEERING, INC.
A CORPORATION OF THE STATE OF RHODE ISLAND
DRAINAGE - WETLANDS - REDS - TRAILWORKS
300 POST ROAD, WARWICK, RI 02886
(401) 944-1300 (401) 944-1313 FAX WWW.JCEALL.COM

JOSEPH A. CASALI
No. 2518
REGISTERED PROFESSIONAL ENGINEER
CIVIL
2518

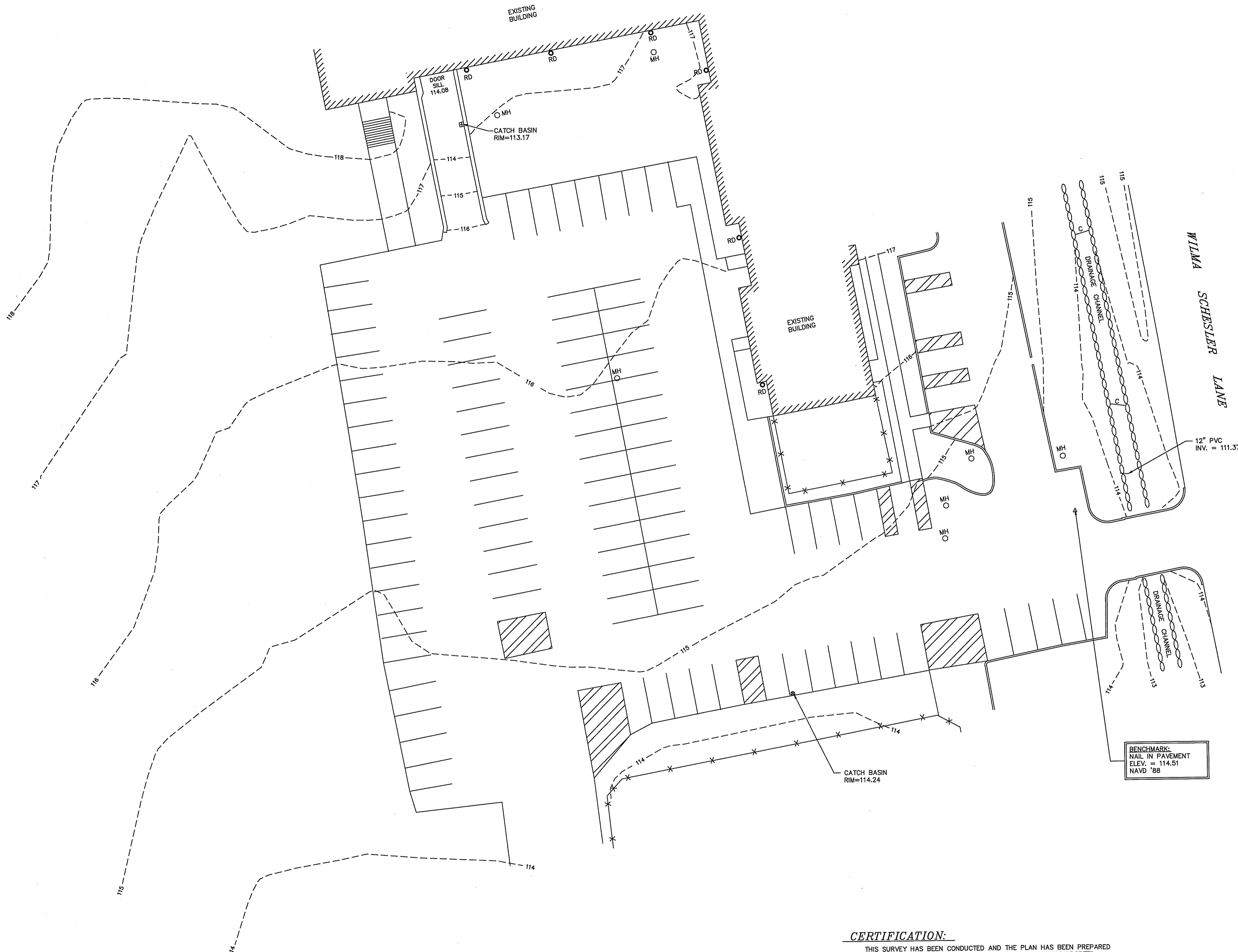
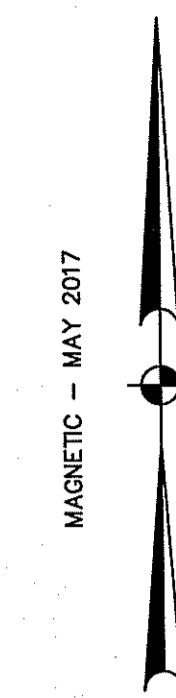

NOTES:
 THE UTILITIES HEREON ARE SHOWN FROM FIELD LOCATIONS OF SURFACE FEATURES. THIS PLAN DOES NOT SHOW ALL UTILITIES ON THIS SITE AND DIG-SAFE MUST BE CONTACTED PRIOR TO ANY EXCAVATION. (1-888-DIG-SAFE)

Kindly be advised that this Permit is not equivalent to a verification of the type or extent of freshwater wetlands on site.

DEPARTMENT OF ENVIRONMENTAL MANAGEMENT
 OFFICE OF WATER RESOURCES
 FRESHWATER WETLANDS PROGRAM
 APPROVED WITH CONDITIONS
 AS SPECIFIED IN THE LETTER OF APPROVAL
 DATED AUG 07 2018 FILE # 18-0108
 NO CHANGES ALLOWED WITHOUT PRIOR APPROVAL
 APPROVED PLANS MUST BE AT CONSTRUCTION SITE
Matthew D. Wenzel

CERTIFICATION:
 THIS SURVEY HAS BEEN CONDUCTED AND THE PLAN HAS BEEN PREPARED PURSUANT TO SECTION 9 OF THE RULES AND REGULATIONS ADOPTED BY THE RHODE ISLAND STATE BOARD OF REGISTRATION FOR PROFESSIONAL LAND SURVEYORS ON NOVEMBER 25, 2015, AS FOLLOWS:
 TYPE OF BOUNDARY SURVEY: NOT A BOUNDARY SURVEY
 MEASUREMENT SPECIFICATION: NONE
 VERTICAL CONTROL STANDARD: V-3
 TOPOGRAPHIC SURVEY ACCURACY: T-2
 THE PURPOSE FOR THE CONDUCT OF THE SURVEY AND FOR THE PREPARATION OF THE PLAN IS AS FOLLOWS:
 THIS PLAN AND SURVEY ARE A PARTIAL EXISTING CONDITIONS PLAN.
 BY: *Anthony E. Muscatelli*
 ANTHONY E. MUSCATELLI, PLS #1718 COA #A368

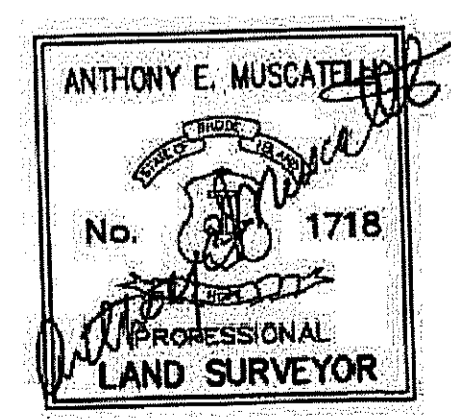

LEGEND:
 EXISTING CONTOUR: - - - - - 100
 EXISTING CHAIN LINK FENCE: - x - x -
 EXISTING STONE LINE DRAINAGE CHANNEL: ○ ○ ○ ○ ○
 EXISTING MANHOLE: ○ MH
 EXISTING CATCH BASIN: ⊙ CB
 EXISTING ROOF DRAIN: ○
 EXISTING UTILITY CONDUIT: -



INTERNATIONAL MAPPING & SURVEYING CORP.			
LAND SURVEYING CIVIL ENGINEERING PHOTOGRAMMETRIC MAPPING 19 INDUSTRIAL DRIVE, SMITHFIELD, R.I. 02917 (401) 232-2620			
PARTIAL EXISTING CONDITIONS PLAN for JOE CASALI ENGINEERING CO., INC. on WILMA SCHESSLER LANE in CRANSTON, RI A.P. 15 LOT 50			
REV. TO NAVD '88	DATE	NO.	
REVISIONS	05/17/17	1	
DRAWN BY	P.A.K.		
CKD. BY	K.R.R.		
APPRD. BY	A.E.M.		
DATE	05/24/17		
SCALE	1"=20'		
SHEET	7 OF 7		
DWG. NO.	170404-SP		