

FED. ROAD DIV. NO.	STATE	FEDERAL AID PROJECT NO.	FISCAL YEAR	SHEET NO.	TOTAL SHEETS
1	RI	BR-BRDG-003	2018	01	115

# INDEX

SHEET NO.	DESCRIPTION
1	COVER SHEET
2	STANDARD PLAN SYMBOLS & STANDARD LEGEND
3	STANDARD NOTES - 1
4	STANDARD NOTES - 2
5	LIST OF ABBREVIATIONS
6	JOB SPECIFIC NOTES - 1
7	JOB SPECIFIC NOTES - 2
8	KEY PLAN
9-13	REPAIR DETAILS
14	MISCELLANEOUS DETAILS
15	MPT DETAILS
16-19	BRIDGE NO. 011401 - RUNNINS RIVER BRIDGE
20-24	BRIDGE NO. 012901 - PECK'S BRIDGE
25-28	BRIDGE NO. 013501 - RUMFORD RR BRIDGE
29-34	BRIDGE NO. 015101 - BARRINGTON PARKWAY BRIDGE
35-39	BRIDGE NO. 015801 - STANDARD OIL CO. BRIDGE
40-43	BRIDGE NO. 020001 - WASHINGTON BRIDGE SOUTH
44-48	BRIDGE NO. 028201 - LUTHER'S CORNER CULVERT
49-52	BRIDGE NO. 029401 - BULLOCKS POINT RR BRIDGE
53-58	BRIDGE NO. 045101 - SIX CORNERS UNDERPASS
59-66	BRIDGE NO. 059501 - MASSASOIT AVE RAMP SOUTH BRIDGE
67-73	BRIDGE NO. 059601 - MASSASOIT AVE RAMP NORTH BRIDGE
74-84	BRIDGE NO. 059701 - NORTH BROADWAY BRIDGE
85-89	BRIDGE NO. 094101 - GREENWOOD AVE RR BRIDGE
90-92	BRIDGE NO. 094601 - WATERMAN AVE SPUR RR BRIDGE
93-98	BRIDGE NO. 099401 - ROGER WILLIAMS AVE BRIDGE
99-101	BRIDGE NO. 012201 - NAYATT BRIDGE
102-105	BRIDGE NO. 012301 - BARRINGTON BRIDGE
106-108	BRIDGE NO. 012401 - WARREN BRIDGE
109-111	BRIDGE NO. 012501 - SOUTH WARREN CULVERT
112-113	BRIDGE NO. 013301 - KICKAMUIT BRIDGE
114-115	BRIDGE NO. 113801 - BELCHERS COVE BRIDGE

## STATE OF RHODE ISLAND

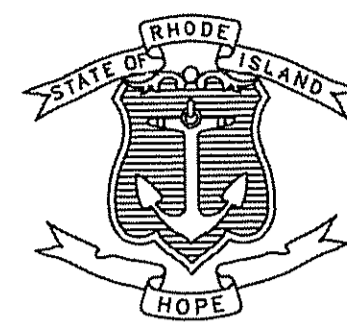

# DEPARTMENT OF TRANSPORTATION

## PLAN, PROFILE AND SECTIONS OF PROPOSED

## STATE HIGHWAY

# EAST BAY BRIDGE PRESERVATION PROJECT

TOWNS OF EAST PROVIDENCE, BARRINGTON AND WARREN  
COUNTIES OF PROVIDENCE AND BRISTOL

R.I. CONTRACT NO. 2016-EB-035  
F.A. PROJECT NO. BR-BRDG-003

Kindly be advised that this Permit is not equivalent to a verification of the type or extent of freshwater wetlands on site.

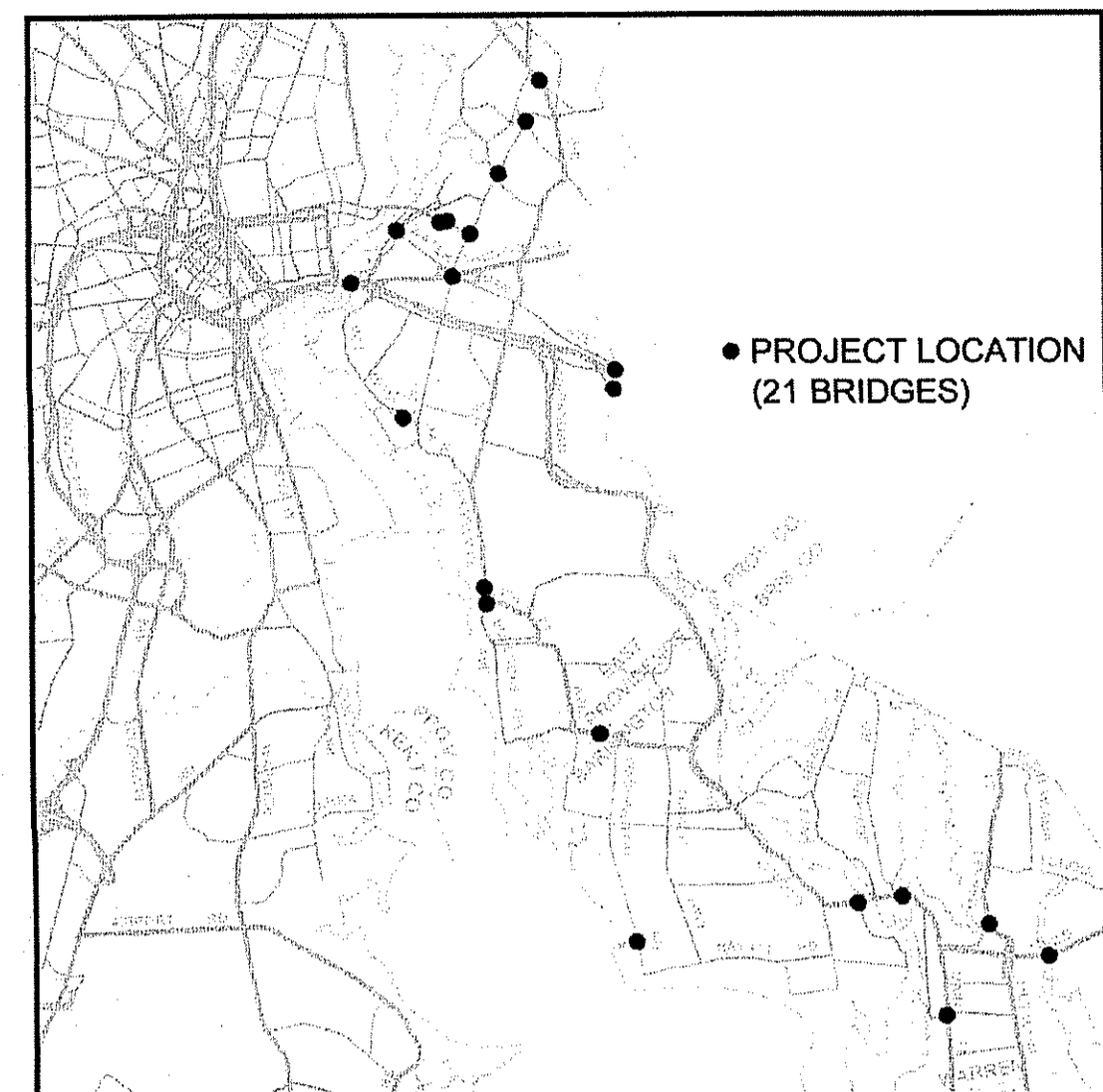

LOCATION MAP  
NOT TO SCALE

DEPARTMENT OF ENVIRONMENTAL MANAGEMENT  
OFFICE OF WATER RESOURCES  
FRESHWATER WETLANDS PROGRAM  
APPROVED WITH CONDITIONS  
AS SPECIFIED IN THE LETTER OF APPROVAL  
DATED JUN 26 2018 FILE # 18-0126  
NO CHANGES ALLOWED WITHOUT PRIOR APPROVAL  
APPROVED PLANS MUST BE AT CONSTRUCTION SITE

*Matthew D. Wenczek*

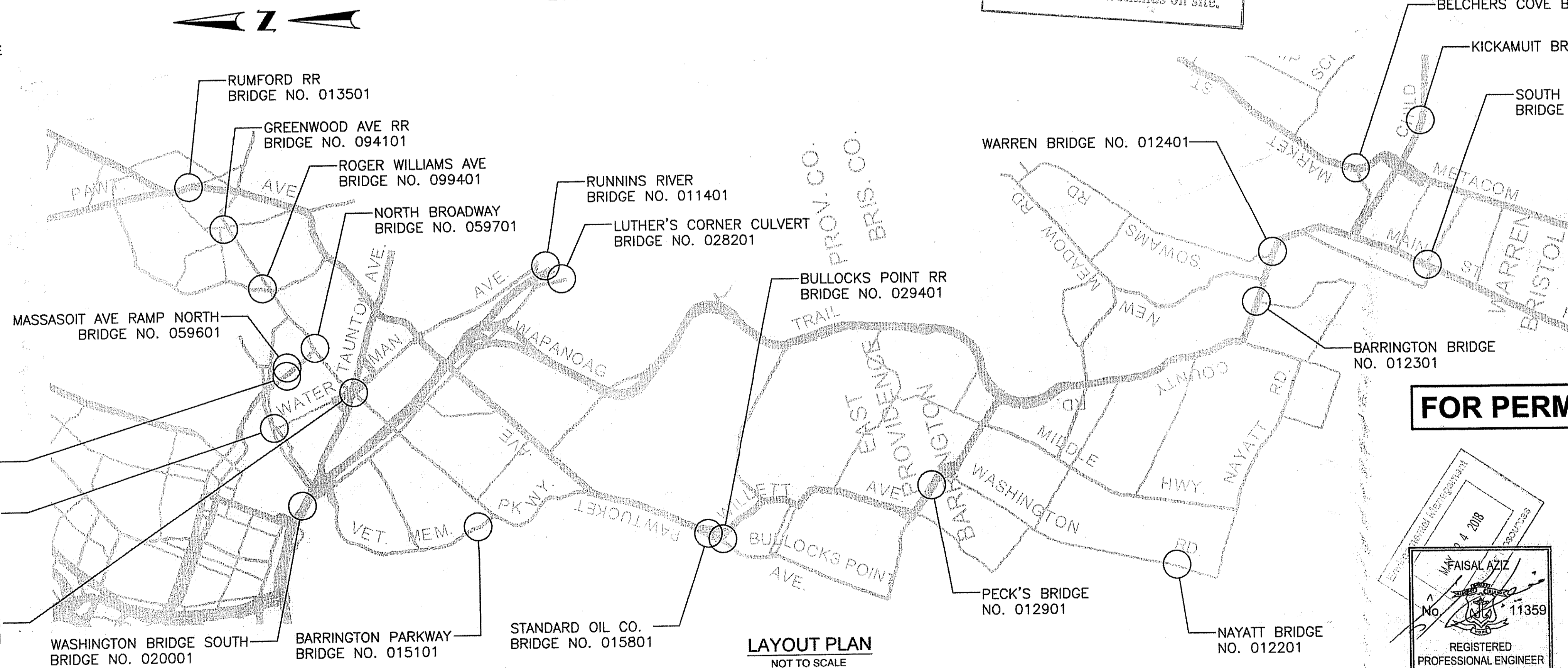

LAYOUT PLAN  
NOT TO SCALE

SCALES OF DRAWINGS  
Plans As Noted

BASE OF LEVELS  
NAVD 88  
NAD 83

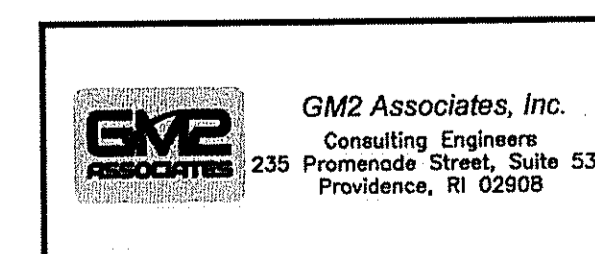

### FOR PERMITTING PURPOSES ONLY

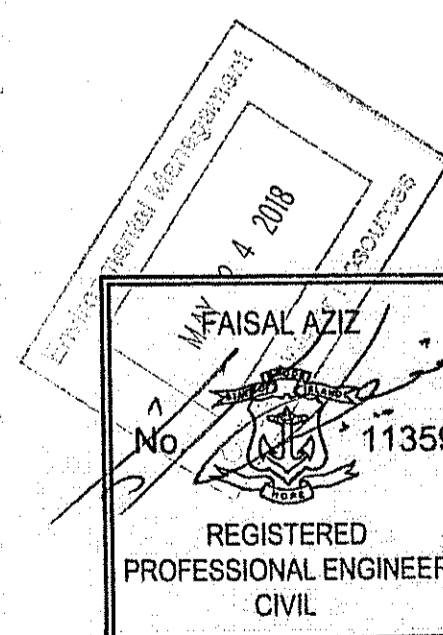

R.I. DEPARTMENT OF TRANSPORTATION	
APPROVED	
ADMINISTRATOR, PROJECT MANAGEMENT	DATE
APPROVED	
CHIEF ENGINEER OF INFRASTRUCTURE	DATE
APPROVED	
DIRECTOR	DATE
DEPARTMENT OF TRANSPORTATION FEDERAL HIGHWAY ADMINISTRATION	
APPROVED	
DIVISION ADMINISTRATOR	DATE

Contract Number 2016-EB-035  
Number of Sheet 1  
Total Sheets 115

R.I. STANDARD SPECIFICATIONS AND STANDARD DETAILS  
SPECIFICATIONS TO GOVERN THIS PROJECT ARE THE R.I. STANDARD SPECIFICATIONS FOR ROAD AND BRIDGE CONSTRUCTION, 2004 EDITION, INCLUDING ALL LATEST SUPPLEMENTALS, AND THE STATE AND FEDERAL SPECIAL PROVISIONS INCLUDED IN THE CONTRACT DOCUMENTS. STANDARD DETAILS FOR THIS PROJECT ARE R.I. STANDARD DETAILS, 1998 EDITION, WITH ALL REVISIONS.



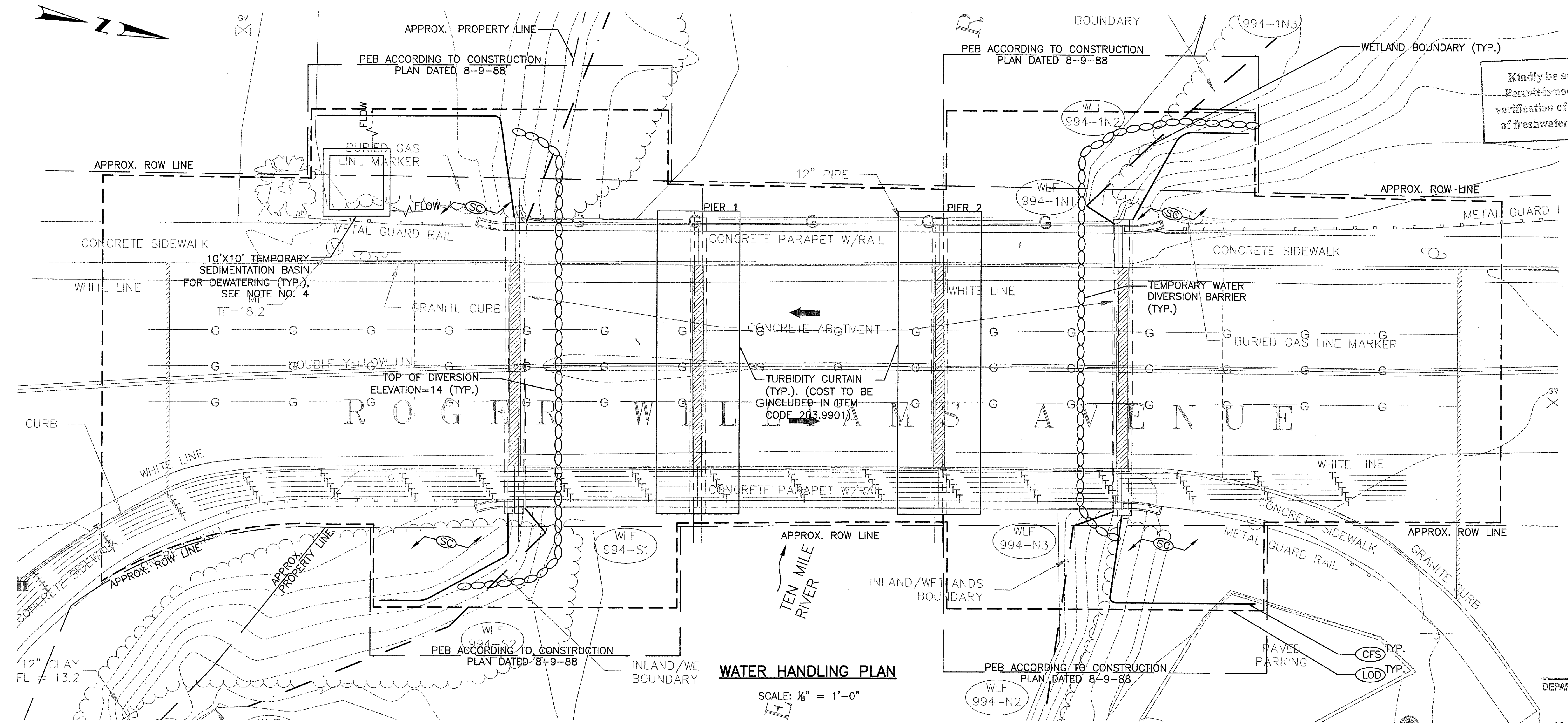

Kindly be advised that this Permit is not equivalent to a verification of the type or extent of freshwater wetlands on site.

**WATER HANDLING NOTES:**

1. WORK FOR REPAIRS TO THE ABUTMENTS SHALL BE DONE UNDER DRY CONDITIONS.
2. THE SUGGESTED METHOD OF CONTROLLING WATER DURING CONSTRUCTION FOR REPAIRS TO ABUTMENTS CONSIST OF FLOW DIVERSION BARRIERS AS SHOWN ON THE PLAN.
3. ALL ACCESS TO THE PILES FOR REPAIR WORK SHALL BE DONE USING BOATS, BARGES AND SCAFFOLDING AS APPROVED BY THE ENGINEER.
4. THE CONTRACTOR SHALL SUBMIT HIS PLAN AND METHOD FOR HANDLING WATER FOR REVIEW AND APPROVAL PRIOR TO THE START OF WORK.
5. THE CONTRACTOR MAY NEED TO INCREASE THE SIZE OF TEMPORARY SEDIMENTATION BASIN FOR DEWATERING AS REQUIRED BY FLOWS. ASSUMED LOCATION OF DEWATERING BASIN IS SHOWN ON PLAN. CONTRACTOR MAY VARY THE LOCATION BASED ON SITE CONDITION AND AS APPROVED BY THE ENGINEER.
6. SOIL EROSION AND SEDIMENT CONTROL DEVICE LOCATIONS SHALL BE LOCATED IN THE FIELD TO MAXIMUM EXTENT FEASIBLE ACCORDING TO THESE PLANS. ALTERATION OF LOCATION SHALL BE DONE WITH THE APPROVAL OF ENGINEER.
7. CONTRACTOR SHALL BE RESPONSIBLE TO ENSURE THAT NO DEBRIS FALLS INTO THE WATERWAY DURING THE REPAIR WORKS. THE USE OF SUSPENDED NETS OR TRAPS TO CATCH THE FALLING DEBRIS SHALL BE EMPLOYED. ANY MATERIAL WHICH DOES FALL INTO THE WATERWAY SHALL BE REMOVED IMMEDIATELY TO THE SATISFACTION OF THE ENGINEER.

DEPARTMENT OF ENVIRONMENTAL MANAGEMENT  
 OFFICE OF WATER RESOURCES  
 FRESHWATER WETLANDS PROGRAM  
 APPROVED WITH CONDITIONS  
 AS SPECIFIED IN THE LETTER OF APPROVAL  
 DATED JUN 26 2018 FILE # 18-0126  
 NO CHANGES ALLOWED WITHOUT PRIOR APPROVAL  
 APPROVED PLANS MUST BE AT CONSTRUCTION SITE

*Jonathan D. Senese*

**FOR PERMITTING PURPOSES ONLY**

REVISIONS		RHODE ISLAND DEPARTMENT OF TRANSPORTATION
DATE		
		EAST BAY BRIDGE PRESERVATION BRIDGE NO. 099401 ROGER WILLIAMS AVE. OVER TEN MILE RIVER EAST PROVIDENCE, RHODE ISLAND
		WATER HANDLING PLAN

**TEMPORARY IMPACTS**

ITEMS	AREA (SF)
DIVERSION BARRIER	870

**GM2 ASSOCIATES**  
 GM2 Associates, Inc.  
 Consulting Engineers  
 235 Promenade Street, Suite 535  
 Providence, RI 02908







