

**NOTES**

1. DISTURBANCE WITHIN 50' PERIMETER WETLAND: 730 SF.

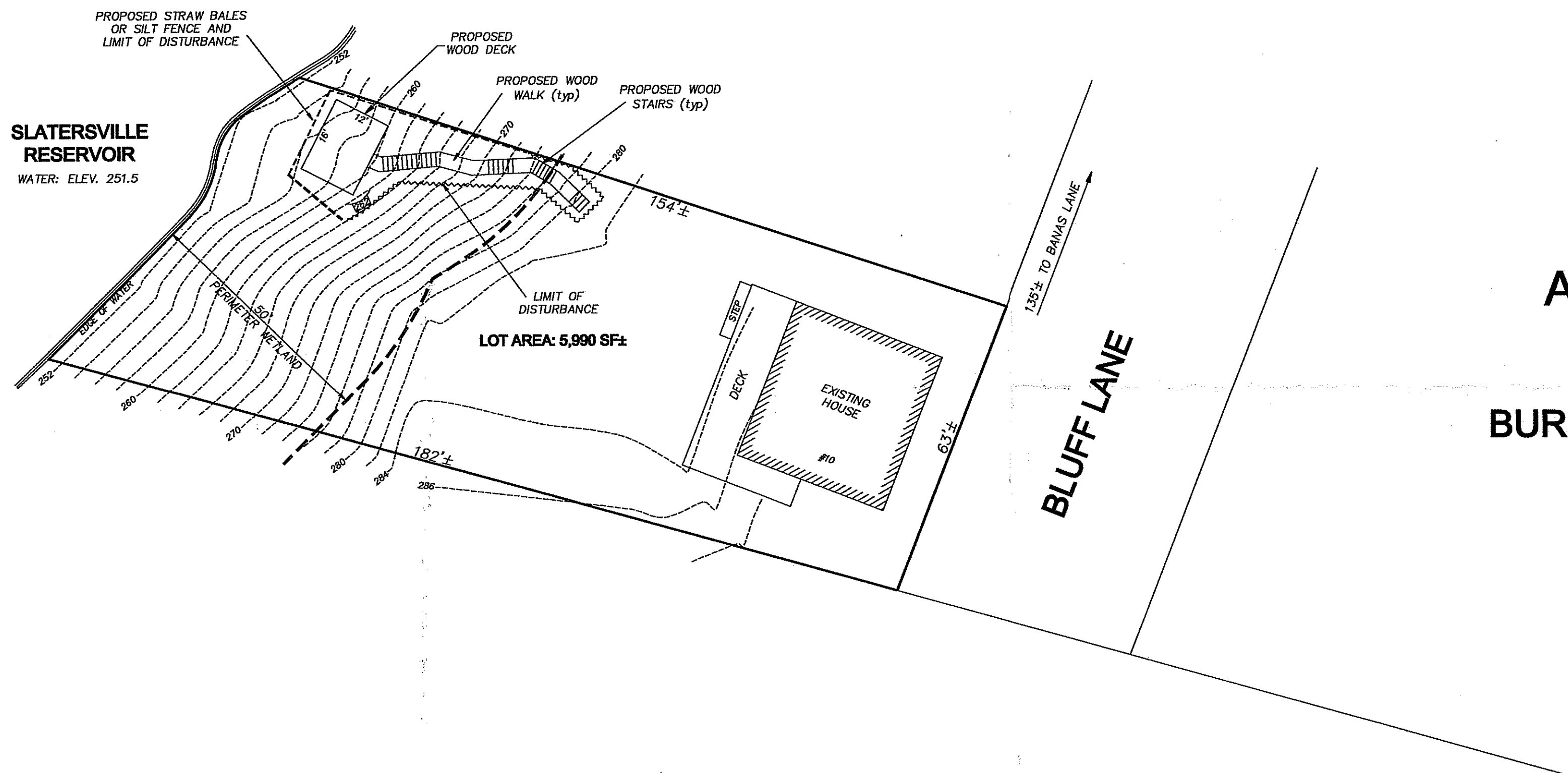

**SITE PLAN**  
for  
**ANDREW BEATSON**  
**PLAT 132, LOT 20**  
**10 BLUFF ROAD**  
**BURRILLVILLE, RHODE ISLAND**  
**APRIL, 2018**  
**SCALE: 1 INCH EQUALS 20 FEET**

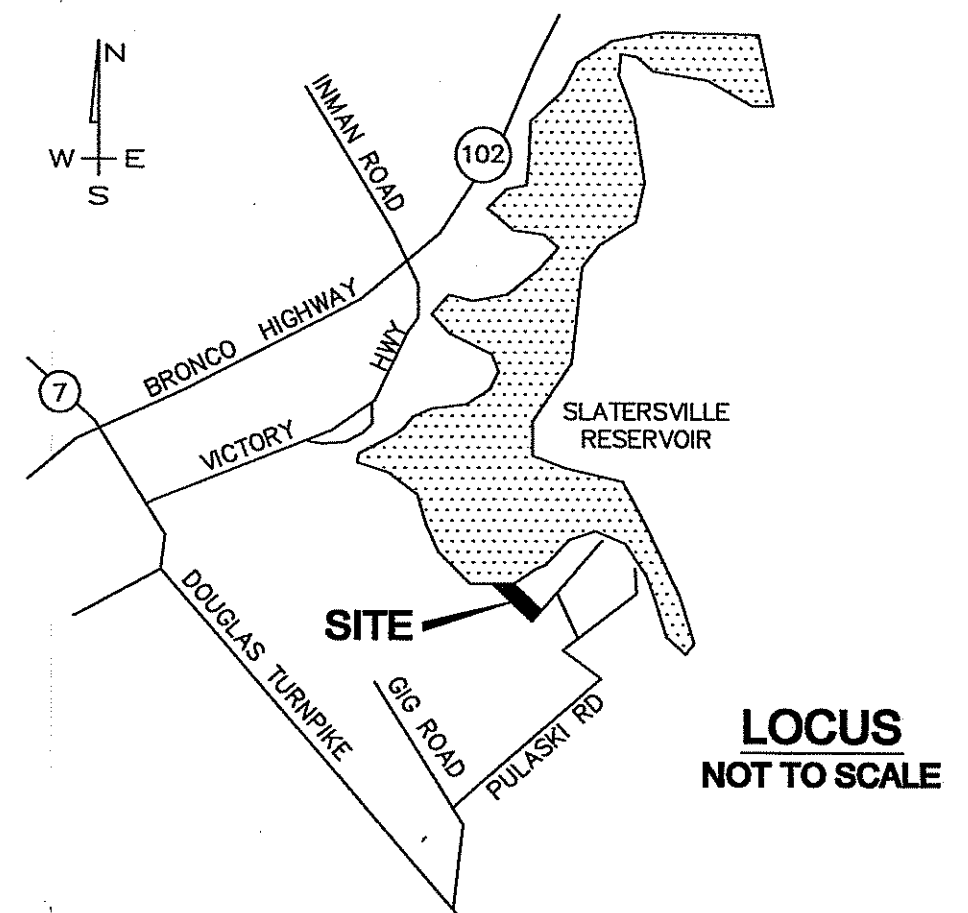

Kindly be advised that this Permit is not equivalent to a verification of the type or extent of freshwater wetlands on site.

**LEGEND**

-----	280	EXISTING CONTOUR
-----		STRAW BALES OR SILT FENCE & LIMIT OF DISTURBANCE
~~~~~		LIMIT OF DISTURBANCE

DEPARTMENT OF ENVIRONMENTAL MANAGEMENT  
OFFICE OF WATER RESOURCES  
FRESHWATER WETLANDS PROGRAM  
APPROVED WITH CONDITIONS  
AS SPECIFIED IN THE LETTER OF APPROVAL  
DATED JUL 27 2018 FILE # 18-0146  
NO CHANGES ALLOWED WITHOUT PRIOR APPROVAL  
APPROVED PLANS MUST BE AT CONSTRUCTION SITE

**CERTIFICATION**  
THIS SURVEY HAS BEEN CONDUCTED AND THE PLAN HAS BEEN PREPARED PURSUANT TO SECTION 9 OF THE RULES AND REGULATIONS ADOPTED BY THE RHODE ISLAND STATE BOARD OF REGISTRATION FOR PROFESSIONAL LAND SURVEYORS ON NOVEMBER 25, 2015, AS FOLLOWS:  
**LIMITED CONTENT BOUNDARY SURVEY: CLASS IV**  
**TOPOGRAPHIC ACCURACY T-4**

**STATEMENT OF PURPOSE**  
THE PURPOSE FOR THE CONDUCT OF THE SURVEY AND THE PREPARATION OF THE PLAN IS AS FOLLOWS: DECK.

BY: *Marc N. Nyberg*  
**MARC N. NYBERG** License No. 1797 COA No.: A52

*Jonathan D. Wenczek*

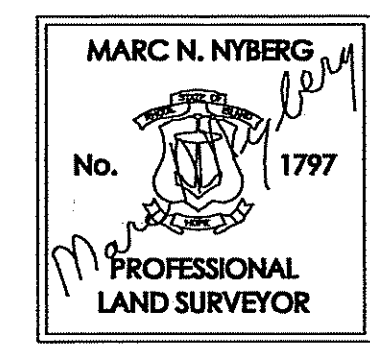

**Marc N. Nyberg Associates, Inc.**  
Land Surveyors  
Planners  
501 Great Road  
Unit 104  
North Smithfield, RI 02896  
Tel: (401) 762-2870  
Fax: (401) 762-2871  
Email: mail@marcnyberg.com

JUN 12 2018