

# INDEX OF DRAWINGS

## ENVIRONMENTAL SUBMISSION

SHEET NO.	DESCRIPTION
1	COVER SHEET
2	STANDARD PLAN SYMBOLS & STANDARD LEGEND
3	STANDARD NOTES - 1
4	STANDARD NOTES - 2
5	JOB SPECIFIC PLAN SYMBOLS, LEGEND AND NOTES
6-7	TYPICAL SECTIONS NO. 1-2
8	BRIDGE TYPICAL SECTIONS
9	KEY PLAN
10-12	GENERAL PLANS NO. 1-3
13	BRIDGE GENERAL PLAN
14-16	DRAINAGE PLANS NO. 1-3
17-18	DRAINAGE DETAILS NO. 1-2
19-21	WATERSHED MAPS NO. 1-3
22	PROFILES
23-24	BORING LOGS
25-26	CROSS SECTIONS

STATE OF RHODE ISLAND

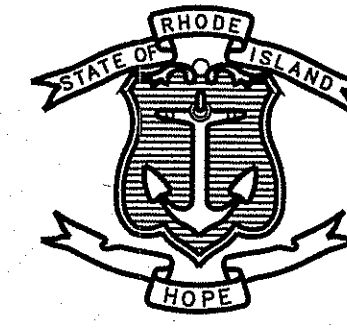

# DEPARTMENT OF TRANSPORTATION

PLAN, PROFILES AND SECTIONS OF PROPOSED

## BRIDGE REHABILITATION

# SUPERSTRUCTURE REPLACEMENT OF WOONASQUATUCKET RIVER BRIDGE No. 604

## ENVIRONMENTAL SUBMISSION

CITY OF PROVIDENCE, RHODE ISLAND  
PROVIDENCE COUNTY

R.I. CONTRACT NO. 2018-DB-006 F.A. PROJECT NO. BRO-0604 (001)  
PROJECT LENGTH = 0.25 MILES

FED. ROAD DIV. NO.	STATE	FEDERAL AID PROJECT NO.	FISCAL YEAR	SHEET NO.	TOTAL SHEETS
1	RI	BRO-0604 (001)	2018	1	26

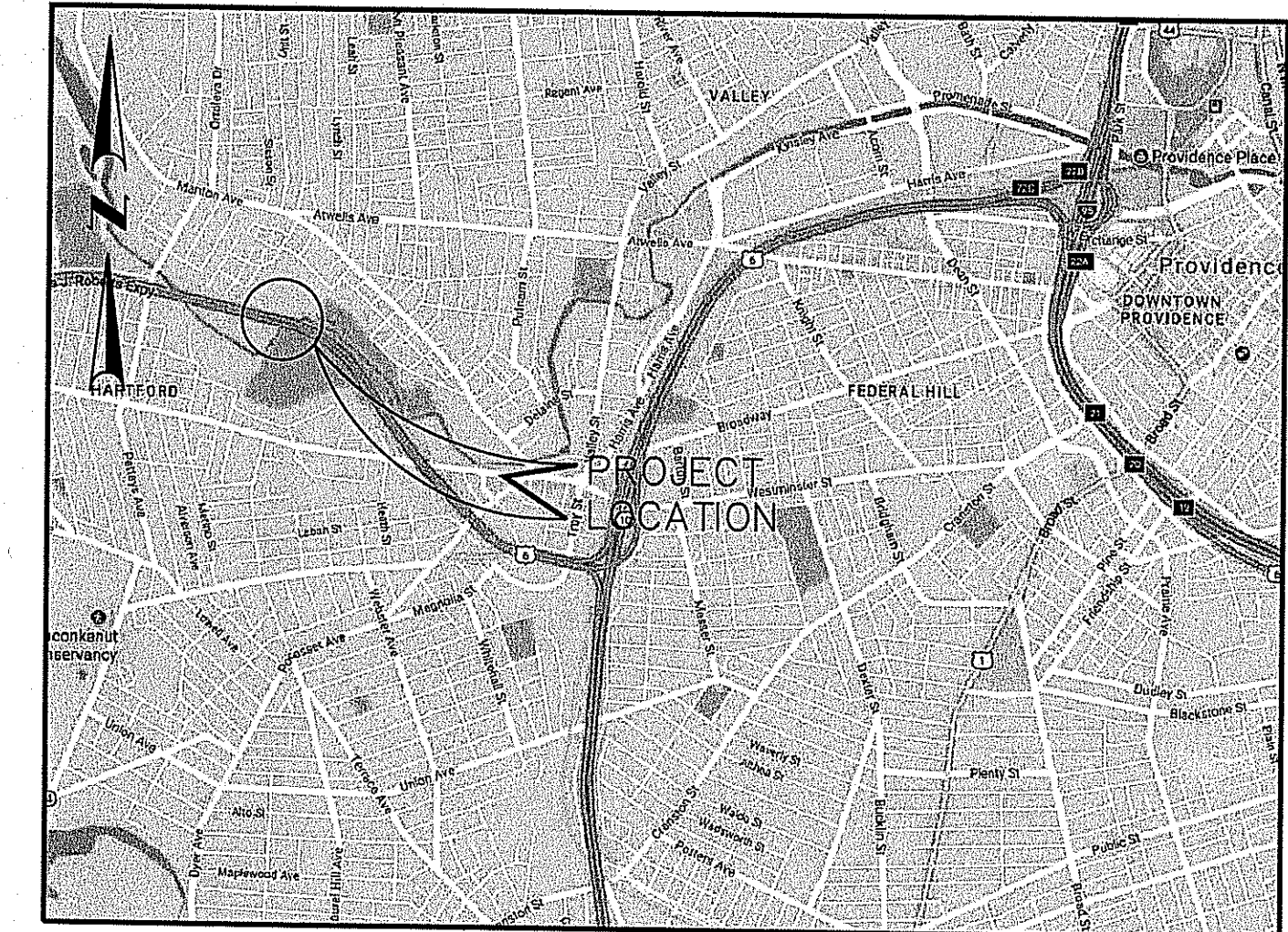

LOCATION MAP

Environmental Management  
JAN 31 2019  
Office of Water Resources

DESIGN	DESIGNATIONS
AADT (2016)	58,200 V.P.D.
D	54%
K	7.6%
T	4.2%
DDHV	2,400 V.P.H.
DHV	4,400 V.P.H.
DESIGN SPEED	60 M.P.H.

**HURRICANE EVACUATION ROUTE**  
THIS PROJECT IS LOCATED ON A HURRICANE EVACUATION AND DIVERSIONARY ROUTE. THE CONTRACTOR SHALL REFER TO THE STANDARD NOTE - 1 (NOTE 18).

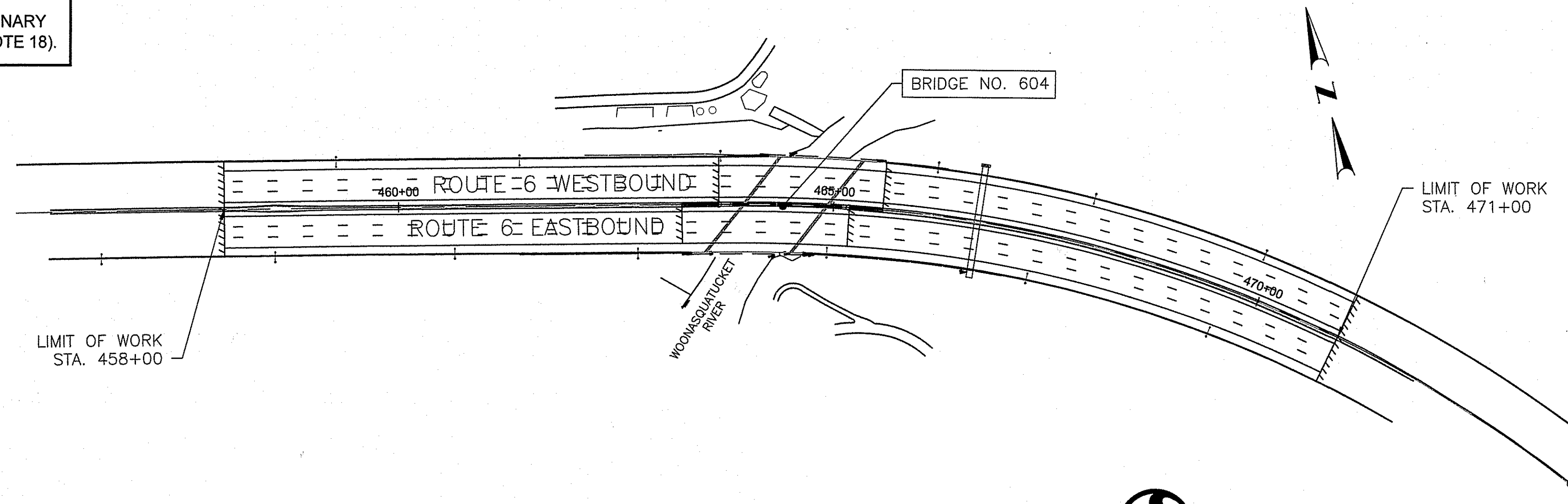

LAYOUT PLAN  
SCALE: 1"=100'

BASE OF LEVELS  
NAVD 1988 VERTICAL  
RI PLANE COORDINATE SYSTEM  
NAD 1983 HORIZONTAL



260 WEST EXCHANGE STREET, SUITE 001  
PROVIDENCE, RI 02903



Contract Number	2018-DB-006
Volume Number	1
Number of Sheet	1
Total Sheets	26

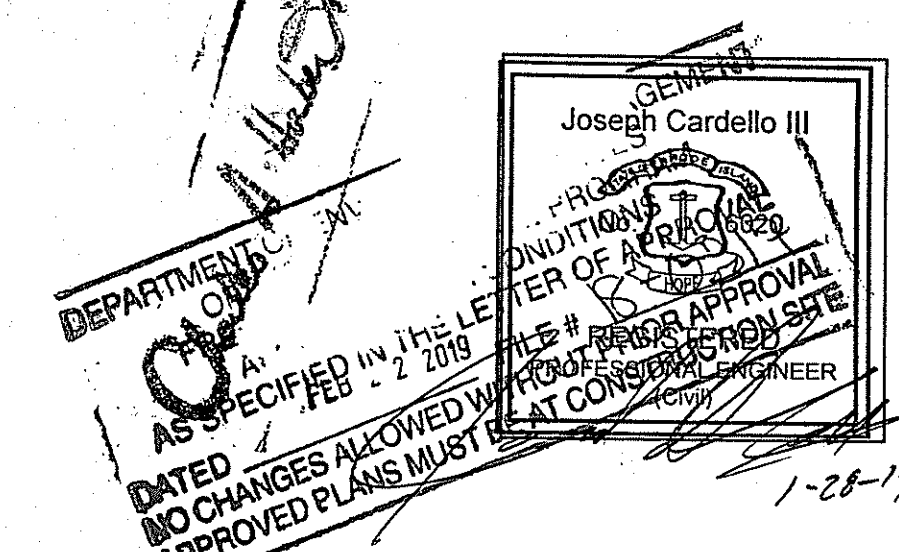

ENVIRONMENTAL PLAN SUBMISSION  
ORIGINAL: NOVEMBER 30, 2018  
REVISED: JANUARY 28, 2019

R.I. DEPARTMENT OF TRANSPORTATION	
APPROVED	
ADMINISTRATOR, PROJECT MANAGEMENT	DATE
APPROVED	
CHIEF ENGINEER OF INFRASTRUCTURE	DATE
APPROVED	
DIRECTOR	DATE
US DEPARTMENT OF TRANSPORTATION FEDERAL HIGHWAY ADMINISTRATION	
APPROVED	
DIVISION ADMINISTRATOR	DATE

R.I. STANDARD SPECIFICATIONS AND STANDARD DETAILS  
SPECIFICATIONS TO GOVERN THIS PROJECT ARE THE R.I. STANDARD SPECIFICATIONS FOR ROAD AND BRIDGE CONSTRUCTION, AMENDED 2013, WITH ALL REVISIONS, AND THE STATE AND FEDERAL SPECIAL PROVISIONS INCLUDED IN THE CONTRACT DOCUMENTS. STANDARD DETAILS FOR THIS PROJECT ARE R.I. STANDARD DETAILS, 1998 EDITION, WITH ALL REVISIONS.

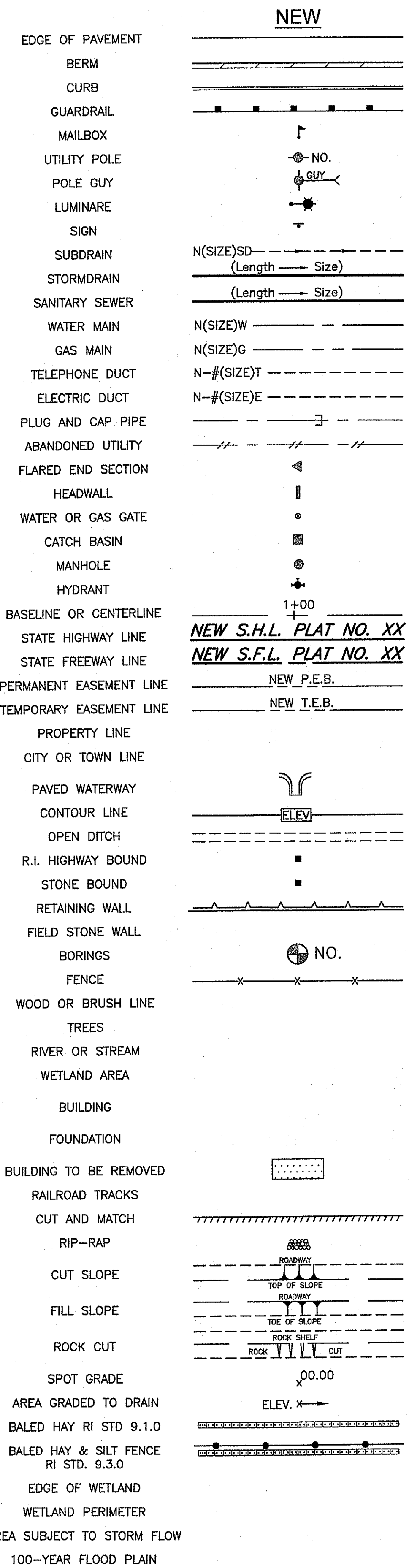
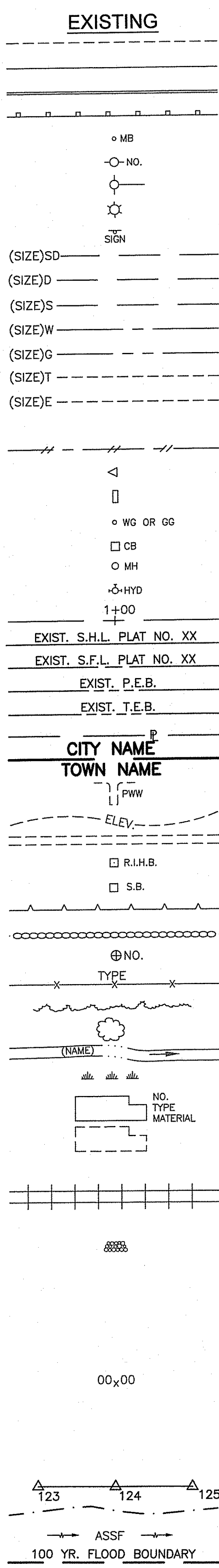

1.1.0	UNDERDRAIN
1.3.0	CONCRETE CONNECTING COLLAR
2.1.0	CONCRETE HEADWALLS FOR PIPE CULVERTS
2.2.0	STANDARD HEADWALLS FOR MULTIPLE 3'-6" TO 7'-0" PIPE CULVERTS
2.3.0 (DIA.)	PRECAST CONCRETE FLARED END SECTION
3.2.0	BRICK/SOLID BLOCK 4'-0" ROUND MANHOLE
3.2.1 (DIA.)	BRICK/SOLID BLOCK 5'-0" OR 6'-0" ROUND MANHOLE
3.3.0	BRICK/SOLID BLOCK TYPE "D" SQUARE CATCH BASIN
3.3.2	BRICK/SOLID BLOCK TYPE "F" SQUARE CATCH BASIN
3.3.3	SOLID BLOCK FLUSH SQUARE CATCH BASIN
3.4.0	BRICK/SOLID BLOCK TYPE "D" ROUND CATCH BASIN
3.4.1	BRICK/SOLID BLOCK ROUND CATCH BASIN WITH GUTTER INLET
3.4.2	BRICK/SOLID BLOCK TYPE "F" ROUND CATCH BASIN
3.4.3	BRICK/SOLID BLOCK TYPE "R" CATCH BASIN
3.4.4	SOLID BLOCK FLUSH ROUND CATCH BASIN
3.4.5 (DIA.)	BRICK/SOLID BLOCK 5'-0" OR 6'-0" ROUND CATCH BASIN
3.5.0	SOLID BLOCK SHALLOW TYPE "F" SQUARE CATCH BASIN
3.5.1 (SIZE)	SOLID BLOCK SHALLOW 5'-0" OR 6'-0" SQUARE CATCH BASIN
3.6.0	BRICK/SOLID BLOCK DROP INLET
3.7.0 (DIA.)	BRICK/SOLID BLOCK ROUND MANHOLE OR CATCH BASIN GREATER THAN 12'-0"
4.2.0	PRECAST 4'-0" ROUND MANHOLE
4.2.1	PRECAST 5'-0" ROUND MANHOLE
4.2.2	PRECAST 6'-0" ROUND MANHOLE
4.3.0 (SIZE)	PRECAST 4'-0" OR 6'-0" SQUARE MANHOLE OR CATCH BASIN
4.4.0 (DIA.)	PRECAST 4'-0", 5'-0", OR 6'-0" ROUND CATCH BASIN
4.5.0	PRECAST CONCRETE DROP INLET
4.5.1	PRECAST CONCRETE DROP INLET LATERAL OUTLET
4.5.2	PRECAST CONCRETE DROP INLET LONGITUDINAL OUTLET
5.3.0	CATCH BASIN AND MANHOLE STEP
5.4.0	CONCRETE COLLARS
6.1.0	LIGHT-DUTY SQUARE FRAME AND ROUND COVER
6.1.1	HEAVY DUTY SQUARE FRAME AND ROUND COVER
6.2.0	LIGHT-DUTY ROUND FRAME AND COVER
6.2.1	HEAVY-DUTY ROUND FRAME AND COVER
6.3.0	SQUARE FRAME AND GRATE
6.3.1	SQUARE FRAME AND GRATE
6.3.2	SQUARE FRAME AND GRATE (BICYCLE SAFE)
6.3.3	HIGH CAPACITY FRAME AND GRATE
6.3.4	HIGH CAPACITY FRAME AND GRATE (BICYCLE SAFE)
6.4.0	ROUND FRAME AND GRATE
7.1.0S	PRECAST CONCRETE CURB (STRAIGHT)
7.1.0C	PRECAST CONCRETE CURB (CIRCULAR)
7.1.1	3'-0" PRECAST CONCRETE TRANSITION CURB
7.1.2	6'-0" PRECAST CONCRETE TRANSITION CURB
7.1.4	PRECAST 2'-0" RADIUS CORNER
7.1.5	PRECAST CONCRETE INLET STONE (FOR SQUARE CATCH BASIN)
7.1.6	PRECAST CONCRETE INLET STONE (FOR ROUND CATCH BASIN)
7.1.7	PRECAST CONCRETE APRON STONE (FOR SQUARE CATCH BASIN)
7.1.8	PRECAST CONCRETE APRON STONE (FOR ROUND CATCH BASIN)
7.2.0S	PRECAST CONCRETE SLOPED FACE CURB (STRAIGHT)
7.2.0C	PRECAST CONCRETE SLOPED FACE CURB (CIRCULAR)
7.2.1	PRECAST CONCRETE SLOPED FACE TRANSITION CURB
7.2.2	PRECAST CONCRETE TRANSITION CURB (VERTICAL FACE TO SLOPED FACE)
7.3.0S	GRANITE CURB (STRAIGHT)
7.3.0C	GRANITE CURB (CIRCULAR)
7.3.1	3'-0" GRANITE TRANSITION CURB
7.3.2	6'-0" GRANITE TRANSITION CURB
7.3.3	GRANITE WHEELCHAIR RAMP TRANSITION CURB
7.3.4	GRANITE 2'-0" RADIUS CORNER
7.3.5	GRANITE INLET STONE (FOR SQUARE CATCH BASIN)
7.3.6	GRANITE INLET STONE (FOR ROUND CATCH BASIN)
7.3.7	GRANITE APRON STONE (FOR SQUARE CATCH BASIN)
7.3.8	GRANITE APRON STONE (FOR ROUND CATCH BASIN)
7.4.0	GRANITE SLOPED FACE CURB
7.4.1	GRANITE SLOPED FACE TRANSITION CURB

7.4.2	GRANITE TRANSITION CURB (VERTICAL FACE TO SLOPE FACE)
7.5.0	BITUMINOUS CONCRETE LIP CURB
7.5.1A	BITUMINOUS BERM (CONSTRUCTION METHOD A)
7.5.1B	BITUMINOUS BERM (CONSTRUCTION METHOD B)
7.6.0	CURB SETTING DETAIL
8.2.0	BITUMINOUS CONCRETE DITCH
8.3.0	RIP-RAP DITCH
8.4.0	PAVED WATERWAY
9.1.0	BALED HAY EROSION CHECK
9.2.0	SILT FENCE DETAIL
9.3.0	BALED HAY DITCH EROSION CHECK AND SILT FENCE COMBINED
9.4.0	BALED HAY DITCH AND SWALE EROSION CHECK
9.5.0	LOG AND HAY CHECK DAM
9.7.0	DEWATERING BASIN
9.8.0	BALED HAY CATCH BASIN INLET PROTECTION
9.9.0	CONSTRUCTION ACCESS
10.1.0	WET STONE MASONRY RETAINING WALL
10.2.0	RUBBLE MASONRY WALL
10.3.0	CONCRETE RETAINING WALL
10.4.0	STONE MASONRY STEPS
14.1.0	CONCRETE HIGHWAY BOUND
15.1.0	POST AND MOUNTINGS FOR RURAL MAILBOX
15.2.0 (NO.)	POST AND MULTIPLE MOUNTINGS FOR RURAL MAILBOXES
18.2.0	PRECAST TYPE "A" HANDHOLE
18.2.2	HEAVY DUTY TYPE "H" HANDHOLE
18.3.0	ALUMINUM LIGHTING STANDARDS
20.2.0	BI-DIRECTIONAL CONTROL DEVICE
24.6.1	STREET SIGN MOUNTING DETAIL
26.2.0	POLYETHYLENE DRUM WITH MARKINGS
26.3.0	PVC PLASTIC PIPE TYPE III BARRICADE
31.1.0	CHAIN LINK FENCE 3'-0" TO 4'-0"
31.2.0	CHAIN LINK FENCE 5'-0" TO 6'-0"
31.2.1	CHAIN LINK FENCE 5'-0" TO 6'-0" INTERMEDIATE POST
31.3.0	WOVEN WIRE RIGHT-OF-WAY FENCE (STEEL POST)
34.1.0	TYPICAL GUARDRAIL INSTALLATION
34.2.0	STEEL BEAM GUARDRAIL
34.2.1	STEEL BEAM GUARDRAIL DETAILS
34.2.2	STEEL BEAM GUARDRAIL DOUBLE FACED ASSEMBLY
34.2.3	STEEL BEAM GUARDRAIL FIXTURES
34.2.5	STEEL BEAM GUARDRAIL REFLECTORIZED TRIANGULAR DELINEATOR
34.3.1	GUARDRAIL END SECTION
34.3.2	TERMINAL END SECTION (SINGLE FACE)
34.3.3	ANCHORAGE DETAILS APPROACH END SECTION
34.3.4	ANCHORAGE DETAILS TRAILING END SECTION
34.4.0	STEEL BACKED TIMBER GUARDRAIL
34.4.1	STEEL BACKED TIMBER GUARDRAIL TERMINAL SECTION-TYPE 1
40.1.0	DOUBLE-FACED PRECAST MEDIAN BARRIER
40.2.0	SINGLE-FACED PRECAST MEDIAN BARRIER
40.2.1	SINGLE-FACED PRECAST MEDIAN BARRIER
40.3.0	PRECAST MEDIAN BARRIER TRANSITION UNIT
40.5.0	PRECAST MEDIAN BARRIER FOR TEMPORARY TRAFFIC CONTROL
43.1.0	CEMENT CONCRETE SIDEWALK
43.2.0	BITUMINOUS CONCRETE SIDEWALK
43.3.0	WHEELCHAIR RAMP
43.3.1	WHEELCHAIR RAMP FOR LIMITED RIGHT-OF-WAY AREAS
43.4.0	DRIVEWAY DEVELOPMENT FOR 3'-0" TRANSITION CURB
43.4.1	DRIVEWAY DEVELOPMENT FOR 6'-0" TRANSITION CURB
43.5.0	CEMENT CONCRETE DRIVEWAYS
48.1.0	DETECTABLE WARNING SYSTEM
51.1.0	TREE PROTECTION DEVICE
51.1.1	DRIP LINE TREE PROTECTION DEVICE FOR EXISTING TREES
51.2.0	SHRUB PROTECTION DEVICE
51.3.0	TREE WELL
51.4.0	TREE WALL

AB	ADJUST CATCH BASIN TO GRADE
ABM	ADJUST CATCH BASIN TO MANHOLE
AC	ADJUST CURB STOP TO GRADE
AD	ADJUST DRAINAGE MANHOLE TO GRADE
AE	ADJUST ELECTRIC MANHOLE TO GRADE
AF	ADJUST FRAME AND COVER TO GRADE
AFG	ADJUST FRAME AND GRATE TO GRADE
AG	ADJUST GAS GATE BOX TO GRADE
AHH	ADJUST HANDHOLE TO GRADE
AS	ADJUST SANITARY SEWER MANHOLE TO GRADE
AT	ADJUST TELEPHONE MANHOLE TO GRADE
AW	ADJUST WATER GATE BOX TO GRADE
BCD	BITUMINOUS CONCRETE DRIVEWAY 3" BITUMINOUS CONCRETE TYPE I-2 8" GRAVEL BORROW SUBBASE COURSE
BPS	BUILD NEW STRUCTURE OVER EXISTING PIPE
CCB	CLEAN CATCH BASIN
CCP	CUT AND CAP PIPE WITH RESTRAINT (ALL SIZES)
CFP	CLEAN AND FLUSH PIPE
CG	CLEARING AND GRUBBING
CMH	CLEAN MANHOLE
CP	(DEPTH) COLD PLANE
CPP	CUT AND PLUG PIPE (ALL TYPES, ALL SIZES)
DB	REMOVE AND DISPOSE BITUMINOUS CURB
DC	REMOVE AND DISPOSE CONCRETE CURB
DCB	REMOVE AND DISPOSE CATCH BASIN
DDI	REMOVE AND DISPOSE DROP INLET
DF	REMOVE AND DISPOSE FENCE
DFC	REMOVE AND DISPOSE FRAME AND COVER
DFE	REMOVE AND DISPOSE FLARED END SECTION
DFG	REMOVE AND DISPOSE FRAME AND GRATE
DFH	REMOVE AND DISPOSE FIRE HYDRANT
DFP	REMOVE AND DISPOSE FLEXIBLE PAVEMENT
DG	REMOVE AND DISPOSE GUARDRAIL
DH	REMOVE AND DISPOSE HEADWALL
DHB	REMOVE AND DISPOSE HIGHWAY BOUND
DHH	REMOVE AND DISPOSE HANDHOLE
DL	REMOVE AND DISPOSE LIGHT AND FOUNDATION
DMB	REMOVE AND DISPOSE MEDIAN BARRIER
DMH	REMOVE AND DISPOSE MANHOLE
DMM	REMOVE AND DISPOSE MEDIAN MARKER
DOW	REMOVE AND DISPOSE OBSERVATION WELL
DP	REMOVE AND DISPOSE PIPE
DPB	REMOVE AND DISPOSE PAVEMENT AND RIGID BASE
DRB	REMOVE AND DISPOSE RIGID BASE
DS	REMOVE AND DISPOSE SIGN
DSS	REMOVE AND DISPOSE TRAFFIC SIGNAL SYSTEM
DSW	REMOVE AND DISPOSE SIDEWALK
DTD	REMOVE AND DISPOSE TELEPHONE DUCT BANKS
DUP	REMOVE AND DISPOSE UTILITY POLE
DWW	REMOVE AND DISPOSE PAVED WATERWAY
FF	FILTER FABRIC RIPRAP FLARED END UNDERLAYMENT
GET	FLARED GUARDRAIL END TREATMENT
IA	IMPACT ATTENUATOR
IDL	IMPERVIOUS DITCH LINER

LOD	LIMIT OF DISTURBANCE
LOR	LIMIT OF REGRADING
LS	4" LOAM AND SEED
NFH	NEW FIRE HYDRANT WITH GATE VALVE
NIC	NOT IN THIS CONSTRUCTION CONTRACT
NWB	FURNISH AND INSTALL NEW WATER GATE VALVE BOX
NWVB	FURNISH AND INSTALL NEW WATER GATE VALVE AND BOX
NWCB	FURNISH AND INSTALL NEW WATER CURB STOP BOX
NWSB	FURNISH AND INSTALL NEW WATER CURB STOP AND BOX
PCD	PERMANENT CHECK DAM
PS	4" PLANTABLE SOIL AND SEED
RCB	RECONSTRUCT TYPE "D" CATCH BASIN, TO CATCH BASIN WITH GUTTER INLET
RCM	R.I.D.O.T. COMMUNICATIONS MANHOLE
RHH	REMOVE, HANDLE, HAUL, TRIM, RESET CURB EDGING, STRAIGHT, CIRCULAR (ALL TYPES)
RLP	RELOCATE LAMP POST
RMB	RELOCATE MAILBOX (BY OTHERS)
RPM	REMOVE PAVEMENT MARKINGS
RRP	RIP-RAP PAD (SEE DETAIL)
RRS	REMOVE AND RELOCATE SIGN
RUP	RELOCATE UTILITY POLE (BY OTHERS)
SB	STONE BAFFLE
SBAE	STEEL BEAM BRIDGE CONNECTION APPROACH END (W/O NESTED RAIL)
SBTE	STEEL BEAM BRIDGE CONNECTION TRAILING END (W/NESTED RAIL)
SD	STRUCTURAL DISPOSITION - SEE CS PAGES OF SPECIFICATION
SF	REMOVE AND STOCKPILE FENCE
SGA	SPECIAL GRADED AGGREGATE
SGC	REMOVE AND STOCKPILE GRANITE CURB
SGR	REMOVE AND STOCKPILE GUARDRAIL
SH	REMOVE AND STOCKPILE HYDRANT
SS	REMOVE AND STOCKPILE SIGN
STS	REMOVE AND STOCKPILE TRAFFIC SIGNAL SYSTEM
TB	CONCRETE THRUST BLOCK
TEP	TIE EXISTING PIPE INTO NEW STRUCTURE
TNP	TIE NEW PIPE INTO EXISTING STRUCTURE
TBT	THREE BEAM TRANSITION
TBBC	THREE BEAM BRIDGE CONNECTION
TT	TREE TRIMMING
WCM	4" WOOD CHIP MULCH
4DY	4" EPOXY RESIN PAVEMENT MARKINGS - DOUBLE YELLOW
6W	6" EPOXY RESIN PAVEMENT MARKINGS - WHITE
12W	12" EPOXY RESIN PAVEMENT MARKINGS - WHITE
6WT	6" PREFORMED PATTERNED MARKING (HIGH PERFORMANCE TAPE)
4YT	4" EPOXY RESIN PAVEMENT MARKINGS - YELLOW
6YT	6" EPOXY RESIN PAVEMENT MARKINGS - YELLOW
P.G.L.	PROFILE GRADE

Environmental Management  
JAN 31 2019  
Office of Water Resources

AS SPECIFIED IN THE LETTER OF APPROVAL  
FRESHWATER WETLANDS PROGRAM  
APPROVED WITH CONDITIONS  
NO CHANGES ALLOWED WITHOUT PRIOR APPROVAL  
APPROVED FOR SUBMISSION  
NOVEMBER 30, 2018  
NOT FOR CONSTRUCTION

**Stantec**  
260 WEST EXCHANGE STREET, SUITE 001  
PROVIDENCE, RI 02903

**Manafort Brothers Incorporated**  
414 New Britain Ave, Plainville, Connecticut 06062 • 860.229.4853

**Steere ENGINEERING INC**

REVISIONS		
NO.	DATE	BY
1	6/07	TRB

RHODE ISLAND  
DEPARTMENT OF TRANSPORTATION

BRIDGE REHABILITATION  
WOONASQUATUCKET RIVER  
BRIDGE No. 604  
PROVIDENCE, RHODE ISLAND

STANDARD PLAN SYMBOLS & STANDARD LEGEND

CHECKED BY \_\_\_\_\_ DATE 11/18 SCALE NO SCALE

FED. ROAD DIV. NO.	STATE	FEDERAL AID PROJECT NO.	FISCAL YEAR	SHEET NO.	TOTAL SHEETS
1	RI	2018-DB-06	2019	3	26

**GENERAL NOTES:**

- ANY DAMAGE TO EXISTING PAVEMENT, BRIDGES, CONDUIT, SIDEWALK, FENCES, ETC., CAUSED BY THE CONTRACTOR SHALL BE REPAIRED BY THE CONTRACTOR AT NO ADDITIONAL COST TO THE STATE.
- THE CONTRACTOR SHALL PLACE ALL EQUIPMENT AND MATERIAL AS FAR AWAY AS POSSIBLE FROM THE EDGE OF THE TRAVEL LANE SO AS NOT TO CAUSE A SAFETY HAZARD, IN ACCORDANCE WITH SECTION 106.06 OF THE R.I.D.O.T. STANDARD SPECIFICATION, LATEST EDITION.
- IT IS THE CONTRACTOR'S RESPONSIBILITY TO ENSURE THAT THE EXISTING CONDITIONS ARE NOT OBLITERATED BEFORE CONTROL POINTS ARE LOCATED AND CONSTRUCTION LAYOUT IS ESTABLISHED. THE CONSTRUCTION LAYOUT SHALL BE PROVIDED IN SUFFICIENT DETAIL, THEREBY ENABLING HIM TO CONSTRUCT THE PROJECT IN CONFORMITY WITH THE PLANS AND SPECIFICATIONS. SURVEY WILL BE PROVIDED BY THE CONTRACTOR. THE RESIDENT ENGINEER WILL NOT AUTHORIZE CONSTRUCTION ACTIVITIES TO BEGIN UNTIL HE IS SATISFIED THAT ALL GROUND CONTROL HAS BEEN ESTABLISHED, TIED DOWN, AND DULY RECORDED IN STANDARD FIELD BOOKS.
- ALL R.I. STD. 9.9.0 CONSTRUCTION ACCESS ROADS SHALL BE CONSTRUCTED PRIOR TO ANY ROADWAY ACCEPTING CONSTRUCTION TRAFFIC.
- THE FREQUENCY AND APPLICATION RATES FOR THE DUST CONTROL ITEMS WILL BE AS DIRECTED BY THE ENGINEER.
- ALL SIDEWALK AND DRIVEWAYS DESIGNATED FOR REPLACEMENT SHALL BE CUT AND MATCHED AT LOCATIONS SHOWN ON THE PLANS OR AS DIRECTED BY THE ENGINEER.
- ASPHALT EMULSION TACK COAT SHALL BE PLACED PRIOR TO PAVEMENT PLACEMENT ON THE CONCRETE BASE OR COLD PLANED PAVEMENT, AND ON ANY NEW COURSE WHICH HAS BEEN OPEN TO TRAFFIC, OR ANY NEW COURSE WHICH HAS BEEN EXPOSED FOR MORE THAN 3 DAYS, AND/OR AS DIRECTED BY THE ENGINEER. IT SHALL ALSO BE APPLIED TO VERTICAL PAVEMENT FACES BETWEEN ADJOINING PAVEMENT SECTIONS. ALL APPLICATIONS ON BOTH HORIZONTAL AND VERTICAL SURFACES SHALL BE PAID FOR UNDER THE CONTRACT UNIT BID PRICE FOR CODE 403.0300 "ASPHALT EMULSION TACK COAT."
- THE LIMITS OF CLEARING AND SURFACE DISTURBANCE MUST BE STRICTLY ADHERED TO IN ALL AREAS. IN ADDITION TO THOSE AREAS SPECIFICALLY DESIGNATED ON THE PLANS, THE CONTRACTOR WILL BE RESPONSIBLE FOR PROVIDING AND PLACING, AT HIS OWN EXPENSE, PLANTABLE SOIL AND SEED IN AREAS WHICH ARE OUTSIDE OF THE PROJECT'S AREAS OF DISTURBANCE AND WHICH ARE IMPACTED BY CONSTRUCTION OPERATIONS INCLUDING THOSE AREAS WHERE VEHICLES, EQUIPMENT AND MATERIALS ARE STORED WITH THE PERMISSION OF THE ENGINEER.
- UNDER NO CIRCUMSTANCE WILL THE CONTRACTOR BE ALLOWED TO STOCKPILE REMOVED PAVEMENT MATERIALS WITHIN THE PROJECT LIMITS.
- CLEANING AND SWEEPING OF PAVEMENT WILL INCLUDE REMOVAL OF ALL PAVEMENT DEBRIS PRIOR TO THE PLACEMENT OF EACH BITUMINOUS PAVEMENT LIFT. ALL CLEANING AND SWEEPING SHALL BE DONE TO THE SATISFACTION OF THE ENGINEER.
- PRIOR TO INSTALLATION, ALL SIGNS, MOUNTINGS AND LOCATIONS SHALL BE APPROVED OR MODIFIED BY THE ENGINEER.
- THE COORDINATE SYSTEM, IF SHOWN, IS THE RHODE ISLAND STATE PLANE COORDINATE SYSTEM.
- PAVEMENT OPERATIONS FOR CURBED SECTIONS: IN AREAS WHERE CURBING IS SET TO FINISH LINE AND GRADE, THE CONTRACTOR WILL NOT BE REQUIRED TO UTILIZE THE SENSOR AND SKY-TYPE DEVICE FOR AUTOMATIC GRADE CONTROL, BUT WILL BE ALLOWED TO MANUALLY ADJUST THE BITUMINOUS PAVER FOR CONTROLLING GRADE.
- THE CONTRACTOR SHALL BE RESPONSIBLE FOR MAINTAINING ALL ROADWAYS FREE OF DEBRIS RESULTING FROM THEIR CONSTRUCTION OPERATIONS. ALL DEBRIS SHALL BE REMOVED TO THE SATISFACTION OF THE ENGINEER AT NO ADDITIONAL COST TO THE STATE.
- NO FUEL STORAGE, VEHICLE REFUELING, OR EQUIPMENT STORAGE SHALL TAKE PLACE IN DESIGNATED WETLANDS, NOR WITHIN 100' OF ANY WATER BODY. THIS REQUIREMENT SHALL NOT SUPERSEDE ANY FEDERAL, STATE OR LOCAL LAW, ORDINANCE, RULE OR REGULATION THAT APPLIES TO THE SAME, UNLESS THIS REQUIREMENT IS MORE STRINGENT THAN SAID LAW, ORDINANCE, RULE OR REGULATION.
- THE CONTRACTOR SHALL BE RESPONSIBLE TO ENSURE THAT AT THE END OF FINAL PAVING OPERATIONS, FLOW TO EXISTING DRAINAGE STRUCTURES HAS BEEN REESTABLISHED AND THAT NO ISOLATED DEPRESSIONS REMAIN. THERE SHALL BE NO SEPARATE PAYMENT FOR THIS PROVISION; IT SHALL BE CONSIDERED INCIDENTAL TO PAVING AND COLD PLANING OPERATIONS.
- ALL EMBANKMENTS SHALL BE PLACED IN HORIZONTAL LAYERS NOT EXCEEDING 12" (AFTER COMPACTION) AND SHALL BE COMPACTED AS SPECIFIED BEFORE THE NEXT LAYER IS PLACED. ALSO, EMBANKMENT CONSTRUCTION SHALL CONFORM TO SECTION 202.03.2 OF THE R.I.D.O.T. STANDARD SPECIFICATIONS, LATEST EDITION.
- IF THIS PROJECT IS ON A HURRICANE EVACUATION AND DIVERSIONARY ROUTE, AS DESIGNATED ON THE COVERSHEET, THE CONTRACTOR IS ADVISED THAT UPON 12 (TWELVE) HOURS NOTICE THE ROADWAY SHALL BE OPEN TO EVACUEES AND EMERGENCY PERSONNEL. ANY EXTRA WORK NECESSARY TO COMPLY WITH THIS REQUIREMENT WILL BE REIMBURSED UNDER FORCE ACCOUNT PROCEDURES.
- THE CONTRACTOR SHALL READ, BECOME FAMILIAR WITH, AND ADHERE TO ALL OF THE PROVISIONS, CONDITIONS, AND STIPULATIONS STATED IN THE ENVIRONMENTAL APPROVALS ISSUED FOR THE PROJECT FROM THE DEPARTMENT OF ENVIRONMENTAL MANAGEMENT (RIDEM), AND/OR THE ARMY CORPS OF ENGINEERS (ACOE), AND/OR THE COASTAL RESOURCES MANAGEMENT COUNCIL (CRMC). COPIES OF EACH OF THESE PERMITS ARE INCLUDED IN THE CS PAGES OF THE CONTRACT DOCUMENTS. ALL COSTS ASSOCIATED WITH THESE CONDITIONS SHALL BE CONSIDERED INCIDENTAL TO THE CONSTRUCTION AND INCLUDED WITH THE COST FOR THE ASSOCIATED BID ITEM(S).
- FOR ALL PROJECTS INVOLVING KNOWN SITE REMEDIATION ISSUES, THE CONTRACTOR SHALL READ, BECOME FAMILIAR WITH, AND ADHERE TO ALL OF THE CONSTRUCTION RELATED PROVISIONS, CONDITIONS, AND STIPULATIONS OF ANY REMEDIAL PLANS DEVELOPED FOR THE PROJECT. COPIES OF THESE DOCUMENTS ARE INCLUDED IN THE CS PAGES OF THE CONTRACT DOCUMENTS. ALL COSTS ASSOCIATED WITH COMPLIANCE WITH THESE DOCUMENTS SHALL BE CONSIDERED INCIDENTAL TO THE CONSTRUCTION AND INCLUDED WITH THE COST FOR THE ASSOCIATED BID ITEM(S).
- NO UNPROTECTED CONSTRUCTED FEATURE MAY PROJECT MORE THAN 4 INCHES ABOVE THE FINISHED GRADE OF A TRAVERSABLE SLOPE IN A CLEAR ZONE, e.g. HEADWALL, DRAINAGE INLET, ETC.
- THE REMAINING SECTION OR STUB OF A BREAKAWAY BASE MAY NOT PROJECT MORE THAN 4 INCHES ABOVE THE FINISHED GRADE OF A TRAVERSABLE SLOPE IN A CLEAR ZONE, e.g. SIGN POSTS, LIGHT POLES, FIRE HYDRANTS, ETC.

**DRAINAGE AND EROSION CONTROL NOTES:**

- FOR ALL PROJECTS WITH AT LEAST ONE(1) ACRE OF SOIL DISTURBANCE. R.I.D.O.T. IS REQUIRED TO DEVELOP AND ENFORCE A SITE SPECIFIC STORM WATER POLLUTION PREVENTION PLAN (SWPPP) IN ORDER TO REMAIN IN COMPLIANCE WITH THE RIDDES GENERAL PERMIT FOR STORMWATER DISCHARGES ASSOCIATED WITH CONSTRUCTION ACTIVITIES. THE CONTRACTOR SHALL READ, BECOME FAMILIAR WITH, AND ADHERE TO ALL OF THE PROVISIONS, CONDITIONS, AND STIPULATIONS OF THE GENERAL PERMIT AND THE SITE SPECIFIC SWPPP FOR THIS PROJECT. COPIES OF THESE DOCUMENTS ARE INCLUDED IN THE CS PAGES OF THE CONTRACT DOCUMENTS. ALL COSTS ASSOCIATED WITH ADHERENCE TO THE SWPPP SHALL BE CONSIDERED INCIDENTAL TO THE CONSTRUCTION AND INCLUDED WITH THE COST FOR THE ASSOCIATED BID ITEM(S).
- NO UNDISTURBED AREAS SHALL BE CLEARED OF EXISTING VEGETATION AFTER OCTOBER 15 OF ANY CALENDAR YEAR OR DURING ANY PERIOD OF FULL OR LIMITED WINTER SHUTDOWN. ALL DISTURBED SOILS EXPOSED PRIOR TO OCTOBER 15 OF ANY CALENDAR YEAR SHALL BE SEEDED OR PROTECTED BY THAT DATE. ANY SUCH AREAS THAT DO NOT HAVE ADEQUATE VEGETATIVE STABILIZATION, AS DETERMINED BY THE RESIDENT ENGINEER OR ENVIRONMENTAL INSPECTOR, BY NOVEMBER 15 OF ANY CALENDAR YEAR, MUST BE STABILIZED THROUGH THE USE OF EROSION CONTROL MATTING OR HAY MULCH, IN ACCORDANCE WITH SPECIFICATIONS CONTAINED WITHIN THE R.I. SOIL EROSION AND SEDIMENT CONTROL HANDBOOK. IF WORK CONTINUES WITHIN ANY OF THESE AREAS DURING THE PERIOD FROM OCTOBER 15 THROUGH APRIL 15, CARE MUST BE TAKEN TO ENSURE THAT ONLY THE AREA REQUIRED FOR THAT DAY'S WORK IS EXPOSED, AND ALL ERODIBLE SOIL MUST BE RESTABILIZED WITHIN 5 WORKING DAYS. ANY WORK TO CORRECT PROBLEMS RESULTING FROM FAILURE TO COMPLY WITH THIS PROVISION SHALL BE THE RESPONSIBILITY OF THE CONTRACTOR. THERE WILL BE NO SEPARATE PAYMENT FOR THIS PROVISION, IT SHALL BE CONSIDERED INCIDENTAL TO CONSTRUCTION OPERATIONS. STABILIZATION OF ONE FORM OR ANOTHER AS DESCRIBED ABOVE SHALL BE ACHIEVED WITHIN 2 WEEKS OF FINAL GRADING.
- STOCKPILES OF MATERIAL SHALL NOT BE LOCATED WITHIN REGULATED WETLANDS OR BUFFER ZONE AREAS. THEY SHALL HAVE SIDE SLOPES NO GREATER THAN 30% AND STOCKPILES OF ERODIBLE MATERIAL SHALL ALSO BE SEEDED AND RINGED WITH R.I. STD. 9.1.0 TO STABILIZE.
- IF THE PLANS INCLUDE SPECIFIC AREAS FOR PLACEMENT OF CONSTRUCTION DEWATERING BASINS AND/OR EQUIPMENT AND MATERIALS STORAGE AND STOCKPILING, AND IF THE CONTRACTOR ELECTS TO UTILIZE ANY OTHER AREAS FOR THESE PURPOSES, THIS SHALL BE APPROVED BY THE ENGINEER ONLY AFTER OBTAINING ANY NECESSARY PERMITS AND/OR PERMIT MODIFICATIONS FROM THE APPROPRIATE REGULATORY AUTHORITY(IES). ANY PERMITTING REQUIREMENTS SHALL BE THE RESPONSIBILITY OF THE CONTRACTOR AND SHALL BE ACCOMPLISHED AT NO COST TO THE STATE. THE ENGINEER WILL COORDINATE SUBMISSION OF ANY REQUIRED PERMIT APPLICATION MATERIALS WITH THE R.I.D.O.T. OFFICE OF ENVIRONMENTAL PROGRAMS.
- JUTE MESH SHALL BE USED TO STABILIZE PLANTABLE SOIL AND/OR LOAM IN ALL DITCHES, ON ALL SLOPES ADJACENT TO WETLANDS AND WETLAND PERIMETERS, AND ON ALL SLOPES WITHIN WATER QUALITY BASINS. JUTE MESH IN DITCHES SHALL EXTEND TO AN ELEVATION 2 FEET ABOVE THE BOTTOM OF THE DITCH.
- SEEDING ON ALL SLOPES 3 TO 1 OR STEEPER SHALL CONSIST OF THE FOLLOWING APPLICATIONS UNLESS CHANGED IN THE CONTRACT.
  - SEEDING TYPE I.
  - ADHESIVE MULCH STABILIZER
- UNVEGETATED SLOPES SHALL NOT BE UNATTENDED OR EXPOSED FOR PERIODS IN EXCESS OF 2 WEEKS OR THROUGH THE INACTIVE WINTER SEASON.
- PRIOR TO DRAINAGE AND UTILITY CONSTRUCTION, THE CONTRACTOR IS RESPONSIBLE FOR VERIFYING THE LOCATION (HORIZONTAL AND VERTICAL) OF ALL EXISTING PIPES AND/OR STRUCTURES WHICH ARE TO BE CONNECTED. ANY VARIATION FOUND FROM THE PLANS MUST BE BROUGHT TO THE ENGINEER'S ATTENTION PRIOR TO DRAINAGE AND UTILITY CONSTRUCTION. WORK CAN COMMENCE ONLY UPON THE ENGINEER'S AUTHORIZATION.
- ALL DRAINAGE AND UTILITY STRUCTURES WITHIN THE PAVED ROADWAY SHALL BE ADJUSTED TO GRADE WITH THE SURROUNDING PAVEMENT PRIOR TO THE WINTER SHUTDOWN.
- DURING CONSTRUCTION, THE CONTRACTOR SHALL BE RESPONSIBLE FOR MAINTAINING DRAINAGE AND RUNOFF FLOW DURING STORMS AND PERIODS OF RAINFALL THROUGHOUT THE WORK AREA.
- CATCH BASIN RIM GRADES NOTED ON PLANS ARE DEPRESSED 0.1' LOWER THAN THE GUTTER GRADE. RIM ELEVATIONS SHOWN ARE FINAL GRADES. THE CONTRACTOR SHALL PLACE FRAMES AND GRATES 0.1' BELOW THE GRADE CONSTRUCTED IN THIS CONTRACT OR AS DIRECTED BY THE ENGINEER.
- PROVISIONS FOR CLEARING TO ACCESS OUTFALLS DURING THE CLEANING AND FLUSHING OF THE CLOSED DRAINAGE SYSTEM SHALL BE KEPT TO A MINIMUM.
 

ANY VEGETATIVE CLEARING SHALL BE LIMITED TO BRUSH AND TREES LESS THAN 3" DIAMETER.

NO HEAVY EQUIPMENT MAY ENCRONCH UPON VEGETATED PERIMETER OR RIVERBANK WETLANDS AS WELL AS BIOLOGICAL WETLANDS.
- THE CONTRACTOR SHALL INSTALL ALL EROSION CONTROL DEVICES FOR OUTLET PROTECTION PRIOR TO CLEANING AND FLUSHING STORM WATER DRAINAGE. EROSION CONTROL DEVICES SHALL REMAIN IN PLACE UNTIL ALL FLUSHED SEDIMENTS ARE REMOVED. AT ALL OUTFALL LOCATIONS WHERE PIPES ARE TO BE CLEANED AND FLUSHED, OUTLET PROTECTION (R.I. STD. 9.1.0 OR 9.3.0) SHALL BE INSTALLED TO TRAP SEDIMENTS. THESE SEDIMENTS SHALL THEN BE REMOVED AND DISPOSED OF LEGALLY BEFORE THE OUTLET PROTECTION DEVICES ARE REMOVED. IF OUTLET PROTECTION AT THE OUTFALL IS NOT FEASIBLE, THEN THE OUTLET PIPE OF THE LAST DRAINAGE STRUCTURE TO BE CLEANED SHALL BE PLUGGED TO CAPTURE ALL MATERIALS FLUSHED FROM PIPES. AFTER THE MATERIALS ARE REMOVED FROM THE DRAINAGE STRUCTURE, THE OUTLET SHALL BE UNPLUGGED TO RESUME NORMAL FUNCTIONING.
- R.I. STD. 9.8.0 BALED HAY INLET PROTECTION SHALL BE INSTALLED AT ALL CATCH BASINS AND INLETS WHENEVER SUBBASE IS EXPOSED, AND SHALL REMAIN IN PLACE UNTIL THE ABUTTING GROUND SURFACES ARE STABILIZED.
- WHERE BALED HAY INLET PROTECTION AND SILT FENCES ARE USED AT CATCH BASINS, THEY SHALL BE REMOVED AT THE END OF THE PROJECT OR AS DIRECTED BY THE ENGINEER IN ORDER TO PREVENT CLOGGING OF THE INLET.

**DRAINAGE AND EROSION CONTROL NOTES (CONTINUED):**

- DETENTION AND RETENTION BASINS MAY BE ROUGH GRADED AND STABILIZED WITH VEGETATION AND/OR OTHER EROSION CONTROL MEASURES AS REQUIRED BY THE ENGINEER PRIOR TO USE AS TEMPORARY SEDIMENTATION BASINS DURING PROJECT CONSTRUCTION. FINAL BASIN CONSTRUCTION SHALL NOT COMMENCE UNTIL ALL SOURCES OF SEDIMENT HAVE BEEN ELIMINATED, FINAL ROADSIDE VEGETATION IS ESTABLISHED AND USE OF TEMPORARY BASINS IS NO LONGER REQUIRED AS DIRECTED BY THE ENGINEER. ANY ISSUES RELATING TO EROSION AND/OR SEDIMENT TRANSPORT INTO WETLAND AREAS RESULTING FROM SUCH USE OF SEDIMENTATION BASINS DURING CONSTRUCTION SHALL BE THE RESPONSIBILITY OF THE CONTRACTOR. ANY CORRECTIVE ACTION REQUIRED TO RESOLVE SUCH ISSUES SHALL BE COMPLETED BY THE CONTRACTOR.
- THE TOE OF ANY FILL SLOPE IS TO REMAIN AT LEAST 1' INSIDE OF ALL EROSION CONTROLS. UNDER NO CIRCUMSTANCES SHALL THE CONTRACTOR COVER ANY PORTION OF THE EROSION CONTROL MEASURES WITH MATERIAL. ANY MATERIAL THAT IS PLACED ON ANY EROSION CONTROLS BY THE CONTRACTOR, OR ANY AGENT OF THE CONTRACTOR, SHALL BE IMMEDIATELY REMOVED BY THE CONTRACTOR, AND ANY NECESSARY REPAIRS TO THE EROSION CONTROLS ACCOMPLISHED.
- PRIOR TO COMMENCING CONSTRUCTION ACTIVITIES, EROSION AND SEDIMENTATION CONTROLS SHALL BE INSTALLED AT THOSE AREAS INDICATED ON THE PLANS. CLEARING MAY OCCUR PRIOR TO INSTALLATION OF SUCH CONTROLS, HOWEVER NO GRUBBING, GRADING, FILLING, OR OTHER SOIL DISTURBANCE SHALL OCCUR PRIOR TO INSTALLATION. THE LIMITS OF CLEARING AND SURFACE DISTURBANCE MUST BE STRICTLY ADHERED TO IN ALL AREAS.
- ALL HAY BALES, SILT FENCE OR TEMPORARY PROTECTION SHALL REMAIN IN PLACE UNTIL AN ACCEPTABLE STAND OF GRASS IS ESTABLISHED. IF NEEDED, TEMPORARY SEEDING CAN HELP TO MINIMIZE EROSION. TEMPORARY SEED WILL CONFORM TO R.I.D.O.T. STANDARD TEMPORARY SEED MIX.
- THE CONTRACTOR MUST REPAIR AND/OR RESEED ANY AREAS THAT DO NOT DEVELOP WITHIN THE PERIOD OF ONE YEAR AND HE SHALL DO SO AT NO ADDITIONAL EXPENSE TO THE STATE.
- THE NORMAL ACCEPTABLE SEASONAL SEEDING DATES ARE SPECIFIED IN SUBSECTION L.02.03 OF THE R.I.D.O.T. STANDARD SPECIFICATIONS, LATEST EDITION.
- ADDITIONAL EROSION CONTROLS, SHALL BE INSTALLED AS DIRECTED BY THE RESIDENT ENGINEER. THESE ADDITIONAL ITEMS WILL BE PAID AT THE UNIT PRICE FOR THAT BID ITEM.

**UTILITY NOTES:**

- EXISTING UTILITIES HAVE BEEN SHOWN ON THE PLANS USING THE BEST AVAILABLE INFORMATION AND ARE APPROXIMATE. BUILDING SERVICE CONNECTIONS (ELECTRIC, GAS, TELEPHONE, WATER AND SANITARY) ARE NOT SHOWN. CONTRACTOR IS TO ASSUME SERVICES ARE PRESENT TO ALL BUILDINGS.
- THE CONTRACTOR SHALL VERIFY THE LOCATIONS OF ALL EXISTING DRAINAGE AND UTILITIES BOTH UNDERGROUND AND OVERHEAD BEFORE EXCAVATION BEGINS IN ACCORDANCE WITH CHAPTER 39-1.2 OF THE R.I. GENERAL LAWS ENTITLED "EXCAVATION NEAR UNDERGROUND UTILITY FACILITIES", WITH AMENDMENTS EFFECTIVE AS OF NOVEMBER 1, 2009 AND, WHEN NECESSARY, BY CONTACTING THE INDIVIDUAL UTILITY COMPANIES. EXCAVATION SHALL BE IN ACCORDANCE WITH ALL STATUTES, ORDINANCES, RULES AND REGULATIONS OF ANY APPLICABLE CITY, TOWN, STATE OR FEDERAL AGENCY. THE CONTRACTOR SHOULD UNDERSTAND THAT NOT ALL UTILITIES SUBSCRIBE TO THE DIG SAFE PROGRAM. IT IS THE CONTRACTOR'S RESPONSIBILITY TO NOTIFY ALL UTILITY COMPANIES AND ENSURE THAT ALL UTILITIES HAVE BEEN MARKED PRIOR TO COMMENCING THEIR WORK. ANY DAMAGE TO EXISTING UTILITIES MARKED IN THE FIELD, OR AS A RESULT OF FAILING TO CONTACT THE APPROPRIATE UTILITY COMPANY, SHALL BE REPAIRED OR REPLACED AT THE CONTRACTOR'S ADDITIONAL COST TO THE STATE.
- ALL EXISTING UTILITIES TO BE ABANDONED SHALL BE CAPPED.
- EXISTING WATER SERVICES SHALL BE RECONNECTED TO THE NEW WATER MAINS.
- UTILITY SERVICE CONNECTIONS SHALL BE MAINTAINED TO ALL EXISTING FACILITIES TO REMAIN.
- FIRE HYDRANTS SHALL NOT BE REMOVED FROM SERVICE WITHOUT WRITTEN AUTHORIZATION FROM THE FIRE DEPARTMENT OR THE WATER AUTHORITY.
- ALL NEW WATER LINES SHALL BE DISINFECTED TO THE SATISFACTION OF THE WATER AUTHORITY IN ACCORDANCE WITH THE SPECIFICATIONS.
- ALL UTILITY POLE RELATED WORK SHALL BE BY OTHERS.

JAN 31 2019  
Water Resources

OFFICE OF ENVIRONMENTAL MANAGEMENT  
FRESHWATER WETLANDS PROGRAM  
APPROVED WITH CONDITIONS  
AS SPECIFIED IN THE LETTER OF APPROVAL  
DATE FEB 2 2019 FILE # 18-0317  
NO CHANGES ALLOWED WITHOUT PRIOR APPROVAL  
APPROVED PLANS MUST BE AT CONSTRUCTION SITE

EPS SUBMISSION  
NOVEMBER 30, 2018  
NOT FOR CONSTRUCTION

**Stantec**  
260 WEST EXCHANGE STREET, SUITE 001  
PROVIDENCE, RI 02903

**Manafort Brothers Incorporated**  
414 New Britain Ave, Plainville, Connecticut 06062 • 860.228.4853

**Steere**  
ENGINEERING INC

REVISIONS		
NO.	DATE	BY
1	4/07	TRB
2	3/10	RBH
3	4/14	MLP

RHODE ISLAND DEPARTMENT OF TRANSPORTATION		
BRIDGE REHABILITATION WOONASQUATUCKET RIVER BRIDGE No. 604 PROVIDENCE, RHODE ISLAND		
STANDARD NOTES - 1		
CHECKED BY	DATE 11/18	SCALE NO SCALE





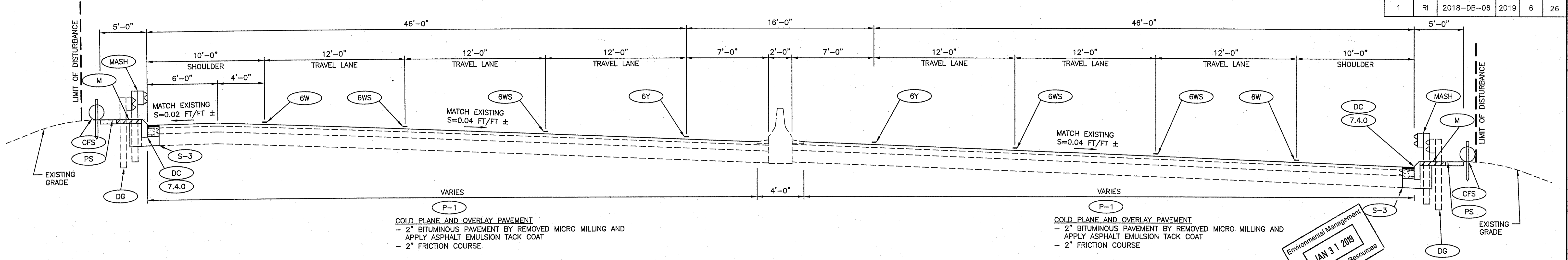

**ROUTE 6 EXPRESSWAY**  
**STA. 465+18± TO STA. 471+00±**  
 SCALE: 1/4"=1'-0"

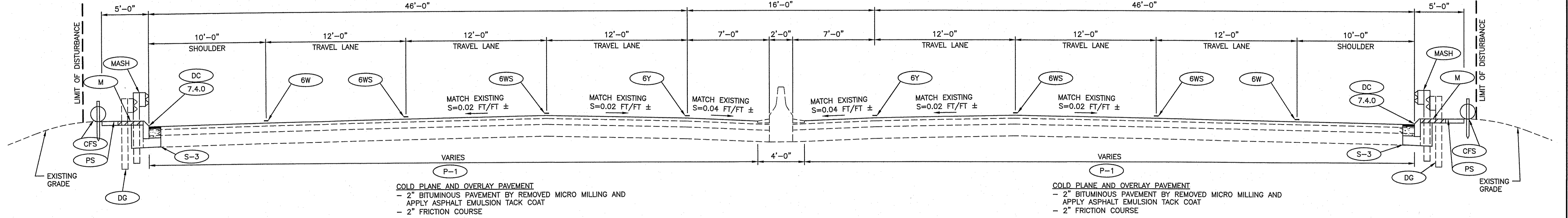

**ROUTE 6 EXPRESSWAY**  
**STA. 458+00± TO STA. 463+67±**  
 SCALE: 1/4"=1'-0"

EPS SUBMISSION  
 NOVEMBER 30, 2018  
 NOT FOR CONSTRUCTION

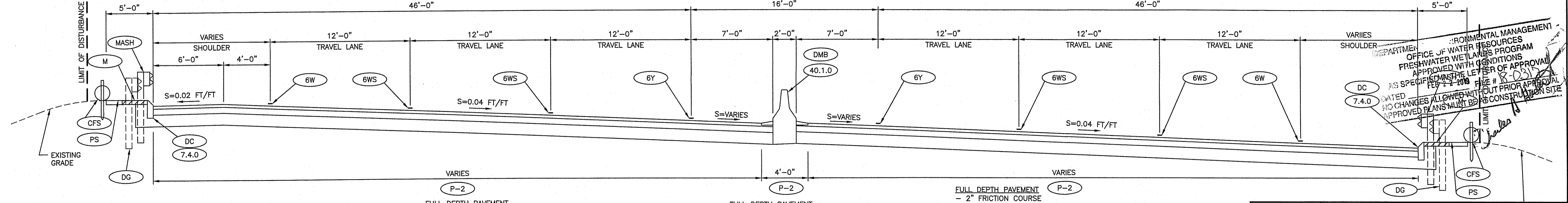

**ROUTE 6 EXPRESSWAY**  
**STA. 463+67± TO STA. 465+18±**  
 SCALE: 1/4"=1'-0"

- FULL DEPTH PAVEMENT**
- 2" FRICTION COURSE
  - 2" MODIFIED CLASS 12.5 HMA SURFACE COURSE
  - 8" CLASS 19 HMA BASE COURSE (THREE LIFTS)
  - 12" GRAVEL BORROW SUBBASE COURSE

**Stantec**  
 260 WEST EXCHANGE STREET, SUITE 001  
 PROVIDENCE, RI 02903

**Manafort Brothers Incorporated**  
 414 New Britain Ave, Plainville, Connecticut 06062 • 860.229.4853

**Steere ENGINEERING INC**

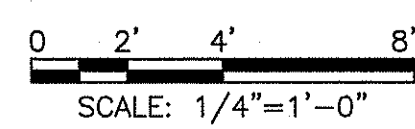

REVISIONS	NO.	DATE	BY

RHODE ISLAND  
 DEPARTMENT OF TRANSPORTATION  
 BRIDGE REHABILITATION  
 WOONASQUATUCKET RIVER  
 BRIDGE No. 604  
 PROVIDENCE, RHODE ISLAND

TYPICAL SECTIONS NO. 1

CHECKED BY \_\_\_\_\_ DATE 11/18 SCALE AS SHOWN







Environmental Management  
**JAN 31 2019**  
 Office of Water Resources

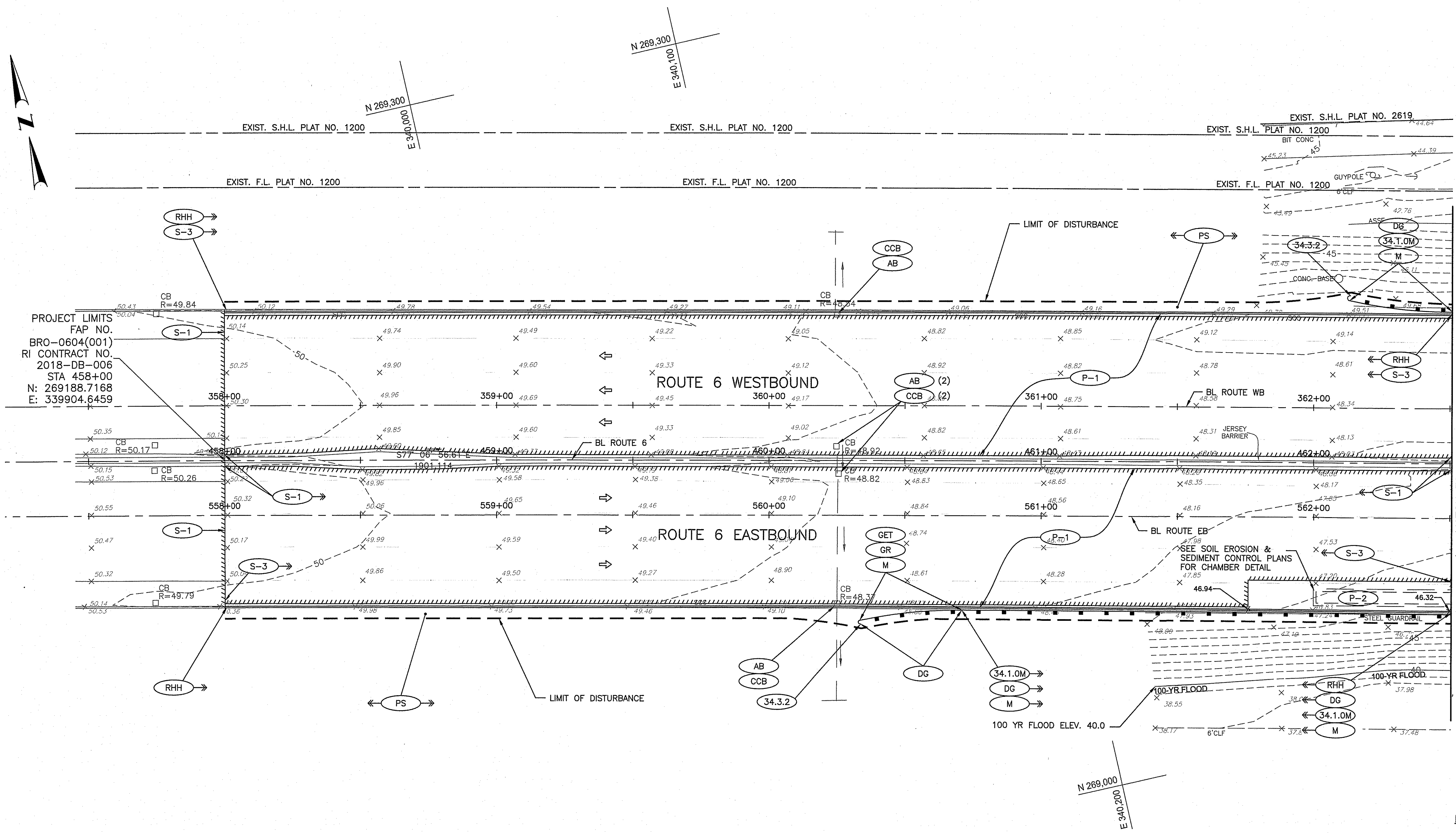

PROJECT LIMITS  
 FAP NO.  
 BRO-0604(001)  
 RI CONTRACT NO.  
 2018-DB-006  
 STA 458+00  
 N: 269188.7168  
 E: 339904.6459

MATCH TO PLAN NO. 2

DEPARTMENT OF ENVIRONMENTAL MANAGEMENT  
 OFFICE OF WATER RESOURCES  
 FRESHWATER WETLANDS PROGRAM  
 APPROVED WITH CONDITIONS  
 AS SPECIFIED IN THE LETTER OF APPROVAL  
 DATED Feb - 2 2019 FILE # 18-0317  
 NO CHANGES ALLOWED WITHOUT PRIOR APPROVAL  
 APPROVED PLANS MUST BE AT CONSTRUCTION SITE

EPS SUBMISSION  
 NOVEMBER 30, 2018  
 REVISED JANUARY 28, 2019  
 NOT FOR CONSTRUCTION

NOTE:  
 1. SEE SOIL EROSION & SEDIMENT CONTROL PLANS FOR EROSION CONTROLS.



0 10' 20' 40'  
 SCALE: 1"=20'

REVISIONS		
NO.	DATE	BY

RHODE ISLAND DEPARTMENT OF TRANSPORTATION	
BRIDGE REHABILITATION WOONASQUATUCKET RIVER BRIDGE No. 604 PROVIDENCE, RHODE ISLAND	
GENERAL PLAN NO. 1	
CHECKED BY	DATE 12/18 SCALE 1"=20'







Environmental Management  
**JAN 31 2018**  
 Office of Water Resources

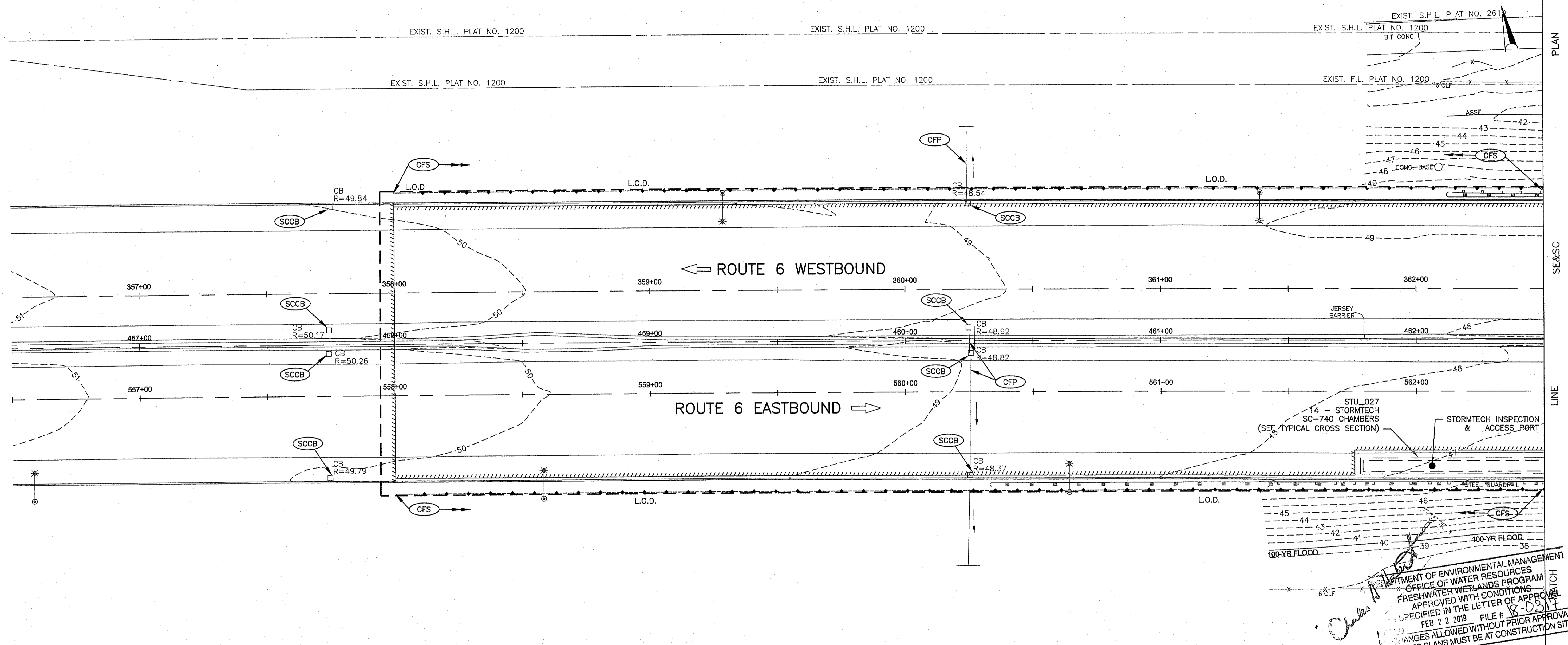

DEPARTMENT OF ENVIRONMENTAL MANAGEMENT  
 OFFICE OF WATER RESOURCES  
 FRESHWATER WETLANDS PROGRAM  
 APPROVED WITH CONDITIONS  
 SPECIFIED IN THE LETTER OF APPROVAL  
 FEB 22 2019 FILE # 18-0517  
 CHANGES ALLOWED WITHOUT PRIOR APPROVAL  
 APPROVED PLANS MUST BE AT CONSTRUCTION SITE

- NOTES:**
- ALL WORK FOR THE SUPERSTRUCTURE REPLACEMENT SHALL BE PERFORMED FROM ABOVE.
  - CONTRACTOR SHALL INSTALL NETTING TARPS OR OTHER DEVICES TO PREVENT ANY DEBRIS FALL INTO THE WOONASQUATUCKET RIVER.
  - ALL EROSION CONTROL DEVICES SHALL BE INSTALLED AS SHOWN. THE CONTRACTOR SHALL ADD, RELOCATE, AND REPAIR EROSION CONTROLS AS NECESSARY AT THE DIRECTION OF THE ENGINEER.
  - STORMTECH CHAMBER INSTALLATION AND ACCESS SHALL BE IN ACCORDANCE WITH MANUFACTURER'S RECOMMENDATIONS.
  - SEE GENERAL PLAN CALLOUTS FOR PROPOSED WORK.

**EPS SUBMISSION**  
**NOVEMBER 30, 2018**  
**REVISED JANUARY 28, 2019**  
**NOT FOR CONSTRUCTION**

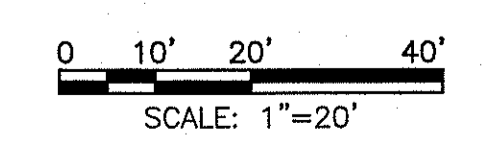

  
 Manafort Brothers Incorporated  
414 New Britain Ave, Plainville, Connecticut 06062 • 860.228.4853  
  
 Steere ENGINEERING INC

REVISIONS		
NO.	DATE	BY

RHODE ISLAND  
 DEPARTMENT OF TRANSPORTATION  
**BRIDGE REHABILITATION**  
**WOONASQUATUCKET RIVER**  
**BRIDGE No. 604**  
 PROVIDENCE, RHODE ISLAND  
**DRAINAGE PLAN NO. 1**  
 CHECKED BY \_\_\_\_\_ DATE \_\_\_\_\_ SCALE \_\_\_\_\_

Environmental Management  
**JAN 31 2019**  
 Office of Water Resources

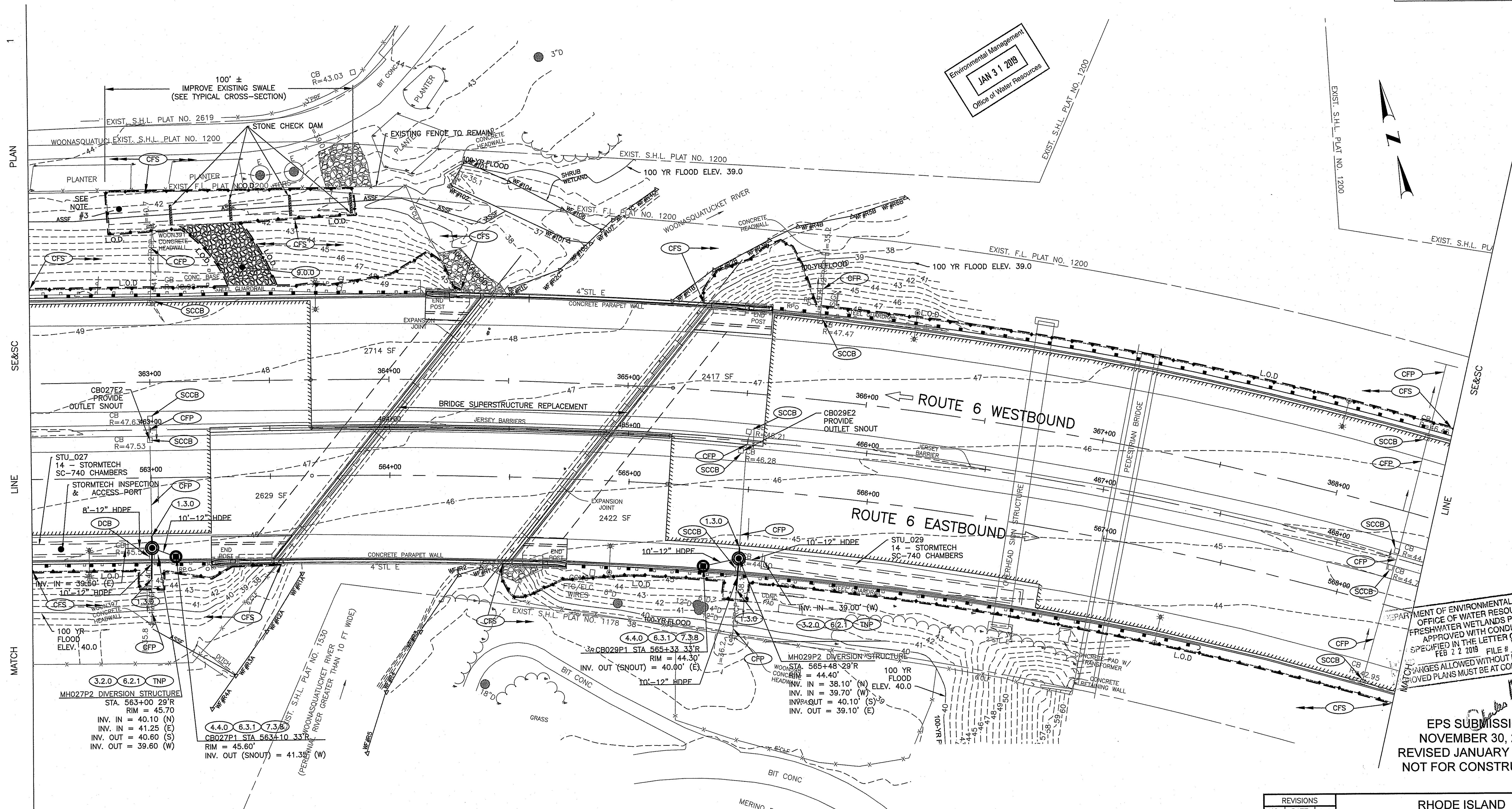
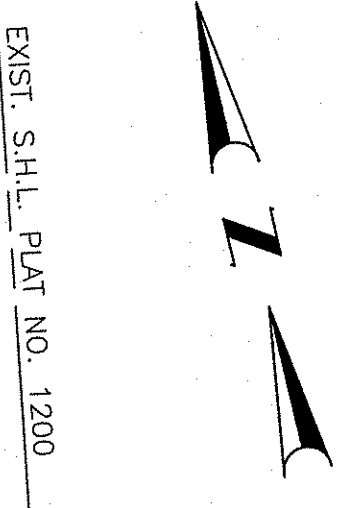

DEPARTMENT OF ENVIRONMENTAL MANAGEMENT  
 OFFICE OF WATER RESOURCES  
 FRESHWATER WETLANDS PROGRAM  
 APPROVED WITH CONDITIONS  
 SPECIFIED IN THE LETTER OF APPROVAL  
 FEB 22 2019 FILE # 18-0317  
 CHANGES ALLOWED WITHOUT PRIOR APPROVAL  
 APPROVED PLANS MUST BE AT CONSTRUCTION SITE

EPS SUBMISSION  
 NOVEMBER 30, 2018  
 REVISED JANUARY 28, 2019  
 NOT FOR CONSTRUCTION

**NOTES:**

- THIS IS A BRIDGE SUPERSTRUCTURE REPLACEMENT PROJECT, AS SUCH THERE WILL BE NO INCREASE OR DECREASE IN IMPERVIOUS AREA.
- NO WORK OR DISTURBANCE IS PROPOSED WITHIN THE 100 YR. FLOOD PLAIN.
- AREA WITHIN THE LOD ASSOCIATED WITH THE SWALE, INCLUSIVE OF THE PROPOSED CONSTRUCTION ACCESS ARE EXISTING PERVIOUS AREAS AND SHALL BE RESTORED TO THE SAME.
- ALL DISTURBED AREAS SHALL BE RESTORED IN ACCORDANCE WITH THE STANDARD DRAINAGE AND UTILITY NOTES 5 AND 6.

- ALL WORK FOR THE SUPERSTRUCTURE REPLACEMENT SHALL BE PERFORMED FROM ABOVE.
- CONTRACTOR SHALL INSTALL NETTING TARPS OR OTHER DEVICES TO PREVENT ANY DEBRIS FALL INTO THE WOONASQUATUCKET RIVER.
- ALL EROSION CONTROL DEVICES SHALL BE INSTALLED AS SHOWN. THE CONTRACTOR SHALL ADD, RELOCATE, AND REPAIR EROSION CONTROLS AS NECESSARY AT THE DIRECTION OF THE ENGINEER.
- STORMTECH CHAMBER INSTALLATION AND ACCESS SHALL BE IN ACCORDANCE WITH MANUFACTURER'S RECOMMENDATIONS.
- SEE GENERAL PLAN CALLOUTS FOR PROPOSED WORK.

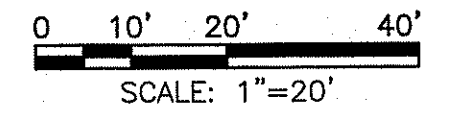

REVISIONS		
NO.	DATE	BY

RHODE ISLAND  
 DEPARTMENT OF TRANSPORTATION

**BRIDGE REHABILITATION  
 WOONASQUATUCKET RIVER  
 BRIDGE No. 604**

PROVIDENCE, RHODE ISLAND

**DRAINAGE PLAN NO. 2**

CHECKED BY \_\_\_\_\_ DATE \_\_\_\_\_ SCALE \_\_\_\_\_



















FED. ROAD DIV. NO.	STATE	FEDERAL AID PROJECT NO.	FISCAL YEAR	SHEET NO.	TOTAL SHEETS
1	RI	BRO-0604 (001)	2018	25	26

462+50

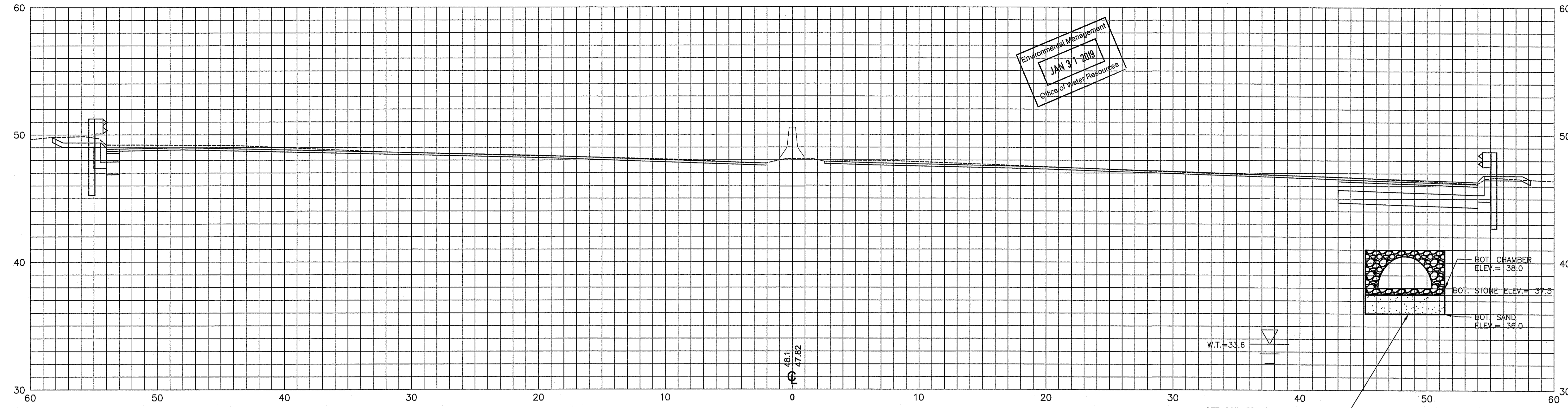

462+00

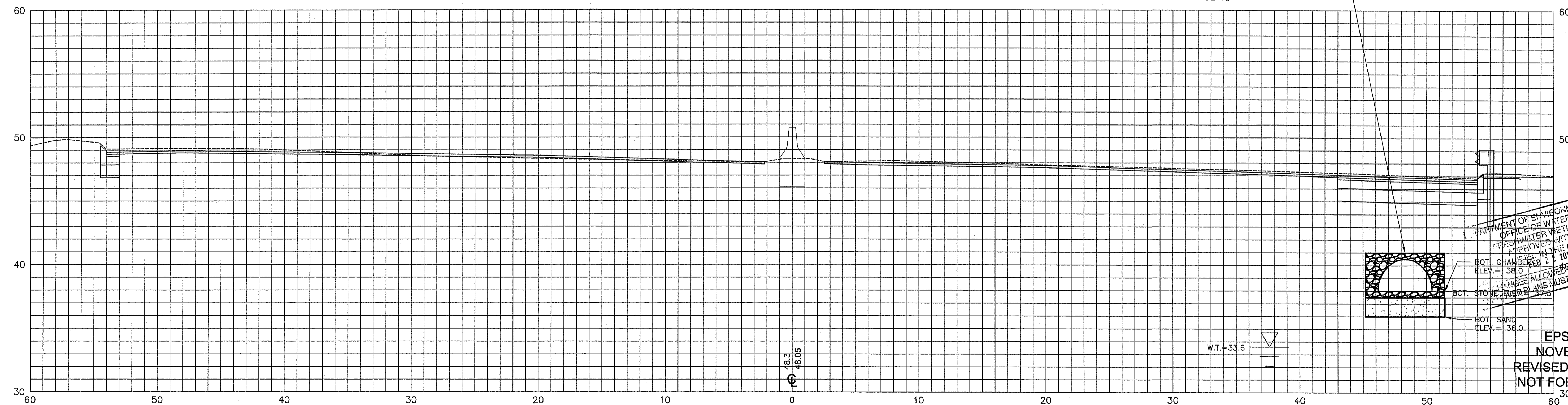

EPS SUBMISSION  
NOVEMBER 30, 2018  
REVISED JANUARY 28, 2019  
NOT FOR CONSTRUCTION

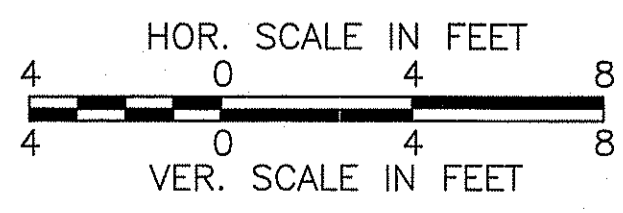

REVISIONS			RHODE ISLAND DEPARTMENT OF TRANSPORTATION	
NO.	DATE	BY		
			BRIDGE REHABILITATION WOONASQUATUCKET RIVER BRIDGE No. 604 PROVIDENCE, RHODE ISLAND	
			CROSS SECTION NO. 1	
			CHECKED BY	DATE <u>12/18</u> SCALE <u>1"=4'</u>

466+50

Environmental Management  
 JAN 31 2019  
 Office of Water Resources

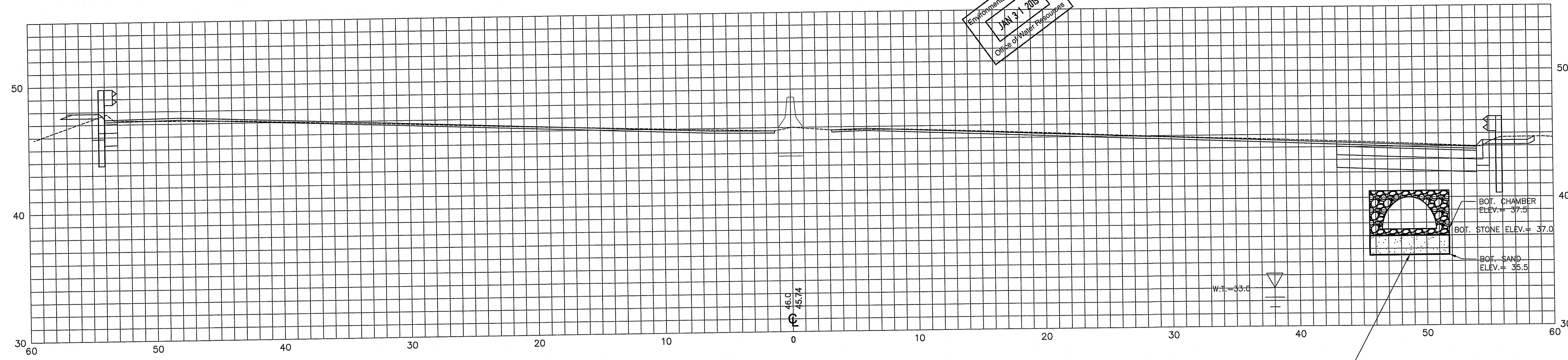

466+00

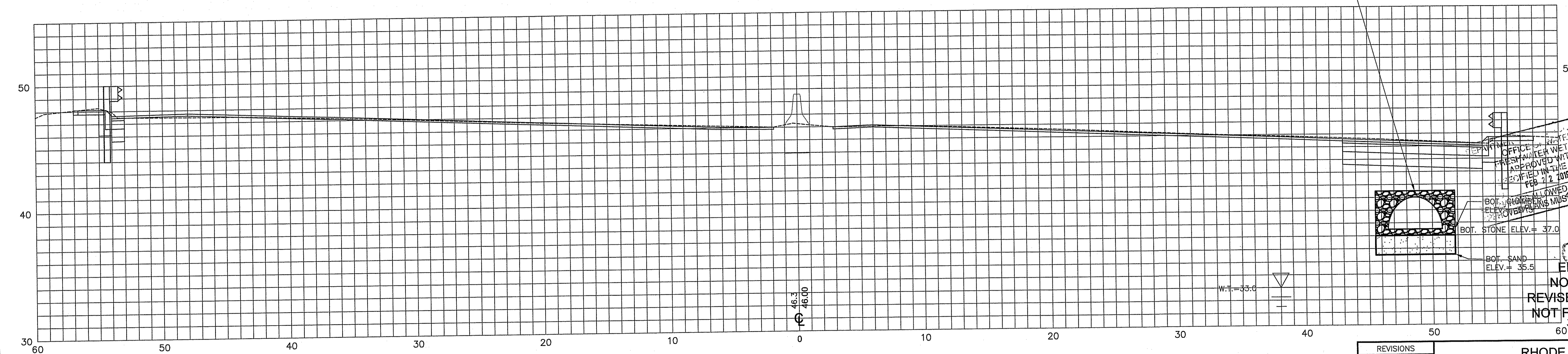

ENVIRONMENTAL MANAGEMENT  
 OFFICE OF WATER RESOURCES  
 FRESHWATER WETLANDS PROGRAM  
 APPROVED WITH CONDITIONS  
 REFLECTED IN THE LETTER OF APPROVAL  
 FEB 22 2019 FILE # 8-0317  
 NOT ALLOWED WITHOUT PRIOR APPROVAL  
 PERMITS MUST BE OBTAINED AT CONSTRUCTION SITE

*Charles H. [Signature]*

EPS SUBMISSION  
 NOVEMBER 30, 2018  
 REVISED JANUARY 28, 2019  
 NOT FOR CONSTRUCTION

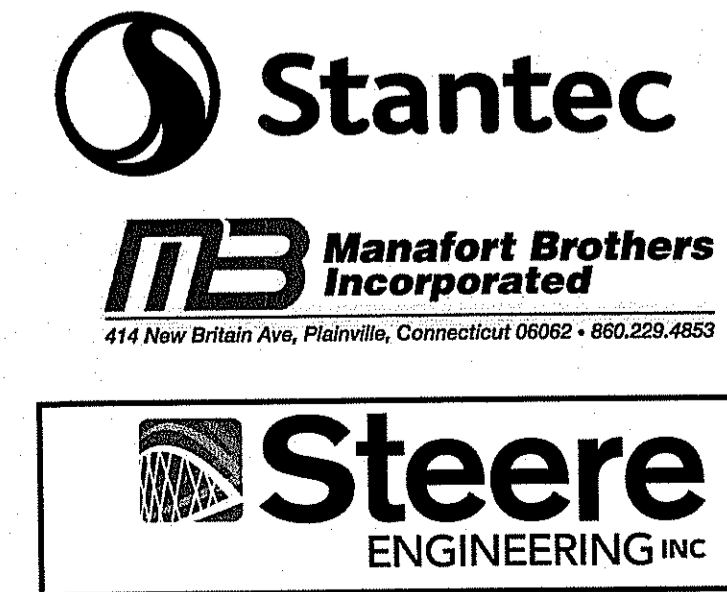
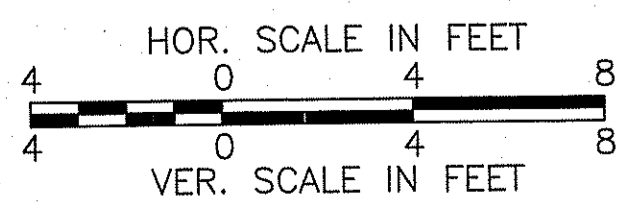

REVISIONS		
NO.	DATE	BY

RHODE ISLAND  
 DEPARTMENT OF TRANSPORTATION  
 BRIDGE REHABILITATION  
 WOONASQUATUCKET RIVER  
 BRIDGE No. 604  
 PROVIDENCE, RHODE ISLAND

**CROSS SECTION NO. 6**

CHECKED BY \_\_\_\_\_ DATE 12/18 SCALE 1"=4'