

Charles A. Hester

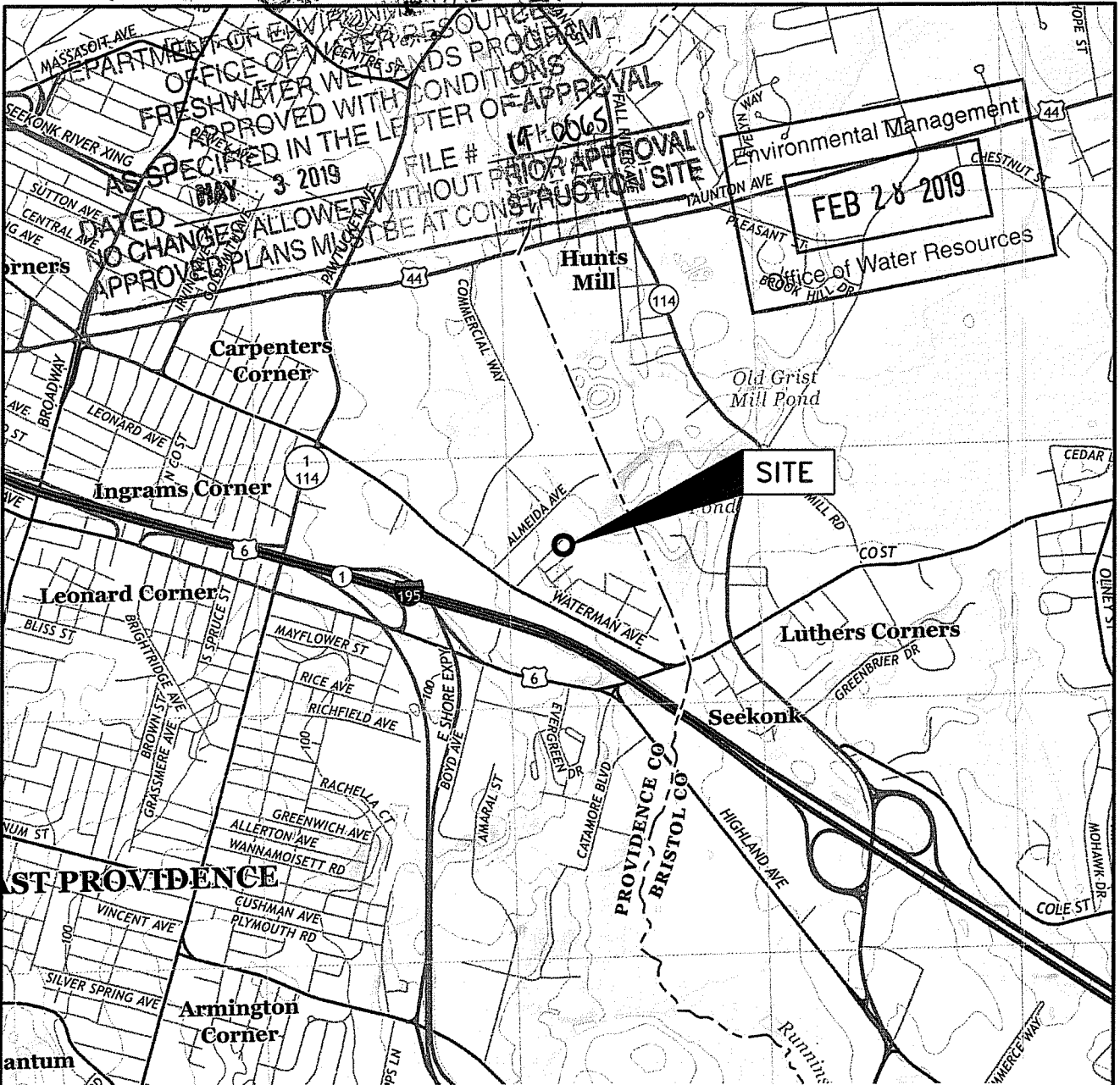

© 2018 - GZA GeoEnvironmental, Inc. GZA-J:\GEO\34557\JER\FIGURES\CAD\DWGS\34557.00_LOCUS MAP_FIG-1.DWG LOCUS JUNE 12, 2014 MICHAEL AUBIN

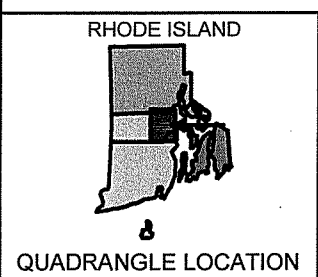

QUADRANGLE LOCATION

SOURCE:
BASE MAP FROM THE FOLLOWING USGS QUADRANGLE MAP:
EAST PROVIDENCE, RHODE ISLAND (2015)
 DIGITAL TOPOGRAPHIC MAPS PROVIDED BY USGSSTORE.GOV.

CONTOUR ELEVATIONS REFERENCE NAVD 88,
 CONTOURS ARE SHOWN IN FEET AT 10' INTERVALS

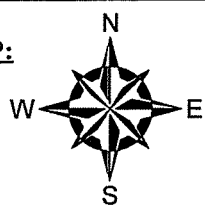

UNLESS SPECIFICALLY STATED BY WRITTEN AGREEMENT, THIS DRAWING IS THE SOLE PROPERTY OF GZA GEOENVIRONMENTAL, INC. (GZA) THE INFORMATION SHOWN ON THE DRAWING IS SOLELY FOR USE BY GZA'S CLIENT OR THE CLIENT'S DESIGNATED REPRESENTATIVE FOR THE SPECIFIC PROJECT AND LOCATION IDENTIFIED ON THE DRAWING. THE DRAWING SHALL NOT BE TRANSFERRED, REUSED, COPIED, OR ALTERED IN ANY MANNER FOR USE AT ANY OTHER LOCATION OR FOR ANY OTHER PURPOSE WITHOUT THE PRIOR WRITTEN CONSENT OF GZA. ANY TRANSFER, REUSE, OR MODIFICATION TO THE DRAWING BY THE CLIENT OR OTHERS, WITHOUT THE PRIOR WRITTEN EXPRESS CONSENT OF GZA, WILL BE AT THE USER'S SOLE RISK AND WITHOUT ANY RISK OR LIABILITY TO GZA.

ROCKWAY PUMP STATION 84 ROCKWAY AVENUE EAST PROVIDENCE, RHODE ISLAND	PREPARED BY: GZA GeoEnvironmental, Inc. Engineers and Scientists www.gza.com		PREPARED FOR: SUEZ	
	PROJ MGR: JER DESIGNED BY: SH DATE: JANUARY 2019	REVIEWED BY: JER DRAWN BY: GRB PROJECT NO. 34557.00	CHECKED BY: MEA SCALE: AS NOTED REVISION NO. 0	FIGURE 1 SHEET NO. 1 OF 3

LOCUS MAP

© 2018 - GZA GeoEnvironmental, Inc. GZA-J:\GEO\34557\JER\FIGURES\CAD\DWG\34557.00_SITE_PLAN_FIG-2.DWG EC PLAN (2) FEBRUARY 14, 2019 CARL BERGDE

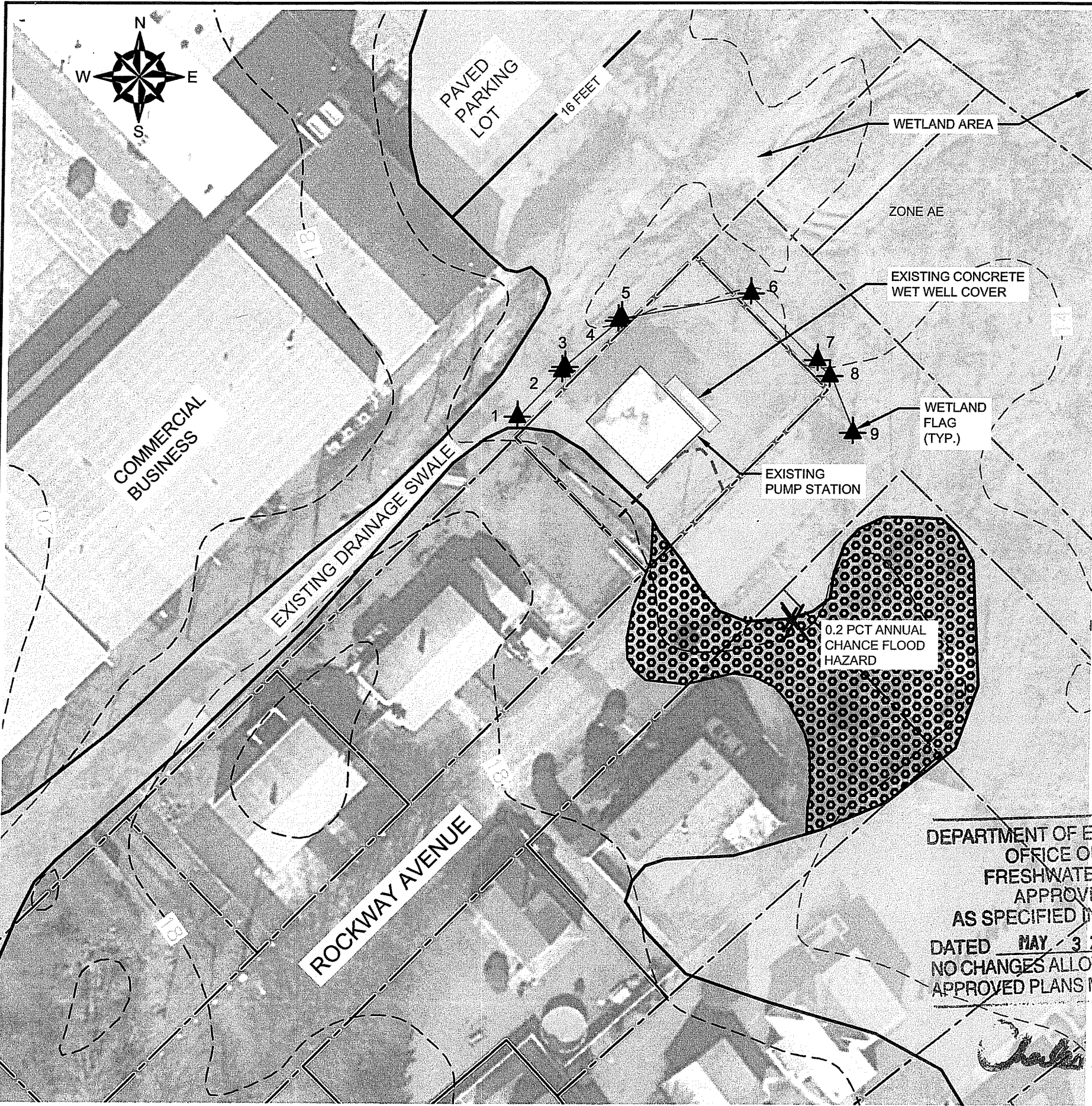

REFERENCE NOTES:

1. BASE MAP DEVELOPED FROM A GOOGLE PROFESSIONAL ELECTRONIC IMAGE FILE. DIGITAL AERIAL ORTHOPHOTOGRAPHY WAS PUBLISHED ON FEBRUARY 2018.

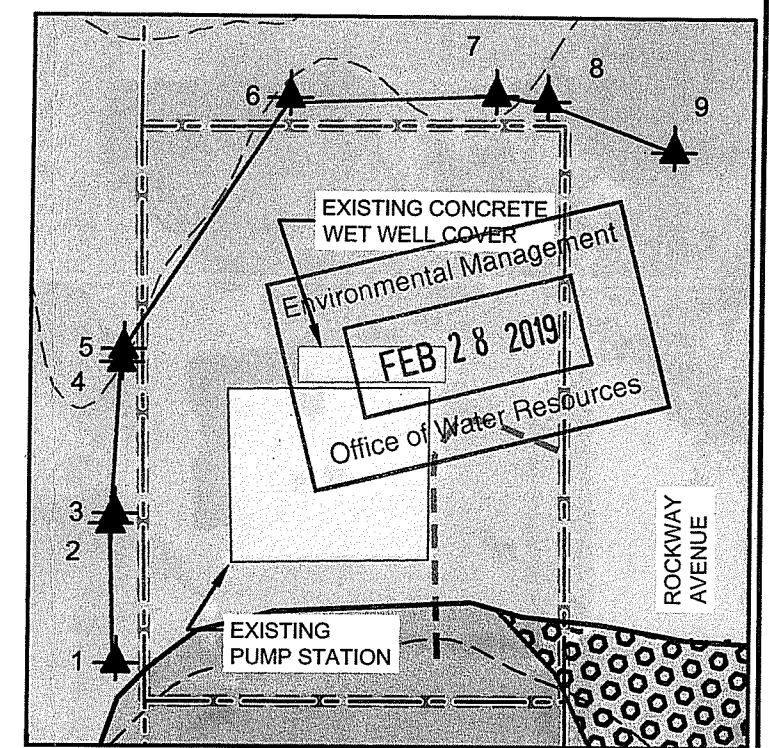

ENLARGED SITE
SCALE: 1"=30'



LEGEND:

- 16 FEET
- 100-YEAR FLOOD CONTOUR (ELEVATION IN FEET)
- 100-YEAR FLOOD PLAIN LIMIT
- AREA OF FLOOD PLAIN
- WETLAND FLAGS
- 50-FOOT WETLAND BUFFER
- SUBJECT PROPERTY BOUNDARY / FENCE LINE
- APPROXIMATE PARCEL BOUNDARY
- CONTOURS (2-FOOT INTERVAL)

DEPARTMENT OF ENVIRONMENTAL MANAGEMENT
OFFICE OF WATER RESOURCES
FRESHWATER WETLANDS PROGRAM
APPROVED WITH CONDITIONS
AS SPECIFIED IN THE LETTER OF APPROVAL
DATED MAY 3 2019 FILE # 19-0065
NO CHANGES ALLOWED WITHOUT PRIOR APPROVAL
APPROVED PLANS MUST BE AT CONSTRUCTION SITE

Charles A. Haber

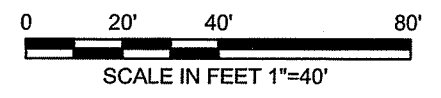

NO.	ISSUE/DESCRIPTION	BY	DATE
<small>UNLESS SPECIFICALLY STATED BY WRITTEN AGREEMENT, THIS DRAWING IS THE SOLE PROPERTY OF GZA GEDENVIRONMENTAL, INC. (GZA). THE INFORMATION SHOWN ON THE DRAWING IS SOLELY FOR USE BY GZA'S CLIENT OR THE CLIENT'S DESIGNATED REPRESENTATIVE FOR THE SPECIFIC PROJECT AND LOCATION IDENTIFIED ON THE DRAWING. THE DRAWING SHALL NOT BE TRANSFERRED, REUSED, COPIED, OR ALTERED IN ANY MANNER FOR USE AT ANY OTHER LOCATION OR FOR ANY OTHER PURPOSE WITHOUT THE PRIOR WRITTEN CONSENT OF GZA. ANY TRANSFER, REUSE, OR MODIFICATION TO THE DRAWING BY THE CLIENT OR OTHERS, WITHOUT THE PRIOR WRITTEN EXPRESS CONSENT OF GZA, WILL BE AT THE USER'S SOLE RISK AND WITHOUT ANY RISK OR LIABILITY TO GZA.</small>			
ROCKWAY PUMP STATION 84 ROCKWAY AVENUE EAST PROVIDENCE, RHODE ISLAND			
EXISTING CONDITIONS PLAN			
PREPARED BY: GZA GeoEnvironmental, Inc. Engineers and Scientists www.gza.com		PREPARED FOR: SUEZ	
PROJ MGR: JER DESIGNED BY: SH DATE: FEBRUARY 2019	REVIEWED BY: JER DRAWN BY: GRB PROJECT NO.: 34557.00	CHECKED BY: MEA SCALE: AS NOTED REVISION NO.: 0	FIGURE 2 SHEET NO. 2 OF 3

© 2018 - GZA GeoEnvironmental, Inc. GZA-J:\GEO\34557\JER\FIGURES\CAD\DWGS\34557.00_SITE_PLAN_FIG-2.DWG PROPOSED PLAN (3) FEBRUARY 14, 2019 CARL BERGDEN

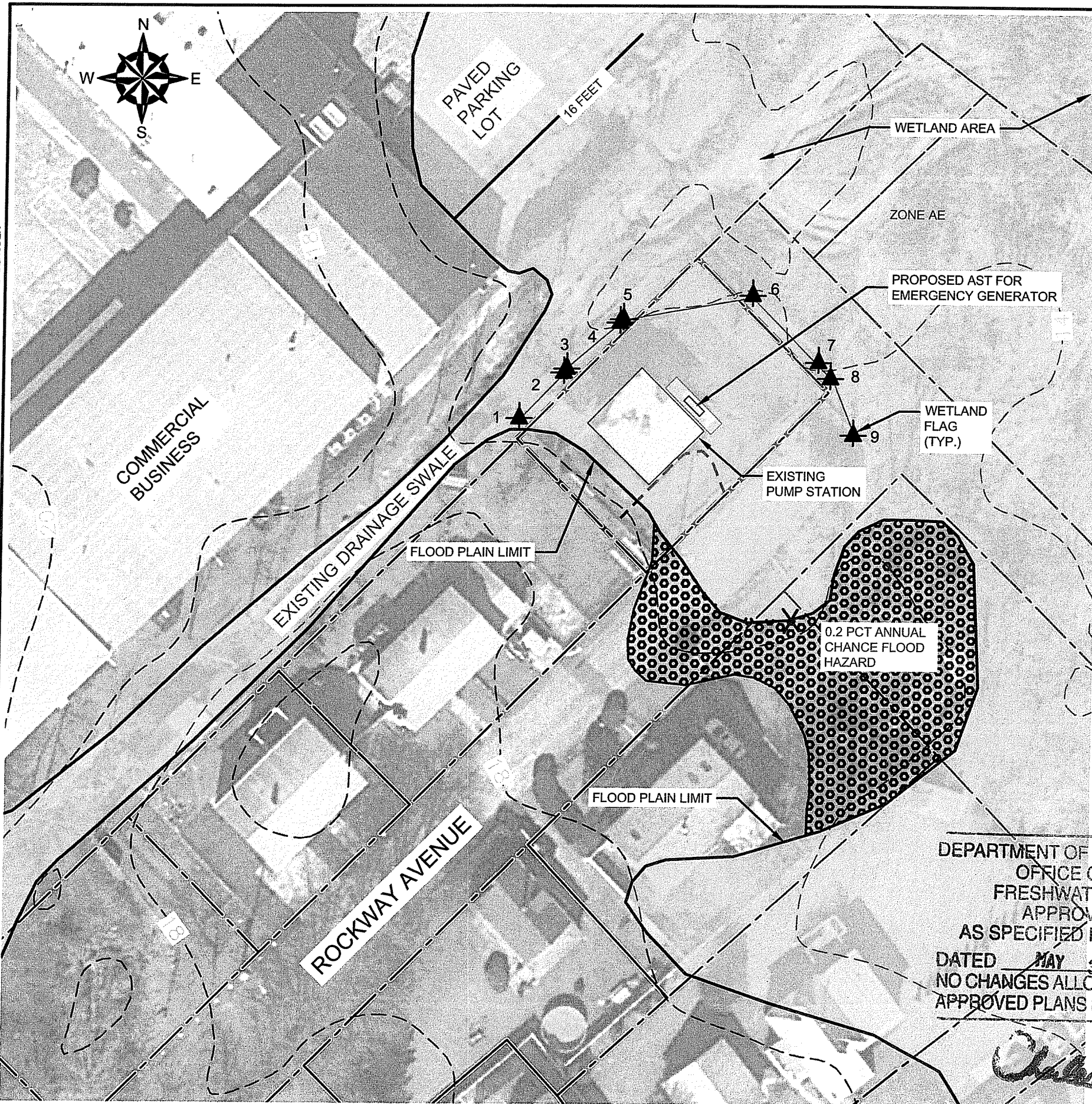

REFERENCE NOTES:

1. BASE MAP DEVELOPED FROM A GOOGLE PROFESSIONAL ELECTRONIC IMAGE FILE. DIGITAL AERIAL ORTHOPHOTOGRAPHY WAS PUBLISHED ON FEBRUARY 2018.

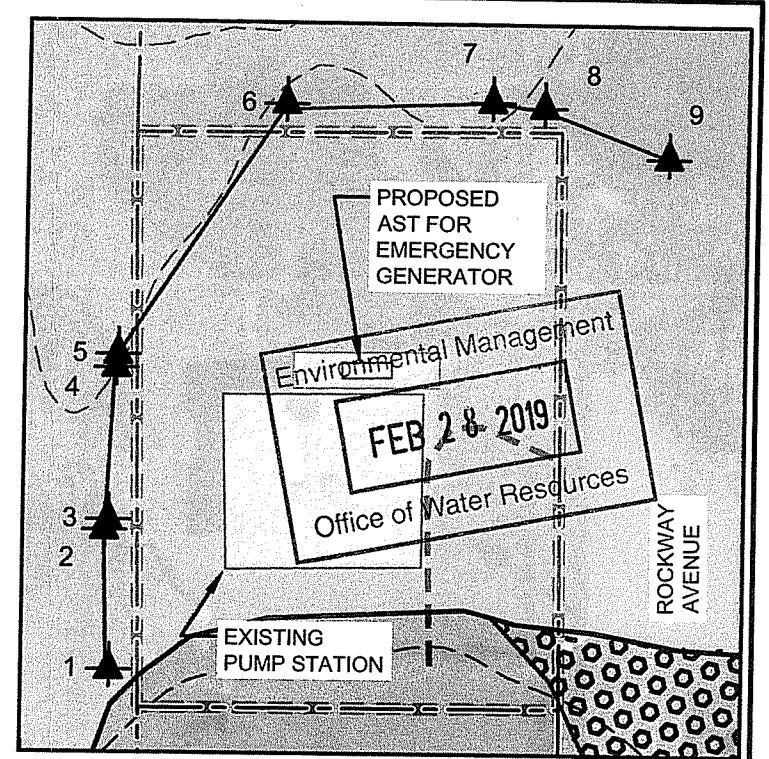

LEGEND:

- 16 FEET
- 100-YEAR FLOOD CONTOUR (ELEVATION IN FEET)
- 100-YEAR FLOOD PLAIN LIMIT
- AREA OF FLOOD PLAIN
- WETLAND FLAGS
- 50-FOOT WETLAND BUFFER
- SUBJECT PROPERTY BOUNDARY / FENCE LINE
- APPROXIMATE PARCEL BOUNDARY
- CONTOURS (2-FOOT INTERVAL)

DEPARTMENT OF ENVIRONMENTAL MANAGEMENT
 OFFICE OF WATER RESOURCES
 FRESHWATER WETLANDS PROGRAM
 APPROVED WITH CONDITIONS
 AS SPECIFIED IN THE LETTER OF APPROVAL
 DATED MAY 3 2019 FILE # 19-0065
 NO CHANGES ALLOWED WITHOUT PRIOR APPROVAL
 APPROVED PLANS MUST BE AT CONSTRUCTION SITE

Carl Bergden

NO.	ISSUE/DESCRIPTION	BY	DATE
UNLESS SPECIFICALLY STATED BY WRITTEN AGREEMENT, THIS DRAWING IS THE SOLE PROPERTY OF GZA GEOENVIRONMENTAL, INC. (GZA). THE INFORMATION SHOWN ON THE DRAWING IS SOLELY FOR USE BY GZA'S CLIENT OR THE CLIENT'S DESIGNATED REPRESENTATIVE FOR THE SPECIFIC PROJECT AND LOCATION IDENTIFIED ON THE DRAWING. THE DRAWING SHALL NOT BE TRANSFERRED, REUSED, COPIED, OR ALTERED IN ANY MANNER FOR USE AT ANY OTHER LOCATION OR FOR ANY OTHER PURPOSE WITHOUT THE PRIOR WRITTEN CONSENT OF GZA. ANY TRANSFER, REUSE, OR MODIFICATION TO THE DRAWING BY THE CLIENT OR OTHERS, WITHOUT THE PRIOR WRITTEN EXPRESS CONSENT OF GZA, WILL BE AT THE USER'S SOLE RISK AND WITHOUT ANY RISK OR LIABILITY TO GZA.			
ROCKWAY PUMP STATION 84 ROCKWAY AVENUE EAST PROVIDENCE, RHODE ISLAND			
PROPOSED CONDITIONS PLAN			
PREPARED BY: GZA GeoEnvironmental, Inc. Engineers and Scientists www.gza.com		PREPARED FOR: SUEZ	
PROJ MGR: JER	REVIEWED BY: JER	CHECKED BY: MEA	FIGURE 3 SHEET NO. 3 OF 3
DESIGNED BY: SH	DRAWN BY: GRB	SCALE: AS NOTED	
DATE: FEBRUARY 2019	PROJECT NO. 34557.00	REVISION NO. 0	

