

GENERAL NOTES:

1. REFERENCE PREVIOUS FWW PERMIT TO ALTER NO. 06-0537.
2. REFERENCE CURRENT OWTS PERMIT NO. 0509-1259
3. ENTIRE SITE IS MODERATELY WOODED WITH 8"-10" MAPLES, 6"-24" BIRCH AND MODERATE UNDERBRUSH.
4. WETLANDS EDGE DELINEATED BY NATURAL RESOURCE SERVICES INC.
5. SITE LIES IN ZONES AE (100 YEAR FLOOD ELEVATION DETERMINED) & AX, AREAS OF 0.2% ANNUAL CHANCE FLOOD; PER FEMA FIRM MAP # 4403C02316J DATED: DEC. 3,2010.
6. SITE DOES NOT FALL WITHIN ANY NATURAL HERITAGE AREAS.
7. SILT SOCK, STRAW BALE OR SILT FENCE EROSION CHECK SHALL BE INSTALLED AT ALL DOWNGRADIENT LIMITS OF DISTURBANCE PRIOR TO EARTH DISTURBING ACTIVITIES AND SHALL BE MAINTAINED UNTIL ALL DISTURBED AREAS ARE PERMANENTLY STABILIZED.
8. ALL WORK SHALL CONFORM TO ALL LOCAL AND STATE PERMITS AND CONDITIONS INCLUDING BUT NOT LIMITED TO: TOWN PLANNING AND ZONING APPROVALS, TOWN ENGINEERING APPROVAL AND FRESHWATER WETLAND PERMIT.
9. ALL PERMANENTLY DISTURBED AREAS SHALL BE STABILIZED WITH 4" LOAM AND SEED OR SOG.
10. SITE TO BE SERVICED BY ONSITE WASTEWATER TREATMENT SYSTEM AND PRIVATE WELL.
11. PROPERTY LINES, PROP. HOUSE, LIMITS OF WORK, FLOOD COMPENSATION AREA, PROP. GRADING, & BUFFER MARKERS SHALL BE ACCURATELY LOCATED AND SURVEY STAKED PRIOR TO COMMENCEMENT OF ANY WORK
12. ALL UTILITIES SHOWN FROM BEST AVAILABLE INFORMATION. THE CONTRACTOR SHALL VERIFY ALL INFORMATION WITH THE APPROPRIATE UTILITY AUTHORITY AND DIG-SAFE PRIOR TO ANY CONSTRUCTION OR EXCAVATION.
13. ROOF DRAINS SHALL BE 4" ADS OR PVC AT S=01 (MIN.).
14. THE RI DEM APPROVED LIMIT OF DISTURBANCE SHALL BE DELINEATED WITH 4"x4" PRESSURE TREATED MARKER POSTS, 30± ON CENTER, SET WITH TOPS 24" ABOVE GRADE WITH PERMANENT SIGNS LABELED "RIDEM BUFFER ZONE"
15. THE PERMANENT BUFFER ZONE LIMIT SHALL BE PLANTED WITH A LINE OF EASTERN WHITE PINE (*Pinus strobus*) BALLED & BURLAPPED, 5" TALL AFTER PLANTING SPACED 8' ON CENTER, 30 REQUIRED

BUFFER ZONE PLANTING NOTES:

1. THE FLOOD COMPENSATION AREA SHALL BE EXCAVATED TO 4" BELOW THE PROPOSED FINISH GRADE AND BACKFILLED WITH 4" OF LOAM.
2. THE BUFFER AREA SHALL BE PLANTED WITH RED MAPLE TREES (*Acer rubrum*) BALLED & BURLAPPED, 5" TALL AFTER PLANTING SPACED 20' ON CENTER, 6 REQUIRED (MIN.)
3. INTERSPERSED BETWEEN THE TREE PLANTINGS SHALL BE SHRUBS SPACED 8' ON CENTER. SHRUBS SHALL BE BALLED & BURLAPPED, 3" TALL AFTER PLANTING AND SHALL CONSIST OF AT LEAST 2 OF THE FOLLOWING SPECIES: SWEET PEPPERBUSH (*Colethra alnifolia*), WITCH HAZEL (*Hamamelis virginiana*), AND HIGHBUSH BLUEBERRY (*Vaccinium corymbosum*).
4. THE AREA SHALL BE SEEDED WITH A NEW ENGLAND CONSERVATION GRASS SEED MIX THEN MULCHED WITH LOOSE STRAW.

MINIMUM BUILDABLE AREA NOTE:

1. THE SITE DOES NOT CONTAIN THE MINIMUM BUILDABLE AREA PER THE TOWN OF EAST GREENWICH ZONING AMENDMENT OF AUGUST 13, 2002.

ZONING VARIANCE NOTE:

1. A DIMENSIONAL VARIANCE ALLOWING A REDUCED FRONT YARD SETBACK FROM 60' TO 40' WAS PREVIOUSLY GRANTED BY THE E.G. ZONING BOARD.

WETLAND APPLICATION NOTES

OVERALL PARCEL AREA	=1.22 Ac. OR 53,143 S.F.
AMOUNT OF PROPOSED ALTERATION IN 100' RIVERBANK WETLAND	=15± S.F.
AMOUNT OF PROPOSED ALTERATION IN 50' PERIMETER WETLAND	=5,125± S.F.
AMOUNT OF PROPOSED ALTERATION IN JURISDICTIONAL WETLAND	=5,140± S.F.

LEGEND

- PROPOSED STONE RET WALL
- EDGE OF PAVE
- W — PROPOSED WELL/WATER LINE
- EXISTING CONTOUR
- EXISTING EDGE OF WOODS
- ▲ WETLAND FLAG
- FLOOD ZONE BOUNDARY
- APPROXIMATE FLOOD ZONE ELEVATION
- 100' PERIMETER WETLAND
- UTILITY POLE
- EXISTING TESTHOLE
- STAKED EROSION CONTROLS & LIMITS OF DISTURBANCE
- SPOT ELEVATION
- PROP. WHITE PINE SCREEN PLANTING
- PROP. RED MAPLE BUFFER PLANTING
- PROP. SHRUB BUFFER PLANTINGS
- PM □ PROP. BUFFER ZONE MARKER

* Or you may substitute Rosebay Rhododendron (*Rhododendron maximum*) Shrubs - See Permit Condition No. 19 of the Permit Letter.

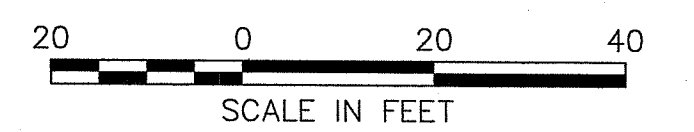

WETLAND APPLICATION PLAN

ASSESSORS MAP 25 PLAT 15, LOT 181
EAST GREENWICH, RHODE ISLAND
POLE 3, BATES TRAIL
PREPARED FOR: MICHAEL ALLAMEY
PREPARED BY: ALPHA ASSOCIATES, LTD.
35 ROCKY HOLLOW ROAD
EAST GREENWICH, RI 02818
SCALE: 1"=20' AUGUST 24, 2018 SHEET 1 OF 1

SCOTT F. MOOREHEAD
REGISTERED PROFESSIONAL ENGINEER
17/26/18

FLOOD COMPENSATION & DRAINAGE SYSTEM DESIGNER
S.F.M. ENGINEERING ASSOCIATES
410 TIOGUE AVENUE
COVENTRY, R.I. 02816
(401)826-3736

DATE	REVISION
5-2-19	HOUSE SIZE, LOD

CHK. BY: SFM JOB. NO. SFM660

PROJECT APPLICANT
MICHAEL ALLAMEY
174 WINDMILL DRIVE
WAKEFIELD, RI 02879
T.401.640.3211

PROJECT SURVEYOR
MICHAEL J. MCCORMICK
ALPHA ASSOCIATES, LTD
35 ROCKY HOLLOW ROAD
EAST GREENWICH, RI 02818
P.401.884.8506
F.401.884.7747

PROJECT BIOLOGIST
NATURAL RESOURCE SERVICES
SCOTT P. RABIDEAU, PWS
P.O. BOX 311
HARRISVILLE, RI 02830
P.401.568.7390
F.401.568.7490

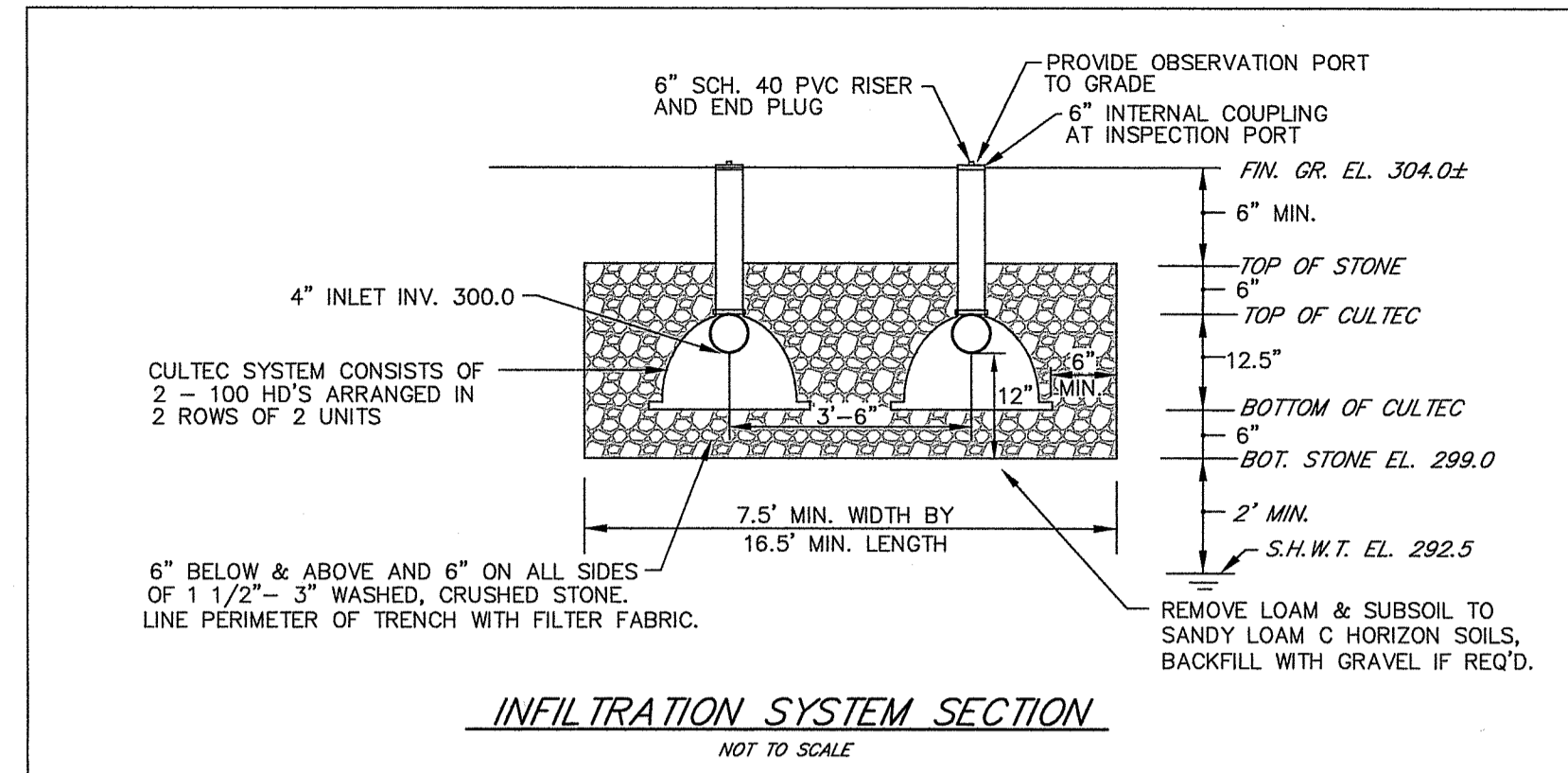
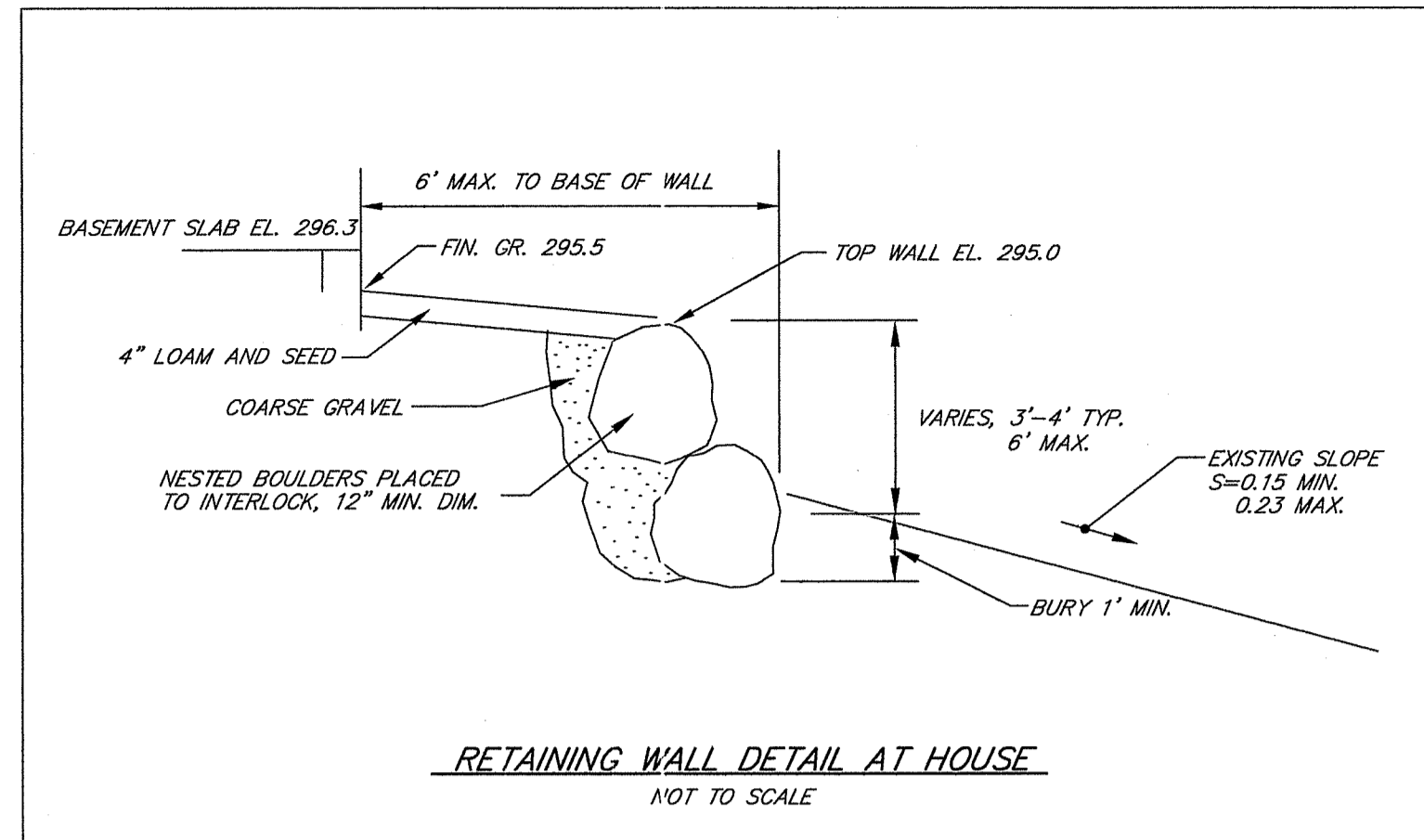
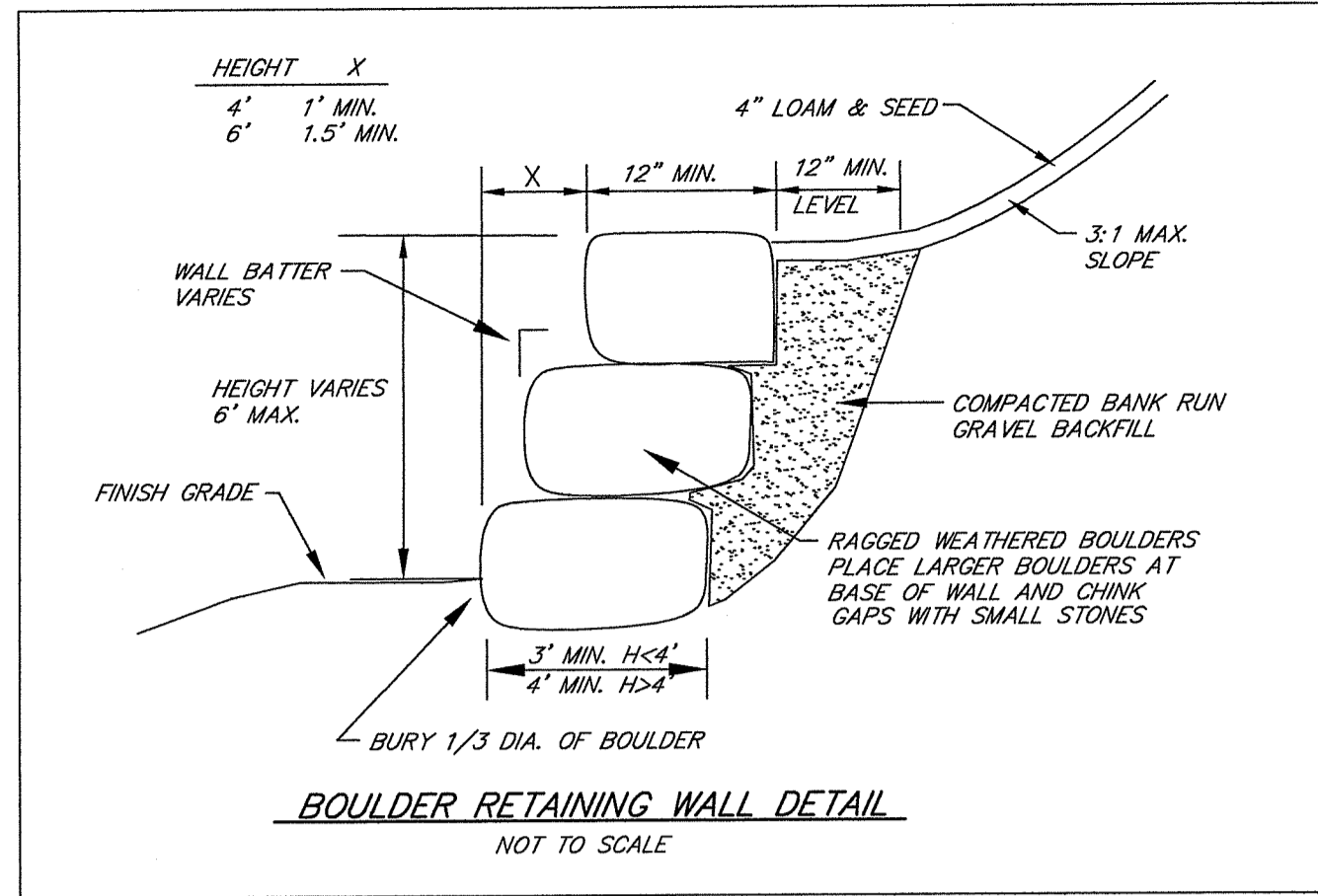

ROOF INFILTRATION SYSTEM SIZING
ROOF INFILTRATION SYSTEM BASED ON A ROOF AREA OF 1,456 S.F.
REQ'D. WATER QUALITY TREATMENT VOL. = 1,456 S.F. X 1 1/2" = 121.3 C.F.
STORAGE VOL. OF CULTECS = 1.87 S.F. X 15.5' X 2' = 58 C.F.
STORAGE VOL. OF STONE = (7.5' X 16.5' X 2' - 58 C.F.) X .33 = 62.5 C.F.
INFILTRATION VOL. = 16.5' X 7.5' X 2.41 1/2" X 2 = 49.7 C.F.
TOTAL TREATMENT VOL. = 58 + 62.5 + 49.7 = 170.2 C.F. > 121.3

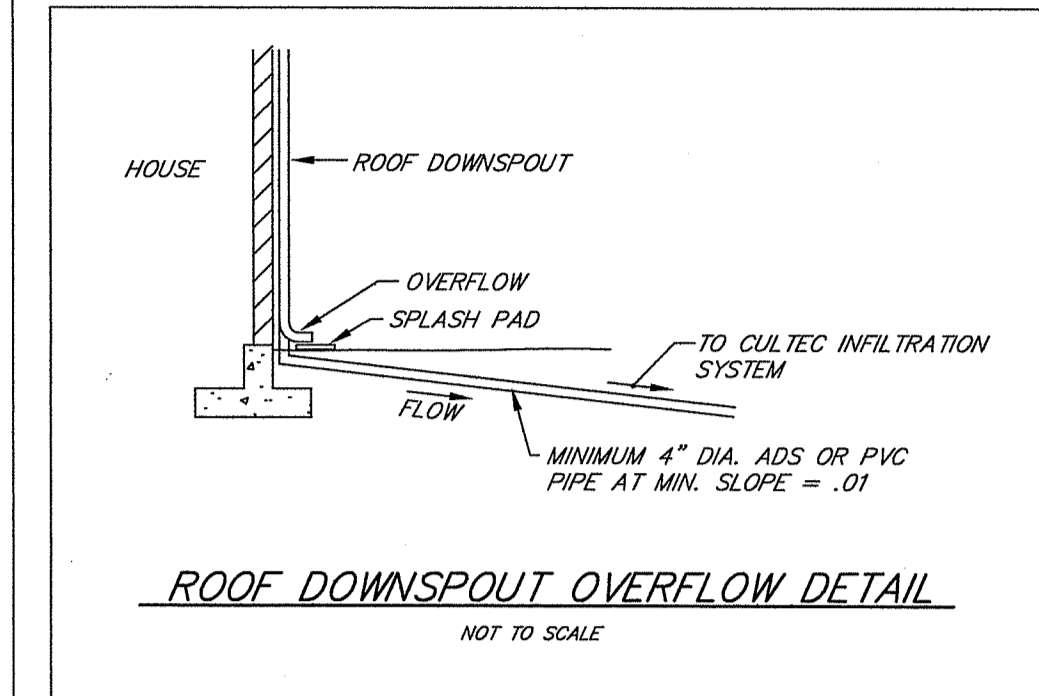

- ROOF INFILTRATION NOTES**
1. ROOF INFILTRATION SYSTEM AREA SHALL BE PROTECTED PRIOR TO COMMENCEMENT OF CONSTRUCTION TO PREVENT COMPACTION OF BOTTOM AREA.
 2. INFILTRATION SYSTEM LOCATIONS AND ELEVATIONS MUST BE SET AND VERIFIED BY THE PROJECT ENGINEER PRIOR TO INSTALLATION.
 3. INFILTRATION SYSTEM INSTALLATION MUST BE INSPECTED BY THE PROJECT ENGINEER.
 4. INFILTRATION SYSTEM CHAMBERS SHALL BE CULTEC RECHARGER 100 HD UNITS OR EQUAL WITH 6" OF STONE BELOW AND ABOVE, AND 6" ON ALL SIDES.
 5. STONE AROUND CHAMBERS SHALL BE 1 1/2" TO 3" WASHED, CRUSHED STONE.
 6. FILTER FABRIC LINER SHALL BE MIRAFI 180-N 4 OR AMCO 4552 OR EQUAL.
 7. ROOF DRAINS SHALL BE 4" PVC OR ADS AT S=.01 (MIN.).
 8. INFILTRATION SYSTEMS SHALL BE LOCATED A MINIMUM OF 10' FROM FOUNDATIONS AND PROPERTY LINES.
 9. INFILTRATION SYSTEMS SHALL BE LOCATED A MINIMUM OF 15' FROM ALL OWTS COMPONENTS.
- MAINTENANCE NOTES**
1. THE INFILTRATION CHAMBERS SHALL BE PERIODICALLY INSPECTED AND MAINTAINED DURING CONSTRUCTION AND A MINIMUM OF TWICE PER YEAR UPON COMPLETION OF CONSTRUCTION.
 2. THE CONTRACTOR SHALL BE RESPONSIBLE FOR INSPECTION AND MAINTENANCE OF ALL DRAINAGE FACILITIES, AS PER THEIR RESPECTIVE PROGRAMS, UNTIL FINAL ACCEPTANCE BY THE OWNER.
 3. UPON FINAL ACCEPTANCE OF INSTALLATION, THE LOT OWNER SHALL BE RESPONSIBLE FOR ALL DRAINAGE INSPECTION AND MAINTENANCE.
 4. ANY INADVERTENT OR DELIBERATE DISCHARGE OF WASTE OIL OR ANY OTHER POLLUTANT TO THE STORMWATER DISPOSAL SYSTEM REQUIRES IMMEDIATE NOTIFICATION OF THE RIDEM-UC PROGRAM.
 5. ANY INCIDENT OF GROUNDWATER CONTAMINATION RESULTING FROM THE IMPROPER DISCHARGE OF CONTAMINANTS TO THE DISPOSAL SYSTEM SHALL BE THE RESPONSIBILITY OF THE PROPERTY OWNER. THE RIDEM WILL REQUIRE THE PROPERTY OWNER TO REMEDIATE ANY INCIDENTS THAT MAY ADVERSELY IMPACT THE QUALITY OF THE GROUNDWATER.

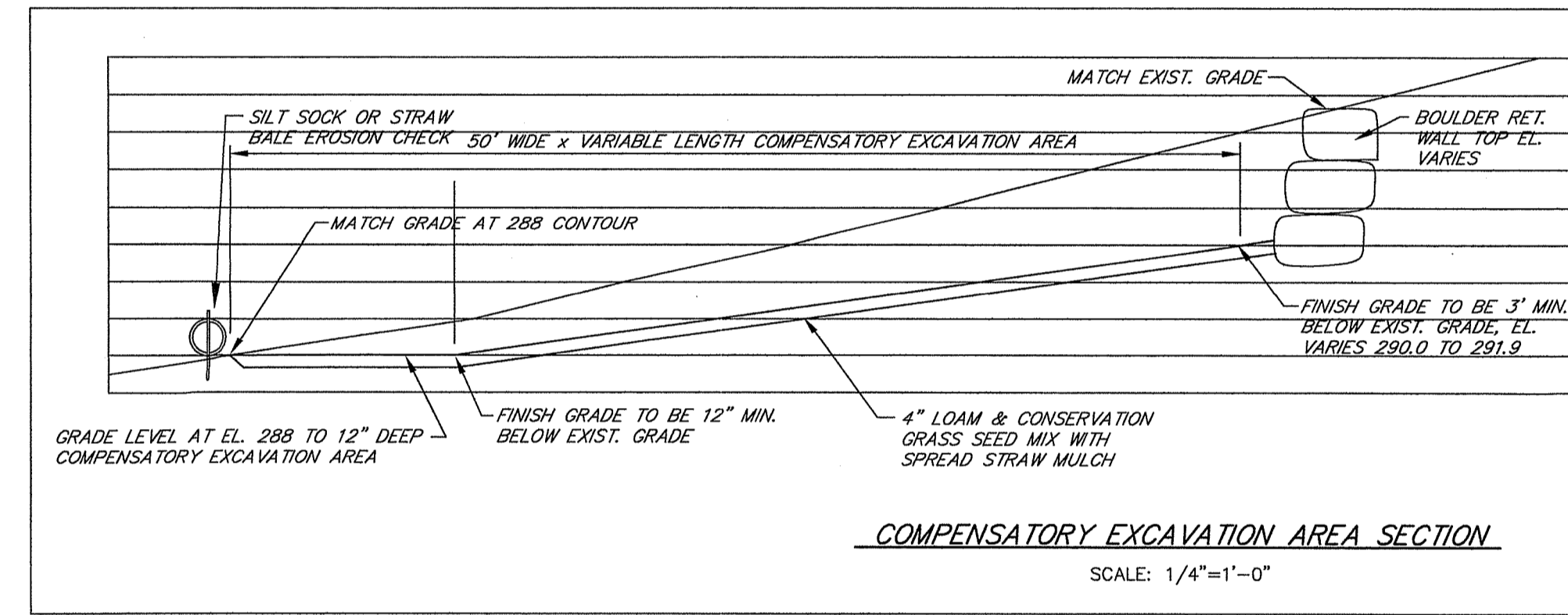
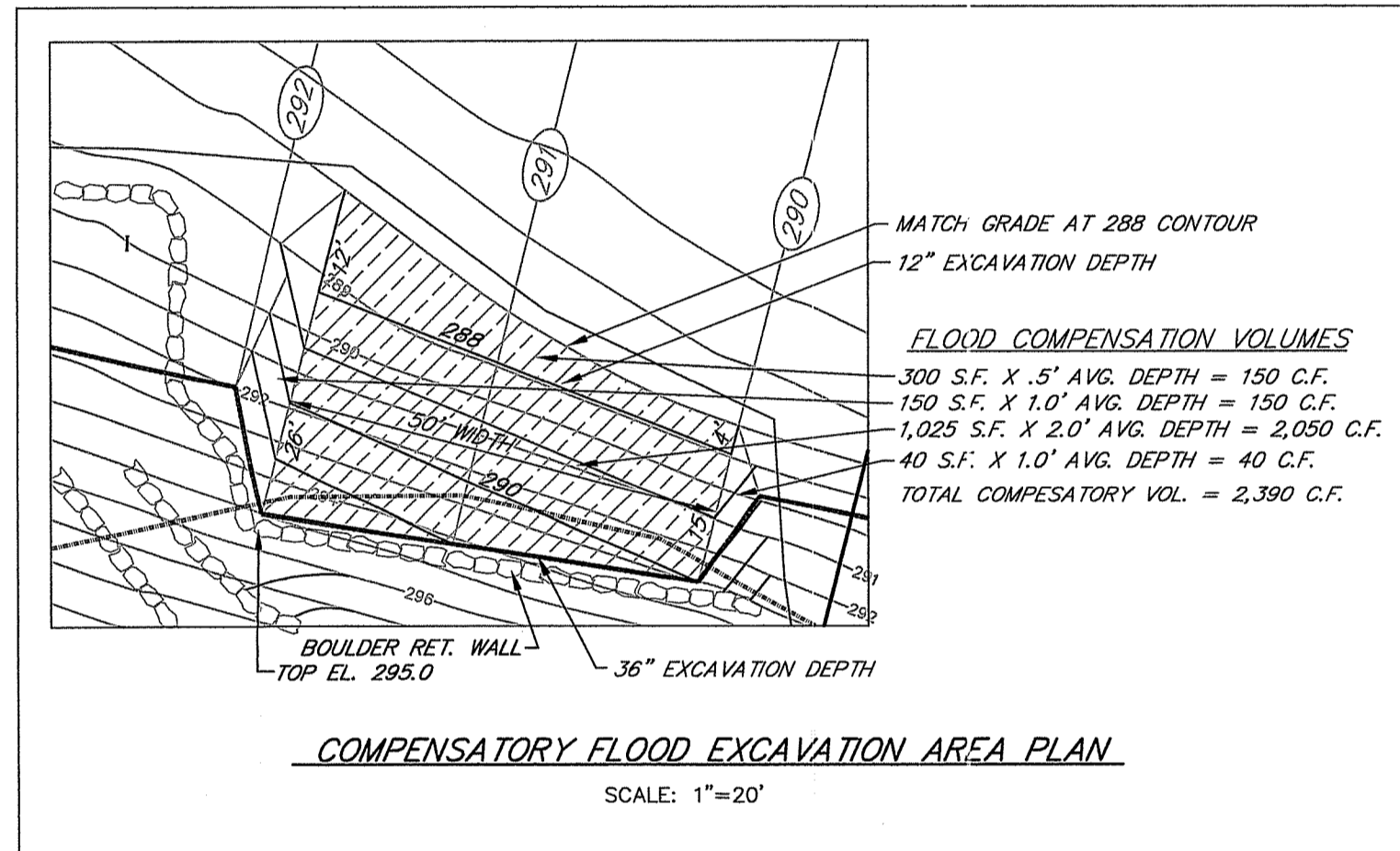

- COMPENSATION AREA NOTES:**
1. COMPENSATORY EXCAVATION AREA SHALL BE STAKED AND GRADED BY THE PROJECT SURVEYOR PRIOR TO CLEARING OR EXCAVATION.
 2. AFTER CONSTRUCTION, THE PROJECT SURVEYOR SHALL AS-BUILT SURVEY THE COMPENSATION AREA TO CERTIFY THE VOLUME OF COMPENSATORY EXCAVATION.
 3. AFTER COMPLETION, THE COMPENSATION AREA SHALL BE LEFT UNDISTURBED TO RE-VEGETATE NATURALLY.

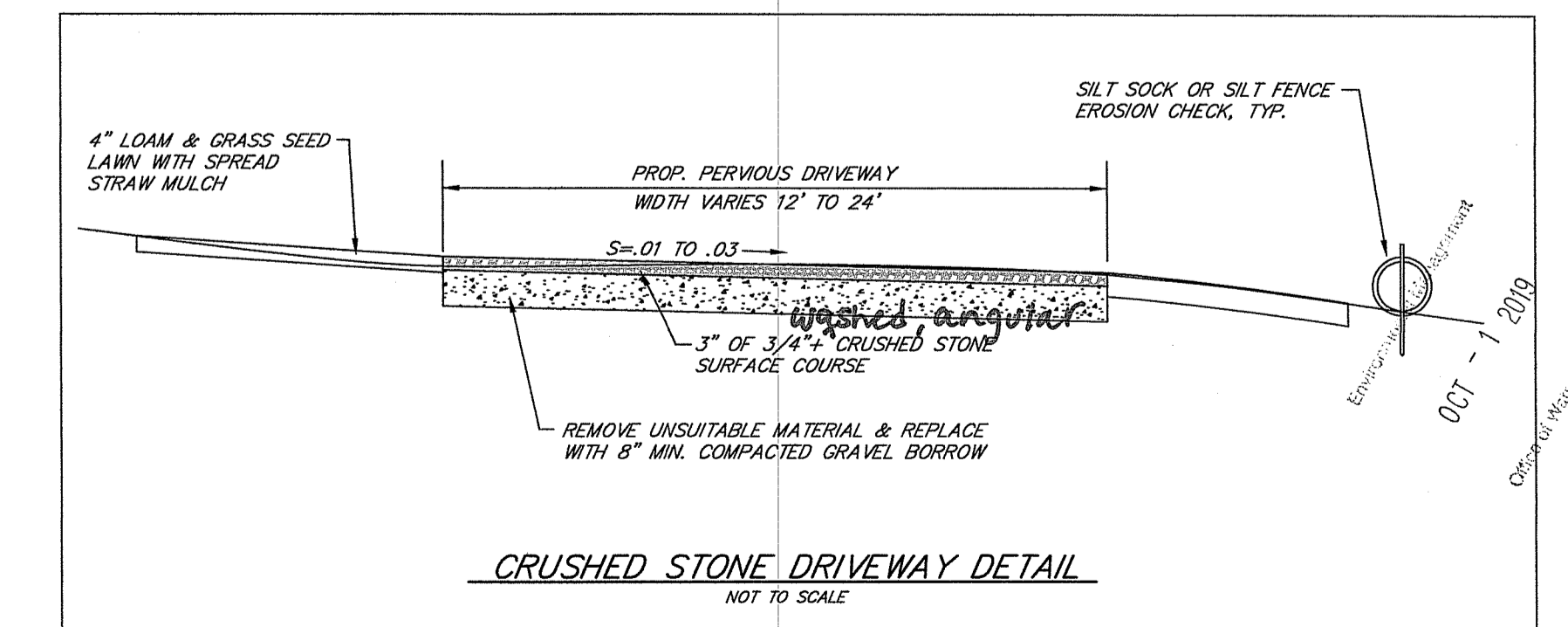
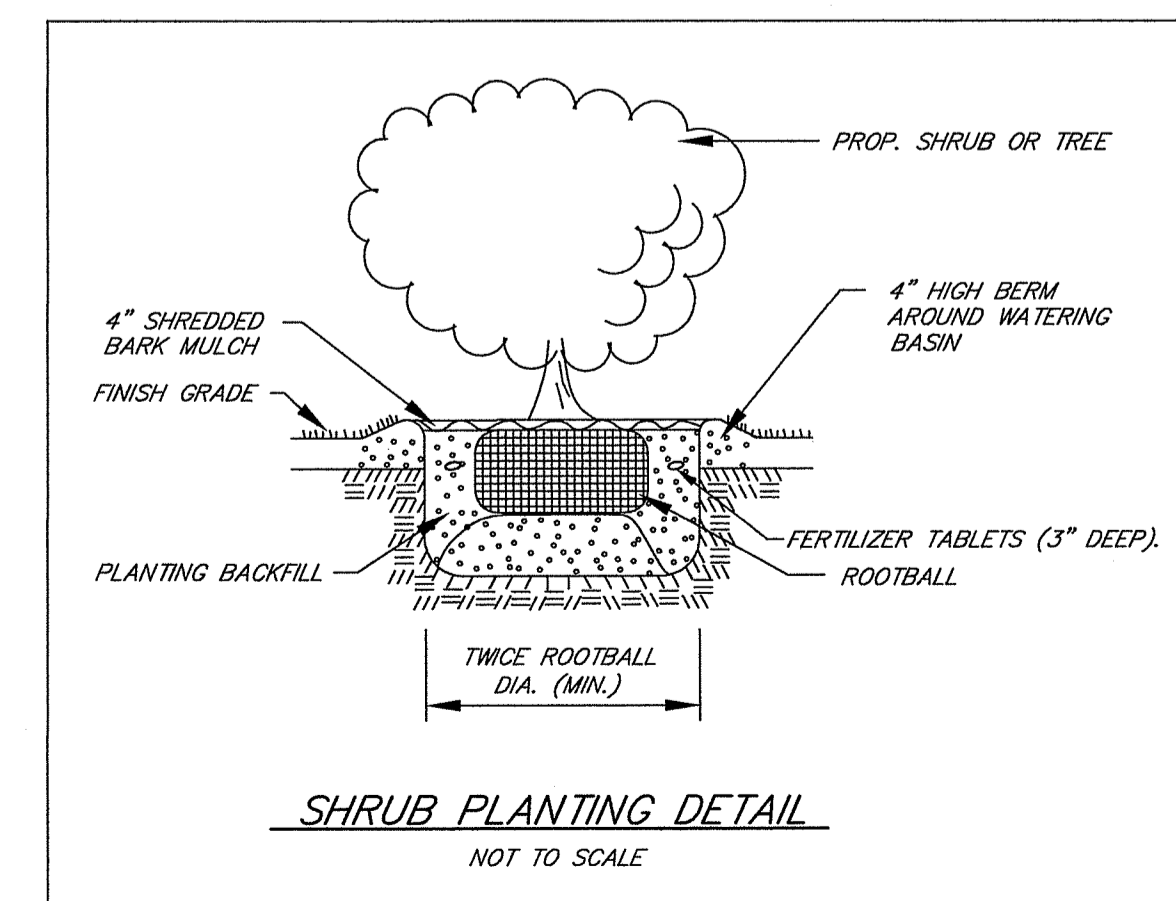
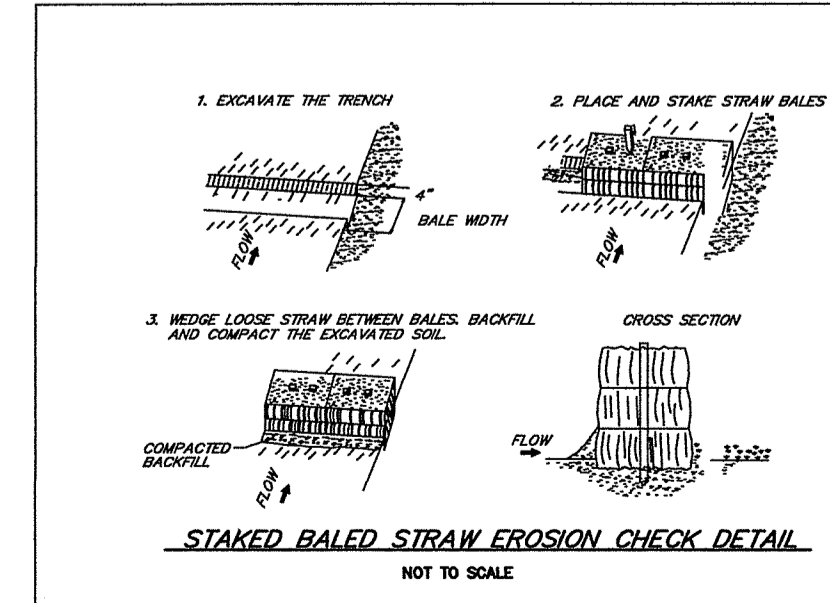
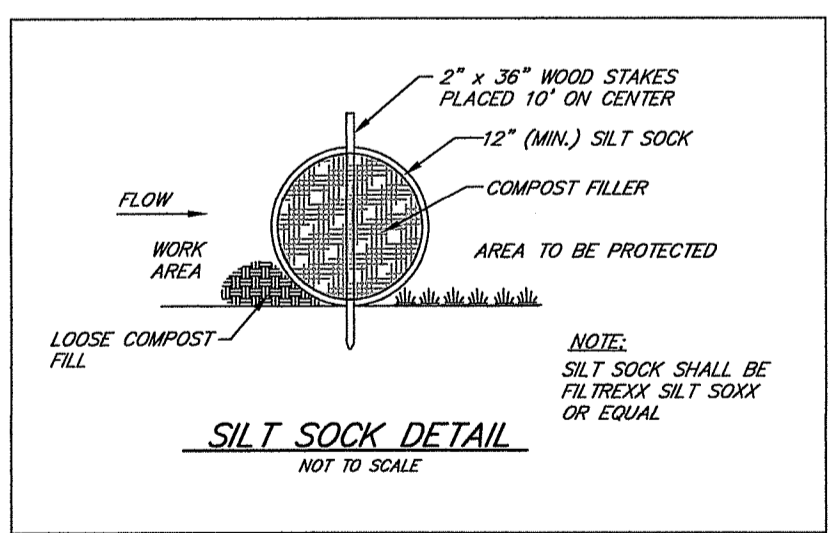
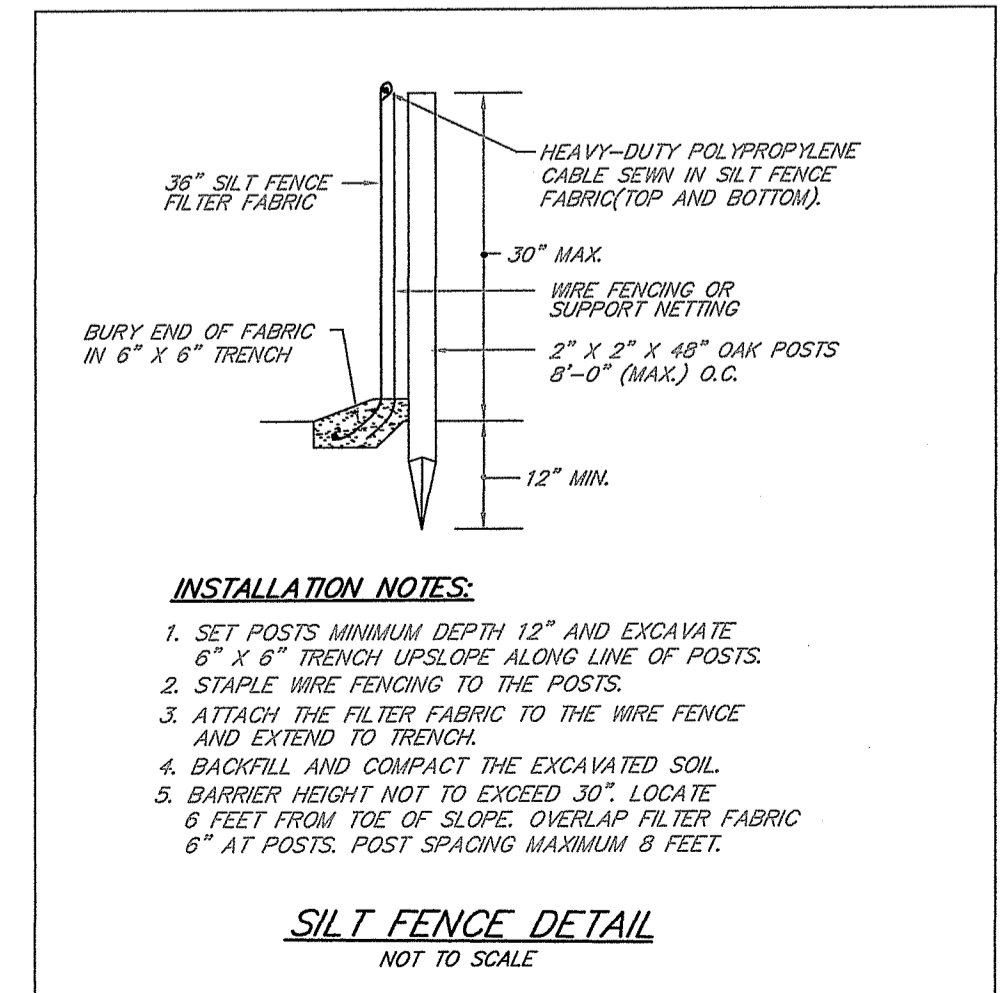

DEPARTMENT OF ENVIRONMENTAL MANAGEMENT
OFFICE OF WATER RESOURCES
FRESHWATER WETLANDS PROGRAM
APPROVED WITH CONDITIONS
AS SPECIFIED IN THE LETTER OF APPROVAL
DATED FEB 25 2020 FILE # 19-0068
NO CHANGES ALLOWED WITHOUT PRIOR APPROVAL

REVISION

DATE

SCOTT F. MOOREHEAD
4298
REGISTERED PROFESSIONAL ENGINEER
12/26/18

APPLICANT
MICHAEL ALLANNEY
174 WINDMILL DRIVE
WAKEFIELD, RI 02879
401-640-3211

PROPOSED LOT DEVELOPMENT
ASSESSOR'S MAP 25 PLAT 15 LOT 181
POLE 3 BATES TRAIL
EAST GREENWICH, RI

SITE CONSTRUCTION DETAILS

S.F.M. ENGINEERING ASSOCIATES
410 TOGUE AVENUE
COVENTRY, RI 02816
PHONE: 401-826-3736
FAX: 401-826-1711
SCOTT.SFM@AOL.COM

SFM

DRN. BY: SFM
CHK. BY: JZL
SCALE: AS NOTED
DATE: DEC. 20, 2018
DWG: SFM860-BATES
SHEET 2 OF 2
WETLAND PERMIT SUBMISSION

C2