

INDEX

SHEET NO.	DESCRIPTION
1	COVER SHEET
2	STANDARD PLAN SYMBOLS & STANDARD LEGEND
3-4	STANDARD NOTES
5	JOB SPECIFIC SYMBOLS, LEGEND & NOTES
6	HIGHWAY GENERAL PLAN
7	BRIDGE PLAN & ELEVATION
8	MISCELLANEOUS DETAILS
9	DRAINAGE & UTILITY PLAN
10	PROFILES
11	HIGHWAY GRADING PLAN
12	MAINTENANCE & PROTECTION OF TRAFFIC & EROSION CONTROL PLAN

STATE OF RHODE ISLAND

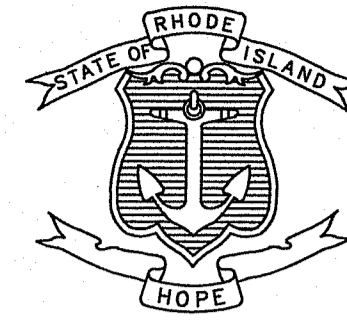

DEPARTMENT OF TRANSPORTATION

PLAN, PROFILE AND SECTIONS OF PROPOSED

STATE HIGHWAY

HAWKINS STREET BRIDGE NO. 796
SUPERSTRUCTURE REPLACEMENT
HAWKINS STREET OVER WEST RIVER

CITY OF PROVIDENCE
COUNTY OF PROVIDENCE

R.I. CONTRACT NO. 2019-CB-071 F.A. PROJECT NO. 405-421-973

PAVEMENT STRUCTURE:

<u>FULL-DEPTH RECONSTRUCTION</u>	<u>PAVEMENT MICROMILLING & OVERLAY</u>
2" MODIFIED CLASS 9.5 HMA	2" MICROMILLING
5" CLASS 19.0 HMA	2" (MINIMUM) MODIFIED CLASS 9.5 HMA
12" GRAVEL BORROW SUBBASE COURSE	

R.I. STANDARD SPECIFICATIONS AND STANDARD DETAILS
SPECIFICATIONS TO GOVERN THIS PROJECT ARE THE R.I. STANDARD SPECIFICATIONS FOR ROAD AND BRIDGE CONSTRUCTION, 2004 EDITION (AMENDED MARCH 2018), WITH ALL REVISIONS, AND THE STATE AND FEDERAL SPECIAL PROVISIONS INCLUDED IN THE CONTRACT DOCUMENTS. STANDARD DETAILS FOR THIS PROJECT ARE R.I. STANDARD DETAILS, 1998 EDITION, WITH ALL REVISIONS AND LATEST CITY OF PROVIDENCE STANDARD DETAILS.

FED. ROAD DIV. NO.	STATE	FEDERAL AID PROJECT NO.	FISCAL YEAR	SHEET NO.	TOTAL SHEETS
	RI	405-421-973		1	12

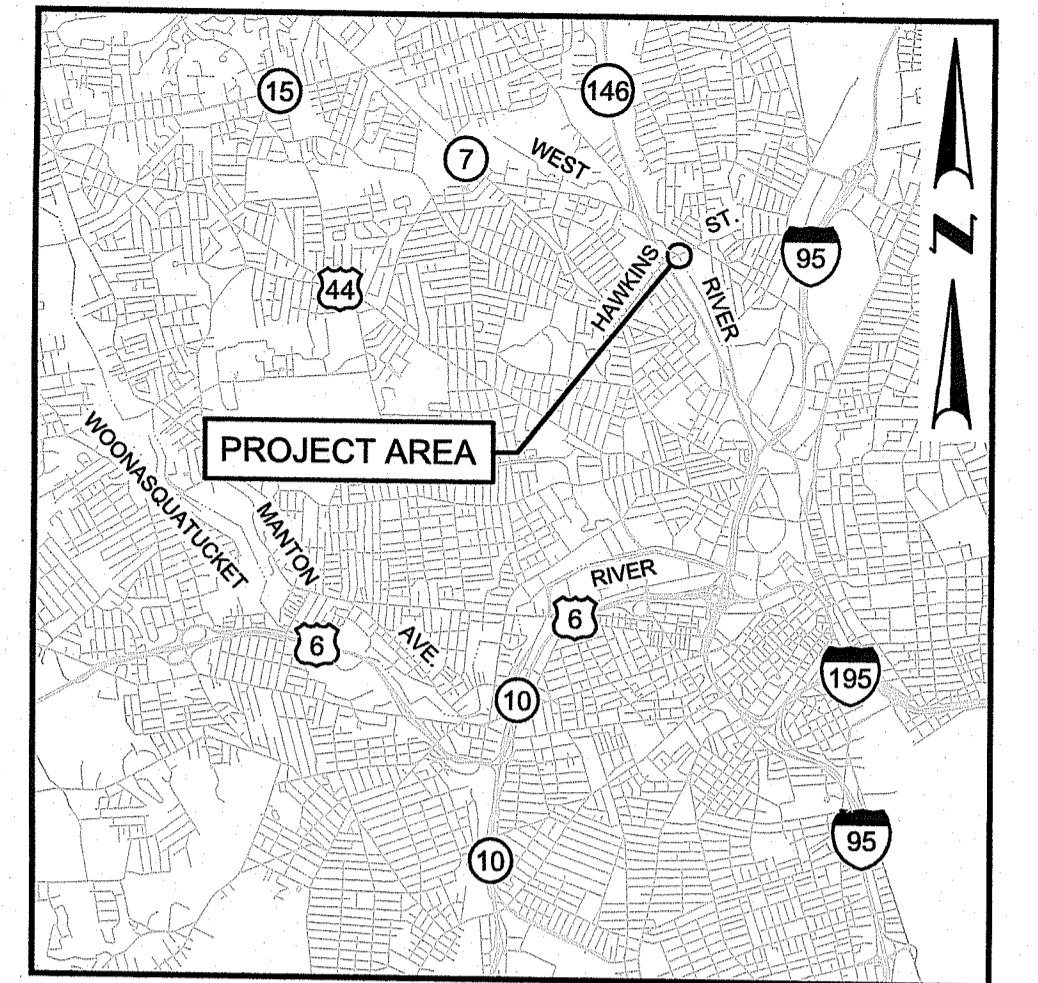

LOCATION MAP
SCALE: 1" = 5,000'

Kindly be advised that this Permit is not equivalent to a verification of the type or extent of freshwater wetlands on site.

Environmental Services
OCT - 7 2019
City of Providence

DESIGN DESIGNATION

<u>HAWKINS STREET</u>	
AA DT (2018)	9,600 V.P.D.
AA DT (2040)	10,200 V.P.D.
D	50/50
K	7%
T	3%
DDHV	357 V.P.H.
DHV	714 V.P.H.
DESIGN SPEED	30 M.P.H.

DEPARTMENT OF ENVIRONMENTAL MANAGEMENT
OFFICE OF WATER RESOURCES
FRESHWATER WETLANDS PROGRAM
APPROVED WITH CONDITIONS
AS SPECIFIED IN THE LETTER OF APPROVAL
DATED JAN 03 2020 FILE # 19-0157
NO CHANGES ALLOWED WITHOUT PRIOR APPROVAL
APPROVED PLANS MUST BE AT CONSTRUCTION SITE

PERMIT SUBMISSION
OCTOBER 1, 2019

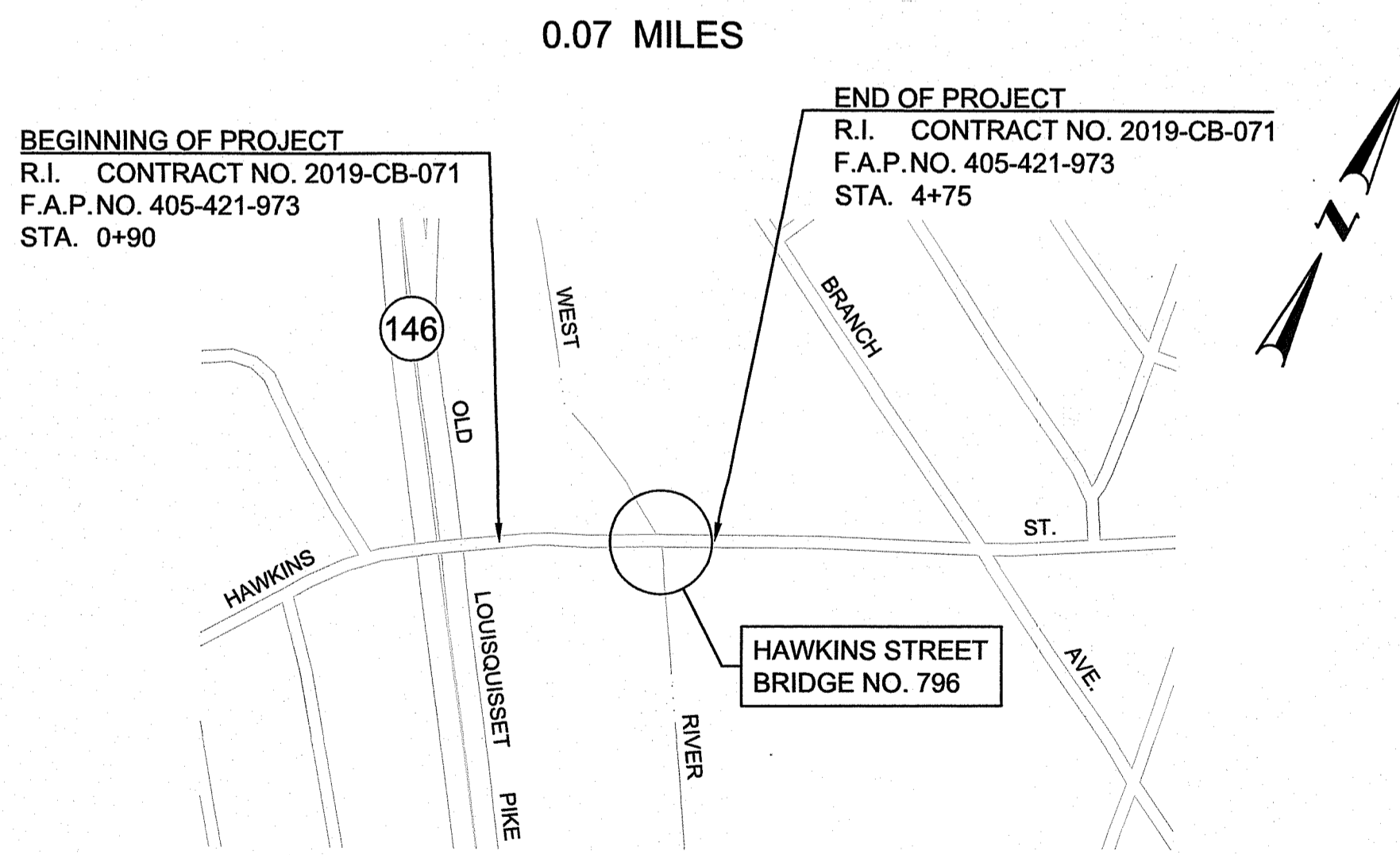

LAYOUT PLAN
SCALE: 1" = 250'

SCALES OF DRAWINGS

Plans	1 inch = 20 feet
Profiles	1 inch = 20 feet Horizontal
Profiles	1 inch = 4 feet Vertical
Cross Sections	1 inch = 4 feet Horizontal
Cross Sections	1 inch = 4 feet Vertical

BASE OF LEVELS
NAVD 88
NAD 83 (2011) (2010.00)

JOHN P. WICKS
No. 6663
REGISTERED PROFESSIONAL ENGINEER (CIVIL)
10/1/2019

wsp
WSP USA Inc.
2374 POST ROAD
SUITE 202
WARWICK, RI 02886
TEL: +1 401.738.6600

Contract Number 2019-CB-071
Number of Sheet 1
Total Sheets 12

R.I. DEPARTMENT OF TRANSPORTATION	
APPROVED	
ADMINISTRATOR, PROJECT MANAGEMENT	DATE
APPROVED	
CHIEF ENGINEER OF INFRASTRUCTURE	DATE
APPROVED	
DIRECTOR	DATE
DEPARTMENT OF TRANSPORTATION FEDERAL HIGHWAY ADMINISTRATION	
APPROVED	
DIVISION ADMINISTRATOR	DATE

LANDSCAPE NOTES:

- ALL PLANT MATERIAL MUST BE TAGGED AT THE NURSERY (A RECOGNIZED GROWER OF PLANT MATERIAL) IN ACCORDANCE WITH THE R.I.D.O.T. STANDARD SPECIFICATIONS, LATEST EDITION. ALL PLANT MATERIAL MUST BE NURSERY GROWN; NO PLANTATION GROWN PLANT MATERIAL WILL BE ACCEPTED.
- ALL PLANT SUBSTITUTIONS AND/OR CHANGES IN PLANT LOCATION MUST BE APPROVED IN ACCORDANCE WITH THE R.I.D.O.T. STANDARD SPECIFICATIONS, LATEST EDITION.
- ALL PLANT MATERIAL IS TO BE FIELD LOCATED BY A REPRESENTATIVE FROM THE R.I.D.O.T. LANDSCAPE ARCHITECTURE UNIT.
- A R.I.D.O.T. LANDSCAPE REPRESENTATIVE MUST BE ON SITE TO APPROVE ALL TRIMMING AND CLEARING NECESSARY TO COMPLETE THE WORK AS SHOWN ON THE PLANS.
- ANY TOPSOIL USED AS PLANTABLE SOIL SHALL HAVE A SANDY LOAM TEXTURE RELATIVELY FREE OF SUBSOIL MATERIAL, STONES, ROOTS, LUMPS OF SOIL, TREE LIMBS, TRASH OR CONSTRUCTION DEBRIS, AND SHALL CONFORM TO SECTION M.18 OF THE R.I.D.O.T. STANDARD SPECIFICATIONS, LATEST EDITION.
- ALL TREES AND SHRUBS SHALL BE MULCHED WITH PINE BARK MULCH IN ACCORDANCE WITH THE R.I.D.O.T. STANDARD SPECIFICATIONS, LATEST EDITION.
- ALL TREES AND/OR SHRUBS THAT ARE PLANTED AS A BED SHALL BE MULCHED AS A BED.
- PROVIDE A MINIMUM 6'-8" BRANCHING STANDARD ON ALL TREES INSTALLED ADJACENT TO SIDEWALKS AND/OR PEDESTRIAN ACCESS AREAS.

STRUCTURAL NOTES FOR HIGHWAY SIGNS, LUMINAIRES AND TRAFFIC SIGNALS:

GENERAL

- ALL SUPPORT DESIGNS AND ASSOCIATED SHOP DRAWING REVIEWS SHALL BE IN CONFORMANCE WITH THE LATEST EDITION, OF THE AASHTO STANDARD SPECIFICATIONS FOR STRUCTURAL SUPPORTS FOR HIGHWAY SIGNS, LUMINAIRES AND TRAFFIC SIGNALS (THE "SPECIFICATIONS"), INCLUDING THE LATEST INTERIM SPECIFICATIONS, EXCEPT AS MODIFIED HEREIN.

CONSTRUCTION DRAWINGS AND DETAILS

- THE FOLLOWING NOTES SHALL BE INCLUDED ON ALL PLANS AND/OR SHOP DRAWINGS IN REFERENCE TO ANCHOR BOLTS:
 - "PRETENSIONING OF ALL ANCHOR NUTS IS REQUIRED, AND SHALL BE ACCOMPLISHED BY TIGHTENING TO 1/6TH TURN BEYOND THE SNUG-TIGHT POSITION."
 - "THE MAXIMUM CLEARANCE BETWEEN THE BOTTOM OF THE LEVELING NUTS AND THE TOP OF THE CONCRETE IS CRITICAL AND SHALL NOT EXCEED THE AMOUNT SPECIFIED ON THIS DRAWING."
- THE USE OF GROUT UNDER BASE PLATES SHALL GENERALLY NOT BE PERMITTED. IF SPECIFIC CONDITIONS WARRANT ITS USE, THE GROUT SHALL NOT BE CONSIDERED LOAD CARRYING; LOADS SHALL BE DIRECTLY SUPPORTED BY THE ANCHOR BOLTS. ADEQUATE DRAINAGE SHALL BE PROVIDED.
- THE DAMPENING EFFECTS OF VIBRATION MITIGATION DEVICES SHALL NOT BE CONSIDERED IN THE DESIGN OF STRUCTURAL SUPPORTS FOR SIGNS AND TRAFFIC SIGNALS. IF THE CONTRACTOR CHOOSES TO USE THESE DEVICES FOR WARRANTY PURPOSES, THE TYPE OF DEVICES PROPOSED SHALL BE APPROVED BY THE DEPARTMENT PRIOR TO FABRICATION OF SUPPORTS.

TRAFFIC SIGNAL NOTES:

- ALL SALVAGED TRAFFIC SIGNAL EQUIPMENT SHALL BE DELIVERED TO THE R.I.D.O.T. MAINTENANCE HEADQUARTERS, 360 LINCOLN AVENUE, WARWICK, RHODE ISLAND, 02888.
- BACK PLATES SHALL BE INSTALLED ON ALL TRAFFIC SIGNAL HEADS.
- THE CONTRACTOR SHALL SUPPLY AND INSTALL ON THE UPPER LEFT HAND CORNER OF THE BACK OF THE CONTROLLER CABINET DOOR A LAMINATED INTERSECTION GRAPHIC AND TABLE DEPICTING THE TRAFFIC DETECTOR RELAY CHANNEL ASSIGNMENTS. THE DIAGRAM SHALL BE A GRAPHIC OF THE INDIVIDUAL INTERSECTION ORIENTED SIMILAR TO THE PLANS SHOWING THE LOCATIONS OF EACH OF THE LOOP DETECTORS. THE DIAGRAM SHALL, AT A MINIMUM, INCLUDE DETECTOR NUMBERS, STREET NAME LABELS, NORTH ARROW, AND CONTROLLER CABINET LOCATION. THE ASSIGNMENT INFORMATION SHALL BE INCLUDED IN A TABLE WHICH SHALL INCLUDE, AT A MINIMUM, THE APPROACH NAME, DETECTOR NUMBER, TERMINAL NUMBER, DETECTOR RACK SLOT NUMBER, RELAY NUMBER, RELAY CHANNEL NUMBER, AND PHASE ASSOCIATED WITH EACH DETECTOR.
- TRAFFIC CONTROLLER CABINETS, UNLESS OTHERWISE NOTED, SHALL BE NEMA TS2 TYPE 1 CABINET SIZE 6 ("P" TYPE) WITH NOMINAL DIMENSIONS OF 52"Hx44"Wx24"D.
- ALL DELAY AND EXTENSION TIMES, AS CALLED FOR ON THE PLANS, FOR PROPOSED LOOP DETECTORS SHALL BE PROGRAMMED IN THE TRAFFIC SIGNAL CONTROLLER AND NOT THE DETECTOR RELAY.
- A BARE GROUND WIRE SHALL BE PLACED IN ALL PVC CONDUITS AND SHALL BE BONDED TO GROUND RODS IN ACCORDANCE WITH SECTION T.03 OF THE RHODE ISLAND DEPARTMENT OF TRANSPORTATION STANDARD SPECIFICATIONS FOR ROAD AND BRIDGE CONSTRUCTION.
- THE FINAL POSITION OF SIGNAL HEADS, PEDESTRIAN PUSHBUTTONS, DETECTORS, AND STOP LINE AND CROSSWALK PAVEMENT MARKINGS SHALL BE AS DIRECTED BY THE ENGINEER IN THE FIELD ACCORDING TO ACTUAL INTERSECTION CHARACTERISTICS.
- A 2' MINIMUM BUFFER SHALL BE PROVIDED BETWEEN THE CURB AND ALL LATERAL OBSTRUCTIONS (INCLUDING ALL SIGNAL POLES AND TRAFFIC/PEDESTRIAN SIGNAL HEADS) TO PROVIDE ADEQUATE CLEARANCE FOR TURNING VEHICLES.
- ALL FOUNDATIONS MUST HAVE CONES OR BARRELS BOLTED TO FOUNDATION BASES UNTIL ACTUAL POLE IS INSTALLED.
- WHEN PLACING TRAFFIC SIGNAL HANDHOLES OR CONDUIT IN EXISTING PORTLAND CEMENT CONCRETE SIDEWALKS, THE ENTIRE SIDEWALK SQUARE OF CONCRETE SHALL BE REPLACED IN ACCORDANCE WITH R.I. STD. 43.1.0. NO PATCHES WILL BE ALLOWED.
- ALL PEDESTRIAN PUSHBUTTONS SHALL BE COMPLIANT WITH "THE AMERICANS WITH DISABILITIES ACT ACCESSIBILITY GUIDELINES FOR BUILDINGS AND FACILITIES" (ADAAG) AND SHALL INCLUDE A PRESSURE-ACTIVATED (NON-MOVING) BUTTON. SIGNS APPLICABLE TO PUSHBUTTON ACTUATION SHALL BE INSTALLED SUCH THAT THE CROSSING ASSIGNED TO EACH BUTTON IS CLEARLY INDICATED. IF SITE CONDITIONS DO NOT ALLOW PEDESTRIAN PUSHBUTTONS TO BE INSTALLED WHERE CALLED FOR ON THE PLANS, THE R.I.D.O.T. TRAFFIC ENGINEERING UNIT SHALL BE CONSULTED WITH THROUGH AN R.F.I. PRIOR TO INSTALLING THE PUSHBUTTONS. THE FINAL PLACEMENT OF ALL PEDESTRIAN PUSHBUTTONS SHALL BE IN ACCORDANCE WITH ADAAG AND THE MANUAL ON UNIFORM TRAFFIC CONTROL DEVICES, LATEST EDITION.
- ALL LOOP DETECTORS SHALL BE CENTERED WITHIN EACH LANE AS DELINEATED, UNLESS OTHERWISE DIMENSIONED ON PLANS.
- ALL LOOP DETECTORS SHALL BE CUT INTO THE FINAL PAVEMENT SURFACE COURSE.
- TRAFFIC SIGNAL CONTROLLERS SHALL BE WIRED SO THAT ANY FIRE PRE-EMPTION SHALL OVERRIDE MANUAL (PUSH BUTTON) OPERATION.
- THE CONTRACTOR SHALL WORK CONTINUOUSLY TO RESTORE TRAFFIC SIGNAL OPERATION TO ITS INTENDED PURPOSE WHEN REPLACING THE TRAFFIC SIGNAL EQUIPMENT. A POLICE DETAIL IS REQUIRED TO DIRECT TRAFFIC AT THE INTERSECTION AT ALL TIMES WHEN THE TRAFFIC SIGNAL IS INOPERATIVE. AT NO TIME SHALL THE CONTRACTOR LEAVE THE SITE BEFORE RESTORING FULL TRAFFIC OPERATIONS.

MAINTENANCE AND PROTECTION OF TRAFFIC NOTES:

ALL MAINTENANCE AND PROTECTION OF TRAFFIC CONTROL SETUPS, SIGNS, CHANNELIZING DEVICES, ETC., SHALL BE IN ACCORDANCE WITH THE MANUAL ON UNIFORM TRAFFIC CONTROL DEVICES, LATEST EDITION.

ALL SIGN MOUNTINGS FOR TEMPORARY AND CONSTRUCTION SIGNS SHALL BE IN ACCORDANCE WITH THE R.I.D.O.T. STANDARD SPECIFICATIONS, LATEST EDITION.

THE CONTRACTOR SHALL COVER ALL EXISTING AND/OR TEMPORARY SIGNS ADVISED THAT THIS PERMIT IS NOT EQUIVALENT TO A VERIFICATION OF THE TYPE OR EXTENT OF ANY WETLANDS OR WETLANDS ON SITE.

ADVANCE FLAGPERSON SIGNS (W20-7A) SHALL BE USED IN ADVANCE OF ANY POINT AT WHICH A FLAGPERSON OR A POLICE OFFICER HAS BEEN STATIONED TO CONTROL TRAFFIC. WHEN NEEDED, AN APPROPRIATE DISTANCE MESSAGE MAY BE DISPLAYED ON A SUPPLEMENTAL PLATE (24"x18") BELOW THE FLAGPERSON SYMBOL SIGN. THE SIGN SHALL BE PROMPTLY REMOVED OR COVERED WHENEVER THE FLAGPERSON IS NOT AT THE STATION.

POLICE OFFICERS (AND NOT FLAGPERSONS) SHALL BE UTILIZED WHEN WORK WILL IMPACT SIGNALIZED INTERSECTIONS AND LIMITED ACCESS HIGHWAYS.

POLYETHYLENE DRUMS SHALL BE UTILIZED AS A CHANNELIZING DEVICE WHEN A TRAFFIC CONTROL SET-UP IS TO REMAIN BEYOND WORKING HOURS WHEN NO WORKERS ARE PRESENT. CONES SHALL BE UTILIZED WHEN A TRAFFIC CONTROL SET-UP IS TO REMAIN ONLY DURING WORKING HOURS AND IS SUBSEQUENTLY BROKEN DOWN AT THE END OF THE WORKDAY.

ARROW PANELS SHALL BE SET IN THE FLASHING FOUR CORNERS CAUTION MODE UNLESS UTILIZED FOR A MERGING TAPER. ARROW PANELS SET IN THE FLASHING ARROW MODE SHALL NOT BE UTILIZED FOR LANE SHIFTS.

TEMPORARY CONSTRUCTION SIGNS AND OTHER WORKZONE TRAFFIC CONTROL DEVICES THAT ARE DAMAGED OR REQUIRE RELOCATION SHALL BE REPLACED AND / OR RELOCATED UNDER THE PAY ITEM FOR "MAINTENANCE AND MOVEMENT TRAFFIC PROTECTION."

THE PRIVATE VEHICLES OF CONSTRUCTION WORKERS SHALL NOT BE PARKED ON THE TRAVEL LANES OR SHOULDERS. THEY MAY BE PARKED WITHIN THE STATE RIGHT-OF-WAY ONLY IN AREAS 30' BEYOND THE OUTSIDE EDGE OF THE TRAVEL LANES AND/OR IN AREAS APPROVED BY THE ENGINEER.

TEMPORARY CONSTRUCTION SIGNS AND OTHER TEMPORARY TRAFFIC CONTROL DEVICES SHALL BE INSTALLED PRIOR TO THE START OF WORK IN ANY AREA OPEN TO TRAFFIC, AND SHALL BE REMOVED AS SOON AS PRACTICAL WHEN THEY ARE NO LONGER APPROPRIATE.

THE INTENDED VEHICLE PATHS THROUGH EACH WORK ZONE SHALL BE CLEARLY MARKED AT ALL TIMES. WATERBORNE PAVEMENT MARKINGS SHALL BE INSTALLED BEFORE THE END OF THE WORK SHIFT ON ALL COLD-PLANNED AND NEW ROADWAY SURFACES THAT WILL BE OPENED TO TRAFFIC AT THE END OF THE SHIFT.

DEPARTMENT OF ENVIRONMENTAL MANAGEMENT
 OFFICE OF WATER RESOURCES
 FRESHWATER WETLANDS PROGRAM
 APPROVED WITH CONDITIONS
 AS SPECIFIED IN THE LETTER OF APPROVAL
 DATED JAN 03 2010 FILE # 19-0157
 NO CHANGES ALLOWED WITHOUT PRIOR APPROVAL
 APPROVED PLANS MUST BE AT CONSTRUCTION SITE

Environmental Management
 OCT - 7 2009
 Office of Water Resources

THIS PLAN SHALL NOT BE ALTERED

REVISIONS			RHODE ISLAND	
NO.	DATE	BY	DEPARTMENT OF TRANSPORTATION	
1	4/07	TRB	PLANS FOR BRIDGE REPLACEMENT	
2	11/07	TRB	BRIDGE NO. 796	
3	3/10	RBH	PROVIDENCE, RHODE ISLAND	
			STANDARD NOTES - 2	
			CHECKED BY _____ DATE _____ SCALE NO. SCALE	

wsp
 WSP USA Inc.
 2374 POST ROAD
 SUITE 202
 WARWICK, RI 02886
 TEL: +1 401.738.6600

JOB SPECIFIC LEGEND

- (4.7.2) ALTERNATE TOP COVER FOR ROUND PRECAST MANHOLES AND CATCH BASINS
- (6.1.1P) SIDEWALK MANHOLE FRAME AND COVER – PROVIDENCE STANDARD
- (6.2.1P) HEAVY DUTY MANHOLE FRAME AND COVER-24 INCH – PROVIDENCE STANDARD
- (6.3.0P) STANDARD CAPACITY GRATE – PROVIDENCE STANDARD
- (7.3.0P)^{S,C} GRANITE CURB-STRAIGHT AND CIRCULAR – PROVIDENCE STANDARD
- (7.3.2M) 6'-0" GRANITE CURB TRANSITION – MODIFIED
- (7.3.3P) GRANITE WHEELCHAIR RAMP TRANSITION CURB – PROVIDENCE STANDARD
- (7.3.4P) GRANITE 2'-0" RADIUS CURB RETURN – PROVIDENCE STANDARD
- (7.3.8P) GRANITE APRON STONE-30 INCH OPENING – PROVIDENCE STANDARD
- (7.6.0P) CURB SETTING DETAIL – PROVIDENCE STANDARD
- (26.3.1) PLASTIC PIPE TYPE III BARRICADE
- (34.3.5) GUARDRAIL CONNECTION TO EXISTING END POST APPROACH END SECTION
- (34.3.6) GUARDRAIL CONNECTION TO EXISTING END POST TRAILING END SECTION
- (43.1.0P) CEMENT CONCRETE SIDEWALK – PROVIDENCE STANDARD
- (43.5.0P) CEMENT CONCRETE DRIVEWAY – PROVIDENCE STANDARD
- (60.1.0P) TEMPORARY ROADWAY RESTORATION – PROVIDENCE STANDARD
- (60.2.0P) PERMANENT ROADWAY RESTORATION – GRANULAR BASE – PROVIDENCE STANDARD
- (60.4.0P) INLET/APRON STONE REVEAL – PROVIDENCE STANDARD
- (ABNM) ABANDON MANHOLE
- (BCDM) BITUMINOUS CONCRETE DRIVEWAY – MODIFIED
3" CLASS 9.5 HMA
8" GRAVEL BORROW SUBBASE COURSE
- (CFS) COMPOST FILTER SOCK 12 INCH DIAMETER
- (DGC) REMOVE AND DISPOSE GRANITE CURB
- (DGC1) REMOVE AND DISPOSE GRANITE CURB INLET
- (DT) REMOVE AND DISPOSE TREE
- (DUP*) REMOVE AND DISPOSE UTILITY POLE (BY OTHERS)
- (ETR) EXISTING TO REMAIN
- (FDC) 2" MODIFIED CLASS 9.5 HMA
5" CLASS 19.0 HMA
12" GRAVEL BORROW SUBBASE COURSE
- (MEPM) MATCH EXISTING PAVEMENT MARKING
- (MMO-2) MICROMILLING 2" AND OVERLAY WITH 2" MODIFIED CLASS 9.5 HMA PAVEMENT SHIMMING WITH CLASS 4.75 HMA FOR LEVELING AS REQUIRED TO MEET PROPOSED GRADES
- (NUP) NEW UTILITY POLE (BY OTHERS)
- (PCP) PLUG AND CAP PIPE
- (PMM) PAVEMENT MILLINGS MULCH
- (PT-1) PAVEMENT TRANSITION – MICROMILLING TO EXISTING
- (PT-2) PAVEMENT TRANSITION – FULL DEPTH TO MICROMILLING
- (PT-3) PAVEMENT TRANSITION – FULL DEPTH PAVEMENT TO EXISTING
- (RRP) RIPRAP PAD
- (S-1) FULL DEPTH SAWCUT OF BITUMINOUS PAVEMENT
- (S-2) CUTTING AND MATCHING ASPHALT
- (S-3) FULL DEPTH SAWCUT OF PORTLAND CEMENT CONCRETE SIDEWALK/DRIVEWAY
- (TGW) TEMPORARY GUY WIRE (BY OTHERS)
- (TOW) TEMPORARY OVERHEAD WIRE (BY OTHERS)
- (TPP) TEMPORARY PUSH POLE (BY OTHERS)
- (TUP) TEMPORARY UTILITY POLE (BY OTHERS)
- (12Y) 12" EPOXY RESIN PAVEMENT MARKINGS – YELLOW

JOB SPECIFIC GENERAL NOTES:

1. CONSTRUCTION INDICATED ON THESE PLANS SHALL BE IN ACCORDANCE WITH:
 - THE LATEST REVISION OF AND MODIFICATIONS TO THE RHODE ISLAND DEPARTMENT OF TRANSPORTATION STANDARD SPECIFICATIONS FOR ROAD AND BRIDGE CONSTRUCTION.
 - THE EIGHTH EDITION OF AND MODIFICATIONS TO THE LRFD BRIDGE DESIGN SPECIFICATIONS OF THE AMERICAN ASSOCIATION OF STATE HIGHWAY AND TRANSPORTATION OFFICIALS DATED 2017.
 - THE INSTALLATION OF ALL GRANITE CURBING AND CONCRETE SIDEWALKS SHALL BE DONE IN ACCORDANCE WITH ANY APPLICABLE CITY OF PROVIDENCE STANDARDS AND THE SPECIAL PROVISIONS ACCOMPANYING THESE PLANS.
 - THE SPECIFICATIONS ACCOMPANYING THESE PLANS.
- IN CASE OF CONFLICT, THE SPECIAL PROVISIONS OF THE SPECIFICATIONS ACCOMPANYING THESE PLANS SHALL GOVERN IN ALL CASES.
2. ALL SUBCONTRACTORS EMPLOYED BY THE CONTRACTOR OR RIDOT ON THIS PROJECT SHALL WORK WITHIN THE SAME PROTECTED WORK AREAS AS THE CONTRACTOR. NO SEPARATE LANE CLOSURES WILL BE PAID FOR.
3. STOCKPILING OF DEMOLISHED MATERIALS WILL NOT BE ALLOWED ON STATE OR CITY PROPERTY OVERNIGHT UNLESS APPROVED BY THE RESIDENT ENGINEER IN COORDINATION WITH THE RIDOT LANDSCAPE DEPARTMENT. IF ANY STOCKPILING OF MATERIAL IS ALLOWED, THE CONTRACTOR WILL REPAIR THE AREA AT NO ADDITIONAL COST TO THE STATE.
4. SANITARY SEWER, GAS, WATER AND OTHER UTILITY SERVICES SHALL BE MAINTAINED AT ALL TIMES DURING CONSTRUCTION.
5. ALL GUARDRAIL REMOVED SHALL BE REPLACED BY THE END OF THAT WORKING DAY IF THE LOCATION IS NOT SHIELDED BY A TEMPORARY PRECAST CONCRETE BARRIER FROM ALL TRAFFIC.
6. THE CONTRACTOR SHALL EXERCISE EXTREME CARE WHEN REPLACING GUARDRAIL IN AREAS NEAR EXISTING CURBING AND SIDEWALKS TO REMAIN. NO PAYMENT SHALL BE MADE TO RESET CURB DISTURBED BY THE CONTRACTOR'S OPERATION WHEN INSTALLING GUARDRAIL. CURB DAMAGED BY THE CONTRACTOR SHALL BE REPLACED AT NO COST TO THE STATE.
7. THE COST OF ANY CURB CUTTING REQUIRED TO INSTALL NEW CURBING WILL BE INCLUDED IN THE UNIT BID PRICES FOR THE NEW CURB.
8. IT IS THE CONTRACTOR'S RESPONSIBILITY TO ENSURE THAT ALL RELOCATED UTILITY POLES AND GUY WIRES ARE PROPERLY STABILIZED DURING EACH PHASE OF CONSTRUCTION.
9. THE FINAL LOCATION OF ALL WHEELCHAIR RAMPS MUST BE COORDINATED, IN THE FIELD, WITH THE PROPOSED LOCATIONS OF SIGNS, UTILITY POLES, LANDSCAPING, HYDRANTS, DRAINAGE GRATES AND COVERS TO ENSURE A CLEAR PEDESTRIAN PATH.
10. THE CONTRACTOR SHALL BE RESPONSIBLE TO COORDINATE WITH THE PROPER UTILITY AGENCIES FOR THE SEQUENCE OF CONSTRUCTION TO REMOVE ANY EXISTING LIGHTING AND THE INSTALLATION OF NEW LIGHTING. STREET AND SIDEWALK LIGHTING MUST BE PROVIDED AT ALL TIMES IN AREAS THAT REMAIN OPEN TO TRAFFIC.
11. THE CONTRACTOR SHALL NOT STORE EQUIPMENT OR MATERIALS WITHIN THE DRIP LINE OF ANY TREES OR SHRUBS.
12. ALL ITEMS NOT LABELED WITH A DISPOSITION WILL BE "EXISTING TO REMAIN" UNLESS OTHERWISE DIRECTED BY THE ENGINEER.
13. THE CONTRACTOR SHALL PLACE ALL EQUIPMENT AND STOCKPILED MATERIAL A MINIMUM DISTANCE OF AND 10 FEET FROM THE OUTSIDE EDGE OF ANY TRAVEL LANE SO AS NOT TO CAUSE A SAFETY HAZARD. ALL STORAGE AND LAYDOWN AREAS REQUIRE APPROVAL BY THE ENGINEER. ALL WORK ZONES SHALL BE BEHIND BARRIERS AS SHOWN ON THE MAINTENANCE AND PROTECTION OF TRAFFIC PLANS. ANY AREAS USED FOR STORAGE AND LAYDOWN THAT ARE OUTSIDE THE LIMITS OF DISTURBANCE SHOWN ON THE PLANS SHALL BE RESTORED TO THEIR ORIGINAL CONDITION AT THE CONTRACTOR'S EXPENSE.
14. THE FREQUENCY AND APPLICATION RATES FOR WATER FOR DUST CONTROL SHALL BE DETERMINED BY THE ENGINEER, PAID FOR UNDER ITEM CODE 907.0100. NO CALCIUM CHLORIDE FOR DUST CONTROL SHALL BE USED ON THIS PROJECT.
15. THE CONTRACTOR SHALL EXERCISE CARE WHEN WORKING IN THE AREA OF EXISTING HIGHWAY BOUNDS. ANY HIGHWAY BOUNDS DISTURBED OR DESTROYED AS A RESULT OF THE CONTRACTOR'S ACTIONS SHALL BE RESET OR REPLACED BY THE CONTRACTOR AS DIRECTED BY THE ENGINEER AND IN CONFORMANCE WITH SECTION 915. OF THE R.I. STANDARD SPECIFICATIONS. SAID RESETTING OR REPLACING OF BOUND REQUIRED SHALL BE AT THE CONTRACTOR'S EXPENSE.
16. NO LONGITUDINAL DROP-OFFS WILL BE ALLOWED TO REMAIN BETWEEN LANES DURING THE NON CONSTRUCTION HOURS FOR PAVEMENT MICROMILLING OPERATIONS. THE CONTRACTOR SHALL SCHEDULE THE MICROMILLING OPERATIONS TO PROVIDE A CONSISTENT FULL-WIDTH PAVEMENT SURFACE AT THE END OF THE WORK DAY.

JOB SPECIFIC GENERAL NOTES - DRAINAGE & UTILITY:

1. ALL EROSION CONTROL MEASURES SHALL BE PUT IN PLACE PRIOR TO COMMENCING WORK.
2. FRAMES, GRATES, COVERS AND CURB INLETS SHALL CONFORM TO ALL APPLICABLE CITY OF PROVIDENCE STANDARDS.
3. ALL PROPOSED DRAINAGE PIPE SHALL BE REINFORCED CONCRETE PIPE UNLESS NOTED OTHERWISE.
4. ALL REINFORCED CONCRETE PIPE SHALL BE AASHTO CLASS III WITH MORTAR JOINTS UNLESS OTHERWISE NOTED.
5. ALL EXISTING DRAIN PIPES, CATCH BASINS, AND DRAIN MANHOLES TO REMAIN WITHIN THE PROJECT LIMITS ARE TO BE CLEANED AS NEEDED IN ACCORDANCE WITH THE SPECIFICATIONS OR AS DIRECTED BY THE ENGINEER.
6. EXISTING PIPE INVERT ELEVATIONS SHOWN ON THE DRAINAGE AND UTILITY PLANS ARE APPROXIMATE.
7. THE CONTRACTOR SHALL COORDINATE THE ADJUSTMENT OF ANY SEWER MANHOLE FRAMES AND COVERS WITH THE CITY OF PROVIDENCE HIGHWAY AND SEWER DEPARTMENT.
8. ANY DRAINAGE STRUCTURES NEEDING TO BE RECONSTRUCTED SHALL BE RECONSTRUCTED PRIOR TO PLACING ANY TEMPORARY TRAFFIC OVER THAT STRUCTURE.
9. DRAINAGE STRUCTURES TO BE ABANDONED SHALL BE FILLED WITH FLOWABLE-EXCAVATABLE CONTROLLED LOW STRENGTH MATERIAL. CONTROLLED LOW STRENGTH MATERIAL SHALL EXTEND TO THE BOTTOM OF THE GRAVEL SUBBASE. THE FRAME AND COVER OR GRATE AS WELL AS ANY BRICKS PRESENT ABOVE THE TOP OF THE STRUCTURE SHALL BE REMOVED. IF THE STRUCTURE IS LOCATED WITHIN THE LIMITS OF PROPOSED MICROMILLING AND OVERLAY, A 12" GRAVEL SUBBASE SHALL BE PLACED AND COMPACTED UP TO THE BOTTOM OF THE EXISTING PAVEMENT. NEW PAVEMENT SHALL BE PLACED TO THE PROPOSED GRADES.
10. DRAINAGE PIPES TO BE ABANDONED SHALL BE CAPPED AT EACH END AND SHALL BE FILLED WITH FLOWABLE-EXCAVATABLE CONTROLLED LOW STRENGTH MATERIAL.
11. A RADIAL CLEARANCE OF THREE FEET (3') MUST BE MAINTAINED BETWEEN NATIONAL GRID'S AERIAL EQUIPMENT (CABLES, TERMINALS, POLES, ETC) IN ACCORDANCE WITH THE NATIONAL ELECTRICAL CODE (NEC) AND THE OCCUPATIONAL SAFETY AND HEALTH ADMINISTRATION (OSHA) REQUIREMENTS. THIS INCLUDES TRAFFIC SIGNAL AND CONSTRUCTION EQUIPMENT. EITHER TEMPORARY OR PERMANENT. PLEASE REFER TO RIDOT DOCUMENT TAC-0049 FOR ADDITIONAL INFORMATION.
12. ALL PROPOSED CATCH BASINS SHALL BE CONSTRUCTED WITH A DEEP (4'-0") SUMP. OUTLET PIPES FOR DEEP SUMP CATCH BASINS SHALL BE EQUIPPED WITH PIPE HOODS.
13. THE CONTRACTOR SHALL COORDINATE REMOVAL AND RESETTING OF CITY OWNED STREET LIGHTING WITH THE CITY OF PROVIDENCE DPW.
14. ROADWAY PAVEMENT AT CURB INLETS SHALL BE GRADED IN ACCORDANCE WITH CITY OF PROVIDENCE STANDARD 60.4.0P.
15. FOR PIPES OR CONDUITS REMOVED OR INSTALLED WITHIN AREAS OF EXISTING ROADWAY TO REMAIN, THE CONTRACTOR SHALL RESTORE THE PAVEMENT IN ACCORDANCE WITH CITY OF PROVIDENCE STANDARD 60.2.0P. FOR PIPES OR CONDUITS INSTALLED WITHIN THE ROADWAY, TEMPORARY RESTORATION OF THE PAVEMENT SHALL BE IN ACCORDANCE WITH CITY OF PROVIDENCE STANDARD 60.1.0P.
16. THE CONTRACTOR SHALL EMPLOY THE SERVICES OF A PROFESSIONAL ENGINEER REGISTERED IN RHODE ISLAND OF THE APPROPRIATE DISCIPLINE TO DESIGN THE TEMPORARY AND PERMANENT WATER MAIN SYSTEM IN THE LOCATIONS SHOWN ON THE PLANS. A COMPLETE SET OF CALCULATIONS AND 24"x36" DRAWINGS ARE TO BE PROVIDED FOR REVIEW AND APPROVAL OF THE PWSB. THE COST OF THE DESIGN AND DETAILING OF THE WATER MAIN SYSTEM IS CONSIDERED INCIDENTAL TO THE VARIOUS ITEMS THAT COMPRISE THE WATER MAIN (SEE JOB SPECIFIC SPECIFICATION SECTION 715 FOR FURTHER INFORMATION).
17. THE CONTRACTOR SHALL SALVAGE ALL EXISTING DRAINAGE INLETS, APRONS, FRAMES, GRATES AND COVERS FROM STRUCTURES SCHEDULED TO BE REMOVED IN ACCORDANCE WITH THESE PLANS. SALVAGED ITEMS SHALL BE DELIVERED TO THE CITY OF PROVIDENCE DEPARTMENT OF PUBLIC WORKS SEWER DEPARTMENT LOCATED AT 700 ALLENS AVENUE, PROVIDENCE, RI 02905. THE CONTRACTOR SHALL COORDINATE DELIVERY WITH THE DPW AT 401-680-7500. ITEMS NOT DEEMED SALVAGEABLE BY THE DPW SHALL BECOME THE PROPERTY OF THE CONTRACTOR AND SHALL BE DISPOSED OF PROPERLY AT THE CONTRACTOR'S EXPENSE.

JOB SPECIFIC GENERAL NOTES - SIGNS:

1. ALL NEW AND RELOCATED SIGN POSTS SHALL BE MOUNTED 18" FROM THE BACK OF CURB OR LOCATED AS DIRECTED BY THE ENGINEER
2. ALL SIGNS AND PAVEMENT MARKINGS SHALL CONFORM TO THE R.I. STANDARD DETAIL DRAWINGS AND THE MANUAL ON UNIFORM TRAFFIC CONTROL DEVICES 2009 EDITION WITH THE LATEST REVISIONS.

JOB SPECIFIC GENERAL NOTES - PAVEMENT MARKINGS

PERMANENT PAVEMENT MARKINGS:

1. THE INSTALLATION OF PERMANENT PAVEMENT MARKINGS WILL NOT BE ALLOWED TO BE OR EXTEND PRIOR TO THE COMPLETE PLACEMENT OF THE FINAL RIDING SURFACE WITHIN THE PROJECT LIMIT.
2. PERMANENT PAVING MARKINGS SHALL BE WHITE AND YELLOW EPOXY RESIN PAVEMENT MARKINGS AT THE LOCATIONS INDICATED ON THE PLANS. THE EPOXY PAVEMENT MARKINGS SHALL BE PLACED ON THE FINAL SURFACE COURSE NO SOONER THAN 2 WEEKS, BUT NO LATER THAN 4 WEEKS FROM THE COMPLETION OF PAVING OPERATION.

Permit is not equivalent to a
 Permit to excavate that this
 will not be allowed to be or extend
 of freshwater wetlands on site.

JOB SPECIFIC GENERAL NOTES - SITE RESTORATION:

1. ALL PUBLIC AND PRIVATE PROPERTY WITHIN OR ADJACENT TO THE PROJECT LIMITS DISTURBED BY THE CONTRACTOR'S OPERATIONS SHALL BE RESTORED TO ITS PRE-CONSTRUCTION CONDITION BY THE CONTRACTOR TO THE SATISFACTION OF THE ENGINEER. ALL RESTORATION SHALL BE IN ACCORDANCE WITH THE APPLICABLE PROVISIONS OF THE R.I. STANDARD SPECIFICATION FOR ROAD AND BRIDGE CONSTRUCTION 2004 EDITION WITH AMENDMENTS. THE COST OF RESTORATION SHALL BE INCLUDED IN THE PRICES BID FOR OTHER SCHEDULED ITEMS OF WORK AND NO SEPARATE PAYMENT SHALL BE MADE.

JOB SPECIFIC GENERAL NOTES - SURVEY:

1. PRIOR TO THE REMOVAL OF ANY EXISTING ROADWAY OR CURBING, THE CONTRACTOR MUST COORDINATE WITH THE RESIDENT ENGINEER AND THE RIDOT SURVEY SECTION. CONSTRUCTION LAYOUT SHALL BE PERFORMED BY THE CONTRACTOR.
2. SURVEY TRAVERSE FOR THE LOCATION OF BRIDGE NO. 796 WAS PERFORMED BY WSP IN APRIL 2018. RAILROAD SPIKES SET ARE FOR TEMPORARY CONTROL AND SHALL BE VERIFIED PRIOR TO CONSTRUCTION LAYOUT USE.

TYPICAL SIGN DESIGNATION SYMBOL

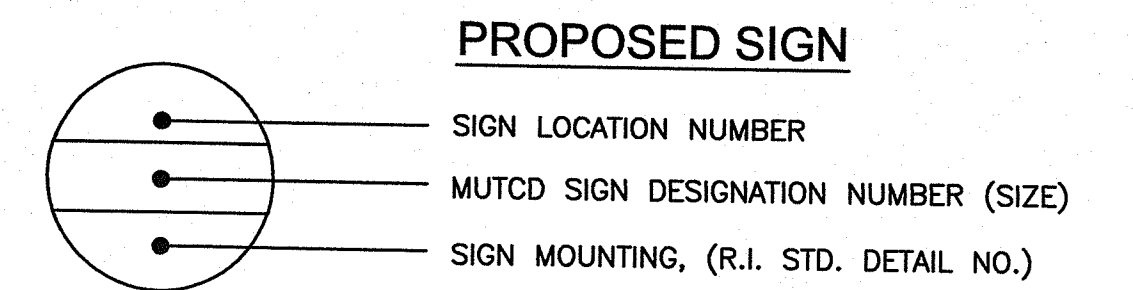

PROPOSED SIGN

Environmental Management
 OCT - 7 2019
 Office of Water Resources

DEPARTMENT OF ENVIRONMENTAL MANAGEMENT
 OFFICE OF WATER RESOURCES
 FRESHWATER WETLANDS PROGRAM
 APPROVED WITH CONDITIONS
 AS SPECIFIED IN THE LETTER OF APPROVAL
 DATED JAN 03 2020 FILE # 19-0151
 NO CHANGES ALLOWED WITHOUT PRIOR APPROVAL
 APPROVED PLANS MUST BE AT CONSTRUCTION SITE

REVISIONS			RHODE ISLAND DEPARTMENT OF TRANSPORTATION	
NO.	DATE	BY		
			PLANS FOR BRIDGE REPLACEMENT	
			BRIDGE NO. 796	
			PROVIDENCE, RHODE ISLAND	
			JOB SPECIFIC SYMBOLS, LEGEND & NOTES	
CHECKED BY _____			DATE _____	SCALE NO SCALE

WSP
 WSP USA Inc.
 2374 POST ROAD
 SUITE 202
 WARWICK, RI 02886
 TEL: +1 401.738.6600

Kindly be advised that this Permit is not equivalent to a verification of the type or extent of freshwater wetlands on site.

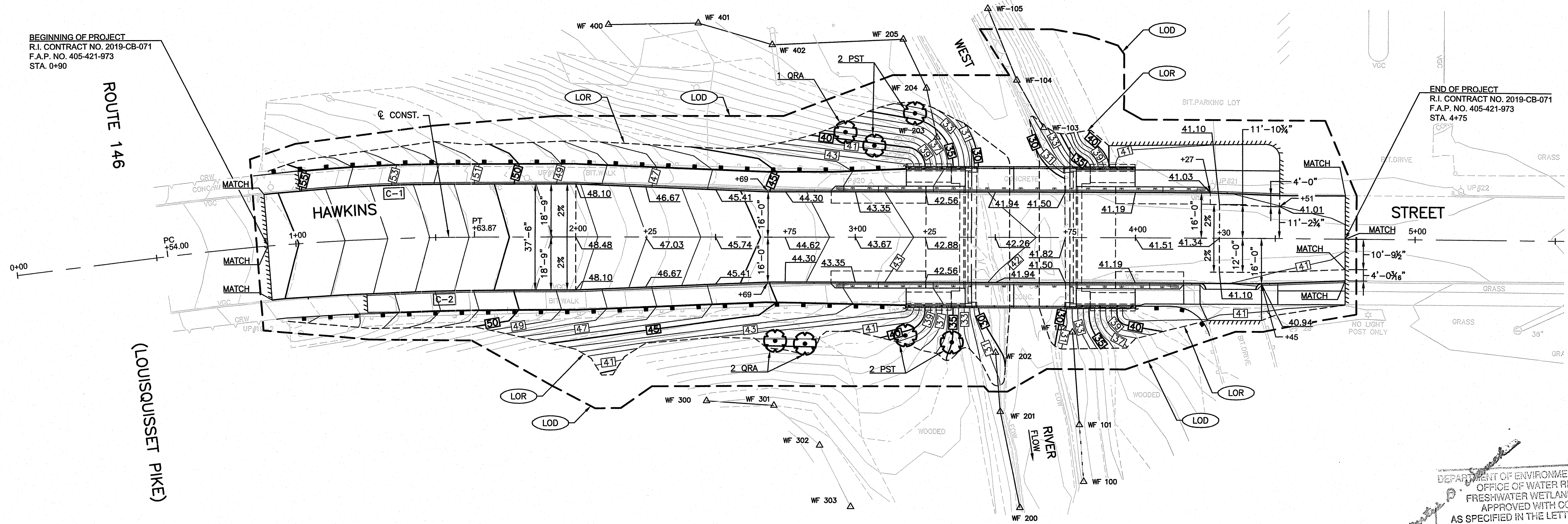

BEGINNING OF PROJECT
R.I. CONTRACT NO. 2019-CB-071
F.A.P. NO. 405-421-973
STA. 0+90

END OF PROJECT
R.I. CONTRACT NO. 2019-CB-071
F.A.P. NO. 405-421-973
STA. 4+75

DEPARTMENT OF ENVIRONMENTAL MANAGEMENT
OFFICE OF WATER RESOURCES
FRESHWATER WETLANDS PROGRAM
APPROVED WITH CONDITIONS
AS SPECIFIED IN THE LETTER OF APPROVAL
DATED JAN 03 2020 FILE # 19-0157
NO CHANGES ALLOWED WITHOUT PRIOR APPROVAL
APPROVED PLANS MUST BE AT CONSTRUCTION SITE

PLANTING SUMMARY					
QTY	SYM	BOTANICAL NAME	COMMON NAME	SIZE	NOTES
TREES					
4	PST	PINUS STROBUS	EASTERN WHITE PINE	10'	16' SPACING
3	QRA	QUERCUS ALBA	WHITE OAK	2.5" CALIPER	10' SPACING

Environmental Management
OCT - 7 2019
Office of Water Resources

wsp
WSP USA Inc.
2374 POST ROAD
SUITE 202
WARWICK, RI 02886
TEL: +1 401.738.6600

REVISIONS			RHODE ISLAND DEPARTMENT OF TRANSPORTATION
NO.	DATE	BY	
			PLANS FOR BRIDGE REPLACEMENT BRIDGE NO. 796 PROVIDENCE, RHODE ISLAND HIGHWAY GRADING/ LANDSCAPING PLAN
CHECKED BY _____ DATE _____ SCALE 1"=20'			

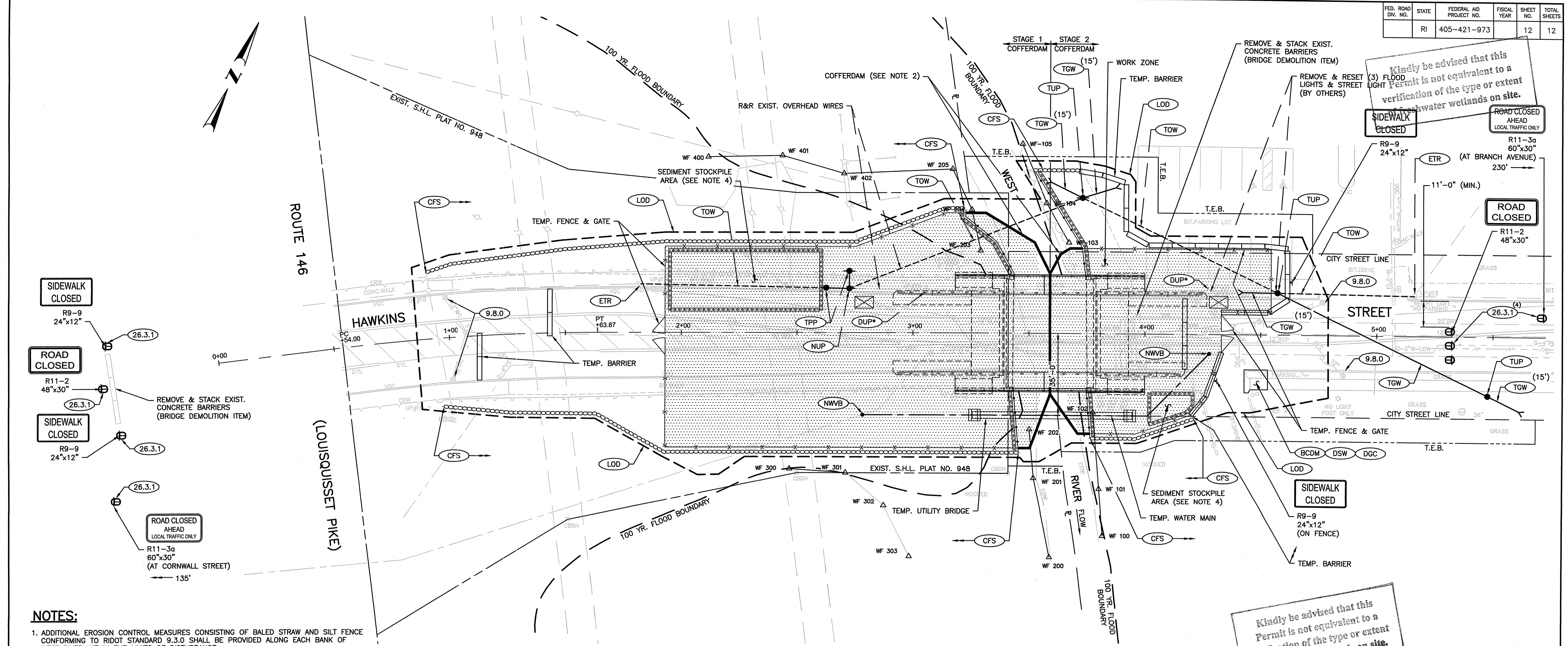

- NOTES:**
- ADDITIONAL EROSION CONTROL MEASURES CONSISTING OF BALED STRAW AND SILT FENCE CONFORMING TO RIDOT STANDARD 9.3.0 SHALL BE PROVIDED ALONG EACH BANK OF WEST RIVER WITHIN THE LIMITS OF DISTURBANCE.
 - COFFERDAMS SHALL BE INSTALLED TO ALLOW FOR REPOINTING AND RIPRAP PLACEMENT. A MINIMUM OF 13'-3" CLEAR CHANNEL SHALL BE MAINTAINED AT ALL TIMES. THE CONTRACTOR SHALL SUBMIT DESIGN CALCULATIONS AND DRAWINGS STAMPED BY A PROFESSIONAL ENGINEER REGISTERED IN THE STATE OF RI FOR REVIEW AND APPROVAL PRIOR TO INSTALLING COFFERDAM. THE HEIGHT OF THE COFFERDAM SHALL BE SET AT A MAXIMUM ELEVATION OF 32.5'. AN ELEVATION OF 32.5' WILL ALLOW FOR UP TO A 10% DURATION FLOW (45 CFS) WHICH IS APPROXIMATELY EQUIVALENT TO SEASONAL FLOWS BETWEEN JULY 1 AND OCTOBER 31. THE CONTRACTOR SHALL PLAN FOR THE COFFERDAM TO BE OVER-TOPPED SHOULD A STORM EVENT BE FORECASTED FOR THIS AREA. THE CONTRACTOR SHALL REMOVE ALL EQUIPMENT THAT COULD BE IMPACTED FROM THE PROTECTED AREA AND TAKE NECESSARY PRECAUTIONS TO PROTECT SITE FROM DAMAGE. THE COST OF REMOVING EQUIPMENT AND SUBSEQUENT DEWATERING, REPAIR AND CONTINUATION OF CONSTRUCTION SHALL BE CONSIDERED INCLUDED IN THE LUMP SUM PRICE FOR THE COFFERDAM.
 - CLEARING FOR INSTALLATION OF THE OVERHEAD WIRE SHALL BE LIMITED TO THAT WHICH IS NECESSARY FOR INSTALLATION OF SAID WIRE ONLY.
 - A CONCEPTUAL LAYOUT FOR THE TEMPORARY SEDIMENT STOCKPILE AREAS IS PROVIDED. IT IS ANTICIPATED THAT THE EXISTING SIDEWALKS AND GUARDRAIL WILL BE REMOVED PRIOR TO ESTABLISHMENT OF THE STOCKPILE AREAS. SIMILARLY, IT IS ANTICIPATED THAT THE TEMPORARY STOCKPILE AREAS WILL BE REMOVED PRIOR TO CONSTRUCTION OF THE FINAL SIDEWALKS AND GUARDRAIL.

- LEGEND**
- ⊙ CHANNELIZING DEVICE (RI STD. 26.2.0)
 - ▭ TEMPORARY BARRIER
 - ▭ TEMPORARY COFFERDAM
 - ➔ DIRECTION OF TRAFFIC
 - ⊙ SIGN
 - ▨ WORK ZONE
 - ⊠ TEMPORARY SEDIMENTATION BASIN

BRIDGE CLOSURE PLAN

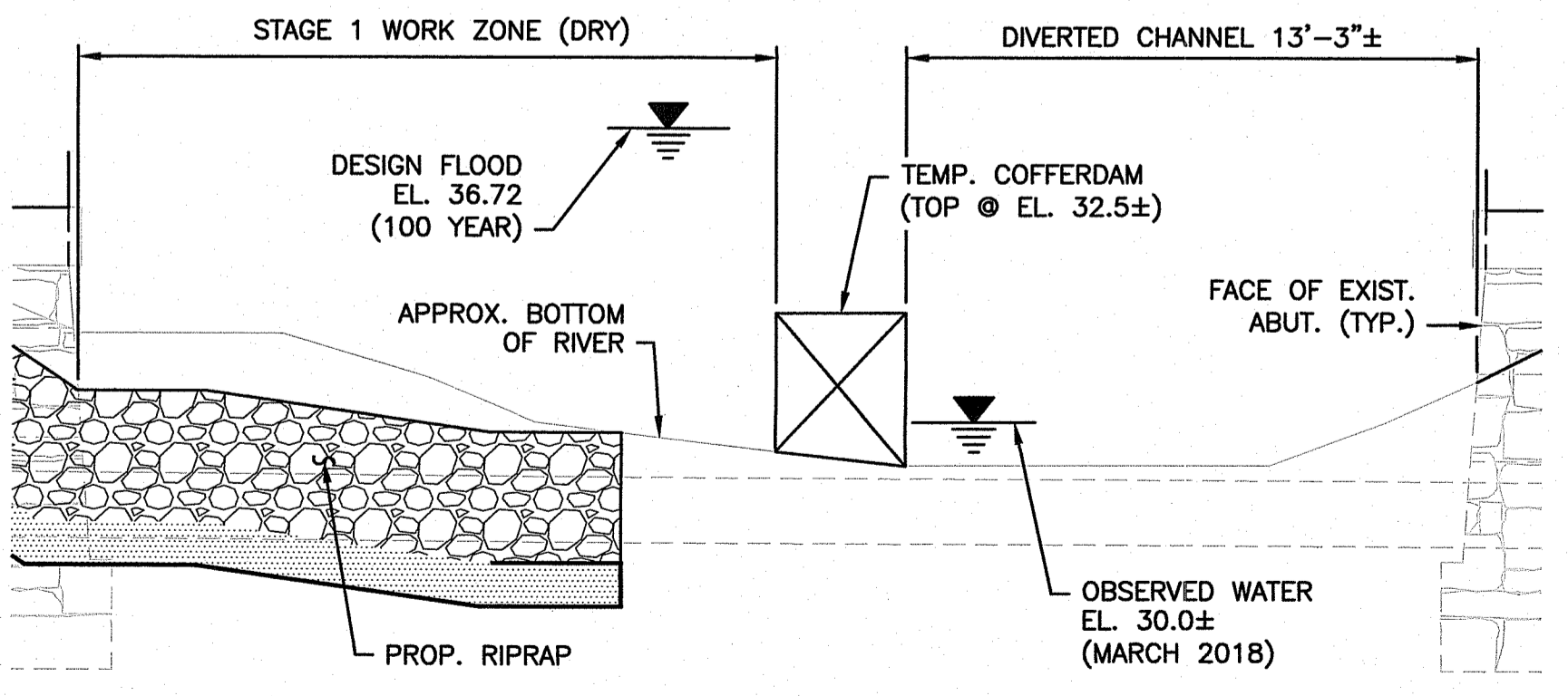

RIPRAP INSTALLATION DETAIL
(WEST SIDE SHOWN, EAST SIDE SIMILAR)
SCALE: 1/4" = 1'-0"

Kindly be advised that this Permit is not equivalent to a verification of the type or extent of freshwater wetlands on site.

DEPARTMENT OF ENVIRONMENTAL MANAGEMENT
OFFICE OF WATER RESOURCES
FRESHWATER WETLANDS PROGRAM
APPROVED WITH CONDITIONS
AS SPECIFIED IN THE LETTER OF APPROVAL
DATED JAN 03 2020 FILE #
NO CHANGES ALLOWED WITHOUT PRIOR APPROVAL
APPROVED PLANS MUST BE AT CONSTRUCTION SITE

Environmental Management
OCT - 7 2018
Office of Water Resources

REVISIONS		
NO.	DATE	BY

wsp
WSP USA Inc.
2374 POST ROAD
SUITE 202
WARWICK, RI 02886
TEL: +1 401.738.6600

RHODE ISLAND
DEPARTMENT OF TRANSPORTATION

PLANS FOR BRIDGE REPLACEMENT
BRIDGE NO. 796
PROVIDENCE, RHODE ISLAND
**MAINTENANCE & PROTECTION
OF TRAFFIC & EROSION
CONTROL PLAN**

CHECKED BY _____ DATE _____ SCALE 1"=20'