

SITE PLAN SET FOR SINGLETON STREET SOLAR ARRAY

PLAT MAP B2, LOT 7-17

ZONING DISTRICT - I-1 (LIGHT INDUSTRIAL DISTRICT)
& RIVER CORRIDOR OVERLAY DISTRICT

SINGLETON STREET
WOONSOCKET, RI

OWNER / APPLICANT

SINGLETON GROUP, LLC
P.O. BOX 309
235 SINGLETON STREET
WOONSOCKET, RHODE ISLAND 02895

OPERATOR

ADVANCED ELECTRICAL
33 APPIAN WAY
SMITHFIELD, RHODE ISLAND 02917

ENGINEERS

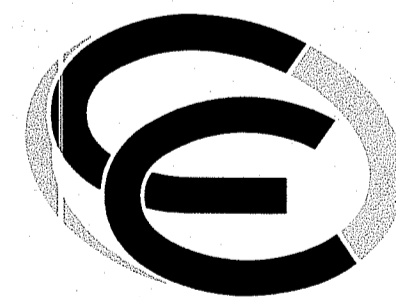

- Civil
- Transportation
- Environmental
- Site Planning
- Surveying
- Permitting
- Landscape Architecture

CROSSMAN ENGINEERING

Rhode Island: 151 Centerville Road, Warwick, RI 02886, Phone: (401) 738-5660
Massachusetts: 103 Commonwealth Avenue, North Attleboro, MA 02763, Phone: (508) 695-1700

Email: cei@crossmaneng.com

JULY 2019
SHEET 1 OF 8

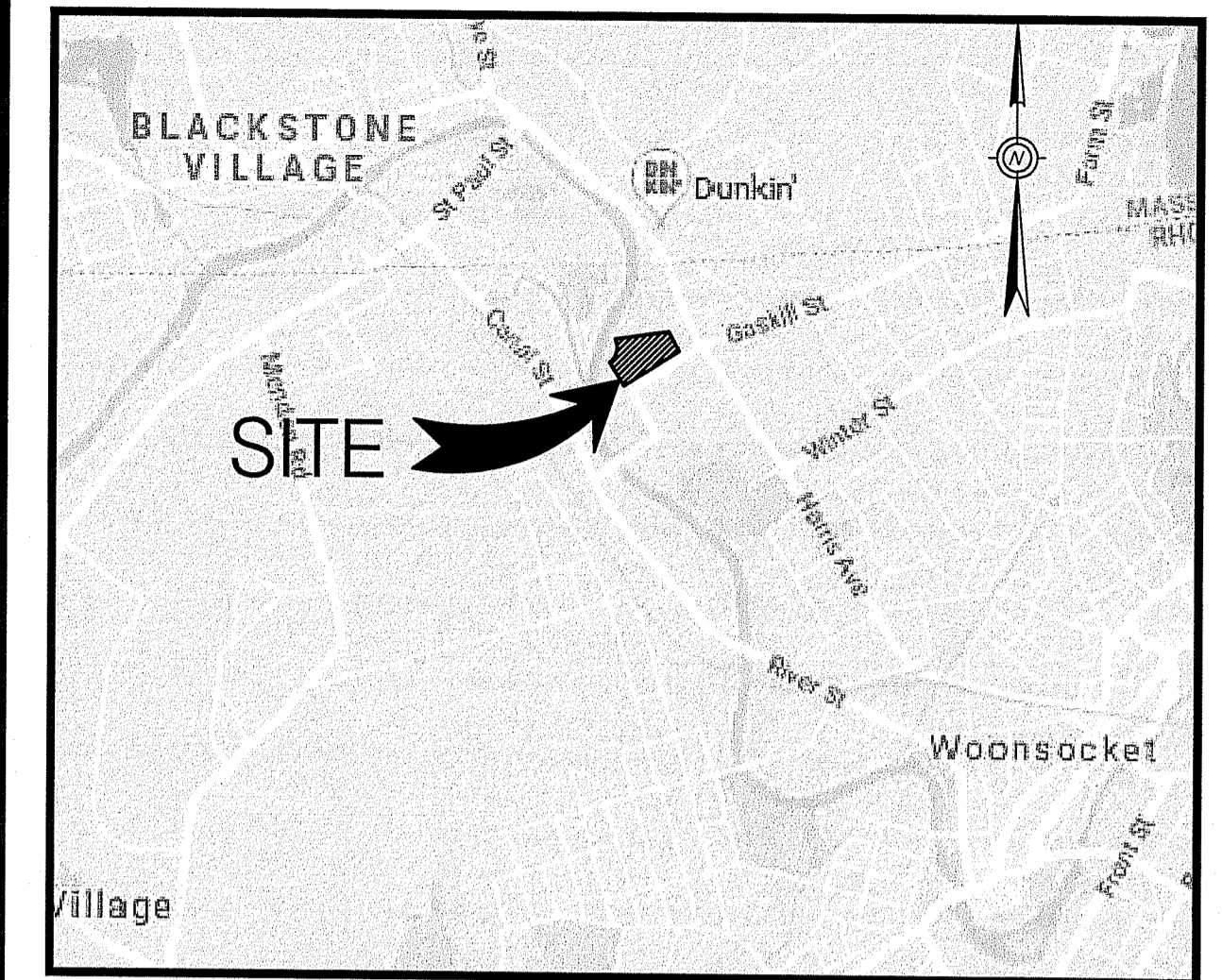

LOCATION MAP
NOT TO SCALE

INDEX OF DRAWINGS

SHEETS PREPARED BY CROSSMAN ENGINEERING

DRAWING No.	PLAN
C1	GENERAL NOTES and LEGEND
C2	LOCATION MAP
C3	AERIAL MAP
C4	EXISTING CONDITIONS PLAN
C5	SITE LAYOUT PLAN
C6	MISCELLANEOUS DETAILS PLAN No. 1
C7	MISCELLANEOUS DETAILS PLAN No. 2

REFERENCE SHEETS PREPARED BY ASSOCIATED ENGINEERS
AND RBI SOLAR

DRAWING No.	PLAN
E-1	249.8 KW/DC - 200.0 KW/AC ELECTRICAL ONE LINE
G-002	GENERAL NOTES/MODULE SPECIFICATION SHEETS
S-301	RACK SECTION & BAY PLAN VIEWS
S-501	DETAILS

DEPARTMENT OF ENVIRONMENTAL MANAGEMENT
OFFICE OF WATER RESOURCES
FRESH WATER WETLANDS PROGRAM
APPROVED WITH CONDITIONS
AS SPECIFIED IN THE LETTER OF APPROVAL
DATED DEC 12 2019 FILE # 19-0262
NO CHANGES ALLOWED WITHOUT PRIOR APPROVAL
APPROVED PLANS MUST BE AT CONSTRUCTION SITE

AUG 29 2019

REVISIONS:

NO.:	DATE:	DESCRIPTION:
1	7/16/19	PLANNING COMMENTS
2	7/29/19	PLANNING COMMENTS
3	8/1/19	REVIEW COMMENTS
4	8/2/19	PLANNING COMMENTS
5	8/20/19	PLANNING COMMENTS

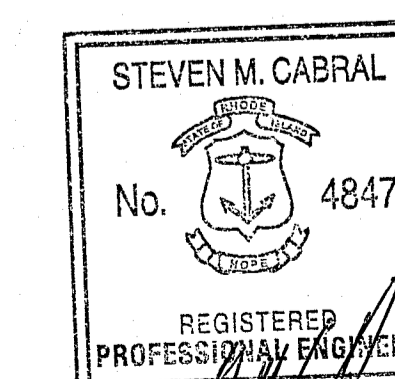

GENERAL NOTES

- ALL EXISTING UTILITIES HAVE BEEN PLOTTED BASED UPON FIELD LOCATION OF VISIBLE ABOVE GROUND STRUCTURES AND INFORMATION OBTAINED FROM VARIOUS MUNICIPAL AND PRIVATE UTILITY COMPANIES AND REPRESENT APPROXIMATE LOCATIONS. THE CONTRACTOR SHALL VERIFY THE LOCATIONS OF ALL EXISTING DRAINAGE & UTILITIES, BOTH UNDERGROUND AND OVERHEAD, BEFORE EXCAVATION BEGINS IN ACCORDANCE WITH "DIG SAFE PROGRAM LAW" ENACTED BY THE R.I. LEGISLATURE AND BY CONTACTING THE INDIVIDUAL UTILITY COMPANIES. EXCAVATION SHALL BE IN ACCORDANCE WITH ALL STATUTES, ORDINANCES, RULES AND REGULATIONS OF ANY CITY, STATE OR FEDERAL AGENCY THAT MAY APPLY. ANY DAMAGE TO EXISTING UTILITIES SHALL BE THE CONTRACTOR'S RESPONSIBILITY.
- CONTOURS REFERENCED IN THIS PLAN SET ARE FROM 2011 RIGIS LIDAR DATA.
- SPECIFICATIONS TO GOVERN THIS PROJECT ARE R.I.D.O.T. STANDARD SPECIFICATIONS. FOR ALL EXCAVATION AND PLACEMENT OF FILL, THE CONTRACTOR SHALL PERFORM THE WORK IN FULL COMPLIANCE WITH THE RHODE ISLAND DEPARTMENT OF TRANSPORTATION STANDARD SPECIFICATIONS FOR ROAD AND BRIDGE CONSTRUCTION, AMENDED AUGUST 2013, WITH LATEST REVISIONS UNLESS OTHERWISE SHOWN ON PLANS. THE "METHOD OF MEASUREMENT" AND "BASIS OF PAYMENT" ARE NOT APPLICABLE. THESE SPECIFICATIONS CAN BE OBTAINED ON-LINE AT:
[HTTP://WWW.DOT.RI.GOV/BUSINESS/BLUEBOOK.PHP](http://www.dot.ri.gov/business/bluebook.php)
- RHODE ISLAND STANDARDS REFERENCED ARE ACCORDING TO THE STATE OF RHODE ISLAND AND PROVIDENCE PLANTATIONS "RHODE ISLAND STANDARD DETAILS" DATED MAY 20, 2015, WITH ALL REVISIONS AS PREPARED BY THE DEPARTMENT OF TRANSPORTATION.
- THE CONTRACTOR MUST VERIFY PRIOR TO CONSTRUCTION THAT ALL REQUIRED AUTHORIZATION TO PERFORM WORK HAS BEEN OBTAINED. THE CONTRACTOR SHALL BE SOLELY RESPONSIBLE FOR CONSTRUCTION OPERATIONS INCLUDING ALL ACTIONS OR OMISSIONS OF ANY SUBCONTRACTORS, AGENTS OR EMPLOYEES. THE CONTRACTOR MUST ENSURE THAT THE CONDITIONS OF ALL PERMITS, SPECIFICATIONS AND FEDERAL, STATE AND LOCAL REGULATIONS ARE STRICTLY ENFORCED. THE CONTRACTOR IS ALSO RESPONSIBLE FOR ASPECTS OF ON-SITE SAFETY INCLUDING ANY DAMAGE TO EXISTING STRUCTURES.
- WORK SHOWN ON THE PLANS FOR WHICH THERE ARE NO PARTICULAR DETAILS OR SPECIFICATIONS DOES NOT RELIEVE THE CONTRACTOR FROM FURNISHING AND INSTALLING THE WORK. THE CONTRACTOR SHALL THOROUGHLY EXAMINE THE CONTRACT DOCUMENTS AND PLANS AND INSPECT THE SITE, AND THE BID PRICE SHALL INCLUDE ALL SERVICES AND MATERIALS NECESSARY TO COMPLETE THE PROJECT. ANY CHANGES TO THE PROJECT OR THE INSTALLATION OF AN ITEM FOR WHICH NO PARTICULAR DETAIL OR SPECIFICATION WAS PROVIDED MUST BE REVIEWED BY AND MUST BE ACCEPTABLE TO THE ENGINEER.
- CONTRACTOR IS RESPONSIBLE TO VERIFY ALL EXISTING CONDITIONS DIMENSIONS PRIOR TO CONSTRUCTION. THE CONTRACTOR SHALL NOTIFY THE ENGINEER OF ANY DISCREPANCIES PRIOR TO ANY WORK.
- ALL DISTURBED AREAS SHALL BE REPLACED IN KIND UNLESS OTHERWISE SHOWN.

LAYOUT NOTE

THE LAYOUT SHOWN REPRESENTS A GRAPHICAL DESIGN, AND PRIOR TO CONSTRUCTION, THE CONTRACTOR SHALL ENGAGE A PROFESSIONAL LAND SURVEYOR (PLS) REGISTERED IN THE STATE TO SET AND VERIFY ALL LINES AND GRADES. ALL EXISTING UTILITY LOCATIONS AND ELEVATIONS ARE TO BE CONFIRMED BY THE CONTRACTOR PRIOR TO CONSTRUCTION. ANY ITEM FOUND WHICH DOES NOT MATCH THE PLANS MUST BE BROUGHT TO THE ENGINEER'S ATTENTION PRIOR TO CONSTRUCTION FOR REVIEW. NO WORK SHALL PROCEED UNTIL AUTHORIZED BY THE ENGINEER.

PRIOR TO CONSTRUCTION, THE CONTRACTOR SHALL COORDINATE WITH A WETLAND BIOLOGIST TO CONFIRM THE EDGE OF THE BLACKSTONE RIVER, WETLAND AREAS, AND THEIR ASSOCIATED BUFFERS. IT IS RECOMMENDED THAT THE WETLAND PERIMETERS BE STAKED OUT IN FIELD PRIOR TO CONSTRUCTION COMMENCEMENT.

MAINTENANCE AND PROTECTION OF TRAFFIC NOTES

- THE CONTRACTOR SHALL BE RESPONSIBLE FOR ALL MAINTENANCE AND PROTECTION OF PEDESTRIAN AND VEHICULAR TRAFFIC INCLUDING POLICE PROTECTION. ALL TEMPORARY CONSTRUCTION SIGNS, BARRICADES AND LANE CLOSURES SHALL BE IN CONFORMANCE WITH THE LATEST REVISIONS OF MANUAL OF UNIFORM TRAFFIC CONTROL DEVICES (M.U.T.C.D.)
- TEMPORARY CONSTRUCTION SIGNS AND ALL APPLICABLE TRAFFIC CONTROL DEVICES SHALL BE IN PLACE PRIOR TO THE START OF WORK IN ANY AREA OPEN TO TRAFFIC.
- THE PRIVATE VEHICLES OF CONSTRUCTION WORKERS WILL NOT BE PARKED IN THE ROADWAY RIGHT-OF-WAY.
- ALL MAINTENANCE AND PROTECTION OF TRAFFIC CONTROL SETUPS, SIGNS, CHANNELING DEVICES, ETC., SHALL BE IN ACCORDANCE WITH THE MANUAL ON UNIFORM TRAFFIC CONTROL DEVICES, 2009 EDITION, AND SUBSEQUENT ADDENDA.
- SIGN MOUNTINGS SHALL BE IN ACCORDANCE WITH THE STATE D.O.T. SPECIFICATIONS FOR TEMPORARY CONSTRUCTION SIGNS.

CONSTRUCTION NOTES

- THE CONTRACTOR SHALL NOTIFY THE OWNER PRIOR TO INSTALLATION OF UTILITIES ON SITE. THE COORDINATION IS NECESSARY FOR THE OWNER TO SCHEDULE SITE INSPECTIONS. INSTALLATIONS PERFORMED WITHOUT INSPECTIONS BY ECONOX RENEWABLES MAY WARRANT COMPLETE REMOVAL AND REINSTALLATION AT THE CONTRACTOR'S SOLE EXPENSE.
- THE CONTRACTOR SHALL COORDINATE SOLAR PANEL AND UTILITY SERVICE AND INSTALLATION WITH ECONOX RENEWABLES, INC. AND NATIONAL GRID PRIOR TO CONSTRUCTION.
- THE CONTRACTOR IS REQUIRED TO MAINTAIN DETAILED AS-BUILT INFORMATION FOR ALL UTILITY INSTALLATIONS. AS-BUILT INFORMATION MUST INCLUDE MATERIAL LIST, PIPE DEPTH AND SWING TIE LOCATIONS (2 MINIMUM) FROM THE NEW UTILITY TO A FIXED MONUMENT. FINAL PAYMENT WILL NOT BE MADE UNTIL SUITABLE AS-BUILT DATA IS PROVIDED.

EROSION CONTROL AND SOIL STABILIZATION PROGRAM

- EXTREME CARE SHALL BE EXERCISED SO AS TO PREVENT ANY UNSUITABLE MATERIAL FROM ENTERING THE DRAINAGE SYSTEM, ADJACENT PROPERTY, WETLANDS, WATERBODIES/STREAMS AND ROADWAYS.
- CONTRACTOR SHALL INSTALL FILTER SOXX OR APPROVED EQUAL AROUND THE LIMIT OF DISTURBANCE PRIOR TO CONSTRUCTION.
- TEMPORARY TREATMENTS SHALL CONSIST OF A HAY, STRAW, OR FIBER MULCH PROTECTIVE COVERS, SUCH AS A MAT OR FIBER LINING (BURLAP, JUTE, FIBERGLASS NETTING, EXCELSIOR BLANKETS). THEY SHALL BE INCORPORATED INTO THE WORK AS WARRANTED OR AS ORDERED BY THE OWNER.
- HAY OR STRAW APPLICATIONS SHALL BE IN THE AMOUNT OF 3,000-4,000 LBS/ACRE.
- STOCKPILES SHALL HAVE NO SLOPE STEEPER THAN 2:1 AND SHALL BE SURROUNDED BY STAKED HAY BALES OR SILT FENCING.
- STOCKPILES EXPOSED FOR EXCESSIVE PERIODS SHALL RECEIVE TEMPORARY TREATMENT CONSISTING OF HAY, STRAW OR FIBER MATTING.
- DURING CONSTRUCTION, THE CONTRACTOR SHALL BE RESPONSIBLE FOR ALL EROSION CONTROL MAINTENANCE AND SHALL INSPECT/REPLACE AS NEEDED.
- ADDITIONAL HAY BALES OR SANDBAGS SHALL BE LOCATED AS CONDITIONS WARRANT OR AS DIRECTED BY THE ENGINEER, OWNER, MUNICIPAL REPRESENTATIVES OR R.I.D.E.M..
- THE CONTRACTOR SHALL BE RESPONSIBLE FOR PROVIDING DUST CONTROL AT NO ADDITIONAL COST TO THE OWNER.

FLOOD ZONE NOTE

THE PROJECT AREA IS LOCATED IN FLOOD ZONE ZONE X, AREAS OF MINIMAL FLOODING AND FLOOD ZONE X AREAS DETERMINED TO BE WITHIN THE 0.2% ANNUAL CHANCE FLOODPLAIN, AS SHOWN ON THE FLOOD INSURANCE RATE MAP, PROVIDENCE COUNTY, RHODE ISLAND, MAP NUMBER 44007C0069G, EFFECTIVE DATE: MARCH 2, 2009.

EXISTING CONDITIONS NOTE

EXISTING CONDITIONS REFERENCED IN THIS PLAN SET ARE TAKEN FROM A CLASS I BOUNDARY SURVEY PREPARED BY VANASSE HANGEN BRUSTLIN, INC., PLANS PROVIDED BY NATIONAL GRID, AND LIMITED SITE INVESTIGATIONS BY CROSSMAN ENGINEERING. REFERENCE IS ALSO MADE TO RIDOT PLAT MAPS 2755 AND 2755A (SEE MAP REFERENCE BELOW).

MAP REFERENCE

- PROPERTY LINE PLAN MAP B2 LOTS 7-17 AND PORTION OF LOT 7-26, BRICKLE RG SINGLETON STREET AT HARRIS AVENUE, WOONSOCKET RI, SCALE 1"=40', DATE: REVISION A 01/31/06, PREPARED BY VANASSE HANGEN BRUSTLIN INC. 530 BROADWAY, PROVIDENCE, RI 02909.
- REFERENCE IS MADE TO THE STATE OF RHODE ISLAND DEPARTMENT OF TRANSPORTATION PLAT MAP 2755 TITLED; PLAT SHOWING LAND IN WOONSOCKET & NORTH SMITHFIELD, RHODE ISLAND TAKEN FOR STATE HIGHWAY PURPOSES ON BEHALF OF STATE OF RHODE ISLAND & PROVIDENCE PLANTATIONS BY THE DIRECTOR OF TRANSPORTATION, DATED JULY 29, 2014, RECORDED IN THE CITY OF WOONSOCKET ON DECEMBER 3, 2014 (BOOK 663, PAGE 86).
- REFERENCE IS MADE TO THE STATE OF RHODE ISLAND DEPARTMENT OF TRANSPORTATION PLAT MAP 2755A TITLED; PLAT SHOWING LAND IN WOONSOCKET & NORTH SMITHFIELD, RHODE ISLAND TAKEN FOR STATE HIGHWAY PURPOSES ON BEHALF OF STATE OF RHODE ISLAND & PROVIDENCE PLANTATIONS BY THE DIRECTOR OF TRANSPORTATION, DATED JUNE 20, 2017, RECORDED IN THE CITY OF WOONSOCKET ON DECEMBER 11, 2017.

PERMIT AND DESIGN NOTES

- APPROVALS FROM THE PLANNING DEPARTMENT FOR MINOR LAND DEVELOPMENT, RIVER CORRIDOR OVERLAY COMMISSION, AND DESIGN REVIEW COMMISSION ARE REQUIRED.
- PERMITS FROM THE RHODE ISLAND DEPARTMENT OF ENVIRONMENTAL MANAGEMENT (RIDEM) WILL BE REQUIRED BECAUSE THE NORTHERLY PORTION OF THE SOLAR ARRAY AND NORTHERLY FENCE ARE WITHIN THE 100' RIVERBANK WETLAND FOR THE INTERMITTENT STREAM/CHANNEL. NOTE: WITHIN THIS 100' RIVERBANK WETLAND THERE WILL BE NO TREE CLEARING AND NO GRADE CHANGES. OTHER CONSIDERATIONS IN THE DESIGN ARE NOTED BELOW:
 - THE SITE IS DESIGNED TO MAINTAIN THE EXISTING GRASS / SURFACE CONDITIONS TO THE EXTENT POSSIBLE. PROPOSED DISTURBANCE TO AN ERODABLE SOIL SHALL BE LESS THAN 10,000 SF.
 - THE PROPOSED SOLAR ARRAY SHALL NOT ALTER THE EXISTING DRAINAGE FLOW DIRECTIONS.
 - TREE AND BRUSH REMOVAL IS LIMITED AND DISTURBED/UNVEGETATED AREAS SHALL BE SEEDED AND LANDSCAPED AS SHOWN ON THE SITE LAYOUT PLAN.
 - THE PROPOSED IMPROVEMENTS ARE OUTSIDE OF THE 200' RIVERBANK WETLAND FOR THE BLACKSTONE RIVER.
 - THE BLACKSTONE RIVER IS A 4TH ORDER RIVER. PEAK, FLOW ATTENUATION IS NOT APPLICABLE.
- THIS PROPOSED USE WILL BE A LOW IMPACT DEVELOPMENT (LID) DESIGN BY MAINTAINING THE EXISTING GRASS AREAS AND IN AREAS NOTED PLANTING A LOW GRASS SEED MIX.

PLAN NOTE:

- CERTIFICATION OF THIS PLAN SET BY CROSSMAN ENGINEERING APPLIES TO SHEETS C1 TO C6, PLANS PREPARED BY CROSSMAN ENGINEERING.
- SHEET E1 HAS BEEN PREPARED BY ASSOCIATED ENGINEERS, AND SHEETS G-002, S-301 AND S-501 HAVE BEEN PREPARED BY RBI SOLAR.
- THE BELOW LISTED INFORMATION ON SHEET C5 HAS BEEN DESIGNED AND PROVIDED BY ASSOCIATED ENGINEERS.
 - SOLAR NOTES 1 AND 2
 - SITE NOTE #10
 - TRANSFORMER SIZE
 - SWITCHBOARD SIZE
 - PROPOSED UTILITY POLE IDENTIFICATION

EXISTING

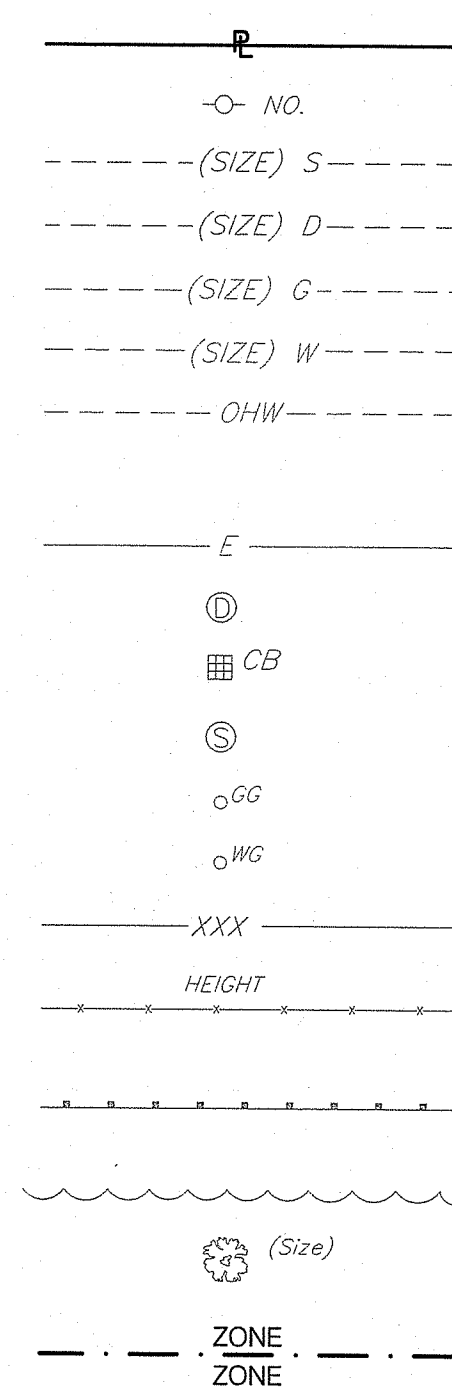

LEGEND

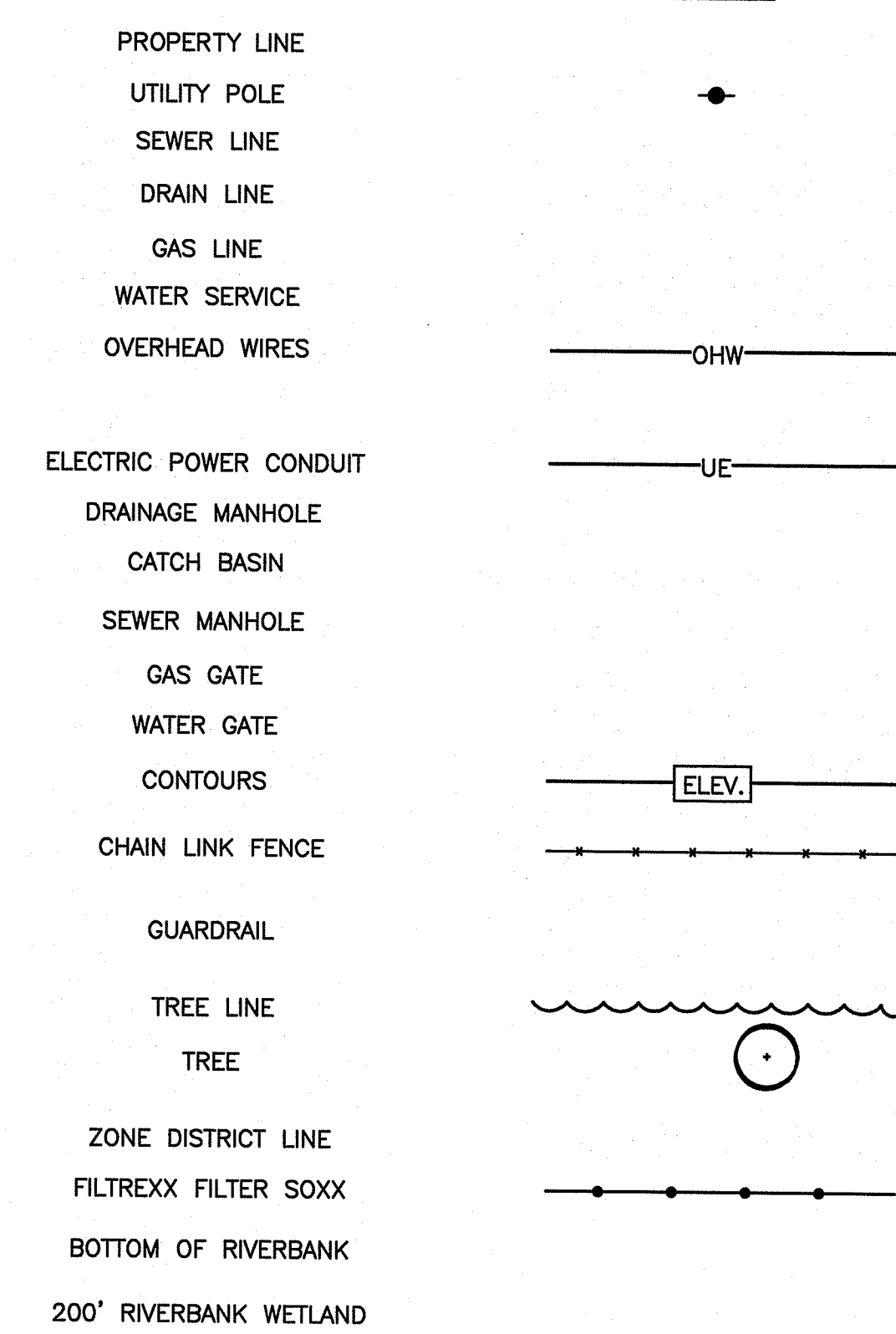

CROSSMAN ENGINEERING
 Rhode Island: 151 Centerville Road, Warwick, RI 02886, Phone: (401) 738-5660
 Massachusetts: 103 Commonwealth Avenue, North Attleboro, MA 02763, Phone: (508) 695-1700
 Email: ce@crosmaneng.com

THESE DRAWINGS ARE THE PROPERTY OF CROSSMAN ENGINEERING AND HAVE BEEN PREPARED FOR THEIR CLIENT FOR A SPECIFIC SITE AND PROJECT. THESE DRAWINGS ARE NOT TO BE COPIED OR USED FOR ANY OTHER PURPOSE WITHOUT THE WRITTEN CONSENT OF CROSSMAN ENGINEERING.

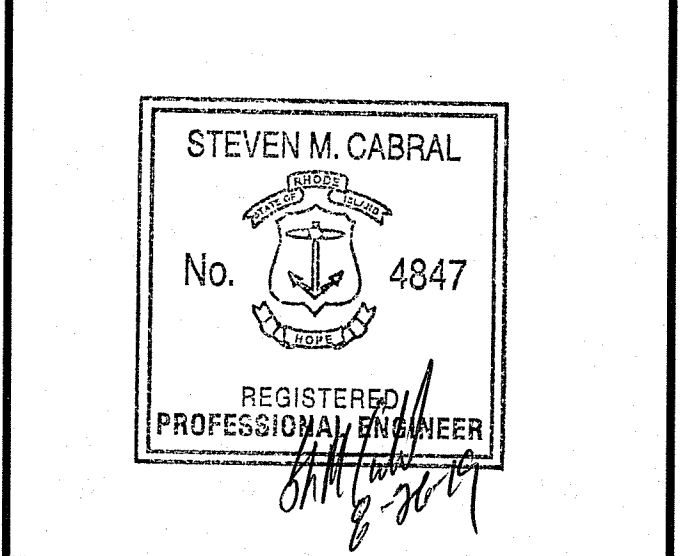
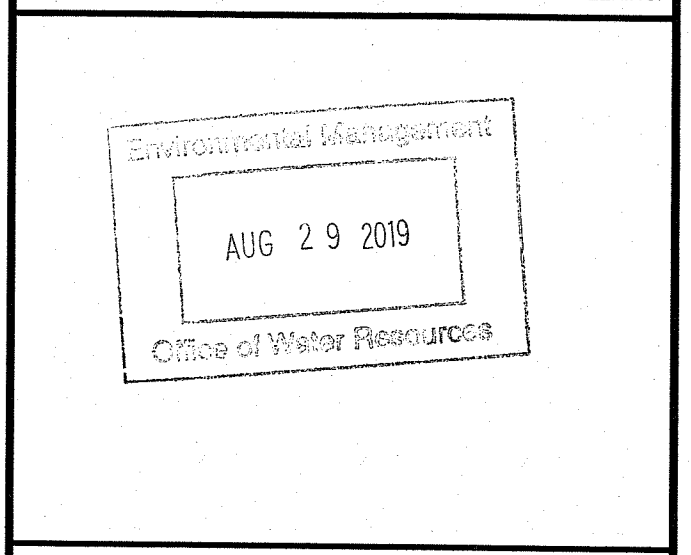

PROJECT TITLE:
SINGLETON STREET SOLAR ARRAY
 PLAT MAP B2, LOT 7-17
 0 SINGLETON STREET
 WOONSOCKET, RHODE ISLAND

PREPARED FOR:
SINGLETON GROUP, LLC.
 P.O. BOX 309
 235 SINGLETON STREET
 WOONSOCKET, RI 02895

DRAWING TITLE:
GENERAL NOTES and LEGEND

DATE: JULY 2019 SCALE: NOT TO SCALE
 DWG. NAME: 2392-C01-NOTES-R5.dwg

NUMBER	REMARKS	DATE
1	PLANNING COMMENTS	7/16/19
2	PLANNING COMMENTS	7/29/19
3	REVIEW COMMENTS	8/1/19
4	PLANNING COMMENTS	8/2/19
5	PLANNING COMMENTS	8/20/19

DEPARTMENT OF ENVIRONMENTAL MANAGEMENT
 OFFICE OF WATER RESOURCES
 FRESHWATER WETLANDS PROGRAM
 APPROVED WITH CONDITIONS
 AS SPECIFIED IN THE LETTER OF APPROVAL
 DATED DEC 12 2019 FILE # 19-0262
 NO CHANGES ALLOWED WITHOUT PRIOR APPROVAL
 APPROVED PLANS MUST BE AT CONSTRUCTION SITE
Christopher D. Donnell

DRAWING NUMBER
C1
 SHEET: 2 OF: 8



Kindly be advised that this Permit is not equivalent to a verification of the type or extent of freshwater wetlands on site.

DEPARTMENT OF ENVIRONMENTAL MANAGEMENT
 OFFICE OF WATER RESOURCES
 FRESHWATER WETLANDS PROGRAM
 APPROVED WITH CONDITIONS
 AS SPECIFIED IN THE LETTER OF APPROVAL
 DATED DEC 12 2019 FILE # 19-0262
 NO CHANGES ALLOWED WITHOUT PRIOR APPROVAL
 APPROVED PLANS MUST BE AT CONSTRUCTION SITE

Stephen D. Cabral

- Civil
- Transportation
- Environmental
- Site Planning
- Surveying
- Permitting
- Landscape Architecture

CROSSMAN ENGINEERING

Rhode Island: 151 Centerville Road, Warwick, RI 02886, Phone: (401) 738-6660
 Massachusetts: 103 Commonwealth Avenue, North Attleboro, MA 02763, Phone: (508) 695-1700
 Email: ce@crossmaneng.com

THESE DRAWINGS ARE THE PROPERTY OF CROSSMAN ENGINEERING AND HAVE BEEN PREPARED FOR THEIR CLIENT FOR A SPECIFIC SITE AND PROJECT. THESE DRAWINGS ARE NOT TO BE COPIED OR USED FOR ANY OTHER PURPOSE WITHOUT THE WRITTEN CONSENT OF CROSSMAN ENGINEERING.

Environmental Management
 AUG 29 2019
 Office of Water Resources

STEVEN M. CABRAL
 No. 4847
 REGISTERED PROFESSIONAL ENGINEER

PROJECT TITLE:
SINGLETON STREET SOLAR ARRAY
 PLAT MAP B2, LOT 7-17
 0 SINGLETON STREET
 WOONSOCKET, RHODE ISLAND

PREPARED FOR:
SINGLETON GROUP, LLC.
 P.O. BOX 309
 235 SINGLETON STREET
 WOONSOCKET, RI 02895

DRAWING TITLE:
LOCATION MAP

DATE: JULY 2019 SCALE: 1"=400'
 DWG. NAME: 2392-C02-LOCATION MAP-R5.dwg

REVISIONS

NUMBER	REMARKS	DATE
1	PLANNING COMMENTS	7/16/19
2	PLANNING COMMENTS	7/29/19
3	REVIEW COMMENTS	8/1/19
4	PLANNING COMMENTS	8/2/19
5	PLANNING COMMENTS	8/20/19

DRAWING NUMBER
C2
 SHEET: 3 OF 8



• Civil
 • Transportation
 • Environmental
 • Site Planning
 • Surveying
 • Permitting
 • Landscape Architecture

CROSSMAN ENGINEERING
 Rhode Island: 151 Centerville Road, Warwick, RI 02886
 Massachusetts: 103 Commonwealth Avenue, North Attleboro, MA 02763
 Phone: (401) 738-5660 Phone: (508) 695-1700
 Email: ce@crosmaneng.com

THESE DRAWINGS ARE THE PROPERTY OF CROSSMAN ENGINEERING AND HAVE BEEN PREPARED FOR THEIR CLIENT FOR A SPECIFIC SITE AND PROJECT. THESE DRAWINGS ARE NOT TO BE COPIED OR USED FOR ANY OTHER PURPOSE WITHOUT THE WRITTEN CONSENT OF CROSSMAN ENGINEERING.

DEPARTMENT OF ENVIRONMENTAL MANAGEMENT
 OFFICE OF WATER RESOURCES
 FRESHWATER WETLANDS PROGRAM
 APPROVED WITH CONDITIONS
 AS SPECIFIED IN THE LETTER OF APPROVAL
 DATED DEC 12 2019 FILE # 19-0262
 NO CHANGES ALLOWED WITHOUT PRIOR APPROVAL
 APPROVED PLANS MUST BE AT CONSTRUCTION SITE

Martin D. Wenczek

AUG 29 2019
 PROFESSIONAL SEAL

STEVEN M. CABRAL
 No. 4847
 REGISTERED PROFESSIONAL ENGINEER

PROJECT TITLE:
SINGLETON STREET SOLAR ARRAY
 PLAT MAP B2, LOT 7-17
 SINGLETON STREET
 WOONSOCKET, RHODE ISLAND

PREPARED FOR:
SINGLETON GROUP, LLC.
 P.O. BOX 309
 235 SINGLETON STREET
 WOONSOCKET, RI 02895

DRAWING TITLE:
EXISTING AERIAL MAP

DATE: JULY 2019 SCALE: 1"=40'
 DWG. NAME: 2392-C03-EX-AERIAL-R5.dwg

REVISIONS

NUMBER	REMARKS	DATE
1	PLANNING COMMENTS	7/16/19
2	PLANNING COMMENTS	7/29/19
3	REVIEW COMMENTS	8/1/19
4	PLANNING COMMENTS	8/2/19
5	PLANNING COMMENTS	8/20/19

DRAWING NUMBER
C3
 SHEET: 4 OF 8

Kindly be advised that this Permit is not equivalent to a verification of the type or extent of freshwater wetlands on site.

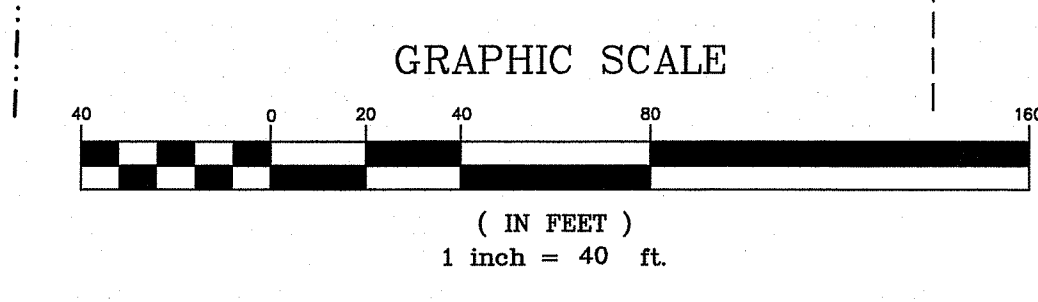
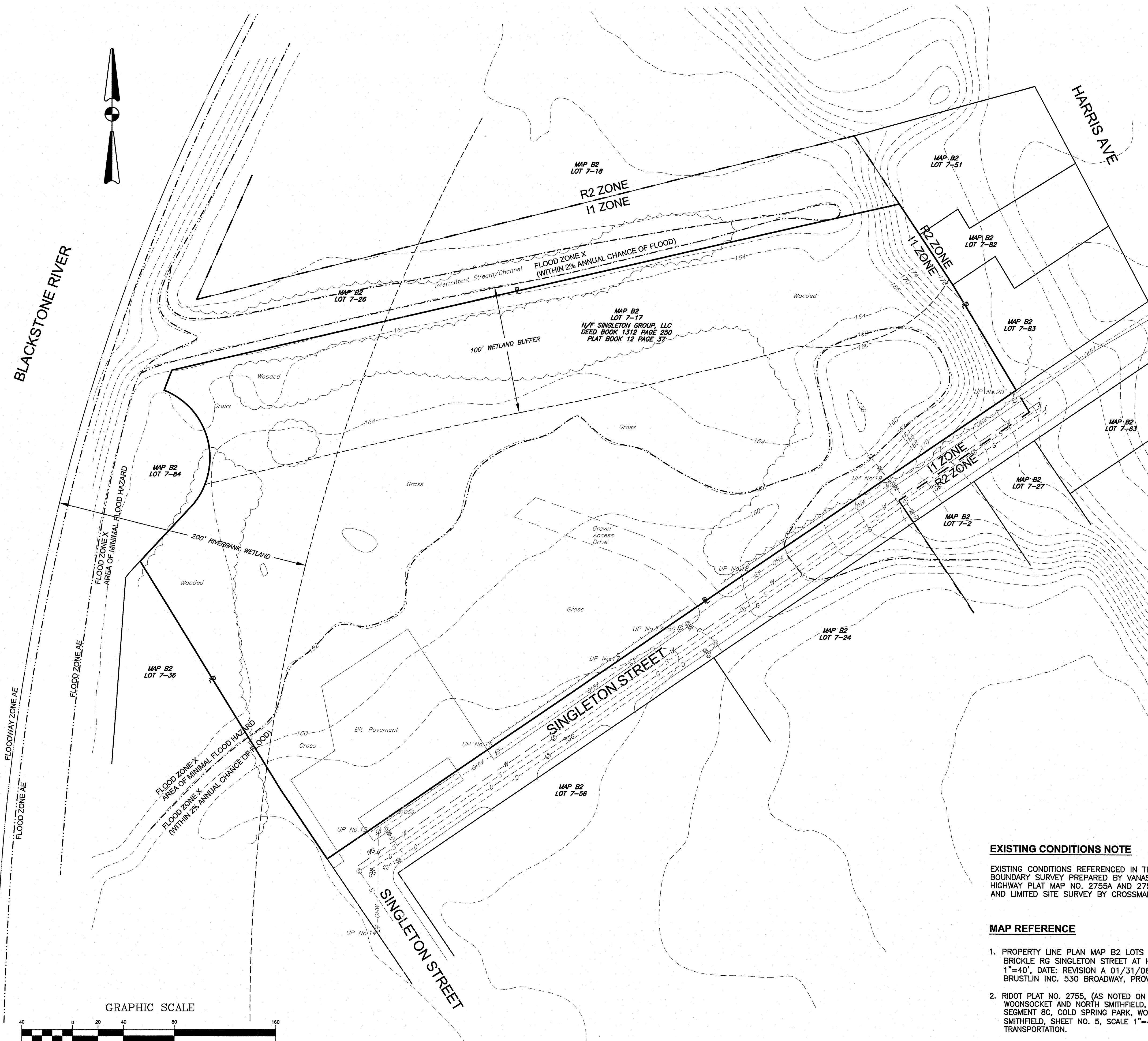

DEPARTMENT OF ENVIRONMENTAL MANAGEMENT
OFFICE OF WATER RESOURCES
FRESHWATER WETLANDS PROGRAM
APPROVED WITH CONDITIONS
AS SPECIFIED IN THE LETTER OF APPROVAL
DATED DEC 12 2019 FILE # 19-0262
NO CHANGES ALLOWED WITHOUT PRIOR APPROVAL
APPROVED PLANS MUST BE AT CONSTRUCTION SITE

EXISTING CONDITIONS NOTE

EXISTING CONDITIONS REFERENCED IN THIS PLAN SET ARE TAKEN FROM A CLASS I BOUNDARY SURVEY PREPARED BY VANASSE HANGEN BRUSTLIN, INC., STATE HIGHWAY PLAT MAP NO. 2755A AND 2755, PLANS PROVIDED BY NATIONAL GRID, AND LIMITED SITE SURVEY BY CROSSMAN ENGINEERING.

MAP REFERENCE

- PROPERTY LINE PLAN MAP B2 LOTS 7-17 AND PORTION OF LOT 7-26, BRICKLE RG SINGLETON STREET AT HARRIS AVENUE, WOONSOCKET RI, SCALE 1"=40', DATE: REVISION A 01/31/06, PREPARED BY VANASSE HANGEN BRUSTLIN INC. 530 BROADWAY, PROVIDENCE, RI 02909.
- RIDOT PLAT NO. 2755, (AS NOTED ON SHEET C1). REFER TO SHEET 5; WOONSOCKET AND NORTH SMITHFIELD, RHODE ISLAND, BLACKSTONE RIVER BIKEWAY SEGMENT 8C, COLD SPRING PARK, WOONSOCKET TO THE MEADOWS PARK, NORTH SMITHFIELD, SHEET NO. 5, SCALE 1"=40', RHODE ISLAND DEPARTMENT OF TRANSPORTATION.
- RIDOT PLAT NO. 2755A, (AS NOTED ON SHEET C1). REFER TO SHEET 5; WOONSOCKET AND NORTH SMITHFIELD, RI, BRWV SEGMENT 8C, COLD SPRING PARK TO THE MEADOWS PARK, SHEET NO. 5, SCALE 1"=40', RHODE ISLAND DEPARTMENT OF TRANSPORTATION.

CROSSMAN ENGINEERING
Rhode Island: 151 Centerville Road, Warwick, RI 02886, Phone: (401) 738-6660
Massachusetts: 103 Commonwealth Avenue, North Attleboro, MA 02763, Phone: (508) 695-1700
Email: ce@crosmaneng.com

THESE DRAWINGS ARE THE PROPERTY OF CROSSMAN ENGINEERING AND HAVE BEEN PREPARED FOR THEIR CLIENT FOR A SPECIFIC SITE AND PROJECT. THESE DRAWINGS ARE NOT TO BE COPIED OR USED FOR ANY OTHER PURPOSE WITHOUT THE WRITTEN CONSENT OF CROSSMAN ENGINEERING.

Professional Seal
AUG 29 2019
Office of Water Resources

STEVEN M. CABRAL
No. 4847
REGISTERED PROFESSIONAL ENGINEER

PROJECT TITLE:
SINGLETON STREET SOLAR ARRAY
PLAT MAP B2, LOT 7-17
0 SINGLETON STREET
WOONSOCKET, RHODE ISLAND

PREPARED FOR:
SINGLETON GROUP, LLC.
P.O. BOX 309
235 SINGLETON STREET
WOONSOCKET, RI 02895

DRAWING TITLE:
EXISTING CONDITIONS PLAN

DATE: JULY 2019 SCALE: 1"=40'
DWG. NAME: 2392-C04-EXCN-R5.dwg

REVISIONS

NUMBER	REMARKS	DATE
1	PLANNING COMMENTS	7/16/19
2	PLANNING COMMENTS	7/29/19
3	REVIEW COMMENTS	8/1/19
4	PLANNING COMMENTS	8/2/19
5	PLANNING COMMENTS	8/20/19

DRAWING NUMBER
C4
SHEET: 5 OF 8

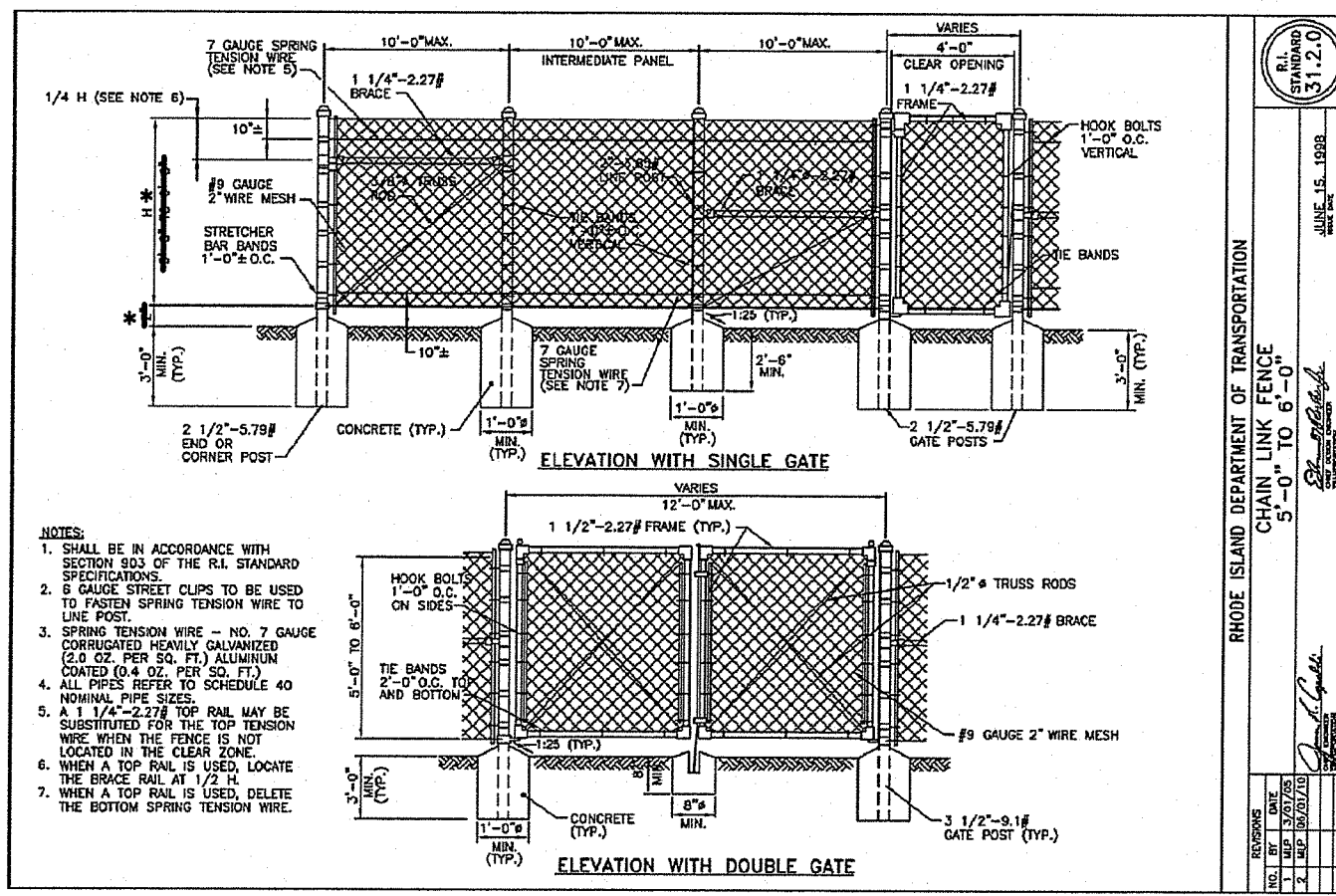

*FENCE SHALL BE 6' HIGH AND SHALL BE INSTALLED SO THAT BOTTOM RAIL/FABRIC IS 5" ABOVE GRADE.

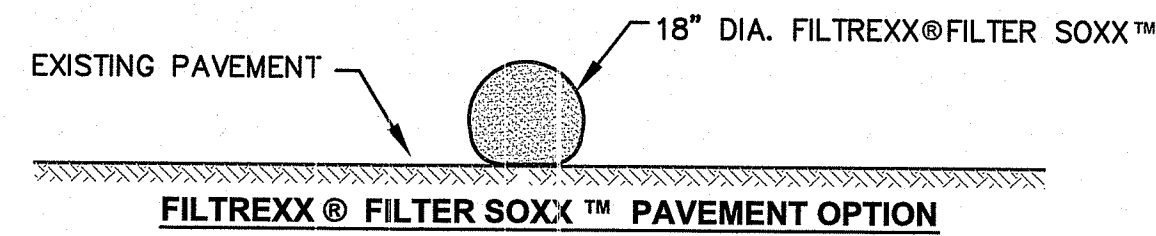
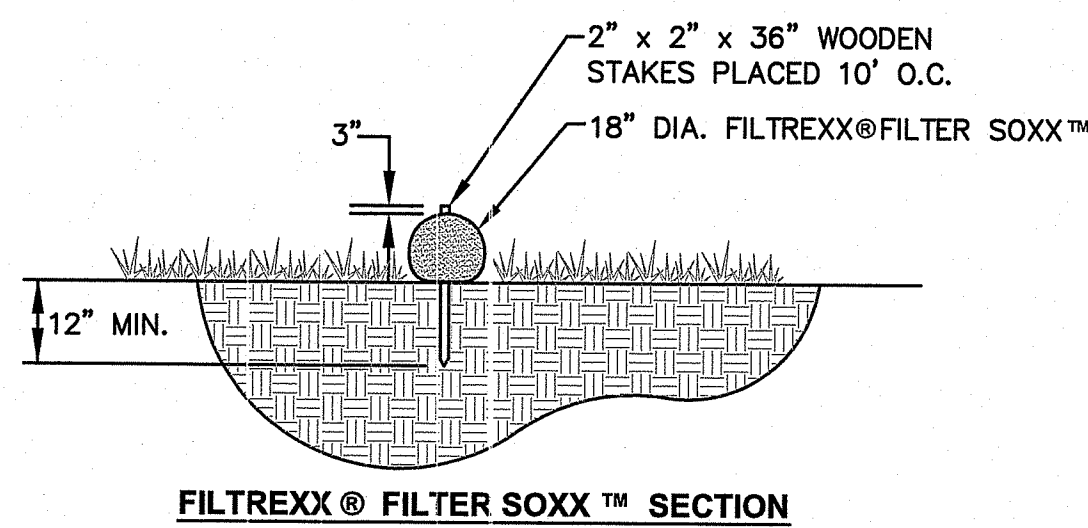

- NOTE**
- FILTREXX FILTER SOXX MAY BE USED IN LIEU OF SILT FENCE.
 - CONTRACTOR IS RESPONSIBLE TO BECOME FAMILIAR WITH THE FILTREXX PRODUCTS AND COORDINATE INSTALLATION SCHEDULES AND METHODS WITH THE ENGINEER PRIOR TO PLACEMENT.
 - ALL MATERIAL SHALL MEET FILTREXX SPECIFICATIONS.
 - COMPOST MATERIAL TO BE DISPERSED ON SITE AS DETERMINED BY ENGINEER.

FILTREXX® FILTER SOXX™ DETAIL
NOT TO SCALE

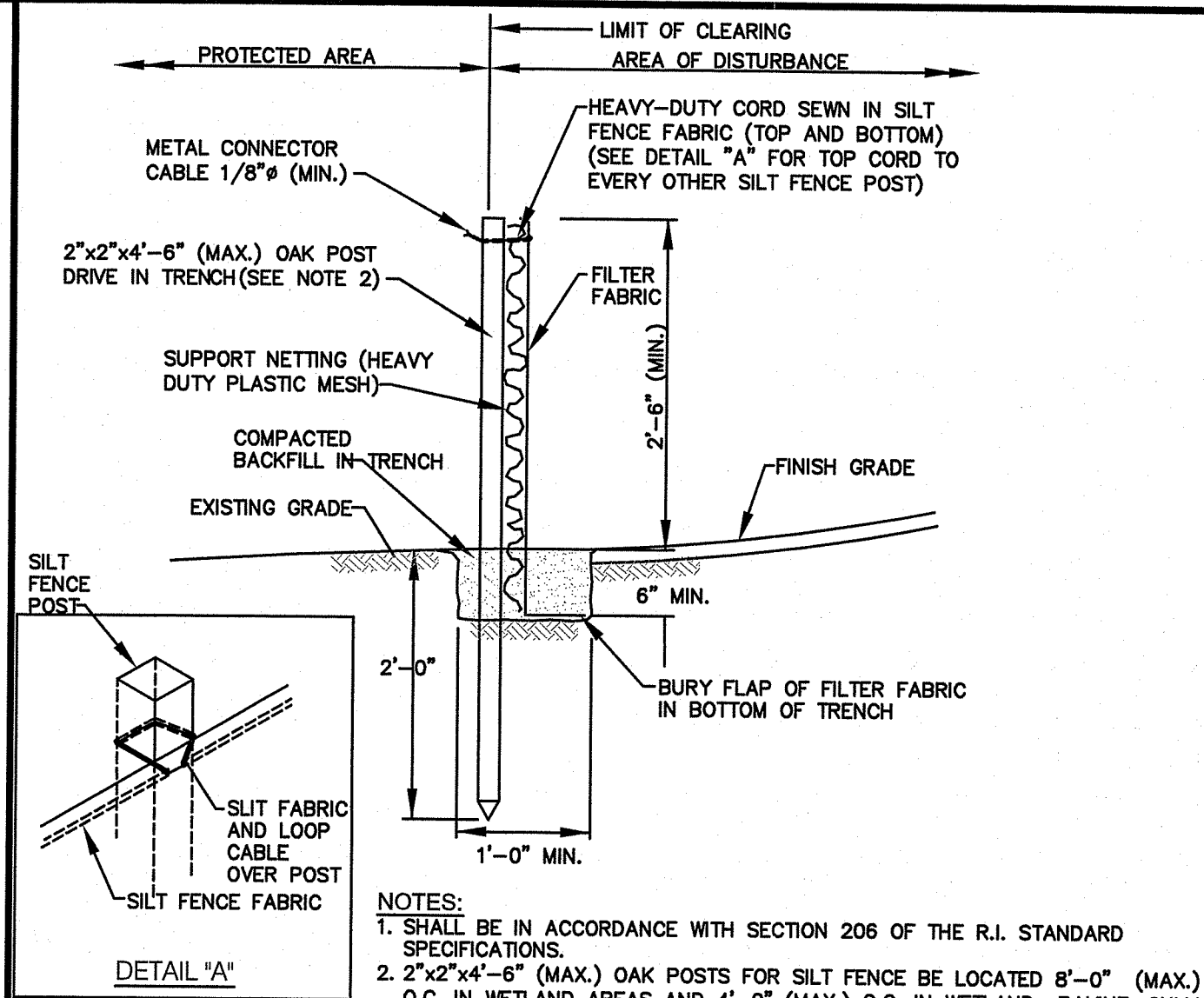

LANDSCAPE CONSTRUCTION NOTES

- FURNISH AND INSTALL ALL PLANTS SHOWN ON THE DRAWINGS SPECIFIED HEREIN, AND IN THE QUANTITIES LISTED ON THE PLANT LIST. NO SUBSTITUTIONS WILL BE PERMITTED, UNLESS APPROVED BY THE LANDSCAPE ARCHITECT.
- LOAM TO BE SCREENED, GOOD QUALITY, FERTILE, FREE OF WEEDS, STICKS, STONES OVER 3/4", AND ROOTS. SPREAD TO A MINIMUM OF 4" OVER ALL PLANTED AREAS.
- NURSERY STOCK SHALL MEET THE STANDARDS OF THE AMERICAN NURSERY AND LANDSCAPE ASSOCIATION AS TO GRADING AND QUALITY.
- ONLY NURSERY-GROWN PLANTS, GROWN IN ACCORDANCE WITH ACCEPTED HORTICULTURAL PRACTICES, AND GROWN UNDER CLIMATIC CONDITIONS SIMILAR TO THOSE IN THE LOCALITY OF THE PROJECT FOR AT LEAST TWO (2) YEARS, WILL BE ACCEPTED.
- CALIPER MEASUREMENTS FOR ALL NEW PLANT STOCK SHALL BE TAKEN SIX (6) INCHES ABOVE GRADE FOR TREES UNDER FOUR (4) INCHES AND TWELVE (12) INCHES ABOVE GRADE FOR TREES OVER FOUR (4) INCHES.
- ALL TREES SHALL BE A MINIMUM OF SEVEN (7) FEET ABOVE FINISHED GRADE WHEN TREES ARE LOCATED WITHIN VEHICULAR AND PEDESTRIAN TRAVEL WAYS.
- SET PLANTS PLUMB AND AT A LEVEL THAT AFTER SETTLEMENT THEY BEAR THE SAME RELATION TO THE SURROUNDING GROUND AS THEY BORE TO THE GROUND FROM WHICH THEY WERE DUG. SETTLE BACKFILL MATERIAL FOR PLANTS, THOROUGHLY AND PROPERLY BY FIRING OR TAMPING. FORM SAUCERS, CAPABLE OF HOLDING WATER ABOUT INDIVIDUAL PLANTS, BY PLACING RIDGES OF PLANTING SOIL AROUND EACH.
- STAKE ALL TREES OVER 5 FEET AS SHOWN ON PLANS. REMOVE STAKES AT THE END OF THE GUARANTEE PERIOD.
- WATERING:** WATER ALL PLANTS WITHIN 48 HOURS AFTER PLANTING. IF CONDITIONS WARRANT, AND AS MANY TIMES THEREAFTER TO SUSTAIN HEALTHY CONDITIONS UNTIL LANDSCAPE INSTALLATION IS COMPLETED. SATURATE THE SOIL AROUND EACH PLANT THOROUGHLY AT EACH WATERING.
- PRUNING:** PRUNE PLANTS, AS DIRECTED BY OWNER, AT THE PROJECT SITE BEFORE OR IMMEDIATELY AFTER PLANTING IN ACCORDANCE WITH THE BEST HORTICULTURAL PRACTICE. CUT BROKEN, DEAD OR INJURED BRANCHES IMMEDIATELY ABOVE THE STEM COLLAR ON THE TRUNK OR LIMB. PRUNE ALL BROKEN ROOTS ON THE PLANT SIDE OF THE BREAK. PAINT CUTS OVER 3/4" IN DIAMETER WITH TREE WOUND PAINT. PRUNING SHALL NOT DEFORM OR OTHERWISE DESTROY THE TYPICAL SHAPE OR SYMMETRY OF THE PLANT, AND SHALL NOT REDUCE THE HEIGHT BY MORE THAN ONE-THIRD. DO NOT CUT BACK THE LEADER OF THE PLANT UNLESS DIRECTED BY THE LANDSCAPE ARCHITECT.
- FERTILIZING:** FERTILIZE SHRUB BEDS WITH 10-6-4 FERTILIZER BROADCAST AT A RATE OF THREE POUNDS PER 100 SQUARE FEET OF SURFACE AREA BROADCAST. APPLY THE FERTILIZER UNIFORMLY TO THE SURFACE BEDS AND WORK INTO THE UPPER TWO INCHES OF SOIL. FERTILIZE INDIVIDUAL TREES AT A RATE OF ONE AGRIFORM PELLET PER INCH OF TRUNK DIAMETER (FOLLOW MANUFACTURER'S WRITTEN INSTRUCTIONS). APPLY A SECOND APPLICATION OF FERTILIZER TO ALL PLANT ITEMS AT THE SAME SPECIFIED RATES OVER THE MULCH AT THE END OF AN EIGHT WEEK PERIOD.
- LIMING:** ADD POWDERED LIME EVERY SIX MONTHS - OR SLOW RELEASE GRANULAR LIME-AS PER MANUFACTURER'S INSTRUCTION.
- MULCHING:** WITHIN A 72 HOUR PERIOD AFTER PLANTING, COVER ALL PLANTED AREAS WITH 3" DARK HEMLOCK MULCH. NO RED OR DYED MULCH IS TO BE USED. MULCH SHOULD BE PULLED ONE INCH AWAY FROM PLANT TRUNK OR STEM, AND NOT ALLOWED TO REST DIRECTLY AGAINST THE TRUNK OR STEM.
- QUARANTEE:** ALL PLANTS FURNISHED BY THE CONTRACTOR SHALL BE GUARANTEED FOR A PERIOD OF ONE (1) YEAR AFTER PRELIMINARY INSPECTION AND SHALL BE ALIVE AND IN SATISFACTORY GROWTH AT THE END OF THE GUARANTEE PERIOD. ALL DEAD OR DYING PLANT MATERIAL SHALL BE REPLACED AT ONCE BY THE CONTRACTOR, FREE OF CHARGE.

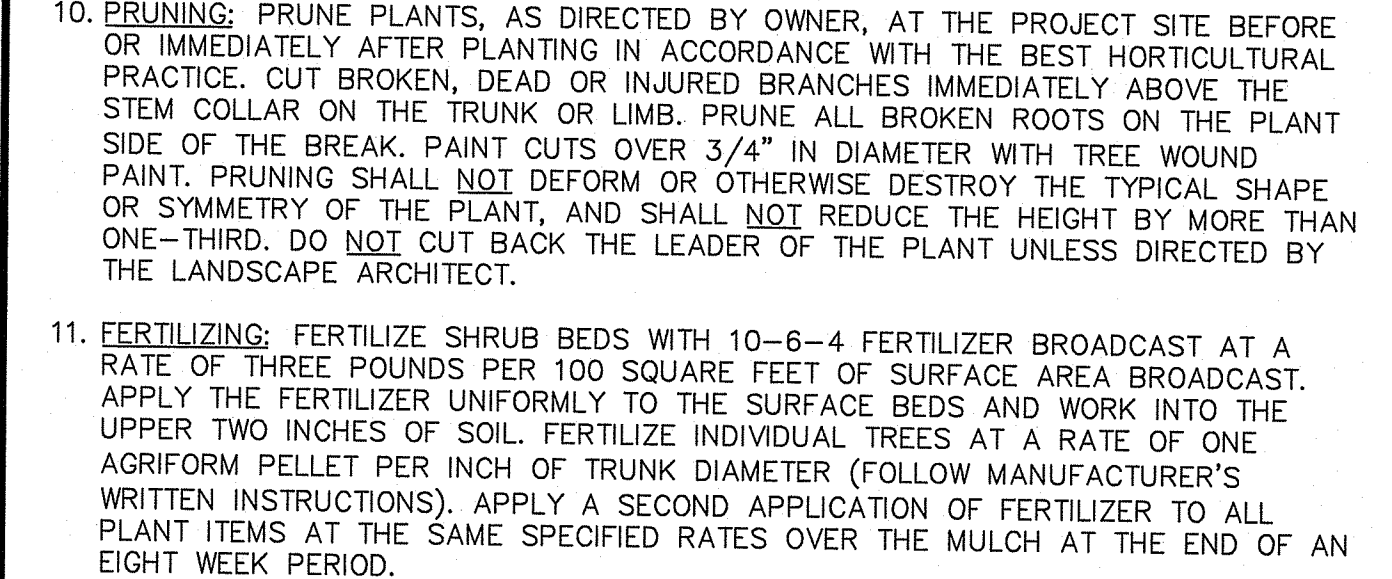

- TREE PROTECTION NOTES**
- R.I. STD 51.1.1 DRIP LINE TREE PROTECTION DEVICE SHALL BE INSTALLED AT ALL EXISTING TREES TO REMAIN IN THE VICINITY OF CONSTRUCTION PRIOR TO THE START OF CONSTRUCTION.
 - DAMAGED ROOTS SHALL BE PROPERLY PRUNED BY A LICENSED ARBORIST, REFER TO PRUNING NOTES ABOVE (LANDSCAPE CONSTRUCTION NOTE 10).
 - PAINT, SOLVENTS, OR OTHER FOREIGN MATERIAL SHALL NOT BE BE DISPOSED OF WITHIN THE DRIP LINE OF EXISTING TREES.
 - KEEP ALL GRADING AND OTHER EQUIPMENT THAT MAY SUBJECT TREES TO DAMAGE DIRECTLY OR INDIRECTLY AWAY FROM THE DRIP LINE OF THE TREE. IF REQUIRED, ERECT A THREE-FOOT HIGH MINIMUM VISIBLE FENCE BARRIER OUTSIDE OF THE DRIP LINE OF THE TREE TO KEEP ALL DANGEROUS EQUIPMENT OUT OF THIS ZONE.

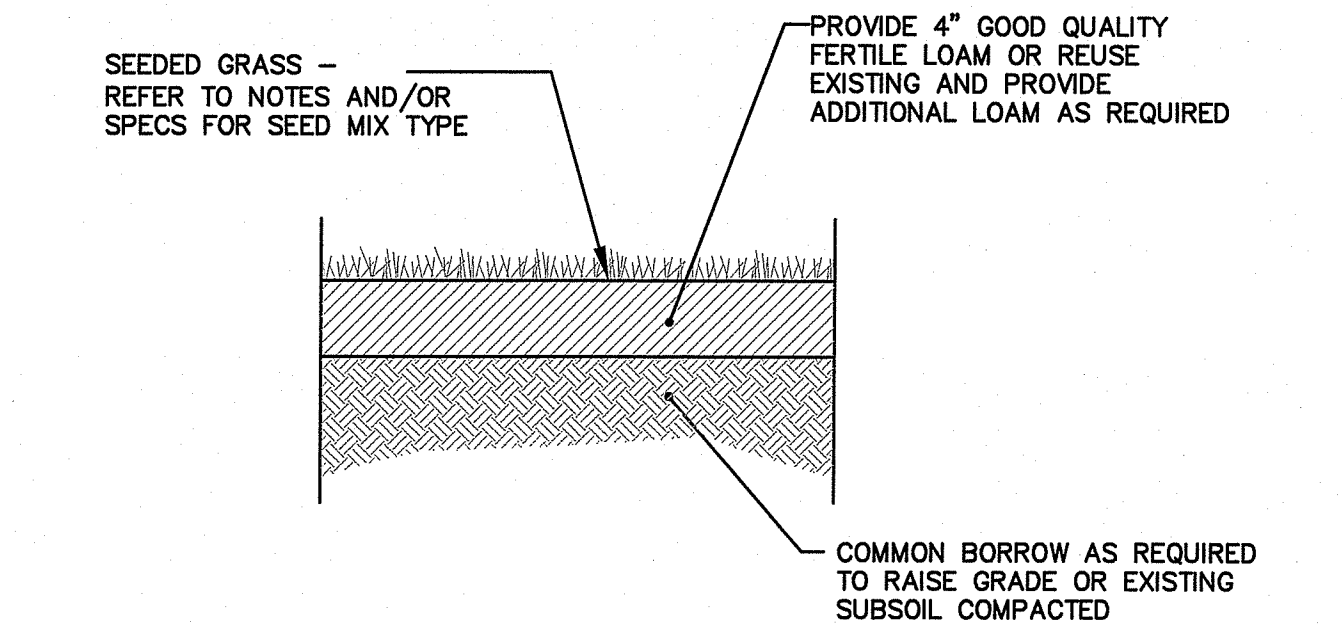
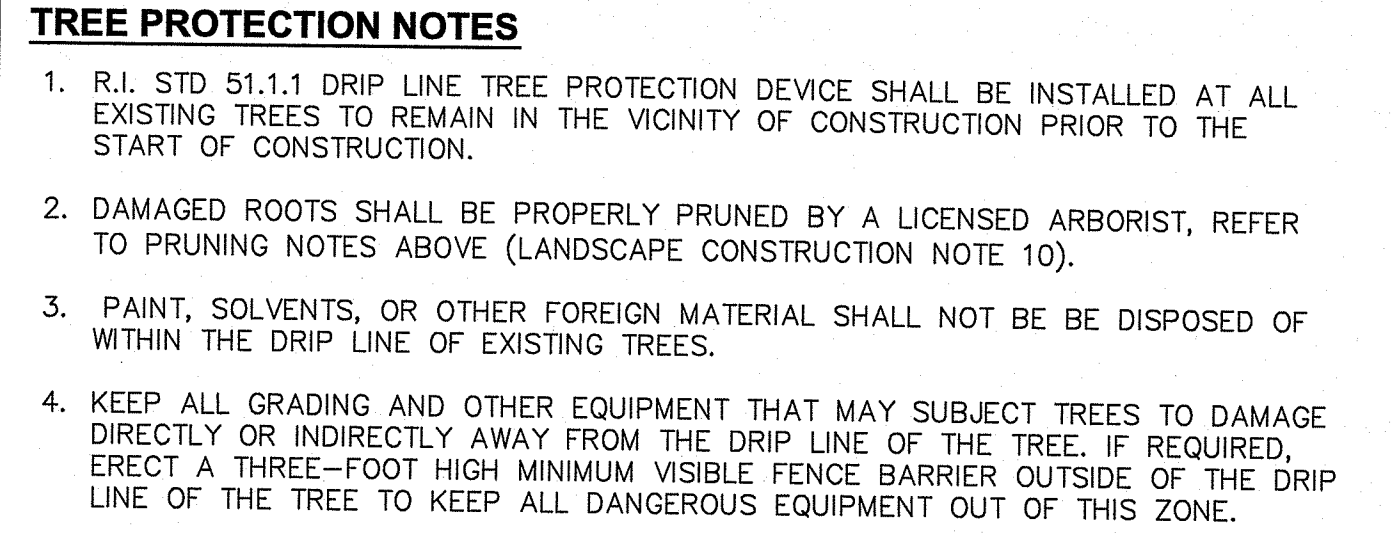

NOTE: THE CONTRACTOR WILL BE RESPONSIBLE FOR WATERING LAWN DURING THE COURSE OF THE GROWING SEASON FOR A PERIOD OF ONE (1) YEAR.

SEED MIX

A LOW GROW POLLINATOR SEED MIX SHALL BE USED ON SITE. THE CONTRACTOR SHALL PROVIDE THE OWNER AND ENGINEER A SEED MIX SUBMITTAL FOR REVIEW AND APPROVAL. THE SEED MIX SHALL ALSO BE APPROVED BY THE CITY OF WOONSOCKET PRIOR TO PLACEMENT.

- SEEDING NOTES**
- LOAM SHALL BE SPREAD TO A MINIMUM DEPTH OF 4" OVER ALL AREAS DESIGNATED ON PLANS.
 - SHAPE AND SMOOTH THE SURFACE TO THE LINES AND GRADES AS SHOWN ON PLANS.
 - FERTILIZE WITH 10-10-10 OR EQUIVALENT ANALYSIS. AT LEAST 40% OF THE FERTILIZER NITROGEN SHALL BE IN A SLOW RELEASE FORM. INCORPORATE THE FERTILIZER INTO THE TOP 3 TO 4 INCHES OF THE PLANTING SOIL. APPLY AT THE RATE OF 8 POUNDS PER 1,000 SQUARE FEET AT SEEDING.
 - LIME: SPREAD EVENLY AND WORK INTO THE SOIL DURING PREPARATION OF SEED BED AT THE RATE OF ONE TON PER ACRE. INCORPORATE INTO THE SOIL BY DICING OR OTHER APPROVED METHOD. DISTRIBUTE LIME UNIFORMLY AND WORK INTO TOP 4 INCHES OF TOP SOIL (MINIMUM) AND UNIFORMLY BLEND BY DICING OR ROTOTILLING.
 - APPLICATION OF SEED:
 - RATE OF APPLICATION OF SEED SHALL BE 8 POUNDS PER 1,000 SQUARE FEET OR AS INDICATED ON PLANS.
 - FALL SEEDING: MARCH 15 TO MAY 31. THE CONTRACTOR SHALL KEEP ALL SEEDED AREAS WATERED AND IN GOOD CONDITION, RESEEDING IF AND WHEN NECESSARY FOR AN 8 WEEK PERIOD OR UNTIL A GOOD, HEALTHY, UNIFORM GROWTH IS ESTABLISHED OVER THE ENTIRE AREA. THE CONTRACTOR SHALL ALSO MAINTAIN THESE AREAS IN AN APPROVED CONDITION UNTIL PROVISIONAL ACCEPTANCE.
 - THE CONTRACTOR SHALL KEEP ALL SEEDED AREAS WATERED AND IN GOOD CONDITION, RESEEDING IF AND WHEN NECESSARY FOR AN 8 WEEK PERIOD OR UNTIL A GOOD, HEALTHY, UNIFORM GROWTH IS ESTABLISHED OVER THE ENTIRE AREA. THE CONTRACTOR SHALL ALSO MAINTAIN THESE AREAS IN AN APPROVED CONDITION UNTIL PROVISIONAL ACCEPTANCE.
 - DURING THIS PERIOD, WATER TURF AS NECESSARY TO MAINTAIN AN ADEQUATE SUPPLY OF MOISTURE WITHIN THE ROOT ZONE. AN ADEQUATE SUPPLY OF MOISTURE IS EQUIVALENT OF ONE INCH OF ABSORBED WATER PER WEEK THAT IS DELIVERED AT WEEKLY INTERVALS IN THE FORM OF NATURAL RAIN OR IS AUGMENTED AS REQUIRED BY PERIODIC WATERING.
 - OVERSEED WHEN NECESSARY TO PROMOTE GRASS GROWTH.
 - REPLANT AREAS VOID OF TURF ONE SQUARE FOOT OR LARGER.
 - SEED ALL AREAS DESIGNATED ON PLAN AS WELL AS ALL DISTURBED EXISTING AREAS WITH THE LOW GROW SEED MIX.

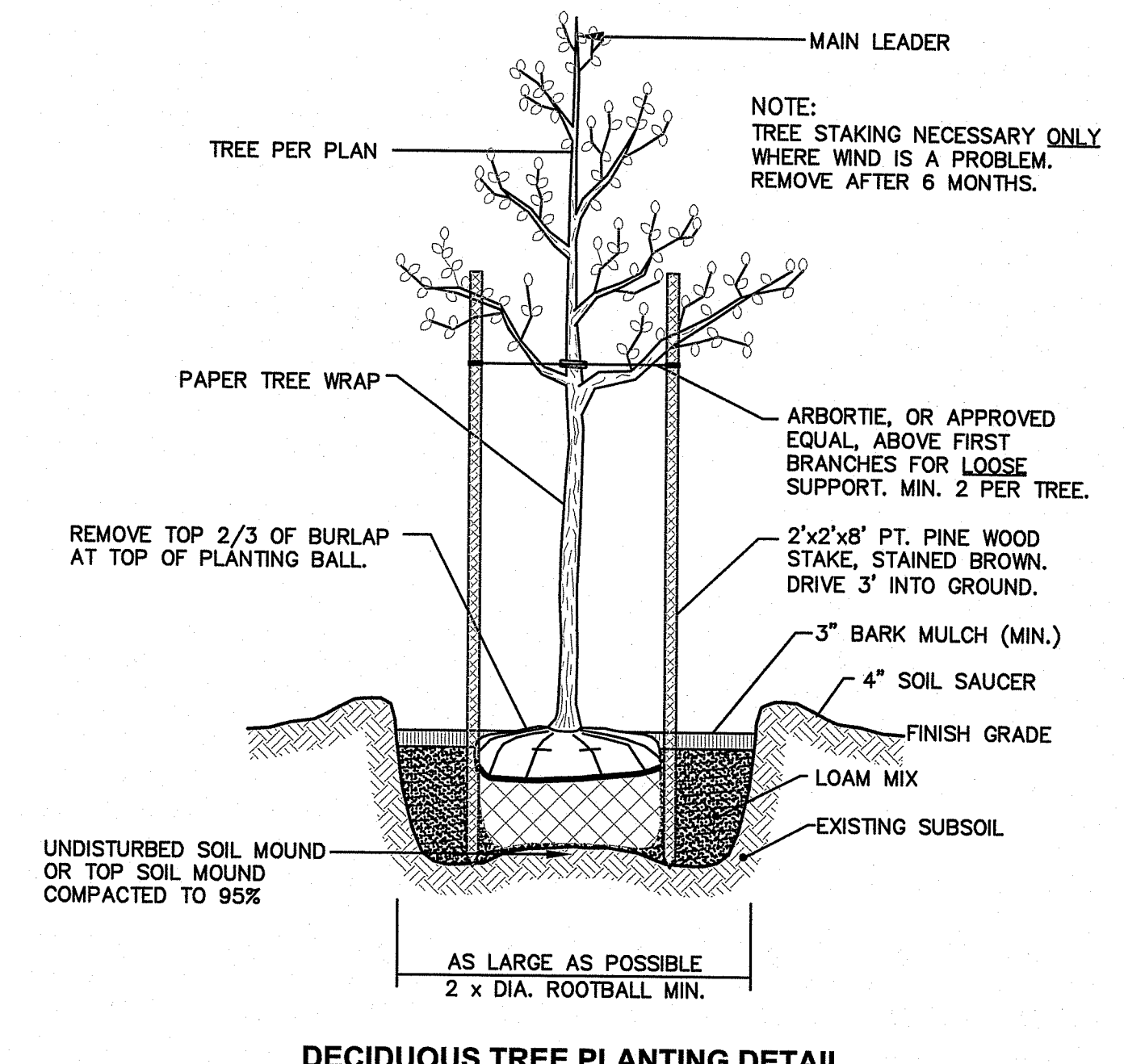
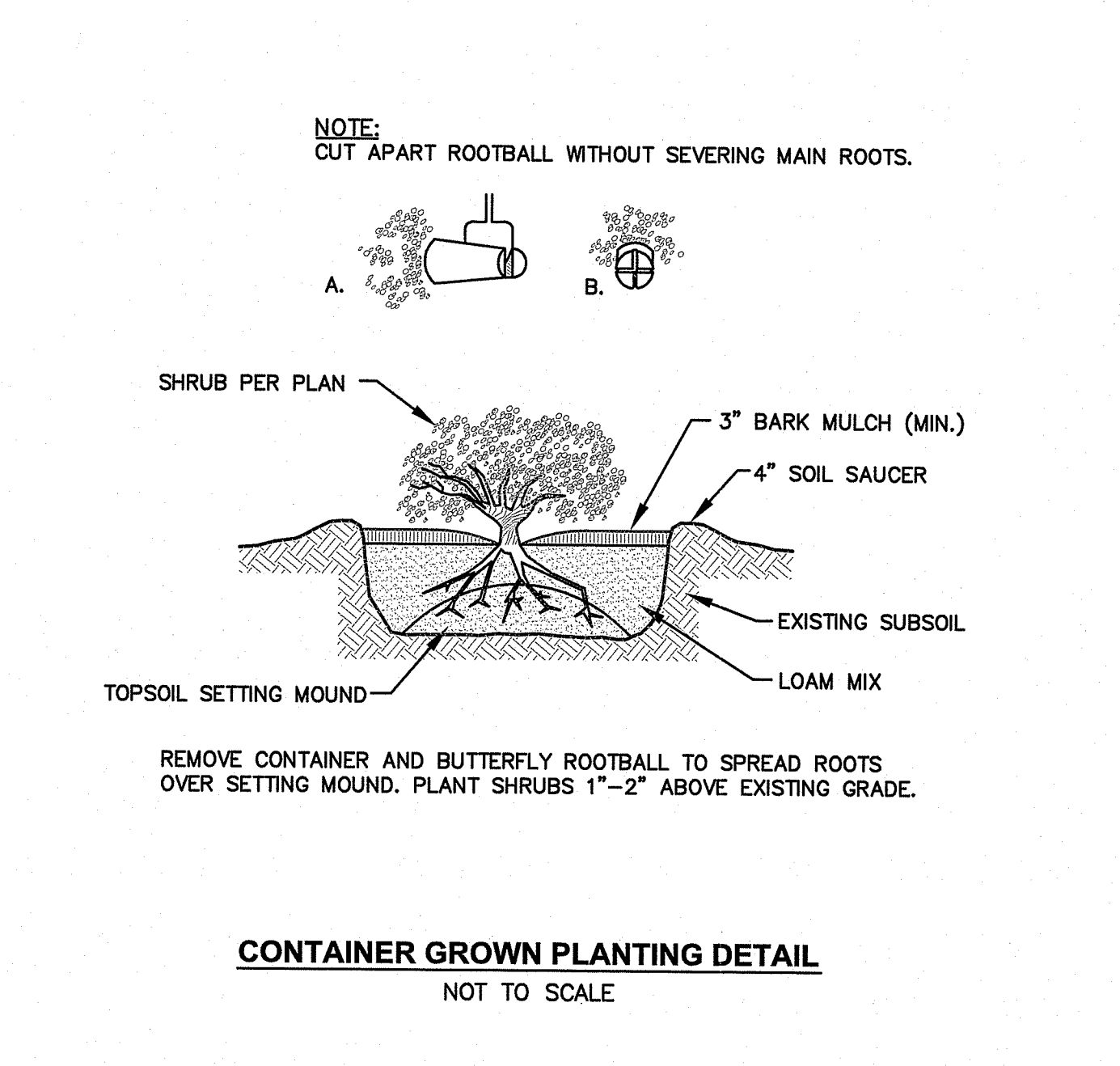
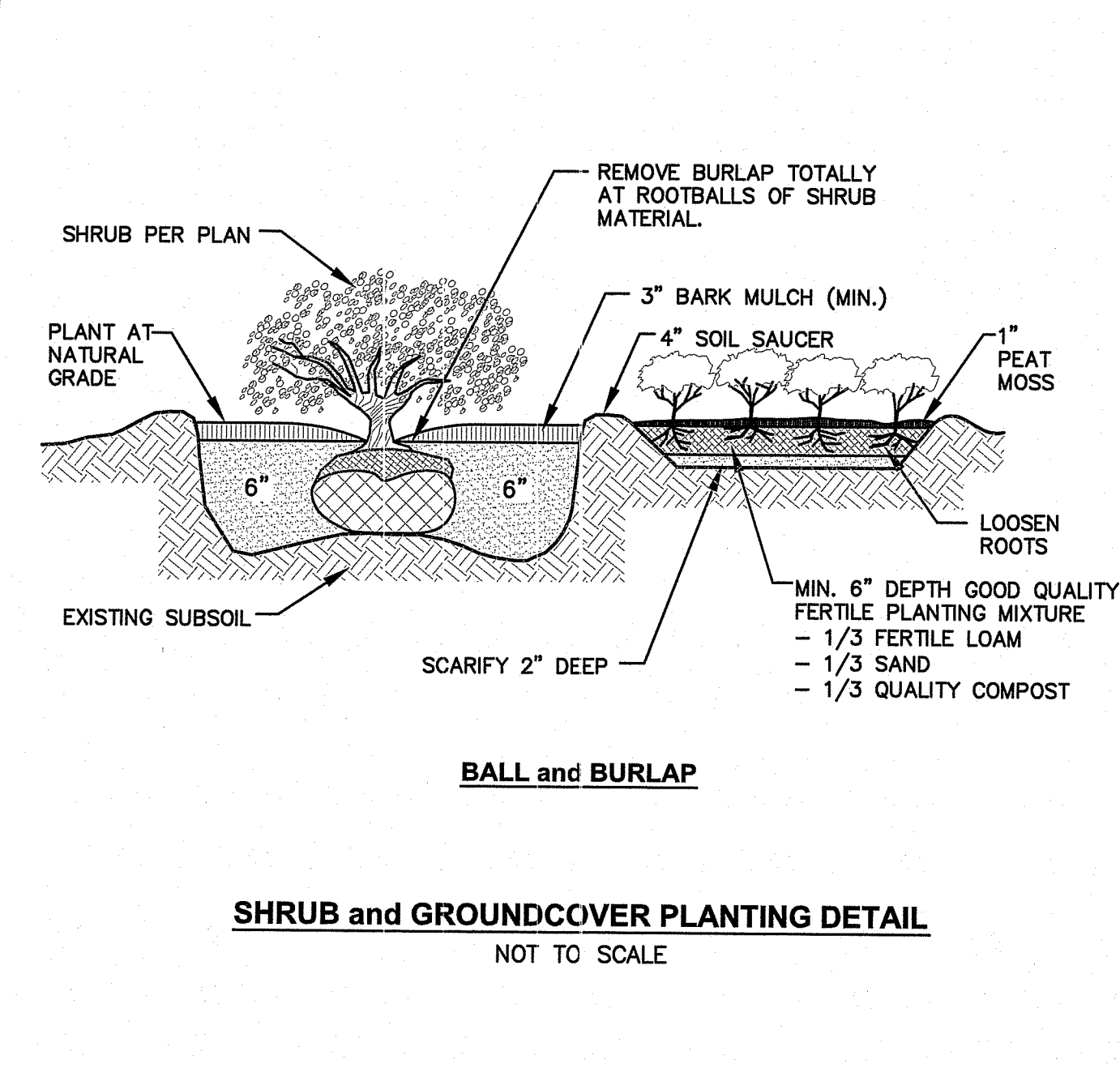
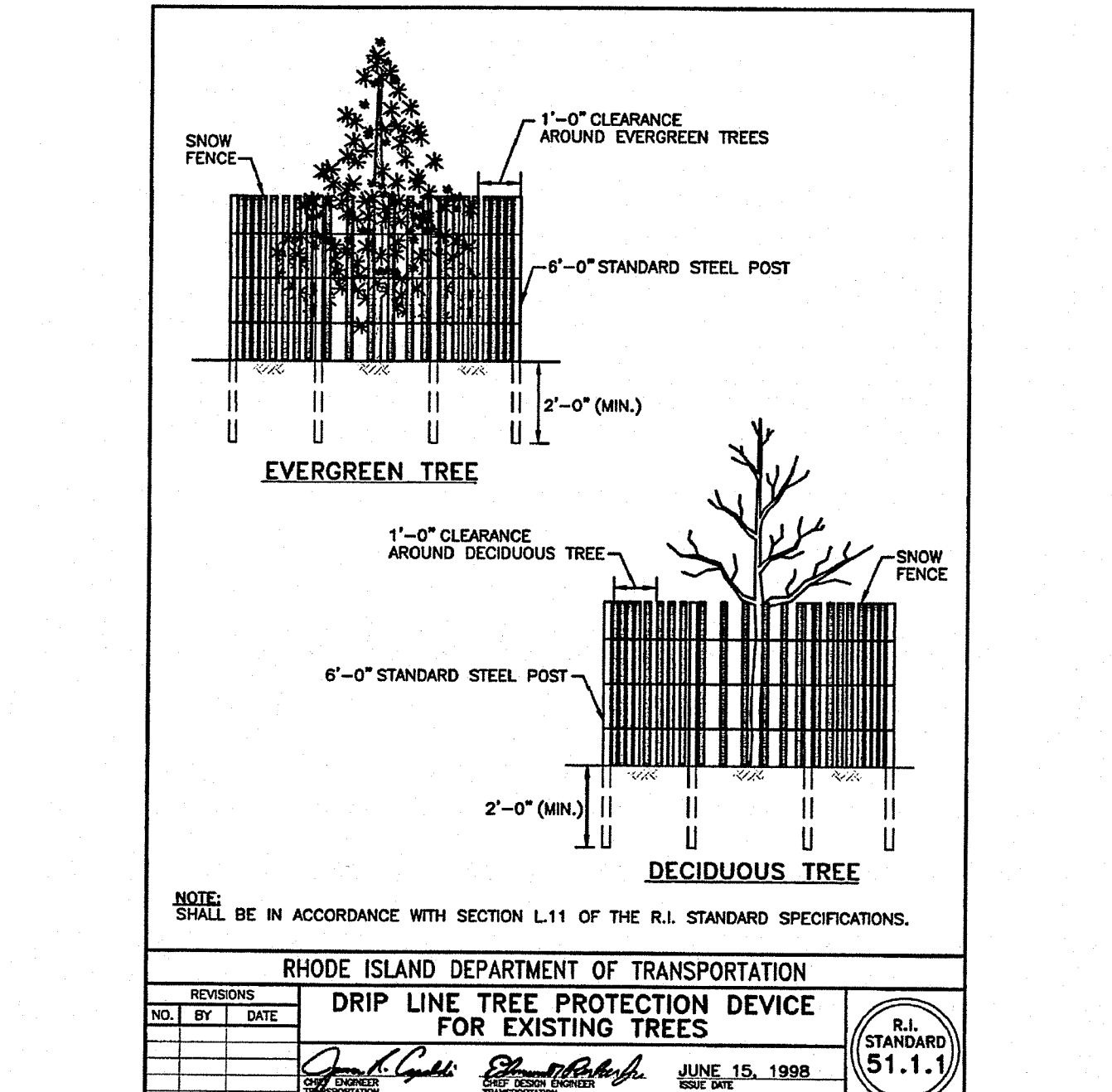
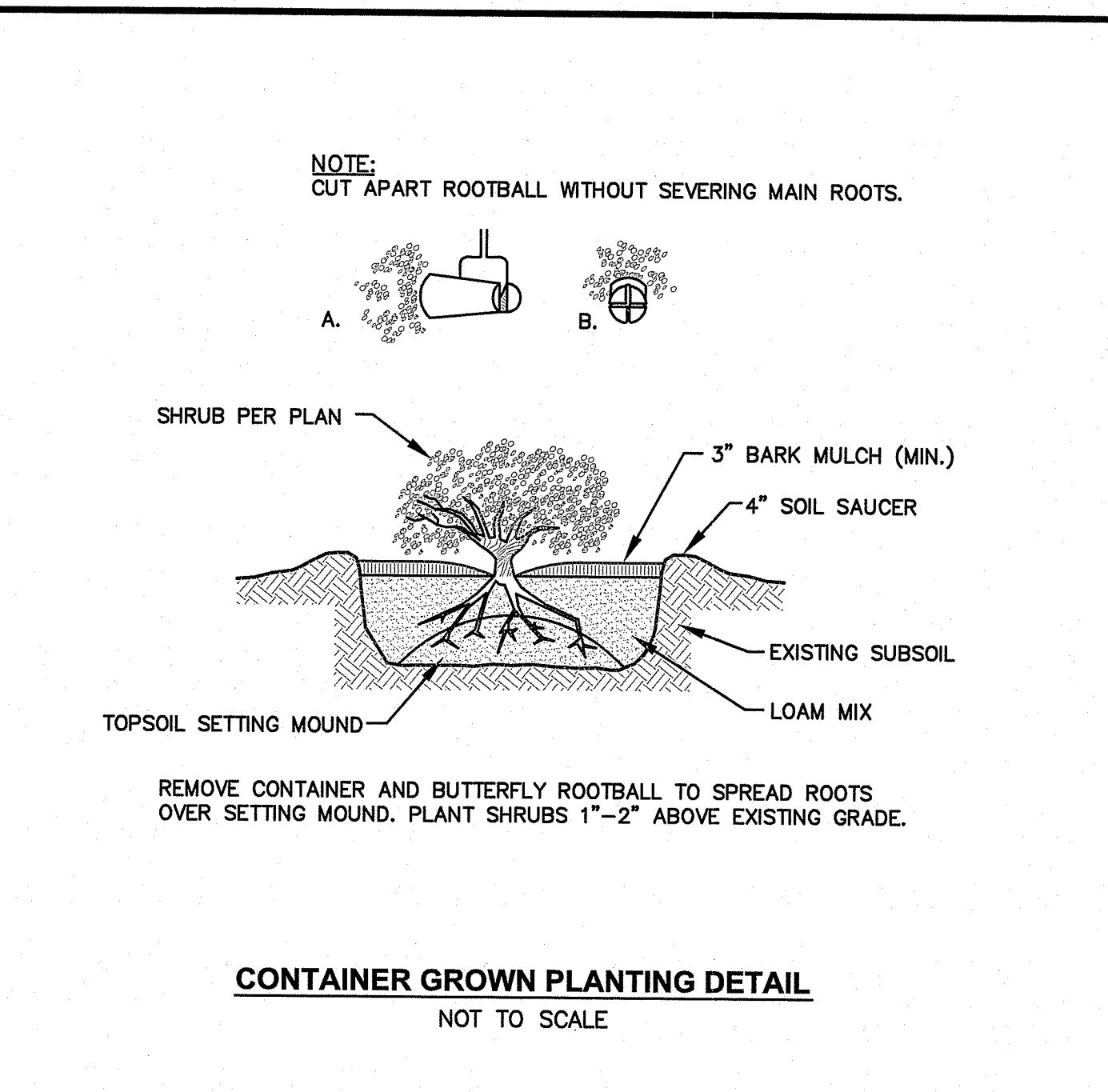
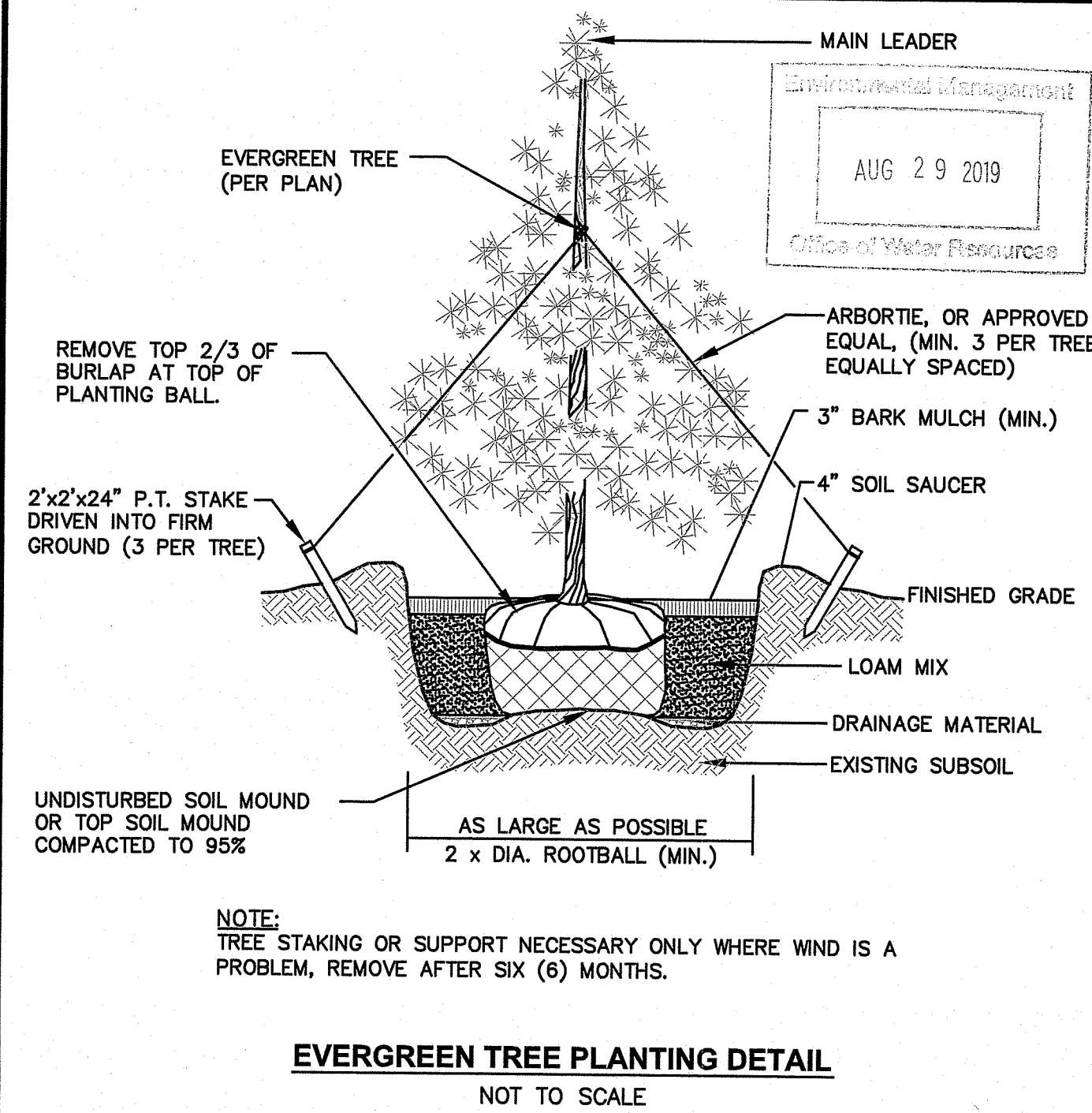

CROSSMAN ENGINEERING

Rhode Island: 151 Centerville Road, Warwick, RI 02886, Phone: (401) 738-5660
 Massachusetts: 103 Commonwealth Avenue, North Attleboro, MA 02763, Phone: (508) 695-1700
 Email: cel@crossmaneng.com

THESE DRAWINGS ARE THE PROPERTY OF CROSSMAN ENGINEERING AND HAVE BEEN PREPARED FOR THEIR CLIENT FOR A SPECIFIC SITE AND PROJECT. THESE DRAWINGS ARE NOT TO BE COPIED OR USED FOR ANY OTHER PURPOSE WITHOUT THE WRITTEN CONSENT OF CROSSMAN ENGINEERING.

DEPARTMENT OF ENVIRONMENTAL MANAGEMENT
 OFFICE OF WATER RESOURCES
 FRESHWATER WETLANDS PROGRAM
 APPROVED WITH CONDITIONS
 AS SPECIFIED IN THE LETTER OF APPROVAL
 DATED DEC 12 2019 FILE # 19-02-22
 NO CHANGES ALLOWED WITHOUT PRIOR APPROVAL
 APPROVED PLANS MUST BE AT CONSTRUCTION SITE

STEVEN M. CABRAL
 No. 4847
 REGISTERED PROFESSIONAL ENGINEER

PROJECT TITLE:
SINGLETON STREET SOLAR ARRAY
 PLAT MAP B2, LOT 7-17
 0 SINGLETON STREET
 WOONSOCKET, RHODE ISLAND

PREPARED FOR:
SINGLETON GROUP, LLC.
 P.O. BOX 309
 235 SINGLETON STREET
 WOONSOCKET, RI 02895

DRAWING TITLE:
MISCELLANEOUS DETAIL PLAN No. 1

DATE: JULY 2019 SCALE: NOT TO SCALE
 DWG. NAME: 2392-C06-DETAIL-R5.dwg

NUMBER	REVISIONS	DATE
1	PLANNING COMMENTS	7/16/19
2	PLANNING COMMENTS	7/29/19
3	REVIEW COMMENTS	8/1/19
4	PLANNING COMMENTS	8/2/19
5	PLANNING COMMENTS	8/20/19

DRAWING NUMBER
C6
 SHEET: 7 OF 8

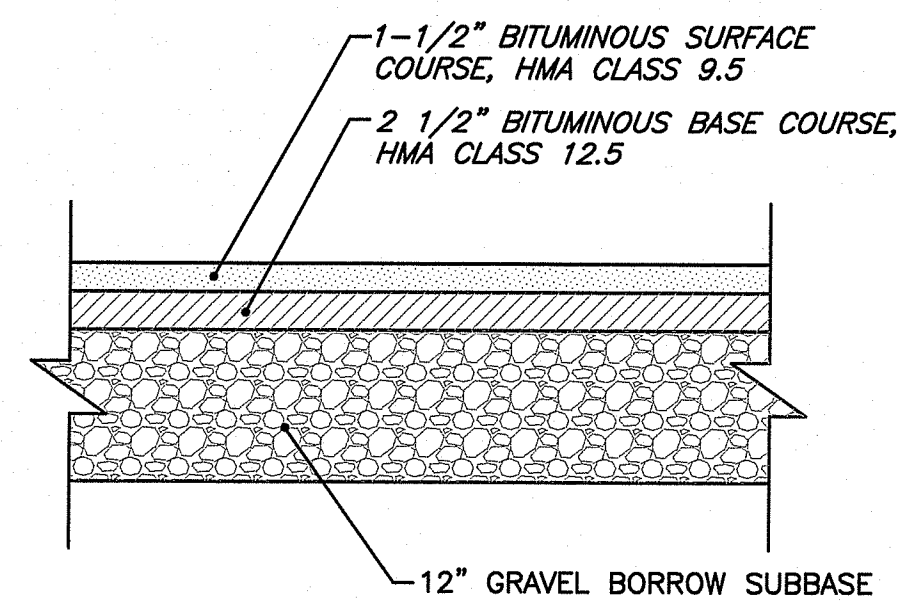

NOTES

1. THE ABOVE PAVEMENT THICKNESS REPRESENTS THE MINIMUM THICKNESS FOR PASSENGER VEHICLE AREAS.

TYPICAL PAVEMENT STRUCTURE DETAIL
NOT TO SCALE

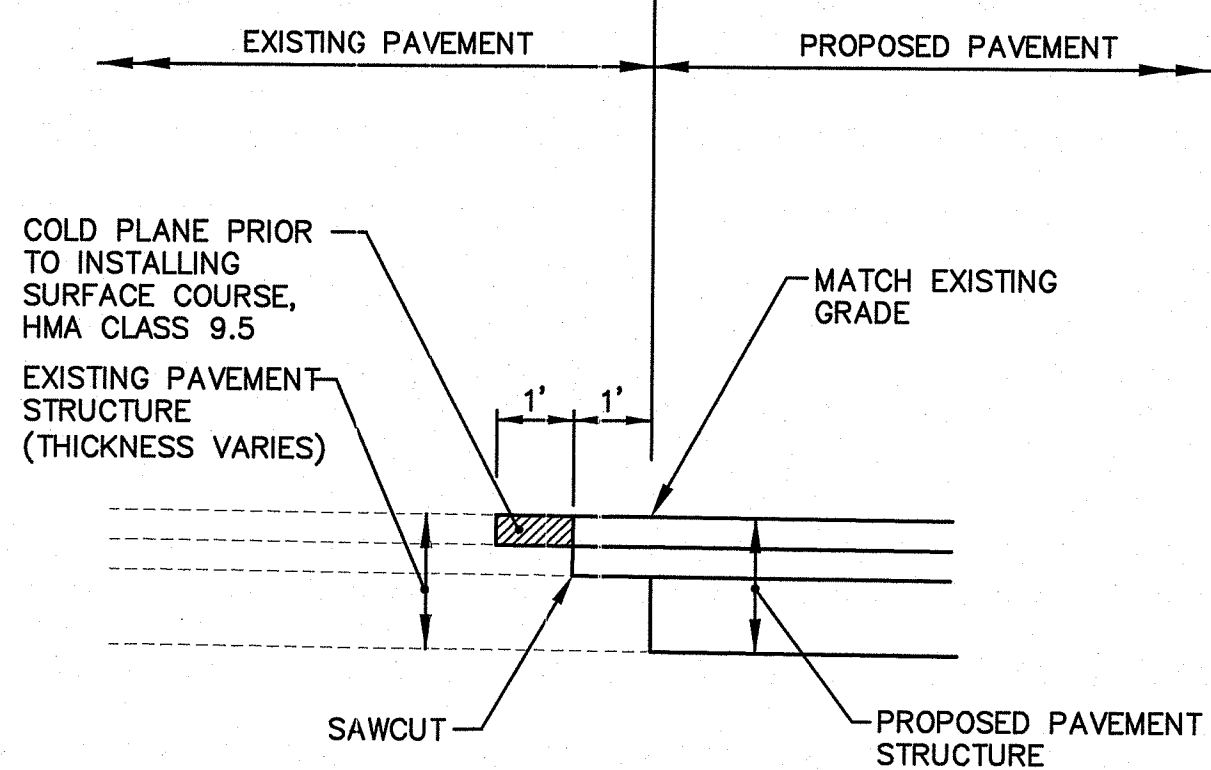

PROPOSED PAVEMENT MATCH AT EXISTING PAVEMENT
NOT TO SCALE

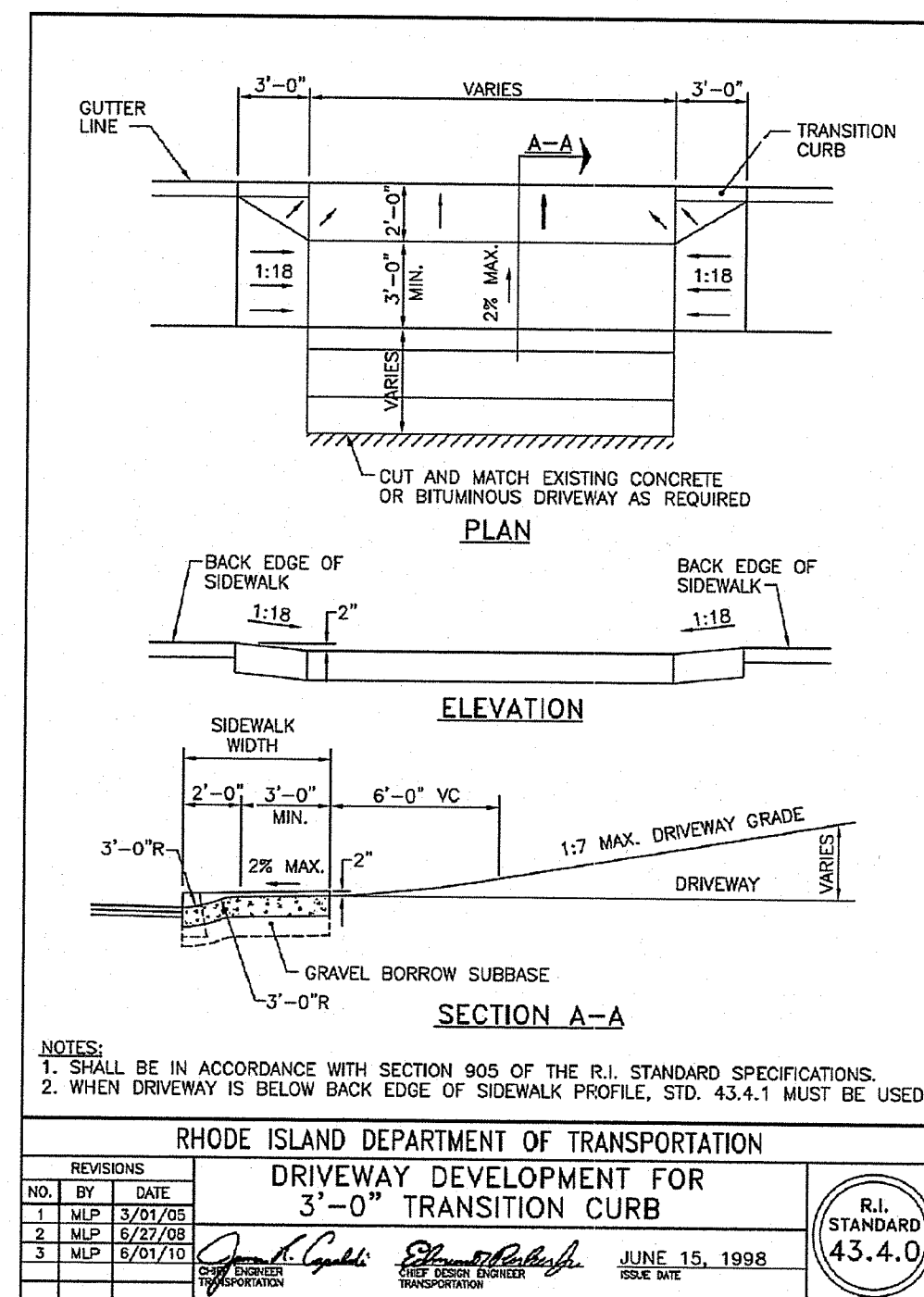

REVISIONS

NO.	BY	DATE
1	M.P.	3/27/05
2	M.P.	6/27/08
3	M.P.	6/27/10

RHODE ISLAND DEPARTMENT OF TRANSPORTATION
DRIVEWAY DEVELOPMENT FOR
3'-0" TRANSITION CURB

JUNE 15, 1998
R.I. STANDARD 43.4.0

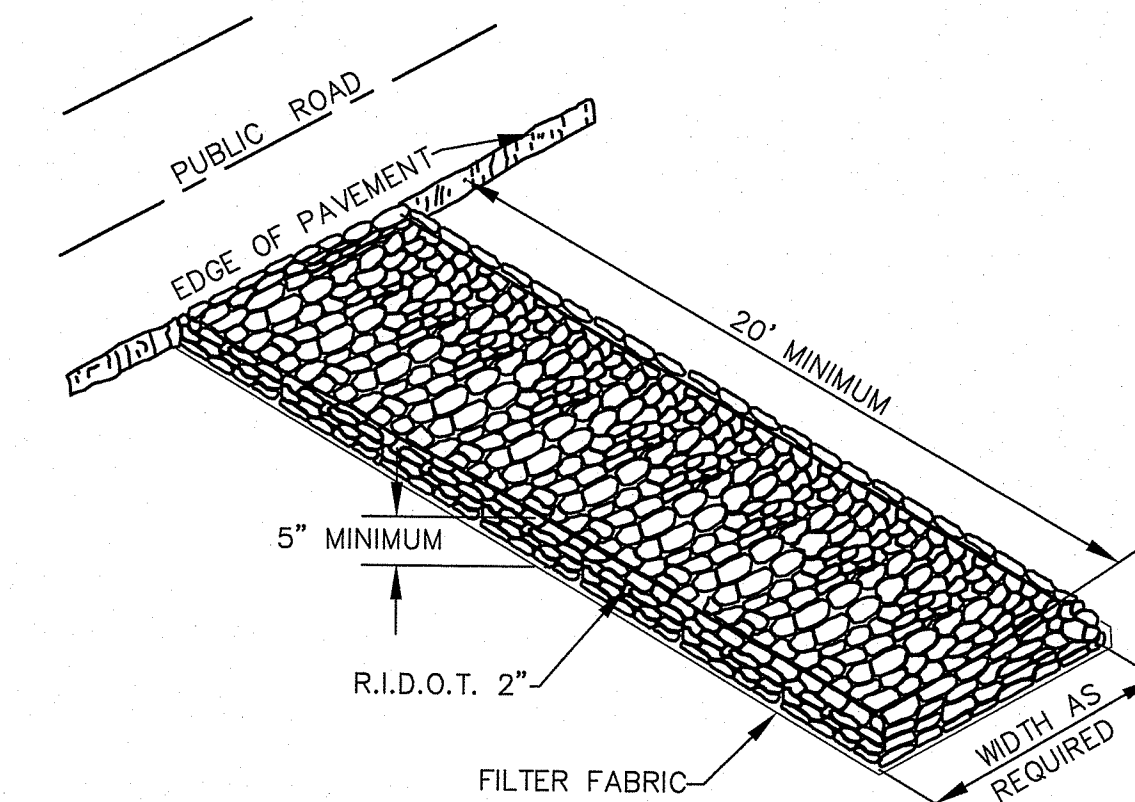

CONSTRUCTION ENTRANCE DETAIL
NOT TO SCALE

DEPARTMENT OF ENVIRONMENTAL MANAGEMENT
OFFICE OF WATER RESOURCES
FRESHWATER WETLANDS PROGRAM
APPROVED WITH CONDITIONS
AS SPECIFIED IN THE LETTER OF APPROVAL
DATED DEC 12 2019 FILE # 19-0262
NO CHANGES ALLOWED WITHOUT PRIOR APPROVAL
APPROVED PLANS MUST BE AT CONSTRUCTION SITE

Stephen M. Cabral

CROSSMAN ENGINEERING
Rhode Island
151 Centerville Road
Warwick, RI 02886
Phone: (401) 738-6660
Email: ce@crossmaneng.com

Massachusetts
103 Commonwealth Avenue
North Attleboro, MA 02763
Phone: (508) 695-1700

- Civil
- Transportation
- Environmental
- Site Planning
- Surveying
- Permitting
- Landscape Architecture

THESE DRAWINGS ARE THE PROPERTY OF CROSSMAN ENGINEERING AND HAVE BEEN PREPARED FOR THEIR CLIENT FOR A SPECIFIC SITE AND PROJECT. THESE DRAWINGS ARE NOT TO BE COPIED OR USED FOR ANY OTHER PURPOSE WITHOUT THE WRITTEN CONSENT OF CROSSMAN ENGINEERING.

Environmental Management
AUG 29 2019
Office of Water Resources

STEVEN M. CABRAL
No. 4847
REGISTERED PROFESSIONAL ENGINEER

PROJECT TITLE:

**SINGLETON STREET
SOLAR ARRAY**

PLAT MAP B2, LOT 7-17

0 SINGLETON STREET
WOONSOCKET, RHODE ISLAND

PREPARED FOR:

**SINGLETON
GROUP, LLC.**
P.O. BOX 309
235 SINGLETON STREET
WOONSOCKET, RI 02895

DRAWING TITLE:

**MISCELLANEOUS
DETAIL PLAN No. 2**

DATE: JULY 2019 SCALE: NOT TO SCALE

DWG. NAME: 2392-C07-DETAIL2-R5.dwg

REVISIONS

NUMBER	REMARKS	DATE
1	PLANNING COMMENTS	7/16/19
2	PLANNING COMMENTS	7/29/19
3	REVIEW COMMENTS	8/1/19
4	PLANNING COMMENTS	8/2/19
5	PLANNING COMMENTS	8/20/19

DRAWING NUMBER

C7

SHEET: 8 OF 8

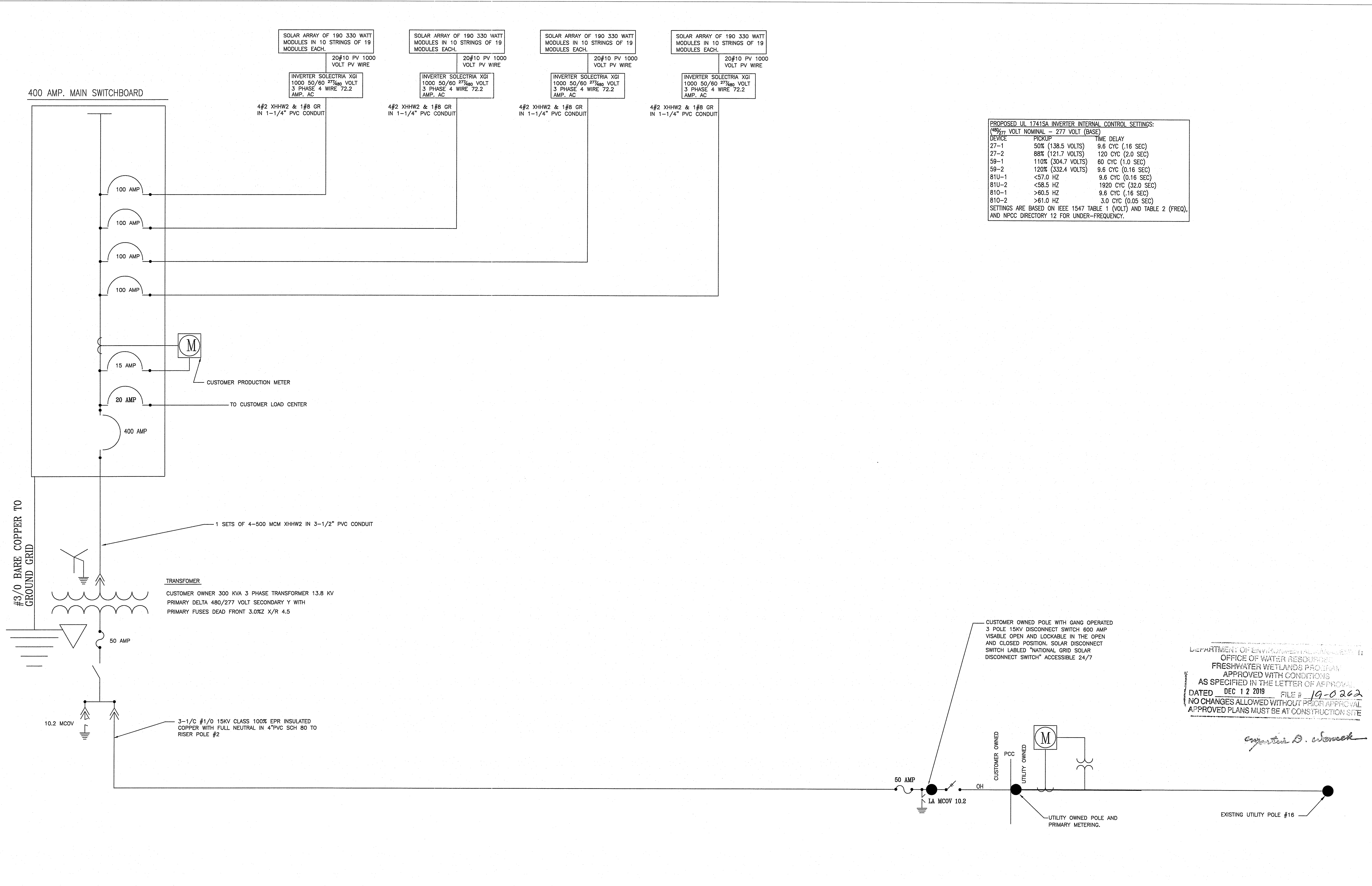

PROPOSED UL 1741SA INVERTER INTERNAL CONTROL SETTINGS:

480/277 VOLT NOMINAL - 277 VOLT (BASE)	PICKUP	TIME DELAY
27-1	50% (138.5 VOLTS)	9.6 CYC (16 SEC)
27-2	88% (121.7 VOLTS)	120 CYC (2.0 SEC)
59-1	110% (304.7 VOLTS)	60 CYC (1.0 SEC)
59-2	120% (332.4 VOLTS)	9.6 CYC (0.16 SEC)
81U-1	<57.0 HZ	9.6 CYC (0.16 SEC)
81U-2	<58.5 HZ	1920 CYC (32.0 SEC)
81O-1	>60.5 HZ	9.6 CYC (.16 SEC)
81O-2	>61.0 HZ	3.0 CYC (0.05 SEC)

SETTINGS ARE BASED ON IEEE 1547 TABLE 1 (VOLT) AND TABLE 2 (FREQ), AND NPCC DIRECTORY 12 FOR UNDER-FREQUENCY.

DEPARTMENT OF ENVIRONMENTAL MANAGEMENT
 OFFICE OF WATER RESOURCES
 FRESHWATER WETLANDS PROGRAM
 APPROVED WITH CONDITIONS
 AS SPECIFIED IN THE LETTER OF APPROVAL
 DATED DEC 12 2019 FILE # 19-0262
 NO CHANGES ALLOWED WITHOUT PRIOR APPROVAL
 APPROVED PLANS MUST BE AT CONSTRUCTION SITE

Christopher D. Chouh

SEE DRAWING E-2 SITE PLAN FOR MORE INFORMATION

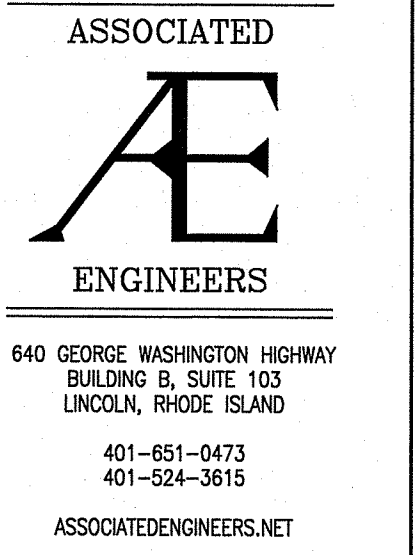

REVISIONS:

No	DATE	REVISION
1		

APPROVED FOR PERMITTING
 AUG 29 2019
 Office of Water Resources

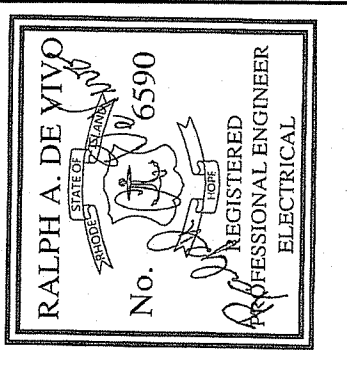

ECONOX RENEWABLES INC.
 0 SINGLETON STREET
 WOONSOCKET, RI

PROJECT TITLE:

PROJECT STATUS: ISSUED FOR PERMITTING
 DRAWING TITLE: 249.8 KW/DC - 200.0 KW/AC ELECTRICAL ONE LINE

PROJECT No.: 17075
 DRAWN BY: RAD
 CHECKED BY: RAD
 CAD FILE: 17075
 DATE: 9 MAR 2019

SHEET No:
E-1

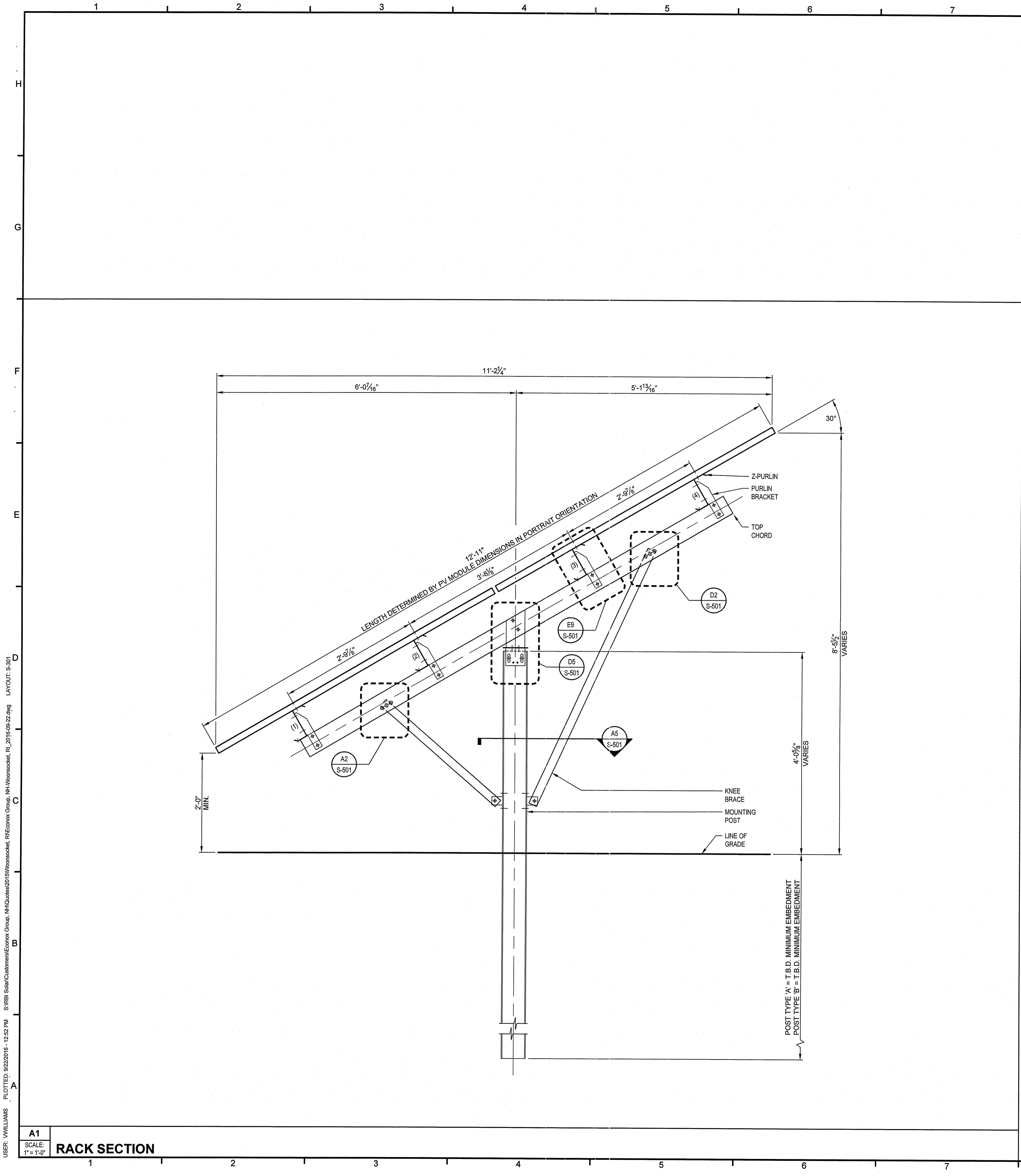

A1
SCALE: 1" = 1'-0"
RACK SECTION

G8
SCALE: 1/4" = 1'-0"
4WP2 BAY PLAN VIEW

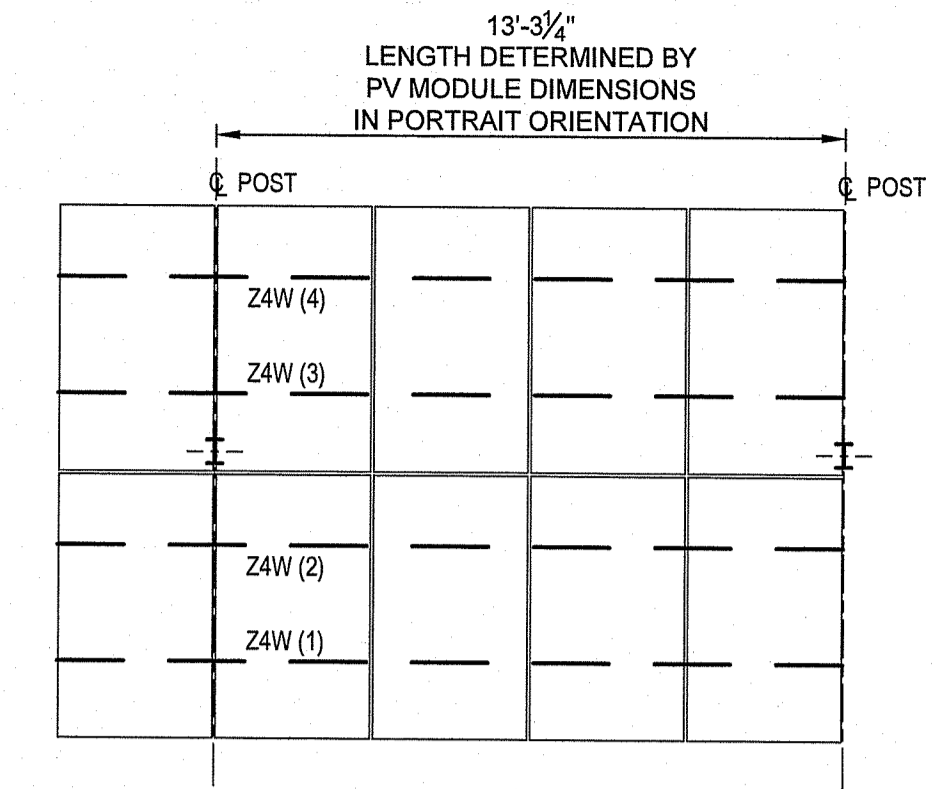

G10
SCALE: 1/4" = 1'-0"
4EP2 BAY PLAN VIEW

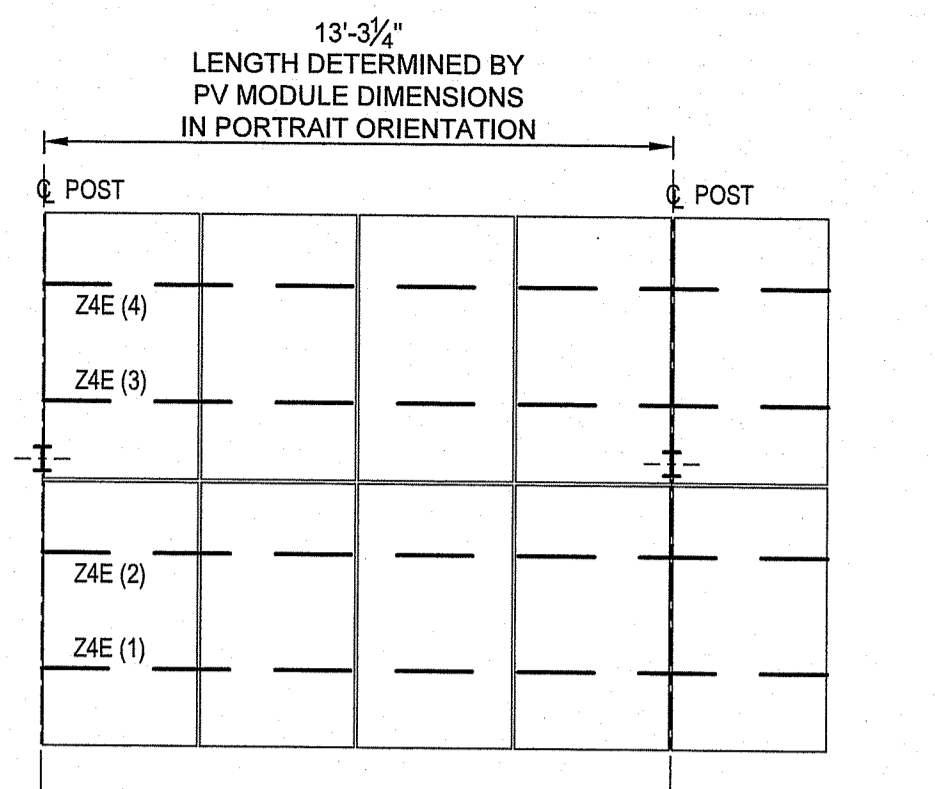

E10
SCALE: 1/4" = 1'-0"
5P2 BAY PLAN VIEW

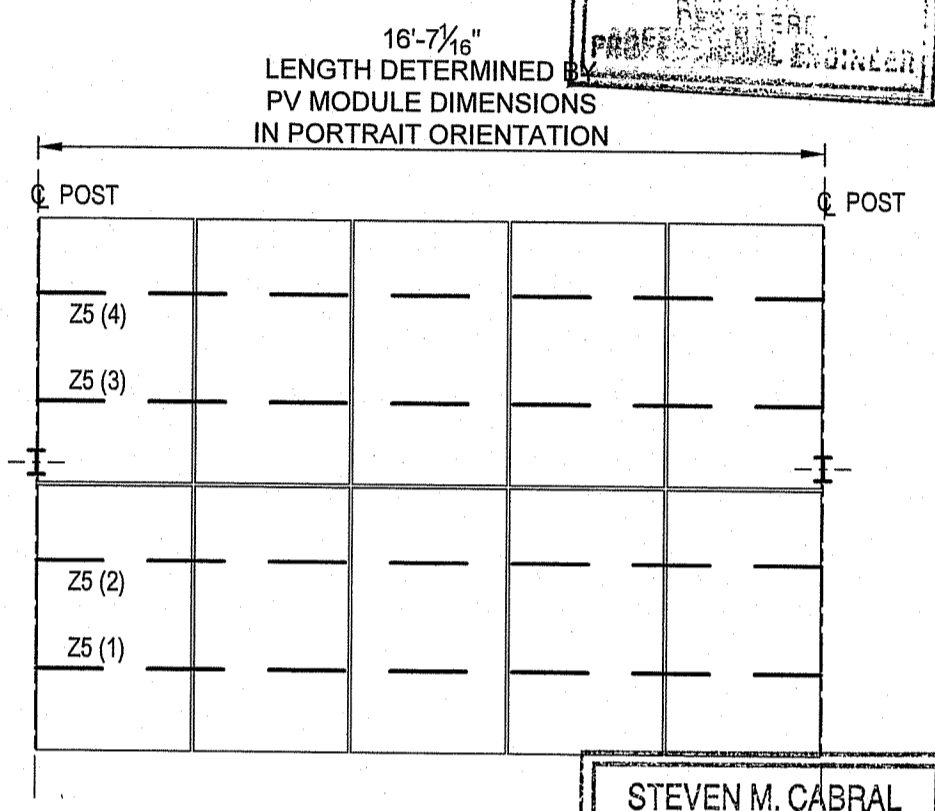

C10
SCALE: 1/4" = 1'-0"
4P2 BAY PLAN VIEW

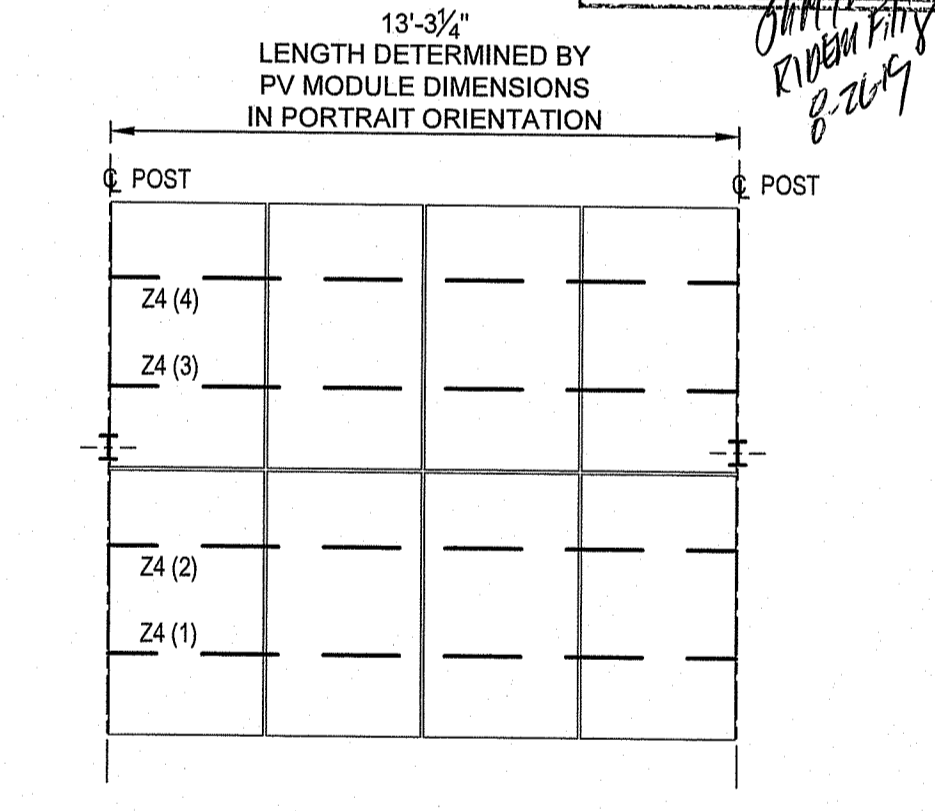

A10
SCALE: 1/4" = 1'-0"
3P2 BAY PLAN VIEW

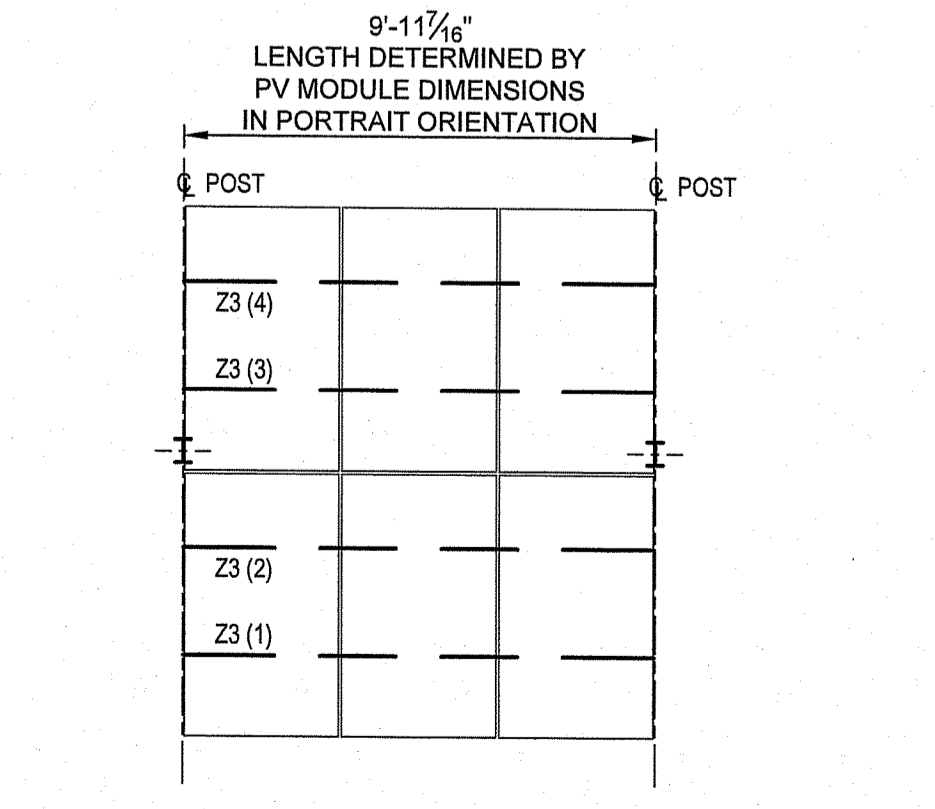

Environmental Management
AUG 29 2019
Office of Water Resources

DEPARTMENT OF ENVIRONMENTAL MANAGEMENT
OFFICE OF WATER RESOURCES
FRESHWATER WETLANDS PROGRAM
APPROVED WITH CONDITIONS
AS SPECIFIED IN THE LETTER OF APPROVAL
DATED DEC 12 2019 FILE # 19-0262
NO CHANGES ALLOWED WITHOUT PRIOR APPROVAL
APPROVED PLANS MUST BE AT CONSTRUCTION SITE
Stephen D. Sanchez

STEVEN M. CABRAL
No. 4847
REGISTERED PROFESSIONAL ENGINEER

STEVEN M. CABRAL
No. 4847
REGISTERED PROFESSIONAL ENGINEER

RBI SOLAR
Total Solar Service: Design • Fabrication
Installation • Parts • Repair Service
5513 VINE STREET
CINCINNATI, OH 45217
513.242.2051
FAX: 513.242.0816

PROFESSIONAL SEAL
ENGINEER'S SEAL APPLIES TO DESIGN OF STRUCTURAL COMPONENTS ONLY
NOT FOR CONSTRUCTION
RBI SOLAR IS NOT RESPONSIBLE FOR CONSTRUCTION THAT IS BUILT FROM SET LABELED "NOT FOR CONSTRUCTION"

GROUND MOUNT FOR ECONOX GROUP

RELEASE RECORD

MARK	DATE	DESCRIPTION
1	09-22-16	PERMIT SET

PROJECT INFORMATION
TITLE & ADDRESS:
SINGLETON GROUP, LLC
P.O. BOX 309
235 SINGLETON STREET
WOONSOCKET, RI 02895
RBI SOLAR PROJECT No.:
T.B.D.
DRAWN BY: VLW
REVIEWED BY: -
SHEET TITLE:
RACK SECTION & BAY PLAN VIEWS
SHEET No.:
S-301

USER: W\WILLIAMS PLOTTED: 8/22/2016 - 12:52 PM S:\RBI Solar\Customer\Econox Group, NHA\Quanta2015\Woonsocket, RI\Econox Group, NHA\Woonsocket, RI\S-301.dwg LAYOUT: S-301

The drawings and data in this document, and the intellectual property and confidential information contained, are the property of RBI Solar, Inc. 5513 Vine Street, Cincinnati, OH, 45217. Any party receiving this document does so in confidence and agrees that it shall not be disclosed, in whole or in part, nor distributed to others without the written consent of RBI Solar, Inc. © 2016

USER: WJLJAMS * PLOTTED: 09/22/2016 - 12:52 PM S:\RBI Solar\Customer\Econox Group, NH\Quota\3075\Woonsocket, RI\Econox Group, NH\Woonsocket, RI_2016-09-22.dwg LAYOUT: S-501

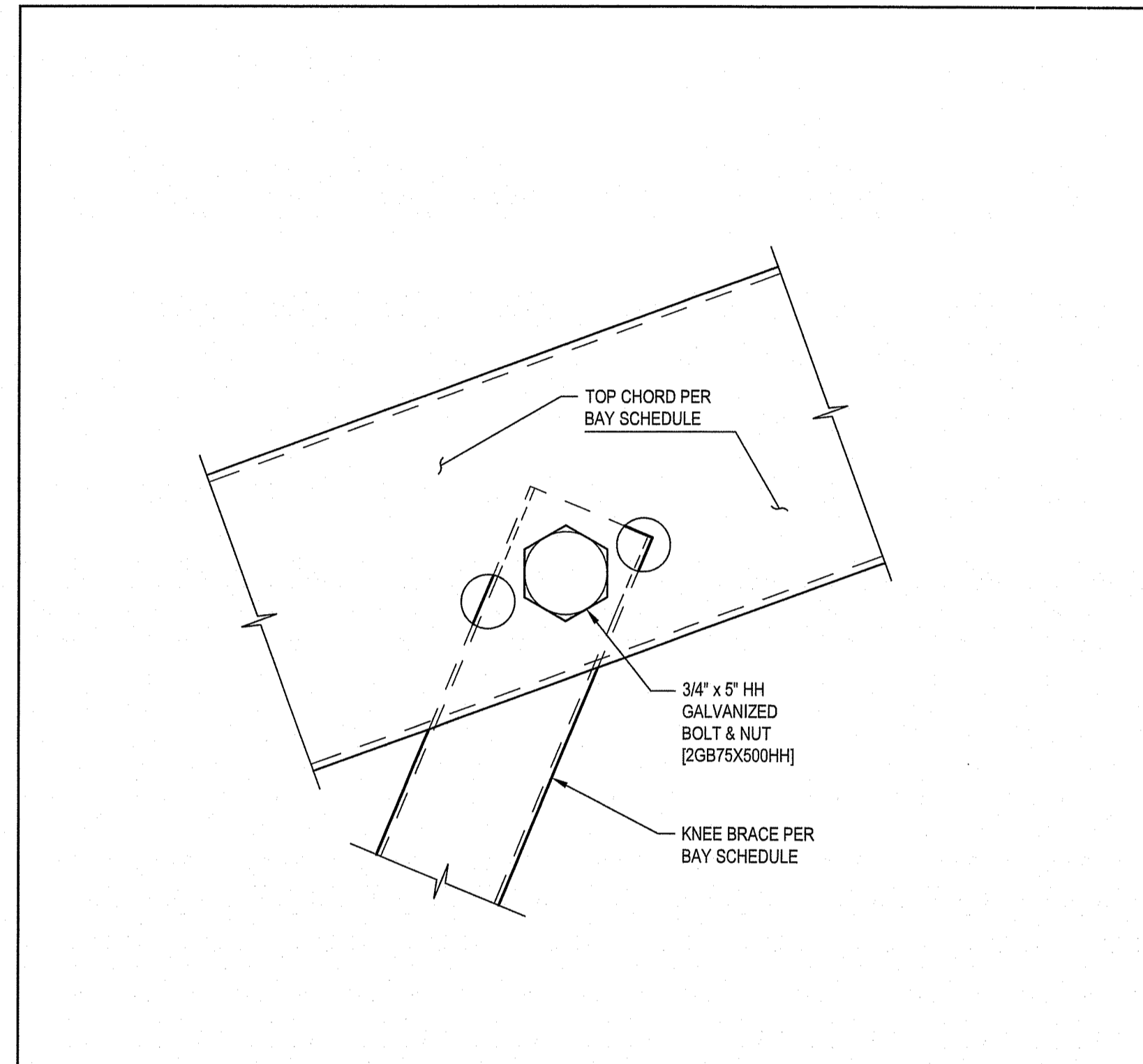

D2
SCALE: 6" = 1'-0"
UPPER KNEE BRACE TO TOP CHORD CONNECTION DETAIL

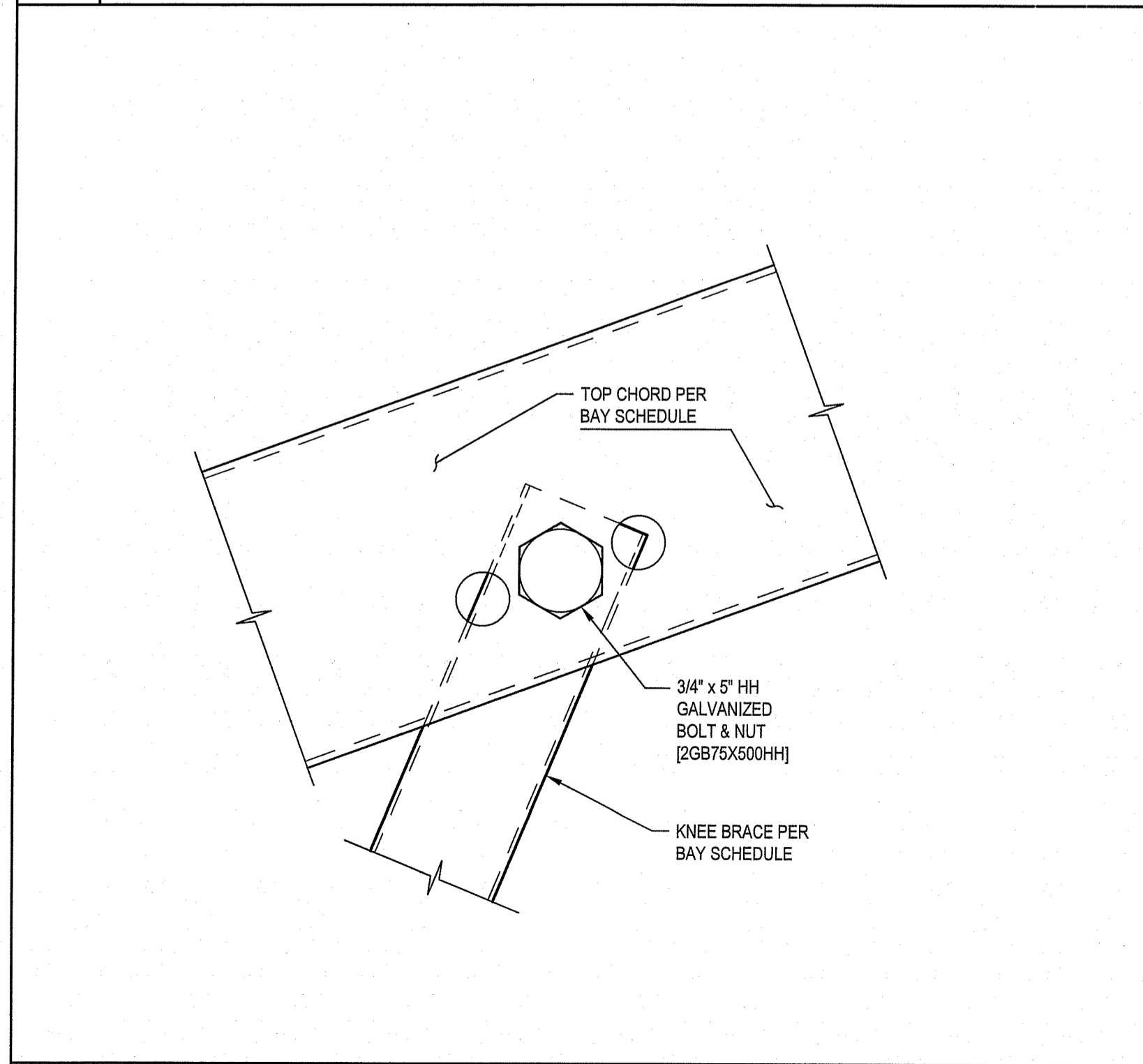

A2
SCALE: 6" = 1'-0"
LOWER KNEE BRACE TO TOP CHORD CONNECTION DETAIL

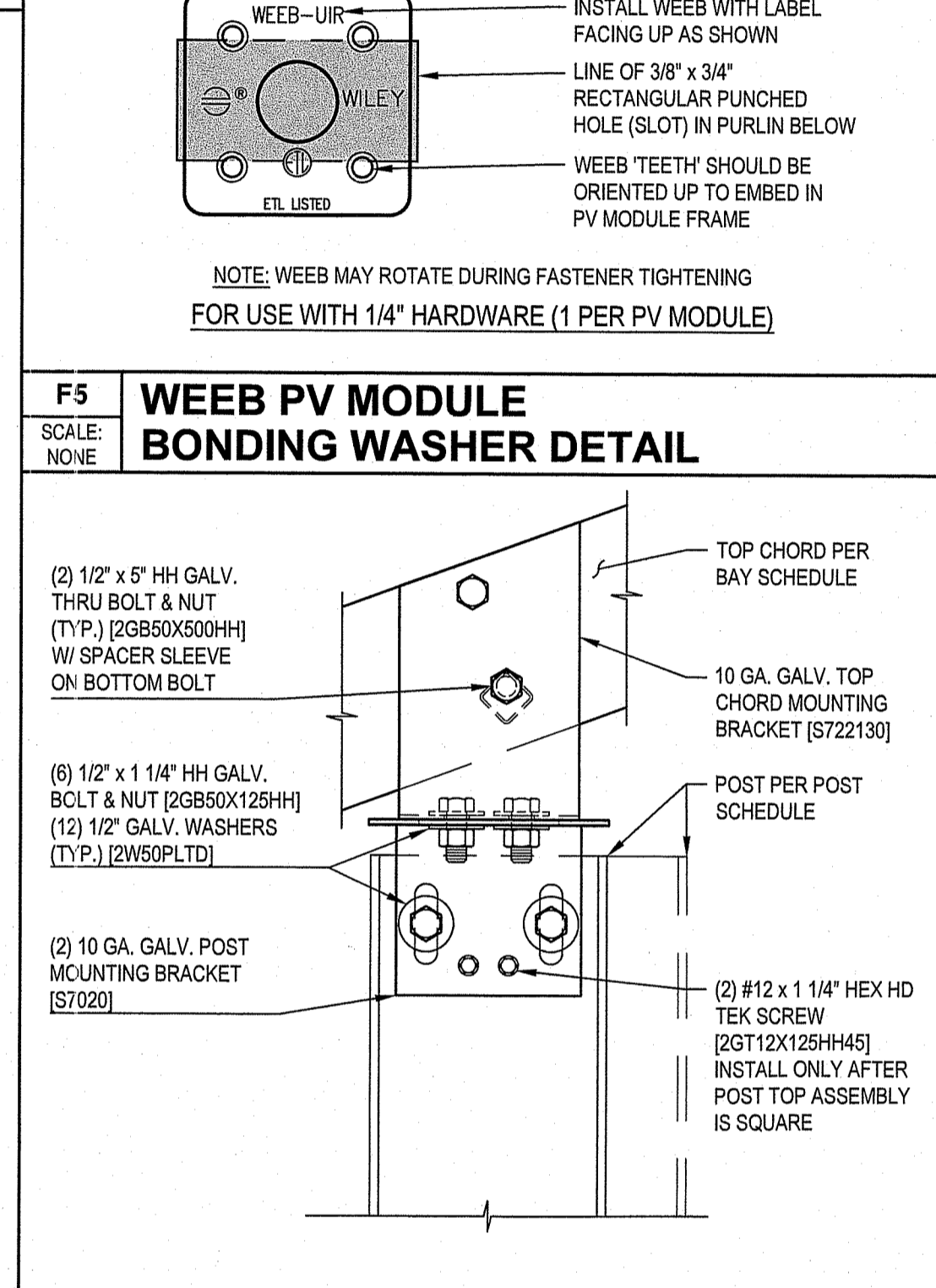

F5
SCALE: NONE
WEEB PV MODULE BONDING WASHER DETAIL

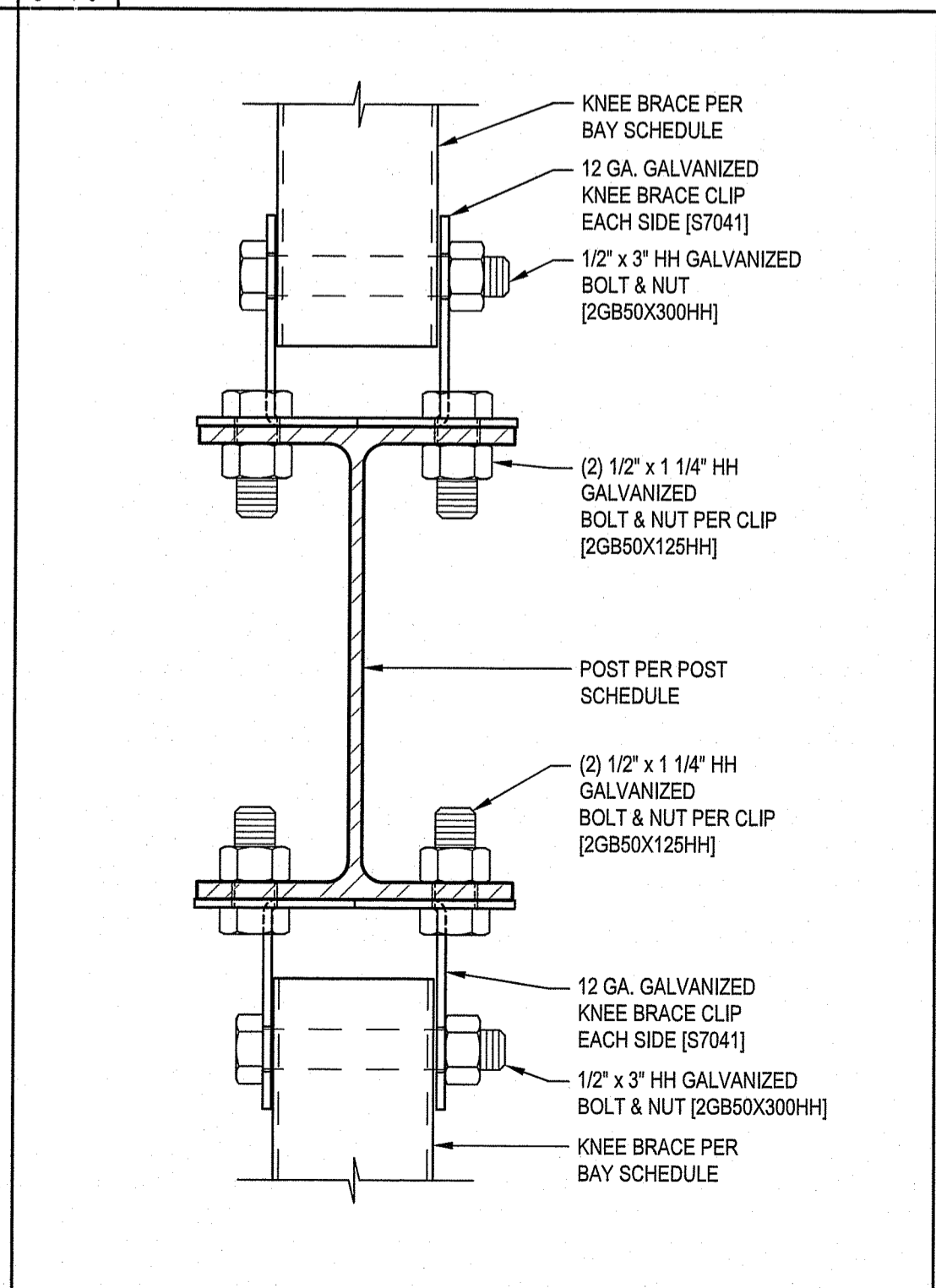

A5
SCALE: 6" = 1'-0"
KNEE BRACE TO POST CONNECTION DETAIL

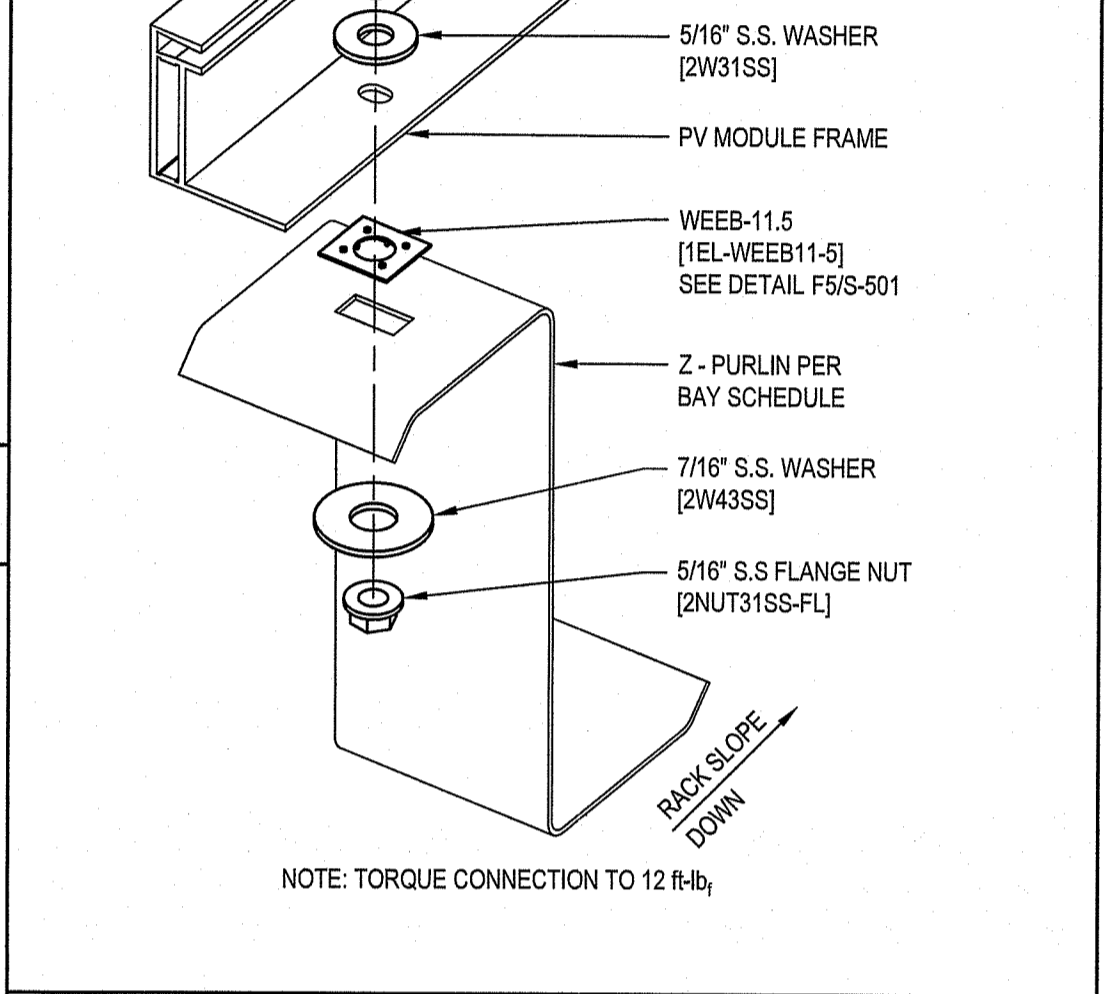

E7
SCALE: NONE
PV MODULE TO PURLIN CONNECTION DETAIL

DEPARTMENT OF ENVIRONMENTAL MANAGEMENT
OFFICE OF WATER RESOURCES
FRESHWATER WETLANDS PROGRAM
APPROVED WITH CONDITIONS
AS SPECIFIED IN THE LETTER OF APPROVAL
DATED DEC 12 2019 FILE # 19-0262
NO CHANGES ALLOWED WITHOUT PRIOR APPROVAL
APPROVED PLANS MUST BE AT CONSTRUCTION SITE

Stephen D. Schneck

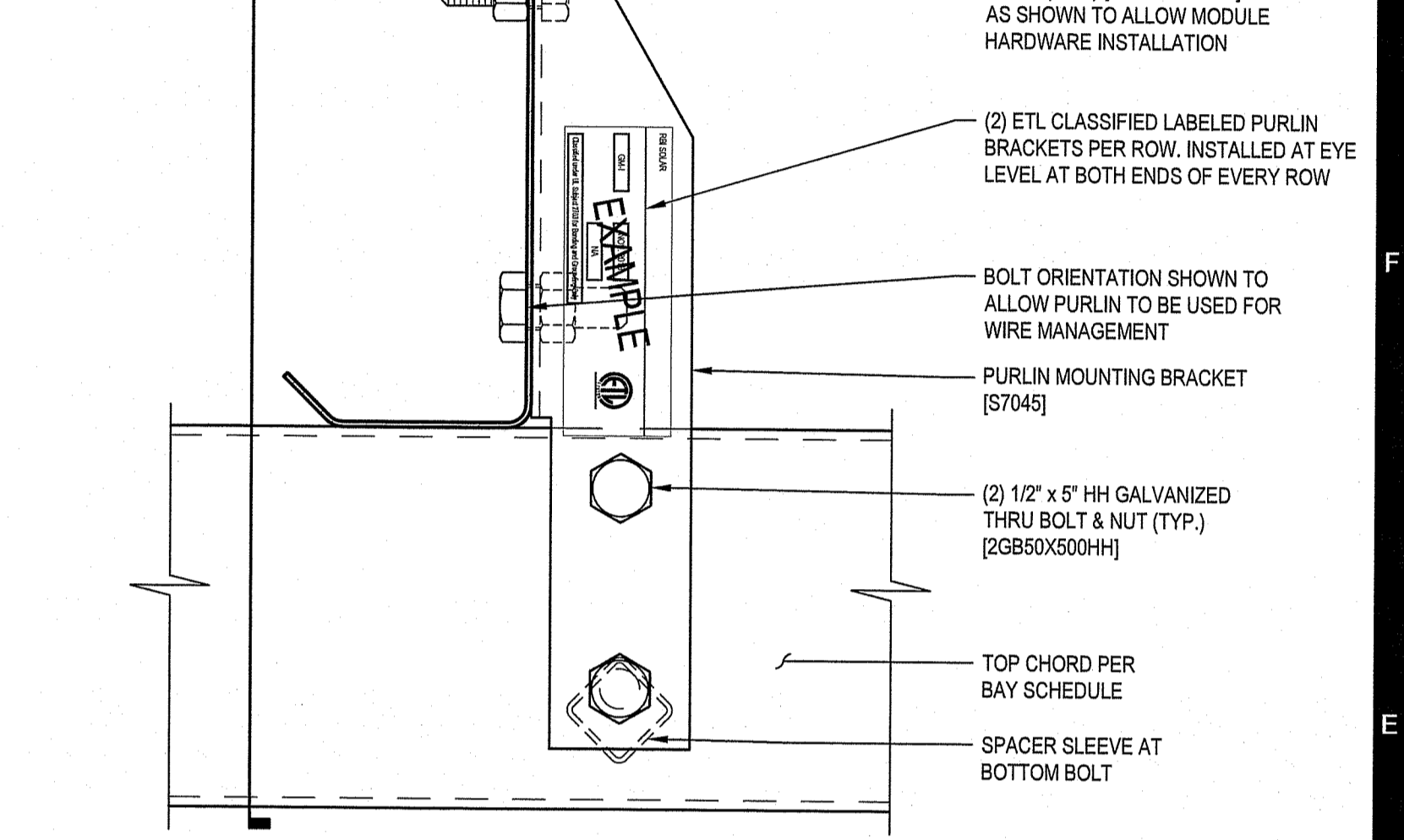

E9
SCALE: 6" = 1'-0"
TRANSVERSE PURLIN CONNECTION DETAIL

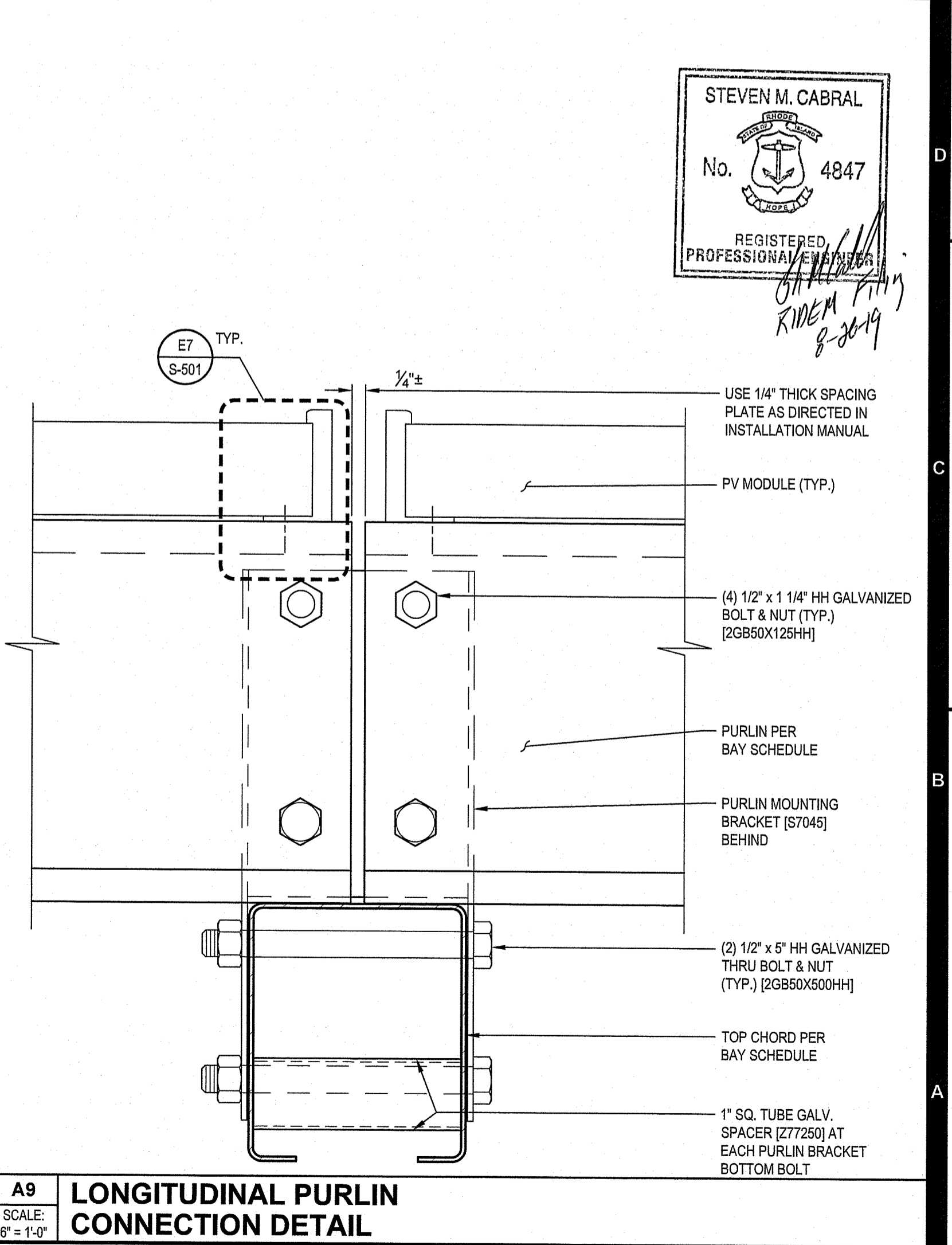

A9
SCALE: 6" = 1'-0"
LONGITUDINAL PURLIN CONNECTION DETAIL

Environmental Management
 AUG 29 2019
 Office of Water Resources

STEVEN M. CABRAL
 No. 4847
 REGISTERED PROFESSIONAL ENGINEER
Steven M. Cabral
 8-2019

RBI SOLAR

Total Solar Service: Design • Fabrication
 Installation • Parts • Repair Service
 5513 VINE STREET
 CINCINNATI, OH 45217
 513.242.2051
 FAX: 513.242.0816

PROFESSIONAL SEAL
 ENGINEER'S SEAL APPLIES TO DESIGN OF STRUCTURAL COMPONENTS ONLY

NOT FOR CONSTRUCTION

 RBI SOLAR IS NOT RESPONSIBLE FOR CONSTRUCTION THAT IS BUILT FROM SET LABELED "NOT FOR CONSTRUCTION"

GROUND MOUNT FOR ECONOX GROUP

RELEASE RECORD

MARK DATE	DESCRIPTION
1 09-22-16	PERMIT SET

PROJECT INFORMATION

TITLE & ADDRESS:
 SINGLETON GROUP, LLC
 P.O. BOX 309
 235 SINGLETON STREET
 WOONSOCKET, RI 02895

RBI SOLAR PROJECT No.:
 T.B.D.

DRAWN BY: VLW REVIEWED BY: -

SHEET TITLE:
 DETAILS

SHEET No.:
S-501

The drawings and data on this document, and the intellectual property and confidential information contained, are the property of RBI Solar, Inc. 5513 Vine Street, Cincinnati, Ohio, 45217. Any party accepting this document does so in confidence and agrees that it shall not be disclosed, in whole or in part, nor otherwise be taken without the written consent of RBI Solar, Inc. © 2014