

WILSON RESERVOIR

VARIANCE REQUESTS:
 Rule 6.23(E) 100' required from leachfield well - 80' provided
 75' required from septic tank to well - 65' provided

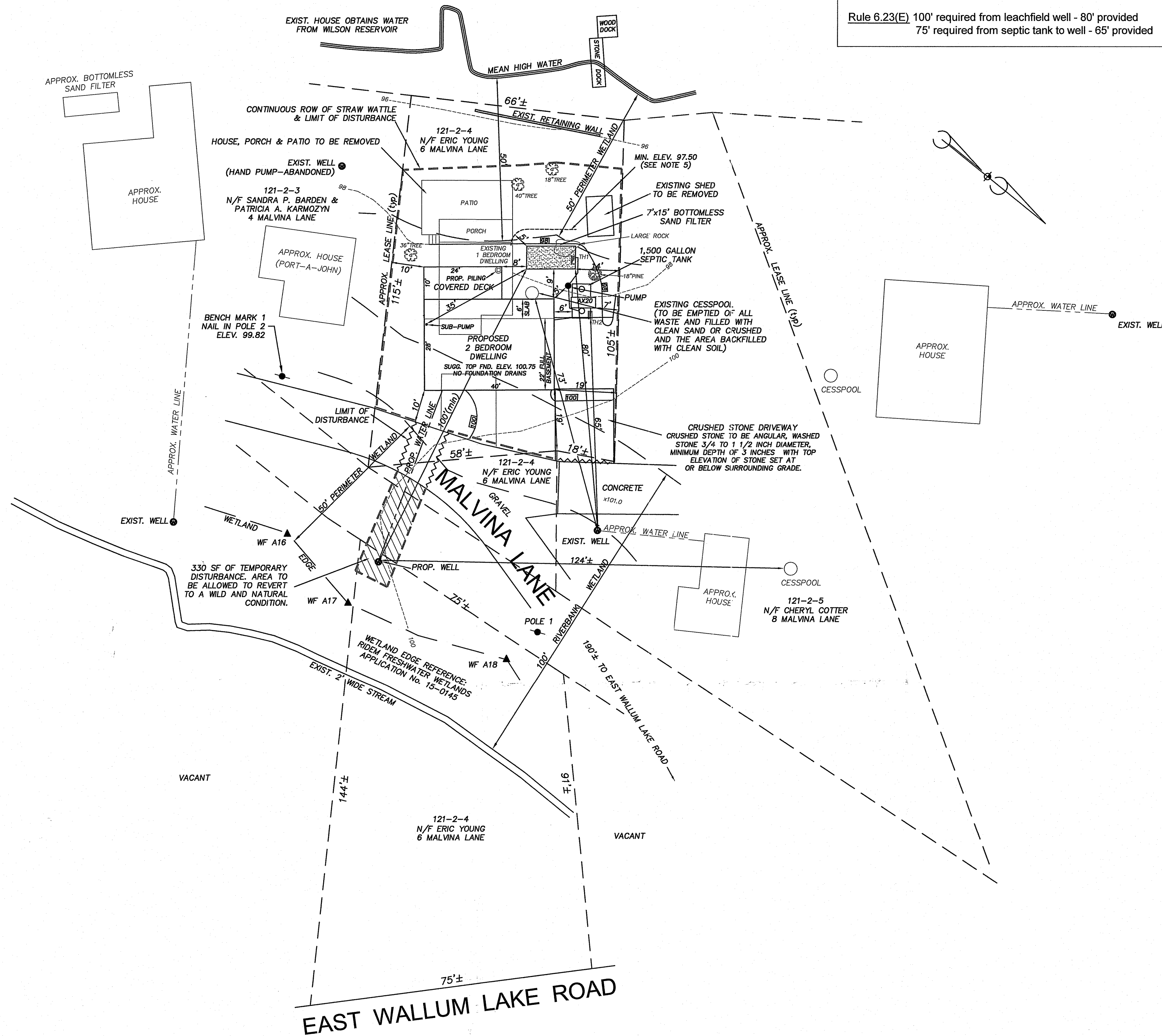

- SYSTEM COMPONENTS**
- 1,500 GALLON 2-COMPARTMENT CONCRETE SEPTIC TANK WITH PUMP VAULT AND RECIRCULATING SPLITTER VALVE AND P3005 PUMP.
 - 5' DEEP - 24" DIAMETER PUMP BASIN.
 - AX-20 ADVANTEX TEXTILE FILTER.
 - BOTTOMLESS SAND FILTER.
 - ORENCO SYSTEMS, INC. CONTROL PANEL.

LEGEND

100' --- 100' EXISTING CONTOURS
 --- PROPOSED CONTOURS
 --- TEST HOLE

TEST HOLE DATA
 DATE: 5-16-19

TH1
 0'-4" A. SL. 10YR 2/2
 4'-22" Bw. SL. 10YR 4/6
 22'-40" C. CB. G. COS. 10YR 5/3
 40'-70" C2. CB. G. SL. 10YR 5/3
 70'-100" C3. FS. L. 2.5 5/2
 ESHWT: 18"
 NO LEDGE: 100"
 TH2
 0'-4" A. SL. 10YR 2/2
 4'-22" Bw. SL. 10YR 4/6
 22'-40" C. CB. G. COS. 10YR 5/3
 40'-70" C2. CB. G. SL. 2.5YR 6/2
 ESHWT: 18"
 LEDGE: 72"
 SOIL CATEGORY: 6

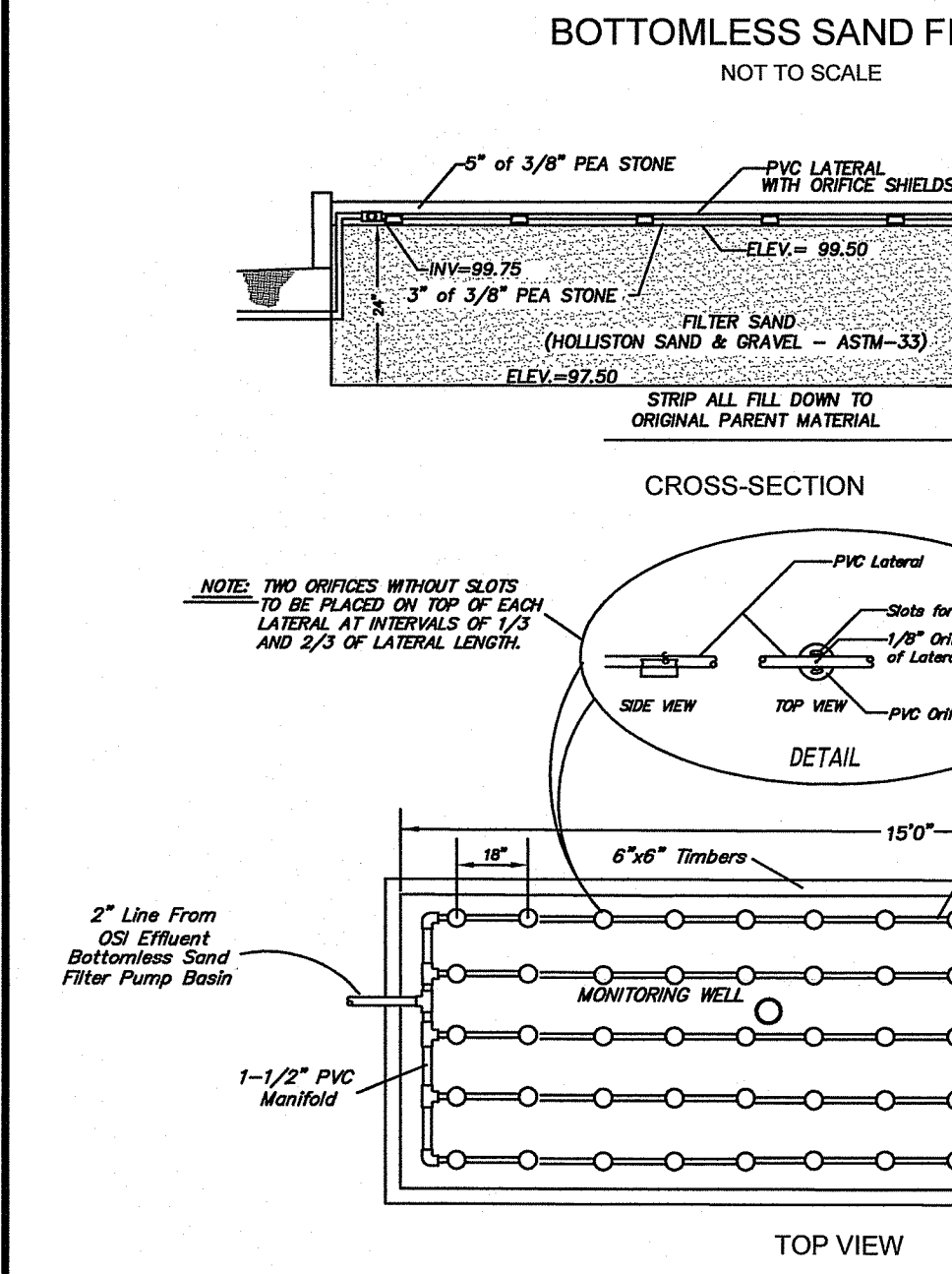
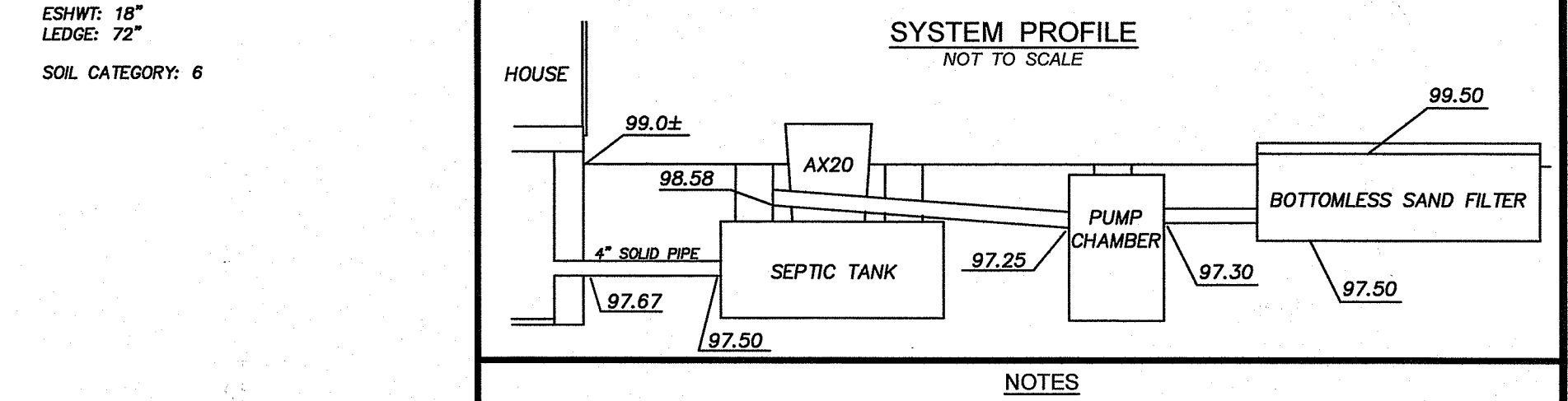
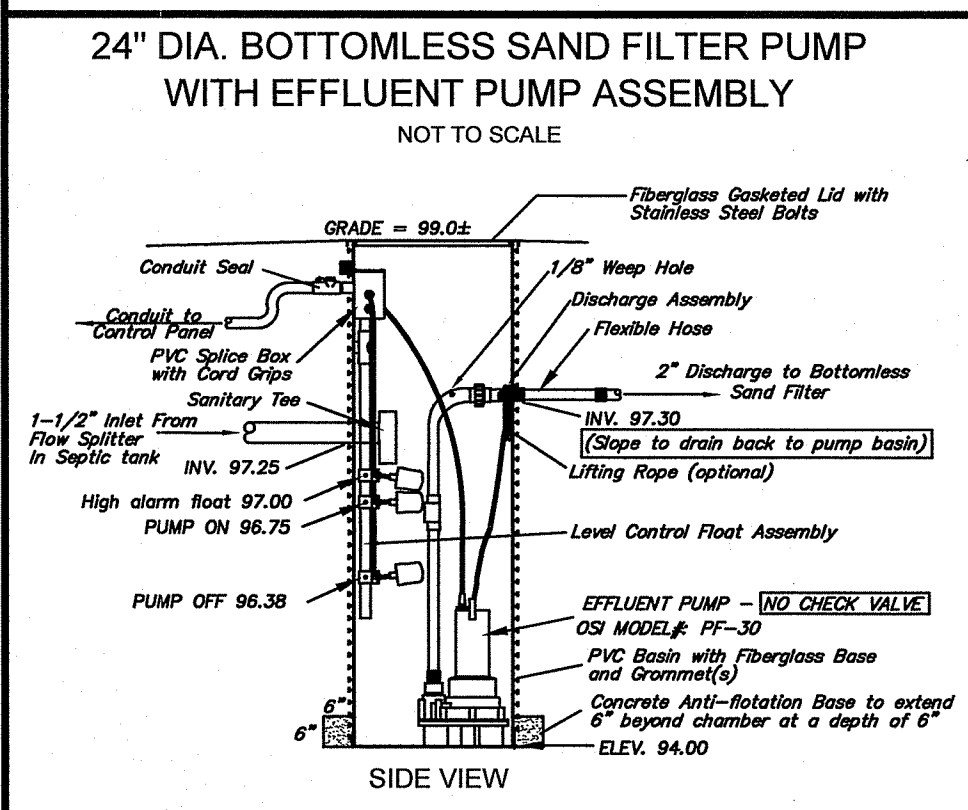
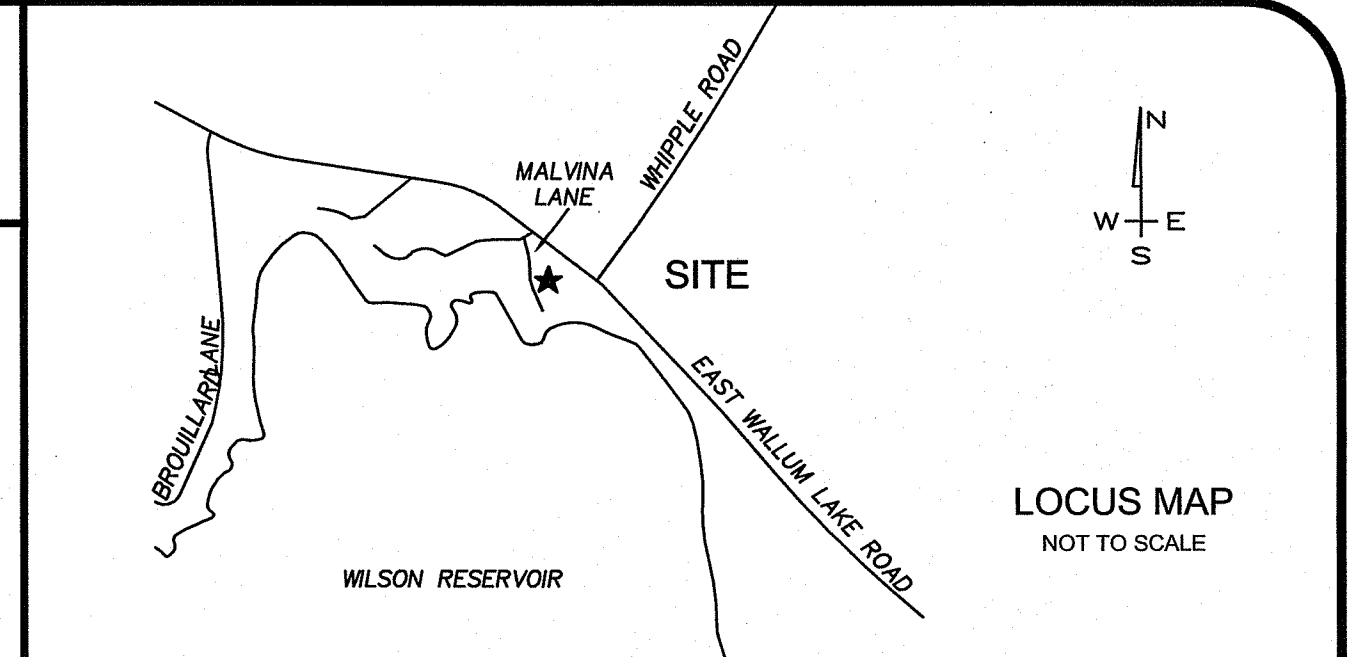

- NOTES**
- 1) SYSTEM INSTALLATION TO BE SUPERVISED BY THE DESIGNER.
 - 2) ALL TREES AND/OR STUMPS WITHIN 10 FEET OF PROPOSED SYSTEM TO BE CLEARED.
 - 3) 5 FEET FROM SAND FILTER NOT TO BE LOWER THAN ELEVATION 97.50.
 - 4) ANY PRIVATE WELLS, EXISTING & PROPOSED, WITHIN 200' OF ISSS ARE SHOWN.
 - 5) ANY PUBLIC WELLS, EXISTING AND PROPOSED, WITHIN 500' OF ISSS ARE SHOWN.
 - 6) NO DRAINS OF ANY KIND SHALL BE WITHIN 25' UPGRADIENT OR 50' DOWNGRADIENT OF THE LEACHING SYSTEM.
 - 7) ALL SOIL AT LEAST 6" BELOW EXISTING GRADE AT BOTTOMLESS SAND FILTER SHALL BE STRIPPED AND BACKFILLED WITH FILTER SAND.
 - 8) THE SEPTIC TANK SHALL BE A WATER-TIGHT, 1,500 GALLON 2-COMPARTMENT TANK WITH 24" DIAMETER INLET AND OUTLET ACCESS RISERS. RISERS SHALL BE PVC WITH SECURE FIBERGLASS LIDS. IF CONCRETE TANK IS USED, ABS TANK ADAPTER SHALL BE CAST IN PLACE. TANK SHALL BE VACUUM TESTED (W/CERTIFICATE) OR WATER TESTED/VACUUM TESTED ON SITE PRIOR TO ACCEPTANCE FROM THE ENGINEER.
 - 9) THE ADVANTEX-AX TREATMENT SYSTEM CONTAINS A PACKED BED FILTER THAT USES SPECIALLY DESIGNED TEXTILE MATERIALS WITHIN A PRE-ASSEMBLED FILTER UNIT.
 - 10) ALL PUMPS SHALL BE EQUIPPED WITH A HIGH WATER LEVEL VISIBLE AND AUDIBLE ALARM POWERED BY A CIRCUIT SEPARATE FROM THE PUMP POWER. THE ALARM SHALL BE PROVIDED WITH A PVC INLET TEE AND SCREENING PUMP VAULT IN THE OUTLET END. AN ACCESS RISER SHALL BE INSTALLED DIRECTLY ABOVE THE SCREENED PUMP VAULT AND INLET TEE.
 - 11) THE SEPTIC TANK SHALL BE PROVIDED WITH A PVC INLET TEE AND SCREENING PUMP VAULT IN THE OUTLET END. AN ACCESS RISER SHALL BE INSTALLED DIRECTLY ABOVE THE SCREENED PUMP VAULT AND INLET TEE.
 - 12) ALL MEDIA WITHIN THE ENCLOSURE AND BELOW THE COVER STONE SHALL HAVE AN EFFECTIVE SIZE (D) OF 0.3 mm (+/-) AND UNIFORMITY COEFFICIENT (U) OF 3.0 TO 4.0. THE MAXIMUM ALLOWABLE PERCENTAGE OF FINES PASSING THROUGH A NUMBER 200 SIEVE SHALL BE 1% OTHER THAN THE GRADATION AND FINE CONTENT SPECIFIED ABOVE. THE SAND MEDIA SHALL MEET OTHER ASTM C-33 SAND SPECIFICATIONS.
 - 13) IF CONTRACTOR ENCOUNTERS ANY CONDITIONS DURING CONSTRUCTION WHICH INDICATE THE SYSTEM CANNOT BE INSTALLED IN ACCORDANCE WITH THE APPROVED DESIGN, OR FIND CONFLICTING INFORMATION ON THE PLAN, CONSTRUCTION SHALL CEASE AND DESIGNER BE NOTIFIED.
 - 14) THE DESIGNER IS NOT RESPONSIBLE FOR ANY NEGLIGENT ACT OF OMISSION OF AN ISSS USER, INCLUDING BUT NOT LIMITED TO, FAILURE TO PROPERLY USE AND MAINTAIN THE SYSTEM, WHICH CAUSES DAMAGE TO THE SYSTEM.
 - 15) LOCAL SUPPLIER OF OS EQUIPMENT: ATLANTIC SOLUTIONS, 2417 EAST MAIN ROAD, PORTSMOUTH, RI 02871 TEL: (401) 293-0178
 - 16) NO STRUCTURES, PERMANENT FEATURES, OR LARGE, HEAVY OR NUMEROUS DECORATIONS SHALL BE PLACED ON TOP OF THE BOTTOMLESS SAND FILTER THAT WOULD OBSTRUCT, PREVENT OR HINDER OPERATION AND MAINTENANCE OR ACCESS TO THE FILTER UNIT.
 - 17) ACCESS PORTS OR MANHOLES SHALL BE REQUIRED FOR SEQUENCING VALVES AND SHALL BE SUFFICIENTLY SIZED TO FACILITATE TIMER SETTINGS SHALL BE CHECKED AT EVERY ESTABLISHED MAINTENANCE AND INSPECTION VISIT AND WHEN HOME OCCUPANCY CHANGES AND ADJUSTED AS NEEDED.
 - 18) THE PANEL BOX MUST BE WITHIN VIEW OF THE SYSTEM LOCATION TO HELP FACILITATE OPERATION AND MAINTENANCE.
 - 19) THE SPACE FROM THE ENDS OF THE LATERALS TO THE LINER SHALL BE CLOSE TO HALF THE ORIFICE SPACING AND BE ABLE TO ACCOMMODATE THE FITTINGS AND HAVE SUFFICIENT SPACE FOR MAINTENANCE ACTIVITIES.
 - 20) SNEEP ELBOWS SHALL BE ATTACHED TO THE DISTAL END OF EACH LATERAL TO FACILITATE MAINTENANCE AND INSPECTION.
 - 21) REFER TO OPERATION & MAINTENANCE AGREEMENT FOR PROPER MAINTENANCE OF ALL SYSTEM COMPONENTS.
 - 22) REFER TO OPERATION & MAINTENANCE AGREEMENT FOR PROPER MAINTENANCE OF ALL SYSTEM COMPONENTS.

RECIRCULATING EFFLUENT PUMP SYSTEM (REPS)
 (2 COMPARTMENT 1,500 GALLON SEPTIC TANK and AX 20 ADVANTEX TEXTILE FILTER)
 NOT TO SCALE

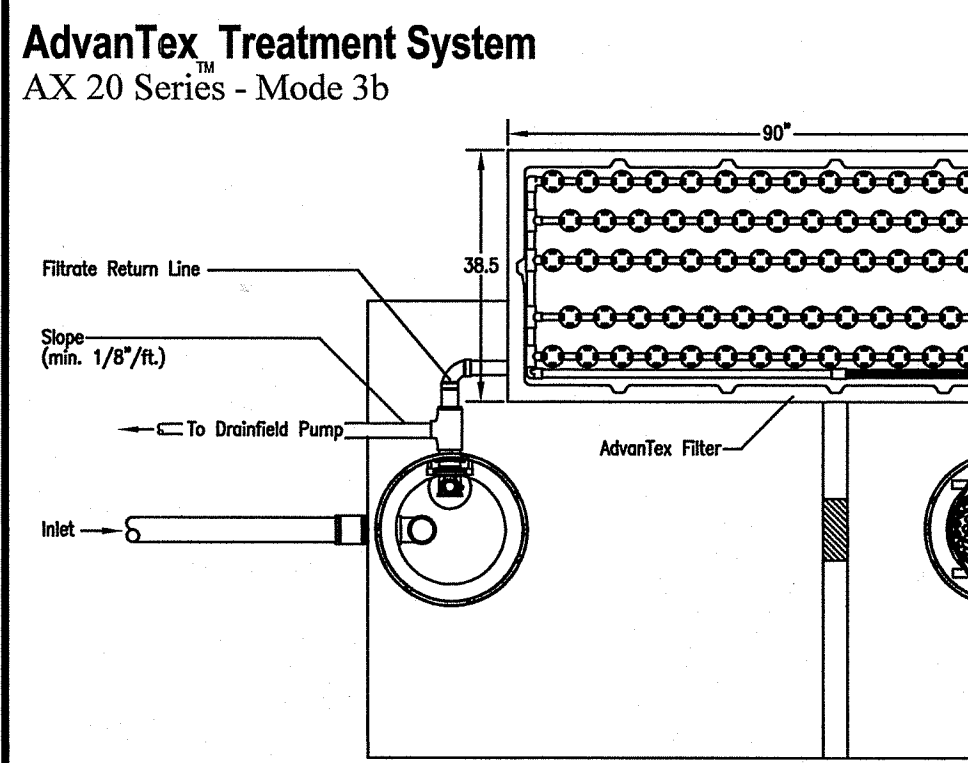

SYSTEM SIZING:
 2 BEDROOMS: 115 GPD x 2 = 230 GPD
 SOIL CATEGORY: 6
 APPLICATION RATE: 2.3 GPD/SF
 AREA REQUIRED: 230/2.3 = 100 SF
 AREA PROVIDED: 7'x15' = 105 SF

TIMER INFO:
 SET ADVANTEX TIMER TO 24 DOSES/DAY
 230 GPD/24 DOSES/DAY = 9.58 GAL/DOSE
 9.58/23.8 GPM = .40 MIN.
 TOTAL PUMP RUN TIME = 9.6 MIN./DAY
 TOTAL PUMP OFF TIME = 1430.4 MIN./DAY
 TIME OFF PER CYCLE = 59.60 MIN.
 TIME ON PER CYCLE = 0.40 MIN.

DOSING RATE:
 9.58 GAL/DOSE
 PUMP CHAMBER CAPACITY = 23.5 GAL./FT OR 1.96 GAL./INCH
 PUMP CHAMBER DEPTH @ 9.58 GAL = .37 FEET
 DOSE PER ORIFICE: 230 GPD/(24 DOSES/DAY)/55 ORIFICES = .17 GAL./ORIFICE/DOSE



DEPARTMENT OF ENVIRONMENTAL MANAGEMENT
 OFFICE OF WATER RESOURCES
 FRESHWATER WETLANDS PROGRAM
 APPROVED WITH CONDITIONS
 AS SPECIFIED IN THE LETTER OF APPROVAL
 DATED OCT 7 2019 FILE # 19-0236
 NO CHANGES ALLOWED WITHOUT PRIOR APPROVAL
 APPROVED PLANS MUST BE AT CONSTRUCTION SITE
Naively L. Freeman

- Wetland Notes**
1. Erosion controls to be established prior to start of any work and remain in place until construction is complete and area is stabilized. Straw wattle to be inspected frequently and repaired or replaced as necessary.
 2. Disturbance from the well and water line installation on the easterly side of Malvina Lane shall be allowed to revert to a wild and natural condition.
 3. All disturbed areas are to be seeded with a quick-grow conservation grass mix as soon as practical after construction is complete.

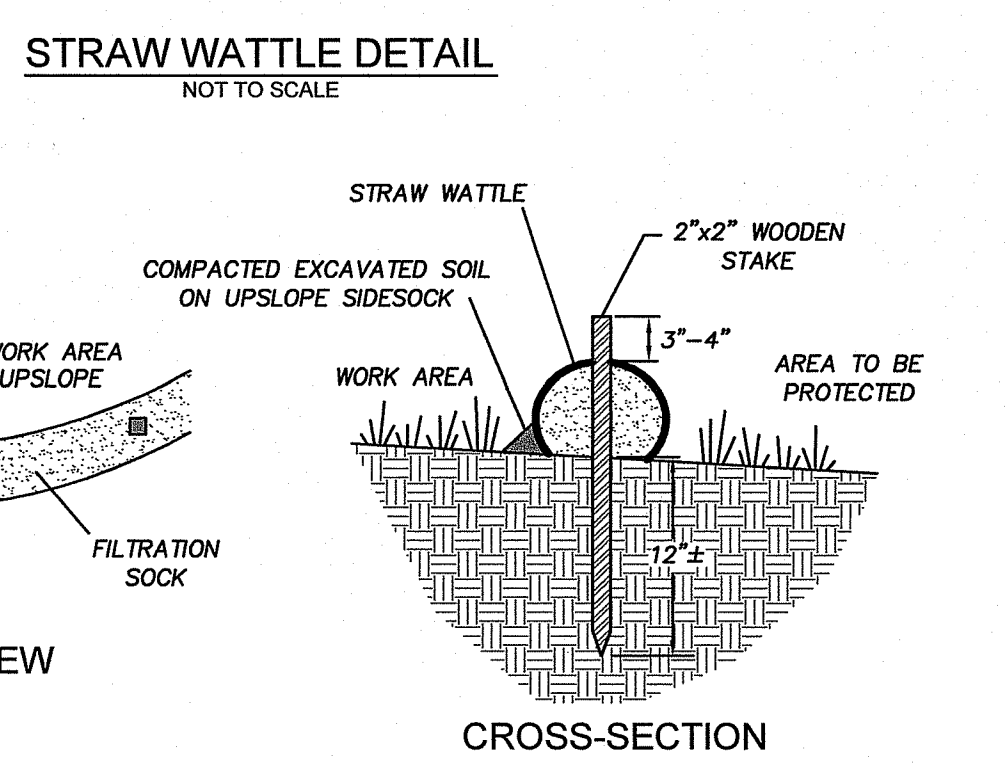

PROPOSED ONSITE WASTEWATER TREATMENT SYSTEM ALTERATION & WETLANDS PLAN
 for
ROSE GARDEN CORP.
 PLAT 121, LOT 2
 6 MALVINA DRIVE
 BURRILLVILLE, RHODE ISLAND
 SEPTEMBER, 2019
 SCALE 1"= 20'

CERTIFICATION
 THIS SURVEY HAS BEEN CONDUCTED AND THE PLAN HAS BEEN PREPARED PURSUANT TO SECTION 9 OF THE RULES AND REGULATIONS ADOPTED BY THE RHODE ISLAND STATE BOARD OF REGISTRATION FOR PROFESSIONAL LAND SURVEYORS ON NOVEMBER 25, 2015, AS FOLLOWS:
 LIMITED CONTENT BOUNDARY SURVEY: CLASS IV
 TOPOGRAPHIC ACCURACY: 1:4
 STATEMENT OF PURPOSE
 THE PURPOSE FOR THE CONDUCT OF THE SURVEY AND THE PREPARATION OF THE PLAN IS AS FOLLOWS: PROPOSED HOUSE
 BY *Marc N. Nyberg*
 MARC N. NYBERG License No. 1797 COA No. A52

Nyberg & Associates A SUBSIDIARY OF
INSITE Engineering Services, LLC
 PROFESSIONAL ENGINEERS | LAND SURVEYORS
 Precision. Clarity. Certainty.
 InSite Professional Complex, Suite 1
 1539 Fall River Avenue Seekonk, MA 02771
 Phone: (508) 338-4500 Fax: (508) 338-4558
 Web Address: InSiteEngineers.com

MARC N. NYBERG
 No. 1797
 PROFESSIONAL LAND SURVEYOR