

EROSION CONTROL NOTES

1. EXPOSED EARTHWORK SHALL BE CONFINED TO AS LIMITED AN AREA AS IS PRACTICAL AT ANY GIVEN TIME THROUGHOUT THE CONSTRUCTION SEQUENCE. LIMIT OF WORK IS NOTED ON THIS SHEET. CONTRACTOR TO WORK WITHIN THESE LIMITS AS SHOWN. NO AREA OF THE SITE SHALL BE LEFT IN AN UNSTABILIZED CONDITION FOR A PERIOD OF TIME EXCEEDING FIVE CALENDAR DAYS.
2. TEMPORARY EROSION CONTROL MEASURES SHALL BE INSTALLED IN STRICT ACCORDANCE WITH PROJECT PANS. IN ADDITION SIMILAR MEASURES SHALL BE INSTALLED WHERE AND WHEN THE FIELD CONDITION, OR FIELD OPERATION OF THE INDIVIDUAL SITE OPERATOR MAY WARRANT. ALL TEMPORARY EROSION CONTROL MEASURES USED SHALL BE INSPECTED WEEKLY AND WITHIN 24 HOURS AFTER 0.5" OF RAINFALL OR MORE. THEY SHALL BE CLEANED AND MAINTAINED AND OTHERWISE KEPT IN AN EFFECTIVE OPERATING MANNER THROUGHOUT THE CONSTRUCTION PERIOD.
3. ALL DISTURBED AREAS DESIGNATED TO BE SEEDED SHALL RECEIVE A MINIMUM OF 4" LOAM (COMPACTED THICKNESS), PRIOR TO SEEDING AND MULCHING
4. ALL SWALES AND DITCH LINES SHALL BE PERIODICALLY CLEANED OF DEPOSITED SEDIMENT SO AS TO MAINTAIN AND EFFECTIVE GRADE AND CROSS SECTION. ALL SWALES AND DITCH LINES SHALL BE FULLY STABILIZED PRIOR TO HAVING STORMWATER DIRECTED TOWARDS THEM.
5. AN AREA SHALL BE CONSIDERED STABILIZE IF ONE OF THE FOLLOWING HAS OCCURRED:
  - A. BASE COURSE OF GRADES ARE INSTALLED IN AREAS TO BE PAVED
  - B. A MINIMUM OF 85% VEGETATIVE GROWTH HAS BEEN ESTABLISHED
  - C. A MINIMUM OF 3" OF NON-EROSIVE MATERIALS, SUCH AS STONE OR RIP-RAP HAS BEEN INSTALLED
  - D. EROSION CONTROL BLANKETS HAVE BEEN PROPERLY INSTALLED
6. DUST SHALL BE CONTROLLED BY THE USE OF WATER AS NECESSARY THROUGHOUT THE CONSTRUCTION PERIOD.
7. IN NO WAY ARE THE TEMPORARY EROSION CONTROL MEASURES INDICATED ON THESE PLANS CONSIDERED ALL INCLUSIVE. THE CONTRACTOR SHALL USE JUDGMENT IN INSTALLING SUPPLEMENTARY EROSION CONTROL MEASURES WHERE AND WHEN SPECIFIC SITE CONDITIONS AND/OR CONSTRUCTION METHODOLOGIES MAY WARRANT.
8. ALL EROSION CONTROL METHODS TO BE INSTALLED AS PER MANUFACTURERS SPECIFICATIONS AS WELL AS INDICATED IN THE RHODE ISLAND STORMWATER DESIGN MANUAL "EROSION AND SEDIMENT CONTROL DURING CONSTRUCTION"

LEGEND

- LIMIT OF DISTURBANCE
- PATHWAY EDGE
- - - REFERENCE LINE
- - - 50' PERIMETER WETLAND
- - - TOPOGRAPHY MIN
- - - TOPOGRAPHY MAJ
- D PROPOSED 4" DRAIN LINE
- - - EXISTING FENCE LINE
- - - EROSION CONTROL
- E - E PROPOSED ELECTRICAL CONDUIT
- STONE DUST PATHWAY
- ASPHALT PATHWAY
- EXISTING ELECTRICAL PANEL
- PROPOSED ELECTRICAL PANEL
- ⊕ EX. ELECTRICAL HAND-HOLE
- ⊙ PROPOSED ELECTRICAL OUTLET

WETLAND RESTORATION PLANT KEY

- *Cornus sericea* / RED-TWIG DOGWOOD
- ⊗ *Aronia melanocarpa* / BLACK CHOKEBERRY
- ⊙ *Ilex verticillata* / WINTERBERRY HOLLY
- ⊙ *Ilex verticillata* "Jim Dandy" / WINTERBERRY HOLLY
- ⊙ NEW ENGLAND WETMIX (WETLAND SEED MIX)

- New England Wetmix (Wetland Seed Mix)  
Botanical Name / Common Name
- Plants
- Carex lurida* / Lund Sedge
  - Carex scirpifolia* / Blunt Broom Sedge
  - Verbena hastata* / Blue Vervain
  - Carex lupulina* / Hop Sedge
  - Scirpus atrovirens* / Green Bulrush
  - Panicum rigidulum* / Redtop Panic Grass
  - Deschampsia cespitosa* / Tufted Hairgrass
  - Bidens aristosa* / Tickseed Sunflower, Bur Marigold
  - Eleocharis palustris* / Creeping Spike Rush
  - Juncus effusus* / Soft Rush
  - Carex crinita* / Fringed Sedge
  - Mimulus ringens* / Square Stemmed Monkey Flower
  - Aster puniceus* / Swamp Aster
  - Eupatorium perfoliatum* / Boneset
  - Glycyca canadensis* / Rattlesnake Grass
  - Asclepias incarnata* / Swamp Milkweed
  - Helenium autumnale* / Common Sneezeweed
  - Penthorum sedoides* / Ditch Stonecrop



NOTE: THIS IS NOT A SURVEY. ALL LOCATIONS ARE APPROXIMATED. VERIFY ALL LOCATIONS IN THE FIELD PRIOR TO CONSTRUCTION

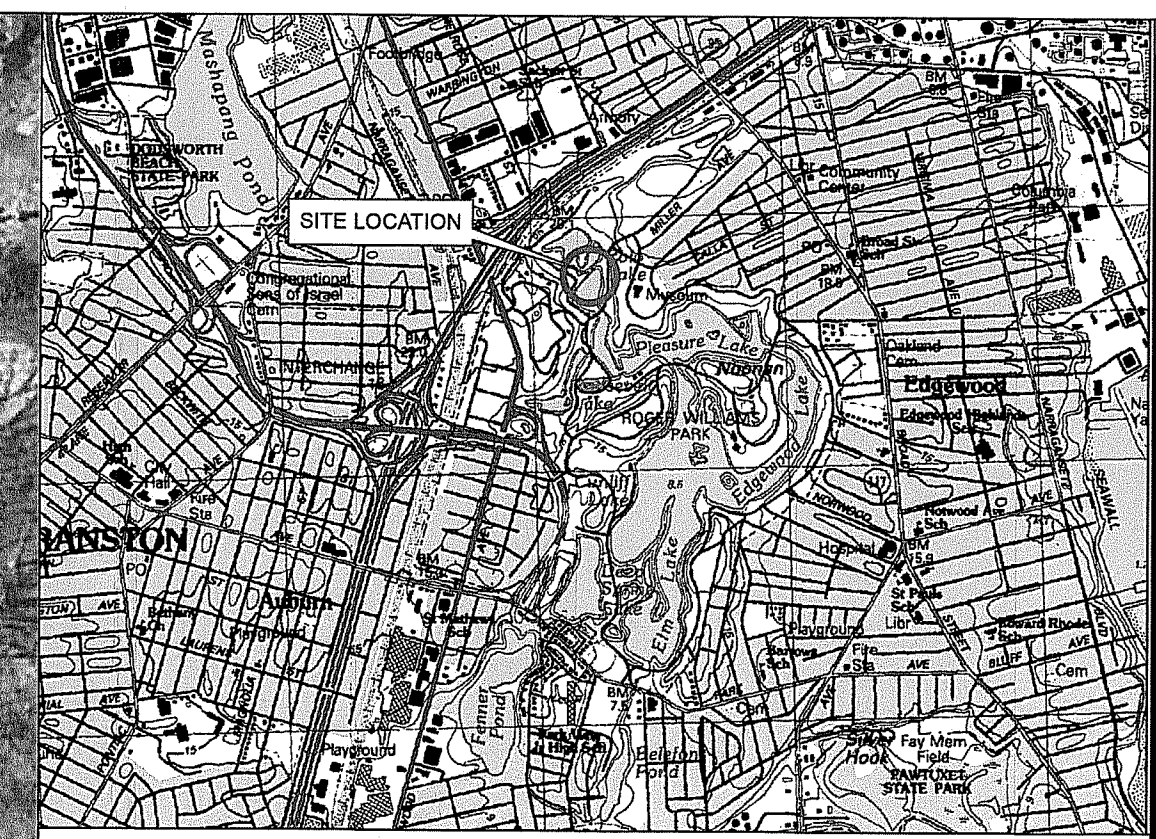

SITE LOCATION MAP - NOT TO SCALE

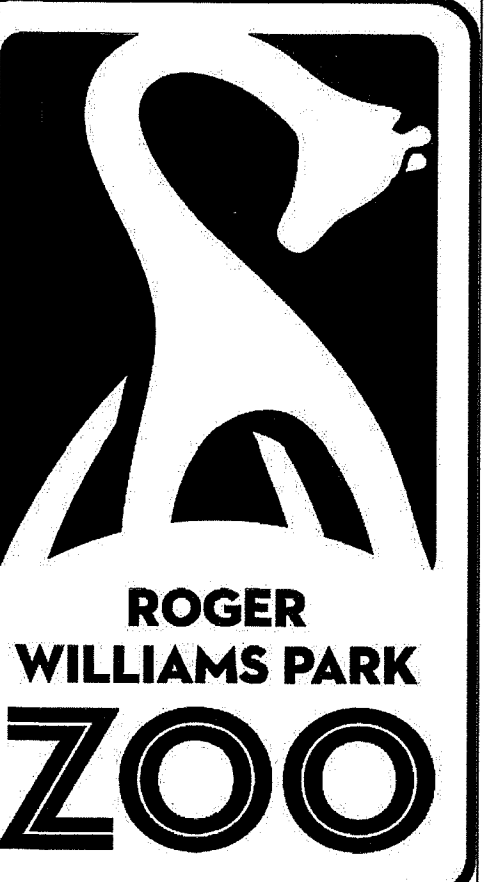

1000 Elmwood Avenue  
Providence, RI 02907  
401 . 785 . 3510  
www.rwpzoo.org

JACK-O-LANTERN SPECTACULAR TRAIL

Site Location:  
Roger Williams Park Zoo  
1000 Elmwood Avenue  
Providence, RI 02907  
MAR 3 0 2020

PROPOSED SITE PLAN

DATE: 03-03-20

SCALE: AS NOTED

REVISIONS: DATE:  
Issued for Review 03-06-20

PROPOSED BEACH AREA - ENLARGEMENT PLAN - 1"=20'

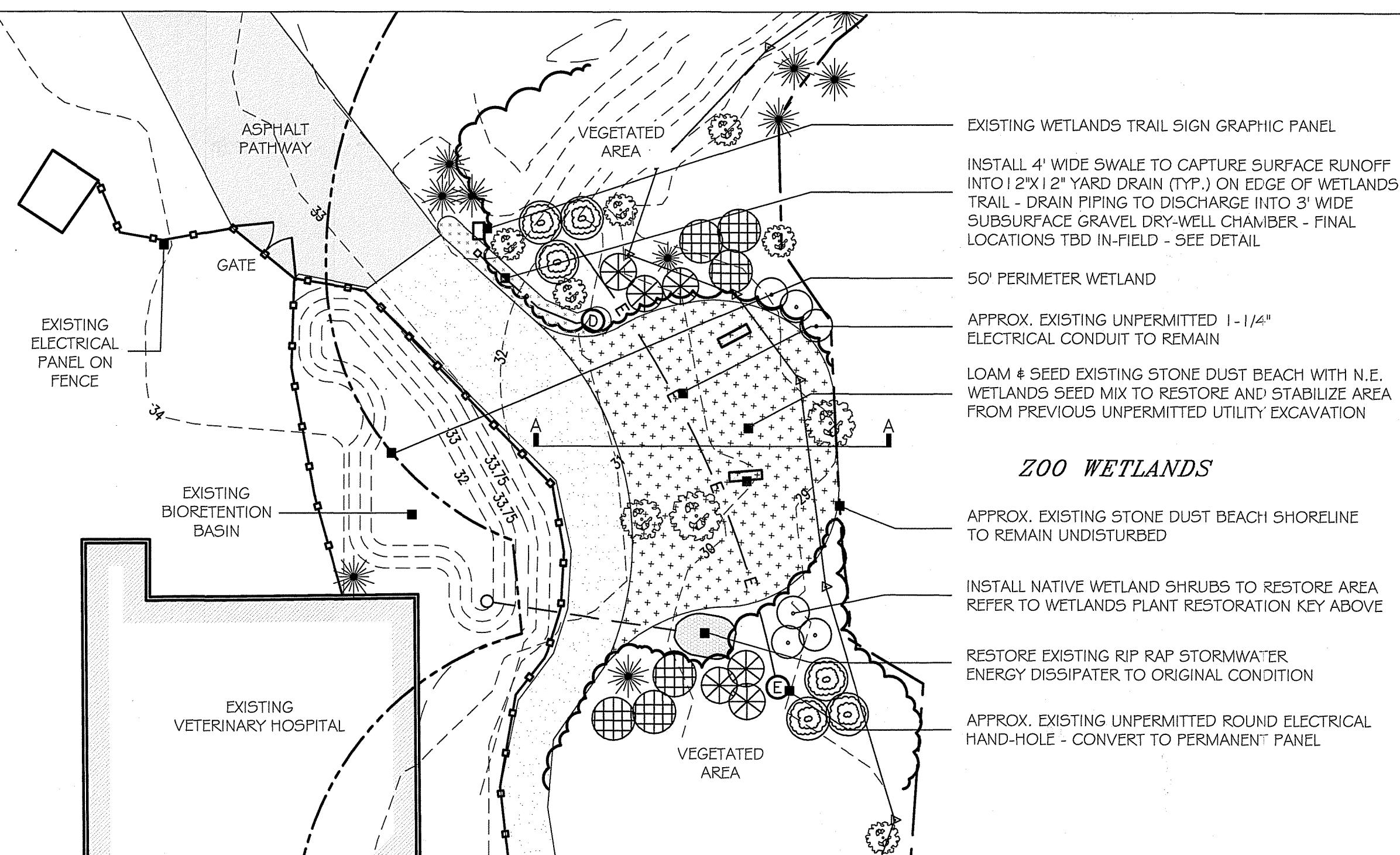

STONE DRY-WELL CHAMBER DETAIL - 3/4" = 1'

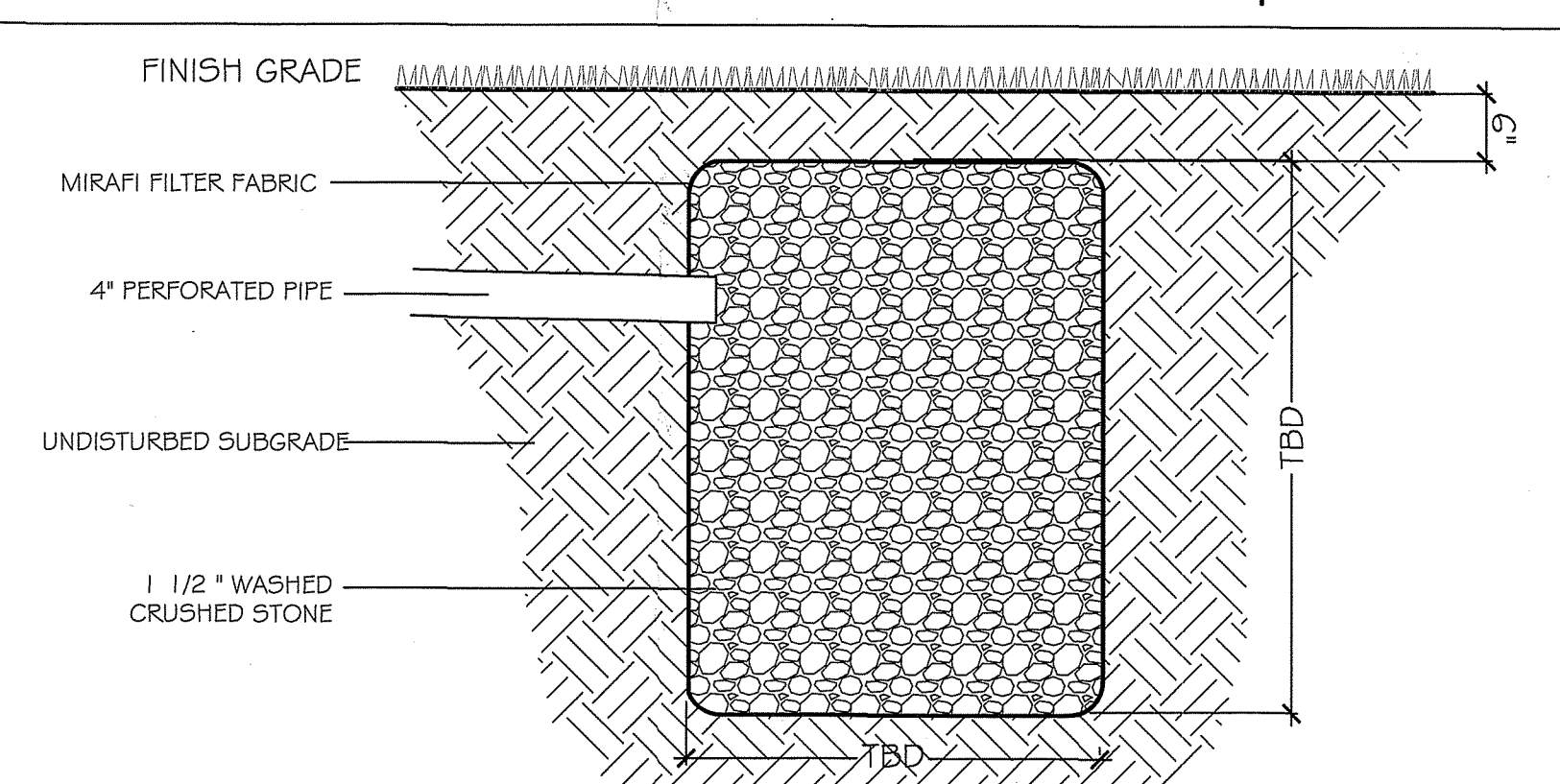

EROSION CONTROL DETAIL - NOT TO SCALE

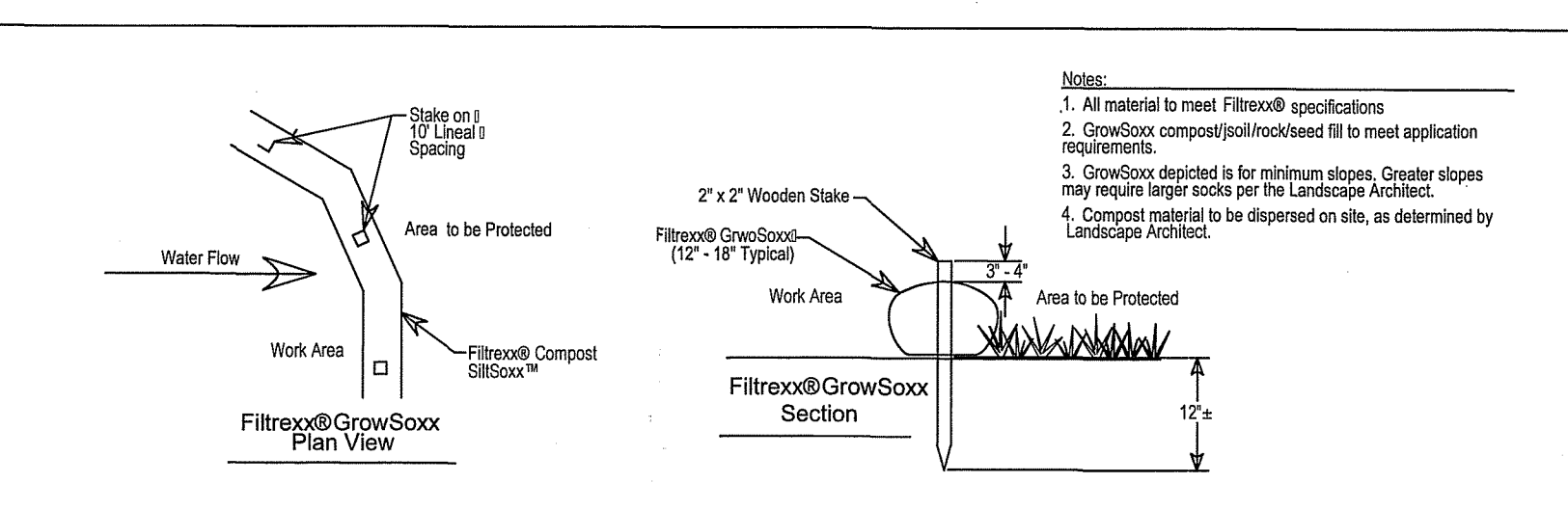

TYPICAL SHRUB PLANTING - NOT TO SCALE

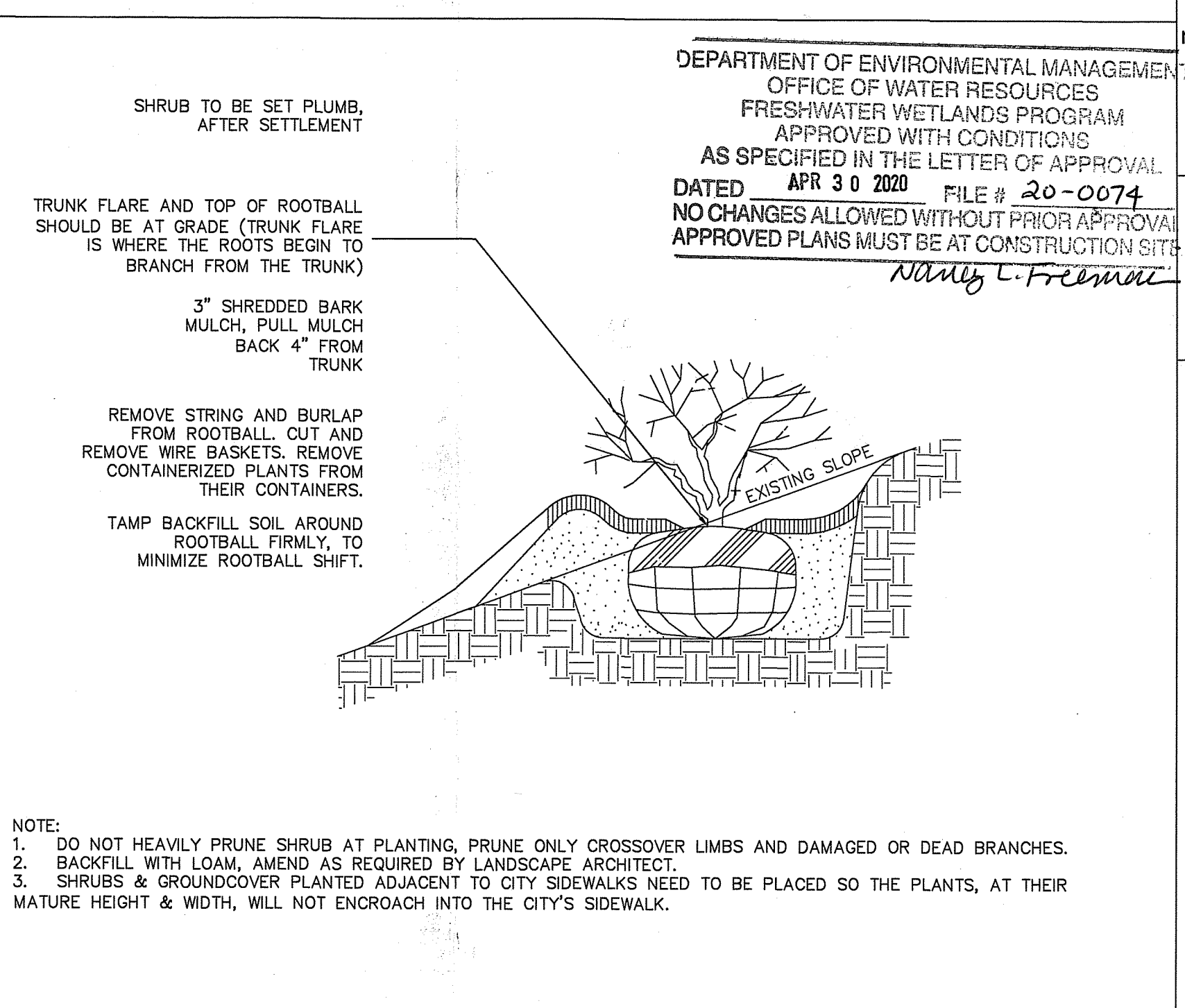

This plan is the property of the R.I. Zoological Society. Use or reproduction of this plan by any means without permission or purchase from R.I. Zoological Society is prohibited.

L-01

