



Site Plan

for propose pool install.

The pool dimensions are 16'x 27' rectangular, however the pool is not a rectangle. The proposed 40' from the pond's edge is to the corner of the rectangle, which is not the exact pool edge.

Environmental Management
JUL 21 2020
Office of Water Resources

DEPARTMENT OF ENVIRONMENTAL MANAGEMENT
OFFICE OF WATER RESOURCES
FRESHWATER WETLANDS PROGRAM
APPROVED WITH CONDITIONS
AS SPECIFIED IN THE LETTER OF APPROVAL
DATED SEP 18 2020 FILE # 20-0153
NO CHANGES ALLOWED WITHOUT PRIOR APPROVAL
APPROVED PLANS MUST BE AT CONSTRUCTION SITE
Nancy L. Flynn

David Caplette
756 Danielson Pike
North Scituate, RI 02857

Danielson Pike

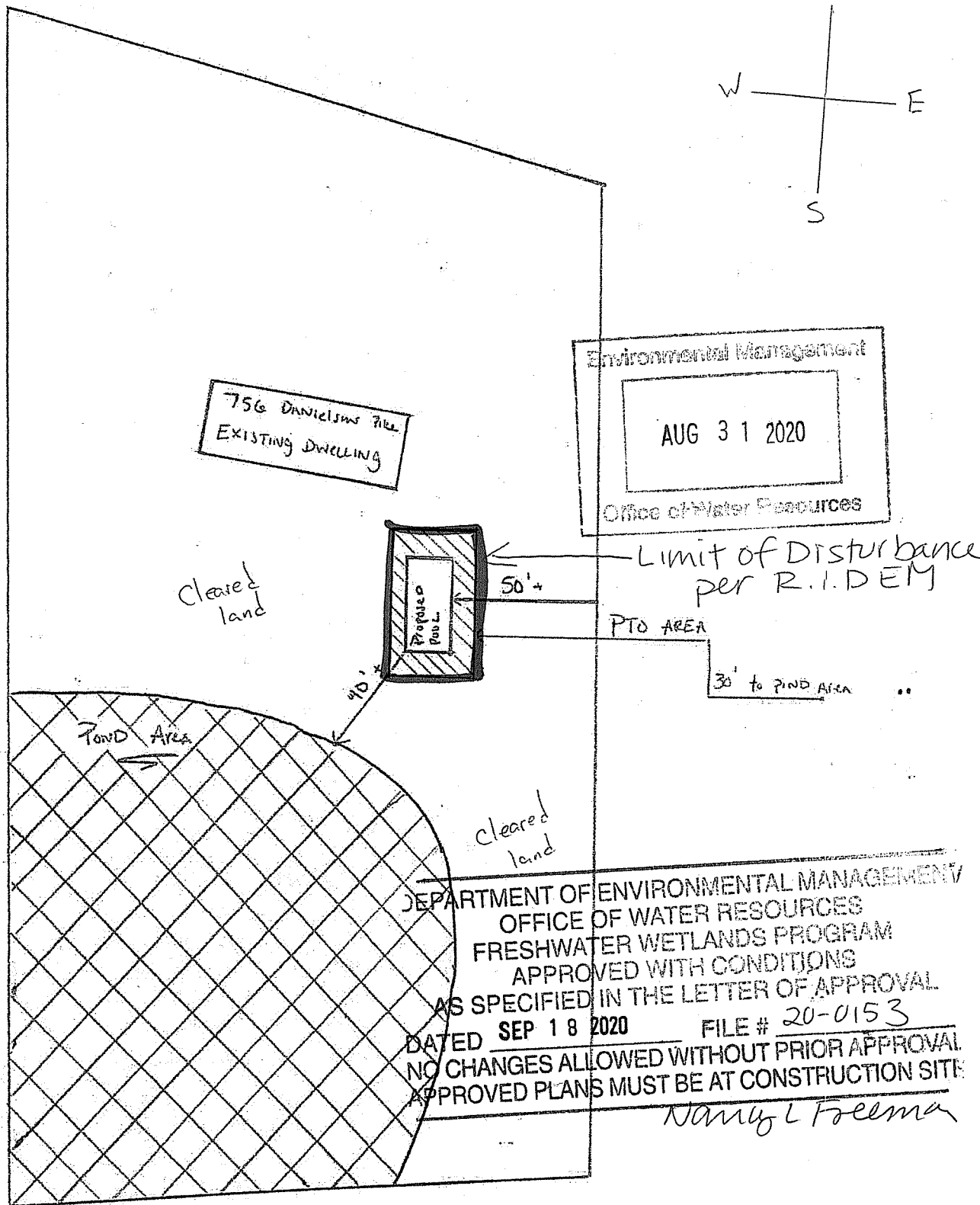
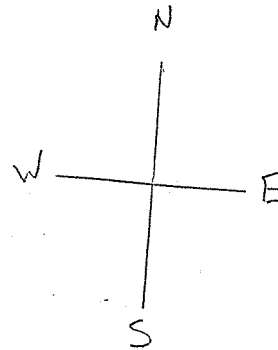

- * Proposed Pool : 18' x 32'
- * 40' + to water's edge
- * 50' + to property line
- * PATIO 30' + to Water's Edge

