

ZONING DISTRICT R1
 SETBACKS: FRONT - 20'
 SIDE - 10'
 REAR - 25'

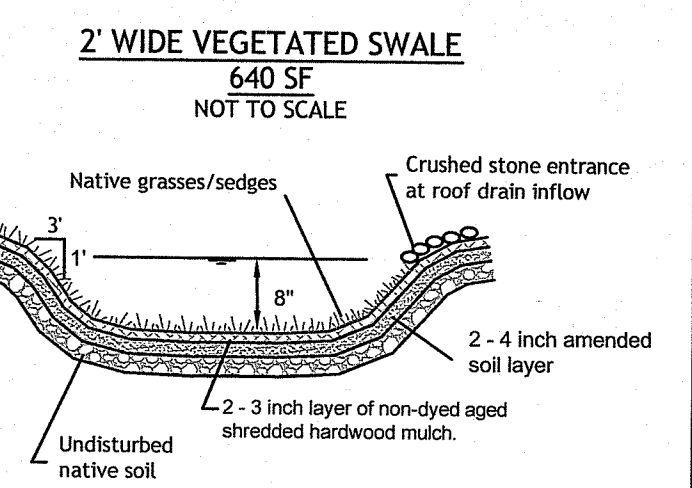
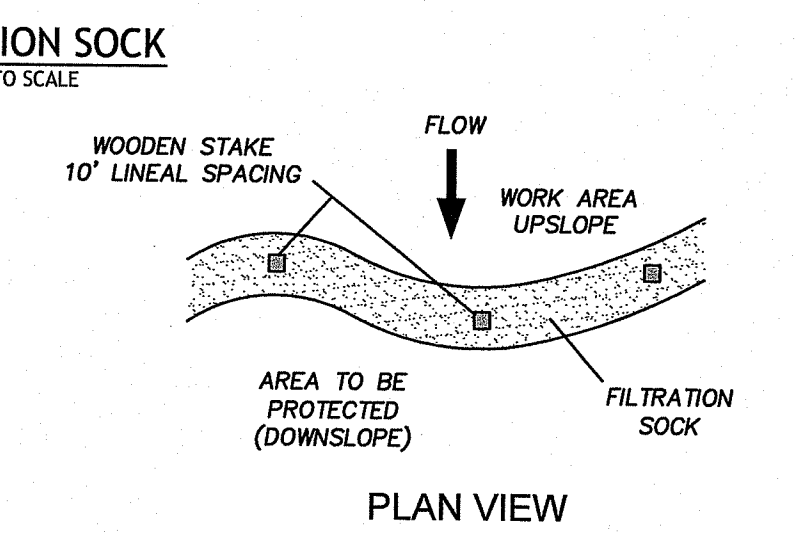
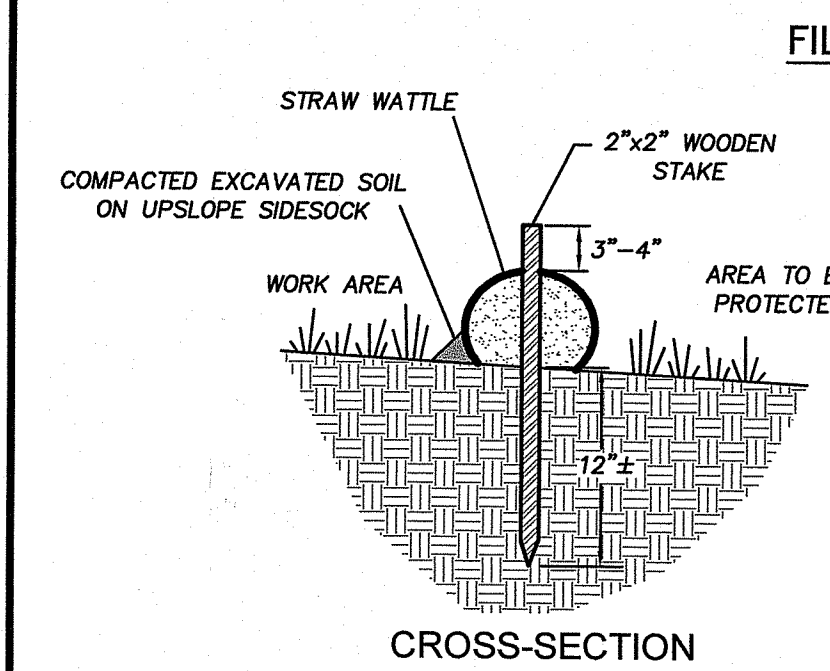
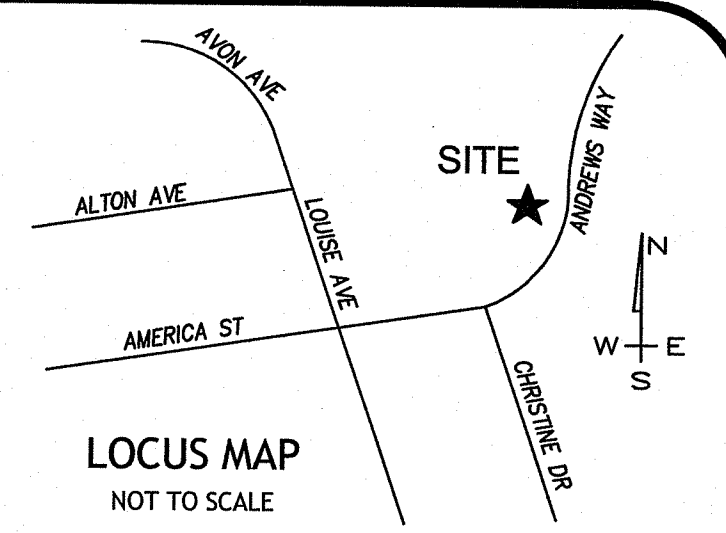
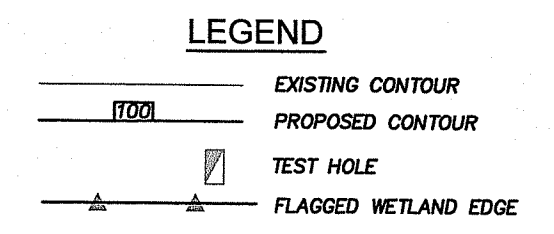
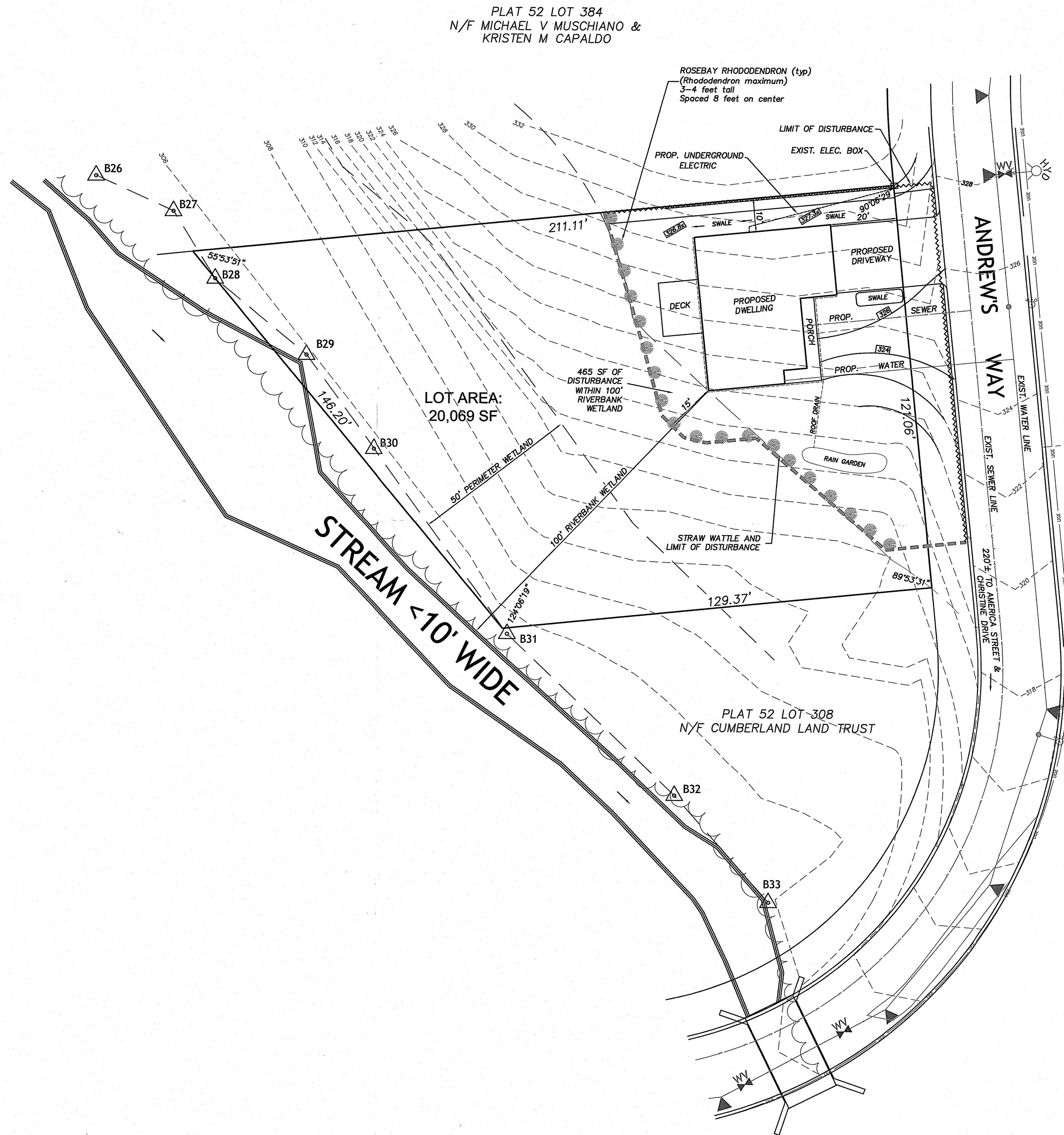

VEGETATIVE SWALE MAINTENANCE

- The vegetated swale shall be inspected annually and after large storm events.
- Eroded side slopes and channel bottom shall be stabilized as necessary.
- If the surface of the dry swale becomes clogged to the point that standing water is observed on the surface 48 hours after precipitation events, the bottom shall be roto-tilled or cultivated to break up any hard-packed sediment, and then reseeded.
- Vegetation in dry swales shall be moved as required to maintain minimum grass heights in the 4-6 inch range.
- Every five years, the channel bottom of dry swales should be scraped to remove sediment and to restore original cross section and infiltration rate, and should be seeded to restore ground cover, where necessary.

NOTE: VEGETATED SWALE SHALL BE INSPECTED ANNUALLY AND SHOULD BE INSPECTED AFTER LARGE STORM EVENTS.

RAIN GARDEN TREATMENT

1. Rain garden to be 8" deep with a 2-4 inch amended soil layer (50% mixture of excavated native soils and mature organic compost) and a 2-3 inch layer of non-dyed aged shredded hardwood mulch.

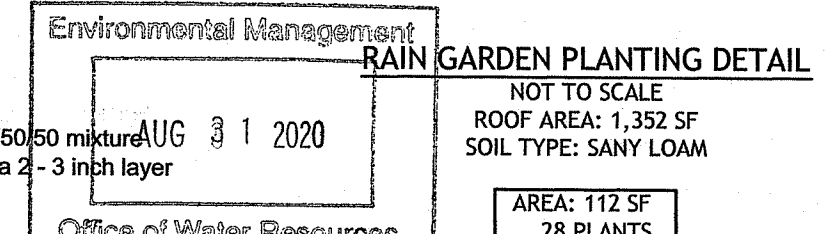

CONSTRUCTION

- A crushed stone entrance should be installed at the inflow to prevent channeling.
- A berm to detain stormwater should be constructed along the downhill side of the rain garden, perpendicular to the slope of the lawn.
- Be sure that the soil within the rain garden area does not become compacted by construction activities (i.e. heavy machinery). If soil becomes severely compacted it may need to be tilled and amended to maintain proper.

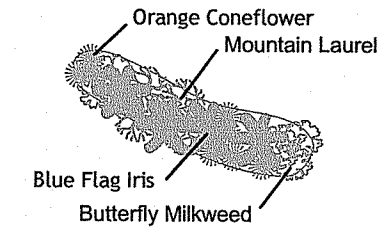

MAINTENANCE

- The rain garden shall be inspected following at least the first two precipitation events of at least 1.0 inch to ensure that the system is functioning properly. Thereafter, the rain garden shall be monitored and maintained to assure proper functioning, plant growth and survival. Plants shall be replaced on an as-needed basis during the growing season.
- Silt/accumulation shall be removed from the rain garden when the accumulation exceeds one inch, or when water ponds on the surface of the rain garden for more than 48 hours. The top few inches of material shall be removed and shall be replaced with fresh soil mixture and mulch.
- Pruning or replacement of woody vegetation shall occur when dead or dying vegetation is observed.
- Soil erosion gullies shall be repaired when they occur.
- Fertilizer or pesticides shall not be applied to plants within rain gardens.
- Perennial plants and ground covers shall be replaced as necessary to maintain an adequate vegetated ground cover. Annual plants may also be used to maintain ground cover.

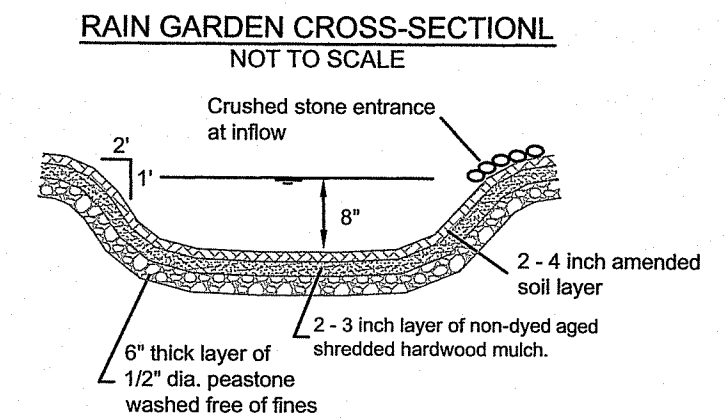

PLAN REFERENCE:
 "HIGHLAND ESTATES, CUMBERLAND, RHODE ISLAND,
 AP 52 LOTS 10, 307, 308, 309, 310, 315 & 316, MAJOR
 LAND DEVELOPMENT, LAST REVISION 11-2017 FINAL
 PLAN" BY JOE CASALI ENGINEERING, INC.

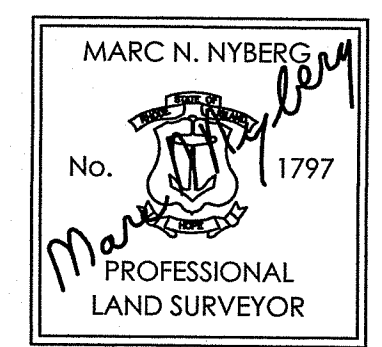

DEPARTMENT OF ENVIRONMENTAL MANAGEMENT
 OFFICE OF WATER RESOURCES
 FRESHWATER WETLANDS PROGRAM
 APPROVED WITH CONDITIONS
 AS SPECIFIED IN THE LETTER OF APPROVAL
 DATED SEP 18 2020 FILE # 20-0164
 NO CHANGES ALLOWED WITHOUT PRIOR APPROVAL
 APPROVED PLANS MUST BE AT CONSTRUCTION SITE

CERTIFICATION

THIS SURVEY HAS BEEN CONDUCTED AND THE PLAN HAS BEEN PREPARED PURSUANT TO SECTION 9 OF THE RULES AND REGULATIONS ADOPTED BY THE RHODE ISLAND STATE BOARD OF REGISTRATION FOR PROFESSIONAL LAND SURVEYORS ON NOVEMBER 25, 2015, AS FOLLOWS:

LIMITED CONTENT BOUNDARY SURVEY: CLASS IV
 TOPOGRAPHIC T-4

STATEMENT OF PURPOSE

THE PURPOSE FOR THE CONDUCT OF THE SURVEY AND THE PREPARATION OF THE PLAN IS AS FOLLOWS: PROPOSED HOUSE

By: *Marc N. Nyberg*

MARC N. NYBERG License No. 1797 COA No.: AS2

PROPOSED WETLANDS
 for
PLAT 52, LOT 309
8 ANDREWS WAY
CUMBERLAND, RHODE ISLAND
 JUNE, 2020
 SCALE 1"= 20'
 SHEET 1 of 1
 REVISED: 8-28-20

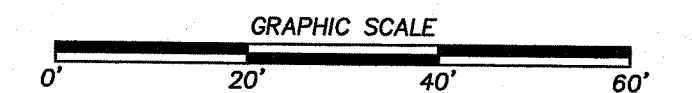

INSITE Engineering Services, LLC
 PROFESSIONAL ENGINEERS | LAND SURVEYORS
 Precision. Clarity. Certainty.

501 Great Road, Unit 104
 North Smithfield, Rhode Island 02896
 Phone: (401) 762-2870 Fax: (401) 401-762-2871
 Web Address: InsiteEngineers.com