

REAR
FRONT

MATCH LINE

(See Page 2 For
Front Details)

EXISTING and PROPOSED
DRIVEWAY TO BE 8'-12'
IN WIDTH WITH LIMITED
EDGE CLEARING FOR MINIMUM
ACCEPTABLE ACCESS & UTILITY
POLES. PVIOUS ROADWAY
SURFACE.

FRONT SECTION

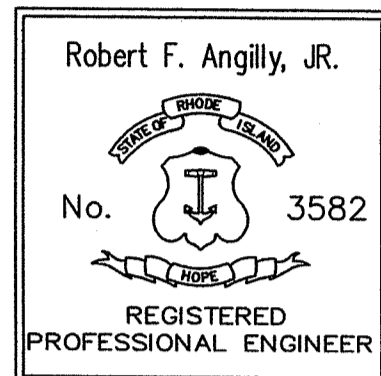

ENGINEERING BY ROBERT F. ANGILLY, JR D3047

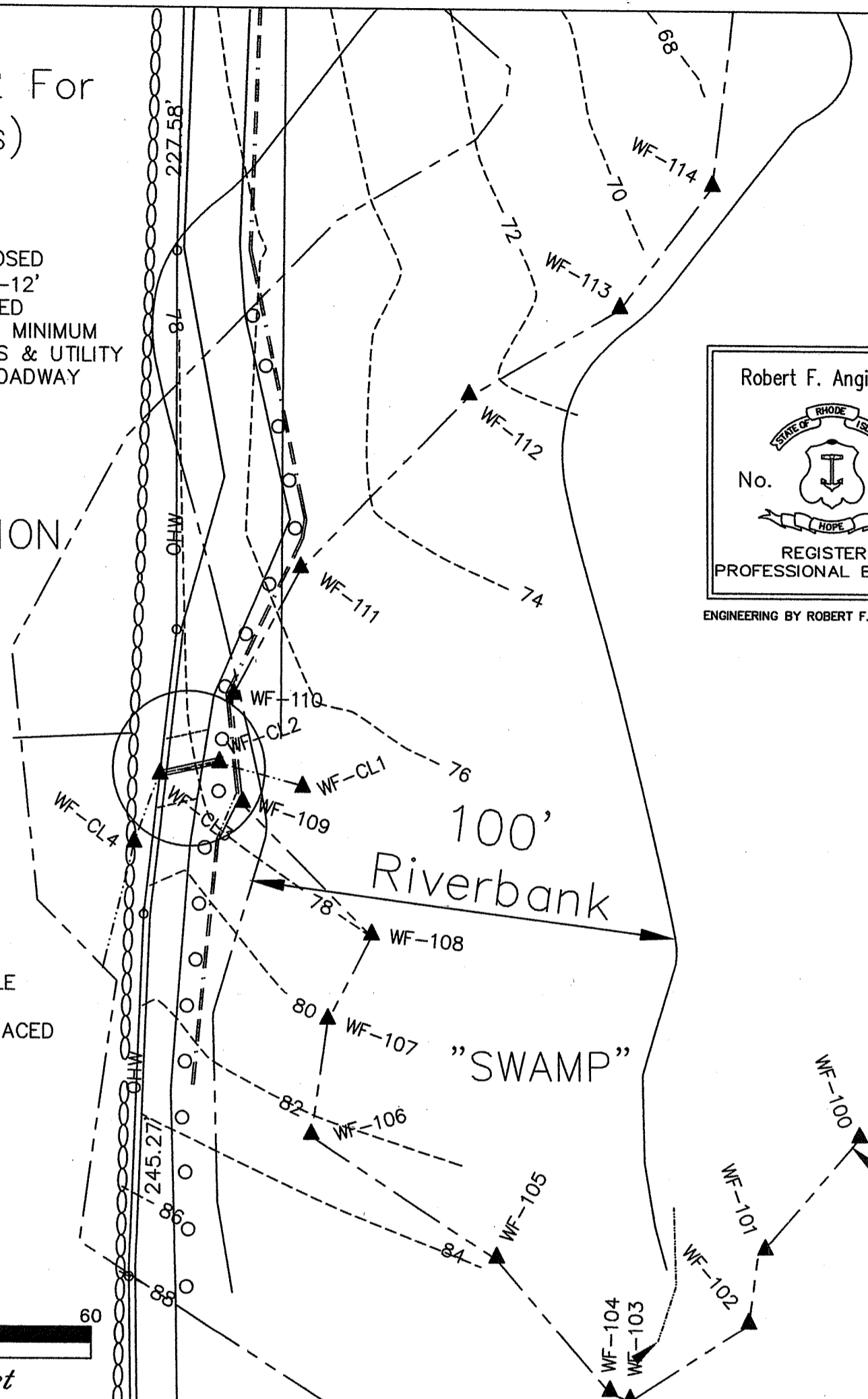

DOTTED "O" AREAS TO
BE PLANTED WITH A SINGLE
ROW OF ARBORVITAE
(THUJA OCCIDENTALIS) SPACED
10 FEET ON CENTER,
4 - 5 FEET TALL
AFTER PLANTING.

ALL AREAS OUTSIDE
OF LOD's TO REMAIN
WOODED and NATURAL

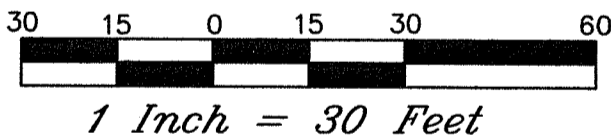

Road Crossing Profile & Details

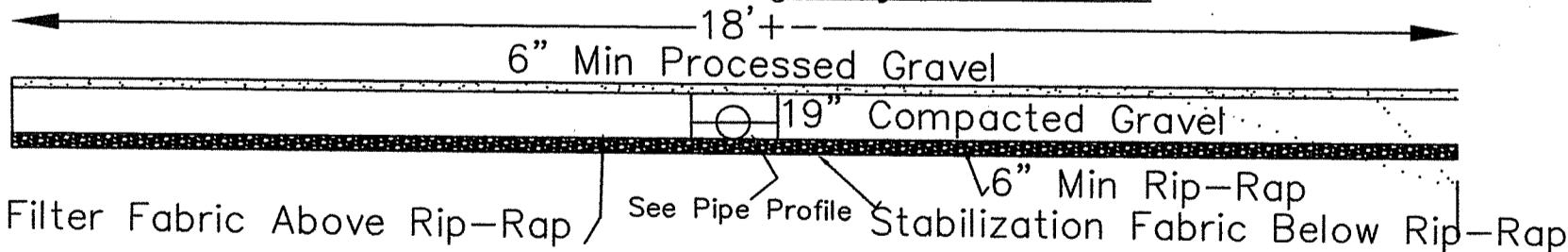

Pipe End Profile

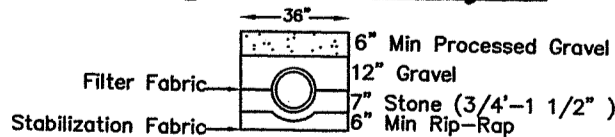
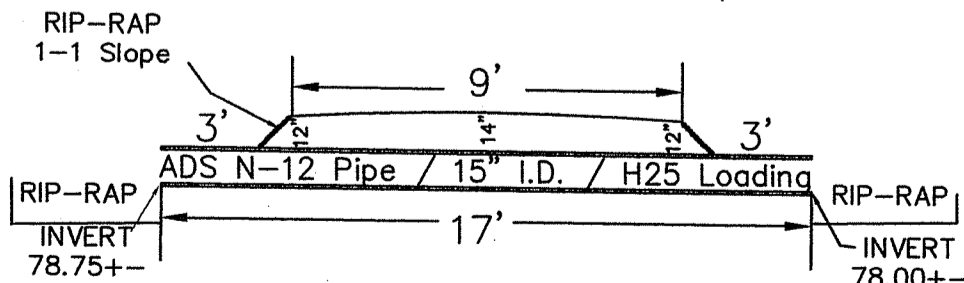

CROSSING CONSTRUCTION NOTES

1. PLACE EROSION CONTROLS PRIOR TO ANY EXCAVATION
2. REMOVE A HORIZON (Loam) IN ROAD AREA ONLY.
3. INSTALL STABILIZATION FABRIC AT BOTTOM EXCAVATION.
4. PLACE MIN 6" RIP-RAP ABOVE FABRIC.
5. INSTALL ADS PIPE AS SHOWN.
6. INSTALL FILTER FABRIC PRIOR TO GRAVEL PLACEMENT.
7. PLACE AND COMPACT GRAVEL IN 6" LIFTS.
8. PLACE PROCESSED GRAVEL TO FINISH GRADE.
9. FINALLY CONTOUR AND PLACE 1-1 SLOPING RIP-RAP.

TERRY LANE COMPANY
LAND USE FACILITATORS-OWTS CONSULTANTS-SOIL EVALUATORS
15A TERRY LANE, CHEPACHET, R.I. 02814 (401) 568-8006 OWTSRI@gmail.com

UTILITIS, PLANTINGS & DRIVEWAY PLAN
for JAMES POOLE
WILLIAM HENRY ROAD
SCITUATE

(See Page 3 For Rear Details)

EXISTING and PROPOSED DRIVEWAY TO BE 8'-12' IN WIDTH WITH LIMITED EDGE CLEARING FOR MINIMUM ACCEPTABLE ACCESS & UTILITY POLES. PERVIOUS ROADWAY SURFACE. FOR CRUSHED STONE DRIVEWAY CONSTRUCTION, THE CRUSHED STONE USED MUST BE INCH TO 1½ INCH DIAMETER, WASHED, ANGULAR CRUSHED STONE INSTALLED TO A MINIMUM DEPTH OF 3 INCHES. THE GRADE OF THE FINISHED DRIVEWAY SHALL NOT BE HIGHER THAN THE ADJACENT GROUND ELEVATION.

REAR SECTION

DOTTED "O" AREAS TO BE PLANTED WITH A SINGLE ROW OF ARBORVITAE (THUJA OCCIDENTALIS) SPACED 10 FEET ON CENTER, 4 - 5 FEET TALL AFTER PLANTING.

ALL AREAS OUTSIDE OF LOD's TO REMAIN WOODED and NATURAL

CONCRETE BOUND w/DRILL HOLE (FOUND)

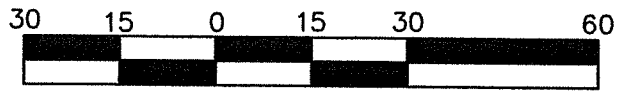

1 Inch = 30 Feet

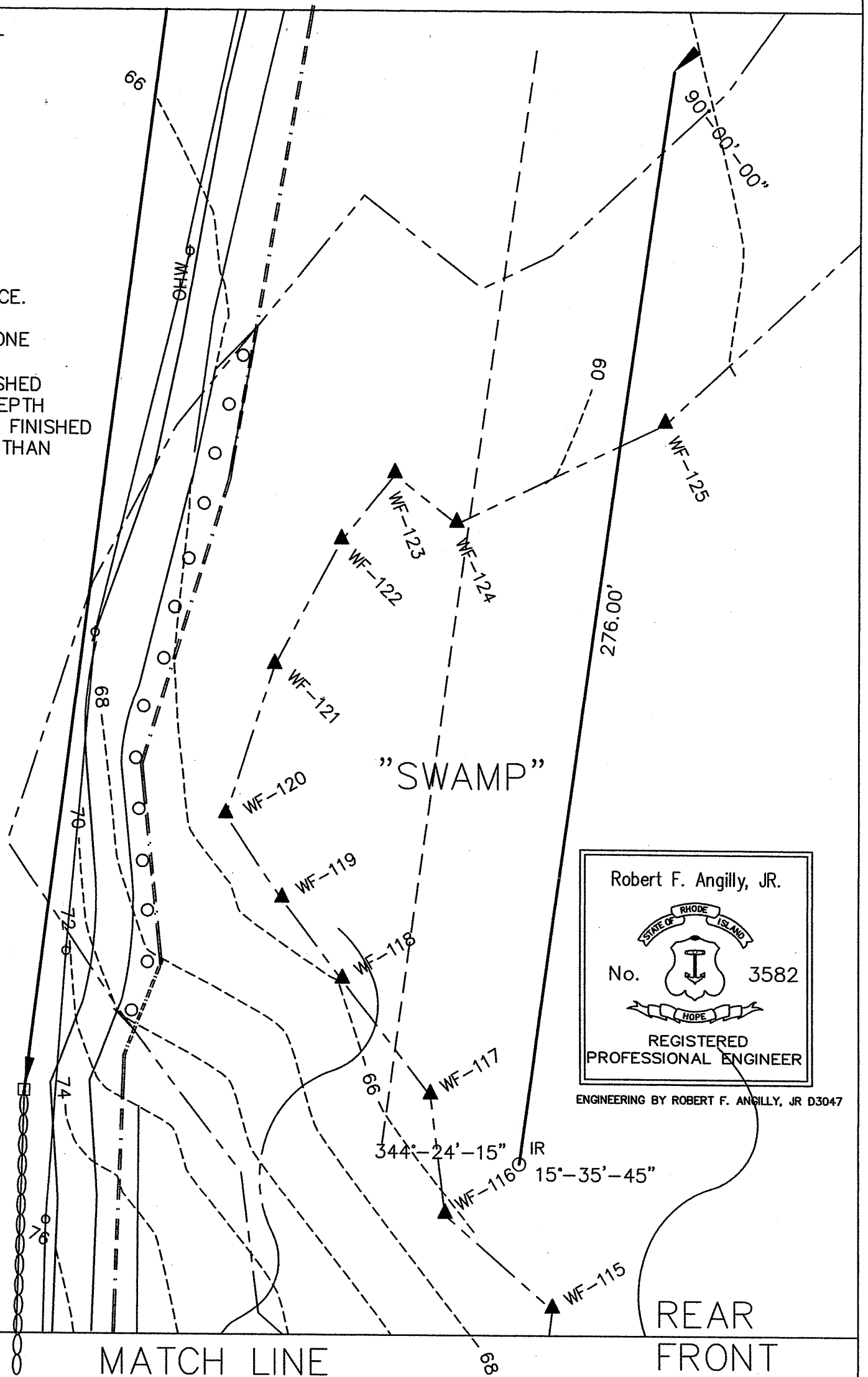

Robert F. Angilly, JR.
 No. 3582
 REGISTERED PROFESSIONAL ENGINEER

ENGINEERING BY ROBERT F. ANGILLY, JR D3047

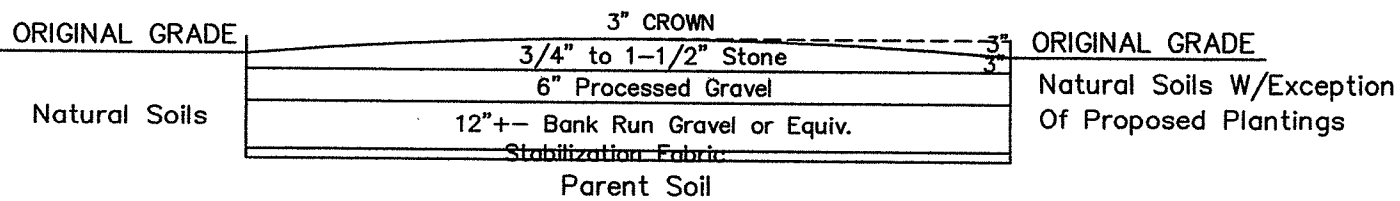

DRIVEWAY CONSTRUCTION NOTES

1. PLACE EROSION CONTROLS PRIOR TO ANY EXCAVATION
2. AS NEEDED REMOVE "A"(loam) & SOME "B" (subsoil) HORIZON SOILS IN ROAD AREA ONLY.
3. INSTALL STABILIZATION FABRIC AT BOTTOM EXCAVATION.
4. PLACE & COMPACT 12"+- BANK RUN GRAVEL ABOVE FABRIC.
5. PLACE MIN 6" PROCESSED GRAVEL ABOVE BANK RUN.
6. PLACE A MIN 3" OF STONE NEXT w/3" CROWN AT CENTER.
7. DO NOT DISTURB SOILS ON NORTH SIDE EXCEPT FOR PLANTINGS.
8. FINISH GRADE AT EDGES TO MEET EXISTING GRADE.
9. TRIM ONLY ENOUGH FOR UTILITIES, PLANTINGS and SAFE ACCESSIBILITY.

TERRY LANE COMPANY
 LAND USE FACILITATORS-OWTS CONSULTANTS-SOIL EVALUATORS
 15A TERRY LANE, CHEPACHET, R.I. 02814 (401) 568-8006 OWTSRI@gmail.com

UTILITIES, PLANTINGS & DRIVEWAY PLAN
 for JAMES POOLE
 WILLIAM HENRY ROAD
 SCITUATE
 A.P. 14 LOT 12 PAGE 3 OF 4

INSTALLION COPY

ELJEN LAYOUT

(See Attached Typical/Notes)

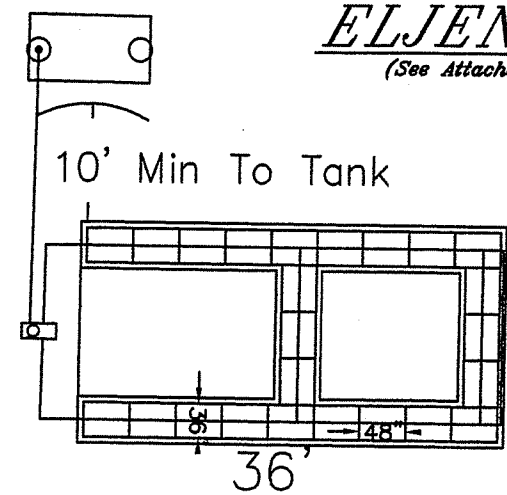
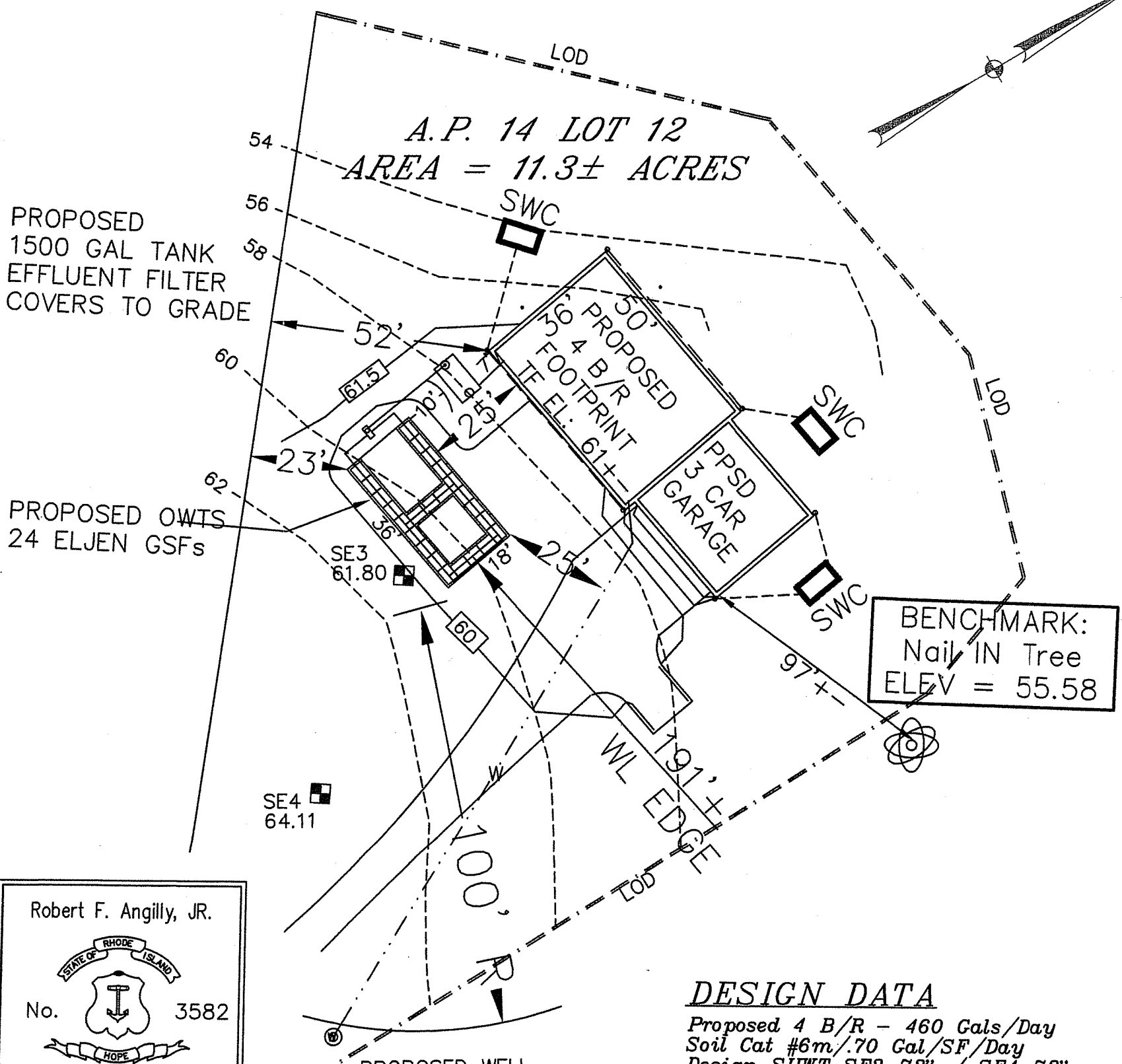

Fin Cr. EL 59.60 to 60.10
 FILTER FABRIC 1" PERF SCH 35
 3" Dia-Down Under Over Pipe/Under Fabric
 ELJEN 3' x 4' GSF 1" Dia EL 58.58
 Bot GSF EL 58.00
 USE 6" ASTM 33 SAND Bot Sand EL 57.50
 18" Min. to GWT IN SCITUATE CRA
 SHWT BELOW EL 54.00

ROOF STORMWATER CHAMBER DETAILS

ROOF STORMWATER
 DWELLING ROOF AREA 1800SF
 GARAGE ROOF AREA 900SF
 TOTAL ROOF AREA 2700SF
 1800SF X 1" = 150CF X 7.48GAL = 1122 GALS
 900SF X 1" = 75CF X 7.48GAL = 561 GALS
 TOTAL MINIMUM AREA REQ. 225 CU FT
 SHALLOW CHAMBER 4 X 8 X 1.5 = 48 CF
 STONE BOTTOM 6 X 10 X 1 = 60 X 40% = 24 CF
 STONE SIDES = 28 X 1 X 1 = 28 X 40% = 7 CF
 TOTAL CF PER CHAMBER = 79 CF X 3 = 237 CF TOTAL

Min. Cover EL: 55.00
 Cover Stone w/Filter Fabric
 INV EL: 53.50
 12" stone 3/4" BOT EL: 52.50
 SHWT BELOW EL 50.00
 12" STONE BELOW & SIDES OF CHAMBER MAINTAIN MIN 10' FROM FOUNDATION & PROPERTY LINES and 25' FROM OWTS.

REMOVE LOAM & SUBSOIL IN CHAMBER AREA ONLY. PLACE 12" OF STONE BELOW and SIDES OF CHAMBER..

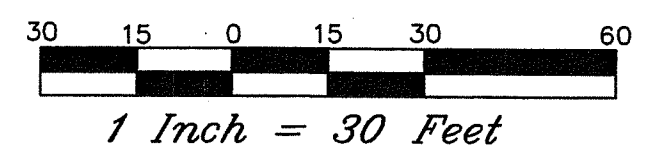

DESIGN DATA
 Proposed 4 B/R - 460 Gals/Day
 Soil Cat #6m/.70 Gal/SF/Day
 Design SHWT SE3-72" / SE4-72"
 Minimum Required Area = 658 S/F
 Area Provided = 672 S/F
 Depth Impervious = >9'
 SHWT EL 54.00/Maintain 4' SHWT Separation

TERRY LANE COMPANY
 LAND USE FACILITATORS-OWTS CONSULTANTS-SOIL EVALUATOR
 15A TERRY LANE, CHEPACHET, R.I. 02814 (401) 568-8006 OWTSRI@gmail.com

PROPOSED OWTS DESIGN
 for JAMES POOLE
 William Henry Rd.
 SCITUATE, RI
 A.P. 14 LOT 12

Mailing Address:
 149 Wm. Henry Rd.
 N. Scituate, RI 02857

Robert F. Angilly, JR.
 No. 3582
 REGISTERED PROFESSIONAL ENGINEER

ENGINEERING BY ROBERT F. ANGILLY, JR D3047

PROPERTY LIES WITH SCITUATE RESERVOIR WATERSHED