

RUNNINS RIVER TRIBUTARY STREAM RESTORATION

EAST PROVIDENCE RHODE ISLAND

MARCH 2020

DRAWING LIST:

- COVER SHEET
- C-1 OVERALL AERIAL PLAN
- C-2 PROPOSED WORK PLAN STA 8+00 TO STA 14+00
- C-3 CHANNEL PROFILE & CROSS SECTIONS
- C-4 DETAILS

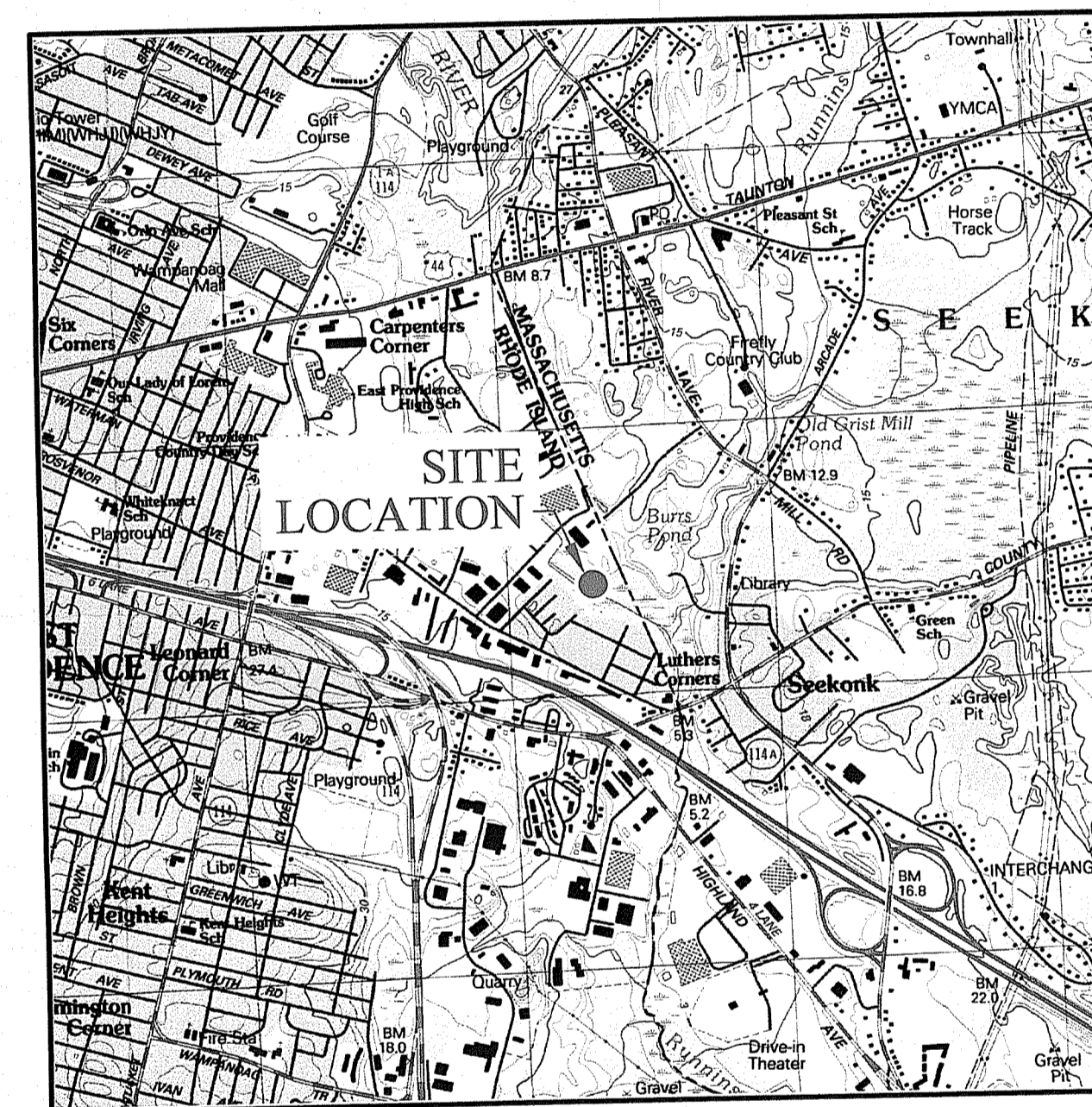

PROJECT LOCUS MAP

SOURCE: USGS Providence, Rhode Island - Massachusetts

0 1000' 2000' 4000' 6000'
SCALE: 1" = 2000 FEET

DEPARTMENT OF ENVIRONMENTAL MANAGEMENT
OFFICE OF WATER RESOURCES
FRESHWATER WETLANDS PROGRAM
APPROVED WITH CONDITIONS
AS SPECIFIED IN THE LETTER OF APPROVAL
DATED FEB 11 2022 FILE # 20-0126
NO CHANGES ALLOWED WITHOUT PRIOR APPROVAL
APPROVED PLANS MUST BE AT CONSTRUCTION SITE
Martin D. Wenczek

PREPARED FOR:

**City Of East Providence
Public Works, Engineering Division**

141 Taunton Avenue
East Providence, RI 02914

DESIGNER:

**GZA GeoEnvironmental, Inc.
Engineers and Scientists**

ONE FINANCIAL PLAZA
1350 Main Street, Suite 1400
Springfield, MA 01103
413-726-2100



PLAN FOR NOTICE

Environmental Management
AUG 27 2021
Office of Water Resources

© GZA-15.0166666.01 RUNNINS RIVER RESTORATION\15.0166666.01 CAD\DWG\666.01-GZA BASE-2.DWG 34X22-AERIAL JULY 22, 2021 11:46AM RACHEL CRUM



DEPARTMENT OF ENVIRONMENTAL MANAGEMENT
 OFFICE OF WATER RESOURCES
 FRESHWATER WETLANDS PROGRAM
 APPROVED WITH CONDITIONS
 AS SPECIFIED IN THE LETTER OF APPROVAL
 DATED FEB 11 2022 FILE # 20-0124
 NO CHANGES ALLOWED WITHOUT PRIOR APPROVAL
 APPROVED PLANS MUST BE AT CONSTRUCTION SITE

Martin D. Wemek

LEGEND

	EXISTING WETLAND BOUNDARY
	EXISTING PROPERTY LINE
	PROPERTY ID: MAP# - BLOCK# - PARCEL#
	STREAM ALIGNMENT
	LIMIT OF WORK
	EXISTING 5FT CONTOUR
	EXISTING 1FT CONTOUR
	TEMPORARY ACCESS EASEMENT
	CONSTRUCTION ENTRANCE
	STAGING AREA
	DEWATERING STOCKPILE LOCATION

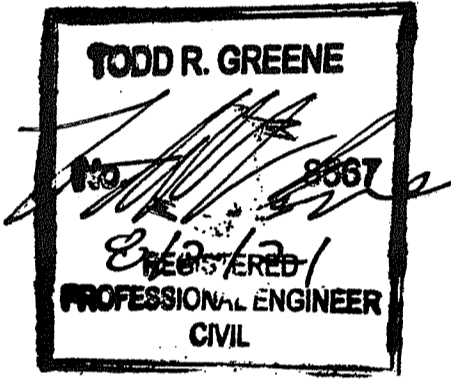

- NOTE:**
- AERIAL IMAGE FROM GOOGLE EARTH PRO. DATE: 6/29/2019
 - EXISTING CONDITIONS PLAN DEVELOPED FROM INFORMATION OBTAINED FROM THE CITY OF EAST PROVIDENCE, RHODE ISLAND GIS AERIAL PHOTOGRAPHY (SPRING 2016), STATEWIDE ELEVATION CONTOUR LINES FROM NORTHEAST LIDAR PROJECT (2011, USGS, RIDOT).
 - CONTOURS WERE GENERATED USING LIDAR DATA: AVAILABLE THROUGH: [HTTPS://COAST.NOAA.GOV/DATA/VIEWER/#/](https://coast.noaa.gov/data/viewer/#/). DATA IS 2016 USGS CONED TOPOBATHYMERIC FROM TOPOBATHYMERIC MODEL FOR THE NEW ENGLAND REGION STATES OF NEW YORK, CONNECTICUT, RHODE ISLAND, AND MASSACHUSETTS, 1187 TO 2016.
 - ENTIRE EXTENT IS WITHIN AREA SUBJECT TO FLOODING (1% ANNUAL CHANCE OF FLOODING). LIMITS OF SPECIAL FLOOD HAZARD AREAS WERE IDENTIFIED USING DATA FROM DIGITIZED FIRMEITE PANELS: 44007C0323J EFF. 10/22/15, 44007C0329I EFF. 10/22/15, 44007C0336H EFF. 9/18/2013, AND 44007C0337G EFF. 3/2/2009 (FEMA.GOV).
 - EXISTING WETLAND BOUNDARY OBTAINED FROM GPS SURVEY (ACCURACY WITHIN 6") OF WETLANDS, DELINEATED BY GZA OCTOBER 2016 AND UPDATED MAY 2019.

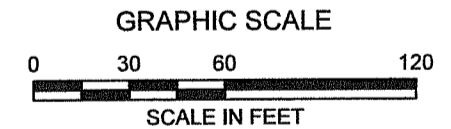

NO. 1	Revision #1 per RIDEM Comments dated 6/23/2021	RAC	7/6/2021
NO.	ISSUE/DESCRIPTION	BY	DATE

UNLESS SPECIFICALLY STATED BY WRITTEN AGREEMENT, THIS DRAWING IS THE SOLE PROPERTY OF GZA GEOTECHNICAL, INC. (GZA). THE INFORMATION SHOWN ON THE DRAWING IS SOLELY FOR USE BY GZA'S CLIENT OR THE CLIENT'S DESIGNATED REPRESENTATIVE FOR THE SPECIFIC PROJECT AND LOCATION IDENTIFIED ON THE DRAWING. THE DRAWING SHALL NOT BE TRANSFERRED, REUSED, COPIED, OR ALTERED IN ANY MANNER FOR USE AT ANY OTHER LOCATION OR FOR ANY OTHER PURPOSE WITHOUT THE PRIOR WRITTEN CONSENT OF GZA. ANY TRANSFER, REUSE, OR MODIFICATION TO THE DRAWING BY THE CLIENT OR OTHERS, WITHOUT THE PRIOR WRITTEN EXPRESS CONSENT OF GZA, WILL BE AT THE USER'S SOLE RISK AND WITHOUT ANY RISK OR LIABILITY TO GZA.

**RUNNINS RIVER TRIBUTARY STREAM RESTORATION
 CITY OF EAST PROVIDENCE PARCEL
 EAST PROVIDENCE, RI**

OVERALL AERIAL PLAN

PREPARED BY: GZA GeoEnvironmental, Inc. Engineers and Scientists www.gza.com	PREPARED FOR: CITY OF EAST PROVIDENCE PUBLIC WORKS, ENGINEERING DIVISION 145 TAUNTON AVENUE EAST PROVIDENCE, RI 02914		
PROJ MGR: SRT	REVIEWED BY: SDR	CHECKED BY: PGD	DRAWING
DESIGNED BY: RTS	DRAWN BY: NJG/EDM	SCALE: 1"=60'	C-1
DATE: JULY, 2021	PROJECT NO. 15.0166666.00	REVISION NO. 1	SHEET NO. 01 OF 04

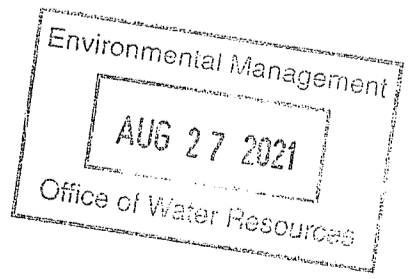

© 2021 - GZA GeoEnvironmental, Inc. GZA-J-1-D 166600 - 0 166699 15.0166666.01 RUNNINS RIVER RESTORATION 15.0166666.01 CAD/DWG/666.01-CZA BASE-2.DWG 3/4/22-PROP JULY 22, 2021 11:46AM RACHEL CRUM

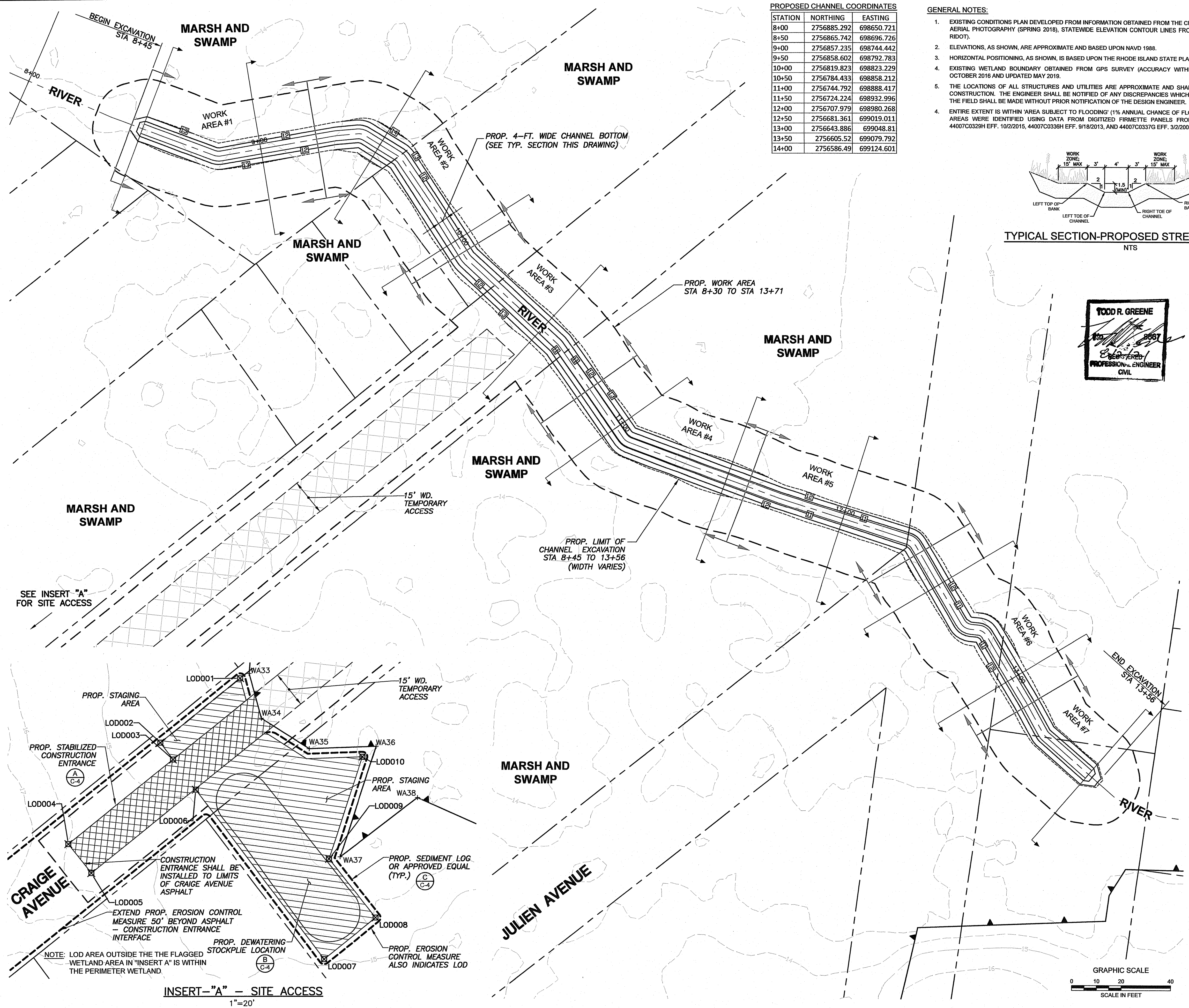

STATION	NORTHING	EASTING
8+00	2756885.292	698650.721
8+50	2756865.742	698696.726
9+00	2756857.235	698744.442
9+50	2756858.602	698792.723
10+00	2756819.823	698823.229
10+50	2756784.433	698858.212
11+00	2756744.792	698888.417
11+50	2756724.224	698932.996
12+00	2756707.979	698980.268
12+50	2756681.361	699019.011
13+00	2756643.886	699048.81
13+50	2756605.52	699079.792
14+00	2756586.49	699124.601

- GENERAL NOTES:**
- EXISTING CONDITIONS PLAN DEVELOPED FROM INFORMATION OBTAINED FROM THE CITY OF EAST PROVIDENCE, RHODE ISLAND GIS AERIAL PHOTOGRAPHY (SPRING 2018), STATEWIDE ELEVATION CONTOUR LINES FROM NORTHEAST LIDAR PROJECT (2011, USGS, RIDOT).
 - ELEVATIONS, AS SHOWN, ARE APPROXIMATE AND BASED UPON NAVD 1988.
 - HORIZONTAL POSITIONING, AS SHOWN, IS BASED UPON THE RHODE ISLAND STATE PLANE COORDINATE SYSTEM (NAS 83).
 - EXISTING WETLAND BOUNDARY OBTAINED FROM GPS SURVEY (ACCURACY WITHIN 6") OF WETLANDS, DELINEATED BY GZA OCTOBER 2016 AND UPDATED MAY 2019.
 - THE LOCATIONS OF ALL STRUCTURES AND UTILITIES ARE APPROXIMATE AND SHALL BE VERIFIED BY CONTRACTOR PRIOR TO CONSTRUCTION. THE ENGINEER SHALL BE NOTIFIED OF ANY DISCREPANCIES WHICH WILL AFFECT SITE DESIGN. NO CHANGES IN THE FIELD SHALL BE MADE WITHOUT PRIOR NOTIFICATION OF THE DESIGN ENGINEER.
 - ENTIRE EXTENT IS WITHIN 'AREA SUBJECT TO FLOODING' (1% ANNUAL CHANCE OF FLOODING). LIMITS OF SPECIAL FLOOD HAZARD AREAS WERE IDENTIFIED USING DATA FROM DIGITIZED FIRMETTE PANELS FROM FEMA.GOV: 44007C0328J EFF. 10/2/2015, 44007C0328H EFF. 10/2/2015, 44007C0338H EFF. 9/18/2013, AND 44007C0337J EFF. 3/2/2009.

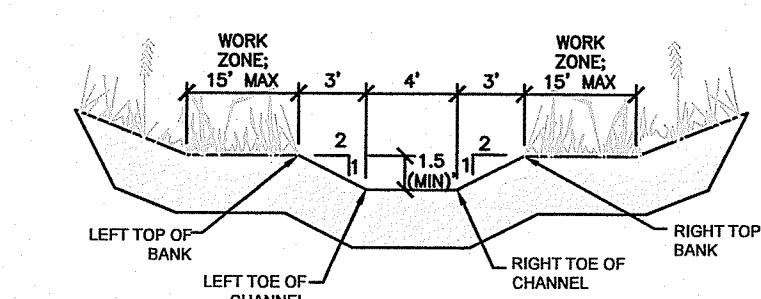

TYPICAL SECTION-PROPOSED STREAM CHANNEL
NTS

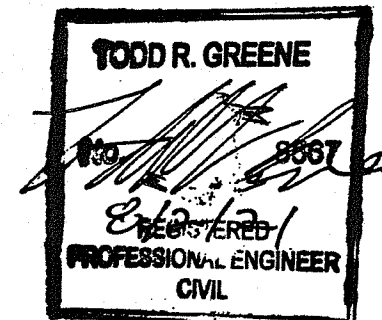

DEPARTMENT OF ENVIRONMENTAL MANAGEMENT
 OFFICE OF WATER RESOURCES
 FRESHWATER WETLANDS PROGRAM
 APPROVED WITH CONDITIONS
 AS SPECIFIED IN THE LETTER OF APPROVAL
 DATED FEB 11 2022 FILE # 20-012
 NO CHANGES ALLOWED WITHOUT PRIOR APPROVAL
 APPROVED PLANS MUST BE AT CONSTRUCTION SITE
 Martin D. Weneck

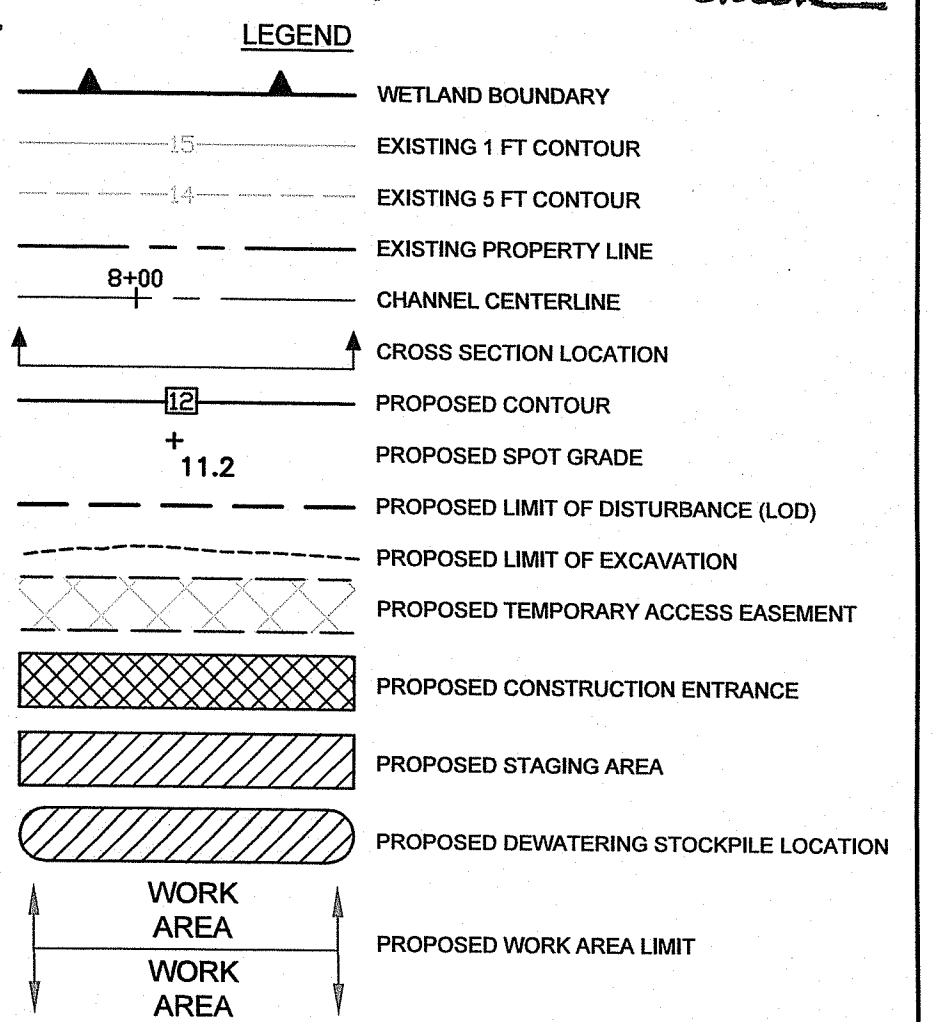

- CONSTRUCTION NOTES:**
- ALL EXCAVATIONS SHALL BE PERFORMED IN A SAFE MANNER, IN ACCORDANCE WITH ALL APPLICABLE FEDERAL AND STATE REGULATIONS AND SO AS TO PROTECT THE PUBLIC.
 - CONTRACTOR SHALL SAFEGUARD AND PROTECT ALL WORK AREAS.
 - THE CONTRACTOR SHALL BE AWARE THAT THE GROUND SURFACE WITHIN THE LIMITS OF DISTURBANCE MAY BE COMPRISED OF FULLY SATURATED ORGANIC MATTER AND ROOT MASSES. DUE TO THE INSTABILITY OF THE GROUND, MARSH/TIMBER MATTING FOR ACCESS WITHIN WETLAND IS RECOMMENDED. LOW GROUND PRESSURE EQUIPMENT SHALL BE USED.
 - CONTRACTOR SHALL SUBMIT A COMPLETE AND DETAILED DEWATERING PLAN TO THE ENGINEER FOR REVIEW AT LEAST TWO WEEKS PRIOR TO CONSTRUCTION.
 - THE CONTRACTOR SHALL STAKE OUT ALL LIMITS OF DISTURBANCE PRIOR TO THE PRE-CONSTRUCTION MEETING FOR REVIEW. THE CONTRACTOR SHALL ALSO STAKE OUT THE LIMITS OF THE CONTRACTOR'S STAGING AREA, DEWATERING AREA, AND FLAG ALL TREES WITHIN THE LIMIT OF DISTURBANCE WHICH WOULD BE REMOVED DURING CONSTRUCTION. THE LIMITS OF DISTURBANCE AND EROSION AND SEDIMENT CONTROL REQUIREMENTS WILL BE REVIEWED BY THE TEAM DURING THE PRE-CONSTRUCTION MEETING. TREES SHALL NOT BE REMOVED WITHIN THE LIMIT OF DISTURBANCE WITHOUT APPROVAL FROM THE LOCAL AUTHORITY.
 - CONSTRUCTION SHALL NOT BEGIN UNTIL ALL EROSION AND SEDIMENT CONTROL MEASURES HAVE BEEN INSTALLED AND APPROVED BY THE ENGINEER. THE CONTRACTOR SHALL STAY WITHIN THE LIMITS OF THE DISTURBANCE AS SHOWN ON THE PLANS AND MINIMIZE DISTURBANCE WITHIN THE WORK AREA WHENEVER POSSIBLE.
 - THE CONTRACTOR SHALL BEGIN WORK AT THE UPSTREAM SECTION AND PROCEED DOWNSTREAM. THE CONTRACTOR SHALL ONLY BEGIN WORK IN AN AREA WHICH CAN BE COMPLETED BY THE END OF THE DAY INCLUDING GRADING ADJACENT TO THE CHANNEL. THE CONTRACTOR MAY CREATE SMALLER CELLS TO FACILITATE THIS WORK. THE CONTRACTOR SHALL INSTALL DOWNSTREAM SEDIMENT LOG CHECK DAM AND ESTABLISH APPROPRIATE TEMPORARY EROSION AND SEDIMENT CONTROL MEASURES FOR THE INDIVIDUAL CELL. AT THE END OF EACH WORK DAY, THE WORK AREA MUST BE STABILIZED, AND THE TEMPORARY EROSION AND SEDIMENT CONTROL MEASURES REMOVED FROM THE CHANNEL. WORK SHALL NOT BE CONDUCTED IN THE CHANNEL DURING RAIN EVENTS. WORK SHALL ONLY OCCUR WITHIN A SINGLE CELL AT ONE TIME. THE DOWNSTREAM SEDIMENT LOG CHECK DAM SHALL NOT BE REMOVED UNTIL THREE (3) DAYS AFTER WORK HAS CEASED WITHIN THE DESIGNATED CELL TO ALLOW SEDIMENT TO SETTLE AND FILTER.
 - TRAVERSING A CHANNEL REACH WITH EQUIPMENT WITHIN THE WORK AREA WHERE NO WORK IS PROPOSED SHALL BE AVOIDED. TEMPORARY STREAM CROSSINGS MAY BE USED.
 - PHRAGMITES AUSTRALIS SHALL BE REMOVED AS INDICATED BY THE DESIGN PLANS AND ALL SURFACES GRADED IN ACCORDANCE WITH THE PLANS AND TYPICAL CROSS-SECTIONS. ALL GRADING OUTSIDE OF THE CHANNEL BUT WITHIN WETLANDS AREA MUST BE STABILIZED AT THE END OF EACH DAY WITH WETLAND SEED MIX AND COVERED BY STRAW MULCH.
 - AFTER CONSTRUCTION, ALL DISTURBED AREAS SHALL BE RESTORED AND REVEGETATED AS FOLLOWS: (1) IN AREAS WHICH ARE CURRENTLY MAINTAINED AS UPLAND LAWN WITHIN STAGING AND DEWATERING AREAS, RUTS SHALL BE GRADED TO MATCH EXISTING CONDITIONS AND AREAS SHALL BE SEED WITH AN UPLAND GRASS SEED MIX TO MATCH EXISTING CONDITIONS AND COVERED WITH STRAW MULCH. (2) REPLACEMENT SHRUBS OF THE SAME OR SIMILAR SPECIES SHALL BE INSTALLED WHERE TREES MUST BE REMOVED FOR ACCESS.
 - SOIL DISTURBANCE SHALL BE CEASED DURING ANY HIGH FLOW EVENT AS DIRECTED BY THE ENGINEER. THE CONTRACTOR SHALL BE EXPECTED TO CONTROL FLOW AROUND THE SITE.
 - EXCAVATED RHIZOMES AND TRAPPED SEDIMENTS (DREDGED MATERIAL) WILL HAVE HIGH WATER CONTENT AND SHALL BE DEWATERED IN ACCORDANCE WITH THESE PLANS. THE CONTRACTOR SHALL BE RESPONSIBLE FOR DEWATERING OF ALL DREDGED MATERIAL GENERATED FROM THE WORK PRIOR TO TRANSPORTATION FROM THE SITE. THE CONTRACTOR SHALL COORDINATE WITH THE CITY REGARDING THE REMOVAL AND DISPOSAL OF DREDGED MATERIAL. DEWATERING, REMOVAL, AND DISPOSAL OF DREDGED MATERIAL SHALL COMPLY WITH ALL STATE, LOCAL, AND FEDERAL REGULATIONS.

NO.	ISSUE/DESCRIPTION	BY	DATE
1	Revision #1 per RIDEM Comments dated 6/23/2021	RAC	7/6/2021

UNLESS SPECIFICALLY STATED BY WRITTEN AGREEMENT, THIS DRAWING IS THE SOLE PROPERTY OF GZA GEOENVIRONMENTAL, INC. (GZA). THE INFORMATION SHOWN ON THIS DRAWING IS SOLELY FOR USE BY GZA'S CLIENT OR THE CLIENT'S DESIGNATED REPRESENTATIVE FOR THE SPECIFIC PROJECT AND LOCATION IDENTIFIED ON THE DRAWING. THE DRAWING SHALL NOT BE TRANSFERRED, REUSED, COPIED, OR ALTERED IN ANY MANNER FOR USE AT ANY OTHER LOCATION OR FOR ANY OTHER PURPOSE WITHOUT THE PRIOR WRITTEN CONSENT OF GZA. ANY TRANSFER, REUSE, OR MODIFICATION TO THE DRAWING BY THE CLIENT OR OTHERS, WITHOUT THE PRIOR WRITTEN EXPRESS CONSENT OF GZA, WILL BE AT THE USER'S SOLE RISK AND WITHOUT ANY RISK OR LIABILITY TO GZA.

RUNNINS RIVER TRIBUTARY STREAM RESTORATION
 CITY OF EAST PROVIDENCE PARCEL
 EAST PROVIDENCE, RI

PROPOSED WORK PLAN
STA 8+00 TO STA 14+00

PREPARED BY: **GZA GeoEnvironmental, Inc.**
 Engineers and Scientists
 www.gza.com

PREPARED FOR: CITY OF EAST PROVIDENCE
 PUBLIC WORKS, ENGINEERING DIVISION
 145 TAUNTON AVENUE
 EAST PROVIDENCE, RI 02914

PROJ MGR: SRT REVIEWED BY: SDR CHECKED BY: TEJ DRAWING
 DESIGNED BY: RTS DRAWN BY: NJG/EDM SCALE: 1"=20'
 DATE: JULY 2021 PROJECT NO. 15.0166666.00 REVISION NO. 1 SHEET NO. 02 OF 04

INSERT-"A" - SITE ACCESS
 1"=20'

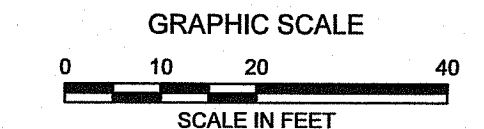

Environmental Management
 AUG 27 2021
 Office of Water Resources

© 2021 - GZA GeoEnvironmental, Inc. GZA-I-0 166600 - 0 166699\15.0166666.01 RUNNINS RIVER RESTORATION\15.0166666.01 CAD DWG\16666.01 -GZA BASE-2.DWG 34X22-DETAILS JULY 22, 2021 11:47AM RACHEL CRUM

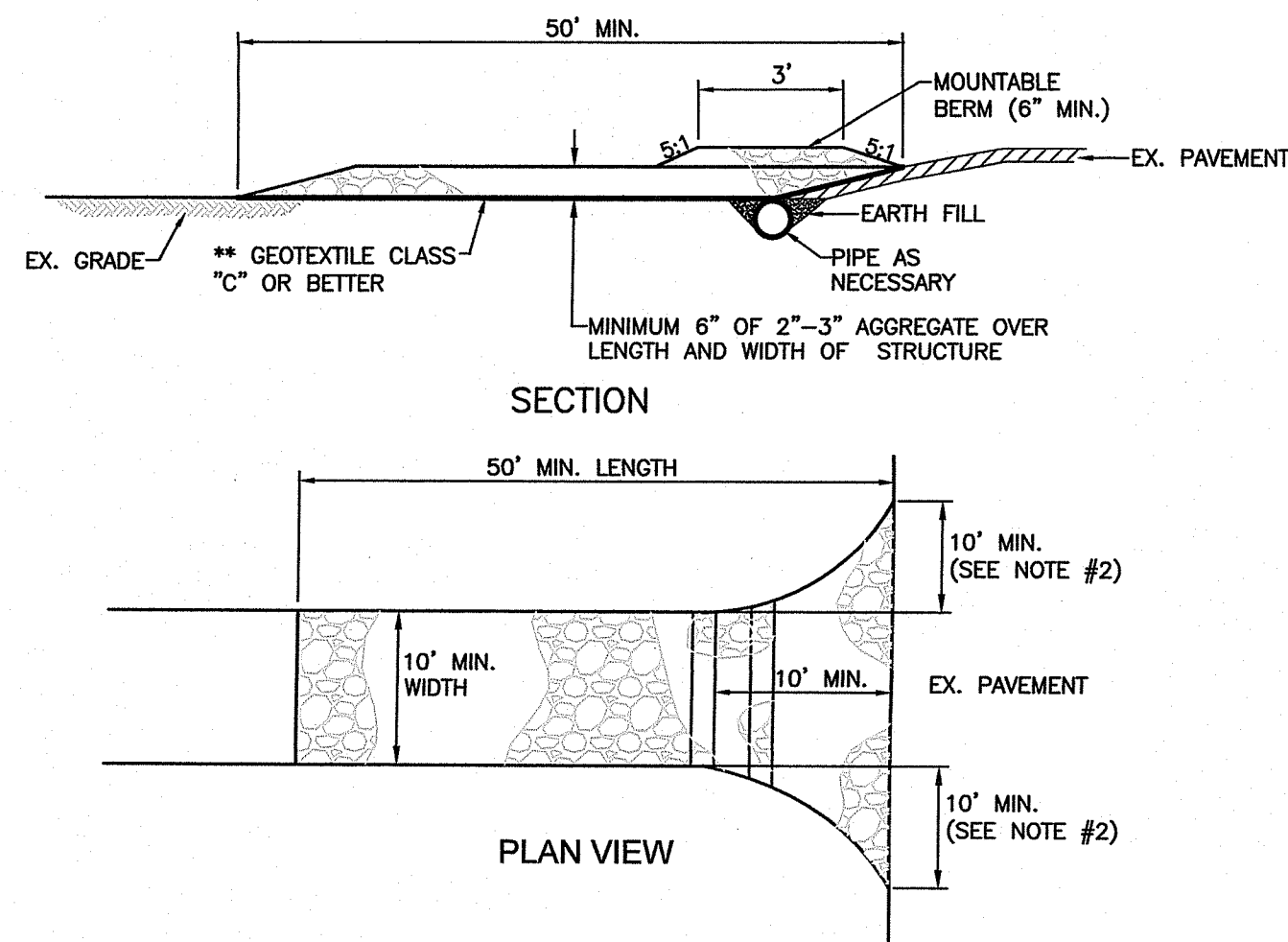

A
C-4 **STABILIZED CONSTRUCTION ENTRANCE**
NTS

STABILIZED CONSTRUCTION ENTRANCE SPECIFICATIONS

- LENGTH - MINIMUM OF 50' (*30' FOR SINGLE RESIDENCE LOT).
- WIDTH - 10' MINIMUM, SHOULD BE FLARED AT THE EXISTING ROAD TO PROVIDE A TURNING RADIUS.
- GEOTEXTILE FABRIC (FILTER CLOTH) SHALL BE PLACED OVER THE EXISTING GROUND PRIOR TO PLACING STONE. **THE PLAN APPROVAL AUTHORITY MAY NOT REQUIRE SINGLE FAMILY RESIDENCES TO USE GEOTEXTILE.
- STONE - CRUSHED AGGREGATE (2" TO 3") OR RECLAIMED OR RECYCLED CONCRETE EQUIVALENT SHALL BE PLACED AT LEAST 6" DEEP OVER THE LENGTH AND WIDTH OF THE ENTRANCE.
- SURFACE WATER - ALL SURFACE WATER FLOWING TO OR DIVERTED TOWARD CONSTRUCTION ENTRANCES SHALL BE PIPED THROUGH THE ENTRANCE, MAINTAINING POSITIVE DRAINAGE. PIPE INSTALLED THROUGH THE STABILIZED CONSTRUCTION ENTRANCE SHALL BE PROTECTED WITH A MOUNTABLE BERM WITH 5:1 SLOPES AND A MINIMUM OF 6" OF STONE OVER THE PIPE. PIPE HAS TO BE SIZED ACCORDING TO THE DRAINAGE. WHEN THE SCE IS LOCATED AT A HIGH SPOT AND HAS NO DRAINAGE TO CONVEY A PIPE WILL NOT BE NECESSARY. PIPE SHOULD BE SIZED ACCORDING TO THE AMOUNT OF RUNOFF TO BE CONVEYED. A 6" MINIMUM DIAMETER PIPE WILL BE REQUIRED.
- LOCATION - A STABILIZED CONSTRUCTION ENTRANCE SHALL BE LOCATED AT EVERY POINT WHERE CONSTRUCTION TRAFFIC ENTERS OR LEAVES A CONSTRUCTION SITE. VEHICLES LEAVING THE SITE MUST TRAVEL OVER THE ENTIRE LENGTH OF THE STABILIZED CONSTRUCTION ENTRANCE.

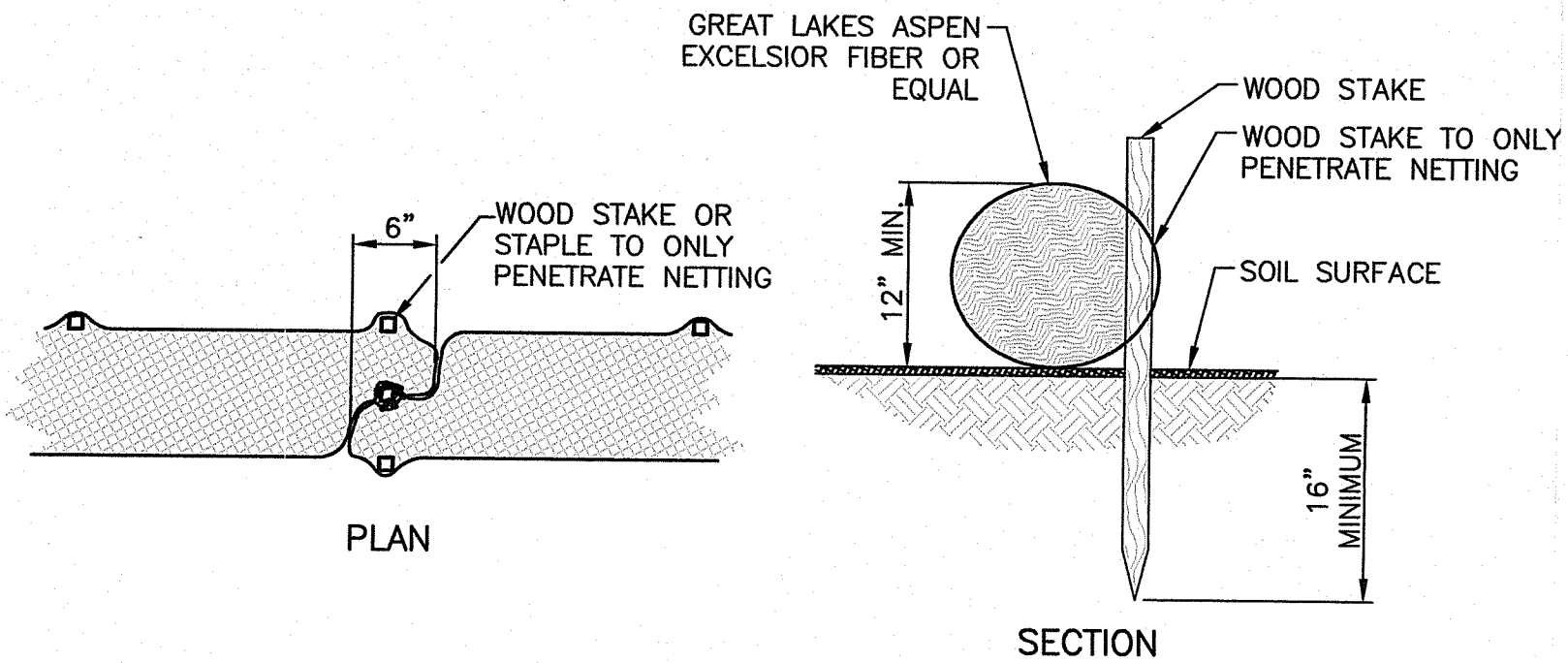

C
C-4 **SEDIMENT LOG PERIMETER PROTECTION**
NTS

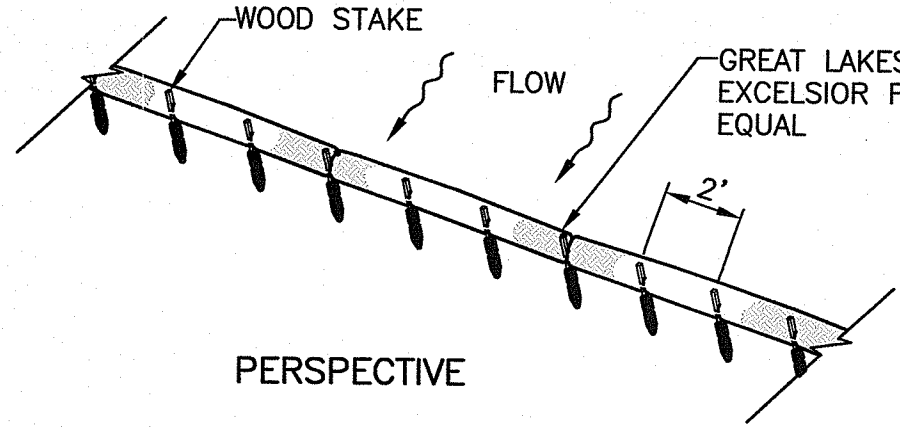

E
C-4 **TYPICAL "MAT" BRIDGE FOR TEMPORARY WETLAND CROSSING**
NTS

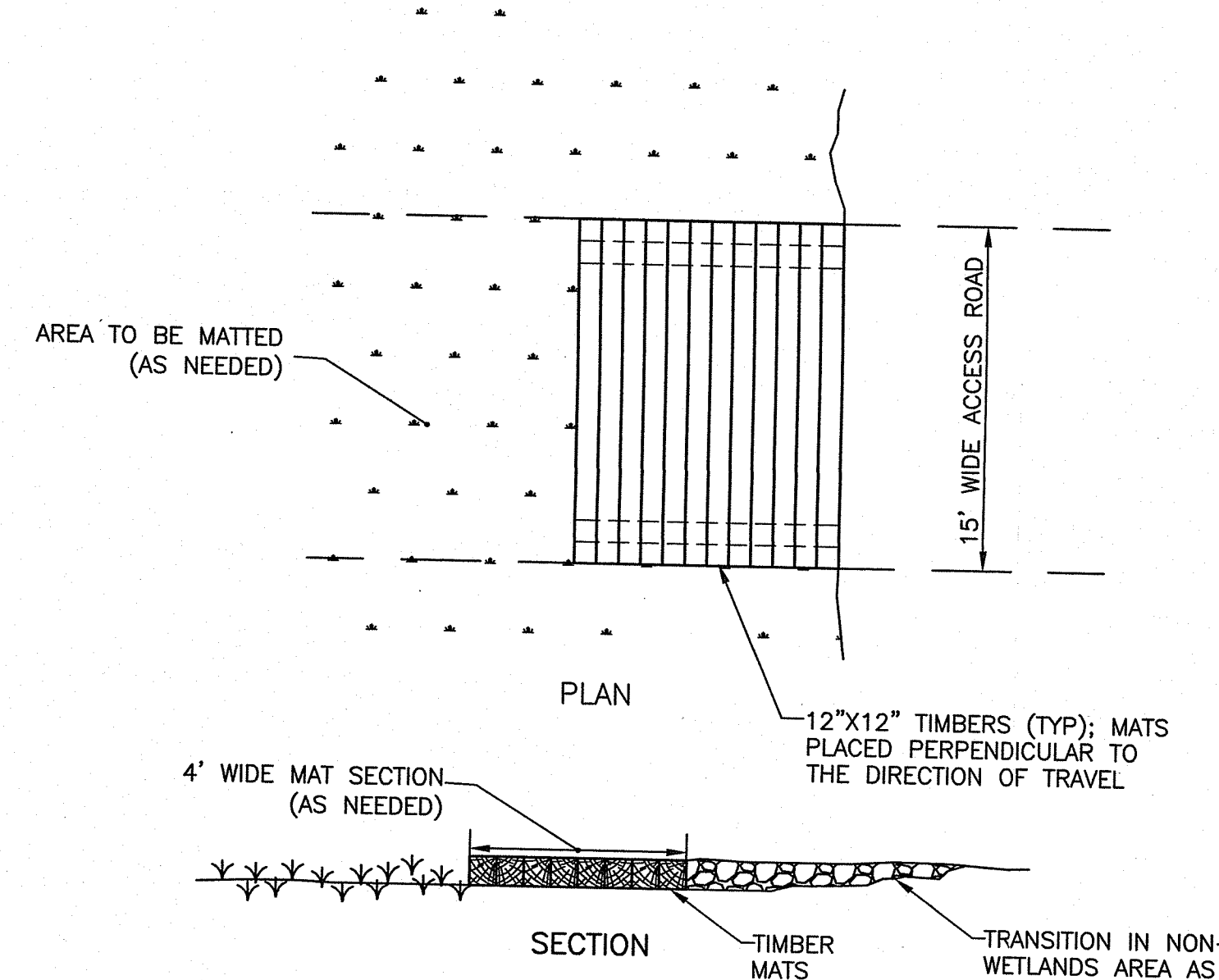

- NOTES:**
- TO BE INSTALLED IF NECESSARY TO PREVENT RUTTING TO DREDGE AREA.
 - THIS DETAIL SHOWS TYPICAL DIMENSION. SOME CONTRACTORS SWAMP MATS ARE DIMENSIONALLY DIFFERENT.
 - DEPENDENT ON SITE CONDITIONS, MULTIPLE LAYERS OF SWAMP MATS MAY BE INSTALLED.

DEPARTMENT OF ENVIRONMENTAL MANAGEMENT
 OFFICE OF WATER RESOURCES
 FRESHWATER WETLANDS PROGRAM
 APPROVED WITH CONDITIONS
 AS SPECIFIED IN THE LETTER OF APPROVAL
 DATED FEB 11 2022 FILE # 20-0126
 NO CHANGES ALLOWED WITHOUT PRIOR APPROVAL
 APPROVED PLANS MUST BE AT CONSTRUCTION SITE
Matthew D. Wenzel

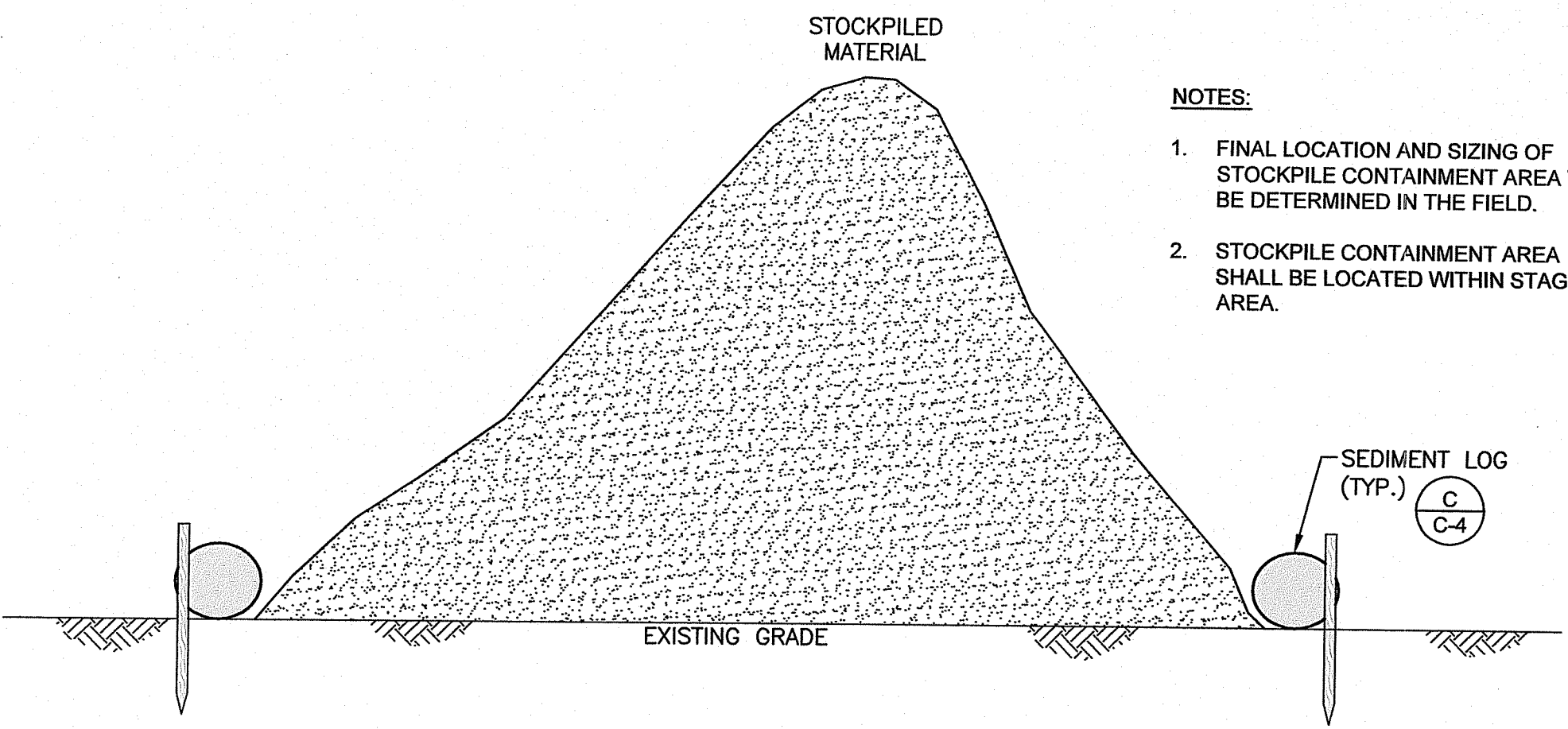

B
C-4 **DEWATERING STOCKPILE CONTAINMENT DETAIL**
NTS

- NOTES:**
- FINAL LOCATION AND SIZING OF STOCKPILE CONTAINMENT AREA TO BE DETERMINED IN THE FIELD.
 - STOCKPILE CONTAINMENT AREA SHALL BE LOCATED WITHIN STAGING AREA.

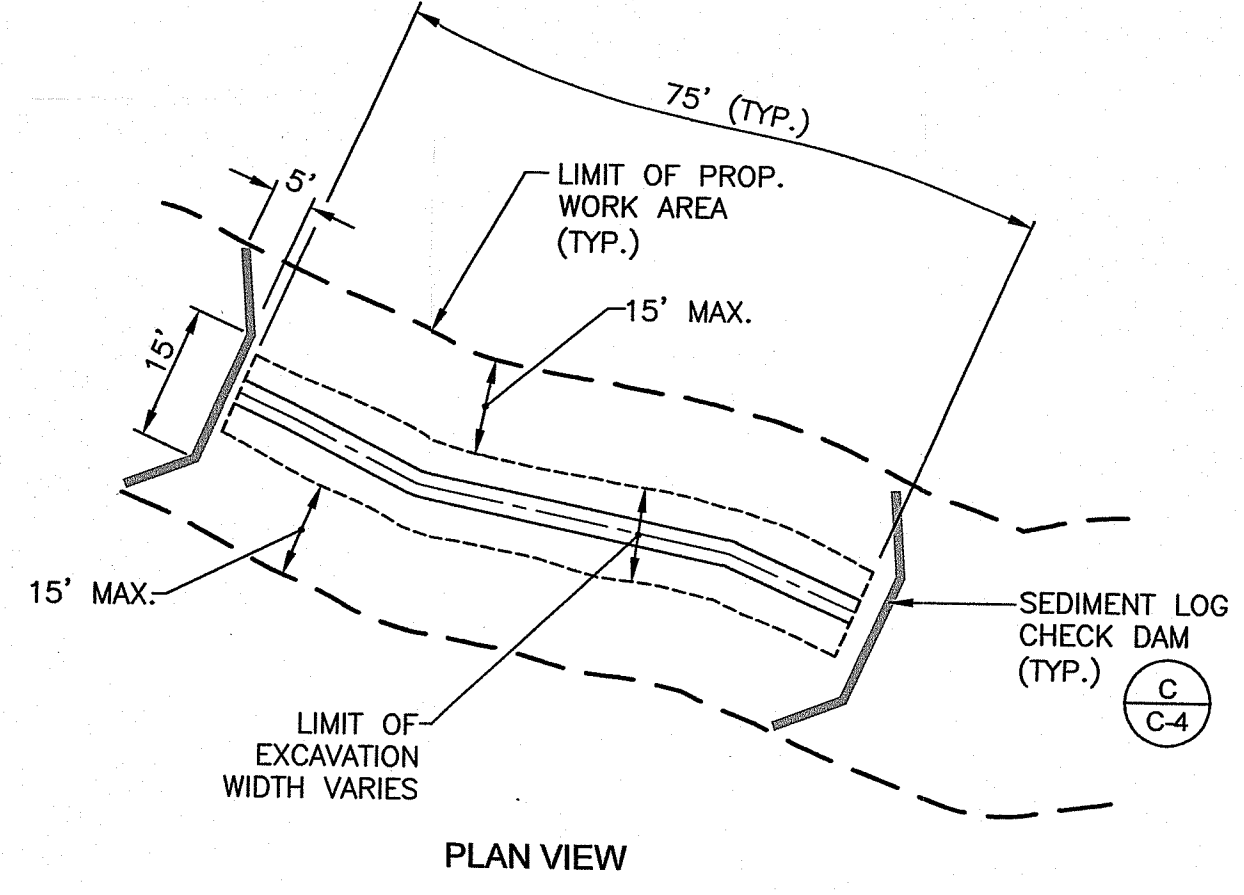

D
C-4 **TYPICAL WORK AREA**
NTS

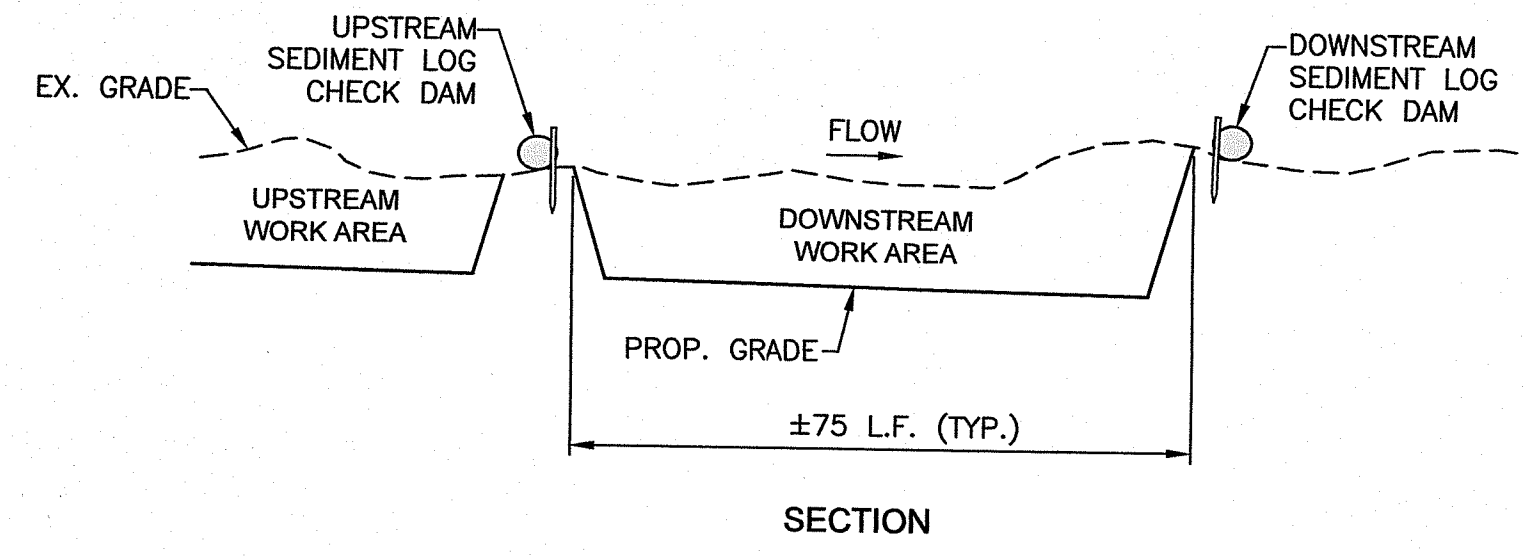

PROPOSED WORK SEQUENCE

- INSTALL UPSTREAM SEDIMENT LOG CHECK DAM.
- EXCAVATE UPSTREAM WORK AREA.
- INSTALL DOWNSTREAM SEDIMENT LOG CHECK DAM.
- EXCAVATE DOWNSTREAM WORK AREA.
- REMOVE UPSTREAM SEDIMENT LOG CHECK DAM AT LEAST 3 DAYS AFTER CEASING WORK IN UPSTREAM WORK AREA.
- EXCAVATE TO CONNECT UPSTREAM WORK AREA TO DOWNSTREAM WORK AREA.
- REMOVE DOWNSTREAM SEDIMENT LOG CHECK DAM AT LEAST 3 DAYS AFTER CEASING WORK IN DOWNSTREAM WORK AREA.

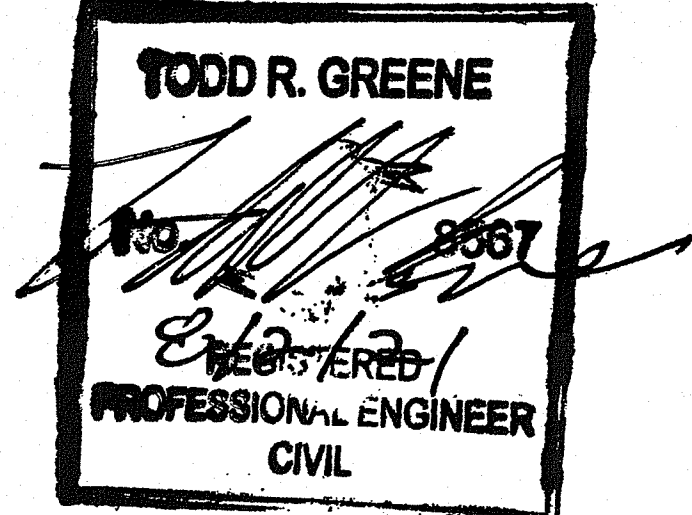

NO.	Revision #1 per RIDEM Comments dated 6/23/2021	RAC	7/6/2021
NO.	ISSUE/DESCRIPTION	BY	DATE

UNLESS SPECIFICALLY STATED BY WRITTEN AGREEMENT, THIS DRAWING IS THE SOLE PROPERTY OF GZA GEOENVIRONMENTAL, INC. (GZA). THE INFORMATION SHOWN ON THE DRAWING IS SOLELY FOR USE BY GZA'S CLIENT OR THE CLIENT'S DESIGNATED REPRESENTATIVE FOR THE SPECIFIC PROJECT AND LOCATION IDENTIFIED ON THE DRAWING. THE DRAWING SHALL NOT BE TRANSFERRED, REUSED, COPIED, OR ALTERED IN ANY MANNER FOR USE AT ANY OTHER LOCATION OR FOR ANY OTHER PURPOSE WITHOUT THE PRIOR WRITTEN CONSENT OF GZA. ANY EXPRESS OR IMPLIED WARRANTIES, INCLUDING BUT NOT LIMITED TO, THE IMPLIED WARRANTIES OF MERCHANTABILITY AND FITNESS FOR A PARTICULAR PURPOSE, ARE HEREBY DISCLAIMED. GZA WILL BE AT THE USER'S SOLE RISK AND WITHOUT ANY RISK OR LIABILITY TO GZA.

RUNNINS RIVER TRIBUTARY STREAM RESTORATION
CITY OF EAST PROVIDENCE PARCEL
EAST PROVIDENCE, RI

DETAILS

PREPARED BY: GZA GeoEnvironmental, Inc. Engineers and Scientists www.gza.com	PREPARED FOR: CITY OF EAST PROVIDENCE PUBLIC WORKS, ENGINEERING DIVISION 145 TAUNTON AVENUE EAST PROVIDENCE, RI 02914		
PROJ MGR: SRT	REVIEWED BY: SDR	CHECKED BY: TEJ	DRAWING
DESIGNED BY: RTS	DRAWN BY: NG/EDM	SCALE: AS NOTED	C-4
DATE: MARCH, 2020	PROJECT NO: 15.0166666.00	REVISION NO:	SHEET NO. 01 OF 04

Environmental Management
AUG 27 2021
Office of Water Resources